

MINUTES OF THE BOARD OF SUPERVISORS
COUNTY OF RIVERSIDE, STATE OF CALIFORNIA



2-8

On motion of Supervisor Tavaglione, seconded by Supervisor Jeffries and duly carried by unanimous vote, IT WAS ORDERED that the recommendation from Transportation & Land Management Agency/Transportation regarding the Adoption of Resolution 2014-022 Accepting Portions of Various Roads for Public Use in the Tenaja Community Services District in the Tenaja Area, 1st/1st District, is taken off calendar.

I hereby certify that the foregoing is a full true, and correct copy of an order made and entered on March 11, 2014 of Supervisors Minutes.

WITNESS my hand and the seal of the Board of Supervisors
Dated: March 11, 2014
Kecia Harper-Ihem, Clerk of the Board of Supervisors, in
and for the County of Riverside, State of California.

(seal)

By: *Terrina Cannon* Deputy

AGENDA NO.
2-8

xc: Transp.

**SUBMITTAL TO THE BOARD OF SUPERVISORS
COUNTY OF RIVERSIDE, STATE OF CALIFORNIA**

806B



FROM: TLMA - Transportation Department

SUBMITTAL DATE:
December 24, 2013

SUBJECT: Resolution No. 2014-022, Accepting Portions of Various Roads for Public Use in the Tenaja Community Services District in the Tenaja Area. 1st/1st District. [\$0]

RECOMMENDED MOTION: That the Board of Supervisors adopt Resolution No. 2014-022, accepting portions of various roads for public road and utility uses in the Tenaja Community Services District.

BACKGROUND:

Summary

The Tenaja Community Services District has requested the acceptance of various roads within the Tenaja Community Service District area, which have not been previously accepted. The acceptance of these roads will provide accepted public access and utility use, but will not become a part of the Maintained Road System pursuant to Section 941 of the Streets and Highway Code.

Juan C. Perez
Director of Transportation and Land Management

WJH
Attachments: Resolution 2014-022
Exhibit "A"

FORM APPROVED COUNTY COUNSEL
DATE 12/18/13
BY: PATRICIA MUNROE

REVIEWED BY EXECUTIVE OFFICE
DATE Alex Gann
Alex Gann
Departmental Concurrence

Dept't Recomm.:
Per Exec. Ofc.:

Consent
 Consent
 Policy
 Policy

2013 DEC 31 11:11:13
CLERK OF SUPERVISORS
COUNTY OF RIVERSIDE, CALIFORNIA

Prev. Agn. Ref. | District: 1/1 | Agenda Number:

**ATTACHMENTS FILED
WITH THE CLERK OF THE BOARD**

2-8

2
3 **RESOLUTION NO. 2014-022**

4 ACCEPTING PORTIONS OF VARIOUS ROADS IN THE TENAJA COMMUNITY SERVICES
5 DISTRICT IN THE TENAJA AREA
6 (1st Supervisorial District)
7

8 **WHEREAS**, the hereinafter described roads were offered for dedication for public road
9 and utility purposes on the maps and documents hereinafter-referred to, which offers of
10 dedication have not been previously accepted for public use by the County of Riverside, now,
11 therefore;

12 **BE IT RESOLVED, DETERMINED, AND ORDERED** by the Board of Supervisors of the
13 County of Riverside, State of California, in regular session assembled on _____, 2014
14 that this Board accepts said offers of dedication and recognizes that these roads are public
15 roads open for use by the general public;

16 **BE IT FURTHER RESOLVED, FOUND, DETERMINED, AND ORDERED** that this
17 acceptance is for the purpose of vesting title in the County of Riverside on behalf of the public
18 for public road and utility uses, and is not an acceptance of the roads into the County
19 Maintained Road System pursuant to Section 941 of the Streets and Highways Code and that
20 said roads will not become part of the County Maintained Road System unless subsequently
21 accepted into said Maintained Road System by a resolution adopted by this Board.

22 Said roads are in the County of Riverside, State of California, and are described as
23 follows:

24 **Calle De Lina** (See Exhibit "A")

25 That portion of Calle De Lina (60.00 feet wide) shown as "Road Easement" on Parcel
26 Map No. 13,816 filed in Book 86, Pages 36 through 38, inclusive of Parcel Maps, Records of
27 Riverside County, California.
28

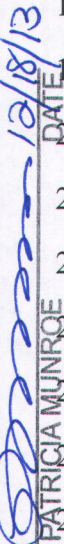
FORM APPROVED COUNTY COUNSEL
BY:  PATRICIA MUNROE
DATE: 12/18/13

1 **Calle Chiquita** (See Exhibit "A") That portion of Calle Chiquita (60.00 feet wide) shown as
2 "Road Easement" on Parcel Map No. 13,816 filed in Book 86, Pages 36 through 38, inclusive of
3 Parcel Maps, Records of Riverside County, California.

4 **Calle Collado** (See Exhibit "A")

5 That portion of Calle Collado (66.00 feet wide and 33.00 feet wide) shown as "Road
6 Easement" on Parcel Map 13816, filed in Book 86, Pages 36 through 38, inclusive, of Parcel
7 Maps, Records of Riverside County, California.

8 **South Tenaja Road** (See Exhibit "A")

9 That portion of South Tenaja Road (44.00 feet wide) shown as "Road Easement" on
10 Parcel Map No. 8242 filed in Book 46, Page 97, of Parcel Maps, Records of Riverside County,
11 California, and that portion of South Tenaja Road (44.00 feet wide) described as "Roadway
12 Dedications" on Parcel Map No. 6076 filed in Book 14, Page 69, of Parcel Maps, Records of
13 Riverside County, California

14 **Via Abrile** (See Exhibit "A")

15 That portion of Via Abril (30.00 feet wide) shown as "Roadway Dedication" on Parcel Map
16 6076, filed in Book 14, Page 69, of Parcel Maps, Records of Riverside County, California and as
17 described in Declaration of Dedication, recorded September 3, 1974, Official Records of
18 Riverside County, California.

19 **Calle Cielo** (See Exhibit "A")

20 That portion of Calle Cielo (30.00 feet wide) from South Tenaja Road to the intersection
21 of Via Abril, shown on Parcel Map 6076, filed in Book 14, Page 69, of Parcel Maps, Records of
22 Riverside County, California.

23 **Unnamed Road** (See Exhibit "A")

24 Unnamed Road (60.00 feet Wide) shown as Lot "A" on Parcel Map 8372 filed in Book 46,
25 page 81 of Parcel Maps, Records of Riverside County, California.

26 **Avenida Escala** (See Exhibit "A")

27 That portion of Avenida Escala (60.00 feet wide) as described in Declaration of
28 Dedication, recorded September 27, 1973 as Instrument No. 127204, Official Records of the

1 Recorder, Riverside County, California, and shown on Parcel Map 5018 filed in Book 10, Pages
2 19 through 25, inclusive, of Parcel Maps, Records of Riverside County, California.

3 **Avenida Bosque** (See Exhibit "A")

4 That portion of Avenida Bosque (40.00 feet wide) as described in Declaration of
5 Dedication, recorded September 27, 1973 as Instrument No. 127204, Official Records of the
6 Recorder, Riverside County, California, and shown on Parcel Map 5018 filed in Book 10, Pages
7 19 through 25, inclusive, of Parcel Maps, Records of Riverside County, California.

8 **Camino De Paz** (See Exhibit "A")

9 Camino De Paz (60.00 feet Wide) shown as Lots "C" through "F," inclusive, on Parcel
10 Map 11,362 filed in Book 75, Page 53 of Parcel Maps, Records of Riverside County, California.

11 **Aronimink Road** (See Exhibit "A")

12 That portion of Aronimink Road (30.00 feet Wide) as described in Declaration of
13 Dedication, recorded February 29, 1972 as Instrument No. 26282, Official Records of the
14 Recorder, Riverside County, California, and on Parcel Map, filed in Book 5, Pages 55 and 56 of
15 Parcel Maps, Records of Riverside County, California.

16 **Alpine View Lane** (See Exhibit "A")

17 That portion of Alpine View Lane (60.00 feet wide and 30.00 feet wide) as described in
18 Declaration of Dedication, recorded February 29, 1972 as Instrument No. 26282, Official
19 Records of the Recorder, Riverside County, California, and on Parcel Map, filed in Book 5,
20 Pages 55 and 56 of Parcel Maps, Records of Riverside County, California.

21 **Avenida La Cresta** (See Exhibit "A")

22 That portion of Avenida La Cresta (60.00 feet wide and 30.00 feet wide) as described in
23 Certificate of Dedication, recorded August 27, 1973, as Instrument No. 112459, Official Records
24 of Riverside County, California.

25 **Calle Roble** (See Exhibit "A")

26 That portion of Calle Roble (20.00 feet wide) shown as Lots "A" through "D," inclusive, on
27 Parcel Map 9634 filed in Book 40, Page 19 of Parcel Maps, Records of Riverside County
28 California.

1 **Calle Viento** (See Exhibit "A")

2 That portion of Calle Viento (30.00 feet wide) shown as Lot "D" on Parcel Map 7390 filed
3 in Book 46, Pages 98 through 100, inclusive, of Parcel Maps, Records of Riverside County,
4 California.

5 **Corte Colinga** (See Exhibit "A")

6 That portion of Corte Colinga (33.00 feet wide) the west half shown as Lot "C" on Parcel
7 Map 7058 filed in Book 24, Pages 86 and 87, of Parcel Maps, Records of Riverside County,
8 California.

9 **Corona Cala Camino** (See Exhibit "A")

10 That portion of Corona Cala Camino (66.00 feet wide and 33.00 feet wide) as described
11 in Certificate of Dedication, recorded April 9, 1973, as Instrument No.44760, Official Records of
12 Riverside County, California. Excepting those portions lying within Parcel Map No. 9879, filed in
13 Book 58, Pages 6 through 8, inclusive, Parcel Map No. 25821, filed in Book 176, Pages 47
14 through 49, inclusive, Parcel Map No. 5064, filed in Book 8, Page 20, Parcel Map No.8499, filed
15 in Book 55, Pages 20 through 22, inclusive, and Parcel Map No 7391 filed in Book 45, Pages 14
16 through 22, inclusive, of Parcel Maps, Records of Riverside County.

17 **Via Tocon** (See Exhibit "A")

18 Via Tocon (60.00 feet wide) as shown on Parcel Map No. 6600, filed in Book 19, Pages
19 52 through 54, inclusive, of Parcel Maps, Records of Riverside County, California.

20 Excepting therefrom all portions of roads previously accepted by the County of Riverside,
21 State of California.

22 **BE IT FURTHER RESOLVED** that the Clerk of the Board shall cause a certified copy of
23 this resolution to be recorded in the Office of the County Recorder of Riverside County,
24 California.

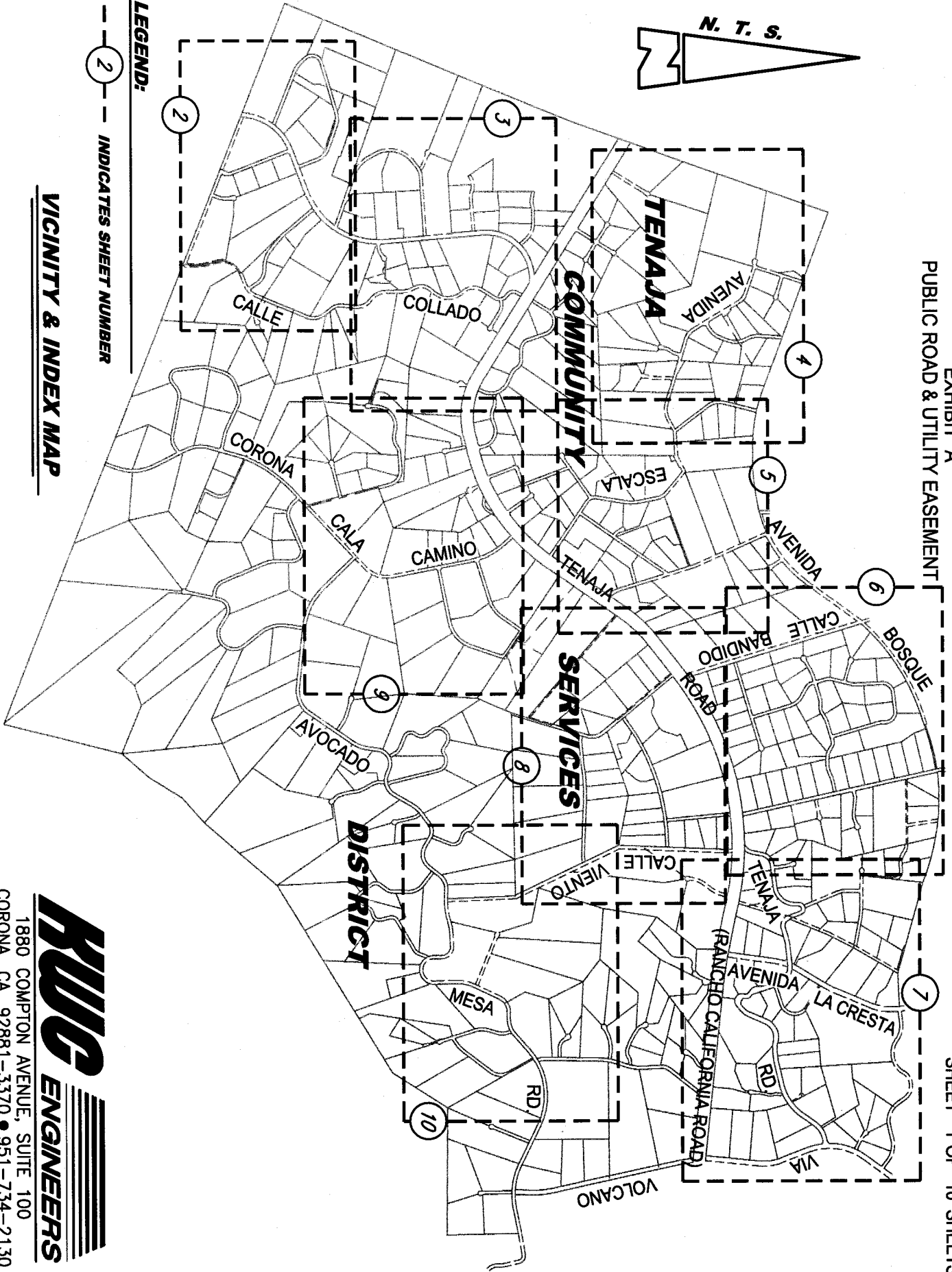

LEGEND:

2 - INDICATES SHEET NUMBER

VICINITY & INDEX MAP



1880 COMPTON AVENUE, SUITE 100
CORONA, CA. 92881-3370 • 951-734-2130

EXHIBIT "A"
PUBLIC ROAD & UTILITY EASEMENT

SHEET 2 OF 10 SHEETS

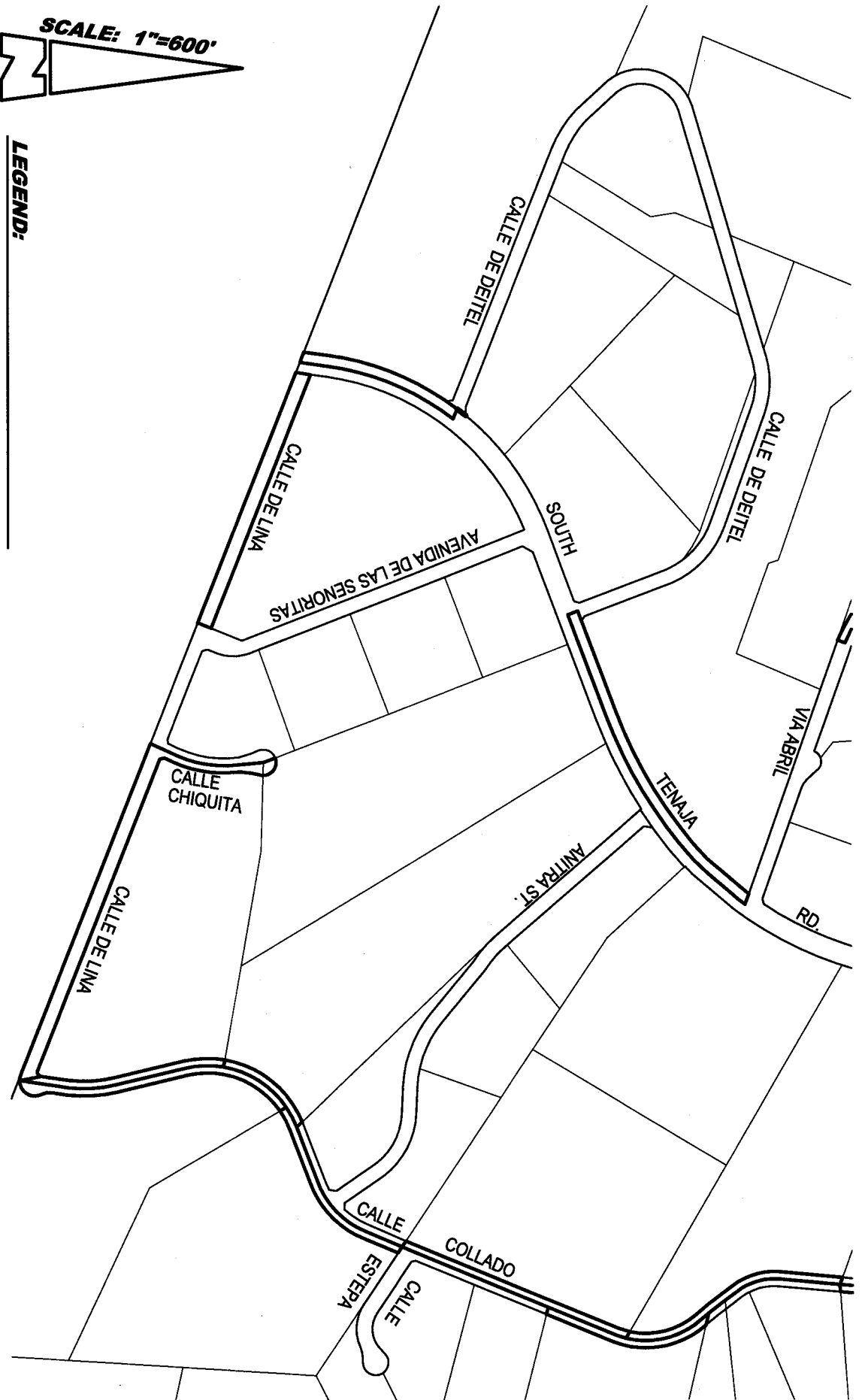

- LEGEND:**
-  ACCEPTED RIGHT OF WAY
 -  EXISTING ROAD EASEMENT
 -  RIGHT OF WAY TO BE ACCEPTED

RWCG
ENGINEERS



1880 COMPTON AVENUE, SUITE 100
CORONA, CA. 92881-3370 • 951-734-2130

EXHIBIT "A"
PUBLIC ROAD & UTILITY EASEMENT

LEGEND:

-  ACCEPTED RIGHT OF WAY
-  EXISTING ROAD EASEMENT
-  RIGHT OF WAY TO BE ACCEPTED

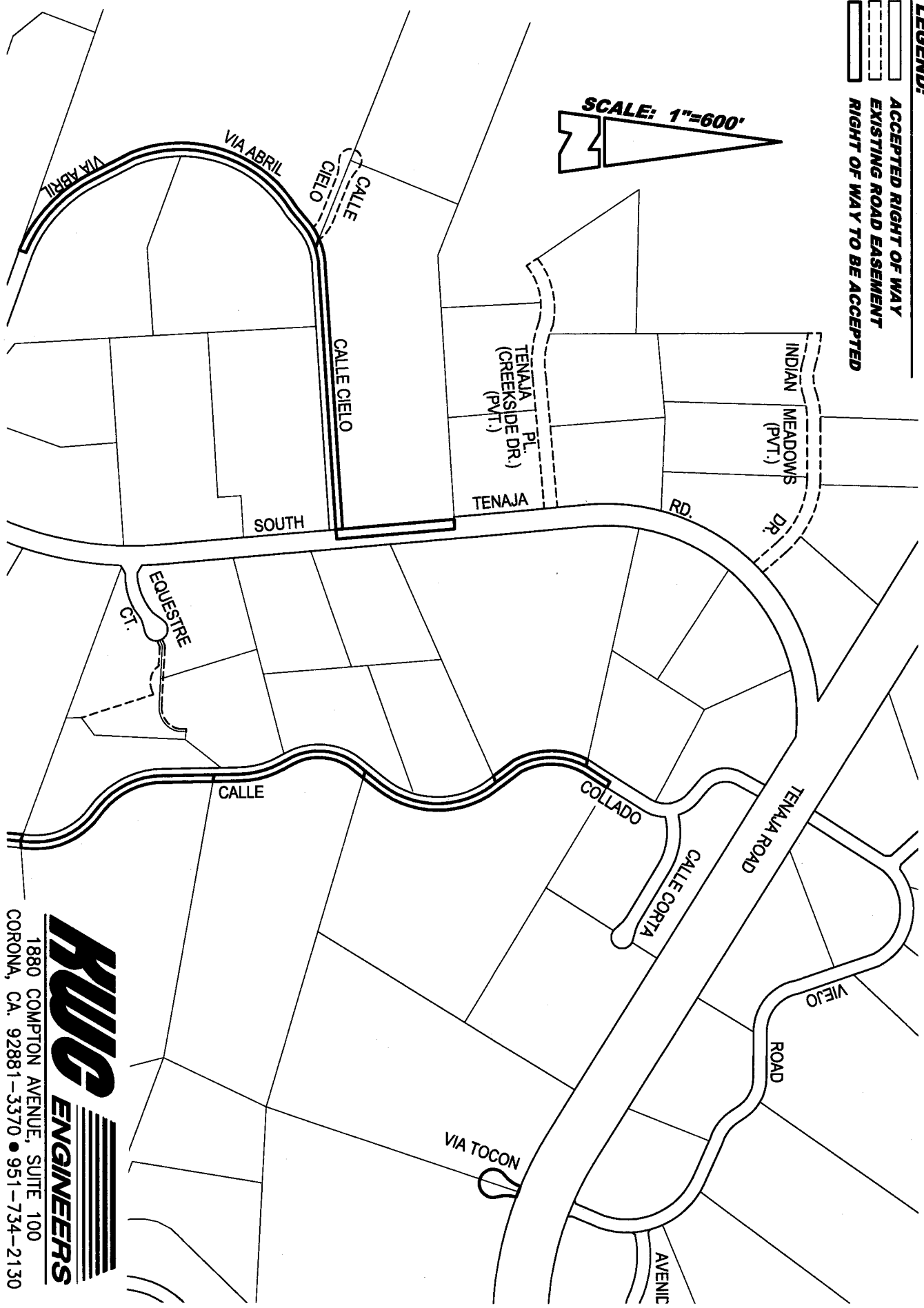
SCALE: 1"=600'



RUG ENGINEERS
1880 COMPTON AVENUE, SUITE 100
CORONA, CA. 92881-3370 • 951-734-2130

EXHIBIT "A"
PUBLIC ROAD & UTILITY EASEMENT

LEGEND:

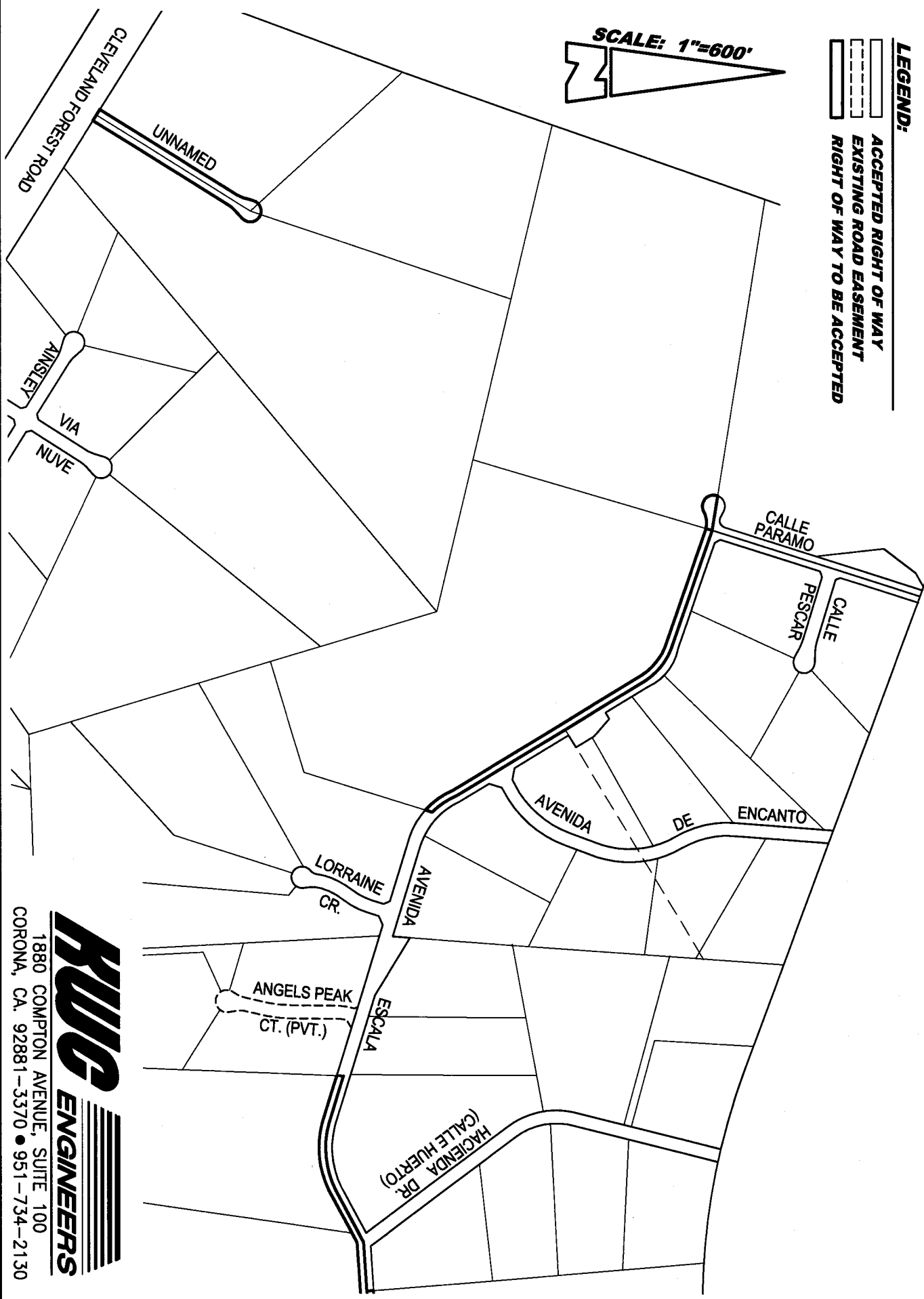

-  ACCEPTED RIGHT OF WAY
-  EXISTING ROAD EASEMENT
-  RIGHT OF WAY TO BE ACCEPTED

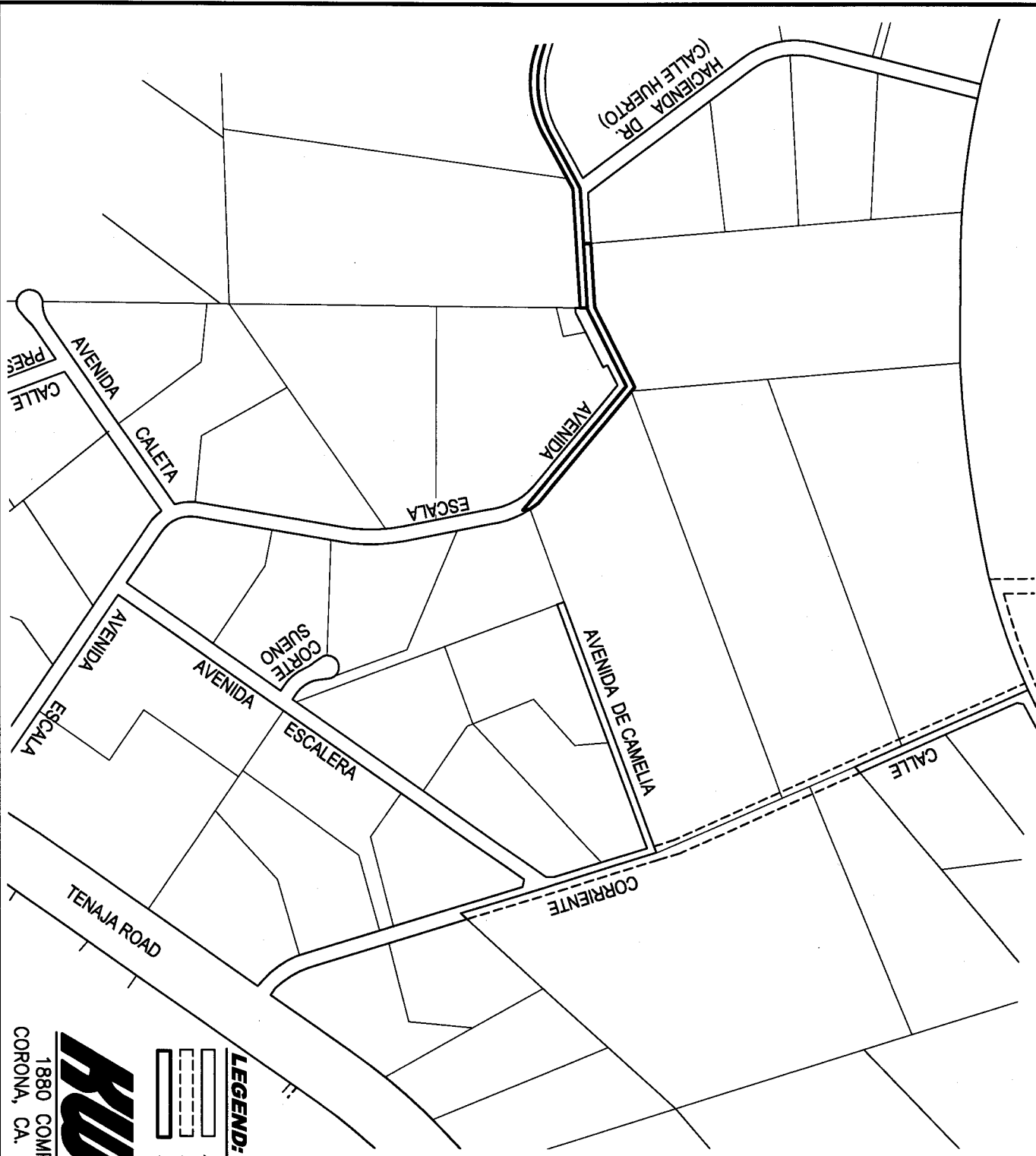

RUG ENGINEERS
1880 COMPTON AVENUE, SUITE 100
CORONA, CA. 92881-3370 • 951-734-2130

EXHIBIT "A"
PUBLIC ROAD & UTILITY EASEMENT



- LEGEND:**
-  ACCEPTED RIGHT OF WAY
 -  EXISTING ROAD EASEMENT
 -  RIGHT OF WAY TO BE ACCEPTED

RWG ENGINEERS
1880 COMPTON AVENUE, SUITE 100
CORONA, CA. 92881-3370 • 951-734-2130



- LEGEND:**
-  ACCEPTED RIGHT OF WAY
 -  EXISTING ROAD EASEMENT
 -  RIGHT OF WAY TO BE ACCEPTED



EXHIBIT "A"
PUBLIC ROAD & UTILITY EASEMENT

SHEET 6 OF 10 SHEETS

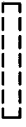

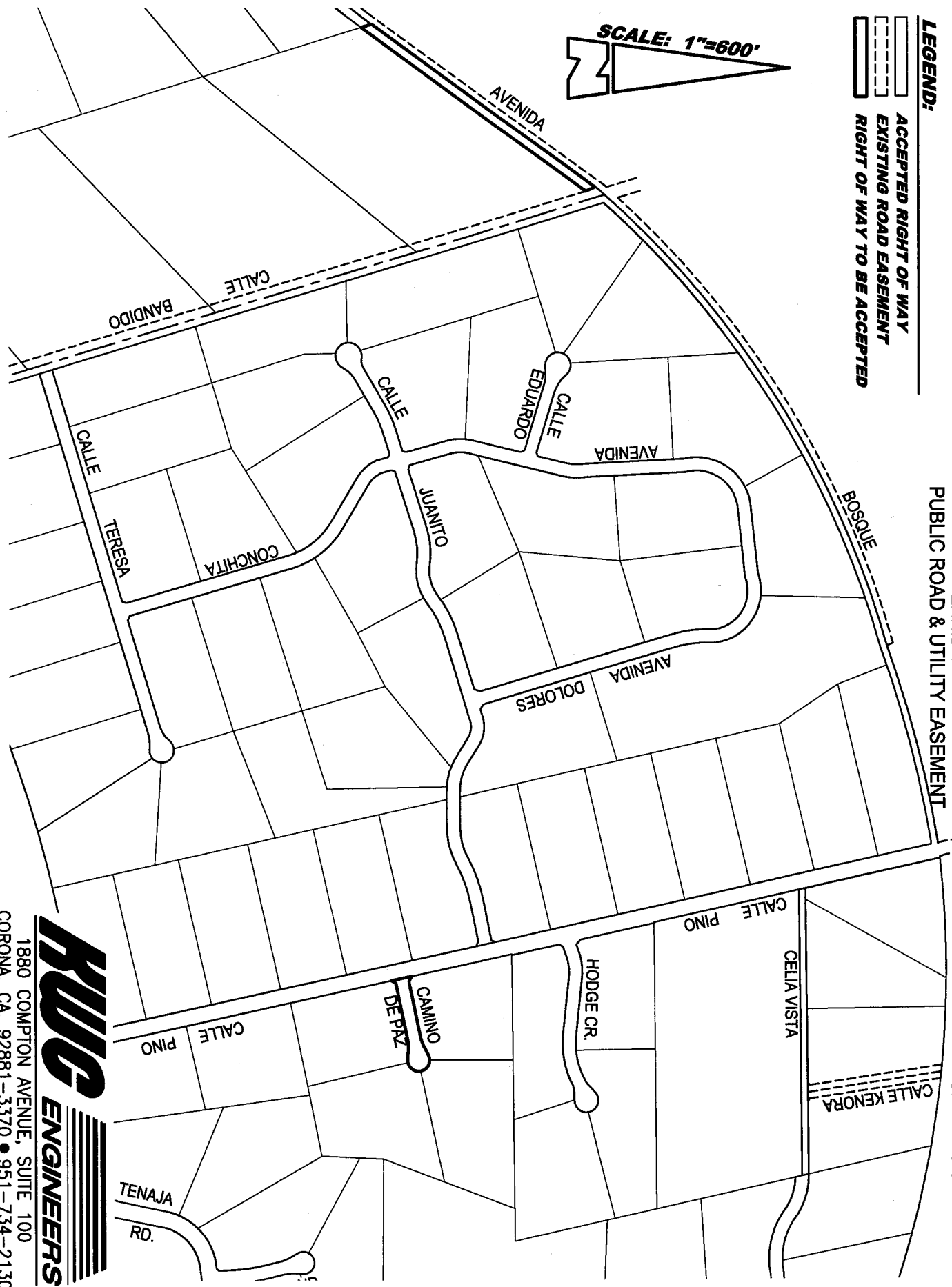
RUG ENGINEERS
 1880 COMPTON AVENUE, SUITE 100
 CORONA, CA. 92881-3370 • 951-734-2130

EXHIBIT "A"
PUBLIC ROAD & UTILITY EASEMENT

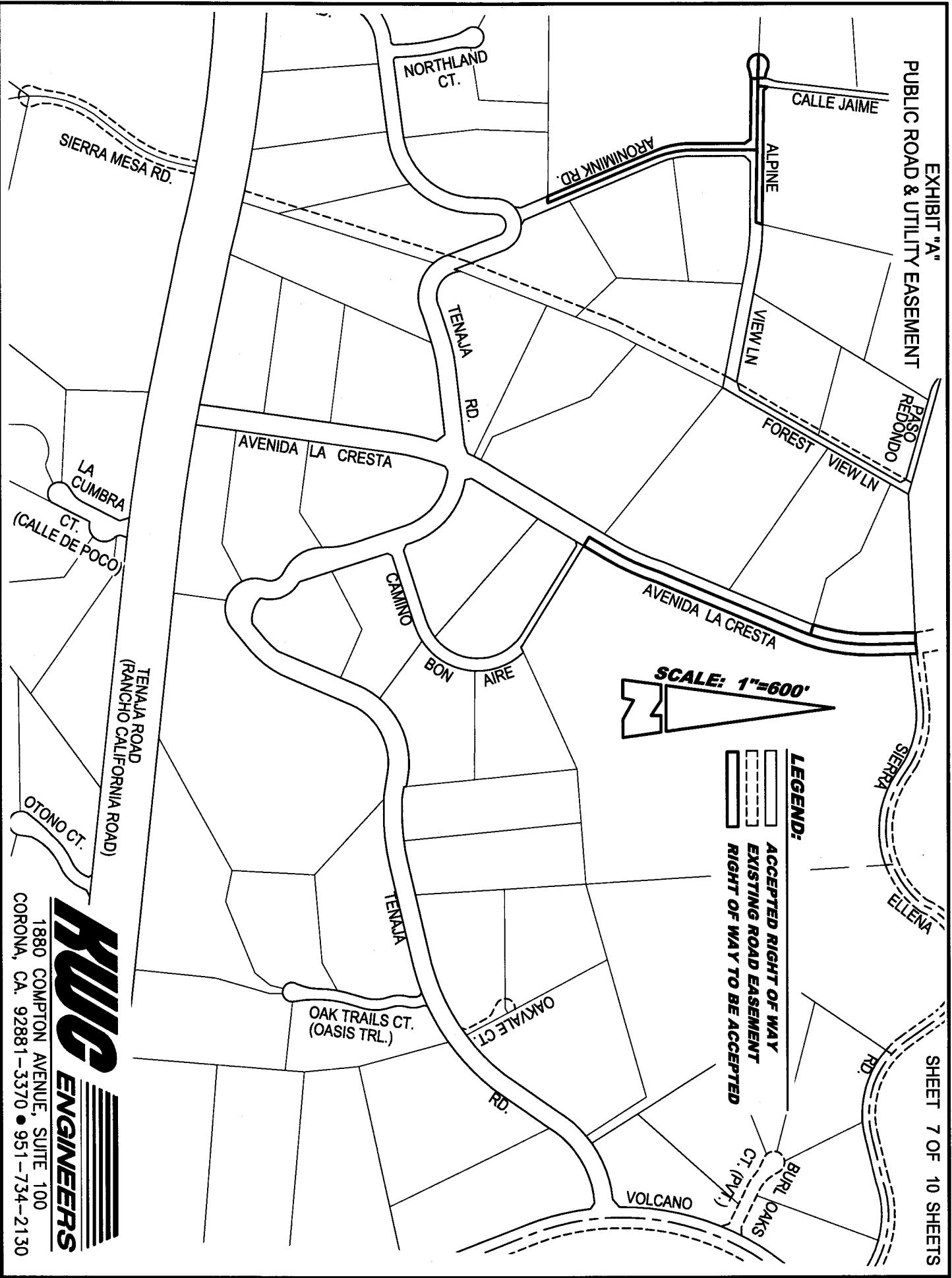

SCALE: 1"=600'

- LEGEND:**
- ACCEPTED RIGHT OF WAY
 - EXISTING ROAD EASEMENT
 - RIGHT OF WAY TO BE ACCEPTED

RUG ENGINEERS
 1880 COMPTON AVENUE, SUITE 100
 CORONA, CA. 92881-3370 • 951-734-2130

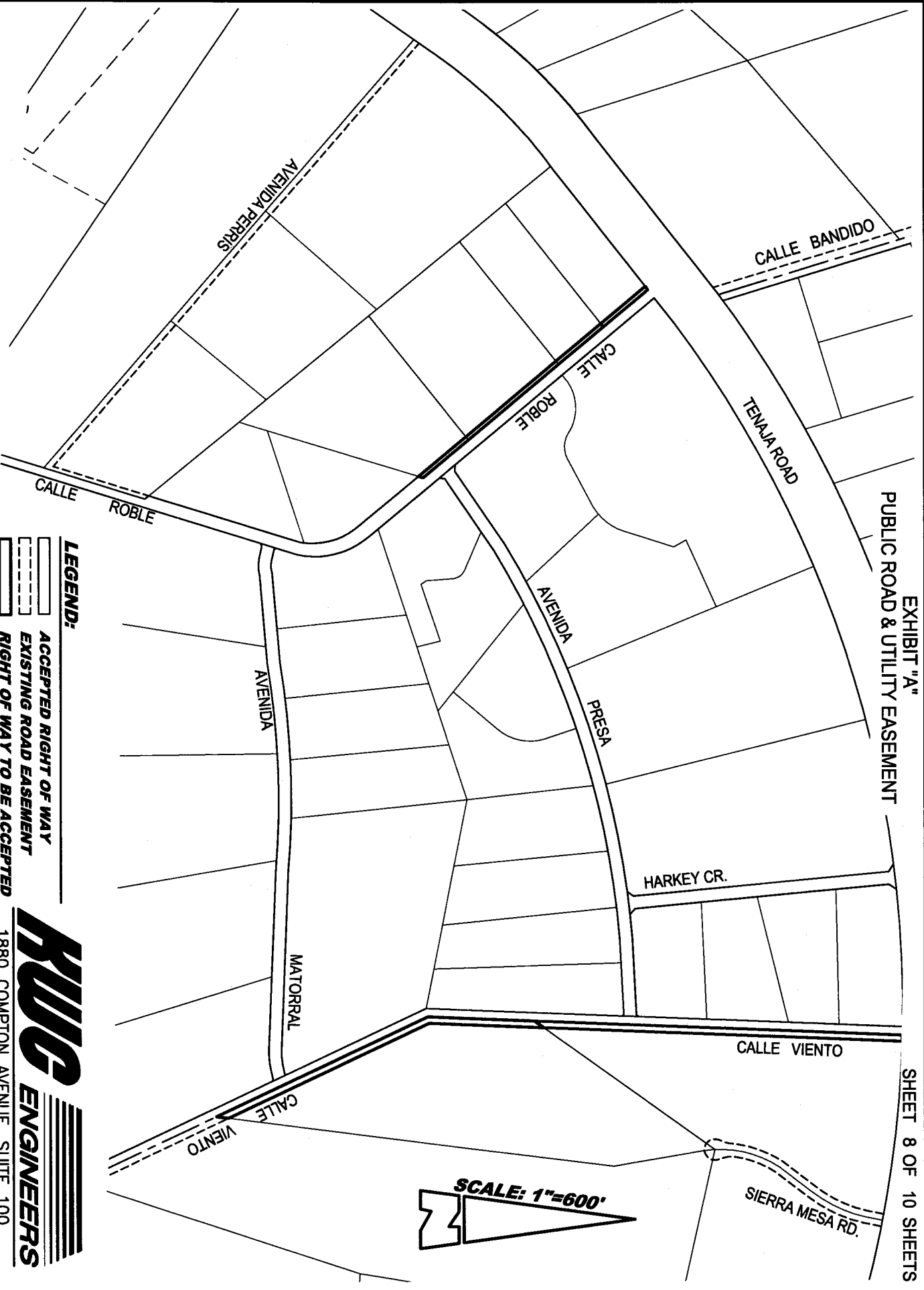

EXHIBIT "A"
PUBLIC ROAD & UTILITY EASEMENT

SHEET 8 OF 10 SHEETS

- LEGEND:**
-  ACCEPTED RIGHT OF WAY
 -  EXISTING ROAD EASEMENT
 -  RIGHT OF WAY TO BE ACCEPTED



RUG ENGINEERS
 1880 COMPTON AVENUE, SUITE 100
 CORONA, CA. 92881-3370 • 951-734-2130

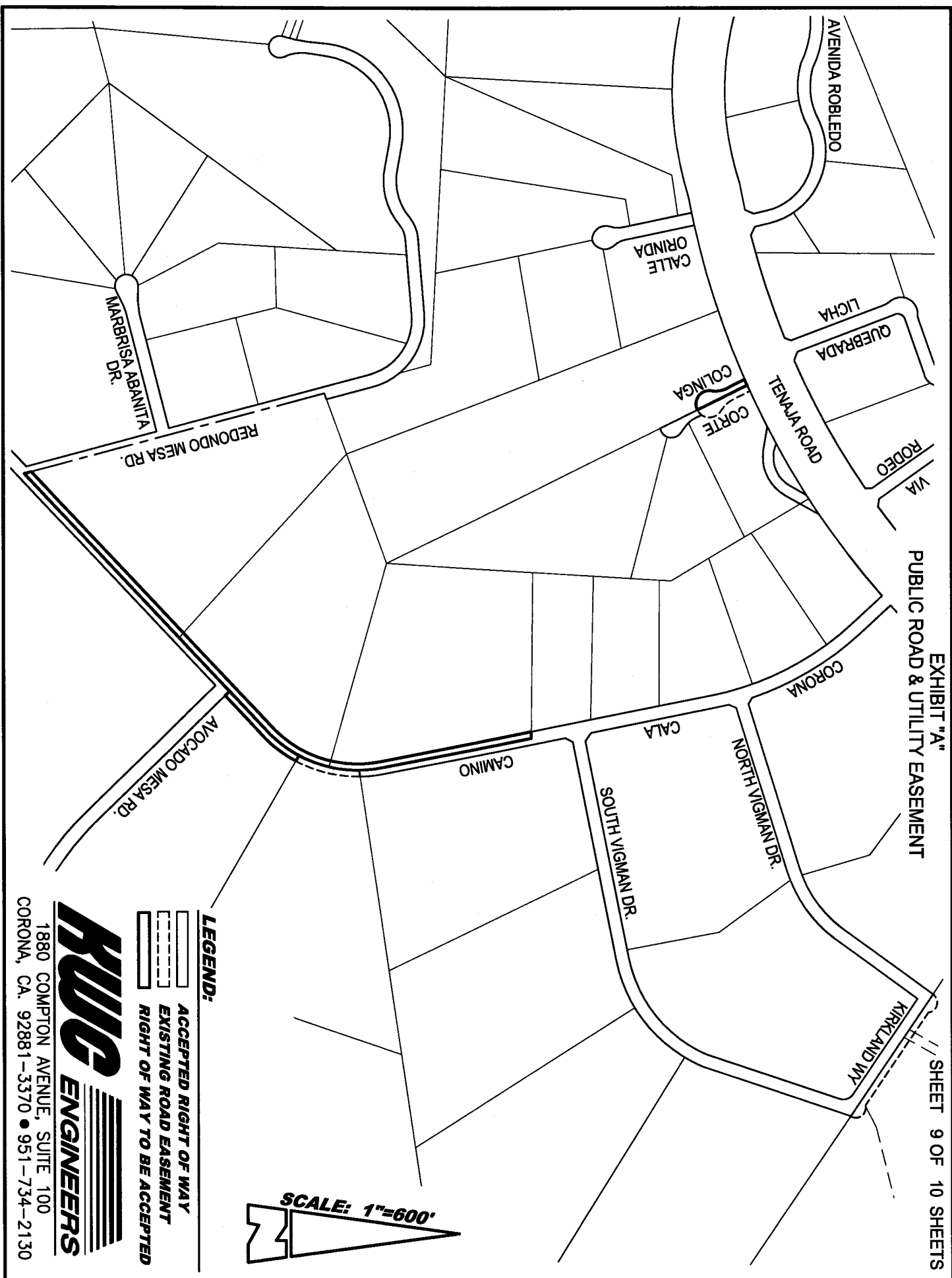

EXHIBIT "A"
PUBLIC ROAD & UTILITY EASEMENT

SHEET 9 OF 10 SHEETS

LEGEND:



-  ACCEPTED RIGHT OF WAY
-  EXISTING ROAD EASEMENT
-  RIGHT OF WAY TO BE ACCEPTED



RUG ENGINEERS
 1880 COMPTON AVENUE, SUITE 100
 CORONA, CA. 92881-3370 • 951-734-2130

EXHIBIT "A"
PUBLIC ROAD & UTILITY EASEMENT

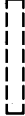
SHEET 10 OF 10 SHEETS

- LEGEND:**
-  ACCEPTED RIGHT OF WAY
 -  EXISTING ROAD EASEMENT
 -  RIGHT OF WAY TO BE ACCEPTED

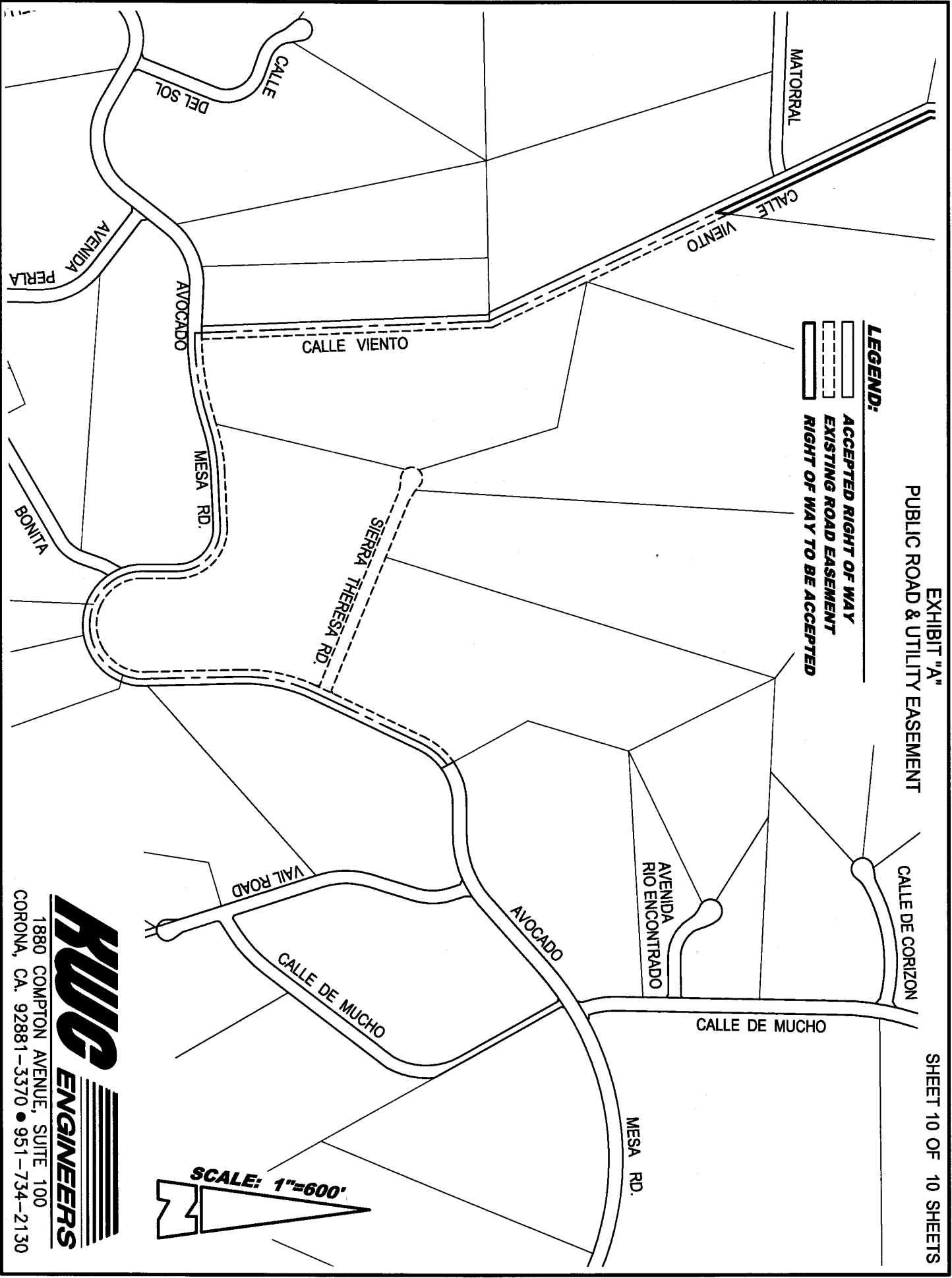

SCALE: 1"=600'

RUG ENGINEERS
1880 COMPTON AVENUE, SUITE 100
CORONA, CA. 92881-3370 • 951-734-2130

VICINITY MAP

FOR WILDOMAR

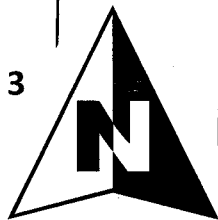

10 N.T.S.
T. 7S, R. 4,5W
S.B.M.

CITY OF MURRIETA

RIVERSIDE COUNTY

SAN DIEGO COUNTY

AREA OF ACCEPTANCES

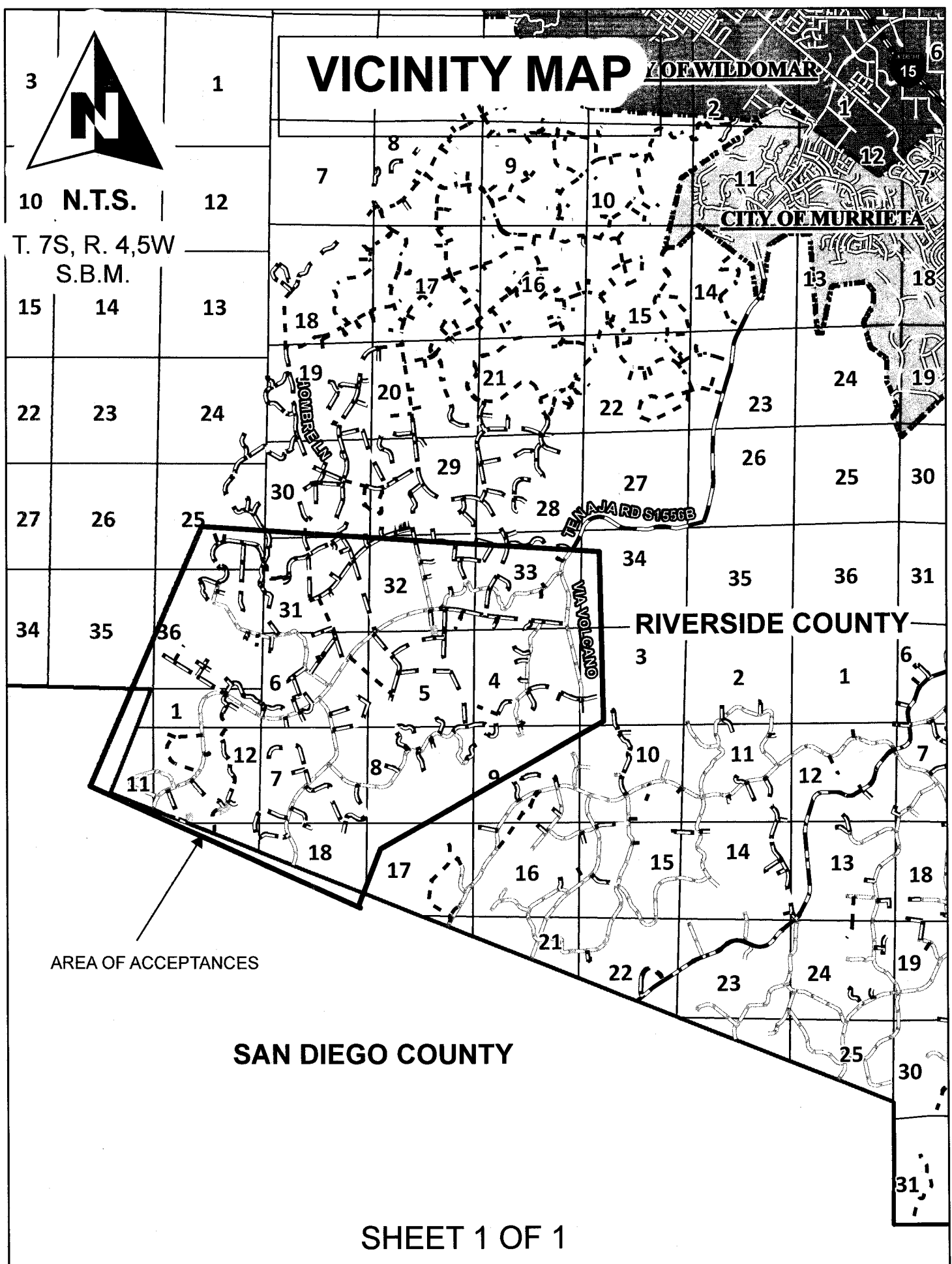

MINUTES OF THE BOARD OF SUPERVISORS
COUNTY OF RIVERSIDE, STATE OF CALIFORNIA



2-13

On motion of Supervisor Jeffries, seconded by Supervisor Ashley and duly carried by unanimous vote, IT WAS ORDERED that the recommendation from Transportation & Land Management Agency/Transportation regarding Adoption of Resolution 2014-022 Accepting Portions of Various Roads for Public Use in the Tenaja Community Services District in the Tenaja Area, 1st/1st District, is continued to Tuesday, April 22, 2014 at 9:00 a.m.

I hereby certify that the foregoing is a full true, and correct copy of an order made and entered on January 28, 2014 of Supervisors Minutes.

WITNESS my hand and the seal of the Board of Supervisors
Dated: January 28, 2014
Kecia Harper-Ihem, Clerk of the Board of Supervisors, in
and for the County of Riverside, State of California.

(seal)

By: Raguel Roseh Deputy

AGENDA NO.
2-13

xc: Transp., COB

2-8 3/11/14

ATTACHMENTS FILED
WITH
THE CLERK OF THE BOARD