

SUBMITTAL TO THE BOARD OF SUPERVISORS  
COUNTY OF RIVERSIDE, STATE OF CALIFORNIA

806B



FROM: TLMA - Transportation Department

SUBMITTAL DATE:  
December 24, 2013

SUBJECT: Resolution No. 2014-022, Accepting Portions of Various Roads for Public Use in the Tenaja Community Services District in the Tenaja Area. 1<sup>st</sup>/1<sup>st</sup> District. [\$0]

RECOMMENDED MOTION: That the Board of Supervisors adopt Resolution No. 2014-022, accepting portions of various roads for public road and utility uses in the Tenaja Community Services District.

BACKGROUND:

Summary

The Tenaja Community Services District has requested the acceptance of various roads within the Tenaja Community Service District area, which have not been previously accepted. The acceptance of these roads will provide accepted public access and utility use, but will not become a part of the Maintained Road System pursuant to Section 941 of the Streets and Highway Code.

Juan C. Perez  
Director of Transportation and Land Management

WJH  
Attachments: Resolution 2014-022  
Exhibit "A"

MINUTES OF THE BOARD OF SUPERVISORS

On motion of Supervisor Ashley, seconded by Supervisor Benoit and duly carried by unanimous vote, IT WAS ORDERED that the above matter is approved as recommended.

Ayes: Jeffries, Tavaglione, Stone, Benoit and Ashley  
Nays: None  
Absent: None  
Date: April 22, 2014  
xc: Transp., Recorder

Kecia Harper-Ihem  
Clerk of the Board  
By:   
Deputy

Prev. Agn. Ref.

District: 1/1

Agenda Number:

ATTACHMENTS FILED  
WITH THE CLERK OF THE BOARD

2-31

FORM APPROVED COUNTY COUNSEL  
DATE: 12/18/13  
BY: PATRICIA MUNROE  
REVIEWED BY EXECUTIVE OFFICE  
DATE: Alex Gam  
Alex Gam  
Departmental Concurrence

Dept't Recomm.:  Consent  Policy  
Per Exec. Ofc.:  Consent  Policy

PLEASE COMPLETE THIS INFORMATION

RECORDING REQUESTED BY:

KECIA HARPER-IHEM, CLERK OF THE BOARD  
RIVERSIDE CO. CLERK OF THE BOARD  
4080 LEMON STREET, 1<sup>ST</sup> FLOOR CAC  
P O BOX 1147 – RIVERSIDE, CA 92502

**MAIL STOP # 1010**

AND WHEN RECORDED MAIL TO:

**RETURN TO: STOP #1010**  
RIVERSIDE COUNTY CLERK OF THE BOARD  
P. O. BOX 1147 – RIVERSIDE, CA 92502

**DOC # 2014-0150653**  
04/25/2014

**Customer Copy Label**

The paper to which this label is  
affixed has not been compared  
with the filed/recorded document

**Larry W Ward**

County of Riverside  
Assessor, County Clerk & Recorder

**THIS SPACE FOR RECORDERS USE ONLY**

**RESOLUTION NO. 2014-022**

Title of Document

**ACCEPTING PORTIONS OF VARIOUS ROADS IN THE TENAJA COMMUNITY SERVICES  
DISTRICT IN THE TENAJA AREA**

**(FIRST SUPERVISORIAL DISTRICT)**

**(Transportation Department ~ Item 2-31 of 04/22/14)**

THIS PAGE ADDED TO PROVIDE ADEQUATE SPACE  
FOR RECORDING INFORMATION

**COPY**

2  
3 **RESOLUTION NO. 2014-022**

4 ACCEPTING PORTIONS OF VARIOUS ROADS IN THE TENAJA COMMUNITY SERVICES  
5 DISTRICT IN THE TENAJA AREA  
6 (1<sup>st</sup> Supervisorial District)  
7

8 **WHEREAS**, the hereinafter described roads were offered for dedication for public road  
9 and utility purposes on the maps and documents hereinafter-referred to, which offers of  
10 dedication have not been previously accepted for public use by the County of Riverside, now,  
11 therefore;

12 **BE IT RESOLVED, DETERMINED, AND ORDERED** by the Board of Supervisors of the  
13 County of Riverside, State of California, in regular session assembled on April 22, 2014,  
14 that this Board accepts said offers of dedication and recognizes that these roads are public  
15 roads open for use by the general public;

16 **BE IT FURTHER RESOLVED, FOUND, DETERMINED, AND ORDERED** that this  
17 acceptance is for the purpose of vesting title in the County of Riverside on behalf of the public  
18 for public road and utility uses, and is not an acceptance of the roads into the County  
19 Maintained Road System pursuant to Section 941 of the Streets and Highways Code and that  
20 said roads will not become part of the County Maintained Road System unless subsequently  
accepted into said Maintained Road System by a resolution adopted by this Board.

Said roads are in the County of Riverside, State of California, and are described as  
23 follows:

24 **Calle De Lina** (See Exhibit "A")

That portion of Calle De Lina (60.00 feet wide) shown as "Road Easement" on Parcel  
Map No. 13,816 filed in Book 86, Pages 36 through 38, inclusive of Parcel Maps, Records of  
Riverside County, California.

FORM APPROVED COUNTY COUNSEL  
BY: PATRICIA GUNDE  
4/15/14  
KDATE

1 **Calle Chiquita** (See Exhibit "A") That portion of Calle Chiquita (60.00 feet wide) shown as  
2 "Road Easement" on Parcel Map No. 13,816 filed in Book 86, Pages 36 through 38, inclusive of  
3 Parcel Maps, Records of Riverside County, California.

4 **Calle Collado** (See Exhibit "A")

5 That portion of Calle Collado (66.00 feet wide and 33.00 feet wide) shown as "Road  
6 Easement" on Parcel Map 13816, filed in Book 86, Pages 36 through 38, inclusive, of Parcel  
7 Maps, Records of Riverside County, California.

8 **Tenaja Road** (See Exhibit "A")

9 That portion of Tenaja Road (44.00 feet wide) shown as "Road Easement" on Parcel Map  
10 No. 8242 filed in Book 46, Page 97, of Parcel Maps, Records of Riverside County, California,  
11 and that portion of Tenaja Road (44.00 feet wide) described as "Roadway Dedications" on  
12 Parcel Map No. 6076 filed in Book 14, Page 69, of Parcel Maps, Records of Riverside County,  
13 California

14 **Via Abril** (See Exhibit "A")

15 That portion of Via Abril (30.00 feet wide) shown as "Roadway Dedication" on Parcel Map  
16 6076, filed in Book 14, Page 69, of Parcel Maps, Records of Riverside County, California and as  
17 described in Declaration of Dedication, recorded September 3, 1974, Official Records of  
18 Riverside County, California.

19 **Calle Cielo** (See Exhibit "A")

20 That portion of Calle Cielo (30.00 feet wide) from South Tenaja Road to the intersection  
21 of Via Abril, shown on Parcel Map 6076, filed in Book 14, Page 69, of Parcel Maps, Records of  
22 Riverside County, California.

23 **Unnamed Road** (See Exhibit "A")

24 Unnamed Road (60.00 feet Wide) shown as Lot "A" on Parcel Map 8372 filed in Book 46,  
25 page 81 of Parcel Maps, Records of Riverside County, California.

1 **Avenida Escala** (See Exhibit "A")

2 That portion of Avenida Escala (60.00 feet wide) as described in Declaration of  
3 Dedication, recorded September 27, 1973 as Instrument No. 127204, Official Records of the  
4 Recorder, Riverside County, California, and shown on Parcel Map 5018 filed in Book 10, Pages  
5 19 through 25, inclusive, of Parcel Maps, Records of Riverside County, California.

6 **Avenida Bosque** (See Exhibit "A")

7 That portion of Avenida Bosque (40.00 feet wide) as described in Declaration of  
8 Dedication, recorded September 27, 1973 as Instrument No. 127204, Official Records of the  
9 Recorder, Riverside County, California, and shown on Parcel Map 5018 filed in Book 10, Pages  
10 19 through 25, inclusive, of Parcel Maps, Records of Riverside County, California.

11 **Camino De Paz** (See Exhibit "A")

12 Camino De Paz (60.00 feet Wide) shown as Lots "C" through "F," inclusive, on Parcel  
13 Map 11,362 filed in Book 75, Page 53 of Parcel Maps, Records of Riverside County, California.

14 **Avenida La Cresta** (See Exhibit "A")

15 That portion of Avenida La Cresta (60.00 feet wide and 30.00 feet wide) as described in  
16 Certificate of Dedication, recorded August 27, 1973, as Instrument No. 112459, Official Records  
17 of Riverside County, California.

18 **Calle Roble** (See Exhibit "A")

19 That portion of Calle Roble (20.00 feet wide) shown as Lots "A" through "D," inclusive, on  
20 Parcel Map 9634 filed in Book 40, Page 19 of Parcel Maps, Records of Riverside County  
21 California.

22 **Calle Viento** (See Exhibit "A")

23 That portion of Calle Viento ( 30.00 feet wide) shown as Lot "D" on Parcel Map 7390 filed  
24 in Book 46, Pages 98 through 100, inclusive, of Parcel Maps, Records of Riverside County,  
25 California, excepting that portion lying easterly of the southerly prolongation of the easterly  
26 boundary line of Parcel 4 of said map.

1 **Corte Colinga** (See Exhibit "A")

2 That portion of Corte Colinga (33.00 feet wide) the west half shown as Lot "C" on Parcel  
3 Map 7058 filed in Book 24, Pages 86 and 87, of Parcel Maps, Records of Riverside County,  
4 California.

5 **Corona Cala Camino** (See Exhibit "A")

6 That portion of Corona Cala Camino (66.00 feet wide and 33.00 feet wide) as described  
7 in Certificate of Dedication, recorded April 9, 1973, as Instrument No.44760, Official Records of  
8 Riverside County, California. Excepting those portions lying within Parcel Map No. 9879, filed in  
9 Book 58, Pages 6 through 8, inclusive, Parcel Map No. 25821, filed in Book 176, Pages 47  
10 through 49, inclusive, Parcel Map No. 5064, filed in Book 8, Page 20, Parcel Map No.8499, filed  
11 in Book 55, Pages 20 through 22, inclusive, and Parcel Map No 7391 filed in Book 45, Pages 14  
12 through 22, inclusive, of Parcel Maps, Records of Riverside County.

13 **Via Tocon** (See Exhibit "A")

14 Via Tocon (60.00 feet wide) as shown on Parcel Map No. 6600, filed in Book 19, Pages  
15 52 through 54, inclusive, of Parcel Maps, Records of Riverside County, California.

16 Excepting therefrom all portions of roads previously accepted by the County of Riverside,  
17 State of California.

18 **BE IT FURTHER RESOLVED** that the Clerk of the Board shall cause a certified copy of  
19 this resolution to be recorded in the Office of the County Recorder of Riverside County,  
20 California.

21 ROLL CALL:

22 Ayes: Jeffries, Tavaglione, Stone, Benoit and Ashley  
23 Nays: None  
24 Absent: None

25 The foregoing is certified to be a true copy of a resolution duly  
26 adopted by said Board of Supervisors on the date therein set forth.

27 KECIA HARPER-IHEM, Clerk of said Board

28 By   
Deputy

EXHIBIT "A"  
PUBLIC ROAD & UTILITY EASEMENT



LEGEND:

--- 2 --- INDICATES SHEET NUMBER

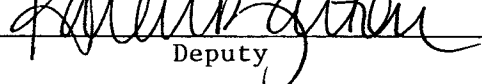
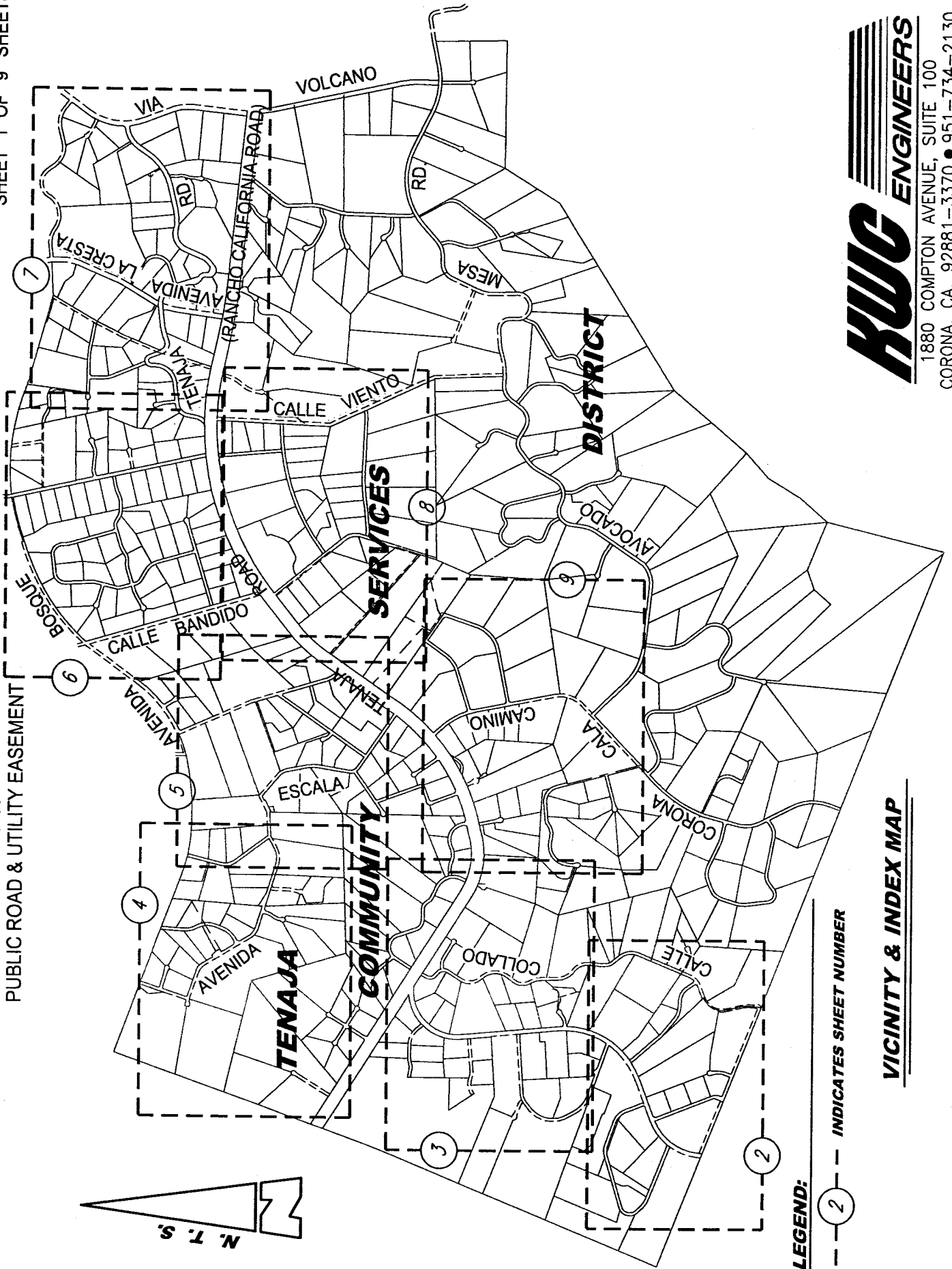
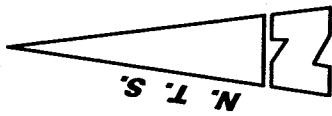
**VICINITY & INDEX MAP**



1880 COMPTON AVENUE, SUITE 100  
CORONA, CA. 92881-3370 • 951-734-2130

EXHIBIT "A"  
PUBLIC ROAD & UTILITY EASEMENT



1880 COMPTON AVENUE, SUITE 100  
CORONA, CA. 92881-3370 • 951-734-2130

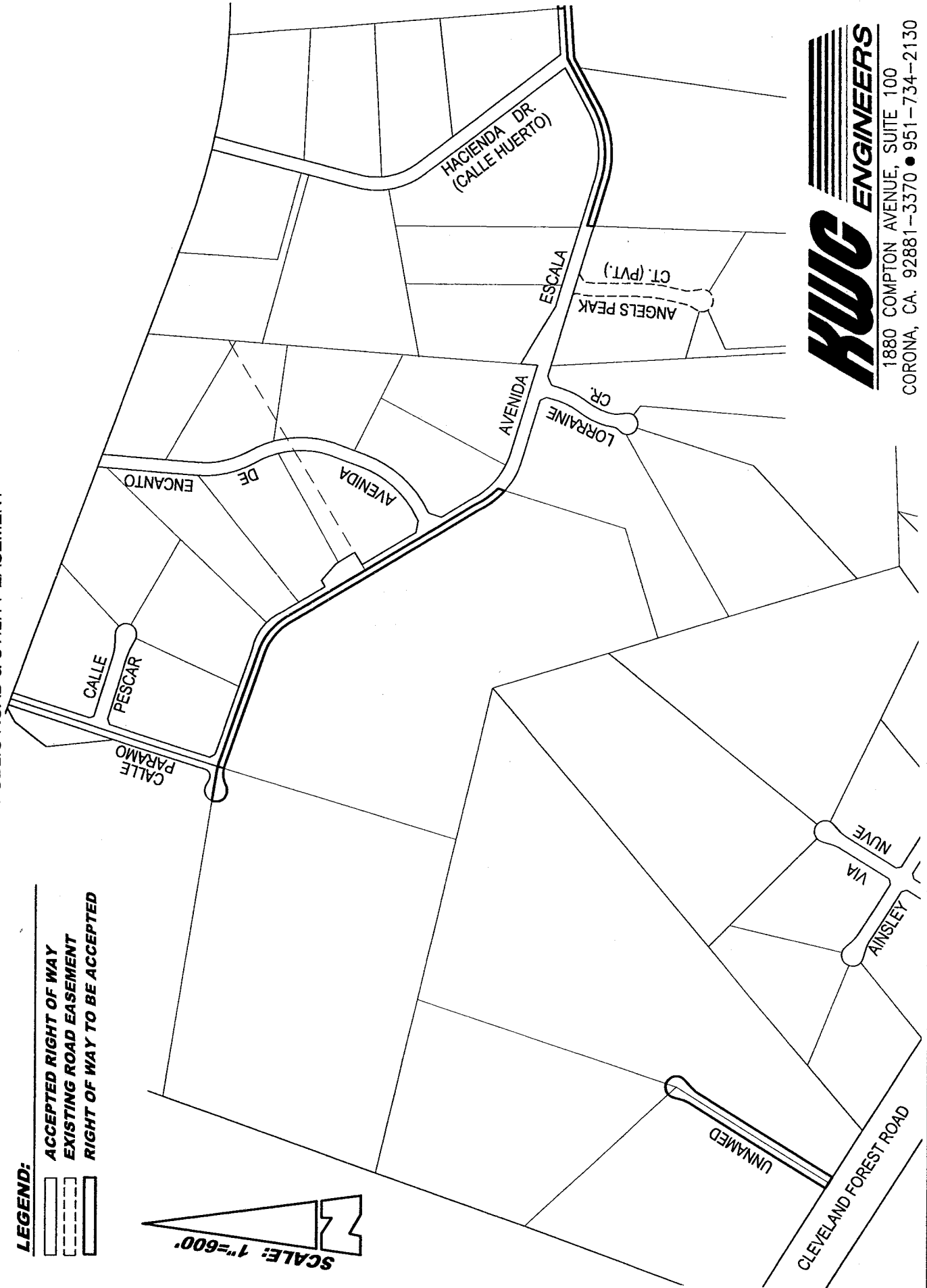



EXHIBIT "A"  
PUBLIC ROAD & UTILITY EASEMENT

- LEGEND:**
- ACCEPTED RIGHT OF WAY
  - EXISTING ROAD EASEMENT
  - RIGHT OF WAY TO BE ACCEPTED

SCALE: 1"=600'



1880 COMPTON AVENUE, SUITE 100  
CORONA, CA. 92881-3370 • 951-734-2130



**LEGEND:**

-  ACCEPTED RIGHT OF WAY
-  EXISTING ROAD EASEMENT
-  RIGHT OF WAY TO BE ACCEPTED



1880 COMPTON AVENUE, SUITE 100  
CORONA, CA. 92881-3370 • 951-734-2130

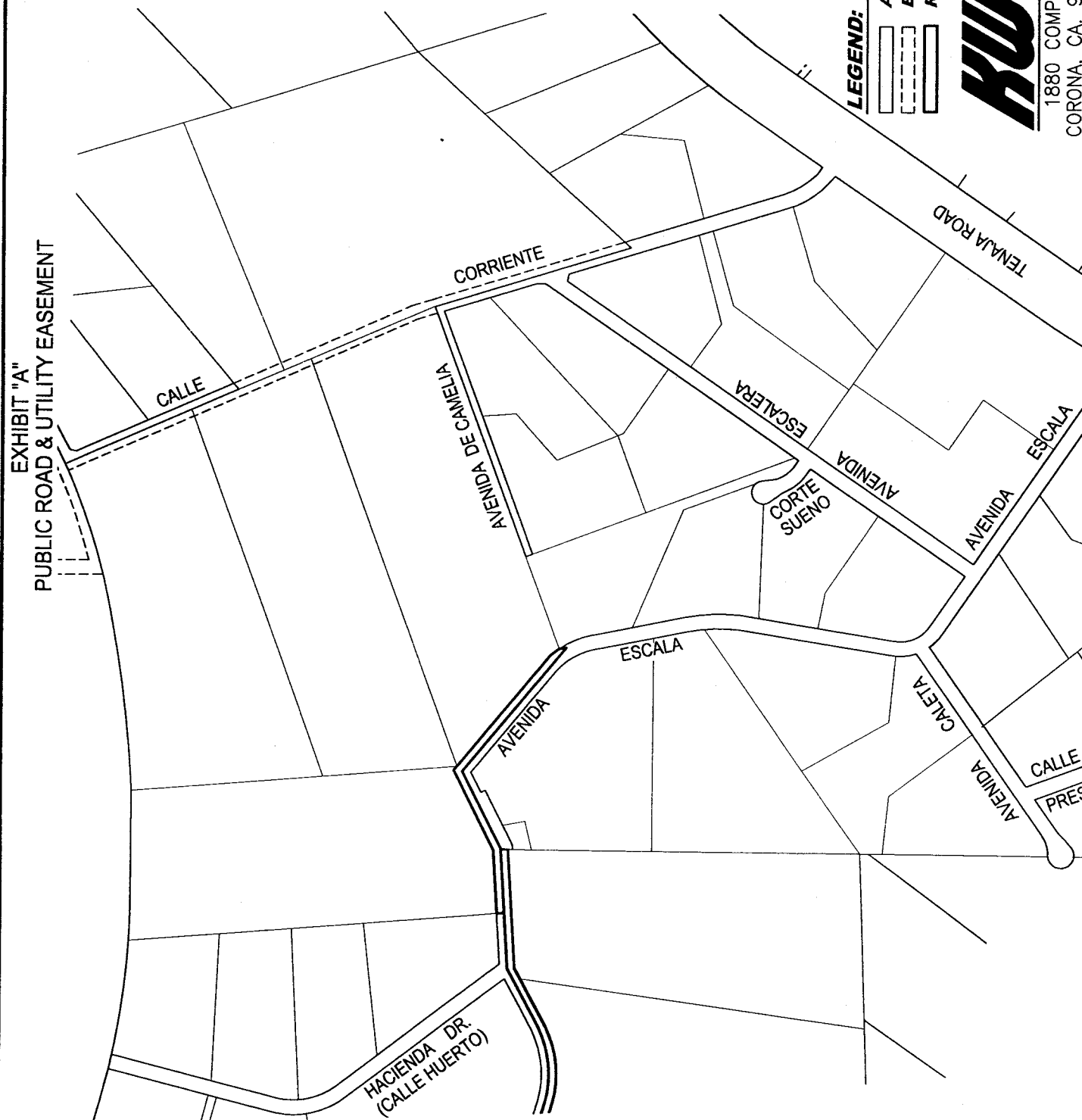

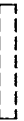

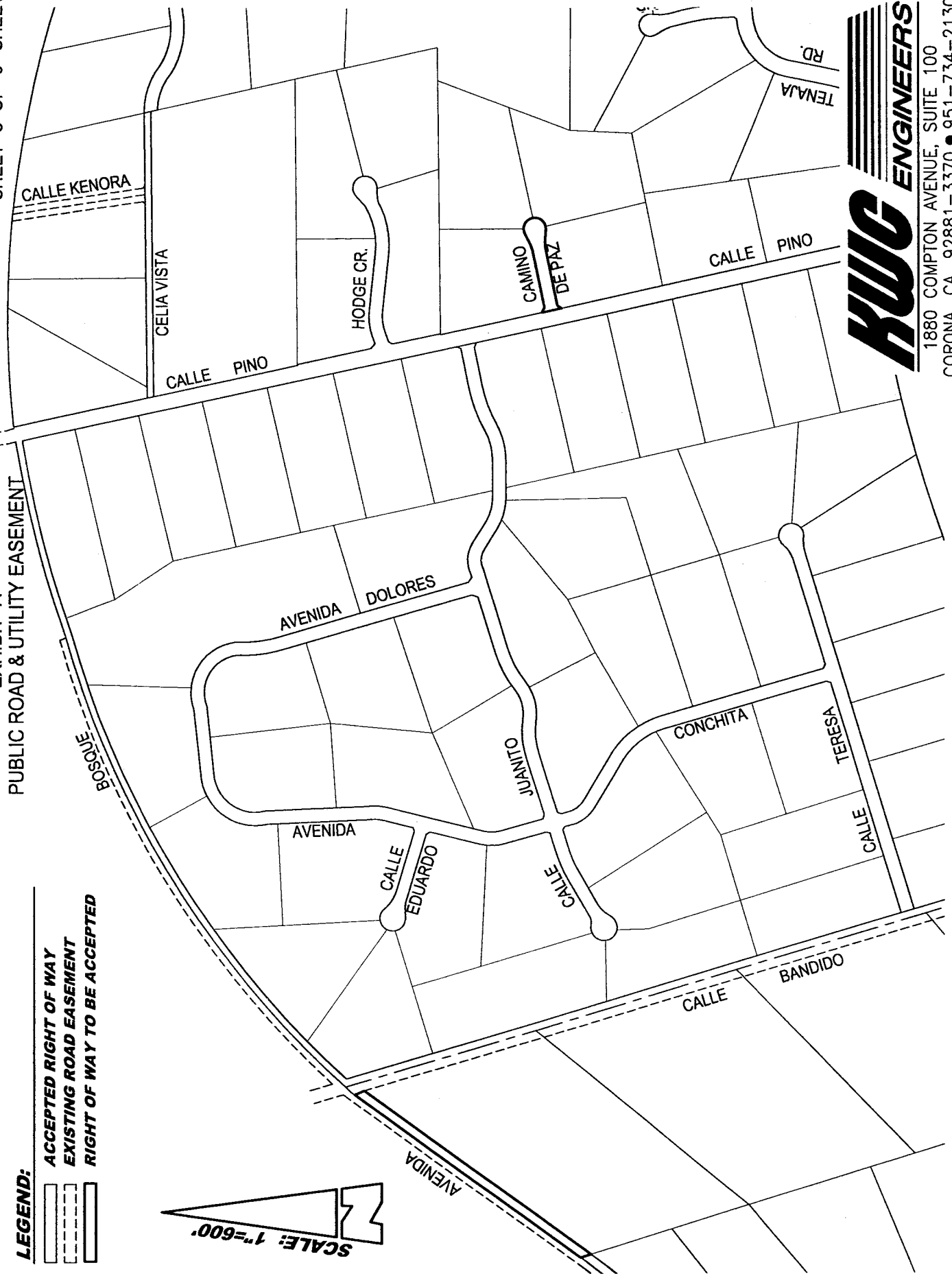

EXHIBIT "A"  
PUBLIC ROAD & UTILITY EASEMENT

- LEGEND:**
-  ACCEPTED RIGHT OF WAY
  -  EXISTING ROAD EASEMENT
  -  RIGHT OF WAY TO BE ACCEPTED



1880 COMPTON AVENUE, SUITE 100  
CORONA, CA. 92881-3370 • 951-734-2130

SIERRA RD.  
ELENA RD.

BURL OAKS CT. (PVT.)  
VOLCANO RD.

OAKVALE CT.  
OAK TRAILS CT. (OASIS TRL.)

TENAJA RD.

**LEGEND:**  
ACCEPTED RIGHT OF WAY  
EXISTING ROAD EASEMENT  
RIGHT OF WAY TO BE ACCEPTED



AVENIDA LA CRESTA

AIRE BON CAMINO

PASO REDONDO

FOREST VIEW LN  
VIEW LN

AVENIDA LA CRESTA

TENAJA RD.

EXHIBIT "A"  
PUBLIC ROAD & UTILITY EASEMENT

CALLE JAIME

ALPINE

ARONIMINK RD.

NORTHLAND CT.

SIERRA MESA RD.

TENAJA ROAD  
(RANCHO CALIFORNIA ROAD)

LA CUMBRA  
CT. (CALE DE POCO)

OTONO CT.

**HWC ENGINEERS**

1880 COMPTON AVENUE, SUITE 100  
CORONA, CA. 92881-3370 • 951-734-2130

EXHIBIT "A"  
PUBLIC ROAD & UTILITY EASEMENT

SIERRA MESA RD.

CALE VIENTO

HARKEY CR.

PRESA

AVENIDA

MATORRAL

AVENIDA

CALE VIENTO

TENJA ROAD

CALE ROBLE

CALE ROBLE

CALE

CALE BANDIDO

AVENIDA PERRIS

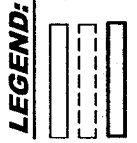

LEGEND:

- ACCEPTED RIGHT OF WAY
- - - EXISTING ROAD EASEMENT
- == RIGHT OF WAY TO BE ACCEPTED

**HWC** ENGINEERS

1880 COMPTON AVENUE, SUITE 100  
CORONA, CA. 92881-3370 • 951-734-2130

EXHIBIT "A"  
PUBLIC ROAD & UTILITY EASEMENT

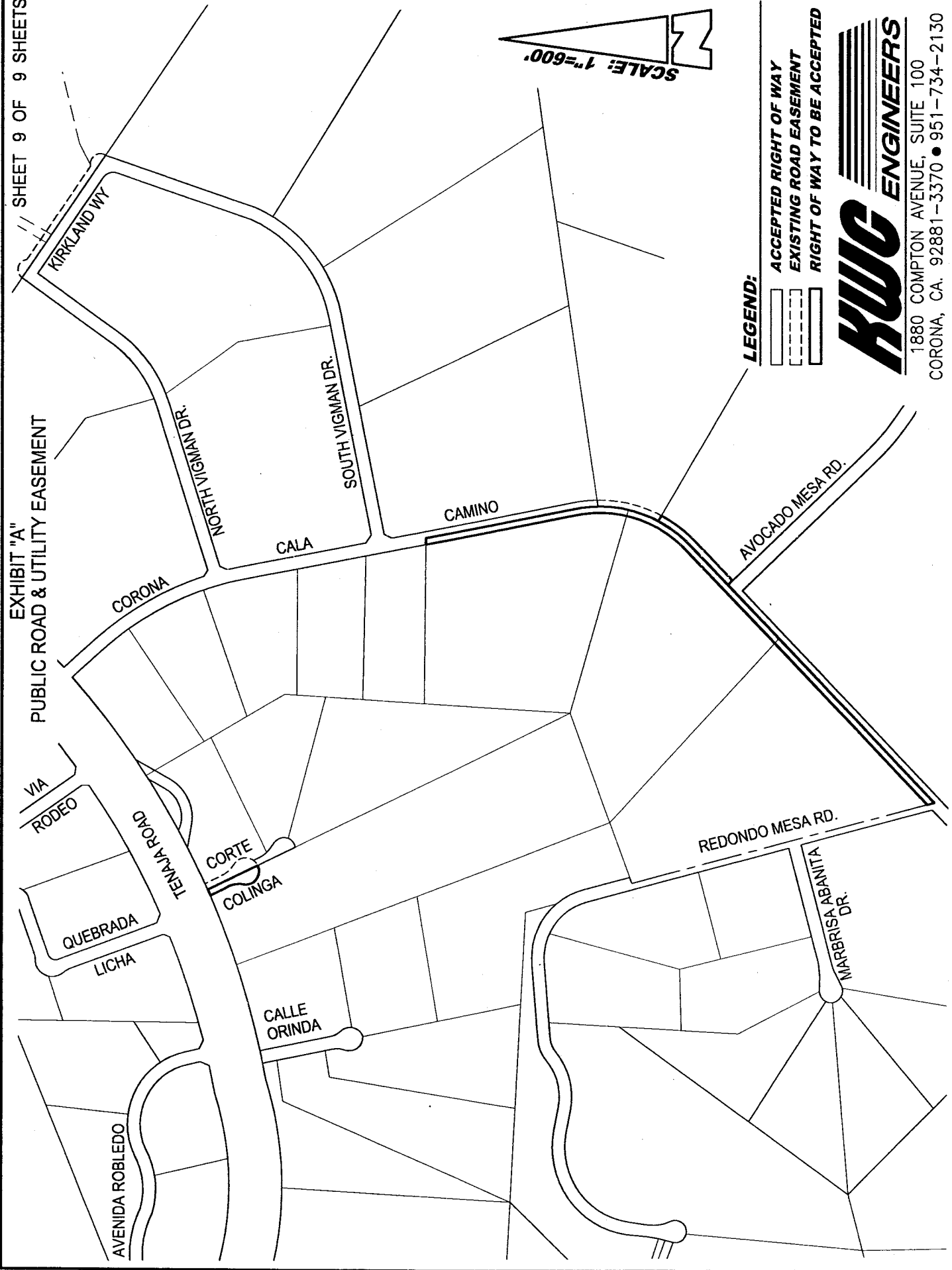

LEGEND:

-  ACCEPTED RIGHT OF WAY
-  EXISTING ROAD EASEMENT
-  RIGHT OF WAY TO BE ACCEPTED



1880 COMPTON AVENUE, SUITE 100  
 CORONA, CA. 92881-3370 • 951-734-2130



**LARRY W. WARD  
COUNTY OF RIVERSIDE  
ASSESSOR-COUNTY CLERK-RECORDER**

Recorder  
P.O. Box 751  
Riverside, CA 92502-0751  
(951) 486-7000

<http://riverside.asrcfrec.com>

**CERTIFICATION**

Pursuant to the provisions of Government Code 27361.7, I certify under the penalty of perjury that the following is a true copy of illegible wording found in the attached document:

(Print or type the page number(s) and wording below):

CLARIFICATION OF THE SEAL for the Riverside County Board of Supervisors  
(embossed on document)

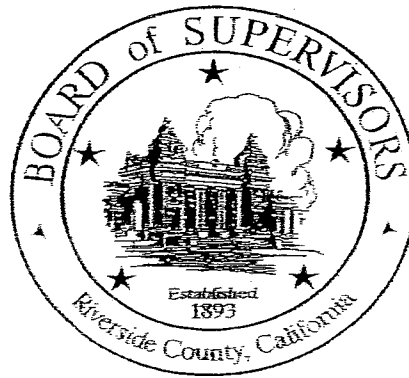

Date:

4-22-14

Signature:

*Karen Barton*

Print Name:

Karen Barton, Board Assistant, Riverside County Clerk of the Board



MINUTES OF THE BOARD OF SUPERVISORS  
COUNTY OF RIVERSIDE, STATE OF CALIFORNIA



2-8

On motion of Supervisor Tavaglione, seconded by Supervisor Jeffries and duly carried by unanimous vote, IT WAS ORDERED that the recommendation from Transportation & Land Management Agency/Transportation regarding the Adoption of Resolution 2014-022 Accepting Portions of Various Roads for Public Use in the Tenaja Community Services District in the Tenaja Area, 1<sup>st</sup>/1<sup>st</sup> District, is taken off calendar.

I hereby certify that the foregoing is a full true, and correct copy of an order made and entered on March 11, 2014 of Supervisors Minutes.

WITNESS my hand and the seal of the Board of Supervisors  
Dated: March 11, 2014  
Kecia Harper-Ihem, Clerk of the Board of Supervisors, in  
and for the County of Riverside, State of California.

(seal)

By: *Morrain Cannon* Deputy

AGENDA NO.  
2-8

xc: Transp.

2  
3 **RESOLUTION NO. 2014-022**

4 ACCEPTING PORTIONS OF VARIOUS ROADS IN THE TENAJA COMMUNITY SERVICES  
5 DISTRICT IN THE TENAJA AREA  
6 (1<sup>st</sup> Supervisorial District)  
7

8 **WHEREAS**, the hereinafter described roads were offered for dedication for public road  
9 and utility purposes on the maps and documents hereinafter-referred to, which offers of  
10 dedication have not been previously accepted for public use by the County of Riverside, now,  
11 therefore;

12 **BE IT RESOLVED, DETERMINED, AND ORDERED** by the Board of Supervisors of the  
13 County of Riverside, State of California, in regular session assembled on \_\_\_\_\_, 2014  
14 that this Board accepts said offers of dedication and recognizes that these roads are public  
15 roads open for use by the general public;

16 **BE IT FURTHER RESOLVED, FOUND, DETERMINED, AND ORDERED** that this  
17 acceptance is for the purpose of vesting title in the County of Riverside on behalf of the public  
18 for public road and utility uses, and is not an acceptance of the roads into the County  
19 Maintained Road System pursuant to Section 941 of the Streets and Highways Code and that  
20 said roads will not become part of the County Maintained Road System unless subsequently  
21 accepted into said Maintained Road System by a resolution adopted by this Board.

22 Said roads are in the County of Riverside, State of California, and are described as  
23 follows:

24 **Calle De Lina** (See Exhibit "A")

25 That portion of Calle De Lina (60.00 feet wide) shown as "Road Easement" on Parcel  
26 Map No. 13,816 filed in Book 86, Pages 36 through 38, inclusive of Parcel Maps, Records of  
27 Riverside County, California.  
28

FORM APPROVED COUNTY COUNSEL  
BY:  PATRICIA MUNROE  
DATE: 12/18/13

1 **Calle Chiquita** (See Exhibit "A") That portion of Calle Chiquita (60.00 feet wide) shown as  
2 "Road Easement" on Parcel Map No. 13,816 filed in Book 86, Pages 36 through 38, inclusive of  
3 Parcel Maps, Records of Riverside County, California.

4 **Calle Collado** (See Exhibit "A")

5 That portion of Calle Collado (66.00 feet wide and 33.00 feet wide) shown as "Road  
6 Easement" on Parcel Map 13816, filed in Book 86, Pages 36 through 38, inclusive, of Parcel  
7 Maps, Records of Riverside County, California.

8 **South Tenaja Road** (See Exhibit "A")

9 That portion of South Tenaja Road (44.00 feet wide) shown as "Road Easement" on  
10 Parcel Map No. 8242 filed in Book 46, Page 97, of Parcel Maps, Records of Riverside County,  
11 California, and that portion of South Tenaja Road (44.00 feet wide) described as "Roadway  
12 Dedications" on Parcel Map No. 6076 filed in Book 14, Page 69, of Parcel Maps, Records of  
13 Riverside County, California

14 **Via Abrile** (See Exhibit "A")

15 That portion of Via Abril (30.00 feet wide) shown as "Roadway Dedication" on Parcel Map  
16 6076, filed in Book 14, Page 69, of Parcel Maps, Records of Riverside County, California and as  
17 described in Declaration of Dedication, recorded September 3, 1974, Official Records of  
18 Riverside County, California.

19 **Calle Cielo** (See Exhibit "A")

20 That portion of Calle Cielo (30.00 feet wide) from South Tenaja Road to the intersection  
21 of Via Abril, shown on Parcel Map 6076, filed in Book 14, Page 69, of Parcel Maps, Records of  
22 Riverside County, California.

23 **Unnamed Road** (See Exhibit "A")

24 Unnamed Road (60.00 feet Wide) shown as Lot "A" on Parcel Map 8372 filed in Book 46,  
25 page 81 of Parcel Maps, Records of Riverside County, California.

26 **Avenida Escala** (See Exhibit "A")

27 That portion of Avenida Escala (60.00 feet wide) as described in Declaration of  
28 Dedication, recorded September 27, 1973 as Instrument No. 127204, Official Records of the

1 Recorder, Riverside County, California, and shown on Parcel Map 5018 filed in Book 10, Pages  
2 19 through 25, inclusive, of Parcel Maps, Records of Riverside County, California.

3 **Avenida Bosque** (See Exhibit "A")

4 That portion of Avenida Bosque (40.00 feet wide) as described in Declaration of  
5 Dedication, recorded September 27, 1973 as Instrument No. 127204, Official Records of the  
6 Recorder, Riverside County, California, and shown on Parcel Map 5018 filed in Book 10, Pages  
7 19 through 25, inclusive, of Parcel Maps, Records of Riverside County, California.

8 **Camino De Paz** (See Exhibit "A")

9 Camino De Paz (60.00 feet Wide) shown as Lots "C" through "F," inclusive, on Parcel  
10 Map 11,362 filed in Book 75, Page 53 of Parcel Maps, Records of Riverside County, California.

11 **Aronimink Road** (See Exhibit "A")

12 That portion of Aronimink Road (30.00 feet Wide) as described in Declaration of  
13 Dedication, recorded February 29, 1972 as Instrument No. 26282, Official Records of the  
14 Recorder, Riverside County, California, and on Parcel Map, filed in Book 5, Pages 55 and 56 of  
15 Parcel Maps, Records of Riverside County, California.

16 **Alpine View Lane** (See Exhibit "A")

17 That portion of Alpine View Lane (60.00 feet wide and 30.00 feet wide) as described in  
18 Declaration of Dedication, recorded February 29, 1972 as Instrument No. 26282, Official  
19 Records of the Recorder, Riverside County, California, and on Parcel Map, filed in Book 5,  
20 Pages 55 and 56 of Parcel Maps, Records of Riverside County, California.

21 **Avenida La Cresta** (See Exhibit "A")

22 That portion of Avenida La Cresta (60.00 feet wide and 30.00 feet wide) as described in  
23 Certificate of Dedication, recorded August 27, 1973, as Instrument No. 112459, Official Records  
24 of Riverside County, California.

25 **Calle Roble** (See Exhibit "A")

26 That portion of Calle Roble (20.00 feet wide) shown as Lots "A" through "D," inclusive, on  
27 Parcel Map 9634 filed in Book 40, Page 19 of Parcel Maps, Records of Riverside County  
28 California.

1 **Calle Viento** (See Exhibit "A")

2 That portion of Calle Viento ( 30.00 feet wide) shown as Lot "D" on Parcel Map 7390 filed  
3 in Book 46, Pages 98 through 100, inclusive, of Parcel Maps, Records of Riverside County,  
4 California.

5 **Corte Colinga** (See Exhibit "A")

6 That portion of Corte Colinga (33.00 feet wide) the west half shown as Lot "C" on Parcel  
7 Map 7058 filed in Book 24, Pages 86 and 87, of Parcel Maps, Records of Riverside County,  
8 California.

9 **Corona Cala Camino** (See Exhibit "A")

10 That portion of Corona Cala Camino (66.00 feet wide and 33.00 feet wide) as described  
11 in Certificate of Dedication, recorded April 9, 1973, as Instrument No.44760, Official Records of  
12 Riverside County, California. Excepting those portions lying within Parcel Map No. 9879, filed in  
13 Book 58, Pages 6 through 8, inclusive, Parcel Map No. 25821, filed in Book 176, Pages 47  
14 through 49, inclusive, Parcel Map No. 5064, filed in Book 8, Page 20, Parcel Map No.8499, filed  
15 in Book 55, Pages 20 through 22, inclusive, and Parcel Map No 7391 filed in Book 45, Pages 14  
16 through 22, inclusive, of Parcel Maps, Records of Riverside County.

17 **Via Tocon** (See Exhibit "A")

18 Via Tocon (60.00 feet wide) as shown on Parcel Map No. 6600, filed in Book 19, Pages  
19 52 through 54, inclusive, of Parcel Maps, Records of Riverside County, California.

20 Excepting therefrom all portions of roads previously accepted by the County of Riverside,  
21 State of California.

22 **BE IT FURTHER RESOLVED** that the Clerk of the Board shall cause a certified copy of  
23 this resolution to be recorded in the Office of the County Recorder of Riverside County,  
24 California.

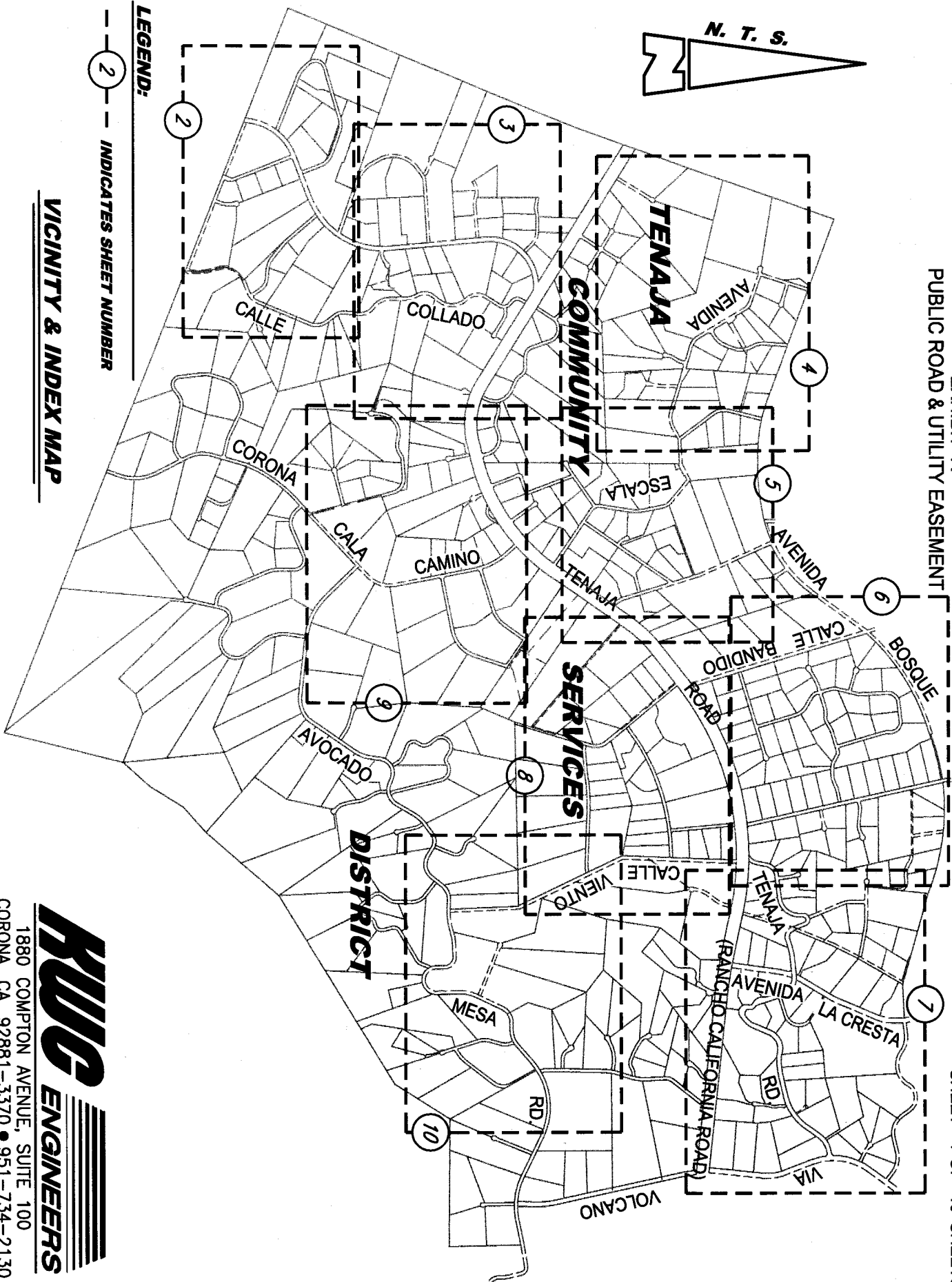

LEGEND:

2 — INDICATES SHEET NUMBER

**VICINITY & INDEX MAP**



1880 COMPTON AVENUE, SUITE 100  
CORONA, CA 92881-3370 • 951-734-2130

EXHIBIT "A"  
PUBLIC ROAD & UTILITY EASEMENT

SHEET 2 OF 10 SHEETS

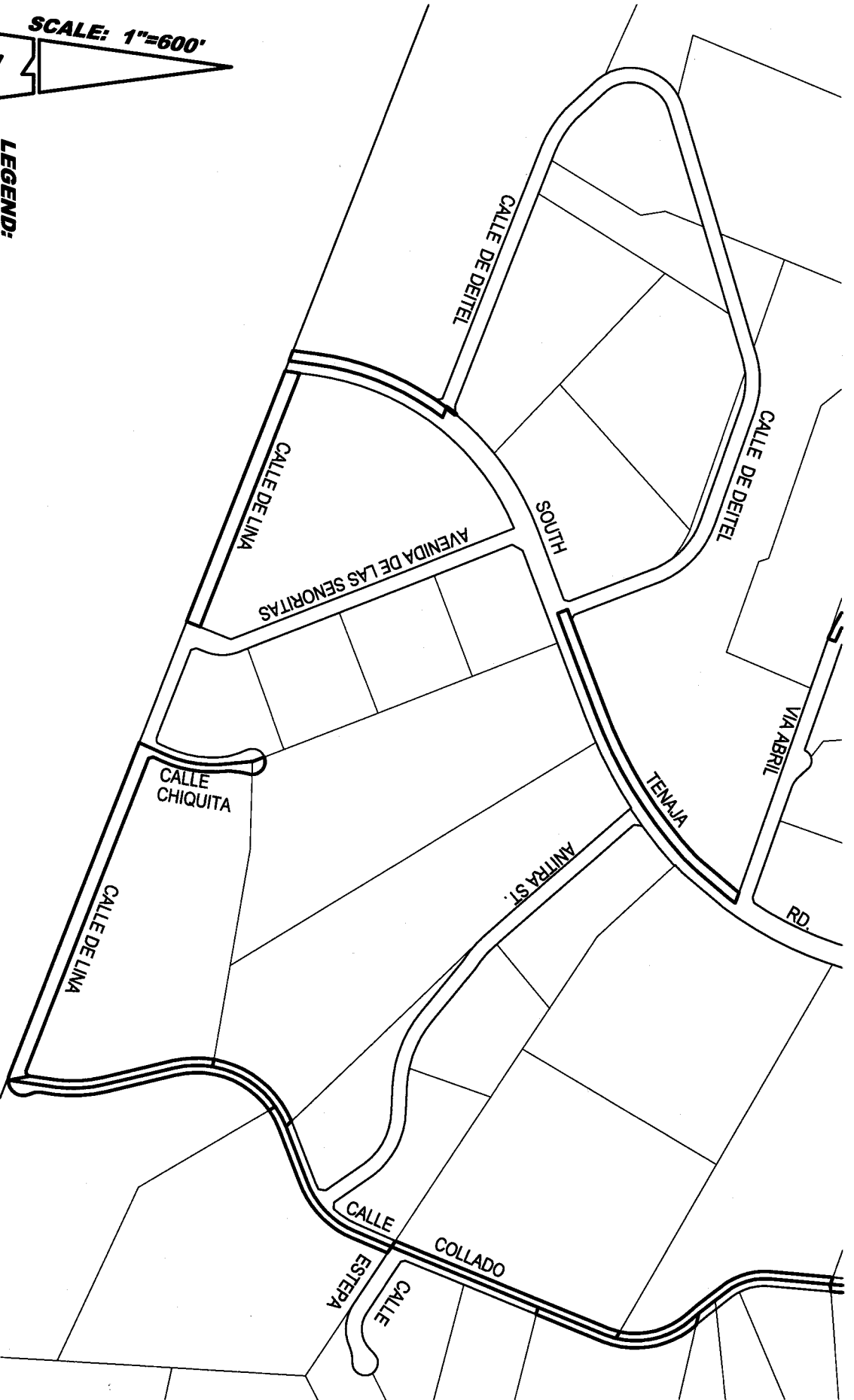

SCALE: 1"=600'

LEGEND:

-  ACCEPTED RIGHT OF WAY
-  EXISTING ROAD EASEMENT
-  RIGHT OF WAY TO BE ACCEPTED



1880 COMPTON AVENUE, SUITE 100  
CORONA, CA. 92881-3370 • 951-734-2130

EXHIBIT "A"  
PUBLIC ROAD & UTILITY EASEMENT

SHEET 3 OF 10 SHEETS

**LEGEND:**

-  ACCEPTED RIGHT OF WAY
-  EXISTING ROAD EASEMENT
-  RIGHT OF WAY TO BE ACCEPTED

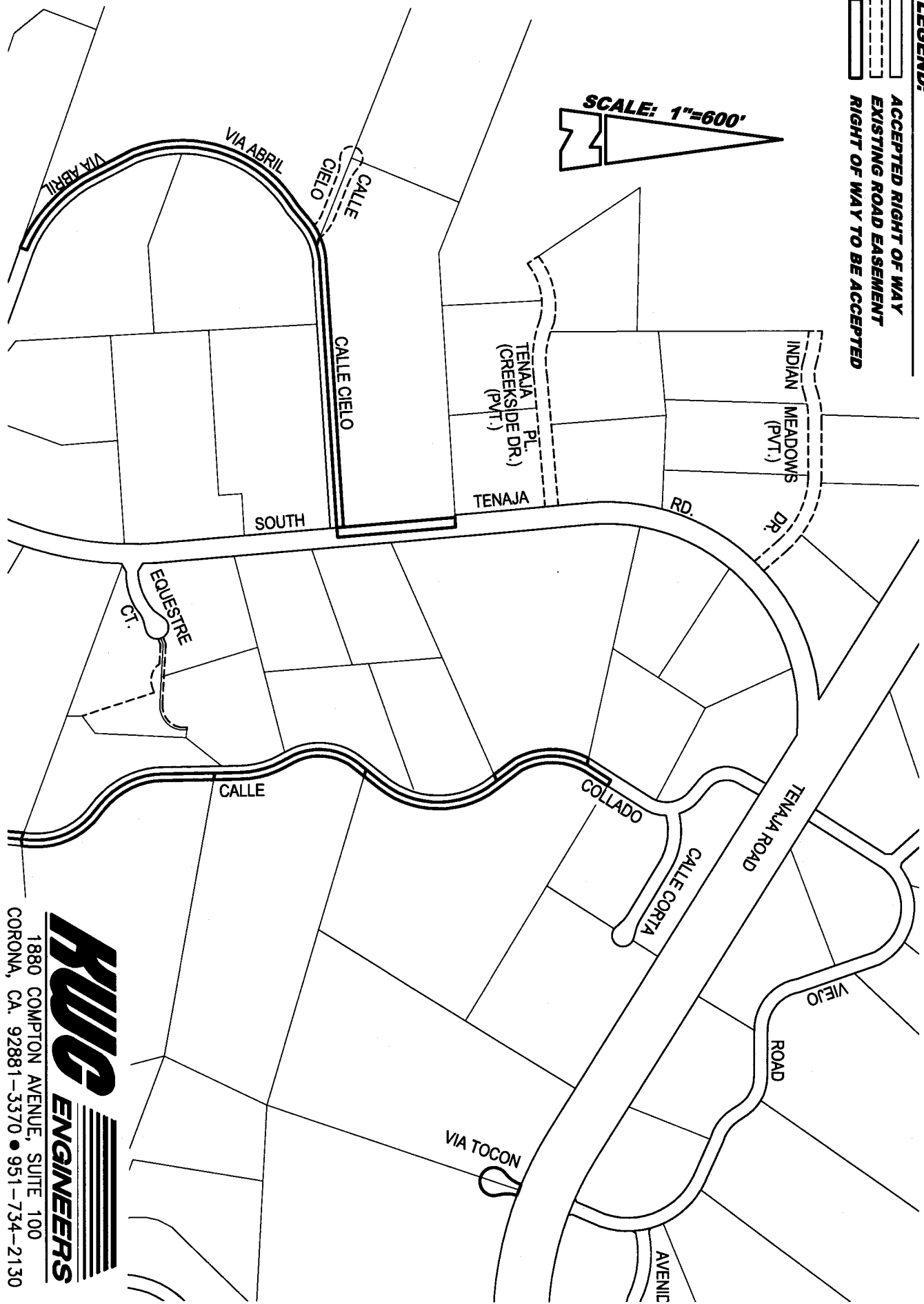

**RWIG ENGINEERS**  
1880 COMPTON AVENUE, SUITE 100  
CORONA, CA. 92881-3370 • 951-734-2130

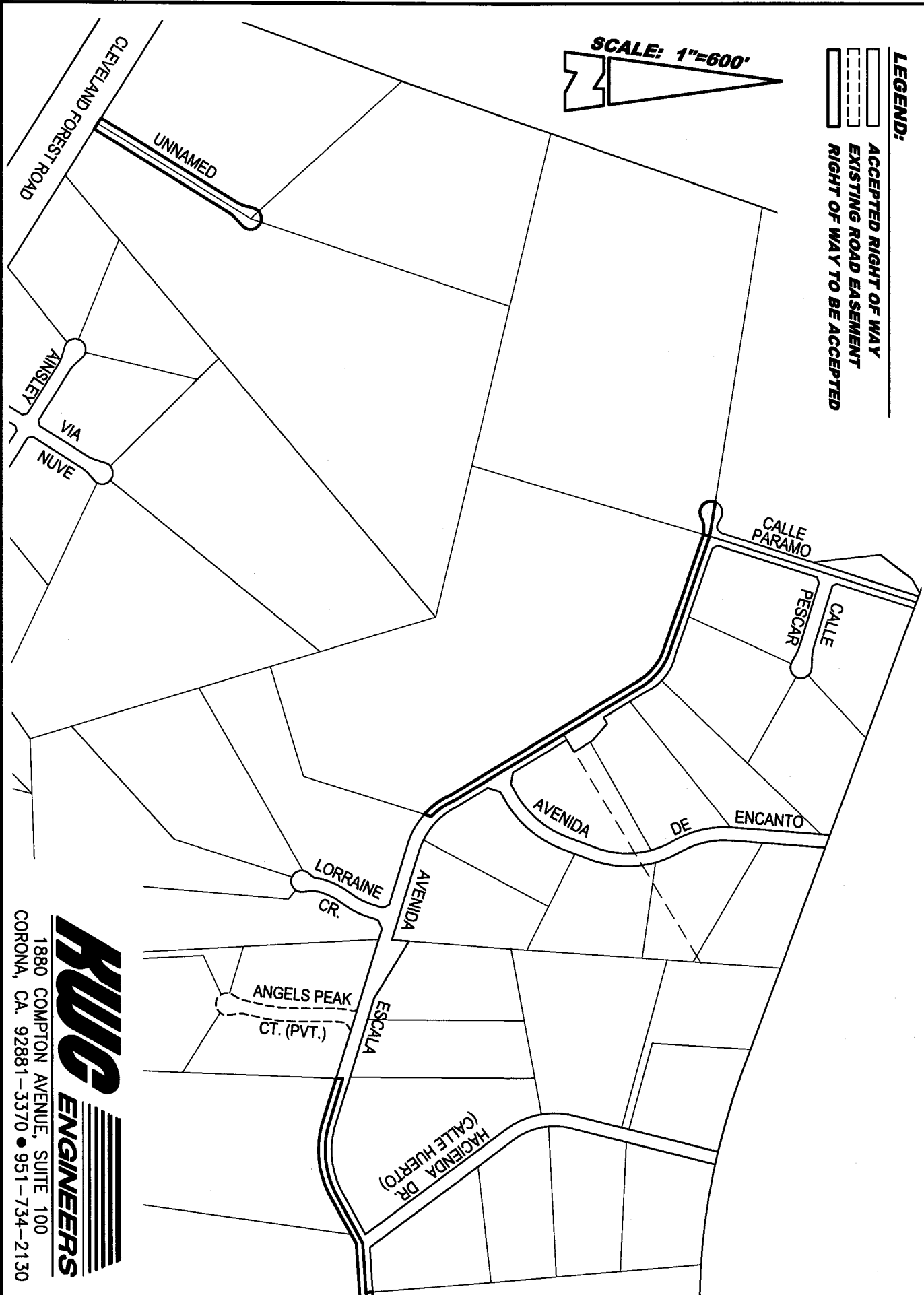

EXHIBIT "A"  
PUBLIC ROAD & UTILITY EASEMENT

SHEET 4 OF 10 SHEETS

LEGEND:

- ACCEPTED RIGHT OF WAY
- EXISTING ROAD EASEMENT
- RIGHT OF WAY TO BE ACCEPTED



**RUG ENGINEERS**  
1880 COMPTON AVENUE, SUITE 100  
CORONA, CA. 92881-3370 • 951-734-2130



EXHIBIT "A"  
PUBLIC ROAD & UTILITY EASEMENT



**LEGEND:**

-  ACCEPTED RIGHT OF WAY
-  EXISTING ROAD EASEMENT
-  RIGHT OF WAY TO BE ACCEPTED

**RWG ENGINEERS**  
1880 COMPTON AVENUE, SUITE 100  
CORONA, CA. 92881-3370 • 951-734-2130

- LEGEND:**
-  ACCEPTED RIGHT OF WAY
  -  EXISTING ROAD EASEMENT
  -  RIGHT OF WAY TO BE ACCEPTED

SCALE: 1"=600'



EXHIBIT "A"  
PUBLIC ROAD & UTILITY EASEMENT

SHEET 6 OF 10 SHEETS

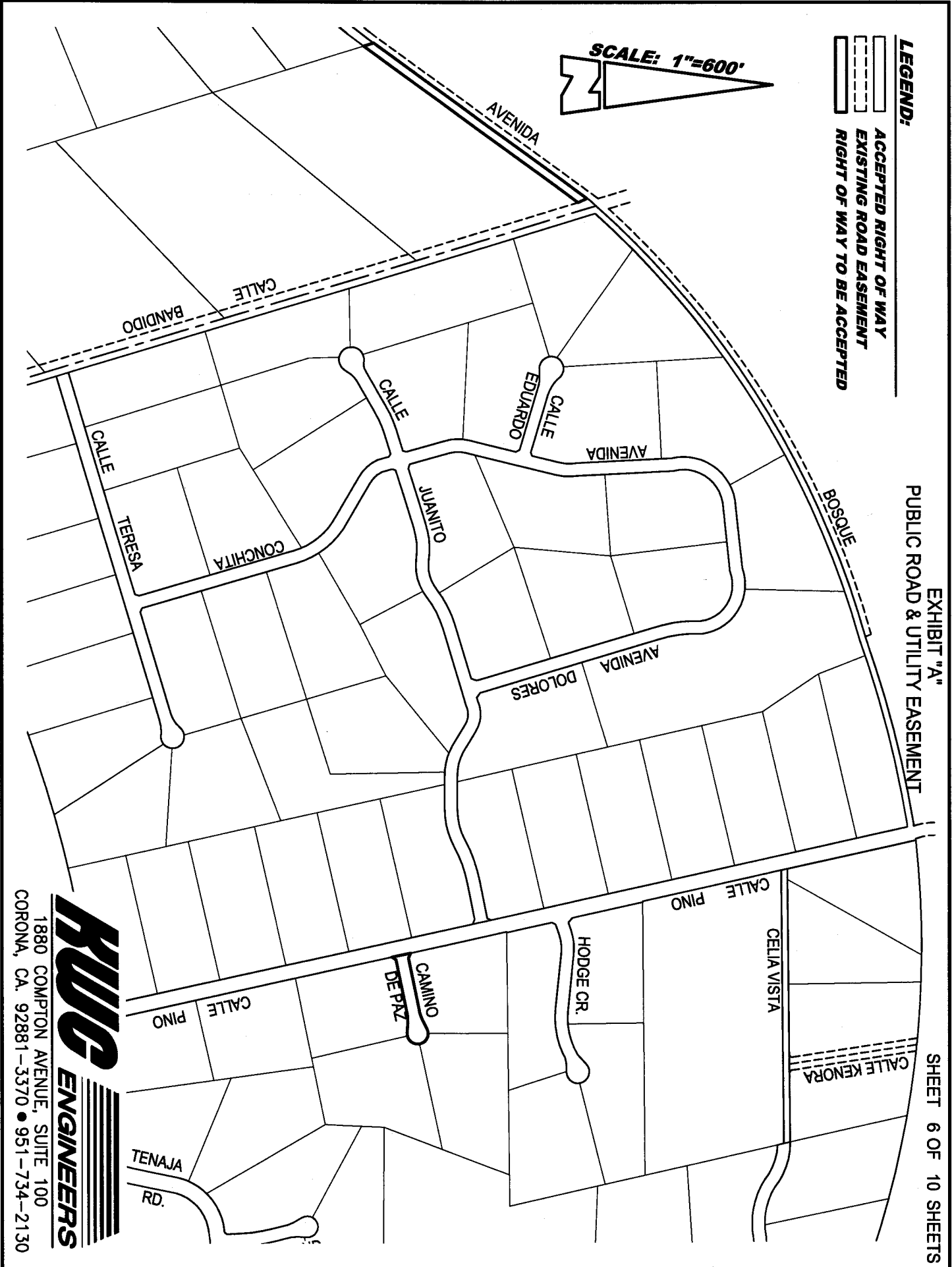

**RWIG ENGINEERS**

1880 COMPTON AVENUE, SUITE 100  
CORONA, CA. 92881-3370 • 951-734-2130

**EXHIBIT "A"**  
**PUBLIC ROAD & UTILITY EASEMENT**

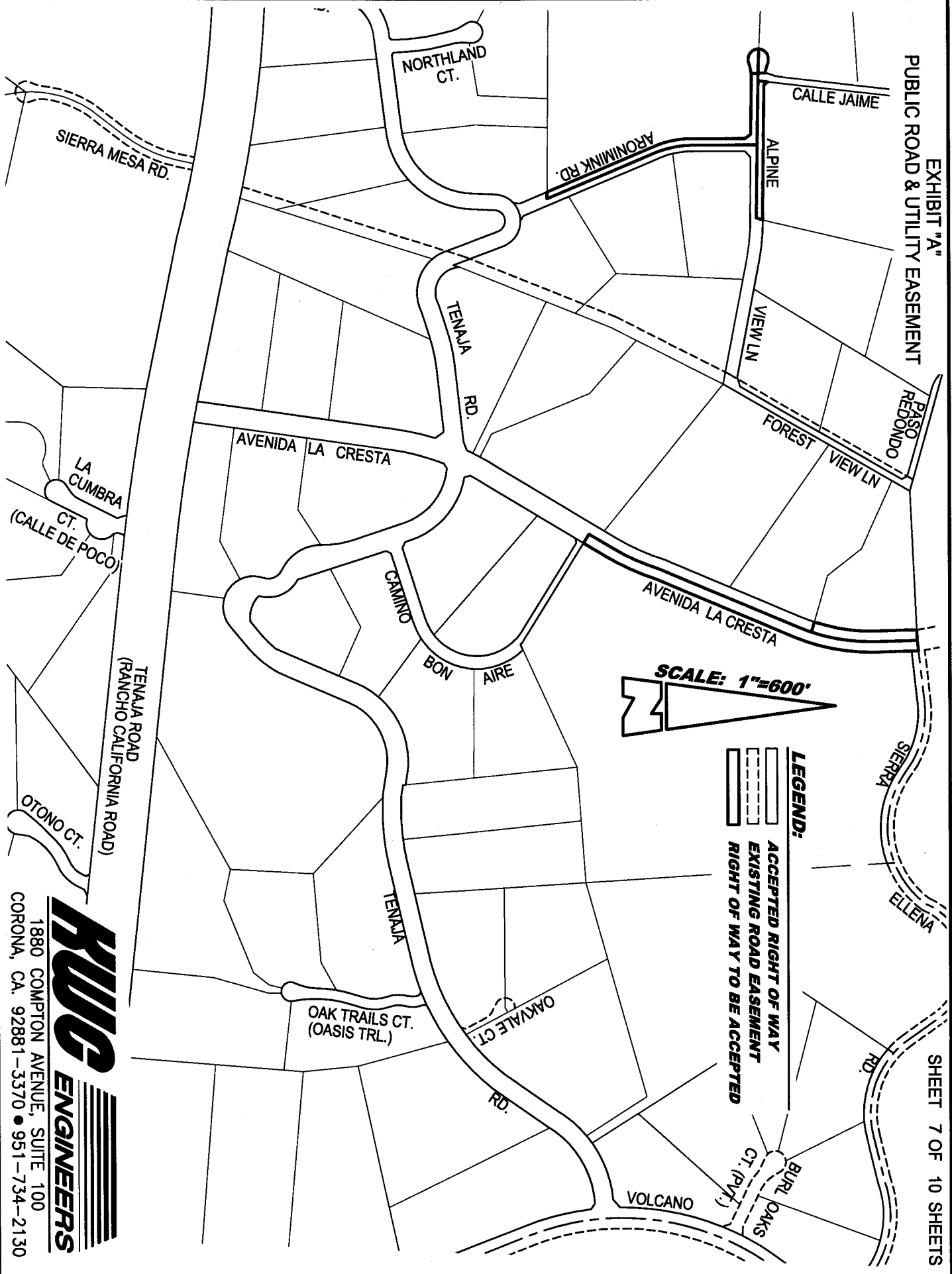

**SCALE: 1"=600'**

- LEGEND:**
- ACCEPTED RIGHT OF WAY
  - EXISTING ROAD EASEMENT
  - RIGHT OF WAY TO BE ACCEPTED

**RUG ENGINEERS**

1880 COMPTON AVENUE, SUITE 100  
 CORONA, CA. 92881-3370 • 951-734-2130

EXHIBIT "A"  
PUBLIC ROAD & UTILITY EASEMENT

SHEET 8 OF 10 SHEETS

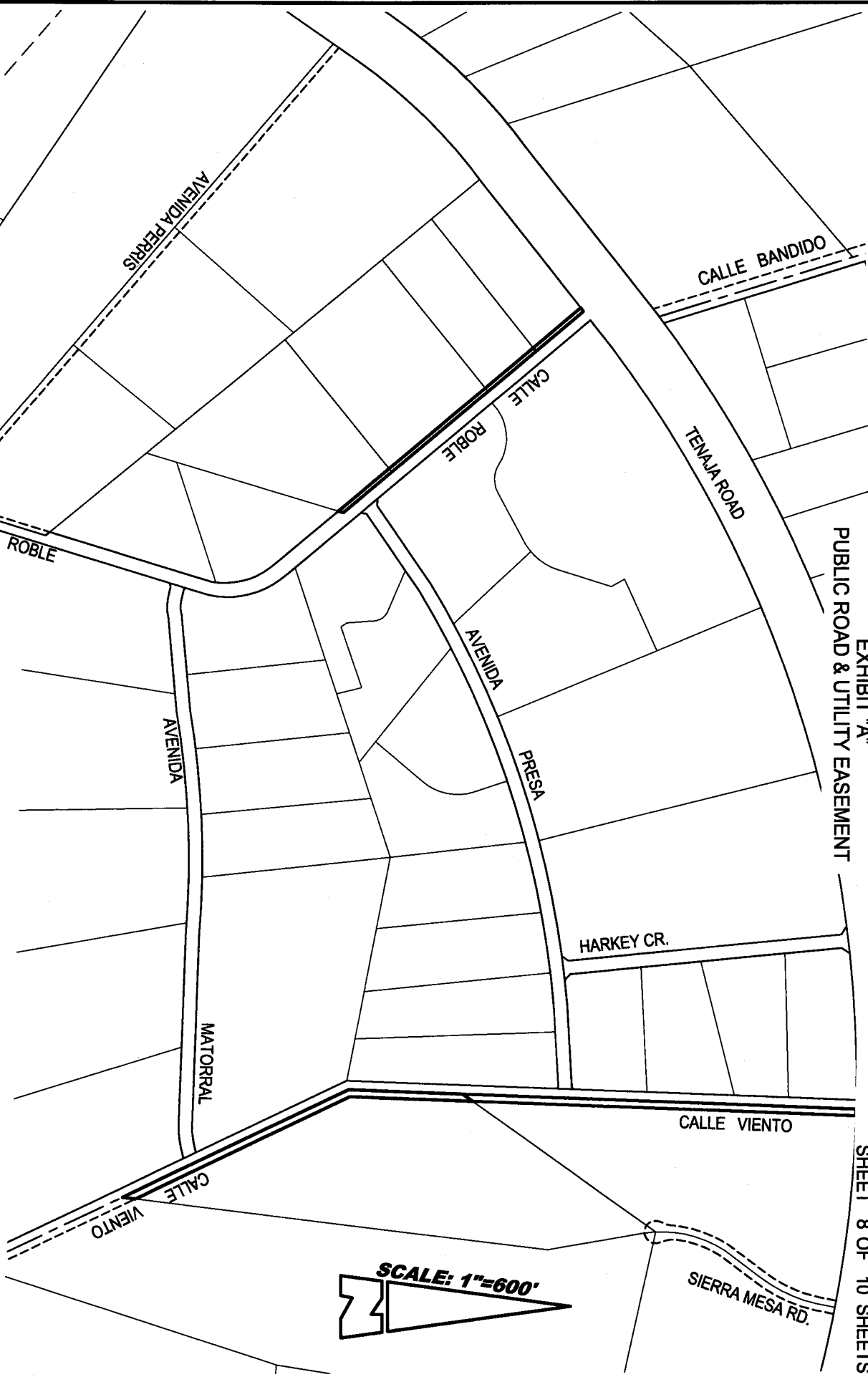

**LEGEND:**

-  ACCEPTED RIGHT OF WAY
-  EXISTING ROAD EASEMENT
-  RIGHT OF WAY TO BE ACCEPTED



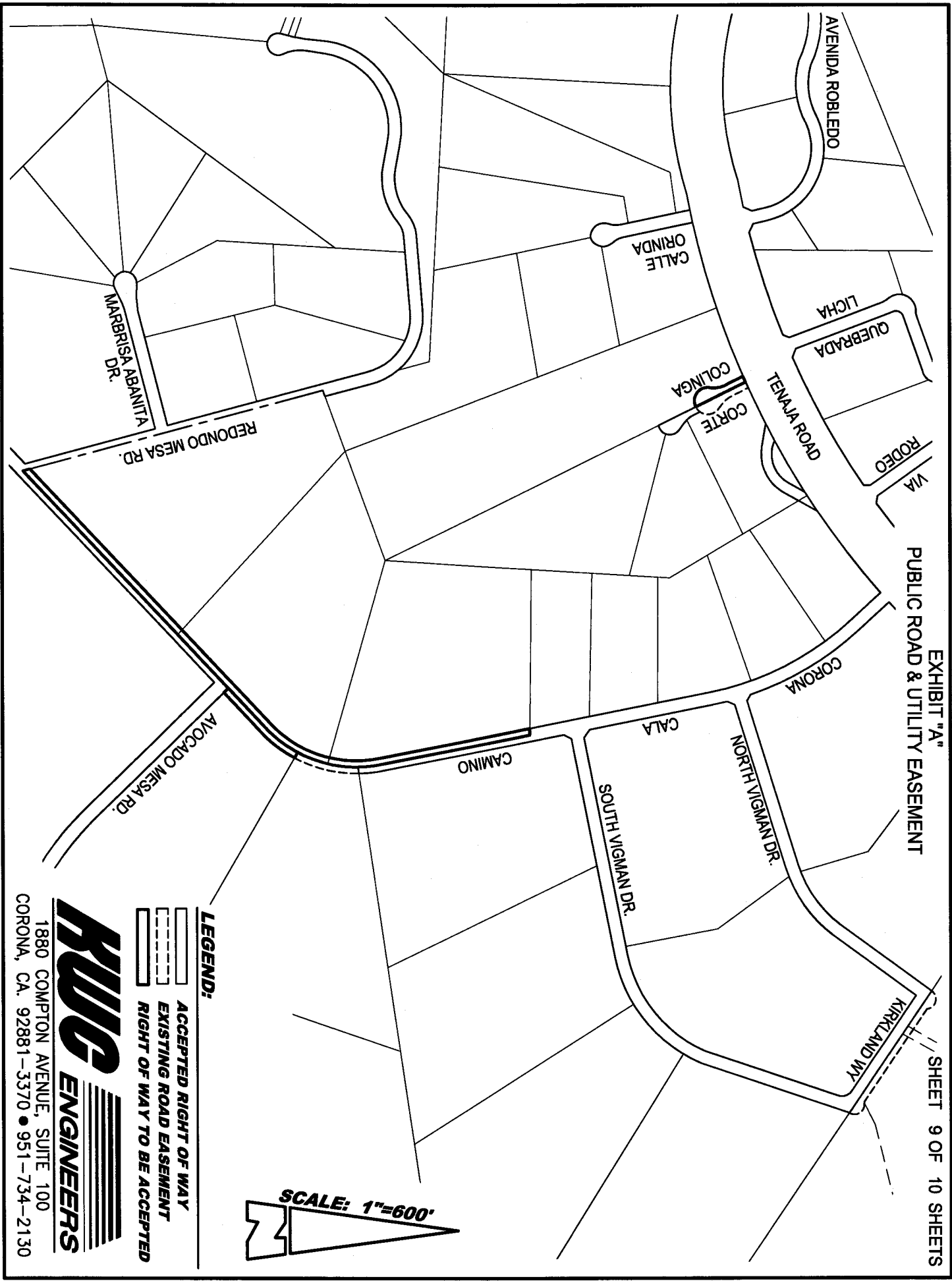

1880 COMPTON AVENUE, SUITE 100  
CORONA, CA. 92881-3370 • 951-734-2130

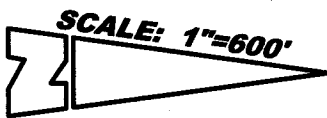

**EXHIBIT "A"**  
**PUBLIC ROAD & UTILITY EASEMENT**

SHEET 9 OF 10 SHEETS



- LEGEND:**
-  ACCEPTED RIGHT OF WAY
  -  EXISTING ROAD EASEMENT
  -  RIGHT OF WAY TO BE ACCEPTED

**RUG ENGINEERS**  
 1880 COMPTON AVENUE, SUITE 100  
 CORONA, CA. 92881-3370 • 951-734-2130

EXHIBIT "A"  
PUBLIC ROAD & UTILITY EASEMENT

SHEET 10 OF 10 SHEETS

- LEGEND:**
-  ACCEPTED RIGHT OF WAY
  -  EXISTING ROAD EASEMENT
  -  RIGHT OF WAY TO BE ACCEPTED

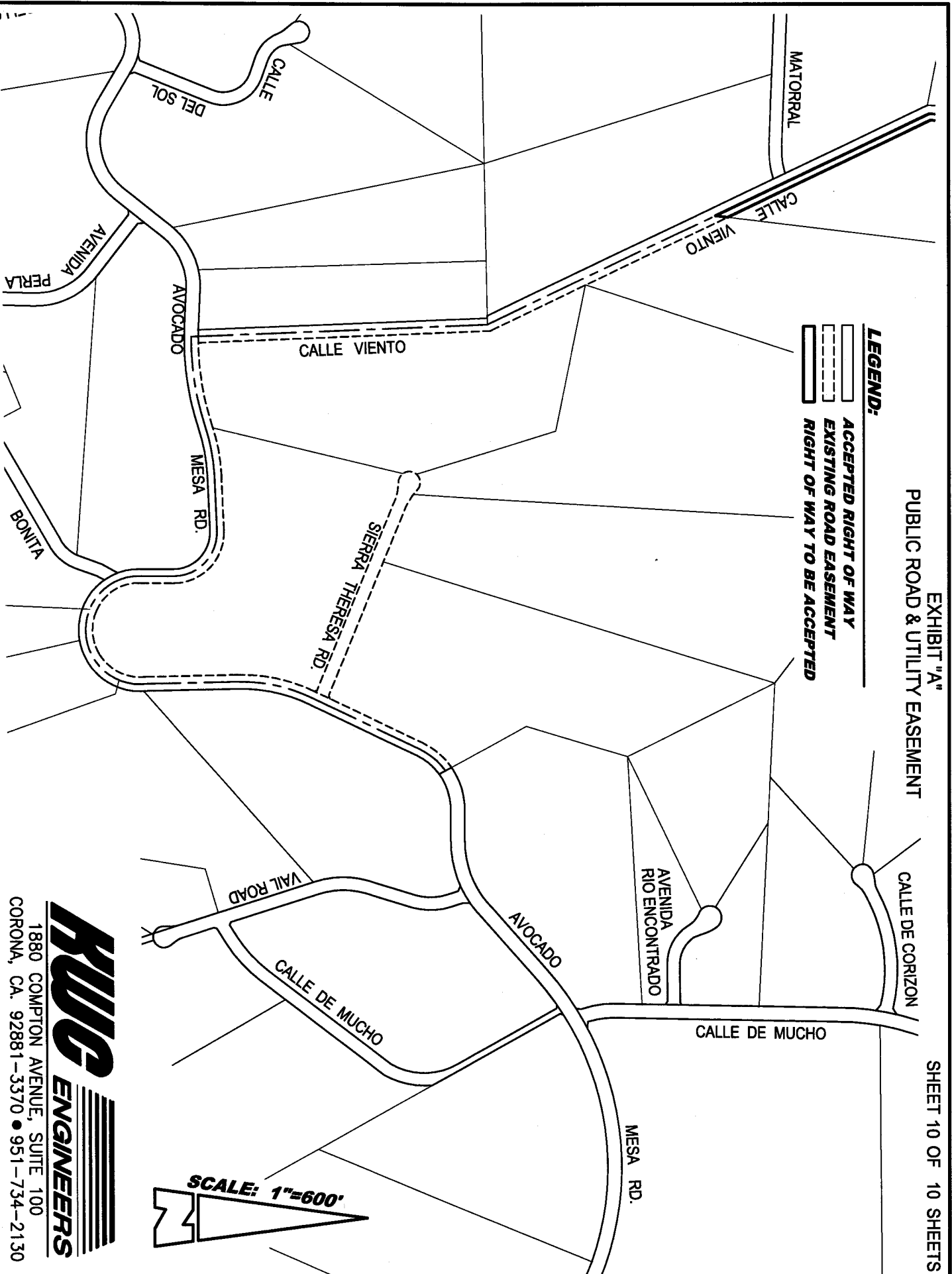

SCALE: 1"=600'

**RUG ENGINEERS**  
1880 COMPTON AVENUE, SUITE 100  
CORONA, CA. 92881-3370 • 951-734-2130

# VICINITY MAP

OF WILDOMAR

CITY OF MURRIETA

RIVERSIDE COUNTY

SAN DIEGO COUNTY

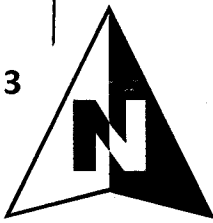

10 N.T.S.

T. 7S, R. 4,5W  
S.B.M.

AREA OF ACCEPTANCES

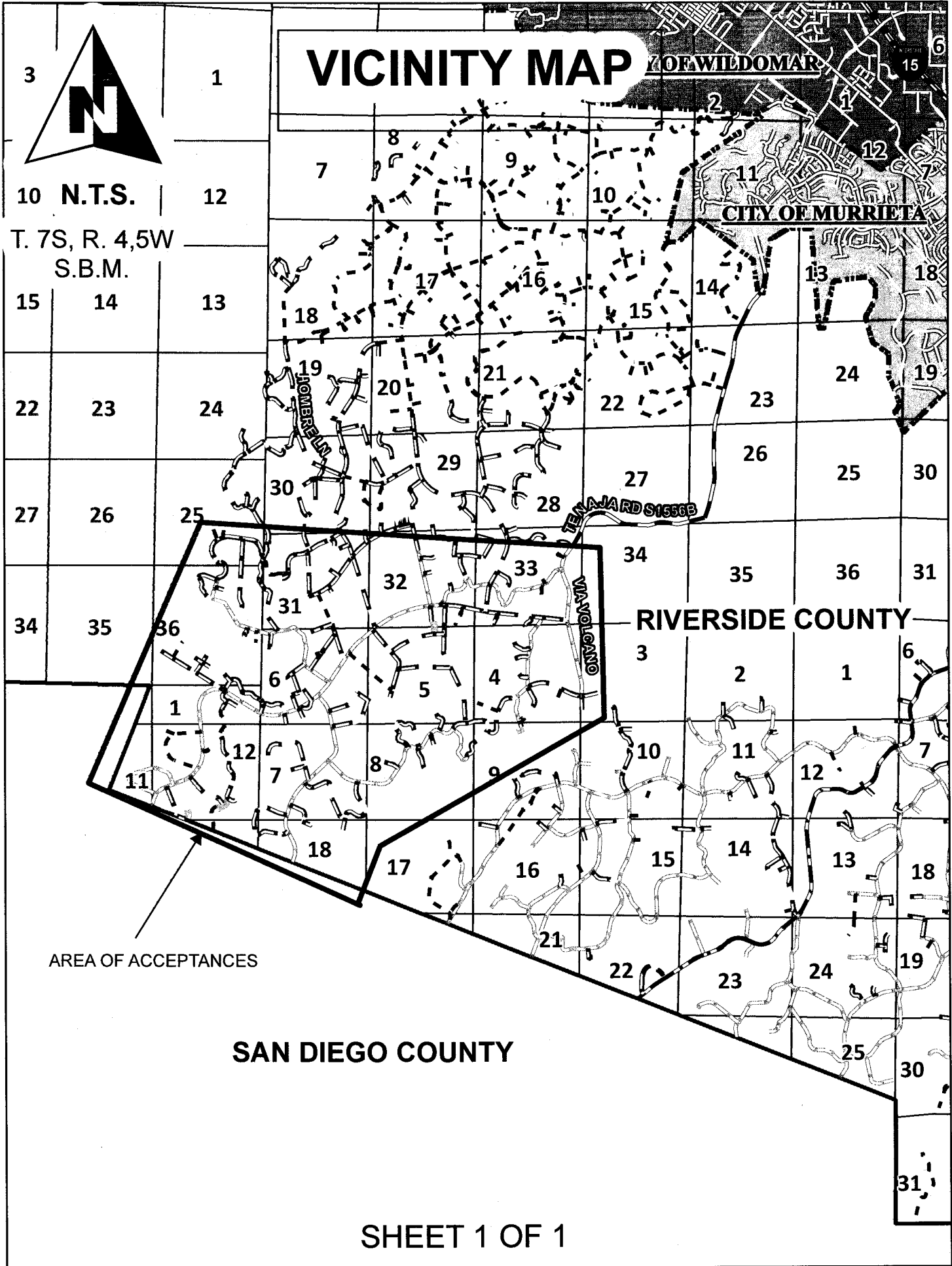



MINUTES OF THE BOARD OF SUPERVISORS  
COUNTY OF RIVERSIDE, STATE OF CALIFORNIA



2-13

On motion of Supervisor Jeffries, seconded by Supervisor Ashley and duly carried by unanimous vote, IT WAS ORDERED that the recommendation from Transportation & Land Management Agency/Transportation regarding Adoption of Resolution 2014-022 Accepting Portions of Various Roads for Public Use in the Tenaja Community Services District in the Tenaja Area, 1<sup>st</sup>/1<sup>st</sup> District, is continued to Tuesday, April 22, 2014 at 9:00 a.m.

I hereby certify that the foregoing is a full true, and correct copy of an order made and entered on January 28, 2014 of Supervisors Minutes.

WITNESS my hand and the seal of the Board of Supervisors  
Dated: January 28, 2014  
Kecia Harper-Ihem, Clerk of the Board of Supervisors, in  
and for the County of Riverside, State of California.

(seal)

By: Roguel Rosek Deputy

AGENDA NO.  
212

xc: Transp., COB

2-8 3/11/14

**ATTACHMENTS FILED**  
**WITH**  
**THE CLERK OF THE BOARD**