

FORM APPROVED COUNTY COUNSEL
 BY: *[Signature]*
 GREGORY P. PRAMOS
 DATE: 10/2/14

Departmental Concurrence

**SUBMITTAL TO THE FLOOD CONTROL AND WATER CONSERVATION DISTRICT BOARD OF SUPERVISORS
 COUNTY OF RIVERSIDE, STATE OF CALIFORNIA**

901B



FROM: General Manager-Chief Engineer

SUBMITTAL DATE:
 October 28, 2014

SUBJECT: Approve for Advertising Romoland MDP Line A, Stages 4, 5 and 6, Homeland MDP Line 1 Briggs Basin, Romoland MDP Line A-2, and Romoland MDP Line A-3, Project No. 4-0-00310-04, 3rd and 5th District/3rd and 5th District [\$0]

RECOMMENDED MOTION: That the Board of Supervisors: Approve the attached plans and specifications for the above referenced project and authorize the Clerk of the Board to advertise the project for construction contract bids.

BACKGROUND:

Summary

The contract documents have been approved as to form by County Counsel. A brief project description and location map are attached.

P8\164037

[Signature]

WARREN D. WILLIAMS
 General Manager-Chief Engineer

FINANCIAL DATA	Current Fiscal Year:	Next Fiscal Year:	Total Cost:	Ongoing Cost:	POLICY/CONSENT (per Exec. Office)
COST	\$ N/A	\$ N/A	\$ N/A	\$ N/A	Consent <input type="checkbox"/> Policy <input type="checkbox"/>
NET DISTRICT COST	\$ N/A	\$ N/A	\$ N/A	\$ N/A	
SOURCE OF FUNDS: N/A				Budget Adjustment: N/A	
				For Fiscal Year: N/A	

C.E.O. RECOMMENDATION:

APPROVE
[Signature]
 BY: Steven C. Horn

County Executive Office Signature

MINUTES OF THE FLOOD CONTROL AND WATER CONSERVATION DISTRICT

On motion of Supervisor Tavaglione, seconded by Supervisor Stone and duly carried, IT WAS ORDERED that the above matter is approved as recommended.

Ayes: Jeffries, Tavaglione and Stone
 Nays: None
 Absent: Benoit
 Disqualify: Ashley
 Date: October 28, 2014
 xc: Flood

Kecia Harper-Ihem
 Clerk of the Board

By: *[Signature]*
 Deputy

Prev. Agn. Ref.:

District: 3&5/3&5 Agenda Number:

11-1

- A-30
- Positions Added
- 4/5 Vote
- Change Order

NOTICE TO CONTRACTORS

Riverside County Flood Control and Water Conservation District hereinafter called "District", invites sealed proposals for construction of:

Romoland MDP Line A, Stages 4, 5 and 6,

Homeland MDP Line 1 Briggs Basin,

Romoland MDP Line A-2, and Romoland MDP Line A-3

Project No. 4-0-00310-04

located in the cities of Menifee, Perris and Riverside County, California

Specifications and Contract Documents may be examined at the District's office at 1995 Market Street, Riverside, California, and may be obtained upon payment to District of \$60.00 per set, received at the District's office and \$65.00 per set if mailed. The Specifications and Contract Documents are also offered on CD-ROM for \$10.00 received at the District's office and \$15.00 if mailed. No refund.

Each proposal must be accompanied by a certified or cashier's check or bid bond equal to ten percent (10%) of the amount bid, payable to the Riverside County Flood Control and Water Conservation District as a guarantee that the Contractor will, if awarded the contract, execute a satisfactory contract and furnish the required bonds and proof of insurance.

Proposals must be in accordance with the instructions and filed with District by **2:00 p.m. on Thursday, December 18, 2014** at the District office at the above address which time and place are fixed for the public opening of bids.

General prevailing rate per diem wages and general prevailing rate of per diem wages for holiday and overtime work, including employer payments for health and welfare, pension, vacation, apprentices and similar purposes for each craft, classification or type of workman needed for execution of contracts under the jurisdiction of District have been obtained by the Board of Supervisors of the District from the

Director of Industrial Relations of the State of California for the area where the work is to be done. The said determinations are on file in the principal office of the District, and will be made available to any interested person upon request.

Contractors submitting proposals for this project shall have an "A" Contractors license from the State of California in order to be considered eligible for the contract award.

Dated: October 28, 2014

RIVERSIDE COUNTY FLOOD CONTROL
AND WATER CONSERVATION DISTRICT

KECIA HARPER-IHEM
Clerk of the Board

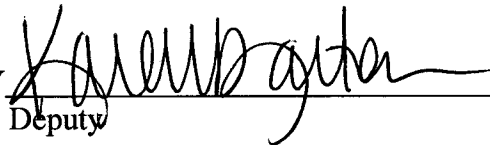
BY 
Deputy

ROMOLAND MDP LINE A, STAGES 4, 5 & 6 HOMELAND MDP LINE 1 BRIGGS BASIN ROMOLAND MDP LINE A-2 & LINE A-3

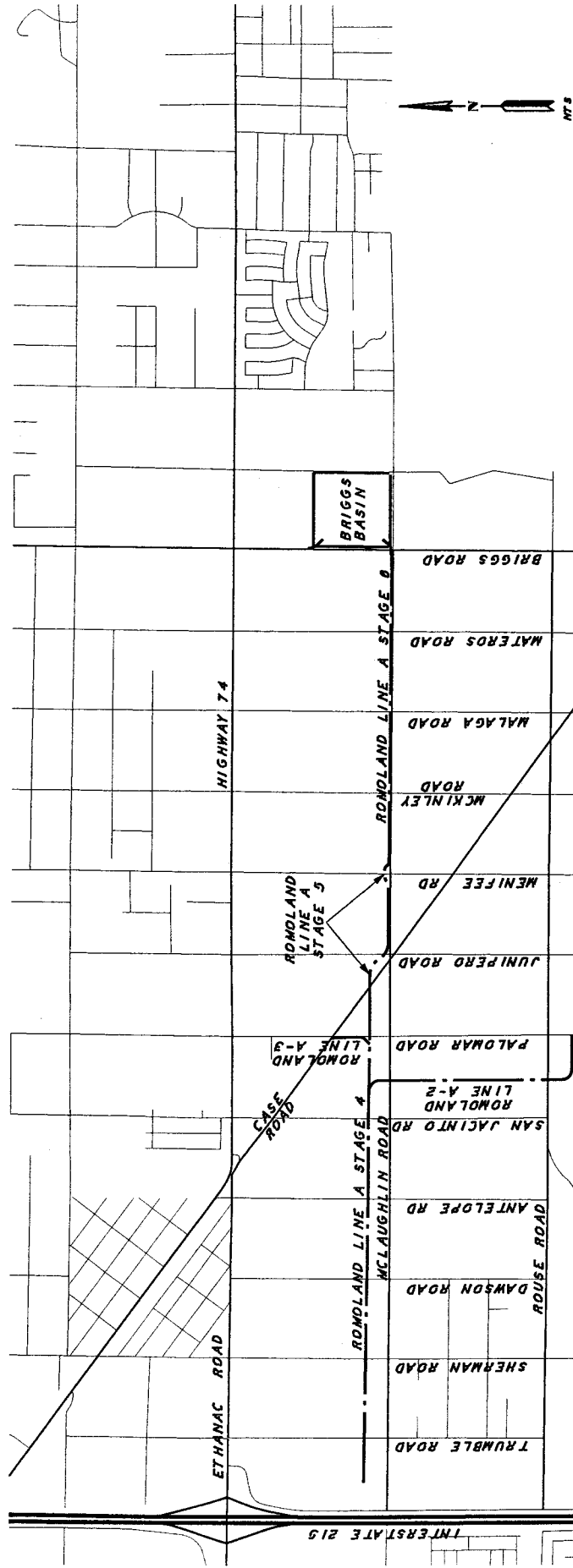

CITY OF MENIFEE

Romoland Line A Stage 4, Stage 5, Stage 6, Homeland MDP Line 1 Briggs Basin, Romoland MDP Line A-2 and Romoland MDP Line A-3 system involves the design, construction, operation and maintenance of approximately 21,000 lined feet storm drain system consisting of open channels, reinforced concrete boxes, reinforced concrete pipes and one basin. The project begins at the upstream end of Romoland MDP Line A, Stage 3 project at Encanto Drive and I-215; traverses east along McLaughlin road and terminates at Briggs Basin located north east to the intersection of Briggs Road and McLaughlin Road. Romoland MDP Line A-2 traverses southerly 400 feet west of San Jacinto Road and terminates at its intersection with Rouse Road. Romoland MDP Line A-3 traverses northerly along Palomar Road and terminates at Case Road near the railroad tracks. The project lies within the cities of Perris, Menifee and unincorporated portions of the County.

FORM APPROVED COUNTY COUNSEL
 BY: *[Signature]* 10/2/14
 DATE: GREGORY P. PRIAMOS

SUBMITTAL TO THE FLOOD CONTROL AND WATER CONSERVATION DISTRICT BOARD OF SUPERVISORS COUNTY OF RIVERSIDE, STATE OF CALIFORNIA

9018



FROM: General Manager-Chief Engineer

SUBMITTAL DATE:
 October 28, 2014

SUBJECT: Approve for Advertising Romoland MDP Line A, Stages 4, 5 and 6, Homeland MDP Line 1 Briggs Basin, Romoland MDP Line A-2, and Romoland MDP Line A-3, Project No. 4-0-00310-04, 3rd and 5th District/3rd and 5th District [\$0]

RECOMMENDED MOTION: That the Board of Supervisors: Approve the attached plans and specifications for the above referenced project and authorize the Clerk of the Board to advertise the project for construction contract bids.

BACKGROUND:

Summary

The contract documents have been approved as to form by County Counsel. A brief project description and location map are attached.

Departmental Concurrence

P8\164037

[Signature]

WARREN D. WILLIAMS
 General Manager-Chief Engineer

FINANCIAL DATA	Current Fiscal Year:	Next Fiscal Year:	Total Cost:	Ongoing Cost:	POLICY/CONSENT (per Exec. Office)
COST	\$ N/A	\$ N/A	\$ N/A	\$ N/A	Consent <input type="checkbox"/> Policy <input type="checkbox"/>
NET DISTRICT COST	\$ N/A	\$ N/A	\$ N/A	\$ N/A	

SOURCE OF FUNDS: N/A
 Budget Adjustment: N/A
 For Fiscal Year: N/A

C.E.O. RECOMMENDATION:

APPROVE
 BY: *[Signature]*
 Steven C. Horn

County Executive Office Signature

MINUTES OF THE FLOOD CONTROL AND WATER CONSERVATION DISTRICT

On motion of Supervisor Tavaglione, seconded by Supervisor Stone and duly carried, IT WAS ORDERED that the above matter is approved as recommended.

Ayes: Jeffries, Tavaglione and Stone
 Nays: None
 Absent: Benoit
 Disqualify: Ashley
 Date: October 28, 2014
 xc: Flood

Kecia Harper-Ihem
 Clerk of the Board

By: *[Signature]*
 Deputy

RJC

- A-30
- Positions Added
- 4/5 Vote
- Change Order

NOTICE TO CONTRACTORS

Riverside County Flood Control and Water Conservation District hereinafter called "District", invites sealed proposals for construction of:

Romoland MDP Line A, Stages 4, 5 and 6,

Homeland MDP Line 1 Briggs Basin,

Romoland MDP Line A-2, and Romoland MDP Line A-3

Project No. 4-0-00310-04

located in the cities of Menifee, Perris and Riverside County, California

Specifications and Contract Documents may be examined at the District's office at 1995 Market Street, Riverside, California, and may be obtained upon payment to District of \$60.00 per set, received at the District's office and \$65.00 per set if mailed. The Specifications and Contract Documents are also offered on CD-ROM for \$10.00 received at the District's office and \$15.00 if mailed. No refund.

Each proposal must be accompanied by a certified or cashier's check or bid bond equal to ten percent (10%) of the amount bid, payable to the Riverside County Flood Control and Water Conservation District as a guarantee that the Contractor will, if awarded the contract, execute a satisfactory contract and furnish the required bonds and proof of insurance.

Proposals must be in accordance with the instructions and filed with District by 2:00 p.m. on Thursday, December 18, 2014 at the District office at the above address which time and place are fixed for the public opening of bids.

General prevailing rate per diem wages and general prevailing rate of per diem wages for holiday and overtime work, including employer payments for health and welfare, pension, vacation, apprentices and similar purposes for each craft, classification or type of workman needed for execution of contracts under the jurisdiction of District have been obtained by the Board of Supervisors of the District from the

Director of Industrial Relations of the State of California for the area where the work is to be done. The said determinations are on file in the principal office of the District, and will be made available to any interested person upon request.

Contractors submitting proposals for this project shall have an "A" Contractors license from the State of California in order to be considered eligible for the contract award.

Dated: October 28, 2014

RIVERSIDE COUNTY FLOOD CONTROL
AND WATER CONSERVATION DISTRICT

KECIA HARPER-IHEM
Clerk of the Board

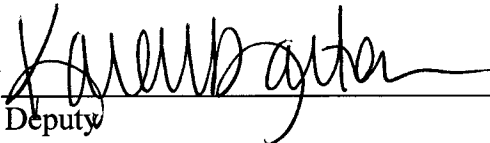
BY 
Deputy

ROMOLAND MDP LINE A, STAGES 4, 5 & 6 HOMELAND MDP LINE 1 BRIGGS BASIN ROMOLAND MDP LINE A-2 & LINE A-3

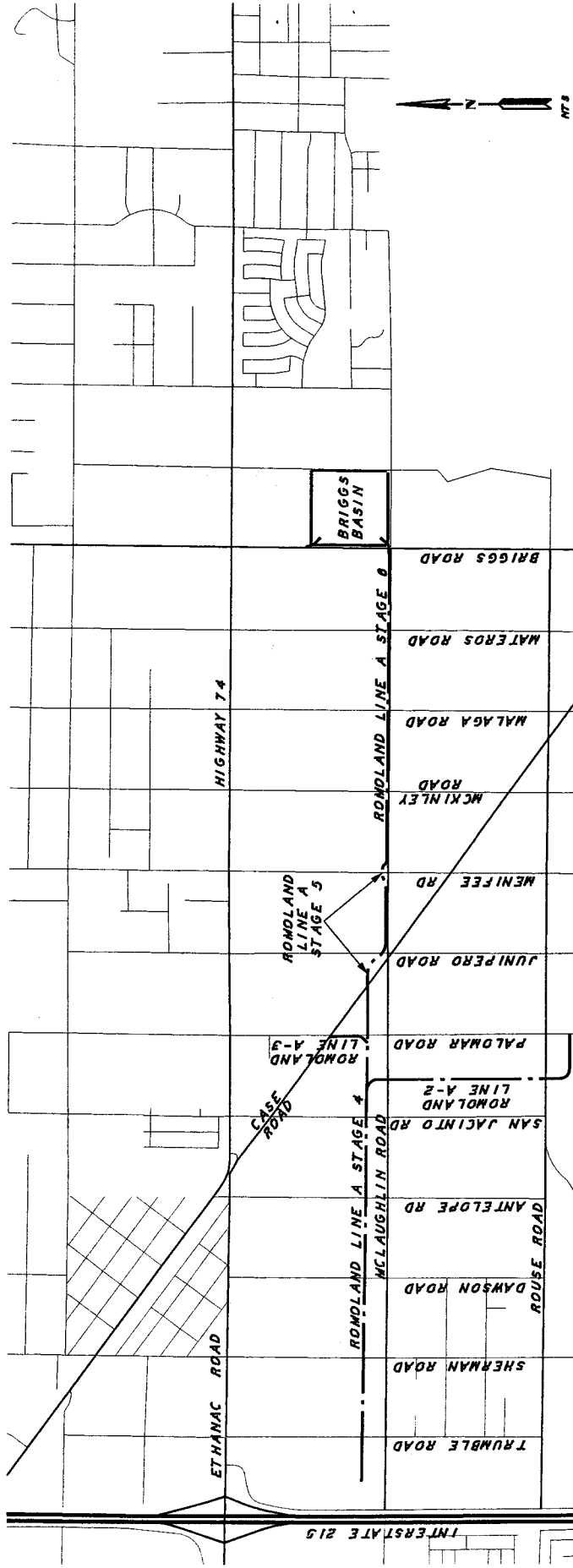

CITY OF MENIFEE

Romoland Line A Stage 4, Stage 5, Stage 6, Homoland MDP Line 1 Briggs Basin, Romoland MDP Line A-2 and Romoland MDP Line A-3 system involves the design, construction, operation and maintenance of approximately 21,000 lined-foot storm drain system consisting of open channels, reinforced concrete boxes, reinforced concrete pipes and one basin. The project begins at the upstream end of Romoland MDP Line A, Stage 3 project at Encanto Drive and I-215; traverses east along McLaughlin road and terminates at Briggs Basin located north east to the intersection of Briggs Road and McLaughlin Road. Romoland MDP Line A-2 traverses southerly 400 feet west of San Jacinto Road and terminates at its intersection with Rouse Road. Romoland MDP Line A-3 traverses northerly along Palomar Road and terminates at Case Road near the railroad tracks. The project lies within the cities of Perris, Menifee and unincorporated portions of the County.



OFFICE OF
CLERK OF THE BOARD OF SUPERVISORS
1st FLOOR, COUNTY ADMINISTRATIVE CENTER
P.O. BOX 1147, 4080 LEMON STREET
RIVERSIDE, CA 92502-1147
PHONE: (951) 955-1060
FAX: (951) 955-1071

KECIA HARPER-IHEM
Clerk of the Board of Supervisors

KIMBERLY A. RECTOR
Assistant Clerk of the Board

November 21, 2014

THE PRESS ENTERPRISE
ATTN: LEGALS
3512 FOURTEENTH STREET
RIVERSIDE, CA 92501

FAX (951) 368-9018
E-MAIL: legals@pe.com

RE: NOTICE INVITING BIDS: ROMOLAND MDP LINES

To Whom It May Concern:

Attached is a copy for publication in your newspaper for **TWO (2) CONSECUTIVE THURSDAYS: November 27, 2014 and December 4, 2014.**

We require your affidavit of publication immediately upon completion of the last publication.

Your invoice must be submitted to this office, WITH TWO CLIPPINGS OF THE PUBLICATION.

NOTE: PLEASE COMPOSE THIS PUBLICATION INTO A SINGLE COLUMN FORMAT.

Thank you in advance for your assistance and expertise.

Sincerely,

Cecilia Gil

Board Assistant to:
KECIA HARPER-IHEM, CLERK OF THE BOARD

Gil, Cecilia

From: PEC Legals Master <legalsmaster@pe.com>
Sent: Friday, November 21, 2014 10:35 AM
To: Gil, Cecilia
Subject: Re: FOR PUBLICATION: ROMOLAND MDP LINES

Received for publication on Nov. 27 and Dec. 4. Proof with cost to follow. Sorry - have been typing away & wasn't paying attention to e-mail.

Thank You!

Legal Advertising



Phone: 1-800-880-0345 / Fax: 951-368-9018 / E-mail: legals@pe.com

Please Note NEW Deadlines (effective 06/14): Deadline is 10:30 AM, three (3) business days prior to the date you would like to publish.

****Additional days required for larger ad sizes****

From: Gil, Cecilia <CCGIL@rcbos.org>
Sent: Friday, November 21, 2014 8:56 AM
To: PEC Legals Master
Subject: FOR PUBLICATION: ROMOLAND MDP LINES

Good morning!

Attached is a Notice Inviting Bids, for publication on 2 Thursdays: Nov. 27 and Dec. 4, 2014. Please confirm. THANK YOU!

Cecilia Gil
Board Assistant
Clerk of the Board
951-955-8464
MS# 1010

NOTICE TO CONTRACTORS

Riverside County Flood Control and Water Conservation District hereinafter called "District", invites sealed proposals for construction of:

**Romoland MDP Line A, Stages 4, 5 and 6,
Homeland MDP Line 1 Briggs Basin,
Romoland MDP Line A-2, and Romoland MDP Line A-3
Project No. 4-0-00310-04**

located in the cities of Menifee, Perris and Riverside County, California

Specifications and Contract Documents may be examined at the District's office at 1995 Market Street, Riverside, California, and may be obtained upon payment to District of **\$60.00** per set, received at the District's office and **\$65.00** per set if mailed. The Specifications and Contract Documents are also offered on CD-ROM for \$10.00 received at the District's office and \$15.00 if mailed. No refund.

Each proposal must be accompanied by a certified or cashier's check or bid bond equal to ten percent (10%) of the amount bid, payable to the Riverside County Flood Control and Water Conservation District as a guarantee that the Contractor will, if awarded the contract, execute a satisfactory contract and furnish the required bonds and proof of insurance.

Proposals must be in accordance with the instructions and filed with District by **2:00 p.m. on Thursday, December 18, 2014** at the District office at the above address which time and place are fixed for the public opening of bids.

General prevailing rate per diem wages and general prevailing rate of per diem wages for holiday and overtime work, including employer payments for health and welfare, pension, vacation, apprentices and similar purposes for each craft, classification or type of workman needed for execution of contracts under the jurisdiction of District have been obtained by the Board of Supervisors of the District from the Director of Industrial Relations of the State of California for the area where the work is to be done. The said determinations are on file in the principal office of the District, and will be made available to any interested person upon request.

Contractors submitting proposals for this project shall have an "A" Contractors license from the State of California in order to be considered eligible for the contract award.

Dated: November 21, 2014

Kecia Harper-Ihem, Clerk of the Board
By: Cecilia Gil, Board Assistant

Date	Reference Number	Description	Product/Zone	Size	Billed Units	Times Run	Rate	Gross Amount	Net Amount
11/27/2014	109994175-11272014	Romoland MDP Lines	Press-Enterprise	2 x 59 Li	118	1	1.45	171.10	171.10
12/4/2014	109994175-12042014	Romoland MDP Lines	Press-Enterprise	2 x 59 Li	118	1	1.3	153.40	153.40

Ordered By: Cecilia Gil

COUNTY OF RIVERSIDE
 BOARD OF SUPERVISORS
 2014 DEC - 8 AM 11:16

*Flood
11-1 of 10/28/14*

Legal Advertising Invoice

Balance

\$324.50

Sales Contact Information		Advertiser Information		
Maria Tinajero 951-368-9225	Billing Period 11/27/2014 - 12/04/2014	Billed Account Number 1100141323	Advertiser/Client Number 1100141323	Advertiser/Client Name BOARD OF SUPERVISORS

PLEASE DETACH AND RETURN THIS PORTION WITH YOUR REMITTANCE

THE PRESS-ENTERPRISE **PE.com**

Legal Advertising Invoice

Advertiser/Client Name		
BOARD OF SUPERVISORS		
Billing Period	Billed Account Number	Advertiser/Client Number
11/27/2014 - 12/04/2014	1100141323	1100141323
Balance	Invoice Number	Terms Of Payment
\$324.50	109994175-12042014	Due Upon Receipt

Billing Account Name And Address

Remittance Address

BOARD OF SUPERVISORS
COUNTY OF RIVERSIDE
P.O. BOX 1147
RIVERSIDE, CA 92502

The Press-Enterprise
POST OFFICE BOX 12009
RIVERSIDE, CA 92502-2209

THE PRESS-ENTERPRISE

1825 Chicago Ave, Suite 100
Riverside, CA 92507
951-684-1200
951-368-9018 FAX

**PROOF OF PUBLICATION
(2010, 2015.5 C.C.P)**

Publication(s): The Press-Enterprise

PROOF OF PUBLICATION OF

Ad Desc.: Romoland MDP Lines /

I am a citizen of the United States. I am over the age of eighteen years and not a party to or interested in the above entitled matter. I am an authorized representative of THE PRESS-ENTERPRISE, a newspaper in general circulation, printed and published daily in the County of Riverside, and which newspaper has been adjudicated a newspaper of general circulation by the Superior Court of the County of Riverside, State of California, under date of April 25, 1952, Case Number 54446, under date of March 29, 1957, Case Number 65673, under date of August 25, 1995, Case Number 267864, under date of February 4, 2013, Case Number RIC 1215735, under date of July 25, 2013, Case Number RIC 1305730, and under date of September 16, 2013, Case Number RIC 1309013; that the notice, of which the annexed is a printed copy, has been published in said newspaper in accordance with the instructions of the person(s) requesting publication, and not in any supplement thereof on the following dates, to wit:

11/27, 12/04/2014

I certify (or declare) under penalty of perjury that the foregoing is true and correct.

Date: December 04, 2014
At: Riverside, California

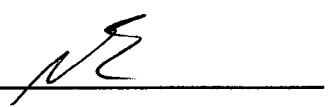

BOARD OF SUPERVISORS
COUNTY OF RIVERSIDE
P.O. BOX 1147
RIVERSIDE, CA 92502

Ad Number: 0009994175-01

P.O. Number:

Ad Copy:

NOTICE TO CONTRACTORS

Riverside County Flood Control and Water Conservation District hereinafter called "District", invites sealed proposals for construction of:

**Romoland MDP Line A, Stages 4, 5 and 6,
Homeland MDP Line 1 Briggs Basin,
Romoland MDP Line A-2, and Romoland MDP
Line A-3**

**Project No. 4-0-00310-04
located in the cities of Menifee, Perris and Riverside County, California**

Specifications and Contract Documents may be examined at the District's office at 1995 Market Street, Riverside, California, and may be obtained upon payment to District of \$60.00 per set, received at the District's office and \$65.00 per set if mailed. The Specifications and Contract Documents are also offered on CD-ROM for \$10.00 received at the District's office and \$15.00 if mailed. No refund.

Each proposal must be accompanied by a certified or cashier's check or bid bond equal to ten percent (10%) of the amount bid, payable to the Riverside County Flood Control and Water Conservation District as a guarantee that the Contractor will, if awarded the contract, execute a satisfactory contract and furnish the required bonds and proof of insurance.

Proposals must be in accordance with the instructions and filed with District by 2:00 p.m. on Thursday, December 18, 2014 at the District office at the above address which time and place are fixed for the public opening of bids.

General prevailing rate per diem wages and general prevailing rate of per diem wages for holiday and overtime work, including employer payments for health and welfare, pension, vacation, apprentices and similar purposes for each craft, classification or type of workman needed for execution of contracts under the jurisdiction of District have been obtained by the Board of Supervisors of the District from the Director of Industrial Relations of the State of California for the area where the work is to be done. The said determinations are on file in the principal office of the District, and will be made available to any interested person upon request.

Contractors submitting proposals for this project shall have an "A" Contractors license from the State of California in order to be considered eligible for the contract award.

Dated: November 21, 2014

Kecia Harper-Thorn, Clerk of the Board
By: Cecilia Gil, Board Assistant

11/27, 12/4

2014 DEC - 8 AM 11:16
CLERK OF SUPERVISORS
COUNTY OF RIVERSIDE