

**SUBMITTAL TO THE BOARD OF SUPERVISORS
COUNTY OF RIVERSIDE, STATE OF CALIFORNIA**

502A



FROM: TLMA – Transportation Department

SUBMITTAL DATE:
March 10, 2015

SUBJECT: Notice of Completion – Phase 1 of the Coachella Valley Mobile Home Park Paving Project Within the Communities of Mecca, Thermal, and Oasis. 4th District; [\$2,111,064]; Local Funds 100%

RECOMMENDED MOTION: That the Board of Supervisors execute and file the attached “Notice of Completion.”

BACKGROUND:

Summary

By Minute Order 3-84 of June 17, 2014, the Board of Supervisors entered into a contract with Golden Vista Construction dba Golden Valley Construction of Palm Springs, CA for the Mobile Home Park Paving Project Phase 1 within the communities of Mecca, Thermal, and Oasis.

Departmental Concurrence

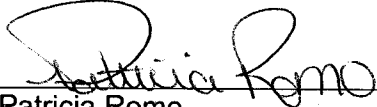

Patricia Romo
Assistant Director of Transportation

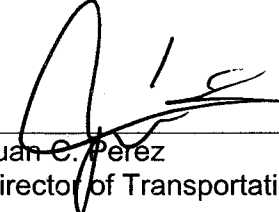

Juan C. Perez
Director of Transportation and Land Management

| FINANCIAL DATA | Current Fiscal Year: | Next Fiscal Year: | Total Cost: | Ongoing Cost: | POLICY/CONSENT (Per Exec. Office) |
|---|----------------------|-------------------|--------------|--|---|
| COST | \$ 2,111,064 | \$ 0 | \$ 2,111,064 | \$ 0 | Consent <input type="checkbox"/> Policy <input checked="" type="checkbox"/> |
| NET COUNTY COST | \$ 0 | \$ 0 | \$ 0 | \$ 0 | |
| SOURCE OF FUNDS: SCAQMD AB1318 (Sentinel) Mitigation Fees Fund (100%). There were no General funds used in this project. | | | | Budget Adjustment: No For Fiscal Year: 14/15 | |

C.E.O. RECOMMENDATION: APPROVE
BY: 
Tina Grande
County Executive Office Signature

MINUTES OF THE BOARD OF SUPERVISORS

On motion of Supervisor Benoit, seconded by Supervisor Jeffries and duly carried, IT WAS ORDERED that the above matter is approved as recommended.

Ayes: Jeffries, Washington, Benoit and Ashley
Nays: None
Absent: Tavaglione
Date: April 7, 2015
xc: Transp., Recorder

Kecia Harper-Ihem
Clerk of the Board
By: 
Deputy

- A-30
- Positions Added
- 4/5 Vote
- Change Order

Prev. Agn. Ref.: 6/17/14, Item 3-84 | District: 4 | Agenda Number:

3-30

SUBMITTAL TO THE BOARD OF SUPERVISORS, COUNTY OF RIVERSIDE, STATE OF CALIFORNIA
FORM 11: Notice of Completion – Phase 1 of the Coachella Valley Mobile Home Park Paving Project Within the Communities of Mecca, Thermal, and Oasis. 4th District; [\$2,111,064]; Local Funds 100%

DATE: March 10, 2015

PAGE: 2 of 2

BACKGROUND:

Summary (continued)

The originally authorized amount of the contract was \$2,270,825. The total amended contract is \$2,111,064, which is 7% less than the originally authorized amount.

The work was completed at the direction of the Transportation Department on October 2, 2014, Work Order Number C4-0053.

Impact on Residents and Businesses

The AB 1318 grant has enabled the County of Riverside to implement an emission reduction project that will have a direct benefit on the air quality and health of residents, while aiding in meeting regional air quality goals. Benefits of the project include improved air quality and improved ability for emergency vehicles, residents, and visitors to access mobile homes, especially during severe weather when communities can find themselves isolated.

SUPPLEMENTAL:

Additional Fiscal Information

Budget

| | | |
|---------------------------------|-------|--------------------|
| Original Contract Amount | | \$2,270,825 |
| Total Change Orders Authorized | 0.0% | \$0 |
| Estimated Pending Change Orders | 0.0% | \$0 |
| Authorized Contract Amount | | \$2,270,825 |
| * Quantity Adjustments | -7.0% | (\$159,761) |
| + CCO FA Adjustments | 0.0% | \$0 |
| Total Amended Contract Amount | 93.0% | \$2,111,064 |

Expenditures

| | |
|----------------------------|--------------------|
| Total Progress Payments | \$2,111,064 |
| Estimated Pending Payments | \$0 |
| Total Expenditures | \$2,111,064 |

(Over)/Under Contract Amount **\$0**

+ Change Orders using the Force Account method of payment issued prior to the work being completed generally do not use the total authorized amount.

* CAL-Trans Standard Specifications 4-1.03B. Increases or decreases in the quantity of a contract item of work will be determined by comparing the total pay quantity of such item of work with the Engineer's Estimate. If the total pay quantity of any item of work required under the contract varies from the Engineer's Estimate by 25 percent or less, payment will be made for the quantity of work of said item performed at the contract unit price, unless eligible for adjustment pursuant to Section 4-1.03C, "Changes in Character of Work."

This project was funded with \$2,111,064 of SCAQMD AB 1318 funds.

Contract History and Price Reasonableness

N/A

PLEASE COMPLETE THIS INFORMATION
RECORDING REQUESTED BY:

**KECIA HARPER-IHEM, CLERK OF THE BOARD
RIVERSIDE CO. CLERK OF THE BOARD
4080 LEMON STREET, 1ST FLOOR CAC
P O BOX 1147 – RIVERSIDE, CA 92502
MAIL STOP # 1010**

AND WHEN RECORDED MAIL TO:

**RETURN TO: STOP #1010
RIVERSIDE COUNTY CLERK OF THE BOARD
P. O. BOX 1147 – RIVERSIDE, CA 92502**

DOC # 2015-0143522

04/09/2015 03:01P Fee:NC

Page 1 of 2

Recorded in Official Records

County of Riverside

Peter Aldana

Assessor, County Clerk & Recorder



| S | R | U | PAGE | SIZE | DA | MISC | LONG | RFD | COPY |
|---------|---|---|------|------|------|------|------|------|------|
| | | | 2 | | 1 | | | | |
| M | A | L | 465 | 426 | PCOR | NCOR | SMF | NCHG | EXAM |
| HCT/ACC | | | | | | T: | CTY | UNI | 508 |

NOTICE OF COMPLETION

To be recorded with County Recorder
within 10 days after completion.
No recording fee.

C
508

Notice is hereby given by the undersigned owner, a public entity of the State of California, that a public work of improvement has been completed, as follows:

Project title or description of work: Coachella Valley Mobile Home Paving Project Phase 1

Date of Completion: Date of this notice 04/07/15

Nature of owner: County of Riverside, public entity

Interest or estate of owner: Public Roadway

Address of owner: 4080 Lemon Street, 8th Floor, Riverside, CA 92501

Name of contractor: Golden Vista Construction dba Golden Valley Construction

Street or legal description of site: Various Locations in the Communities of Mecca, Thermal and Oasis

Dated: April 7, 2015

Owner: County of Riverside
(Name of Public Entity)

By: Marion Ashley
Chairman, Board of Supervisors
Marion Ashley

STATE OF CALIFORNIA)

ss

COUNTY OF RIVERSIDE)

I am the Chairman of the governing board of the County of Riverside, the public entity which executed the foregoing notice and on whose behalf I make this verification; I have read this notice, know its contents, and the same is true. I certify under penalty of perjury that the foregoing is true and correct.

Executed at Riverside, California on 04/07/15 (Date)

Marion Ashley, Chairman of the Board of Supervisors
Marion Ashley

ATTEST:
Kecia Harper-Ihem, Clerk

By: Kecia Harper-Ihem Deputy

04.07.15 3-30

2015-4-12704



2015-0143522
04/09/2015 03:01P
2 of 2

**PETER ALDANA
COUNTY OF RIVERSIDE
ASSESSOR-COUNTY CLERK-RECORDER**

Recorder
P.O. Box 751
Riverside, CA 92502-0751
(951) 486-7000

www.riversideacr.com

CERTIFICATION

Pursuant to the provisions of Government Code 27361.7, I certify under the penalty of perjury that the following is a true copy of illegible wording found in the attached document:

(Print or type the page number(s) and wording below):

CLARIFICATION OF THE SEAL for the Riverside County Board of Supervisors
(embossed on document)



Date:

4-7-15

Signature:

Karen Barton

Print Name:

Karen Barton, Board Assistant, Riverside County Clerk of the Board

**COUNTY OF RIVERSIDE
TRANSPORTATION DEPARTMENT**

**Coachella Valley Mobile Home Park Paving Project - Phase 1
Communities of Mecca, Thermal and Oasis
Project No. C4-0053
SCAQMD Contract No. 13442**

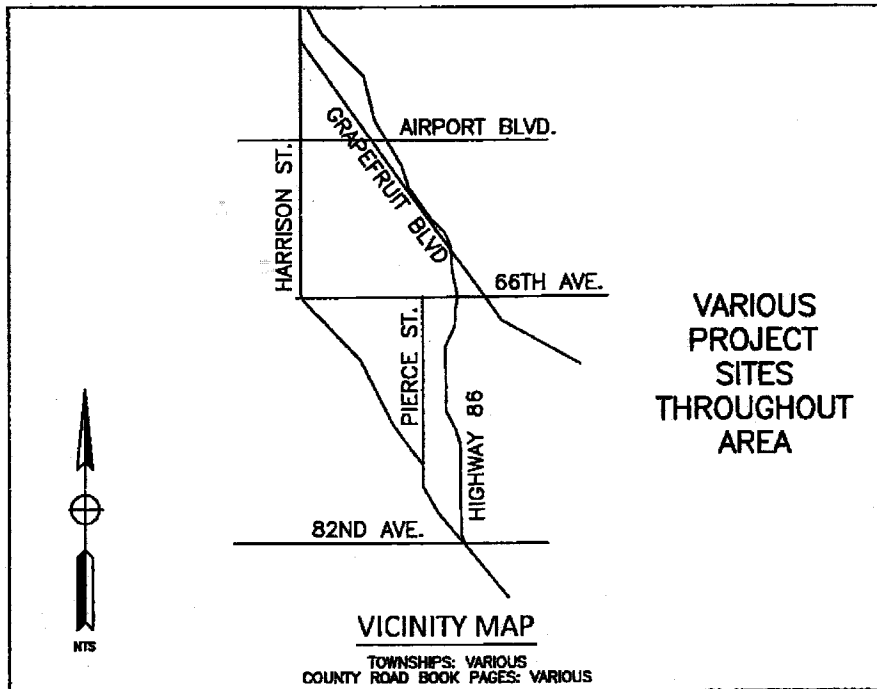
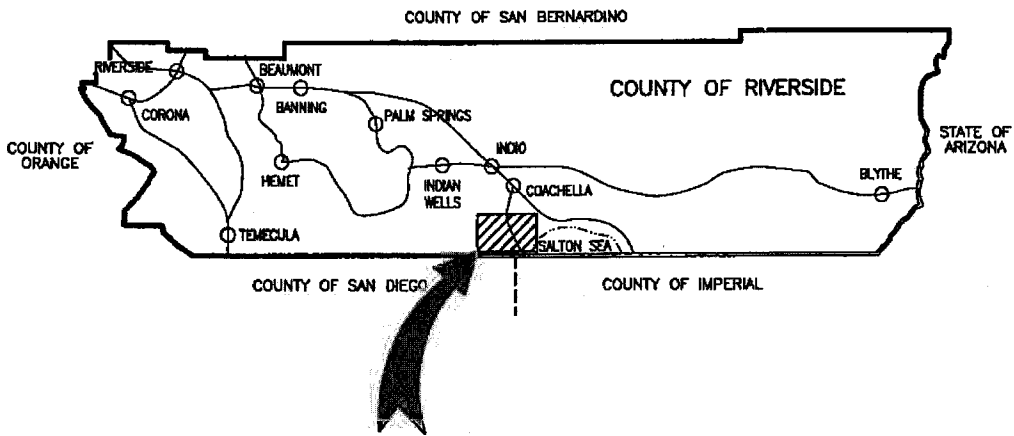



PROJECT: Coachella Valley Mobile Home Park Paving Project Phase 1
 County Project No: C4-0953, SCAQMD 13442
 Contract No. 14-05-007

Contractor: Golden Valley Construction
 Address: 2000 Executive Drive
 City, State, Zip: Palm Springs, CA 92262

Estimate No. 2 Final
 From: August 26, 2014
 To: October 25, 2014

| Item No. | Item Description | Units | Quantity | Unit Price | Original Contract Amount | Change Orders Quantity | Change Orders Amount | Amended Contract Quantity | Amended Contract Amount | This Estimate Quantity | This Estimate Amount | Previous Quantity | Total Estimate To Date Quantity | Total Estimate To Date Amount | % Auth. |
|----------|---|-------|----------|------------|--------------------------|------------------------|----------------------|---------------------------|-------------------------|------------------------|----------------------|-------------------|---------------------------------|-------------------------------|---------|
| | Base Bid - Location #: 7.11.12.15.17.18.19.20.21.27.29.30.31.14C.41A | | | | | | | | | | | | | | |
| 1 | MOBILIZATION | LS | 1 | 5,000.00 | 5,000.00 | | | 1.00 | 5,000.00 | 1.00 | 5,000.00 | 1.00 | 1.00 | 5,000.00 | 100% |
| 2 | DEVELOP WATER SUPPLY | LS | 1 | 2,500.00 | 2,500.00 | | | 1.00 | 2,500.00 | 1.00 | 2,500.00 | 1.00 | 1.00 | 2,500.00 | 100% |
| 3 | DUST ABATEMENT | LS | 1 | 2,000.00 | 2,000.00 | | | 1.00 | 2,000.00 | 1.00 | 2,000.00 | 1.00 | 1.00 | 2,000.00 | 100% |
| 4 | WATER POLLUTION CONTROL | LS | 1 | 1,500.00 | 1,500.00 | | | 1.00 | 1,500.00 | 1.00 | 1,500.00 | 1.00 | 1.00 | 1,500.00 | 100% |
| 5 | TRAFFIC CONTROL SYSTEM | LS | 1 | 1,000.00 | 1,000.00 | | | 1.00 | 1,000.00 | 1.00 | 1,000.00 | 1.00 | 1.00 | 1,000.00 | 100% |
| 6 | CLEARING AND GRUBBING | LS | 1 | 10,000.00 | 10,000.00 | | | 1.00 | 10,000.00 | 1.00 | 10,000.00 | 1.00 | 1.00 | 10,000.00 | 100% |
| 7 | ROADWAY PREPARATION | CY | 2,060 | 25.00 | 51,500.00 | | | 2,060.00 | 51,500.00 | 1,216.66 | 30,416.50 | 1,209.52 | 2,426.18 | 60,654.50 | 118% |
| 8 | GRINDING ASPHALT CONCRETE IN PLACE | SQYD | 19,030 | 0.65 | 12,369.50 | | | 19,030.00 | 12,369.50 | 14,067.22 | 9,143.69 | 8,676.11 | 22,743.33 | 14,783.16 | 120% |
| 9 | HOT MIX ASPHALT | TON | 5,720 | 85.00 | 486,200.00 | | | 5,720.00 | 486,200.00 | 4,854.21 | 412,607.85 | 1,266.22 | 6,120.43 | 520,238.55 | 107% |
| 10 | ASPHALT CONCRETE DIKE [RIV CO STD 212 - 6 INCH] | LF | 210 | 8.00 | 1,680.00 | | | 210.00 | 1,680.00 | 188.00 | 1,504.00 | | 188.00 | 1,504.00 | 90% |
| 11 | CLASS 2 AGGREGATE BASE | CY | 7,390 | 35.00 | 258,650.00 | | | 7,390.00 | 258,650.00 | 4,960.93 | 173,632.55 | 2,125.98 | 7,086.91 | 248,041.85 | 96% |
| 12 | SUBGRADE ENHANCEMENT FABRIC [GEOGRID 1-LAYER] | SQYD | 3,550 | 4.50 | 15,975.00 | | | 3,550.00 | 15,975.00 | 101.39 | 456.26 | 4,336.11 | 4,437.50 | 19,968.75 | 125% |
| 13 | RELOCATE ROADSIDE SIGN & REPLACE POST | EA | 1 | 150.00 | 150.00 | | | 1.00 | 150.00 | 1.00 | 150.00 | | 1.00 | 150.00 | 100% |
| 14 | BARRIER POST (BOLLARD) | EA | 3 | 600.00 | 1,800.00 | | | 3.00 | 1,800.00 | 3.00 | 1,800.00 | | 3.00 | 1,800.00 | 100% |
| 15 | 4" WELDED STEEL EPOXY LINED AND COATED PIPE | LF | 50 | 120.00 | 6,000.00 | | | 50.00 | 6,000.00 | 50.00 | 6,000.00 | | 50.00 | 6,000.00 | 100% |
| 16 | 10" WELDED STEEL EPOXY LINED AND COATED PIPE | LF | 50 | 250.00 | 12,500.00 | | | 50.00 | 12,500.00 | 50.00 | 12,500.00 | | 50.00 | 12,500.00 | 100% |
| 17 | 18" WELDED STEEL EPOXY LINED AND COATED PIPE | LF | 50 | 375.00 | 18,750.00 | | | 50.00 | 18,750.00 | 60.00 | 22,500.00 | | 60.00 | 22,500.00 | 120% |
| 18 | 15" PLASTIC PIPE [HDPE] | LF | 50 | 140.00 | 7,000.00 | | | 50.00 | 7,000.00 | 60.00 | 8,400.00 | | 60.00 | 8,400.00 | 120% |
| 19 | 24" PLASTIC PIPE [HDPE] | LF | 50 | 180.00 | 9,000.00 | | | 50.00 | 9,000.00 | 50.00 | 9,000.00 | | 50.00 | 9,000.00 | 100% |
| 20 | MISCELLANEOUS WORK (AS DIRECTED) | FA | 394,382 | 1.00 | 394,382.00 | | | 394,382.00 | 394,382.00 | 130,888.80 | 130,888.80 | | 130,888.80 | 130,888.80 | 33% |
| | Alternate Bid Schedule 1 - Location #: 2.3.4.5.6.8.9.13.22 | | | | | | | | | | | | | | |
| 21 | MOBILIZATION | LS | 1 | 5,000.00 | 5,000.00 | | | 1.00 | 5,000.00 | | | | 1.00 | 5,000.00 | 100% |



Contractor: Golden Valley Construction
 Address: 2000 Executive Drive
 City, State, Zip: Palm Springs, CA 92282

Estimate No. 2 Final
 From: August 26, 2014
 To: October 25, 2014

PROJECT: Coachella Valley Mobile Home Park Paving Project Phase 1
 County Project No.: CA-0053, SCAQMD 13442
 Contract No. 14-05-007

| Item No. | Item Description | Units | Quantity | Unit Price | Original Contract Amount | Change Orders Quantity | Change Orders Amount | Amended Contract Quantity | Amended Contract Amount | This Estimate Quantity | This Estimate Amount | Previous Quantity | Total Estimate To Date Quantity | Total Estimate To Date Amount | % Adh. |
|---|---|-------|----------|------------|--------------------------|------------------------|----------------------|---------------------------|-------------------------|------------------------|----------------------|-------------------|---------------------------------|-------------------------------|--------|
| 22 | DEVELOP WATER SUPPLY | LS | 1 | 1,500.00 | 1,500.00 | | | 1.00 | 1,500.00 | 1.00 | 1,500.00 | 1.00 | 1.00 | 1,500.00 | 100% |
| 23 | DUST ABATEMENT | LS | 1 | 2,000.00 | 2,000.00 | | | 1.00 | 2,000.00 | 1.00 | 2,000.00 | 1.00 | 1.00 | 2,000.00 | 100% |
| 24 | WATER POLLUTION CONTROL | LS | 1 | 1,000.00 | 1,000.00 | | | 1.00 | 1,000.00 | 1.00 | 1,000.00 | 1.00 | 1.00 | 1,000.00 | 100% |
| 25 | TRAFFIC CONTROL SYSTEM | LS | 1 | 1,000.00 | 1,000.00 | | | 1.00 | 1,000.00 | 1.00 | 1,000.00 | 1.00 | 1.00 | 1,000.00 | 100% |
| 26 | CLEARING AND GRUBBING | LS | 1 | 5,000.00 | 5,000.00 | | | 1.00 | 5,000.00 | 1.00 | 5,000.00 | 1.00 | 1.00 | 5,000.00 | 100% |
| 27 | ROADWAY PREPARATION | CY | 1,780 | 25.00 | 44,500.00 | | | 1,780.00 | 44,500.00 | 164.29 | 4,107.25 | 2,013.36 | 2,177.65 | 54,441.25 | 122% |
| 28 | GRINDING ASPHALT CONCRETE IN PLACE | SQYD | 18,180 | 0.65 | 11,817.00 | | | 18,180.00 | 11,817.00 | 5,322.78 | 3,459.81 | 14,036.67 | 19,359.45 | 12,583.64 | 106% |
| 29 | HOT MIX ASPHALT | TON | 5,020 | 85.00 | 426,700.00 | | | 5,020.00 | 426,700.00 | 1,883.92 | 160,133.20 | 3,630.17 | 5,514.09 | 468,697.65 | 110% |
| 30 | ASPHALT CONCRETE DIKE [RIV CO STD 212 - 6 INCH] | LF | 620 | 8.00 | 4,960.00 | | | 620.00 | 4,960.00 | 610.00 | 4,880.00 | | 610.00 | 4,880.00 | 98% |
| 31 | CLASS 2 AGGREGATE BASE | CY | 6,350 | 35.00 | 222,250.00 | | | 6,350.00 | 222,250.00 | 2,888.60 | 94,101.00 | 3,882.83 | 6,571.43 | 230,000.05 | 103% |
| 32 | MINOR CONCRETE (GUTTER DEPRESSION) [V-DITCH] | CY | 5 | 150.00 | 750.00 | | | 5.00 | 750.00 | 5.00 | 750.00 | | 5.00 | 750.00 | 100% |
| 33 | ROADSIDE SIGN - ONE POST ["ONE WAY" SIGNS] | EA | 6 | 250.00 | 1,500.00 | | | 6.00 | 1,500.00 | 6.00 | 1,500.00 | | 6.00 | 1,500.00 | 100% |
| 34 | RELOCATE ROADSIDE SIGN & REPLACE POST | EA | 1 | 150.00 | 150.00 | | | 1.00 | 150.00 | 1.00 | 150.00 | | 1.00 | 150.00 | 100% |
| 35 | BARRIER POST (BOLLARD) | EA | 3 | 600.00 | 1,800.00 | | | 3.00 | 1,800.00 | 3.00 | 1,800.00 | | 3.00 | 1,800.00 | 100% |
| 36 | 4" WELDED STEEL EPOXY LINED AND COATED PIPE | LF | 260 | 120.00 | 31,200.00 | | | 260.00 | 31,200.00 | 300.00 | 36,000.00 | | 300.00 | 36,000.00 | 115% |
| Alternate Bid Schedule 2 - Location #: 10 | | | | | | | | | | | | | | | |
| 37 | MOBILIZATION | LS | 1 | 1,000.00 | 1,000.00 | | | 1.00 | 1,000.00 | | | 1.00 | 1.00 | 1,000.00 | 100% |
| 38 | DEVELOP WATER SUPPLY | LS | 1 | 500.00 | 500.00 | | | 1.00 | 500.00 | | | 1.00 | 1.00 | 500.00 | 100% |
| 39 | DUST ABATEMENT | LS | 1 | 500.00 | 500.00 | | | 1.00 | 500.00 | | | 1.00 | 1.00 | 500.00 | 100% |
| 40 | WATER POLLUTION CONTROL | LS | 1 | 1,000.00 | 1,000.00 | | | 1.00 | 1,000.00 | | | 1.00 | 1.00 | 1,000.00 | 100% |
| 41 | TRAFFIC CONTROL SYSTEM | LS | 1 | 500.00 | 500.00 | | | 1.00 | 500.00 | | | 1.00 | 1.00 | 500.00 | 100% |
| 42 | CLEARING AND GRUBBING | LS | 1 | 2,000.00 | 2,000.00 | | | 1.00 | 2,000.00 | | | 1.00 | 1.00 | 2,000.00 | 100% |
| 43 | ROADWAY PREPARATION | CY | 150 | 25.00 | 3,750.00 | | | 150.00 | 3,750.00 | | | 187.50 | 187.50 | 4,687.50 | 125% |



Contractor: Golden Valley Construction
 Address: 2000 Executive Drive
 City, State, Zip: Palm Springs, CA 92262

Estimate No. 2 Final
 From: August 26, 2014
 To: October 25, 2014

PROJECT: Coachella Valley Mobile Home Park Paving Project Phase 1
 County Project No.: C4-0053, SCAQMD 13442
 Contract No. 14-05-007

| Item No. | Item Description | Units | Quantity | Unit Price | Original Contract Amount | Change Orders Quantity | Change Orders Amount | Amended Contract Quantity | Amended Contract Amount | This Estimate Quantity | This Estimate Amount | Previous Quantity | Total Estimate To Date Amount | % Auth. |
|----------|---|-------|----------|------------|--------------------------|------------------------|----------------------|---------------------------|-------------------------|------------------------|----------------------|-------------------|-------------------------------|---------|
| 44 | GRINDING ASPHALT CONCRETE IN PLACE | SQYD | 1,910 | 0.65 | 1,241.50 | | | 1,910.00 | 1,241.50 | 1,877.78 | 1,877.78 | 1,877.78 | 1,220.56 | 98% |
| 45 | HOT MIX ASPHALT | TON | 410 | 85.00 | 34,850.00 | | | 410.00 | 34,850.00 | 419.04 | 419.04 | 419.04 | 35,618.40 | 102% |
| 46 | ASPHALT CONCRETE DIKE [RIV CO STD 212 - 6 INCH] | LF | 220 | 8.00 | 1,760.00 | | | 220.00 | 1,760.00 | 198.00 | 1,584.00 | 198.00 | 1,584.00 | 90% |
| 47 | CLASS 2 AGGREGATE BASE | CY | 500 | 35.00 | 17,500.00 | | | 500.00 | 17,500.00 | 482.43 | 16,885.05 | 482.43 | 16,885.05 | 96% |
| | Alternate Bid Schedule 3 - Location #. 16 | | | | | | | | | | | | | |
| 48 | MOBILIZATION | LS | 1 | 500.00 | 500.00 | | | 1.00 | 500.00 | 1.00 | 500.00 | 1.00 | 500.00 | 100% |
| 49 | DEVELOP WATER SUPPLY | LS | 1 | 500.00 | 500.00 | | | 1.00 | 500.00 | 1.00 | 500.00 | 1.00 | 500.00 | 100% |
| 50 | DUST ABATEMENT | LS | 1 | 500.00 | 500.00 | | | 1.00 | 500.00 | 1.00 | 500.00 | 1.00 | 500.00 | 100% |
| 51 | WATER POLLUTION CONTROL | LS | 1 | 500.00 | 500.00 | | | 1.00 | 500.00 | 1.00 | 500.00 | 1.00 | 500.00 | 100% |
| 52 | TRAFFIC CONTROL SYSTEM | LS | 1 | 200.00 | 200.00 | | | 1.00 | 200.00 | 1.00 | 200.00 | 1.00 | 200.00 | 100% |
| 53 | CLEARING AND GRUBBING | LS | 1 | 1,000.00 | 1,000.00 | | | 1.00 | 1,000.00 | 1.00 | 1,000.00 | 1.00 | 1,000.00 | 100% |
| 54 | ROADWAY PREPARATION | CY | 60 | 25.00 | 1,500.00 | | | 60.00 | 1,500.00 | 54.00 | 1,350.00 | 54.00 | 1,350.00 | 90% |
| 55 | HOT MIX ASPHALT | TON | 160 | 85.00 | 13,600.00 | | | 160.00 | 13,600.00 | 147.45 | 12,533.25 | 147.45 | 12,533.25 | 92% |
| 56 | CLASS 2 AGGREGATE BASE | CY | 260 | 35.00 | 9,100.00 | | | 260.00 | 9,100.00 | 243.73 | 8,530.55 | 243.73 | 8,530.55 | 94% |
| | Alternate Bid Schedule 4 - Location #. 14 | | | | | | | | | | | | | |
| 57 | MOBILIZATION | LS | 1 | 500.00 | 500.00 | | | 1.00 | 500.00 | 1.00 | 500.00 | 1.00 | 500.00 | 100% |
| 58 | DEVELOP WATER SUPPLY | LS | 1 | 500.00 | 500.00 | | | 1.00 | 500.00 | 1.00 | 500.00 | 1.00 | 500.00 | 100% |
| 59 | DUST ABATEMENT | LS | 1 | 500.00 | 500.00 | | | 1.00 | 500.00 | 1.00 | 500.00 | 1.00 | 500.00 | 100% |
| 60 | WATER POLLUTION CONTROL | LS | 1 | 200.00 | 200.00 | | | 1.00 | 200.00 | 1.00 | 200.00 | 1.00 | 200.00 | 100% |
| 61 | TRAFFIC CONTROL SYSTEM | LS | 1 | 200.00 | 200.00 | | | 1.00 | 200.00 | 1.00 | 200.00 | 1.00 | 200.00 | 100% |
| 62 | CLEARING AND GRUBBING | LS | 1 | 1,000.00 | 1,000.00 | | | 1.00 | 1,000.00 | 1.00 | 1,000.00 | 1.00 | 1,000.00 | 100% |
| 63 | ROADWAY PREPARATION | CY | 170 | 25.00 | 4,250.00 | | | 170.00 | 4,250.00 | 159.26 | 3,981.50 | 159.26 | 3,981.50 | 94% |
| 64 | GRINDING ASPHALT CONCRETE IN PLACE | SQYD | 3,030 | 0.65 | 1,969.50 | | | 3,030.00 | 1,969.50 | 1,794.44 | 1,166.39 | 1,794.44 | 1,166.39 | 59% |

PROJECT: Coachella Valley Mobile Home Park Paving Project Phase 1
 County Project No.: C4-0053, SCAMHD-13442
 Contract No. 14-05-407

Contractor: Golden Valley Construction
 Address: 2000 Executive Drive
 City, State, Zip: Palm Springs, CA 92262

Estimate No. 2 Final
 From: August 26, 2014
 To: October 25, 2014



| Item No. | Units | Item Description | Quantity | Unit Price | Original Contract Amount | Change Orders Quantity | Change Orders Amount | Amended Contract Quantity | Amended Contract Amount | This Estimate Quantity | This Estimate Amount | Previous Quantity | Total Estimate To Date Quantity | Total Estimate To Date Amount | % Add. |
|----------|-------|--|----------|------------|--------------------------|------------------------|----------------------|---------------------------|-------------------------|------------------------|----------------------|-------------------|---------------------------------|-------------------------------|--------|
| 65 | TON | HOT MIX ASPHALT | 440 | 85.00 | 37,400.00 | | | 440.00 | 37,400.00 | 388.60 | 33,031.00 | | 388.60 | 33,031.00 | 88% |
| 66 | CY | CLASS 2 AGGREGATE BASE | 700 | 35.00 | 24,500.00 | | | 700.00 | 24,500.00 | 698.76 | 24,456.60 | | 698.76 | 24,456.60 | 100% |
| | | <u>Alternate Bid Schedule 9 - Location # 36:</u> | | | | | | | | | | | | | |
| 104 | LS | MOBILIZATION | 1 | 500.00 | 500.00 | | | 1.00 | 500.00 | 1.00 | 500.00 | | 1.00 | 500.00 | 100% |
| 105 | LS | DEVELOP WATER SUPPLY | 1 | 500.00 | 500.00 | | | 1.00 | 500.00 | 1.00 | 500.00 | | 1.00 | 500.00 | 100% |
| 106 | LS | DUST ABATEMENT | 1 | 200.00 | 200.00 | | | 1.00 | 200.00 | 1.00 | 200.00 | | 1.00 | 200.00 | 100% |
| 107 | LS | WATER POLLUTION CONTROL | 1 | 200.00 | 200.00 | | | 1.00 | 200.00 | 1.00 | 200.00 | | 1.00 | 200.00 | 100% |
| 108 | LS | TRAFFIC CONTROL SYSTEM | 1 | 200.00 | 200.00 | | | 1.00 | 200.00 | 1.00 | 200.00 | | 1.00 | 200.00 | 100% |
| 109 | LS | CLEARING AND GRUBBING | 1 | 1,000.00 | 1,000.00 | | | 1.00 | 1,000.00 | 1.00 | 1,000.00 | | 1.00 | 1,000.00 | 100% |
| 110 | CY | ROADWAY PREPARATION | 80 | 25.00 | 2,000.00 | | | 80.00 | 2,000.00 | 70.37 | 1,759.25 | | 70.37 | 1,759.25 | 88% |
| 111 | TON | HOT MIX ASPHALT | 220 | 85.00 | 18,700.00 | | | 220.00 | 18,700.00 | 207.61 | 17,646.85 | | 207.61 | 17,646.85 | 94% |
| 112 | LF | ASPHALT CONCRETE DIKE [RIV CO STD 2'12 - 6 INCH] | 40 | 8.00 | 320.00 | | | 40.00 | 320.00 | 40.00 | 320.00 | | 40.00 | 320.00 | 100% |
| 113 | CY | CLASS 2 AGGREGATE BASE | 340 | 35.00 | 11,900.00 | | | 340.00 | 11,900.00 | 370.37 | 12,962.95 | | 370.37 | 12,962.95 | 109% |
| 114 | LF | 4" WELDED STEEL EPOXY LINED AND COATED PIPE | 110 | 120.00 | 13,200.00 | | | 110.00 | 13,200.00 | 120.00 | 14,400.00 | | 120.00 | 14,400.00 | 109% |

Contractor: Golden Valley Construction
 Address: 2000 Executive Drive
 City, State, Zip: Palm Springs, CA 92262

Estimate No. 2 Final
 From: August 26, 2014
 To: October 25, 2014

| Item No. | Item Description | Units | Quantity | Unit Price | Original Contract Amount | Amended Contract Quantity | Amended Contract Amount | Changes Orders Quantity | Changes Orders Amount | This Estimate Quantity | This Estimate Amount | Previous Quantity | Previous Amount | Total Estimate To Date Quantity | Total Estimate To Date Amount | % Auth. |
|----------------------|------------------|-------|----------|------------|--------------------------|---------------------------|-------------------------|-------------------------|-----------------------|------------------------|----------------------|-------------------|-----------------|---------------------------------|-------------------------------|---------|
| | | | | | 2,270,824.50 | | 2,270,824.50 | | 0.00 | | 1,288,303.25 | | | | 2,111,064.05 | |
| PROJECT TOTAL | | | | | | | | | | | | | | | | |

Made by: Jesse Mendoza
 Checked by: JRM 11/2/14
 OK Const. Supv. JRM 11/2/14

Working Days: 100
 Days Added: 0
 Subtotal: 100
 Days Used: 48
 % Time Elapsed: 48%

Start Date: 7-28-14
 End Date: 10-2-14
 % \$ Complete: 93%

Original Contract: \$2,270,824.50
 Amended Contract: \$2,270,824.50

TOTAL VALUE OF WORK TO DATE: \$2,111,064.05
 LESS RETENTION: 5% 105,553.18
 TOTAL DUE TO DATE: \$2,005,510.87
 LESS PREVIOUSLY INVOICED: 800,622.78
 LESS LABOR NON COMPLIANCE: 0.00
 TOTAL DUE THIS PAYMENT: \$1,204,888.09

This Estimate Approved [Signature] Date: 11/2/14 for:
 Patricia Romo, Assistant Director of Transportation

Received by Accounts Payable: _____
 By: _____

Quantities on This Estimate Approved [Signature] Date: 11.7.14
 Mike Helzer
 Golden Valley Construction

TRANSFISCAL APPROVED
 By: Crystal Potter 5-3461
 NOV 21 2014

PAYMENT APPROVAL

Fund 20000
 Dept ID 31305
 Account 527980
 Project EC4-0053E
 Activity ID Z3500

Resource Type CAT
 Signature [Signature]
 Date 11/13/14

794
 11/19/14