

**SUBMITTAL TO THE BOARD OF SUPERVISORS
COUNTY OF RIVERSIDE, STATE OF CALIFORNIA**

843
A



FROM: TLMA – Transportation Department

SUBMITTAL DATE:
January 13, 2015

SUBJECT: Notice of Completion – Mecca Group 4 Street Improvement Project, Coahuilla Street, Date Palm Street, and 4th Street in the Unincorporated Community of Mecca. 4th District; [\$1,101,707]; Local Funds 87%, State Funds 13%

RECOMMENDED MOTION: That the Board of Supervisors execute and file the attached “Notice of Completion.”

BACKGROUND:

Summary

By Minute Order 3-34 of February 25, 2014, the Board of Supervisors entered into a contract with Golden Valley Construction of Palm Springs, CA for the construction of street improvements in the unincorporated community of Mecca.

Departmental Concurrence

Patricia Romo
Assistant Director of Transportation for
Juan C. Perez
Director of Transportation and Land Management

FINANCIAL DATA	Current Fiscal Year:	Next Fiscal Year:	Total Cost:	Ongoing Cost:	POLICY/CONSENT (Per Exec. Office)
COST	\$ 1,101,707	\$ 0	\$ 1,101,707	\$ 0	Consent <input type="checkbox"/> Policy <input checked="" type="checkbox"/>
NET COUNTY COST	\$ 0	\$ 0	\$ 0	\$ 0	

SOURCE OF FUNDS: Gas Tax (87%), State Safe Routes to School Funds (13%). There were no General Funds used in this project.

Budget Adjustment: No
For Fiscal Year: 2014-2015

C.E.O. RECOMMENDATION:

APPROVE

BY:

Tina Grande

County Executive Office Signature

MINUTES OF THE BOARD OF SUPERVISORS

On motion of Supervisor Jeffries, seconded by Supervisor Tavaglione and duly carried, IT WAS ORDERED that the above matter is approved as recommended.

Ayes: Jeffries, Tavaglione and Ashley
Nays: None
Absent: Benoit
Date: January 27, 2015
xc: Transp., Recorder

Kecia Harper-Ihem
Clerk of the Board

By: Deputy

Positions Added

Change Order

A-30

4/5 Vote

Prev. Agn. Ref.: 02/25/14, Item 3-34

District: 4

Agenda Number:

3-21

SUBMITTAL TO THE BOARD OF SUPERVISORS, COUNTY OF RIVERSIDE, STATE OF CALIFORNIA
FORM 11: Notice of Completion – Mecca Group 4 Street Improvement Project, Coahuilla Street, Date Palm Street, and 4th Street in the Unincorporated Community of Mecca, 4th District; [\$1,101,707]; Local Funds 87%, State Funds 13%

DATE: January 13, 2015

PAGE: 2 of 3

BACKGROUND:

Summary (continued)

The originally authorized amount of the contract was \$1,024,063. The total amended contract is \$1,101,707, which is 7.6% more than the originally authorized amount. The 7.6% increase in the contract price was the result of unsuitable underlying subgrade material that was discovered during the construction of the project. Additional excavation, aggregate base, and geosynthetic subgrade reinforcing fabric was required to stabilize the roadway prior to asphalt paving operations.

This work was completed at the direction of the Transportation Department on April 22, 2014, Work Order Number C1-0654, State Project No. SR2SL-5956 (215)

Impact on Residents and Businesses

The improvements on Coahuilla Street, Date Palm Street, and 4th Street have benefitted the community by improving driving surfaces, drainage, and pedestrian access, specifically for children who walk to Mecca Elementary School fronting Coahuilla Street and Date Palm Street.

SUPPLEMENTAL:

Additional Fiscal Information

Budget

Original Contract Amount		1,024,063
Total Change Orders Authorized	0.0%	0
Estimated Pending Change Orders	0.0%	0
Authorized Contract Amount		1,024,063
* Quantity Adjustments	7.6%	77,644
+ CCO FA Adjustments	0.0%	0
Total Amended Contract Amount	107.6%	1,101,707

Expenditures

Total Progress Payments		1,101,707
Estimated Pending Payments		0
Total Expenditures		1,101,707

(Over)/Under Contract Amount **0**

+ Change Orders using the Force Account method of payment issued prior to the work being completed generally do not use the total authorized amount.

* CAL-Trans Standard Specifications 4-1.03B. Increases or decreases in the quantity of a contract item of work will be determined by comparing the total pay quantity of such item of work with the Engineer's Estimate. If the total pay quantity of any item of work required under the contract varies from the Engineer's Estimate by 25 percent or less, payment will be made for the quantity of work of said item performed at the contract unit price, unless eligible for adjustment pursuant to Section 4-1.03C, "Changes in Character of Work."

SUBMITTAL TO THE BOARD OF SUPERVISORS, COUNTY OF RIVERSIDE, STATE OF CALIFORNIA
FORM 11: Notice of Completion – Mecca Group 4 Street Improvement Project, Coahuilla Street, Date Palm Street, and 4th Street in the Unincorporated Community of Mecca, 4th District; [\$1,101,707]; Local Funds 87%, State Funds 13%

DATE: January 13, 2015

PAGE: 3 of 3

Mecca Group 4 Improvement Project was funded with \$958,485 of Gas Tax funds and \$143,222 of State Safe Routes to School funds.

Contract History and Price Reasonableness

N/A

PLEASE COMPLETE THIS INFORMATION
RECORDING REQUESTED BY:

**KECIA HARPER-IHEM, CLERK OF THE BOARD
RIVERSIDE CO. CLERK OF THE BOARD
4080 LEMON STREET, 1ST FLOOR CAC
P O BOX 1147 – RIVERSIDE, CA 92502**

MAIL STOP # 1010

AND WHEN RECORDED MAIL TO:

**RETURN TO: STOP #1010
RIVERSIDE COUNTY CLERK OF THE BOARD
P. O. BOX 1147 – RIVERSIDE, CA 92502**

DOC # 2015-0040905

02/02/2015 08:51A Fee:NC

Page 1 of 2

Recorded in Official Records
County of Riverside

Peter Aldana

Assessor, County Clerk & Recorder



S	R	U	PAGE	SIZE	DA	MISC	LONG	RFD	COPY
1			2						
M	A	L	465	426	PCOR	NCOR	SMF	NCHG	EXAM
NCT/OC					T:		CTY	UNI	50

NOTICE OF COMPLETION

To be recorded with County Recorder
within 10 days after completion.
No recording fee.



Notice is hereby given by the undersigned owner, a public entity of the State of California, that a public work of improvement has been completed, as follows:

Project title or description of work: Mecca Group 4 Street Improvement Project

Date of Completion: Date of this notice 01/27/15

Nature of owner: County of Riverside, public entity

Interest or estate of owner: Public Roadway

Address of owner: 4080 Lemon Street, 8th Floor, Riverside, CA 92501

Name of contractor: Golden Valley Construction

Street or legal description of site: Coahuilla Street, Date Palm Street and 4th Street

Dated: January 27, 2015

A notary public or other officer completing this certificate verifies only the identity of the individual who signed the document to which this certificate is attached, and not the truthfulness, accuracy, or validity of that document.

STATE OF CALIFORNIA)

COUNTY OF RIVERSIDE)

Owner: County of Riverside
(Name of Public Entity)

By: Marion Ashley
Chairman, Board of Supervisors
Marion Ashley

I am the Chairman of the governing board of the County of Riverside, the public entity which executed the foregoing notice and on whose behalf I make this verification; I have read this notice, know its contents, and the same is true. I certify under penalty of perjury that the foregoing is true and correct.

Executed at Riverside, California on 01/27/15 (Date)

Marion Ashley, Chairman of the Board of Supervisors
Marion Ashley

ATTEST:

Kecia Harper-Ihem, Clerk

By [Signature] Deputy

01.27.15 3-21

2015-2-120010



**PETER ALDANA
COUNTY OF RIVERSIDE
ASSESSOR-COUNTY CLERK-RECORDER**

Recorder
P.O. Box 751
Riverside, CA 92502-0751
(951) 486-7000

www.riversideacr.com

CERTIFICATION

Pursuant to the provisions of Government Code 27361.7, I certify under the penalty of perjury that the following is a true copy of illegible wording found in the attached document:

(Print or type the page number(s) and wording below):

CLARIFICATION OF THE SEAL for the Riverside County Board of Supervisors
(embossed on document)



Date: 1-27-15

Signature: Karen Barton

Print Name: Karen Barton, Board Assistant, Riverside County Clerk of the Board

PROJECT: Mecca Group Improvement Project Coahuilla Street, Date Palm Street and 4th Street, Community of Mecca County Project No.: C1-0654, State Project No. SR2SL-4956(215) Contract No. 14-01-002										Contractor: Golden Valley Construction 2000 Executive Drive Palm Springs, CA 92262			Estimate No. 3 Final From: May 26, 2014 To: July 25, 2014	
Item No.	Item Description	Units	Quantity	Unit Price	Original Contract Amount	Change Orders Quantity	Amended Contract Quantity	This Estimate Quantity	Previous Quantity	Total Estimate To Date Quantity	% Auth.			
1	MOBILIZATION, DEMOBILIZATION AND FINAL CLEANUP	LS	1	10,000.00	10,000.00		1.00	0.15	0.85	10,000.00	100%			
2	DUST ABATEMENT	LS	1	2,500.00	2,500.00		1.00	0.15	0.85	2,500.00	100%			
3	DEVELOP WATER SUPPLY	LS	1	2,000.00	2,000.00		1.00	0.15	0.85	2,000.00	100%			
4	WATER POLLUTION CONTROL	LS	1	1,500.00	1,500.00		1.00	0.15	0.85	1,500.00	100%			
5	TRAFFIC CONTROL SYSTEM	LS	1	7,000.00	7,000.00		1.00	0.15	0.85	7,000.00	100%			
6	TEMPORARY CONSTRUCTION PROJECT FUNDING IDENTIFICATION SIGN	EA	1	1,000.00	1,000.00		1.00	0.15	0.85	1,000.00	100%			
7	CLEARING AND GRUBBING (INCLUDING VARIOUS ITEMS LISTED IN SPECIAL	LS	1	12,000.00	12,000.00		1.00		1.00	12,000.00	100%			
8	ROADWAY EXCAVATION	CY	4,100	9.00	36,900.00		4,100.00		4,174.00	37,566.00	102%			
9	HOT MIX ASPHALT	TON	900	85.00	76,500.00		900.00	61.64	841.01	76,725.25	100%			
10	CLASS 2 AGGREGATE BASE	CY	3,700	45.00	166,500.00		3,700.00		4,174.00	187,830.00	113%			
11	COLD PLANE EXISTING AC PAVEMENT	SQYD	120	2.00	240.00		120.00		107.00	214.00	89%			
12	PAVEMENT REINFORCING FABRIC (GEOGRID 2-LAYERS)	SQYD	4,800	4.50	21,600.00		4,800.00		6,000.00	27,000.00	125%			
13	MINOR CONCRETE (CURB & GUTTER) (CRS 200)	LF	1,610	25.00	40,250.00		1,610.00		1,651.00	41,275.00	103%			
14	MINOR CONCRETE (TYPE D CURB)(CRS 204)	LF	110	21.00	2,310.00		110.00		108.00	2,268.00	98%			
15	MINOR CONCRETE (SIDEWALK)(CRS 401)	SQFT	11,000	6.75	74,250.00		11,000.00		12,353.00	83,382.75	112%			
16	MINOR CONCRETE (8" PAVEMENT)	SQFT	670	8.20	5,494.00		670.00		660.00	5,412.00	98%			
17	MINOR CONCRETE (CURB RAMP)(CRS 403 - CASE A)	EA	3	1,800.00	5,400.00		3.00		3.00	5,400.00	100%			
18	MINOR CONCRETE (ADA ACCESSIBLE RAMP) (CRS 403 - CASE A PER DETAIL)	EA	1	1,800.00	1,800.00		1.00		1.00	1,800.00	100%			
19	MINOR CONCRETE (CROSS-GUTTER)(CRS 209)	SQFT	850	9.75	8,287.50		850.00		840.00	8,190.00	98%			
20	MINOR CONCRETE (DRIVEWAY)(CRS 207)	SQFT	5,300	6.50	34,450.00		5,300.00		5,006.00	32,539.00	94%			
21	DRIVEWAY TIE-IN (0.33 PCC)	SQFT	990	7.00	6,930.00		990.00		892.00	6,244.00	90%			
22	PLACE ASPHALT CONCRETE (DRIVEWAY TIE-IN)	SQFT	110	4.00	440.00		110.00	18.50	93.50	448.00	102%			



PROJECT: Mecca Group 4 Improvement Project Coahuilla Street, Date Palm Street and 4th Street,
Community of Mecca
County Project No.: C1-0654, State Project No. SR25L-9386(215)
Contract No. 14-01-002

Contractor: Golden Valley Construction
Address: 2000 Executive Drive
City, State, Zip: Palm Springs, CA 92262

Estimate No. 3 Final
From: May 26, 2014
To: July 25, 2014

Item No.	Item Description	Units	Quantity	Unit Price	Original Contract		Change Orders		Amended Contract		This Estimate		Previous		Total Estimate To Date		% Auth.
					Amount	Quantity	Amount	Quantity	Amount	Quantity	Amount	Quantity	Amount	Quantity	Amount	Quantity	
23	REMOVE EXISTING FENCE/GATE AND REPLACE	LF	20	140.00	2,800.00	20.00			2,800.00	20.00	3.00	420.00	17.00	20.00	2,800.00	100%	
24	ITEM DELETED BY ADDENDUM				0.00											N/A	
25	PAINT TRAFFIC STRIPE (2 COAT)	LF	860	1.15	989.00	860.00			989.00	860.00			856.00	856.00	984.40	100%	
26	THERMOPLASTIC CROSSWALK AND PAVEMENT MARKINGS	SQFT	590	5.00	2,950.00	590.00			2,950.00	590.00			595.00	595.00	2,975.00	101%	
27	RELOCATE ROADSIDE SIGN	EA	3	150.00	450.00	3.00			450.00	3.00			3.00	3.00	450.00	100%	
28	ROADSIDE SIGN - ONE POST	EA	13	200.00	2,600.00	13.00			2,600.00	13.00			16.00	16.00	3,200.00	123%	
29	PAINT RED CURB	LF	320	1.00	320.00	320.00			320.00	320.00			400.00	400.00	400.00	125%	
30	SALVAGE ROADSIDE SIGN	EA	10	60.00	600.00	10.00			600.00	10.00			12.00	12.00	720.00	120%	
31	MOBILIZATION, DEMOBILIZATION AND FINAL CLEANUP	LS	1	6,000.00	6,000.00	1.00			6,000.00	1.00	0.15	900.00	0.85	1.00	6,000.00	100%	
32	DUST ABATEMENT	LS	1	2,000.00	2,000.00	1.00			2,000.00	1.00	0.15	300.00	0.85	1.00	2,000.00	100%	
33	DEVELOP WATER SUPPLY	LS	1	2,000.00	2,000.00	1.00			2,000.00	1.00	0.15	300.00	0.85	1.00	2,000.00	100%	
34	WATER POLLUTION CONTROL	LS	1	1,500.00	1,500.00	1.00			1,500.00	1.00	0.15	225.00	0.85	1.00	1,500.00	100%	
35	TRAFFIC CONTROL SYSTEM	LS	1	4,000.00	4,000.00	1.00			4,000.00	1.00	0.15	600.00	0.85	1.00	4,000.00	100%	
36	CLEARING AND GRUBBING [INCLUDING VARIOUS ITEMS LISTED IN SPECIAL	LS	1	8,000.00	8,000.00	1.00			8,000.00	1.00			1.00	1.00	8,000.00	100%	
37	ROADWAY EXCAVATION	CY	1,000	9.00	9,000.00	1,000.00			9,000.00	1,000.00			1,225.00	1,225.00	11,025.00	123%	
38	HOT MIX ASPHALT	TON	850	85.00	72,250.00	850.00			72,250.00	850.00	205.44	17,462.40	722.50	927.94	78,874.90	109%	
39	CLASS 2 AGGREGATE BASE	CY	1,060	45.00	47,700.00	1,060.00			47,700.00	1,060.00			1,225.00	1,225.00	55,125.00	116%	
40	COLD PLANE EXISTING AC PAVEMENT	SQYD	5,700	2.00	11,400.00	5,700.00			11,400.00	5,700.00			5,219.00	5,219.00	10,438.00	92%	
41	PAVEMENT REINFORCING FABRIC (GEOGRID 2-LAYERS)	SQYD	1,400	4.50	6,300.00	1,400.00			6,300.00	1,400.00			1,750.00	1,750.00	7,875.00	125%	
42	MINOR CONCRETE (CURB AND GUTTER)(CRS 200)	LF	275	25.00	6,875.00	275.00			6,875.00	275.00			339.00	339.00	8,475.00	123%	
43	MINOR CONCRETE (CURB AND GUTTER)(CRS 201)	LF	50	28.00	1,400.00	50.00			1,400.00	50.00	7.50	210.00	42.50	50.00	1,400.00	100%	
44	MINOR CONCRETE (CURB AND GUTTER) (TRANSITION 8'-6")	LF	160	18.00	2,880.00	160.00			2,880.00	160.00	19.00	342.00	136.00	155.00	2,790.00	97%	

PROJECT: Mecca Group 4 Improvement Project Coahuilla Street, Date Palm Street and 4th Street,
 Community of Mecca
 County Project No.: C1-0654, State Project No. SRZSL-5956(215)
 Contract No. 14-01-002

Contractor: Golden Valley Construction
 Address: 2000 Executive Drive
 City, State, Zip: Palm Springs, CA 92282

Estimate No. 3 Final
 From: May 26, 2014
 To: July 26, 2014

Item No.	Item Description	Units	Quantity	Unit Price	Original Contract		Amended Contract		Change Orders		This Estimate		Previous		% Auth.
					Amount	Quantity	Amount	Quantity	Quantity	Amount	Quantity	Quantity	Amount		
45	MINOR CONCRETE (SIDEWALK)(CRS 401)	SQFT	2,500	6.75	16,875.00	2,500.00	16,875.00				2,861.00	2,861.00	19,311.75	114%	
46	MINOR CONCRETE (CURB RAMP)(CRS 403 - CASE A)	EA	4	1,800.00	7,200.00	4.00	7,200.00				4.00	4.00	7,200.00	100%	
47	MINOR CONCRETE (CURB RAMP)(CRS 403 - CASE B AND PER DETAIL)	EA	1	1,800.00	1,800.00	1.00	1,800.00				1.00	1.00	1,800.00	100%	
48	MINOR CONCRETE (MODIFIED CURB RAMP)(CRS 403 - PER DETAIL)	EA	1	1,800.00	1,800.00	1.00	1,800.00				0.85	1.00	1,800.00	100%	
49	MINOR CONCRETE (CROSS-GUTTER)(CRS 209)	SQFT	1,600	9.75	15,600.00	1,600.00	15,600.00				1,360.00	1,868.00	18,213.00	117%	
50	MINOR CONCRETE (DRIVEWAY)(CRS 207)	SQFT	480	6.50	3,120.00	480.00	3,120.00				408.00	448.00	2,912.00	93%	
51	DRIVEWAY TIE-IN [0.33 PCC]	SQFT	100	7.00	700.00	100.00	700.00				85.00	80.00	560.00	80%	
52	REMOVE EXISTING FENCE/GATE AND REPLACE WITH NEW CHAIN LINK FENCE/GATE OUTSIDE	LF	45	75.00	3,375.00	45.00	3,375.00				38.25	49.00	3,675.00	109%	
53	PAINT TRAFFIC STRIPE (2 COAT)	LF	1,050	1.15	1,207.50	1,050.00	1,207.50				892.50	1,201.00	1,381.15	114%	
54	THERMOPLASTIC CROSSWALK AND PAVEMENT MARKINGS	SQFT	620	5.00	3,100.00	620.00	3,100.00				527.00	709.00	3,545.00	114%	
55	RELOCATE ROADSIDE SIGN	EA	7	150.00	1,050.00	7.00	1,050.00				5.95	7.00	1,050.00	100%	
56	ROADSIDE SIGN - ONE POST	EA	9	200.00	1,800.00	9.00	1,800.00				7.65	11.00	2,200.00	122%	
57	PAINT RED CURB	LF	640	1.00	640.00	640.00	640.00				544.00	640.00	640.00	100%	
58	SALVAGE ROADSIDE SIGN	EA	6	60.00	360.00	6.00	360.00				5.10	6.00	360.00	100%	
59	MISCELLANEOUS DIRECTED WORK	FA	95,000	1.00	95,000.00	95,000.00	95,000.00				80,750.00	95,137.01	95,137.01	100%	
60	MOBILIZATION, DEMOBILIZATION AND FINAL CLEANUP	LS	1	8,000.00	8,000.00	1.00	8,000.00				0.85	1.00	8,000.00	100%	
61	DUST ABATEMENT	LS	1	4,000.00	4,000.00	1.00	4,000.00				0.85	1.00	4,000.00	100%	
62	DEVELOP WATER SUPPLY	LS	1	2,000.00	2,000.00	1.00	2,000.00				0.85	1.00	2,000.00	100%	
63	WATER POLLUTION CONTROL	LS	1	1,500.00	1,500.00	1.00	1,500.00				0.85	1.00	1,500.00	100%	
64	TRAFFIC CONTROL SYSTEM	LS	1	4,000.00	4,000.00	1.00	4,000.00				0.85	1.00	4,000.00	100%	
65	CLEARING AND GRUBBING [INCLUDING VARIOUS ITEMS LISTED IN SPECIAL	LS	1	6,000.00	6,000.00	1.00	6,000.00				0.85	1.00	6,000.00	100%	
66	ROADWAY EXCAVATION	CY	840	9.00	7,560.00	840.00	7,560.00				714.00	945.00	8,505.00	113%	

PROJECT: Mecca Group 4 Improvement Project Coahuilla Street, Date Palm Street and 4th Street,
 Community of Mecca
 County Project No.: C-1-9654, State Project No. SR23L-5956(215)
 Contract No. 14-01-002

Contractor: Golden Valley Construction
 Address: 2000 Executive Drive
 City, State, Zip: Palm Springs, CA 92262

Estimate No. 3 Final
 From: May 26, 2014
 To: July 25, 2014



Item No.	Item Description	Units	Quantity	Unit Price	Original Contract		Change Orders		Amended Contract		This Estimate		Previous		Total Estimate To Date		% Auth.
					Amount	Quantity	Amount	Quantity	Amount	Quantity	Amount	Quantity	Amount	Quantity	Amount	Quantity	
67	HOT MIX ASPHALT	TON	200	100.00	20,000.00				200.00	20,000.00	68.12	6,812.00	170.00	238.12	23,812.00	119%	
68	CLASS 2 AGGREGATE BASE	CY	700	45.00	31,500.00			700.00	31,500.00	235.00	10,575.00	595.00	830.00	37,350.00	119%		
69	PAVEMENT REINFORCING FABRIC (GEOGRID 2-LAYERS)	SQYD	1,100	6.50	7,150.00			1,100.00	7,150.00	440.00	2,860.00	935.00	1,375.00	8,937.50	125%		
70	MINOR CONCRETE (CURB & GUTTER) (CRS 200)	LF	450	30.00	13,500.00			450.00	13,500.00	93.50	2,805.00	382.50	476.00	14,280.00	106%		
71	MINOR CONCRETE (SIDEWALK)(CRS 401)	SQFT	2,500	6.75	16,875.00			2,500.00	16,875.00	614.00	4,144.50	2,125.00	2,739.00	18,488.25	110%		
72	MINOR CONCRETE (DRIVEWAY)(CRS 207)	SQFT	1,275	8.00	10,200.00			1,275.00	10,200.00	312.25	2,498.00	1,083.75	1,396.00	11,168.00	109%		
73	DRIVEWAY TIE-IN (0.33 PCC)	SQFT	390	8.00	3,120.00			390.00	3,120.00	98.50	788.00	331.50	430.00	3,440.00	110%		
74	MINOR CONCRETE (MINOR STRUCTURE)(CONCRETE U-DRAIN PER DETAIL	LS	1	2,500.00	2,500.00			1.00	2,500.00	0.15	375.00	0.85	1.00	2,500.00	100%		
75	MINOR CONCRETE (MINOR STRUCTURE)(UNDER SIDEWALK DRAIN 24"	EA	2	1,500.00	3,000.00			2.00	3,000.00	0.30	450.00	1.70	2.00	3,000.00	100%		
76	CONTAMINATED SOIL MANAGEMENT	LS	1	5,000.00	5,000.00			1.00	5,000.00	0.15	750.00	0.85	1.00	5,000.00	100%		
77	CONTAMINATED SOIL MITIGATION/EXPORT	CY	235	25.00	5,875.00			235.00	5,875.00	93.25	2,331.25	199.75	293.00	7,325.00	125%		
78	SALVAGE ROADSIDE SIGN	EA	3	60.00	180.00			3.00	180.00	0.45	27.00	2.55	3.00	180.00	100%		
79	CHAIN LINK FENCE (6' HIGH)	LF	94	40.00	3,760.00			94.00	3,760.00	14.10	564.00	79.90	94.00	3,760.00	100%		
80	REMOVE EXISTING (MISCELLANEOUS)	LS	1	5,000.00	5,000.00			1.00	5,000.00	0.15	750.00	0.85	1.00	5,000.00	100%		
81	IMPORTED GRANULAR MATERIAL (DECOMPOSED GRANITE)	CY	7	50.00	350.00			7.00	350.00	1.05	52.50	5.95	7.00	350.00	100%		

PROJECT: Mecca Group 4 Improvement Project Coahuilla Street, Date Palm Street and 4th Street,
 Community of Mecca
 County Project No.: C1-0654, State Project No. SR25L-5956(215)
 Contract No. 14-01-002

Contractor: Golden Valley Construction
 Address: 2000 Executive Drive
 City, State, Zip: Palm Springs, CA 92262

Item No.	Item Description	Units	Quantity	Unit Price	Original Contract		Change Orders		Amended Contract		This Estimate		Previous		Total Estimate To Date		% Auth
					Amount	Quantity	Amount	Quantity	Amount	Quantity	Amount	Quantity	Amount	Quantity	Amount	Quantity	
					1,024,063.00		0.00		1,024,063.00							1,101,706.96	
PROJECT TOTAL																	

Made by: Jesse Mendoza
 Checked by: [Signature] 8-1-14
 OK Const. Supv. [Signature] 8/1/14

Working Days: 30
 Days Added: 0
 Subtotal: 30
 Days Used: 30
 % Time Elapsed: 100%

Start Date: 3-22-14
 End Date: 4-22-14
 % \$ Complete: 108%
 Original Contract: \$1,024,063.00
 Amended Contract: \$1,024,063.00

TOTAL VALUE OF WORK TO DATE: \$1,101,706.96
 LESS RETENTION: 5% 55,085.34
 TOTAL DUE TO DATE: \$1,046,621.62
 LESS PREVIOUSLY INVOICED: 957,091.16
 LESS LABOR NON COMPLIANCE: 0.00
 TOTAL DUE THIS PAYMENT: \$89,530.46

This Estimate Approved _____ Date: _____ for: _____
 Juan C. Perez, Director of Transportation and Land Management

Received by Accounts Payable: _____
 By: _____

Quantities on This Estimate Approved [Signature] Mike Hanz Date: 8.4.14
 Golden Valley Construction

PAYMENT APPROVAL
 Fund 20000
 Dept ID 31305
 Account 587980
 Project ZC1-0654E
 Activity ID Z3500
 Resource Type CNT
 Signature [Signature]
 Date 8/1/14

COUNTY OF RIVERSIDE
DEPARTMENT OF TRANSPORTATION

MECCA GROUP 4 STREET IMPROVEMENT PROJECT

MECCA, CALIFORNIA

PROJECT No. C1-0654

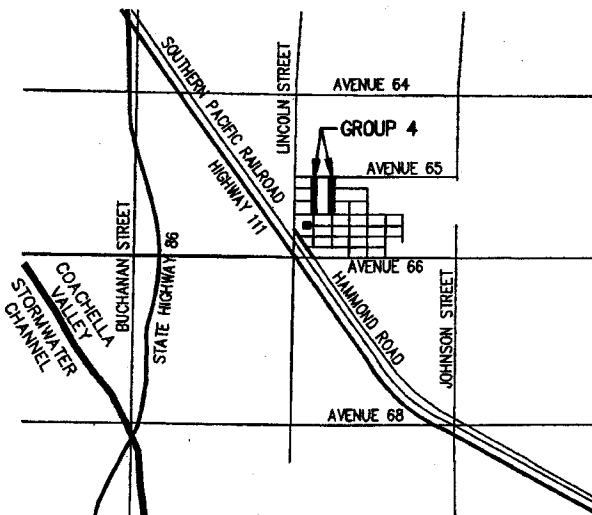
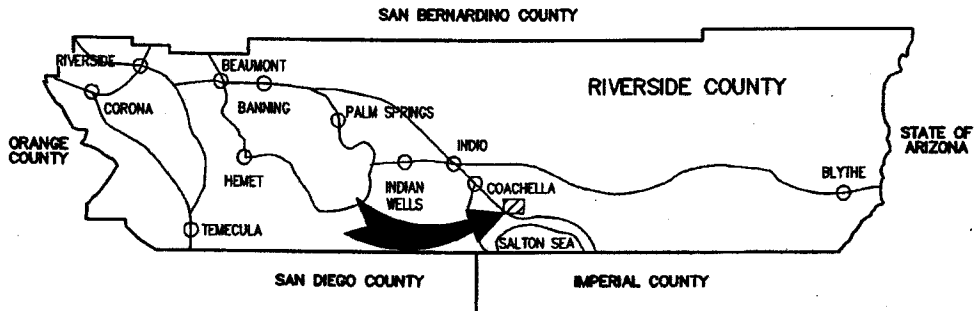

VICINITY MAP

TOWNSHIP 7S RANGE 9E SECTION 8
COUNTY ROAD BOOK PAGE No. 230A