

FORM APPROVED COUNTY COUNSEL 12/20/15
 BY: GREGORY P. PRIAMOS DATE

**SUBMITTAL TO THE BOARD OF SUPERVISORS
 COUNTY OF RIVERSIDE, STATE OF CALIFORNIA**

311B



SUBMITTAL DATE:
 March 12, 2015

FROM: TLMA – Code Enforcement Department

SUBJECT: Abatement of Public Nuisance [Accumulated Rubbish]
 Case No: CV12-01015 [RUSSELL]
 Subject Property: 1 Lot South of 12892 Balsam Circle, San Geronio, APN: 517-153-011
 District: 5 [\$0]

RECOMMENDED MOTION: That the Board of Supervisors move that:

1. The accumulation of rubbish on the real property located at 1 Lot South of 12892 Balsam Circle, San Geronio, Riverside County, California, APN: 517-153-011 be declared a public nuisance and a violation of Riverside County Ordinance No. 541 which does not permit the accumulation of rubbish on the property.
2. Raymond L. Russell and R. L. Russell, the owners of the subject real property, be directed to abate the accumulation of rubbish on the property by removing the same from the real property within ninety (90) days.

Greg Flannery
 GREG FLANNERY
 Code Enforcement Official

(Continued)

| FINANCIAL DATA | Current Fiscal Year: | Next Fiscal Year: | Total Cost: | Ongoing Cost: | POLICY/CONSENT (per Exec. Office) |
|-----------------|----------------------|-------------------|-------------|--|---|
| COST | \$ N/A | \$ N/A | \$ N/A | \$ N/A | Consent <input type="checkbox"/> Policy <input checked="" type="checkbox"/> |
| NET COUNTY COST | \$ N/A | \$ N/A | \$ N/A | \$ N/A | |
| SOURCE OF FUNDS | | | | Budget Adjustment: For Fiscal Year: | |

C.E.O. RECOMMENDATION:

APPROVE
Tina Grande
 Tina Grande

County Executive Office Signature

MINUTES OF THE BOARD OF SUPERVISORS

On motion of Supervisor Washington, seconded by Supervisor Benoit and duly carried by unanimous vote, IT WAS ORDERED that the above matter is approved as recommended.

Ayes: Jeffries, Tavaglione, Washington, Benoit and Ashley
 Nays: None
 Absent: None
 Date: March 24, 2015
 xc: Co.Co., TLMA-Code, Sheriff

Kecia Harper-Ihem
 Clerk of the Board
 By: *Kecia Harper-Ihem*
 Deputy

Prev. Agn. Ref.: District: 5 Agenda Number:

9-3

A-30
 4/5 Vote
 Positions Added
 Change Order

Departmental Concurrence

SUBMITTAL TO THE BOARD OF SUPERVISORS, COUNTY OF RIVERSIDE, STATE OF CALIFORNIA

FORM 11: Abatement of Public Nuisance [Accumulated Rubbish]

Case No: CV12-01015 [RUSSELL]

Subject Property: 1 Lot South of 12892 Balsam Circle, San Geronio;

APN: 517-153-011

District: 5

DATE: March 12, 2015

PAGE: 2 of 3

RECOMMENDED MOTION (continued):

3. If the owners or whoever has possession or control of the real property do not take the above described action within ninety (90) days of the date of the Board's Order to Abate, that representatives of the Code Enforcement Department, Sheriff's Department, and/or a contractor, upon consent of the owner or receipt of a Court Order authorizing entry onto the real property, when necessary under applicable law, may abate the accumulation of rubbish by removing and disposing of the same from the real property.

4. The reasonable costs of abatement, after notice and an opportunity for hearing, shall be imposed as a lien on the real property, which may be collected as a special assessment against the real property pursuant to Government Code Section 25845 and Riverside County Ordinance No. 725.

5. County Counsel be directed to prepare the necessary Findings of Fact and Conclusions that the accumulation of rubbish on the real property is declared to be in violation of Riverside County Ordinance No. 541, and a public nuisance, and further, to prepare an Order to Abate for approval by the Board.

BACKGROUND:

1. An initial inspection was made on the subject property by Code Enforcement Officer Adam Hermanson on February 22, 2012. The inspection revealed the accumulation of rubbish on the subject property in violation of Riverside County Ordinance 541. The rubbish consisted of, but was not limited to: scrap wood, siding, a tire and miscellaneous items.

2. There have been approximately 10 subsequent follow up inspections, with the last inspection occurring on December 3, 2014, revealed the property continues to be in violation of Riverside County Ordinance No. 541.

3. Staff and the Code Enforcement Department have complied with the notice requirements set forth in the appropriate laws of this jurisdiction pertaining to the administrative abatement proceedings for the removal of accumulated rubbish.

Impact on Citizens and Businesses

Failure to abate will have a negative impact on citizens or business due to health and safety, hazards, nuisance, and potential impact on real estate values.

SUPPLEMENTAL:

Additional Fiscal Information

N/A

Contract History and Price Reasonableness

N/A

SUBMITTAL TO THE BOARD OF SUPERVISORS, COUNTY OF RIVERSIDE, STATE OF CALIFORNIA

FORM 11: Abatement of Public Nuisance [Accumulated Rubbish]

Case No: CV12-01015 [RUSSELL]

Subject Property: 1 Lot South of 12892 Balsam Circle, San Geronio;

APN: 517-153-011

District: 5

DATE: March 12, 2015

PAGE: 3 of 3

ATTACHMENTS

Declaration
Exhibits A-G

1 **BOARD OF SUPERVISORS**
2 **COUNTY OF RIVERSIDE**

3 IN RE ABATEMENT OF PUBLIC NUISANCE) CASE NO. CV 12-01015
4 [ACCUMULATED RUBBISH]; APN: 517-153-011,)
5 1 LOT SOUTH OF 12892 BALSAM CIRCLE, SAN) DECLARATION OF CODE
6 GORGONIO, COUNTY OF RIVERSIDE, STATE) ENFORCEMENT TECHNICIAN
7 OF CALIFORNIA; RAYMOND L. RUSSELL AND) DAVID JURDEN
8 R.L. RUSSELL, OWNERS.)
9) [RCO No. 541]
10)
11)
12)

13 I, David Jurden, declare that the facts set forth below are personally known to me except to the
14 extent that certain information is based on information and belief which I believe to be true, and if called
15 as a witness, I could and would competently testify thereof under oath:

16 1. I am currently employed by the Riverside County Code Enforcement Department as a
17 Code Enforcement Technician. My current official duties as a Code Enforcement Technician include
18 inspecting properties for violations and enforcement of the provisions of Riverside County Ordinances.

19 2. I am informed and believe and thereon allege that on February 22, 2012, Officer
20 Hermanson conducted an inspection of the real property described as 1 Lot South of 12892 Balsam
21 Circle, San Gorgonio, Riverside County, California and further described as Assessor's Parcel Number
22 517-153-011 (hereinafter described as "THE PROPERTY"). A true and correct copy of a Thomas
23 Brothers map page indicating the location of THE PROPERTY is attached hereto and incorporated
24 herein by reference as Exhibit "A."

25 3. A review of County records and documents disclosed that THE PROPERTY is owned by
26 Raymond L. Russell and R. L. Russell (hereinafter referred to as "OWNERS"). A certified copy of the
27 County Equalized Assessment Roll for 2014-2015 tax year and a copy of the report generated from the
28 County Geographic Information System ("GIS") is attached hereto and incorporated herein by reference
as Exhibit "B."

29 ///
30 ///
31 ///
32 ///

FORM APPROVED COUNTY COUNSEL

BY: *[Signature]* DATE: 1/15/15
SOPHIA H. CHOI

1 4. Based on the Lot Book Reports from RZ Title Service dated June 6, 2014 and updated on
2 November 3, 2014, it is determined that other parties may potentially hold an interest in THE
3 PROPERTY, to wit: Lake Hemet Municipal Water District (hereinafter referred to as "INTERESTED
4 PARTY"). True and correct copies of the Lot Book Reports are attached hereto and incorporated herein
5 by reference as Exhibit "C."

6 5. I am informed and believe and thereon allege that on February 22, 2012, Officer
7 Hermanson conducted an inspection. Officer Hermanson observed accumulated rubbish on THE
8 PROPERTY which consisted of, but was not limited to the following materials: scrap wood, siding, a tire
9 and miscellaneous items.

10 6. As a result of the accumulated rubbish, THE PROPERTY constituted a public nuisance in
11 violation of the provisions set forth in Riverside County Ordinance ("RCO") No. 541.

12 7. On February 22, 2012, August 28, 2014 and November 19, 2014, a Notice of Violation for
13 accumulated rubbish was posted on THE PROPERTY.

14 8. On August 27, 2014, a Notice of Violation was mailed to OWNERS by certified mail, return
15 receipt requested. On November 19, 2014, a Notice of Violation was mailed to INTERESTED PARTY by
16 certified mail, return receipt requested.

17 9. A site plan and photographs depicting the conditions of THE PROPERTY are attached
18 hereto and incorporated herein by reference as Exhibit "D."

19 10. A true and correct copy of each Notice issued in this matter and other supporting
20 documentation are attached hereto and incorporated herein by reference as Exhibit "E."

21 11. There have been approximately 10 subsequent follow up inspections, with the last
22 inspection being December 3, 2014. At each of these inspections accumulated rubbish remained in
23 violation of RCO No. 541.

24 12. Based upon my experience, knowledge and visual observations, it is my determination
25 that the conditions on THE PROPERTY are dangerous to the neighboring property owners and the
26 general public.

27 13. Furthermore a recent inspection showed THE PROPERTY remained in violation of RCO
28 No. 541.

1 14. I am informed and believe and based upon said information and beliefs allege that the
2 OWNERS do not have legal authority or permission to store or accumulate the above described
3 materials on THE PROPERTY.

4 15. A Notice of Pendency of Administrative Proceedings regarding the accumulated rubbish
5 was recorded in the Office of the County Recorder, County of Riverside, State of California, on
6 September 26, 2013, as Instrument Number 2013-0466414. A true and correct copy is attached hereto
7 and incorporated herein by reference as Exhibit "F."

8 16. A "Notice to Correct County Ordinance Violations and Abate Public Nuisance" providing
9 notification of the Board of Supervisors' hearing as required by RCO No. 725 was mailed to OWNERS
10 and INTERERSTED PARTY by first class mail and was posted on THE PROPERTY. True and correct
11 copies of the Notices, together with the Proofs of Service, and the Affidavit of Posting of Notices are
12 attached hereto and incorporated herein by reference as Exhibit "G."

13 17. Removal of all accumulated rubbish on THE PROPERTY is required to bring THE
14 PROPERTY into compliance with RCO No. 541, and the Health and Safety Code. Under RCO No. 541,
15 no amount of rubbish is allowed to accumulate on THE PROPERTY.

16 18. Accordingly, the following findings and conclusions are recommended:

17 (a) the accumulation of rubbish on THE PROPERTY be deemed and declared a
18 public nuisance;

19 (b) the OWNERS or whoever has possession or control of THE PROPERTY, be
20 required to remove all accumulated rubbish within ninety (90) days of the date of the posting and mailing
21 of the Board's Order to Abate Nuisance, in strict accordance with all Riverside County Ordinances,
22 including but not limited to the provision of RCO No. 541;

23 (c) in the event the rubbish is not removed and disposed of during the above referenced
24 ninety (90) day time period in strict accordance with all Riverside County Ordinances, including but not
25 limited to RCO No. 541, the rubbish may be abated and disposed of by representatives of the Riverside
26 County Code Enforcement Department, a contractor, or the Sheriff's Department upon receipt of an
27 owner's consent or a Court Order when necessary under applicable law.

28 ///

1 (d) that reasonable costs of abatement, after notice and opportunity for hearing, shall
2 be imposed as a lien on THE PROPERTY, which may be collected as a special assessment against THE
3 PROPERTY pursuant to Government Code Section 25845 and RCO No. 541.

4 I declare under penalty of perjury under the laws of the State of California that the foregoing is
5 true and correct.

6 Executed this 9TH day of JANUARY, 2015, at SAN JACINTO, California

7 
8 _____
9 DAVID JURDEN
10 Code Enforcement Technician
11 Code Enforcement Department
12
13
14
15
16
17
18
19
20
21
22
23
24
25
26
27
28

EXHIBIT “A”



724

SAN GORGONIO

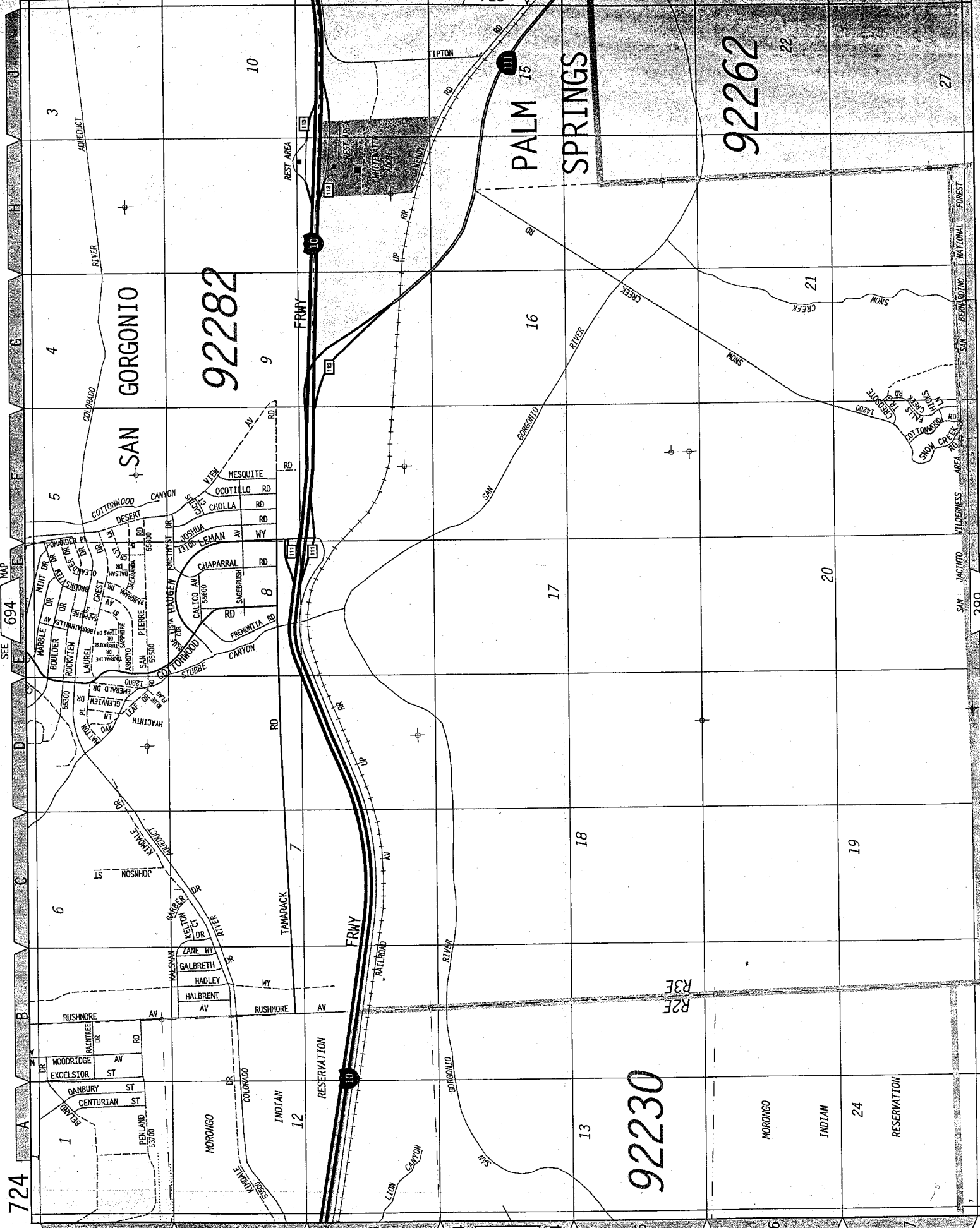
PALM SPRINGS

92282

92262

92230

SEE 694 MAP

SEE 724 MAP

SEE 389 MAP

724

SAN GORGONIO

PALM SPRINGS

92282

92262

92230

SEE 694 MAP

SEE 724 MAP

SEE 389 MAP

724

EXHIBIT “B”

Assessment Roll For the 2014-2015 Tax Year as of January 1, 2014

| Assessment #517153011-0 | | Parcel # 517153011-0 | |
|--------------------------------|--|----------------------|-----|
| Assessee: | RUSSELL RAYMOND L | Land | 893 |
| Assessee: | RUSSELL R L | Full Value | 893 |
| Mail Address: | 17115 RANCHERO RD | Total Net | 893 |
| City, State Zip: | RIVERSIDE, CA 92504 | | |
| Real Property Use Code: | YY | | |
| Base Year | 1978 | | |
| Conveyance Number: | 0245591 | | |
| Conveyance (mm/yy): | 12/1977 | | |
| PUI: | Y040000 | | |
| TRA: | 55-040 | | |
| Taxability Code: | 0-00 | | |
| ID Data: | Lot 345 MB 034/043 SAN GORGONIO PASS 5 | | |

[View Parcel Map](#)

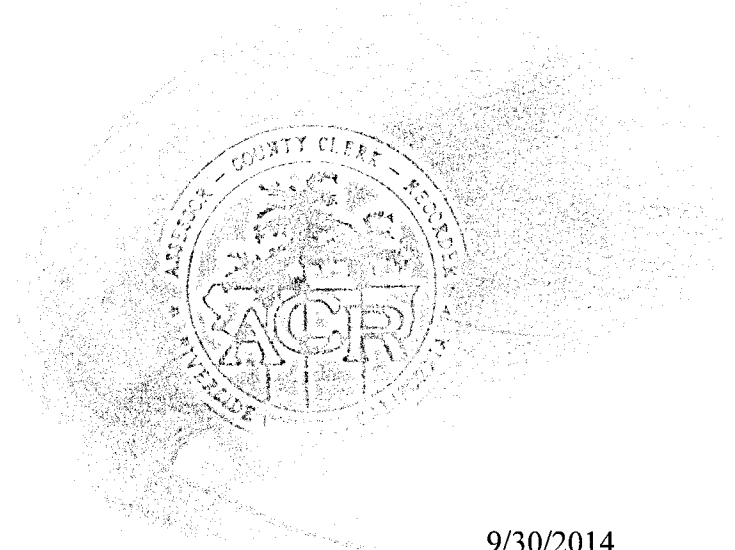

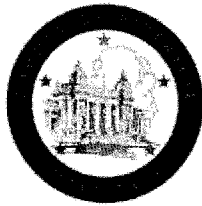

Riverside County Parcel Report
APN 517-153-011
Disclaimer

Report Date: Tuesday, January 06, 2015

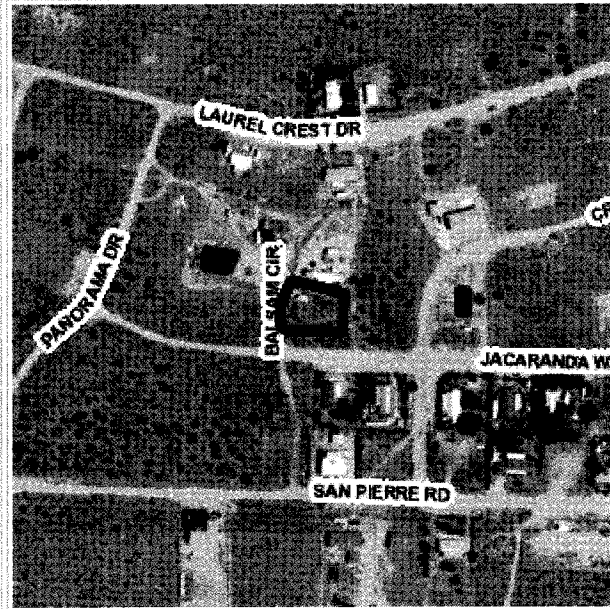
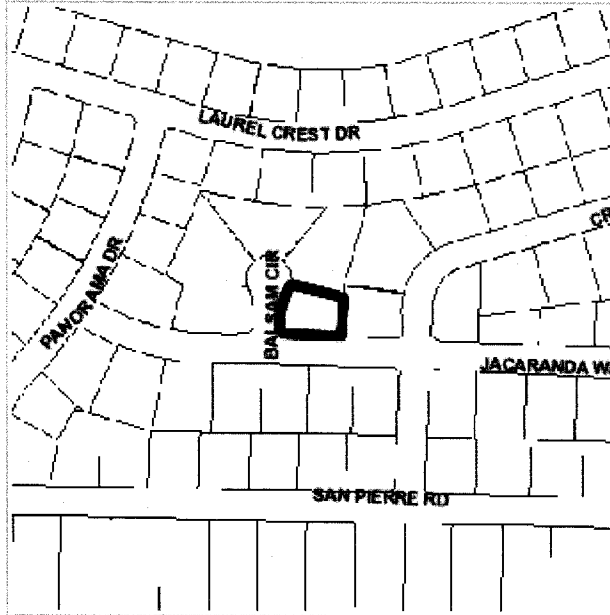

| | | | |
|--------------------------|--|------------------------------------|---|
| APN | <u>517-153-011-0</u> | Supervisorial District 2011 | MARION ASHLEY, DISTRICT 5 |
| | | Supervisorial District 2001 | MARION ASHLEY, DISTRICT 5 |
| Previous APN | 000000000 | Township/Range | T3SR3E SEC 5 |
| Owner Name | RAYMOND L RUSSELL R L RUSSELL | Elevation Range | 1,536 - 1,540 |
| Address | No address available | Thomas Bros. Map Page/Grid | PAGE: 724 GRID: E1 |
| Mailing Address | 17115 RANCHERO RD RIVERSIDE CA, CA 92504 | Indian Tribal Land | Not in Tribal Land |
| Legal Description | Recorded Book/Page: <u>MB 34/43</u> Subdivision Name: SAN GORGONIO PASS 5 Lot/Parcel: 345 Block: Not Available Tract Number: Not Available | City Boundary/Sphere | Not within a City Boundary Not within a City Sphere Annexation Date: Not Applicable No LAFCO Case # Available Proposals: Not Applicable |
| Lot Size | Recorded lot size is | March Joint | NOT WITHIN THE |

| | | | |
|---|--|--|--|
| | 0.25 acres | Powers Authority | JURISDICTION OF THE MARCH JOINT POWERS AUTHORITY |
| Property Characteristics | No Property Description Available | County Service Area | Not in a County Service Area |
| Specific Plans | Not within a Specific Plan | Historic Preservation Districts | Not in an Historic Preservation District |
| Land Use Designations | MDR | Agricultural Preserve | Not in an agricultural preserve |
| General Plan Policy Overlays | Not in a General Plan Policy Overlay Area | Redevelopment Areas | Not in a Redevelopment Area |
| Area Plan (RCIP) | Western Coachella Valley | Airport Influence Areas | Not in an Airport Influence Area |
| General Plan Policy Areas | SAN GORGONIO PASS WIND ENERGY POLICY AREA | Airport Compatibility Zones | Not in an Airport Compatibility Zone |
| Zoning Classifications (ORD. 348) | Zoning: R-R CZNumber: 0 | Zoning Districts and Zoning Areas | WHITEWATER, AREA |
| Zoning Overlays | Not in a Zoning Overlay | Community Advisory Councils | WEST DESERT(MAC) |
| CVMSHCP (Coachella Valley Multi-Species Habitat Conservation Plan) Plan Area | WITHIN THE COACHELLA VALLEY MSHCP FEE AREA MSHCP Plan Area | WRMSHCP (Western Riverside County Multi-Species Habitat Conservation Plan) Cell Group | Not in a Cell Group |
| CVMSHCP (Coachella Valley Multi-Species Habitat Conservation Plan) Conservation Area | Not in a Conservation Area | WRMSHCP Cell Number | None |
| CVMSHCP Fluvial Sand Transport Special Provision Areas | Not in a Fluvial Sand Transport Special Provision Area | HANS/ERP (Habitat Acquisition and Negotiation Strategy/Expedited Review Process) | None |
| WRMSHCP (Western Riverside County Multi-Species Habitat Conservation Plan) Plan Area | None | Vegetation (2005) | No Data Available |

| | | | |
|---|--|---|---|
| High Fire Area (Ord. 787) | Y | Fire Responsibility Area | STATE RESPONSIBILITY AREA |
| CVMSHCP (Coachella Valley Multi-Species Habitat Conservation Plan) Fee Area (Ord 875) | WITHIN THE COACHELLA VALLEY MSHCP FEE AREA MSHCP Fee Area | RBBD (Road & Bridge Benefit District) | Not in a District |
| WRMSHCP (Western Riverside County Multi-Species Habitat Conservation Plan) Fee Area (Ord. 810) | NOT WITHIN THE WESTERN RIVERSIDE COUNTY MSHCP FEE AREA | DIF (Development Impact Fee Area Ord. 659) | WESTERN COACHELLA VALLEY |
| Western TUMF (Transportation Uniform Mitigation Fee Ord. 824) | NOT WITHIN THE WESTERN TUMF FEE AREA | SKR Fee Area (Stephen's Kagaroo Rat Ord. 663.10) | Not within a SKR Fee Area |
| Eastern TUMF (Transportation Uniform Mitigation Fee Ord. 673) | IN OR PARTIALLY WITHIN A TUMF FEE AREA. SEE MAP FOR MORE INFORMATION. EAST | DA (Development Agreements) | Not in a Development Agreement Area |
| Circulation Element Ultimate Right-of-Way | Not in a Circulation Element Right-of-Way | Road Book Page | 142 |
| | | Transportation Agreements | Not in a Transportation Agreement |
| | | CETAP (Community and Environmental Transportation Acceptability Process) Corridors | Not in a CETAP Corridor |
| Flood Plan Review | Not Required | Watershed | WHITEWATER |
| Water District | DWA | California Water Board | None |
| Flood Control District | RIVERSIDE COUNTY FLOOD CONTROL DISTRICT | | |
| Fault Zone | Not in a Fault Zone | Paleontological Sensitivity | Low Potential: FOLLOWING A LITERATURE SEARCH, RECORDS |

| | | |
|-------------------------------|--|--|
| Faults | WITHIN A 1/2 MILE OF SAN ANDREAS FAULT | CHECK AND A FIELD SURVEY, AREAS MAY BE DETERMINED BY A QUALIFIED VERTEBRATE PALEONTOLOGIST AS HAVING LOW POTENTIAL FOR CONTAINING SIGNIFICANT PALEONTOLOGICAL RESOURCES SUBJECT TO ADVERSE IMPACTS. |
| Liquefaction Potential | Moderate | |
| Subsidence | Susceptible | |
| School District | BANNING UNIFIED | Tax Rate Areas 055040 BANNING LIBRARY DISTRICT BANNING UNIFIED SCHOOL COACHELLA VALLEY RESOURCE CONSERVATION COUNTY STRUCTURE FIRE PROTECTION COUNTY WASTE RESOURCE MGMT DIST CSA 152 DESERT HOT SPRINGS COUNTY WATER DESERT HOT SPRINGS CO WATER IMP E DESERT WATER AGENCY FLOOD CONTROL ADMINISTRATION FLOOD CONTROL ZONE 6 GENERAL GENERAL PURPOSE MT SAN JACINTO JUNIOR COLLEGE RIV CO REG PARK & OPEN SPACE RIV. CO. OFFICE OF EDUCATION SAN GORGONIO PASS MEM HOSPITAL SAN GORGONIO SERIES BOND A SUMMIT CEMETERY DISTRICT |
| Communities | San Gorgonio | |
| Lighting (Ord. 655) | Zone B, 41.03 Miles From Mt. Palomar Observatory | |
| 2010 Census Tract | 044521 | |
| Farmland | OTHER LANDS URBAN-BUILT UP LAND | |
| Special Notes | No Special Notes | |

Building Permits

| Case # | Description | Status |
|---------------------|----------------|----------------|
| No Building Permits | Not Applicable | Not Applicable |

Environmental Health Permits

| Case # | Description | Status |
|---------------------------------|----------------|----------------|
| No Environmental Health Permits | Not Applicable | Not Applicable |

Planning Cases

| Case # | Description | Status |
|-------------------|----------------|----------------|
| No Planning Cases | Not Applicable | Not Applicable |

Code Cases

| Case # | Description | Status |
|-----------|-------------------------------|--------|
| CV1201015 | ACCUMULATED RUBBISH EXPEDITED | OPEN |

EXHIBIT “C”



P.O. Box 1193
 Whittier, CA 90609
 Tel # (562) 325-8351
 Fax # (714) 783-3038

Updated Lot Book

Customer:

RIVERSIDE COUNTY TLMA-CODE ENFORCEMENT

4080 Lemon Street
 Riverside

CA 92501

Attn: Brent Steele
 Reference: CV12-01015/Regina Keyes - #31825
 IN RE: RUSSELL, RAYMOND L.

Order Number: **32761**

Order Date: 10/31/2014

Dated as of: 11/3/2014

County Name: Riverside

FEE(s):
 Report: \$60.00

Property Address: Vacant Land

CA

RZ Title Reporting Service hereby reports, as disclosed by the Official Records of the Recorder of said County as of the date shown above, that subsequent to the date of the original report that (i) No document in the chain of title to said land has been recorded purporting to convey the fee title to said land, and (ii) No encumbrances affecting said land have been recorded nor has a homestead been executed on said land, and (iii) No encumbrances affecting said land on the date of the original report have been released or reconveyed.

All exceptions are as follows:

Assessor's Parcel No. : 517-153-011-0

| | | |
|--------------|--------------------|----------|
| Assessments: | Land Value: | \$893.00 |
| | Improvement Value: | \$0.00 |
| | Exemption Value: | \$0.00 |
| | Total Value: | \$893.00 |

| | |
|------------------------------------|-------------------------------------|
| Property Taxes for the Fiscal Year | 2014-2015 |
| First Installment | \$44.46 |
| Penalty | \$0.00 |
| Status | OPEN NOT-PAID (DUE DATE 12/10/2014) |
| Second Installment | \$44.46 |
| Penalty | \$0.00 |
| Status | OPEN NOT-PAID (DUE DATE 04/10/2015) |

NO OTHER EXCEPTIONS



P.O. Box 1193
Whittier, CA 90609
Tel # (562) 325-8351
Fax # (714) 783-3038

Lot Book Report

Order Number: **31825**

Customer:

RIVERSIDE COUNTY TLMA-CODE INFORCEMENT
4080 Lemon Street
Riverside CA 92501

Order Date: 6/2/2014
Dated as of: 6/6/2014
County Name: Riverside

Attn: Brent Steele
Reference: CV12-01015/Technician Jurden
IN RE: RUSSELL, RAYMOND L.

FEE(s):
Report: \$120.00

Property Address: Vacant Land

CA

Assessor's Parcel No. : 517-153-011-0

Assessments:

| | |
|--------------------|----------|
| Land Value: | \$890.00 |
| Improvement Value: | \$0.00 |
| Exemption Value: | \$0.00 |
| Total Value: | \$890.00 |

Tax Information

| | |
|------------------------------------|------------|
| Property Taxes for the Fiscal Year | 2013-2014 |
| Total Annual Tax | \$88.12 |
| Status: Paid through | 06/30/2014 |

Property Vesting

The last recorded document transferring title of said property

| | |
|----------|------------|
| Dated | 12/17/1976 |
| Recorded | 08/08/1977 |



P.O. Box 1193
Whittier, CA 90609
Tel # (562) 325-8351
Fax # (714) 783-3038

Order Number: 31825
Reference: CV12-01015/Tech

| | |
|------------------|---|
| Document No. | 152424 |
| D.T.T. | \$1.10 |
| Grantor | Lou Gladstein and Sylvia Gladstein |
| Grantee | Raymond L. Russell, Jr. and Raymond L. Russell, III, as tenants in common with rights of survivorship |
| Re-recorded Deed | |
| Recorded | 12/09/1977 |
| Document No. | 245591 |
| To | correct the map book and page. |

Deeds of Trust

No Deeds of Trust of Record

Additional Information

| | |
|---|-------------------------------------|
| Document Type | Certificate of Completion |
| Document No. | 2012-0459520 |
| Recorded | 09/26/2012 |
| A Notice of Administrative Proceedings by the | |
| City of | San Jacinto |
| County of | Riverside |
| Recorded | 09/26/2013 |
| Document No. | 2013-0466414 |
| A Notice of Lien Recorded | 02/10/2010 |
| Document No. | 2010-0062362 |
| Amount | \$203.61 |
| Owner | Raymond Russell |
| Claimant | Lake Hemet Municipal Water District |
| A Bankruptcy filed by | Raymond Russell Sr. |



P.O. Box 1193
Whittier, CA 90609
Tel # (562) 325-8351
Fax # (714) 783-3038

Order Number: 31825
Reference: CV12-01015/Tech

| | |
|---------------------------|------------|
| Social Security Number(s) | XXXXX9854 |
| Date filed | 05/29/2014 |
| Case No. | 17029 |

Legal Description

THE LAND REFERRED TO IN THIS REPORT IS LOCATED IN AND IS DESCRIBED AS FOLLOWS:

LOT 345 SAN GORGONIO PASS, IN THE COUNTY OF RIVERSIDE, STATE OF CALIFORNIA, AS PER MAP RECORDED IN BOOK 34 PAGE 43 OF MAPS IN THE OFFICE OF THE COUNTY RECORDER OF SAID COUNTY.

152424

RECORDING REQUESTED BY

AND WHEN RECORDED MAIL THIS DEED AND, UNLESS OTHERWISE SHOWN BELOW, MAIL TAX STATEMENTS TO:

NAME: Mr. Raymond L. Russell, Jr.
Mr. Raymond L. Russell, III
STREET ADDRESS: 132 W. Adams Street
CITY, STATE, ZIP: Somerville, Mass 02144

TITLE ORDER NO. _____ Escrow NO. _____

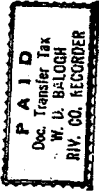

RECEIVED FOR RECORD
AUG 8 1977
Min. Post. Clerk
Book 1977, Page 152424
Recorded in Official Records of Riverside County, California
W.D. Balogh Recorder
FEE \$ 3

SPACE ABOVE THIS LINE FOR RECORDER'S USE

GRANT DEED

THE UNDERSIGNED GRANTOR(S) DECLARE(S)
DOCUMENTARY TRANSFER TAX is \$ 1.10
 computed on full value of property conveyed, or
 computed on full value less value of liens or encumbrances remaining at time of sale, and

FOR A VALUABLE CONSIDERATION, receipt of which is hereby acknowledged,

LOU GLADSTEIN AND SYLVIA GLADSTEIN

hereby GRANT(S) to

RAYMOND L. RUSSELL, JR. AND RAYMOND L. RUSSELL, III as TENANTS IN COMMON with Rights of Survivorship

the following described real property in the Unincorporated area

County of Riverside State of California:

Lot 345 San Geronio Pass as per map recorded in Book 1976 Page 185172 of maps in the office of the County Recorder of Riverside County.

Dated December 17, 1976

Lou Gladstein
Lou Gladstein

STATE OF CALIFORNIA
COUNTY OF Riverside } ss.
On December 22, 1976 before me, the undersigned, a Notary Public in and for said State, personally appeared Lou Gladstein and Sylvia Gladstein

Sylvia Gladstein
Sylvia Gladstein

known to me to be the persons whose names are subscribed to the within instrument and acknowledged that they executed the same. WITNESS my hand and official seal.

Signature: *Renée J. Doze*

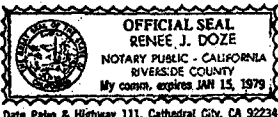

(This area for official notarial seal)

PR 6 1/76

MAIL TAX STATEMENTS AS DIRECTED ABOVE.

END RECORDED DOCUMENT

W. D. BALOGH, COUNTY RECORDER

152424 245591

RECORDING REQUESTED BY

AND WHEN RECORDED MAIL THIS DEED AND, UNLESS OTHERWISE SHOWN BELOW, MAIL TAX STATEMENTS TO:

NAME Mr. Raymond L. Russell, Jr.
Mr. Raymond L. Russell, III

STREET ADDRESS 132 W. Adams Street

CITY, STATE ZIP Somerville, Mass 02144

TITLE ORDER NO. _____ ESCROW NO. _____

PAID
 Doc. Transfer Tax
 W. L. BALOGH
 RIV. CO. RECORDER

RECEIVED FOR RECORD
 AUG 8 1977
 3:10 Min. Past 1 o'clock P.M.
 At Expense of
W.L. Balogh
 152424
 Recorded in Official Records
 of Riverside County, California
 W.L. Balogh Recorder
 FEES \$ 3

SPACE ABOVE THIS LINE FOR RECORDER'S USE

GRANT DEED

THE UNDERSIGNED GRANTOR(S) DECLARE(S)
 DOCUMENTARY TRANSFER TAX is \$ 1.10
 computed on full value of property conveyed, or
 computed on full value less value of liens or encumbrances remaining at time of sale, and

FOR A VALUABLE CONSIDERATION, receipt of which is hereby acknowledged,

LOU GLADSTEIN AND SYLVIA GLADSTEIN

hereby GRANT(S) to

RAYMOND L. RUSSELL, JR. AND RAYMOND L. RUSSELL, III as TENANTS IN COMMON
 with Rights of Survivorship
 the following described real property in the **Unincorporated area**

County of **Riverside**, State of California:

PAGE 43 Lot 345 San Gorgonio Pass as per map recorded in Book ³⁴ 1976
 Page 183172 of maps in the office of the County Recorder of
 Riverside County.

*This document is being re-recorded to correct
 the map book and page.*

Dated December 17, 1976

Lou Gladstein
 Lou Gladstein

STATE OF CALIFORNIA
 COUNTY OF Riverside } ss.
 On December 22, 1976 before me, the
 undersigned, a Notary Public in and for said State, personally appeared
Lou Gladstein and Sylvia Gladstein

Sylvia Gladstein
 Sylvia Gladstein

_____, known to me
 to be the person(s) whose name(s) are subscribed to the within
 instrument and acknowledged that they executed the same.
 WITNESS my hand and official seal.

Signature *Renee J. Doze*

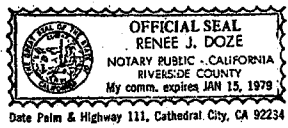

(This area for official notarial seal)

PR-6 1/70

MAIL TAX STATEMENTS AS DIRECTED ABOVE.

245591

RECEIVED FOR RECORD

DEC 9 1977

Min. Past 2 o'clock 2 M.
At Request of

GRANTEE

Book 1977, Page **245591**

Recorded in Official Records
of Riverside County, California

W.D. Balogh Recorder

FEE \$ 3

3

END RECORDED DOCUMENT

W. D. BALOGH, COUNTY RECORDER

DOC # 2012-0459520

09/26/2012 12:15P Fee:NC

Page 1 of 42

Recorded in Official Records

County of Riverside

Larry W. Ward

Assessor, County Clerk & Recorder



3850 Vine Street, Suite 110
Riverside, CA 92507

| S | R | U | PAGE | SIZE | DA | MISC | LONG | RFD | COPY |
|-----------------|---|---|----------------------|------|------|------|------|------|------|
| 1 | | | 42 | | | | | | |
| M | A | L | 465 | 426 | PCOR | NCOR | SMF | NCHG | EXAM |
| CONCHG PER CUST | | | NO change Account I: | | | | CTY | UNI | 517 |

φ
C
517

**CERTIFICATE OF COMPLETION
STOP #1030**

Pursuant to the Cortese-Knox-Hertzberg Local Government Reorganization Act of 2000, Section 57200 et seq. this Certificate is hereby issued by the Executive Officer of the Local Agency Formation Commission of Riverside County, California.

- Short-form designation, as designated by LAFCO, is 2012-04-4&5.
- The name of the district involved in this change of organization and the kind or type of change ordered is as follows:

| | |
|------------------------------------|---------------------------------------|
| <u>District</u> | <u>Type of Change of Organization</u> |
| Banning Library District (Cabazon) | Detachment |
- The above-listed district is located within the following county: Riverside.
- A description of the boundaries of the above-cited change of organization are shown on the attached map and legal description, marked Exhibit "A" and by reference incorporated herein.
- The territory is legally inhabited.
- This change of organization has been approved subject to the terms and conditions outlined on the attached resolution.
- Conducting Authority Resolution No. C-03-12 ordering this change of organization was approved on September 10, 2012. A certified copy of the resolution is attached hereto and by reference incorporated herein.

I hereby certify that as Executive Officer for the Local Agency Formation Commission of Riverside County, the above-listed agency has completed the change of organization pursuant to the Cortese-Knox-Hertzberg Local Government Reorganization Act of 2000.

GEORGE SPILIOTIS
Executive Officer

Date: September 26, 2012

RIVERSIDE LOCAL AGENCY FORMATION COMMISSION • 3850 VINE STREET, SUITE 110 • RIVERSIDE, CA 92507-4277
Phone (951) 369-0631 • www.lafco.org • Fax (951) 369-8479



1
2
3
4
5
6
7
8
9
10
11
12
13
14
15
16
17
18
19
20
21
22
23
24
25
26
27
28

WHEREAS, Resolution 08-12 directed the Executive Officer to commence protest proceedings pursuant to Part 4 of the Cortese-Knox-Hertzberg Local Government Reorganization Act of 2000, commencing with Section 57000; and

WHEREAS, the reason for this proposed detachment is to provide library services by the County of Riverside Library System; and

WHEREAS, the Commission determined the territory proposed to be reorganized is legally inhabited; and

WHEREAS, the terms and conditions of the proposal as approved by the Local Agency Formation Commission are as follows:

a. The County of Riverside shall defend, indemnify and hold harmless the Riverside County Local Agency Formation Commission (LAFCO), its agents, officers, and employees from any claim, action, or proceeding against LAFCO, its agents, officers, and employees to attach, set aside, void, or annul an approval of LAFCO concerning this proposal.

b. In accordance with Government Code Sections 56886(t) and 57330, the subject territory shall be subject to the levying and collection of any previously authorized charge, fee, assessment or tax of the County of Riverside.

WHEREAS, the Executive Officer of the Local Agency Formation Commission, acting on behalf of the Commission as the conducting authority, held a properly noticed public hearing on this matter on Monday, September 10, 2012 at 9:00 a.m. at 3850 Vine Street, Suite 110, Riverside, California 92507; and

WHEREAS, the Executive Officer has found the

RIVERSIDE
LOCAL AGENCY
FORMATION COMMISSION
3850 Vine Street
Suite 110
Riverside, California
92507-4277
(951) 389-0631



1
2
3
4
5
6
7
8
9
10
11
12
13
14
15
16
17
18
19
20
21
22
23
24
25
26
27
28

value of the written protests filed and not withdrawn was less than 25 percent of the registered voters within the affected area and less than 25 percent of the number of owners of land owning 25 percent of the assessed value of land within the affected territory in accordance with Government Code Section 57075(a); and

WHEREAS, the regular County assessment roll is utilized by the subject agencies; and

WHEREAS, the affected territory will not be subject to existing general bonded indebtedness of the District; and

NOW, THEREFORE, BE IT RESOLVED that the Executive Officer, on behalf of the Local Agency Formation Commission pursuant to the Cortese-Knox-Hertzberg Local Government Reorganization Act of 2000, orders the detachment of the territory described in Exhibit "A" to include Detachment from the Banning Library District (Cabazon).

BE IT FURTHER RESOLVED that the Executive Officer shall complete this proposal pursuant to State Law subject to payment of required fees and terms and conditions as approved by the Commission.

ADOPTED, this 10th day of September 2012.



GEORGE J. SPILIOTIS
EXECUTIVE OFFICER

Acknowledged:



STEPHEN J. TOMANELLI, CHAIR

FORM APPROVED COUNTY COUNSEL
BY:  9-13-12
ANITA C. WILLIS DATE

RIVERSIDE
LOCAL AGENCY
FORMATION COMMISSION
1850 Vine Street
Suite 110
Riverside, California
92507-6277
(951) 369-0631



EXHIBIT "A"

LAFCO 2012-03-4&5

Sphere of Influence Amendment (removal) to the Banning Library District

LAFCO 2012-04-4&5

Detachment from Banning Library District (Cabazon Library)

Those portions of Township 2 South, Range 1 East, San Bernardino Meridian, Township 2 South, Range 2 East, San Bernardino Meridian, Township 2 South, Range 3 East, San Bernardino Meridian, Township 3 South, Range 1 East, San Bernardino Meridian, Township 3 South, Range 2 East, San Bernardino Meridian and Township 3 South, Range 3 East, San Bernardino Meridian, described as follows;

Beginning at the Northeast corner of Section 4, Township 2 South, Range 1 East, San Bernardino Meridian, also being a point on the boundary of the San Bernardino County and Riverside County Line;

- 1 Thence Easterly along the San Bernardino, Riverside County Line to the Northeast corner of Section 1, Township 2 South, Range 3 East;
- 2 Thence southerly along the East line of Township 2 South, Range 3 East and Township 3 South, Range 3 East to the point of intersection of the East line of Section 24, Township 3 South, Range 3 East with the Centerline of State Highway Route 111;
- 3 Thence Westerly following said centerline to a point of intersection with the East line of Section 23, Township 3 South, Range 3 East;
- 4 Thence Southerly along the East line of said Section 23 and Section 26, Township 3 South, Range 3 East to the Southwest corner of said Section 26,;
- 5 Thence Westerly along the South line of said Section 26 and Section 27, Township 3 South, Range 3 East to the Northeast corner of Section 33, Township 3 South, Range 3 East;
- 6 Thence Southerly along the East line of said Section 33 to the Southeast corner of said Section 33;
- 7 Thence Westerly along the South line of said Section 33 to the Southwest corner of said Section 33;
- 8 Thence Northerly along the West line of said Section 33 and Section 28, Township 3 South, Range 3 East to the Northeast corner of Section 20, Township 3 South, Range 3 East;





- 9 Thence Westerly along the South line of said Section 20 and Section 19, Township 3 South, Range 3 East to the Southwest corner of said Section 19, also being a point on the East Range line of Township 3 South, Range 2 East ;
- 10 Thence Southerly along the East Range line of Township 3 South, Range 2 East to the Southeast Corner of Section 24, Township 3 South, Range 2 East;
- 11 Thence Westerly along the South line of said Section 24 and Sections 23, 22, 21, 20 and 19, Township 3 South, Range 2 East, and Sections 24 and 23, Township 3 South, Range 1 East to the point of intersection with the Centerline of State Highway 243;
- 12 Thence Northerly and Westerly along said centerline of State Highway 243 to the point of intersection with the West line of said Section 23;
- 13 Thence Northerly along the West line of said Section 23 to the point of intersection with the centerline of State Highway 243;
- 14 Thence Southerly and Northerly along said centerline of State Highway 243 through portions of Sections 23 and 14 of Township 3 South, Range 1 East to the point of intersection on the West line of Said Section 14;
- 15 Thence Northerly along West line of said Section 14 to the South One Sixteenth Corner of said Section 14;
- 16 Thence Easterly along the One Sixteenth section line to the South One Sixteenth Corner on the East line of said Section 14;
- 17 Thence Southerly along the East line of said Sections 14 and 23, to the Southwest corner of Section 13, Township 3 South, Range 1 East;
- 18 Thence Easterly along the South line of said Section 13 to the Southeast corner of said Section 13;
- 19 Thence Northerly along the East line of said Section 13 to the Northeast corner of said Section 13;
- 20 Thence Westerly along the North line of said Section 13 to the Northwest corner of said Section 13;
- 21 Thence Northerly along the West line of Section 12, Township 3 South, Range 1 East, to the point of intersection on the Southerly right of way of the Southern Pacific Rail Road;
- 22 Thence Northeasterly along said Rail Road right of way to the point of intersection on the East line of said Section 12;
- 23 Thence Northerly along the East line of said Section 12 and Section 1, Township 3 South, Range 1 East to the East One Quarter corner of said Section 1;





- 24 Thence Westerly along the Center Section line of said Section 1 to the West One Quarter corner of said Section 1;
- 25 Thence Southerly along the West line of said Section 1 to the Southeast corner of Section 2, Township 3 South, Range 1 East;
- 26 Thence Westerly along the South line of said Section 2 to the Southwest corner of said Section 2;
- 27 Thence Northerly along the West line of said Section 2 to the Southeast corner of Section 34, Township 2 South, Range 1 East;
- 28 Thence Westerly along the South line of said Section 34 to the Southwest corner of said Section 34;
- 29 Thence Northerly along the West line of said Section 34 and Section 27, Township 2 South, Range 1 East to the southeast corner of Section 21, Township 2 South, Range 1 East;
- 30 Thence Westerly along the South line of said Section 21 to the Southwest corner of said Section 21;
- 31 Thence Northerly along the West line of said Section 21 to the West One Quarter corner of said Section 21;
- 32 Thence Easterly along the Center Section line of said Section 21 to the Center-West-West One Sixty-fourth corner of said Section 21;
- 33 Thence Northerly to the West-West One Sixty-fourth corner on the North section line of said Section 21;
- 34 Thence Westerly along the North line of said Section 21 and Section 20, Township 2 South, Range 1 East to the West-East One Sixty-fourth corner on the North line of said Section 20;
- 35 Thence Northerly to the Center-West-East One Sixty-fourth corner of Section 17 Township 2 South, Range 1 East;
- 36 Thence Westerly along the Center Section line of said Section 17 to the Center of Section of said Section 17;
- 37 Thence Northerly along the Center Section line of said Section 17 and Section 8, Township 2 South, Range 1 East to the Center of Section of said Section 8;
- 38 Thence Easterly along the Center Section line of said Section 8 to the Center-East One Sixteenth corner of said Section 8;
- 39 Thence Northerly to the North-East One Sixteenth corner of said Section 8;





2012-0459520
09/26/2012 12:15P
8 of 42

- 40 Thence Easterly to the North One Sixteenth corner on the East Section line of said Section 8;
- 41 Thence Northerly along the East Section line of said Section 8 to the Southwest Corner of Section 4 Township 2 South, Range 1 East;
- 42 Thence Easterly along the South line of said Section 4 to the Southeast corner of said Section 4;
- 43 Thence Northerly along the East line of said Section 4 to the northeast corner of said Section 4, also being the Point of Beginning.

Prepared under my Supervision;



By *Kenneth D Teich*, Deputy
Kenneth D Teich P.L.S. 5705
Riverside County Surveyor

APPROVED BY THE
LOCAL AGENCY FORMATION COMMISSION

Gregory EHE 7/26/2012

1 inch = 9.941 feet

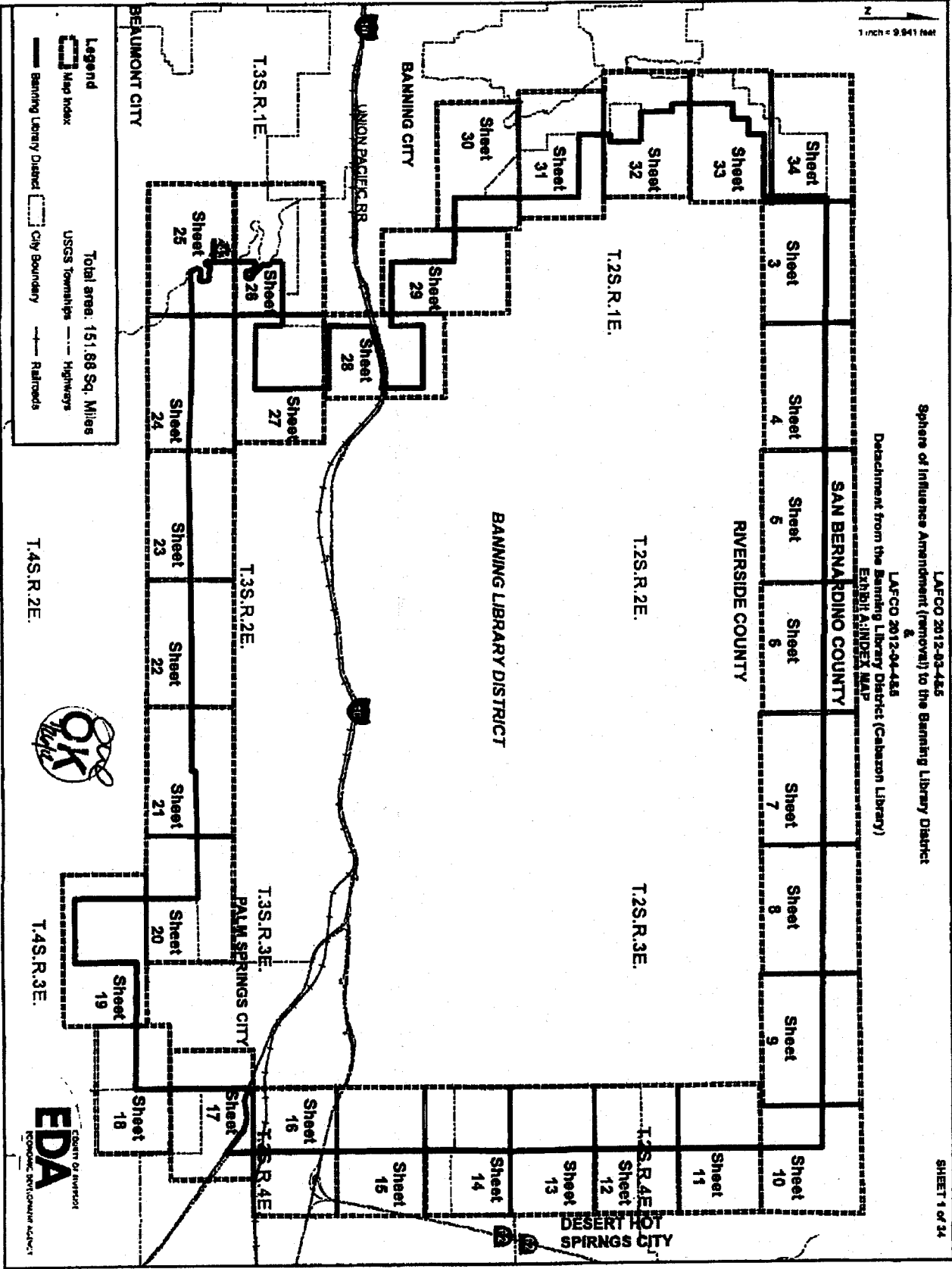

Legend

Map Index

USGS Townships

City Boundary

Highways

Railroads

Banning Library District

Total area: 151.88 Sq. Miles

T.4S.R.2E.

T.4S.R.3E.



LAFCO 2012-03-485
 Sphere of Influence Amendment (removal) to the Banning Library District
 LAFCO 2012-04-485
 Detachment from the Banning Library District (Cabrera Library)
 Exhibit A: INDEX MAP

SHEET 1 of 34



2012-0459520
 09/26/2012 12:15P
 9 of 42

EXHIBIT "A"
LAFCO 2012-03-48.5 Sphere of Influence Amendment (removal) to the Banning Library District
&
LAFCO 2012-04-48.5 Detachment from the Banning Library District (Cabazon Library)
DATA TABLE

| MAP POINTS AND DIRECTION | |
|--------------------------|-------------------------|
| POINT | DIRECTION |
| 1 | EASTERLY |
| 2 | SOUTHERLY |
| 3 | WESTERLY |
| 4 | SOUTHERLY |
| 5 | WESTERLY |
| 6 | SOUTHERLY |
| 7 | WESTERLY |
| 8 | NORTHERLY |
| 9 | WESTERLY |
| 10 | SOUTHERLY |
| 11 | WESTERLY |
| 12 | NORTHERLY AND WESTERLY |
| 13 | NORTHERLY |
| 14 | SOUTHERLY AND NORTHERLY |
| 15 | NORTHERLY |

| MAP POINTS AND DIRECTION | |
|--------------------------|---------------|
| POINT | DIRECTION |
| 16 | EASTERLY |
| 17 | SOUTHERLY |
| 18 | EASTERLY |
| 19 | NORTHERLY |
| 20 | WESTERLY |
| 21 | NORTHERLY |
| 22 | NORTHEASTERLY |
| 23 | NORTHERLY |
| 24 | WESTERLY |
| 25 | SOUTHERLY |
| 26 | WESTERLY |
| 27 | NORTHERLY |
| 28 | WESTERLY |
| 29 | NORTHERLY |
| 30 | WESTERLY |

| MAP POINTS AND DIRECTION | |
|--------------------------|-----------|
| POINT | DIRECTION |
| 31 | NORTHERLY |
| 32 | EASTERLY |
| 33 | NORTHERLY |
| 34 | WESTERLY |
| 35 | NORTHERLY |
| 36 | WESTERLY |
| 37 | NORTHERLY |
| 38 | EASTERLY |
| 39 | NORTHERLY |
| 40 | EASTERLY |
| 41 | NORTHERLY |
| 42 | EASTERLY |
| 43 | NORTHERLY |



2012-0459520
 03/26/2012 12:15P
 10 of 42

EXHIBIT "A"

LAFCO 2012-03-485
Sphere of Influence Amendment (removal) to the Banning Library District
LAFCO 2012-04-485
Detachment from the Banning Library District (Cabazon Library)

SHEET 3 OF 34 SHEETS

1 inch = 1,200 feet

P.O.B. ①
EASTERLY

SAN BERNARDINO COUNTY

RIVERSIDE COUNTY

BANNING CITY

BANNING LIBRARY DISTRICT

SECTION 3
T.2S.R.1E.

03132007

SECTION 2
03132002

See Sheet 4

See Sheet 34

03132004

SECTION 10
03132004

SECTION 11



Legend

- Banning Library District
- USGS Sections
- Assessor Parcels
- City Boundary



2012-0459520
09/28/2012 12:15P
11 of 42

EXHIBIT "A"

SHEET 4 OF 34 SHEETS

LAFCO 2012-03-485
Sphere of Influence Amendment (removal) to the Banning Library District
&
LAFCO 2012-04-485
Detachment from the Banning Library District (Cabazon Library)

1 inch = 1,200 feet

EASTERLY

SAN BERNARDINO COUNTY

BANNING LIBRARY DISTRICT

RIVERSIDE COUNTY

See Sheet 3

See Sheet 5

63122903

SECTION 1

T.2S.R.1E.

SECTION 6

81418018

T.2S.R.2E.

SECTION 12

SECTION 7



Legend

- Banning Library District
- USGS Sections
- Assessor Parcels



2012-0459520
09/26/2012 12:15P
12 of 42

EXHIBIT "A"

SHEET 6 OF 34 SHEETS

LAFCO 2012-03-4&5
Sphere of Influence Amendment (removal) to the Banning Library District
&
LAFCO 2012-04-4&5
Detachment from the Banning Library District (Cabazon Library)

N
1 inch = 1,200 feet

See Sheet 4

EASTERNLY

SAN BERNARDINO COUNTY

RIVERSIDE COUNTY

See Sheet 6

BANNING LIBRARY
DISTRICT

514180019

SECTION 5

514180020

SECTION 4

T.2S.R.2E.

SECTION 8

SECTION 9



Legend

Banning Library District

UICBA Services

Assessor's Parcels



2012-0459520
09/26/2012 12:15P
13 of 42

EXHIBIT "A"

SHEET 6 OF 14 SHEETS

LAFCO 2012-03-4&5
Sphere of Influence Amendment (removal) to the Banning Library District
&
LAFCO 2012-04-4&6
Detachment from the Banning Library District (Cabazon Library)

1 inch = 1,200 feet

See Sheet 5

See Sheet 7

EASTERLY

SAN BERNARDINO COUNTY

BANNING LIBRARY DISTRICT

RIVERSIDE COUNTY

814180021
SECTION 3

814180022
SECTION 2

T.2S.R.2E.

SECTION 10

SECTION 11



Legend

- Banning Library District
- UDCS Streams
- Aesthetic Features



2012-0459520
09/26/2012 12:15P
14 of 42

EXHIBIT "A"

SHEET 7 OF 24 SHEETS

LAFCO 2012-03-4&5
Sphere of Influence Amendment (removal) to the Banning Library District

LAFCO 2012-04-4&5
Detachment from the Banning Library District (Cabazon Library)



1 inch = 1,200 feet

See Sheet 6

EASTERLY

SAN BERNARDINO COUNTY

See Sheet 8

RIVERSIDE COUNTY

BANNING LIBRARY DISTRICT

514190023

T.2S.R.2E.

SECTION 1

514210007

T.2S.R.3E.

SECTION 6

514210008



SECTION 12

SECTION 7

Legend
Banning Library District
USGS Section
Avonlea Parcel



2012-0459520
09/26/2012 12:15P
15 of 42

EXHIBIT "A"

LAFCO 2012-03-4&5
Sphere of Influence Amendment (removal) to the Banning Library District
&
LAFCO 2012-04-4&5
Detachment from the Banning Library District (Cabazon Library)

SHEET 8 OF 34 SHEETS



1 inch = 1,200 feet

See Sheet 9

SAN BERNARDINO COUNTY

EASTERLY

BANNING LIBRARY DISTRICT

RIVERSIDE COUNTY

SECTION 6

014210000

T.2S.R.3E.

SECTION 4

014210000

SECTION 3

014220007

SECTION 8

SECTION 9



Legend

- Banning Library District
- UACS Sections
- Accession Parcels



2012-0459520
09/26/2012 12:15P
16 of 42

EXHIBIT "A"

LAFCO 2012-03-485
Sphere of Influence Amendment (removal) to the Banning Library District
&
LAFCO 2012-04-485
Detachment from the Banning Library District (Cabazon Library)

SHEET 9 OF 34 SHEETS



N
1 inch = 1,200 feet

See Sheet 8

See Sheet 10

EASTERLY

SAN BERNARDINO COUNTY

RIVERSIDE COUNTY

BANNING LIBRARY DISTRICT

SECTION 3

§14220007

T.2S.R.3E.

SECTION 2

§14220008

§14220001

SECTION 1

§14220009

§14220002



SECTION 10

SECTION 11

Legend

Banning Library District

USGS Section

Assessor's Parcel



2012-0459520

09/28/2012 12:15P

17 of 42

EXHIBIT "A"

SHEET 18 OF 34 SHEETS

LAFCO 2012-03-485
Sphere of Influence Amendment (removal) to the Banning Library District
&
LAFCO 2012-04-485
Detachment from the Banning Library District (Cabazon Library)

CRF
3/14/12

1 inch = 1,200 feet

See Sheet 9

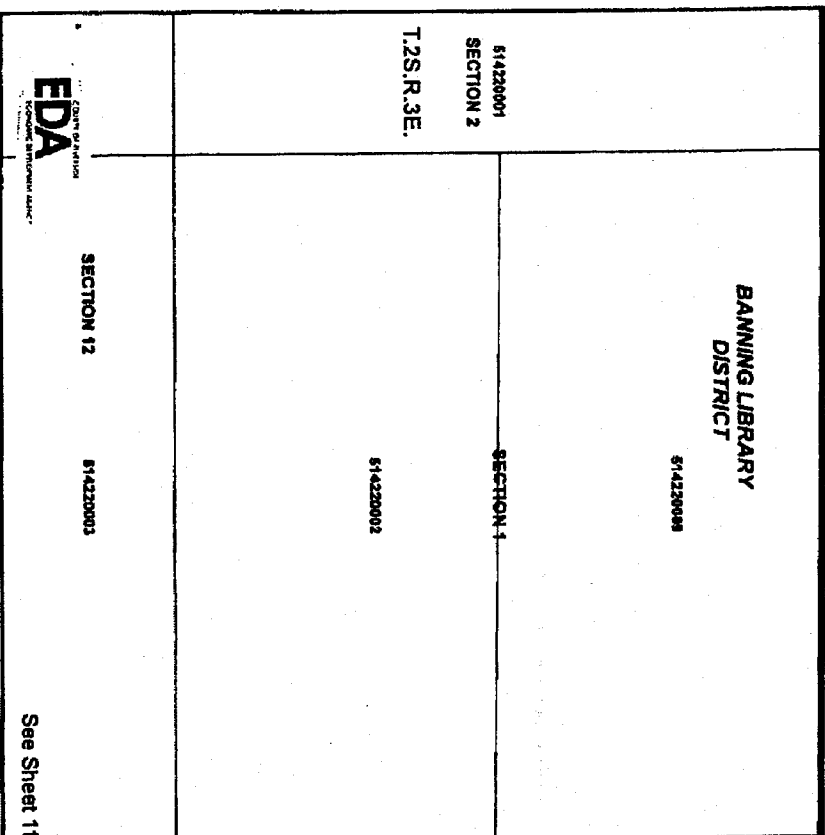

SAN BERNARDINO COUNTY

RIVERSIDE COUNTY



SECTION 6

T.2S.R.4E.

SECTION 8



See Sheet 11

Legend

- Banning Library District
- USGS Section
- Assessor's Parcels



2012-0459528
09/26/2012 12:15P
18 / 42

51422001
SECTION 2

51422002
SECTION 1

See Sheet 10

SHEET 11 OF 34 SHEETS

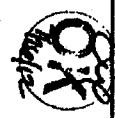

EXHIBIT "A"
LAFCO 2012-03-485
Sphere of Influence Amendment (removal) to the Banning Library District
LAFCO 2012-04-485
Detachment from the Banning Library District (Cabazon Library)

1 inch = 1,200 feet



SECTION 11

SECTION 12

51422004

51422003

SOUTHERLY

T.2S.R.3E.

BANNING LIBRARY DISTRICT

SECTION 7

SECTION 8

T.2S.R.4E.

SECTION 14

SECTION 13

51424018

SECTION 18

SECTION 17



51424020
See Sheet 12

Legend

- Banning Library District
- USGS Sections
- Assessor Parcel



2012-0453520
03/26/2012 12:15P
19 of 42

See Sheet 11

614240018

SECTION 14

SECTION 13

614240020

SOUTHERLY

T.2S.R.3E.

BANNING LIBRARY DISTRICT

SECTION 23

614240013

SECTION 24



See Sheet 13



EXHIBIT "A"

SHEET 12 OF 34 SHEETS

Sphere of Influence Amendment (removal) to the Banning Library District

Detachment from the Banning Library District (Cabazon Library)

SECTION 18

SECTION 17

T.2S.R.4E.

1 inch = 1,200 feet

DESERT HOT SPRINGS CITY

SECTION 19

SECTION 20

Legend

- Banning Library District
- USGS Sections
- Assessor Parcel
- City Boundary



2012-0459520
09/26/2012 12:15P
29 of 42

See Sheet 12

SECTION 23

SECTION 24

514280013

T.2S.R.3E.

DESERT HOT SPRINGS CITY

SOUTHERLY



SECTION 26

SECTION 25

514280009

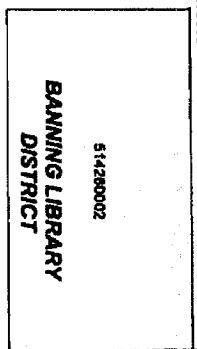

BANNING LIBRARY DISTRICT

514280002



COUNTY OF AVARADO
ECONOMIC DEVELOPMENT SERVICES

SECTION 36

514280012

See Sheet 14

EXHIBIT "A"

SHEET 13 OF 34 SHEETS

LAFCO 2012-03-485
Sphere of Influence Amendment (removal) to the Banning Library District

LAFCO 2012-04-425
Detachment from the Banning Library District (Cabazon Library)



SECTION 19

SECTION 20

T.2S.R.4E.



1 inch = 1,200 feet

SECTION 30

SECTION 29

SECTION 31

Legend

- Banning Library District
- USGS Sections
- Assessor Parcel
- City Boundary



2012-0459520
09/26/2012 12:15P
21 of 42

SECTION 26

SECTION 26

514280009

See Sheet 13

T.2S.R.3E.

SECTION 36

DESERT HOT SPRINGS CITY

SECTION 36

514280012

SOUTHERLY



T.3S.R.3E.

SECTION 2

SECTION 1

516030015

BANNING LIBRARY DISTRICT



COUNTY OF AVILA
EDDA
ECONOMIC DEVELOPMENT AUTHORITY

616030014
See Sheet 15

516030010

SHEET 14 OF 34 SHEETS

EXHIBIT "A"

LAFCO 2012-03-485
Sphere of Influence Amendment (removal) to the Banning Library District

LAFCO 2012-04-485
Detachment from the Banning Library District (Cabazon Library)



SECTION 31

T.2S.R.4E.

SECTION 32

1 inch = 1,200 feet



SECTION 6

T.3S.R.4E.

Legend

- Banning Library District
- USGS Sections
- Assessor Parcel
- City Boundary
- Highways



2012-0459520
09/26/2012 12:15P
22 of 42

See Sheet 14

EXHIBIT "A"

SHEET 14 OF 34 SHEETS

LAFCO 2012-03-4&5
Sphere of Influence Amendment (removal) to the Banning Library District
LAFCO 2012-04-4&5
Detachment from the Banning Library District (Cabazon Library)

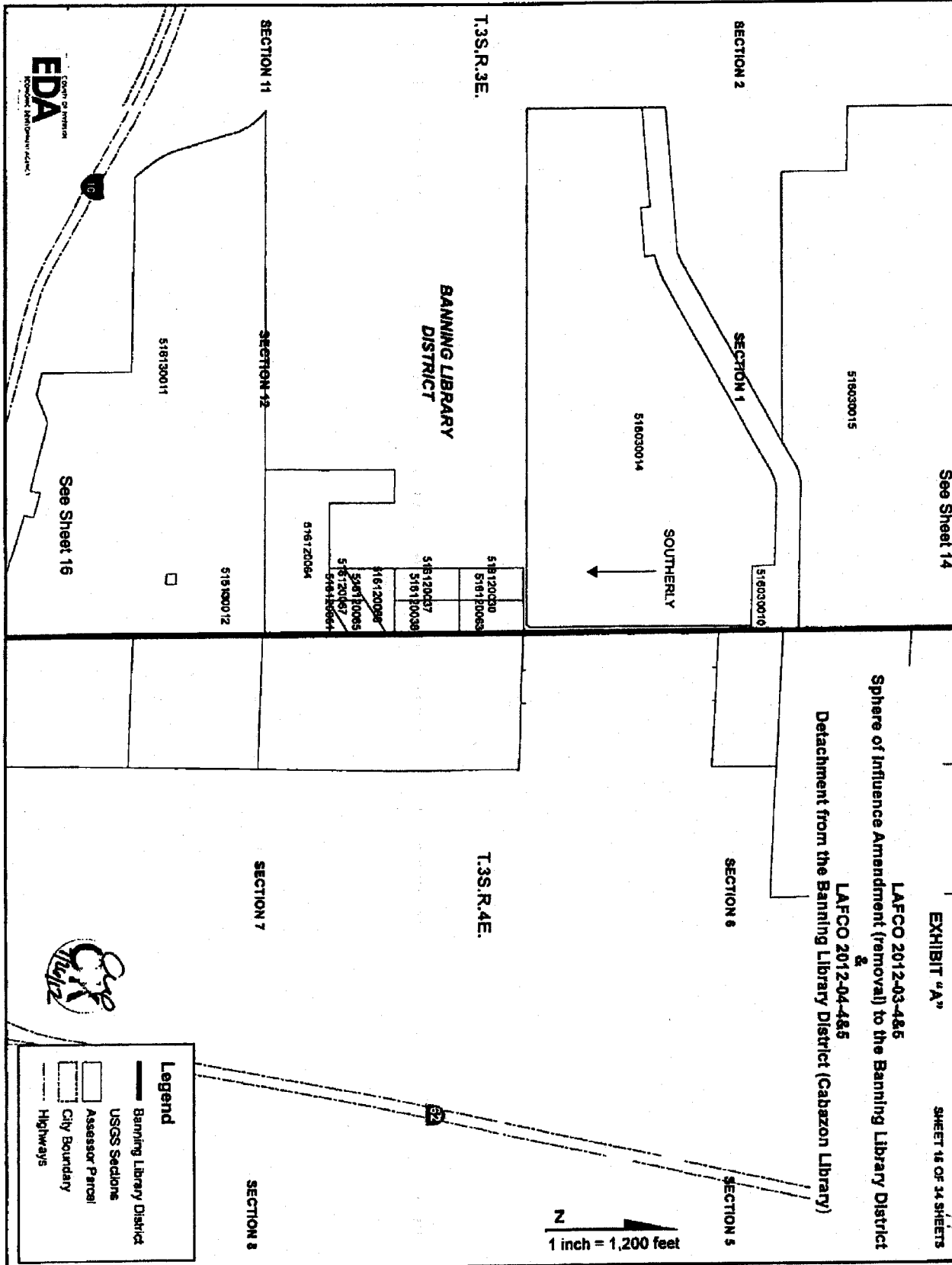

1 inch = 1,200 feet

Legend

- Banning Library District
- USGS Sections
- Assessor Parcel
- City Boundary
- Highways



2012-0459520
03/26/2012 12:15P
23 of 42

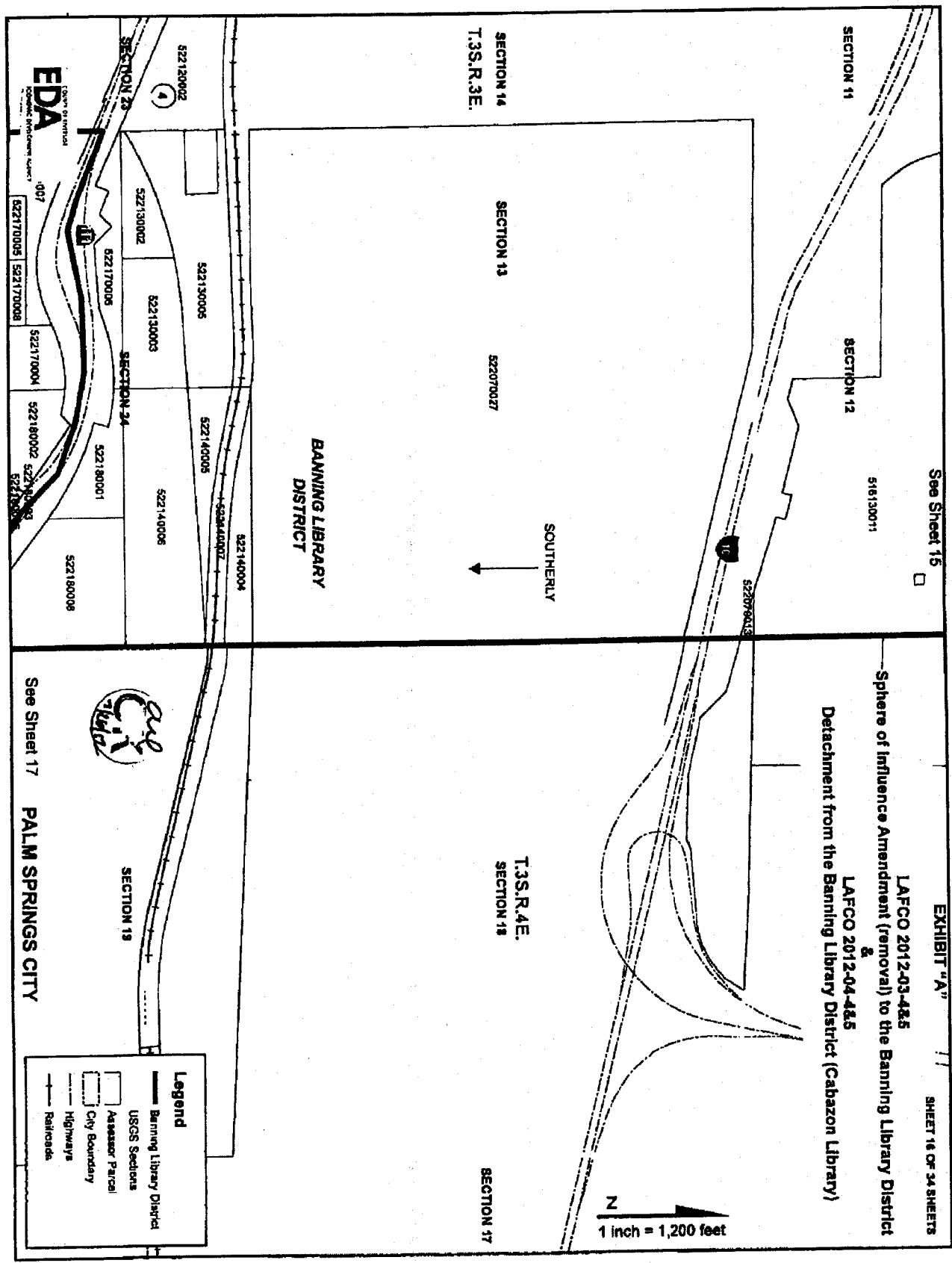

See Sheet 15

EXHIBIT "A"

SHEET 16 OF 34 SHEETS

LAFCO 2012-03-485
 Sphere of Influence Amendment (removal) to the Banning Library District
 LAFCO 2012-04-485
 Detachment from the Banning Library District (Cabazon Library)

1 inch = 1,200 feet



See Sheet 17 PALM SPRINGS CITY

Legend

- Banning Library District
- USGS Sections
- Assessor's Parcel
- City Boundary
- Highways
- Railroads



2012-0453520
 09/26/2012 12:15P
 24 of 42

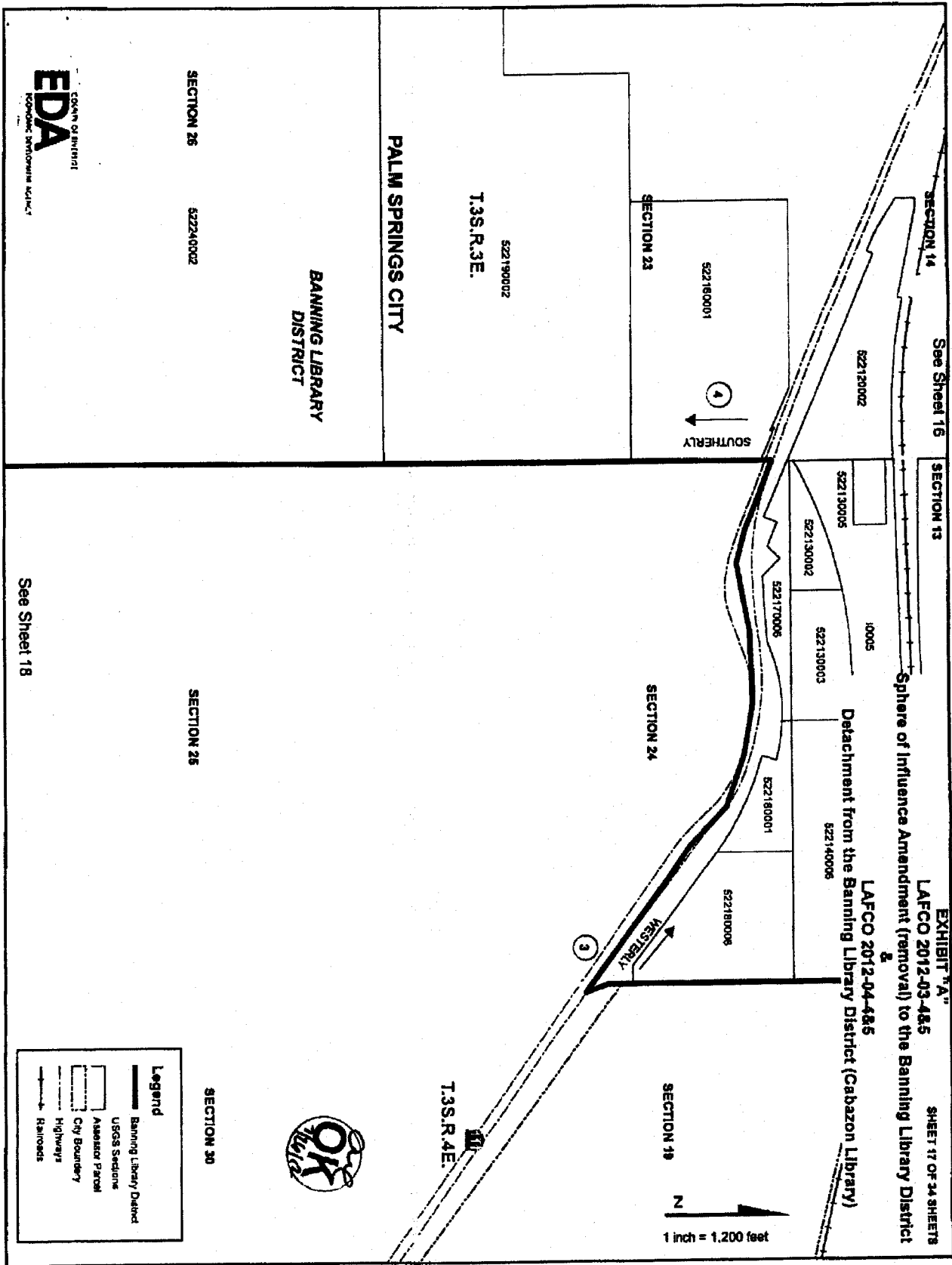

SHEET 17 OF 24 SHEETS



2012-0459520
 09/26/2012 12:15P
 25 of 42

See Sheet 17

BANNING LIBRARY DISTRICT

SECTION 27
522240001

SECTION 28
522240002

T.3S.R.3E.

See Sheet 19

SECTION 36



EXHIBIT "A"
LAFCO 2012-03-4&5
Sphere of Influence Amendment (removal) to the Banning Library District
&
LAFCO 2012-04-4&5
Detachment from the Banning Library District (Cabazon Library)

SHEET 18 OF 34 SHEETS



SECTION 29

PALM SPRINGS CITY

SECTION 30

T.3S.R.4E.

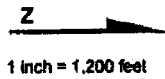

SECTION 35

SECTION 31



COUNTY OF INVERSON
EDA
ECONOMIC DEVELOPMENT AUTHORITY

Legend

- Banning Library District
- USGS Sections
- Assessor Parcel
- City Boundary



2012-0459520
09/26/2012 12:15P
28 of 42

T.4S.R.3E.
SECTION 6
EDA
COUNTY OF BANNING
ECONOMIC DEVELOPMENT AGENCY

T.3S.R.3E.



522230008

See Sheet 20

SECTION 28

522230013

BANNING LIBRARY DISTRICT

SECTION 33

522230002

PALM SPRINGS CITY

SECTION 4



EXHIBIT "A" SHEET 19 OF 34 SHEETS
LAFCO 2012-03-4&5 to the Banning Library District
Sphere of Influence Amendment (removal)

Detachment from the Banning Library District (Cabazon Library)
LAFCO 2012-04-4&5
SECTION 27

522240001

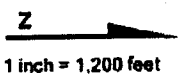
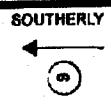

See Sheet 18



Legend

- Banning Library District
- USGS Sections
- Assessor Parcel
- City Boundary

2012-0459520
09/26/2012 12:15P
27 of 42





T.3S.R.3E.

522090001
SECTION 19
See Sheet 21

SECTION 20
522090002
BANNING LIBRARY DISTRICT

522090006

522090013

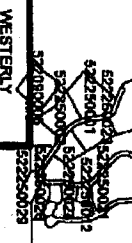

WESTERLY
9



EXHIBIT "A"
LAFCO 2012-03-485 SHEET 28 OF 34 SHEETS
Sphere of Influence Amendment (removal) to the Banning Library District
&
LAFCO 2012-04-485
Detachment from the Banning Library District (Cabazon Library)

SECTION 21

SECTION 22

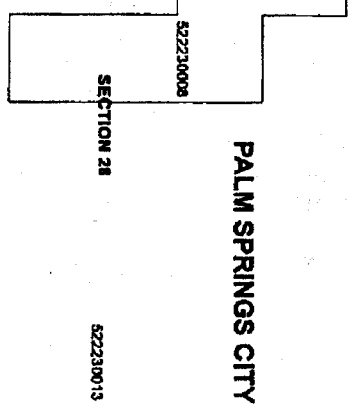
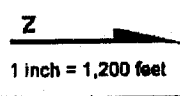

PALM SPRINGS CITY

SECTION 26

52230006

SECTION 27
52240001

See Sheet 19



Legend

- Banning Library District
- USGS Sections
- Assessor Parcel
- City Boundary



2012-0459520
09/26/2012 12:15P
28 of 42

EXHIBIT "A"

SHEET 31 OF 34 SHEETS

LAFCO 2012-03-4&5
Sphere of Influence Amendment (removal) to the Banning Library District

LAFCO 2012-04-4&5
&
Detachment from the Banning Library District (Cabazon Library)

See Sheet 22

SECTION 23
528240018

SECTION 24
528240004

BANNING LIBRARY
DISTRICT

528240008

10
←
SOUTHERLY

T.3S.R.2E.

←
WESTERLY
11

SECTION 26

SECTION 25

SECTION 19

522090001

9

←
WESTERLY

T.3S.R.3E.

See Sheet 20



522090006
SECTION 20

N
1 inch = 1,200 feet

COUNTY OF INDIANA
EDA
ECONOMIC DEVELOPMENT AUTHORITY

SECTION 31

Legend

-  Banning Library District
-  USGS Sections
-  Assessor Parcel

OK



2012-0459520
09/26/2012 12:15P
29 of 42

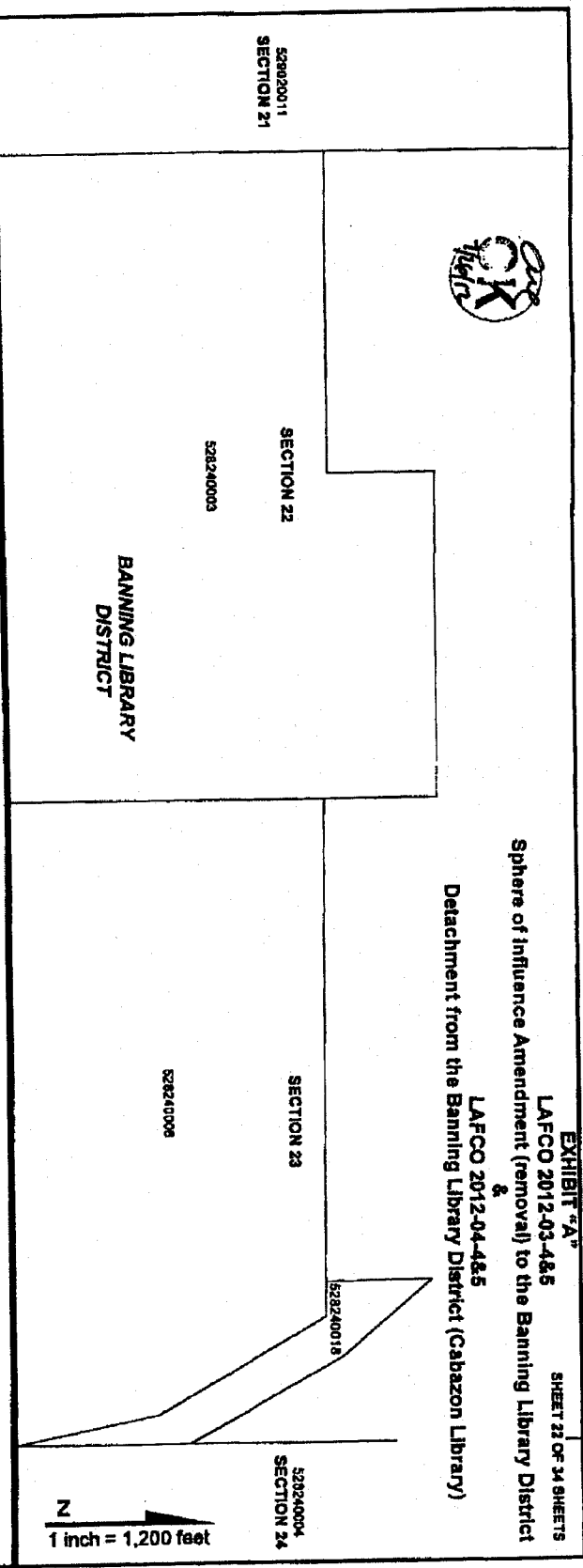

EXHIBIT "A"

SHEET 22 OF 24 SHEETS

LAFCD 2012-03-4&5
Sphere of Influence Amendment (removal) to the Banning Library District

LAFCD 2012-04-4&5
&
Detachment from the Banning Library District (Cabazon Library)



T.J.S.R.2E.

See Sheet 23

SECTION 28

SECTION 27

SECTION 26

SECTION 25

See Sheet 21



Legend

- Banning Library District
- USGS Sections
- Assessor Parcel



2012-0459520
09/28/2012 12:15P
39 of 42



EXHIBIT "A"
SHEET 33 OF 34 SHEETS
LAFCO 2012-03-4&5
Sphere of Influence Amendment (removal) to the Banning Library District
&
LAFCO 2012-04-4&5
Detachment from the Banning Library District (Cabazon Library)

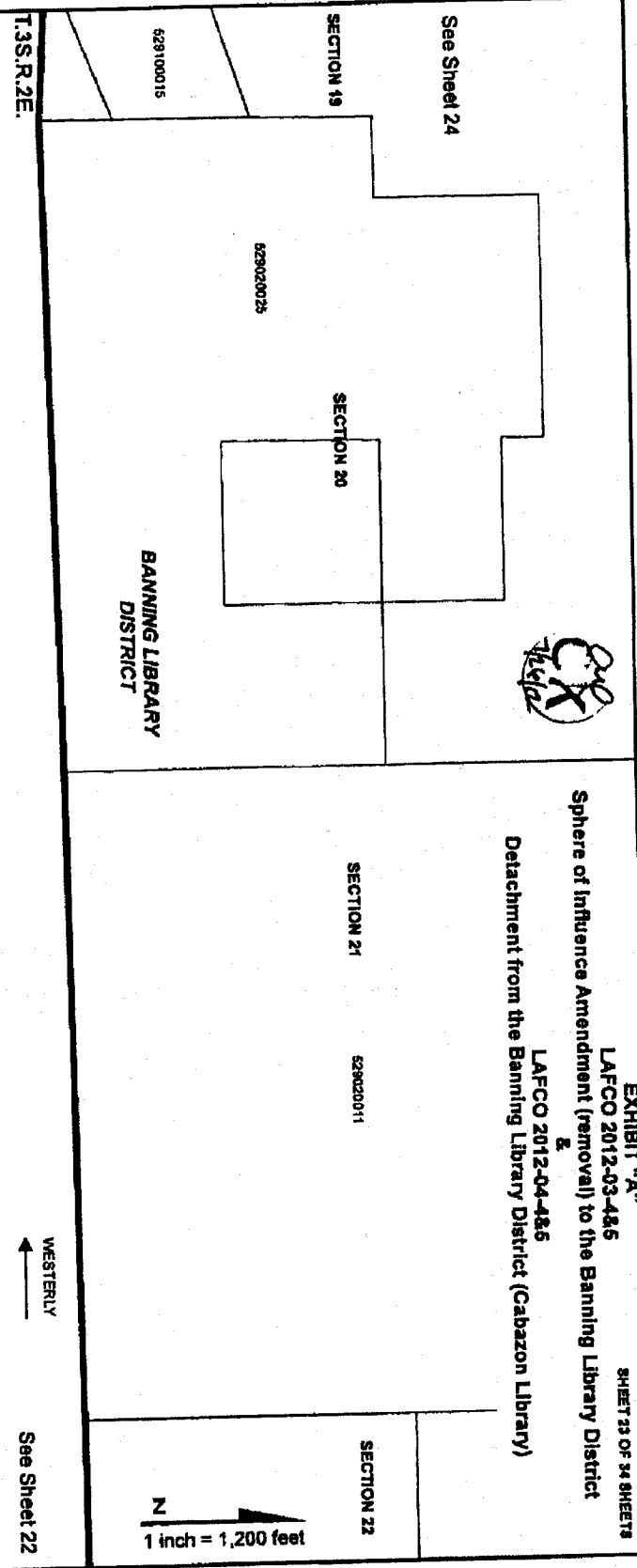

Legend

- Banning Library District
- USGS Sections
- Assessor Parcel

2012-0459520
 09/26/2012 12:15P
 31 of 42



EXHIBIT "A"

LAFCO 2012-03-4&5

SHEET 24 OF 24 SHEETS

Sphere of Influence Amendment (removal) to the Banning Library District

LAFCO 2012-04-4&5

Detachment from the Banning Library District (Cabazon Library)

1 inch = 1,200 feet

T3S,R.1E.

SECTION 23

SECTION 24

SECTION 19

BANNING LIBRARY DISTRICT

532220006

WESTERLY



T3S,R.2E.

529090021

529090022

529100018

529100019

529100017

529100016

529100015

529100012

529100013

See Sheet 25

SECTION 24

SECTION 25

SECTION 30

See Sheet 23



Center of Excellence
Economic Development Agency



Legend

- Banning Library District
- USGS Sections
- Assessor Parcel
- Highways



2012-0459520
09/26/2012 12:15P
32 of 42

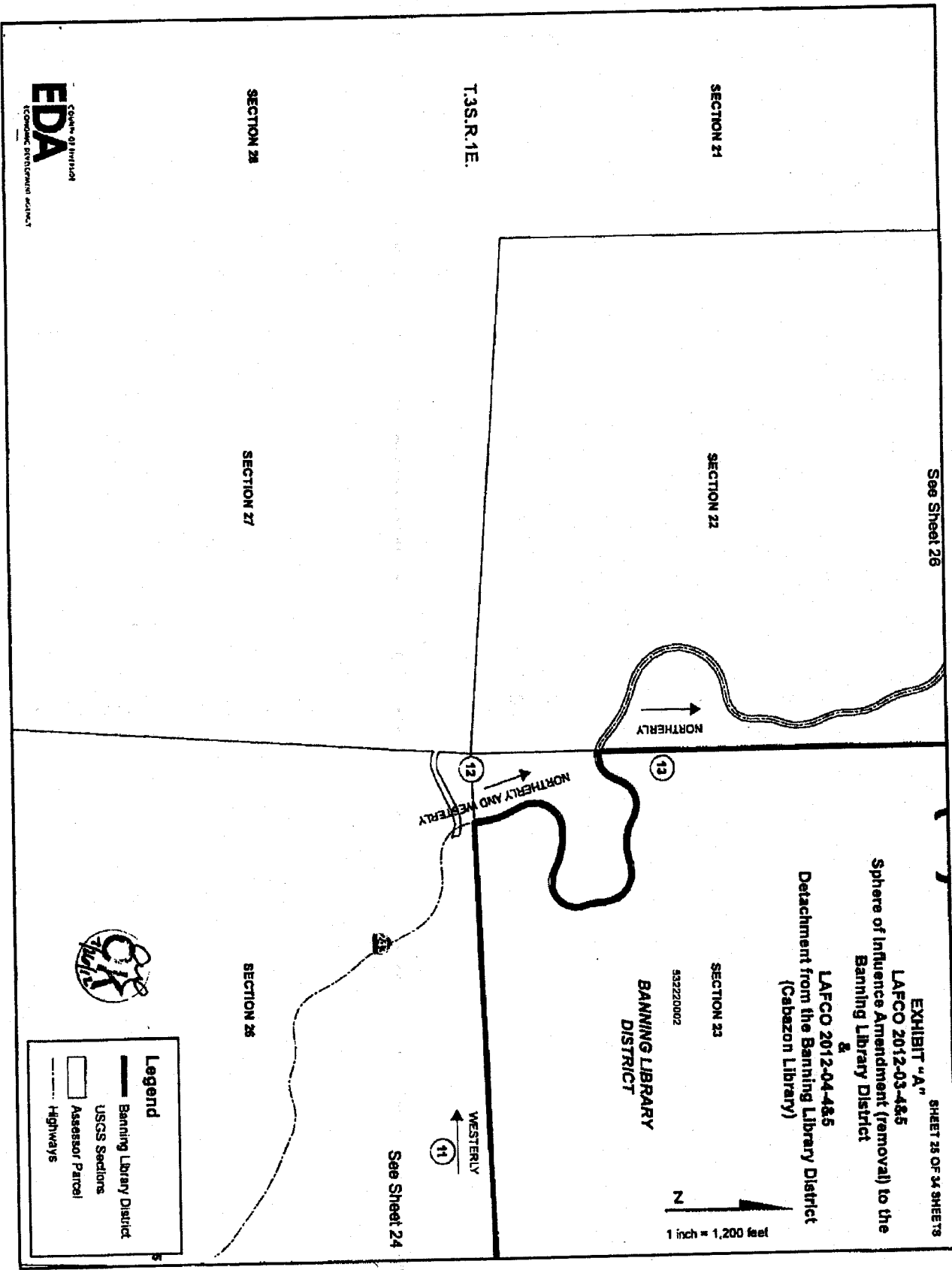

EXHIBIT "A"
 SHEET 28 OF 34 SHEETS
 LAFCO 2012-03-485
 Sphere of Influence Amendment (removal) to the
 Banning Library District
 &
 LAFCO 2012-04-485
 Detachment from the Banning Library District
 (Cabazon Library)

SECTION 23
 53220002
 BANNING LIBRARY
 DISTRICT

1 inch = 1,200 feet

Legend
 — Banning Library District
 □ USGS Sections
 □ Assessor Parcel
 --- Highways



2012-0459520
 09/26/2012 12:15P
 33 of 42

BANNING CITY

SECTION 9

SECTION 10

SECTION 16

T.3S.R.1E.

SECTION 21

SECTION 15

SECTION 22

See Sheet 25

EXHIBIT "A"
LAFCO 2012-03-4&5
Sphere of Influence Amendment (removal) to
the Banning Library District
&
LAFCO 2012-04-4&5
Detachment from the Banning Library District
(Cabazon Library)

SHEET 26 OF 34 SHEETS



1 inch = 1,200 feet

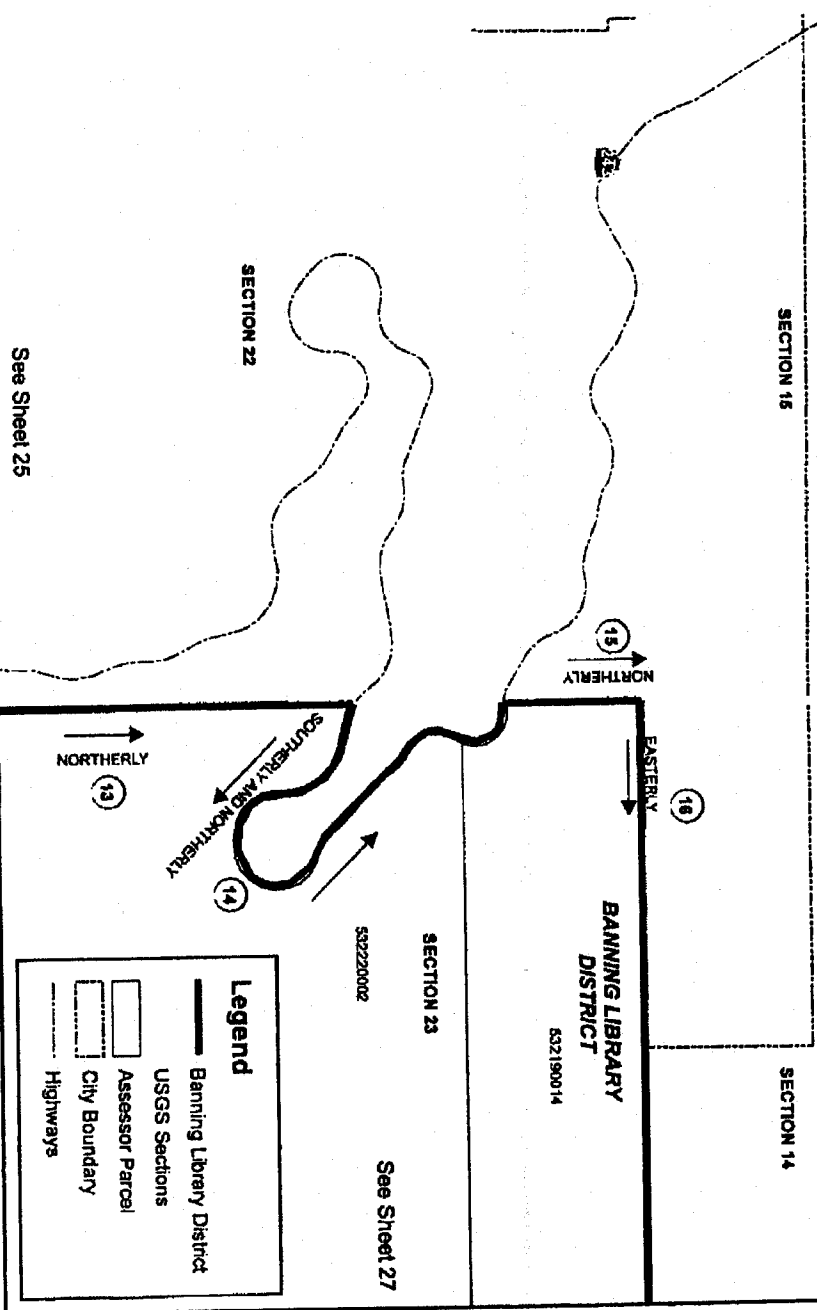

Legend

- Banning Library District
- USGS Sections
- Assessor Parcel
- City Boundary
- Highways



2012-0459520
68/26/2012 12:15P
34 of 42

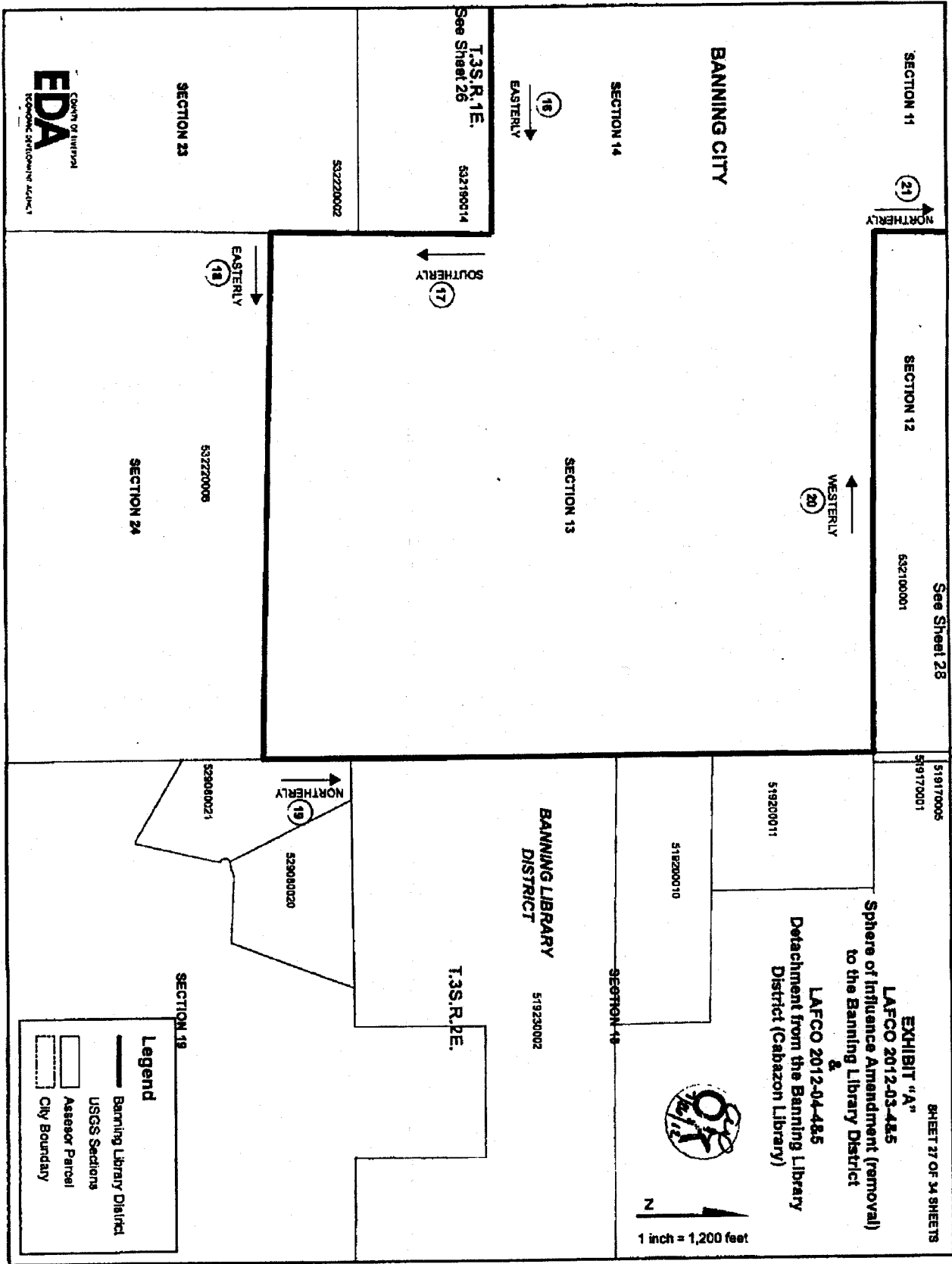

County of Imperial
EDA
Economic Development Authority

Legend

- Banning Library District
- USGS Sections
- ▭ Assessor Parcel
- ▭ City Boundary

EXHIBIT "A"
LAFCO 2012-03-4&5
Sphere of Influence Amendment (removal)
to the Banning Library District
&
LAFCO 2012-04-4&5
Detachment from the Banning Library
District (Cabazon Library)

1 inch = 1,200 feet

2012-0459520
09/26/2012 12:15P
35 of 42

EXHIBIT "A"
LAFCO 2012-03-4&5
Sphere of Influence Amendment (removal) to the Banning Library District
&
LAFCO 2012-04-4&5
Detachment from the Banning Library District (Cabazon Library)

SHEET 28 OF 34 SHEETS

1 inch = 1200 Feet

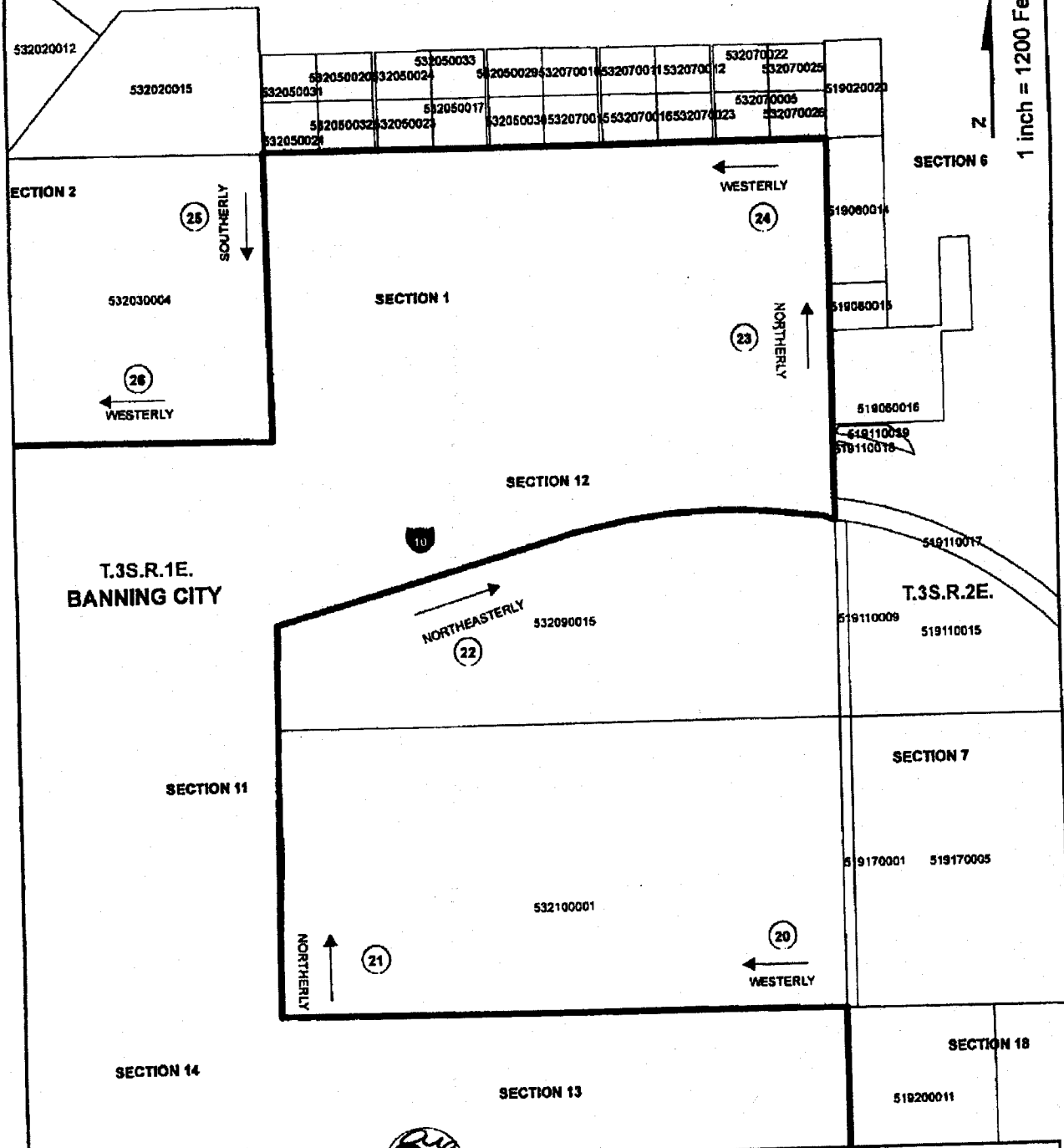

T.3S.R.1E.
BANNING CITY

T.3S.R.2E.



Legend

- Banning Library District
- Assessor Parcel
- USGS Sections

2012-0459520
 09/26/2012 12:15P
 36 of 42



531120009

EXHIBIT "A"
LAFCO 2012-03-4&5
Sphere of Influence Amendment (removal)
to the Banning Library District
&
LAFCO 2012-04-4&5
Detachment from the Banning Library District
(Cabazon Library)

SHEET 29 OF 34 SHEETS

SECTION 34 T.2S.R.1E.

See Sheet 30

531130003

SECTION 35

SECTION 36

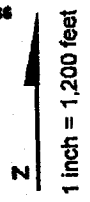

BANNING LIBRARY DISTRICT



531140021

531130004

See Sheet 28



532020012

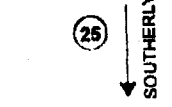

SECTION 3

SECTION 2

SECTION 1

T.3S.R.1E.

BANNING CITY

532030003

532030004

Legend

- Banning Library District
- USGS Sections
- Assessor Parcel
- City Boundary
- Highways
- Railroads



SECTION 11

SECTION 12

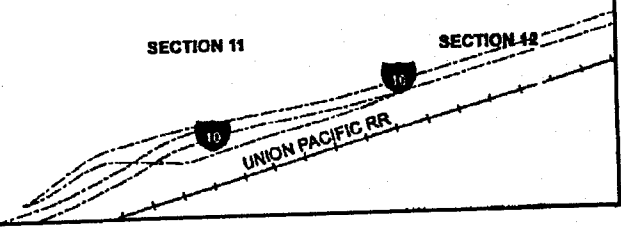

2012-0459520
09/26/2012 12:15P
37 of 42

BANNING CITY

SECTION 5

SECTION 32

SECTION 29

SECTION 4

SECTION 33

SECTION 28

See Sheet 31



SECTION 3

Legend

- Banning Library District
- USGS Sections
- Assessor Parcel
- City Boundary

531120008

EXHIBIT "A"
 SHEET 38 OF 34 SHEETS

LAFCO 2012-03-485
 Sphere of Influence Amendment (removal) to
 the Banning Library District
 &
 LAFCO 2012-04-485
 Detachment from the Banning Library District
 (Cabazon Library)

BANNING LIBRARY
 DISTRICT

531120009

See Sheet 29

1 inch = 1,200 feet

531130003

531130004



See Sheet 32

EXHIBIT "A"
LAFCO 2012-03-485
Sphere of Influence Amendment (removal)
to the Banning Library District

LAFCO 2012-04-486
&
Detachment from the Banning Library District
(Cabazon Library)



SECTION 20

T.2S.R.1E.

1 inch = 1,200 feet



See Sheet 30

SECTION 32

SECTION 29

BANNING CITY

NORTHERLY

SECTION 21

SECTION 23

BANNING LIBRARY DISTRICT

SECTION 21

SHEET 31 OF 34 SHEETS

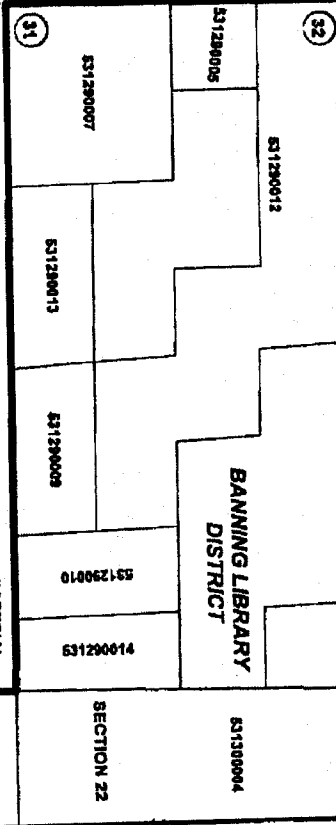

WESTERLY

NORTHERLY

Legend

- Banning Library District
- USGS Sections
- Assessor's Parcels
- City Boundary



2012-0459520
83/26/2012 12:15P
38 of 42

EXHIBIT "A"
LAFCO 2012-03-4&5
Sphere of Influence Amendment (removal)
to the Banning Library District
LAFCO 2012-04-4&5
Detachment from the Banning Library District
(Cabazon Library)

See Sheet 33 E31310012 SECTION 9 SHEET 32 OF 34 SHEETS E31320004
 E31310014 SECTION 10

12S.R.1E.
 inch = 1,300 feet



Legend

- Banning Library District
- USGS Section
- Assessor's Parcel
- City Boundary



BANNING CITY

(37) NORTHERLY

(38) NORTHERLY

(36) WESTERLY

(34) WESTERLY

(32) EASTERLY

(33) NORTHERLY

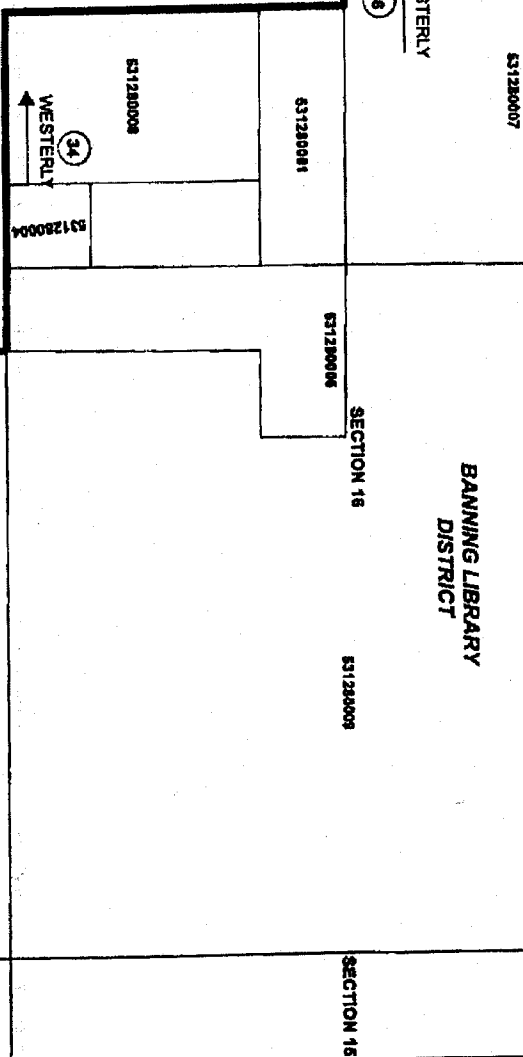

See Sheet 31

2012-0459520
 09/26/2012 12:15P
 40 of 42

EXHIBIT "A"
LAFCO 2012-03-485
 Sphere of Influence Amendment (removal)
 to the Banning Library District
 &
LAFCO 2012-04-485
 Detachment from the Banning Library
 District (Cabazon Library)

See Sheet 34

SHEET 33 OF 34 SHEETS

531328001
 N
 1 inch = 1,200 feet

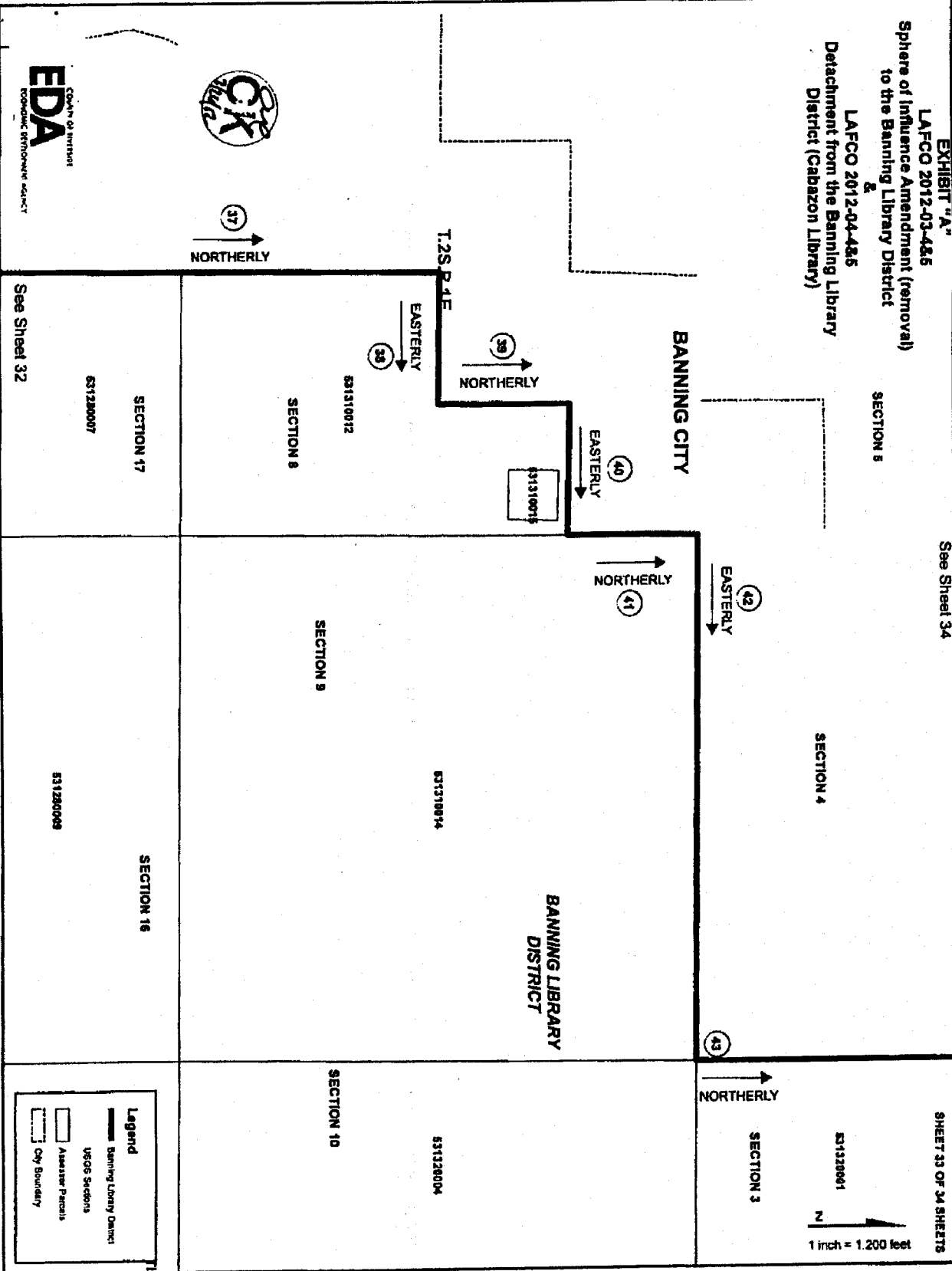

2012-0459520
 09/26/2012 12:15P
 41 of 42





EXHIBIT "A"
LAFCO 2012-03-486
 Sphere of Influence Amendment (removal) to the Banning Library District
LAFCO 2012-04-485
 Detachment from the Banning Library District (Cabazon Library)

SHEET 34 OF 34 SHEETS



1 inch = 1,200 feet

SAN BERNARDINO COUNTY
 RIVERSIDE COUNTY

SECTION 5
 T.2S.R.1E.

SECTION 4

BANNING CITY

SECTION 3 831328001

BANNING LIBRARY DISTRICT

P.O.B. ①

See Sheet 3



Legend

- Banning Library District
- USGS Section
- Assessor Parcel
- City Boundary

SECTIONS 8
 See Sheet 33

④
 NORTHERLY

④
 EASTERLY

④
 NORTHERLY

831310014

SECTION 9

SECTION 10

831320004



2012-0459520
 89/26/2012 12:15P
 42 of 42

RECORDING REQUESTED BY:
County of Riverside
Code Enforcement Department

AND WHEN RECORDED MAIL TO:
County of Riverside
Code Enforcement Department
581 South Grand Avenue
San Jacinto, California, 92582
Mail Stop #5002

DOC # 2013-0466414

09/26/2013 04:00P Fee:NC

Page 1 of 1

Recorded in Official Records
County of Riverside

Larry W. Ward
Assessor, County Clerk & Recorder



| S | R | U | PAGE | SIZE | DA | MISC | LONG | RFD | COPY |
|---------|---|---|------|------|------|------|------|------|----------|
| | | | | | | | | | |
| M | A | L | 465 | 426 | PCOR | NCOR | SMF | NCHG | EXAM 030 |
| NCHG CE | | | | | T: | CTY | UNI | | |

NOTICE OF PENDENCY OF ADMINISTRATIVE PROCEEDINGS

M 030

In the matter of the public or other code violation(s) on the property of:

RAYMOND L RUSSELL / R L RUSSELL)
and DOES 1 through X, Owners)

Case #: CV-1201015

NOTICE IS HEREBY GIVEN to all persons, pursuant to Section 14 of Ordinance Number 725 of the County of Riverside, State of California, that administrative proceedings have been commenced with respect to the structure or land located upon the following described real property in the County of Riverside:

ADDRESS: 1 lot south of 12892 Balsam Circle, SAN GORGONIO CA, 0

PARCEL #: 517-153-011

LEGAL DESCRIPTION: 0.25 acres in LOT 345 of SAN GORGONIO PASS 5, recorded in MB 34 page 43

VIOLATION(S): Riverside County Code (Ordinance) 8.120.010 (Ord. 541) that such proceedings are based upon the noncompliance of such structure or land with the requirements of Riverside County Codes (Ordinances) listed above; and that failure to comply with the lawful orders of the Code Enforcement Director and/or authorized agents of the County of Riverside heretofore and hereafter issued relative to the above matter may result in demolition of the offending structure, abatement of the public nuisance or other available legal remedies and assessment of the costs, expenses, and administrative costs thereof to the property heretofore described as a tax and special assessment lien on such property; that any purchaser, his heirs, or assigns acquiring said property subsequent to the recording of the Notice with the County Recorder shall have such interest subject and subordinate to said tax and assessment lien. Notice is Further Given in accordance with Sections 17274 and 24436.5 of the California Revenue and Taxation Code, that a tax deduction may not be allowed for interest, taxes, depreciation or amortization paid or incurred in the taxable year affected by these proceedings.

COUNTY OF RIVERSIDE CODE ENFORCEMENT DEPARTMENT

By: Brian Black
Brian Black, Code Enforcement Department

ACKNOWLEDGEMENT

State of California)
County of Riverside)SS

On 9/19/13 before me, Jamison D. Cole, Notary Public, personally appeared Brian Black who proved to me on the basis of satisfactory evidence to be the person(s) whose name(s) is/are subscribed to the within instrument and acknowledged to me that he/she/they executed the same in his/her/their authorized capacity(ies), and that by his/her/their signature(s) on the instrument the person(s), or the entity upon behalf of which the person(s) acted, executed the instrument.

I certify under PENALTY OF PERJURY under the laws of the State of California that the foregoing paragraph is true and correct.

WITNESS my hand and official seal.

Commission # 2018834 Expires: May 7, 2017

Signature: Jamison D Cole (Seal)

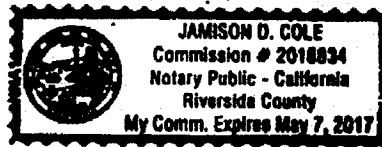

DOC # 2010-0062362

02/10/2010 08:00A Fee:NC

Page 1 of 1

Recorded in Official Records
County of Riverside

Larry W. Hard
Assessor, County Clerk & Recorder

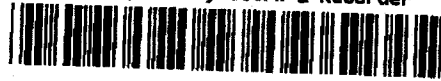

Please Record And Return To:
Lake Hemet Municipal Water District
P.O. Box 5039
Hemet, CA 92544-0039

**In the Matter of the Lien of
Lake Hemet Municipal Water District
Upon the Real Property of:**

| S | R | U | PAGE | SIZE | DA | MISC | LONG | RFD | COPY |
|---|---|---|------|------|------|------|------|------|------|
| | | | 1 | | | | | | |
| M | A | L | 465 | 426 | PCOR | NCOR | SMF | NCHG | EXAM |
| | | | | | | | | | 701 |

NAME: RUSSELL, Raymond
ADDRESS: 5461 Broderick
CITY, STATE: Hemet, CA 92544

C
701

◆ **STATEMENT OF LIEN** ◆

This is to certify, pursuant to Water Code Section 72102, that Lake Hemet Municipal Water District claims a lien upon all real property owned by the following named person within Riverside County, for delinquent charges, penalty and interest, in the amounts hereinafter set forth:

NAME: RUSSELL, Raymond
SERVICE ADDRESS: 5461 Broderick
Hemet, CA 92544

Amount of Delinquency: \$203.61
Late Penalty: \$ -0-
Processing fee: \$ 40.00
Total: \$253.61

I certify that the foregoing is true and correct.

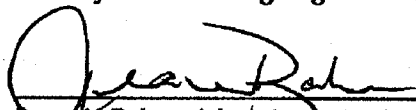
Jeanie Baker, Administrative Assistant
Lake Hemet Municipal Water District

Document Date: February 8, 2010
Account No: 8-8-86-2

EXHIBIT “D”



CODE ENFORCEMENT DEPARTMENT COUNTY OF RIVERSIDE

Greg Flannery
Code Enforcement
Official

CASE #: CV12-01015
A.P.N.: 517-153-011

PROPERTY SITUS: 1 lot S/O 12892 Balsam Circle, San Geronio
DRAWN ON: 9/16/14 DRAWN BY: D Jurden, CET

NORTH



PROPERTY LINE

P
R
O
P
E
R
T
Y

L
I
N
E

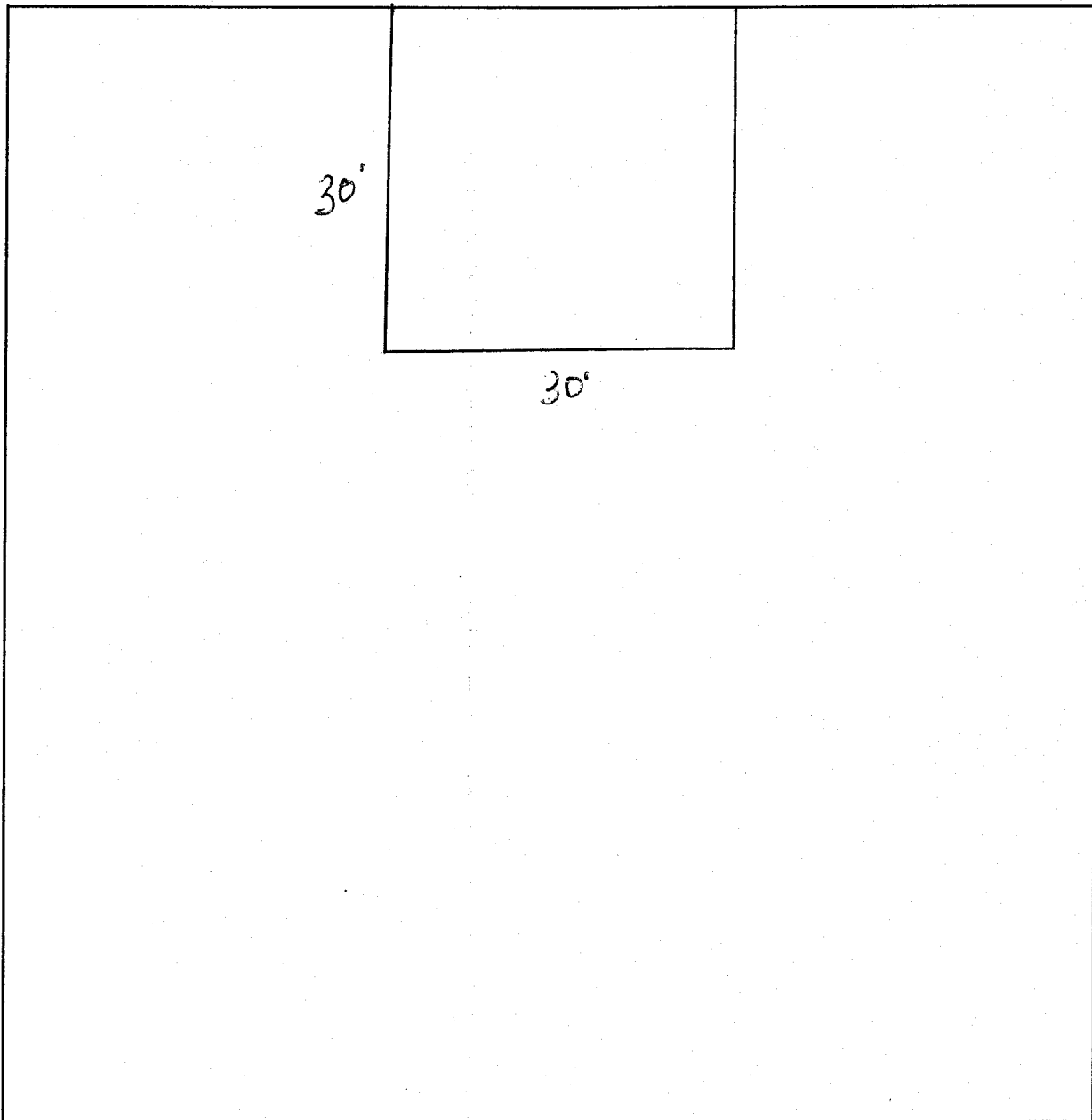

P
R
O
P
E
R
T
Y

L
I
N
E

PROPERTY LINE

4080 LEMON STREET, 12TH FLOOR, RIVERSIDE, CALIFORNIA 92501
(951) 955-2004 • FAX (951) 955-8680

Photographs



Initial - NOV - Hermanson



Initial - NOV - Hermanson



04/18/12 - Violation Remains - Citation Issued - Pike



04/18/12 - Violation Remains - Citation Issued -]



Property. J Chamberlain



Rubbish remains. J Chamberlain



Rubbish 9/9/13 J. Cole



Rubbish 9/9/13 J. Cole



Rubbish 9/9/13 J. Cole



Photo taken from the right of way D Jurden, CE



Photo taken from the right of way D Jurden, CET



Photo taken from the right of way D Jurden, CE



Photo taken from the right of way D Jurden, CET



Photo taken from the right of way D Jurden, CE



Photo taken from the right of way D Jurden, CET



Photo taken from the right of way D Jurden, CE



Photo taken from the right of way D Jurden, CET



Photo taken from the right of way D Jurden, CE



Photo taken from the right of way D Jurden, CET



Photo taken from the right of way D Jurden, CE



Photo taken from the right of way D Jurden, CET



Photo taken on the parcel D Jurden, CET



Photo taken on the parcel D Jurden, CET



Photo taken from the right of way D Jurden, CE



Photo taken of the posting D Jurden, CET



Photo taken from the right of way D Jurden, CE



Photo taken from the right of way D Jurden, CET

EXHIBIT “E”



**CODE ENFORCEMENT DEPARTMENT
COUNTY OF RIVERSIDE**

AFFIDAVIT OF POSTING OF NOTICES

September 23, 2014

RE CASE NO: CV1201015

I, Adam Hermanson, hereby declare:

I am employed by the Riverside County Code Enforcement Department; that my business address is:
77588 El Duna Court
Palm Desert CA 92211

That on 2/22/2012 at 1:16 pm, I securely and conspicuously posted Notice of Violation for Accumulated Rubbish (RCC 8.120.010) at the property described as:

Property Address: 1 lot south of 12892 Balsam Circle, SAN GORGONIO

Assessor's Parcel Number: 517-153-011

I declare under the penalty of perjury that the foregoing is true and correct.

Executed on September 23, 2014 in the County of Riverside, California.

CODE ENFORCEMENT DEPARTMENT

By: Adam Hermanson, Code Enforcement Officer



**CODE ENFORCEMENT DEPARTMENT
COUNTY OF RIVERSIDE**

NOTICE OF VIOLATION

August 27, 2014

RAYMOND L RUSSELL / R L RUSSELL
17115 RANCHERO RD
RIVERSIDE, CA 92504

RE CASE NO: CV1201015 at 1 lot south of 12892 Balsam Circle, in the community of SAN GORGONIO, California, Assessor's Parcel Number 517-153-011

NOTICE IS HEREBY GIVEN that property owned or controlled by you at 1 lot south of 12892 Balsam Circle, in the community of SAN GORGONIO California, Assessor's Parcel Number 517-153-011, is in violation of Section(s) RCC Section No. 8.120.010 (Ord. 541), of the Riverside County Code.

Said violation is described as:

- 1) 8.120.010 (Ord. 541) - No person or entity shall permit the accumulation of rubbish or other material, dangerous or injurious to the health and welfare of persons or the environment, on any real property in the unincorporated area of Riverside County owned by them or under their control.

YOU ARE HEREBY REQUIRED TO COMPLY with the provisions of the ordinance by:

- 1) Remove all rubbish and dispose of it in an approved, legal landfill.

COMPLIANCE MUST BE COMPLETED BY September 10, 2014. FAILURE TO COMPLY WILL RESULT IN LEGAL ACTION BEING BROUGHT AGAINST YOU.

NOTICE IS HEREBY GIVEN THAT AT THE CONCLUSION OF THIS CASE YOU WILL RECEIVE A SUMMARY OF ADMINISTRATIVE COSTS ASSOCIATED WITH THE PROCESSING OF SUCH VIOLATION(S), AT AN HOURLY RATE OF \$82.00 AS DETERMINED BY THE BOARD OF SUPERVISORS.

YOU WILL HAVE THE RIGHT TO OBJECT TO THESE CHARGES BY FILING A REQUEST FOR HEARING WITH THE DEPARTMENT OF CODE ENFORCEMENT WITHIN TEN (10) DAYS OF SERVICE OF THE SUMMARY OF CHARGES, PURSUANT TO SECTION 1.16.080 OF RIVERSIDE COUNTY CODE.

CODE ENFORCEMENT DEPARTMENT

By: David Jurden, Code Enforcement Technician



**CODE ENFORCEMENT DEPARTMENT
COUNTY OF RIVERSIDE**

NOTICE OF VIOLATION

August 27, 2014

Raymond L. Russell
17115 Rancho Rd.
Riverside, CA 92504

RE CASE NO: CV1201015 at 1 lot south of 12892 Balsam Circle, in the community of SAN GORGONIO, California, Assessor's Parcel Number 517-153-011

NOTICE IS HEREBY GIVEN that property owned or controlled by you at 1 lot south of 12892 Balsam Circle, in the community of SAN GORGONIO California, Assessor's Parcel Number 517-153-011, is in violation of Section(s) RCC Section No. 8.120.010 (Ord. 541), of the Riverside County Code.

Said violation is described as:

- 1) 8.120.010 (Ord. 541) - No person or entity shall permit the accumulation of rubbish or other material, dangerous or injurious to the health and welfare of persons or the environment, on any real property in the unincorporated area of Riverside County owned by them or under their control.

YOU ARE HEREBY REQUIRED TO COMPLY with the provisions of the ordinance by:

- 1) Remove all rubbish and dispose of it in an approved, legal landfill.

COMPLIANCE MUST BE COMPLETED BY September 10, 2014. FAILURE TO COMPLY WILL RESULT IN LEGAL ACTION BEING BROUGHT AGAINST YOU.

NOTICE IS HEREBY GIVEN THAT AT THE CONCLUSION OF THIS CASE YOU WILL RECEIVE A SUMMARY OF ADMINISTRATIVE COSTS ASSOCIATED WITH THE PROCESSING OF SUCH VIOLATION(S), AT AN HOURLY RATE OF \$82.00 AS DETERMINED BY THE BOARD OF SUPERVISORS.

YOU WILL HAVE THE RIGHT TO OBJECT TO THESE CHARGES BY FILING A REQUEST FOR HEARING WITH THE DEPARTMENT OF CODE ENFORCEMENT WITHIN TEN (10) DAYS OF SERVICE OF THE SUMMARY OF CHARGES, PURSUANT TO SECTION 1.16.080 OF RIVERSIDE COUNTY CODE.

CODE ENFORCEMENT DEPARTMENT

By: David Jurden, Code Enforcement Technician



**CODE ENFORCEMENT DEPARTMENT
COUNTY OF RIVERSIDE**

NOTICE OF VIOLATION

August 27, 2014

RAYMOND L. RUSSELL, Jr.
RAYMOND L. RUSSELL, III
132 W. ADAMS STREET
SOMERVILLE, MA 02144

RE CASE NO: CV1201015 at 1 lot south of 12892 Balsam Circle, in the community of SAN GORGONIO, California, Assessor's Parcel Number 517-153-011

NOTICE IS HEREBY GIVEN that property owned or controlled by you at 1 lot south of 12892 Balsam Circle, in the community of SAN GORGONIO California, Assessor's Parcel Number 517-153-011, is in violation of Section(s) RCC Section No. 8.120.010 (Ord. 541), of the Riverside County Code.

Said violation is described as:

- 1) 8.120.010 (Ord. 541) - No person or entity shall permit the accumulation of rubbish or other material, dangerous or injurious to the health and welfare of persons or the environment, on any real property in the unincorporated area of Riverside County owned by them or under their control.

YOU ARE HEREBY REQUIRED TO COMPLY with the provisions of the ordinance by:

- 1) Remove all rubbish and dispose of it in an approved, legal landfill.

COMPLIANCE MUST BE COMPLETED BY September 10, 2014. FAILURE TO COMPLY WILL RESULT IN LEGAL ACTION BEING BROUGHT AGAINST YOU.

NOTICE IS HEREBY GIVEN THAT AT THE CONCLUSION OF THIS CASE YOU WILL RECEIVE A SUMMARY OF ADMINISTRATIVE COSTS ASSOCIATED WITH THE PROCESSING OF SUCH VIOLATION(S), AT AN HOURLY RATE OF \$82.00 AS DETERMINED BY THE BOARD OF SUPERVISORS.

YOU WILL HAVE THE RIGHT TO OBJECT TO THESE CHARGES BY FILING A REQUEST FOR HEARING WITH THE DEPARTMENT OF CODE ENFORCEMENT WITHIN TEN (10) DAYS OF SERVICE OF THE SUMMARY OF CHARGES, PURSUANT TO SECTION 1.16.080 OF RIVERSIDE COUNTY CODE.

CODE ENFORCEMENT DEPARTMENT

By: David Jurden, Code Enforcement Technician



**CODE ENFORCEMENT DEPARTMENT
COUNTY OF RIVERSIDE**

PROOF OF SERVICE

Case No. CV1201015

STATE OF CALIFORNIA, COUNTY OF RIVERSIDE

I, Carol Lucero, declare that I am a citizen of the United States and am employed in the County of Riverside, over the age of 18 years and not a party to the within action or proceeding; that my business address is at the footer of this notice.

That on August 27, 2014, I served the following documents(s):

Notice of Violation

by placing a true copy thereof enclosed in a sealed envelope(s) by **CERTIFIED MAIL, RETURN RECEIPT REQUESTED** addressed as follows:

RAYMOND L RUSSELL / R L RUSSELL 17115 RANCHERO RD, RIVERSIDE, CA 92504

Raymond L. Russell 17115 Ranchero Rd., Riverside, CA 92504

RAYMOND L. RUSSELL, Jr. RAYMOND L. RUSSELL, III 132 W. ADAMS STREET, SOMERVILLE, MA 02144

XX **By First Class Mail.** I am readily familiar with the office's practice of collection and processing correspondence for mailing. Under that practice it would be deposited with the U.S. Postal Service with postage thereon fully prepaid in the County of Riverside, California, in the ordinary course of business.

XX **STATE.** I declare under the penalty of perjury under the laws of the State of California that the above is true and correct.

EXECUTED ON August 27, 2014, in the County of Riverside, California.

CODE ENFORCEMENT DEPARTMENT

Carol Lucero

By: Carol Lucero, Code Enforcement Technician

| SENDER: COMPLETE THIS SECTION | | COMPLETE THIS SECTION ON DELIVERY | |
|--|--|--|--|
| <ul style="list-style-type: none"> Complete items 1, 2, and 3. Also complete item 4 if Restricted Delivery is desired. Print your name and address on the reverse so that we can return the card to you. Attach this card to the back of the mailpiece, or on the front if space permits. | | A. Signature X <i>Raymond Russell</i> | |
| 1. Article Addressed to: <div style="border: 1px solid black; padding: 5px;"> RAYMOND L RUSSELL R L RUSSELL 17115 RANCHERO RD RIVERSIDE, CA 92504 CV12-01015 DJ 517 </div> | | B. Received by (Printed Name) C. Date of Delivery <i>9/2/14</i> | |
| | | D. Is delivery address different from Item 1? <input type="checkbox"/> Yes If YES, enter delivery address below: <input type="checkbox"/> No | |
| | | 3. Service Type <input checked="" type="checkbox"/> Certified Mail <input type="checkbox"/> Express Mail <input type="checkbox"/> Registered <input checked="" type="checkbox"/> Return Receipt for Merchandise <input type="checkbox"/> Insured Mail <input type="checkbox"/> C.O.D. | |
| 2. Article Number (Transfer from serv) | | 4. Restricted Delivery? (Extra Fee) <input type="checkbox"/> Yes | |
| 7010 0290 0000 7228 8211 | | | |
| PS Form 3811, February 2004 | | Domestic Return Receipt | |
| | | 102595-02-M-1540 | |

RECEIVED

BY: SEP 02 2014

7010 0290 0000 7228 8211

U.S. Postal Service™
CERTIFIED MAIL™ RECEIPT
(Domestic Mail Only; No Insurance Coverage Provided)

For delivery information visit our website at www.usps.com

OFFICIAL USE

| | | |
|---|----|------------------|
| Postage | \$ | Postmark Here |
| Certified Fee | | |
| Return Receipt Fee (Endorsement Required) | | |
| Restricted Delivery Fee (Endorsement Required) | | |
| Total Pc | | |

| | |
|-----------------------------|---------------------|
| <i>Sent To</i> | RAYMOND L RUSSELL |
| | R L RUSSELL |
| <i>Street, Ap or PO Box</i> | 17115 RANCHERO RD |
| <i>City, State</i> | RIVERSIDE, CA 92504 |
| | CV12-01015 DJ 517 |

PS Form 3800, August 2006 See Reverse for Instructions

| SENDER: COMPLETE THIS SECTION | COMPLETE THIS SECTION ON DELIVERY |
|--|---|
| <p>■ Complete items 1, 2, and 3. Also complete item 4 if Restricted Delivery is desired.</p> <p>■ Print your name and address on the reverse so that we can return the card to you.</p> <p>■ Attach this card to the back of the mailpiece or on the front if space permits.</p> <p>1. Article Addressed to:</p> <p>Raymond L. Russell 17115 Ranchero Rd. Riverside, CA 92504 CV12-01015 DJ 517</p> | <p>A. Signature <i>x Raymond Russell</i> <input type="checkbox"/> Agent <input type="checkbox"/> Addressee</p> <p>B. Received by (Printed Name) _____ C. Date of Delivery 9/29</p> <p>D. Is delivery address different from item 1? <input type="checkbox"/> Yes If YES, enter delivery address below: <input type="checkbox"/> No</p> <p>3. Service Type <input checked="" type="checkbox"/> Certified Mail <input type="checkbox"/> Express Mail <input type="checkbox"/> Registered <input checked="" type="checkbox"/> Return Receipt for Merchandise <input type="checkbox"/> Insured Mail <input type="checkbox"/> C.O.D.</p> <p>4. Restricted Delivery? (Extra Fee) <input type="checkbox"/> Yes</p> |
| <p>2. Article Number (Transfer from service label)</p> | <p>7010 0290 0000 7228 8228</p> |
| <p>PS Form 3811, February 2004 Domestic Return Receipt 102595-02-M-1540</p> | |

RECEIVED
BY: SEP 02 2004

| U.S. Postal Service™ CERTIFIED MAIL™ RECEIPT (Domestic Mail Only; No Insurance Coverage Provided) | | | | | | | | | | | |
|--|---------------------|----|---------------|--------------------|--|--------------------|---|---------------------|------------------|-------------------|------------------------------|
| For delivery information visit our website at www.usps.com | | | | | | | | | | | |
| OFFICIAL USE | | | | | | | | | | | |
| <table border="1"> <tr><td>Postage</td><td>\$</td></tr> <tr><td>Certified Fee</td><td></td></tr> <tr><td>Return Receipt Fee (Endorsement Required)</td><td></td></tr> <tr><td>Restricted Delivery Fee (Endorsement Required)</td><td></td></tr> </table> | Postage | \$ | Certified Fee | | Return Receipt Fee (Endorsement Required) | | Restricted Delivery Fee (Endorsement Required) | | Postmark Here | | |
| Postage | \$ | | | | | | | | | | |
| Certified Fee | | | | | | | | | | | |
| Return Receipt Fee (Endorsement Required) | | | | | | | | | | | |
| Restricted Delivery Fee (Endorsement Required) | | | | | | | | | | | |
| <table border="1"> <tr><td>1</td><td></td></tr> <tr><td>Se</td><td>Raymond L. Russell</td></tr> <tr><td>St</td><td>17115 Ranchero Rd.</td></tr> <tr><td>or</td><td>Riverside, CA 92504</td></tr> <tr><td>Ci</td><td>CV12-01015 DJ 517</td></tr> </table> | 1 | | Se | Raymond L. Russell | St | 17115 Ranchero Rd. | or | Riverside, CA 92504 | Ci | CV12-01015 DJ 517 | See Reverse for Instructions |
| 1 | | | | | | | | | | | |
| Se | Raymond L. Russell | | | | | | | | | | |
| St | 17115 Ranchero Rd. | | | | | | | | | | |
| or | Riverside, CA 92504 | | | | | | | | | | |
| Ci | CV12-01015 DJ 517 | | | | | | | | | | |

7010 0290 0000 7228 8228

English

Customer Service

USPS Mobile

Register / Sign In



Search USPS.com or Track Packages [Subr](#)

Quick Tools

Ship a Package

Send Mail

Manage Your Mail

Shop

Business Solutions

USPS Tracking™



[Customer Service >](#)
Have questions? We're here to help.

Tracking Number: 7010029000072288235

Product & Tracking Information

Postal Product:

Features:
Certified Mail™

Available Actions

[Text Updates](#)

[Email Updates](#)

| DATE & TIME | STATUS OF ITEM | LOCATION |
|---|---|--------------------------|
| September 23, 2014 , 5:57 pm | Arrived at USPS Facility | SHREWSBURY, MA 01546 |
| <p>Your item arrived at our USPS facility in SHREWSBURY, MA 01546 on September 23, 2014 at 5:57 pm. The item is currently in transit to the destination. Information, if available, is updated periodically throughout the day. Please check again later.</p> | | |
| September 18, 2014 , 9:15 am | Unclaimed | SOMERVILLE, MA 02144 |
| August 30, 2014 , 1:55 pm | Notice Left (No Authorized Recipient Available) | SOMERVILLE, MA 02144 |
| August 30, 2014 , 9:00 am | Out for Delivery | CHELSEA, MA 02150 |
| August 30, 2014 , 8:50 am | Sorting Complete | CHELSEA, MA 02150 |
| August 30, 2014 , 5:33 am | Arrived at Unit | CHELSEA, MA 02150 |
| August 30, 2014 , 2:49 am | Departed USPS Facility | BOSTON, MA 02205 |
| August 29, 2014 , 4:37 pm | Arrived at USPS Facility | BOSTON, MA 02205 |
| August 27, 2014 , 10:18 pm | Departed USPS Facility | SAN BERNARDINO, CA 92403 |
| August 27, 2014 , 7:24 pm | Arrived at USPS Facility | SAN BERNARDINO, CA 92403 |

Track Another Package

Tracking (or receipt) number

[Track It](#)

LEGAL

- [Privacy Policy >](#)
- [Terms of Use >](#)
- [FOIA >](#)
- [No FEAR Act EEO Data >](#)

ON USPS.COM

- [Government Services >](#)
- [Buy Stamps & Shop >](#)
- [Print a Label with Postage >](#)
- [Customer Service >](#)
- [Delivering Solutions to the Last Mile >](#)

ON ABOUT.USPS.COM

- [About USPS Home >](#)
- [Newsroom >](#)
- [USPS Service Alerts >](#)
- [Forms & Publications >](#)
- [Careers >](#)

OTHER USPS SITES

- [Business Customer Gateway >](#)
- [Postal Inspectors >](#)
- [Inspector General >](#)
- [Postal Explorer >](#)
- [National Postal Museum >](#)

U.S. Postal Service™
CERTIFIED MAIL™ RECEIPT
(Domestic Mail Only; No Insurance Coverage Provided)

For delivery information visit our website at www.usps.com®

OFFICIAL USE

7010 0290 0000 7228 8235

| | |
|---|----|
| Postage | \$ |
| Certified Fee | |
| Return Receipt Fee (Endorsement Required) | |
| Restricted Delivery Fee (Endorsement Required) | |

Postmark
Here

To

| | |
|-------------------|-------------------------|
| Send | RAYMOND L. RUSSELL, Jr. |
| Street or P.O. | RAYMOND L. RUSSELL, III |
| City | 132 W. ADAMS STREET |
| | SOMERVILLE, MA 02144 |
| PS F | CV12-01015 DJ 517 |

Reverse for Instructions



**CODE ENFORCEMENT DEPARTMENT
COUNTY OF RIVERSIDE**

Greg Flannery
Code
Enforcement
Official

AFFIDAVIT OF POSTING OF NOTICES

Case No.: CV12-01015

I, David Jurden, hereby declare:

1. I am employed by the Riverside County Code Enforcement Department; that my business address is:

County of Riverside
Code Enforcement Department
581 S. Grand Avenue
San Jacinto, CA 92582

2. That on **August 28, 2014 at 1220 PM**, I securely and conspicuously posted the **Notice of Violation (RCC 8.120.010) Accumulated Rubbish** at the property described as:

Property Address: 1 lot S/O 12892 Balsam Circle, San Gorgonio

Assessor's Parcel Number: 517-153-011

I declare under the penalty of perjury that the foregoing is true and correct.

Executed on **August 28, 2014** at San Jacinto, California.

CODE ENFORCEMENT DEPARTMENT

By: 

David Jurden, Code Enforcement Technician



**CODE ENFORCEMENT DEPARTMENT
COUNTY OF RIVERSIDE**

NOTICE OF VIOLATION

November 19, 2014

LAKE EHEMET MUNICIPAL WATER DISTRICT
P.O. BOX 5039
HEMET, CA 92544-0039

RE CASE NO: CV1201015 at 1 lot south of 12892 Balsam Circle, in the community of SAN GORGONIO, California,
Assessor's Parcel Number 517-153-011

NOTICE IS HEREBY GIVEN that property owned or controlled by you at 1 lot south of 12892 Balsam Circle, in the community of SAN GORGONIO California, Assessor's Parcel Number 517-153-011, is in violation of Section(s) RCC Section No. 8.120.010 (Ord. 541), of the Riverside County Code.

Said violation is described as:

- 1) 8.120.010 (Ord. 541) - No person or entity shall permit the accumulation of rubbish or other material, dangerous or injurious to the health and welfare of persons or the environment, on any real property in the unincorporated area of Riverside County owned by them or under their control.

YOU ARE HEREBY REQUIRED TO COMPLY with the provisions of the ordinance by:

- 1) Remove all rubbish and dispose of it in an approved, legal landfill.

COMPLIANCE MUST BE COMPLETED BY December 3, 2014. FAILURE TO COMPLY WILL RESULT IN LEGAL ACTION BEING BROUGHT AGAINST YOU.

NOTICE IS HEREBY GIVEN THAT AT THE CONCLUSION OF THIS CASE YOU WILL RECEIVE A SUMMARY OF ADMINISTRATIVE COSTS ASSOCIATED WITH THE PROCESSING OF SUCH VIOLATION(S), AT AN HOURLY RATE OF \$82.00 AS DETERMINED BY THE BOARD OF SUPERVISORS.

YOU WILL HAVE THE RIGHT TO OBJECT TO THESE CHARGES BY FILING A REQUEST FOR HEARING WITH THE DEPARTMENT OF CODE ENFORCEMENT WITHIN TEN (10) DAYS OF SERVICE OF THE SUMMARY OF CHARGES, PURSUANT TO SECTION 1.16.080 OF RIVERSIDE COUNTY CODE.

CODE ENFORCEMENT DEPARTMENT

By: David Jurden, Code Enforcement Technician

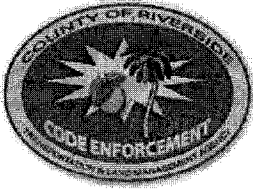

**CODE ENFORCEMENT DEPARTMENT
COUNTY OF RIVERSIDE**

PROOF OF SERVICE

Case No. CV1201015

STATE OF CALIFORNIA, COUNTY OF RIVERSIDE

I, Dean Deines, declare that I am a citizen of the United States and am employed in the County of Riverside, over the age of 18 years and not a party to the within action or proceeding; that my business address is at the footer of this notice.

That on November 19, 2014, I served the following document(s):

Notice of Violation

by placing a true copy thereof enclosed in a sealed envelope(s) by **CERTIFIED MAIL, RETURN RECEIPT REQUESTED** addressed as follows:

LAKE HEMET MUNICIPAL WATER DISTRICT P.O. BOX 5039, HEMET, CA 92544-0039

XX **By First Class Mail.** I am readily familiar with the office's practice of collection and processing correspondence for mailing. Under that practice it would be deposited with the U.S. Postal Service with postage thereon fully prepaid in the County of Riverside, California, in the ordinary course of business.

XX **STATE.** I declare under the penalty of perjury under the laws of the State of California that the above is true and correct.

EXECUTED ON November 19, 2014, in the County of Riverside, California.

CODE ENFORCEMENT DEPARTMENT

Dean Deines
By: Dean Deines, Sr. Accounting Assistant

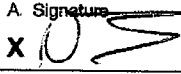
| SENDER: COMPLETE THIS SECTION | COMPLETE THIS SECTION ON DELIVERY |
|--|---|
| <ul style="list-style-type: none"> Complete items 1, 2, and 3. Also complete item 4 if Restricted Delivery is desired. Print your name and address on the reverse so that we can return the card to you. Attach this card to the back of the mailpiece, or on the front if space permits. | <p>A. Signature <u>X</u>  <input type="checkbox"/> Agent <input checked="" type="checkbox"/> Addressee</p> <p>B. Received by (Printed Name) <u>Noah Bischof</u> C. Date of Delivery <u>11-20-14</u></p> |
| <p>1. Article Addressed to:</p> | <p>D. Is delivery address different from item 1? <input type="checkbox"/> Yes <input checked="" type="checkbox"/> No If YES, enter delivery address below:</p> |
| <p>LAKE EHEMET MUNICIPAL WATER DISTRICT P.O. BOX 5039 HEMET, CA 92544-0039</p> | |
| <p>2. Article Number (Transfer from service label) <u>7009 2250 0001 9035 6304</u></p> <p><input type="checkbox"/> Restricted Delivery? (Extra Fee) <input type="checkbox"/> Yes</p> | |
| <p>PS Form 3811, February 2004 Domestic Return Receipt 102595-02-M-1540</p> | |

U.S. Postal Service™
CERTIFIED MAIL™ RECEIPT
(Domestic Mail Only; No Insurance Coverage Provided)

For delivery information visit our website at www.usps.com

OFFICIAL USE

| | |
|--|------------------|
| Postage \$ | Postmark Here |
| Certified Fee | |
| Return Receipt Fee (Endorsement Required) | |

LAKE EHEMET MUNICIPAL WATER DISTRICT
P.O. BOX 5039
HEMET, CA 92544-0039

City, State, ZIP+4

PS Form 3800, August 2006 See Reverse for Instructions

7009 2250 0001 9035 6304



**CODE ENFORCEMENT DEPARTMENT
COUNTY OF RIVERSIDE**

Greg Flannery
Code
Enforcement
Official

AFFIDAVIT OF POSTING OF NOTICES

Case No.: CV12-01015

I, David Jurden, hereby declare:

1. I am employed by the Riverside County Code Enforcement Department; that my business address is:

County of Riverside
Code Enforcement Department
581 S. Grand Avenue
San Jacinto, CA 92582

2. That on **November 19, 2014 at 1034 AM**, I securely and conspicuously posted the **Notice of Violation (RCC 8.120.010) Accumulated Rubbish** at the property described as:

Property Address: 1 parcel S/O 12892 Balsam Circle, San Geronimo

Assessor's Parcel Number: 517-153-011

I declare under the penalty of perjury that the foregoing is true and correct.

Executed on **November 19, 2014** at San Jacinto, California.

CODE ENFORCEMENT DEPARTMENT

By: 

David Jurden, Code Enforcement Technician

EXHIBIT “F”

DOC # 2013-0466414

09/26/2013 04:00P Fee:NC

Page 1 of 1

Recorded in Official Records

County of Riverside

Larry W. Ward

Assessor, County Clerk & Recorder

RECORDING REQUESTED BY:
County of Riverside
Code Enforcement Department

AND WHEN RECORDED MAIL TO:
County of Riverside
Code Enforcement Department
581 South Grand Avenue
San Jacinto, California, 92582
Mail Stop #5002



| S | R | U | PAGE | SIZE | DA | MISC | LONG | RFD | COPY |
|---------|---|---|------|------|------|------|------|------|----------|
| \ | | | \ | | | | | | |
| M | A | L | 465 | 426 | PCOR | NCOR | SMF | NCHG | EXAM 030 |
| NCHG CC | | | | | | T: | CTY | UNI | |

NOTICE OF PENDENCY OF ADMINISTRATIVE PROCEEDINGS

M 030

In the matter of the public or other code violation(s) on the property of:

Case #: CV-1201015

RAYMOND L RUSSELL / R L RUSSELL)

and DOES I through X, Owners)

NOTICE IS HEREBY GIVEN to all persons, pursuant to Section 14 of Ordinance Number 725 of the County of Riverside, State of California, that administrative proceedings have been commenced with respect to the structure or land located upon the following described real property in the County of Riverside:

ADDRESS: 1 lot south of 12892 Balsam Circle, SAN GORGONIO CA, 0

PARCEL #: 517-153-011

LEGAL DESCRIPTION: 0.25 acres in LOT 345 of SAN GORGONIO PASS 5, recorded in MB 34 page 43

VIOLATION(S): Riverside County Code (Ordinance) 8.120.010 (Ord. 541) that such proceedings are based upon the noncompliance of such structure or land with the requirements of Riverside County Codes (Ordinances) listed above; and that failure to comply with the lawful orders of the Code Enforcement Director and/or authorized agents of the County of Riverside heretofore and hereafter issued relative to the above matter may result in demolition of the offending structure, abatement of the public nuisance or other available legal remedies and assessment of the costs, expenses, and administrative costs thereof to the property heretofore described as a tax and special assessment lien on such property; that any purchaser, his heirs, or assigns acquiring said property subsequent to the recording of the Notice with the County Recorder shall have such interest subject and subordinate to said tax and assessment lien. **Notice is Further Given** in accordance with Sections 17274 and 24436.5 of the California Revenue and Taxation Code, that a tax deduction may not be allowed for interest, taxes, depreciation or amortization paid or incurred in the taxable year affected by these proceedings.

COUNTY OF RIVERSIDE CODE ENFORCEMENT DEPARTMENT

By: Brian Black
Brian Black, Code Enforcement Department

ACKNOWLEDGEMENT

State of California)
County of Riverside)SS

On 9/19/13 before me, Jamison D. Cole, Notary Public, personally appeared Brian Black who proved to me on the basis of satisfactory evidence to be the person(s) whose name(s) is/are subscribed to the within instrument and acknowledged to me that he/she/they executed the same in his/her/their authorized capacity(ies), and that by his/her/their signature(s) on the instrument the person(s), or the entity upon behalf of which the person(s) acted, executed the instrument.

I certify under PENALTY OF PERJURY under the laws of the State of California that the foregoing paragraph is true and correct.

WITNESS my hand and official seal.

Commission # 2018834 Expires: May 7, 2017

Signature: Jamison D Cole (Seal)

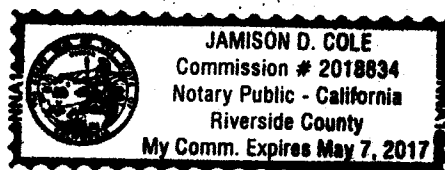

EXHIBIT “G”



**CODE ENFORCEMENT DEPARTMENT
COUNTY OF RIVERSIDE**

Greg Flannery
Code Enforcement Official

January 9, 2015

**RESCHEDULED
NOTICE TO CORRECT COUNTY ORDINANCE VIOLATIONS
AND ABATE PUBLIC NUISANCE**

TO: Owners and Interested Parties
(See Attached Proof of Service
and Responsible Party)

Case No.: CV12-01015
APN: 517-153-011
Property: 1 Lot South of 12892 Balsam Circle, San Geronio

NOTICE IS HEREBY GIVEN that a hearing will be held before the Riverside County Board of Supervisors pursuant to Riverside County Ordinance ("RCO") Nos. 541 and 725 to consider the accumulation of rubbish located on the SUBJECT PROPERTY described as 1 Lot South of 12892 Balsam Circle, San Geronio, Riverside County, California, and more particularly described as Assessor's Parcel Number 517-153-011.

YOU ARE HEREBY DIRECTED as owners of the SUBJECT PROPERTY, to appear at this hearing to show cause why the SUBJECT PROPERTY should not be declared a public nuisance and be abated by removing the violations from the real property.

SAID HEARING originally scheduled for Tuesday, February 24, 2015, is being **rescheduled for Tuesday, March 24, 2015** at **9:30 a.m.** in the Board of Supervisors Room, County Administrative Center, 4080 Lemon Street, 1st Floor Annex, Riverside, California at which time and place pertinent evidence will be received and/or testimony from all concerned parties will be heard. Failure to appear on your behalf will result in the exclusion of your testimony, and facts as known to the Code Enforcement Department ("Department") will be presented to the Board of Supervisors for consideration and deliberation in this matter.

Please be advised that the costs already accrued in this case, including but not limited to, enforcement and investigation costs, are recoverable by the Department, as allowed under RCO No. 725. The Department may seek recovery of such costs from the property owner(s) which may result in a special assessment lien against the SUBJECT PROPERTY. Additionally, should the Department abate the property, the costs associated therewith, as well as all abatement costs allowed under RCO No. 725, will be sought from the property owner(s) and/or may result in a special assessment lien against the property.

We encourage you to contact Code Enforcement at (951) 955-2004 upon receipt of this Notice to discuss the case and attempt to reach a resolution prior to the hearing. If you plan to attend the hearing, please check-in with Code Enforcement staff at 8:30 a.m. on the day of the hearing in the lobby of the first floor annex in front of the Clerk of the Board's Office.

GREG FLANNERY
CODE ENFORCEMENT OFFICIAL

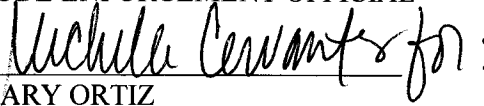

MARY ORTIZ
Supervising Code Enforcement Officer

NOTICE LIST

Subject Property: 1 Lot South of 12892 Balsam Circle, San Geronio;

Case No.: CV12-01015

APN: 517-153-011; District 5

RAYMOND L. RUSSELL
R.L. RUSSELL
17115 RANCHERO ROAD
RIVERSIDE, CA 92504

LAKE HEMET
MUNICIPAL WATER DISTRICT
P.O. BOX 5039
HEMET, CA 92544-0039

1 **PROOF OF SERVICE**

2 Case No. CV12-01015

3 STATE OF CALIFORNIA, COUNTY OF RIVERSIDE

4 I, Sue Jimenez, the undersigned, declare that I am a citizen of the United States and am employed in
5 the County of Riverside, over the age of 18 years and not a party to the within action or proceeding;
6 that my business address is 4080 Lemon Street, 12th Floor, Riverside, California 92501.

7 That on February 6, 2015, I served the following document(s):

- 8 • **RESCHEDULED NOTICE TO CORRECT COUNTY ORDINANCE VIOLATIONS AND ABATE PUBLIC NUISANCE**
- 9 • **NOTICE LIST**

10 by placing a true copy thereof enclosed in a sealed envelope(s) addressed as follows:

11 **OWNERS OR INTERESTED PARTIES**
12 **(SEE ATTACHED NOTICE LIST)**

13 XX **BY FIRST CLASS MAIL.** I am "readily familiar" with the office's practice of collection
14 and processing correspondence for mailing. Under that practice it would be deposited with
15 the U.S. Postal Service on that same day with postage thereon fully prepaid at Riverside,
16 California, in the ordinary course of business.

16 — **BY PERSONAL SERVICE:** I caused to be delivered such envelope(s) by hand to the offices
17 of the addressee(s).

18 XX **STATE - I declare under penalty of perjury under the laws of the State of California that the**
19 **above is true and correct.**

19 — **FEDERAL - I declare that I am employed in the office of a member of the bar of this court at**
20 **whose direction the service was made.**

21 EXECUTED ON February 6, 2015, at Riverside, California.

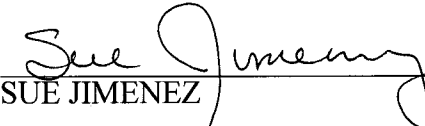
22 
23 SUE JIMENEZ

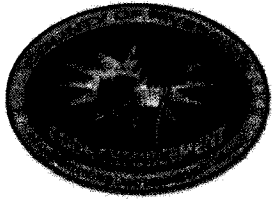

**CODE ENFORCEMENT DEPARTMENT
COUNTY OF RIVERSIDE**

AFFIDAVIT OF POSTING OF NOTICES

February 11, 2015

RE CASE NO: CV1201015

I, Edward Torres, hereby declare:

I am employed by the Riverside County Code Enforcement Department; that my business address is:

581 South Grand Avenue
San Jacinto, California, 92582
Mail Stop #5002.

That on 2/11/2015 at 1150 hours, I securely and conspicuously posted Rescheduled Notice to Correct County Ordinance Violations and Abate Public Nuisance at the property described as:

Property Address: 1 lot south of 12892 Balsam Circle, SAN GORGONIO

Assessor's Parcel Number: 517-153-011

I declare under the penalty of perjury that the foregoing is true and correct.

Executed on February 11, 2015 in the County of Riverside, California.

CODE ENFORCEMENT DEPARTMENT

A handwritten signature in black ink, appearing to read 'E. Torres', is written over a horizontal line.

By: Edward Torres, Code Enforcement Officer