

HOMELAND MDP LINE 1, STAGE 1

TEMPORARY TRAFFIC CONTROL PLANS: BRIGGS ROAD - PHASE 13

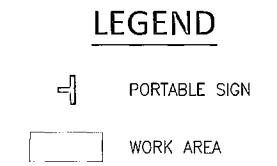
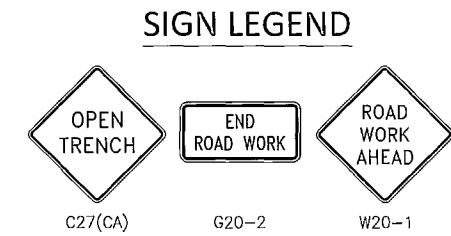
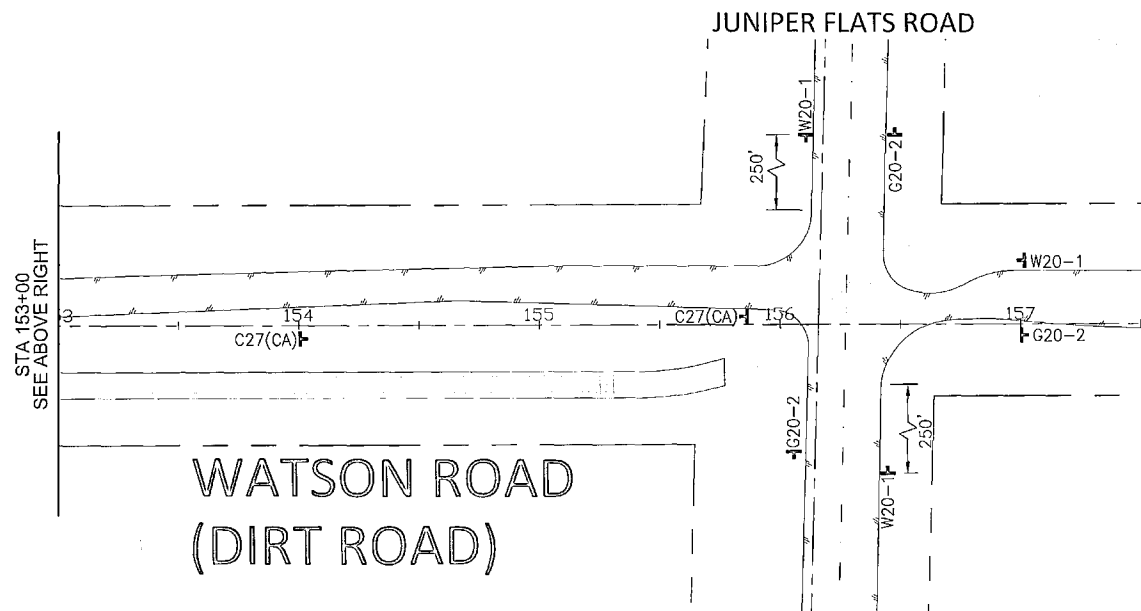
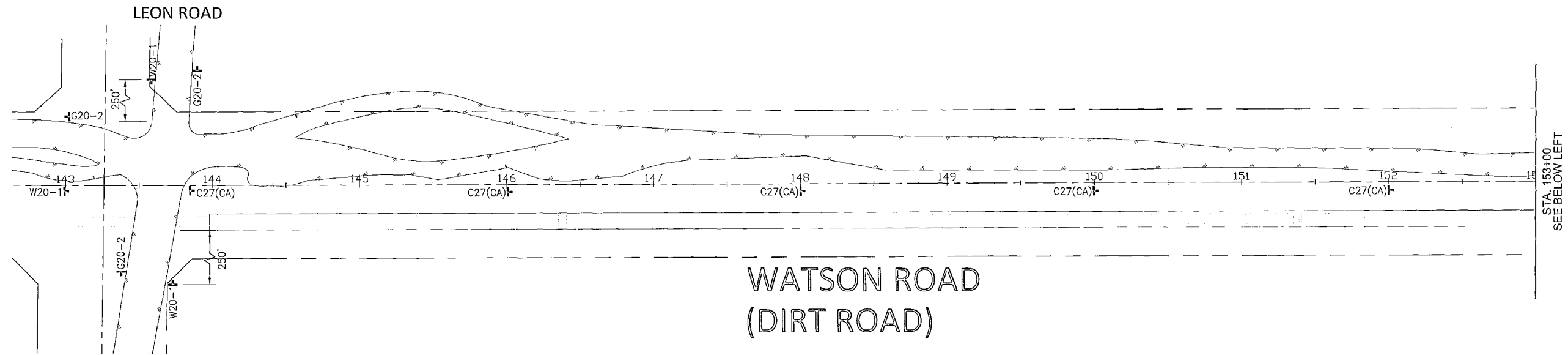

Don't Dig...Until You Call U.S.A. Toll Free
1-800-227-2600
for the location of buried utility lines.
Don't disrupt vital services.
TWO WORKING DAYS BEFORE YOU DIG

BENCHMARK
B.M. NO. S 327-1935
3.9 MI. NW FROM WINCHESTER
AND SANTA FE RAILWAY FROM THE STATION
AT WINCHESTER, RIVERSIDE COUNTY, AT
MONTICUE SIDING, 193 YRDS. NW OF THE SE
SWITCH STAND, 72 FT. E. OF MILEPOST 6,
16.5 FT. NE OF THE CENTERLINE OF THE TRACK,
AND 4.5 FT. NW OF THE STATION SIGN. A
STANDARD DOW, STAMPED R 327 1935 AND SET
IN THE TOP OF A CONCRETE POST.

REF.	DESCRIPTION	APPR.	DATE	APPR.	DATE

DESIGNED BY:
DRAWN BY:
DATE DRAWN:

APPROVED BY:
ALBERT A. WEBB
ENGINEERING CONSULTANTS
3788 McCRAY STREET
RIVERSIDE CA, 92506
PH. (951) 686-1070
FAX (951) 788-1256
Dilesh Sheth
DILESH SHETH, RCE #65078
DATE: 5/29/15



RIVERSIDE COUNTY FLOOD CONTROL AND WATER CONSERVATION DISTRICT
RECOMMENDED FOR APPROVAL BY: *Alfred S. Singsis*
DATE: 7/8/15
APPROVED BY: *Robert Webb*
DATE: 8 July 2015

COUNTY OF RIVERSIDE TRANSPORTATION DEPARTMENT
APPROVED BY: *Alan French*
ALAN FRENCH
DATE: 7-13-15

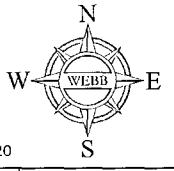
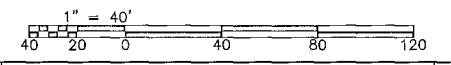

TRAFFIC CONTROL PLANS
HOMELAND MDP
LINE 1, STAGE 1
PHASE 13 - WATSON ROAD

PROJECT NO. 2014-0142
DRAWING NO. 4-859
SHEET NO. T14 OF T23

HOMELAND MDP LINE 1, STAGE 1 TEMPORARY TRAFFIC CONTROL PLANS: BRIGGS ROAD - PHASE 14

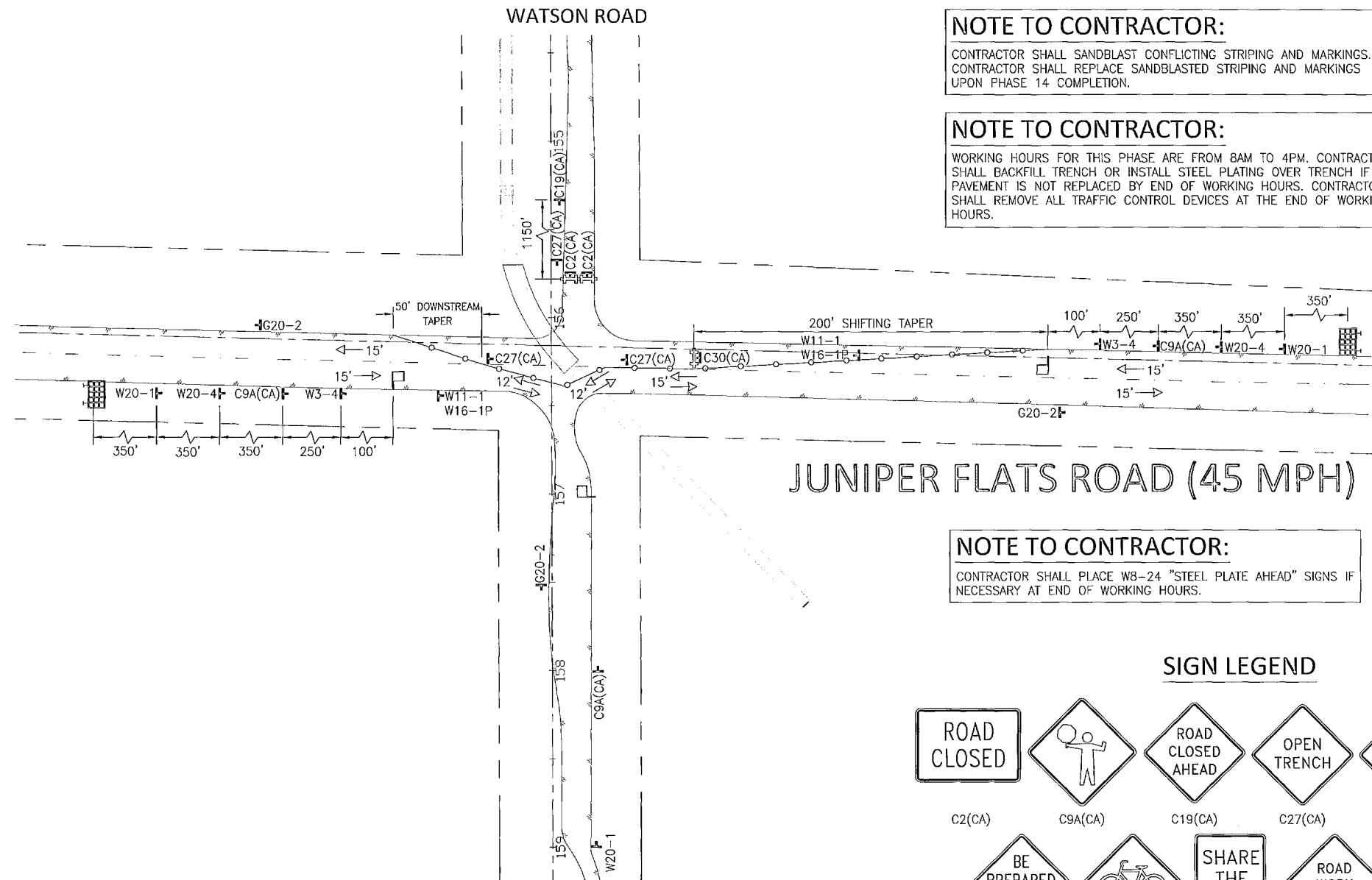

NOTE TO CONTRACTOR:
CONTRACTOR SHALL SANDBLAST CONFLICTING STRIPING AND MARKINGS. CONTRACTOR SHALL REPLACE SANDBLASTED STRIPING AND MARKINGS UPON PHASE 14 COMPLETION.

NOTE TO CONTRACTOR:
WORKING HOURS FOR THIS PHASE ARE FROM 8AM TO 4PM. CONTRACTOR SHALL BACKFILL TRENCH OR INSTALL STEEL PLATING OVER TRENCH IF PAVEMENT IS NOT REPLACED BY END OF WORKING HOURS. CONTRACTOR SHALL REMOVE ALL TRAFFIC CONTROL DEVICES AT THE END OF WORKING HOURS.

NOTE TO CONTRACTOR:
CONTRACTOR SHALL PLACE W8-24 "STEEL PLATE AHEAD" SIGNS IF NECESSARY AT END OF WORKING HOURS.

SIGN LEGEND

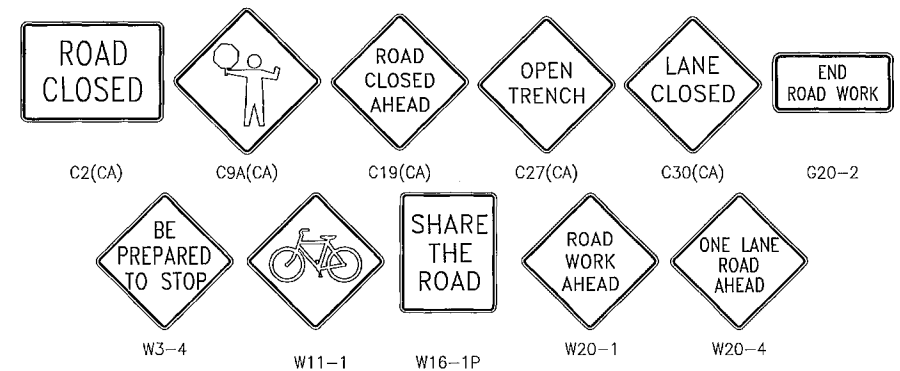

LEGEND

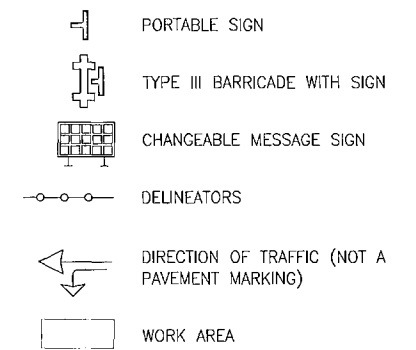

Don't Dig...Until You Call U.S.A. Toll Free
1-800-227-2600
for the location of buried utility lines.
Don't disrupt vital services.
TWO WORKING DAYS BEFORE YOU DIG

BENCHMARK
B.M. NO. S 327-1935
3.9 MI. NW FROM WINCHESTER
3.9 MI. NW ALONG THE ATCHISON, TOPEKA AND SANTA FE RAILWAY FROM THE STATION AT WINCHESTER, RIVERSIDE COUNTY, AT MENEFEE SIDING, 199' TRES. NW OF THE SE SWITCH STAND, 72 FT. E OF MILEPOST 6, 16.5 FT. NE OF THE CENTERLINE OF THE TRACK, AND 4.5 FT. NW OF THE STATION SIGN. A STANDARD DISK, STAMPED 11 327 1935 AND SET IN THE TOP OF A CONCRETE POST.

REF.	DESCRIPTION	APPR.	DATE	APPR.	DATE

DESIGNED BY:
DRAWN BY:
DATE DRAWN:

APPROVED BY:
ALBERT A. WEBB
ASSOCIATES
ENGINEERING CONSULTANTS
3788 McCRAV STREET
RIVERSIDE CA. 92506
PH. (951) 686-1070
FAX (951) 788-1256
DATE: 5/20/15



RIVERSIDE COUNTY FLOOD CONTROL AND WATER CONSERVATION DISTRICT
RECOMMENDED FOR APPROVAL BY: *Alfred...* DATE: 7/8/15
APPROVED BY: *Alan French* DATE: 9 July 2015

COUNTY OF RIVERSIDE TRANSPORTATION DEPARTMENT
APPROVED BY: *Alan French* DATE: 7-13-15

TRAFFIC CONTROL PLANS
HOMELAND MDP LINE 1, STAGE 1
PHASE 14 - WATSON ROAD
PROJECT NO. 2014-0142
DRAWING NO. 4-859
SHEET NO. T15 of T23

G:\2014\14-0142\DRAWINGS\DESIGN\14-0142 TCP.DWG 5/29/2015 10:45:2 AM

HOMELAND MDP LINE 1, STAGE 1 TEMPORARY TRAFFIC CONTROL PLANS: BRIGGS ROAD - PHASE 15

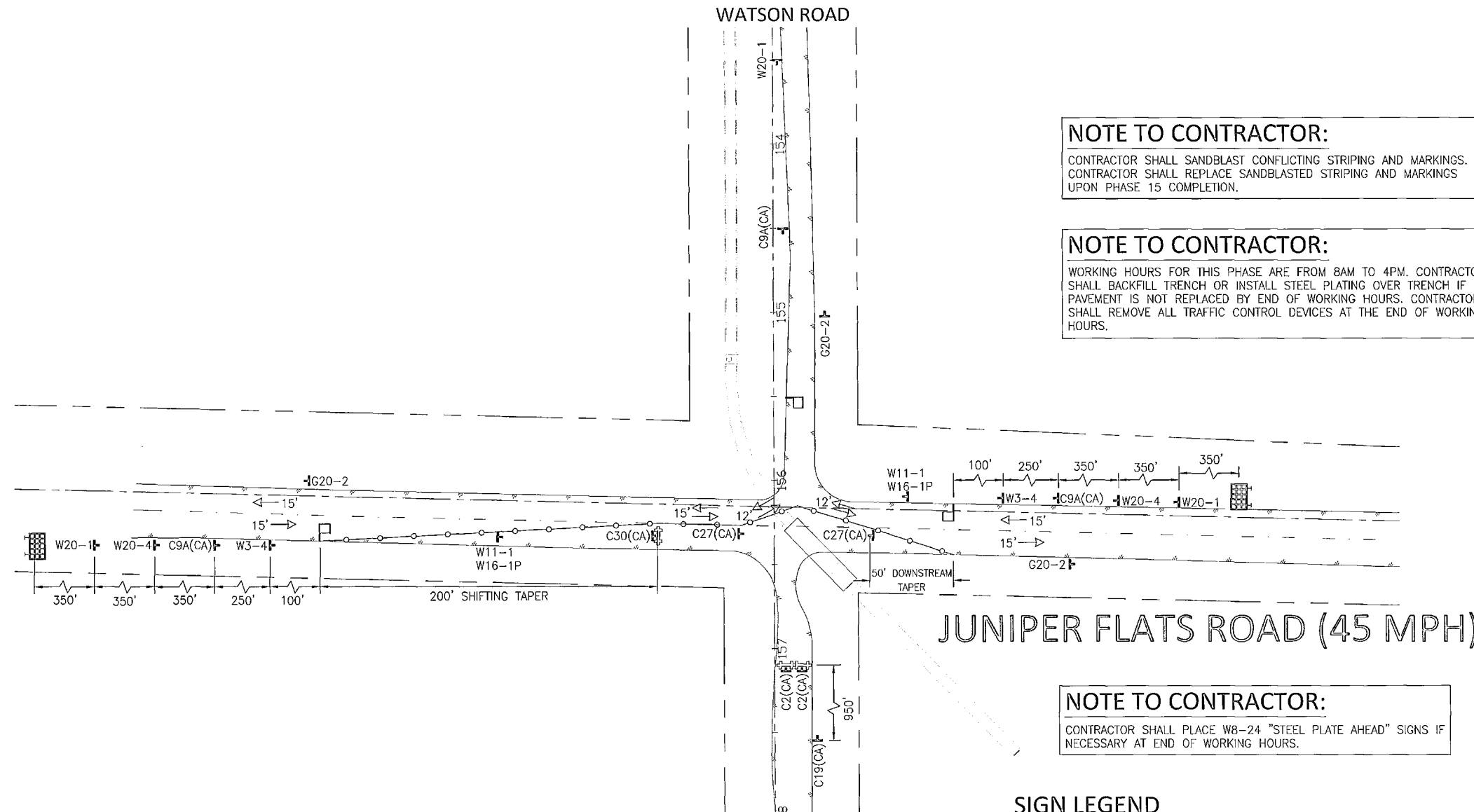

NOTE TO CONTRACTOR:
CONTRACTOR SHALL SANDBLAST CONFLICTING STRIPING AND MARKINGS. CONTRACTOR SHALL REPLACE SANDBLASTED STRIPING AND MARKINGS UPON PHASE 15 COMPLETION.

NOTE TO CONTRACTOR:
WORKING HOURS FOR THIS PHASE ARE FROM 8AM TO 4PM. CONTRACTOR SHALL BACKFILL TRENCH OR INSTALL STEEL PLATING OVER TRENCH IF PAVEMENT IS NOT REPLACED BY END OF WORKING HOURS. CONTRACTOR SHALL REMOVE ALL TRAFFIC CONTROL DEVICES AT THE END OF WORKING HOURS.

NOTE TO CONTRACTOR:
CONTRACTOR SHALL PLACE W8-24 "STEEL PLATE AHEAD" SIGNS IF NECESSARY AT END OF WORKING HOURS.

SIGN LEGEND

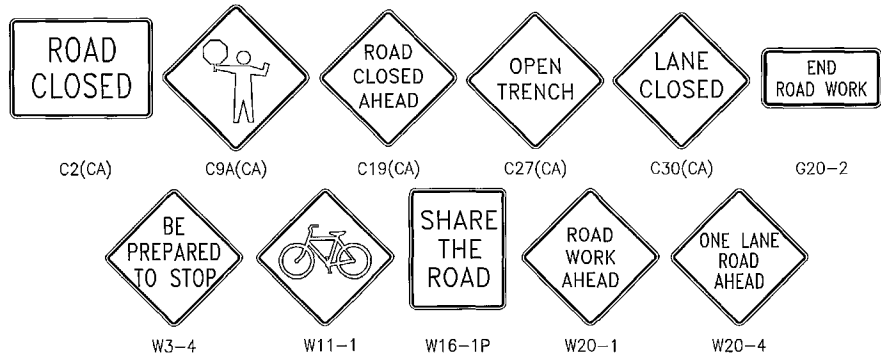

LEGEND

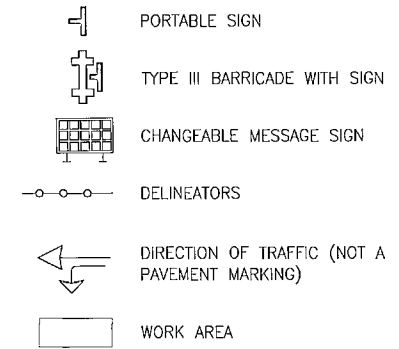

Don't Dig...Until You Call U.S.A. Toll Free
1-800-227-2600
for the location of buried utility lines.
Don't disrupt vital services.
TWO WORKING DAYS BEFORE YOU DIG

BENCHMARK
B.M. NO. S 327-1935
3.9 MI. NW FROM WINCHESTER
3.9 MI. NW ALONG THE ATCHISON, TOPEKA
AND SANTA FE RAILWAY FROM THE STATION
AT WINCHESTER, RIVERSIDE COUNTY, AT
MENEFEE SIDING, 190 YDS. NW OF THE SE
SWITCH STAND, 72 FT. E OF MILEPOST 6,
16.5 FT. NE OF THE CENTERLINE OF THE TRACK,
AND 4.5 FT. NW OF THE STATION SIGN. A
STANDARD DISK, STAMPED R 327 1935 AND SET
IN THE TOP OF A CONCRETE POST.

REF.	DESCRIPTION	APPR.	DATE	APPR.	DATE

DESIGNED BY:
DRAWN BY:
DATE DRAWN:
APPROVED BY:
ALBERT A. WEBB
ASSOCIATES
ENGINEERING CONSULTANTS
3788 McCRAV STREET
RIVERSIDE CA. 92506
PH. (951) 688-1070
FAX (951) 788-1258
DATE: 5/20/12



RIVERSIDE COUNTY FLOOD CONTROL AND WATER CONSERVATION DISTRICT
RECOMMENDED FOR APPROVAL BY: *Smadhi Omigrio* DATE: 7/8/15
APPROVED BY: *Robert All* DATE: 8 July 2015

COUNTY OF RIVERSIDE TRANSPORTATION DEPARTMENT
APPROVED BY: *Alan French* 7-13-15
ALAN FRENCH DATE: 7-13-15

TRAFFIC CONTROL PLANS
HOMELAND MDP
LINE 1, STAGE 1
PHASE 15 - WATSON ROAD
PROJECT NO. 2014-0142
DRAWING NO. 4-859
SHEET NO. T16 OF T23

HOMELAND MDP LINE 1, STAGE 1 TEMPORARY TRAFFIC CONTROL PLANS HIGHWAY 74 AT BRIGGS ROAD

SHEET INDEX

TITLE SHEET	SHEET 1
PHASE 1 - ALONG HIGHWAY 74	SHEET 2
PHASE 1 - ALONG BRIGGS ROAD	SHEET 3
PHASE 2 - ALONG HIGHWAY 74	SHEET 4
PHASE 2 - ALONG BRIGGS ROAD	SHEET 5
PHASE 1 - VIDEO DETECTION PLAN	SHEET 6
PHASE 2 - VIDEO DETECTION PLAN	SHEET 7

GENERAL NOTES

1. ALL ITEMS TO BE FURNISHED AND ALL WORK TO BE DONE SHALL CONFORM TO THE REQUIREMENTS OF THE STATE OF CALIFORNIA, 2010 DEPARTMENT OF TRANSPORTATION (CALTRANS) STANDARD PLANS AND STANDARD SPECIFICATIONS, THE CALIFORNIA MANUAL ON UNIFORM TRAFFIC CONTROL DEVICES (CA-MUTCD), 2014 EDITION, AND COUNTY OF RIVERSIDE.
2. TRAFFIC CONTROL SHOWN HEREIN IS THE MINIMUM REQUIRED. ADDITIONAL TRAFFIC CONTROLS, TRAFFIC SIGNAL EQUIPMENT, TRAFFIC SIGNS, BARRICADES, AND TEMPORARY PAVEMENT MARKINGS MAY BE REQUIRED IN THE FIELD. THE CONTRACTOR SHALL BE RESPONSIBLE FOR FURNISHING AND INSTALLING ANY ADDITIONAL DEVICES NECESSARY TO ASSURE PUBLIC SAFETY AND TRAFFIC FLOW AT ALL TIMES DURING CONSTRUCTION.
3. THE CONTRACTOR SHALL FURNISH AND PROPERLY INSTALL, CONSTRUCT, ERECT, USE AND CONTINUOUSLY INSPECT AND MAINTAIN, TWENTY-FOUR (24) HOURS PER DAY, SEVEN (7) DAYS PER WEEK, WHICH INCLUDES HOLIDAYS, ALL SAID DEVICES, EQUIPMENT AND MATERIALS AND ALL TEMPORARY AND PERMANENT PEDESTRIAN AND DRIVING SURFACES AS NECESSARY TO PROVIDE FOR THE SAFETY AND CONVENIENCE OF, AND TO PROPERLY WARN, GUIDE, CONTROL, REGULATE, CHANNELIZE AND PROTECT THE VEHICULAR TRAFFIC, PEDESTRIAN TRAFFIC, PROTECT WORKERS, AND THE PUBLIC THROUGHOUT THE ENTIRE LIMITS OF THE WORK ACTIVITY AND BEYOND SAID LIMITS AS NECESSARY TO INCLUDE AREAS AFFECTING OR AFFECTED BY THE WORK, FROM THE DATE OF NOTICE TO PROCEED TO THE COMPLETION AND ACCEPTANCE OF THE WORK.
4. ANY CONTRACTOR PERFORMING WORK ON THIS PROJECT SHALL FAMILIARIZE HIMSELF WITH THIS SITE AND SHALL BE SOLELY RESPONSIBLE FOR ANY DAMAGE TO EXISTING FACILITIES RESULTING DIRECTLY OR INDIRECTLY FROM THEIR OPERATIONS, WHETHER OR NOT SUCH FACILITIES ARE SHOWN ON THESE PLANS.
5. ANY REVISIONS TO THESE DRAWINGS SHALL BE APPROVED IN WRITING BY THE ENGINEER OF RECORD AND THE AGENCY HAVING JURISDICTION.
6. CONTRACTOR SHALL OBTAIN ALL NECESSARY PERMITS AND A BUSINESS LICENSE FROM THE COUNTY BEFORE BEGINNING ANY WORK IN ROAD RIGHT-OF-WAY.
7. NO EQUIPMENT OR MATERIAL SHALL BE STORED IN THE COUNTY OR CALTRANS RIGHT-OF-WAY.
8. CONTRACTOR SHALL CONTACT CALTRANS AT LEAST SEVEN (7) DAYS IN ADVANCE OF PLACING TRAFFIC CONTROL EQUIPMENT FOR APPROVAL.
9. ALL ADJACENT BUSINESSES, SCHOOLS, RESIDENCES, AND CHURCHES SHALL BE DULY NOTIFIED BY THE CONTRACTOR, IN WRITING, OF HIS PROPOSED OPERATIONS. NOTICE SHALL BE DELIVERED AT LEAST SEVEN (7) WORKING DAYS PRIOR TO START OF CONSTRUCTION ACTIVITIES. THE CONTRACTOR SHALL BE RESPONSIBLE FOR REPRODUCTION OF NOTIFICATION LETTERS. RE-NOTIFICATION WILL BE REQUIRED IF THE CONTRACTOR'S SCHEDULE IS ALTERED OR OTHER DELAYS OCCUR WHICH AFFECT THE PROJECT SCHEDULE.
10. ACCESS TO BUSINESSES, RESIDENCES, SCHOOLS AND CHURCHES SHALL REMAIN OPEN AT ALL TIMES UNLESS OTHERWISE AUTHORIZED. ACCESS CLOSURE SHALL BE SCHEDULED WITH THE PROPERTY OWNERS AND APPROVED BY THE COUNTY AND CALTRANS.
11. CONTRACTOR SHALL COVER EXISTING TRAFFIC SIGNS, TRAFFIC SIGNALS, OR PEDESTRIAN SIGNAL INDICATIONS SHOULD SAID CONTROLS CONFLICT WITH TEMPORARY TRAFFIC CONTROL PLAN OR AS DIRECTED BY THE COUNTY OR CALTRANS.
12. CONTRACTOR SHALL SANDBLAST ANY EXISTING STRIPING THAT CONFLICTS WITH THE TRAFFIC CONTROL PLAN.
13. TEMPORARY PAVEMENT DELINEATION SHALL BE FURNISHED, PLACED, MAINTAINED, AND REMOVED IN ACCORDANCE WITH THE PROVISIONS IN SECTION 12-3.01, "GENERAL," OF THE CALTRANS STANDARD SPECIFICATIONS. CONTRACTOR SHALL USE REMOVABLE PREFORMED PLASTIC MARKINGS FOR PAVEMENT DELINEATION.
14. WHENEVER THE WORK CAUSES OBLITERATION OF PAVEMENT DELINEATION, TEMPORARY OR PERMANENT PAVEMENT DELINEATION SHALL BE IN PLACE PRIOR TO OPENING THE TRAVELED WAY TO PUBLIC TRAFFIC. LANE LINES AND CENTERLINE PAVEMENT DELINEATION SHALL BE PROVIDED AT ALL TIMES FOR TRAVELED WAYS OPEN TO THE PUBLIC TRAFFIC.
15. CONTRACTOR SHALL REPLACE/REPAIR ANY AND ALL STRIPING, PAVEMENT MARKINGS, RAISED PAVEMENT MARKERS, AND CURB PAINT DISRUPTED OR REMOVED DURING THE CONSTRUCTION TO THE SATISFACTION OF THE COUNTY ENGINEER AND CALTRANS.
16. ALL TEMPORARY TRAFFIC CONTROL DEVICES SHALL BE REMOVED FOLLOWING COMPLETION OF CONSTRUCTION AND THE PERMANENT TRAFFIC CONTROL DEVICES SHALL BE RESTORED BY THE CONTRACTOR UPON COMPLETION OF PROJECT.
17. ALL ADVANCED WARNING SIGNS SHALL BE EQUIPPED WITH FLAGS.

18. FLASHING YELLOW BEACONS, TYPE -B SHALL BE USED ON ALL W20-1 SIGNS AND ON ALL TYPE-III BARRICADES GUARDING THE WORK AREA OVERNIGHT.
19. TRAFFIC SIGNALS SHALL REMAIN IN OPERATION AT ALL TIMES. SIGNAL OPERATION MODIFICATION DURING CONSTRUCTION SHALL BE COORDINATED WITH AND APPROVED BY THE COUNTY, CITY OF MENIFEE, AND CALTRANS FOR THE TRAFFIC SIGNAL AT BRIGGS ROAD & HERITAGE HIGH SCHOOL SEVEN (7) DAYS IN ADVANCE. COUNTY TRAFFIC SIGNAL MAINTENANCE CAN BE REACHED AT 951-955-6894.
20. CONTRACTOR IS RESPONSIBLE TO PROVIDE QUALIFIED TRAFFIC SIGNAL CONTRACTOR TO MODIFY AND MAINTAIN TRAFFIC SIGNAL DURING CONSTRUCTION.
21. CONTRACTOR SHALL COMPLY WITH THE REQUIREMENTS OF THE AMERICANS WITH DISABILITIES ACT (ADA) AS RELATED TO PEDESTRIAN ACCESS AND SHALL MAINTAIN PEDESTRIAN ACCESS AT ALL TIMES PER ADA REQUIREMENTS. SIDEWALK CLOSURE/DETOUR SHALL COMPLY WITH CA-MUTCD AND SHALL OBTAIN APPROVAL FROM THE CALTRANS.
22. PROPERLY TRAINED AND EXPERIENCED FLAGGERS SHALL BE PROVIDED TO DIRECT TRAFFIC WHEN SAID TRAFFIC IS TO BE INTERRUPTED, WHEN TWO-WAY TRAFFIC IS TO BE REDUCED TO ONE-WAY TRAFFIC, AND AT OTHER SUCH TIMES AS IS NECESSARY TO SAFELY PASS TRAFFIC THROUGH OR AROUND THE WORK AREA AND WHEN SO DIRECTED BY THE ENGINEER.
23. CONSTRUCTION TRUCK TRAFFIC MERGING INTO TRAFFIC LANES SHALL BE BY USE OF FLAGGERS AND APPROPRIATE SIGNAGE.
24. THE COUNTY MAY REQUIRE ADDITIONAL TRAFFIC CONTROL IN SCHOOL ZONES, IF SCHOOLS ARE IN SESSION.
25. TRAFFIC CONTROL WITHIN THE STATE RIGHT-OF-WAY SHALL BE TO STATE STANDARDS. THE CONTRACTOR SHALL INSTALL AND MAINTAIN ALL TRAFFIC CONTROL DEVICES AS NECESSARY TO MAINTAIN PUBLIC SAFETY.
26. CONTRACTOR SHALL PROTECT IN PLACE ANY TRAFFIC SIGNAL INTERCONNECT CONDUIT AND WIRING ALONG HIGHWAY 74. IF PERMIT PROJECT COMES IN CLOSE PROXIMITY OF CONDUITS IN THE CALTRANS RIGHT-OF-WAY, A CALTRANS REPRESENTATIVE MUST BE PRESENT TO INSPECT THE JOB TO ENSURE THAT THE CONDUITS OR WIRING WILL NOT BE DAMAGED.
27. CONTRACTOR SHALL REPLACE ANY VEHICLE LOOP DETECTORS THAT ARE DAMAGED OR DESTROYED DURING CONSTRUCTION.
28. ENSURE THAT WORK VEHICLES OR EQUIPMENT SHOULD NOT BE PARKED WITHIN 6 FEET OF TRAFFIC LANE TO PERFORM ACTIVE CONSTRUCTION.
29. THE CONTRACTOR IS REQUIRED TO TAKE DUE PRECAUTIONARY MEASURES TO PROTECT ALL UTILITIES SHOWN ON THESE PLANS AND/OR ANY OTHER UNDERGROUND UTILITIES NOT OF RECORD OR NOT SHOWN ON THESE PLANS.

SIGN LEGEND

LEGEND

CALTRANS NOTES TO CONTRACTOR

1. IT IS THE PERMITEE/CONTRACTOR'S RESPONSIBILITY TO NOTIFY THE UNDERGROUND SERVICE ALERT IN ORDER TO CLEAR ANY POSSIBLE CONFLICTS PRIOR TO CONSTRUCTION.
2. WHERE DAMAGE IS CAUSED BY THE CONTRACTOR'S OPERATION, THE CONTRACTOR SHALL, AT HIS OWN EXPENSE, REPAIR OR REPLACE DAMAGED FACILITIES PROMPTLY IN ACCORDANCE WITH 2010 STATE SPECIFICATIONS AND/OR AS DIRECTED BY THE STATE REPRESENTATIVE.
3. ALL WORK WITHIN STATE'S RIGHT-OF-WAY SHALL BE COMPLETED IN ACCORDANCE WITH THE 2010 STATE OF CALIFORNIA DEPARTMENT OF TRANSPORTATION STANDARD PLANS & STANDARD SPECIFICATIONS, REVISED STANDARD PLANS (RSP), STANDARD SPECIAL PROVISIONS (SSP); HIGHWAY DESIGN MANUAL (HDM) POST MAY 2012 EDITION; ENCROACHMENT PERMIT MANUAL (EPM), ENCROACHMENT PERMIT UTILITY PROVISIONS; AND CALIFORNIA MANUAL ON UNIFORM TRAFFIC CONTROL DEVICES (CA MUTCD) 2014 EDITION. SHOULD A CONFLICT ARISE BETWEEN THE CONTRACT PLANS, SPECIFICATIONS AND/OR DETAILS PREPARED BY THE PERMITEE, THE STATE'S STANDARD PLANS, REVISED STANDARD PLAN, STANDARD SPECIFICATIONS AND STANDARD SPECIAL PROVISIONS SHALL GOVERN AS DETERMINED BY THE STATE'S REPRESENTATIVE.
4. ALL STRIPING AND SIGN STRUCTURES SHALL BE RESTORED (IF DISTURBED) TO PRE-CONSTRUCTION CONDITIONS UPON COMPLETION OF CONSTRUCTION.
5. ALL SURVEY MONUMENTS DESTROYED DURING THE PERMIT CONSTRUCTION SHALL BE REPLACED ACCORDING TO CURRENT STATE STANDARD PLAN A74.
6. DTM RECOMMENDS THE PLACEMENT OF PORTABLE CHANGEABLE MESSAGE SIGNS (PCMS) 7 CALENDAR DAYS PRIOR TO REQUESTED CLOSURE DATE TO ADVISE MOTORISTS OF THE UPCOMING LANE REDUCTION.
7. THE CALTRANS TRANSPORTATION PERMITS OFFICE REQUIRES 14 DAYS NOTICE FOR THE REDUCTION OF WIDTH AND/OR HEIGHT MAINLINE, WHICH ARE/OR MAY BE USED AS PART OF THEIR ROUTING OF OVERSIZED LOADS.
8. THE CALTRANS PUBLIC AFFAIRS OFFICE MUST BE MADE AWARE OF THE CONSTRUCTION ACTIVITIES, ESPECIALLY "LANE CLOSURE WITH REDUCTION OF WIDTH TO TRAFFIC LANES" TRAFFIC. IN THE EVENT THE CALTRANS PUBLIC AFFAIRS OFFICE IS ASKED TO ISSUE PRESS RELEASES, SAID INFORMATION IS REQUIRED 7 DAYS PRIOR TO THE CLOSURE.

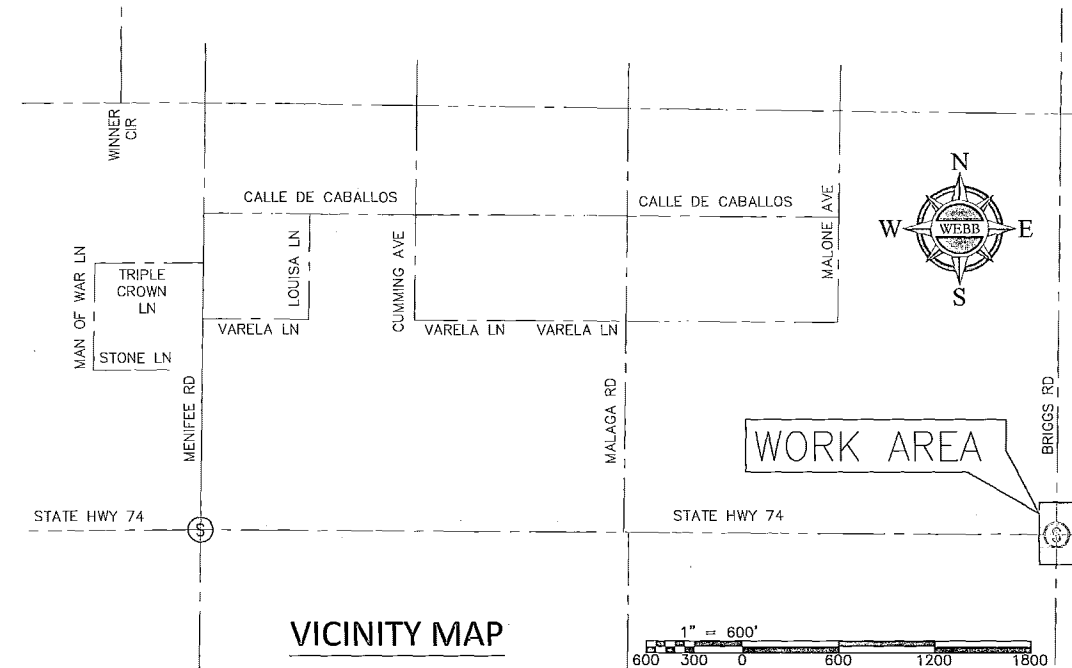

BENCHMARK
 B.M. NO. S 327-1935
 3.9 MI. NW FROM WINCHESTER
 3.9 MI. NW ALONG THE ATCHISON, TOPEKA
 AND SANTA FE RAILWAY FROM THE STATION
 AT WINCHESTER, RIVERSIDE COUNTY, AT
 MENIFEE SIDING, 198 YDS. NW OF THE SE
 SWITCH STAND, 72 FT. E OF MILEPOST 6,
 16.5 FT. NE OF THE CENTERLINE OF THE TRACK,
 AND 4.5 FT. NW OF THE STATION SIGN. A
 STANDARD DISK, STAMPED R 327 1935 AND SET
 IN THE TOP OF A CONCRETE POST.

REF.	DESCRIPTION	APPR.	DATE	APPR.	DATE

DESIGNED BY: _____
 DRAWN BY: _____
 DATE DRAWN: _____

APPROVED BY: **ALBERT A. WEBB**
 ENGINEERING CONSULTANTS
 3788 McCRAY STREET
 RIVERSIDE CA. 92506
 PH. (951) 686-1070
 FAX (951) 788-1256

Albert A. Webb
 7/6/15
 DATE: _____

RIVERSIDE COUNTY FLOOD CONTROL
 AND
 WATER CONSERVATION DISTRICT

RECOMMENDED FOR APPROVAL BY: *Snadell*
 DATE: 7/8/15

APPROVED BY: *Alan French*
 DATE: 8/10/2015

COUNTY OF RIVERSIDE
 TRANSPORTATION DEPARTMENT

APPROVED BY: *Alan French*
 ALAN FRENCH
 DATE: 7-13-15

CALTRANS PERMIT # 08-14-N-DD-1090

TRAFFIC CONTROL PLANS
 HOMELAND MDP LINE 1
 HIGHWAY 74 AND BRIGGS

TITLE SHEET

PROJECT NO. 4-0-00345
DRAWING NO. 4-859
SHEET NO. T17 OF T23

HOMELAND MDP LINE 1, STAGE 1

TEMPORARY TRAFFIC CONTROL PLANS: HIGHWAY 74 AND BRIGGS ROAD - PHASE 1

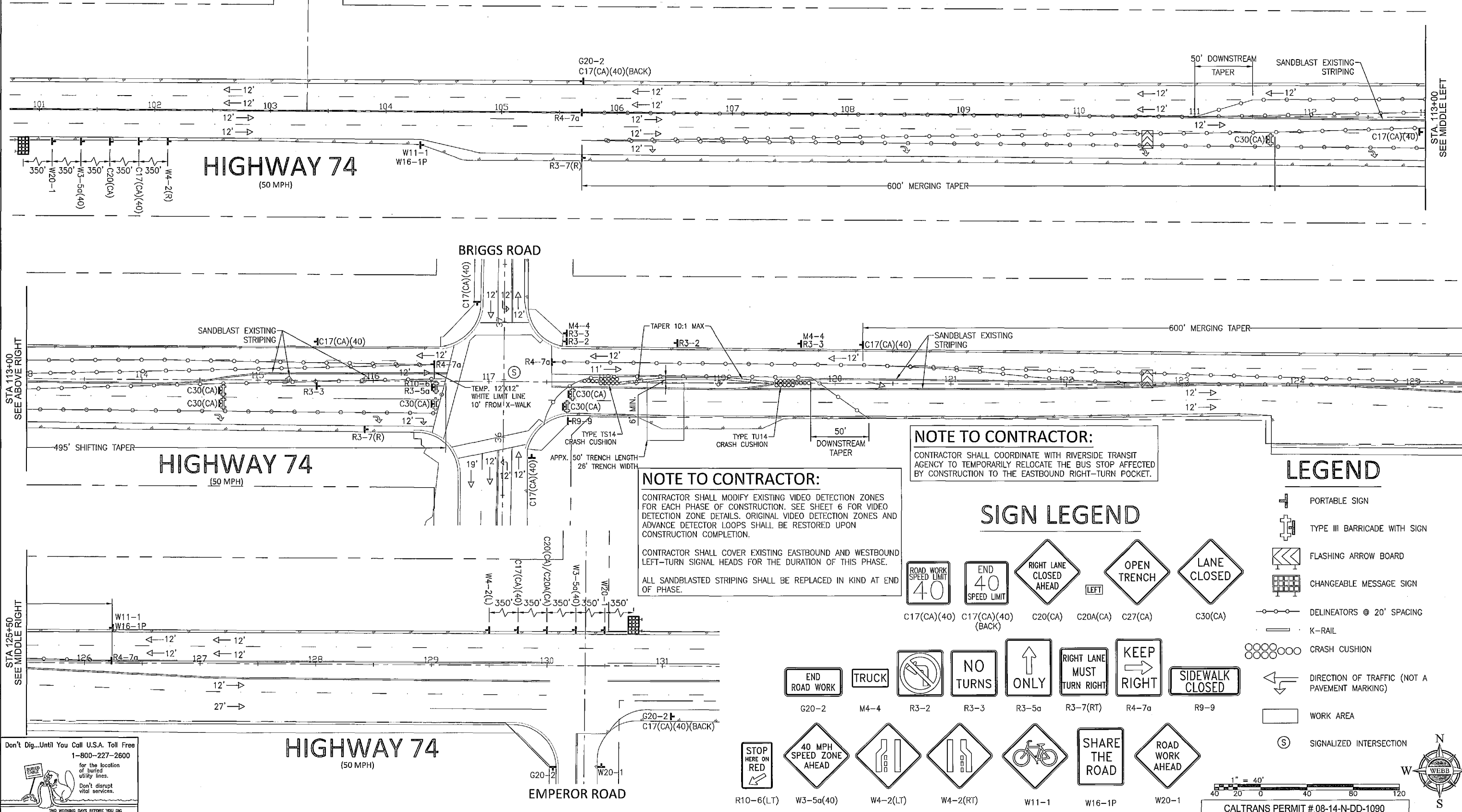

NOTE TO CONTRACTOR:
 CONTRACTOR SHALL COORDINATE WITH RIVERSIDE TRANSIT AGENCY TO TEMPORARILY RELOCATE THE BUS STOP AFFECTED BY CONSTRUCTION TO THE EASTBOUND RIGHT-TURN POCKET.

NOTE TO CONTRACTOR:
 CONTRACTOR SHALL MODIFY EXISTING VIDEO DETECTION ZONES FOR EACH PHASE OF CONSTRUCTION. SEE SHEET 6 FOR VIDEO DETECTION ZONE DETAILS. ORIGINAL VIDEO DETECTION ZONES AND ADVANCE DETECTOR LOOPS SHALL BE RESTORED UPON CONSTRUCTION COMPLETION.
 CONTRACTOR SHALL COVER EXISTING EASTBOUND AND WESTBOUND LEFT-TURN SIGNAL HEADS FOR THE DURATION OF THIS PHASE.
 ALL SANDBLASTED STRIPING SHALL BE REPLACED IN KIND AT END OF PHASE.

SIGN LEGEND

C17(CA)(40)	C17(CA)(40) (BACK)	C20(CA)	C20A(CA)	C27(CA)
G20-2	M4-4	R3-2	R3-3	R3-5a
R10-6(LT)	W3-5a(40)	W4-2(LT)	W4-2(RT)	W11-1
				W16-1P
				W20-1

LEGEND

- PORTABLE SIGN
- TYPE III BARRICADE WITH SIGN
- FLASHING ARROW BOARD
- CHANGEABLE MESSAGE SIGN
- DELINEATORS @ 20' SPACING
- K-RAIL
- CRASH CUSHION
- DIRECTION OF TRAFFIC (NOT A PAVEMENT MARKING)
- WORK AREA
- SIGNALIZED INTERSECTION

Don't Dig...Until You Call U.S.A. Toll Free
 1-800-227-2600
 for the location of buried utility lines.
 Don't disrupt vital services.
 TWO WORKING DAYS BEFORE YOU DIG

BENCHMARK
 B.M. NO. S 327-1935
 3.9 MI. NW FROM WINCHESTER
 3.9 MI. NW ALONG THE ATCHISON, TOPEKA
 AND SANTA FE RAILWAY FROM THE STATION
 AT WINCHESTER, RIVERSIDE COUNTY, AT
 MENEFEE SIDING, 190 YDS. NW OF THE SE
 SWITCH STAND, 72 FT. E OF MILEPOST 6,
 16.5 FT. NE OF THE CENTERLINE OF THE TRACK,
 AND 4.5 FT. NW OF THE STATION SIGN, A
 STANDARD DISK, STAMPED R 327 1935 AND SET
 IN THE TOP OF A CONCRETE POST.

REF.	DESCRIPTION	APPR.	DATE	APPR.	DATE

DESIGNED BY: _____
 DRAWN BY: _____
 DATE DRAWN: _____

APPROVED BY:
ALBERT A. WEBB
 ASSOCIATES
 ENGINEERING CONSULTANTS
 3788 MCCRAY STREET
 RIVERSIDE, CA. 92506
 PH. (951) 686-1070
 FAX (951) 788-1256

DATE: 7/8/15



RIVERSIDE COUNTY FLOOD CONTROL
 AND
 WATER CONSERVATION DISTRICT

RECOMMENDED FOR APPROVAL BY:
Stuadell Cimiguis
 DATE: 7/8/15

APPROVED BY:
Robert All
 DATE: 8 July 2015

COUNTY OF RIVERSIDE
 TRANSPORTATION DEPARTMENT

APPROVED BY:
Alan French 7-13-15
 ALAN FRENCH
 DATE: 7-13-15

CALTRANS PERMIT # 08-14-N-DD-1090

TRAFFIC CONTROL PLANS
 HOMELAND MDP LINE 1
 HIGHWAY 74 AND BRIGGS ROAD
 PHASE 1 - HIGHWAY 74

PROJECT NO.
 4-0-00345
 DRAWING NO.
 4-859
 SHEET NO.
 T18 OF T23

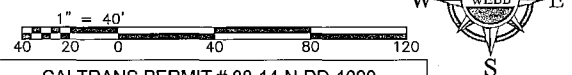

HOMELAND MDP LINE 1, STAGE 1

TEMPORARY TRAFFIC CONTROL PLANS: HIGHWAY 74 AND BRIGGS ROAD - PHASE 1

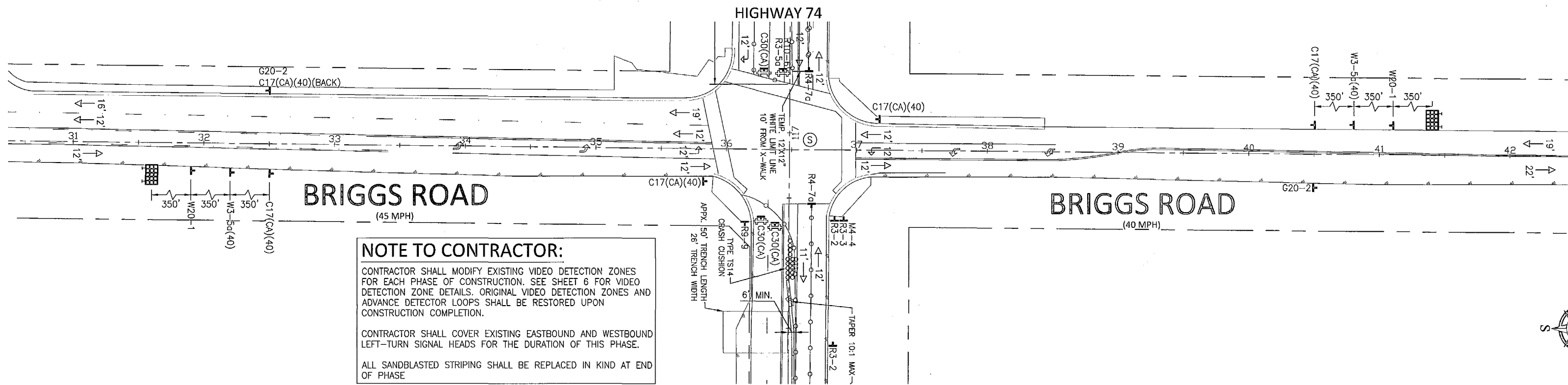

NOTE TO CONTRACTOR:

CONTRACTOR SHALL MODIFY EXISTING VIDEO DETECTION ZONES FOR EACH PHASE OF CONSTRUCTION. SEE SHEET 6 FOR VIDEO DETECTION ZONE DETAILS. ORIGINAL VIDEO DETECTION ZONES AND ADVANCE DETECTOR LOOPS SHALL BE RESTORED UPON CONSTRUCTION COMPLETION.

CONTRACTOR SHALL COVER EXISTING EASTBOUND AND WESTBOUND LEFT-TURN SIGNAL HEADS FOR THE DURATION OF THIS PHASE.

ALL SANDBLASTED STRIPING SHALL BE REPLACED IN KIND AT END OF PHASE.

NOTE TO CONTRACTOR:

CONTRACTOR SHALL COORDINATE WITH RIVERSIDE TRANSIT AGENCY TO TEMPORARILY RELOCATE THE BUS STOP AFFECTED BY CONSTRUCTION TO THE EASTBOUND RIGHT-TURN POCKET.

SIGN LEGEND

LEGEND

DETOUR PLAN - NTS

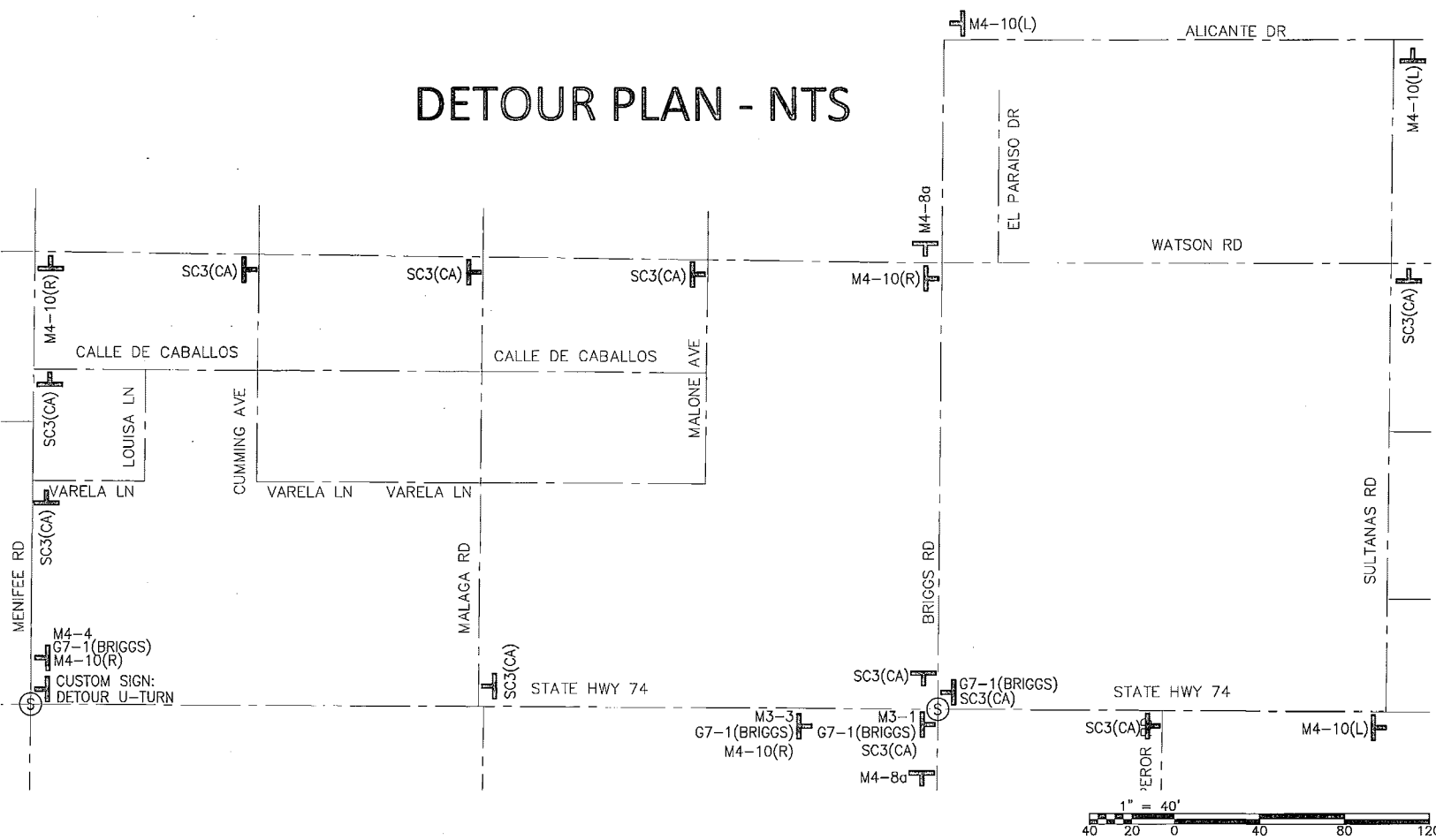

Don't Dig...Until You Call U.S.A. Toll Free
1-800-227-2600
for the location of buried utility lines.
Don't disrupt vital services.
TWO WORKING DAYS BEFORE YOU DIG

BENCHMARK
B.M. NO. S 327-1935
3.9 MI. NW FROM WINCHESTER
3.9 MI. NW ALONG THE ATCHISON, TOPEKA
AND SANTA FE RAILWAY FROM THE STATION
AT WINCHESTER, RIVERSIDE COUNTY, AT
MENEFEE SIDING, 198 YDS. NW OF THE SE
SWITCH STAND, 72 FT. E OF MILEPOST 6,
16.5 FT. NE OF THE CENTERLINE OF THE TRACK,
AND 4.5 FT. NW OF THE STATION SIGN. A
STANDARD DISK, STAMPED R 327 1935 AND SET
IN THE TOP OF A CONCRETE POST.

REF.	DESCRIPTION	APPR.	DATE	APPR.	DATE

DESIGNED BY:
DRAWN BY:
DATE DRAWN:

APPROVED BY:
ALBERT A. WEBB
ASSOCIATES
ENGINEERING CONSULTANTS
3788 McCRAE STREET
RIVERSIDE CA. 92506
PH. (951) 686-1070
FAX (951) 788-1256
DATE: 7/16/15

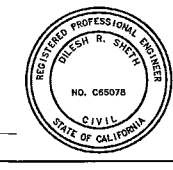

RIVERSIDE COUNTY FLOOD CONTROL
AND
WATER CONSERVATION DISTRICT
RECOMMENDED FOR APPROVAL BY:
Smadell Quijias
DATE: 7/16/15
APPROVED BY:
Alan French
DATE: 8 July 2015

COUNTY OF RIVERSIDE
TRANSPORTATION DEPARTMENT
APPROVED BY:
Alan French
ALAN FRENCH
DATE: 7-13-15

CALTRANS PERMIT # 08-14-N-DD-1090
TRAFFIC CONTROL PLANS
HOMELAND MDP LINE 1
HIGHWAY 74 AND BRIGGS ROAD
PHASE 1- BRIGGS ROAD

PROJECT NO.
4-0-00345
DRAWING NO.
4-859
SHEET NO.
T19 OF T23

HOMELAND MDP LINE 1, STAGE 1

TEMPORARY TRAFFIC CONTROL PLANS: HIGHWAY 74 AND BRIGGS ROAD - PHASE 2

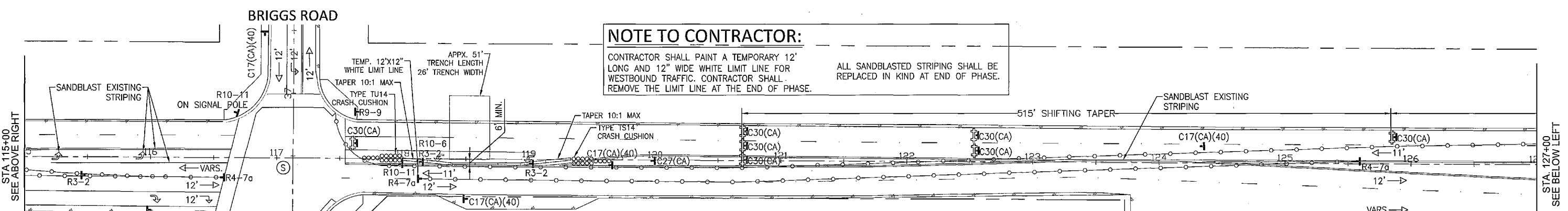
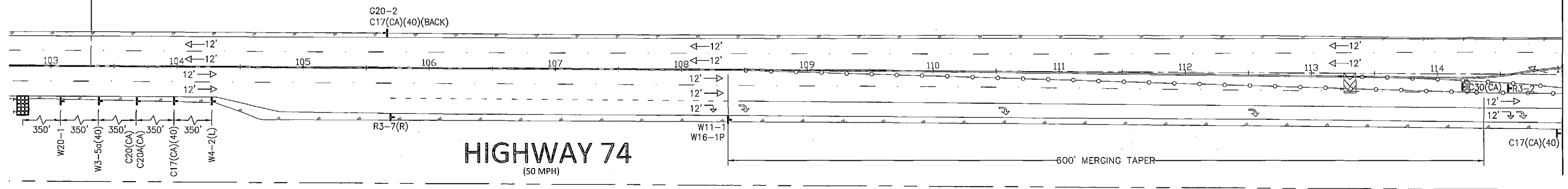

NOTE TO CONTRACTOR:
 CONTRACTOR SHALL PAINT A TEMPORARY 12" LONG AND 12" WIDE WHITE LIMIT LINE FOR WESTBOUND TRAFFIC. CONTRACTOR SHALL REMOVE THE LIMIT LINE AT THE END OF PHASE.
 ALL SANDBLASTED STRIPING SHALL BE REPLACED IN KIND AT END OF PHASE.

NOTE TO CONTRACTOR:
 CONTRACTOR SHALL MODIFY EXISTING VIDEO DETECTION ZONES FOR EACH PHASE OF CONSTRUCTION. SEE SHEET 6 FOR VIDEO DETECTION ZONE DETAILS. ORIGINAL VIDEO DETECTION ZONES AND ADVANCE DETECTOR LOOPS SHALL BE RESTORED UPON CONSTRUCTION COMPLETION.
 CONTRACTOR SHALL COVER EXISTING EASTBOUND AND WESTBOUND LEFT-TURN SIGNAL HEADS FOR THE DURATION OF THIS PHASE.

HIGHWAY 74
(50 MPH)

HIGHWAY 74
(50 MPH)

SIGN LEGEND

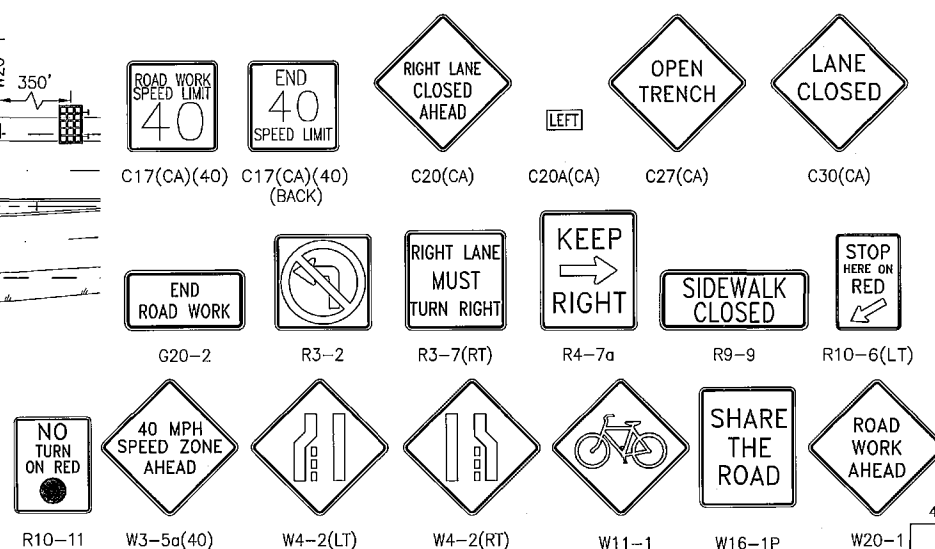

LEGEND

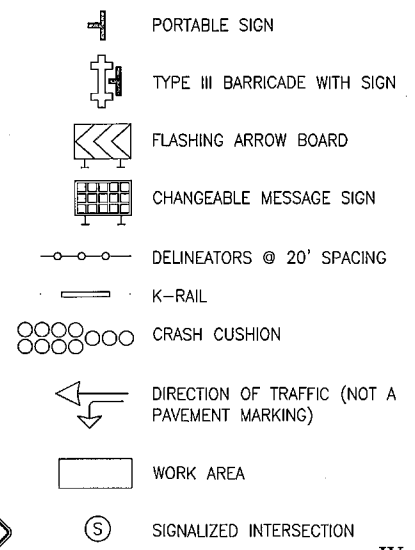

Don't Dig...Until You Call U.S.A. Toll Free
 1-800-227-2800
 for the location of buried utility lines.
 Don't disrupt vital services.
 TWO WORKING DAYS BEFORE YOU DIG

BENCHMARK
 B.M. NO. S 327-1935
 3.9 MI. NW FROM WINCHESTER
 3.9 MI. NW ALONG THE ATCHISON, TOPEKA
 AND SANTA FE RAILWAY FROM THE STATION
 AT WINCHESTER, RIVERSIDE COUNTY, AT
 MENEFEE SIDING, 198 YARDS. NW OF THE SE
 SWITCH STAND, 72 FT. E. OF MILEPOST 6,
 16.5 FT. NE. OF THE CENTERLINE OF THE TRACK,
 AND 4.5 FT. NW OF THE STATION SIGN. A
 STANDARD DISK, STAMPED R 327 1935 AND SET
 IN THE TOP OF A CONCRETE POST.

REF.	DESCRIPTION	APPR.	DATE	APPR.	DATE

DESIGNED BY: **ALBERT A. WEBB ASSOCIATES**
 DRAWN BY: *Dilesh Shekh*
 DATE DRAWN: *7/6/15*
 APPROVED BY: *Dilesh Shekh*
 DILESH SHEKH, RCE #05078

RIVERSIDE COUNTY FLOOD CONTROL AND WATER CONSERVATION DISTRICT
 RECOMMENDED FOR APPROVAL BY: *Sanad M. Angris*
 DATE: *7/8/15*
 APPROVED BY: *Alan French*
 DATE: *8 Aug 2015*

COUNTY OF RIVERSIDE TRANSPORTATION DEPARTMENT
 APPROVED BY: *Alan French*
 DATE: *7-13-15*

CALTRANS PERMIT # 08-14-N-DD-1090
 TRAFFIC CONTROL PLANS
 HOMELAND MDP LINE 1
 HIGHWAY 74 AND BRIGGS ROAD
 PHASE 2 - HIGHWAY 74

PROJECT NO. 4-0-00345
 DRAWING NO. 4-859
 SHEET NO. T20 OF T23

HOMELAND MDP LINE 1, STAGE 1 TEMPORARY TRAFFIC CONTROL PLANS: HIGHWAY 74 AND BRIGGS ROAD - PHASE 2

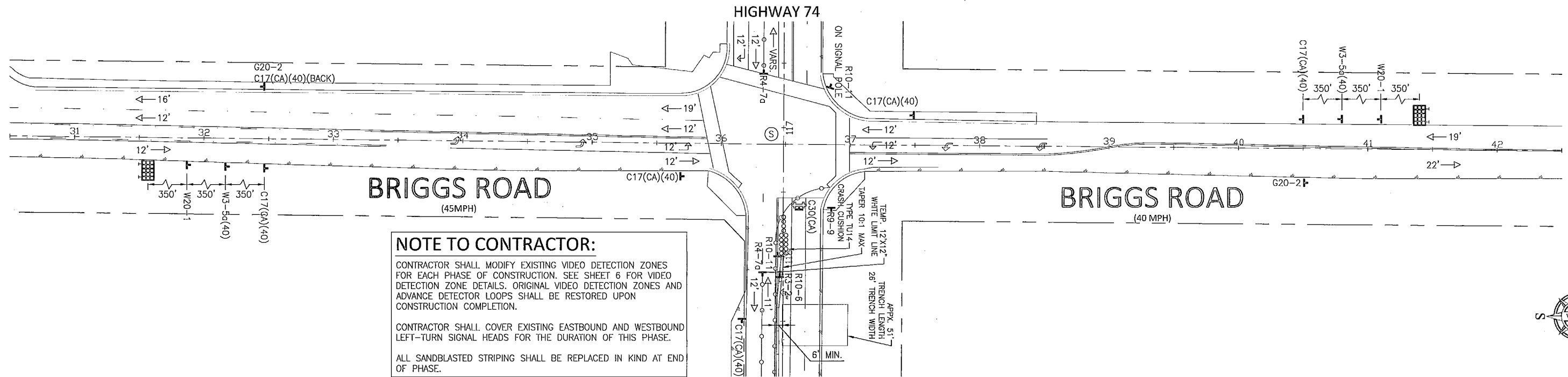

NOTE TO CONTRACTOR:
 CONTRACTOR SHALL MODIFY EXISTING VIDEO DETECTION ZONES FOR EACH PHASE OF CONSTRUCTION. SEE SHEET 6 FOR VIDEO DETECTION ZONE DETAILS. ORIGINAL VIDEO DETECTION ZONES AND ADVANCE DETECTOR LOOPS SHALL BE RESTORED UPON CONSTRUCTION COMPLETION.
 CONTRACTOR SHALL COVER EXISTING EASTBOUND AND WESTBOUND LEFT-TURN SIGNAL HEADS FOR THE DURATION OF THIS PHASE.
 ALL SANDBLASTED STRIPING SHALL BE REPLACED IN KIND AT END OF PHASE.

NOTE TO CONTRACTOR:
 CONTRACTOR SHALL PAINT A TEMPORARY 12' LONG AND 12" WIDE WHITE LIMIT LINE FOR WESTBOUND TRAFFIC. CONTRACTOR SHALL REMOVE THE LIMIT LINE AT THE END OF PHASE.

SIGN LEGEND

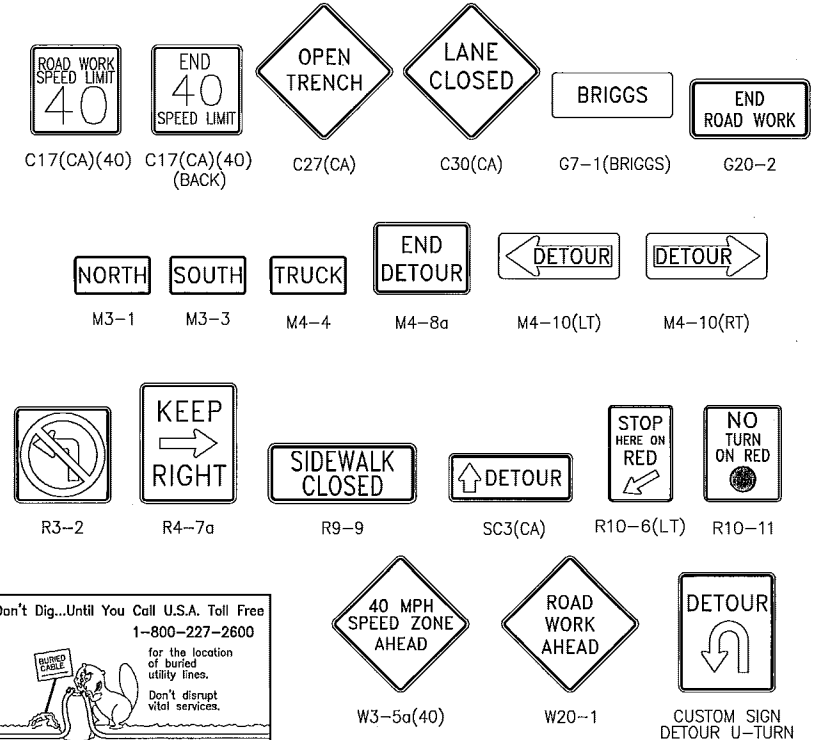

LEGEND

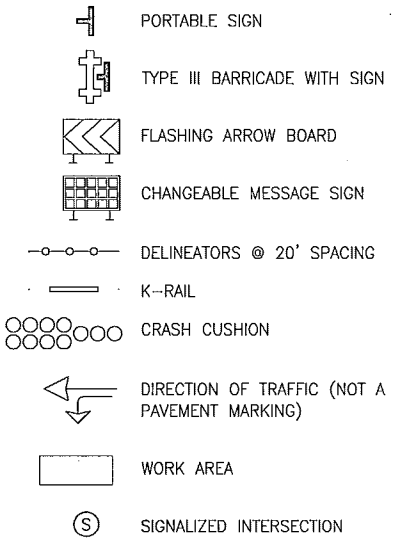

DETOUR PLAN - NTS

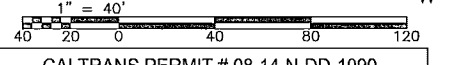
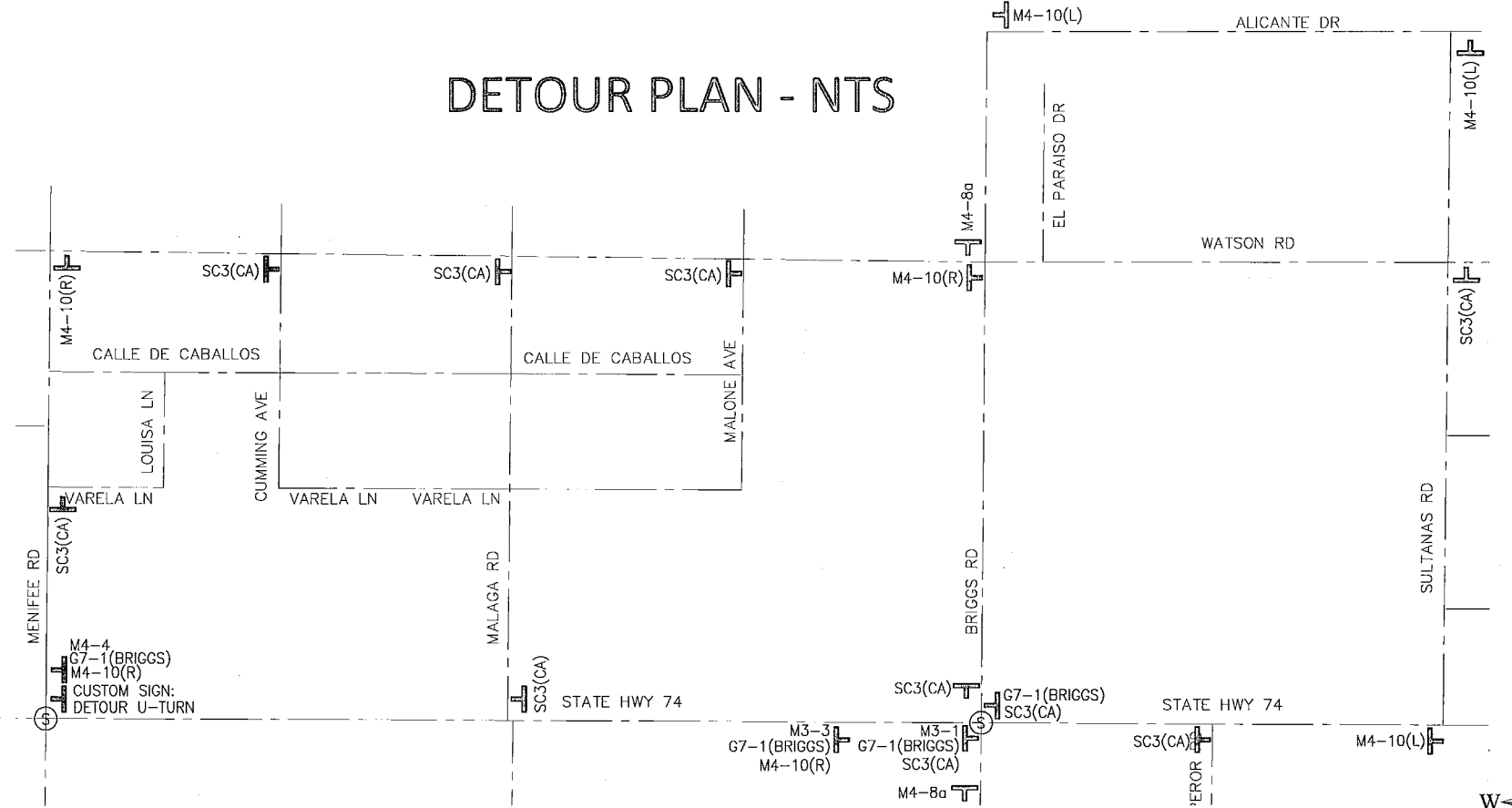

BENCHMARK
 B.M. NO. 5 327-1935
 3.9 MI. NW FROM WINCHESTER
 3.9 MI. NW ALONG THE ATCHISON, TOPEKA
 AND SANTA FE RAILWAY FROM THE STATION
 AT WINCHESTER, RIVERSIDE COUNTY, AT
 MENEFEE SIDING, 198 YARDS. NW OF THE SE
 SWITCH STAND, 72 FT. E OF MILEPOST 6,
 16.5 FT. NE OF THE CENTERLINE OF THE TRACK,
 AND 4.5 FT. NW OF THE STATION SIGN. A
 STANDARD DISK, STAMPED R 327 1935 AND SET
 IN THE TOP OF A CONCRETE POST.

REF.	DESCRIPTION	APPR.	DATE	APPR.	DATE

DESIGNED BY:
 DRAWN BY:
 DATE DRAWN:

APPROVED BY:
ALBERT A. WEBB
 ASSOCIATES
 ENGINEERING CONSULTANTS
 3788 McCRAY STREET
 RIVERSIDE CA. 92506
 PH. (951) 686-1070
 FAX (951) 788-1256
 DATE: 7/8/15

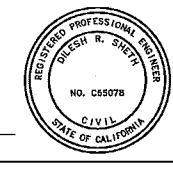

RIVERSIDE COUNTY FLOOD CONTROL
 AND
 WATER CONSERVATION DISTRICT
 RECOMMENDED FOR APPROVAL BY:
Smadell Quignis
 DATE: 7/8/15
 APPROVED BY:
Roland Hill
 DATE: 8 July 2015

COUNTY OF RIVERSIDE
 TRANSPORTATION DEPARTMENT
 APPROVED BY:
Alan French
 ALAN FRENCH
 DATE: 7-13-15

CALTRANS PERMIT # 08-14-N-DD-1090
 TRAFFIC CONTROL PLANS
 HOMELAND MDP LINE 1
 HIGHWAY 74 AND BRIGGS ROAD
 PHASE 2 - BRIGGS ROAD

PROJECT NO.
 4-0-00345
 DRAWING NO.
 4-859
 SHEET NO.
 T21 OF T23

HOMELAND MDP LINE 1, STAGE 1 TEMPORARY VIDEO DETECTION SYSTEM PLAN - PHASE 1

LEGEND

- MODIFIED 22'X6' VIDEO DETECTION ZONE
- MODIFIED 6'X6' VIDEO DETECTION ZONE
- DELINEATORS @ 20' SPACING
- K-RAIL
- DIRECTION OF TRAFFIC (NOT A PAVEMENT MARKING)
- SIGNALIZED INTERSECTION

NOTE TO CONTRACTOR:

CONTRACTOR SHALL MODIFY EXISTING EASTBOUND AND WESTBOUND VIDEO DETECTION ZONES FOR EACH PHASE OF CONSTRUCTION. ORIGINAL VIDEO DETECTION ZONES AND ADVANCE DETECTOR LOOPS SHALL BE RESTORED UPON CONSTRUCTION COMPLETION. NORTHBOUND AND SOUTHBOUND DETECTION ZONES SHALL REMAIN FROM NORMAL SIGNAL OPERATIONS.

CONTRACTOR SHALL COVER EXISTING EASTBOUND AND WESTBOUND LEFT-TURN SIGNAL HEADS FOR THE DURATION OF THIS PHASE.

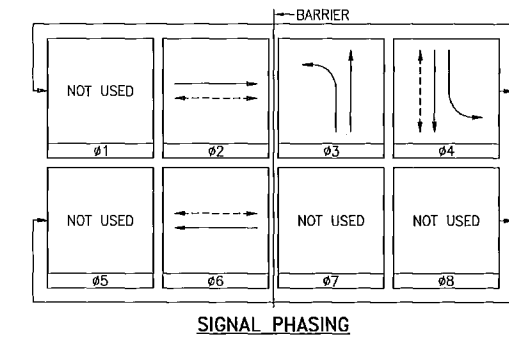
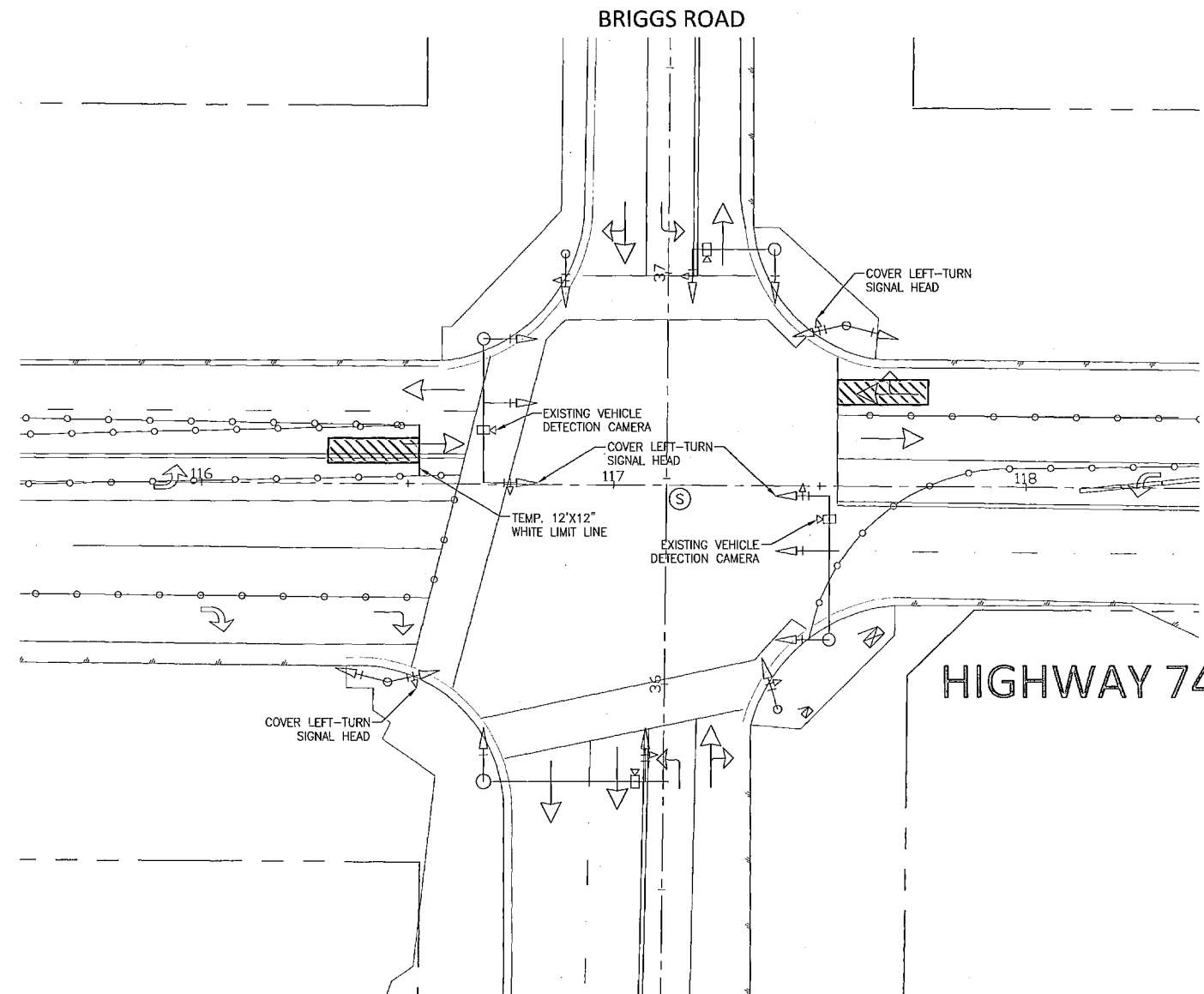

BENCHMARK
 B.M. NO. S 327-1935
 3.9 MI. NW FROM WINCHESTER
 AND SANTA FE RAILWAY FROM THE STATION
 AT WINCHESTER, RIVERSIDE COUNTY, AT
 MENEFEE SIDING, 199 YRDS. NW OF THE SE
 SWITCH STAND, 72 FT. E OF MILEPOST 6,
 16.5 FT. NE OF THE CENTERLINE OF THE TRACK,
 AND 4.5 FT. NW OF THE STATION SIGN. A
 STANDARD DISK, STAMPED R 327 1935 AND SET
 IN THE TOP OF A CONCRETE POST.

REF.	DESCRIPTION	APPR.	DATE	APPR.	DATE

DESIGNED BY:
 DRAWN BY:
 DATE DRAWN:

APPROVED BY:
ALBERT A. WEBB
 ASSOCIATES
 ENGINEERING CONSULTANTS
 3788 McCRAY STREET
 RIVERSIDE CA. 92506
 PH. (951) 686-1070
 FAX (951) 788-1256
Dilesh Sheeth
 DILESH SHEETH, RCE #65078
 DATE: 7/6/15



RIVERSIDE COUNTY FLOOD CONTROL
 AND
 WATER CONSERVATION DISTRICT
 RECOMMENDED FOR APPROVAL BY:
Smuel Guignio
 DATE: 7/8/15
 APPROVED BY:
Alan French
 DATE: 8 July 2015

COUNTY OF RIVERSIDE
 TRANSPORTATION DEPARTMENT
 APPROVED BY:
Alan French 7-13-15
 ALAN FRENCH
 DATE: 7-13-15

1" = 20'
 20 10 0 20 40 60
 CALTRANS PERMIT # 08-14-N-DD-1090

TRAFFIC CONTROL PLANS
 HOMELAND MDP LINE 1
 HIGHWAY 74 AND BRIGGS ROAD
 VIDEO DETECTION PLAN

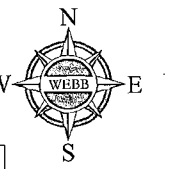

PROJECT NO.
4-0-00345
 DRAWING NO.
4-859
 SHEET NO.
T22 OF T23

HOMELAND MDP LINE 1, STAGE 1 TEMPORARY VIDEO DETECTION SYSTEM PLAN - PHASE 2

LEGEND

- MODIFIED 22'X6' VIDEO DETECTION ZONE
- MODIFIED 6'X6' VIDEO DETECTION ZONE
- DELINEATORS @ 20' SPACING
- K-RAIL
- DIRECTION OF TRAFFIC (NOT A PAVEMENT MARKING)
- SIGNALIZED INTERSECTION

NOTE TO CONTRACTOR:

CONTRACTOR SHALL MODIFY EXISTING EASTBOUND AND WESTBOUND VIDEO DETECTION ZONES FOR EACH PHASE OF CONSTRUCTION. ORIGINAL VIDEO DETECTION ZONES AND ADVANCE DETECTOR LOOPS SHALL BE RESTORED UPON CONSTRUCTION COMPLETION. NORTHBOUND AND SOUTHBOUND DETECTION ZONES SHALL REMAIN FROM NORMAL SIGNAL OPERATIONS.

CONTRACTOR SHALL COVER EXISTING EASTBOUND AND WESTBOUND LEFT-TURN SIGNAL HEADS FOR THE DURATION OF THIS PHASE.

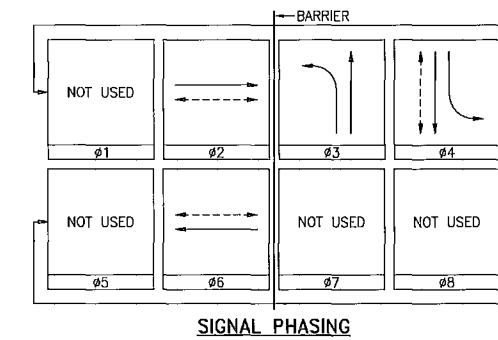
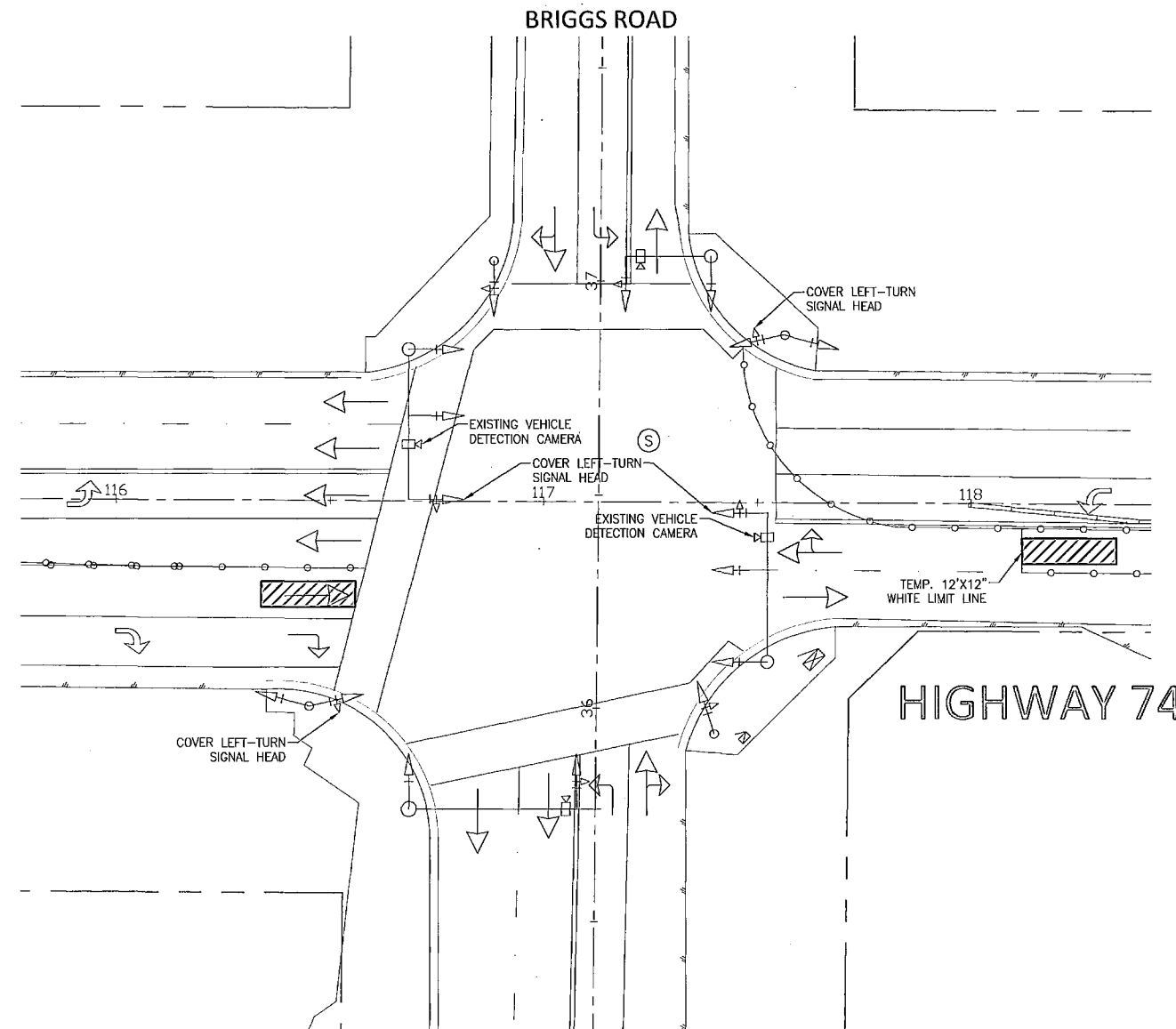

BENCHMARK
 B.M. NO. S 327-1935
 3.9 MI. NW FROM WINCHESTER
 3.0 MI. NW ALONG THE ATCHISON, TOPEKA
 AND SANTA FE RAILWAY FROM THE STATION
 AT WINCHESTER, RIVERSIDE COUNTY, AT
 MENEFEE SIDING, 193 YRDS. NW OF THE SE
 SWITCH STAND, 72 FT. E OF MILEPOST 6,
 16.3 FT. NE OF THE CENTERLINE OF THE TRACK,
 AND 4.3 FT. NW OF THE STATION SIGN, A
 STANDARD DISK, STAMPED R 327 1935 AND SET
 IN THE TOP OF A CONCRETE POST.

REF.	DESCRIPTION	APPR.	DATE	APPR.	DATE

DESIGNED BY:
 DRAWN BY:
 DATE DRAWN:

APPROVED BY:

ALBERT A. WEBB
 ASSOCIATES
 ENGINEERING CONSULTANTS
 3788 McCRAY STREET
 RIVERSIDE CA, 92506
 PH. (951) 686-1070
 FAX (951) 788-1256
 DATE: 7/8/15

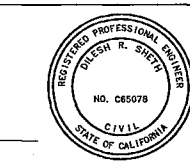

RIVERSIDE COUNTY FLOOD CONTROL
 AND
 WATER CONSERVATION DISTRICT
 RECOMMENDED FOR APPROVAL BY:

 DATE: 7/8/15
 APPROVED BY:

 DATE: 8 July 2015

COUNTY OF RIVERSIDE
 TRANSPORTATION DEPARTMENT
 APPROVED BY:

 ALAN FRENCH
 DATE: 7-13-15

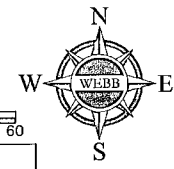
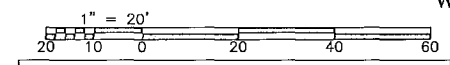

CALTRANS PERMIT # 08-14-N-DD-1090
 TRAFFIC CONTROL PLANS
 HOMELAND MDP LINE 1
 HIGHWAY 74 AND BRIGGS ROAD
 VIDEO DETECTION PLAN

PROJECT NO.
4-0-00345
 DRAWING NO.
4-859
 SHEET NO.
T23 OF T23

COUNTY OF RIVERSIDE

SR-74/BRIGGS ROAD

TRAFFIC SIGNAL MODIFICATION PLAN

TRAFFIC SIGNAL GENERAL NOTES:

1. ALL WORK DONE SHALL CONFORM TO CALTRANS STANDARD PLANS AND SPECIFICATIONS; LATEST EDITION, THE 2014 CA-MUTCD AND THIS PROJECT'S SPECIAL PROVISIONS.
2. LOCATIONS OF ALL UNDERGROUND UTILITIES ARE APPROXIMATE. THE CONTRACTOR SHALL DETERMINE THE EXACT LOCATIONS AND VERIFY ALL CONDITIONS ON THE JOB SITE PRIOR TO COMMENCING WORK. THE CONTRACTOR AGREES TO BE FULLY RESPONSIBLE FOR ANY AND ALL DAMAGES WHICH MIGHT BE OCCASIONED BY HIS FAILURE TO EXACTLY LOCATE AND PRESERVE ANY AND ALL UNDERGROUND UTILITIES. THE CONTRACTOR SHALL NOTIFY ALL CONCERNED UTILITY COMPANIES AT LEAST 48 HOURS IN ADVANCE OF EXCAVATION. CALL UNDERGROUND SERVICE ALERT AT (800) 227-2600. HAND DIG UNTIL CLEAR OR OBSTRUCTION AS DIRECTED BY THE ENGINEER.
3. SEE CALTRANS STANDARD PLANS ES-1A, ES-1B AND ES-1C FOR SYMBOL AND ABBREVIATION LEGEND.
4. EXISTING PRIVATELY OWNED IMPROVEMENTS ON PUBLIC RIGHT-OF-WAY SHALL BE PROTECTED OR REPLACED, AS DIRECTED BY THE ENGINEER.
5. THE STATE AND COUNTY RIGHT-OF-WAY SHALL BE KEPT CLEAN OF DEBRIS, WITH DUST AND OTHER NUISANCES BEING CONTROLLED AT ALL TIMES. THE CONTRACTOR SHALL BE RESPONSIBLE FOR ANY CLEAN UP ON COUNTY RIGHT-OF-WAY AFFECTED BY HIS CONSTRUCTION. METHOD OF STREET CLEANING SHALL BE DRY SWEEPING OF ALL PAVED AREAS. THERE SHALL BE NO STOCKPILING OF CONSTRUCTION MATERIALS WITHIN THE COUNTY RIGHT-OF-WAY WITHOUT THE PERMISSION OF THE INSPECTOR.
6. ALL PAVEMENT DELINEATION AND SIGN REQUIREMENTS SHALL BE COMPLETED PRIOR TO SIGNAL TURN-ON.
7. DETECTOR LOOP AND VIDEO DETECTION CAMERA INSTALLATION SHALL BE APPROVED BY THE RESIDENT ENGINEER.
8. DISTANCE TO OVERHEAD POWER LINES FROM ALL SIGNAL HEADS AND LUMINAIRES SHALL BE MIN. 10' RADIAL CLEARANCE.
9. ALL NEW PULL BOXES SHALL BE #5 UNLESS OTHERWISE INDICATED OR APPROVED BY THE ENGINEER. MAXIMUM SPACING SHALL BE 200'. PULL BOX ADJACENT TO THE CONTROLLER CABINET SHALL BE #6 WITH EXTENSION. PULL BOX SHALL BE #6 WHEN THERE ARE FOUR OR MORE CONDUITS ENTERING IT.
10. ALL SPARE CONDUCTORS SHALL BE CONTINUOUS, WITH 3' OF SLACK IN EACH PULL BOX.
11. DETECTOR LOOP CURB TERMINATIONS SHALL BE TYPE "A" PER STANDARD PLAN ES-5D.
12. A MINIMUM OF 61M OF CLEARANCE SHALL BE MAINTAINED BETWEEN TELEPHONE CONDUIT AND ELECTRICAL CONDUITS.
13. ALL PULL BOXES IN UNIMPROVED AREAS SHALL BE TRAFFIC BEARING.
14. OBTAIN APPROVAL FOR EXACT EQUIPMENT LOCATIONS PRIOR TO FINAL PLACEMENT. STRIPING LAYOUT (CAT-TRACKING) SHALL BE APPROVED PRIOR TO LOOP DETECTOR INSTALLATION.
15. ALL DETECTOR LOOPS SHALL BE ROUND 6" DIA. WITH 10' MINIMUM SPACING BETWEEN LOOPS IN THE DIRECTION OF TRAVEL AND CENTERED IN THE LANE UNLESS OTHERWISE INDICATED. LOOPS SHALL BE TESTED AND APPROVED PRIOR TO FILLING SAWCUTS.

16. ALL NEW INSTALLED CONDUITS SHALL BE PVC TYPE 3 SCHEDULE 80. ALL CONDUIT PLACED UNDER PAVING SHALL BE INSTALLED WITHOUT OPEN CUTTING.
17. ALL UNUSED TENONS SHALL BE CAPPED IN A WATERPROOF METHOD AS DIRECTED BY THE RESIDENT ENGINEER.
18. INSTALL 1#8 A.W.G. BARE GROUND IN ALL GALVANIZED RIGID STEEL CONDUITS WHICH CONTAIN SIGNAL CABLE, 1#10 A.W.G. BARE GROUND IS REQUIRED IN CONDUITS WHICH CONTAIN ONLY LOOP LEAD-IN CABLE.
19. WHERE DAMAGE TO THE STATE FACILITIES IS CAUSED BY THE CONSTRUCTION ACTIVITIES, THE CONTRACTOR SHALL AT HIS EXPENSE REPLACE DAMAGED FACILITIES PROMPTLY IN ACCORDANCE WITH APPLICABLE CALTRANS STANDARD SPECIFICATIONS.
20. CONTRACTOR SHALL ARRANGE TO HAVE A SIGNAL TECHNICIAN, QUALIFIED TO WORK ON EMERGENCY VEHICLE PRE-EMPTION (EVP) UNIT AND EMPLOYED BY THE EVP MANUFACTURER OR HIS REPRESENTATIVE, PRESENT AT THE TIME WHEN THE EQUIPMENT IS TURNED ON.
21. CONTRACTOR SHALL ARRANGE TO HAVE A SIGNAL TECHNICIAN, QUALIFIED TO WORK ON THE CONTROLLER UNIT AND EMPLOYED BY THE CONTROLLER MANUFACTURER OR HIS REPRESENTATIVE, PRESENT AT THE TIME WHEN THE EQUIPMENT IS TURNED ON.
22. SIGNAL SHUTDOWN SHALL BE LIMITED TO THE HOURS BETWEEN 9AM AND 3PM MONDAY THROUGH THURSDAY EXCEPT HOLIDAYS.
23. CALTRANS ELECTRICAL OPERATIONS (951) 383-6427 SHALL BE NOTIFIED AT LEAST 14 DAYS IN ADVANCE OF THE ANTICIPATED WORK COMPLETION.
24. SIGNAL CABLES (12CSC AND 3CSC) SHALL BE RUN UP TO THE TERMINAL COMPARTMENT, AT WHICH POINT THE OUTER JACKET SHALL BE REMOVED AND CONDUCTORS BEING USED CONNECTED TO APPROPRIATE TERMINALS. CONDUCTORS NOT BEING USED SHALL HAVE THEIR ENDS INSULATED AND LEFT IN THE TERMINAL COMPARTMENT FOR FUTURE USE.
25. WHERE DAMAGE IS CAUSED BY THE CONTRACTOR'S OPERATION, THE CONTRACTOR SHALL, AT HIS EXPENSE, REPAIR OR REPLACE DAMAGED FACILITIES PROMPTLY IN ACCORDANCE WITH STATE SPECIFICATIONS.

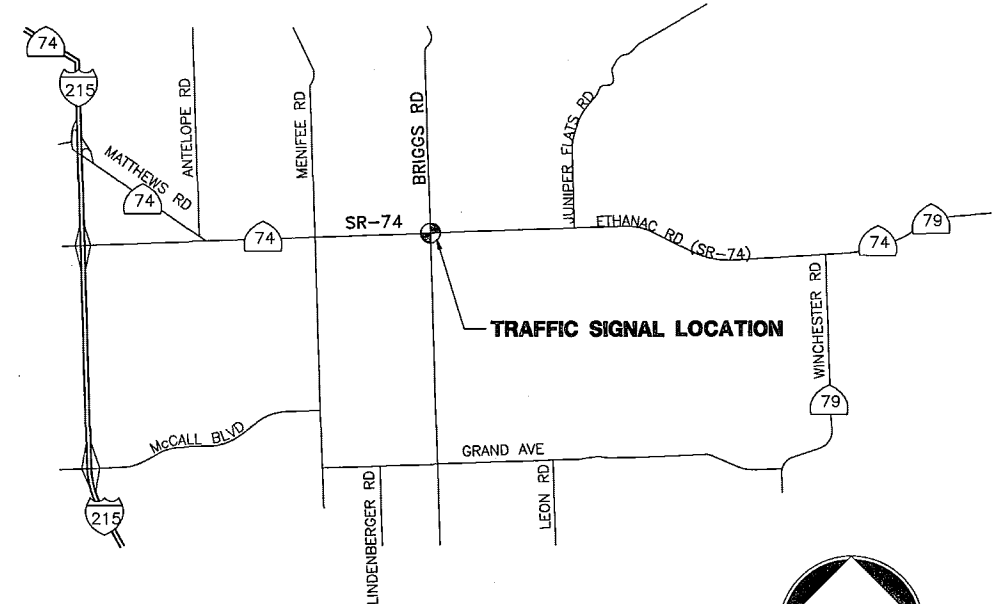

VICINITY MAP
NOT TO SCALE

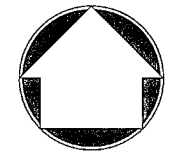

NOTICE TO CONTRACTOR

ACCORDING TO INFORMATION PROVIDED BY UNDERGROUND SERVICE ALERT (U.S.A.) DATED 6/25/2004, THE FOLLOWING ORGANIZATIONS ARE U.S.A. MEMBERS WITHIN THE PROJECT AREA:

- SOUTHERN CALIFORNIA EDISON
- SOUTHERN CALIFORNIA GAS
- VERIZON

THE EXISTENCE AND LOCATIONS OF ALL UNDERGROUND UTILITIES (UTILITY PIPES, STRUCTURES, ETC.) SHOWN ON THESE PLANS (MAIN LINES ONLY - NO SERVICE LATERALS) WERE ASCERTAINED BY A REVIEW OF RECORDS PROVIDED BY THESE MEMBER AGENCIES AND ARE APPROXIMATE. NEITHER THE OWNER NOR THE ENGINEER ASSUMES ANY RESPONSIBILITY FOR UTILITIES NOT SHOWN OR NOT IN THE LOCATION SHOWN.

THE CONTRACTOR IS REQUIRED TO TAKE DUE PRECAUTIONARY MEASURES TO PROTECT ALL UTILITIES SHOWN ON THESE PLANS AND/OR ANY OTHER UNDERGROUND UTILITIES NOT OF RECORD OR NOT SHOWN ON THESE PLANS.

CALL UNDERGROUND SERVICE ALERT (U.S.A.) 1-800-422-4133 AT LEAST 2 WORKING DAYS PRIOR TO EXCAVATION.

SHEET INDEX

1. TITLE SHEET
2. PLAN SHEET

6:\2014\14-01-42 Drawings\Design\Traffic Signal\proj7/9/2015\6-00-57PM

BENCHMARK:
B.M. NO. S 327-1935
3.9 MI. NW FROM WINCHESTER
3.9 MI. NW ALONG THE ATCHISON, TOPEKA
AND SANTA FE RAILWAY FROM THE STATION
AT WINCHESTER, RIVERSIDE COUNTY, AT
MENEFEE SIDING, 198 YRDS. NW OF THE SE
SWITCH STAND, 72 FT. E OF MILEPOST 8,
16.5 FT. NE OF THE CENTERLINE OF THE TRACK,
AND 4.5 FT. NW OF THE STATION SIGN. A
STANDARD DISK, STAMPED R 327 1935 AND SET
IN THE TOP OF A CONCRETE POST.

REF.	DESCRIPTION	APPR.	DATE	APPR.	DATE

DESIGNED BY: NRL
DRAWN BY: NRL
DATE DRAWN: 7/2015

ALBERT A. WEBB ASSOCIATES
CIVIL ENGINEERS
3788 MCCRAY STREET
RIVERSIDE, CA. 92506
PH: (951) 686-1070
FAX: (951) 788-1256

Dilesh Sheth 6/8/15
DILESH SHETH, RCE #65078 DATE:



RIVERSIDE COUNTY FLOOD CONTROL AND WATER CONSERVATION DISTRICT

RECOMMENDED FOR APPROVAL BY: *Mad M. Quignio* DATE: 7/8/15
APPROVED BY: *[Signature]* DATE: 8 July 2015

CALTRANS PERMIT # 08-14-N-DD-1090

TRAFFIC SIGNAL MODIFICATION PLANS
HIGHWAY 74 AND BRIGGS ROAD
TITLE SHEET

PROJECT NO. 4-0-00345-01
DRAWING NO. 4-859
SHEET NO. TS1 OF TS2

CONDUCTOR SCHEDULE

AWG #14	CIRCUIT	RUNS									
		1	2	3	4	5	6	7	8	9	10
12	POLE A	1	1	1	1	1	1	1	1	1	
	POLE B	1	1	1	1	1	1	1	1	1	
	POLE C	1	1	1	1	1	1	1	1	1	
	POLE D	1	1	1	1	1	1	1	1	1	
	POLE E	1	1	1	1	1	1	1	1	1	
	POLE F										1
	POLE G										1
	POLE H										1
TOTAL		1	2	3	4	5	5	3	3	2	1
12	IISNS		2	2	2	2				2	2
	TOTAL		2	2	2	2				2	2
10	LUMINAIRE	2	2	2	2	2				2	2
	TOTAL	2	2	2	2	2				2	2
8	GROUND	2	2	2	2	2	2	2	2	2	2
	TOTAL	2	2	2	2	2	2	2	2	2	2
DLC	Ø 1 DETECTOR										
	Ø 2 DETECTOR							2	2	2	2
	Ø 3 DETECTOR										
	Ø 4 DETECTOR										
	Ø 5 DETECTOR										
	Ø 6 DETECTOR					2	2	2			
	Ø 7 DETECTOR										
	Ø 8 DETECTOR										
	TOTAL					2	2	2	2	2	2
EMER. PRE-EMPT.							1	1	1		
VIDEO DETECTION	CABLE	1	1	2	2	3	3	1	1	1	
	POWER	1	1	2	2	3	3	1	1	1	
EX. CONDUIT SIZE		2"	3"	3.5"	2-3"	2-3.5"	4"	4"	4"	3"	
PROP. CONDUIT SIZE		2"	3"	3.5"	2-3"	2-3.5"	4"	4"	4"	3"	
% CONDUIT FILLED		32%	23%	27%	22%	21%	20%	21%	16%	13%	

E = EXISTING

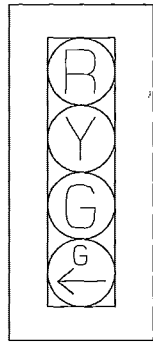

SR-74

POLE SCHEDULE

NO.	TYPE	HEIGHT	SIG. MA	LUM. MA	LUMINAIRE (HPSV)	SNS# LEGEND	SIGNAL MOUNTING		PPB	PLACEMENT		REMARKS		
							VEHICLE	PED		A	B			
A	24-4-129	30'	35'	15'	200W	Briggs Rd	MAS	MAS	SV-1-T	SP-1-T	4	EX.	EX.	EXISTING
B	1-A	10'							TV-1-T	SP-1-T	6	EX.	EX.	EXISTING
C	17-3-80	30'	20'	15'	200W	HWY 74 (IISNS)	MAS	MAS	SV-1-T		6	EX.	EX.	EXISTING
D	1-A	10'							TV-2-T	SP-1-T		EX.	EX.	EXISTING
E	24-4-129	30'	35'	15'	200W	Briggs Rd	MAS	MAS	SV-1-T	SP-1-T		EX.	EX.	EXISTING
F	1-A	10'							TV-1-T		2	EX.	EX.	EXISTING
G	26-4-161	30'	45'	15'	200W	HWY 74 (IISNS)	MAS	MAS	SV-1-T	SP-1-T	2	EX.	EX.	EXISTING
H	1-A	10'							TV-2-T	SP-1-T	4	EX.	EX.	EXISTING

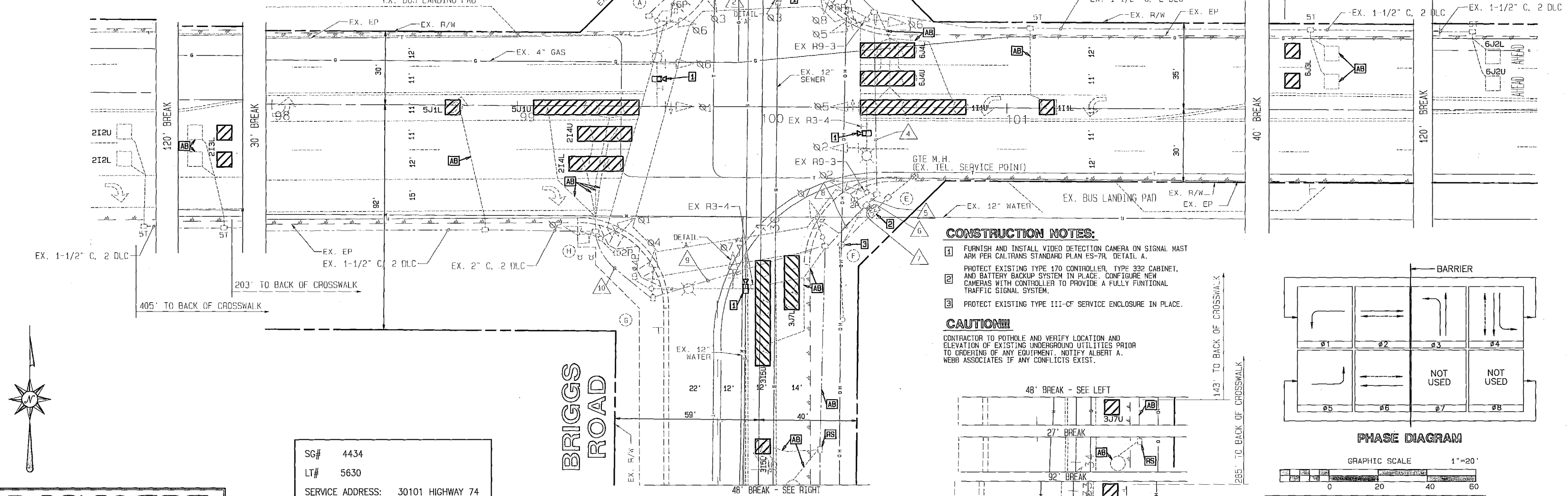

CONSTRUCTION NOTES:

- 1 FURNISH AND INSTALL VIDEO DETECTION CAMERA ON SIGNAL MAST PER CALTRANS STANDARD PLAN ES-7R, DETAIL A.
- 2 PROTECT EXISTING TYPE 470 CONTROLLER, TYPE 332 CABINET, AND BATTERY BACKUP SYSTEM IN PLACE. CONFIGURE NEW CAMERAS WITH CONTROLLER TO PROVIDE A FULLY FUNCTIONAL TRAFFIC SIGNAL SYSTEM.
- 3 PROTECT EXISTING TYPE III-CF SERVICE ENCLOSURE IN PLACE.

CAUTION!!!

CONTRACTOR TO POTHOLE AND VERIFY LOCATION AND ELEVATION OF EXISTING UNDERGROUND UTILITIES PRIOR TO ORDERING OF ANY EQUIPMENT. NOTIFY ALBERT A. WEBB ASSOCIATES IF ANY CONFLICTS EXIST.

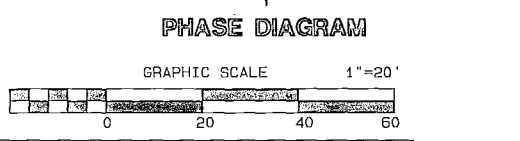
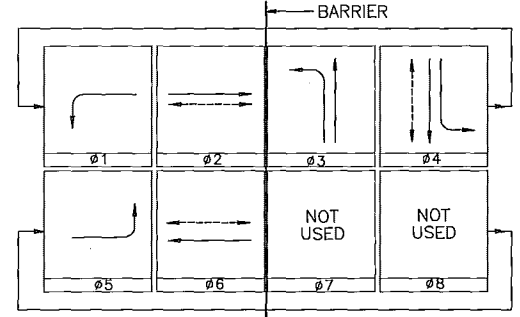

SG# 4434
 LT# 5630
 SERVICE ADDRESS: 30101 HIGHWAY 74

BENCHMARK:
 B.M. NO. S 327-1935
 3.9 MI. NW FROM WINCHESTER
 3.9 MI. NW ALONG THE ATCHISON, TOPEKA AND SANTA FE RAILWAY FROM THE STATION AT WINCHESTER, RIVERSIDE COUNTY, AT MENEFEE SIDING, 199 YRDS. NW OF THE SE SWITCH STAND, 72 FT. E OF MILEPOST 5, 16.5 FT. NE OF THE CENTERLINE OF THE TRACK, AND 4.5 FT. NW OF THE STATION SIGN, A STANDARD DISK, STAMPED R 327 1935 AND SET IN THE TOP OF A CONCRETE POST.

REF.	DESCRIPTION	APPR.	DATE	APPR.	DATE

DESIGNED BY: NRL
 DRAWN BY: NRL
 DATE DRAWN: 7/2015

ALBERT A. WEBB ASSOCIATES
 CIVIL ENGINEERS
 3788 McCRAY STREET
 RIVERSIDE, CA. 92506
 PH: (951) 686-1070
 FAX: (951) 788-1256
 DILESH SHETH, RCE #65078
 DATE: 6/15



RIVERSIDE COUNTY FLOOD CONTROL AND WATER CONSERVATION DISTRICT
 RECOMMENDED FOR APPROVAL BY: [Signature]
 DATE: 7/8/15
 APPROVED BY: [Signature]
 DATE: 8 July 2015

CALTRANS PERMIT # 08-14-N-DD-1090
 TRAFFIC SIGNAL MODIFICATION PLANS
 HIGHWAY 74 AND BRIGGS ROAD
 PLAN SHEET
 PROJECT NO. 4-0-00345-01
 DRAWING NO. 4-859
 SHEET NO. TS2 OF TS2