

FORM APPROVED COUNTY COUNSEL  
 BY: GREGORY P. PRIAMOS  
 DATE: 2/24/16

**SUBMITTAL TO THE BOARD OF SUPERVISORS  
 COUNTY OF RIVERSIDE, STATE OF CALIFORNIA**

922



**FROM:** TLMA – Transportation Department

**SUBMITTAL DATE:**  
 December 24, 2015

**SUBJECT:** Adopt Ordinance No. 452.240 to Establish Speed Zones Enforceable by Radar Speed Detection Equipment in the Cabazon, French Valley, Perris, Temecula, and Temescal Valley Areas. 1<sup>st</sup>, 3<sup>rd</sup>, and 5<sup>th</sup> Districts; [\$4,000]; Gas Tax 100%

**RECOMMENDED MOTION:** That the Board of Supervisors adopt Ordinance No. 452.240, amending Ordinance No. 452 relating to prima facie speed limits to establish various speed zones in the above-referenced areas of Riverside County.

**BACKGROUND:**

Summary

The County of Riverside Transportation Department (Transportation Department) staff has conducted Engineering and Traffic Surveys (E&TS) in accordance with the California Vehicle Code (CVC), Sections 627 and 40802, for various county-maintained roads in the Cabazon, French Valley, Perris, Temecula, and Temescal Valley areas of Riverside County.

Patricia Romo  
 Assistant Director of Transportation

Juan C. Perez  
 Director of Transportation and Land Management

LTT:DA:sa

FINANCIAL DATA	Current Fiscal Year:	Next Fiscal Year:	Total Cost:	Ongoing Cost:	POLICY/CONSENT (Per Exec. Office)
<b>COST</b>	\$ 4,000	\$ 0	\$ 0	\$ 0	Consent <input type="checkbox"/> Policy <input checked="" type="checkbox"/>
<b>NET COUNTY COST</b>	\$ 0	\$ 0	\$ 0	\$ 0	

**SOURCE OF FUNDS:** Gas Tax (100%). No General Funds used in this project.  
**Budget Adjustment:** No  
**For Fiscal Year:** 2015/2016

**C.E.O. RECOMMENDATION:**

APPROVE

BY:

Tina Grande

County Executive Office Signature

**MINUTES OF THE BOARD OF SUPERVISORS**

On motion of Supervisor Jeffries, seconded by Supervisor Ashley and duly carried, IT WAS ORDERED that the above matter is approved as recommended and that Ordinance 452.240 is adopted with waiver of the reading.

**Ayes:** Jeffries, Tavaglione, Benoit and Ashley  
**Nays:** None  
**Absent:** Washington  
**Date:** March 29, 2016  
**xc:** Transp., MC, COB

Kecia Harper-Ihem  
 Clerk of the Board  
 By: Deputy

Prev. Agn. Ref.:

District: 1,3,5

Agenda Number:

3-30

- A-30
- Positions Added
- 4/5 Vote
- Change Order

Departmental Concurrence

**SUBMITTAL TO THE BOARD OF SUPERVISORS, COUNTY OF RIVERSIDE, STATE OF CALIFORNIA**

**FORM 11:** Adopt Ordinance No. 452.240 to Establish Speed Zones Enforceable by Radar Speed Detection Equipment in the Cabazon, French Valley, Perris, Temecula, and Temescal Valley Areas. 1<sup>st</sup>, 3<sup>rd</sup>, and 5<sup>th</sup> Districts; [\$4,000]; Gas Tax 100%

**DATE:** December 24, 2015

**PAGE:** 2 of 2

**BACKGROUND:**

**Summary (continued)**

Based upon the results of the E&TS for these roads, the radar-enforceable speed limits recommended by the Transportation Department are summarized in the attached tables and have been determined to be appropriate to facilitate the safe and orderly movement of vehicular traffic.

Transportation Department staff has contacted the Riverside, Temecula, and San Geronio area offices of the California Highway Patrol (CHP) regarding the recommended speed zones.

The Ordinance amendment has been reviewed and approved by County Counsel as to form.

**Impact on Residents and Businesses**

The establishing and posting of appropriate speed limits promote safe and orderly movements of vehicular traffic and enable the CHP to use radar equipment to enforce the speed limits. Since the recommended speed limits were determined based on actual speed surveys, the majority of the motorists are already driving at or below the recommended speed limits. Posted speed limits also guide motorists to drive at a reasonable speed in unfamiliar locations.

**SUPPLEMENTAL:**

**Additional Fiscal Information**

The cost for establishing the recommended speed limits is primarily for the installation of speed limit signs, which is estimated at about \$4,000.

**Contract History and Price Reasonableness**

N/A

**ATTACHMENTS**

- Vicinity Maps
- Ordinance No. 452.240
- List of Speed Zone Submittals
- Speed Zone Diagrams



1                   “3.     On Borel Road between Sky Canyon Drive and Leon Road, a total  
2                   distance of approximately 1.20 miles, in the French Valley area.

3                   4.     On Leon Road between Borel Road and Auld Road, a total distance  
4                   of approximately 0.76 miles, in the French Valley area.”

5                   Section 6.     Subsection 70 of Section 2.5 of Ordinance 452 adopted on February 4,  
6 2003, pursuant to Ordinance No. 452.214, is repealed in its entirety. Subsection 70 of Section 2.5  
7 established a forty-five miles per hour speed limit on Seminole Drive between the centerline of Fields  
8 Road and the centerline of Apache Trail.

9                   Subsection 68 of Section 2.4 of Ordinance 452 adopted on August 26, 2003, pursuant to  
10 Ordinance No. 452.216, is repealed in its entirety. Subsection 68 of Section 2.4 established a forty miles  
11 per hour speed limit on Willows Avenue between Winchester Road and Town View Avenue.

12  
13                   Section 7.     This ordinance shall take effect 30 days after its adoption.

14  
15                   BOARD OF SUPERVISORS OF THE COUNTY  
16                   OF RIVERSIDE, STATE OF CALIFORNIA

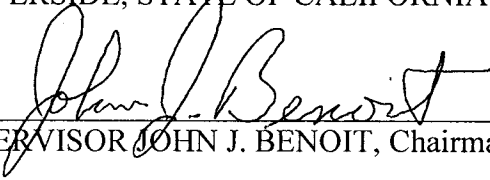
17                   BY:   
18                   SUPERVISOR JOHN J. BENOIT, Chairman

19                   ATTEST:  
20                   KECIA HARPER-IHEM, Clerk of the Board

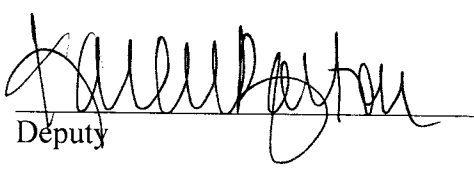
21                   By:   
22                   Deputy

23  
24                   APPROVED AS TO FORM:  
25                   GREGORY P. PRIAMOS, County Counsel

26  
27                   By:  1/21/14  
28                   Deputy Kristine Bell-Valdez

1  
2  
3  
4  
5  
6  
7  
8  
9  
10  
11  
12  
13  
14  
15  
16  
17  
18  
19  
20  
21  
22  
23  
24  
25  
26  
27  
28

STATE OF CALIFORNIA        )  
                                          )  
COUNTY OF RIVERSIDE        )        SS

I HEREBY CERTIFY that at a regular meeting of the Board of Supervisors of said county held on March 29, 2016, the foregoing ordinance consisting of 7 Sections was adopted by the following vote:

AYES:                   Jeffries, Tavaglione, Benoit and Ashley  
NAYS:                   None  
ABSENT:                 Washington

DATE:            March 29, 2016

KECIA HARPER-IHEM  
Clerk of the Board  
BY: *[Signature]*  
Deputy

SEAL

ORDINANCE 452.240 DISTRICT 1 SPEED ZONE VICINITY MAP

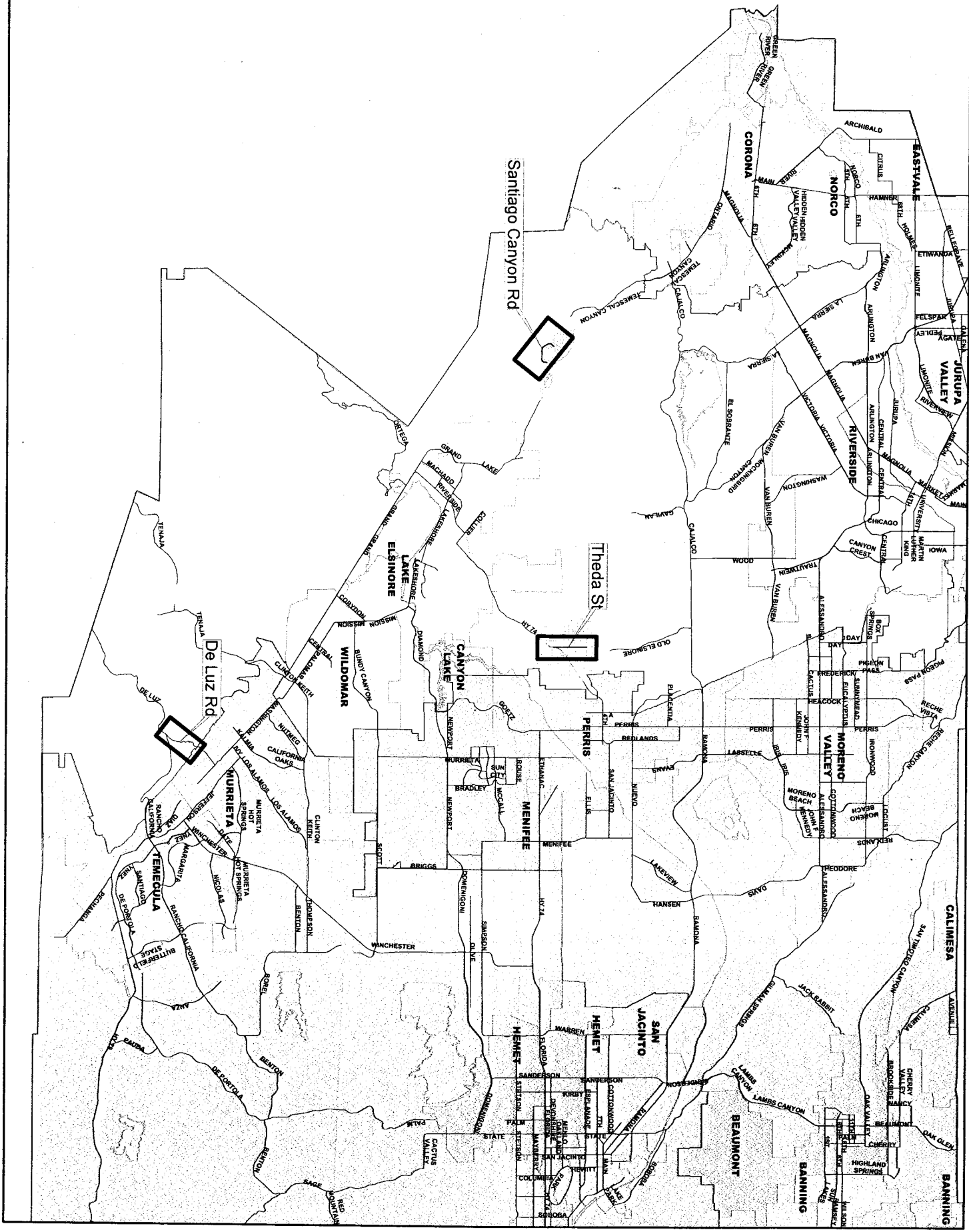

ORDINANCE 452.240 DISTRICT 3 SPEED ZONE VICINITY MAP

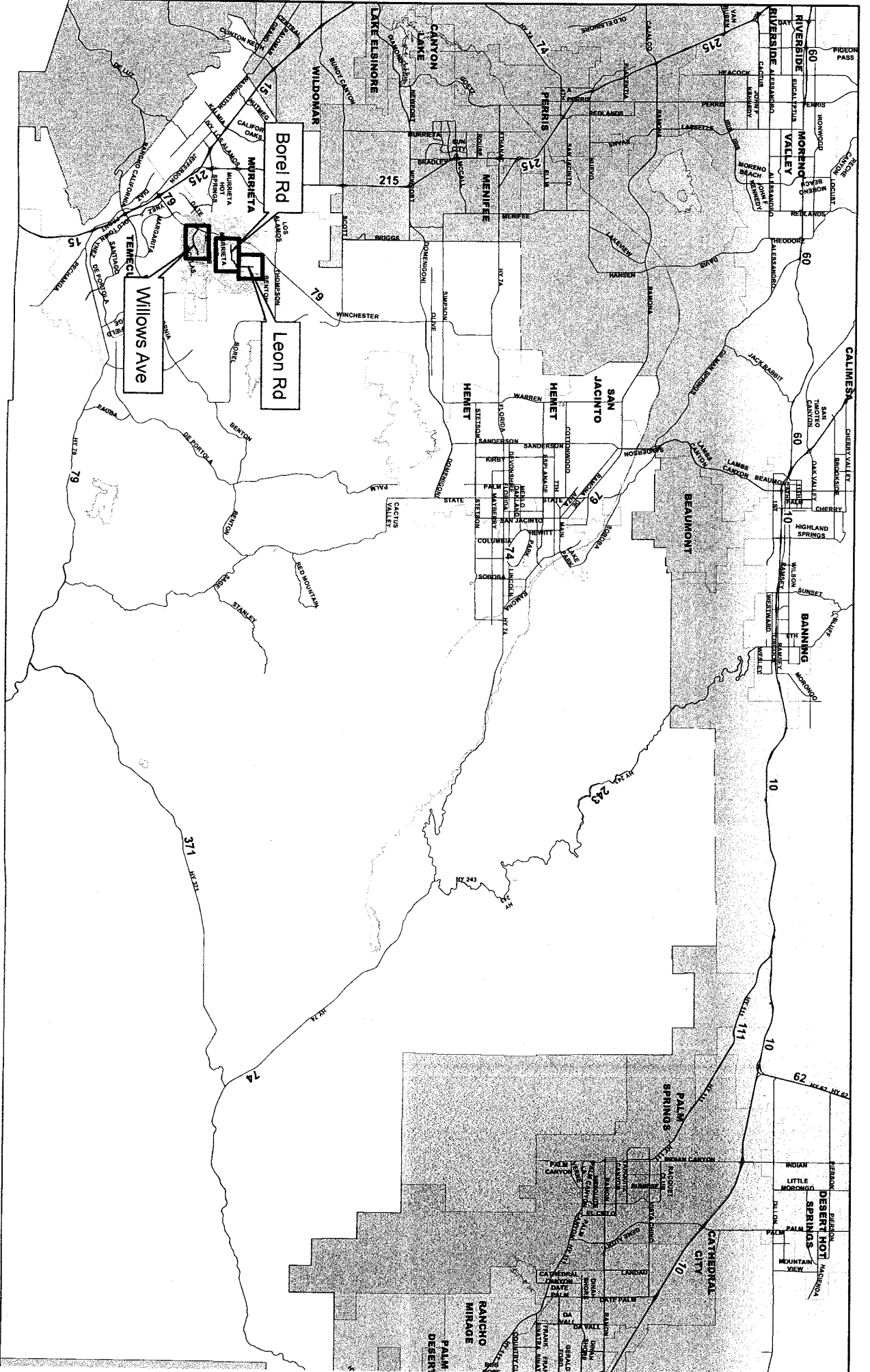

ORDINANCE 452.240 DISTRICT 5 SPEED ZONE VICINITY MAP

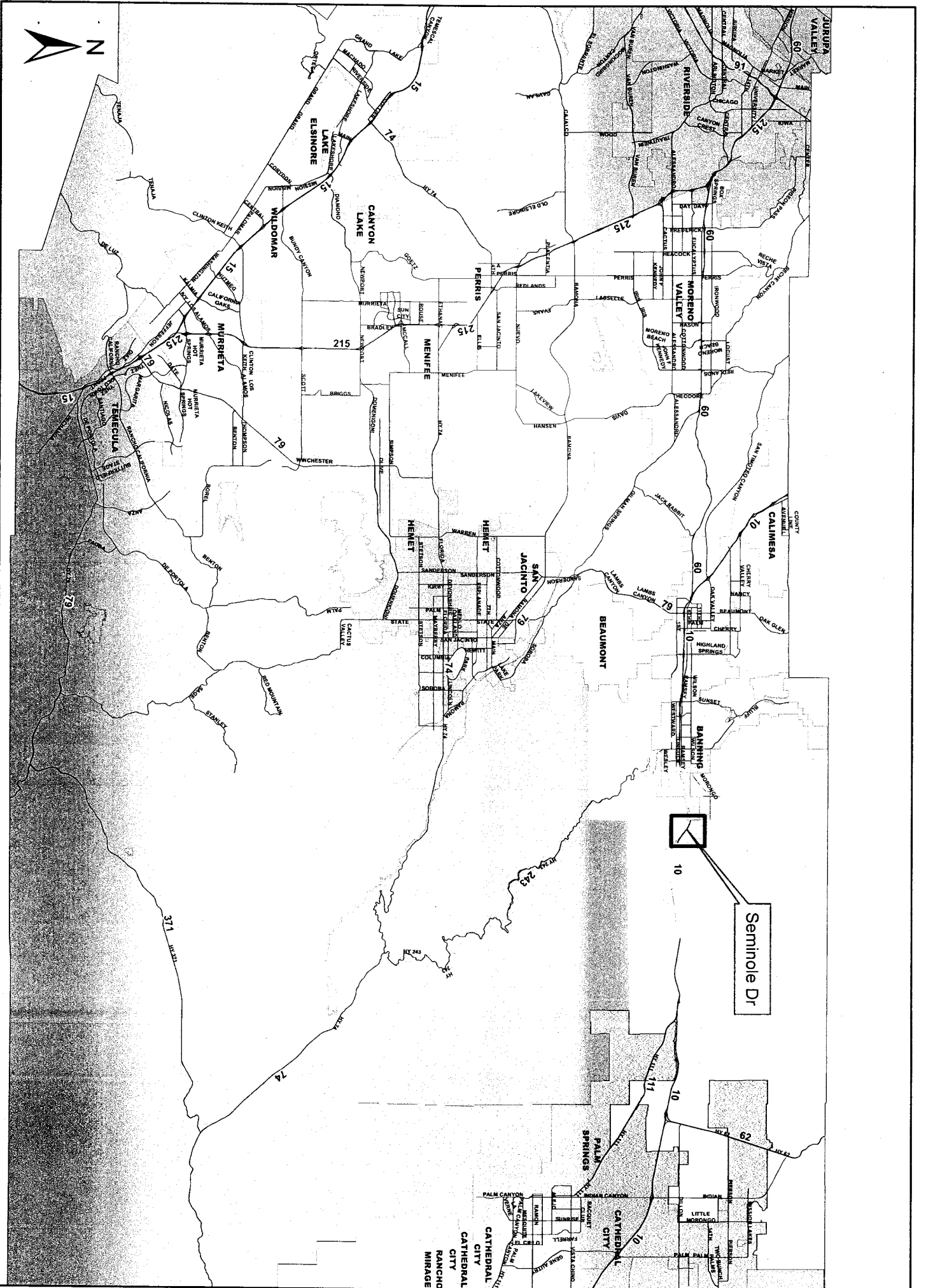



**LIST OF SPEED ZONE SUBMITTALS  
ORDINANCE AMENDMENT NO 452.240  
SUPERVISORIAL DISTRICT NO. 1**

AREA	ROAD NAME/ LIMITS	EXISTING SPEED LIMIT	PROPOSED SPEED LIMIT	NOTES
TEMECULA	<b>DE LUZ ROAD</b> Between Rancho California Road and a point 2,785 feet north of Via Medeiros	Not Posted <sup>^</sup>	20	NEW
TEMESCAL VALLEY	<b>SANTIAGO CANYON ROAD</b> Between Mayhew Canyon Road and De Palma Road	Not Posted*	30	NEW
PERRIS	<b>THEDA STREET</b> Between SH-74 and Ellis Avenue	Not Posted*	40	NEW

- \* Maximum allowable speed limit for a two-lane highway is 55 mph
- \*\*Maximum allowable speed limit for a multi-lane highway is 65 mph
- \*\*\*Change in speed zone boundary
- ^ Existing county-maintained dirt road

**LIST OF SPEED ZONE SUBMITTALS  
ORDINANCE AMENDMENT NO 452.240  
SUPERVISORIAL DISTRICT NO. 3**

AREA	ROAD NAME/ LIMITS	EXISTING SPEED LIMIT	PROPOSED SPEED LIMIT	NOTES
FRENCH VALLEY	<b>BOREL ROAD</b> Between Sky Canyon Drive and Leon Road	Not Posted <sup>^</sup>	25	NEW
FRENCH VALLEY	<b>LEON ROAD</b> Between Borel Road and Auld Road	Not Posted <sup>^</sup>	25	NEW
TEMECULA	<b>WILLOWS AVENUE</b> Between Winchester Road/SH-79 and Golden Rod Road	40	35	SPEED LIMIT REDUCTION



- \* Maximum allowable speed limit for a two-lane highway is 55 mph
- \*\*Maximum allowable speed limit for a multi-lane highway is 65 mph
- \*\*\*Change in speed zone boundary
- ^ Existing county-maintained dirt road

**LIST OF SPEED ZONE SUBMITTALS  
ORDINANCE AMENDMENT NO 452.240  
SUPERVISORIAL DISTRICT NO. 5**

AREA	ROAD NAME/ LIMITS	EXISTING SPEED LIMIT	PROPOSED SPEED LIMIT	NOTES
CABAZON	<b>SEMINOLE DRIVE</b> Between Malki Road and Morongo Trail	45	40	SPEED LIMIT REDUCTION

- \* Maximum allowable speed limit for a two-lane highway is 55 mph
- \*\*Maximum allowable speed limit for a multi-lane highway is 65 mph
- \*\*\*Change in speed zone boundary

LEGEND:

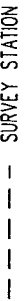
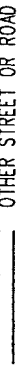
-  CITY LIMITS
-  RADAR ZONE
-  SURVEY STATION
-  OTHER STREET OR ROAD

# DE LUZ ROAD (#1562)

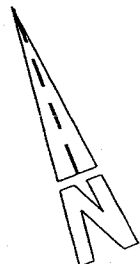
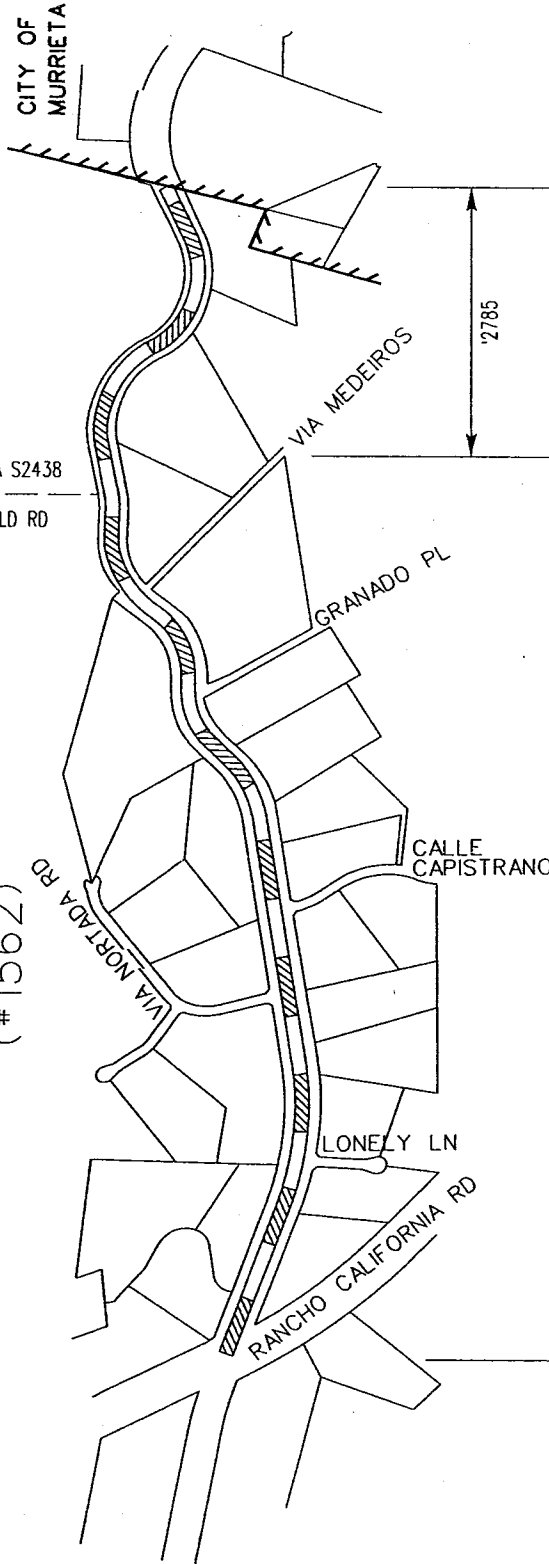

NO SCALE

BEGIN ZONE

END ZONE

★ 25 MPH PER CVC 22365	COUNTY MAINTAINED DIRT ROAD
RECOMMENDED SPEED LIMIT	★ 20 MPH
85th%TILE SPEED	N/A
VEHICLES IN 24 HR (2 WAY)	385
SEGMENT LENGTH	1.48 MILE
ALL ACCIDENTS IN 2 YRS.	0
ACCIDENT RATE ★	00.00 ACC/MVM
EXISTING SPEED LIMIT	NOT POSTED

★ RATE:  $\frac{\text{NO. OF ACCIDENT} \times 1,000,000}{\text{VEH} \times 365 \times 2 \times \text{MILE}}$

APPROVED BY: *Lawrence T. Talpe*  
 DATE: 12/10/2015  
**LAWRENCE T. TALPE**  
 COUNTY TRAFFIC ENGINEER

COUNTY OF RIVERSIDE  
**TRANSPORTATION DEPARTMENT**  
 TRAFFIC ENGINEERING DIVISION





ENGINEERING AND TRAFFIC SURVEY  
 AT  
**DE LUZ ROAD**

PAGE 1 OF 1

STUDY DATE: NOV 4, 2015  
 MAP DATE: DEC 10, 2015  
 DRAWN BY: J VALADEZ  
 CAD FILE: DE LUZ RD.DGN

COUNTY AREA: TEMECULA  
 COUNTY MAP: 82, 84A  
 SUPERVISOR DISTRICT: 1/1

LEGEND:

-  CITY LIMITS
-  RADAR ZONE
-  SURVEY STATION
-  OTHER STREET OR ROAD

SURVEY STA S2398  
900' S/O MAYHEW CYN RD

SURVEY STA S2400  
150' W/O VIOLA CIR

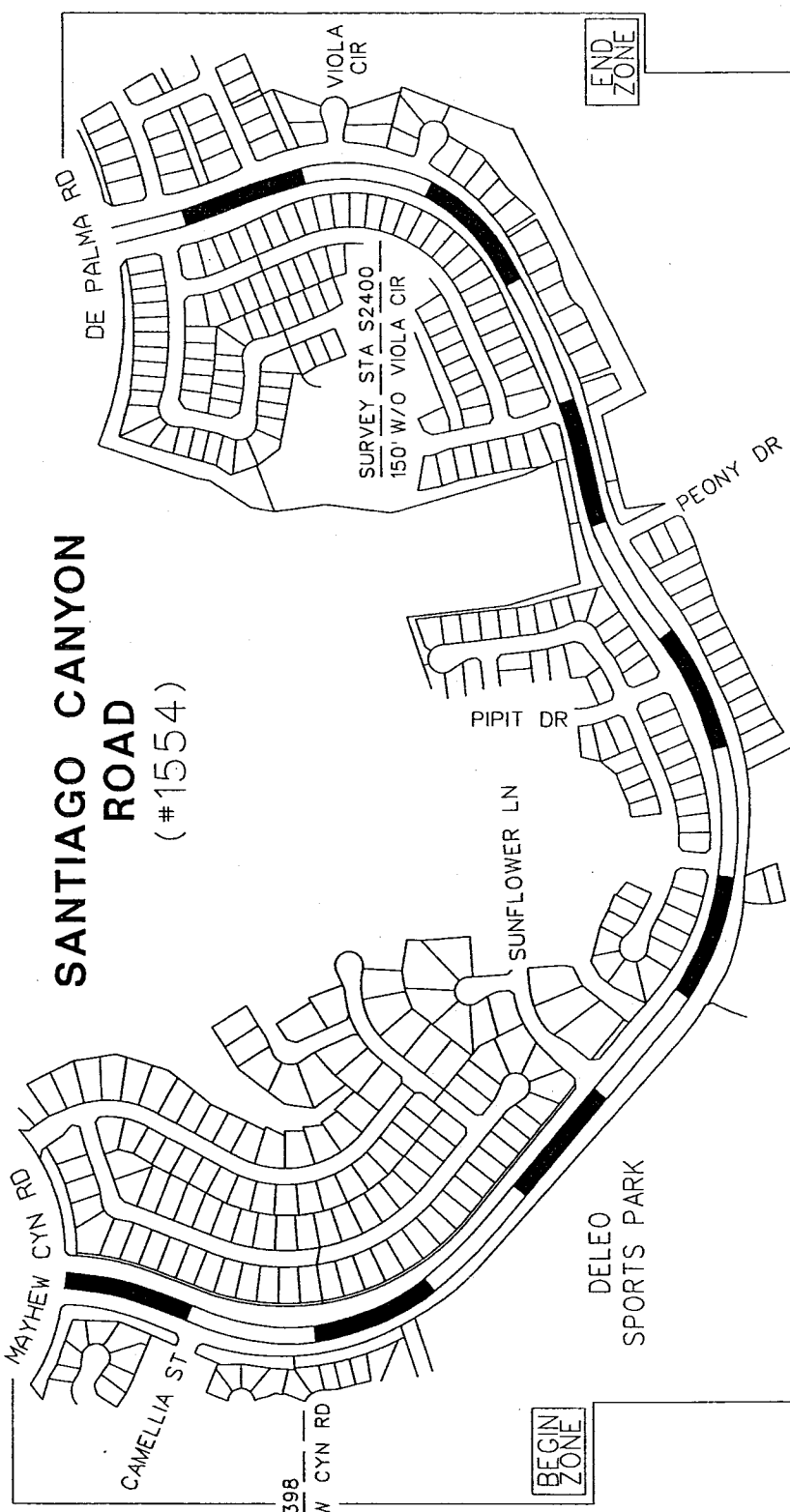

END ZONE

BEGIN ZONE

NO SCALE

RECOMMENDED SPEED LIMIT	30 MPH
85th%TILE SPEED	35.5 MPH (AVERAGE OF TWO SIMILAR SEGMENTS 36.0 & 35.0)
VEHICLES IN 24 HR (2 WAY)	1,275
SEGMENT LENGTH	1.3 MILE
ALL ACCIDENTS IN 2 YRS.	0
ACCIDENT RATE ☆	0.00 ACC/MVM
EXISTING SPEED LIMIT	NOT POSTED

☆ RATE: NO. OF ACCIDENT x 1,000,000  
VEH x 365 x 2 x MILE

COUNTY AREA:	TEMESCAL VALLEY	SURVEY DATE:	JUL 1, 2015
COUNTY MAP:	33-1	MAP DATE:	AUG 10, 2015
SUPERVISOR DISTRICT:	1/1	DRAWN BY:	N AHMAD
		CAD FILE:	SANTIAGO_CYN.DGN

APPROVED BY: *Lawrence T. Tai*  
DATE: 8/26/15

COUNTY OF RIVERSIDE  
**TRANSPORTATION DEPARTMENT**  
TRAFFIC ENGINEERING DIVISION

ENGINEERING AND TRAFFIC SURVEY  
AT  
**SANTIAGO CANYON ROAD**

.PAGE 1 OF 1

# THEDA STREET (#1556)

- LEGEND:
- CITY LIMITS
  - RADAR ZONE
  - SURVEY STATION
  - OTHER STREET OR ROAD
  - SCHOOL

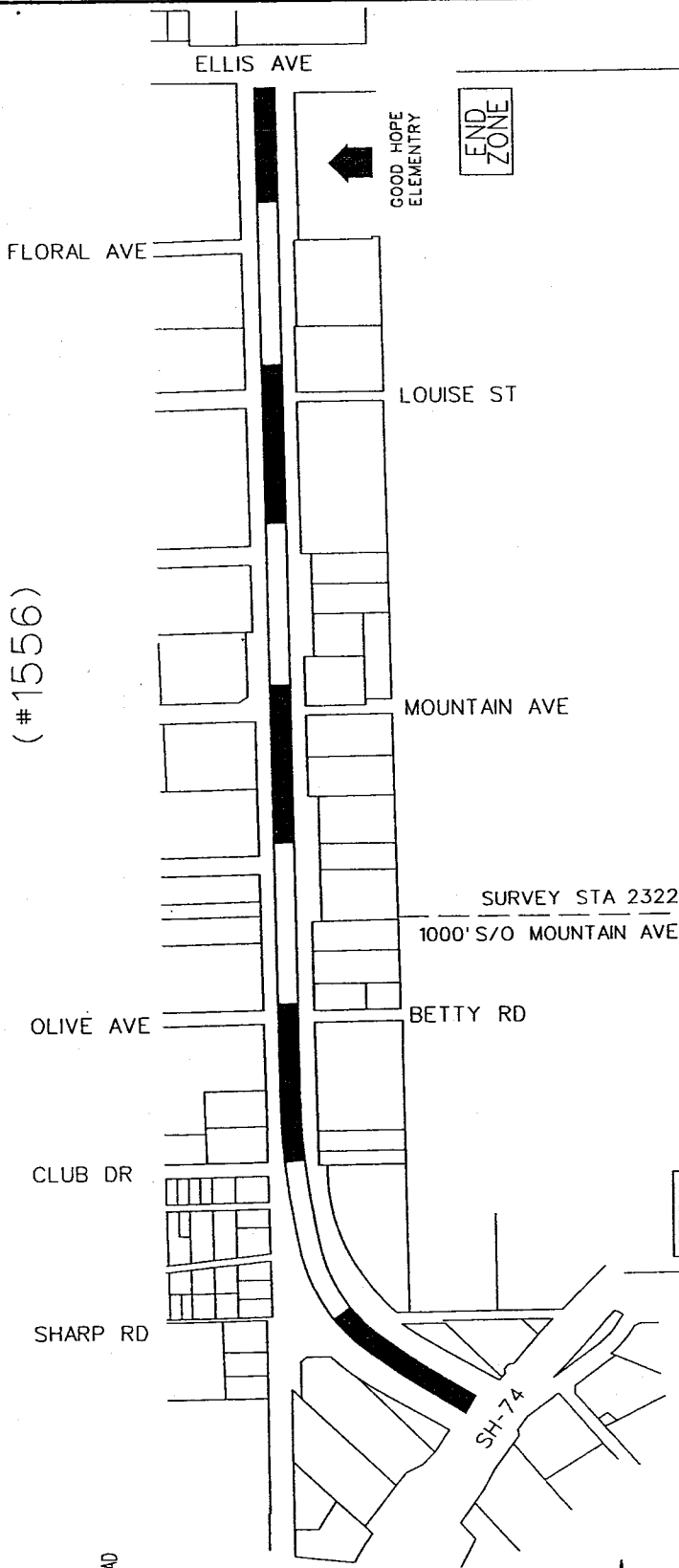

RECOMMENDED SPEED LIMIT	40 MPH
85th% TILE SPEED	43.0 MPH
VEHICLES IN 24 HR (2 WAY)	3,200
SEGMENT LENGTH	1.1 MI
ALL ACCIDENTS IN 2 YRS.	3
ACCIDENT RATE ★	1.17 ACC/MVM
EXISTING SPEED LIMIT	NOT POSTED

★ RATE:  $\frac{\text{NO. OF ACCIDENT} \times 1000,000}{\text{VEH} \times 365 \times 2 \times \text{MILE}}$

COUNTY AREA:	PERRIS	SURVEY DATE:	SEP 9, 2015
COUNTY MAP:	63A	MAP DATE:	NOV 9, 2015
SUPERVISOR DISTRICT:	5/1	DRAWN BY:	J VALADEZ
		CAD FILE:	THEDA_ST.DGN

APPROVED BY: *Lawrence T. Tai*  
 DATE: 11/16/2015  
 LAWRENCE T. TAI, P.E.  
 COUNTY TRAFFIC ENGINEER

LEGEND:

- ////// CITY LIMITS
- ////// RADAR ZONE
- SURVEY STATION
- ==== OTHER STREET OR ROAD

# BOREL ROAD (#1558)

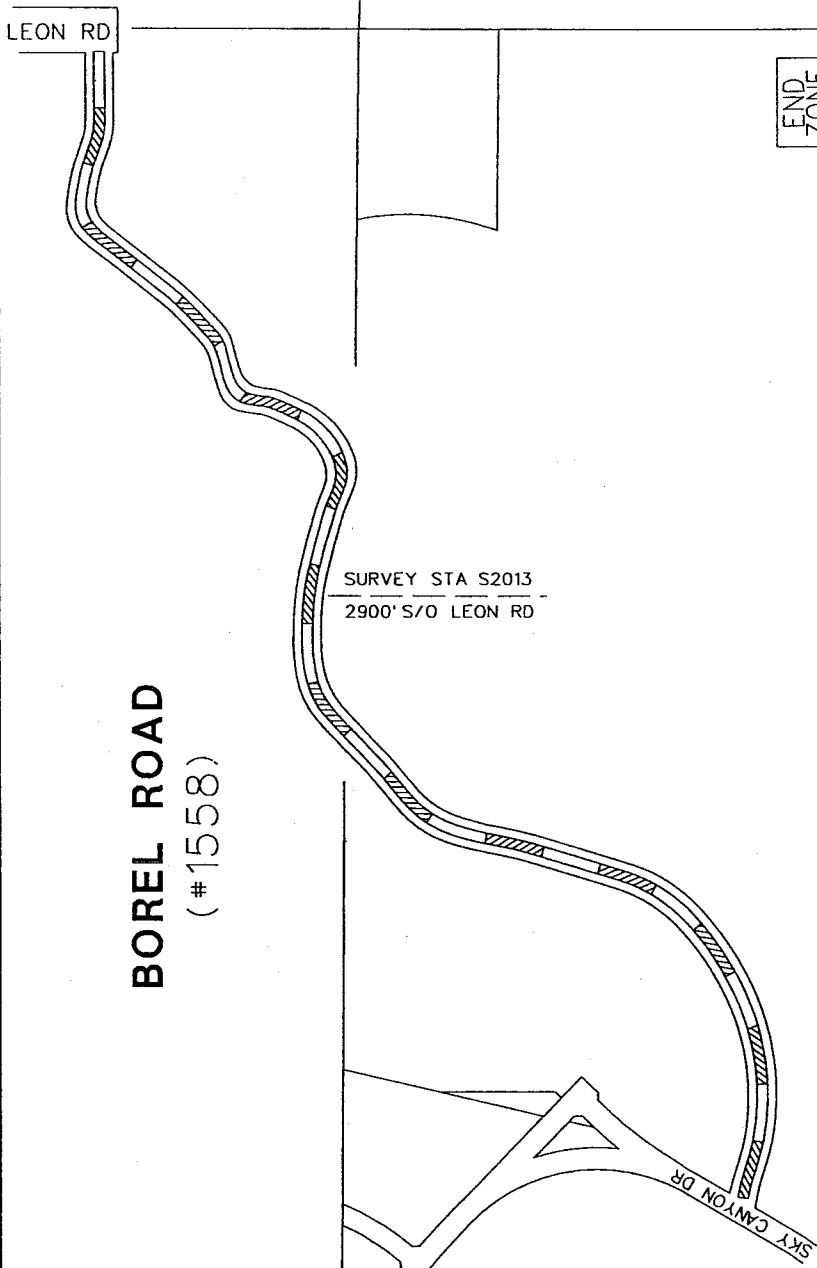

BEGIN ZONE

END ZONE

NO SCALE

*PRIMA FACIE 25 MPH PER CVC 22365	COUNTY MAINTAINED DIRT ROAD
RECOMMENDED SPEED LIMIT	* 25 MPH
85th% TILE SPEED	N/A
VEHICLES IN 24 HR (2 WAY)	103
SEGMENT LENGTH	1.2 MILE
ALL ACCIDENTS IN 2 YRS.	2
ACCIDENT RATE ★	22.1 ACC/MVM
EXISTING SPEED LIMIT	NOT POSTED

★ RATE =  $\frac{\text{NO. OF ACCIDENT} \times 1,000,000}{\text{VEH} \times 365 \times 2 \times \text{MILE}}$

APPROVED BY: *Lawrence T. Tai, P.E.*  
 DATE: 12/10/2015  
**LAWRENCE T. TAI, P.E.**  
 COUNTY TRAFFIC ENGINEER

STUDY DATE: NOV 4, 2015  
 MAP DATE: DEC 2, 2015  
 DRAWN BY: J VALADEZ  
 CAD FILE: BOREL RD.DGN

COUNTY AREA: FRENCH VALLEY  
 COUNTY MAP: 124C  
 SUPERVISOR DISTRICT: 3/3

LEGEND:

- ////// CITY LIMITS
- ▨ RADAR ZONE
- - - SURVEY STATION
- ==== OTHER STREET OR ROAD

# LEON ROAD

(#1560)

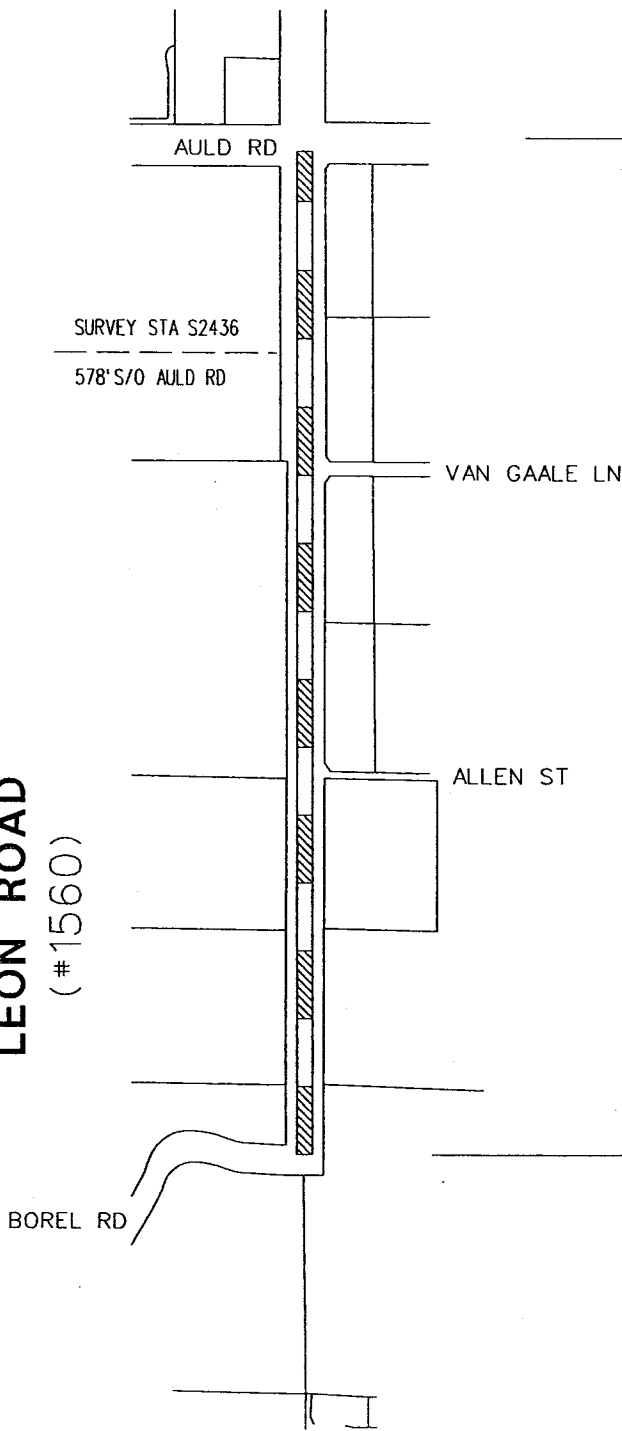

BEGIN ZONE

END ZONE

\* 25 MPH PER CVC 22365

COUNTY MAINTAINED DIRT ROAD

RECOMMENDED SPEED LIMIT

\* 25 MPH

85th% TILE SPEED

N/A

VEHICLES IN 24 HR (2 WAY)

130

SEGMENT LENGTH

0.76 MILE

ALL ACCIDENTS IN 2 YRS.

0

ACCIDENT RATE ★

00.00 ACC/MVM

EXISTING SPEED LIMIT

NOT POSTED

★ RATE: NO. OF ACCIDENT x 1000 000  
VEH x 365 x 2 x MILE

COUNTY AREA: FRENCH VALLEY

STUDY DATE: NOV 4, 2015

COUNTY MAP: 124B, 124C

MAP DATE: DEC 9, 2015

SUPERVISOR DISTRICT: 3/3

DRAWN BY: J VALADEZ

CAD FILE: LEON RD.DGN

COUNTY OF RIVERSIDE  
**TRANSPORTATION DEPARTMENT**  
TRAFFIC ENGINEERING DIVISION

ENGINEERING AND TRAFFIC SURVEY  
AT

**LEON ROAD**

APPROVED BY:

*Lawrence T. Tai*

DATE: 12/10/2015

LAWRENCE T. TAI, P.E.  
COUNTY TRAFFIC ENGINEER



PAGE

1 OF 1



SEE SHEET  
2 OF 2

# WILLOWS AVENUE (#1363)

- LEGEND:
- CITY LIMITS
  - RADAR ZONE
  - SURVEY STATION
  - OTHER STREET OR ROAD
  - SCHOOL

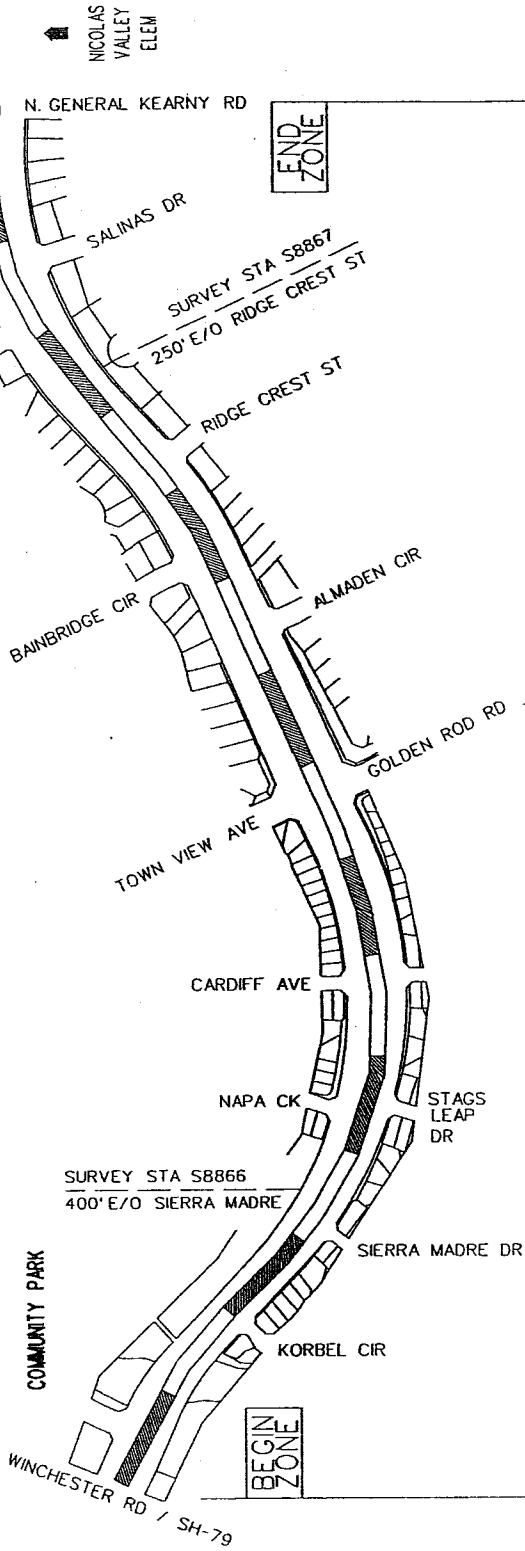

RECOMMENDED SPEED LIMIT	35 MPH	35 MPH
85th % TILE SPEED	37.0 MPH	38.0 MPH
VEHICLES IN 24 HR (2 WAY)	4,745	2,775
SEGMENT LENGTH	0.63 MILE	0.4 MILE
ALL ACCIDENTS IN 2 YRS.	2	1
ACCIDENT RATE ☆	0.92 ACC/MVM	1.23 ACC/MVM
EXISTING SPEED LIMIT	40 MPH (Ord. 452.216 Sec. 2.4 No. 68)	35 MPH (Ord. 452.214 Sec. 2.3 No. 60)

☆ RATE: NO. OF ACCIDENT x 1,000,000  
VEH x 365 x 2 x MILE

COUNTY AREA:	TEMECULA	SURVEY DATE:	JAN 27, 2015
COUNTY MAP:	128A, 128B	MAP DATE:	APR 10, 2015
SUPERVISOR DISTRICT:	3/3	DRAWN BY:	N AHMAD
		CAD FILE:	WILLOWS.DGN

APPROVED BY: *Lawrence T. Tai*  
DATE: 10/8/2015  
LAWRENCE T. TAI, P.E.  
COUNTY TRAFFIC ENGINEER

COUNTY OF RIVERSIDE  
TRANSPORTATION DEPARTMENT  
TRAFFIC ENGINEERING DIVISION

ENGINEERING AND TRAFFIC SURVEY  
AT  
**WILLOWS AVENUE**

PAGE 1 OF 2

# SEMINOLE DRIVE

(#1335)

- LEGEND:
- ////// CITY LIMITS
  - ▬ RADAR ZONE
  - - - SURVEY STATION
  - ▬ OTHER STREET OR ROAD

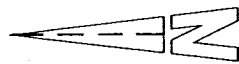

NO SCALE

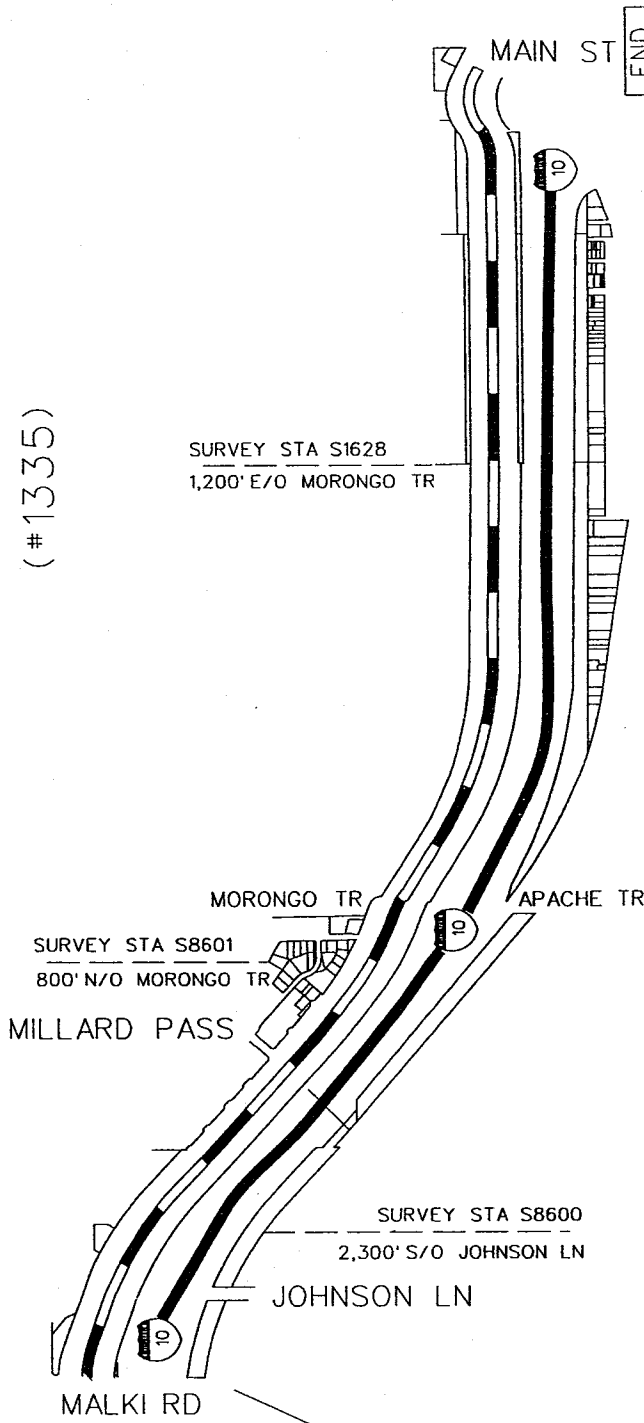

RECOMMENDED SPEED LIMIT	40 MPH	50 MPH
PREVAILING SPEED (85%th)	41.5 MPH (AVERAGE OF 45.0 & 38.0 MPH)	51.3 MPH
VEHICLES IN 24 HR (2 WAY)	6,100	7,609
SEGMENT LENGTH	1.2 MILE	2.1 MILE
ALL ACCIDENTS IN 2 YRS.	18	18
ACCIDENT RATE ☆	3.37 ACC/MVM	1.54 ACC/MVM
EXISTING SPEED LIMIT	45 MPH (Ord. 452.214 Sec. 2.5 No. 70)	50 MPH (Ord. 452.214 Sec. 2.6 No. 30)

☆ RATE =  $\frac{\text{ACCIDENT} \times 1,000,000}{\text{VEH} \times 365 \times 2 \times \text{MILE}}$

APPROVED BY:

*Lawrence T. Tai*  
DATE: 12/16/2015

LAWRENCE T. TAI, P.E.  
COUNTY TRAFFIC ENGINEER

SURVEY DATE:	FEB 20, 2014
MAP DATE:	NOV 5, 2015
DRAWN BY:	J VALADEZ
CAD FILE:	SEMINOLE.DGN

COUNTY AREA:	CABAZON
COUNTY MAP:	139, 140A
SUPERVISOR DISTRICT:	5/5



COUNTY OF RIVERSIDE  
TRANSPORTATION DEPARTMENT  
TRAFFIC ENGINEERING DIVISION

ENGINEERING AND TRAFFIC SURVEY  
AT

SEMINOLE DRIVE



OFFICE OF  
CLERK OF THE BOARD OF SUPERVISORS  
1st FLOOR, COUNTY ADMINISTRATIVE CENTER  
P.O. BOX 1147, 4080 LEMON STREET  
RIVERSIDE, CA 92502-1147  
PHONE: (951) 955-1060  
FAX: (951) 955-1071

KECIA HARPER-IHEM  
Clerk of the Board of Supervisors

KIMBERLY A. RECTOR  
Assistant Clerk of the Board

April 4, 2016

THE PRESS ENTERPRISE  
ATTN: LEGALS  
P.O. BOX 792  
RIVERSIDE, CA 92501

TEL: (951) 368-9225  
E-MAIL: [legals@pe.com](mailto:legals@pe.com)

RE: ADOPTION OF ORDINANCE NO. 452.240

To Whom It May Concern:

Attached is a copy for publication in your newspaper for **ONE (1) TIME** on **Thursday, April 7, 2016.**

We require your affidavit of publication immediately upon completion of the last publication.

Your invoice must be submitted to this office, **WITH TWO CLIPPINGS OF THE PUBLICATION.**

NOTE: PLEASE COMPOSE THIS PUBLICATION INTO A SINGLE COLUMN FORMAT.

Thank you in advance for your assistance and expertise.

Sincerely,

*Cecilia Gil*

Board Assistant to:  
KECIA HARPER-IHEM, CLERK OF THE BOARD

Printed at: 9:22 am  
On: Monday, Apr 04, 2016

Ad #: 0010152454  
Order Taker: neller

# THE PRESS-ENTERPRISE

## Classified Advertising

### Proof

1825 Chicago Ave, Suite 100  
Riverside, CA 92507  
(951) 684-1200  
(800) 514-7253  
(951) 368-9018 Fax

#### Account Information

Phone #: 951-955-1066  
Name: BOARD OF SUPERVISORS  
Address: COUNTY OF RIVERSIDE  
P.O. BOX 1147  
RIVERSIDE, CA 92502

Account #: 1100141323  
Client:  
Placed By: Cecilia Gil  
Fax #:

#### Ad Information

Placement: Legal Liner PE P2W  
Publication: PE Riverside, PE.com

Start Date: 04/07/2016  
Stop Date: 04/07/2016  
Insertions: 1 print / 1 online

Rate code: County Ad Lgl-PE  
Ad type: C Legal

Size: 2 X 76 Li  
Bill Size: 152.00

Amount Due: \$220.40

#### Ad Copy:

BOARD OF SUPERVISORS OF THE COUNTY OF  
RIVERSIDE, STATE OF CALIFORNIA

ORDINANCE NO. 452.240  
AN ORDINANCE OF THE COUNTY OF RIVERSIDE  
AMENDING ORDINANCE NO. 452

The Board of Supervisors of the County of Riverside or-  
dains as follows:

Section 1. Section 2.2 of Ordinance No. 452, entitled  
"Thirty miles per hour," is hereby amended to add new  
subsection 32 to read as follows:

"32. On Santiago Canyon Road between Mayhew  
Canyon Road and De Palma Road, a total dis-  
tance of approximately 1.30 miles, in the  
Temescal Valley area."

Section 2. Section 2.3 of Ordinance No. 452, entitled  
"Thirty-five miles per hour," is hereby amended to add  
new subsection 130 to read as follows:

"130. On Willows Avenue between Winchester  
Road/SH-79 and Golden Rod Road, a total dis-  
tance of approximately 0.63 miles, in the  
Temecula area."

Section 3. Section 2.4 of Ordinance 452, entitled "For-  
ty miles per hour," is hereby amended to add new sub-  
sections 148 and 149 to read as follows:

"148. On Seminole Drive between Malki Road and  
Morongo Trail, a total distance of approximately  
1.20 miles, in the Cabazon area.

149. On Theda Street between SH-74 and Ellis Ave-  
nue, a total distance of approximately 1.10 miles,  
in the Perris area."

Section 4. Section 3.5 of Ordinance 452, entitled  
"Twenty miles per hour," is hereby amended to add new  
subsection 1 to read as follows:

"1. On De Luz Road between Rancho California  
Road and a point 2,785 feet north of Via  
Medeiros, a total distance of approximately 1.48  
miles, in the Temecula area."

Section 5. Section 3.6 of Ordinance No. 452, entitled  
"Twenty-five miles per hour," is hereby amended to add  
new subsections 3 and 4 to read as follows:

"3. On Borel Road between Sky Canyon Drive and  
Leon Road, a total distance of approximately 1.20  
miles, in the French Valley area.

4. On Leon Road between Borel Road and Auld  
Road, a total distance of approximately 0.76  
miles, in the French Valley area."

Section 6. Subsection 70 of Section 2.5 of Ordinance  
452 adopted on February 4, 2003, pursuant to Ordinance  
No. 452.214, is repealed in its entirety. Subsection 70 of  
Section 2.5 established a forty-five miles per hour speed  
limit on Seminole Drive between the centerline of Fields  
Road and the centerline of Apache Trail.

Subsection 68 of Section 2.4 of Ordinance 452 adopt-  
ed on August 26, 2003, pursuant to Ordinance No.  
452.216, is repealed in its entirety. Subsection 68 of Sec-  
tion 2.4 established a forty miles per hour speed limit on  
Willows Avenue between Winchester Road and Town  
View Avenue.

Section 7. This ordinance shall take effect 30 days af-  
ter its adoption.

John J. Benoit, Chairman of the Board

I HEREBY CERTIFY that at a regular meeting of the  
Board of Supervisors of said County, held on **March  
29, 2016** the foregoing Ordinance consisting of **seven  
(7)** sections was adopted by said Board by the following  
vote:

AYES: Jeffries, Tavaglione, Benoit and Ashley  
NAYS: None  
ABSENT: Washington  
Kecia Harper-Ihem, Clerk of the Board  
By: Cecilia Gil, Board Assistant

4/7



OFFICE OF  
CLERK OF THE BOARD OF SUPERVISORS  
1st FLOOR, COUNTY ADMINISTRATIVE CENTER  
P.O. BOX 1147, 4080 LEMON STREET  
RIVERSIDE, CA 92502-1147  
PHONE: (951) 955-1060  
FAX: (951) 955-1071

KECIA HARPER-IHEM  
Clerk of the Board of Supervisors

KIMBERLY A. RECTOR  
Assistant Clerk of the Board

April 4, 2016

THE CALIFORNIAN  
ATTN: LEGALS  
P.O. BOX 120191  
TEMECULA, CA 92590

TEL: (951) 251-0329  
E-MAIL: [LegalsSWRiverside@UTSanDiego.com](mailto:LegalsSWRiverside@UTSanDiego.com)

RE: ADOPTION OF ORDINANCE NO. 452.240

To Whom It May Concern:

Attached is a copy for publication in your newspaper for **ONE (1) TIME** on **Thursday, April 7, 2016**.

We require your affidavit of publication immediately upon completion of the last publication.

Your invoice must be submitted to this office, WITH TWO CLIPPINGS OF THE PUBLICATION.

NOTE: PLEASE COMPOSE THIS PUBLICATION INTO A SINGLE COLUMN FORMAT.

Thank you in advance for your assistance and expertise.

Sincerely,

*Cecilia Gil*

Board Assistant to:  
KECIA HARPER-IHEM, CLERK OF THE BOARD



Order ID: 4091967

\* Agency Commission not included

GROSS PRICE \* : \$352.50

PACKAGE NAME: Legal-6col-Legal Notices

Product(s): San Diego Union Tribune, CApublicnotice.com, mobile.sduniontribune.com

AdSize(s): 3 Column,

Run Date(s): Thursday, April 07, 2016

Color Spec. B/W

Preview

**BOARD OF SUPERVISORS OF THE COUNTY OF RIVERSIDE, STATE OF CALIFORNIA**

**ORDINANCE NO. 452.240  
AN ORDINANCE OF THE COUNTY OF RIVERSIDE  
AMENDING ORDINANCE NO. 452**

The Board of Supervisors of the County of Riverside ordains as follows:

**Section 1.** Section 2.2 of Ordinance No. 452, entitled "Thirty miles per hour," is hereby amended to add new subsection 32 to read as follows:

- "32. On Santiago Canyon Road between Mayhew Canyon Road and De Palma Road, a total distance of approximately 1.30 miles, in the Temescal Valley area."

**Section 2.** Section 2.3 of Ordinance No. 452, entitled "Thirty-five miles per hour," is hereby amended to add new subsection 130 to read as follows:

- "130. On Willows Avenue between Winchester Road/SH-79 and Golden Rod Road, a total distance of approximately 0.63 miles, in the Temecula area."

**Section 3.** Section 2.4 of Ordinance 452, entitled "Forty miles per hour," is hereby amended to add new subsections 148 and 149 to read as follows:

- "148. On Seminole Drive between Malki Road and Morongo Trail, a total distance of approximately 1.20 miles, in the Cabazon area.
- 149. On Theda Street between SH-74 and Ellis Avenue, a total distance of approximately 1.10 miles, in the Perris area."

**Section 4.** Section 3.5 of Ordinance 452, entitled "Twenty miles per hour," is hereby amended to add new subsection 1 to read as follows:

- "1. On De Luz Road between Rancho California Road and a point 2,785 feet north of Via Medeiros, a total distance of approximately 1.48 miles, in the Temecula area."

**Section 5.** Section 3.6 of Ordinance No. 452, entitled "Twenty-five miles per hour," is hereby amended to add new subsections 3 and 4 to read as follows:

- "3. On Borel Road between Sky Canyon Drive and Leon Road, a total distance of approximately 1.20 miles, in the French Valley area.
- 4. On Leon Road between Borel Road and Auld Road, a total distance of approximately 0.76 miles, in the French Valley area."

**Section 6.** Subsection 70 of Section 2.5 of Ordinance 452 adopted on February 4, 2003, pursuant to Ordinance No. 452.214, is repealed in its entirety. Subsection 70 of Section 2.5 established a forty-five miles per hour speed limit on Seminole Drive between the centerline of Fields Road and the centerline of Apache Trail.

Subsection 68 of Section 2.4 of Ordinance 452 adopted on August 26, 2003, pursuant to Ordinance No. 452.216, is repealed in its entirety. Subsection 68 of Section 2.4 established a forty miles per hour speed limit on Willows Avenue between Winchester Road and Town View Avenue.

**Section 7.** This ordinance shall take effect 30 days after its adoption.

John J. Benoit, Chairman of the Board

I HEREBY CERTIFY that at a regular meeting of the Board of Supervisors of said County, held on **March 29, 2016** the foregoing Ordinance consisting of seven (7) sections was adopted by said Board by the following vote:

AYES: Jeffries, Tavaglione, Benoit and Ashley

NAYS: None

ABSENT: Washington

Kecia Harper-Ihem, Clerk of the Board

By: Cecilia Gil, Board Assistant

BOARD OF SUPERVISORS OF THE COUNTY OF RIVERSIDE, STATE OF CALIFORNIA

ORDINANCE NO. 452.240  
AN ORDINANCE OF THE COUNTY OF RIVERSIDE  
AMENDING ORDINANCE NO. 452

The Board of Supervisors of the County of Riverside ordains as follows:

Section 1. Section 2.2 of Ordinance No. 452, entitled "Thirty miles per hour," is hereby amended to add new subsection 32 to read as follows:

"32. On Santiago Canyon Road between Mayhew Canyon Road and De Palma Road, a total distance of approximately 1.30 miles, in the Temescal Valley area."

Section 2. Section 2.3 of Ordinance No. 452, entitled "Thirty-five miles per hour," is hereby amended to add new subsection 130 to read as follows:

"130. On Willows Avenue between Winchester Road/SH-79 and Golden Rod Road, a total distance of approximately 0.63 miles, in the Temecula area."

Section 3. Section 2.4 of Ordinance 452, entitled "Forty miles per hour," is hereby amended to add new subsections 148 and 149 to read as follows:

"148. On Seminole Drive between Malki Road and Morongo Trail, a total distance of approximately 1.20 miles, in the Cabazon area.

149. On Theda Street between SH-74 and Ellis Avenue, a total distance of approximately 1.10 miles, in the Perris area."

Section 4. Section 3.5 of Ordinance 452, entitled "Twenty miles per hour," is hereby amended to add new subsection 1 to read as follows:

"1. On De Luz Road between Rancho California Road and a point 2,785 feet north of Via Medeiros, a total distance of approximately 1.48 miles, in the Temecula area."

Section 5. Section 3.6 of Ordinance No. 452, entitled "Twenty-five miles per hour," is hereby amended to add new subsections 3 and 4 to read as follows:

"3. On Borel Road between Sky Canyon Drive and Leon Road, a total distance of approximately 1.20 miles, in the French Valley area.

4. On Leon Road between Borel Road and Auld Road, a total distance of approximately 0.76 miles, in the French Valley area."

Section 6. Subsection 70 of Section 2.5 of Ordinance 452 adopted on February 4, 2003, pursuant to Ordinance No. 452.214, is repealed in its entirety. Subsection 70 of Section 2.5 established a forty-five miles per hour speed limit on Seminole Drive between the centerline of Fields Road and the centerline of Apache Trail.

Subsection 68 of Section 2.4 of Ordinance 452 adopted on August 26, 2003, pursuant to Ordinance No. 452.216, is repealed in its entirety. Subsection 68 of Section 2.4 established a forty miles per hour speed limit on Willows Avenue between Winchester Road and Town View Avenue.

Section 7. This ordinance shall take effect 30 days after its adoption.

John J. Benoit, Chairman of the Board

I HEREBY CERTIFY that at a regular meeting of the Board of Supervisors of said County, held on **March 29, 2016** the foregoing Ordinance consisting of seven (7) sections was adopted by said Board by the following vote:

AYES: Jeffries, Tavaglione, Benoit and Ashley

NAYS: None

ABSENT: Washington

Kecia Harper-Ihem, Clerk of the Board

By: Cecilia Gil, Board Assistant