



Juan C. Perez, P.E., T.E.
 Director of Transportation and Land
 Management

COUNTY OF RIVERSIDE

TRANSPORTATION AND LAND MANAGEMENT AGENCY



Patricia Romo, P.E.
 Assistant Director of Transportation

Transportation Department

ADDENDUM NUMBER 1

Dated April 15, 2016

to the
 Specifications and Contract Documents
 for the construction of

Exchange Club Park
 Frontage Improvements Project
 Mayberry Avenue and Fairview Avenue
 Community of Valle Vista
 Project No. C6-0081

Bids Due: (Revised) Wednesday, April 27, 2016; 2:00 p.m.
 14th Street Transportation Annex
 3525 14th Street; Riverside, CA 92501
 (951) 955-6780

This Addendum is issued pursuant to the Instructions to Bidders, Item No. 8, of the Contract Documents for the reference project. This Addendum is issued as a supplement to the specification and special provisions for the referenced project. The revisions to the specifications shall become a part of the Contract Documents, and each bidder shall acknowledge receipt thereof on the Bid (Proposal). Bidders are directed to sign this addendum as acknowledged, and attach the signed addendum to the contractor's submitted proposal.

Note: During the advertisement period of this project, this document and attachments (if any) are available upon request at the office of the Transportation Department, and are available as a free download at the Transportation Department's website:

<http://rctlma.org/trans/Contractors-Corner/Notices-Inviting-Bids>

MODIFICATIONS / CLARIFICATIONS TO SPECIAL PROVISIONS:

Item 1: The new designated date and time for the receipt and opening of bids is revised as follows:

Wednesday, April 27, 2016; 2:00 p.m.
14th Street Transportation Annex
3525 14th Street; Riverside, CA 92501
(951) 955-6780

Item 2: Revised Proposal. Refer to "Proposal" pages B2-B4. Delete and replace "Proposal" (pages B2 through B4) with "Proposal (Revised)" attached herewith as **Attachment "A"**. The following changes have been made to the Proposal:

a. Estimated Quantities are revised for the following bid items:

- Item 7, "ROADWAY EXCAVATION"
- Item 10, "ASPHALTIC EMULSION (FOG SEAL COAT)"

- Item 16, "REMOVE ROADSIDE SIGN"
- Item 20, "THERMOPLASTIC CROSS WALK AND PAVEMENT MARKINGS"
- Item 27, "CLASS 2 AGGREGATE BASE"
- Item 28, "HOT MIX ASPHALT (PARKING LOT PAVING)"
- Item 30, "6" TYPE "A-6" CONCRETE PARKING LOT CURB & GUTTER (CRS 200)"
- Item 32, "MINOR CONCRETE (WIDENED CURB AT END STALLS IN PLANTERS)"
- Item 36, "PARKING LOT HANDICAPPED RAMPS"
- Item 37, "6" PVC SCH 80 CONDUIT/ SLEEVES FOR FUTURE, VERIZON AND CATV
- Item 38, "STREET LIGHT (INSTALLATION OF CONDUIT AND PULL BOXES) [AT MAYBERRY AVENUE AND FAIRVIEW AVENUE]"
- Item 45, "4" MISCELLANEOUS FITTINGS"
- Item 50, "8" (PVC) SEWER LATERAL TO SCHOOL CLASS ROOMS P.O.C."

b. The following bid items have been added:

- Item 14.A, "MINOR CONCRETE (CURB RAMP) (CASE B)"
- Item 15.A, "DRAINAGE INLET FILTRATION"
- Item 19.A, "PAINT CURB (2-COAT) [RED]"
- Item 32.A, "MINOR CONCRETE (SIDEWALK) (VWPD STD LC-02 AND LC-03)"
- Item 32.B, "MINOR CONCRETE (MISCELLANEOUS CONSTRUCTION) [6" THICK PCC WITH 6x6-W1.4xW1.4 WELDED WIRE MESH]"
- Item 32.C, "MINOR CONCRETE (MISCELLANEOUS CONSTRUCTION) [6" THICK V-GUTTER]"
- Item 33.A, "3' X 3' CONCRETE LOW FLOW OUTLET BOX W/1-12" HDPE DRAIN LINE TO BACK OF STREET CATCH BASIN ON MAYBERRY AVENUE"
- Item 37.A, "5" PVC SCH 80 CONDUIT / SLEEVES FOR FUTURE, SCE"
- Item 39.A, "MISCELLANEOUS WORK (AS DIRECTED)"
- Item 39.B, "HYDROSEED (GRADED AREAS)"
- Item 39.C, "INSTALL 6' TUBULAR STEEL FENCING INCLUDING GATE"
- Item 40.A, "6" (PVC) WATER LINE"
- Item 43.A, "6" MISCELLANEOUS FITTINGS"
- Item 47.A, "1" SERVICE CONNECTIONS (PER LHMWD STD. H-5)"
- Item 47.B, "THRUST BLOCKS"
- Item 51.A, "6" x 6" (PVC) SEWER WYE"

c. The following bid items have been deleted:

- Item 3, "WATER POLLUTION CONTROL (IN RIGHT OF WAY ONLY)"
- Item 39, "REMOVE EXISTING STANDARD GUY WIRE AND ANCHOR"
- Item 44, "4" GATE VALVE"
- Item 46, "2" BACKFLOW FOR DOMESTIC WATER LINE"
- Item 48, "ADJUST WATER VALVE TO GRADE"

d. Description and/or Unit have been revised for the following bid items:

- Item 14, "MINOR CONCRETE (CURB RAMP) (1- CASE A, 1- MODIFIED CASE A, 2- CASE C)"
- Item 15, "CATCH BASIN (CURB INLET) (CRS 300), W=14', [INCLUDING REMOVAL OF EXISTING INLET AND EXTENSION OF EXISTING RCP]"
- Item 16, "REMOVE ROADSIDE SIGN"
- Item 18, "ROADSIDE SIGN - ONE POST"
- Item 25, "WATER POLLUTION CONTROL (ON-SITE AND STREET IMPROVMENTS)"
- Item 26, "OVER EXCAVATE, IMPORT MATERIAL, RE-COMPACT AND EXCAVATION (SITE GRADING)"
- Item 27, "CLASS 2 AGGREGATE BASE"
- Item 28, "HOT MIX ASPHALT (PARKING LOT PAVING)"
- Item 33, "2' X 2' CONCRETE CATCH BASIN (BROOKS No. 2424 T24 W/ STEEL GRATE) W/THREE (3)-

- 6" HDPE DRAIN LINES TO INFILTRATION (DETENTION) BASIN"
- Item 34, "PARKING LOT STRIPING AND PAVEMENT MARKINGS, AND PARKING LOT BUMPERS"
- Item 37, "6" PVC SCH 80 CONDUIT / SLEEVES FOR FUTURE, VERIZON AND CATV"
- Item 38, "STREET LIGHT (INSTALLATION OF CONDUIT AND PULL BOXES) [AT MAYBERRY AVENUE AND FAIRVIEW AVENUE]"
- Item 40, "6" FIRE HYDRANT ASSEMBLY W/GATE VALVE (PER LHMWD STD. H-2B)"
- Item 41, "6" DOUBLE CHECK DETECTOR ASSEMBLY (PER LHMWD STD. H-3)"
- Item 47, "2" SERVICE CONNECTIONS (PER LHMWD STD. H-4)"
- Item 50, "8" (PVC) SEWER LATERAL TO SCHOOL CLASS ROOMS P.O.C."

- e. Final Pay Quantity (F) designation has been added to the following bid item:
Item 7, "ROADWAY EXCAVATION"

Item 3: Modification to Special Provisions – Street Name Update to Fairview Avenue. Refer to Section 00-1.01, Project Description, on page 1 of the Special Provisions.

Whenever and wherever in the Contract Documents the name Fairway Avenue is used, it shall be understood to mean and refer to Fairview Avenue.

Item 4: Addition to Special Provisions – Prosecution and Progress. Refer to Section 00-1.05, Prosecution and Progress on page 2 of the Special Provisions. The following Special Provisions are added to Section 00-1.05 and made part hereby:

Within 14 calendar days after the issuance of the Notice of Acceptance of Proposal and Intent to Award, the Contractor shall provide the following submittals for County review and acceptance:

1. SWPPP
2. Traffic Control Plans
3. Material Submittals for Water and Sewer

In the event that the Contract is not awarded by the County, the low bidder will be compensated for the cost of the submittals provided.

Item 5: Addition to Special Provisions – Supplemental Project Information. The following Special Provisions are added and made part hereby:

Add to section 2-1.06B, Supplemental Project Information, of the Standard Specifications:

The following Supplemental Project Information is available for inspection and to download for your use on the County of Riverside Transportation Department website:

<http://rctlma.org/trans/Contractors-Corner/Notices-Inviting-Bids>

- **Geotechnical Investigation, Dated April 7, 2016**

The Geotechnical Investigation (downloadable file) is provided for reference only. The County of Riverside Transportation Department does not guarantee the accuracy of this data.

Item 6: Modification to Special Provision – Survey Request. Refer to Section 5-1.26B, Survey Request, on page 12 through 13 of the Special Provisions. Delete Section 5-1.26B and replace it with the following special provisions:

5-1.26B Survey Request

The Thomsen Company, Inc. will provide Contractor with a survey request form. Survey staking requests must be received from Contractor a minimum of three (3) Business Days prior to the installation of the requested construction staking. The Thomsen Company, Inc. shall receive written survey request on operating Business Day, **Monday** through **Friday**, and prior to 4:00 p.m. Requests received after 4:00 p.m. or on any other day, shall be considered as submitted at 7:30 a.m. the next Business Day.

Item 7: Modifications to Special Provision – Water and Sewer Improvements.

1. Refer to Section 5-1.36D(1)(c), Construction, on page 13 of the Special Provisions. Delete Section 5-1.36D(1)(c) and replace it with the following special provisions:

5-1.36D(1)(c) Construction

Contractor will furnish and install all required materials and equipment. Contractor is required to perform all testing for water and sewer lines.

Contractor must provide LHMWD with a construction window for a period of 5 working days. LHMWD will make all connections (hot tapping) to existing main water line

The contractor will make all connections to existing sewer line.

Attention is directed to Section 00-1.08, Cooperation, of these Special Provisions for full cooperation with LHMWD. The contractor must cooperate with LHMWD in performing the work required to make the connection to the existing main water line including but not limited to providing materials, excavation, traffic control, and backfill, in conformance with the Standard Specifications, these Special Provisions and as directed by the Engineer.

2. Refer to Section 5-1.36D(1)(d), Payment, on page 13 of the Special Provisions. Delete Section 5-4.36D(1)(d) and replace it with the following special provisions:

5-1.36D(1)(d) Payment

Payment for furnishing and installing water and sewer line extensions and installations shall be considered as included in the payment for the different items of work found on "Bid Schedules 3 and 4" of the proposal (bid items list), water and sewer improvements.

The Contractor will pay all fees required by LHMWD. LHMWD fees are estimated to be \$2,500. The Contractor will not be directly reimbursed for LHMWD fee paid but shall include any compensation for this fee paid in the contract prices paid for the various items of work involved.

Item 8: Modification to Special Provision – Water Pollution Control. Refer to Section 13-1.01, General, Water Pollution Control (Santa Ana Region), on page 19 of the Special Provisions. Delete the first paragraph of Section 13-1.01 and replace it with the following paragraph:

Contractor must provide one Storm Water Pollution Prevention Plan and Monitoring Program (SWPPP/MP) that includes both the frontage improvements work performed on Mayberry Avenue and Fairview Avenue and the on-site grading work and construction of parking lot.

Item 9: Addition to Special Provisions – Removal of Traffic Stripes and Pavement Markings. The following Special Provisions are added and made part hereby:

Add to Section 15-2.02C Remove Traffic Stripes and Pavement Markings:

REMOVE TRAFFIC STRIPES AND PAVEMENT MARKINGS:

Traffic stripes and pavement markings shall be removed as shown on the plans and as directed by the Engineer.

The removal of traffic stripes and markings shall be accomplished by either of the following methods.

- A. Wet Sandblasting: Where blast cleaning is used for the removal of painted traffic stripes and pavement markings or for removal of objectionable material, and such removal operation is being performed within Ten (10) feet of a lane occupied by public traffic, the residue including dust shall be removed immediately after contact between the sand and the surface being treated. Such removal shall be by a vacuum attachment operating concurrently with the blast cleaning operation and shall comply with AQMD regulations.
- B. Grinding: A minimum of 3 passes with the grinder in a rectangular area rather than just lettering or markings so the old message cannot be identified is required. Removal shall be to a maximum depth of 1/10". Removal depth may exceed 1/10" only when necessary to effectively remove paint, and only on approval by the Engineer. Asphalt emulsion slurry shall be applied to the areas where stripes or pavement markings have been removed.

After removal of traffic stripes and pavement markings, a fog seal coat shall be applied in conformance with the provisions in Section 37, "Bituminous Seals" of the Standard Specifications and the following:

If removal of existing striping is performed more than 24 hours prior to final striping, the Contractor shall place reflective temporary striping tape throughout the limits of sandblasting, to provide channelization of traffic, for all lanes of travel.

Temporary striping tape shall be removed subsequent to final striping.

Nothing in these Special Provisions shall relieve the Contractor from his responsibilities as provided in Section 7-1.04, "Public Safety," of the Standard Specifications.

It shall be the responsibility of the Contractor to properly dispose of the residue from removal of striping and pavement markings.

Payment:

Full compensation for removing traffic stripes and pavement markings including furnishing all labor materials, tools, equipment and incidentals as specified in the Standard Specifications and these Special Provisions, and as directed by the Engineer, shall be considered as included in the contract prices paid per linear foot for Paint Traffic Stripe (2-Coat), and per square foot for Thermoplastic Crosswalk and Pavement Markings and no additional compensation will be allowed therefor.

Item 10: Modification of Special Provision – Removal of Existing Signs. Delete Section 15-2.03, Salvage, Remove and Salvage Existing Signs and Posts, on page 27 of the Special Provisions, and, replace with the following Special Provisions added and made part hereby:

Add following to section 15-2.02J

15-2.02J Remove Roadside Sign

Existing roadside signs and posts, shall be removed, and properly disposed of as shown on the plans in conformance with Sections 15-2.02J, "Remove Roadside Signs" of the Standard Specifications.

Payment:

Full compensation for Remove Roadside Sign shall be considered as included in the price paid per each, and shall include full compensation for furnishing all labor, materials, tools, equipment, incidentals and for doing all the work including properly disposing of Road Signs as specified in the these Special Provisions and no additional compensation will be allowed therefor.

Item 11: Modifications to Special Provision – Roadway Excavation. Refer to Section 19-2.01, General, on pages 29 and 30 of the Special Provisions, Roadway Excavation. Delete the payment paragraph on page 30 and replace it with the following paragraph:

Payment:

Roadway Excavation will be paid for by the cubic yard, in conformance with section 9-1.02C "Final Pay Item Quantities" of Standard Specifications. The unit price paid per cubic yard for Roadway Excavation shall include full compensation for furnishing all labor, materials, tools, equipment, and incidentals, and for doing all work involved including hauling, excavation and compaction, saw-cutting as shown on the plans, removal of existing pavement and base, as directed by the Engineer and no additional compensation will be allowed therefor.

Item 12: Modification of Special Provision – Site Grading. Refer to Section 19-10, Site Grading on pages 30 and 31 of the Special Provisions. Delete Payment paragraph on page 31 of the Special Provisions and replace it with the following paragraph:

Payment:

Full compensation for Over Excavate, Import Material, Re-compact and Excavation (Site Grading) including compensation for furnishing all labor, materials, tools, equipment, and incidentals, and for doing all work involved including hauling, excavation, over-excavation and compaction, removal of existing concrete footing, as directed by the Engineer shall be paid on a lump sum basis and no additional compensation will be allowed therefor.

Item 13: Addition to Special Provisions – Import Borrow Material. Refer to Section 19-10, Site Grading, on pages 30 through 31 of the Special Provisions. The following Special Provisions are added and made part hereby:

Add to Section 19-10, Site Grading, of the Special Provisions:

IMPORT BORROW:

Imported borrow and fill material needed for on-site fill areas shall be free from organics and deleterious material, and free from man-made refuse (such as: Portland cement concrete, Asphalt concrete, Residue from grooving and grinding operations, Metal, Rubber, Mixed debris, Rubble), and shall conform to the provisions of Section 19 Earthwork of the Standard Specifications and these Special Provisions, and shall be material that is similar or better in quality than the existing soil.

Imported Borrow material must be obtained from sources that comply with section 6-2.04, Local Materials, of the Standard Specifications.

Payment:

Full compensation for imported borrow shall be considered as included in the contract price paid per lump sum for Over Excavate, Import Material, Re-compact and Excavation (Site Grading), and shall include full compensation for clearing and stripping the material sites if necessary; excavating, loading, hauling, depositing, spreading and compacting the material in place, within the on-site as specified. It shall also include furnishing all labor material, tools, equipment and incidentals, and for doing all the work involved in obtaining and placing import borrow, complete in place and as shown on the plans and as specified in these specification and special provisions and as directed by the Engineer and no additional compensation will be allowed therefor.

Item 14: Addition to Special Provisions – Erosion Control (Hydroseed). The following Special Provisions are added and made part hereby:

Replace Reserved Section 21-1.02N in the Standard Specifications with:

21-1.02N Erosion Control (Hydroseed)

21-1.02N(1) GENERAL

21-1.02N(2) Summary

This work includes applying erosion control (hydroseed) materials including seed, fiber, commercial fertilizer, organic fertilizer, straw, and tackifier to on-site graded areas shown on the plans.

Comply with Section 21, "Erosion Control," of the Standard Specifications.

If notified by the Engineer that an area is ready to receive erosion control materials, start erosion control (hydroseed) work within 5 business days of the Engineer's notification to perform the work.

The Engineer will designate the ground location of all erosion control (hydroseed) areas in increments of one acre or smaller by directing the placing of stakes or other suitable markers. Furnish all tools, labor, materials, and transportation required to adequately mark the various erosion control (hydroseed) locations.

21-1.02N(3) MATERIALS

21-1.02N(3)A Seed

Deliver seed to the job site in unopened separate containers with the seed tags attached. A container without a seed tag attached is not accepted. The Engineer takes a sample of approximately **1 Oz or 2 Oz** of seed for each seed lot greater than **2 lbs.** Seed must comply with the following and table shown in section **21-1.02N(4)B "Application"** of these Special Provisions:

SEED		
Botanical Name (Common Name)	Percent Germination (Minimum)	Pounds Pure Live Seed (Per Acre)
Bromus carinatus" Cucamonga" (Cucamonga Brome)	85	20
Trifolium tridentatum (Tomcat Clover)	85	4
Vulpia microstachys (Small Fescue)	85	8
Total:		32

21-1.02N(3)B Seed Sampling Supplies

At the time of seed sampling, provide the Engineer a glassine lined bag and custody seal tag for each seed lot sample.

21-1.02N(3)C Commercial Fertilizer

Commercial fertilizer must have a guaranteed chemical analysis within 10 percent of 5 to 8 percent nitrogen, 3 to 6 percent phosphoric acid and 1 to 3 percent water soluble potash.

21-1.02N(3)D Straw

Straw must be one of the following:

1. Wheat
2. Barley
3. Wheat or barley

Wheat and barley straw must be derived from irrigated crops. Straw must be free of plastic, glass, metal, rocks, and refuse or other deleterious material.

21-1.02N(3)E Tackifier

Tackifier must be:

1. Nonflammable
2. Nontoxic to aquatic organisms
3. Free from growth or germination inhibiting factors
4. Bonded to the fiber or prepackaged with the fiber by the manufacturer
5. At least 10 percent of the weight of the dry fiber and include the weight of the activating agents and additives
6. Organic, high viscosity colloidal polysaccharide with activating agents, or a blended hydrocolloid-based binder

21-1.02N(3)F Fiber

Fiber must be:

1. Long strand, whole wood fibers, thermo-mechanically processed from clean, whole wood chips.
2. Not made from sawdust, cardboard, paper, or paper byproducts.
3. At least 25 percent of fibers 3/8 inch long.
4. At least 50 percent held on a No. 25 sieve.
5. Free from lead paint, printing ink, varnish, petroleum products, seed germination inhibitors, or chlorine bleach.
6. Free from synthetic or plastic materials.
7. At most 7 percent ash.
8. Coloring agent for fiber must be a biodegradable nontoxic coloring agent free from copper, mercury, and arsenic.

21-1.02N(3)G Coloring Agent

Use a biodegradable, nontoxic coloring agent free from copper, mercury, and arsenic.

21-1.02N(4) CONSTRUCTION

21-1.02N(4)A Site Preparation

Immediately before applying seed to erosion control (Hydroseed) areas, remove trash and debris and weeds.

Removed weeds must be disposed of in conformance with the provisions in Section 7-1.13, "Disposal of Material Outside the Highway Right of Way," of the Standard Specifications.

21-1.02N(4)B Application

Apply erosion control (hydroseed) materials in separate applications in the following sequence:

1. Apply the following mixture with hydroseeding equipment at the rates indicated within 60 minutes after the seed has been added to the mixture:

Material	Pounds Per Acre
Seed	32
Fiber	3,500
Commercial Fertilizer	1,000

2. Apply straw at the rate of 565 pounds per acre based on slope measurements. Incorporation of straw will not be required. Distribute straw evenly without clumping or piling.
3. Apply the following mixture with hydroseeding equipment at the corresponding

Material	Pounds Per Acre
Fiber	565
Tackifier	565

The ratio of total water to total tackifier in the mixture must be as recommended by the manufacturer.

Seed may be dry applied at the total rate specified in the preceding table for small areas not accessible by the hydroseeding equipment if approved by the Engineer. Dry-applied seed must be incorporated into the soil a maximum depth of 1/4 inch by raking or dragging.

Hydraulic application of erosion control (hydroseed) materials for rolled erosion control product (netting) areas must be applied by hose, from the ground. Erosion control (hydroseed) materials must be applied onto the slope face such that the materials are well integrated into the rolled erosion control product (netting) and in contact with ground surface. Application must be perpendicular to the slope face such that rolled erosion control product (netting) materials are not damaged or displaced. Once straw work is started in an area, complete tackifier applications in that area within the same work shift.

The Engineer may change the rates of erosion control (hydroseed) materials to meet field conditions.

For any area where erosion control (hydroseed) materials are to be applied, the application of all erosion control (hydroseed) materials to be applied to that area must be completed within 72 hours from when the first materials were applied.

21-1.02N(5) PAYMENT

Erosion control (hydroseed) will be measured to the nearest 0.01 of an acre. The area will be calculated on the basis of field measurement and as computed for slope surface (not plan view) measurements.

The contract price paid per acre for erosion control (hydroseed) includes full compensation for furnishing all labor, materials, tools, equipment, and incidentals, and for doing all the work involved in erosion control (hydroseed) complete in place, as shown on the plans, as specified in the Standard Specifications and these special provisions, and as directed by the Engineer.

Item 15: Addition to Special Provisions – Apply Fog Seal to Intersection. Refer to Section 37-2.01A on page 33 of the Special Provisions. The following Special Provisions are added and made part hereby:

Add to Section 37-2.01A, Summary, of the Special Provisions:

Although not shown on the plans, the contractor will be required to apply fog seal at the intersection of Mayberry Avenue and Fairview Avenue in conformance with the requirements of Section 37, Bituminous Seals, of the Standard Specifications and these Special Provisions.

Payment for Fog Seal application on Mayberry Avenue and Fairview Avenue Intersection shall be considered as included in the contract price paid per ton for Asphaltic Emulsion (Fog Seal Coat) and shall include full compensation for, furnishing and placing fog seal, and all labor and materials needed to perform the work.

Item 16: Modifications to Special Provisions – Minor Concrete Structures. Refer to Section 51, Minor Concrete Structures, on pages 45 and 46 of the Special Provisions.

1. Delete the list of minor concrete structures on Section 51-1.01, General, page 45, and replace it with the following list:

Minor concrete structures for this project shall consist of:

- Catch basin (curb inlet) per County Standard No. 300, including RCP
- 2' x 2' concrete catch basin per Brooks No. 2424 T24 including steel grate and three (3) 6" HDPE drain lines to infiltration (detention) basin
- 3' x 3' BROOKS CB3636 CATCH BASIN. Use Galvanized Traffic Grate. Use E6 TOP (Extension Section) and B36 Bottom Section. Including one (1) 12" HDPE drain line to back of street catch basin on Mayberry Avenue.

2. The following Special Provisions are added to Section 51-1.01 and made part hereby:

The Contractor shall furnish and install the necessary section of reinforced concrete pipe (RCP) required for connecting the new catch basin on Mayberry Avenue at Station 17+21 to the existing RCP. RCP shall conform to Section 65, Concrete Pipe, of the Standard Specifications, these special provisions, and as directed by the Engineer.

Except as otherwise designated by classification on the plans or in the specifications, joints for culvert and drainage pipes shall conform to the plans or specifications for standard joints.

Full compensation for the removal of existing drop inlet, and for furnishing and installing RCP to connect the new catch basin and the existing RCP at Mayberry Avenue, Station 17+21, including the work, equipment, labor and materials involved shall be considered as included in the contract price paid per each for Catch Basin (Curb Inlet) CRS 300, and no additional compensation shall be allowed therefor.

3. The following Special Provisions are added to Section 51-1.01 and made part hereby:

The Contractor must furnish one stencil with the legend "ONLY RAIN IN THE DRAIN". The Contractor shall submit a copy of the final stencil design for approval by the Engineer prior to fabrication. After approval from the Engineer, the Contractor must spray paint the legend at the catch basin inlet located on Station 17+21. Full compensation for furnishing stencil and painting the legend shall be considered as included in the contract price paid per each for Catch Basin (Curb Inlet) CRS 300.

4. Delete Section 51-1.0, Payment, on pages 45 and 46 of the Special Provisions and replace it with the following:

51-1.04 PAYMENT

The contract unit price paid for each minor structure will not be adjusted if the constructed height of said minor structure, including revisions by Engineer, is within ± 0.5 foot of the vertical dimension shown on the plans.

Payment for all work involved in the construction of minor structures will be per each for Catch basin (curb inlet) per County Standard No. 300 including RCP, 2' x 2' concrete catch basin per Brooks No. 2424 T24 including steel grate and three (3) 6" HDPE drain lines to infiltration (detention) basin, and 3' x 3' BROOKS CB3636 CATCH BASIN including one (1) 12" HDPE drain line to back of street catch basin on Mayberry Avenue; and shall include full compensation for furnishing all labor, materials, tools and equipment, and doing all work involved in the complete structure, including the structures structural excavation and backfill, removal of existing structures (inlets), furnishing and placing reinforcement steel, and metal frames, covers and grates, and no further allowances shall be allowed.

Item 17: Addition to Special Provisions – HDPE Pipe. The following Special Provisions are added and made part hereby:

HIGH DENSITY POLYETHYLENE (HDPE) PIPE:

Plastic Pipe shall conform to the provisions in Section 64, "Plastic Pipe", of the Standard Specifications, except as otherwise specified in these specifications.

Plastic Pipe shall be Type S corrugated polyethylene pipe with smooth interior wall manufactured from high density polyethylene (HDPE) virgin compounds.

Installation shall be in accordance with the plans, Standard Specifications, these specifications, and as recommended by the pipe manufacturer.

All the joints of the HDPE pipes need to be watertight. The watertight joints shall conform to section 64 of the Standard specifications. Full compensation of all labor, materials, tools, and incidentals for making the HDPE pipes watertight shall be included in the payment for the different concrete structures (2' x 2' concrete catch basin, and 3' x 3' BROOKS CB3636 catch basin) connecting to HDPE Pipe.

At all pipe joint locations, the inside of the pipe shall be smooth and free of obstructions.

Except as otherwise designated by classification on the plans or in the specifications, joints for culvert and drainage pipes shall conform to the plans or specifications for standard joints.

Pipe shall be placed in a trench 12" minimum wider than the outside diameter of the pipe being installed. Trenching shall be 6" minimum in width on each side of the pipe.

The pipe shall be placed in the bottom of the trench and the trench shall be backfilled.

If so directed by the Engineer, the pipe shall be backfilled with two sack slurry.

The slurry shall be allowed to cure a minimum of two days prior to final paving.

Slurry cement backfill shall conform to Section 19-3.02D of the Standard Specifications, except that full compensation therefor shall be considered as included in the prices paid per each for the different concrete structures (2' x 2' concrete catch basin, and 3' x 3' BROOKS CB3636 catch basin) connecting to HDPE Pipe, and no additional compensation will be allowed therefor.

Payment:

Full compensation for furnishing and installing HDPE pipe shall be as considered included in the contract prices paid per each for the different concrete structures (2' x 2' concrete catch basin, and 3' x 3' BROOKS CB3636 catch basin) connecting to HDPE Pipe, and shall include full compensation for furnishing all labor, materials, tools, equipment, and incidentals, and for doing all of the work involved in installing HDPE Pipe, complete in place, including structure excavation and backfill, slurry encasement if required, as specified in the Standard Specifications and these special provisions, and as directed by the Engineer.

Item 18: Addition to Special Provisions – Sign Sizes. Refer to Section 56-4, Roadside Signs, on page 46 of the Special Provisions. The following Special Provisions are added and made part hereby:

Roadside signs for this project shall be of the following sizes:

- R1-1: 36"
- R1-3P: 18" x 6"
- W3-1: 36" x 36"
- SR4-1 (School Speed Limit Assembly C): 24" x 48"
- S1-1: 36" x 36"
- W16-9P: 24" x 12"

Item 19: Addition to Special Provision – Painting Curb Red. The following Special Provisions are added and made part hereby:

Add to Section 59-6, Painting Concrete of the Standard Specifications:

59-6.01 General

This work shall consist of preparing and painting concrete curb, where shown on the plans, and in conformance with these special provisions.

59-6.02 Materials

The paint shall be a light-stable, alkali-resistant, acrylic latex or acrylic latex copolymer emulsion, commercially manufactured for use as an exterior concrete coating. The paint shall conform to the provisions in Section 91-4.05, Paint, Acrylic Emulsion, Exterior White and Light and Medium Tints, of the Standard Specifications.

The paint shall be formulated and applied so that the color of the coated concrete matches Federal Standard 595B No. FS 31302, Red, or as approved by the Engineer.

The Contractor shall submit to the Engineer, not less than 7 days before initial application of the concrete coating, a copy of the manufacturer's recommendations and written application instructions.

59-6.03 Construction

Surface Preparation

New concrete surfaces to be painted shall be at least 14 calendar days old before painting, or as approved by the resident Engineer.

Concrete curb to be painted shall be prepared in conformance with the requirements of SSPC SP 13/NACE No. 6, "Surface Preparation of Concrete," of the "SSPC: The Society of Protective Coatings." After concrete surface preparation is complete, the Contractor shall clean all concrete surfaces to be painted by pressure rinsing as defined in Section 59 1.03, "Application," of the Standard Specifications.

Painting Concrete

The coating shall be applied per the manufacturer's recommendations and in conformance with the requirements of SSPC PA 7, "Applying Thin Film Coatings to Concrete," of the "SSPC: The Society of Protective Coatings."

Any damaged areas shall be repaired in the same manner as the original surface preparation and paint application.

59-6.04 Payment

The contract price paid per linear foot for Paint Curb (2-Coat) [Red] shall include full compensation for furnishing all labor, materials, tools, equipment, and incidentals for doing all the work involved in preparing, and applying paint to concrete curbs, complete in place, including repairing damaged areas, as shown on the

plans, as specified in the Standard Specifications and these special provisions, and as directed by the Engineer.

Item 20: Addition to Special Provision – Drainage Inlet Filtration System. The following Special Provisions are added and made part hereby:

Add as Section 70-5.04A:

70-5.04A Drainage Inlet Filtration System

Section 70-5.04A includes specifications for constructing drainage inlet filtration systems. Submit a certificate of compliance from the manufacturer.

70-5.04A (2) Materials

Drainage inlet filtration system must be furnished and installed as shown under these special provisions.

The allowable drainage inlet filtration systems must consist of the following or a Department-authorized equal.

1. Kristar – Flogard Plus Catch Basin Insert Filter. The Flogard can be obtained from the manufacturer Oldcastle Stormwater Solutions, 7921 Southpark Plaza, Suite 200, Littleton, CO 80120. Phone 1-800-579-8819.

70-5.04A(3) Construction

Installation of drainage inlet filtration system must comply with the manufacturer's instructions.

70-5.04A(4) Payment

Drainage inlet filtration system will be measured and paid for by the unit, determined from actual count of units installed in place.

The unit price paid for installation of the drainage inlet filtration system shall include full compensation for furnishing all labor, materials, tools, equipment, and incidentals, and for doing the work involved installing the drainage inlet filtration system in accordance with these special provisions, and as directed by the Engineer.

Item 21: Modifications to Special Provisions – Minor Concrete Items. Refer to Section 73, Concrete Curbs and Sidewalks, on pages 47 and 48 of the Special Provisions.

1. The following Special Provisions are added to Section 73-1.01, General, and made part hereby:

The two curb ramps located on Mayberry Avenue at approximately Station 15+15 shall be constructed per County Standard No. 403, Curb Ramp Case C. Refer to Addendum No. 1, Attachment B, for County Standard No. 403, Curb Ramp Case C.

2. The following Special Provisions are added to Section 73-1.01, General, and made part hereby:

DETECTABLE WARNING SURFACES (TRUNCATED DOMES)

This work includes installing detectable warning surface on the curb ramps or on the areas as shown on the plans, and as specified in these Special Provisions, and as directed by the Engineer.

Curb ramp detectable warning surface must be:

1. Yellow color complying with Federal Standard 595B, Color No. 33538.
2. Raised truncated domes.

The manufacturer must provide a written 5-year warranty for detectable warning surface, guaranteeing replacement when there is defect in the dome shape, color fastness, sound-on-cane acoustic quality, resilience, or attachment. The warranty period will begin upon acceptance of the contract.

Installation of curb ramp detectable warning surface must comply with the manufacturer's recommendations.

Full compensation for Detectable Warning Surface (Truncated Domes) shall be considered as included in the contract unit prices paid for the different Minor Concrete items of work found in the bid items list, and shall include full compensation for furnishing all labor, materials, tools, equipment and incidentals for doing all work involved in constructing detectable warning surface, complete in place, as shown on the plans, as specified in these Special Provisions, and as directed by the Engineer, and no separate payment will be made therefor.

3. Delete the Payment paragraph on page 48 of the Special Provisions, Section 73-1.04, and replace it with the following paragraph:

Payment:

The contract unit bid prices paid per:

- each (EA) for Minor Concrete Curb Ramps, and Parking Lot Handicapped Ramps;
- linear foot (LF) for the different kinds of Curb, and Curb and Gutter; and
- square foot (SQFT) for the different kinds of sidewalk, commercial driveway, widened curb at parking lot end stalls in planters, 6" thick PCC (on-site apron at trash enclosure), and 6" thick on-site V-gutter; shall include full compensation for furnishing all labor, equipment, materials and tools, and incidentals, and for doing all the work involved in the concrete items construction including the grading and the removal of any obstacles within the areas of proposed concrete items, removal of existing concrete items (ramps, sidewalk, curb and gutter), concrete items transitions (curb, curb and gutter), furnishing and placing reinforcement steel, welded wire mesh, furnishing and placing expansion joints, complete in place as shown on the plans, the standard drawings, architectural details, as specified in the Standard Specifications and these Special Provisions, and as directed by the Engineer, and no additional compensation will be allowed therefor.

Item 22: Addition to Special Provision – Infiltration (Detention) Basin Tubular Steel Fencing and Gate.

The following Special Provisions are added and made part hereby:

Replace Section 80-11, Reserved, of the Standard Specifications with:

Tubular fencing and gate shall be installed on the infiltration (detention) basin perimeter in accordance with these Special Provisions and Valley-Wide Recreation & Parks District details and requirements.

Refer to Addendum 1, Attachment B, for VWR&PD Std. LC-12 for Tubular Steel Fencing and VWR&PD Std. LC-13 for Tubular Steel Gate.

Fencing shall be tubular steel with black powder coating. Any proposed alterations must be submitted for approval.

Vehicle access gate shall be provided for the basin entrance. Gate must be designed to restrict pedestrian or vehicle public access.

Tubular Steel Fencing

Steel material for fence panels and posts shall conform to the requirements of ASTM A653/A653M, with a minimum yield strength of 50,000 psi (344 MPa) and a minimum zinc (hot-dip galvanized) coating weight of 0.90 oz/ft² (276 g/m²), Coating Designation G-90.

Material for fence pickets shall be 3/4" square x 16 Ga. tubing. Picket holes in the rail shall be spaced 4" O.C.

Posts shall be a minimum of 2-1/2" square x 14 Ga. Rails shall be tubular steel with a minimum radius of 1-3/8". Rails shall be installed 4" above concrete mowcurb.

Pickets, rails and posts shall be pre-cut to specified lengths.

The manufactured panels and posts shall be subjected to inline electrode position coating process consisting of a multi-stage pretreatment/wash (with zinc phosphate), followed by a duplex cathodic electro coat application of an epoxy primer followed by an acrylic topcoat. The minimum cumulative coating thickness of epoxy and acrylic shall be 2 mils (0.058 mm). The color shall be black. Any field welds if required must have one coat of epoxy primer and two coats of exterior enamel. Painting must be guaranteed for 5 years.

Gates shall be fabricated using welded ornamental panel material and gate ends having a 1-3/4" square cross-sectional size. All rail and upright intersections shall be joined by welding. All picket and rail intersections shall also be joined by welding. All welds shall be primed and receive two coats of black enamel paint.

All fence posts shall have a 2" min. standard square cap permanently secured to each post.

Concrete footings shall be 2500 PSI @ 28 days. Footings shall be as indicated within the District details.

All tubular steel fencing shall have a maintenance concrete mowcurb between each post per District detail unless approved by the District. Footing height shall allow for mow curb form boards to avoid breaking post footings in order to form and pour mowcurb

All fencing shall be installed per District details.

Payment:

The contract price paid per linear foot for Install 6' Tubular Steel Fencing including Gate shall include full compensation for furnishing all labor, materials, tools, equipment, and incidentals for doing all the work involved in furnishing and installing tubular steel fencing and gate, including concrete footings, excavation and backfill, as shown on the plans, as specified in the Standard Specifications and these special provisions, and as directed by the Engineer, and no additional compensation will be allowed.

Item 23: Modification of Special Provision – Conduit. Refer to Section 86-2.05, Conduit on pages 49 and 50 of the Special Provisions.

1. The following Special Provisions are added to Section 86-2.05 and made part hereby:

Conduit depth shall not exceed 60 inches below finish grade. Conduit depth shall be at a minimum of 36 inches below finished grade.

2. The following Special Provisions are added to Section 86-2.05 and made part hereby

Pull boxes (shown on the plans) will be required at the ends of the PVC conduit installed. Pull boxes must be 17"x30" electrical pull boxes with fiberglass body and polymer concrete ring as manufactured by J&R Concrete Products, Std. P-E6B, or approved equal. Full compensation for furnishing and installing these pull boxes shall be considered as included in the linear feet contract price paid for the different types of conduit included in the bid items list.

3. Delete the Payment paragraph on page 50 of the Special Provisions and replace it with the following paragraph:

Payment:

The contract price paid per linear foot for the different types of conduits found in the bid items list shall include full compensation for furnishing all labor, materials, tools, equipment, incidentals, and for doing all the work involved in installing conduit, furnishing and installing required pull boxes, complete in place as shown on the plans, as specified in the Standard Specifications and these Special Provisions, as directed by the Engineer, and no additional compensation will be allowed therefor.

Item 24: Clarification of Bid Items 47 and 47.A, 2" and 1" Service Connections. Refer to Bid Schedule 3, Water Improvements, Items 47 and 47.A for 2" and 1" Service Connections, and refer to Lake Hemet Municipal Water District Standards H-4 and H-5 on pages 90 and 91 of 195, in Appendix D of the Special Provisions.

The limits of the service connections required for this project are from the existing main line up to the proposed water meter boxes.

The Contractor shall furnish and install all the service connection assembly items and meter boxes listed and shown on LHMWD Standards H-4 and H-5 with the exception of the following items:

Multi-Jet Meters, Ball Valve Assemblies, and Backflow Devices

The contract price paid per each for 2" Service Connection and 1" Service Connections shall include full compensation for furnishing all labor, materials, tools, equipment, and incidentals for doing all the work involved in furnishing and installing service connections assemblies, including, meter boxes, gravel, excavation and backfill, as shown on the plans, as shown on LHMWD Standards H-4 and H-5, as specified in the Standard Specifications and these special provisions, and as directed by the Engineer, and no additional compensation will be allowed.

Item 25: Addition of Reference Drawings. Refer to Appendix B, Reference Drawings, of the Special Provisions. The following reference drawings are added by **Attachment "B"** and made part hereby:

- County Std. 403 for Curb Ramp-Case C, "T" Intersection with Sidewalk at Curb
- Brooks Products, Std. 3636 CV, 36" x 36" Catch Basin
- J&R Concrete Products, Std. P-E6B, Electrical Pull Box
- On-Site Detail – Accessible Curb Ramp
- On-Site Detail – Accessible Entry Signage
- On-Site Detail – Accessible Parking Stall
- On-Site Detail – Accessible Parking Signage
- On-Site Detail – Accessible Van Parking Signage
- On-Site Detail – Painted Accessible Parking Symbol
- On-Site Detail – Truncated Dome Tiles
- VWR&PD Std. LC-02 for Concrete Flatwork
- VWR&PD Std. LC-03 for Concrete Rebar and Joints
- VWR&PD Std. LC-12 for Tubular Steel Fencing
- VWR&PD Std. LC-13 for Tubular Steel Gate

MODIFICATIONS / CLARIFICATIONS TO THE PLANS

Item 26: Construction Notes and Opinion of Quantities Table. Refer to "Construction Notes & Opinion of

Quantities" table on sheets 2 through 9 of 11 on the plans.

Delete all the quantities found in the tables. These quantities are inaccurate and were inadvertently not deleted from the plans.

Contractors shall only refer to the quantities found on the bid items list, Proposal, attached herewith as **Attachment "A"**, for the preparation of their bid proposals.

Item 27: General Notes. Refer to "General Notes" on sheet 2 of 11 on the plans. Delete the General Notes found on sheet 2 of 11 of the plans and replace them with the following General Notes:

GENERAL NOTES

1. ALL MATERIAL AND WORK SHALL CONFORM TO THE JULY 2010 EDITION OF THE PLANS AND SPECIFICATIONS OF THE STATE OF CALIFORNIA DEPARTMENT OF TRANSPORTATION. UNLESS OTHERWISE NOTED.
2. LOCATIONS OF ALL UNDERGROUND UTILITIES ARE APPROXIMATE. THE CONTRACTOR SHALL DETERMINE THE EXACT LOCATIONS AND VERIFY ALL CONDITIONS ON THE JOB SITE PRIOR TO COMMENCING WORK. THE CONTRACTOR AGREES TO BE FULLY RESPONSIBLE FOR ANY AND ALL DAMAGES WHICH MIGHT BE OCCASIONED BY HIS FAILURE TO EXACTLY LOCATE AND PRESERVE ANY AND ALL UNDERGROUND UTILITIES. THE CONTRACTOR SHALL NOTIFY ALL CONCERNED UTILITY COMPANIES AT LEAST 48 HOURS IN ADVANCE OF EXCAVATION. CALL UNDERGROUND SERVICE ALERT AT (800) 227-2600.
3. SEE CALTRANS STANDARD PLANS, A10A, A10B, ES-1A AND ES-1B FOR SYMBOL AND ABBREVIATION LEGEND. (2010 EDITION)
4. EXISTING PRIVATELY OWNED IMPROVEMENTS ON PUBLIC RIGHT-OF-WAY SHALL BE PROTECTED OR REPLACED IF DAMAGED, AS DIRECTED BY THE ENGINEER.
5. CONTRACTOR LICENSE CLASS A REQUIRED.
6. IT SHALL BE THE RESPONSABILITY OF THE CONTRACTOR TO CLEAR THE RIGHTIF WAY IN ACCORDANCE WITH THE PROVISIONS OF LAW AS IT AFFECTS EACH UTILITY INCLUDING IRRIGATION LINES AND APPURTENANCES AND AT NO COST TO THE COUNTY.
7. THE CONTRACTOR SHALL BE RESPONSIBLE FOR PRESERVING OR RE-ESTABLISHING AND REFERENCING SURVEY MONUMENTS DESTROYED, DISTURBED OR BURIED AS A RESULT OF CONSTRUCTION SHOWN HEREON.
8. WHERE NEW PAVEMENT IS TO JOIN THE EXISTING PAVEMENT, THE EDGE OF THE EXISTING PAVEMENT SHALL BE TRIMMED IN A SMOOTH AND STRAIGHT LINE. CONSTRUCT MATCH-UP PAVING AS SHOWN ON THE PLANS AND OVERLAY PAVING AS DIRECTED IN THE FIELD TO PRODUCE A SMOOTH SECTION.
9. ALL OVERHANGING TREE LIMBS THAT ARE LESS THAN 14' ABOVE THE STREET GRADE SHALL BE TRIMMED BACK.

Item 28: Plan sheet revisions. The following Plan sheets are revised by **Attachment "C"** and made a part hereby:

Delete and replace the following eleven (11) plan sheets:

- | | |
|-----------------------|-------------------------|
| 1. Plan sheet 1 of 11 | 7. Plan sheet 7 of 11 |
| 2. Plan sheet 2 of 11 | 8. Plan sheet 8 of 11 |
| 3. Plan sheet 3 of 11 | 9. Plan sheet 9 of 11 |
| 4. Plan sheet 4 of 11 | 10. Plan sheet 10 of 11 |
| 5. Plan sheet 5 of 11 | 11. Plan sheet 11 of 11 |
| 6. Plan sheet 6 of 11 | |

Note: All revised plan sheets are posted on the County website and are available for download during the advertisement period.

<http://rctlma.org/trans/Contractors-Corner/Notices-Inviting-Bids>

This addendum has been prepared under the direction of the following registered Civil Engineer(s):



Susan Vombaur, PE

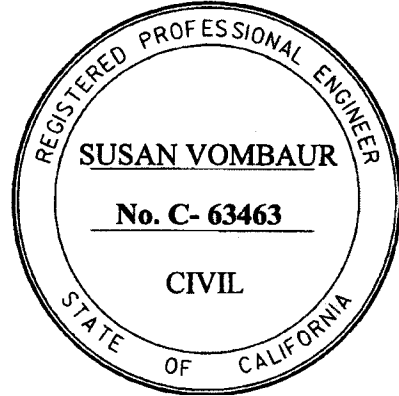

Concurrence:



4/14/16

Khalid Nasim, PE
Engineering Division Manager

Acknowledged: _____ **Date:** _____
(Contractor)

JRJ:jj:rr

Note: Refer to Instruction to Bidders Item No. 8, "Addenda". Submission of all addendum pages and non-bidding document attachments of addendum are not necessary for Bid submittal. Submittal of this acknowledgement page is adequate for Bid reception. Bidders are reminded to list addendum number(s) received on the first page of the Bid form (Proposal).

ATTACHMENTS

A – Revised Proposal

B – Reference Drawings

C – Revised Plans

**Exchange Club Park
Frontage Improvements Project
Mayberry Avenue and Fairview Avenue
Community of Valle Vista
Project No. C6-0081**

REVISED PROPOSAL

Bid Schedule 1

Mayberry Avneue and Fairview Avenue Frontage Improvements

ITEM No.	ITEM CODE	ITEM	UNIT	ESTIMATED QUANTITY	ITEM PRICE (IN FIGURES)	TOTAL (IN FIGURES)
1	760090	MOBILIZATION, DEMOBILIZATION, AND FINAL CLEANUP	LS	1		
2	066102	DUST ABATEMENT	LS	1		
3	000001	ITEM DELETED BY ADDENDUM No. 1	----	----	----	----
4	120100	TRAFFIC CONTROL SYSTEM	LS	1		
5	160101	CLEARING AND GRUBBING	LS	1		
6	170101	DEVELOP WATER SUPPLY	LS	1		
7	190101 (F)	ROADWAY EXCAVATION	CY	1,405		
8	260201	CLASS 2 AGGREGATE BASE	CY	915		
9	390130	HOT MIX ASPHALT	TON	1,021		
10	374002	ASPHALTIC EMULSION (FOG SEAL COAT)	TON	1.8		
11	731504	MINOR CONCRETE (CURB AND GUTTER) (CRS 201)	LF	1,105		
12	731521	MINOR CONCRETE (SIDEWALK) (CRS 401)	SQFT	7,050		
13	017312	MINOR CONCRETE (COMMERCIAL DRIVEWAY) (CRS 207A)	SQFT	1,780		
14	017315	MINOR CONCRETE (CURB RAMP) (1- CASE A, 1- MODIFIED CASE A, 2- CASE C)	EA	4		
15	017003	CATCH BASIN (CURB INLET) (CRS 300), W=14', [INCLUDING REMOVAL OF EXISTING INLET AND EXTENSION OF EXISTING RCP]	EA	1		
15.A	000003	DRAINAGE INLET FILTRATION	EA	1		
16	150742	REMOVE ROADSIDE SIGN	EA	5		
17	566012	ROADSIDE SIGN - ONE POST [STREET NAME SIGN]	EA	1		
18	566012	ROADSIDE SIGN - ONE POST	EA	3		
19	840656	PAINT TRAFFIC STRIPE (2-COAT)	LF	1,235		
19.A	597401	PAINT CURB (2-COAT) [RED]	LF	350		
20	840519	THERMOPLASTIC CROSS WALK AND PAVEMENT MARKINGS	SQFT	1,960		

Addendum No. 1, Page 21 of 49

REVISED PROPOSAL

Bid Schedule 1 (continued)

Mayberry Avneue and Fairview Avenue Frontage Improvements

ITEM No.	ITEM CODE	ITEM	UNIT	ESTIMATED QUANTITY	ITEM PRICE (IN FIGURES)	TOTAL (IN FIGURES)
21	010602	MISCELLANEOUS WORK (AS DIRECTED)	FA	1	25,000.00	25,000.00

BID SCH. 1

SUB-TOTAL:

\$

ITEMS 1-21

"WORDS"

Bid Schedule 2

Site Grading and Parking Lot Construction

ITEM No.	ITEM CODE	ITEM	UNIT	ESTIMATED QUANTITY	ITEM PRICE (IN FIGURES)	TOTAL (IN FIGURES)
22	066102	DUST ABATEMENT	LS	1		
23	160101	CLEARING AND GRUBBING	LS	1		
24	170101	DEVELOP WATER SUPPLY	LS	1		
25	074020	WATER POLLUTION CONTROL (ON-SITE AND STREET IMPROVEMENTS)	LS	1		
26	190101	OVER EXCAVATE, IMPORT MATERIAL, RECOMPACT & EXCAVATION (SITE GRADING)	LS	1		
27	260201	CLASS 2 AGGREGATE BASE	CY	640		
28	390130	HOT MIX ASPHALT (PARKING LOT PAVING)	TON	940		
29	000003	PVC CONDUIT INSTALLATION [FOR FUTURE PARKING LOT LIGHTING]	LF	500		
30	000003	6" TYPE "A-6" CONCRETE PARKING LOT CURB & GUTTER (CRS 200)	LF	1,000		
31	000003	6" TYPE "D" CONCRETE PARKING LOT CURB (CRS 204)	LF	600		
32	017317	MINOR CONCRETE (WIDENED CURB AT END STALLS IN PLANTERS)	SQFT	400		
32.A	731521	MINOR CONCRETE (SIDEWALK) (VWPD STD LC-02 AND LC-03)	SQFT	5,240		
32.B	731502	MINOR CONCRETE (MISCELLANEOUS CONSTRUCTION) [6" THICK PCC WITH 6x6-W1.4xW1.4 WELDED WIRE MESH]	SQFT	380		
32.C	731502	MINOR CONCRETE (MISCELLANEOUS CONSTRUCTION) [6" THICK V-GUTTER]	SQFT	270		
33	000003	2' X 2' CONCRETE CATCH BASIN (BROOKS No. 2424 T24 W/ STEEL GRATE) W/THREE (3) 6" HDPE DRAIN LINES TO INFILTRATION (DETENTION) BASIN	EA	1		
33.A	000003	3' X 3' BROOKS CB3636 CATCH BASIN (INCLUDING ONE (1) 12" HDPE DRAIN LINE TO BACK OF STREET CATCH BASIN ON MAYBERRY AVENUE)	EA	1		

Addendum No. 1, Page 22 of 49

Note: See 'Instructions to Bidders' item 15, Like Bid Items. "Like Bid Item" bidding requirement does not apply to this project.

REVISED PROPOSAL

Bid Schedule 2 (continued)

Site Grading and Parking Lot Construction

ITEM No.	ITEM CODE	ITEM	UNIT	ESTIMATED QUANTITY	ITEM PRICE (IN FIGURES)	TOTAL (IN FIGURES)
34	000003	PARKING LOT STRIPING AND PAVEMENT MARKINGS, AND PARKING LOT BUMPERS	LS	1		
35	000003	PARKING LOT SIGNING [4 EA. HANDICAP STALLS & 2 EA. HANDICAP NOTICE AT DRIVEWAY ENTRANCES]	EA	6		
36	000003	PARKING LOT HANDICAPPED RAMPS	EA	3		
37	000003	6" PVC SCH 80 CONDUIT / SLEEVES FOR FUTURE, VERIZON & CATV	LF	140		
37.A	000003	5" PVC SCH 80 CONDUIT / SLEEVES FOR FUTURE, SCE	LF	380		
38	860401	STREET LIGHT (INSTALLATION OF CONDUIT AND PULL BOXES) [AT MAYBERRY AVENUE AND FAIRVIEW AVENUE]	LF	630		
39	000001	ITEM DELETED BY ADDENDUM No. 1	----	----	----	----
39.A	010602	MISCELLANEOUS WORK (AS DIRECTED)	FA	1	25,000.00	25,000.00
39.B	210430	HYDROSEED (GRADED AREAS)	ACRE	6.5		
39.C	000003	INSTALL 6' TUBULAR STEEL FENCING INCLUDING GATE	LF	715		

BID SCH. 2

SUB-TOTAL:

ITEMS 22-39.C

"WORDS"

\$

Bid Schedule 3

Water Improvements

ITEM No.	ITEM CODE	ITEM	UNIT	ESTIMATED QUANTITY	ITEM PRICE (IN FIGURES)	TOTAL (IN FIGURES)
40	000003	6" FIRE HYDRANT ASSEMBLY W/GATE VALVE (PER LHMWD STD. H-2B)	EA	1		
40.A	000003	6" (PVC) WATER LINE	LF	180		
41	000003	6" DOUBLE CHECK DETECTOR ASSEMBLY (PER LHMWD STD. H-3)	EA	1		
42	000003	POST INDICATOR VALVE/FIRE DEPT. CONNECTION	EA	1		
43	000003	4" WATER LINE FOR FIRE SPRINKLERS	LF	120		
43.A	000003	6" MISCELLANEOUS FITTINGS	EA	2		
44	000001	ITEM DELETED BY ADDENDUM No. 1	----	----	----	----
45	000003	4" MISCELLANEOUS FITTINGS	EA	1		

Note: See 'Instructions to Bidders' item 15, Like Bid Items. "Like Bid Item" bidding requirement does not apply to this project.

REVISED PROPOSAL

Bid Schedule 3 (continued)

Water Improvements

ITEM No.	ITEM CODE	ITEM	UNIT	ESTIMATED QUANTITY	ITEM PRICE (IN FIGURES)	TOTAL (IN FIGURES)
46	000001	ITEM DELETED BY ADDENDUM No. 1	----	----	----	----
47	000003	2" SERVICE CONNECTIONS (PER LHMWD STD. H-4)	EA	1		
47.A	000003	1" SERVICE CONNECTIONS (PER LHMWD STD. H-5)	EA	2		
47.B	000003	THRUST BLOCKS	CY	2		
48	000001	ITEM DELETED BY ADDENDUM No. 1	----	----	----	----
49	000003	REMOVE 90 BEND & REPLACE WITH TEE FOR FIRE LINE (12X6X6)	EA	1		

BID SCH. 3

SUB-TOTAL: _____ \$ _____
ITEMS 40-49 "WORDS"

Bid Schedule 4

Sewer Improvements

ITEM No.	ITEM CODE	ITEM	UNIT	ESTIMATED QUANTITY	ITEM PRICE (IN FIGURES)	TOTAL (IN FIGURES)
50	000003	8" (PVC) SEWER LATERAL TO SCHOOL CLASS ROOMS P.O.C.	LF	720		
51	000003	CLEANOUTS @ 100-FOOT INTERVALS	EA	7		
51.A	000003	8" (PVC) SEWER WYE	EA	1		
52	000003	TIE INTO EXISTING SEWER MANHOLE IN FAIRVIEW AVENUE (LHMWD)	EA	1		

BID SCH. 4

SUB-TOTAL: _____ \$ _____
ITEMS 50-52 "WORDS"

BID SCHEDULES 1, 2, 3 and 4

PROJECT TOTAL: _____ \$ _____
ITEMS 1-52 "WORDS"

Page 24 of 49
Addendum No. 1

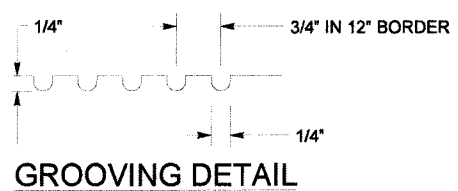
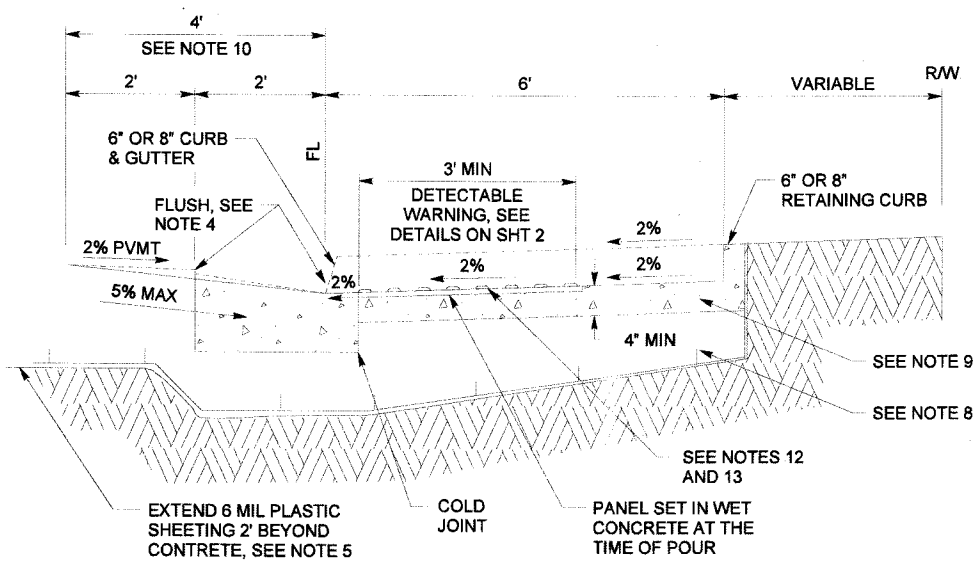
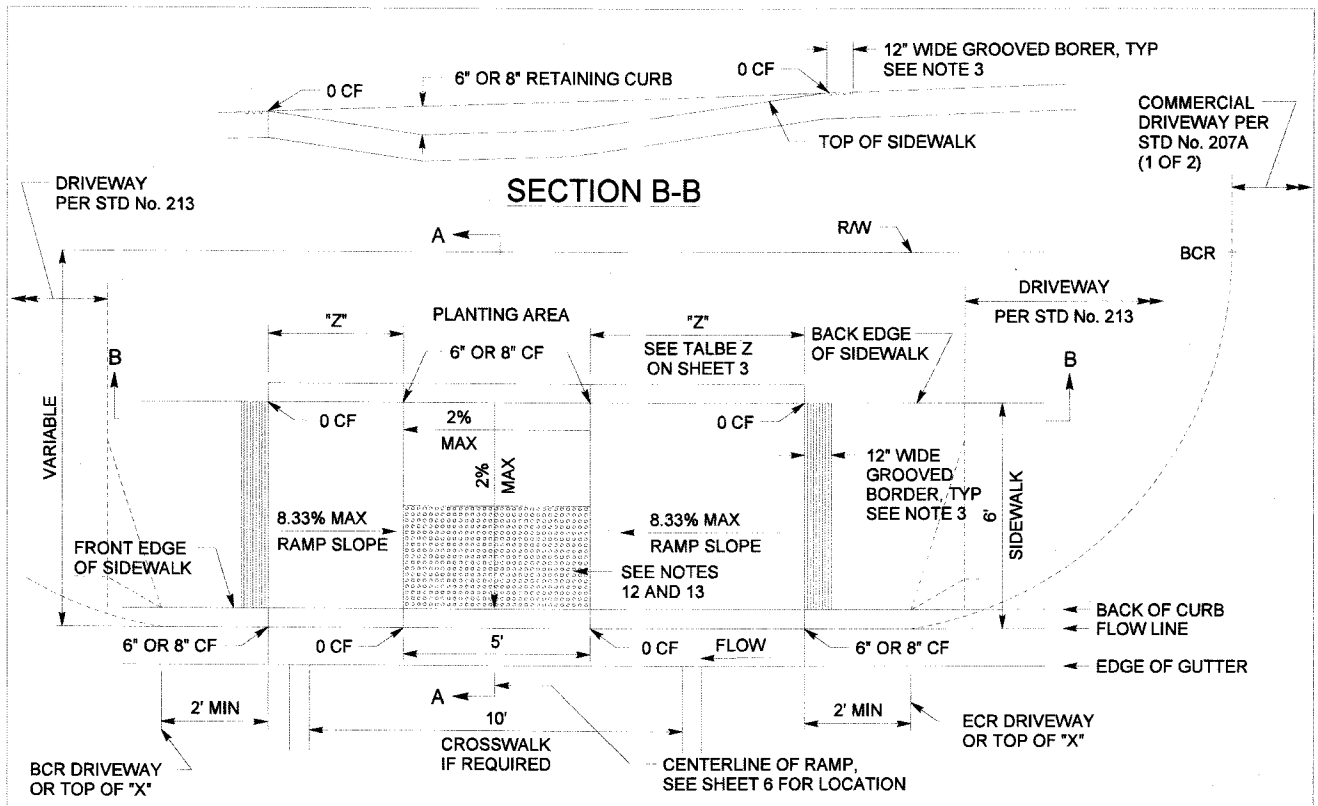

FOR NOTES SEE SHEET 7 OF 7
SEE NOTE 16 FOR CONSTRUCTION TOLERANCES

APPROVED BY:

DATE: 00/00/00

DIRECTOR OF TRANSPORTATION
JUAN C. PEREZ, RCE 49568

DATE



COUNTY OF RIVERSIDE

**CURB RAMP-CASE C
"T" INTERSECTION
WITH SIDEWALK AT CURB**

NO SCALE

STANDARD No. 403 (←→)

REVISIONS	REV	BY:	APR'D	DATE	REV	BY:	APR'D	DATE
	1	JK	JP	08-05-10				
	2							
	3							

3636 STEEL GRATES - 1 Pc.

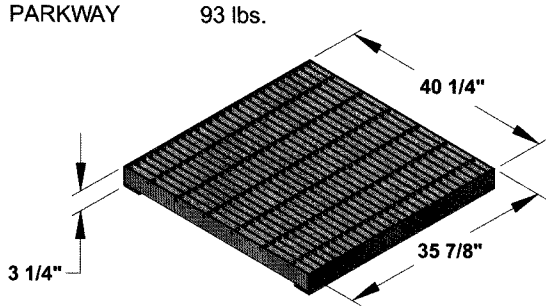

3636 FRAME ONLY

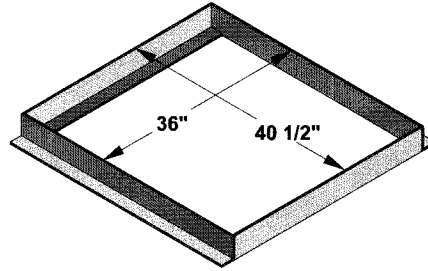

3636 STEEL GRATES - 2 Pc.

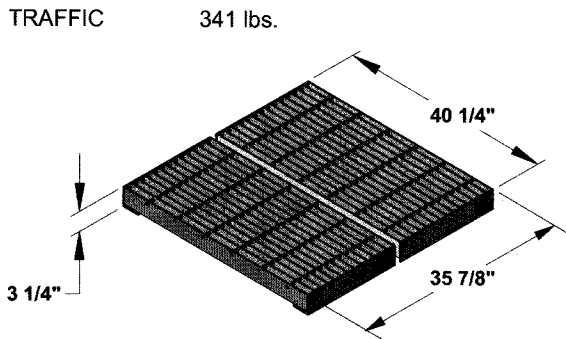

3636 EXTENSION (NO FRAME)

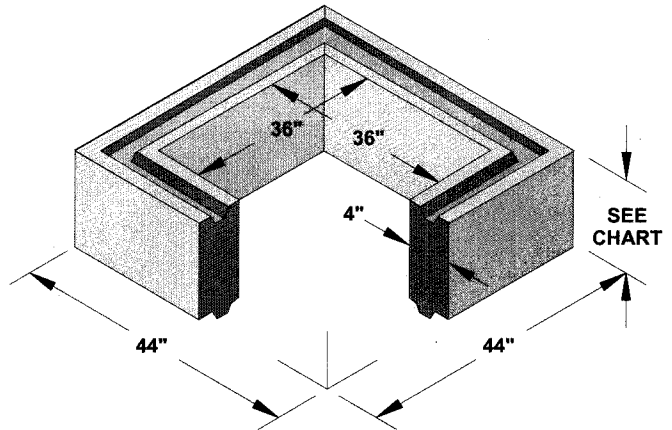

3636 STEEL COVER - 1 Pc.

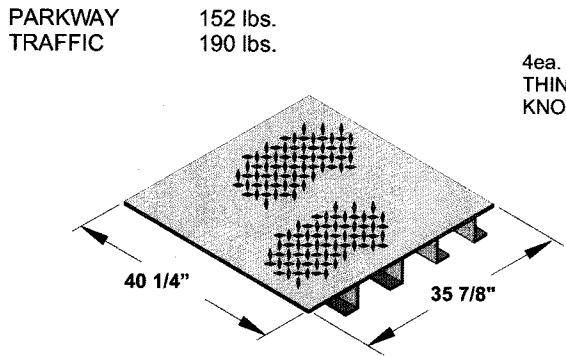

3636 BOTTOM SECTION (NO FRAME)

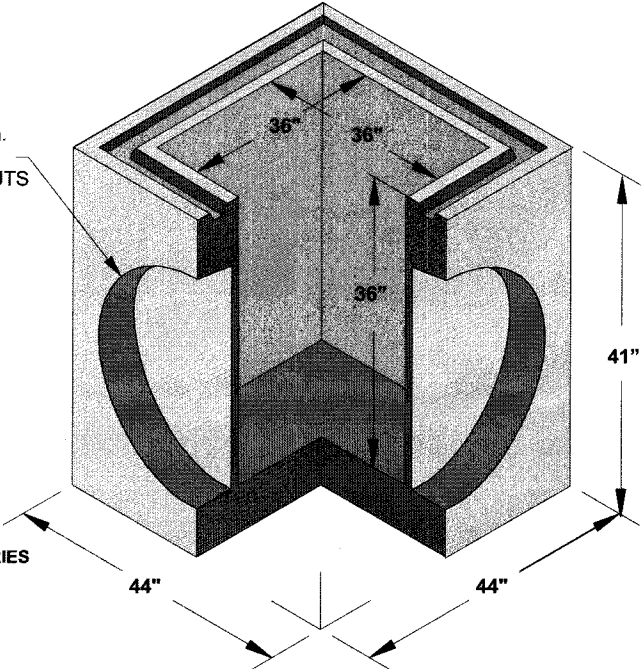

NOTES:

1. GRATES AND COVERS AVAILABLE PAINTED BLACK OR GALVANIZED
2. "ADA" OR "HEEL-PROOF" GRATES ARE **NOT AVAILABLE** FOR THIS SERIES
3. BOLT DOWN GRATES AND COVERS ARE AVAILABLE

EXTENSION SECTION	HT.	LBS	KNOCK-OUTS
3636 E6	6"	525	NONE
3636 E12	12"	1050	NONE

BOTTOM SECTION	HT.	LBS	KNOCK-OUTS
3636 B36	36"	2,230	(4) 30" DIA.

**36" x 36"
CATCH BASIN**

BROOKE PRODUCTS

3636 CB

ORG. DWG. DATE 11-23-99	REV. DWG. DATE 02-18-00
-----------------------------------	-----------------------------------

7 0 5
Addendum No. 1, Page 26 of 49

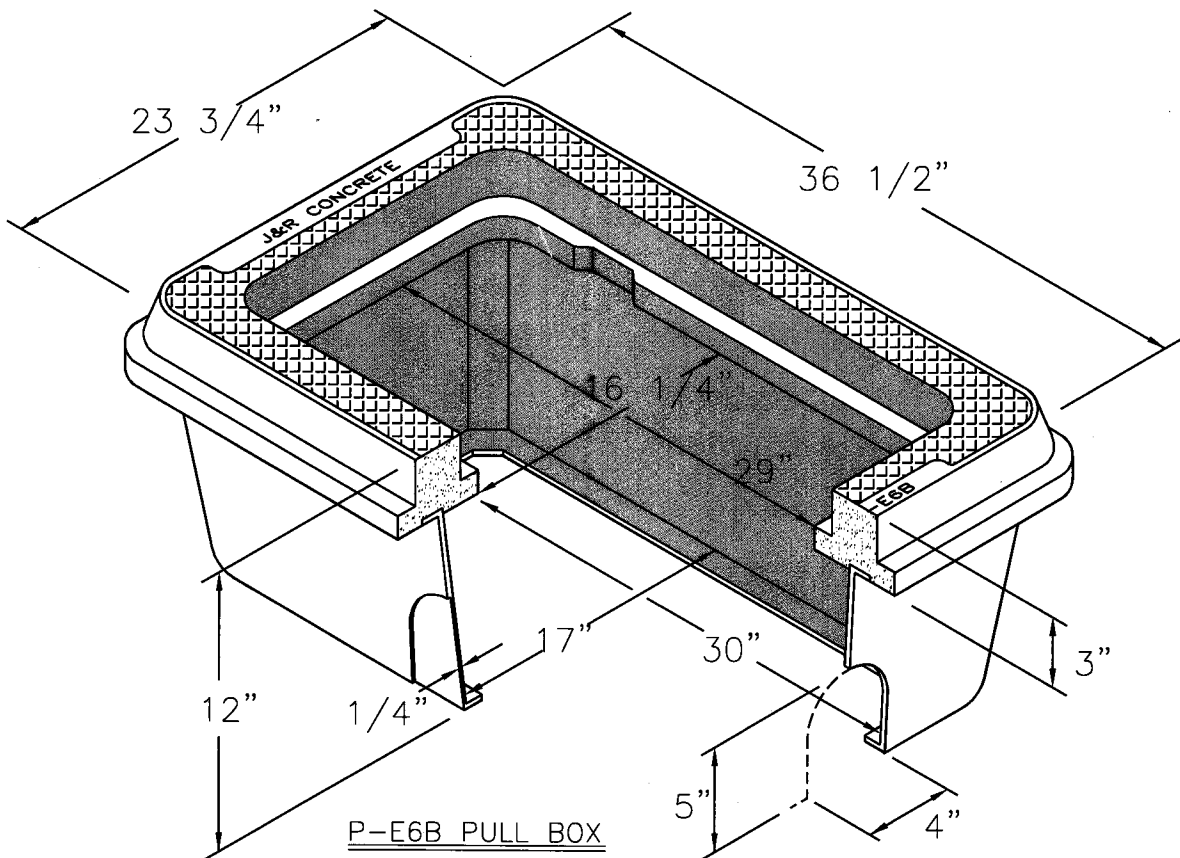
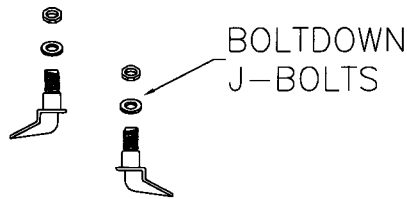
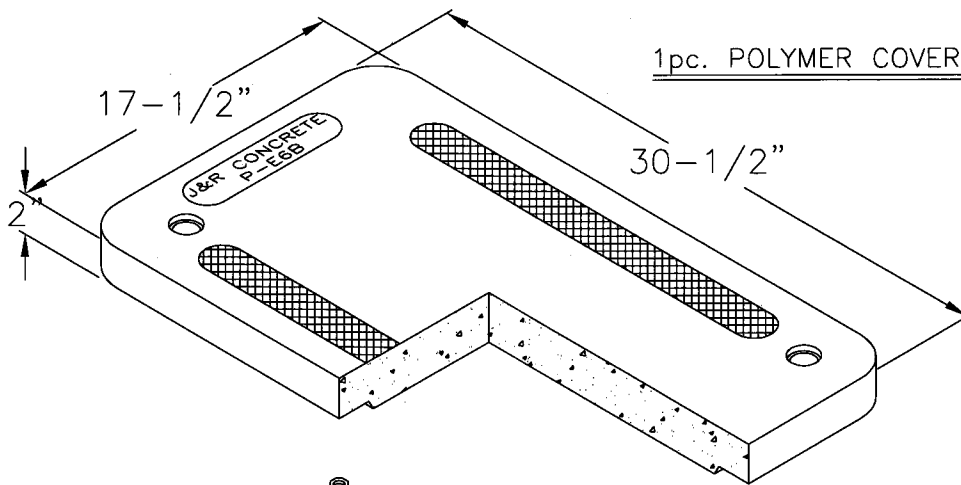
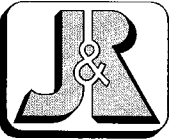

Addendum No. 1, Page 27 of 49

P-E6B Polymer Series / 17" x 30"
Electrical Pullbox w/ Fiberglass
Body & Polymer Concrete Ring

J&R CONCRETE PRODUCTS

440 W. MARKHAM ST.
PERRIS, CA. 92571
PHONE:(951) 943-5855 FAX:(951) 940-9207

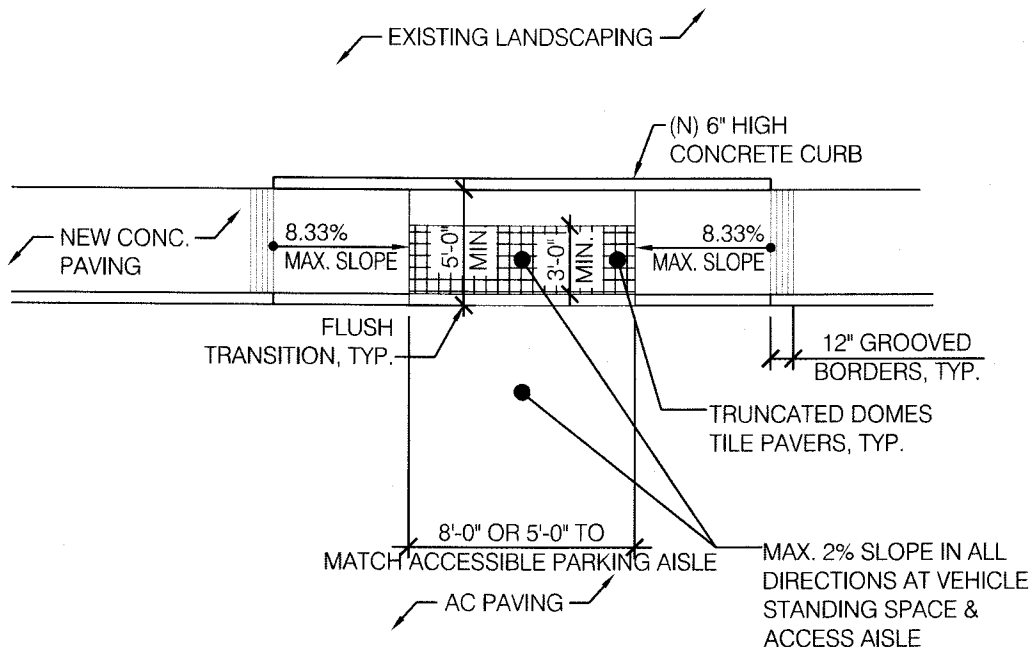

ACCESSIBLE CURB RAMP

1/8" = 1'-0"

**EXCHANGE CLUB PARK
ON-SITE DETAIL**

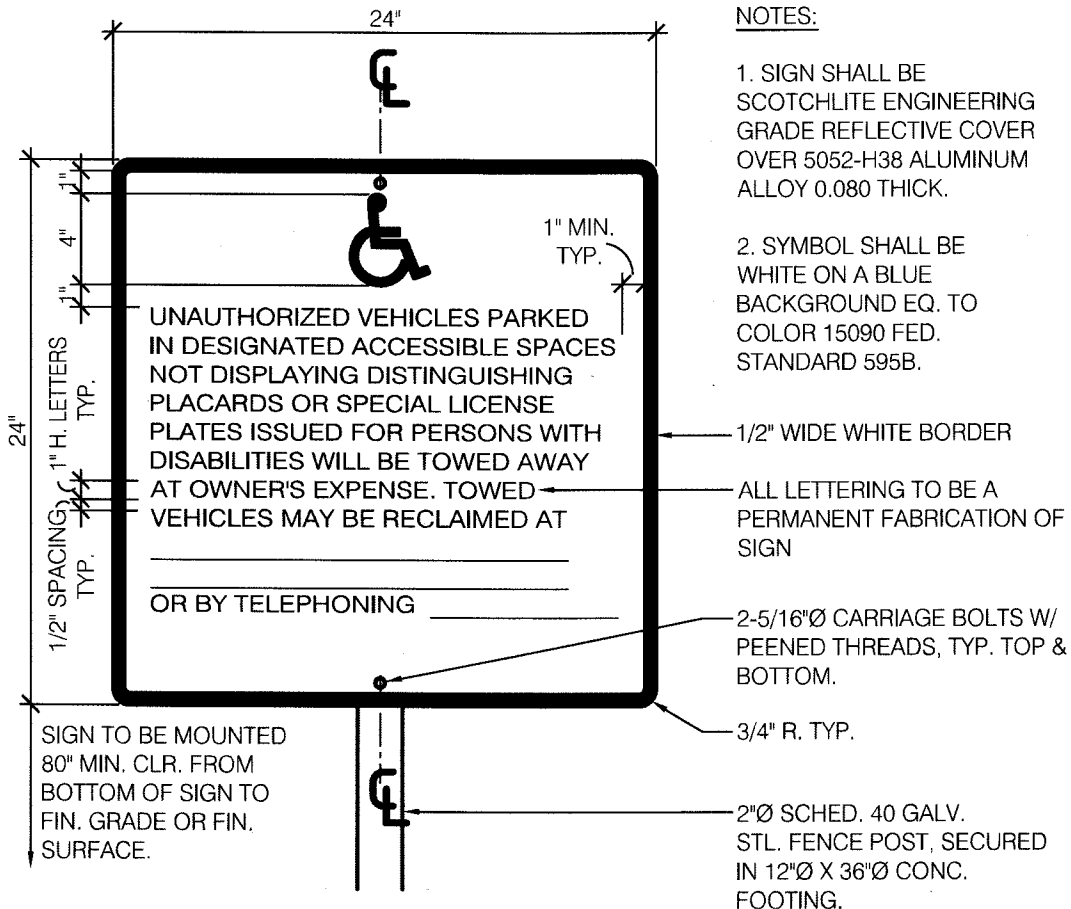

ACCESSIBLE ENTRY SIGNAGE

1 1/2" = 1'-0"

**EXCHANGE CLUB PARK
ON-SITE DETAIL**

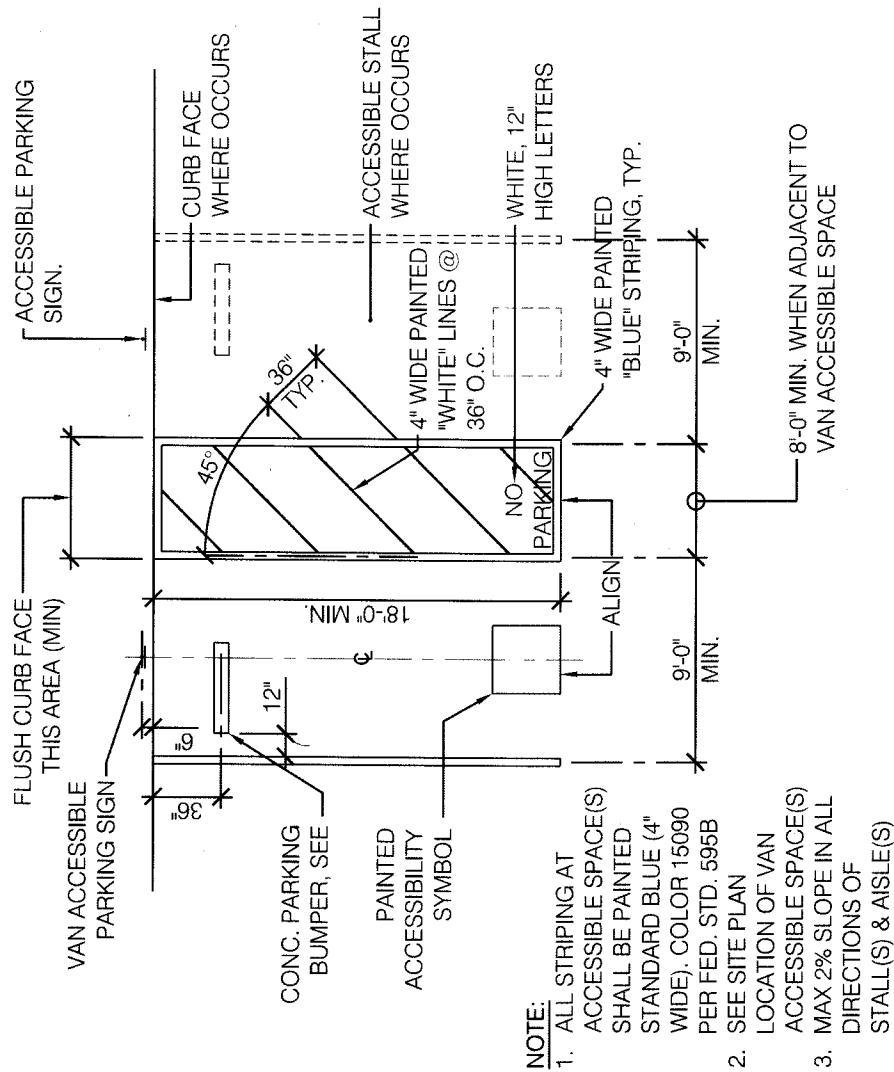

ACCESSIBLE PARKING STALL

1/8" = 1'-0"

**EXCHANGE CLUB PARK
ON-SITE DETAIL**

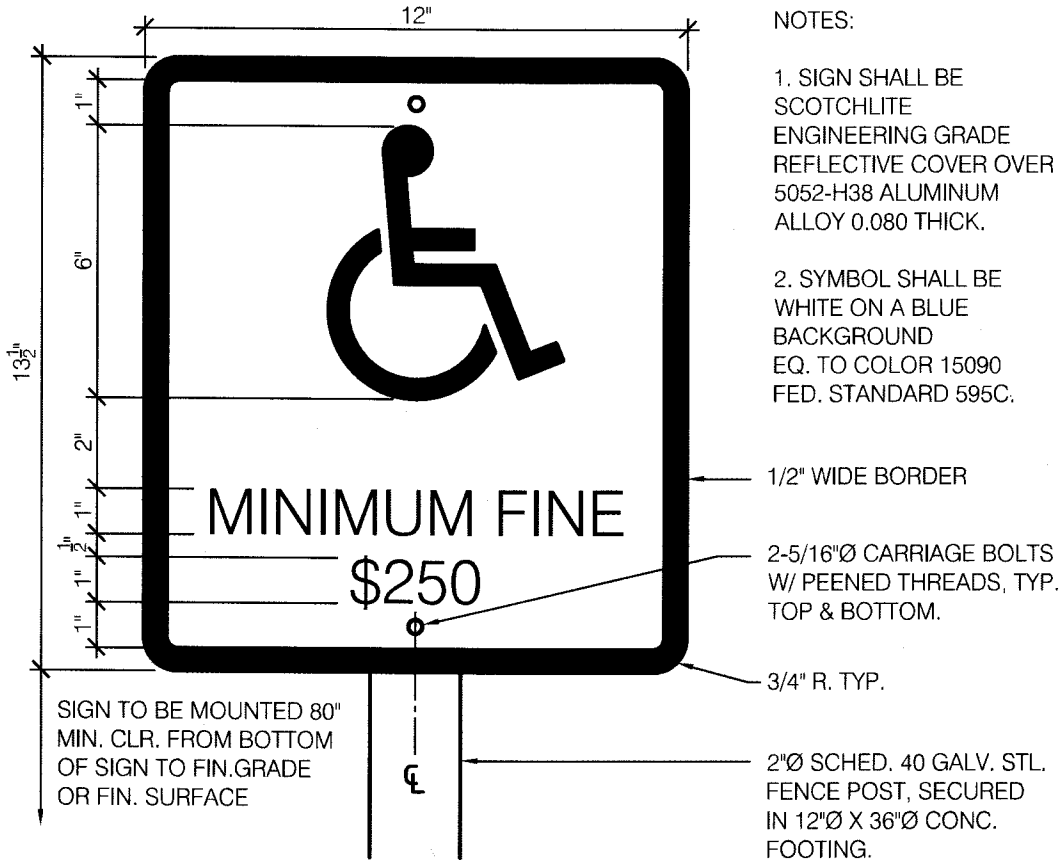

Addendum No. 1, Page 31 of 49

ACCESSIBLE PARKING SIGNAGE

3" = 1'-0"

**EXCHANGE CLUB PARK
ON-SITE DETAIL**

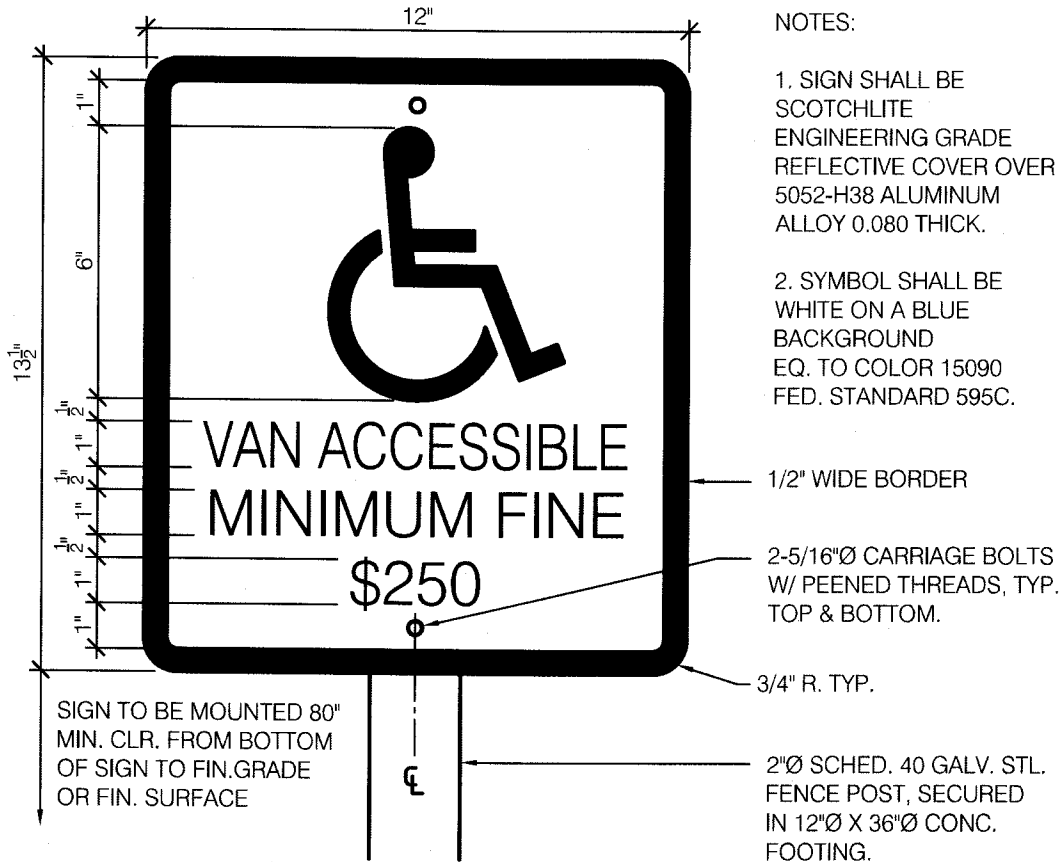

Addendum No. 1, Page 32 of 49

ACCESSIBLE VAN PARKING SIGNAGE

3" = 1'-0"

**EXCHANGE CLUB PARK
ON-SITE DETAIL**

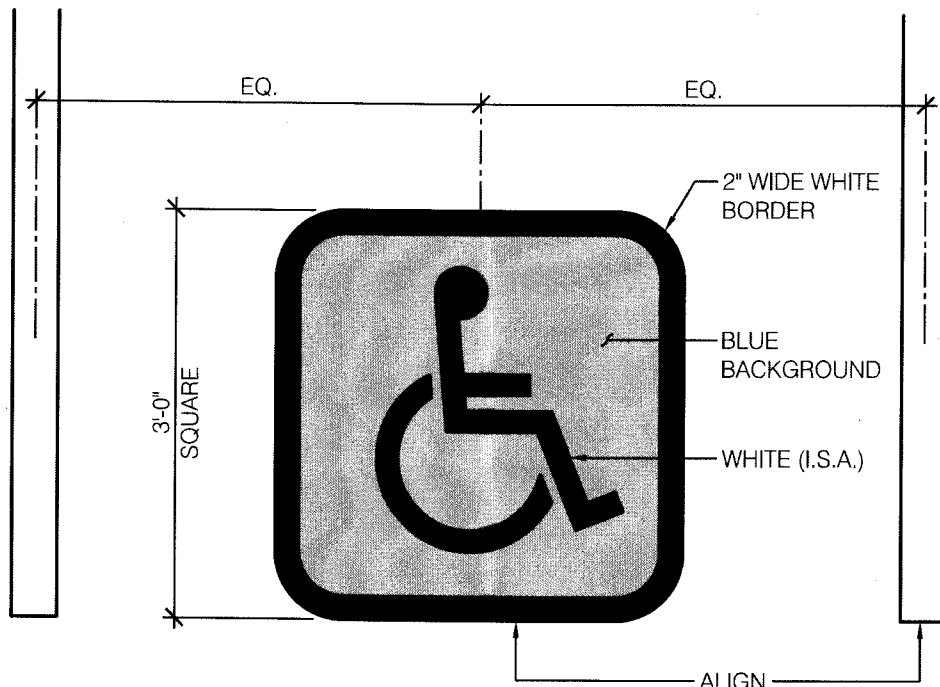

NOTE:
 INTERNATIONAL SYMBOL OF
 ACCESSIBILITY (I.S.A.) PAINTED
 WHITE REFLECTORIZED STRIPING
 ON BLUE BACKGROUND COLOR
 #15090 FED. STD. 595C

PAINTED ACCESSIBLE PARKING SYMBOL

3/4" = 1'-0"

Addendum No. 1, Page 33 of 49

**EXCHANGE CLUB PARK
 ON-SITE DETAIL**

Addendum No. 1, Page 35 of 49

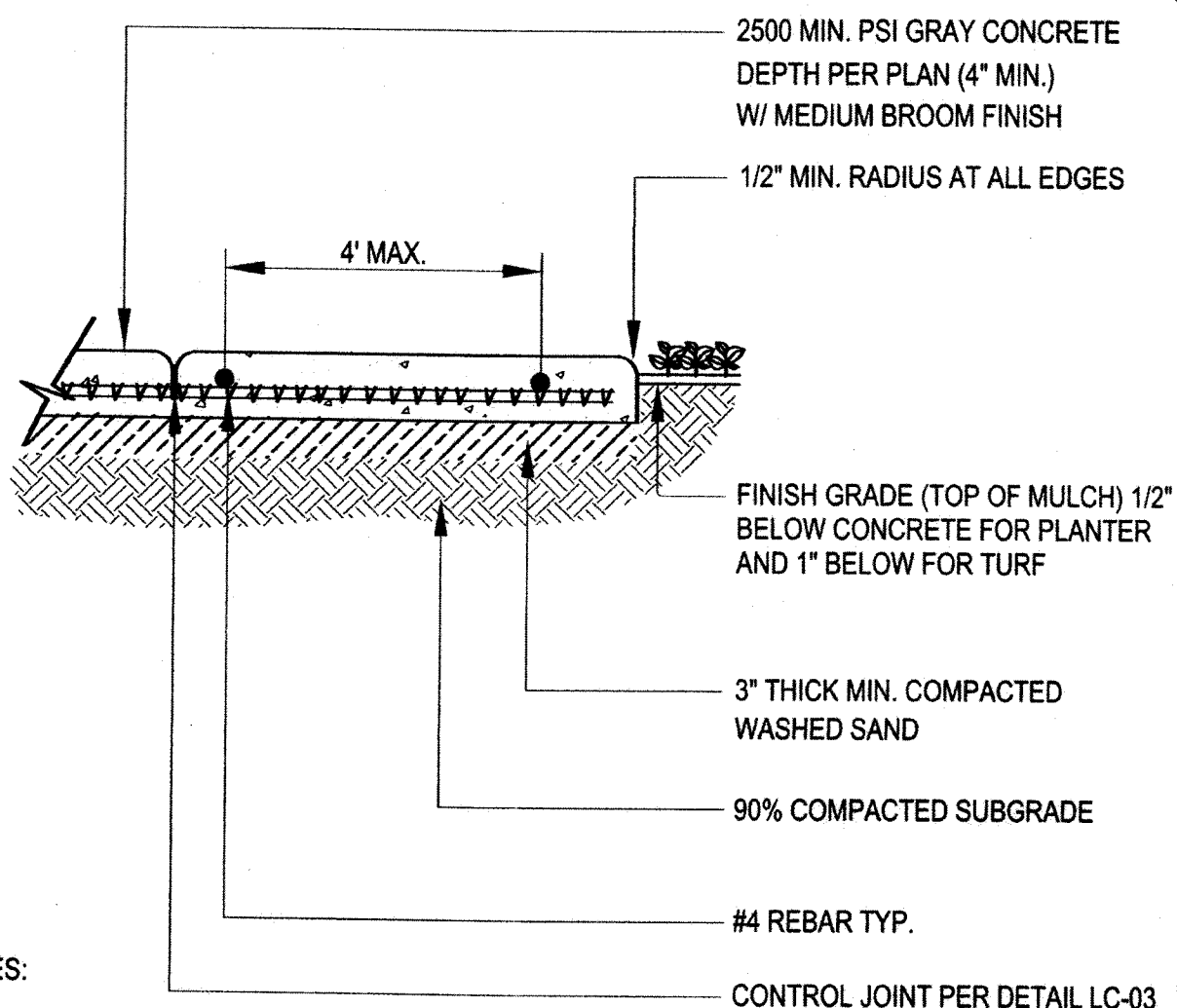

NOTES:

- CONCRETE CROSS SLOPE SHALL NOT BE GREATER THAN 2%
- CONCRETE LONGITUDINAL SLOPE SHALL NOT BE GREATER THAN 5% WITHOUT HANDRAILS
- CONCRETE SHALL NOT BE FLATTER THAN 0.5% TO AVOID PONDING
- PROVIDE 3/8" FELT EXPANSION JOINTS WHEN CONCRETE JOINS WITH A BLOCK WALL OR OTHER STRUCTURE
- ALL CONCRETE MUST COMPLY WITH ADA REGULATIONS
- PROVIDE #4 REBAR AT 4' SQUARE SPACING (2 CONTINUOUS ALONG SIDEWALKS)
- ALL CONCRETE FORMS MUST BE INSPECTED PRIOR TO POURING
- ALL CONCRETE AND SUBGRADES SHALL COMPLY WITH SOILS REPORT
- REFER TO ADDITIONAL REQUIREMENTS ON DETAIL LC-03

LD Consulting 2011 (Any deviation or reproduction of this design must be approved in writing by Valley-Wide Recreation & Park District)



VALLEY-WIDE RECREATION & PARK DISTRICT

CONCRETE FLATWORK

LC-02
REV. 2011

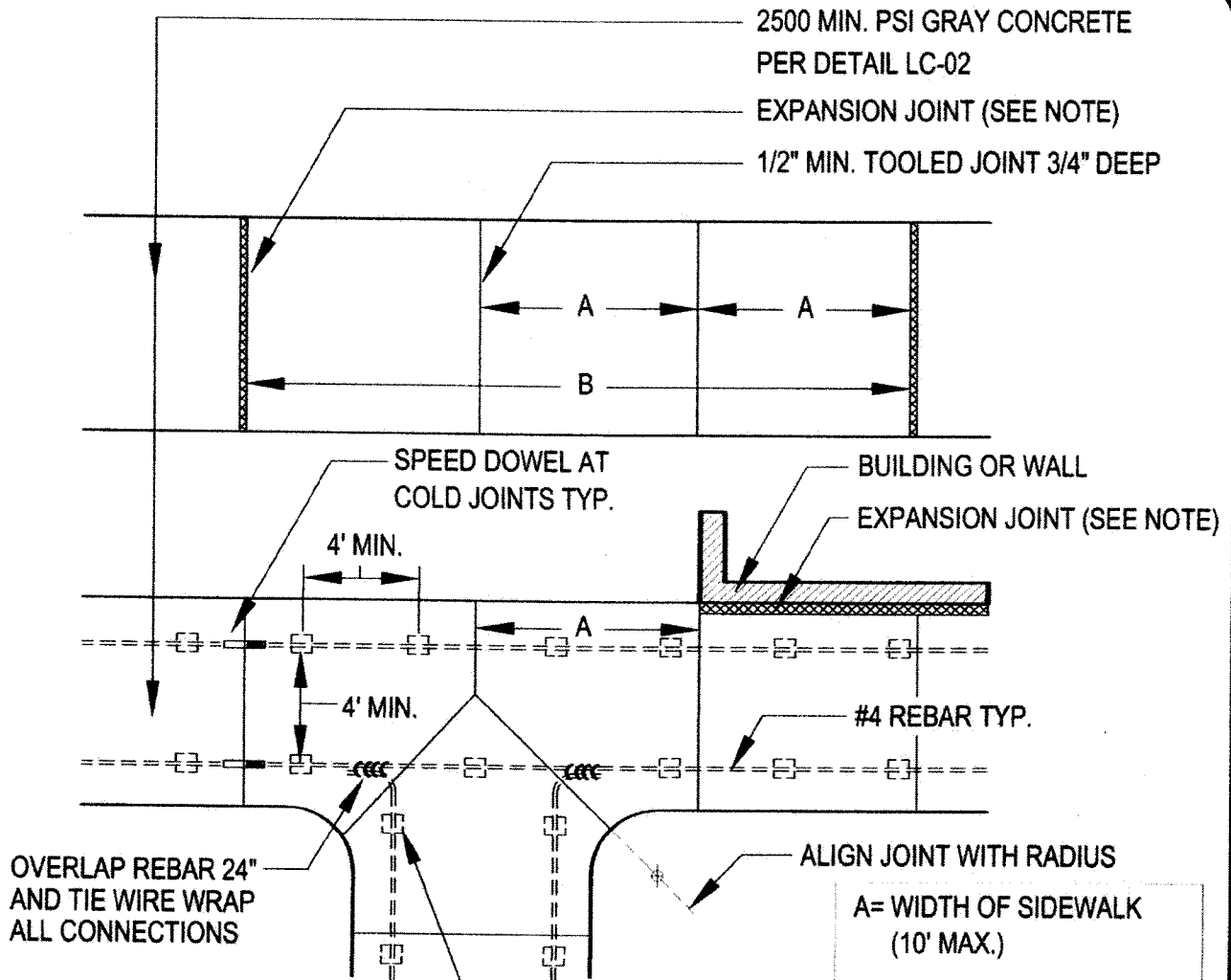

NOTES:

- ALL JOINTS SHALL BE PERPENDICULAR TO CONCRETE EDGE
- ALL JOINTS SHALL BE HAND TOOLED AND SAWCUT TO A DEPTH OF 1-1/2"
- SAW CUTTING IN LIEU OF TOOLED JOINT MUST BE APPROVED IN WRITING BY THE DISTRICT
- PROVIDE 3/8" FELT EXPANSION JOINTS WHEN CONCRETE JOINS WITH WALL OR BUILDING
- PROVIDE 3/8" FELT EXPANSION JOINTS AT 30 FOOT SPACING TYP.
- PROVIDE ALL RAMP JOINT TOOLING PER ADA STANDARDS
- SPEED DOWELS SHALL BE USED BETWEEN EACH COLD JOINT POURS
- ALL REBAR MUST BE 2" FROM ANY EDGE OF CONCRETE AND BE SECURED TO A 2"X2" MINIMUM CONCRETE BLOCK AT 4' O.C. MINIMUM SPACING PER SPECS.
- DRILL AND SECURE REBAR WITH EPOXY AGAINST ALL EXISTING COLD JOINTS WITH SPEED DOWELS

LD Consulting 2011 (Any deviation or reproduction of this design must be approved in writing by Valley-Wide Recreation & Park District)



VALLEY-WIDE RECREATION & PARK DISTRICT

CONCRETE REBAR AND JOINTS

LC-03
REV. 2011

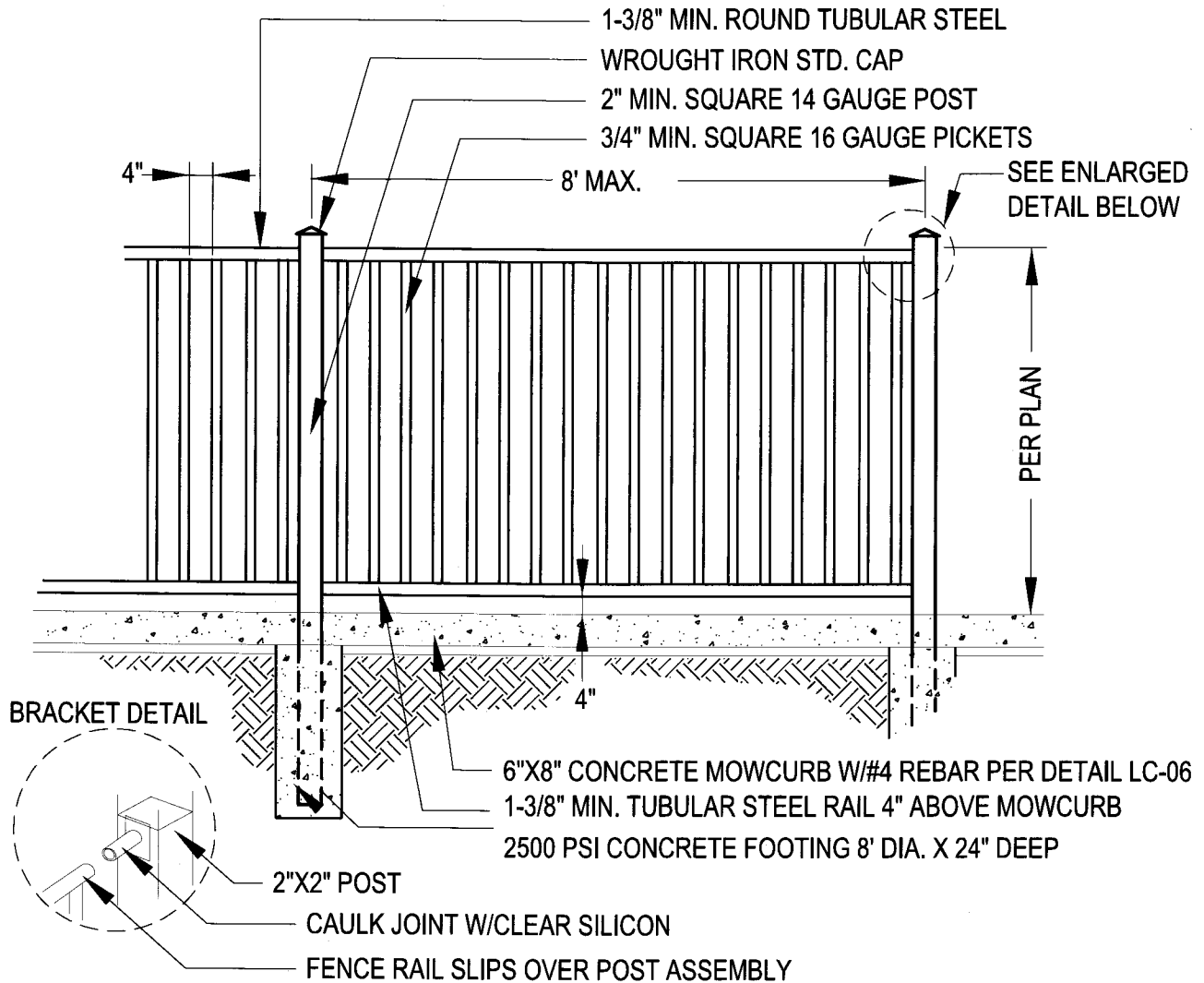

NOTES:

- ALL PANELS AND POST MUST BE BLACK POWDER COATED.
- CONCRETE MOWCURB MUST BE CONTINUOUS BELOW ALL TUBULAR STEEL FENCING TYP.
- CONTRACTOR MUST CONFIRM RAIL PANELS FIT PROPERLY PRIOR TO FOOTING INSTALLATION
- TOP OF FOOTING MUST BE AT ELEVATION TO ACCOMMODATE 6" DEEP FORM BOARDS AND
- CONCRETE MOWCURB TO BE POURED AFTER FOOTING AND POST INSTALLATION ALONG ALL FENCING
- VERTICAL PICKETS SHALL HAVE 4-1/2" OPENING MAX. 2" MAX. OPENING WHEN USED AT DOG PARKS
- BOTTOM RAIL TO BE 4" FROM TOP OF MOWCURB. BOTTOM RAIL TO BE 2" FROM TOP FOR DOG PARKS
- ALL FOOTINGS ARE SUBJECT TO SAME REQUIREMENTS INDICATED ON NOTE 4 OF DETAIL LC-06

LD Consulting 2012 (Any deviation or reproduction of this design must be approved in writing by Valley-Wide Recreation & Park District)



VALLEY-WIDE RECREATION & PARK DISTRICT

TUBULAR STEEL FENCING

LC-12
REV. 2012

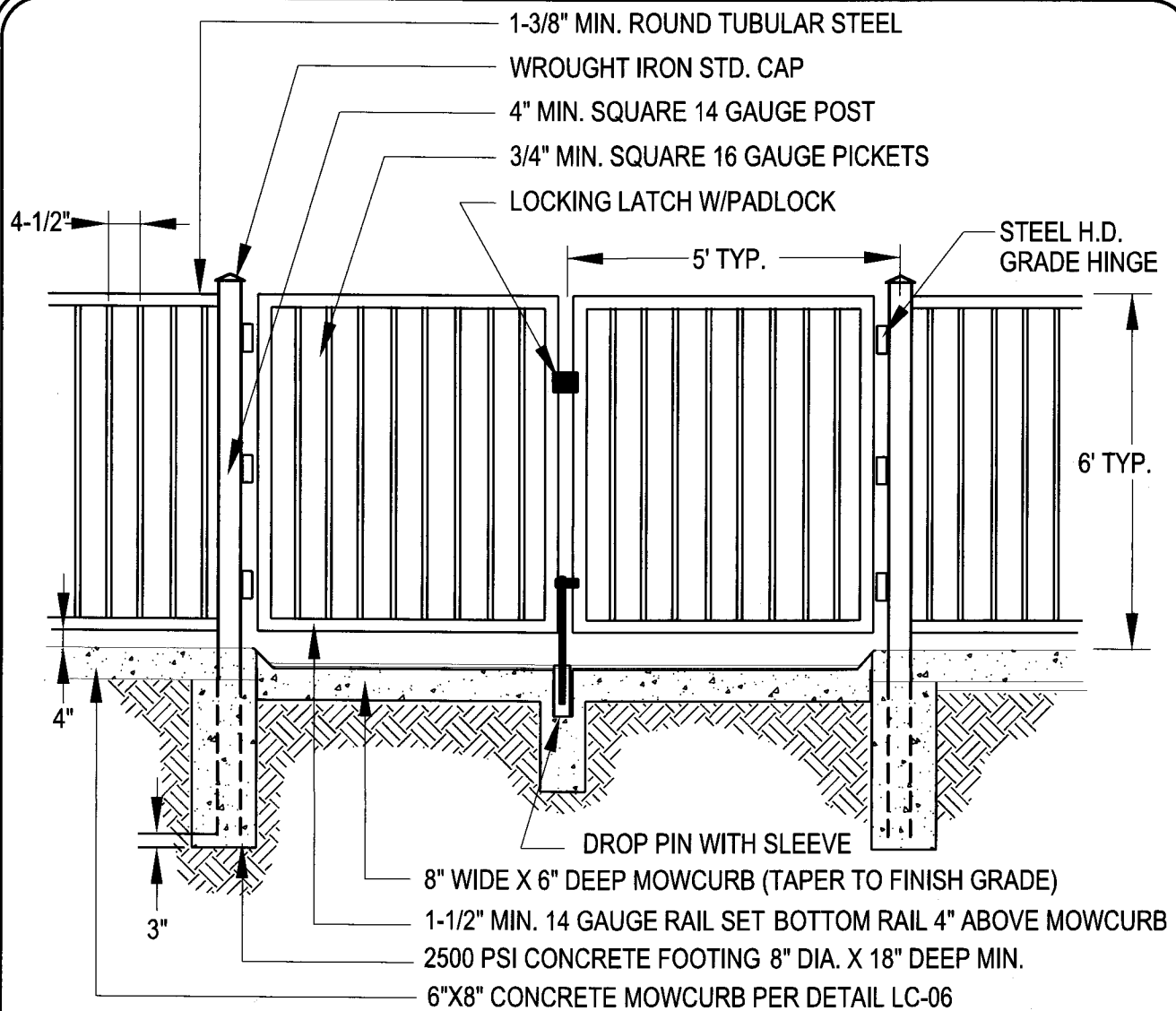

NOTES:

ALL PANELS AND POST MUST BE BLACK POWDER COATED. WHEN NEEDED, ALL WELDS FOR GATE HINGES MUST HAVE ONE COAT EPOXY PRIMER & TWO COATS OF EXTERIOR ENAMEL
 TOP OF FOOTING MUST BE AT ELEVATION TO ACCOMMODATE 6" DEEP FORM BOARDS AND CONCRETE MOWCURB TO BE POURED AFTER FOOTING AND POST INSTALLATION ALONG ALL FENCING
 VERTICAL PICKETS SHALL HAVE BE AT 4-1/2" O.C. 2" MAX. OPENING WHEN USED AT DOG PARKS
 BOTTOM RAIL TO BE 4" FROM TOP OF MOWCURB. BOTTOM RAIL TO BE 2" FOR DOG PARKS
 ALL FOOTINGS ARE SUBJECT TO SAME REQUIREMENTS INDICATED ON NOTE 4 OF DETAIL LC-06

LD Consulting 2012 (Any deviation or reproduction of this design must be approved in writing by Valley-Wide Recreation & Park District)



VALLEY-WIDE RECREATION & PARK DISTRICT

TUBULAR STEEL GATE

LC-13
REV. 2012



**VALLEY-WIDE RECREATION
AND PARK DISTRICT**
AWARD WINNING CALIFORNIA PARKS

BOARD OF DIRECTORS:

- DEAN WETTER - GENERAL MANAGER
- LARRY MINOR - PRESIDENT
- MATTHEW DUARTE - VICE PRESIDENT
- JOHN BRAGG - SECRETARY
- FRANK GORMAN - MEMBER
- STEVE SIMPSON - MEMBER

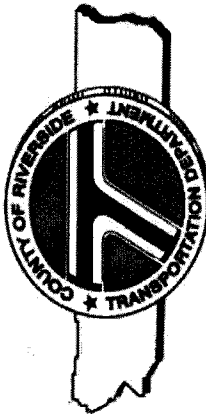

BOARD OF SUPERVISORS:

- KEVIN JEFFRIES - FIRST DISTRICT
- JOHN F. TAVAGLIONE - SECOND DISTRICT
- CHUCK WASHINGTON - THIRD DISTRICT
- JOHN J. BENOIT - FOURTH DISTRICT / CHAIRMAN
- MARION ASHLEY - FIFTH DISTRICT

**TRANSPORTATION AND
LAND MANAGEMENT AGENCY**

- JUAN C. PEREZ, P.E., T.E. - DIRECTOR
- PATRICIA ROMO, P.E. - ASSISTANT DIRECTOR
- SUSAN VOMBAUR, P.E., T.E. - PROJECT MANAGER

IN THE UNINCORPORATED TERRITORY OF THE COUNTY OF RIVERSIDE, STATE OF CALIFORNIA

EXCHANGE CLUB PARK

A JOINT USE FACILITY FOR HEMET UNIFIED & VALLEY WIDE RECREATION
LAND PROVIDED BY THE COUNTY OF RIVERSIDE, BY THE EFFORTS OF FORMER
THIRD DISTRICT SUPERVISOR, MR. JAMES VENABLE



HEMET
Unified School District

HUSD SCHOOL BOARD:

- MARILYN FORST - BOARD MEMBER
 - MEGAN HALEY - BOARD MEMBER
 - VIC SCAVARDA - BOARD MEMBER
 - PATRICK SEARL - BOARD MEMBER
 - JIM SMITH - BOARD MEMBER
 - HORACIO VALENZUELA - BOARD MEMBER
 - JOE WOJCIK - BOARD MEMBER
- WITH THE GRATEFUL ASSISTANCE OF:**



BOARD OF DIRECTORS:

- THOMAS W. WAGONER - GENERAL MANAGER
- FRANK D. GORMAN - PRESIDENT
- LARRY MINOR - VICE PRESIDENT
- TODD A. FOJUTZ - SECRETARY/TREASURER
- CORNELIUS T. SCHOUTEN - DIRECTOR
- RICK HOFFMAN - DIRECTOR

PROJECT NO. C6-0081



INDEX OF SHEETS

SHEET	DESCRIPTION
1 OF 11	COVER SHEET
2 OF 11	PROPOSED PROJECT TITLE SHEET
3 OF 11	MANHOLE AVENUE PLAN PROFILE
4 OF 11	FANBUSH AVENUE PLAN PROFILE
5 OF 11	STREET LIGHTING PLAN
6 OF 11	STREET LIGHTING PLAN
7 OF 11	GRADING PLAN TITLE SHEET
8 OF 11	GRADING PLAN COVERALL SHEET
9 OF 11	PROPOSED MANHOLE PLAN SHEET
10 OF 11	EROSION CONTROL PLAN
11 OF 11	EROSION CONTROL PLAN

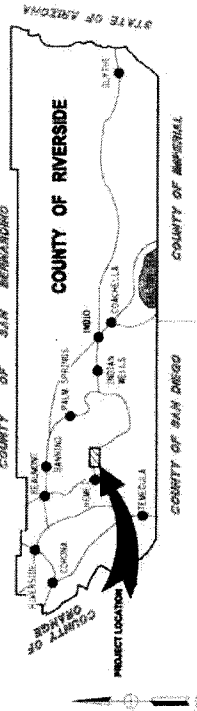

LOCATION MAP
COUNTY OF RIVERSIDE
COUNTY ROAD BOOK PAGE NO. 112

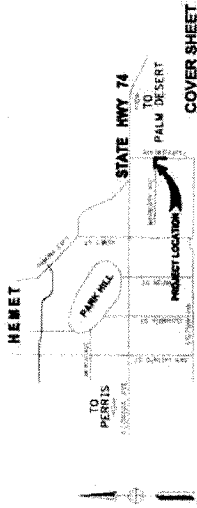

VICINITY MAP
COUNTY OF RIVERSIDE
COUNTY ROAD BOOK PAGE NO. 112

OF 11 SHEETS
SHEET NO. 1

COVER SHEET

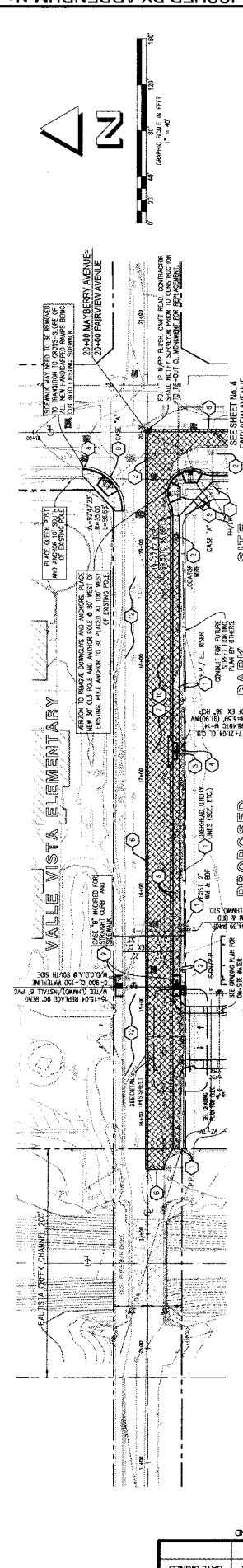
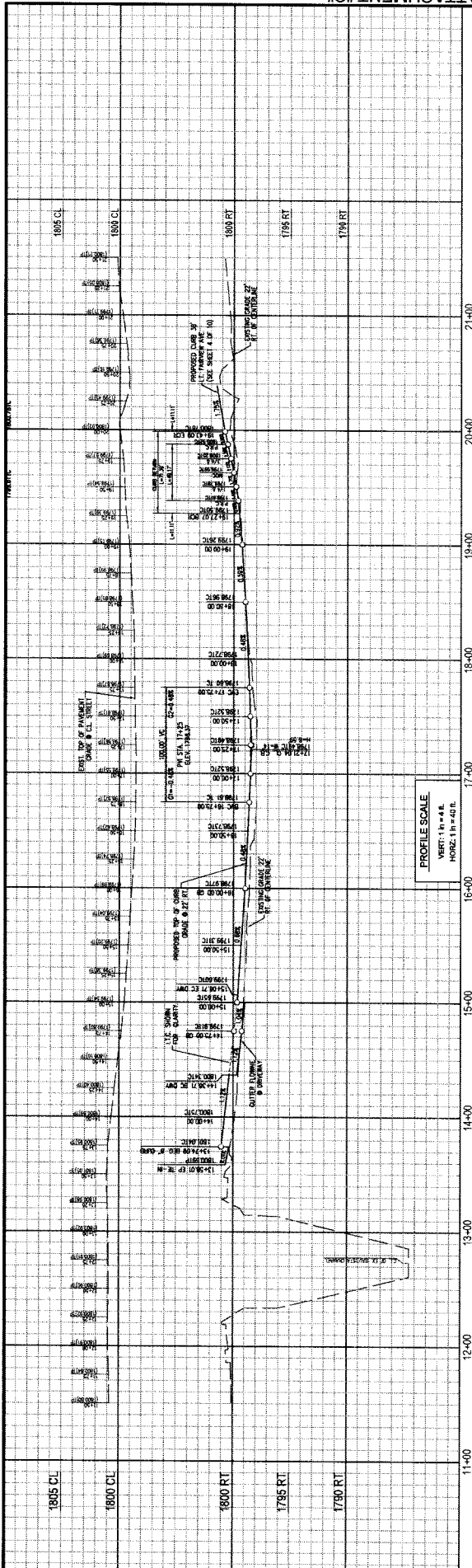

PROPOSED PARK CONSTRUCTION NOTES

- PROTECT IN PLACE
- REMOVE EXISTING CONCRETE DRIVEWAY (SEE PLAN) AND RECONSTRUCT TO 4" ASPHALT OVER 4" SAND FILL TO FINISH TO EXISTING GROUND.
- REMOVE EXISTING CONCRETE DRIVEWAY (SEE PLAN) AND RECONSTRUCT TO 4" ASPHALT OVER 4" SAND FILL TO FINISH TO EXISTING GROUND.
- REMOVE EXISTING CONCRETE DRIVEWAY (SEE PLAN) AND RECONSTRUCT TO 4" ASPHALT OVER 4" SAND FILL TO FINISH TO EXISTING GROUND.
- REMOVE EXISTING CONCRETE DRIVEWAY (SEE PLAN) AND RECONSTRUCT TO 4" ASPHALT OVER 4" SAND FILL TO FINISH TO EXISTING GROUND.
- REMOVE EXISTING CONCRETE DRIVEWAY (SEE PLAN) AND RECONSTRUCT TO 4" ASPHALT OVER 4" SAND FILL TO FINISH TO EXISTING GROUND.
- REMOVE EXISTING CONCRETE DRIVEWAY (SEE PLAN) AND RECONSTRUCT TO 4" ASPHALT OVER 4" SAND FILL TO FINISH TO EXISTING GROUND.
- REMOVE EXISTING CONCRETE DRIVEWAY (SEE PLAN) AND RECONSTRUCT TO 4" ASPHALT OVER 4" SAND FILL TO FINISH TO EXISTING GROUND.
- REMOVE EXISTING CONCRETE DRIVEWAY (SEE PLAN) AND RECONSTRUCT TO 4" ASPHALT OVER 4" SAND FILL TO FINISH TO EXISTING GROUND.
- REMOVE EXISTING CONCRETE DRIVEWAY (SEE PLAN) AND RECONSTRUCT TO 4" ASPHALT OVER 4" SAND FILL TO FINISH TO EXISTING GROUND.

LEGEND

(Symbol)	MAINTENANCE
(Symbol)	AV & S
(Symbol)	EXCUT
(Symbol)	POWER POLE
(Symbol)	PIPE
(Symbol)	SEWER
(Symbol)	LOCATOR WIRE
(Symbol)	18" CURB
(Symbol)	CONCRETE DRIVEWAY
(Symbol)	ASPHALT DRIVEWAY
(Symbol)	REMOVE EXIST. AC

CURB RETURN DATA DETAIL
SCALE: 1"=20"

CURVE DATA TABLE

CHAIN	CHAIN BEG.	CHAIN END	ARC LENGTH	CURVE CENTER	DELTA ANGLE	TANGENT	CHORD BEG.	CHORD END	CHORD MID.
1	17+25.00	17+50.00	25.00'	17+37.50'	36.87°	13.50'	17+37.50'	17+37.50'	17+37.50'
2	17+50.00	17+75.00	25.00'	17+62.50'	36.87°	13.50'	17+62.50'	17+62.50'	17+62.50'
3	17+75.00	18+00.00	25.00'	17+87.50'	36.87°	13.50'	17+87.50'	17+87.50'	17+87.50'
4	18+00.00	18+25.00	25.00'	18+12.50'	36.87°	13.50'	18+12.50'	18+12.50'	18+12.50'
5	18+25.00	18+50.00	25.00'	18+37.50'	36.87°	13.50'	18+37.50'	18+37.50'	18+37.50'
6	18+50.00	18+75.00	25.00'	18+62.50'	36.87°	13.50'	18+62.50'	18+62.50'	18+62.50'
7	18+75.00	19+00.00	25.00'	18+87.50'	36.87°	13.50'	18+87.50'	18+87.50'	18+87.50'
8	19+00.00	19+25.00	25.00'	19+12.50'	36.87°	13.50'	19+12.50'	19+12.50'	19+12.50'
9	19+25.00	19+50.00	25.00'	19+37.50'	36.87°	13.50'	19+37.50'	19+37.50'	19+37.50'
10	19+50.00	19+75.00	25.00'	19+62.50'	36.87°	13.50'	19+62.50'	19+62.50'	19+62.50'
11	19+75.00	20+00.00	25.00'	19+87.50'	36.87°	13.50'	19+87.50'	19+87.50'	19+87.50'

811
Know what's below. Call before you dig.

PROFESIONAL ENGINEER
DANIEL M. THOMPSON, INC.
2900 JORDAN AVENUE, SAN JUAN BAUTISTA, CA 95078
(408) 252-8900
www.danieldmthompson.com

CONTRACTOR
DANIEL M. THOMPSON, INC.
2900 JORDAN AVENUE, SAN JUAN BAUTISTA, CA 95078
(408) 252-8900
www.danieldmthompson.com

APPROVED AS TO CONFORMANCE WITH APPLICABLE COUNTY STANDARDS AND PRACTICES. IP 090086

RECORD PLAN CHECK OVERSIGHT ENGINEER REGISTRATION NUMBER DATE SIGNED

SHEET NO. 3 OF 11 SHEETS
IN THE COUNTY OF RIVERSIDE
MAYBERRY AVE. PLAN / PROFILE
EXCHANGE CLUB PARK
M.S. NO. 4023

DATE: 10/18/20
SCALE: 1"=20"

BENCHMARK
MAYBERRY AVE. AT INTERSECTION WITH FAIRMWAY AVENUE. ELEVATION: 127.50' (SEE SHEET 11-1)

CURB RETURN DATA DETAIL
SCALE: 1"=20"

MAYBERRY AVENUE

PROPOSED DRIVEWAY DETAIL
SCALE: 1"=20"

PROPOSED PARK CONSTRUCTION NOTES

LEGEND

CURVE DATA TABLE

HANDICAP RAMP DATA (FOR USE: R RAMP ONLY)

CURB RETURN DATA DETAIL
SCALE: 1"=20"

MAYBERRY AVENUE

PROPOSED DRIVEWAY DETAIL
SCALE: 1"=20"

PROPOSED PARK CONSTRUCTION NOTES

LEGEND

CURVE DATA TABLE

HANDICAP RAMP DATA (FOR USE: R RAMP ONLY)

CURB RETURN DATA DETAIL
SCALE: 1"=20"

PROPOSED DRIVEWAY DETAIL
SCALE: 1"=20"

PROPOSED PARK CONSTRUCTION NOTES

LEGEND

CURVE DATA TABLE

HANDICAP RAMP DATA (FOR USE: R RAMP ONLY)

CURB RETURN DATA DETAIL
SCALE: 1"=20"

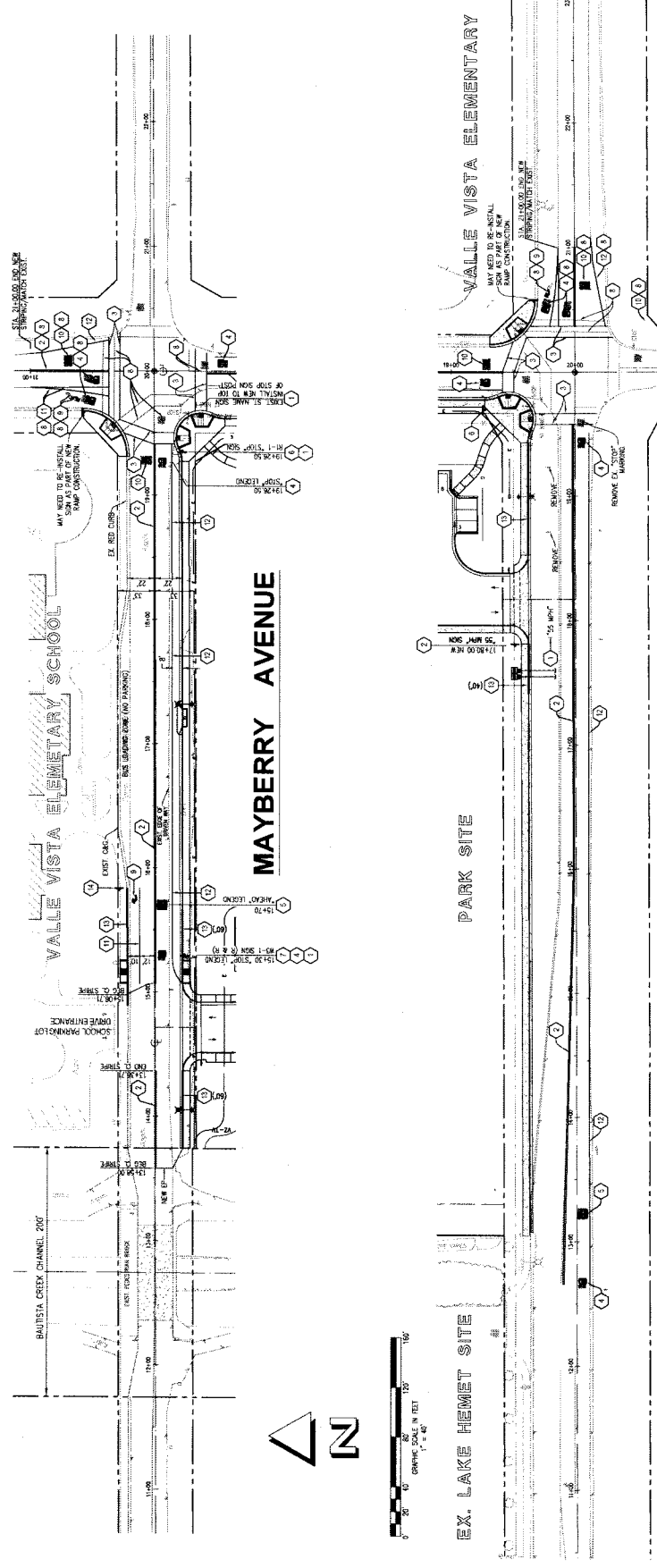

MAYBERRY AVENUE

VALLE VISTA ELEMENTARY

PARK SITE

EX. LAKE HEMET SITE



GENERAL NOTES AND REQUIREMENTS

1. TRAFFIC STRIPES, PAVEMENT MARKINGS AND RAISED PAVEMENT MARKINGS ARE FOR CALTRANS AND CALIFORNIA SUPPLEMENT 224 (S) LATEST EDITION, CALTRANS STANDARD PLANS AND SPECIFICATIONS 2012 EDITION.
2. ALL SIGNS SHALL BE STAINLESS STEEL AND SHALL BE INSTALLED BY THE SPECIAL PROVISIONS PROVIDED IN ITEM 1222 OF THE STANDARD SPECIFICATIONS FOR HIGHWAYS AND BRIDGES. ALL SIGNS SHALL BE FABRICATED BY A SPECIALTY SIGN MANUFACTURER.
3. ALL STRIPES, SIGNS AND PAVEMENT MARKINGS SHALL BE REFLECTORIZED. STRIPES FOR PAVEMENT MARKINGS SHALL MATCH COUNTY STANDARD STRIPES. STRIPES SHALL BE 1/2" WIDE.
4. CONSTRUCTION SHALL BE THE RESPONSIBILITY OF THE CONTRACTOR. ALL MATERIALS AND METHODS OF CONSTRUCTION SHALL BE APPROVED BY THE COUNTY.
5. PAVEMENT MARKINGS AND RAISED PAVEMENT MARKINGS SHALL BE REMOVED. ALL MATERIALS AND METHODS OF CONSTRUCTION SHALL BE APPROVED BY THE COUNTY.
6. PAVEMENT MARKINGS SHALL BE SALVAGED AND DELIVERED TO THE COUNTY (VMS) AS DIRECTED BY THE COUNTY.
7. THE CONTRACTOR SHALL BE RESPONSIBLE FOR THE INSTALLATION OF SIGNS AND STRIPES AND SHALL BE IN COMPLIANCE WITH THE APPROVED PLAN WITH ALL INQUIRIES, QUESTIONS AND CONCERNS BY THE DEVELOPER/PLANNING, THE COUNTY ENGINEER OR THE COUNTY SUPERVISOR.
8. PAVEMENT MARKINGS SHALL BE REMOVED AND INSTALLED BY THE CONTRACTOR IN ACCORDANCE WITH THE STANDARD SPECIFICATIONS FOR HIGHWAYS AND BRIDGES. RAISED PAVEMENT MARKINGS ARE TO BE INSTALLED OUTSTANDING WITH THE PAVEMENT SURFACE. CONSTRUCTION OF ALL STRIPES TO BE COMPLETED BY THE CONTRACTOR.

FAIRVIEW AVENUE

ENGINEER'S NOTES

1. ALL SIGNS SHALL BE OF CURRENT CORRECT SIZE AND MUST BE APPROVED BY THE COUNTY PRIOR TO INSTALLATION. EXISTING SIGNS ARE TO BE REMOVED OR BY THE CONTRACTOR.

CONSTRUCTION NOTES

DESCRIPTION	NOTES
1. REMOVE EXISTING SIGN (SEE WEST PLAN)	
2. INSTALL SIGN (SEE WEST PLAN)	
3. APPLY TRAFFIC STRIPES (SEE WEST PLAN)	
4. APPLY TRAFFIC STRIPES (SEE WEST PLAN)	
5. APPLY TRAFFIC STRIPES (SEE WEST PLAN)	
6. APPLY TRAFFIC STRIPES (SEE WEST PLAN)	
7. APPLY TRAFFIC STRIPES (SEE WEST PLAN)	
8. APPLY TRAFFIC STRIPES (SEE WEST PLAN)	
9. APPLY TRAFFIC STRIPES (SEE WEST PLAN)	
10. APPLY TRAFFIC STRIPES (SEE WEST PLAN)	
11. APPLY TRAFFIC STRIPES (SEE WEST PLAN)	
12. APPLY TRAFFIC STRIPES (SEE WEST PLAN)	
13. APPLY TRAFFIC STRIPES (SEE WEST PLAN)	
14. APPLY TRAFFIC STRIPES (SEE WEST PLAN)	
15. APPLY TRAFFIC STRIPES (SEE WEST PLAN)	
16. APPLY TRAFFIC STRIPES (SEE WEST PLAN)	
17. APPLY TRAFFIC STRIPES (SEE WEST PLAN)	
18. APPLY TRAFFIC STRIPES (SEE WEST PLAN)	
19. APPLY TRAFFIC STRIPES (SEE WEST PLAN)	
20. APPLY TRAFFIC STRIPES (SEE WEST PLAN)	
21. APPLY TRAFFIC STRIPES (SEE WEST PLAN)	
22. APPLY TRAFFIC STRIPES (SEE WEST PLAN)	
23. APPLY TRAFFIC STRIPES (SEE WEST PLAN)	
24. APPLY TRAFFIC STRIPES (SEE WEST PLAN)	
25. APPLY TRAFFIC STRIPES (SEE WEST PLAN)	
26. APPLY TRAFFIC STRIPES (SEE WEST PLAN)	
27. APPLY TRAFFIC STRIPES (SEE WEST PLAN)	
28. APPLY TRAFFIC STRIPES (SEE WEST PLAN)	
29. APPLY TRAFFIC STRIPES (SEE WEST PLAN)	
30. APPLY TRAFFIC STRIPES (SEE WEST PLAN)	
31. APPLY TRAFFIC STRIPES (SEE WEST PLAN)	
32. APPLY TRAFFIC STRIPES (SEE WEST PLAN)	
33. APPLY TRAFFIC STRIPES (SEE WEST PLAN)	
34. APPLY TRAFFIC STRIPES (SEE WEST PLAN)	
35. APPLY TRAFFIC STRIPES (SEE WEST PLAN)	
36. APPLY TRAFFIC STRIPES (SEE WEST PLAN)	
37. APPLY TRAFFIC STRIPES (SEE WEST PLAN)	
38. APPLY TRAFFIC STRIPES (SEE WEST PLAN)	
39. APPLY TRAFFIC STRIPES (SEE WEST PLAN)	
40. APPLY TRAFFIC STRIPES (SEE WEST PLAN)	
41. APPLY TRAFFIC STRIPES (SEE WEST PLAN)	
42. APPLY TRAFFIC STRIPES (SEE WEST PLAN)	
43. APPLY TRAFFIC STRIPES (SEE WEST PLAN)	
44. APPLY TRAFFIC STRIPES (SEE WEST PLAN)	
45. APPLY TRAFFIC STRIPES (SEE WEST PLAN)	
46. APPLY TRAFFIC STRIPES (SEE WEST PLAN)	
47. APPLY TRAFFIC STRIPES (SEE WEST PLAN)	
48. APPLY TRAFFIC STRIPES (SEE WEST PLAN)	
49. APPLY TRAFFIC STRIPES (SEE WEST PLAN)	
50. APPLY TRAFFIC STRIPES (SEE WEST PLAN)	
51. APPLY TRAFFIC STRIPES (SEE WEST PLAN)	
52. APPLY TRAFFIC STRIPES (SEE WEST PLAN)	
53. APPLY TRAFFIC STRIPES (SEE WEST PLAN)	
54. APPLY TRAFFIC STRIPES (SEE WEST PLAN)	
55. APPLY TRAFFIC STRIPES (SEE WEST PLAN)	
56. APPLY TRAFFIC STRIPES (SEE WEST PLAN)	
57. APPLY TRAFFIC STRIPES (SEE WEST PLAN)	
58. APPLY TRAFFIC STRIPES (SEE WEST PLAN)	
59. APPLY TRAFFIC STRIPES (SEE WEST PLAN)	
60. APPLY TRAFFIC STRIPES (SEE WEST PLAN)	
61. APPLY TRAFFIC STRIPES (SEE WEST PLAN)	
62. APPLY TRAFFIC STRIPES (SEE WEST PLAN)	
63. APPLY TRAFFIC STRIPES (SEE WEST PLAN)	
64. APPLY TRAFFIC STRIPES (SEE WEST PLAN)	
65. APPLY TRAFFIC STRIPES (SEE WEST PLAN)	
66. APPLY TRAFFIC STRIPES (SEE WEST PLAN)	
67. APPLY TRAFFIC STRIPES (SEE WEST PLAN)	
68. APPLY TRAFFIC STRIPES (SEE WEST PLAN)	
69. APPLY TRAFFIC STRIPES (SEE WEST PLAN)	
70. APPLY TRAFFIC STRIPES (SEE WEST PLAN)	
71. APPLY TRAFFIC STRIPES (SEE WEST PLAN)	
72. APPLY TRAFFIC STRIPES (SEE WEST PLAN)	
73. APPLY TRAFFIC STRIPES (SEE WEST PLAN)	
74. APPLY TRAFFIC STRIPES (SEE WEST PLAN)	
75. APPLY TRAFFIC STRIPES (SEE WEST PLAN)	
76. APPLY TRAFFIC STRIPES (SEE WEST PLAN)	
77. APPLY TRAFFIC STRIPES (SEE WEST PLAN)	
78. APPLY TRAFFIC STRIPES (SEE WEST PLAN)	
79. APPLY TRAFFIC STRIPES (SEE WEST PLAN)	
80. APPLY TRAFFIC STRIPES (SEE WEST PLAN)	
81. APPLY TRAFFIC STRIPES (SEE WEST PLAN)	
82. APPLY TRAFFIC STRIPES (SEE WEST PLAN)	
83. APPLY TRAFFIC STRIPES (SEE WEST PLAN)	
84. APPLY TRAFFIC STRIPES (SEE WEST PLAN)	
85. APPLY TRAFFIC STRIPES (SEE WEST PLAN)	
86. APPLY TRAFFIC STRIPES (SEE WEST PLAN)	
87. APPLY TRAFFIC STRIPES (SEE WEST PLAN)	
88. APPLY TRAFFIC STRIPES (SEE WEST PLAN)	
89. APPLY TRAFFIC STRIPES (SEE WEST PLAN)	
90. APPLY TRAFFIC STRIPES (SEE WEST PLAN)	
91. APPLY TRAFFIC STRIPES (SEE WEST PLAN)	
92. APPLY TRAFFIC STRIPES (SEE WEST PLAN)	
93. APPLY TRAFFIC STRIPES (SEE WEST PLAN)	
94. APPLY TRAFFIC STRIPES (SEE WEST PLAN)	
95. APPLY TRAFFIC STRIPES (SEE WEST PLAN)	
96. APPLY TRAFFIC STRIPES (SEE WEST PLAN)	
97. APPLY TRAFFIC STRIPES (SEE WEST PLAN)	
98. APPLY TRAFFIC STRIPES (SEE WEST PLAN)	
99. APPLY TRAFFIC STRIPES (SEE WEST PLAN)	
100. APPLY TRAFFIC STRIPES (SEE WEST PLAN)	

NOTE: ALL SIGNS SHALL BE OF CURRENT CORRECT SIZE AND MUST BE APPROVED BY THE COUNTY PRIOR TO INSTALLATION. EXISTING SIGNS ARE TO BE REMOVED OR BY THE CONTRACTOR.

811

Know what's below. Call before you dig.

WORK CONTAINED WITHIN THESE PLANS SHALL NOT BE CONSIDERED A GUARANTEE OF ACCURACY OR A STATEMENT OF OPINION BY THE ENGINEER. THE ENGINEER HAS CONDUCTED VISUAL INSPECTIONS AND A VISUAL INSPECTION HAS BEEN MADE. A SIGNING PERMIT HAS BEEN ISSUED.

THE CONTRACTOR SHALL BE RESPONSIBLE FOR THE INSTALLATION OF SIGNS AND STRIPES AND SHALL BE IN COMPLIANCE WITH THE APPROVED PLAN WITH ALL INQUIRIES, QUESTIONS AND CONCERNS BY THE DEVELOPER/PLANNING, THE COUNTY ENGINEER OR THE COUNTY SUPERVISOR.



THOMPSON
 CIVIL ENGINEERING
 2800 SOUTH SAN JACINTO AVE. SAN JACINTO, CA 95026
 (925) 781-1111
 PREPARED UNDER THE SUPERVISION OF
 THOMAS J. THOMPSON
 LICENSE NO. 10000
 REGISTERED PROFESSIONAL ENGINEER

PROJECT NO.	10000
DATE	10/15/2024
COUNTY	CONTRA COSTA
SHEET NO.	5
OF 11 SHEETS	
SCALE	1" = 40'
PROJECT NAME	IN THE COUNTY OF RIVERSIDE SIGNING AND STRIPING PLAN EXCHANGE CLUB PARK M.S. NO. 4023
PROJECT NO.	10000
DATE	10/15/2024
COUNTY	CONTRA COSTA

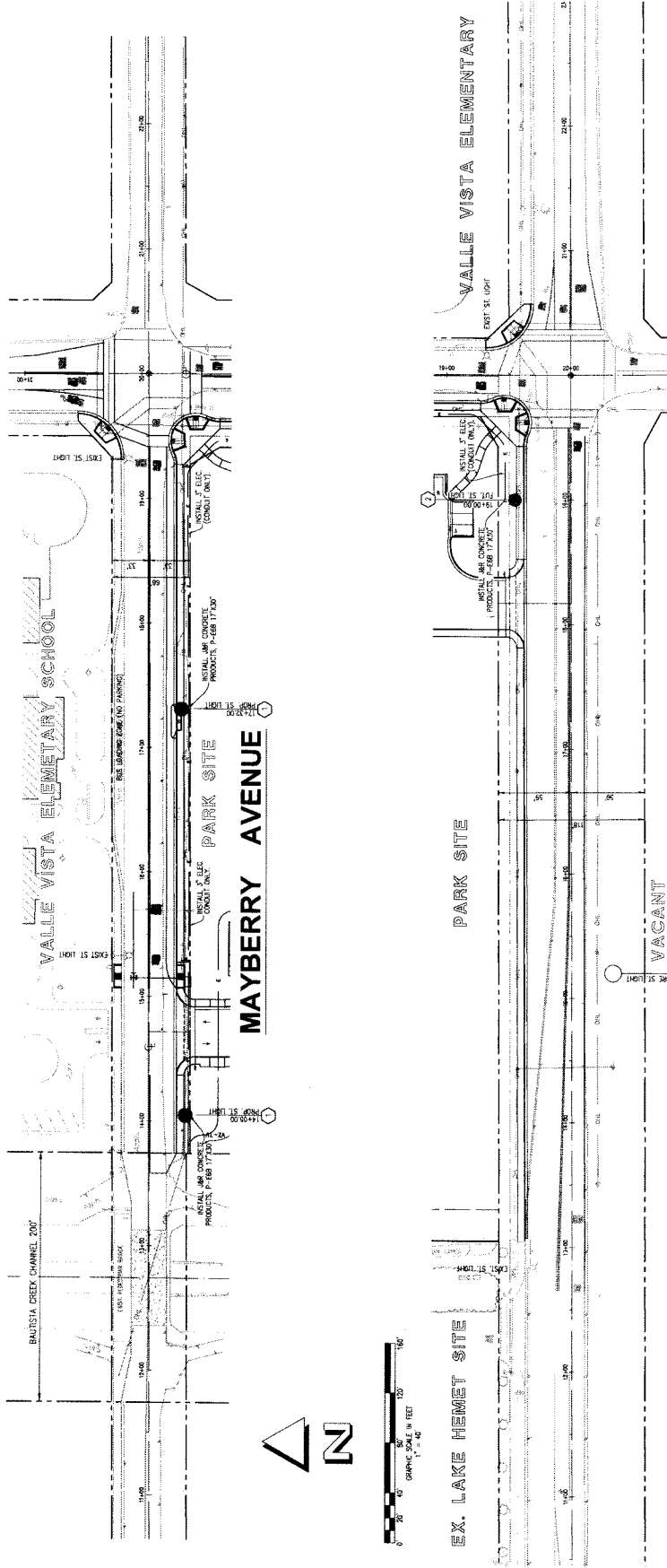

FAIRVIEW AVENUE

- GENERAL NOTES**
1. THE CONTRACTOR SHALL BE RESPONSIBLE FOR OBTAINING ALL NECESSARY PERMITS AND APPROVALS FROM THE LOCAL JURISDICTIONS.
 2. IT SHALL BE THE RESPONSIBILITY OF THE DEVELOPER OR CONTRACTOR TO NOTIFY EVERY AN ENCROACHMENT PERMIT AGENCY OF ANY ENCROACHMENTS ON PUBLIC RIGHTS-OF-WAY AND TO OBTAIN ALL NECESSARY PERMITS AND APPROVALS FROM THE LOCAL JURISDICTIONS.
 3. THE CONTRACTOR SHALL BE RESPONSIBLE FOR OBTAINING ALL NECESSARY PERMITS AND APPROVALS FROM THE LOCAL JURISDICTIONS.
 4. THE PROJECT IS WITHIN THE LIMITS OF THE PLAN.
 5. THERE ARE EXISTING STREET LIGHTS WITHIN THE PROJECT. SPECIFIC LOCATIONS INDICATED ON PLAN.
 6. CONSTRUCTION SHALL BE IN ACCORDANCE WITH THE LOCAL JURISDICTIONS AND SHALL INCLUDE A DISTRIBUTION OF THE PROJECT TO THE LOCAL JURISDICTIONS.
 7. SEE DRAWING # _____ FOR DETAILS.

- LEGEND AND QUANTITIES**
- EXISTING STREET LIGHTS WITHIN THE PROJECT AT THE LOCAL JURISDICTIONS.
 - PROPOSED STREET LIGHTS WITHIN THE PROJECT AT THE LOCAL JURISDICTIONS.
- NOTE:**
THERE ARE EXISTING STREET LIGHTS WITHIN THE PROJECT AT THE LOCAL JURISDICTIONS.

CONSTRUCTION NOTES

NO.	DESCRIPTION	DATE	BY
1	INSTALL 100' LUMBER LAMP POST PER M.S. NO. 4023		
2	INSTALL 100' LUMBER LAMP POST PER M.S. NO. 4023		
3	INSTALL 100' LUMBER LAMP POST PER M.S. NO. 4023		

NOTE:
CONTRACTOR SHALL OBTAIN ALL NECESSARY PERMITS AND APPROVALS FROM THE LOCAL JURISDICTIONS. THE CONTRACTOR SHALL BE RESPONSIBLE FOR OBTAINING ALL NECESSARY PERMITS AND APPROVALS FROM THE LOCAL JURISDICTIONS.

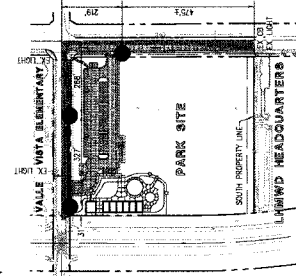

INDEX MAP & FLOW CHART
SCALE: 1" = 200'

811
Know what's below you dig.
Call before you dig.

THOMSEN ENGINEERING
200 S. 20TH AVENUE, SUITE 100
DENVER, CO 80202
TEL: 303.733.1111
WWW.THOMSENENGINEERING.COM

PREPARED UNDER THE SUPERVISION OF:
[Signature]
DATE: _____



NO.	DATE	REVISIONS

NOTE:
THIS PLAN CONTAINS THESE PLANS SHALL NOT BE USED FOR ANY OTHER PROJECT WITHOUT THE WRITTEN CONSENT OF THE ENGINEER. THE CONTRACTOR SHALL BE RESPONSIBLE FOR OBTAINING ALL NECESSARY PERMITS AND APPROVALS FROM THE LOCAL JURISDICTIONS. THE CONTRACTOR SHALL BE RESPONSIBLE FOR OBTAINING ALL NECESSARY PERMITS AND APPROVALS FROM THE LOCAL JURISDICTIONS.

APPROVED AS TO CONFORMANCE WITH APPLICABLE COUNTY STANDARDS AND PRACTICES, IF 050066

PLAN CHECK OVERSIGHT ENGINEER: _____
REGISTRATION NUMBER: _____
DATE SIGNED: _____

BENCHMARK:
BENCHMARK TO BE SET BY THE CONTRACTOR AT THE INTERSECTION OF VALLE VISTA ELEMENTARY AND MAYBERRY AVENUE. THE BENCHMARK SHALL BE SET TO THE INTERSECTION OF VALLE VISTA ELEMENTARY AND MAYBERRY AVENUE.

BENCH MARK:
BENCHMARK TO BE SET BY THE CONTRACTOR AT THE INTERSECTION OF VALLE VISTA ELEMENTARY AND MAYBERRY AVENUE. THE BENCHMARK SHALL BE SET TO THE INTERSECTION OF VALLE VISTA ELEMENTARY AND MAYBERRY AVENUE.

SCALE: 1" = 200'

FOR VANDERBILT
M.S. NO. 4023

IN THE UNINCORPORATED TERRITORY OF THE COUNTY OF RIVERSIDE, STATE OF CALIFORNIA
EXCHANGE CLUB PARK PUBLIC FACILITY
ON-SITE GRADING PLAN
MS NO. 4023
PROJECT NO. C6-0081



OWNER

ALLEN DEVELOPMENT PARTNERSHIP
 12101 VAN COTT AVENUE
 SUITE 400
 SAN ANTONIO, TEXAS 78249
 PH: (214) 949-7838

ASSASSOR'S PARCEL NO.

000000

LEGAL DESCRIPTION

THE PART OF PARCEL 14 MAP 184 IN THE TRACT OF THE PARTNERSHIP AND THE PART OF PARCEL 15 MAP 184 IN THE TRACT OF THE PARTNERSHIP, BOTH OF WHICH ARE MORE PARTICULARLY DESCRIBED AS SAN BEGO COUNTY, CALIFORNIA AND COMPLETELY DESCRIBED AND IDENTIFIED BY RECORD MAP NO. 4023, A RECORD MAP FILED AND RECORDED IN THE OFFICE OF THE COUNTY CLERK OF SAN BEGO COUNTY, TEXAS ON AUGUST 26, 2003 AS INSTRUMENT NO. 007988.

TOPOGRAPHY SOURCE

THE TOPOGRAPHY SOURCE IS THE DIGITAL DATUM DATED DECEMBER 11, 2004.

BASIS OF BEARINGS

THE BEARINGS FOR ALL CONSTRUCTION ARE GIVEN AS BEARINGS FROM THE CENTERLINE OF THE RAILROAD TRACKS AND THE CENTERLINE OF THE RAILROAD TRACKS ARE GIVEN AS BEARINGS FROM THE CENTERLINE OF THE RAILROAD TRACKS.

PROPERTY INFORMATION

ENTIRE LOT 15-10
 PROJECT NO. C6-0081

SOILS ENGINEER

REGISTERED PROFESSIONAL ENGINEER
 RICHARD J. GAY
 10510 BRIDLEWAY DRIVE
 SAN ANTONIO, TEXAS 78249
 PH: (214) 496-1555 FAX: (214) 496-1556

SWMP RESPONSIBLE PARTY

REGISTERED PROFESSIONAL ENGINEER
 RICHARD J. GAY
 10510 BRIDLEWAY DRIVE
 SAN ANTONIO, TEXAS 78249
 PH: (214) 496-1555 FAX: (214) 496-1556

UTILITY NOTIFICATIONS

UTILITY NOTIFICATION CALLS HAVE BEEN MADE AT LEAST 48 HOURS PRIOR TO THE DATE OF CONSTRUCTION. ALL UTILITIES WILL BE MAINTAINED AT ALL TIMES.

STANDARD DETAIL NOTE

STANDARD DETAILS ARE REFERENCED TO THE LATEST EDITION OF THE STANDARD SPECIFICATIONS FOR CONSTRUCTION OF PUBLIC WORKS, WITH THE LATEST SUPPLEMENTARY NOTES.

INDEX OF SHEETS

1 OF 11
 COVER SHEET
 2 OF 11
 INDEX MAP, STREET TITLES SHEET
 3 OF 11
 PARKWAY AVENUE PLANNING
 4 OF 11
 STREET LIGHTING PLAN
 5 OF 11
 SIDEWALK LAYOUT PLAN
 6 OF 11
 GRADING PLAN TITLES SHEET
 7 OF 11
 GRADING PLAN TITLES SHEET
 8 OF 11
 GRADING PLAN TITLES SHEET
 9 OF 11
 BRUSH CONTROL PLAN TITLES SHEET
 10 OF 11
 BRUSH CONTROL PLAN
 11 OF 11
 BRUSH CONTROL PLAN

CONSTRUCTION NOTES

- PROTECT EXISTING UTILITIES AND STRUCTURES.
- PROTECT EXISTING ROADWAYS AND DRIVEWAYS.
- PROTECT EXISTING CONCRETE FOOTINGS.
- CONTRACTOR SHALL PROTECT EXISTING UTILITIES AND STRUCTURES TO REMAIN AND SHALL BE RESPONSIBLE FOR ANY DAMAGE TO EXISTING UTILITIES AND STRUCTURES.
- CONTRACTOR SHALL PROTECT EXISTING ROADWAYS AND DRIVEWAYS TO REMAIN AND SHALL BE RESPONSIBLE FOR ANY DAMAGE TO EXISTING ROADWAYS AND DRIVEWAYS.
- CONTRACTOR SHALL PROTECT EXISTING CONCRETE FOOTINGS TO REMAIN AND SHALL BE RESPONSIBLE FOR ANY DAMAGE TO EXISTING CONCRETE FOOTINGS.
- CONTRACTOR SHALL PROTECT EXISTING UTILITIES AND STRUCTURES TO REMAIN AND SHALL BE RESPONSIBLE FOR ANY DAMAGE TO EXISTING UTILITIES AND STRUCTURES.
- CONTRACTOR SHALL PROTECT EXISTING ROADWAYS AND DRIVEWAYS TO REMAIN AND SHALL BE RESPONSIBLE FOR ANY DAMAGE TO EXISTING ROADWAYS AND DRIVEWAYS.
- CONTRACTOR SHALL PROTECT EXISTING CONCRETE FOOTINGS TO REMAIN AND SHALL BE RESPONSIBLE FOR ANY DAMAGE TO EXISTING CONCRETE FOOTINGS.
- CONTRACTOR SHALL PROTECT EXISTING UTILITIES AND STRUCTURES TO REMAIN AND SHALL BE RESPONSIBLE FOR ANY DAMAGE TO EXISTING UTILITIES AND STRUCTURES.
- CONTRACTOR SHALL PROTECT EXISTING ROADWAYS AND DRIVEWAYS TO REMAIN AND SHALL BE RESPONSIBLE FOR ANY DAMAGE TO EXISTING ROADWAYS AND DRIVEWAYS.
- CONTRACTOR SHALL PROTECT EXISTING CONCRETE FOOTINGS TO REMAIN AND SHALL BE RESPONSIBLE FOR ANY DAMAGE TO EXISTING CONCRETE FOOTINGS.
- CONTRACTOR SHALL PROTECT EXISTING UTILITIES AND STRUCTURES TO REMAIN AND SHALL BE RESPONSIBLE FOR ANY DAMAGE TO EXISTING UTILITIES AND STRUCTURES.
- CONTRACTOR SHALL PROTECT EXISTING ROADWAYS AND DRIVEWAYS TO REMAIN AND SHALL BE RESPONSIBLE FOR ANY DAMAGE TO EXISTING ROADWAYS AND DRIVEWAYS.
- CONTRACTOR SHALL PROTECT EXISTING CONCRETE FOOTINGS TO REMAIN AND SHALL BE RESPONSIBLE FOR ANY DAMAGE TO EXISTING CONCRETE FOOTINGS.

PROJECT NOTES

- ALL GRADING SHALL CONFORM TO THE APPLICABLE CODE, APPROXIMATELY 15% MAXIMUM, AND TO COUNTY OF RIVERSIDE GRADING CODE.
- ALL GRADING SHALL BE OBTAINED FROM THE DEPARTMENT OF BIOMASS AND SAFETY, COUNTY OF RIVERSIDE PERMIT TO GRADE.
- THE CONTRACTOR SHALL BE RESPONSIBLE FOR OBTAINING A PERMIT TO GRADE FROM THE COUNTY OF RIVERSIDE DEPARTMENT OF BIOMASS AND SAFETY.
- THE CONTRACTOR SHALL BE RESPONSIBLE FOR OBTAINING A PERMIT TO GRADE FROM THE COUNTY OF RIVERSIDE DEPARTMENT OF BIOMASS AND SAFETY.
- THE CONTRACTOR SHALL BE RESPONSIBLE FOR OBTAINING A PERMIT TO GRADE FROM THE COUNTY OF RIVERSIDE DEPARTMENT OF BIOMASS AND SAFETY.
- THE CONTRACTOR SHALL BE RESPONSIBLE FOR OBTAINING A PERMIT TO GRADE FROM THE COUNTY OF RIVERSIDE DEPARTMENT OF BIOMASS AND SAFETY.
- THE CONTRACTOR SHALL BE RESPONSIBLE FOR OBTAINING A PERMIT TO GRADE FROM THE COUNTY OF RIVERSIDE DEPARTMENT OF BIOMASS AND SAFETY.
- THE CONTRACTOR SHALL BE RESPONSIBLE FOR OBTAINING A PERMIT TO GRADE FROM THE COUNTY OF RIVERSIDE DEPARTMENT OF BIOMASS AND SAFETY.
- THE CONTRACTOR SHALL BE RESPONSIBLE FOR OBTAINING A PERMIT TO GRADE FROM THE COUNTY OF RIVERSIDE DEPARTMENT OF BIOMASS AND SAFETY.
- THE CONTRACTOR SHALL BE RESPONSIBLE FOR OBTAINING A PERMIT TO GRADE FROM THE COUNTY OF RIVERSIDE DEPARTMENT OF BIOMASS AND SAFETY.
- THE CONTRACTOR SHALL BE RESPONSIBLE FOR OBTAINING A PERMIT TO GRADE FROM THE COUNTY OF RIVERSIDE DEPARTMENT OF BIOMASS AND SAFETY.
- THE CONTRACTOR SHALL BE RESPONSIBLE FOR OBTAINING A PERMIT TO GRADE FROM THE COUNTY OF RIVERSIDE DEPARTMENT OF BIOMASS AND SAFETY.
- THE CONTRACTOR SHALL BE RESPONSIBLE FOR OBTAINING A PERMIT TO GRADE FROM THE COUNTY OF RIVERSIDE DEPARTMENT OF BIOMASS AND SAFETY.
- THE CONTRACTOR SHALL BE RESPONSIBLE FOR OBTAINING A PERMIT TO GRADE FROM THE COUNTY OF RIVERSIDE DEPARTMENT OF BIOMASS AND SAFETY.
- THE CONTRACTOR SHALL BE RESPONSIBLE FOR OBTAINING A PERMIT TO GRADE FROM THE COUNTY OF RIVERSIDE DEPARTMENT OF BIOMASS AND SAFETY.

PROJECT NOTES

- THE SITE WILL BE IMPROVED AND MAINTAINED BY TWO SEPARATE PUBLIC DISTRICTS. THE IMPROVEMENTS AND MAINTENANCE SHALL BE THE RESPONSIBILITY OF THE PUBLIC DISTRICTS.
- THE CONTRACTOR SHALL BE RESPONSIBLE FOR OBTAINING A PERMIT TO GRADE FROM THE COUNTY OF RIVERSIDE DEPARTMENT OF BIOMASS AND SAFETY.
- THE CONTRACTOR SHALL BE RESPONSIBLE FOR OBTAINING A PERMIT TO GRADE FROM THE COUNTY OF RIVERSIDE DEPARTMENT OF BIOMASS AND SAFETY.
- THE CONTRACTOR SHALL BE RESPONSIBLE FOR OBTAINING A PERMIT TO GRADE FROM THE COUNTY OF RIVERSIDE DEPARTMENT OF BIOMASS AND SAFETY.
- THE CONTRACTOR SHALL BE RESPONSIBLE FOR OBTAINING A PERMIT TO GRADE FROM THE COUNTY OF RIVERSIDE DEPARTMENT OF BIOMASS AND SAFETY.
- THE CONTRACTOR SHALL BE RESPONSIBLE FOR OBTAINING A PERMIT TO GRADE FROM THE COUNTY OF RIVERSIDE DEPARTMENT OF BIOMASS AND SAFETY.
- THE CONTRACTOR SHALL BE RESPONSIBLE FOR OBTAINING A PERMIT TO GRADE FROM THE COUNTY OF RIVERSIDE DEPARTMENT OF BIOMASS AND SAFETY.
- THE CONTRACTOR SHALL BE RESPONSIBLE FOR OBTAINING A PERMIT TO GRADE FROM THE COUNTY OF RIVERSIDE DEPARTMENT OF BIOMASS AND SAFETY.
- THE CONTRACTOR SHALL BE RESPONSIBLE FOR OBTAINING A PERMIT TO GRADE FROM THE COUNTY OF RIVERSIDE DEPARTMENT OF BIOMASS AND SAFETY.
- THE CONTRACTOR SHALL BE RESPONSIBLE FOR OBTAINING A PERMIT TO GRADE FROM THE COUNTY OF RIVERSIDE DEPARTMENT OF BIOMASS AND SAFETY.
- THE CONTRACTOR SHALL BE RESPONSIBLE FOR OBTAINING A PERMIT TO GRADE FROM THE COUNTY OF RIVERSIDE DEPARTMENT OF BIOMASS AND SAFETY.
- THE CONTRACTOR SHALL BE RESPONSIBLE FOR OBTAINING A PERMIT TO GRADE FROM THE COUNTY OF RIVERSIDE DEPARTMENT OF BIOMASS AND SAFETY.
- THE CONTRACTOR SHALL BE RESPONSIBLE FOR OBTAINING A PERMIT TO GRADE FROM THE COUNTY OF RIVERSIDE DEPARTMENT OF BIOMASS AND SAFETY.
- THE CONTRACTOR SHALL BE RESPONSIBLE FOR OBTAINING A PERMIT TO GRADE FROM THE COUNTY OF RIVERSIDE DEPARTMENT OF BIOMASS AND SAFETY.
- THE CONTRACTOR SHALL BE RESPONSIBLE FOR OBTAINING A PERMIT TO GRADE FROM THE COUNTY OF RIVERSIDE DEPARTMENT OF BIOMASS AND SAFETY.

CONTRACTOR NOTICE

THE CONTRACTOR SHALL BE RESPONSIBLE FOR OBTAINING A PERMIT TO GRADE FROM THE COUNTY OF RIVERSIDE DEPARTMENT OF BIOMASS AND SAFETY.

SPECIAL NOTE

ALL CONSTRUCTION SHALL BE COMPLETED BY THE END OF THE MONTH OF OCTOBER, 2004.

PAVING NOTES

ALL PAVING SHALL BE DONE IN ACCORDANCE WITH THE LATEST EDITION OF THE STANDARD SPECIFICATIONS FOR CONSTRUCTION OF PUBLIC WORKS.

COPYRIGHT NOTE

ALL RIGHTS RESERVED. NO PART OF THIS DRAWING SHALL BE REPRODUCED OR TRANSMITTED IN ANY FORM OR BY ANY MEANS WITHOUT THE WRITTEN PERMISSION OF THE ENGINEER.

SURVEY NOTICE

THE SURVEY WAS CONDUCTED BY THE ENGINEER AND THE RESULTS ARE AS SHOWN ON THIS DRAWING.

PRIVATE ENGINEER'S NOTICE TO CONTRACTOR

THE ENGINEER SHALL NOT BE RESPONSIBLE FOR THE ACTIONS OF THE CONTRACTOR OR THE ACTIONS OF OTHER PARTIES.

AMERICANS WITH DISABILITIES NOTES

1. ALL GRADING SHALL CONFORM TO THE APPLICABLE CODE, APPROXIMATELY 15% MAXIMUM, AND TO COUNTY OF RIVERSIDE GRADING CODE.

CONTRACTOR NOTICE

THE CONTRACTOR SHALL BE RESPONSIBLE FOR OBTAINING A PERMIT TO GRADE FROM THE COUNTY OF RIVERSIDE DEPARTMENT OF BIOMASS AND SAFETY.

SPECIAL NOTE

ALL CONSTRUCTION SHALL BE COMPLETED BY THE END OF THE MONTH OF OCTOBER, 2004.

PAVING NOTES

ALL PAVING SHALL BE DONE IN ACCORDANCE WITH THE LATEST EDITION OF THE STANDARD SPECIFICATIONS FOR CONSTRUCTION OF PUBLIC WORKS.

COPYRIGHT NOTE

ALL RIGHTS RESERVED. NO PART OF THIS DRAWING SHALL BE REPRODUCED OR TRANSMITTED IN ANY FORM OR BY ANY MEANS WITHOUT THE WRITTEN PERMISSION OF THE ENGINEER.

SURVEY NOTICE

THE SURVEY WAS CONDUCTED BY THE ENGINEER AND THE RESULTS ARE AS SHOWN ON THIS DRAWING.

PRIVATE ENGINEER'S NOTICE TO CONTRACTOR

THE ENGINEER SHALL NOT BE RESPONSIBLE FOR THE ACTIONS OF THE CONTRACTOR OR THE ACTIONS OF OTHER PARTIES.

NOTICE

IF YOU ARE A CONTRACTOR WITH THESE PLANS, YOU SHALL NOT REPRODUCE OR TRANSMIT IN ANY FORM OR BY ANY MEANS WITHOUT THE WRITTEN PERMISSION OF THE ENGINEER.

APPROVED AS TO CONFORMANCE WITH APPLICABLE COUNTY STANDARDS AND PRACTICES.		DATE SIGNED	REGISTRATION NUMBER	ENGINEER
RECORD	PLAN CHECK OVERSIGHT ENGINEER	DATE SIGNED	REGISTRATION NUMBER	ENGINEER

811
Know what's below.
Call before you dig.

APPROVED AS TO CONFORMANCE WITH APPLICABLE COUNTY STANDARDS AND PRACTICES.		DATE SIGNED	REGISTRATION NUMBER	ENGINEER
APPROVED AS TO CONFORMANCE WITH APPLICABLE COUNTY STANDARDS AND PRACTICES.		DATE SIGNED	REGISTRATION NUMBER	ENGINEER

ISSUED BY ADDENDUM NO. 1, ATTACHMENT 'C'

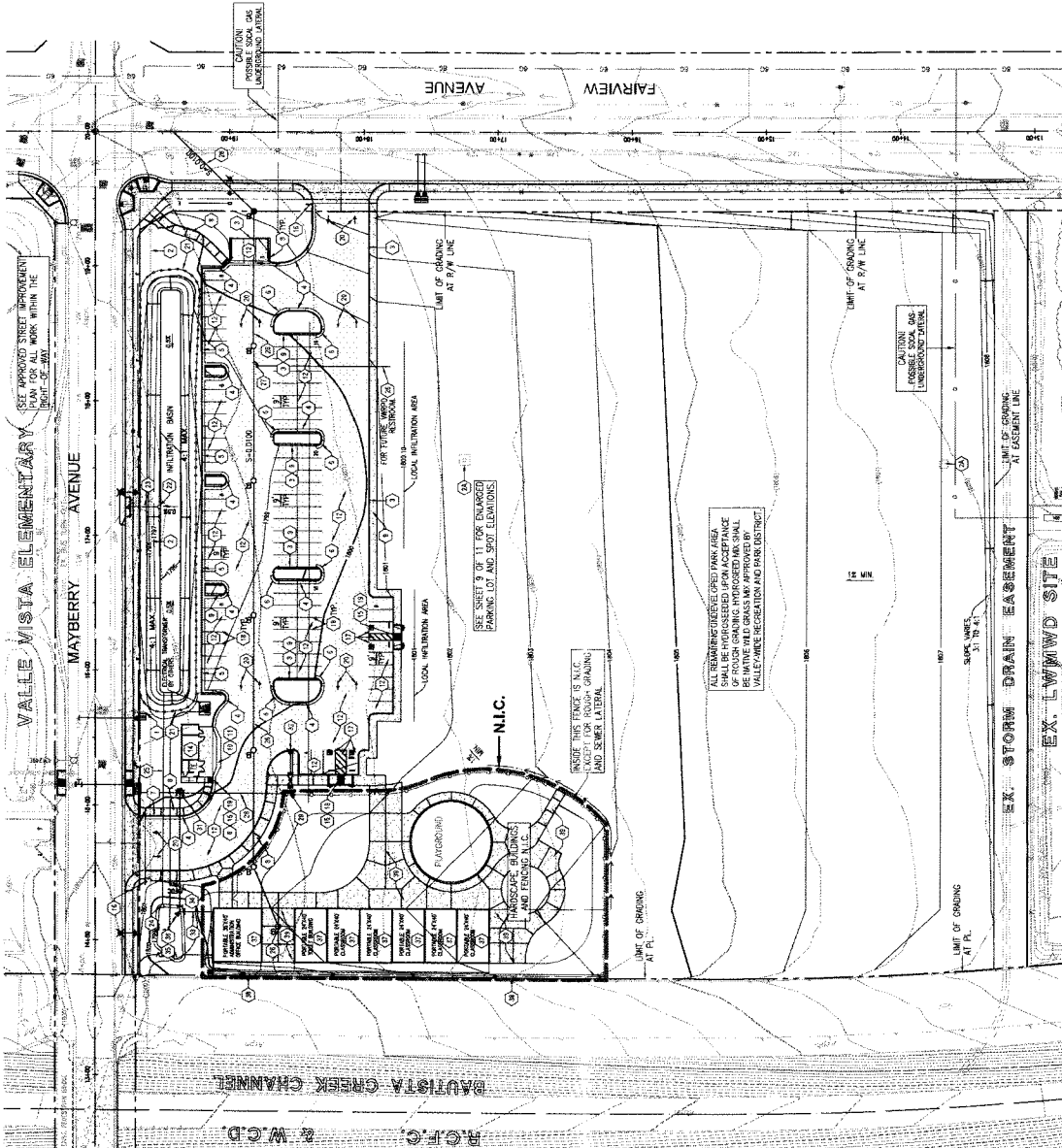

CONSTRUCTION NOTES

1. EXISTING CONCRETE FOUNDINGS.
2. EXISTING CONCRETE FOUNDINGS.
3. EXISTING CONCRETE FOUNDINGS.
4. EXISTING CONCRETE FOUNDINGS.
5. EXISTING CONCRETE FOUNDINGS.
6. EXISTING CONCRETE FOUNDINGS.
7. EXISTING CONCRETE FOUNDINGS.
8. EXISTING CONCRETE FOUNDINGS.
9. EXISTING CONCRETE FOUNDINGS.
10. EXISTING CONCRETE FOUNDINGS.
11. EXISTING CONCRETE FOUNDINGS.
12. EXISTING CONCRETE FOUNDINGS.
13. EXISTING CONCRETE FOUNDINGS.
14. EXISTING CONCRETE FOUNDINGS.
15. EXISTING CONCRETE FOUNDINGS.
16. EXISTING CONCRETE FOUNDINGS.
17. EXISTING CONCRETE FOUNDINGS.
18. EXISTING CONCRETE FOUNDINGS.
19. EXISTING CONCRETE FOUNDINGS.
20. EXISTING CONCRETE FOUNDINGS.
21. EXISTING CONCRETE FOUNDINGS.
22. EXISTING CONCRETE FOUNDINGS.
23. EXISTING CONCRETE FOUNDINGS.
24. EXISTING CONCRETE FOUNDINGS.
25. EXISTING CONCRETE FOUNDINGS.
26. EXISTING CONCRETE FOUNDINGS.
27. EXISTING CONCRETE FOUNDINGS.
28. EXISTING CONCRETE FOUNDINGS.
29. EXISTING CONCRETE FOUNDINGS.
30. EXISTING CONCRETE FOUNDINGS.
31. EXISTING CONCRETE FOUNDINGS.
32. EXISTING CONCRETE FOUNDINGS.
33. EXISTING CONCRETE FOUNDINGS.
34. EXISTING CONCRETE FOUNDINGS.
35. EXISTING CONCRETE FOUNDINGS.
36. EXISTING CONCRETE FOUNDINGS.
37. EXISTING CONCRETE FOUNDINGS.
38. EXISTING CONCRETE FOUNDINGS.
39. EXISTING CONCRETE FOUNDINGS.
40. EXISTING CONCRETE FOUNDINGS.
41. EXISTING CONCRETE FOUNDINGS.
42. EXISTING CONCRETE FOUNDINGS.
43. EXISTING CONCRETE FOUNDINGS.
44. EXISTING CONCRETE FOUNDINGS.
45. EXISTING CONCRETE FOUNDINGS.
46. EXISTING CONCRETE FOUNDINGS.
47. EXISTING CONCRETE FOUNDINGS.
48. EXISTING CONCRETE FOUNDINGS.
49. EXISTING CONCRETE FOUNDINGS.
50. EXISTING CONCRETE FOUNDINGS.

811
Know what's below.
Call before you dig.

NOTE:
WORK CONTAINED WITHIN THESE PLANS SHALL NOT BE CONSIDERED AS A GUARANTEE OF ACCURACY OR A GRADING PERMIT HAS BEEN ISSUED.
THE CONTRACTOR SHALL BE RESPONSIBLE FOR OBTAINING ALL NECESSARY PERMITS AND SHALL BE RESPONSIBLE FOR THE ACCURACY OF ALL INFORMATION SUBMITTED TO THE CITY ENGINEER.
THE CONTRACTOR SHALL BE RESPONSIBLE FOR THE ACCURACY OF ALL INFORMATION SUBMITTED TO THE CITY ENGINEER.

APPROVED AS TO CONFORMANCE WITH APPLICABLE COUNTY STANDARDS AND PRACTICES:

RECORD	PLAN CHECK OVERSIGHT ENGINEER	REGISTRATION NUMBER	DATE SIGNED

PRINCIPAL ENGINEER:

D. J. THOMSEN
 2800 EDITH LANE, JARDINE AVE, SAN JUAN CA, 95038
 PHONE: (408) 486-1111 FAX: (408) 486-1112
 WWW: www.thomsen-engineering.com
 PREPARED UNDER THE SUPERVISION OF:
D. J. THOMSEN
 REGISTERED PROFESSIONAL ENGINEER
 No. 10000
 State of California
 Civil Engineering

BENCHMARK:
 IN THE COUNTY OF RIVERSIDE
 EXCHANGING PLAN-OVERALL SITE
 EXCHANGING CLUB PARK
 M.S. NO. 4023
 OF 11 SHEETS

SCALE: H. 1" = 40' V. 1" = 40'

DATE: 11-18-2017

NO.: WIND 1430

COUNTY: R.E.N.

PROJECT NO.: CS-0081

SHEET NO.: 8

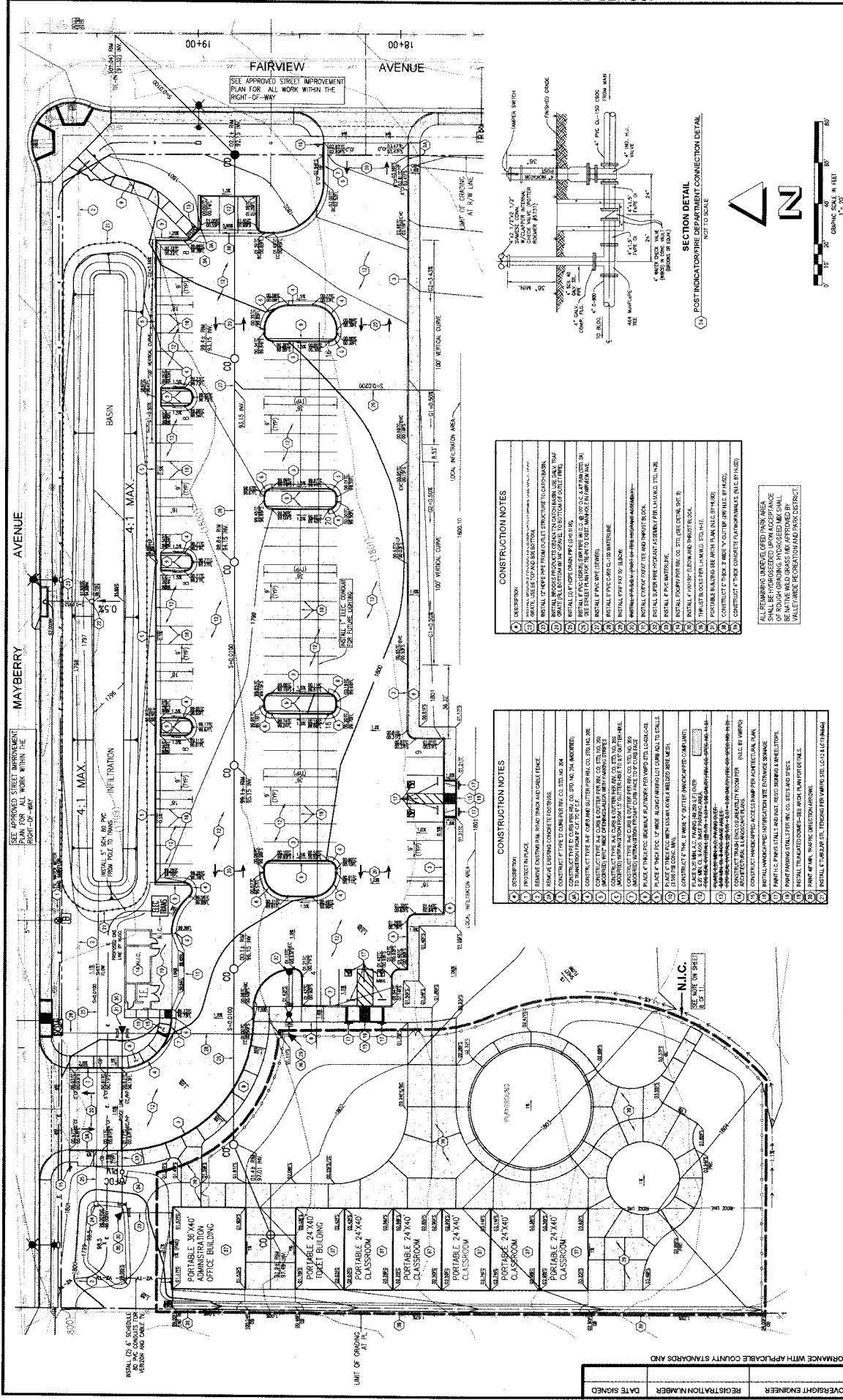

ISSUED BY ADDENDUM NO. 1, ATTACHMENT "C"

APPROVED AS TO CONFORMANCE WITH APPLICABLE COUNTY STANDARDS AND PRACTICES.

RECORD PLAN CHECK OVERSIGHT ENGINEER REGISTRATION NUMBER DATE SIGNED

811
 Know what's below.
 Call before you dig.

NOTE: CONTRACTORS WITH THESE PLANS SHALL NOT COME UPON ANY UTILITIES OR STRUCTURES UNLESS A GRADING PERMIT HAS BEEN ISSUED. THE CONTRACTOR SHALL BE RESPONSIBLE FOR VERIFYING THE LOCATION, DEPTH, AND CONTENTS OF ALL UTILITIES AND STRUCTURES PRIOR TO CONSTRUCTION. THE CONTRACTOR SHALL BE RESPONSIBLE FOR OBTAINING ALL NECESSARY PERMITS AND APPROVALS FROM THE APPROPRIATE AGENCIES.

MARKS BY DATE PROJECT NUMBER REASONS APRIL DATE COUNTY

PRINCIPAL ENGINEER: **THOMSEN** CIVIL ENGINEERING
 200 SOUTH SAN JACINTO AVE, SAN JACINTO, CA 92580
 TEL: (951) 770-0000 FAX: (951) 770-0001
 WWW.THOMSENENGINEERING.COM

PREPARED UNDER THE SUPERVISION OF:
DAVID CALDWELL REGISTERED PROFESSIONAL ENGINEER
 CIVIL ENGINEERING
 11000 WILSON AVENUE, SUITE 100
 WESTMINSTER, CALIFORNIA 92683
 TEL: (714) 731-1100 FAX: (714) 731-1101
 WWW.DAVIDCALDWELL.COM

BENCH MARK: IN THE COUNTY OF RIVERSIDE
 GRADING PLAN-ENLARGED SITE
 EXCHANGE CLUB PARK
 M.S. NO. 4023
 OF 11 SHEETS

SHEET NO. 9

SCALE: H. 1"=20' V. 1"=20'

FOR: Y&H AND ASSOC.

COUNTY: RIVERSIDE
 REEL NO.: CR-0081

963-F

IN THE UNINCORPORATED TERRITORY OF THE COUNTY OF RIVERSIDE, STATE OF CALIFORNIA
EXCHANGE CLUB PARK PUBLIC FACILITY
EROSION CONTROL PLAN
MS NO. 4023

NPDES NOTES:

- 1) EROSION CONTROL BMPs SHALL BE IMPLEMENTED AND MAINTAINED TO MINIMIZE AND/OR PREVENT THE ENRICHMENT OF SOIL IN RUNOFF FROM DISTURBED SOIL AREAS ON CONSTRUCTION SITES.
- 2) SEDIMENT CONTROL BMPs SHALL BE MAINTAINED AND MAINTAINED TO PREVENT AND/OR MINIMIZE THE TRANSPORT OF SOIL FROM THE CONSTRUCTION SITE.
- 3) STOCKPILES OF SOIL SHALL BE PROPERLY COVERED TO DRAINAGE OR REDUCE SEDIMENT TRANSPORT FROM THE SITE TO STREETS, DRAINAGE FACILITIES OR ADJACENT PROPERTIES VIA RUNOFF, VEHICLE TRACKING, OR WIND.
- 4) APPROPRIATE BMPs FOR CONSTRUCTION-RELATED MATERIALS, WASTES, SPILLS OR OILS SHALL BE IMPLEMENTED TO PREVENT POLLUTION OF STREETS, DRAINAGE FACILITIES OR ADJACENT PROPERTIES BY WIND OR RUNOFF. CONSTRUCTION SITES MUST NOT BE DISCHARGING TO RECEIVING WATERS OR THE CASCADA STORMWATER BMP HANDBOOK LATEST REVISED EDITION, SHALL APPLY DURING CONSTRUCTION. ADDITIONAL MEASURES SHALL BE REQUIRED IF DETERMINED APPROPRIATE BY THE COUNTY.
- 5) ALL CONSTRUCTION CONTRACTOR AND SUBCONTRACTOR OPERATIONS ARE TO BE MADE IN ACCORDANCE WITH THE BEST MANAGEMENT PRACTICES AND GOOD HOUSEKEEPING MEASURES FOR THE PROJECT SITE AND ANY ASSOCIATED CONSTRUCTION STAGING AREAS.
- 6) MATERIALS SHALL BE COLLECTED AND PROPERLY DISPOSED IN TRASH OR RECYCLE BINS.
- 7) AT THE END OF EACH DAY OF CONSTRUCTION ACTIVITY ALL CONSTRUCTION DEBRIS DOES NOT CARRY WASTES OR POLLUTANTS OF THE SITE. DISCHARGES OTHER THAN BY AN INDIVIDUAL, NPDES PERMIT OR THE STATE GENERAL PERMIT FOR CONSTRUCTION SHALL BE PROHIBITED.
- 8) WASTES FROM PAINTS, STAINING, SEALANTS, SOLVENTS, OILS, GREASES, LIQUIDS, SPILLS, WASTES FROM FERTILIZERS, WOOD PRESERVATIVES, AND AEROSOLS (PRESSURIZED RADIATOR OR BATTERY FLUIDS, CONCRETE AND RELATED CUTTING OR CURING RESIDUES, ADHESIVES, GLUES, AND OTHER LIQUIDS) SHALL BE STORED IN CONTAINERS AND PROPERLY LABELLED. WASTES FROM STREET CLEANING, DISPOSAL OF SUCH MATERIALS SHOULD BE SEPARATED FROM POTENTIAL STORMWATER RUNOFF, WITH ULTIMATE DISPOSAL IN ACCORDANCE WITH LOCAL, STATE AND FEDERAL REQUIREMENTS.
- 9) ALL MATERIALS RELATED TO THE CONSTRUCTION SITE SHALL BE PROPERLY STORED AND COVERED TO PREVENT EROSION. IT IS ALSO PROHIBITED DISCHARGING TO RECEIVING WATERS. A NATIONAL POLLUTANT DISCHARGE ELIMINATION SYSTEM (NPDES) PERMIT ISSUED BY THE REGIONAL BOARD.
- 10) CONSTRUCTION SITES SHALL BE MAINTAINED TO MINIMIZE THE EXPOSURE TIME OF FEASIBLE AND THE USE OF TEMPORARY AND PERMANENT SOIL STABILIZATION TO THE EXTENT FEASIBLE AND TO PREVENT STORM EVENTS AND FOLLOWING STORM EVENTS.

STORM WATER POLLUTION CONTROL REQUIREMENTS

1. EROSION CONTROL AND OTHER POLLUTIONS SHALL BE MAINTAINED ON SITE AND SHALL NOT BE TRANSPORTED FROM THE SITE VIA SHEET FLOW, WALES, AREA DRAINS, NATURAL DRAINAGE COURSES OR WIND.
2. STOCKPILES OF EARTH AND OTHER CONSTRUCTION RELATED MATERIALS SHALL BE PROTECTED FROM WIND AND OTHER POLLUTIONS SHALL BE STORED IN A MANNER WHICH PREVENTS THEM FROM LEAKING AND ARE NOT TO CONTAMINATE THE SOIL AND SURFACE WATERS. ALL WASTES FROM PAINTS, STAINING, SEALANTS, SOLVENTS, OILS, GREASES, LIQUIDS, SPILLS, WASTES FROM FERTILIZERS, WOOD PRESERVATIVES, AND AEROSOLS (PRESSURIZED RADIATOR OR BATTERY FLUIDS, CONCRETE AND RELATED CUTTING OR CURING RESIDUES, ADHESIVES, GLUES, AND OTHER LIQUIDS) SHALL BE STORED IN CONTAINERS AND PROPERLY LABELLED. WASTES FROM STREET CLEANING, DISPOSAL OF SUCH MATERIALS SHOULD BE SEPARATED FROM POTENTIAL STORMWATER RUNOFF, WITH ULTIMATE DISPOSAL IN ACCORDANCE WITH LOCAL, STATE AND FEDERAL REQUIREMENTS.
3. EXCESS OR WASTE CONCRETE SHALL NOT BE WASHED INTO THE PUBLIC RIGHT-OF-WAY OR INTO STREETS, DRAINAGE FACILITIES OR ADJACENT PROPERTIES VIA RUNOFF, VEHICLE TRACKING, OR WIND.
4. EXCESS OR WASTE CONCRETE SHALL NOT BE WASHED INTO THE PUBLIC RIGHT-OF-WAY OR INTO STREETS, DRAINAGE FACILITIES OR ADJACENT PROPERTIES VIA RUNOFF, VEHICLE TRACKING, OR WIND.
5. TRASH AND CONSTRUCTION RELATED SOLID WASTES SHALL BE DEPOSITED INTO A COVERED RECEPTACLE TO PREVENT CONTAMINATION OF RUNWAY AND DISPERSED BY WIND.
6. SEDIMENTS AND OTHER MATERIALS SHALL NOT BE TRACKED FROM THE SITE BY VEHICLE TRACKING OR WIND. SEDIMENTS FROM BEING DEPOSITED INTO THE PUBLIC RIGHT-OF-WAY, ADJACENT PROPERTIES VIA RUNOFF, VEHICLE TRACKING, OR WIND.
7. ANY SOLES WITH REMOVED SOLE OR COVERED OF VEGETATION SHALL BE STABILIZED SO AS TO PREVENT EROSION BY WIND AND WATER.
8. THE CASCADA STORMWATER BMP HANDBOOK LATEST REVISED EDITION, SHALL APPLY DURING CONSTRUCTION. ADDITIONAL MEASURES SHALL BE REQUIRED IF DETERMINED APPROPRIATE BY THE COUNTY.

CURB INLET SEDIMENTATION BARRIERS CONSTRUCTION SPECIFICATIONS (PRECISE GRADING)

1. BARRIERS SHALL BE PLACED ON GENTLY SLOPING STREETS WHERE WATER CAN POOL.
2. THE BARRIERS SHALL ALLOW FOR OVERFLOW FROM A SEVERE STORM EVENT. SLOPE SHALL BE MAINTAINED TO PREVENT OVERFLOW FROM THE CURB INTO THE DRIVEWAY.
3. GRAVEL BAGS SHOULD BE OF WORK-PILE GEOTEXTILE FABRIC.
4. OPEN ENDS SHALL BE FILLED WITH 3/4 INCH (19 mm) DRAIN ROCK OR 1/4 INCH (6.35 mm) SAND.
5. GRAVEL BAGS SHALL BE PLACED IN A CURVED ROW FROM THE TOP OF CURB AT LEAST 4 FEET (1.22m) INTO THE STREET. THE ROW SHOULD BE CURVED AT THE ENDS, POINTING UPHILL.
7. LEAVE ONE GRAVEL BAG GAP IN THE TOP ROW TO ACT AS A SPILLWAY.

INSPECTION & MAINTENANCE

1. THE CONTRACTOR SHALL INSPECT AND CLEAN BARRIERS BEFORE AND AFTER EACH STORM AND REMOVE SEDIMENT FROM BEHIND GRAVEL BAG STRUCTURE AFTER EACH STORM.
2. IF SEDIMENT AND GRAVEL SHALL BE IMMEDIATELY REMOVED FROM THE TRAVELED SURFACE.
3. THE REMOVED SEDIMENT SHALL BE PLACED WHERE IT CANNOT ENTER A STORM DRAIN, STREAM, OR BE TRANSPORTED OFF SITE.
4. IF THE GRAVEL BECOMES GLOUED WITH SEDIMENT, IT MUST BE REMOVED FROM THE INLET AND REPLACED WITH NEW GRAVEL.
5. IT IS IMPERATIVE THAT EROSION CONTROL MEASURES ARE IN PLACE AT THE SOURCE OF THE SEDIMENT IN ADDITION TO PROTECTING THE CATCH BASINS AND CURB INLETS.

EROSION CONTROL GRADING REQUIREMENTS (ROUGH GRADING)

1. ALL GRADING WORK PERFORMED TO CONSTRUCT EROSION CONTROL MEASURES SHALL BE APPROVED BY THE COUNTY ENGINEER.
2. DAMAGE DONE ON THE SLOPE ARE APPROXIMATE ESTIMATES OF WORK TO BE DONE AND THE CONTRACTOR SHALL VERIFY FIELD CONDITIONS AND QUANTITIES PRIOR TO THE START OF WORK.
3. THE CONTRACTOR SHALL MAKE PROVISION FOR CONVEYING DEBRIS AWAY FROM THE WORK AREA IN REMOVABLE CONDITION BY THE CONTRACTOR.
4. ROCK DISPOSAL AREAS ARE SHOWN ON PLANS. NO ROCK GREATER THAN 12" IN DIAMETER WILL BE PLACED IN THE FILL, UNLESS APPROVED BY THE COUNTY ENGINEER.
5. ALL FILL SHALL BE COMPACTED TO THE PROPOSED GRADE. TERRAIN SHALL BE SUPPORTED ON HORIZONTAL BENCH CUTS TO PREVENT SLIDING.
6. ANY MODIFICATIONS TO PLAN SHALL REQUIRE THE APPROVAL OF A REGISTERED CIVIL ENGINEER.
7. ALL FILL SHALL BE COMPACTED TO THE PROPOSED GRADE. TERRAIN SHALL BE SUPPORTED ON HORIZONTAL BENCH CUTS TO PREVENT SLIDING.
8. THE SOIL ENGINEER SHALL PROVIDE SUFFICIENT INSPECTION OF EARTHWORK IN CASE OF EMERGENCY.
9. THE SOIL ENGINEER SHALL PROVIDE SUFFICIENT INSPECTION OF EARTHWORK TO ENSURE COMPLIANCE WITH THE APPROVED PLANS AND APPLICABLE CODES.

EROSION CONTROL MAINTENANCE & INSPECTION

1. THE CONTRACTOR SHALL MAINTAIN ALL EROSION CONTROL MEASURES THROUGHOUT THE PROJECT.
2. THE CONTRACTOR SHALL MAINTAIN ALL EROSION CONTROL MEASURES THROUGHOUT THE PROJECT.
3. THE CONTRACTOR SHALL MAINTAIN ALL EROSION CONTROL MEASURES THROUGHOUT THE PROJECT.
4. THE CONTRACTOR SHALL MAINTAIN ALL EROSION CONTROL MEASURES THROUGHOUT THE PROJECT.
5. THE CONTRACTOR SHALL MAINTAIN ALL EROSION CONTROL MEASURES THROUGHOUT THE PROJECT.
6. THE CONTRACTOR SHALL MAINTAIN ALL EROSION CONTROL MEASURES THROUGHOUT THE PROJECT.
7. THE CONTRACTOR SHALL MAINTAIN ALL EROSION CONTROL MEASURES THROUGHOUT THE PROJECT.
8. THE CONTRACTOR SHALL MAINTAIN ALL EROSION CONTROL MEASURES THROUGHOUT THE PROJECT.
9. THE CONTRACTOR SHALL MAINTAIN ALL EROSION CONTROL MEASURES THROUGHOUT THE PROJECT.

EROSION & SEDIMENT CONTROL NOTES:

1. INFORMATION ON THIS PLAN IS FOR EROSION PREVENTION AND SEDIMENT CONTROL. THE CONTRACTOR SHALL BE RESPONSIBLE FOR THE INSTALLATION AND MAINTENANCE OF A COMBINATION OF EROSION CONTROL MEASURES TO PROTECT THE SITE. THE CONTRACTOR SHALL BE RESPONSIBLE FOR THE INSTALLATION AND MAINTENANCE OF A COMBINATION OF EROSION CONTROL MEASURES TO PROTECT THE SITE. THE CONTRACTOR SHALL BE RESPONSIBLE FOR THE INSTALLATION AND MAINTENANCE OF A COMBINATION OF EROSION CONTROL MEASURES TO PROTECT THE SITE.
2. EMERGENCY 24-HOUR CONTACT INFORMATION:
 MS DEAN WETTER, GENERAL MANAGER
 VALLEY WIDE RECREATION AND PARK DISTRICT
 900 WEST ESPANOLA AVENUE
 RIVERSIDE, CA 92507
 951-524-1500 PHONE
 951-524-1500 FAX
 951-524-1500 TDD
3. NOTIFY THE COUNTY ENGINEER IMMEDIATELY UPON THE OCCURRENCE OF AN EROSION CONTROL MEASURE FAILURE. THE CONTRACTOR SHALL BE RESPONSIBLE FOR THE REPAIR OF THE FAILURE AND FOR THE PROTECTION OF THE SITE FROM FURTHER EROSION.
4. CONSTRUCTION WASTE AND MISCELLANEOUS DEBRIS SHALL BE PLACED IN WATER-TIGHT BINS. WASTE TRASH RECEPTACLES WILL NOT BE ALLOWED. WASH-OFF STATIONS SHALL BE PROVIDED FOR ALL EQUIPMENT. WASH-OFF STATIONS SHALL BE PLACED AWAY FROM STREETS, SIDEWALKS, DRIVEWAYS, AND DRAINAGE SYSTEMS. WASH-OFF STATIONS SHALL BE PLACED AWAY FROM STREETS, SIDEWALKS, DRIVEWAYS, AND DRAINAGE SYSTEMS. WASH-OFF STATIONS SHALL BE PLACED AWAY FROM STREETS, SIDEWALKS, DRIVEWAYS, AND DRAINAGE SYSTEMS.
5. ALL PORTABLE WATERS SHALL HAVE PLASTIC UNDER-LINERS TO CONTAIN SPILLAGE. GRAVEL BAGS SHALL ALSO BE PLACED ON THE DOWN-HILL SIDE OF THE LINERS TO PREVENT SPILLAGE.
6. THE COUNTY BUILDING DEPARTMENT RESERVES THE RIGHT TO MAKE CHANGES TO THIS PLAN. THE COUNTY ENGINEER'S APPROVAL OF THIS PLAN DOES NOT RELIEVE THE CONTRACTOR OF RESPONSIBILITY FOR CORRECTIONS OF ERRORS AND OMISSIONS DISCOVERED DURING CONSTRUCTION.

DUST CONTROL NOTES:

1. THE COUNTY BUILDING DEPARTMENT MAY REQUIRE THE SUBMITTAL OF A DUST CONTROL PLAN FOR ALL CONSTRUCTION PROJECTS. THE DUST CONTROL PLAN SHALL BE NECESSARY AT THE VERY MINIMUM, THE FOLLOWING CONDITIONS CONSIDERED NECESSARY:
2. DUST CONTROL MEASURES SHALL BE INSTALLED TO PREVENT DUST FROM BEING BLOWN OFF THE SITE. DUST CONTROL MEASURES SHALL BE INSTALLED TO PREVENT DUST FROM BEING BLOWN OFF THE SITE. DUST CONTROL MEASURES SHALL BE INSTALLED TO PREVENT DUST FROM BEING BLOWN OFF THE SITE.
3. THE CONTRACTOR SHALL MAKE PROVISION FOR CONVEYING DEBRIS AWAY FROM THE WORK AREA IN REMOVABLE CONDITION BY THE CONTRACTOR.
4. WHEN AN EROSION CONTROL MEASURE IS INSTALLED, THE SUBSEQUENT CONSTRUCTION ON THE SITE SHALL BE COMPLETED IN PHASES. THE PORTION OF THE SITE NOT UNDER CONSTRUCTION SHALL BE PROTECTED BY A CURB, GRAVEL BAGS, OR PLASTIC MATERIALS AND AN EROSION CONTROL MEASURE. THE PORTION OF THE SITE NOT UNDER CONSTRUCTION SHALL BE PROTECTED BY A CURB, GRAVEL BAGS, OR PLASTIC MATERIALS AND AN EROSION CONTROL MEASURE.
5. THE CONTRACTOR SHALL MAINTAIN ALL EROSION CONTROL MEASURES THROUGHOUT THE PROJECT.

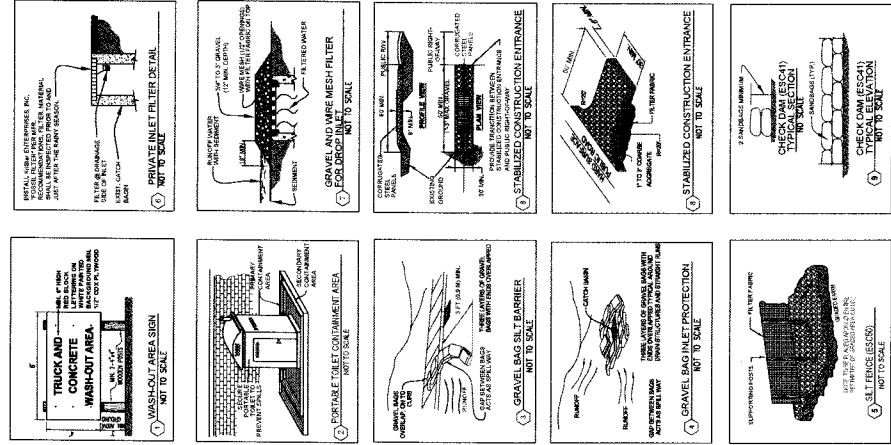

811
 Know what's below.
 Call before you dig.

NOTE:
 WORK CONTAINED WITHIN THESE PLANS SHALL NOT BE CONSIDERED A GUARANTEE OF ACCURACY AND/OR A GRADING BENEFIT HAS BEEN ISSUED.
 THE CONTRACTOR SHALL BE RESPONSIBLE FOR OBTAINING ALL NECESSARY PERMITS AND APPROVALS FROM THE COUNTY ENGINEER AND THE COUNTY ENGINEER SHALL BE RESPONSIBLE FOR OBTAINING ALL NECESSARY PERMITS AND APPROVALS FROM THE COUNTY ENGINEER.

APPROVED AS TO CONFORMANCE WITH APPLICABLE COUNTY STANDARDS AND REGULATIONS:

RECORD	PLAN CHECK OVERSIGHT ENGINEER	REGISTRATION NUMBER	DATE SIGNED

PRINCIPAL ENGINEER:

J. THOMSEN
 2800 SOUTHERN JACQUETTE LANE, JACOBA, CA 92550
 PREPARED UNDER THE SUPERVISION OF:
Dir. OALMAN
 REGISTERED PROFESSIONAL ENGINEER

BENCH MARK:
 THE BENCHMARK IS LOCATED AT THE INTERSECTION OF THE CENTERLINE OF THE PROJECT AND THE CENTERLINE OF THE MAINWAY. THE BENCHMARK IS LOCATED AT THE INTERSECTION OF THE CENTERLINE OF THE PROJECT AND THE CENTERLINE OF THE MAINWAY. THE BENCHMARK IS LOCATED AT THE INTERSECTION OF THE CENTERLINE OF THE PROJECT AND THE CENTERLINE OF THE MAINWAY.

SCALE: HORIZONTAL: 1" = 40'-0" VERTICAL: 1" = 4'-0"

DATE: 11/15/2023

PROJECT: WIND HILLS

SHEET NO. 10 OF 11 SHEETS

IN THE COUNTY OF RIVERSIDE
EROSION CONTROL PLAN
EXCHANGE CLUB PARK
M.S. NO. 4023

COUNTY: RIVERSIDE
PROJECT NO.: CE-0081

963-F

ISSUED BY ADDENDUM NO. 1, ATTACHMENT 'C'
 DATE: 11/15/2023
 PROJECT: WIND HILLS
 SHEET: 10 OF 11

IN THE UNINCORPORATED TERRITORY
OF THE COUNTY OF RIVERSIDE,
STATE OF CALIFORNIA

**EXCHANGE CLUB PARK PUBLIC FACILITY
EROSION CONTROL PLAN
MS NO. 4023**

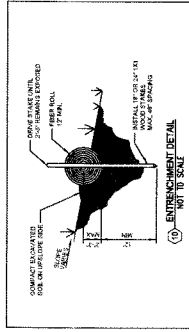
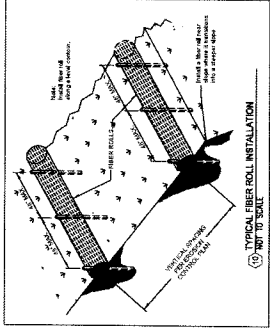
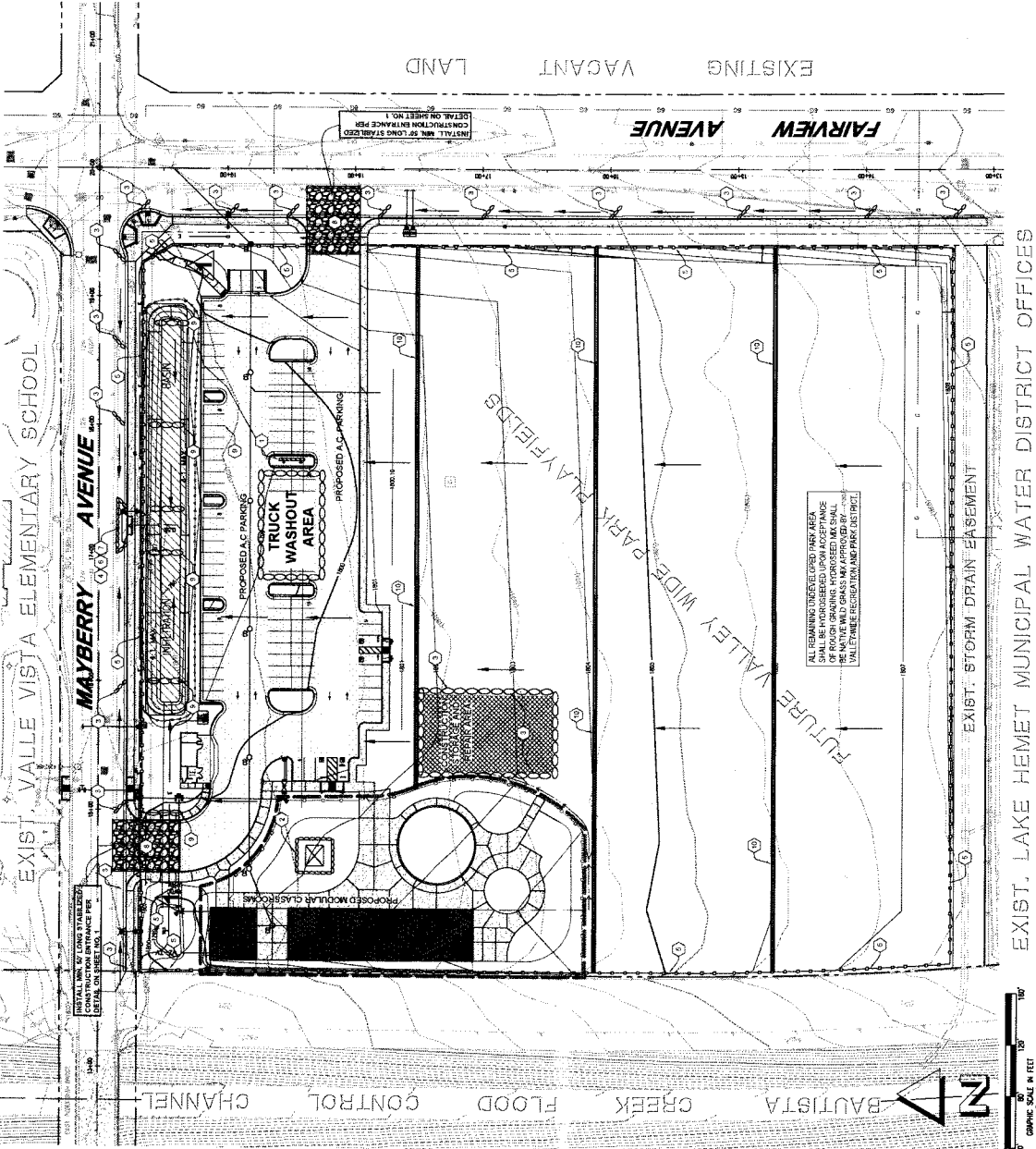

NOTE:
FIBER ROLLS AND SILT FENCE TO BE RETAINED FOR VALLEY WIDE USE.

- LEGEND:**
- CONSTRUCTION NOTE PER DETAIL ON SHEET 11 OR 12
 - APPROXIMATE SAMPLING LOCATIONS
 - EXISTING CONTOUR
 - INDICATES DIRECTION OF FLOW
 - INDICATES PORTABLE RESTROOM
 - INDICATES SANDBAGS TO BE PLACED PER ESC 41
 - INDICATES CONTROLLED ENTRANCE OR EXIT PER ESC 24.
 - INDICATES INFILTRATION BASIN
 - INDICATES CONSTRUCTION MATERIAL LOADING, UNLOADING AND ACCESS AREA PER CAD
 - INDICATES PROPOSED BUILDINGS

INSTALL 2' DIA. SAND BAGS PER DETAIL ON SHEET NO. 1

ALL REMAINING UNDEVELOPED PARK AREA SHALL BE HYDRATED FROM ACCEPTANCE OF THE COUNTY ENGINEER AND SHALL BE NATIVE WILD GRASS AS APPROVED BY THE VALLEY WIDE REGISTRATION AND PARK DISTRICT.



811
Know what's below.
Call before you dig.

NOTE:
WORK SHOWN WITHIN THESE PLANS SHALL NOT BE CONSIDERED AS A GUARANTEE OF ACCURACY AND/OR A GRADING PERMIT HAS BEEN ISSUED. THE USER SHALL BE RESPONSIBLE FOR OBTAINING ALL NECESSARY PERMITS AND FOR THE ACCURACY AND COMPLETENESS OF THE DATA PROVIDED. THE USER SHALL BE RESPONSIBLE FOR VERIFYING THE ACCURACY OF ALL DATA PROVIDED AND FOR THE ACCURACY OF THE DATA PROVIDED. THE USER SHALL BE RESPONSIBLE FOR OBTAINING ALL NECESSARY PERMITS AND FOR THE ACCURACY AND COMPLETENESS OF THE DATA PROVIDED.

EMP.	BT.	DATE	ENGINEER

THOMSEN ENGINEERING
CIVIL ENGINEERING
2880 SOUTH SAN JUAN AVENUE, SAN ANTONIO, CA 78249
WWW.THOMSENENGINEERING.COM

PREPARED UNDER THE SUPERVISION OF
DR. G. W. WALKER
REGISTERED PROFESSIONAL ENGINEER
NO. 4023

DATE: 11/11/11
SCALE: 1" = 40'

BENCHMARK: IN THE COUNTY OF RIVERSIDE
EROSION CONTROL PLAN
EXCHANGE CLUB PARK
M.S. NO. 4023

FOR: WINDMILLER
SCALE: 1" = 40' V, 1" = 40' H
DATE: 11/11/11
DRAWN BY: [Signature]
CHECKED BY: [Signature]

RECORD	PLAN CHECK OVERSIGHT ENGINEER	REGISTRATION NUMBER	DATE SIGNED

ISSUED BY ADDENDUM NO. 1, ATTACHMENT "C"