

**SUBMITTAL TO THE BOARD OF SUPERVISORS
COUNTY OF RIVERSIDE, STATE OF CALIFORNIA**

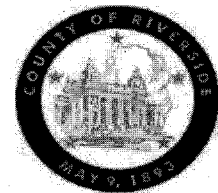

**ITEM
3.8
(ID # 3222)**

MEETING DATE:
Tuesday, January 24, 2017

FROM : TLMA-TRANSPORTATION:

SUBJECT: TLMA- TRANSPORTATION DEPARTMENT: Introduction of Ordinance No. 452.242 to Establish Speed Zones Enforceable by Radar Speed Detection Equipment in the Corona, Mead Valley, Nuevo, and Temecula Areas. 1st, 3rd, and 5th Districts; [\$4,500 - Total Cost]; Local Funds 100%

RECOMMENDED MOTION: That the Board of Supervisors:

1. Introduce and adopt, on successive meetings, Ordinance No. 452.242, Amending Ordinance No. 452 relating to prima facie speed limits to establish various speed zones in the above-referenced areas of Riverside County.

ACTION: Policy

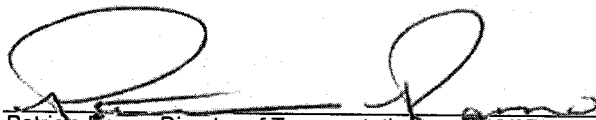
Patricia Romo, Director of Transportation 12/27/2016

| FINANCIAL DATA | Current Fiscal Year: | Next Fiscal Year: | Total Cost: | Ongoing Cost |
|--|-----------------------------|--------------------------|-------------------------------|---------------------|
| COST | \$ 4,500 | \$ 0 | \$ 4,500 | \$ 0 |
| NET COUNTY COST | \$ 0 | \$ 0 | \$ 0 | \$ 0 |
| SOURCE OF FUNDS: Gas Tax (100%). There are no General funds used in this project. | | | Budget Adjustment: No | |
| | | | For Fiscal Year: 16/17 | |

C.E.O. RECOMMENDATION: Approve

MINUTES OF THE BOARD OF SUPERVISORS

On motion of Supervisor Ashley, seconded by Supervisor Jeffries and duly carried, IT WAS ORDERED that the above matter is approved as recommended and that the above Ordinance is approved as introduced with a waiver of reading.

Ayes: Jeffries, Washington and Ashley
Nays: None
Absent: Tavaglione
Date: January 24, 2017
xc: Transp., COB

Kecia Harper-Ihem
Clerk of the Board
By: 
Deputy

**SUBMITTAL TO THE BOARD OF SUPERVISORS COUNTY OF RIVERSIDE,
STATE OF CALIFORNIA**

BACKGROUND:

Summary

The County of Riverside Transportation Department (Transportation Department) staff has conducted Engineering and Traffic Surveys (E&TS) in accordance with the California Vehicle Code (CVC), Sections 627 and 40802, for various county-maintained roads in the Corona, Mead Valley, Nuevo and Temecula areas of Riverside County.

Based upon the results of the E&TS for these roads, the radar-enforceable speed limits recommended by the Transportation Department are summarized in the attached tables and have been determined to be appropriate to facilitate the safe and orderly movement of vehicular traffic.

Transportation Department staff has contacted the Riverside and Temecula area offices of the California Highway Patrol (CHP) regarding the recommended speed zones.

The Ordinance Amendment has been reviewed and approved by County Counsel as to form.

Impact on Residents and Businesses

The establishing and posting of appropriate speed limits promote safe and orderly movements of vehicular traffic and enable the CHP to use radar equipment to enforce the speed limits. Since the recommended speed limits were determined based on actual speed surveys, the majority of the motorists are already driving at or below the recommended speed limits. Posted speed limits also guide motorists to drive at a reasonable speed in unfamiliar locations.

SUPPLEMENTAL:

Additional Fiscal Information

The cost for establishing the recommended speed limits is primarily for the installation of speed limit signs, which is estimated at approximately \$4,500. There are no General funds used in this project.

Contract History and Price Reasonableness

N/A

ATTACHMENTS:

Vicinity Maps
Ordinance No. 452.242
List of Speed Zones
Speed Zone Diagrams



Gregory T. Priamos, Director County Counsel

1/5/2017



1
2
3
4
5
6
7
8
9
10
11
12
13
14
15
16
17
18
19
20
21
22
23
24
25
26
27
28

ORDINANCE NO. 452.242

AN ORDINANCE OF THE COUNTY OF RIVERSIDE

AMENDING ORDINANCE NO. 452

RELATING TO PRIMA FACIE SPEED LIMITS

The Board of Supervisors of the County of Riverside ordains as follows:

Section 1. Section 2.1 of Ordinance No. 452, entitled "Twenty-five miles per hour," is hereby amended to add new subsection 8 to read as follows:

"8. On De Luz Road between Calle Capistrano and Granado Place, a total distance of approximately 0.28 miles, in the Temecula area."

Section 2. Section 2.3 of Ordinance No. 452, entitled "Thirty-five miles per hour," is hereby amended to add new subsection 133 to read as follows:

"133. On Thirteenth Street between Reservoir Avenue and Gibson Avenue, a total distance of approximately 1.24 miles, in the Nuevo area."

Section 3. Section 2.4 of Ordinance 452, entitled "Forty miles per hour," is hereby amended to add new subsection 151 to read as follows:

"151. On De Luz Road between Rancho California Road and Calle Capistrano, a total distance of approximately 0.54 miles, in the Temecula area."

Section 4. Section 2.5 of Ordinance 452, entitled "Forty-five miles per hour," is hereby amended to add new subsections 172 and 173 to read as follows:

"172. On Carroll Street between Rider Street and Cajalco Road, a total distance of approximately 0.50 miles, in the Mead Valley area.

173. On Trilogy Parkway between Hunt Road and Temescal Canyon Road, a total distance of approximately 1.84 miles, in the Corona area."

Section 5. Section 2.6 of Ordinance No. 452, entitled "Fifty miles per hour," is hereby amended to add new subsection 89 to read as follows:

1
2
3
4
5
6
7
8
9
10
11
12
13
14
15
16
17
18
19
20
21
22
23
24
25
26
27
28

“89. On De Portola Road, between Pauba Road and Glen Oaks Road, a total distance of approximately 4.18 miles, in the Temecula area.”

Section 6. Section 3.5 of Ordinance No. 452, entitled “Twenty miles per hour,” is hereby amended to add new subsection 2 to read as follows:

“2. On De Luz Road from Granado Place to a point 2,785 feet north of Via Medeiros, a total distance of approximately 0.94 miles, in the Temecula area.”

Section 7. Subsection 1 of Section 3.5 of Ordinance 452 adopted on March 29, 2016, pursuant to Ordinance No. 452.240, is repealed in its entirety. Subsection 1 of Section 3.5 established a twenty miles per hour speed limit on De Luz Road between Rancho California Road and a point 2,785 feet north of Via Medeiros.

Section 8. This ordinance shall take effect 30 days after its adoption.

BOARD OF SUPERVISORS OF THE COUNTY
OF RIVERSIDE, STATE OF CALIFORNIA

BY: _____
SUPERVISOR JOHN J. BENOIT, Chairman

ATTEST:
KECIA HARPER-IHEM, Clerk of the Board

By: _____
Deputy

APPROVED AS TO FORM:
GREGORY P. PRIAMOS, County Counsel

By: Synthia M. Gunzel
Deputy
SYNTHIA M. GUNZEL

LTT:sa
Y:\Traffic\Ord 452 Speed Zones\Ord. 452.242\Ord. 452.242.Docx



ORDINANCE 452.242 DISTRICT 1 SPEED ZONE VICINITY MAP

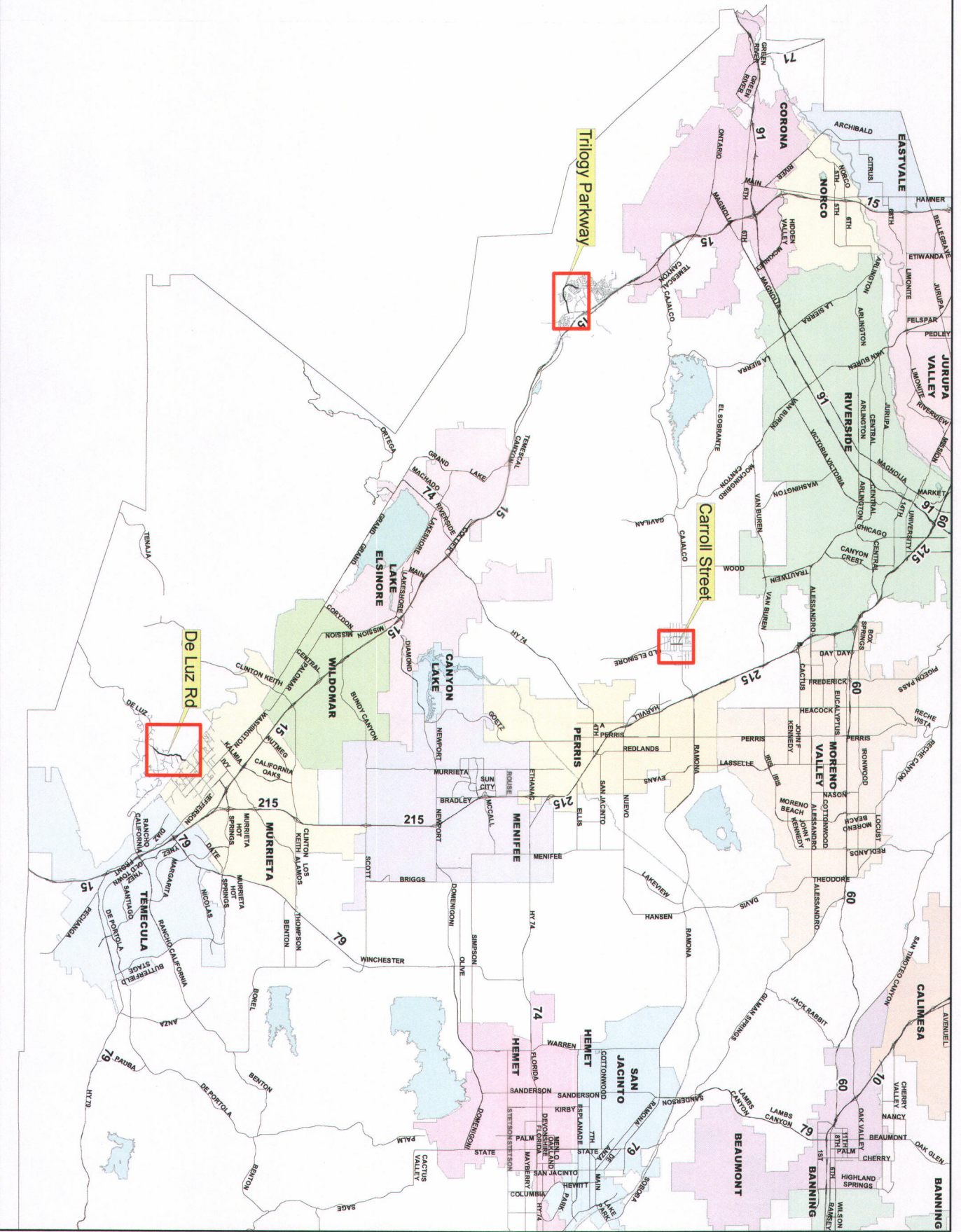

ORDINANCE 452.242 DISTRICT 3 SPEED ZONE VICINITY MAP

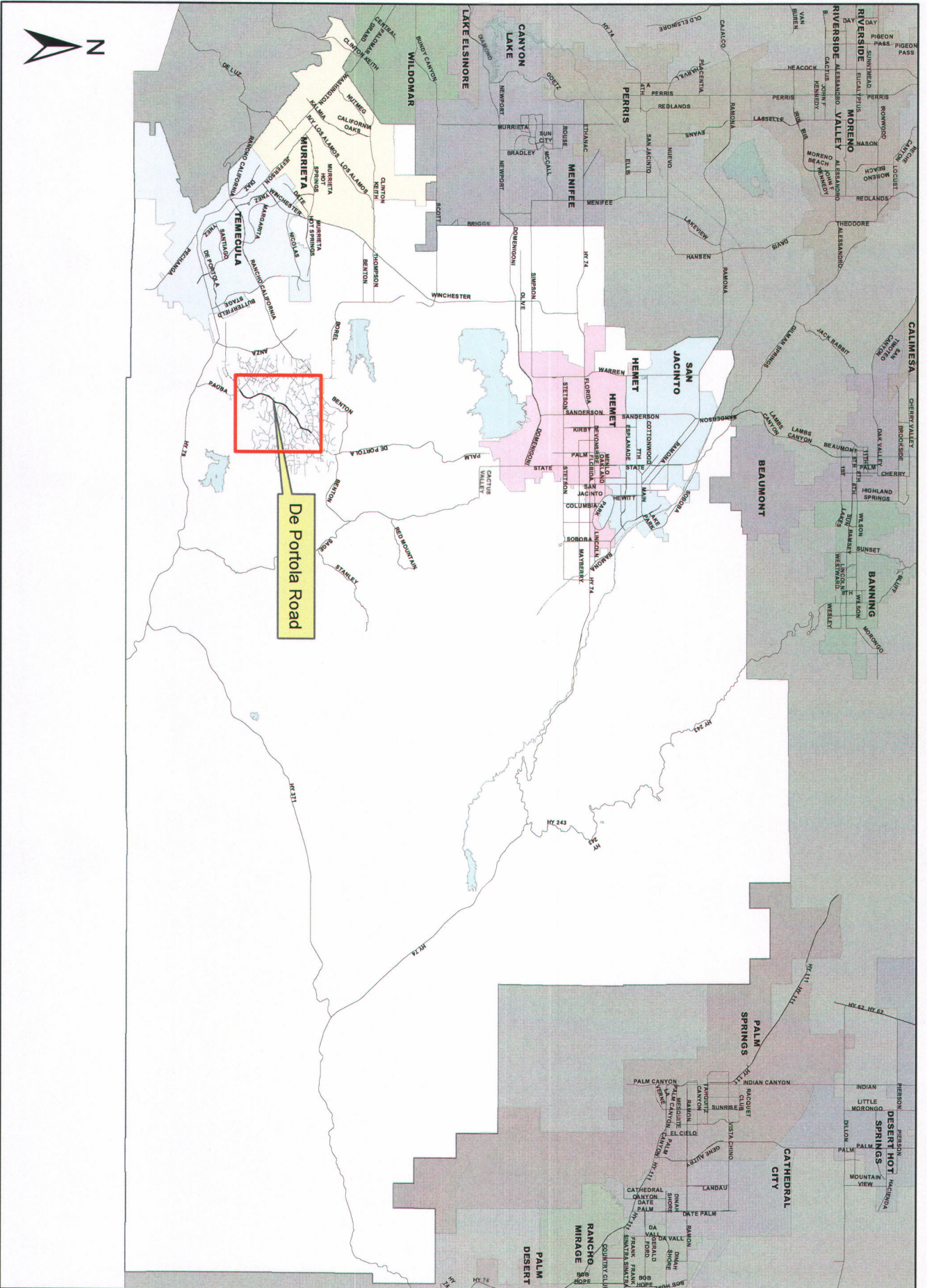

ORDINANCE 452.242 DISTRICT 5 SPEED ZONE VICINITY MAP

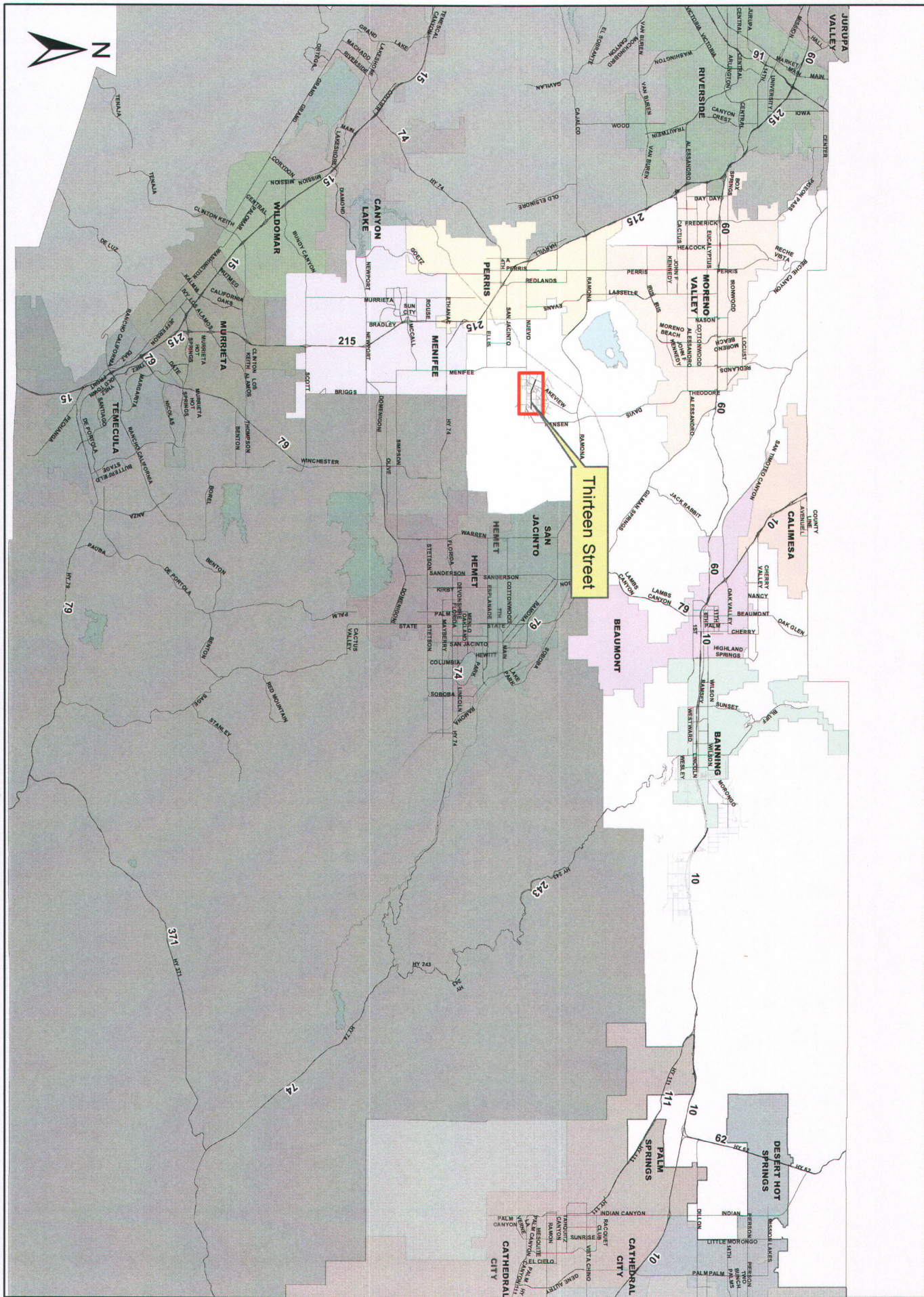

**LIST OF SPEED ZONE SUBMITTALS
ORDINANCE AMENDMENT NO 452.242
SUPERVISORIAL DISTRICT NO. 1**

| AREA | ROAD NAME/ LIMITS | EXISTING SPEED LIMIT | PROPOSED SPEED LIMIT | NOTES |
|-------------|---|-------------------------|-------------------------|--|
| MEAD VALLEY | CARROLL STREET Between Rider Street and Cajalco Road | Not Posted | 45 | NEW SPEED ZONE |
| TEMECULA | DE LUZ ROAD Between Granada Place to a point 2,785 feet north of Via Medeiros | 20 | 20 | BOUNDARY CHANGE DUE TO ROADWAY IMPROVEMENTS |
| TEMECULA | DE LUZ ROAD Between Calle Capistrano and Granada Place | 20 | 25 | ROADWAY IMPROVED FROM DIRT TO ASPHALT PAVEMENT. EXISTING 20 MPH NO LONGER VALID |
| TEMECULA | DE LUZ ROAD Between Rancho California Road and Calle Capistrano | 20 | 40 | ROADWAY IMPROVED FROM DIRT TO ASPHALT PAVEMENT. EXISTING 20 MPH NO LONGER VALID. |
| CORONA | TRILOGY PARKWAY Between Hunt Road and Temescal Canyon Road | 45 | 45 | UPDATE (NOT PREVIOUSLY INCLUDED IN ORDINANCE 452) |

- * Maximum allowable speed limit for a two-lane highway is 55 mph
- **Maximum allowable speed limit for a multi-lane highway is 65 mph
- ***Change in speed zone boundary

**LIST OF SPEED ZONE SUBMITTALS
ORDINANCE AMENDMENT NO 452.242
SUPERVISORIAL DISTRICT NO. 3**

| AREA | ROAD NAME/ LIMITS | EXISTING SPEED LIMIT | PROPOSED SPEED LIMIT | NOTES |
|----------|---|-------------------------|-------------------------|--|
| TEMECULA | DE PORTOLA ROAD Between Pauba Road and Glen Oaks Road | 55* | 50 | NEW SPEED SURVEY; LOWER EXISTING POSTED SPEED LIMIT |

- * Maximum allowable speed limit for a two-lane highway is 55 mph
- **Maximum allowable speed limit for a multi-lane highway is 65 mph
- ***Change in speed zone boundary

December 13, 2016

**LIST OF SPEED ZONE SUBMITTALS
ORDINANCE AMENDMENT NO 452.242
SUPERVISORIAL DISTRICT NO. 5**

| AREA | ROAD NAME/ LIMITS | EXISTING SPEED LIMIT | PROPOSED SPEED LIMIT | NOTES |
|-------|---|-------------------------|-------------------------|-------|
| NUEVO | THIRTEENTH STREET Between Reservoir Avenue and Gibson Avenue | Not Posted | 35 | NEW |

* Maximum allowable speed limit for a two-lane highway is 55 mph

** Maximum allowable speed limit for a multi-lane highway is 65 mph

*** Change in speed zone boundary

December 13, 2016

DE LUZ ROAD

(#1562)

LEGEND:

- ////// CITY LIMITS
- ▬ RADAR ZONE
- ▨ RADAR ZONE (DIRT ROAD)
- - - SURVEY STATION
- ▬ OTHER STREET OR ROAD

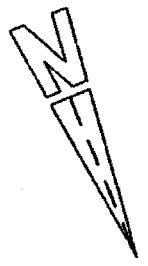

NO SCALE

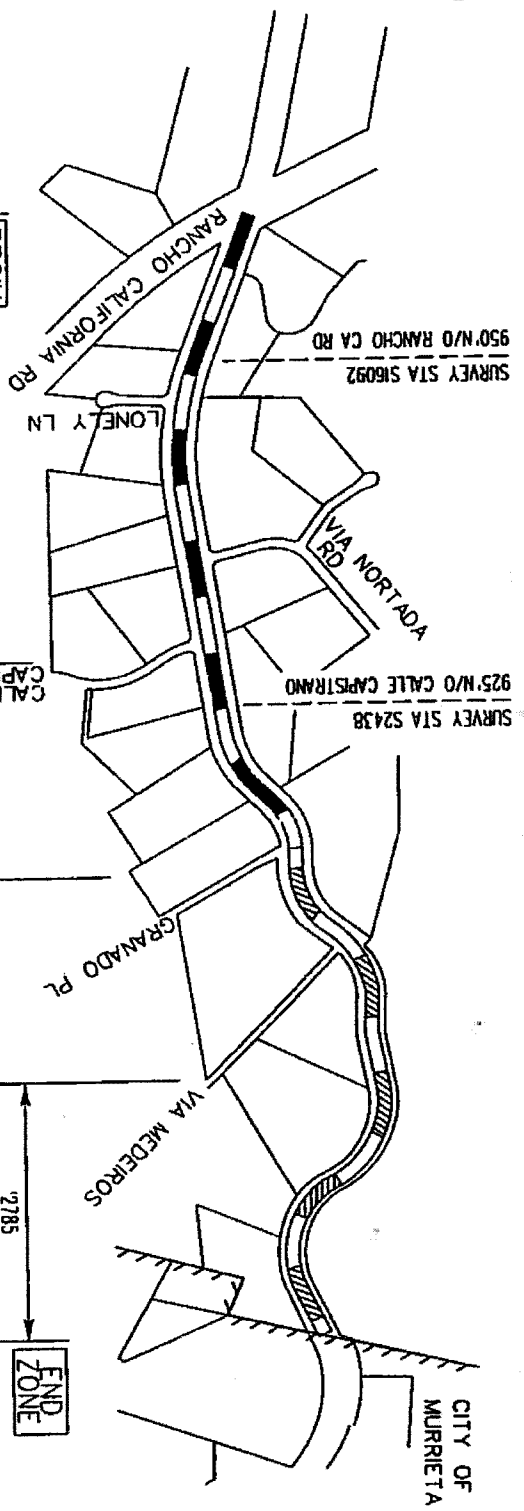

| | | | | |
|---------------------------|--------------------------------------|--------------|---|--------------|
| * 20 MPH PER CVC 22365 | | | | |
| RECOMMENDED SPEED LIMIT | 40 MPH | 25 MPH | COUNTY MAINTAINED DIRT ROAD | * 20 MPH |
| 85th/116 SPEED | 44 MPH | 32 MPH | NARROW PAVEMENT WINDING ROAD REDUCE TO 25 MPH | N/A |
| VEHICLES IN 24 HR (2 WAY) | 366 | 470 | | 470 |
| SEGMENT LENGTH | 0.54 MILE | 0.28 MILE | | 0.94 MILE |
| ALL ACCIDENTS IN 2 YRS. | 0 | 0 | | 0 |
| ACCIDENT RATE ☆ | 0.00 ACC/MVM | 0.00 ACC/MVM | | 0.00 ACC/MVM |
| EXISTING SPEED LIMIT | * 20 MPH (Ord 452.240 Sec 3.5 No. 1) | | | |

☆ RATE. NO. OF ACCIDENT x 1000 000
VEH x 365 x 2 x MILE

| | | | | | | |
|----------------------|----------|--------------|--------------|--------------|--------------------------|--|
| COUNTY AREA: | TEMECULA | SURVEY DATE: | AUG 23, 2016 | APPROVED BY: | <i>Lawrence T. Talpe</i> | COUNTY OF RIVERSIDE TRANSPORTATION DEPARTMENT TRAFFIC ENGINEERING DIVISION |
| COUNTY MAP: | 82, 84A | MAP DATE: | SEP 15, 2016 | DATE: | 12/5/2016 | ENGINEERING AND TRAFFIC SURVEY AT DE LUZ ROAD |
| SUPERVISOR DISTRICT: | 1/1 | DRAWN BY: | J VALADEZ | CAD FILE: | DE LUZ RD.DGN | PAGE 1 OF 1 |



THIRTEENTH STREET (#1604)

- LEGEND:
- ////// CITY LIMITS
 - ▨▨▨▨ RADAR ZONE
 - - - - SURVEY STATION
 - ===== OTHER STREET OR ROAD



NO SCALE

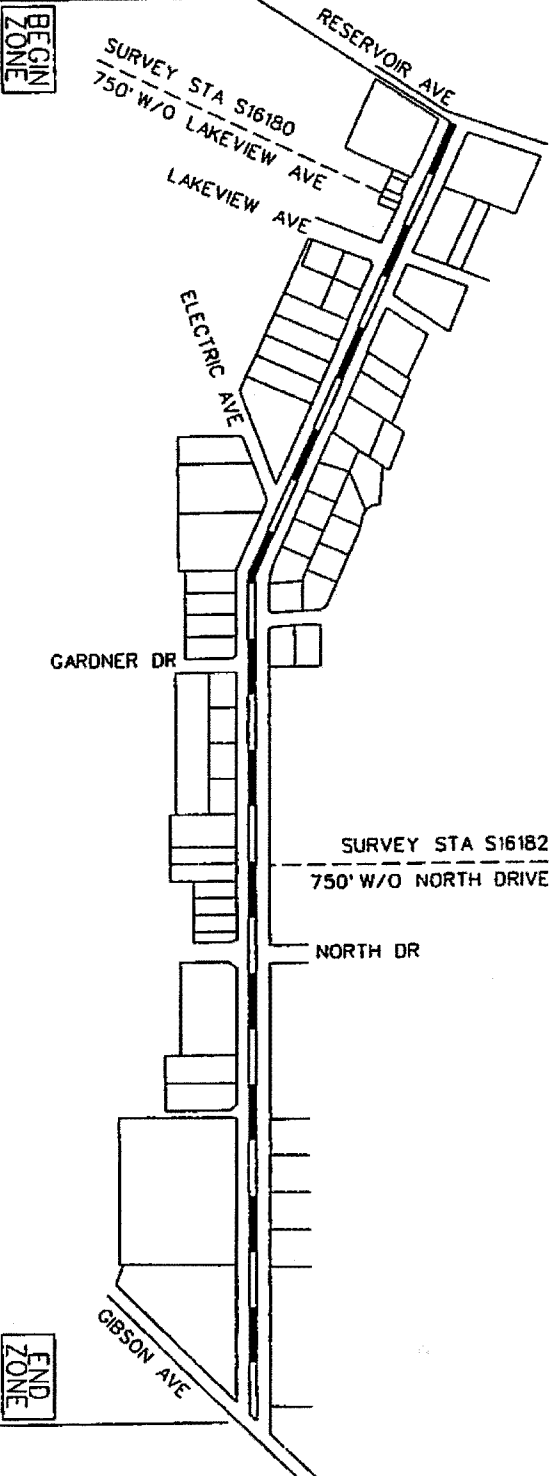

| | |
|---------------------------|---|
| RECOMMENDED SPEED LIMIT | 35 MPH |
| 85th/THILE SPEED | 39 MPH (AVERAGE OF TWO SIMILAR SEGMENTS OF 39 & 39 MPH) |
| VEHICLES IN 24 HR (2 WAY) | 310 |
| SEGMENT LENGTH | 1.24 MILE |
| ALL ACCIDENTS IN 2 YRS. | 1 |
| ACCIDENT RATE ★ | 3.56 ACC/MVM |
| EXISTING SPEED LIMIT | NOT POSTED |

★ RATE: $\frac{\text{NO. OF ACCIDENT} \times 1000}{\text{VEH} \times 365 \times 2 \times \text{MILE}}$

| | | | |
|--|----------|-----------------------|-------------------------|
| COUNTY AREA: | NUEVO | SURVEY DATE: | OCT 18, 2016 |
| COUNTY MAP: | 99A, 99B | MAP DATE: | OCT 20, 2016 |
| SUPERVISOR DISTRICT: | 5/5 | DRAWN BY: | J VALADEZ |
| | | CAD FILE: | THIRTEENTH ST.DGN |
| | | APPROVED BY: | <i>[Signature]</i> |
| | | DATE: | 11/15/2016 |
| | | LAWRENCE T. TAL, P.E. | COUNTY TRAFFIC ENGINEER |
| COUNTY OF RIVERSIDE TRANSPORTATION DEPARTMENT TRAFFIC ENGINEERING DIVISION | | | |
| ENGINEERING AND TRAFFIC SURVEY AT THIRTEENTH STREET | | | |
| | | | PAGE 1 OF 1 |



LEGEND:

- ////// CITY LIMITS
- ▬ RADAR ZONE
- - - SURVEY STATION
- ▬ OTHER STREET OR ROAD

CARROLL STREET

(# 1600)

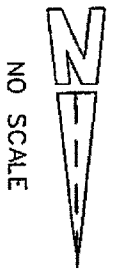
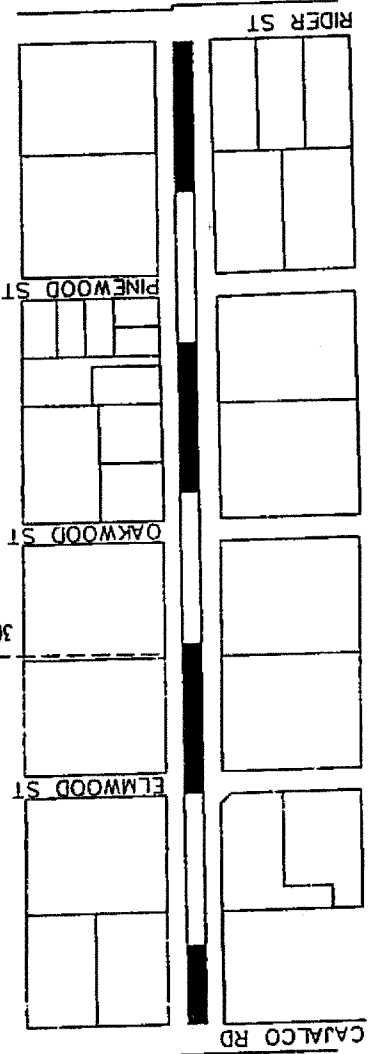

NO SCALE

BEGIN ZONE

END ZONE





| | |
|---------------------------|--------------|
| RECOMMENDED SPEED LIMIT | 45 MPH |
| 85th/71st SPEED | 48 MPH |
| VEHICLES IN 24 HR (2 WAY) | 2675 |
| SEGMENT LENGTH | 0.50 MILE |
| ALL ACCIDENTS IN 2 YRS. | 3 |
| ACCIDENT RATE ☆ | 3.07 ACC/MVM |
| EXISTING SPEED LIMIT | NOT POSTED |

☆ RATE: $\frac{\text{NO. OF ACCIDENT} \times 1,000,000}{\text{VEH} \times 365 \times 2 \times \text{MILE}}$

| | |
|--|--|
| COUNTY AREA: MEAD VALLEY | SURVEY DATE: AUG 16, 2016 |
| COUNTY MAP: 58B | MAP DATE: SEP 15, 2016 |
| SUPERVISOR DISTRICT: 1/1 | DRAWN BY: J VALADEZ |
| | DATE: 11/15/2016 |
| | CAD FILE: CARROLL ST.DGN |
| | APPROVED BY: <i>[Signature]</i> |
| | LAWRENCE T. TAI, P.E. COUNTY TRAFFIC ENGINEER |
| COUNTY OF RIVERSIDE TRANSPORTATION DEPARTMENT TRAFFIC ENGINEERING DIVISION | |
| ENGINEERING AND TRAFFIC SURVEY AT CARROLL STREET | |
| PAGE | 1 OF 1 |

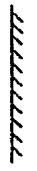

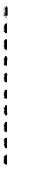
TRILOGY PARKWAY (#1419)

- LEGEND:**
-  CITY LIMITS
 -  RADAR ZONE
 -  SURVEY STATION
 -  OTHER STREET OR ROAD

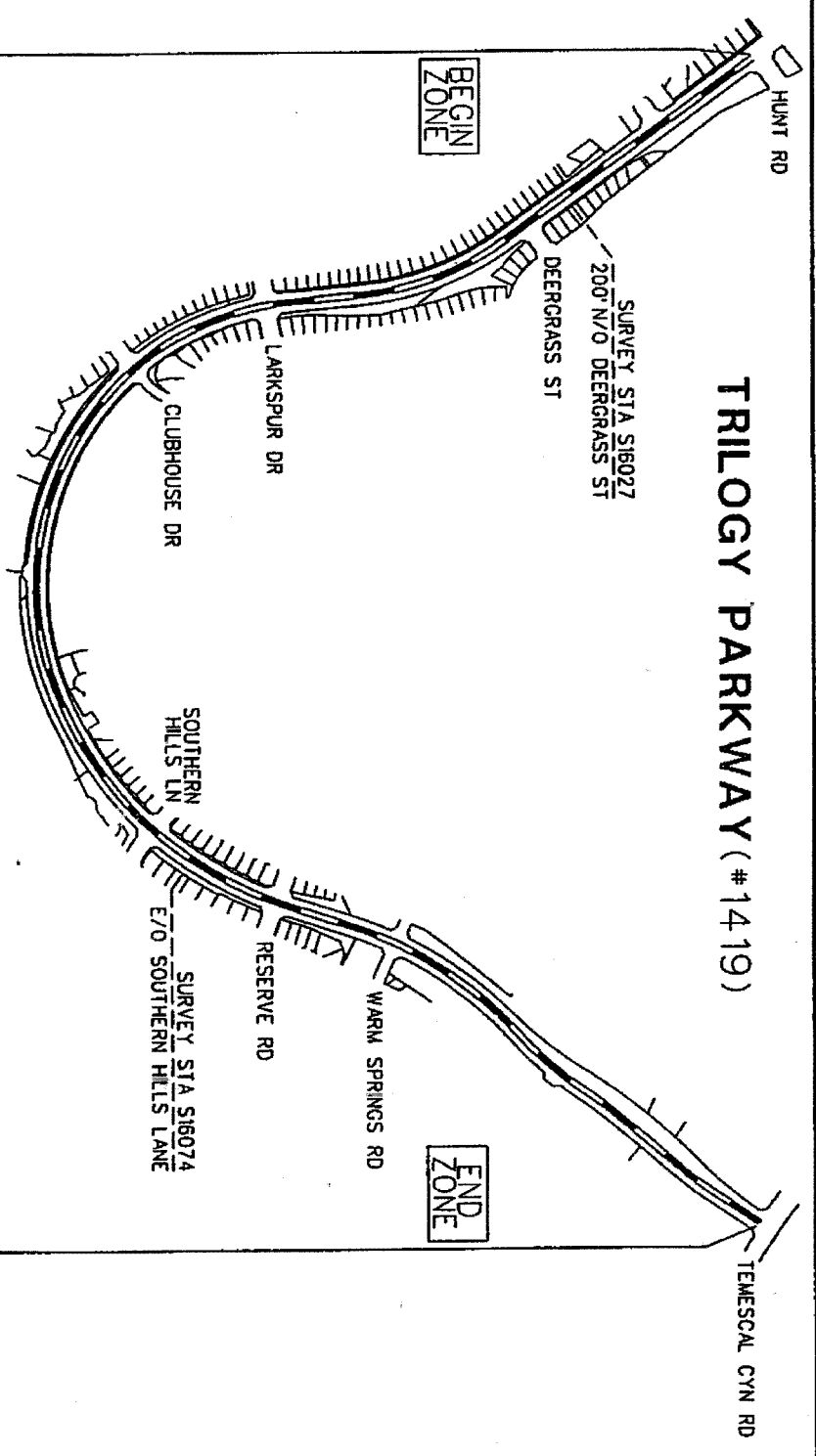

VERTICAL & HORIZONTAL CURVES, SENIOR COMMUNITY, REDUCE SPEED LIMIT TO 45 MPH

| | |
|---------------------------|---|
| RECOMMENDED SPEED LIMIT | 45 MPH |
| PREVAILING SPEED (85%) | 52 MPH (AVERAGE OF TWO SIMILAR SEGMENTS OF 51 & 53 MPH) |
| VEHICLES IN 24 HR (2 WAY) | 2260 |
| SEGMENT LENGTH | 1.84 MILE |
| ALL ACCIDENTS IN 2 YRS. | 2 |
| ACCIDENT RATE ☆ | 0.66 ACC/MVM |
| EXISTING SPEED LIMIT | 45 MPH |

☆ RATE - ACCIDENT x 1000 000
VEH x 365 x 2 x MILE

| | | | | | | | |
|----------------------|----------|--------------|--------------|--|------------------------|---|---|
| COUNTY AREA: | CORONA | SURVEY DATE: | 07/27/2016 | APPROVED BY: | <i>Lawrence T. Tai</i> | COUNTY OF RIVERSIDE TRANSPORTATION DEPARTMENT TRAFFIC ENGINEERING SECTION |  |
| COUNTY MAP PAGE: | 33D, 33F | MAP DATE: | 10/24/2016 | DATE: | 12/5/2016 | ENGINEERING AND TRAFFIC SURVEY AT TRILOGY PKY | |
| SUPERVISOR DISTRICT: | 1/1 | CAD FILE: | TRIOLOGY.DGN | LAWRENCE T. TAI, P.E. COUNTY TRAFFIC ENGINEER | | PAGE 1 OF 1 | |

LEGEND:

- CITY LIMITS
- ▨ RADAR ZONE
- SURVEY STATION
- ===== OTHER STREET OR ROAD

DE PORTOLA ROAD

(#1602)

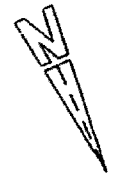
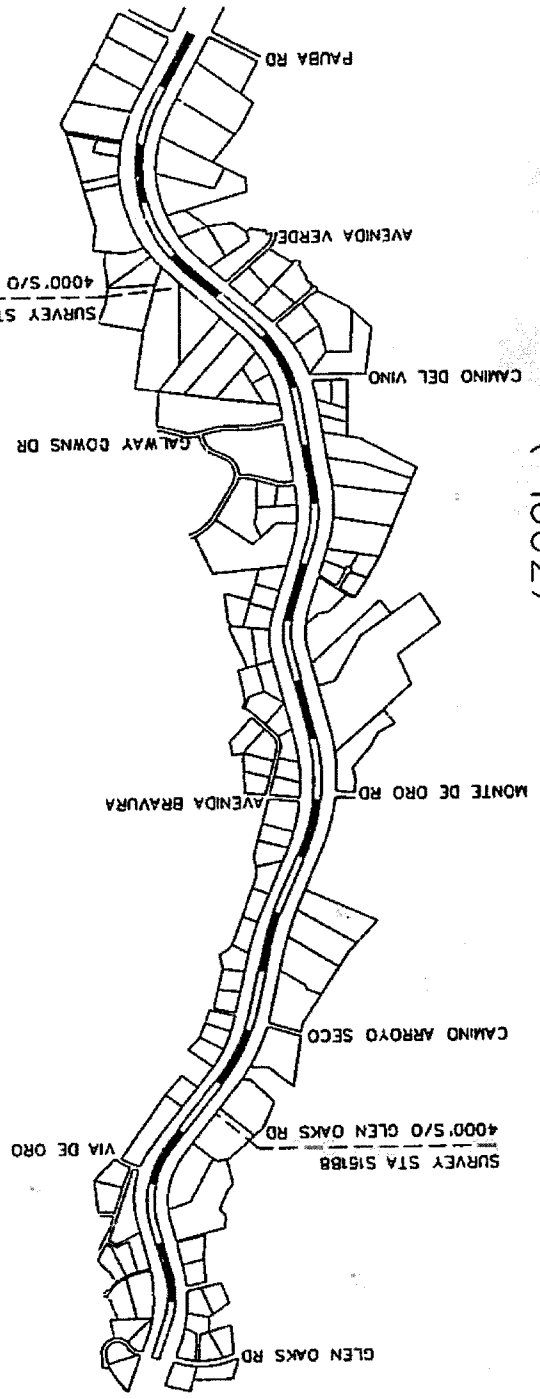

NO SCALE

• 55 MPH PER CVC 22349

| | |
|---------------------------|---|
| RECOMMENDED SPEED LIMIT | 50 MPH |
| 85in/TILE SPEED | 57.4 MPH (AVERAGE OF TWO SIMILAR SEGMENTS OF 57.8 & 57.0 MPH) |
| VEHICLES IN 24 HR (2 WAY) | 5500 |
| SEGMENT LENGTH | 4.18 MILE |
| ALL ACCIDENTS IN 2 YRS. | 13 |
| ACCIDENT RATE ☆ | 0.77 ACC/MVM |
| EXISTING SPEED LIMIT | 55 MPH* |

NARROW RURAL ROADWAY - HIDDEN DRIVEWAYS - MULTIPLE TURNING MOVEMENTS
DIRT SHOULDERS - NO SIDEWALKS - REDUCE TO 50 MPH.

BEGIN ZONE

END ZONE

☆ RATE: $\frac{\text{NO. OF ACCIDENT} \times 1,000,000}{\text{VEH} \times 365 \times 2 \times \text{MILE}}$

| | | | | | | |
|----------------------|----------|-------------|-------------------|-----------------------|-------------------------|--|
| COUNTY AREA: | TEMECULA | STUDY DATE: | OCT 11, 2016 | APPROVED BY: | <i>Lawrence T. Tai</i> | COUNTY OF RIVERSIDE TRANSPORTATION DEPARTMENT TRAFFIC ENGINEERING DIVISION |
| COUNTY MAP: | 130, 136 | MAP DATE: | OCT 17, 2016 | DATE: | 11/15/2016 | |
| SUPERVISOR DISTRICT: | 3/3 | DRAWN BY: | J VALADEZ | LAWRENCE T. TAI, P.E. | COUNTY TRAFFIC ENGINEER | ENGINEERING AND TRAFFIC SURVEY AT DE PORTOLA ROAD |
| | | CAD FILE: | DE PORTOLA RD.DGN | | | PAGE 1 OF 1 |

