

**SUBMITTAL TO THE BOARD OF SUPERVISORS
COUNTY OF RIVERSIDE, STATE OF CALIFORNIA**



ITEM
3.11
(ID # 2798)

MEETING DATE:
Tuesday, January 24, 2017

FROM : TLMA-TRANSPORTATION:

SUBJECT: TLMA-TRANSPORTATION: Approval of Amendment No. 6 in the amount of \$266,690 to the Engineering Services Agreement between the County of Riverside and CH2MHILL, Inc., for the Clinton Keith Road - Interstate 215 to State Route 79 Extension Project. 3rd District; [\$4,819,695 - Total Cost]; Local Funds 100%

RECOMMENDED MOTION: That the Board of Supervisors:

1. Approve Amendment No. 6 to the Engineering Services Agreement No. 02-02-005 between the County of Riverside (County) and CH2MHILL, Inc., for the Clinton Keith Road - Interstate 215 (I-215) to State Route 79 (SR-79) Extension Project; and
2. Authorize the Chairman of the Board to execute the same.

ACTION: Policy

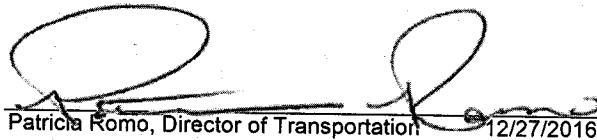
Patricia Romo, Director of Transportation 12/27/2016

FINANCIAL DATA	Current Fiscal Year:	Next Fiscal Year:	Total Cost:	Ongoing Cost
COST	\$ 213,141	\$ 53,549	\$ 4,819,695	\$ 0
NET COUNTY COST	\$ 0	\$ 0	\$ 0	\$ 0
SOURCE OF FUNDS: Clinton Keith Community Facility District 07-2 (100%). No General Funds are used on this project.			Budget Adjustment: No	
			For Fiscal Year: 16/17	

C.E.O. RECOMMENDATION: Approve

MINUTES OF THE BOARD OF SUPERVISORS

On motion of Supervisor Ashley, seconded by Supervisor Jeffries and duly carried, IT WAS ORDERED that the above matter is approved as recommended.

Ayes: Jeffries, Washington and Ashley
Nays: None
Absent: Tavaglione
Date: January 24, 2017
xc: Transp.

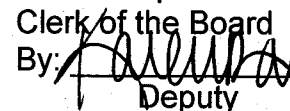
Kecia Harper-Ihem
Clerk of the Board
By: 
Deputy

**SUBMITTAL TO THE BOARD OF SUPERVISORS COUNTY OF RIVERSIDE,
STATE OF CALIFORNIA**

BACKGROUND:

Summary

On March 5, 2002 (Agenda Item 3-41), the Board of Supervisors approved the Engineering Services Agreement between the County and CH2M HILL, Inc. for the preparation of Plans, Specifications and Estimates for the Clinton Keith Road Extension Project between Antelope Road and SR-79.

The Board of Supervisors approved Amendment No. 1, on November 2, 2004 (Agenda Item 3-30), and Amendment No. 2, on December 19, 2006 (Agenda Item 3-46), to the original agreement to modify the scope to incorporate additional environmental tasks and provide final engineering design services. On November 2, 2010 (Agenda Item 3-51), the Board of Supervisors approved Amendment No. 3 to the Agreement which extended the termination date to June 30, 2014, to continue design activities, support right-of-way acquisition, and develop construction strategies. Amendment No. 4 to the Agreement was approved by the Board of Supervisors on December 4, 2012 (Agenda Item 3-30), to modify the scope to include revisions to the environmental documents and design plans for the next phase of work. On January 6, 2015 (Agenda Item 3-41), the Board of Supervisors approved Amendment No. 5 to the Agreement to modify the scope of services to include updating technical studies and permit applications for newly created and identified environmental resources, and to include the scope services for an alternate bid for constructing a four lane facility, including additional environmental and design document updates.

The construction of the Clinton Keith Road Extension Project is being constructed in phases as funding becomes available. Phase 1 construction was completed by the City of Murrieta in 2012 and widened Clinton Keith Road, from Antelope Road to Whitewood Road, to the ultimate six (6) lane road width. Phase 2, from Whitewood Road to Trois Valley Street, is currently under construction and includes the construction of four (4) lanes, two (2) in each direction, a sidewalk on the south side of the roadway, and new traffic signals at Trois Valley Street and at Menifee Road. The County received \$16.5 million in Measure A Regional Arterial (MARA) Funds for Phase 2 construction. Phase 3 is to improve Clinton Keith Road from Leon road to SR-79 and it includes a bridge over French Valley Creek. Phase 3 will follow Phase 4 as funding becomes available. Due to favorable bids for Phase 2 construction, the County desires to use the cost savings in MARA funds to construct Phase 4 of the project. Phase 4 completes the ultimate six (6) lane facility from Whitewood Road to Trois Valley Street, which includes the final two travel lanes, sidewalk on the north side, drainage modifications and a raised median. The Riverside County Transportation Commission (RCTC) funding agreement, "Amendment No. 1 to the Agreement for Funding of Measure A Regional Arterial Improvements with the County", was approved by the Board of Supervisors on November 15, 2016 (Agenda Item 3.30). The amendment was signed by the RCTC Director on December 7, 2016. This amendment allows the County to utilize \$2.7 Million of the cost saving from the Phase 2 Project for Phase 4.

Amendment No. 6 will modify the contract scope to include the additional design and construction support services for Phase 4 of the Clinton Keith Road Extension Project as described below:

**SUBMITTAL TO THE BOARD OF SUPERVISORS COUNTY OF RIVERSIDE,
STATE OF CALIFORNIA**

- Increase the scope of services to include preparation of Plans, Specifications and Estimates for the roadway, sidewalk, raised median, drainage facilities and traffic signal modifications for the additional 2 lanes to complete the ultimate 6 lane facility.
- Increase the scope of services to provide support service during bidding and award of the construction contract, and to provide support services during the construction of Phase 4 improvements.
- Extend the term of the agreement to December 30, 2019.

The cost of Amendment No. 6 is \$266,690, including a 10% contingency. Below is the budget summary including Amendment No. 6:

Current Contract	\$4,553,005
Amendment No. 6	<u>\$ 266,690</u>
Total contract	\$4,819,695

County Counsel has approved the Amendment as to form.

Impact on Residents and Businesses

The Clinton Keith Road Extension Project will benefit the public by providing an alternative arterial road between SR-79 and I-215 in the French Valley/Murrieta area. The road will provide for reduced travel times and congestion relief along the existing roadways.

Additional Fiscal Information

The County of Riverside Transportation Department (Transportation Department) was successful in competing for funding in response to the Riverside County Transportation Commission (RCTC) 2013 Call for Projects and the Clinton Keith Road Extension Project received \$16.5 million in funding. The County received favorable bids for Phase 2, which resulted in \$2,931,047 in savings of MARA funds. RCTC has agreed to allocate \$2,717,000 of the savings to Phase 4 construction of the Clinton Keith Road Extension Project. This project has been environmentally cleared based on the California Environmental Quality Act (CEQA) criteria and is eligible for local funding only, including MARA funds. No County funds will be used on this project.

ATTACHMENTS

Vicinity Map
Amendment No. 6

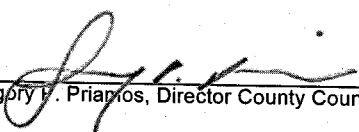

Gregory F. Priamos, Director County Counsel 1/9/2017

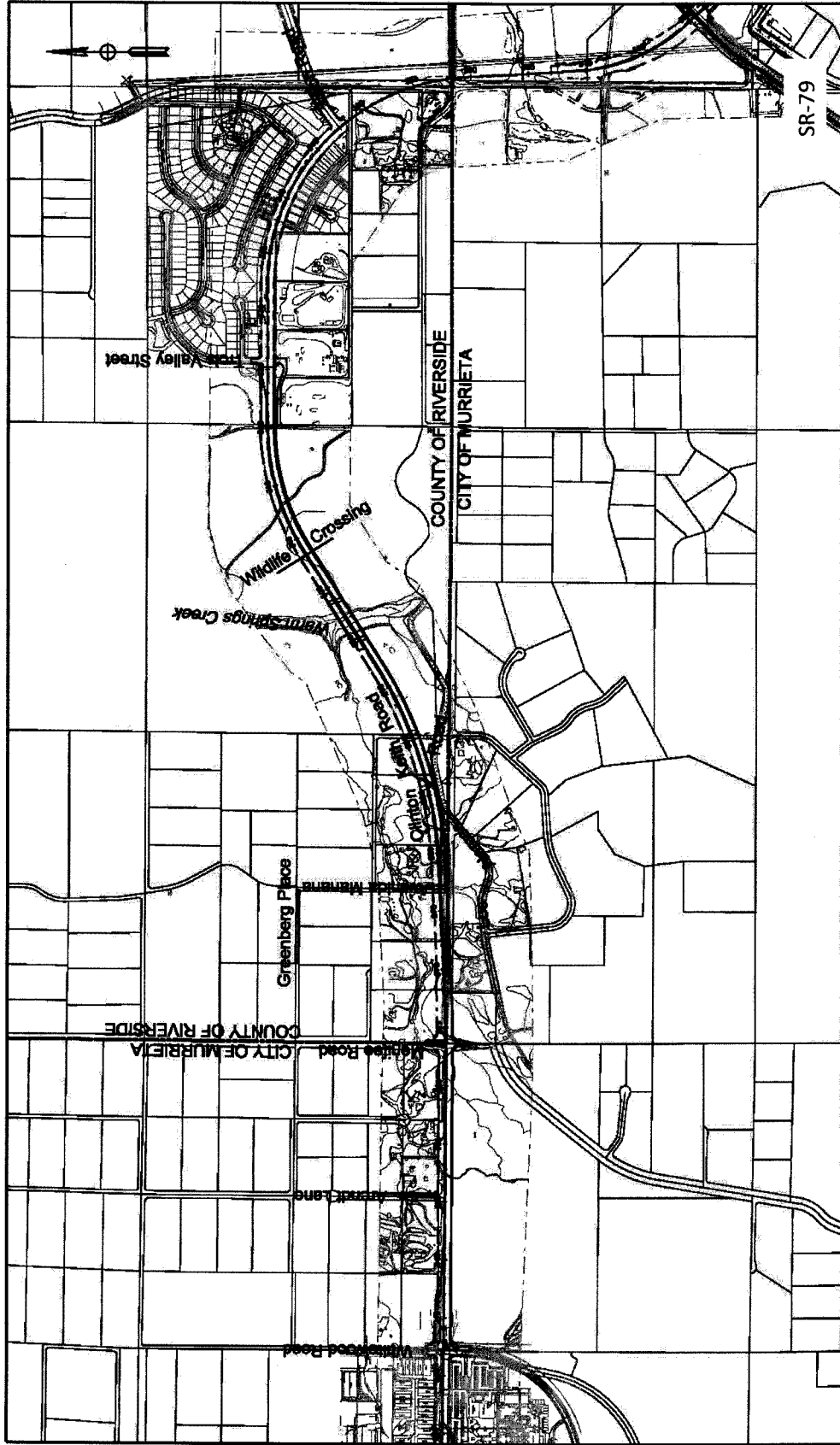

LEGEND

----- City of Murrieta/County of Riverside Boundary

Clinton Keith Road Vicinity Map

AMENDMENT NO 6

AMENDMENT TO AGREEMENT BETWEEN

THE COUNTY OF RIVERSIDE AND CH2M HILL INC.

FOR ENGINEERING SERVICES ON THE CLINTON KEITH ROAD – I-215 TO SR-79 PROJECT

THIS AMENDMENT 6 (hereinafter the "Amendment") to an agreement is made and entered into as of this 24th day of January, 2016, by and between the County of Riverside, a political subdivision of the State of California (hereinafter the "COUNTY"), and CH2M Hill Inc. (hereinafter "ENGINEER").

RECITALS

- A. COUNTY and ENGINEER have entered in an agreement entitled " Engineering Services Agreement for the Clinton Keith Road – I-215 to SR-79 project between the County of Riverside • Transportation Department and CH2M Hill Inc.," that is dated March 5, 2002 and amended on November 2, 2004, December 19, 2006, November 2, 2010, December 4, 2012, and January 6, 2015 (hereinafter the "Agreement"). The Agreement provides the terms and conditions, scope of work, schedule and budget for the performance of professional and technical services necessary to prepare an environmental document, project report, plans, specifications and estimates.
- B. On November 10, 2015 the Board of Supervisors awarded a construction contract to Sukut Construction for the Clinton Keith Road Phase 2 improvements for the construction of a four lane roadway segment from Whitewood Road to Trois Valley Street. The County received favorable bids for Phase 2 and would now want to use a portion of the costs savings for construction of Phase 4 of the Clinton Keith Road Project. Phase 4 completes the ultimate six lane facility from Whitewood Road to Trois Valley Street which includes the final two travel lanes, sidewalk on the north side, drainage modifications and a raised median.
- C. The parties now desire to supplement the Agreement to include consultant services for completing Phase 4 of the project.

AGREEMENT

NOW, THEREFORE, in consideration of the mutual covenants hereinafter contained, the parties agree as follows:

- 1. To amend the scope of the Agreement to include the additional Administration, Design, Bid Support and Construction Support for Phase 4 of the project.
- 2. The current contract budget of \$4,551,539.00 shall be increased by \$266,690.00 including contingencies

1 to \$4,818,229.00 for: additional Phase 2 Plans, Specifications and Estimates work effort; additional
2 Phase 3 Bid Support; and Phase 4 Construction Support; all as detailed in Attachment "A" to this
3 Amendment, consisting of twelve (12) pages attached and incorporated by this reference.

4 3. Appendix "B", Article B is amended to extend the term of the agreement from June 30, 2016 to December
5 30, 2019.

6 4. Except to the extent specifically modified or amended hereunder, all of the terms, covenants and
7 conditions of the Agreement as approved on dated March 5, 2002 and amended on November 2, 2004,
8 December 19, 2006, November 2, 2010, December 4, 2012, and January 6, 2015 shall remain in full
9 force and effect between the parties hereto.

10 IN WITNESS HEREOF, the parties hereto have caused this Amendment to the Agreement to be duly executed
11 this day and year first written above.

ARTICLE VII • APPROVALS

COUNTY Approvals

RECOMMENDED FOR APPROVAL:

 Dated: 12-23-16

PATRICIA ROMO

Director of Transportation

APPROVED AS TO FORM:

GREGORY P. PRIAMOS, County Counsel

 Dated: 1/6/17

By Marsha L. Victor, Chief Deputy

APPROVAL BY THE BOARD OF SUPERVISORS

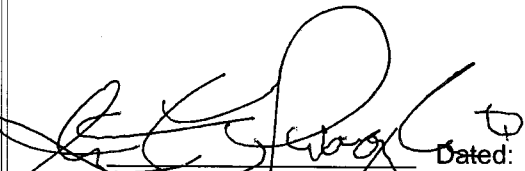
 Dated: JAN 24 2017

JOHN TAVAGLIONE

PRINTED NAME

Chairman, Riverside County Board of Supervisors

ATTEST:

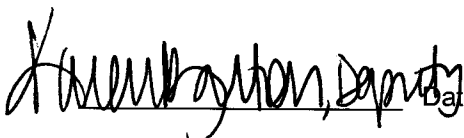
 Dated: JAN 24 2017

KECIA HARPER-IHEM

Clerk to the Board of Supervisors (SEAL)

ENGINEER Approvals

ENGINEER:

 Dated: 11/3/16

THOMAS IONTA

PRINTED NAME

Vice President

TITLE

ENGINEER:

_____ Dated: _____

PRINTED NAME

TITLE

Clinton Keith Road Extension Project

Amendment No. 6

Additional Scope of Work

October 25, 2016

Introduction

This Amendment No. 6 is submitted to cover out of scope work tasks and to be able to continue design, bid and construction support for Phase 4 of the Clinton Keith Road Extension Project (Project) for the Riverside County Transportation Department (RCTD).

This Amendment is required in order to incorporate additions to the scope of work for the current CH2M HILL INC Engineering and Environmental Services Agreement.

The following describes the reasons why the additional compensation is necessary, and the additional scope of work for each task that is involved in this Amendment. The cost associated with each of these Tasks is attached.

PHASE 1 (PA&ED)

No additional work is anticipated for this Phase of Work.

PHASE 2 (PS&E)

Engineering and Management Tasks - \$188,896.09

A. (Task T2.10.PM) – Project Administration/Project Management - \$16,539.22

The scope of these tasks has been modified and the associated budget needs to be increased by a total of \$16,539.22 for the following reasons:

Additional Project Management and Administration efforts for the design, bid and construction support to build two additional inside lanes and the median improvements (Phase 4 PS&E) for the duration of the project between Whitewood Road and Trois Valley Street through December 2019.

B. (Tasks T2.10) – Roadway Design - \$172,356.87

The scope of this task has been modified and the associated budget needs to be increased by \$172,356.87 for the following reasons:

Additional work in support of new requests by the County to design the ultimate improvements of the project which includes new pavement to construct the inside lanes and center median, and to adjust the drainage facilities to work with these improvements. These improvements require the following additional work:

- Prepare a new set of Plans, Specifications and Estimates (PS&E) that incorporates design of the inside lane of the 6-lane urban arterial and median improvements to include curb and gutter from Whitewood Road to Trois Valley Street. Approximately 100 plan sheets will require modifications.
- Revise layout plans to include sidewalk along the north side of Clinton Keith Road and concrete barrier within the environmentally sensitive area.
- Include decomposed granite with decorative rock within the median area.
- Revise drainage plans, profiles, details and quantities for the additional lanes and median improvements to comply with the 6-lane facility.
- Modify the median to accommodate the 6-lane facility. A contract change order (CCO) will need to be negotiated with the current contractor so that materials are not ordered and paid for by RCTD during the construction of Phase 2 of the project.
- Grated line drains will need to be modified to tie-in to the Phase 2 construction work.
- The ultimate 6-lane drainage design will need to be implemented and coordinated with the 4-lane design.
- Update grading and erosion control plans in the median.
- Revise striping plans to include the inside lane adjacent to the median and to include changes at the intersections.
- Modifications to traffic signal design to accommodate the ultimate 6-lane design.
- Revise cost estimates for all roadway features, drainage revisions and striping revisions.
- Prepare Specifications for new PS&E package.

Submittals:

- Two submittal packages of Phase 4 will be provided. An initial 95% submittal that the County can review and provide comments on, and a final submittal that the County can put out for bids.

Addendum Assumptions:

- No additional submittals will be made unless additional review(s) are required due to substandard quality of the deliverables.
- An updated Drainage Report, Geotechnical Report and WQMP is not included in this Amendment. It is assumed that the reports completed for the Clinton Keith Road project are sufficient.

PHASE 3 (Bid Support)

C. (Task T3) – Bid Support - \$14,112.40

The scope of this task has been modified and the associated budget needs to be increased by a total of \$14,112.40 for the following reasons:

RCTD's decision to revise the project to include the ultimate improvements of the 6-lane facility from Whitewood Road to Trois Valley Street creates additional Bid Support efforts to cover the duration of the bid support tasks for this bid package through December 2019.

This task includes up to 100 hours to provide clarification and design support to the contractors. For any additional out of scope work beyond this, another amendment will need to be prepared and approved by RCTD.

PHASE 4 (Construction Support)

D. (Task T4) – Construction Support - \$39,436.81

The scope of this task has been modified and the associated budget needs to be increased by a total of \$39,436.81 for the following reasons:

RCTD's decision to revise the project to include the ultimate improvements of the 6-lane facility from Whitewood Rd to Trois Valley Street creates additional Construction Support efforts to cover the duration of this task through December 2019. This task includes up to 5 hours per week for a duration of 8 months, 32 hours to attend meetings and project field visits, and 80 hours to prepare as-builts and close out the project. For any additional out of scope work beyond this, another amendment will need to be prepared and approved by RCTD.



CH2MHILL

COST PROPOSAL

Contract No. 02-02-005A2

Environmental and Design Support of the Clinton Keith Road Extension Project

AMENDMENT NO. 6 Ultimate 6-lane PS&E

Task Summary

25-Oct-16

Amendment No. 6 Task Number	Task Description	Fee
A	Engineering and Management Tasks	\$16,539.22
B	Roadway Design	\$172,356.87
	Total Phase 2	\$188,896.09
C	Bid Support	\$14,112.40
	Total Phase 3	\$14,112.40
D	Construction Support	\$39,436.81
	Total Phase 4	\$39,436.81
	Total Phases 2, 3 and 4	\$242,445.30
	Contingency @ 10%	\$24,244.53
	Total Amendment No. 6	\$266,689.83

COMPANY: CH2M HILL	SCOPE OF WORK Final PS&E	DATE: 9/30/2016	REV:
PROJECT: Clinton Keith Road		MILESTONE/PHASE: Final Design	

DIRECT LABOR

CLASSIFICATION	HOURS		RATE	AMOUNT
Project Manager	299	@	\$72.45	\$21,662.55
Env. Task Leader	0		\$0.00	
Roadway QA/QC	84	@	\$76.37	\$6,415.08
Senior Drainage Engineer	120	@	\$78.43	\$9,411.60
Drainage Engineer	180	@	\$37.44	\$6,739.20
Senior Structural Engineer	0		\$0.00	
Structural Engineer	0		\$0.00	
Senior Roadway Engineer	500	@	\$59.30	\$29,650.00
Roadway Engineer	240	@	\$28.85	\$6,924.00
Planner	0		\$0.00	
Assoc Planner	0		\$0.00	
CADD	400	@	\$39.54	\$15,816.00
Technical Editor	0		\$0.00	
Contracts	12	@	\$73.58	\$882.96
Clerical	42	@	\$32.63	\$1,370.46
TOTAL HOURS			1,877	
			TOTAL DIRECT LABOR	\$98,871.85

MULTIPLIERS

TR ESCALATION @	2.67%	(Rate)	\$2,642.88
SP ESCALATION @	2.67%	(Rate)	\$173.37
TR OVERHEAD @	102.467%	(of Total Direct Labor + Escalation)	\$95,136.75
SP OVERHEAD @	85.467%	(of Total Direct Labor + Escalation)	\$7,556.88
TOTAL MULTIPLIERS			\$105,509.88

OTHER DIRE* Billed at Actual Cost *****

ITEM	QUANTITY	UNIT		UNIT COST	AMOUNT
Outside Repro Services	620	LS	@	\$1.00	\$620.00
Postage & Freight	8	ea	@	\$10.00	\$80.00
Mileage	800	miles	@	\$0.540	\$432.00
TOTAL OTHER DIRECT EXPENSES					\$1,132.00

OUTSIDE SERVICES (w/o fee)

COMPANY	LABOR	MULTIPLIER	EXPENSES	TOTAL
FPL & Associates				\$16,170.00
TOTAL OUTSIDE SERVICES				\$16,170.00

FEES

OUTSIDE SERVICES ADMIN FEE @	2.00% (of Total Outside Services)	\$323.40
CH2M HILL @	10.00% (of Total Direct Labor + Total Multipliers)	\$20,438.17
TOTAL FEES		\$20,761.57
TOTAL COST		\$242,445.30

COMPANY: CH2M HILL	SCOPE OF WORK Engineering & Management Tasks	DATE: 9/30/2016	REV:
PROJECT: Clinton Keith Road		MILESTONE/PHASE: Phase 1 Project Administration/Project Management	

DIRECT LABOR

CLASSIFICATION		HOURS		RATE	AMOUNT
TR	Project Manager	72	@	\$72.45	\$5,216.40
	Env. Task Leader	0		\$0.00	
	Roadway QA/QC	0		\$76.37	
	Senior Drainage Engineer	0		\$78.43	
	Drainage Engineer	0		\$37.44	
	Senior Structural Engineer	0		\$0.00	
	Structural Engineer	0		\$0.00	
	Senior Roadway Engineer	0		\$59.30	
	Roadway Engineer	0		\$28.85	
	Planner	0		\$0.00	
	Assoc Planner	0		\$0.00	
	CADD	0		\$39.54	
	Technical Editor	0		\$0.00	
SP	Contracts	12	@	\$73.58	\$882.96
SP	Clerical	42	@	\$32.63	\$1,370.46
TOTAL HOURS		126			
				TOTAL DIRECT LABOR	\$7,469.82

MULTIPLIERS

TR ESCALATION @	2.00%	(Rate)	\$104.33
SP ESCALATION @	2.00%	(Rate)	\$45.07
TR OVERHEAD @	102.467%	(of Total Direct Labor + Escalation)	\$5,451.99
SP OVERHEAD @	85.467%	(of Total Direct Labor + Escalation)	\$1,964.45
TOTAL MULTIPLIERS			\$7,565.84

OTHER DIRECT CH2M HILL

ITEM	QUANTITY	UNIT	UNIT COST	AMOUNT
				TOTAL OTHER DIRECT EXPENSES
				\$0.00

OUTSIDE SERVICES (w/o fee)

COMPANY	LABOR	MULTIPLIER	EXPENSES	TOTAL
				TOTAL OUTSIDE SERVICES
				\$0.00

FEEES

OUTSIDE SERVICES ADMIN FEE @	2.00%	(of Total Outside Services)	\$0.00
CH2M HILL @	10.00%	(of Total Direct Labor + Total Multipliers)	\$1,503.57
TOTAL FEES			\$1,503.57
TOTAL COST			\$16,539.22

COMPANY: CH2M HILL	SCOPE OF WORK Final PS&E	DATE: 9/30/2016	REV:
PROJECT: Clinton Keith Road		MILESTONE/PHASE: Phase 2 Roadway Design	

DIRECT LABOR

	CLASSIFICATION	HOURS		RATE	AMOUNT
TR	Project Manager	120	@	\$72.45	\$8,694.00
	Env. Task Leader	0		\$0.00	
SP	Roadway QA/QC	84	@	\$76.37	\$6,415.08
TR	Senior Drainage Engineer	80	@	\$78.43	\$6,274.40
TR	Drainage Engineer	180	@	\$37.44	\$6,739.20
	Senior Structural Engineer	0		\$0.00	
	Structural Engineer	0		\$0.00	
TR	Senior Roadway Engineer	380	@	\$59.30	\$22,534.00
TR	Roadway Engineer	240	@	\$28.85	\$6,924.00
	Planner	0		\$0.00	
	Assoc Planner	0		\$0.00	
TR	CADD	280	@	\$39.54	\$11,071.20
	Technical Editor	0		\$0.00	
	Contracts	0		\$73.58	
	Clerical	0		\$32.63	
		TOTAL HOURS			
		1364		TOTAL DIRECT LABOR	\$68,651.88

MULTIPLIERS

TR ESCALATION @	2.00%	(Rate)	\$1,244.74
SP ESCALATION @	2.00%	(Rate)	\$128.30
TR OVERHEAD @	102.467%	(of Total Direct Labor + Escalation)	\$65,047.63
SP OVERHEAD @	85.467%	(of Total Direct Labor + Escalation)	\$5,592.43
			TOTAL MULTIPLIERS
			\$72,013.10

OTHER DIRECT CH2M HILL

ITEM	QUANTITY	UNIT		UNIT COST	AMOUNT
Outside Repro Services	620	LS	@	\$1.00	\$620.00
Postage & Freight	8	ea	@	\$10.00	\$80.00
Mileage	800	miles	@	\$0.540	\$432.00
					TOTAL OTHER DIRECT EXPENSES
					\$1,132.00

OUTSIDE SERVICES (w/o fee)

COMPANY	LABOR	MULTIPLIER	EXPENSES	TOTAL
FPL & Associates				\$16,170.00
				TOTAL OUTSIDE SERVICES
				\$16,170.00

FEES

OUTSIDE SERVICES ADMIN FEE @	2.00% (of Total Outside Services)	\$323.40
CH2M HILL @	10.00% (of Total Direct Labor + Total Multipliers)	\$14,066.50
		TOTAL FEES
		\$14,389.90
		TOTAL COST
		\$172,356.87

COMPANY: CH2M HILL	SCOPE OF WORK Phase 3 - Bid Support	DATE: 9/30/2016	REV:
PROJECT: Clinton Keith Road		MILESTONE/PHASE: Phase 3 Bid Support	

DIRECT LABOR

	CLASSIFICATION	HOURS		RATE	AMOUNT
TR	Project Manager	40	@	\$72.45	\$2,898.00
	Env. Task Leader	0		\$0.00	
	Senior Consultant	0		\$76.37	
	Senior Drainage Engineer	0		\$78.43	
	Drainage Engineer	0		\$37.44	
	Senior Structural Engineer	0		\$0.00	
	Structural Engineer	0		\$0.00	
TR	Senior Roadway Engineer	40	@	\$59.30	\$2,372.00
	Roadway Engineer	0		\$28.85	
	Planner	0		\$0.00	
	Assoc Planner	0		\$0.00	
TR	CADD	20	@	\$39.54	\$790.80
	Technical Editor	0		\$0.00	
	Contracts	0		\$73.58	
	Clerical	0		\$32.63	
TOTAL HOURS		100		TOTAL DIRECT LABOR	\$6,060.80

MULTIPLIERS

ESCALATION @	4.55%	(Rate)	\$275.77
TR OVERHEAD @	102.467%	(of Total Direct Labor + Escalation)	\$6,492.89
TOTAL MULTIPLIERS			\$6,768.66

OTHER DIRE CH2M HILL

ITEM	QUANTITY	UNIT	UNIT COST	AMOUNT
TOTAL OTHER DIRECT EXPENSES				\$0.00

OUTSIDE SERVICES (w/o fee)

COMPANY	LABOR	MULTIPLIER	EXPENSES	TOTAL
TOTAL OUTSIDE SERVICES				\$0.00

FEEES

OUTSIDE SERVICES ADMIN FEE @	2.00%	(of Total Outside Services)	\$0.00
CH2M HILL @	10.00%	(of Total Direct Labor + Total Multipliers)	\$1,282.95
TOTAL FEES			\$1,282.95
TOTAL COST			\$14,112.40

COMPANY: CH2M HILL	SCOPE OF WORK Phase 4 - Construction Support	DATE: 9/30/2016	REV:
PROJECT: Clinton Keith Road		MILESTONE/PHASE: Phase 4 Construction Support	

DIRECT LABOR

	CLASSIFICATION	HOURS		RATE	AMOUNT
TR	Project Manager	67	@	\$72.45	\$4,854.15
	Env. Task Leader	0		\$0.00	
	Senior Consultant	0		\$76.37	
TR	Senior Drainage Engineer	40	@	\$78.43	\$3,137.20
	Drainage Engineer	0		\$37.44	
	Senior Structural Engineer	0		\$0.00	
	Structural Engineer	0		\$0.00	
TR	Senior Roadway Engineer	80	@	\$59.30	\$4,744.00
	Roadway Engineer	0		\$28.85	
	Planner	0		\$0.00	
	Assoc Planner	0		\$0.00	
TR	CADD	100	@	\$39.54	\$3,954.00
	Technical Editor	0		\$0.00	
	Contracts	0		\$73.58	
	Clerical	0		\$32.63	
		TOTAL HOURS			
		287		TOTAL DIRECT LABOR	\$16,689.35

MULTIPLIERS

ESCALATION @	6.10%	(Rate)	\$1,018.05
TR OVERHEAD @	102.467%	(of Total Direct Labor + Escalation)	\$18,144.24
			TOTAL MULTIPLIERS
			\$19,162.29

OTHER DIRECT EXPENSES

ITEM	QUANTITY	UNIT	UNIT COST	AMOUNT
				TOTAL OTHER DIRECT EXPENSES
				\$0.00

OUTSIDE SERVICES (w/o fee)

COMPANY	LABOR	MULTIPLIER	EXPENSES	TOTAL
				TOTAL OUTSIDE SERVICES
				\$0.00

FEEES

OUTSIDE SERVICES ADMIN FEE @	2.00%	(of Total Outside Services)	\$0.00
CH2M HILL @	10.00%	(of Total Direct Labor + Total Multipliers)	\$3,585.16
			TOTAL FEES
			\$3,585.16
			TOTAL COST
			\$39,436.81

October 20, 2016

Job No.: 1089

CH2M

No. of Pages: 2

Attn: Ms. Alicia Cannon
1770 Iowa Avenue, Suite 200
Riverside, CA 92507

SUBJECT: PROPOSAL TO PREPARE TRAFFIC SIGNAL MODIFICATION PLANS AT:

- Clinton Keith Road & Trois Valley Street
- Clinton Keith Road & Menifee Road

Clinton Keith Road Improvements – Phase 4
County of Riverside, California

Dear Ms. Cannon:

FPL and Associates, Inc. (FPL) is pleased to submit for your consideration this fee proposal, per your e-mail request dated September 23, 2016, for the design of traffic signal modification plans at the above listed intersections in the County of Riverside.

The scope of this proposal is to provide new traffic signal modification design plans for the two subject intersections to accommodate 3 through lanes in each direction along Clinton Keith Road. It is assumed that the currently-designed traffic signal elements will be shown as an existing installed condition, with proposed modifications shown to accommodate the new 3-lane configuration.

Our scope is limited to the traffic signal plan revisions only. All submittals will be made to CH2M. We assume that CH2M will submit and process the plan through the County. FPL will revise plans based on review comments received from the County.

We assume revised plan geometric and striping base information will be provided to FPL by CH2M.

Our scope includes preparing the specifications and construction cost estimate for the traffic signal, two (2) submittals for agency review, and comment resolution with the agency.

Our scope includes attending two (2) meetings with the County.

We assume that the current signal design at the two subject locations will be constructed exactly per plan.

Construction support and as-built preparation is not included in our scope, but will be provided by CH2M.

Ms. Alicia Cannon
Page 2
October 10, 2016

Field verification of existing conditions is not included in our scope. It is assumed that the traffic signals will be built per the Phase 2 design unless field plans reveal otherwise.

We propose to provide the above-described scope of services for a lump-sum fee of \$16,170. The itemized fee summary is attached.

If you have any questions or need more information, please feel free to give me a call.

Sincerely,
FPL and Associates, Inc.



Alexander D. Zupanski, P.E., T.E.
Vice President – Traffic Design
alex.zupanski@fplandassociates.com

Attachments: Fee Schedule

FPL and Associates, Inc.

10 Corporate Park, Suite 310 • Irvine, California 92606 • (949) 252-1688 • Fax: (949) 252-0088

Client: County of Riverside

Date: 10/10/2016

Project: Clinton Keith Road Improvements - Phase 4

Prepare New Traffic Signal Modification Plans

Clinton Keith Road & Trois Valley Street; Clinton Keith Road & Menifee Road

Lump Sum

		Fully Burdened Rate (2016):				Hours per Task	Cost per Task
		\$195.00 Project Manager	\$175.00 Project Engineer	\$135.00 Associate Engineer	\$100.00 Assistant Design Engineer		
1.0	Meetings (2 total)	4	2			6	\$ 1,130
2.1	New Traffic Signal Modification Plan (Clinton Keith & Trois Valley)	6	6	8	16	36	\$ 4,900
2.2	New Traffic Signal Modification Plan (Clinton Keith & Menifee)	6	8	10	24	48	\$ 6,320
3.0	Specification	4	8			12	\$ 2,180
4.0	Engineer's Construction Cost Estimate	2		4	6	12	\$ 1,530
	ODCs (mileage and reprographics)						\$ 110
Total:		22	24	22	46	114	\$ 16,170

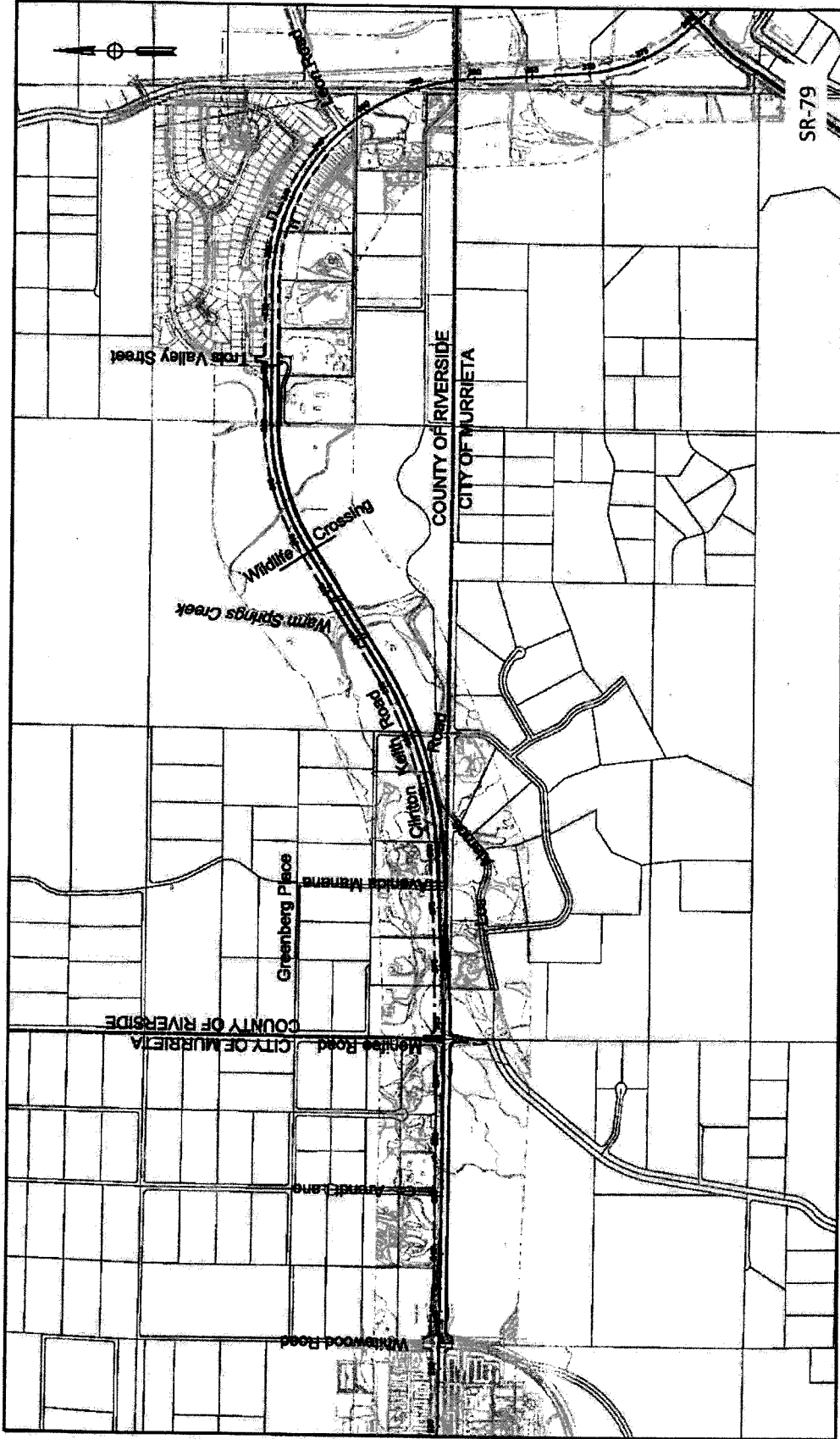

LEGEND

————— City of Murrieta/County of Riverside Boundary

Clinton Keith Road Vicinity Map