

**SUBMITTAL TO THE BOARD OF SUPERVISORS
COUNTY OF RIVERSIDE, STATE OF CALIFORNIA**



ITEM
3.37
(ID # 3503)

MEETING DATE:

Tuesday, February 7, 2017

FROM : TLMA-TRANSPORTATION:

SUBJECT: TLMA-TRANSPORTATION: Mead Valley Area and Temecula Area Force Account Construction Project. 1st and 3rd Districts; [\$343,600 - Total Cost; Local Funds 100%]

RECOMMENDED MOTION: That the Board of Supervisors:

1. Grant approval to the Director of Transportation, or designee, to conduct force account work in the Mead Valley area and Temecula area utilizing the County of Riverside Transportation Department (Transportation Department) day labor construction crews as set forth in Attachment A-1 hereto.

ACTION: Policy

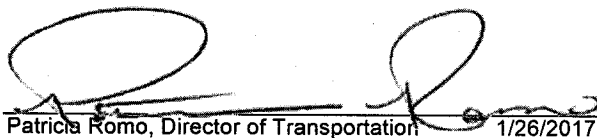
Patricia Romo, Director of Transportation 1/26/2017

MINUTES OF THE BOARD OF SUPERVISORS

On motion of Supervisor Tavaglione, seconded by Supervisor Jeffries and duly carried by unanimous vote, IT WAS ORDERED that the above matter is approved as recommended.

Ayes: Jeffries, Tavaglione, Washington and Ashley
Nays: None
Absent: None
Date: February 7, 2017
xc: Transp.

Kecia Harper-Ihem
Clerk of the Board
By: 
Deputy

**SUBMITTAL TO THE BOARD OF SUPERVISORS COUNTY OF RIVERSIDE,
STATE OF CALIFORNIA**

FINANCIAL DATA	Current Fiscal Year:	Next Fiscal Year:	Total Cost:	Ongoing Cost
COST	\$ 343,600	\$ 0	\$ 343,600	\$ 0
NET COUNTY COST	\$ 0	\$ 0	\$ 0	\$ 0
SOURCE OF FUNDS: CDBG (71%), Gas Tax (29%). No general funds will be used.			Budget Adjustment: No	
			For Fiscal Year: 16/17	

C.E.O. RECOMMENDATION: Approve

BACKGROUND:

Summary

The Transportation Department is planning on conducting new roadway construction and pavement widening of existing roads in the Mead Valley and Temecula areas using Transportation Department construction crews. This work can be efficiently and cost effectively completed using Transportation Department crews, compared to the traditional bidding process. It should be noted that the Transportation Department contracts out the vast majority of its construction work to private contractors (over 90% last year).

Certain projects that are less complex and of a maintenance nature can be more efficiently and quickly accomplished using our road crews, due to the time and cost savings realized through not having to generate engineered plans and contract specifications, surveying, and inspection costs.

The following road will be constructed in the Mead Valley area (1st District):

<u>Name</u>	<u>From</u>	<u>To</u>
*Hunter St	Una St	Barton St

The following road will be widened in the Temecula area (3rd District):

<u>Name</u>	<u>From</u>	<u>To</u>
Rancho California	Road Butterfield Stage Road	900' Easterly

*Existing dirt road, non-county maintained

Assembly Bill 720 (AB720) sets forth modified requirements by which new road construction and road reconstruction can be performed by employees of a public agency. Under AB720, an agency may elect to utilize public employees to perform force account work, provided this work does not exceed 30% of the total value of all work performed by force account other than maintenance, as reported in the State Controller's Streets and Roads Annual Report as of January 1st of each year. The intent to use this authority must be declared prior to commencing the work.

**SUBMITTAL TO THE BOARD OF SUPERVISORS COUNTY OF RIVERSIDE,
STATE OF CALIFORNIA**

The proposed projects with their associated construction budgets are listed in Attachment A-1. The total cost of the work is \$343,600.

Impact on Residents and Businesses

The proposed projects will reduce dust, improve access to local residences and reduce traffic congestion.

SUPPLEMENTAL:

Additional Fiscal Information

The Mead Valley area paving will be funded by CDBG funds (\$243,600).

The Temecula area paving will be funded by Gas Tax funds (\$100,000).

Contract History and Price Reasonableness

N/A

ATTACHMENTS:

Vicinity Maps

Attachment A-1

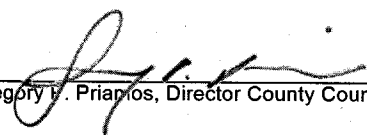

Gregory V. Priamos, Director County Counsel

1/27/2017

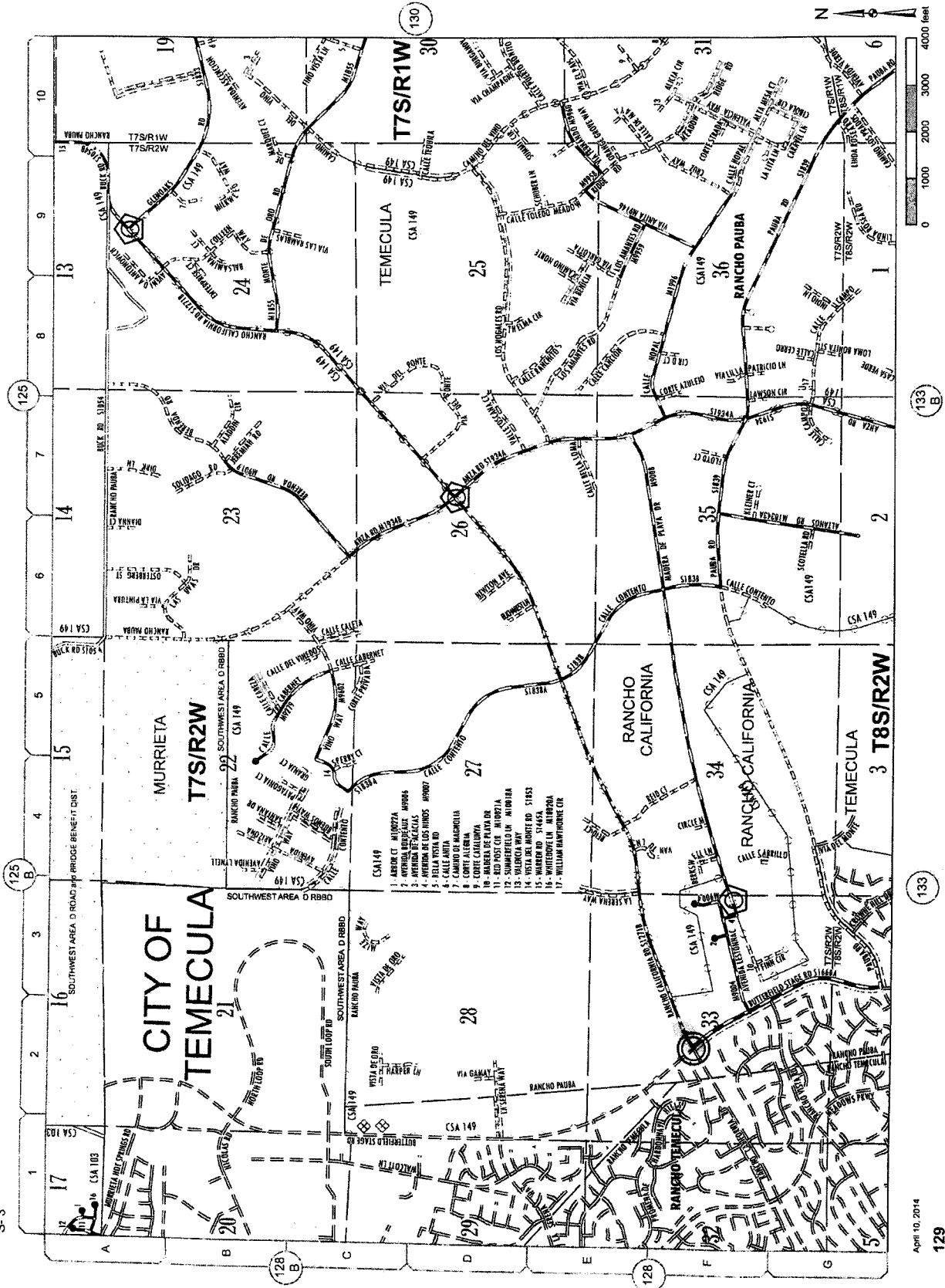

- 1. AVENUE CT. ANTONIA
- 2. AVENUE CT. ANTONIA
- 3. AVENUE CT. ANTONIA
- 4. AVENUE CT. ANTONIA
- 5. AVENUE CT. ANTONIA
- 6. AVENUE CT. ANTONIA
- 7. AVENUE CT. ANTONIA
- 8. AVENUE CT. ANTONIA
- 9. AVENUE CT. ANTONIA
- 10. AVENUE CT. ANTONIA
- 11. AVENUE CT. ANTONIA
- 12. AVENUE CT. ANTONIA
- 13. AVENUE CT. ANTONIA
- 14. AVENUE CT. ANTONIA
- 15. AVENUE CT. ANTONIA
- 16. AVENUE CT. ANTONIA
- 17. AVENUE CT. ANTONIA

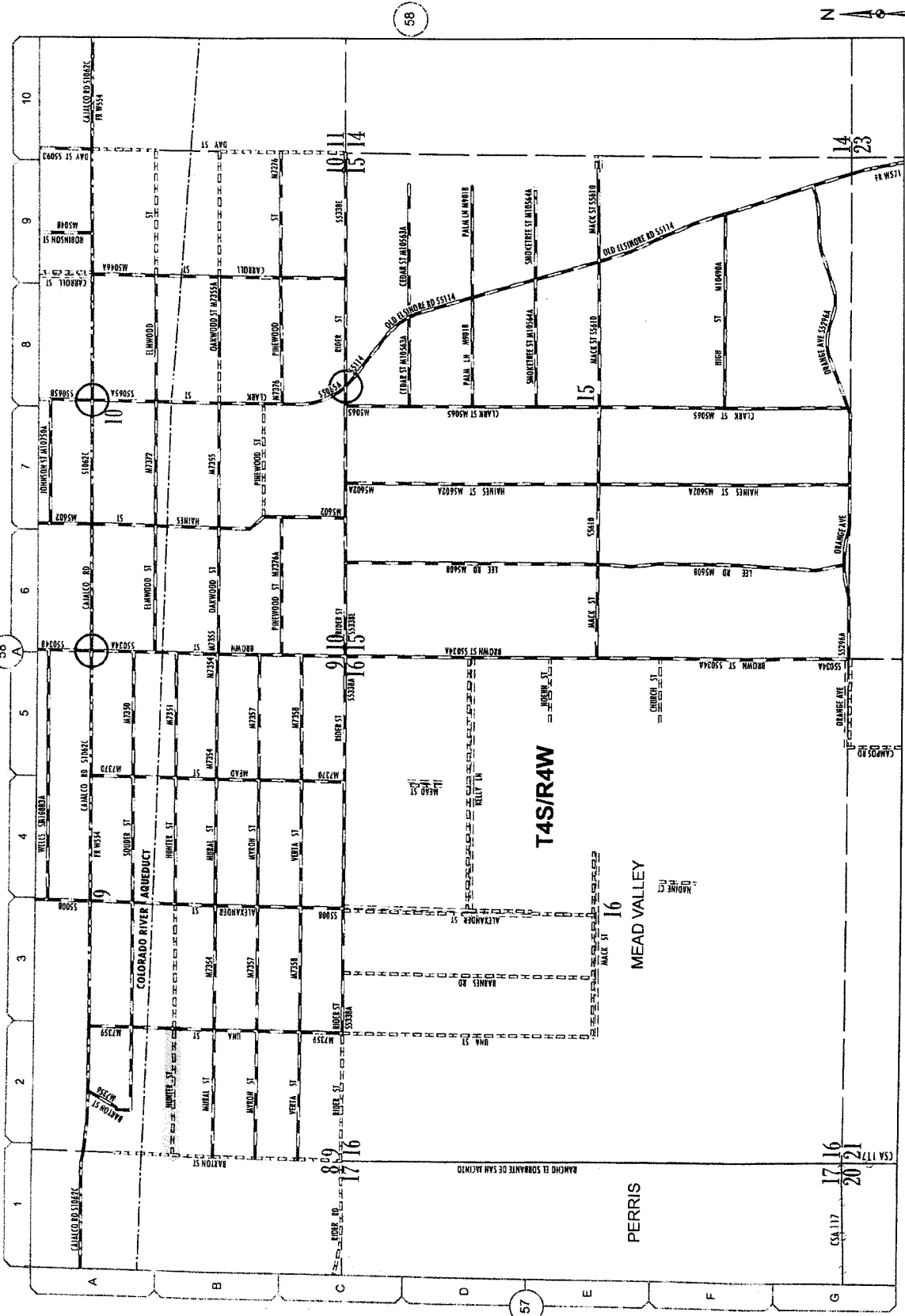

ATTACHMENT A -1

I. Mead Valley Area

Project No.	Road Name	From	To	Construction Cost (\$)
TBD	HUNTER ST	UNA ST	BARTON ST	243,600
Subtotal				243,600

II. Temecula Area

Project No.	Road Name	From	To	Construction Cost (\$)
TBD	RANCHO CALIFORNIA ROAD	BUTTERFIELD STAGE ROAD	900 FT EASTERLY	100,000
Subtotal				100,000
Total				343,600