

**SUBMITTAL TO THE BOARD OF SUPERVISORS  
COUNTY OF RIVERSIDE, STATE OF CALIFORNIA**



**ITEM**  
3.31  
(ID # 3584)

**MEETING DATE:**

Tuesday, May 9, 2017

**FROM :** TLMA-TRANSPORTATION:

**SUBJECT:** TLMA - TRANSPORTATION DEPARTMENT: Notice of Completion and Contract Change Order No. 15 – Airport Boulevard (Avenue 56) Union Pacific Railroad Grade Separation Project, Community of Thermal. 4th District. [\$20,600,000 - Total Cost]; State Funds 51%, Local Funds 49%

**RECOMMENDED MOTION:** That the Board of Supervisors

1. Execute and Authorize the County of Riverside (County) Transportation Department to issue Contract Change Order No. 15 with Granite Construction Company;
2. Accept Airport Boulevard Grade Separation Project as completed; and
3. Authorize the Chairman of the Board to execute the Notice of Completion and the Clerk of the Board to record the Notice.

**ACTION:** Change Order, Policy

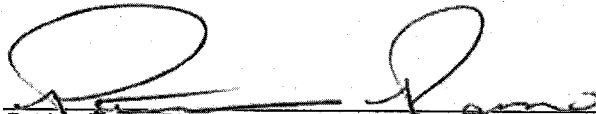
  
Patricia Romo, Director of Transportation 5/1/2017

---

**MINUTES OF THE BOARD OF SUPERVISORS**

On motion of Supervisor Ashley, seconded by Supervisor Washington and duly carried by unanimous vote, IT WAS ORDERED that the above matter is approved as recommended.

Ayes: Jeffries, Tavaglione, Washington and Ashley  
Nays: None  
Absent: None  
Date: May 9, 2017  
xc: TLMA-Transp., Recorder

Kecia Harper-Ihem  
Clerk of the Board  
By:   
Deputy

**SUBMITTAL TO THE BOARD OF SUPERVISORS COUNTY OF RIVERSIDE,  
STATE OF CALIFORNIA**

| <b>FINANCIAL DATA</b>   | <b>Current Fiscal Year:</b> | <b>Next Fiscal Year:</b> | <b>Total Cost:</b>        | <b>Ongoing Cost</b> |
|---|-----------------------------|--------------------------|---------------------------|---------------------|
| <b>COST</b>   | \$ 1,900,000                | \$ 0                     | \$ 20,600,000             | \$ 0                |
| <b>NET COUNTY COST</b>  | \$ 0                        | \$ 0                     | \$ 0                      | \$ 0                |
| <b>SOURCE OF FUNDS:</b> Prop 1B- Trade Corridor Improvement Funds (51%), Transportation Uniform Mitigation Fee (CVAG) (45%), Coachella Valley Water District (CVWD) (4%) There are no General Funds used in this project. |                             |                          | <b>Budget Adjustment:</b> | N/A                 |
|   |                             |                          | <b>For Fiscal Year:</b>   | 12/13 - 16/17       |

**C.E.O. RECOMMENDATION:** Approve

**BACKGROUND:**

**Summary**

By Minute Order 3-50 of November 5, 2013, the Board of Supervisors entered into a contract with Granite Construction Company of Indio, CA for the Airport Boulevard (Avenue 56) Railroad Grade Separation Project in the Community of Thermal.

Contract Change Order No. 15 became necessary to resolve potential claims resulting in issues related to the light weight fill, construction staging and bridge construction. Due to the high water table, light weight fill was specified for the project. Placing this non-typical material took longer than specified and impacted the construction staging of the project. Additionally, constructability issues of the bridge deck and walls were encountered due to the close spacing of the steel bars. The total amount of Contract Change Order No. 15 is \$1,760,403 (9.98% of the original contract amount), which exceeds the maximum change order amount that can be authorized by the Director of the County Transportation Department and requires Board of Supervisors approval in accordance with Resolution No. 93-047.

After a thorough review and analysis of the issues and costs of a more formal mediation process, staff is recommending the Board approve Contract Change Order No. 15. By approving this change order amount, the County of Riverside will avoid additional staff administration costs, professional legal fees, and interest paid to the contractor for the potential settlement claim amount and the Contractor expressly waves any other claims related to this project.

The Airport Boulevard Bridge over the Union Pacific Railroad tracks and Grapefruit Boulevard was opened to traffic in June 2016.

Not including this change order, the County has issued 14 change orders totaling \$1,155,040 (6.55% of the original contract amount). These change orders can be summarized into the following categories:

- Soil Stabilization due high ground water table (\$170,000)

**SUBMITTAL TO THE BOARD OF SUPERVISORS COUNTY OF RIVERSIDE,  
STATE OF CALIFORNIA**

- Replacement of sidewalk and placement of aggregate base and plastic sheeting to mitigate the swelling effect of the subgrade due to the high alkali content of the existing soil (\$312,216).
- Caltrans Encroachment Permit, State Water Control Resources Board and Dispute Resolution Board fees (\$150,000)
- Steel walkway modifications necessary for proper attachment to the existing Whitewater River Bridge. (\$144,892)
- Unforeseen issues such as adjacent roadway and drainage modifications at various locations, retaining wall modifications, and signal modifications to comply with the latest ADA standards, and Asphalt Concrete and Aggregate Base modifications. (\$377,932).

The original authorized amount of the contract was \$17,646,646. The total amended contract is \$20,600,000 which is 16.7% more than the originally authorized amount and was the result of 15 contract change orders and bid quantity adjustments as discussed in detail in the attached Contract Change Order Report.

The work was completed in conformance with the plans and specifications and the contractor was granted relief of maintenance on June 20, 2016. Work Order Number A6-0241, TCIFL-5956(216).

**Impact on Residents and Businesses**

The project has increased public safety by eliminating train and vehicle conflicts. Train noise has been reduced, as well as greenhouse gas emissions.

**SUPPLEMENTAL  
Additional Fiscal Information**

**Budget**

|                                 |        |              |
|---------------------------------|--------|--------------|
| Original Contract Amount        |        | \$17,646,646 |
| Total Change Orders Authorized  | 16.5%  | \$2,915,444  |
| Estimated Pending Change Orders | 0.0%   | \$0          |
| Authorized Contract Amount      |        | \$20,562,090 |
| * Quantity Adjustments          | 0.2%   | \$37,910     |
| + CCO FA Adjustments            | 0.0%   | \$0          |
| Total Amended Contract Amount   | 116.7% | \$20,600,000 |

**Expenditures**

|                            |              |
|----------------------------|--------------|
| Total Progress Payments    | \$20,600,000 |
| Estimated Pending Payments | \$0          |
| Total Expenditures         | \$20,600,000 |

**(Over)/Under Contract Amount** \$0

**SUBMITTAL TO THE BOARD OF SUPERVISORS COUNTY OF RIVERSIDE,  
STATE OF CALIFORNIA**

+ Change Orders using the Force Account method of payment issued prior to the work being completed generally do not use the total authorized amount.

\* CAL-Trans Standard Specifications 4-1.03B. Increases or decreases in the quantity of a contract item of work will be determined by comparing the total pay quantity of such item of work with the Engineer's Estimate. If the total pay quantity of any item of work required under the contract varies from the Engineer's Estimate by 25 percent or less, payment will be made for the quantity of work of said item performed at the contract unit price, unless eligible for adjustment pursuant to Section 4-1.03C, "Changes in Character of Work."

This project was funded with \$9,888,000 of Proposition 1B Trade Corridor Improvement Funds, \$9,888,000 of Transportation Uniform Mitigation Fee (CVAG) funds and \$824,000 of Coachella Valley Water District funds.

**Contract History and Price Reasonableness**

Five bids were received on September 11, 2013 ranging from \$17,646,646 to \$20,166,385. The basis for the selection of a contractor is the lowest responsive and responsible bid. The lowest responsible bid was submitted by Granite of Indio, CA in the amount of \$17,646,646 which is \$3,754,847 (17.5%) lower than the Engineer's Estimate.

**ATTACHMENTS:**

Vicinity Map  
Change Order Letter of Transmittal  
Change Order Report  
Progress Estimate Report  
Notice of Completion

  
\_\_\_\_\_  
Marsha Victor, Chief Deputy County Counsel

5/2/2017

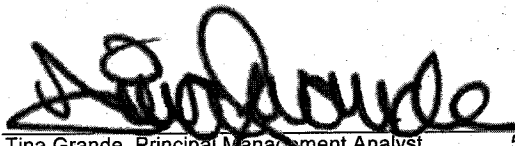
  
\_\_\_\_\_  
Tina Grande, Principal Management Analyst

5/4/2017

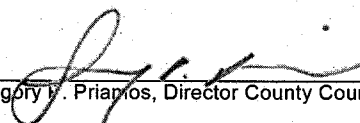
  
\_\_\_\_\_  
Gregory V. Priamos, Director County Counsel

5/3/2017

COUNTY OF RIVERSIDE  
DEPARTMENT OF TRANSPORTATION

**Airport Boulevard (Avenue 56)**

At Grapefruit Boulevard (Hwy 111) and Union Pacific Railroad

**Grade Separation Project**

In the Community of Thermal of the Coachella Valley

Project No. A6-0241

State Project ID: TCIFL- 5956(216)

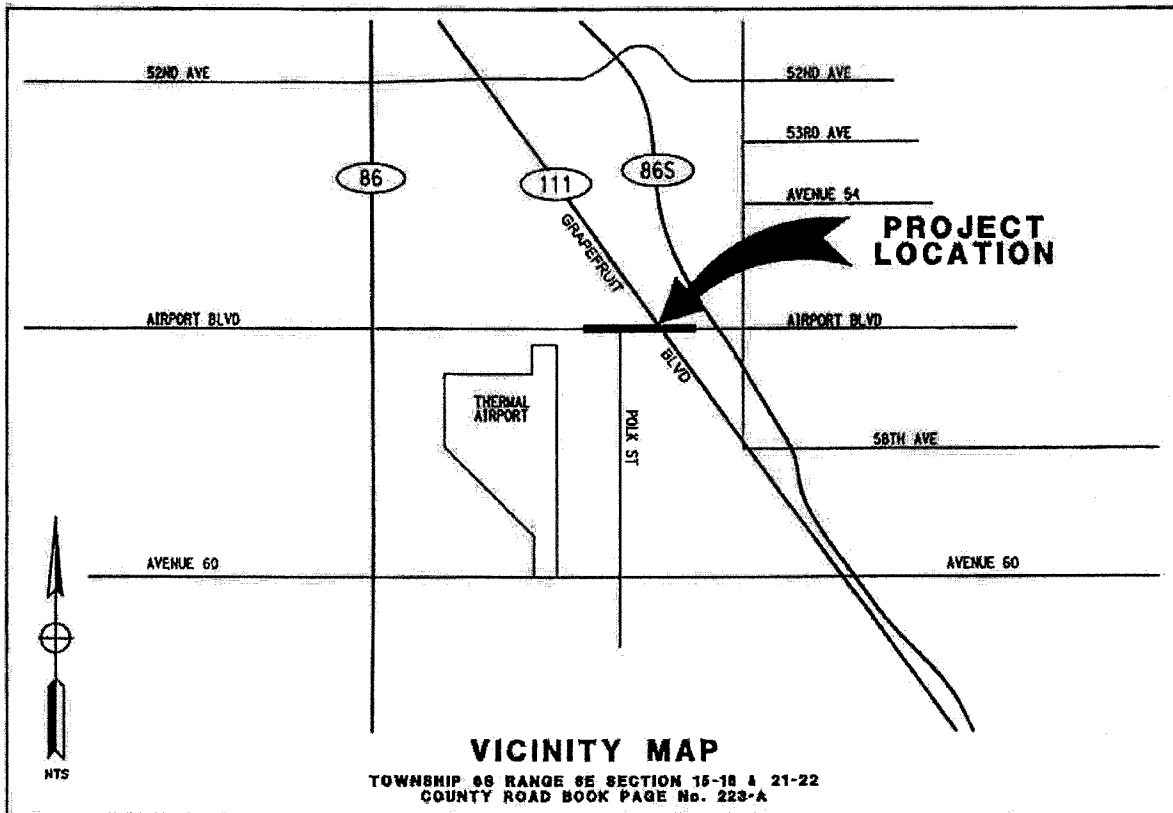
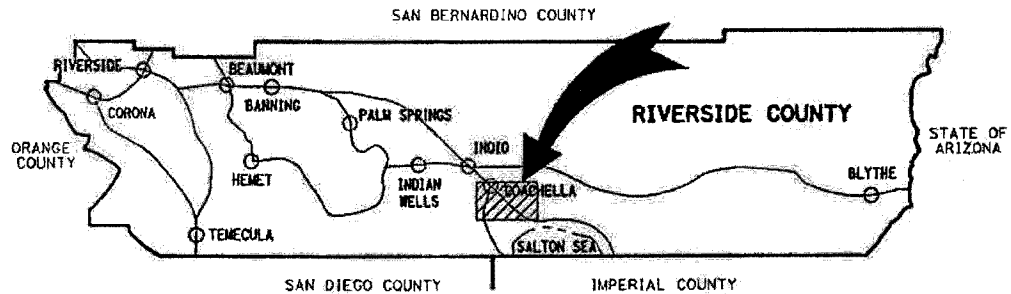

**CHANGE ORDER REPORT**  
**(Airport Boulevard Grade Separation Project)**

| CCO # | Amount                                   | Percent | Description   |
|-------|--|---------|---|
|       | Original Contract Amount<br>\$17,646,646 |         |   |
| 1     | \$85,000                                 | 0.48%   | Encroachment permit from Caltrans required to install notification signs and temporary traffic control devices; fees to the State Water Control Resources Board; Dispute Resolution Board.  |
| 1S1   | \$65,000                                 | 0.37%   | The fees for the Caltrans encroachment permit, State Water Control Resources Board and the Dispute Resolution Board were still on a continuous basis until the completion of the project; Miscellaneous extra work due to unforeseen conditions.  |
| 2     | \$20,866                                 | 0.12%   | Furnished modified signal poles, anchor bolts, HPS Luminaires, Edge Lit LED ISNS Sign Arms and service became necessary to conform to 2010 Standard specifications in lieu of the 2006 with amendments issued October, 19, 2012.  |
| 3     | -\$14,962                                | -0.08%  | The use of HDPE pipe in lieu of RCP was due to the corrosive nature of the native soil; Credit for the architectural fractured rib form liner; The increase of Item No. 28 became necessary to compensate the Contractor for actual quantities of removal as indicated on the project plans   |
| 4     | \$4,594                                  | 0.03%   | Temporary relocation of the existing sewer service lateral was necessary for the placement of the sewer forcemain, borne entirely by CVWD.  |
| 5     | \$5,772                                  | 0.03%   | Compensation to the Contractor for actual quantities of obliterate surfacing as indicated on the revised project plans.   |
| 6     | \$50,000                                 | 0.28%   | Standard No. 300 catch basin, 18" HDPE pipe lateral and connection to drainage system no. 6 to carry the runoff was recommended by the Design Engineer; ponding mitigation was also recommended.  |
| 7     | \$93,525                                 | 0.53%   | Due to the discrepancy in elevations, it was calculated that Item No. 52, Hot Mix Asphalt, would increase by approximately 353 tons (\$28,895.76) for the overlay as specified; installation of temporary chain link fence was required in conformance with Union Pacific Railroad safety precautions; modification and redesign of the architectural pattern on the MSE Wall precast panels; The Pak Ryt driveway was modified and realigned to conform to the final agreement with the owners versus as indicated in the original construction drawings; to mitigate the swelling effect of subgrade with high alkali content, plastic sheeting with 6" Class 2 Base was placed under the proposed concrete sidewalk. |
| 8     | \$5,584                                  | 0.03%   | Manhole shaft was replaced with eccentric cone and shifted outside the curb and gutter and reset within the driveway approach. The manhole was missed by CVWD and is borne entirely upon CVWD.  |

**CHANGE ORDER REPORT**  
**(Airport Boulevard Grade Separation Project)**

|     |           |       |   |
|-----|-----------|-------|---|
| 9   | \$145,000 | 0.82% | Unstable subgrade, due to ground water, was stabilized prior to placement of embankment fill. The subgrade stabilization required over-excavation of approximately 2,300 cubic yards of unstable material, placement of 5,600 square yards of geotextile fabric and 2,300 cubic yards of crushed gravel.  |
| 9S1 | \$25,000  | 0.14% | The initial estimate requested under CCO 9 was insufficient to cover payment for the actual cost of subgrade stabilization.   |
| 10  | \$119,391 | 0.68% | Plastic sheeting with 6" Class 2 base was placed under the proposed concrete sidewalk in order to mitigate the swelling effect of subgrade with high alkali content; Sidewalk removal and construction of new driveway approach was required to restore an existing property access point; installed a new street light pole at the mobile home park entrance for public safety; removed existing pavement, grade and pave driveway tie-ins not shown on the plans but necessary due to proposed street improvements; removed and reinstalled existing fencing; painted exterior girders to provide aesthetic blending with painted street light poles and bridge fencing; conduit and loops required reinstallation; Item No. 89 Minor Concrete Driveway contract quantity was increased.                                    |
| 11  | \$110,276 | 0.62% | Repaired the existing bridge steel railing damaged by traffic during construction located on the northerly side of the Whitewater River Bridge; Constructed the above ground signal pole foundations at Palm St. and Airport Blvd in order to comply with ADA requirements; removed deteriorated, hazardous sidewalk for pedestrian traffic; wrapped slotted drainage PVC pipe with filter fabric within utility corridor to prevent fill fine material from migrating into the pipes and clogging them; provided additional soil retainage for the construction of sidewalk on Airport Blvd.; placed approximately 51,000 SF of filter fabric (to conform to project specifications) between treated permeable base (TPB) and class 2 base to prevent the fine aggregates in the class 2 base from migrating down to the TPB |
| 12  | \$144,892 | 0.82% | Steel Walkway modifications were necessary for proper fitment of walkway on to existing Whitewater River Bridge.  |
| 13  | \$147,000 | 0.83% | Sidewalk that had become a tripping hazard was removed and replaced with 6" of class 2 base over visqueen plastic below the concrete sidewalk to prevent future lifting and corrosion.  |
| 14  | \$148,103 | 0.84% | Paint touch up of exterior girders; removed light weight fill at Abutment No. 1 and 3; potholed the gas line; constructed sidewalk near Desert Cactus for safety; reconstructed sign pole foundation E and F; removed and stabilize unsuitable subgrade at Polk and Airport; new drainage inlet installation to alleviate flooding at Polk and Airport; trim tops of MSE wall No. 2 and 4; extend RW No. 2 (MSE) wall drains; reconstructed existing catch basin; removed/eliminated the existing driveway approach and replace with curb and   |

**CHANGE ORDER REPORT**  
**(Airport Boulevard Grade Separation Project)**

|   |              |       |   |
|---|--------------|-------|---|
|   |              |       | gutter; removal of extra thick and deteriorated HMA along east side of Grapefruit Blvd.; regraded curb and gutter along the south side of Airport Blvd. due to survey grade bust; provide traffic control for cold plane operation on Grapefruit Blvd; placement of overside drains that did not show a payment method; add raised median island at Palm and Airport Frontage; install IISNS at Airport Frontage Rd. and Grapefruit Blvd. signs; New street name signs at Palm St. and Airport Frontage Rd., the street name was changed; one Storm Water Annual Report was added due to the project extending to June. |
| 15  | \$1,760,403  | 9.98% | Settlement of outstanding Notices of Potential Claims which include outstanding claims, requests for time extensions, extended field overhead or home office overhead costs, interest, and all cumulative impact on work under the contract.  |
| Quantity Adjustments                      | \$37,910     | 0.2%  |   |
| Change Order Total and New Contract Total | \$20,600,000 |       |   |



PROJECT: Airport Blvd. (Avenue 59) at Gregefruit Blvd. (Hwy 111) and Union Pacific Railroad, Grade Separation Project  
 County Project No.: AS-0241, State Aid ID: TCFL-0856(216)  
 Contract No. 13-10-005

Contractor: Granite Construction Company  
 Address: 38000 Monroe Street  
 City, State, Zip: Indio, CA 92203

Estimate No. 32 FINAL  
 From: February 26, 2017  
 To: April 25, 2017



| Item No.             | Item Description | Units | Quantity | Unit Price | Original Contract Amount | Change Orders Quantity | Amount       | Ameneded Contract Quantity | Amount        | This Estimate Quantity | Amount       | Previous Quantity | Total Estimate To Date Quantity | Amount        | % Avh. |
|----------------------|------------------|-------|----------|------------|--------------------------|------------------------|--------------|----------------------------|---------------|------------------------|--------------|-------------------|---------------------------------|---------------|--------|
|                      |                  |       |          |            | 17,646,646.00            |                        | 2,915,443.90 |                            | 20,562,089.90 |                        | 1,983,108.12 |                   |                                 | 20,600,000.00 |        |
| <b>PROJECT TOTAL</b> |                  |       |          |            |                          |                        |              |                            |               |                        |              |                   |                                 |               |        |

Made by: Gabriel Minoz  
 Checked by: [Signature] 4-25-17  
 OK Const. Supv.: [Signature] 4/20/17

Working Days: 2-28-14  
 Days Added: 3-1-16  
 Subtotal: 100%  
 Days Used: 591  
 % Time Elapsed: 100%

TOTAL VALUE OF WORK TO DATE: \$20,600,000.00  
 LESS RETENTION: 0%  
 TOTAL DUE TO DATE: \$20,600,000.00  
 LESS PREVIOUSLY INVOICED: 18,616,891.88  
 LESS LABOR NON COMPLIANCE: 0.00  
 TOTAL DUE THIS PAYMENT: \$1,983,108.12

This Estimate Approved

Date: 5/1/17 for \$1,983,108.12

Received by Accounts Payable: \_\_\_\_\_  
 By: \_\_\_\_\_

Quantities on This Estimate Approved \_\_\_\_\_ Date: \_\_\_\_\_  
 Granite Construction Company

PROGRESS ESTIMATE RECORD - COUNTY OF RIVERSIDE

PROJECT: Airport Blvd. (Avenue 56) at Grapefruit Blvd. ( Hwy 111) and Union Pacific Railroad, Grade Separation Project  
 County Project No: AA-0241, State Aid ID: TCIFL-5556(216)  
 Contract No. 13-10-005

Contractor: Granite Construction Company  
 Address: 38000 Monroe Street  
 Indio, CA 92203

SHEET 1 of 8

Processed Construction Inspection 4/25/2017



Estimate No. 32 FINAL  
 From: February 28, 2017  
 To: April 25, 2017

| Item No. | Item Description                                  | Units | Quantity | Unit Price | Original Contract Amount | Change Orders Quantity | Amount   | Amended Contract Quantity | Amount    | This Estimate Quantity | Amount | Previous Quantity | Total Estimate To Date Quantity | Amount    | % Auth. |
|----------|---|-------|----------|------------|--------------------------|------------------------|----------|---------------------------|-----------|------------------------|--------|-------------------|---------------------------------|-----------|---------|
| 1        | TRAFFIC MANAGEMENT PLAN - PUBLIC INFORMATION      | LS    | 1        | -          | 30,000.00                |                        |          | 1.00                      | 30,000.00 |                        |        | 1.00              | 1.00                            | 30,000.00 | N/A     |
| 2        | DUST ABATEMENT                                    | LS    | 1        | 30,000.00  | 30,000.00                |                        |          | 1.00                      | 30,000.00 |                        |        | 1.00              | 1.00                            | 30,000.00 | 100%    |
| 3        | RESIDENT ENGINEERS OFFICE                         | LS    | 1        | 80,000.00  | 80,000.00                |                        |          | 1.00                      | 80,000.00 |                        |        | 1.00              | 1.00                            | 80,000.00 | 100%    |
| 4        | OBLITERATE SURFACING & CCO 5                      | SOFT  | 13,500   | 0.70       | 9,450.00                 | 8,245.00               | 5,771.50 | 21,745.00                 | 15,221.50 |                        |        | 21,745.00         | 21,745.00                       | 15,221.50 | 100%    |
| 5        | PARTNERING  | LS    | 28,000   | 1.00       | 28,000.00                |                        |          | 28,000.00                 | 28,000.00 |                        |        | 28,055.80         | 28,055.80                       | 28,055.80 | 100%    |
| 6        | MAINTAIN EXISTING AND TEMPORARY ELECTRICAL SYSTEM | LS    | 1        | 70,000.00  | 70,000.00                |                        |          | 1.00                      | 70,000.00 |                        |        | 1.00              | 1.00                            | 70,000.00 | 100%    |
| 7        | DISPUTES REVIEW BOARD                             | LS    | 1        | -          |                          |                        |          |                           |           |                        |        |                   |                                 |           | N/A     |
| 8        | PROGRESS SCHEDULE (CRITICAL PATH METHOD)          | LS    | 1        | 500.00     | 500.00                   |                        |          | 1.00                      | 500.00    | 0.25                   | 125.00 | 0.75              | 1.00                            | 500.00    | 100%    |
| 9        | CONSTRUCTION SITE MANAGEMENT                      | LS    | 1        | 80,000.00  | 80,000.00                |                        |          | 1.00                      | 80,000.00 |                        |        | 1.00              | 1.00                            | 80,000.00 | 100%    |
| 10       | PREPARE STORM WATER POLLUTION PREVENTION PLAN     | LS    | 1        | 2,000.00   | 2,000.00                 |                        |          | 1.00                      | 2,000.00  | 0.10                   | 200.00 | 0.90              | 1.00                            | 2,000.00  | 100%    |
| 11       | STORM WATER ANNUAL REPORT & CCO 14                | EA    | 2        | 500.00     | 1,000.00                 | 1.00                   | 500.00   | 3.00                      | 1,500.00  |                        |        | 3.00              | 3.00                            | 1,500.00  | 100%    |
| 12       | FUNDING AWARENESS SIGN                            | EA    | 2        | 1,200.00   | 2,400.00                 |                        |          | 2.00                      | 2,400.00  |                        |        | 2.00              | 2.00                            | 2,400.00  | 100%    |
| 13       | CONSTRUCTION AREA SIGNS                           | LS    | 1        | 75,000.00  | 75,000.00                |                        |          | 1.00                      | 75,000.00 |                        |        | 1.00              | 1.00                            | 75,000.00 | 100%    |
| 14       | TRAFFIC CONTROL SYSTEM                            | LS    | 1        | 74,894.00  | 74,894.00                |                        |          | 1.00                      | 74,894.00 |                        |        | 1.00              | 1.00                            | 74,894.00 | 100%    |
| 15       | TEMPORARY PAVEMENT MARKING (PAINT)                | SOFT  | 320      | 3.00       | 960.00                   |                        |          | 320.00                    | 960.00    |                        |        | 400.00            | 400.00                          | 1,200.00  | 125%    |
| 16       | TEMPORARY TRAFFIC STRIPE (PAINT)                  | LF    | 11,700   | 0.40       | 4,680.00                 |                        |          | 11,700.00                 | 4,680.00  |                        |        | 13,584.00         | 13,584.00                       | 5,433.60  | 116%    |
| 17       | PORTABLE DELINEATOR                               | EA    | 460      | 12.00      | 5,520.00                 |                        |          | 460.00                    | 5,520.00  |                        |        | 460.00            | 460.00                          | 5,520.00  | 100%    |
| 18       | PORTABLE CHANGEABLE MESSAGE SIGN                  | LS    | 1        | 50,000.00  | 50,000.00                |                        |          | 1.00                      | 50,000.00 |                        |        | 1.00              | 1.00                            | 50,000.00 | 100%    |
| 19       | TEMPORARY RAILING (TYPE K)                        | LF    | 2,540    | 28.50      | 72,390.00                |                        |          | 2,540.00                  | 72,390.00 |                        |        | 3,175.00          | 3,175.00                        | 90,487.50 | 125%    |
| 20       | TEMPORARY CRASH CUSHION MODULE                    | EA    | 149      | 190.00     | 28,310.00                |                        |          | 149.00                    | 28,310.00 |                        |        | 129.00            | 129.00                          | 24,510.00 | 87%     |
| 21       | RELOCATE CONDUIT                                  | LF    | 366      | 30.00      | 10,980.00                |                        |          | 366.00                    | 10,980.00 |                        |        | 366.00            | 366.00                          | 10,980.00 | 100%    |
| 22       | ABANDON PIPELINE                                  | LF    | 1,140    | 22.00      | 25,080.00                |                        |          | 1,140.00                  | 25,080.00 |                        |        | 1,140.00          | 1,140.00                        | 25,080.00 | 100%    |
| 23       | REMOVE CHAIN LINK FENCE                           | LF    | 1,300    | 6.00       | 7,800.00                 |                        |          | 1,300.00                  | 7,800.00  |                        |        | 1,124.00          | 1,124.00                        | 6,744.00  | 86%     |
| 24       | REMOVE GATE                                       | EA    | 1        | 500.00     | 500.00                   |                        |          | 1.00                      | 500.00    |                        |        | 1.00              | 1.00                            | 500.00    | 100%    |
| 25       | REMOVE ROADSIDE SIGN                              | EA    | 25       | 100.00     | 2,500.00                 |                        |          | 25.00                     | 2,500.00  |                        |        | 26.00             | 26.00                           | 2,600.00  | 104%    |
| 26       | REMOVE PIPE                                       | LF    | 6        | 50.00      | 300.00                   |                        |          | 6.00                      | 300.00    |                        |        | 6.00              | 6.00                            | 300.00    | 100%    |

| Item No. | Item Description                                    | Units | Quantity | Unit Price | Original Contract |           | Change Orders |          | This Estimate |          | Previous |          | Total Estimate To Date |              | % Auth. |
|----------|---|-------|----------|------------|-------------------|-----------|---------------|----------|---------------|----------|----------|----------|------------------------|--------------|---------|
|          |   |       |          |            | Amount            | Quantity  | Amount        | Quantity | Amount        | Quantity | Amount   | Quantity | Amount                 | Quantity     |         |
| 27       | REMOVE INLET  | EA    | 8        | 1,000.00   | 8,000.00          | 8.00      |               |          |               |          |          |          | 8.00                   | 8,000.00     | 100%    |
| 28       | REMOVE CONCRETE PAVEMENT                            | SQYD  | 52       | 25.00      | 1,300.00          | 275.00    | 5,575.00      |          |               |          |          |          | 274.50                 | 6,875.00     | 100%    |
| 29       | RELOCATE ROADSIDE SIGN                              | EA    | 19       | 250.00     | 4,750.00          | 19.00     |               |          |               |          |          |          | 15.00                  | 3,750.00     | 79%     |
| 30       | ADJUST MANHOLE TO GRADE                             | EA    | 10       | 1,200.00   | 12,000.00         | 10.00     |               |          |               |          |          |          | 10.00                  | 12,000.00    | 100%    |
| 31       | ADJUST VALVE BOX FRAME AND COVER TO GRADE           | EA    | 11       | 850.00     | 9,350.00          | 11.00     |               |          |               |          |          |          | 3.00                   | 2,550.00     | 27%     |
| 32       | COLD PLANE ASPHALT CONCRETE PAVEMENT (.20' MAXIMUM) | SQYD  | 5,360    | 2.90       | 15,544.00         | 5,360.00  |               |          |               |          |          |          | 3,318.00               | 9,622.20     | 62%     |
| 33       | REMOVE CONCRETE CURB AND GUTTER                     | LF    | 1,800    | 6.00       | 10,800.00         | 1,800.00  |               |          |               |          |          |          | 1,818.00               | 10,908.00    | 101%    |
| 34       | REMOVE CONCRETE SIDEWALK                            | SOFT  | 9,350    | 1.00       | 9,350.00          | 9,350.00  |               |          |               |          |          |          | 9,533.00               | 9,533.00     | 102%    |
| 35       | REMOVE BRIDGE RAILING                               | LF    | 382      | 30.00      | 11,460.00         | 382.00    |               |          |               |          |          |          | 382.00                 | 11,460.00    | 100%    |
| 36       | ROCK SLOPE PROTECTION (1/4 TON, METHOD B)           | CY    | 2        | 700.00     | 1,400.00          | 2.00      |               |          |               |          |          |          | 2.00                   | 1,400.00     | 100%    |
| 37       | CLEARING AND GRUBBING                               | ACRE  | 13       | 3,500.00   | 45,500.00         | 13.00     |               |          |               |          |          |          | 13.00                  | 45,500.00    | 100%    |
| 38       | DEMOLISH BUILDING                                   | LS    | 1        | 40,000.00  | 40,000.00         | 1.00      |               |          |               |          |          |          | 1.00                   | 40,000.00    | 100%    |
| 39       | DEVELOP WATER SUPPLY                                | LS    | 1        | 50,000.00  | 50,000.00         | 1.00      |               |          |               |          |          |          | 1.00                   | 50,000.00    | 100%    |
| 40       | ROADWAY EXCAVATION                                  | CY    | 26,700   | 10.00      | 267,000.00        | 26,700.00 |               |          |               |          |          |          | 27,960.00              | 279,600.00   | 105%    |
| 41       | STRUCTURE EXCAVATION (BRIDGE)                       | CY    | 770      | 50.00      | 38,500.00         | 770.00    |               |          |               |          |          |          | 770.00                 | 38,500.00    | 100%    |
| 42       | STRUCTURE EXCAVATION (TYPE D)                       | CY    | 281      | 100.00     | 28,100.00         | 281.00    |               |          |               |          |          |          | 281.00                 | 28,100.00    | 100%    |
| 43       | STRUCTURE EXCAVATION (RETAINING WALL)               | CY    | 11,393   | 15.00      | 170,895.00        | 11,393.00 |               |          |               |          |          |          | 11,393.00              | 170,895.00   | 100%    |
| 44       | STRUCTURE BACKFILL (BRIDGE)                         | CY    | 1,390    | 60.00      | 83,400.00         | 1,390.00  |               |          |               |          |          |          | 1,390.00               | 83,400.00    | 100%    |
| 45       | STRUCTURE BACKFILL (RETAINING WALL)                 | CY    | 14,206   | 20.00      | 284,120.00        | 14,206.00 |               |          |               |          |          |          | 14,206.00              | 284,120.00   | 100%    |
| 46       | DITCH EXCAVATION                                    | CY    | 650      | 14.00      | 9,100.00          | 650.00    |               |          |               |          |          |          | 306.00                 | 4,284.00     | 47%     |
| 47       | IMPORTED BORROW                                     | CY    | 24,800   | 11.00      | 272,800.00        | 24,800.00 |               |          |               |          |          |          | 28,131.00              | 320,441.00   | 117%    |
| 48       | LIGHTWEIGHT FILL [CELLULAR CONCRETE 42 PCF]         | CY    | 3,486    | 50.00      | 174,300.00        | 3,486.00  |               |          |               |          |          |          | 3,486.00               | 174,300.00   | 100%    |
| 49       | LIGHTWEIGHT FILL [CELLULAR CONCRETE 30 PCF]         | CY    | 31,866   | 38.00      | 1,211,668.00      | 31,866.00 |               |          |               |          |          |          | 31,866.00              | 1,211,668.00 | 100%    |
| 50       | 6" PVC (SCHEDULE 80)                                | LF    | 140      | 80.00      | 11,200.00         | 140.00    |               |          |               |          |          |          | 140.00                 | 11,200.00    | 100%    |
| 51       | CLASS 2 AGGREGATE BASE                              | CY    | 21,600   | 30.00      | 648,000.00        | 21,600.00 |               |          |               |          |          |          | 23,389.00              | 701,670.00   | 108%    |
| 52       | HOT MIX ASPHALT (TYPE A)                            | TON   | 18,600   | 81.75      | 1,520,550.00      | 18,600.00 |               |          |               |          |          |          | 19,716.17              | 1,611,796.80 | 106%    |

Contractor: Granite Construction Company  
 38000 Monroe Street  
 Indio, CA 92203

Contract No. 13-10-005  
 County Project No. AS-0241, State Aid ID: TCFL-3956(218)  
 PROJECT: Airport Blvd. (Avenue 90) at Grapefruit Blvd. ( Hwy 111) and Union Pacific Railroad, Grade Separation Project  
 Estimate No. 32 FINAL  
 From: February 26, 2017  
 To: April 25, 2017







Contractor: Granite Construction Company  
 Address: 38800 Monroe Street  
 City, State, Zip: Indio, CA 92203

PROJECT: Airport Blvd. (Avenue 59) at Grapefruit Blvd. ( Hwy 111) and Union Pacific Railroad, Grade Separation Project  
 County Project No.: AS-0241, State Aid ID: TCF-5866(216)  
 Contract No. 13-19-005

Estimate No. 33 FINAL  
 From: February 26, 2017  
 To: April 25, 2017

| Item No. | Item Description                           | Units | Quantity | Unit Price | Original Contract Amount | Change Orders Quantity | Change Orders Amount | Ameneded Contract Quantity | Ameneded Contract Amount | This Estimate Quantity | This Estimate Amount | Previous Quantity | Total Estimate To Date Quantity | Total Estimate To Date Amount | % Auth. |
|----------|--|-------|----------|------------|--------------------------|------------------------|----------------------|----------------------------|--------------------------|------------------------|----------------------|-------------------|---------------------------------|-------------------------------|---------|
| 79       | P 36" REINFORCED CONCRETE PIPE             | LF    | 1,590    | 195.00     | 310,050.00               | -786.00                | -153,270.00          | 804.00                     | 156,780.00               | 899.00                 | 176,305.00           | 899.00            | 899.00                          | 176,305.00                    | 112%    |
| 80       | JACK AND BORE 48" STEEL CASING             | LF    | 250      | 1,500.00   | 375,000.00               |                        |                      | 250.00                     | 375,000.00               | 232.00                 | 348,000.00           | 232.00            | 232.00                          | 348,000.00                    | 93%     |
| 81       | P WELDED STEEL PIPE CASING (BRIDGE)        | LF    | 140      | 275.00     | 38,500.00                |                        |                      | 140.00                     | 38,500.00                | 140.00                 | 38,500.00            | 140.00            | 140.00                          | 38,500.00                     | 100%    |
| 82       | 18" CONCRETE FLARED END SECTION            | EA    | 2        | 2,300.00   | 4,600.00                 | -2.00                  | -4,600.00            |                            |                          |                        |                      |                   |                                 |                               | N/A     |
| 83       | P ROCK SLOPE PROTECTION FABRIC             | SOYD  | 4        | 13.00      | 52.00                    |                        |                      | 4.00                       | 52.00                    | 4.00                   | 52.00                | 4.00              | 4.00                            | 52.00                         | 100%    |
| 84       | MINOR CONCRETE (CROSS-GUTTER AND SPANDREL) | CY    | 30       | 400.00     | 12,000.00                |                        |                      | 30.00                      | 12,000.00                | 30.00                  | 12,000.00            | 30.00             | 30.00                           | 12,000.00                     | 100%    |
| 85       | MINOR CONCRETE (CURB AND GUTTER)           | CY    | 565      | 320.00     | 180,800.00               |                        |                      | 565.00                     | 180,800.00               | 477.00                 | 152,640.00           | 477.00            | 477.00                          | 152,640.00                    | 84%     |
| 86       | MINOR CONCRETE (DRIVEWAY) & CCO 10         | CY    | 100      | 360.00     | 36,000.00                | 35.00                  | 12,600.00            | 135.00                     | 48,600.00                | 128.70                 | 46,682.00            | 128.70            | 128.70                          | 46,682.00                     | 96%     |
| 87       | MINOR CONCRETE (SIDEWALK)                  | CY    | 320      | 485.00     | 155,200.00               |                        |                      | 320.00                     | 155,200.00               | 301.00                 | 146,985.00           | 301.00            | 301.00                          | 146,985.00                    | 94%     |
| 88       | MINOR CONCRETE (BUS PAD)                   | CY    | 35       | 700.00     | 24,500.00                |                        |                      | 35.00                      | 24,500.00                | 35.00                  | 24,500.00            | 35.00             | 35.00                           | 24,500.00                     | 100%    |
| 89       | PF MISCELLANEOUS METAL (BRIDGE)            | LB    | 312      | 10.00      | 3,120.00                 |                        |                      | 312.00                     | 3,120.00                 | 312.00                 | 3,120.00             | 312.00            | 312.00                          | 3,120.00                      | 100%    |
| 90       | PF BRIDGE DECK DRAINAGE SYSTEM             | LB    | 9,435    | 7.00       | 66,045.00                |                        |                      | 9,435.00                   | 66,045.00                | 9,435.00               | 66,045.00            | 9,435.00          | 9,435.00                        | 66,045.00                     | 100%    |
| 91       | PF STEEL RAILING FENCE (7' WIRE MESH)      | LF    | 833      | 260.00     | 216,580.00               |                        |                      | 833.00                     | 216,580.00               | 704.00                 | 183,540.00           | 704.00            | 704.00                          | 183,540.00                    | 100%    |
| 92       | PF STEEL RAILING FENCE (5' WIRE MESH)      | LF    | 416      | 220.00     | 91,520.00                |                        |                      | 416.00                     | 91,520.00                | 384.00                 | 7,040.00             | 384.00            | 416.00                          | 91,520.00                     | 100%    |
| 93       | PF STEEL RAILING FENCE (3')                | LF    | 1,522    | 100.00     | 152,200.00               |                        |                      | 1,522.00                   | 152,200.00               | 1,504.00               | 1,800.00             | 1,504.00          | 1,522.00                        | 152,200.00                    | 100%    |
| 94       | P CHAIN LINK FENCE (TYPE CL-6)             | LF    | 970      | 25.00      | 24,250.00                |                        |                      | 970.00                     | 24,250.00                |                        |                      |                   | 858.00                          | 21,450.00                     | 88%     |
| 95       | P 12' CHAIN LINK GATE (TYPE CL-6) & CCO 7  | EA    | 2        | 4,000.00   | 8,000.00                 | -2.00                  | -8,000.00            |                            |                          |                        |                      |                   |                                 |                               | N/A     |
| 96       | F CONCRETE BARRIER (TYPE 268 MODIFIED)     | LF    | 35       | 100.00     | 3,500.00                 |                        |                      | 35.00                      | 3,500.00                 | 35.00                  | 3,500.00             | 35.00             | 35.00                           | 3,500.00                      | 100%    |
| 97       | P METAL BEAM GUARD RAILING (WOOD POST)     | LF    | 90       | 80.00      | 7,200.00                 |                        |                      | 90.00                      | 7,200.00                 | 80.00                  | 7,200.00             | 80.00             | 90.00                           | 7,200.00                      | 100%    |
| 98       | PF TUBULAR HANDRAILING                     | LF    | 366      | 300.00     | 109,800.00               |                        |                      | 366.00                     | 109,800.00               | 366.00                 | 109,800.00           | 366.00            | 366.00                          | 109,800.00                    | 100%    |
| 99       | F CONCRETE BARRIER (TYPE 26 MODIFIED)      | LF    | 1,604    | 100.00     | 160,400.00               |                        |                      | 1,604.00                   | 160,400.00               | 1,604.00               | 160,400.00           | 1,604.00          | 1,604.00                        | 160,400.00                    | 100%    |
| 100      | P TRANSITION RAILING (TYPE WB)             | EA    | 1        | 500.00     | 500.00                   |                        |                      | 1.00                       | 500.00                   | 1.00                   | 500.00               | 1.00              | 1.00                            | 500.00                        | 100%    |
| 101      | ALTERNATIVE FLARED TERMINAL SYSTEM         | EA    | 1        | 1,000.00   | 1,000.00                 |                        |                      | 1.00                       | 1,000.00                 | 1.00                   | 1,000.00             | 1.00              | 1.00                            | 1,000.00                      | 100%    |
| 102      | CONCRETE BARRIER (TYPE 60SC)               | LF    | 63       | 120.00     | 7,560.00                 |                        |                      | 63.00                      | 7,560.00                 | 63.00                  | 7,560.00             | 63.00             | 63.00                           | 7,560.00                      | 100%    |
| 103      | F CONCRETE BARRIER (TYPE 736)              | LF    | 501      | 70.00      | 35,070.00                |                        |                      | 501.00                     | 35,070.00                | 501.00                 | 35,070.00            | 501.00            | 501.00                          | 35,070.00                     | 100%    |
| 104      | F CONCRETE BARRIER (TYPE 736 MODIFIED)     | LF    | 626      | 70.00      | 43,820.00                |                        |                      | 626.00                     | 43,820.00                | 626.00                 | 43,820.00            | 626.00            | 626.00                          | 43,820.00                     | 100%    |

PROJECT: Airport Blvd. (Avenue 59) at Grapefruit Blvd. (Hwy 111) and Union Pacific Railroad, Grade Separation Project  
 County Project No.: AR-0241, State Aid ID: TCFE-4856(218)  
 Contract No. 13-10-005

Contractor: Granite Construction Company  
 Address: 38000 Monroe Street  
 City, State, Zip: Indio, CA 92203

Estimate No. 32 FINAL  
 From: February 24, 2017  
 To: April 26, 2017



| Item No. | Item Description   | Units | Quantity | Unit Price   | Original Contract Amount | Charge Orders Quantity | Amount | Amended Contract Quantity | Amount       | This Estimate Quantity | Amount     | Previous Quantity | Total Estimate To Date Quantity | Amount       | % Auth. |
|----------|--|-------|----------|--------------|--------------------------|------------------------|--------|---------------------------|--------------|------------------------|------------|-------------------|---------------------------------|--------------|---------|
| 105      | 4" THERMOPLASTIC TRAFFIC STRIPE  | LF    | 39,800   | 0.60         | 23,880.00                |                        |        | 39,800.00                 | 23,880.00    |                        |            | 39,800.00         | 39,800.00                       | 23,880.00    | 100%    |
| 106      | 8" THERMOPLASTIC TRAFFIC STRIPE  | LF    | 2,300    | 1.40         | 3,220.00                 |                        |        | 2,300.00                  | 3,220.00     |                        |            | 2,300.00          | 2,300.00                        | 3,220.00     | 100%    |
| 107      | THERMOPLASTIC PAVEMENT MARKING   | SQFT  | 2,100    | 3.60         | 7,560.00                 |                        |        | 2,100.00                  | 7,560.00     |                        |            | 2,100.00          | 2,100.00                        | 7,560.00     | 100%    |
| 108      | 4" THERMOPLASTIC TRAFFIC STRIPE (BROKEN 17-7)  | LF    | 5,100    | 0.45         | 2,295.00                 |                        |        | 5,100.00                  | 2,295.00     |                        |            | 5,100.00          | 5,100.00                        | 2,295.00     | 100%    |
| 109      | PAVEMENT MARKER (RETROREFLECTIVE)  | EA    | 1,040    | 3.30         | 3,432.00                 |                        |        | 1,040.00                  | 3,432.00     |                        |            | 1,040.00          | 1,040.00                        | 3,432.00     | 100%    |
| 110      | SIGNAL AND LIGHTING (AIRPORT BLVD & POLK ST)   | LS    | 195,000  | 1.00         | 195,000.00               |                        |        | 195,000.00                | 195,000.00   |                        |            | 195,000.00        | 195,000.00                      | 195,000.00   | 100%    |
| 111      | SIGNAL AND LIGHTING (AIRPORT BLVD & PALM ST)   | LS    | 185,000  | 1.00         | 185,000.00               |                        |        | 185,000.00                | 185,000.00   |                        |            | 185,000.00        | 185,000.00                      | 185,000.00   | 100%    |
| 112      | SIGNAL AND LIGHTING (GRAPEFRUIT BLVD & FRONTAGE RD)  | LS    | 150,000  | 1.00         | 150,000.00               |                        |        | 150,000.00                | 150,000.00   |                        |            | 150,000.00        | 150,000.00                      | 150,000.00   | 100%    |
| 113      | SIGNAL AND LIGHTING (GRAPEFRUIT BLVD & PALM ST)  | LS    | 180,000  | 1.00         | 180,000.00               |                        |        | 180,000.00                | 180,000.00   |                        |            | 180,000.00        | 180,000.00                      | 180,000.00   | 100%    |
| 114      | LIGHTING (STREET)  | LS    | 1        | 120,000.00   | 120,000.00               |                        |        | 1.00                      | 120,000.00   |                        |            | 1.00              | 1.00                            | 120,000.00   | 100%    |
| 115      | INTERCONNECTION CONDUIT AND CONDUCTOR  | LS    | 1        | 30,000.00    | 30,000.00                |                        |        | 1.00                      | 30,000.00    |                        |            | 1.00              | 1.00                            | 30,000.00    | 100%    |
| 116      | ITEM DELETED PER ADDENDUM No. 2  | --    | --       | --           | --                       |                        |        |                           |              |                        |            |                   |                                 |              | N/A     |
| 117      | COURSE OF CONSTRUCTION INSURANCE   | LS    | 1        | 10,000.00    | 10,000.00                |                        |        | 1.00                      | 10,000.00    |                        |            | 1.00              | 1.00                            | 10,000.00    | 100%    |
| 118      | MOBILIZATION, DEMOBILIZATION, AND FINAL CLEAN UP   | LS    | 1        | 1,200,000.00 | 1,200,000.00             |                        |        | 1.00                      | 1,200,000.00 | 0.15                   | 180,000.00 |                   | 1.00                            | 1,200,000.00 | 100%    |
| 118A     | RELATIONS WITH RAILROAD (INCLUDING FLAGGING)   | LS    | 1        | 100,000.00   | 100,000.00               |                        |        | 1.00                      | 100,000.00   |                        |            | 1.00              | 1.00                            | 100,000.00   | 100%    |
| 119      | PREMIUM FOR ALL-RISK INSTALLATION FLOATER INSURANCE  | LS    | 1        | 600.00       | 600.00                   |                        |        | 1.00                      | 600.00       |                        |            | 1.00              | 1.00                            | 600.00       | 100%    |
| 120      | WATER TRANSMISSION MAIN MOBILIZATION   | LS    | 1        | 30,000.00    | 30,000.00                |                        |        | 1.00                      | 30,000.00    |                        |            | 1.00              | 1.00                            | 30,000.00    | 100%    |
| 121      | UTILITY POT-HOLING   | LS    | 1        | 20,000.00    | 20,000.00                |                        |        | 1.00                      | 20,000.00    |                        |            | 1.00              | 1.00                            | 20,000.00    | 100%    |
| 122      | FURNISH AND INSTALL A 30-INCH DUCTILE IRON DOMESTIC WATER MAIN   | LF    | 1,185    | 300.00       | 355,500.00               |                        |        | 1,185.00                  | 355,500.00   |                        |            | 1,185.00          | 1,185.00                        | 355,500.00   | 100%    |
| 123      | FURNISH AND INSTALL FIRE HYDRANT ASSEMBLY PER CWVD STD W33A  | EA    | 1        | 10,000.00    | 10,000.00                |                        |        | 1.00                      | 10,000.00    |                        |            | 1.00              | 1.00                            | 10,000.00    | 100%    |
| 124      | FURNISH AND INSTALL 30-INCH DUCTILE IRON BUTTERFLY VALVE AND ALL RELATED APPURTENANCES                     | EA    | 1        | 10,000.00    | 10,000.00                |                        |        | 1.00                      | 10,000.00    |                        |            | 1.00              | 1.00                            | 10,000.00    | 100%    |
| 125      | FURNISH AND INSTALL 6-INCH COMBINATION AIR RELEASE AND VACUUM VALVE PER PLAN AND ALL RELATED APPURTENANCES | EA    | 2        | 12,000.00    | 24,000.00                |                        |        | 2.00                      | 24,000.00    |                        |            | 2.00              | 2.00                            | 24,000.00    | 100%    |

| Item No. | Units | Item Description   | Quantity | Unit Price | Original Contract Amount | Change Orders Quantity | Original Contract Amount | Amended Contract Quantity | Amended Contract Amount | This Estimate Quantity | This Estimate Amount | Previous Quantity | Previous Amount | Total Estimate To Date Quantity | Total Estimate To Date Amount | % Auth.   |             |
|----------|-------|--|----------|------------|--------------------------|------------------------|--------------------------|---------------------------|-------------------------|------------------------|----------------------|-------------------|-----------------|---------------------------------|-------------------------------|-----------|-------------|
|          |       |  |          |            |                          |                        |                          |                           |                         |                        |                      |                   |                 |                                 |                               |           | Contractor: |
| 126      | EA    | 1-INCH WATER SERVICE WITH POLYMER METER BOX WITH BEE PROOF LID   | 1        | 2,000.00   | 2,000.00                 |                        | 2,000.00                 | 1.00                      | 2,000.00                | 1.00                   | 2,000.00             |                   | 2,000.00        | 1.00                            | 2,000.00                      | 100%      |             |
| 127      | LS    | FURNISH ALL LABOR, MATERIALS AND EQUIPMENT FOR ADEQUATE TRENCH AND EXCAVATION, SHEETING, SHORING AND BRACING                 | 1        | 10,000.00  | 10,000.00                |                        | 10,000.00                | 1.00                      | 10,000.00               | 1.00                   | 10,000.00            |                   | 10,000.00       | 1.00                            | 10,000.00                     | 100%      |             |
| 128      | LF    | FURNISH AND INSTALL 8-INCH PVC FORCE MAIN, INCLUDING CONNECTIONS TO EXISTING FORCE MAIN, CONCRETE ENCASEMENT, etc.           | 50       | 1,100.00   | 55,000.00                |                        | 55,000.00                | 50.00                     | 55,000.00               | 50.00                  | 55,000.00            |                   | 55,000.00       | 50.00                           | 55,000.00                     | 100%      |             |
| 129      | LF    | THRUST RESTRAINT, TESTING, TEMPORARY PAVING AND SURFACE RESTORATION NOT INCLUDED IN THE ROAD IMPROVEMENT WORK                | 825      | 150.00     | 123,750.00               |                        | 123,750.00               | 825.00                    | 123,750.00              | 825.00                 | 123,750.00           |                   | 123,750.00      | 825.00                          | 123,750.00                    | 100%      |             |
| 130      | LF    | SLURRY FILL ANNULAR SPACE BETWEEN EXISTING 24-INCH STEEL CASING AND EXISTING 12-INCH PVC FORCE MAIN TO LIMITS SHOWN ON PLAN. | 142      | 75.00      | 10,650.00                |                        | 10,650.00                | 142.00                    | 10,650.00               | 142.00                 | 10,650.00            |                   | 10,650.00       | 142.00                          | 10,650.00                     | 100%      |             |
| 131      | LS    | SHUTDOWN AND DEWATERING OF EXISTING FORCE MAIN   | 1        | 15,000.00  | 15,000.00                |                        | 15,000.00                | 1.00                      | 15,000.00               | 1.00                   | 15,000.00            |                   | 15,000.00       | 1.00                            | 15,000.00                     | 100%      |             |
| 132      | EA    | RELOCATE EXISTING SEWAGE AIR/VACUUM VALVE ASSEMBLY AND VAULT AND EXTEND 2-INCH SCHEDULE 80 PVC PIPE                          | 1        | 5,000.00   | 5,000.00                 |                        | 5,000.00                 | 1.00                      | 5,000.00                | 1.00                   | 5,000.00             |                   | 5,000.00        | 1.00                            | 5,000.00                      | 100%      |             |
| 133      | EA    | FURNISH AND INSTALL 48-INCH DIAMETER SEWER MANHOLE   | 2        | 6,000.00   | 12,000.00                |                        | 12,000.00                | 2.00                      | 12,000.00               | 2.00                   | 12,000.00            |                   | 12,000.00       | 2.00                            | 12,000.00                     | 100%      |             |
| 134      | LF    | FURNISH AND INSTALL 8-INCH PVC SEWER MAIN  | 264      | 50.00      | 13,200.00                |                        | 13,200.00                | 264.00                    | 13,200.00               | 264.00                 | 13,200.00            |                   | 13,200.00       | 264.00                          | 13,200.00                     | 100%      |             |
| 135      | LF    | FURNISH AND INSTALL 4-INCH AND 6-INCH PVC LATERALS   | 182      | 80.00      | 14,560.00                |                        | 14,560.00                | 182.00                    | 14,560.00               | 182.00                 | 14,560.00            |                   | 14,560.00       | 182.00                          | 14,560.00                     | 100%      |             |
| CCO 1    | FA    | PERMITS FEES, DRB AND MISC. EXTRA WORK   | 0        | 1.00       | 0.00                     | 85,000.00              | 85,000.00                | 85,000.00                 | 85,000.00               | 85,000.00              | 85,000.00            |                   | 85,000.00       | 85,000.00                       | 85,000.00                     | 100%      |             |
| CCO 1S1  | FA    | PERMITS FEES, DRB AND MISC. EXTRA WORK   | 0        | 1.00       | 0.00                     | 65,000.00              | 65,000.00                | 65,000.00                 | 65,000.00               | 65,000.00              | 65,000.00            |                   | 65,000.00       | 65,000.00                       | 65,000.00                     | 96%       |             |
| CCO 2    | AP    | UPGRADE SIGNAL POLES   | 0        | 1.00       | 0.00                     | 20,865.78              | 20,865.78                | 20,865.78                 | 20,865.78               | 20,865.78              | 20,865.78            |                   | 20,865.78       | 20,865.78                       | 20,865.78                     | 100%      |             |
| CCO 3    | AP    | DRAINAGE ITEMS   | 0        | 1.00       | 0.00                     | 413,737.00             | 413,737.00               | 413,737.00                | 413,737.00              | 413,737.00             | 413,737.00           |                   | 413,737.00      | 413,737.00                      | 413,737.00                    | 96%       |             |
| CCO 3    | AP    | CREDIT FOR FORM LINER  | 0        | 1.00       | 0.00                     | -2,300.00              | -2,300.00                | -2,300.00                 | -2,300.00               | -2,300.00              | -2,300.00            |                   | -2,300.00       | -2,300.00                       | -2,300.00                     | 100%      |             |
| CCO 4    | FA    | CWMD EXTRA WORK  | 0        | 1.00       | 0.00                     | 4,594.30               | 4,594.30                 | 4,594.30                  | 4,594.30                | 4,594.30               | 4,594.30             |                   | 4,594.30        | 4,594.30                        | 4,594.30                      | 100%      |             |
| CCO 6    | FA    | POST OFFICE DRAINAGE   | 0        | 1.00       | 0.00                     | 50,000.00              | 50,000.00                | 50,000.00                 | 50,000.00               | 50,000.00              | 50,000.00            |                   | 50,000.00       | 50,000.00                       | 50,000.00                     | 92%       |             |
| CCO 7    | AP    | MSE WALL DESIGN CHANGES  | 0        | 1.00       | 0.00                     | 16,514.00              | 16,514.00                | 16,514.00                 | 16,514.00               | 16,514.00              | 16,514.00            |                   | 16,514.00       | 16,514.00                       | 16,514.00                     | 100%      |             |
| CCO 7    | FA    | PLACE PLASTIC SHEETING, INSTALL & REMOVE FENCE, SMOOTH TRANSITION TIE IN   | 0        | 1.00       | 0.00                     | 70,000.00              | 70,000.00                | 70,000.00                 | 70,000.00               | 70,000.00              | 70,000.00            |                   | 70,000.00       | 70,000.00                       | 70,000.00                     | 70,000.00 | 100%        |



Contractor: Granite Construction Company  
 Address: 38000 Monroe Street  
 Irifio, CA 92503

PROJECT: Airport Blvd. (Avenue 56) at Grapefruit Blvd. (Hwy 111) and Union Pacific Railroad, Grade Separation Project  
 County Project No. - A6-0241, State Aid ID: TCFL-6966(216)  
 Contract No. - 13-10-005

Estimate No. 32 FINAL  
 From: February 26, 2017  
 To: April 26, 2017





## LETTER OF TRANSMITTAL

**Local Agency: County of Riverside  
Transportation Department**

**DATE: April 7, 2017**

**File: Airport Blvd. Grade Separation**

**W.O. No.: A6-0241**

**C.C.O.: 15**

**TO: Patricia Romo**

**From: Cindi Wachi**

**\$1,760,403.12 (9.98% of the original contract amount of \$17,646,646.00)**

The Contractor has filed Notices of Potential Claims for several issues in the construction of the Airport Boulevard Grade Separation Project in the Thermal area of the County. After numerous meetings and discussions, this Change Order is the result of negotiations between the parties for closing out the project which includes settlement of all outstanding claims, requests for time extensions, extended field overhead or home office overhead costs, interest, and all cumulative impact on work under the contract.

The amount of \$1,760,403.12 comprises the total settlement due the Contractor (and all subcontractors and suppliers) for all the claims. Contractor expressly waives any other claims related to this project.

The amount of this Contract Change Order is \$1,760,403.12. The accumulation of all Contract Change Orders thus far, including this one, is \$2,915,443.90.

Previous Contract Change Order Amounts Approved:

See C.C.O. History  
(attached)

\$1,155,040.78

MAY 09 2017 3.31

**File: Airport Blvd. Grade Separation**  
**W.O. No.: A6-0241**  
**C.C.O. No. 15**  
**Page 2**

This Contract Change Order was discussed with County staff and they gave concurrence to this change.

Adjustment of Time: 111 Working Days

**ESTIMATE OF COST**

Items  
Force Account  
Agreed Price  
Adjustment  
Settlement 1,760,403.12  
**TOTAL \$1,760,403.12**



**Cindi Wachi**  
**Engineering Division Manger**

| CCO | Amount         | Funding Source    |
|-----|----------------|-------------------|
| 15  | \$1,760,403.12 | 58% CVAG, 42%TCIF |

| CCO Category |                           |   |
|--------------|---------------------------|---|
| AFA          | Anticipated Force Account |   |
| CFC          | Changed Field Condition   | √ |
| CME          | Contract Management Error |   |
| DO           | Design Omission           |   |
| OAM          | Outside Agency Mandate    |   |
| RWO          | Right-of-Way Obligation   |   |
| SE           | Survey Error              |   |
| UB           | Upgrade/Betterment        |   |
| UI           | Utility Interference      |   |



COUNTY OF RIVERSIDE  
TRANSPORTATION DEPARTMENT

SHEET 1 OF 1 SHEETS

Contract Change Order No. 15

CONTRACT: Airport Blvd. Grade Separation

WORK ORDER NO. A6-0241

CALTRANS EA NO.

LOCAL-FED AID NO.

TCIFL-5956(216)

STATE-FED AID NO.

TO: Granite Construction CONTRACTOR: YOU ARE HEREBY DIRECTED TO MAKE THE HEREIN DESCRIBED CHANGES FROM THE PLANS AND SPECIFICATIONS OR DO THE FOLLOWING DESCRIBED WORK NOT INCLUDED IN THE PLANS AND SPECIFICATIONS ON THIS CONTRACT.

Description of work to be done, estimate of quantities and prices to be paid. Segregated between additional work at contract price, agreed price and force account. Unless otherwise stated, rates for rental of equipment cover only such time as equipment is actually used and no allowance will be made for idle time.

Agreed Compensation for Settlement of Claims

The Contractor has presented numerous claims on several issues that arose during the construction of the Airport Boulevard Grade Separation Project in the Thermal area of the County. These issues included differences in railroad flagging, areas of unsuitable subgrade, contended steel spacing issues, claimed out of order construction activities due to clarifications in the architectural treatment of the abutments and MSE walls, issues involving testing results that may have caused delays and a claimed ambiguity in the placement of the fuel resistant fluid proof geomembrane. A large portion of the claimed amount is for costs associated with delays caused to the project by the various items mentioned previously. After a thorough review and analysis of the issues and the costs of a more formal mediation process, the Contractor's Regional Manager and the Director of Transportation came to an agreement on the settlement of these issues. This Change Order includes the settlement of all outstanding claims, requests for time extensions, extended field and home office overhead costs, interest, and all cumulative impacts on and for the work under this contract.

The amount of \$1,760,403.12 comprises the total settlement due the Contractor (and all subcontractors and suppliers) for all claims and work associated with this project. The Contractor expressly waives any other claims, known and unknown, related to this project. This change order and all payment(s) related thereto are made for the purpose of settlement and compromise only; accordingly, agreement to this change order, by either party, does not constitute and should not be construed as an admission of any fault, liability, or wrongdoing by either party, all of which are hereby expressly denied.

Participating: YES:[x] NO:[ ] N/A:[ ]

Estimated Cost: Decrease \$ Increase \$ 1,760,403.12

WE, the undersigned contractor, have given careful consideration to the change proposed and hereby agree that we will provide all equipment, furnish all materials, except as may otherwise be noted above, and perform all services necessary for the work above specified, and will accept as full payment therefor the prices shown above.

By reason of this proposed change 111 days adjustment of time will be allowed.

Accepted Granite Construction 12-21-2016 Date

Approval Recommended 12/20/2016 Date

Approval Recommended Patricia Romo, Director of Transportation 5/1/17 Date

NOTE: This change order is not effective until approved by County. If the Contractor does not sign acceptance of this order, his attention is directed to the requirements of the specifications as to proceeding with the ordered work and filing a written protest with the time therein specified.

Approved JOHN TAVAGLIONE 5/9/17 Date Chairman, Riverside County Board of Supervisors

ATTEST: KECIA HARPER-IFEM, Clerk BY [Signature] DEPUTY

FORM APPROVED COUNTY COUNSEL

BY: MARSHA L. VICTOR 5/1/17 DATE

Airport Blvd (Avenue 56)/Grade Serparation Project  
 Contract CCO History

Contract No. 13-10-005  
 Work Order No. A6-0241  
 Contract Amount \$17,646,646.00  
 Single Maximum CCO \$150,000.00  
 Maximum CCO's \$1,764,664.60

| CCO Category Legend |                           |
|---------------------|---------------------------|
| AFA                 | Anticipated Force Account |
| CFC                 | Changed Field Conditon    |
| CME                 | Contract Management Error |
| DO                  | Design Omission           |
| OAM                 | Outside Agency Mandate    |
| RWO                 | Right-of-Way Obligation   |
| SE                  | Survey Error              |
| UB                  | Upgrade/Betterment        |
| UI                  | Utility Interference      |

| CCO No. | Amount This CCO | Authority | Cumulative CCO's | % Original Authorized | Cumulative CCO % | CCO Category | Classification |
|---------|-----------------|-----------|------------------|-----------------------|------------------|--------------|----------------|
| 1       | \$85,000.00     | Director  | \$85,000.00      | 0.48%                 | 0.48%            | OAM          | Unavoidable    |
| 2       | \$20,865.78     | Director  | \$105,865.78     | 0.12%                 | 0.60%            | CFC          | Unavoidable    |
| 3       | -\$14,962.00    | Director  | \$90,903.78      | -0.08%                | 0.52%            | CFC          | Unavoidable    |
| 4       | \$4,594.30      | Director  | \$95,498.08      | 0.03%                 | 0.54%            | CFC          | Unavoidable    |
| 5       | \$5,771.50      | Director  | \$101,269.58     | 0.03%                 | 0.57%            | CFC          | Unavoidable    |
| 1S1     | \$65,000.00     | Director  | \$166,269.58     | 0.37%                 | 0.94%            | DO           | Avoidable      |
| 6       | \$50,000.00     | Director  | \$216,269.58     | 0.28%                 | 1.23%            | CFC          | Unavoidable    |
| 8       | \$5,584.04      | Director  | \$221,853.62     | 0.03%                 | 1.26%            | OAM          | Unavoidable    |
| 7       | \$93,525.00     | Director  | \$315,378.62     | 0.53%                 | 1.79%            | CFC          | Unavoidable    |
| 9       | \$145,000.00    | Director  | \$460,378.62     | 0.82%                 | 2.61%            | AFA          | Unavoidable    |
| 10      | \$119,390.95    | Director  | \$579,769.57     | 0.68%                 | 3.29%            | CFC          | Unavoidable    |
| 11      | \$110,276.00    | Director  | \$690,045.57     | 0.62%                 | 3.91%            | CFC          | Unavoidable    |
| 9S1     | \$25,000.00     | Director  | \$715,045.57     | 0.14%                 | 4.05%            | AFA          | Unavoidable    |
| 12      | \$144,892.33    | Director  | \$859,937.90     | 0.82%                 | 4.87%            | DO           | Unavoidable    |
| 13      | \$147,000.00    | Director  | \$1,006,937.90   | 0.83%                 | 5.71%            | CFC          | Unavoidable    |
| 14      | \$148,102.88    | Director  | \$1,155,040.78   | 0.84%                 | 6.55%            | CFC          | Unavoidable    |
| 15      | \$1,760,403.12  | Board     | \$2,915,443.90   | 9.98%                 | 16.52%           | CFC          | Unavoidable    |
|         |                 |           | \$2,915,443.90   | 16.52%                |                  |              |                |

New Authorized Contract Total \$20,562,089.90  
 Total CCO Dollars To Date \$2,915,443.90  
 Total % Increased by CCO's 16.52%

PLEASE COMPLETE THIS INFORMATION  
RECORDING REQUESTED BY:

KECIA HARPER-IHEM, CLERK OF THE BOARD  
RIVERSIDE CO. CLERK OF THE BOARD  
4080 LEMON STREET, 1ST FLOOR CAC  
P O BOX 1147 - RIVERSIDE, CA 92502

MAIL STOP # 1010

AND WHEN RECORDED MAIL TO:

RETURN TO: STOP #1010  
RIVERSIDE COUNTY CLERK OF THE BOARD  
P. O. BOX 1147 - RIVERSIDE, CA 92502

2017-0187686

05/10/2017 03:41 PM

\*\*\*Customer Copy Label\*\*\*

The paper to which this label is affixed  
has not been compared with the  
filed/recorded document

Peter Aldana  
County Of Riverside  
Assessor-County Clerk-Recorder

THIS SPACE FOR RECORDERS USE ONLY

NOTICE OF COMPLETION

To be recorded with County Recorder  
within 10 days after completion.  
No recording fee.

Notice is hereby given by the undersigned owner, a public entity of the State of California, that a public work of  
improvement has been completed, as follows:

Project title or description of work: Airport Boulevard (Avenue 56) Grade Separation Project

Date of Completion: Date of this notice 05/09/17

Nature of owner: County of Riverside, public entity

Interest or estate of owner: Public Roadway

Address of owner: 4080 Lemon Street, 8th Floor, Riverside, CA 92501

Name of contractor: Granite Construction Company

Street or legal description of site: Airport Boulevard at Grapefruit Boulevard (Hwy 111) and Union Pacific Railroad  
Project Number A6-0241, Township3S Range 6W County Road Book Page No.  
223-A

Dated: May 9, 2017

Owner: County of Riverside  
(Name of Public Entity)

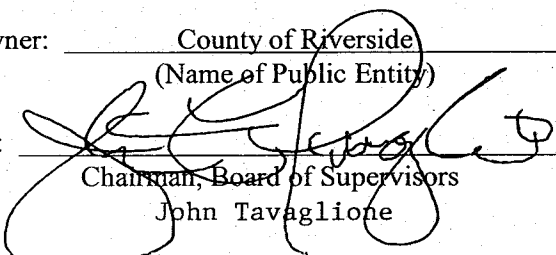
By:   
Chairman, Board of Supervisors  
John Tavaglione

STATE OF CALIFORNIA )

ss

COUNTY OF RIVERSIDE )

I am the Chairman of the governing board of the County of Riverside, the public entity which executed the  
foregoing notice and on whose behalf I make this verification; I have read this notice, know its contents, and the same is  
true. I certify under penalty of perjury that the foregoing is true and correct.

Executed at Riverside, California on 05/09/17 (Date)

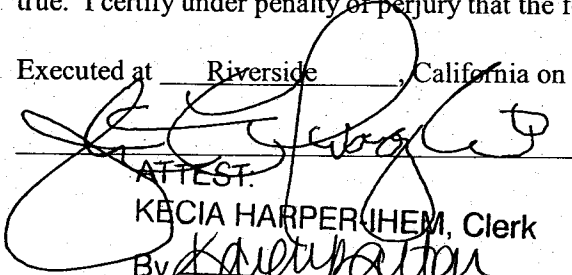
  
\_\_\_\_\_, Chairman of the Board of Supervisors  
John Tavaglione

ATTEST.

KECIA HARPER-IHEM, Clerk

By:   
\_\_\_\_\_  
DEPUTY

COPY



**PETER ALDANA**  
**COUNTY OF RIVERSIDE**  
**ASSESSOR-COUNTY CLERK-RECORDER**

**Recorder**  
P.O. Box 751  
Riverside, CA 92502-0751  
(951) 486-7000

www.riversideacr.com

**CERTIFICATION**

Pursuant to the provisions of Government Code 27361.7, I certify under the penalty of perjury that the following is a true copy of illegible wording found in the attached document:

(Print or type the page number(s) and wording below):

CLARIFICATION OF THE SEAL for the Riverside County Board of Supervisors.  
(embossed on document)

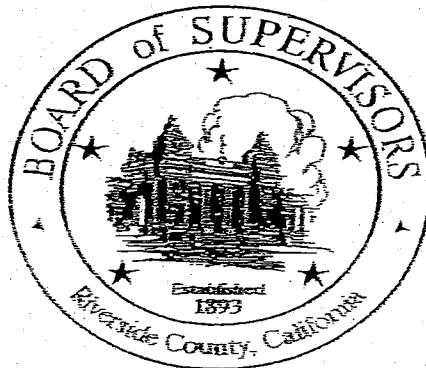

Date:

5-9-17

Signature:

*Karen Barton*

Print Name:

Karen Barton, Board Assistant, Riverside County Clerk of the Board