



COUNTY OF RIVERSIDE TRANSPORTATION AND LAND MANAGEMENT AGENCY



Juan C. Perez, P.E., T.E.
Director of Transportation

Transportation Department

ADDENDUM NUMBER 2

Dated August 22, 2017

to the
Specifications and Contract Documents
for the construction of

Grapefruit Boulevard/ SR-111 and 4th Street
Pedestrian and Roadway Improvement Project; and
4th Street Sidewalk Crossing UPRR Tracks
In the Community of Mecca
Project No. C5-0077, C5-0085
Federal Project No. ATPL- 5956(247)

Bids Due: Wednesday, August 30, 2017; 2:00 PM
14th Street Transportation Annex
3525 14th Street; Riverside, CA 92501
(951) 955-6780

This Addendum is issued pursuant to the Instructions to Bidders, Item No. 8, of the Contract Documents for the reference project. This Addendum is issued as a supplement to the specification and special provisions for the referenced project. The revisions to the specifications shall become a part of the Contract Documents, and each bidder shall acknowledge receipt thereof on the Bid (Proposal). Bidders are directed to sign this addendum as acknowledged, and attach the signed addendum to the contractor's submitted proposal.

Note: During the advertisement period of this project, this document and attachments (if any) are available upon request at the office of the Transportation Department, and are available as a free download at the Transportation Department's website:

<http://rctlma.org/trans/Contractors-Corner/Notices-Inviting-Bids>

MODIFICATIONS / CLARIFICATIONS TO SPECIAL PROVISIONS:

Item 1: Revised Proposal.

Refer to "Proposal" pages B2-B5. Proposal pages B2 through B5 are deleted and replaced with revised Proposal issued with this addendum as **Attachment "A"**. The following changes have been made to the Proposal:

- a. The quantities of following bid items has been revised.
 - Item 8, "Minor Concrete (Retaining/Warning Curb)"
 - Item 26, "Roadway Excavation"

- Item 31, "Subgrade Enhancement Fabric (Geogrid 1-Layer)
 - Item 32, "Tackifier (Soil Stabilizer)
 - Item 33, "Class 2 Aggregate Base
 - Item 34, "Hot Mix Asphalt (Type A)
 - Item 35, "Polymer Modified Hot Mix Asphalt
 - Item 39, "Cold Mill AC Pavement
 - Item 64, "6" Thermoplastic Traffic Stripe (White)
 - Item 65, "8" Thermoplastic Traffic Stripe (White))
 - Item 69, "12" Rumble Strip (Asphalt Concrete Pavement)
 - Item 71, "Traffic Pullboxes (Per Caltrans Std. ES-8B)
 - Item 80, "Micro-Surfacing
- b. The following bid item has been deleted from Base Bid Schedule A:
- Item 4, "Place Asphalt Concrete Dike (CRS 212) (4")"
 - Item 70, "Traffic Pullboxes"
- c. The following bid item has been added to Base Bid Schedule A:
- Item 74A, "Cable Railing"

Note1: The title of base bid schedule (Pedestrian and Roadway Improvement Project) has been revised to Base Bid schedule "A" and, alternate bid schedule 1 (4th Street Sidewalk Crossing UPRR Tracks) has been revised to Base Bid Schedule "B".

Note 2: The basis of the selection of the lowest bid will be the lowest responsive and responsible bid for the sum of all bid schedules.

See Attachment "A" Revised Proposal

Item 2: General Table of Contents.

Refer to General Table of Contents (first page of Bid Book) Following correction has been made and made part thereof.

~~County Of Riverside Transportation Department Contractor Job
Mix Formula Proposal~~

Appendix H

Appendix "H" is a duplication of Appendix "E", therefore cross out Appendix H

Item 3: Federal Prevailing Wages Decision.

Refer to Appendix C entitled "Federal Prevailing Wages Decision", pages 1 through 21. Delete and replace these pages with the following:

Federal wage determination, General Decision No. CA170036-CA36, Modification No. 13, dated **08/04/2017**, shall apply to this project. This document is available upon request from the Transportation Department: (951) 955-6780, and also posted on following County website: **See Attachment "B"**

<http://rctlma.org/trans/Contractors-Corner/Notices-Inviting-Bids>

Item 4: Section 2, Bidding.

Refer to Section 2 Bidding, and subsection 2-1.06B, "Supplemental Project Information" on page 18 of the Bid Book. Item 2, California Department of Fish and Wildlife, Streambed Alteration Permit 1600 was included in the Bid Book as Appendix "F" and item 3, California Regional Water Quality Control Board Water Quality Certification, Permit 401 was included in the Bid Book as Appendix G. Following additional Supplemental information is being provided by this addendum and made part thereof.

4. California Department of Fish and Game Streambed Alteration Notification.
5. Cross Sections

Item 5: Environmental Stewardship.

Refer to Section, "Environmental Stewardship" on page 32 of the Bid Book. Following additional information is add and made part thereof:

The 401 Certification provisions for ESA fencing will be reviewed by a biological monitor and the pre-construction bat roost assessment will also be completed by a Biologist obtained by the County. As referenced in Appendix F; the measures described in "Section 12" are "Biological Measures" that are located in the California Department of Fish and Wildlife (CDFW) Notification of Lake or Streambed Alternation Permit Application on pages 12, 13 and 14.

Refer to County website link shown below for the copy of California Department of Fish and Wildlife (CDFW) Notification as Supplemental Project Information.

<http://rctlma.org/trans/Contractors-Corner/Notices-Inviting-Bids>

Item 6: Clearing and Grubbing.

Refer to Section, 17-2.01 General, Clearing and Grubbing on page 34 and section 17-2.04 Payment on page 35 of the Bid Book. Following additional provision is add and made part thereof:

Full compensation for clearing and grubbing of the Construction Staging Area as shown on the plan shall be considered as included in the lump sum bid price paid for Clearing and Grubbing and no additional compensation will be allowed.

Item 7: Section 39, Asphalt Concrete.

Refer to Section 39 Asphalt Concrete of Special Provisions on page 50-59 of the Bid Book. Following Special Provisions sections are being added and made part thereof.

39-2.01(1c.7a) HMA Production

The HMA construction process shall comply with the provisions of Section 39 of the Standard Specification, the provisions of these Special Provisions.

Contractor shall determine the in-place density and relative compaction of HMA pavement in accordance with the procedures of California Test 375. The Contractor shall use California Test 308, Method A, in determining in-place density of each density core instead of using the nuclear gauge in Part 4, "Determining In-Place Density by the Nuclear Density Device." The Contractor shall use California Test 309 to determine the maximum theoretical density instead of calculating test maximum density in Part 5, "Determining Test Maximum Density" and shall be at the frequency specified for Test Maximum Density under California Test 375, Part 5D. Relative compaction is required for HMA Type A, and shall be reported at various pave thicknesses as listed in the following table:

HMA Relative Compaction Requirements

HMA	Minimum Pave Thickness (ft)	Relative Compaction (%)
Type A, (3/4-inch)	0.15	91-97

The contractor shall submit a quality control plan with the proposed HMA mix design in accordance with Section 39-2.01A(3)(c), "Quality Control Plan."

The Contractor shall perform quality control sampling and testing at the specified frequency for the quality characteristics shown in the following table:

Quality characteristic	Test method	Minimum sampling and testing frequency	HMA Type		
			A	C	RHMA-G
Aggregate gradation ^a	California Test 202	1 per 750 tons and any remaining part	JMF ± Tolerance ^b	JMF ± Tolerance ^b	JMF ± Tolerance ^b
Sand equivalent (min) ^c	California Test 217		47	47	47
Asphalt binder content (%)	California Test 379 or 382		JMF ± 0.45	JMF ± 0.45	JMF ± 0.50
HMA moisture content (% max)	California Test 226 or 370	1 per 1,500 tons but not less than 1 per paving day	1.0	1.0	1.0
Percent of maximum theoretical density (%) ^{d, e}	QC plan	1 per day's production (min.)	91-97	91-97	91-97
Stabilometer value (min) ^{c, f} 1/2" and 3/4" gradings 1" gradings	California Test 366	One per 1,500 tons or 2 per 5 business days, whichever is greater	37	--	23
			--	37	--
Air void content (%) ^{c, g}	California Test 367		4 ± 2	5 ± 2	
Aggregate moisture content at continuous mixing plants and RAP moisture content at continuous mixing plants and batch mixing plants ^h	California Test 226 or 370	2 per day during production	--	--	--
Percent of crushed particles coarse aggregate (% min) One fractured face Two fractured faces Fine aggregate (% min) (Passing no. 4 sieve and retained on no. 8 sieve.) One fractured face	California Test 205	As designated in the QC plan. At least once per project.	90	90	--
			75	95	90
			70	90	70
Los Angeles Rattler (% max) Loss at 100 rev.	California Test 211		12 45	12 40	12 40

Loss at 500 rev.						
Flat and elongated particles (% max by weight @ 5:1)	California Test 235		Report only	10	Report only	
Fine aggregate angularity (% min)	California Test 234		45	45	45	
Voids filled with asphalt (%) ^j 1/2" grading 3/4" grading 1" grading	California Test 367	As designated in the QC plan. At least once per project.	65.0–75.0 65.0–75.0	60.0–70.0	Report only	
Voids in mineral aggregate (% min) ^j 1/2" grading 3/4" grading 1" grading	California Test 367		14.0 13.0	13.0	18.0-23.0 ^k 18.0-23.0 ^k	
Dust proportion ⁱ 1/2" and 3/4" gradings 1" grading	California Test 367		0.6–1.3	0.6–1.3	Report only	
Smoothness	Section 39-1.12		--	12-foot straight-edge, must grind, and Pl ₀	12-foot straight-edge, must grind, and Pl ₀	12-foot straight-edge, must grind, and Pl ₀
Asphalt rubber binder viscosity @ 350 °F, centipoises	Section 39-1.02D		Section 39-1.04C	--	--	1,500-4,000
Asphalt modifier	Section 39-1.02D	Section 39-1.04C	--	--	Section 39-1.02D	
CRM	Section 39-1.02D	Section 39-1.04C	--	--	Section 39-1.02D	

^a Determine combined aggregate gradation containing RAP under California Test 367.

^b The tolerances must comply with the allowable tolerances in section 39-1.02E.

^c Report the average of 3 tests from a single split sample.

^d Required for HMA Type A, Type C, and RHMA-G if the specified paved thickness is at least 0.15 foot.

^e Determine maximum theoretical density (California Test 309) at the frequency specified for Test Maximum Density under California Test 375, Part 5.D.

^f California Test 304, Part 2.13.

^g Determine the bulk specific gravity of each lab-compacted briquette under California Test 308, Method A, and theoretical maximum specific gravity under California Test 309.

^h For adjusting the plant controller at the HMA plant.

ⁱ Report only if the adjustment for the asphalt binder content TV is less than or equal to ±0.3 percent from OBC value.

^j Voids in mineral aggregate for RHMA-G must be within this range.

For any single quality characteristic except smoothness, if 2 consecutive quality control test results do not comply with the action limits or specifications:

1. Stop production.
2. Notify the Engineer.
3. Take corrective action.
4. Demonstrate compliance with the specifications before resuming production and placement.

39-2.01(1c.7b) Acceptance Criteria

The Engineer shall accept HMA based on compliance with the in place HMA quality requirements shown in the following table:

HMA Acceptance In Place

Quality characteristic	Test method	HMA type					
		A	B	RHMA-G			
Aggregate gradation ^a	California Test 202	JMF ± tolerance ^c	JMF ± tolerance ^c	JMF ± tolerance ^c			
Sieve					3/4"	1/2"	3/8"
1/2"					X ^b		
3/8"						X	
No. 4							X
No. 8					X	X	X
No. 200	X	X	X				
Sand equivalent (min) ^d	California Test 217	47	42	47			
Asphalt binder content (%)	California Test 379 or 382	JMF ± 0.45	JMF ± 0.45	JMF ± 0.50			
HMA moisture content (% max)	California Test 226 or 370	1.0	1.0	1.0			
Percent of maximum theoretical density (%) ^{e, f}	California Test 375	91–97	91–97	91–97			
Stabilometer value (min) ^{d, g} No. 4 and 3/8" gradings 1/2" and 3/4" gradings	California Test 366	30	30	--			
		37	35	23			
Air void content (%) ^{d, h}	California Test 367	4 ± 2	4 ± 2	TV ± 2			
Percent of crushed particles Coarse aggregate (% min) One fractured face Two fractured faces Fine aggregate (% min) (Passing no. 4 sieve and retained on no. 8 sieve.) One fractured face	California Test 205	90	25	--			
		75	--	90			
		70	20	70			
Los Angeles Rattler (% max) Loss at 100 rev. Loss at 500 rev.	California Test 211	12	--	12			
		45	50	40			
Fine aggregate angularity (% min)	California Test 234	45	45	45			
Flat and elongated particles (% max by weight @ 5:1)	California Test 235	Report only	Report only	Report only			
Voids filled with asphalt (%) ⁱ No. 4 grading 3/8" grading 1/2" grading 3/4" grading	California Test 367	76.0–80.0	76.0–80.0	Report only			
		73.0–76.0	73.0–76.0				
		65.0–75.0	65.0–75.0				
		65.0–75.0	65.0–75.0				
Voids in mineral aggregate (% min) ⁱ No. 4 grading 3/8" grading 1/2" grading 3/4" grading	California Test 367	17.0	17.0	--			
		15.0	15.0	--			
		14.0	14.0	18.0–23.0 ^j			
		13.0	13.0	18.0–23.0 ^j			
Dust proportion ⁱ No. 4 and 3/8" gradings 1/2" and 3/4" gradings	California Test 367	0.9–2.0	0.9–2.0	Report only			
		0.6–1.3	0.6–1.3				
Smoothness	Section	12-foot	12-foot	12-foot straight-edge,			

	39-1.12	straight- edge, must grind, and P ₁₀	straight- edge, must grind, and P ₁₀	must grind, and P ₁₀
Asphalt binder	Various	Section 92	Section 92	Section 92
Asphalt rubber binder	Various	--	--	Section 92-1.01D(2) and section 39-1.02D
Asphalt modifier	Various	--	--	Section 39-1.02D
CRM	Various	--	--	Section 39-1.02D

^a The Engineer determines combined aggregate gradations containing RAP under California Test 367.

^b "X" denotes the sieves the Engineer tests for the specified aggregate gradation.

^c The tolerances must comply with the allowable tolerances in section 39-1.02E.

^d The Engineer reports the average of 3 tests from a single split sample.

^e The Engineer determines percent of maximum theoretical density if the specified paved thickness is at least 0.15 foot under California Test 375, except the Engineer uses:

1. California Test 308, Method A, to determine in-place density of each density core instead of using the nuclear gauge in Part 4, "Determining In-Place Density By The Nuclear Density Device."
2. California Test 309 to determine maximum theoretical density instead of calculating test maximum density in Part 5, "Determining Test Maximum Density."

^f The Engineer determines maximum theoretical density (California Test 309) at the frequency specified for Test Maximum Density under California Test 375, Part 5.D.

^g California Test 304, Part 2.13.

^h The Engineer determines the bulk specific gravity of each lab-compacted briquette under California Test 308, Method A, and theoretical maximum specific gravity under California Test 309.

ⁱ Report only if the adjustment for the asphalt binder content TV is less than or equal to ± 0.3 percent from the OBC value submitted on a *Contractor Hot Mix Asphalt Design Data* form.

^j Voids in mineral aggregate for RHMA-G must be within this range.

No single test result may represent more than 750 tons or 1 day's production, whichever is less.

For any single quality characteristic except smoothness, if 2 consecutive acceptance test results do not comply with the specifications:

1. Stop production.
2. Take corrective action.
3. Take samples and split each sample into 4 parts in the Engineer's presence. Test 1 part for compliance with the specifications and submit 3 parts to the Engineer. The Engineer tests 1 part for compliance with the specifications and reserves and stores 2 parts.
4. Demonstrate compliance with the specifications before resuming production and placement.

Item 8: Section 51, Concrete Structures.

Refer to payment clause section "51-1.04 Payment" on page 61 and 62 of the Bid Book. The following Special Provisions are added and made part thereof:

Method of Payment

The quantity of 12" class 2 aggregate base where required by the Special Provisions to place under the concrete structures shall be considered as included in the bid item entitled "CLASS 2 AGREGATE BASE" and bidders shall NOT include quantity of

aggregate base in the per unit price bid for the related bid item.

Item 9: Section 73, Concrete Curbs and Sidewalks.

Refer to payment clause section "73-1.04 Payment" on page 64 of the Bid Book. The following Special Provisions are added and made part hereof:

Method of Payment

The quantity of 12" class 2 aggregate base where required by the Special Provisions to place under concrete structures shall be considered as included in the bid item entitled "CLASS 2 AGREGATE BASE" and bidders shall NOT include quantity of aggregate base in the per unit price bid for the related bid item.

Item 10: Section 83, Railing and Barriers.

Refer to payment clause section "83-2.01B(4) Payment" on page 70 of the Bid Book. The following Special Provisions are added and made part hereof:

Method of Payment

The quantity of 12" class 2 aggregate base where required by the Special Provisions to place under concrete structures shall be considered as included in the bid item entitled "CLASS 2 AGREGATE BASE" and bidders shall NOT include quantity of aggregate base in the per unit price bid for the related bid item. However the payment of furnishing and placing 6-mil visqueen under the aggregate base where required by the Special Provisions shall be considered as included in the unit bid price of related bid item.

Item 11: Section 87, Electrical Systems.

Refer to payment clause section "EE Payment Method" on page 113 of the Bid Book. The following Special Provisions are added and made part hereof:

Method of Payment

The quantity of 12" class 2 aggregate base where required by the Special Provisions to place under concrete structures shall be considered as included in the bid item entitled "CLASS 2 AGREGATE BASE" and bidders shall NOT include quantity of aggregate base in the bid price for the related bid item. However the payment of furnishing and placing 6-mil visqueen under the aggregate base where required by the Special Provisions shall be considered as included in the lump sum bid price for Signal and Lighting.

Item 12: Order of Work.

The following Special Provisions are added and made part hereof:

ORDER OF WORK:

The County of Riverside is in the process of securing an agreement with Union Pacific

Railroad Company (UPRR) for the acquisition of right-of-way and temporary access onto UPRR property specifically for the construction of sidewalk improvements in the immediate vicinity of the railroad tracks on 4th Street, as shown on Sheet 33 of the improvement plans.

The UPRR agreement is expected to be executed during the final one month of the construction period allowed for the project. Therefore, the construction of sidewalk improvements in the immediate vicinity of the railroad tracks on 4th Street will be the last order of work on the project. In addition, the Contractor shall provide a 3-week window for UPRR to install concrete panel extensions and to reset the rails prior to the Contractor's final construction of sidewalk improvements over the tracks.

Due to the unavailability of access to UPRR property prior to the execution of the UPRR agreement, the Contractor shall construct the concrete bridge structure, roadway, other sidewalk and associated improvements of the project without access onto UPRR property.

Item 13: Traffic Requirements

The following Special Provisions are added and made part hereof:

TRAFFIC REQUIREMENTS:

Contractor shall maintain one lane of travel in each direction on all roadways. It should be noted that 4th Street between Grapefruit Blvd and Hammond Road is the primary access point used by motorists into the downtown community of Mecca. In addition, Sunline Transit Agency utilizes bus routes on 4th Street several times a day. No closure of 4th Street will be permitted.

The County of Riverside has secured a parent encroachment permit from Caltrans for work within state highway right-of-way along State Route 111 south of 66th Avenue and along 66th Avenue (also known as State Route 195) west of State Route 111. The parent encroachment permit and the traffic control plans submitted as part of the parent encroachment permit are available for reference by clicking on the link below. The Contractor shall have traffic control plans prepared by a registered civil engineer in accordance with Section 12 of the special provisions and as required by Caltrans to secure a duplicate encroachment permit. **See Attachment "C and D"**

Payment:

Full compensation for complying with the Traffic Control requirements stated herein shall be considered as included in the contract lump sum price paid for Traffic Control System and no additional compensation will be allowed therefor.

<http://rctlma.org/trans/Contractors-Corner/Notices-Inviting-Bids>

Item 14: Conceptual Construction Staging Exhibit.

The following Special Provisions are added and made part hereof:

Construction staging exhibits are attached for Contractor's information only. The construction staging exhibits shall not be construed as a required or preferred construction method or sequence. The Contractor shall be responsible for preparing their own construction staging and traffic handling plan according to his specific construction sequence and work requirements and shall comply with all conditions of the specifications for standards, safety, maintenance of traffic, and requirements of the reviewing agencies. The exhibits may be downloaded at the website shown below.

<http://rctlma.org/trans/Contractors-Corner/Notices-Inviting-Bids>

See Attachment "E AND F"

MODIFICATIONS / CLARIFICATIONS TO THE PLANS

Item 15: Construction Note 21.

Refer construction plan file 964-DD; Construction Note 21 has been revised to call out Caltrans Standard A77L1 instead of A77L2, see below:

Note# 21: INSTALL MIDWEST GUARDRAIL SYSTEM PER CALTRANS STD A77L1

Item 16: Rumble Strip.

Contractor shall construct a rumble strip along the centerline of Grapefruit Boulevard from Sta. 62+47 to 72+68. The additional quantity has been included in the Revised Proposal.

Item 17: Plan Sheet C-4 (13 of 34)- Retaining/Warning Curb Detail

Refer Retaining/Warning Curb Detail at lower left corner of plan sheet C-4 (13 of 34), The base width of the Retaining/Warning curb is 10".

This addendum has been prepared under the direction of the following registered Civil Engineer(s):

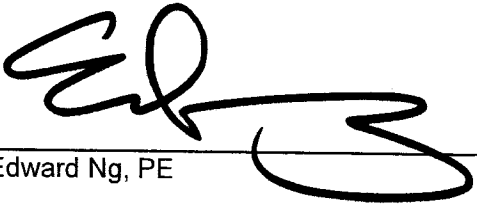

Edward Ng, PE

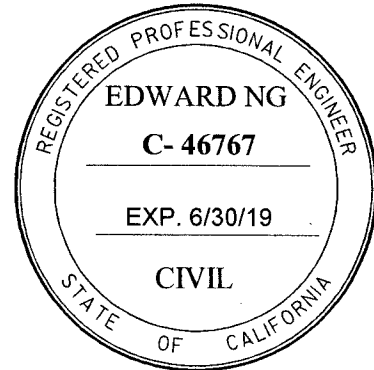

Recommended by:

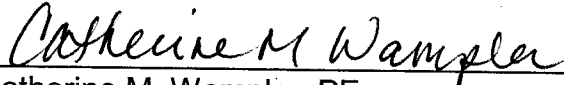

Catherine M. Wampler, PE
County Project Manager

Concurrence:

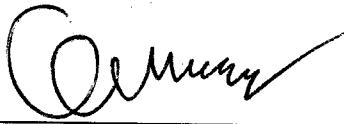
 8/22/17

Khalid Nasim, PE
Engineering Division Manager

Acknowledged: _____ **Date:** _____
(Contractor)

JRJ:jrj:sb

Note: Refer to Instruction to Bidders Item No. 8, "Addenda". Submission of all addendum pages and non-bidding document attachments of addendum are not necessary for Bid submittal. Submittal of this acknowledgement page is adequate for Bid reception. Bidders are reminded to list addendum number(s) received on the first page of the Bid form (Proposal).

ATTACHMENTS

A – Revised Proposal (4 Pages)

B – Federal Wages (20 Pages)

C – Caltrans Encroachment Permit (7 Pages)

D – Traffic Control Plan (3 sheets)

E – Conceptual Construction Staging (Bridge Construction) (3 Pages)

F – Conceptual Construction Staging (Pavement Construction) (12 Pages)

**Grapefruit Boulevard/ SR-111 and 4th Street
Pedestrian and Roadway Improvement Project; and
4th Street Sidewalk Crossing UPRR Tracks
In the Community of Mecca
Project No. C5-0077, C5-0085
Federal Project No. ATPL- 5956(247)**

PROPOSAL (REVISED)

BASE BID SCHEDULE A (Pedestrian and Roadway Improvement Project)

ITEM No.	ITEM CODE	ITEM	UNIT	Like Bid Item*	ESTIMATED QUANTITY	ITEM PRICE (IN FIGURES)	TOTAL (IN FIGURES)
1	000003	TEMPORARY CONSTRUCTION PROJECT FUNDING IDENTIFICATION SIGN	EA		2		
2	011503	UNDER SIDEWALK DRAIN CAST IN PLACE (CRS 309)	EA		1		
3	013902	ASPHALT CONCRETE OVERSIDE DRAIN (CRS 306)	EA		2		
4	-----	ITEM DELETED BY ADDENDUM	-----		-----	-----	-----
5	017300 A	MINOR CONCRETE (AC OVERSIDE DRAIN ENDWALL)	LS		1		
6	017304	MINOR CONCRETE (CURB AND GUTTER) (CRS 200 - 6")	LF	Like 1	230		
7	017315	MINOR CONCRETE (CURB RAMP) (CRS 403 - CASE A)	EA		1		
8	017318 A	MINOR CONCRETE (RETAINING/WARNING CURB)	LF		160		
9	017319 A	MINOR CONCRETE (CONCRETE WALK SLAB)	EA		1		
10	018202 A	REPLACE WOOD POST W/ NEW STEEL POST	EA		5		
11	100100	DEVELOP WATER SUPPLY	LS		1		
12	120100	TRAFFIC CONTROL SYSTEM	LS		1		
13	120159	TEMPORARY TRAFFIC STRIPE (PAINT)	LS		1		
14	128601	TEMPORARY SIGNAL SYSTEM	LS		1		
15	130210 A	WATER POLLUTION CONTROL	LS		1		
16	150310	RAPID SETTING CONCRETE (PATCH)	CF		10		
17	150312	REPAIR SPALLED SURFACE AREA	SQFT		140		
18	153223	REMOVE UNSOUND CONCRETE	CF		10		
19	153225	PREPARE CONCRETE BRIDGE DECK SURFACE	SQFT		1,300		
20	153233 F	TREAT BRIDGE DECK	SQFT		1,300		
21	153234	FURNISH BRIDGE DECK TREATMENT MATERIAL	GAL		25		
22	157560	BRIDGE REMOVAL (PORTION)	LS		1		
23	160120 A	TEMPORARY FENCE (TYPE ESA)	LF		1,230		
24	170103	CLEARING AND GRUBBING	LS		1		
25	180110 A	DUST ABATEMENT	LS		1		

* NOTE: See Instructions to Bidders, Section 24 "Like Bid Items", on page A18; corrections will apply if Like Bid items cost discrepancies are submitted.

PROPOSAL (REVISED)**BASE BID SCHEDULE A (Pedestrian and Roadway Improvement Project)**

ITEM No.	ITEM CODE	ITEM	UNIT	Like Bid Item*	ESTIMATED QUANTITY	ITEM PRICE (IN FIGURES)	TOTAL (IN FIGURES)
26	190101 F	ROADWAY EXCAVATION	CY	Like 2	2,900		
27	190155 A	REGRADE CHANNEL	LS		1		
28	192025 F	STRUCTURE EXCAVATION (CULVERT)	CY		310		
29	193004 F	STRUCTURE BACKFILL (CULVERT)	CY		240		
30	198010 F	IMPORTED BORROW	CY		50		
31	198200	SUBGRADE ENHANCEMENT FABRIC (GEOGRID 1-LAYER)	SQYD		140		
32	2102000	TACKIFIER (SOIL STABILIZER)	SQFT		77,520		
33	260203	CLASS 2 AGGREGATE BASE	CY	Like 3	1,900		
34	390132	HOT MIX ASPHALT (TYPE A)	TON		2,550		
35	390132M	POLYMER MODIFIED HOT MIX ASPHALT	TON	Like 4	1,110		
36	394074	PLACE HMA DIKE (TYPE C)	LF		40		
37	394077	PLACE HMA DIKE (TYPE F)	LF		450		
38	394096 A	HMA SIDEWALK RAMP	SQYD		8		
39	398200	COLD MILL AC PAVEMENT	SQYD		7,100		
40	510090 F	STRUCTURAL CONCRETE, BOX CULVERT	CY		140		
41	511106	DRILL AND BOND DOWEL	LF		11		
42	519102	JOINT SEAL (TYPE AL)	LF		55		
43	520107 P-F	BAR REINFORCING STEEL (BOX CULVERT)	LB		40,030		
44	721017 F	ROCK SLOPE PROTECTION (FACING, METHOD B)	CY		40		
45	731521	MINOR CONCRETE (SIDEWALK) (CRS 401)	SQFT	Like 5	1,300		
46	750501 P-F	MISCELLANEOUS METAL (BRIDGE)	LB		317		
47	810170	DELINEATOR (CLASS I)	EA		3		
48	810230 P	PAVEMENT MARKER (RETROREFLECTIVE)	EA		560		
49	820231 A	REMOVE/ SALVAGE SIGN	EA		8		
50	820610	RELOCATE ROADSIDE SIGN	EA		15		
51	820840	ROADSIDE SIGN - ONE POST (WOOD)	EA		7		
52	820841 A	ROADSIDE SIGN - ONE POST (STEEL)	EA		5		
53	820860	INSTALL SIGN (STRAP AND SADDLE BRACKET METHOD)	EA	Like 6	4		
54	820880	INSTALL SIGN (MAST-ARM HANGER METHOD)	EA		3		

* NOTE: See Instructions to Bidders, Section 24 "Like Bid Items", on page A18; corrections will apply if Like Bid items cost discrepancies are submitted.

PROPOSAL (REVISED)

BASE BID SCHEDULE A (Pedestrian and Roadway Improvement Project)

ITEM No.	ITEM CODE	ITEM	UNIT	Like Bid Item*	ESTIMATED QUANTITY	ITEM PRICE (IN FIGURES)	TOTAL (IN FIGURES)
55	832007 P	MIDWEST GUARDRAIL SYSTEM (WOOD POST)	LF		670		
56	832070	VEGETATION CONTROL (MINOR CONCRETE)	SQYD		170		
57	833090 P-F	TUBULAR HANDRAILING (MODIFIED)	LF		35		
58	839543 P	TRANSITION RAILING (TYPE WB-31)	EA		1		
59	839585	ALTERNATIVE FLARED TERMINAL SYSTEM	EA		1		
60	839725 F	CONCRETE BARRIER (TYPE 736)	LF		65		
61	839726 F	CONCRETE BARRIER (TYPE 736A)	LF		40		
62	840503 A	4" THERMOPLASTIC TRAFFIC STRIPE (YELLOW)	LF		9,000		
63	840504	4" THERMOPLASTIC TRAFFIC STRIPE (WHITE)	LF		7,000		
64	840505	6" THERMOPLASTIC TRAFFIC STRIPE (WHITE)	LF		3,350		
65	840506	8" THERMOPLASTIC TRAFFIC STRIPE (WHITE)	LF		5,640		
66	840515	THERMOPLASTIC PAVEMENT MARKING	SQFT	Like 7	1,070		
67	840519	12" THERMOPLASTIC CROSSWALK AND PAVEMENT MARKING	SQFT		1,250		
68	846020	REMOVE PAINTED TRAFFIC STRIPE	LS		1		
69	846051	12" RUMBLE STRIP (ASPHALT CONCRETE PAVEMENT)	STA		40		
70	-----	ITEM DELETED BY ADDENDUM	---		---	---	---
71	860201	TRAFFIC PULLBOXES (PER CALTRANS STD. ES-8B)	EA		6		
72	870201	RELOCATE STREET LIGHT POLE	EA		1		
73	870401 A	INSTALL TRAFFIC SIGNAL (GRAPEFRUIT BLVD/SR-111 & 4TH ST)	LS		1		
74	999991 A	MOBILIZATION, DEMOBILIZATION AND FINAL CLEANUP	LS		1		
74 A	839521	CABLE RAILING	LF		6		

PROJECT SUBTOTAL: _____ \$
 ITEMS 1-74A "WORDS"

* NOTE: See Instructions to Bidders, Section 24 "Like Bid Items", on page A18; corrections will apply if Like Bid items cost discrepancies are submitted.

PROPOSAL (REVISED)**BASE BID SCHEDULE B (4th Street Sidewalk Crossing UPRR Tracks)**

ITEM No.	ITEM CODE	ITEM	UNIT	Like Bid Item*	ESTIMATED QUANTITY	ITEM PRICE (IN FIGURES)	TOTAL (IN FIGURES)
75	017304	MINOR CONCRETE (CURB AND GUTTER) (CRS 200 - 6")	LF	Like 1	37		
76	120100	TRAFFIC CONTROL SYSTEM	LS		1		
77	190101 F	ROADWAY EXCAVATION	CY	Like 2	50		
78	198005	IMPORTED GRANULAR MATERIAL (DECOMPOSED GRANITE - 3" THICK, STABILIZED)	CY		6		
79	260203	CLASS 2 AGGREGATE BASE	CY	Like 3	75		
80	378000	MICRO-SURFACING	TON		18		
81	390132M	POLYMER MODIFIED HOT MIX ASPHALT	TON	Like 4	990		
82	731521	MINOR CONCRETE (SIDEWALK) (CRS 401)	SQFT	Like 5	450		
83	820860	INSTALL SIGN (STRAP AND SADDLE BRACKET METHOD)	EA	Like 6	5		
84	840515 F	THERMOPLASTIC PAVEMENT MARKING	SF	Like 7	1,000		
85	066020	WORKING WITHIN RAILROAD RIGHT OF WAY, RELATIONS WITH RAILROAD [INCLUDING FLAGGING]	LS		1		
86	010602	MISCELLANEOUS WORK AS DIRECTED	FA		1	150,000.00	150,000.00

PROJECT SUBTOTAL: _____ \$ _____
 ITEMS 75-86 "WORDS"

PROJECT TOTAL: _____ \$ _____
 ITEMS 1-86 "WORDS"

- A ITEM CODE WITH SUFFIX A MEAN NON STANDARD ITEM
- F ITEM CODE WITH SUFFIX F MEAN FIX FINAL PAY ITEM
- P ITEM CODE WITH SUFFIX P MEAN PARTIAL PAY ITEM

* NOTE: See Instructions to Bidders, Section 24 "Like Bid Items", on page A18; corrections will apply if Like Bid items cost discrepancies are submitted.

APPENDIX C
Federal Prevailing Wage Decision

General Decision Number: CA170036 08/04/2017 CA36

Superseded General Decision Number: CA20160036

State: California

Construction Types: Building, Heavy (Heavy and Dredging) and Highway

County: Riverside County in California.

BUILDING CONSTRUCTION PROJECTS; DREDGING PROJECTS (does not include hopper dredge work); HEAVY CONSTRUCTION PROJECTS (does not include water well drilling); HIGHWAY CONSTRUCTION PROJECTS

Note: Under Executive Order (EO) 13658, an hourly minimum wage of \$10.20 for calendar year 2017 applies to all contracts subject to the Davis-Bacon Act for which the contract is awarded (and any solicitation was issued) on or after January 1, 2015. If this contract is covered by the EO, the contractor must pay all workers in any classification listed on this wage determination at least \$10.20 (or the applicable wage rate listed on this wage determination, if it is higher) for all hours spent performing on the contract in calendar year 2017. The EO minimum wage rate will be adjusted annually. Additional information on contractor requirements and worker protections under the EO is available at www.dol.gov/whd/govcontracts.

Modification Number	Publication Date
0	01/06/2017
1	01/27/2017
2	02/17/2017
3	02/24/2017
4	03/10/2017
5	03/31/2017
6	05/12/2017
7	05/26/2017
8	06/02/2017
9	06/30/2017
10	07/07/2017
11	07/14/2017
12	07/28/2017
13	08/04/2017

ASBE0005-002 07/04/2016

	Rates	Fringes
Asbestos Workers/Insulator (Includes the application of all insulating materials, protective coverings, coatings, and finishes to all types of mechanical systems).....	\$ 38.37	20.13
Fire Stop Technician (Application of Firestopping Materials for wall openings and penetrations in walls, floors, ceilings and curtain walls).....	\$ 26.15	17.31

ASBE0005-004 07/04/2016

	Rates	Fringes
Asbestos Removal worker/hazardous material handler (Includes preparation, wetting, stripping, removal, scrapping, vacuuming, bagging and disposing of all insulation materials from mechanical systems, whether they contain asbestos or not).....	\$ 18.38	10.82

BOIL0092-003 10/01/2012

	Rates	Fringes
BOILERMAKER.....	\$ 41.17	28.27

* BRCA0004-011 05/01/2017

	Rates	Fringes
BRICKLAYER; MARBLE SETTER.....	\$ 39.07	14.57

*The wage scale for prevailing wage projects performed in Blythe, China lake, Death Valley, Fort Irwin, Twenty-Nine Palms, Needles and 1-15 corridor (Barstow to the Nevada State Line) will be Three Dollars (\$3.00) above the standard San Bernardino/Riverside County hourly wage rate

BRCA0018-004 06/01/2016

	Rates	Fringes
MARBLE FINISHER.....	\$ 29.20	12.93
TILE FINISHER.....	\$ 24.53	11.08
TILE LAYER.....	\$ 35.89	16.24

BRCA0018-010 09/01/2016

	Rates	Fringes
TERRAZZO FINISHER.....	\$ 28.53	12.27
TERRAZZO WORKER/SETTER.....	\$ 35.57	13.14

CARP0409-001 07/01/2016

	Rates	Fringes
CARPENTER		
(1) Carpenter, Cabinet Installer, Insulation Installer, Hardwood Floor Worker and acoustical installer.....	\$ 39.83	15.50
(2) Millwright.....	\$ 40.90	15.50
(3) Piledrivermen/Derrick Bargeman, Bridge or Dock Carpenter, Heavy Framer, Rock Bargeman or Scowman, Rockslinger, Shingler (Commercial).....	\$ 40.53	15.50
(4) Pneumatic Nailer, Power Stapler.....	\$ 40.09	15.50
(5) Sawfiler.....	\$ 39.83	15.50
(6) Scaffold Builder.....	\$ 31.60	15.50

(7) Table Power Saw
 Operator.....\$ 40.93 15.50

FOOTNOTE: Work of forming in the construction of open cut sewers or storm drains, on operations in which horizontal lagging is used in conjunction with steel H-Beams driven or placed in pre- drilled holes, for that portion of a lagged trench against which concrete is poured, namely, as a substitute for back forms (which work is performed by piledrivers): \$0.13 per hour additional.

CARP0409-002 07/01/2008

	Rates	Fringes
Diver		
(1) Wet.....	\$ 663.68	9.82
(2) Standby.....	\$ 331.84	9.82
(3) Tender.....	\$ 323.84	9.82
(4) Assistant Tender.....	\$ 299.84	9.82

Amounts in "Rates" column are per day

CARP0409-005 07/01/2015

	Rates	Fringes
Drywall		
DRYWALL INSTALLER/LATHER....	\$ 40.40	15.03
STOCKER/SCRAPPER.....	\$ 10.00	7.17

CARP0409-008 08/01/2010

	Rates	Fringes
Modular Furniture Installer.....	\$ 17.00	7.41

ELEC0440-001 06/26/2017

	Rates	Fringes
ELECTRICIAN		
INSIDE ELECTRICIAN.....	\$ 36.99	3%+23.18
INTELLIGENT TRANSPORTATION SYSTEMS		
Electrician.....	\$ 36.99	3%+23.18
Technician.....	\$ 27.75	3%+23.18

ZONE PAY: Zone A: Free travel zone for all contractors performing work in Zone A.
 Zone B: Any work performed in Zone (B) shall add \$12.00 per hour to the current wage scale. Zone (B) shall be the area from the eastern perimeter of Zone (A) to a line which runs north and south beginning at Little Morongo Canyon (San Bernardino/Riverside County Line), Southeast along the Coachella Tunnels, Colorado River Aqueduct and Mecca Tunnels to Pinkham Wash then South to Box Canyon Road, then southwest along Box Canyon Road to Highway 195 west onto 195 south to Highway 86 to Riverside/Imperial County Line.

ELEC0440-004 12/26/2016

COMMUNICATIONS AND SYSTEMS WORK

	Rates	Fringes
Communications System		
Installer.....	\$ 30.54	4%+13.75
Technician.....	\$ 30.18	4%+11.45

SCOPE OF WORK:

Installation, testing, service and maintenance of systems utilizing the transmission and/or transference of voice, sound, vision and digital for commercial, educational, security and entertainment purposes for the following: TV monitoring and surveillance, background-foreground music, intercom and telephone interconnect, inventory control systems, microwave transmission, multi-media, multiplex, nurse call systems, radio page, school intercom and sound, burglar alarms, fire alarms, and low voltage master clock systems in commercial buildings. Communication Systems that transmit or receive information and/or control systems that are intrinsic to the above listed systems; inclusion or exclusion of terminations and testings of conductors determined by their function; excluding all other data systems or multiple systems which include control function or power supply; excluding installation of raceway systems, conduit systems, line voltage work, and energy management systems. Does not cover work performed at China Lake Naval Ordnance Test Station.

 * ELEC1245-001 06/01/2017

	Rates	Fringes
LINE CONSTRUCTION		
(1) Lineman; Cable splicer..\$ 55.49		3%+17.65
(2) Equipment specialist (operates crawler tractors, commercial motor vehicles, backhoes, trenchers, cranes (50 tons and below), overhead & underground distribution line equipment).....\$ 44.32		3%+17.65
(3) Groundman.....\$ 33.89		3%+17.65
(4) Powderman.....\$ 49.55		3%+17.65

HOLIDAYS: New Year's Day, M.L. King Day, Memorial Day, Independence Day, Labor Day, Veterans Day, Thanksgiving Day and day after Thanksgiving, Christmas Day

 ELEV0018-001 01/01/2017

	Rates	Fringes
ELEVATOR MECHANIC.....\$ 52.21		31.585

FOOTNOTE:

PAID VACATION: Employer contributes 8% of regular hourly rate as vacation pay credit for employees with more than 5 years of service, and 6% for 6 months to 5 years of service.

PAID HOLIDAYS: New Years Day, Memorial Day, Independence Day, Labor Day, Veterans Day, Thanksgiving Day, Friday after Thanksgiving, and Christmas Day.

 ENGI0012-003 07/01/2016

	Rates	Fringes
OPERATOR: Power Equipment (All Other Work)		
GROUP 1.....\$ 39.95		23.35
GROUP 2.....\$ 40.73		23.35
GROUP 3.....\$ 41.02		23.35
GROUP 4.....\$ 42.51		23.35
GROUP 5.....\$ 41.86		23.35

GROUP 6.....	\$ 41.83	23.35
GROUP 8.....	\$ 42.84	23.35
GROUP 9.....	\$ 42.19	23.35
GROUP 10.....	\$ 42.96	23.35
GROUP 11.....	\$ 42.31	23.35
GROUP 12.....	\$ 43.13	23.35
GROUP 13.....	\$ 43.23	23.35
GROUP 14.....	\$ 43.26	23.35
GROUP 15.....	\$ 43.34	23.35
GROUP 16.....	\$ 43.46	23.35
GROUP 17.....	\$ 43.63	23.35
GROUP 18.....	\$ 43.73	23.35
GROUP 19.....	\$ 43.84	23.35
GROUP 20.....	\$ 43.96	23.35
GROUP 21.....	\$ 44.13	23.35
GROUP 22.....	\$ 44.23	23.35
GROUP 23.....	\$ 44.34	23.35
GROUP 24.....	\$ 44.46	23.35
GROUP 25.....	\$ 44.63	23.35

OPERATOR: Power Equipment
(Cranes, Piledriving &
Hoisting)

GROUP 1.....	\$ 43.20	22.15
GROUP 2.....	\$ 43.98	22.15
GROUP 3.....	\$ 44.27	22.15
GROUP 4.....	\$ 44.41	22.15
GROUP 5.....	\$ 44.63	22.15
GROUP 6.....	\$ 44.74	22.15
GROUP 7.....	\$ 44.86	22.15
GROUP 8.....	\$ 45.03	22.15
GROUP 9.....	\$ 45.20	22.15
GROUP 10.....	\$ 46.20	22.15
GROUP 11.....	\$ 47.20	22.15
GROUP 12.....	\$ 48.20	22.15
GROUP 13.....	\$ 49.20	22.15

OPERATOR: Power Equipment
(Tunnel Work)

GROUP 1.....	\$ 41.80	23.35
GROUP 2.....	\$ 42.58	23.35
GROUP 3.....	\$ 42.87	23.35
GROUP 4.....	\$ 43.01	23.35
GROUP 5.....	\$ 43.23	23.35
GROUP 6.....	\$ 43.34	23.35
GROUP 7.....	\$ 43.46	23.35

PREMIUM PAY:

\$3.75 per hour shall be paid on all Power Equipment Operator work on the following Military Bases: China Lake Naval Reserve, Vandenberg AFB, Point Arguello, Seely Naval Base, Fort Irwin, Nebo Annex Marine Base, Marine Corp Logistics Base Yermo, Edwards AFB, 29 Palms Marine Base and Camp Pendleton Workers required to suit up and work in a hazardous material environment: \$2.00 per hour additional. Combination mixer and compressor operator on gunite work shall be classified as a concrete mobile mixer operator.

SEE ZONE DEFINITIONS AFTER CLASSIFICATIONS

POWER EQUIPMENT OPERATORS CLASSIFICATIONS

GROUP 1: Bargeman; Brakeman; Compressor operator; Ditch Witch, with seat or similar type equipment; Elevator operator-inside; Engineer Oiler; Forklift operator

(includes loed, lull or similar types under 5 tons; Generator operator; Generator, pump or compressor plant operator; Pump operator; Signalman; Switchman

GROUP 2: Asphalt-rubber plant operator (nurse tank operator); Concrete mixer operator-skip type; Conveyor operator; Fireman; Forklift operator (includes loed, lull or similar types over 5 tons; Hydrostatic pump operator; oiler crusher (asphalt or concrete plant); Petromat laydown machine; PJU side dum jack; Screening and conveyor machine operator (or similar types); Skiploader (wheel type up to 3/4 yd. without attachment); Tar pot fireman; Temporary heating plant operator; Trenching machine oiler

GROUP 3: Asphalt-rubber blend operator; Bobcat or similar type (Skid steer); Equipment greaser (rack); Ford Ferguson (with dragtype attachments); Helicopter radioman (ground); Stationary pipe wrapping and cleaning machine operator

GROUP 4: Asphalt plant fireman; Backhoe operator (mini-max or similar type); Boring machine operator; Boxman or mixerman (asphalt or concrete); Chip spreading machine operator; Concrete cleaning decontamination machine operator; Concrete Pump Operator (small portable); Drilling machine operator, small auger types (Texoma super economatic or similar types - Hughes 100 or 200 or similar types - drilling depth of 30' maximum); Equipment greaser (grease truck); Guard rail post driver operator; Highline cableway signalman; Hydra-hammer-aero stomper; Micro Tunneling (above ground tunnel); Power concrete curing machine operator; Power concrete saw operator; Power-driven jumbo form setter operator; Power sweeper operator; Rock Wheel Saw/Trencher; Roller operator (compacting); Screed operator (asphalt or concrete); Trenching machine operator (up to 6 ft.); Vacuum or much truck

GROUP 5: Equipment Greaser (Grease Truck/Multi Shift).

GROUP 6: Articulating material hauler; Asphalt plant engineer; Batch plant operator; Bit sharpener; Concrete joint machine operator (canal and similar type); Concrete planer operator; Dandy digger; Deck engine operator; Derrickman (oilfield type); Drilling machine operator, bucket or auger types (Calweld 100 bucket or similar types - Watson 1000 auger or similar types - Texoma 330, 500 or 600 auger or similar types - drilling depth of 45' maximum); Drilling machine operator; Hydrographic seeder machine operator (straw, pulp or seed), Jackson track maintainer, or similar type; Kalamazoo Switch tamper, or similar type; Machine tool operator; Maginnis internal full slab vibrator, Mechanical berm, curb or gutter (concrete or asphalt); Mechanical finisher operator (concrete, Clary-Johnson-Bidwell or similar); Micro tunnel system (below ground); Pavement breaker operator (truck mounted); Road oil mixing machine operator; Roller operator (asphalt or finish), rubber-tired earth moving equipment (single engine, up to and including 25 yds. struck); Self-propelled tar pipelining machine operator; Skiploader operator (crawler and wheel type, over 3/4 yd. and up to and including 1-1/2 yds.); Slip form pump operator (power driven hydraulic lifting device for concrete forms); Tractor operator-bulldozer, tamper-scraper (single engine, up to 100 h.p. flywheel and similar types, up to and including D-5 and similar types); Tugger hoist operator (1 drum); Ultra high pressure waterjet cutting tool system operator; Vacuum blasting machine operator

GROUP 8: Asphalt or concrete spreading operator (tamping or finishing); Asphalt paving machine operator (Barber Greene or similar type); Asphalt-rubber distribution operator; Backhoe operator (up to and including 3/4 yd.), small ford, Case or similar; Cast-in-place pipe laying machine operator; Combination mixer and compressor operator (gunite work); Compactor operator (self-propelled); Concrete mixer operator (paving); Crushing plant operator; Drill Doctor; Drilling machine operator, Bucket or auger types (Calweld 150 bucket or similar types - Watson 1500, 2000 2500 auger or similar types - Texoma 700, 800 auger or similar types - drilling depth of 60' maximum); Elevating grader operator; Grade checker; Gradall operator; Grouting machine operator; Heavy-duty repairman; Heavy equipment robotics operator; Kalamazoo balliste regulator or similar type; Kolman belt

loader and similar type; Le Tourneau blob compactor or similar type; Loader operator (Athey, Euclid, Sierra and similar types); Mobark Chipper or similar; Ozzie padder or similar types; P.C. slot saw; Pneumatic concrete placing machine operator (Hackley-Presswell or similar type); Pumpcrete gun operator; Rock Drill or similar types; Rotary drill operator (excluding caisson type); Rubber-tired earth-moving equipment operator (single engine, caterpillar, Euclid, Athey Wagon and similar types with any and all attachments over 25 yds. up to and including 50 cu.

yds. struck); Rubber-tired earth-moving equipment operator (multiple engine up to and including 25 yds. struck); Rubber-tired scraper operator (self-loading paddle wheel type-John Deere, 1040 and similar single unit); Self-propelled curb and gutter machine operator; Shuttle buggy; Skiploader operator (crawler and wheel type over 1-1/2 yds. up to and including 6-1/2 yds.); Soil remediation plant operator; Surface heaters and planer operator; Tractor compressor drill combination operator; Tractor operator (any type larger than D-5 - 100 flywheel h.p. and over, or similar-bulldozer, tamper, scraper and push tractor single engine); Tractor operator (boom attachments), Traveling pipe wrapping, cleaning and bending machine operator; Trenching machine operator (over 6 ft. depth capacity, manufacturer's rating); trenching Machine with Road Miner attachment (over 6 ft depth capacity): Ultra high pressure waterjet cutting tool system mechanic; Water pull (compaction) operator

GROUP 9: Heavy Duty Repairman

GROUP 10: Drilling machine operator, Bucket or auger types (Calweld 200 B bucket or similar types-Watson 3000 or 5000 auger or similar types-Texoma 900 auger or similar types-drilling depth of 105' maximum); Dual drum mixer, dynamic compactor LDC350 (or similar types); Monorail locomotive operator (diesel, gas or electric); Motor patrol-blade operator (single engine); Multiple engine tractor operator (Euclid and similar type-except Quad 9 cat.); Rubber-tired earth-moving equipment operator (single engine, over 50 yds. struck); Pneumatic pipe ramming tool and similar types; Prestressed wrapping machine operator; Rubber-tired earth-moving equipment operator (single engine, over 50 yds. struck); Rubber tired earth moving equipment operator (multiple engine, Euclid, caterpillar and similar over 25 yds. and up to 50 yds. struck), Tower crane repairman; Tractor loader operator (crawler and wheel type over 6-1/2 yds.); Woods mixer operator (and similar Pugmill equipment)

GROUP 11: Heavy Duty Repairman - Welder Combination, Welder - Certified.

GROUP 12: Auto grader operator; Automatic slip form operator; Drilling machine operator, bucket or auger types (Calweld, auger 200 CA or similar types - Watson, auger 6000 or similar types - Hughes Super Duty, auger 200 or similar types - drilling depth of 175' maximum); Hoe ram or similar with compressor; Mass excavator operator less tha 750 cu. yards; Mechanical finishing machine operator; Mobile form traveler operator; Motor patrol operator (multi-engine); Pipe mobile machine operator; Rubber-tired earth-moving equipment operator (multiple engine, Euclid, Caterpillar and similar type, over 50 cu. yds. struck); Rubber-tired self-loading scraper operator (paddle-wheel-auger type self-loading - two (2) or more units)

GROUP 13: Rubber-tired earth-moving equipment operator operating equipment with push-pull system (single engine, up to and including 25 yds. struck)

GROUP 14: Canal liner operator; Canal trimmer operator; Remote-control earth-moving equipment operator (operating a second piece of equipment: \$1.00 per hour additional); Wheel excavator operator (over 750 cu. yds.)

GROUP 15: Rubber-tired earth-moving equipment operator, operating equipment with push-pull system (single engine, Caterpillar, Euclid, Athey Wagon and similar types with any and all attachments over 25 yds. and up to and including 50 yds. struck); Rubber-tired earth-moving equipment operator, operating equipment with push-pull system (multiple engine-up to and including 25 yds. struck)

GROUP 16: Rubber-tired earth-moving equipment operator, operating equipment with push-pull system (single engine, over 50 yds. struck); Rubber-tired earth-moving equipment operator, operating equipment with push-pull system (multiple engine, Euclid, Caterpillar and similar, over 25 yds. and up to 50 yds. struck)

GROUP 17: Rubber-tired earth-moving equipment operator, operating equipment with push-pull system (multiple engine, Euclid, Caterpillar and similar, over 50 cu. yds. struck); Tandem tractor operator (operating crawler type tractors in tandem - Quad 9 and similar type)

GROUP 18: Rubber-tired earth-moving equipment operator, operating in tandem (scrapers, belly dumps and similar types in any combination, excluding compaction units - single engine, up to and including 25 yds. struck)

GROUP 19: Rotex concrete belt operator (or similar types); Rubber-tired earth-moving equipment operator, operating in tandem (scrapers, belly dumps and similar types in any combination, excluding compaction units - single engine, Caterpillar, Euclid, Athey Wagon and similar types with any and all attachments over 25 yds. and up to and including 50 cu. yds. struck); Rubber-tired earth-moving equipment operator, operating in tandem (scrapers, belly dumps and similar types in any combination, excluding compaction units - multiple engine, up to and including 25 yds. struck)

GROUP 20: Rubber-tired earth-moving equipment operator, operating in tandem (scrapers, belly dumps and similar types in any combination, excluding compaction units - single engine, over 50 yds. struck); Rubber-tired earth-moving equipment operator, operating in tandem (scrapers, belly dumps, and similar types in any combination, excluding compaction units - multiple engine, Euclid, Caterpillar and similar, over 25 yds. and up to 50 yds. struck)

GROUP 21: Rubber-tired earth-moving equipment operator, operating in tandem (scrapers, belly dumps and similar types in any combination, excluding compaction units - multiple engine, Euclid, Caterpillar and similar type, over 50 cu. yds. struck)

GROUP 22: Rubber-tired earth-moving equipment operator, operating equipment with the tandem push-pull system (single engine, up to and including 25 yds. struck)

GROUP 23: Rubber-tired earth-moving equipment operator, operating equipment with the tandem push-pull system (single engine, Caterpillar, Euclid, Athey Wagon and similar types with any and all attachments over 25 yds. and up to and including 50 yds. struck); Rubber-tired earth-moving equipment operator, operating with the tandem push-pull system (multiple engine, up to and including 25 yds. struck)

GROUP 24: Rubber-tired earth-moving equipment operator, operating equipment with the tandem push-pull system (single engine, over 50 yds. struck); Rubber-tired earth-moving equipment operator, operating equipment with the tandem push-pull system (multiple engine, Euclid, Caterpillar and similar, over 25 yds. and up to 50 yds. struck)

GROUP 25: Concrete pump operator-truck mounted; Rubber-tired earth-moving equipment operator, operating equipment with the tandem push-pull system (multiple engine, Euclid, Caterpillar and similar type, over 50 cu. yds. struck)

CRANES, PILEDIVING AND HOISTING EQUIPMENT CLASSIFICATIONS

GROUP 1: Engineer oiler; Fork lift operator (includes loed, lull or similar types)

GROUP 2: Truck crane oiler

GROUP 3: A-frame or winch truck operator; Ross carrier operator (jobsite)

GROUP 4: Bridge-type unloader and turntable operator; Helicopter hoist operator

GROUP 5: Hydraulic boom truck; Stinger crane (Austin-Western or similar type); Tugger hoist operator (1 drum)

GROUP 6: Bridge crane operator; Cretor crane operator; Hoist operator (Chicago boom and similar type); Lift mobile operator; Lift slab machine operator (Vagtborg and similar types); Material hoist and/or manlift operator; Polar gantry crane operator; Self Climbing scaffold (or similar type); Shovel, backhoe, dragline, clamshell operator (over 3/4 yd. and up to 5 cu. yds. mrc); Tugger hoist operator

GROUP 7: Pedestal crane operator; Shovel, backhoe, dragline, clamshell operator (over 5 cu. yds. mrc); Tower crane repair; Tugger hoist operator (3 drum)

GROUP 8: Crane operator (up to and including 25 ton capacity); Crawler transporter operator; Derrick barge operator (up to and including 25 ton capacity); Hoist operator, stiff legs, Guy derrick or similar type (up to and including 25 ton capacity); Shovel, backhoe, dragline, clamshell operator (over 7 cu. yds., M.R.C.)

GROUP 9: Crane operator (over 25 tons and up to and including 50 tons mrc); Derrick barge operator (over 25 tons up to and including 50 tons mrc); Highline cableway operator; Hoist operator, stiff legs, Guy derrick or similar type (over 25 tons up to and including 50 tons mrc); K-crane operator; Polar crane operator; Self erecting tower crane operator maximum lifting capacity ten tons

GROUP 10: Crane operator (over 50 tons and up to and including 100 tons mrc); Derrick barge operator (over 50 tons up to and including 100 tons mrc); Hoist operator, stiff legs, Guy derrick or similar type (over 50 tons up to and including 100 tons mrc); Mobile tower crane operator (over 50 tons, up to and including 100 tons M.R.C.); Tower crane operator and tower gantry

GROUP 11: Crane operator (over 100 tons and up to and including 200 tons mrc); Derrick barge operator (over 100 tons up to and including 200 tons mrc); Hoist operator, stiff legs, Guy derrick or similar type (over 100 tons up to and including 200 tons mrc); Mobile tower crane operator (over 100 tons up to and including 200 tons mrc)

GROUP 12: Crane operator (over 200 tons up to and including 300 tons mrc); Derrick barge operator (over 200 tons up to and including 300 tons mrc); Hoist operator, stiff legs, Guy derrick or similar type (over 200 tons, up to and including 300 tons mrc); Mobile tower crane operator (over 200 tons, up to and including 300 tons mrc)

GROUP 13: Crane operator (over 300 tons); Derrick barge operator (over 300 tons); Helicopter pilot; Hoist operator, stiff legs, Guy derrick or similar type (over 300 tons); Mobile tower crane operator (over 300 tons)

TUNNEL CLASSIFICATIONS

GROUP 1: Skiploader (wheel type up to 3/4 yd. without attachment)

GROUP 2: Power-driven jumbo form setter operator

GROUP 3: Dinkey locomotive or motorperson (up to and including 10 tons)

GROUP 4: Bit sharpener; Equipment greaser (grease truck); Slip form pump operator (power-driven hydraulic lifting device for concrete forms); Tugger hoist operator (1 drum); Tunnel locomotive operator (over 10 and up to and including 30 tons)

GROUP 5: Backhoe operator (up to and including 3/4 yd.); Small Ford, Case or similar; Drill doctor; Grouting machine operator; Heading shield operator; Heavy-duty repairperson; Loader operator (Athey, Euclid, Sierra and similar types); Mucking machine operator (1/4 yd., rubber-tired, rail or track type); Pneumatic concrete placing machine operator (Hackley-Presswell or similar type); Pneumatic heading shield (tunnel); Pumpcrete gun operator; Tractor compressor drill combination operator; Tugger hoist operator (2 drum); Tunnel locomotive operator (over 30 tons)

GROUP 6: Heavy Duty Repairman

GROUP 7: Tunnel mole boring machine operator

ENGINEERS ZONES

\$1.00 additional per hour for all of IMPERIAL County and the portions of KERN, RIVERSIDE & SAN BERNARDINO Counties as defined below:

That area within the following Boundary: Begin in San Bernardino County, approximately 3 miles NE of the intersection of I-15 and the California State line at that point which is the NW corner of Section 1, T17N, R14E, San Bernardino Meridian. Continue W in a straight line to that point which is the SW corner of the northwest quarter of Section 6, T27S, R42E, Mt. Diablo Meridian. Continue North to the intersection with the Inyo County Boundary at that point which is the NE corner of the western half of the northern quarter of Section 6, T25S, R42E, MDM. Continue W along the Inyo and San Bernardino County boundary until the intersection with Kern County, as that point which is the SE corner of Section 34, T24S, R40E, MDM. Continue W along the Inyo and Kern County boundary until the intersection with Tulare County, at that point which is the SW corner of the SE quarter of Section 32, T24S, R37E, MDM. Continue W along the Kern and Tulare County boundary, until that point which is the NW corner of T25S, R32E, MDM. Continue S following R32E lines to the NW corner of T31S, R32E, MDM. Continue W to the NW corner of T31S, R31E, MDM. Continue S to the SW corner of T32S, R31E, MDM. Continue W to SW corner of SE quarter of Section 34, T32S, R30E, MDM. Continue S to SW corner of T11N, R17W, SBM. Continue E along south boundary of T11N, SBM to SW corner of T11N, R7W, SBM. Continue S to SW corner of T9N, R7W, SBM. Continue E along south boundary of T9N, SBM to SW corner of T9N, R1E, SBM. Continue S along west boundary of R1E, SBM to Riverside County line at the SW corner of T1S, R1E, SBM. Continue E along south boundary of T1S, SBM (Riverside County Line) to SW corner of T1S, R10E, SBM. Continue S along west boundary of R10E, SBM to Imperial County line at the SW corner of T8S, R10E, SBM. Continue W along Imperial and Riverside county line to NW corner of T9S, R9E, SBM. Continue S along the boundary between Imperial and San Diego Counties, along the west edge of R9E, SBM to the south boundary of Imperial County/California state line. Follow the California state line west to Arizona state line, then north to Nevada state line, then continuing NW back to start at the point which is the NW corner of Section 1, T17N, R14E, SBM

\$1.00 additional per hour for portions of SAN LUIS OBISPO, KERN, SANTA BARBARA & VENTURA as defined below:

That area within the following Boundary: Begin approximately 5 miles north of the community of Cholame, on the Monterey County and San Luis Obispo County boundary at the NW corner of T25S, R16E, Mt. Diablo Meridian. Continue south along the west side of R16E to the SW corner of T30S, R16E, MDM. Continue E to SW corner of T30S, R17E, MDM. Continue S to SW corner of T31S, R17E, MDM. Continue E to SW corner of T31S, R18E, MDM. Continue S along West side of R18E, MDM as it crosses into San Bernardino Meridian numbering area and becomes R30W. Follow the west side of R30W, SBM to the SW corner of T9N, R30W, SBM.

Continue E along the south edge of T9N, SBM to the Santa Barbara County and Ventura County boundary at that point which is the SW corner of Section 34. T9N, R24W, SBM, continue S along the Ventura County line to that point which is the SW corner of the SE quarter of Section 32, T7N, R24W, SBM. Continue E along the south edge of T7N, SBM to the SE corner to T7N, R21W, SBM. Continue N along East side of R21W, SBM to Ventura County and Kern County boundary at the NE corner of T8N, R21W. Continue W along the Ventura County and Kern County boundary to the SE corner of T9N, R21W. Continue North along the East edge of R21W, SBM to the NE corner of T12N, R21W, SBM. Continue West along the north edge of T12N, SBM to the SE corner of T32S, R21E, MDM. [T12N SBM is a think strip between T11N SBM and T32S MDM]. Continue North along the East side of R21E, MDM to the Kings County and Kern County border at the NE corner of T25S, R21E, MDM, continue West along the Kings County and Kern County Boundary until the intersection of San Luis Obispo County. Continue west along the Kings County and San Luis Obispo County boundary until the intersection with Monterey County. Continue West along the Monterey County and San Luis Obispo County boundary to the beginning point at the NW corner of T25S, R16E, MDM.

\$2.00 additional per hour for INYO and MONO Counties and the Northern portion of SAN BERNARDINO County as defined below:

That area within the following Boundary: Begin at the intersection of the northern boundary of Mono County and the California state line at the point which is the center of Section 17, T10N, R22E, Mt. Diablo Meridian. Continue S then SE along the entire western boundary of Mono County, until it reaches Inyo County at the point which is the NE corner of the Western half of the NW quarter of Section 2, T8S, R29E, MDM.

Continue SSE along the entire western boundary of Inyo County, until the intersection with Kern County at the point which is the SW corner of the SE 1/4 of Section 32, T24S, R37E, MDM.

Continue E along the Inyo and Kern County boundary until the intersection with San Bernardino County at that point which is the SE corner of section 34, T24S, R40E, MDM. Continue E along the Inyo and San Bernardino County boundary until the point which is the NE corner of the Western half of the NW quarter of Section 6, T25S, R42E, MDM. Continue S to that point which is the SW corner of the NW quarter of Section 6, T27S, R42E, MDM.

Continue E in a straight line to the California and Nevada state border at the point which is the NW corner of Section 1, T17N, R14E, San Bernardino Meridian. Then continue NW along the state line to the starting point, which is the center of Section 18, T10N, R22E, MDM.

REMAINING AREA NOT DEFINED ABOVE RECIEVES BASE RATE

 ENGI0012-004 08/01/2015

	Rates	Fringes
OPERATOR: Power Equipment		
(DREDGING)		
(1) Leverman.....	\$ 49.50	23.60
(2) Dredge dozer.....	\$ 43.53	23.60
(3) Deckmate.....	\$ 43.42	23.60
(4) Winch operator (stern winch on dredge).....	\$ 42.87	23.60
(5) Fireman-Oiler, Deckhand, Bargeman, Leveehand.....	\$ 42.33	23.60
(6) Barge Mate.....	\$ 42.94	23.60

 IRON0377-002 07/01/2016

	Rates	Fringes
--	-------	---------

Ironworkers:

Fence Erector.....	\$ 28.33	20.64
Ornamental, Reinforcing and Structural.....	\$ 34.75	29.20

PREMIUM PAY:

\$6.00 additional per hour at the following locations:

China Lake Naval Test Station, Chocolate Mountains Naval Reserve-Niland, Edwards AFB, Fort Irwin Military Station, Fort Irwin Training Center-Goldstone, San Clemente Island, San Nicholas Island, Susanville Federal Prison, 29 Palms - Marine Corps, U.S. Marine Base - Barstow, U.S. Naval Air Facility - Sealey, Vandenberg AFB

\$4.00 additional per hour at the following locations:

Army Defense Language Institute - Monterey, Fallon Air Base, Naval Post Graduate School - Monterey, Yermo Marine Corps Logistics Center

\$2.00 additional per hour at the following locations:

Port Hueneme, Port Mugu, U.S. Coast Guard Station - Two Rock

LABO0300-005 01/01/2017

	Rates	Fringes
Asbestos Removal Laborer.....	\$ 31.88	16.82

SCOPE OF WORK: Includes site mobilization, initial site cleanup, site preparation, removal of asbestos-containing material and toxic waste, encapsulation, enclosure and disposal of asbestos- containing materials and toxic waste by hand or with equipment or machinery; scaffolding, fabrication of temporary wooden barriers and assembly of decontamination stations.

LABO0345-001 07/02/2017

	Rates	Fringes
LABORER (GUNITE)		
GROUP 1.....	\$ 41.08	17.39
GROUP 2.....	\$ 40.13	17.39
GROUP 3.....	\$ 36.59	17.39

FOOTNOTE: GUNITE PREMIUM PAY: Workers working from a Bosn'n's Chair or suspended from a rope or cable shall receive 40 cents per hour above the foregoing applicable classification rates. Workers doing gunite and/or shotcrete work in a tunnel shall receive 35 cents per hour above the foregoing applicable classification rates, paid on a portal-to-portal basis. Any work performed on, in or above any smoke stack, silo, storage elevator or similar type of structure, when such structure is in excess of 75'-0" above base level and which work must be performed in whole or in part more than 75'-0" above base level, that work performed above the 75'-0" level shall be compensated for at 35 cents per hour above the applicable classification wage rate.

GUNITE LABORER CLASSIFICATIONS

GROUP 1: Rodmen, Nozzlemen

GROUP 2: Gunmen

GROUP 3: Reboundmen

LABO1184-001 07/01/2017

	Rates	Fringes
Laborers: (HORIZONTAL DIRECTIONAL DRILLING)		
(1) Drilling Crew Laborer...	\$ 34.65	13.20
(2) Vehicle Operator/Hauler.	\$ 34.82	13.20
(3) Horizontal Directional Drill Operator.....	\$ 36.67	13.20
(4) Electronic Tracking Locator.....	\$ 38.67	13.20
Laborers: (STRIPING/SLURRY SEAL)		
GROUP 1.....	\$ 35.86	16.21
GROUP 2.....	\$ 37.16	16.21
GROUP 3.....	\$ 39.17	16.21
GROUP 4.....	\$ 40.91	16.21

LABORERS - STRIPING CLASSIFICATIONS

GROUP 1: Protective coating, pavement sealing, including repair and filling of cracks by any method on any surface in parking lots, game courts and playgrounds; carstops; operation of all related machinery and equipment; equipment repair technician

GROUP 2: Traffic surface abrasive blaster; pot tender - removal of all traffic lines and markings by any method (sandblasting, waterblasting, grinding, etc.) and preparation of surface for coatings. Traffic control person: controlling and directing traffic through both conventional and moving lane closures; operation of all related machinery and equipment

GROUP 3: Traffic delineating device applicator: Layout and application of pavement markers, delineating signs, rumble and traffic bars, adhesives, guide markers, other traffic delineating devices including traffic control. This category includes all traffic related surface preparation (sandblasting, waterblasting, grinding) as part of the application process. Traffic protective delineating system installer: removes, relocates, installs, permanently affixed roadside and parking delineation barricades, fencing, cable anchor, guard rail, reference signs, monument markers; operation of all related machinery and equipment; power broom sweeper

GROUP 4: Striper: layout and application of traffic stripes and markings; hot thermo plastic; tape traffic stripes and markings, including traffic control; operation of all related machinery and equipment

LABO1184-002 07/03/2017

	Rates	Fringes
LABORER (TUNNEL)		
GROUP 1.....	\$ 39.04	18.24
GROUP 2.....	\$ 39.36	18.24
GROUP 3.....	\$ 39.82	18.24
GROUP 4.....	\$ 40.51	18.24
LABORER		

GROUP 1.....	\$ 32.34	19.07
GROUP 2.....	\$ 32.89	19.07
GROUP 3.....	\$ 33.44	19.07
GROUP 4.....	\$ 34.99	19.07
GROUP 5.....	\$ 35.34	19.07

LABORER CLASSIFICATIONS

GROUP 1: Cleaning and handling of panel forms; Concrete screeding for rough strike-off; Concrete, water curing; Demolition laborer, the cleaning of brick if performed by a worker performing any other phase of demolition work, and the cleaning of lumber; Fire watcher, limber, brush loader, piler and debris handler; Flag person; Gas, oil and/or water pipeline laborer; Laborer, asphalt-rubber material loader; Laborer, general or construction; Laborer, general clean-up; Laborer, landscaping; Laborer, jetting; Laborer, temporary water and air lines; Material hose operator (walls, slabs, floors and decks); Plugging, filling of shee bolt holes; Dry packing of concrete; Railroad maintenance, repair track person and road beds; Streetcar and railroad construction track laborers; Rigging and signaling; Scaler; Slip form raiser; Tar and mortar; Tool crib or tool house laborer; Traffic control by any method; Window cleaner; Wire mesh pulling - all concrete pouring operations

GROUP 2: Asphalt shoveler; Cement dumper (on 1 yd. or larger mixer and handling bulk cement); Cesspool digger and installer; Chucktender; Chute handler, pouring concrete, the handling of the chute from readymix trucks, such as walls, slabs, decks, floors, foundation, footings, curbs, gutters and sidewalks; Concrete curer, impervious membrane and form oiler; Cutting torch operator (demolition); Fine grader, highways and street paving, airport, runways and similar type heavy construction; Gas, oil and/or water pipeline wrapper - pot tender and form person; Guinea chaser; Headerboard person - asphalt; Laborer, packing rod steel and pans; Membrane vapor barrier installer; Power broom sweeper (small); Riprap stonepaver, placing stone or wet sacked concrete; Roto scraper and tiller; Sandblaster (pot tender); Septic tank digger and installer(lead); Tank scaler and cleaner; Tree climber, faller, chain saw operator, Pittsburgh chipper and similar type brush shredder; Underground laborer, including caisson bellower

GROUP 3: Buggymobile person; Concrete cutting torch; Concrete pile cutter; Driller, jackhammer, 2-1/2 ft. drill steel or longer; Dri-pak-it machine; Gas, oil and/or water pipeline wrapper, 6-in. pipe and over, by any method, inside and out; High scaler (including drilling of same); Hydro seeder and similar type; Impact wrench multi-plate; Kettle person, pot person and workers applying asphalt, lay-kold, creosote, lime caustic and similar type materials ("applying" means applying, dipping, brushing or handling of such materials for pipe wrapping and waterproofing); Operator of pneumatic, gas, electric tools, vibrating machine, pavement breaker, air blasting, come-alongs, and similar mechanical tools not separately classified herein; Pipelayer's backup person, coating, grouting, making of joints, sealing, caulking, diapering and including rubber gasket joints, pointing and any and all other services; Rock slinger; Rotary scarifier or multiple head concrete chipping scarifier; Steel headerboard and guideline setter; Tamper, Barko, Wacker and similar type; Trenching machine, hand-propelled

GROUP 4: Asphalt raker, lute person, ironer, asphalt dump person, and asphalt spreader boxes (all types); Concrete core cutter (walls, floors or ceilings), grinder or sander; Concrete saw person, cutting walls or flat work, scoring old or new concrete; Cribber, shorer, lagging, sheeting and trench bracing, hand-guided lagging hammer; Head rock slinger; Laborer, asphalt- rubber distributor boot person; Laser beam in connection with laborers' work; Oversize concrete vibrator operator, 70 lbs. and over; Pipelayer performing all services in the laying and installation of pipe from the point of receiving pipe in the ditch until completion of operation, including any and all forms of tubular material, whether pipe, metallic or non-metallic, conduit and any other stationary type of tubular

device used for the conveying of any substance or element, whether water, sewage, solid gas, air, or other product whatsoever and without regard to the nature of material from which the tubular material is fabricated; No-joint pipe and stripping of same; Prefabricated manhole installer; Sandblaster (nozzle person), water blasting, Porta Shot-Blast

GROUP 5: Blaster powder, all work of loading holes, placing and blasting of all powder and explosives of whatever type, regardless of method used for such loading and placing; Driller: All power drills, excluding jackhammer, whether core, diamond, wagon, track, multiple unit, and any and all other types of mechanical drills without regard to the form of motive power; Toxic waste removal

TUNNEL LABORER CLASSIFICATIONS

GROUP 1: Batch plant laborer; Changehouse person; Dump person; Dump person (outside); Swamper (brake person and switch person on tunnel work); Tunnel materials handling person; Nipper; Pot tender, using mastic or other materials (for example, but not by way of limitation, shotcrete, etc.)

GROUP 2: Chucktender, cabletender; Loading and unloading agitator cars; Vibrator person, jack hammer, pneumatic tools (except driller); Bull gang mucker, track person; Concrete crew, including rodder and spreader

GROUP 3: Blaster, driller, powder person; Chemical grout jet person; Cherry picker person; Grout gun person; Grout mixer person; Grout pump person; Jackleg miner; Jumbo person; Kemper and other pneumatic concrete placer operator; Miner, tunnel (hand or machine); Nozzle person; Operating of troweling and/or grouting machines; Powder person (primer house); Primer person; Sandblaster; Shotcrete person; Steel form raiser and setter; Timber person, retimber person, wood or steel; Tunnel Concrete finisher

GROUP 4: Diamond driller; Sandblaster; Shaft and raise work

LABO1184-004 07/01/2017

	Rates	Fringes
Brick Tender.....	\$ 31.36	17.82

* LABO1414-001 08/02/2017

	Rates	Fringes
LABORER		
PLASTER CLEAN-UP LABORER....	\$ 32.50	18.29
PLASTER TENDER.....	\$ 35.05	18.29

Work on a swing stage scaffold: \$1.00 per hour additional.

* PAIN0036-001 07/01/2017

	Rates	Fringes
Painters: (Including Lead Abatement)		
(1) Repaint (excludes San Diego County).....	\$ 27.59	13.94
(2) All Other Work.....	\$ 31.12	13.94

REPAINT of any previously painted structure. Exceptions: work involving the aerospace industry, breweries, commercial recreational facilities, hotels which operate commercial establishments as part of hotel service, and sports facilities.

PAIN0036-008 10/01/2016		
	Rates	Fringes
DRYWALL FINISHER/TAPER.....	\$ 37.18	17.99

PAIN0036-015 06/01/2016		
	Rates	Fringes
GLAZIER.....	\$ 41.70	21.13

FOOTNOTE: Additional \$1.25 per hour for work in a condor, from the third (3rd) floor and up Additional \$1.25 per hour for work on the outside of the building from a swing stage or any suspended contrivance, from the ground up

PAIN1247-002 05/01/2017		
	Rates	Fringes
SOFT FLOOR LAYER.....	\$ 32.35	14.56

* PLAS0200-009 08/02/2017		
	Rates	Fringes
PLASTERER.....	\$ 41.26	14.46

PLAS0500-002 07/01/2016		
	Rates	Fringes
CEMENT MASON/CONCRETE FINISHER...	\$ 33.30	23.33

PLUM0016-001 07/01/2017		
	Rates	Fringes

PLUMBER/PIPEFITTER		
Plumber and Pipefitter		
All other work except		
work on new additions and		
remodeling of bars,		
restaurant, stores and		
commercial buildings not		
to exceed 5,000 sq. ft.		
of floor space and work		
on strip malls, light		
commercial, tenant		
improvement and remodel		
work.....	\$ 49.28	21.61
Work ONLY on new additions		
and remodeling of bars,		
restaurant, stores and		
commercial buildings not		
to exceed 5,000 sq. ft. of		
floor space.....	\$ 47.76	20.63
Work ONLY on strip malls,		
light commercial, tenant		
improvement and remodel		
work.....	\$ 36.91	18.96

PLUM0078-001 07/01/2016		
	Rates	Fringes

PLUMBER

Landscape/Irrigation Fitter.....	\$ 44.16	25.19
Sewer & Storm Drain Work.....	\$ 44.16	25.19

* ROOF0036-002 08/01/2017

	Rates	Fringes
ROOFER.....	\$ 37.07	16.17

FOOTNOTE: Pitch premium: Work on which employees are exposed to pitch fumes or required to handle pitch, pitch base or pitch impregnated products, or any material containing coal tar pitch, the entire roofing crew shall receive \$1.75 per hour "pitch premium" pay.

SFCA0669-002 04/01/2017

	Rates	Fringes
SPRINKLER FITTER.....	\$ 38.28	15.84

SHEE0105-003 07/01/2016

LOS ANGELES (South of a straight line drawn between Gorman and Big Pines) and Catalina Island, INYO, KERN (Northeast part, East of Hwy 395), MONO ORANGE, RIVERSIDE, AND SAN BERNARDINO COUNTIES

	Rates	Fringes
SHEET METAL WORKER		
(1) Commercial - New Construction and Remodel work.....	\$ 41.86	26.88
(2) Industrial work including air pollution control systems, noise abatement, hand rails, guard rails, excluding architectural sheet metal work, excluding A-C, heating, ventilating systems for human comfort....	\$ 41.86	26.88

TEAM0011-002 07/01/2017

	Rates	Fringes
TRUCK DRIVER		
GROUP 1.....	\$ 29.59	27.74
GROUP 2.....	\$ 29.74	27.74
GROUP 3.....	\$ 29.87	27.74
GROUP 4.....	\$ 30.06	27.74
GROUP 5.....	\$ 30.09	27.74
GROUP 6.....	\$ 30.12	27.74
GROUP 7.....	\$ 30.37	27.74
GROUP 8.....	\$ 30.62	27.74
GROUP 9.....	\$ 30.82	27.74
GROUP 10.....	\$ 31.12	27.74
GROUP 11.....	\$ 31.62	27.74
GROUP 12.....	\$ 32.05	27.74

WORK ON ALL MILITARY BASES:

PREMIUM PAY: \$3.00 per hour additional. [29 palms Marine Base, Camp Roberts, China Lake, Edwards AFB, El Centro Naval Facility, Fort Irwin, Marine Corps Logistics Base at Nebo & Yermo, Mountain Warfare Training Center, Bridgeport, Point Arguello, Point Conception, Vandenberg AFB]

TRUCK DRIVERS CLASSIFICATIONS

GROUP 1: Truck driver

GROUP 2: Driver of vehicle or combination of vehicles - 2 axles; Traffic control pilot car excluding moving heavy equipment permit load; Truck mounted broom

GROUP 3: Driver of vehicle or combination of vehicles - 3 axles; Boot person; Cement mason distribution truck; Fuel truck driver; Water truck - 2 axle; Dump truck, less than 16 yds. water level; Erosion control driver

GROUP 4: Driver of transit mix truck, under 3 yds.; Dumpcrete truck, less than 6-1/2 yds. water level

GROUP 5: Water truck, 3 or more axles; Truck greaser and tire person (\$0.50 additional for tire person); Pipeline and utility working truck driver, including winch truck and plastic fusion, limited to pipeline and utility work; Slurry truck driver

GROUP 6: Transit mix truck, 3 yds. or more; Dumpcrete truck, 6-1/2 yds. water level and over; Vehicle or combination of vehicles - 4 or more axles; Oil spreader truck; Dump truck, 16 yds. to 25 yds. water level

GROUP 7: A Frame, Swedish crane or similar; Forklift driver; Ross carrier driver

GROUP 8: Dump truck, 25 yds. to 49 yds. water level; Truck repair person; Water pull - single engine; Welder

GROUP 9: Truck repair person/welder; Low bed driver, 9 axles or over

GROUP 10: Dump truck - 50 yds. or more water level; Water pull - single engine with attachment

GROUP 11: Water pull - twin engine; Water pull - twin engine with attachments; Winch truck driver - \$1.25 additional when operating winch or similar special attachments

GROUP 12: Boom Truck 17K and above

WELDERS - Receive rate prescribed for craft performing operation to which welding is incidental.
=====

Note: Executive Order (EO) 13706, Establishing Paid Sick Leave for Federal Contractors applies to all contracts subject to the Davis-Bacon Act for which the contract is awarded (and any solicitation was issued) on or after January 1, 2017. If this contract is covered by the EO, the contractor must provide employees with 1 hour of paid sick leave for every 30 hours they work, up to 56 hours of paid sick leave each year.

Employees must be permitted to use paid sick leave for their own illness, injury or other health-related needs, including preventive care; to assist a family member (or person who is like family to the employee) who is ill, injured, or has other

health-related needs, including preventive care; or for reasons resulting from, or to assist a family member (or person who is like family to the employee) who is a victim of, domestic violence, sexual assault, or stalking. Additional information on contractor requirements and worker protections under the EO is available at www.dol.gov/whd/govcontracts.

Unlisted classifications needed for work not included within the scope of the classifications listed may be added after award only as provided in the labor standards contract clauses (29CFR 5.5 (a) (1) (ii)).

The body of each wage determination lists the classification and wage rates that have been found to be prevailing for the cited type(s) of construction in the area covered by the wage determination. The classifications are listed in alphabetical order of "identifiers" that indicate whether the particular rate is a union rate (current union negotiated rate for local), a survey rate (weighted average rate) or a union average rate (weighted union average rate).

Union Rate Identifiers

A four letter classification abbreviation identifier enclosed in dotted lines beginning with characters other than "SU" or "UAVG" denotes that the union classification and rate were prevailing for that classification in the survey. Example:

PLUM0198-005 07/01/2014. PLUM is an abbreviation identifier of the union which prevailed in the survey for this classification, which in this example would be Plumbers. 0198 indicates the local union number or district council number where applicable, i.e., Plumbers Local 0198. The next number, 005 in the example, is an internal number used in processing the wage determination. 07/01/2014 is the effective date of the most current negotiated rate, which in this example is July 1, 2014.

Union prevailing wage rates are updated to reflect all rate changes in the collective bargaining agreement (CBA) governing this classification and rate.

Survey Rate Identifiers

Classifications listed under the "SU" identifier indicate that no one rate prevailed for this classification in the survey and the published rate is derived by computing a weighted average rate based on all the rates reported in the survey for that classification. As this weighted average rate includes all rates reported in the survey, it may include both union and non-union rates. Example: SULA2012-007 5/13/2014. SU indicates the rates are survey rates based on a weighted average calculation of rates and are not majority rates. LA indicates the State of Louisiana. 2012 is the year of survey on which these classifications and rates are based. The next number, 007 in the example, is an internal number used in producing the wage determination. 5/13/2014 indicates the survey completion date for the classifications and rates under that identifier.

Survey wage rates are not updated and remain in effect until a new survey is conducted.

Union Average Rate Identifiers

Classification(s) listed under the UAVG identifier indicate that no single majority rate prevailed for those classifications; however, 100% of the data reported for the classifications was union data. EXAMPLE: UAVG-OH-0010 08/29/2014. UAVG indicates that the rate is a weighted union average rate. OH indicates the state. The next number, 0010 in the example, is an internal number used in producing the wage determination. 08/29/2014 indicates the survey completion date for the classifications and rates under that identifier.

A UAVG rate will be updated once a year, usually in January of each year, to reflect a weighted average of the current negotiated/CBA rate of the union locals from which the rate is based.

WAGE DETERMINATION APPEALS PROCESS

1.) Has there been an initial decision in the matter? This can be:

- * an existing published wage determination
- * a survey underlying a wage determination
- * a Wage and Hour Division letter setting forth a position on a wage determination matter
- * a conformance (additional classification and rate) ruling

On survey related matters, initial contact, including requests for summaries of surveys, should be with the Wage and Hour Regional Office for the area in which the survey was conducted because those Regional Offices have responsibility for the Davis-Bacon survey program. If the response from this initial contact is not satisfactory, then the process described in 2.) and 3.) should be followed.

With regard to any other matter not yet ripe for the formal process described here, initial contact should be with the Branch of Construction Wage Determinations. Write to:

Branch of Construction Wage Determinations
Wage and Hour Division
U.S. Department of Labor
200 Constitution Avenue, N.W.
Washington, DC 20210

2.) If the answer to the question in 1.) is yes, then an interested party (those affected by the action) can request review and reconsideration from the Wage and Hour Administrator (See 29 CFR Part 1.8 and 29 CFR Part 7). Write to:

Wage and Hour Administrator
U.S. Department of Labor
200 Constitution Avenue, N.W.
Washington, DC 20210

The request should be accompanied by a full statement of the interested party's position and by any information (wage payment data, project description, area practice material, etc.) that the requestor considers relevant to the issue.

3.) If the decision of the Administrator is not favorable, an interested party may appeal directly to the Administrative Review Board (formerly the Wage Appeals Board). Write to:

Administrative Review Board
U.S. Department of Labor
200 Constitution Avenue, N.W.
Washington, DC 20210

4.) All decisions by the Administrative Review Board are final.

=====

END OF GENERAL DECISION

ENCROACHMENT PERMIT

TR-0120 (REV. 6/2012)

Permit No 08-17-N-MC-0053	
Dist/Co/Rte/PM 08-RIV-111 PM 17 77-PM 18 373	
Date 03/13/2017	
Fee Paid \$ EA C5-0077	Deposit \$ EA C5-0077
Performance Bond Amount (1) \$ 0.00	Payment Bond Amount (2) \$ 0.00
Bond Company	
Bond Number (1)	Bond Number (2)

In compliance with:

- Your application of January 20, 2017
- Utility Notice No. _____ of _____
- Agreement No. _____ of _____
- R/W Contract No. _____ of _____

TO: County of Riverside- Transportation Department
 3525 14th Street
 Riverside, CA 92501
 Attn: Cathy Wampler 951-955-6803

, PERMITTEE

and subject to the following. PERMISSION IS HEREBY GRANTED to

Enter onto State Route 111 right-of-way from SR 195 to 0.60 miles south of SR 111 in Mecca, within Riverside County, to widen the existing paved shoulder for a pedestrian access route, as per plans date stamped March 13, 2017 by the Department of Transportation, Caltrans, District 8 Encroachment Permits Office and/or to the satisfaction of the Caltrans Representative.

Notwithstanding General Provision #4, your contractor is required to apply for and obtain an encroachment permit at no cost prior to start work by providing document that the project is federally funded through the Active Transportation Program (ATP). An approved SWPPP is required at the time of application.

A pre-job meeting with the assigned Caltrans Representative, Martin Morris, (909) 383-4207, is required at least 7 days prior to start of any work under this permit. Failure to do so may result in permit revocation with no prejudice.

THIS PERMIT IS NOT A PROPERTY RIGHT AND DOES NOT TRANSFER WITH THE PROPERTY TO A NEW OWNER.

The following attachments are also included as part of this permit (Check applicable)

- Yes No General Provisions
- Yes No Utility Maintenance Provisions
- Yes No Storm Water Special Provisions
- Yes No Special Provisions
- Yes No A Cal-OSHA permit, if required: Permit No. _____
- Yes No As-Built Plans Submittal Route Slip for Locally Advertised Projects
- Yes No Storm Water Pollution Prevention Plan / Water Pollution Control Plan

in addition to fee, the permittee will be billed actual costs for:

- Yes No Review
- Yes No Inspection
- Yes No Field Work

(if any Caltrans effort expended)

Yes No The information in the environmental documentation has been reviewed and considered prior to approval of this permit.

This permit is void unless the work is completed before March 13, 2018

This permit is to be strictly construed and no other work other than specifically mentioned is hereby authorized.

No project work shall be commenced until all the other necessary permits and the environmental clearances have been obtained

PERMIT ENGINEER Reza Moslemi
 COPIES TO
 Maintenance Indio 740
 EP Inspector Martin Morris
 File 17-0053

APPROVED

John Bulinski, District Director

BY

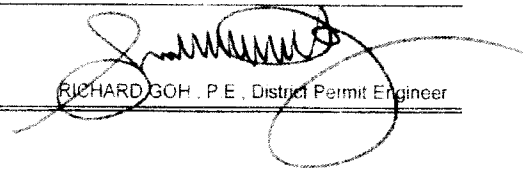
 RICHARD GOEH, P.E., District Permit Engineer

Except for installing, maintaining and removing traffic control devices, any work encroaching within 3 feet of the edge of a travel lane for areas with a posted speed limit below 45mph, or 6 feet of the edge of a travel lane, for areas with a speed limit posted at 45mph or higher, shall require closing of that travel lane. Any work encroaching within 6 feet of the edge of the shoulder, shall require closing of that shoulder. Permittee shall notify the Department's Representative, and obtain approval of, all traffic control, lane closures or detours, at least seven (7) WORKING DAYS prior to setting up of any traffic control.

No lane may be closed or obstructed at any time unless specifically allowed per the encroachment permit, shown in approved traffic control plans, and/or as directed by the Department's Representative.

Traffic control is generally authorized between 9:00 AM and 3:00 PM only on Monday through Thursday and until 1:00 PM on Fridays, excluding holidays except specified in the Permit. Lane closure is not allowed on Saturdays, Sundays and designated holidays. The designated holidays are: January 1st, the third Monday in January, the second and third Mondays in February, March 31, the last Monday in May, July 4th, the first Monday in September, the second Monday in October, November 11th, Thanksgiving Day, the day after Thanksgiving Day, and December 25th. When a fixed holiday falls on Saturday, the preceding Friday shall be designated as holiday.

Should any deviation from these procedures or conditions be observed, all work shall be suspended until satisfactory steps have been taken to ensure compliance.

If time extension is necessary, a request for time extension and the accompanying attachments must be made a minimum of two (2) weeks prior to completion date stated on face of permit. If work has not been started before completion date, the permit will be voided. Failure to comply with rules and regulations stated on permit will jeopardize future permit privileges.

"AS-BUILT" PLANS ARE REQUIRED UPON COMPLETION OF ALL WORK. PLEASE REFER TO THE GENERAL PROVISION TR-0045, ITEM 22 FOR THE "AS-BUILT" REQUIREMENTS. NO FINAL INSPECTION WILL BE PERFORMED UNTIL THE DEPARTMENT IS IN RECEIPT OF "AS-BUILT" PLANS.

No vehicle or equipment shall be stored overnight within the right of way; it shall be removed immediately at the completion of the day's work. Refueling of vehicle or equipment within the right of way is strictly prohibited.

Required traffic control devices shall be installed around fixed objects to warn the motoring public for safety. Personal vehicles of the contractor shall not be parked within freeway right of way.

No materials or waste shall be stockpiled within State right of way.

Except as specifically provided herein, all requirements of the Vehicle Code and other applicable laws must be complied with in all particulars.

When traffic cones or delineators are used to delineate a temporary edge of traffic lane, the line of cones or delineators shall be considered to be the edge of the traffic lane. The permittee shall not reduce the width of the existing lane to less than 10 feet without written approval from the Department's Representative.

Excavations made within the limits of the right of way shall be backfilled and resurfaced to original condition before leaving the work area unless otherwise authorized by the Department's Representative.

- Permittee shall be responsible for arranging the services of a qualified traffic control contractor to provide any needed traffic control.
- The permittee shall arrange a meeting between his field representative, traffic control contractor, Department's Representative and/or CHP at least two (2) weeks prior to start of any work covered under this permit to arrange date and time of starting work and determine appropriate methods of handling traffic. At least 3 working days notice shall be given to the Caltrans representative and/or the CHP, prior to the meeting to allow time to arrange for attendance.

- A copy of this permit, complete with all attachments, shall be kept by permittee/contractor working under this permit and must be shown to the Department Permit Inspector, Department's Representatives, or Law Enforcement Officer, on demand.

- The permittee shall be responsible for notifying the appropriate utility companies or underground service alert prior to any excavation work.

- The permittee shall notify the California Highway Patrol Area Commander at least 72 hours prior to implementing traffic control.

- When the work area encroaches upon a sidewalk, walkway, or crosswalk area, special consideration must be given to pedestrian safety. Protective barricades, fencing, handrails and bridges, together with warning and guidance devices and signs must be utilized so that the passageway for pedestrians, especially blind and other physically handicapped, is safe and well defined and shown on the approved permit plan.

- Pedestrian walkways and canopies within State Right of Way shall comply with the requirements of the applicable local agency or of the latest edition of the Uniform Building Code whichever contains the higher standards.

[For City or County projects with utility relocations:]

If existing public or private utilities conflict with the construction PROJECT, PERMITTEE will make necessary arrangements with the owners of such utilities for their protection, relocation, or removal. PERMITTEE shall inspect the protection, relocation, or removal of such facilities. Total costs of such protection, relocation, or removal which STATE or PERMITTEE must legally pay, will be borne by PERMITTEE. If any protection, relocation, or removal of utilities is required, including determination of liability for cost, such work shall be performed in accordance with STATE policy and procedure. PERMITTEE shall require any utility company performing relocation work in the STATE's right-of-way to obtain a State Encroachment Permit before the performance of said relocation work. Any relocated utilities shall be correctly located and identified on the as-built plans.

[For other projects with utility relocations:]

If existing public or private utilities conflict with the construction PROJECT, PERMITTEE will make necessary arrangements with the owners of such utilities for their protection, relocation, or removal. PERMITTEE shall inspect the protection, relocation, or removal of such facilities. Total costs of such protection, relocation, or removal shall be borne by PERMITTEE in compliance with the terms of the Highway Encroachment Permits, Case Law, Public Utility Regulations, and Property Rights. PERMITTEE shall require any utility company performing relocation work in the STATE's right-of-way to obtain a State Encroachment Permit before the performance of said relocation work. Any relocated utilities shall be correctly located and identified on the as-built plans.

PERMIT NO.: 08-17-N-MC-0053

CO/RTE/PM: 08/RIV/111/17.77-18.373

PRECONSTRUCTION MEETING AGREEMENT

I, _____, acting as an authorized agent for the permittee, _____, do hereby agree to personally accomplish or have another designated person arrange for all involved company representatives to attend a pre-construction meeting with the authorized Department's Representative at _____, as specified on this permit. Such meeting must be held two (2) days or more prior to the planned start of the work on this project. The Authorized Department's Representative shall have complete authority to determine whether the permit conditions, either implied or written, have been complied with. The Department's Representative may then allow the permit work to proceed as appropriate. The Pre-construction Meeting Record below must be signed by both the Department's Representative and the permittee before the permit work may start.

I have read and understand the attached General Provisions TR-0045 and other attached provisions of this permit.

This agreement or a copy thereof, must be mailed back to the **Department's District 8 Encroachment Permit Office at 464 W. 4th. Street, MS 619, San Bernardino, CA 92401-1400**, within three (3) working days prior to the pre-construction meeting. Failure to return this form could delay the release of your bonds. A copy of this document shall be at the job site at all times when work is in progress and failure to do so may result in the suspension of work, as directed by the Department's Representative.

It is the permittee's responsibility to insure that the Department's Representative is notified of work completion and that the attached Completion Notice is mailed to the Department's Permit office.

Signature Date

Print or Type Name

Position or Title

PRECONSTRUCTION MEETING RECORD

Department's Representative

Date

Permittee's Representative

Date

Date Work May Begin: _____

TRAFFIC CONTROL PLAN GENERAL NOTES

1. ALL WORK AND MATERIAL SHALL COMPLY WITH THE 2012 CALIFORNIA MANUAL ON UNIFORM CONTROL DEVICES AND MARKINGS TO THE STATE OF CALIFORNIA STANDARD PLANS AND SPECIFICATIONS.
2. ALL STRIPING AND MARKINGS SHALL CONFORM TO THE STATE OF CALIFORNIA STANDARD PLANS AND SPECIFICATIONS.
3. ALL WORK SHALL BE 4" MINIMUM HEIGHT AND CONES SHALL BE 28" MINIMUM HEIGHT WITH 12" DIA. AND MAINTAINED DIRECT IN THE INDICATED POSITION AT ALL TIMES AND SHALL BE REPAIRED OR REPLACED AS NECESSARY TO PRESERVE THEIR APPEARANCE THROUGHOUT THE WORK.
4. THE CONTRACTOR SHALL MAINTAIN, ON A CONTINUOUS BASIS, ALL SIGNS, DEFINATORS AND CHANNELIZERS IN PLACE AND IN GOOD CONDITION THROUGHOUT THE WORK.
5. THE CONTRACTOR SHALL MAINTAIN ALL SIGNS, DEFINATORS, CHANNELIZERS, ETC. PROPERLY INSTALLED PRIOR TO COMMENCING CONSTRUCTION.
6. THE CONTRACTOR SHALL MAINTAIN ALL SIGNS, DEFINATORS, CHANNELIZERS, ETC. PROPERLY THROUGHOUT THE WORK.
7. ADDITIONAL TRAFFIC CONTROLS, TRAFFIC SIGNS OR BARRIERS MAY BE REQUIRED IN THE FIELD. THE CONTRACTOR SHALL BE RESPONSIBLE FOR THE PLACEMENT OF ANY ADDITIONAL TRAFFIC CONTROLS, TRAFFIC SIGNS OR BARRIERS AS REQUIRED BY THE CALTRANS ENGINEER BASED UPON CONSTRUCTION CONDITIONS.
8. THE CONTRACTOR SHALL MAINTAIN ALL TRAFFIC SIGNS AS SHOWN ON THE CALTRANS PLAN AND SHALL MAINTAIN THEM THROUGHOUT THE WORK.
9. ALL WORK SHALL BE COMPLETED WITHIN THE HOURS OF 7:00 AM AND 5:00 PM, MONDAY THROUGH FRIDAY.
10. REMOVE OR TURN SIGNS DURING NON-WORKING HOURS.
11. A MINIMUM OF 5 FEET CLEARANCE SHALL BE MAINTAINED BETWEEN ANY OPEN EXCAVATION AND THE TRAFFIC CONTROL PLAN.
12. THE CONTRACTOR SHALL PROVIDE FLAGGERS AS DEEMED NECESSARY BY THE CALTRANS ENGINEER.
13. FLAGGERS SHALL COMPLY WITH CHAPTER 11.11.1 FLAGGER CONTROL OF THE 2012 CALIFORNIA MANUAL ON UNIFORM CONTROL DEVICES AND MARKINGS AND SHALL MAINTAIN PEDESTRIAN ACCESS AT ALL TIMES PER ADA REQUIREMENTS. SIDEWALK CLOSURE/WORK SHALL COMPLY WITH THE CALTRANS PLAN.
14. THE CONTRACTOR SHALL NOTIFY AFFECTED SCHOOLS, BUSINESSES, HOMEOWNERS, POLICE AND FIRE DEPARTMENTS ONE (1) WEEK PRIOR TO START OF WORK.
15. THE CONTRACTOR SHALL MAINTAIN CONTACT AND TELEPHONE NUMBER FOR RESPONSE TO TRAFFIC CONTROL ISSUES.
16. SIGNS SHALL BE 48" INDIVIDUAL VISIBILITY TRAFFIC SIGNS.

- LEGEND**
- Work Zone (Activity Area) Limits
 - Channelizing Device
 - Sign
 - Direction of Traffic (Not Pavement Marking)

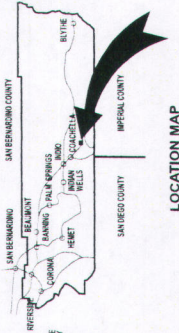
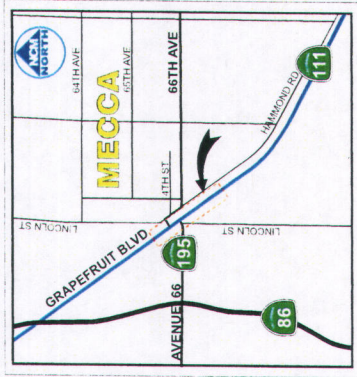

VICINITY MAP

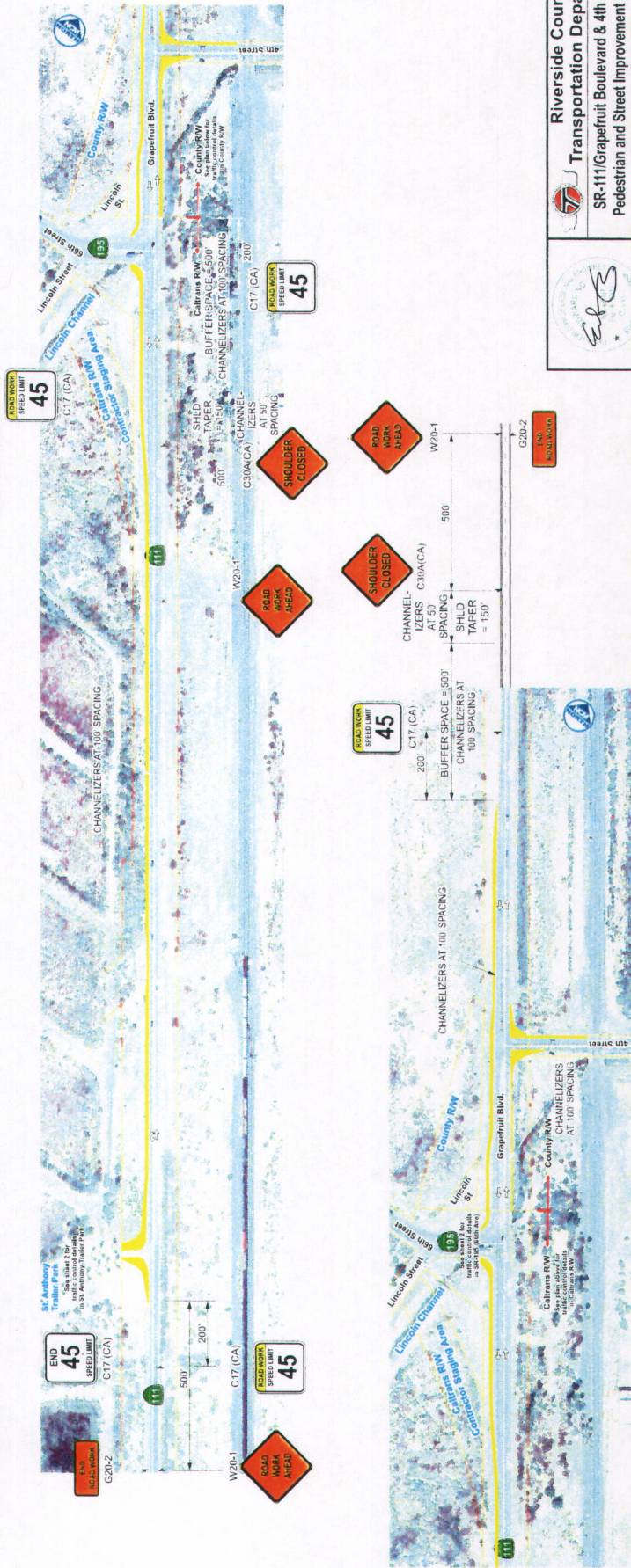





Riverside County
Transportation Department
SR-111/Grapefruit Boulevard & 4th Street
Pedestrian and Street Improvement Project
 County Project # C5-0077
Traffic Control Plan
for Shoulder Widening

REVISIONS

NO.	DATE	DESCRIPTION
1		
2		

JANUARY 2017

- LEGEND**
-  Work Zone (Activity Area) Limits
 -  Channelizing Device
 -  Sign
 -  Direction of Traffic (Not Pavement Marking)

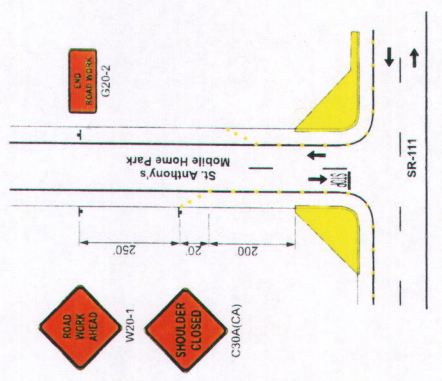

TRAFFIC CONTROL FOR ST. ANTHONY MOBILE HOME PARK DRIVEWAY

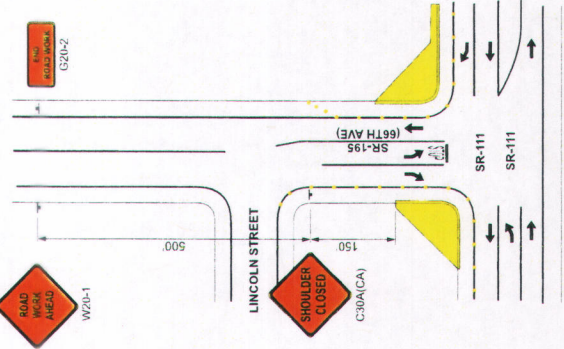

TRAFFIC CONTROL FOR SR-195 (66TH AVENUE)



Riverside County
Transportation Department
 SR-111/Grapefruit Boulevard & 4th Street
 Pedestrian and Street Improvement Project
 County Project # CS-0077
Traffic Control Plan
for Shoulder Widening

REVISIONS

NO.	DATE	DESCRIPTION
2		
1		

CALTRANS PERMIT # 08-XXXXXXX

LEGEND

- Pothole Location
- Work Zone (Activity Area) Limits
- Channelizing Device
- Sign
- Direction of Traffic (Not Pavement Marking)

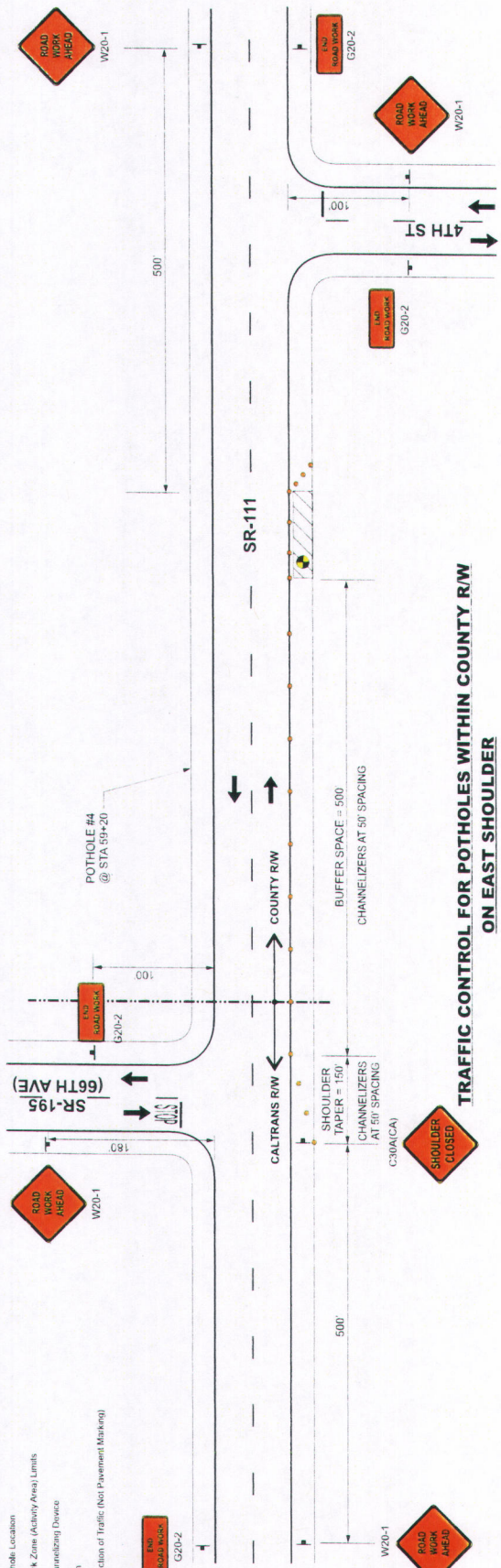

**TRAFFIC CONTROL FOR POTHOLES WITHIN COUNTY R/W
ON EAST SHOULDER**



**TRAFFIC CONTROL FOR POTHOLES WITHIN COUNTY R/W
ON WEST SHOULDER**

Riverside County
Transportation Department
 SR-111/Grapefruit Boulevard & 4th Street
 Pedestrian and Street Improvement Project
 County Project # C5-0077
Traffic Control Plan
for Shoulder Widening
 JANUARY, 2017

REVISIONS

CALTRANS PERMIT # 08-XXXXXXX

Stage 1 Construction

- Remove traffic signal poles and equipment and install temporary traffic signal
- Restripe WB lanes into single right-turn/left-turn lane at intersection
- Install K-railing along north side of WB traveled way
- Remove north side barrier, paving, and 4' width of top slab
- Construct RCB north side soffit and wall repairs and reconstruct portion of existing top slab
- Remove existing north side wingwalls and invert slab
- Construct north side bridge widening, soffit slab, and wingwalls
- Construct initial asphalt concrete surfacing on new bridge

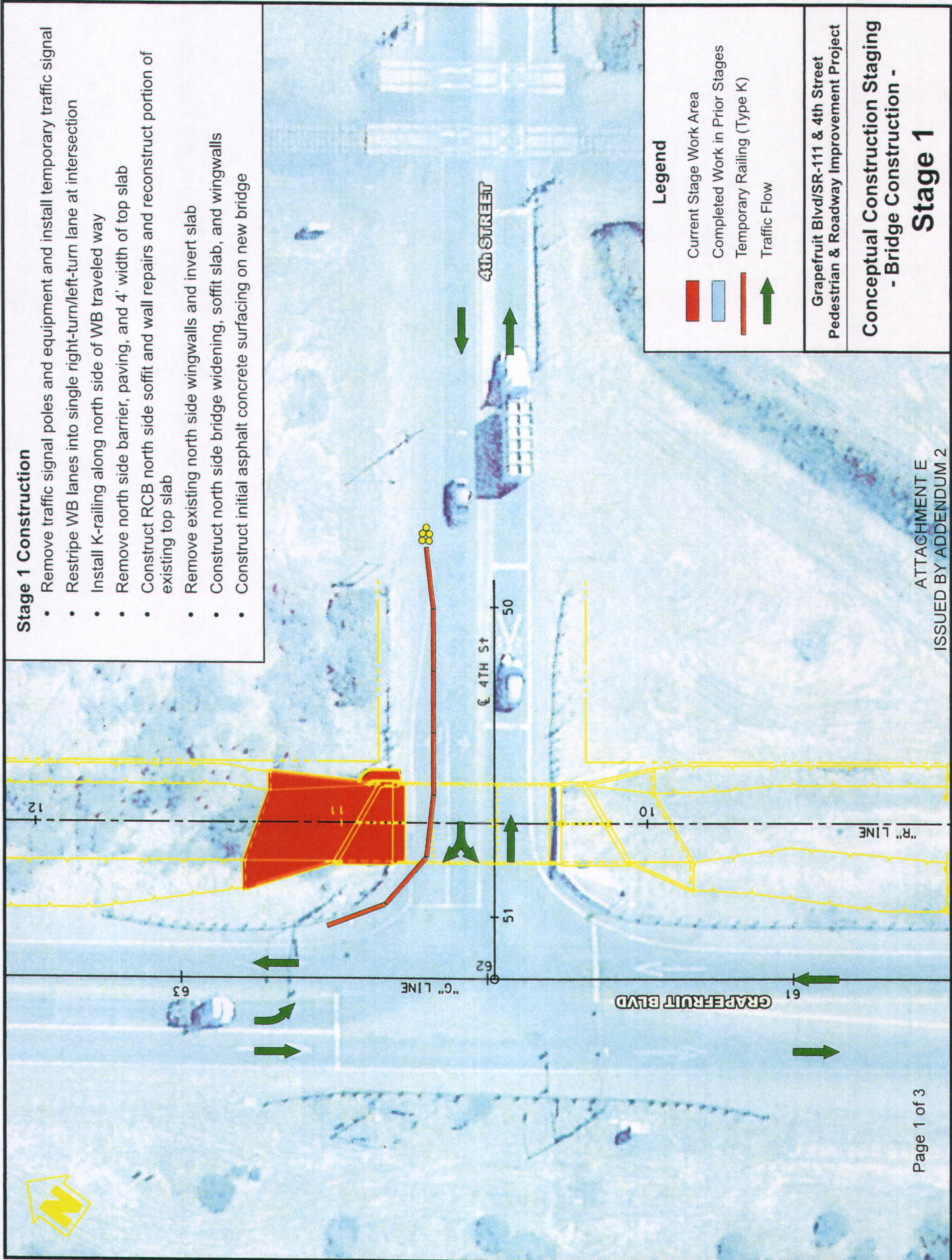

Legend

- Current Stage Work Area
- Completed Work in Prior Stages
- Temporary Railing (Type K)
- Traffic Flow

Grapefruit Blvd/SR-111 & 4th Street
Pedestrian & Roadway Improvement Project

Conceptual Construction Staging
- Bridge Construction -
Stage 1

Stage 2 Construction

- Shift the north side K-railing and WB striping northerly onto the widened bridge
- Install K-railing along south side of EB traveled way
- Remove south side barrier, paving, and 4' width of top slab
- Construct RCB south side soffit and wall repairs and reconstruct top slab
- Remove existing south side wingwalls and invert slab
- Construct south side bridge widening, soffit slab, and wingwalls
- Construct initial asphalt concrete surfacing on new south bridge
- Together with roadway grading, regrade channel and install rock slope protection

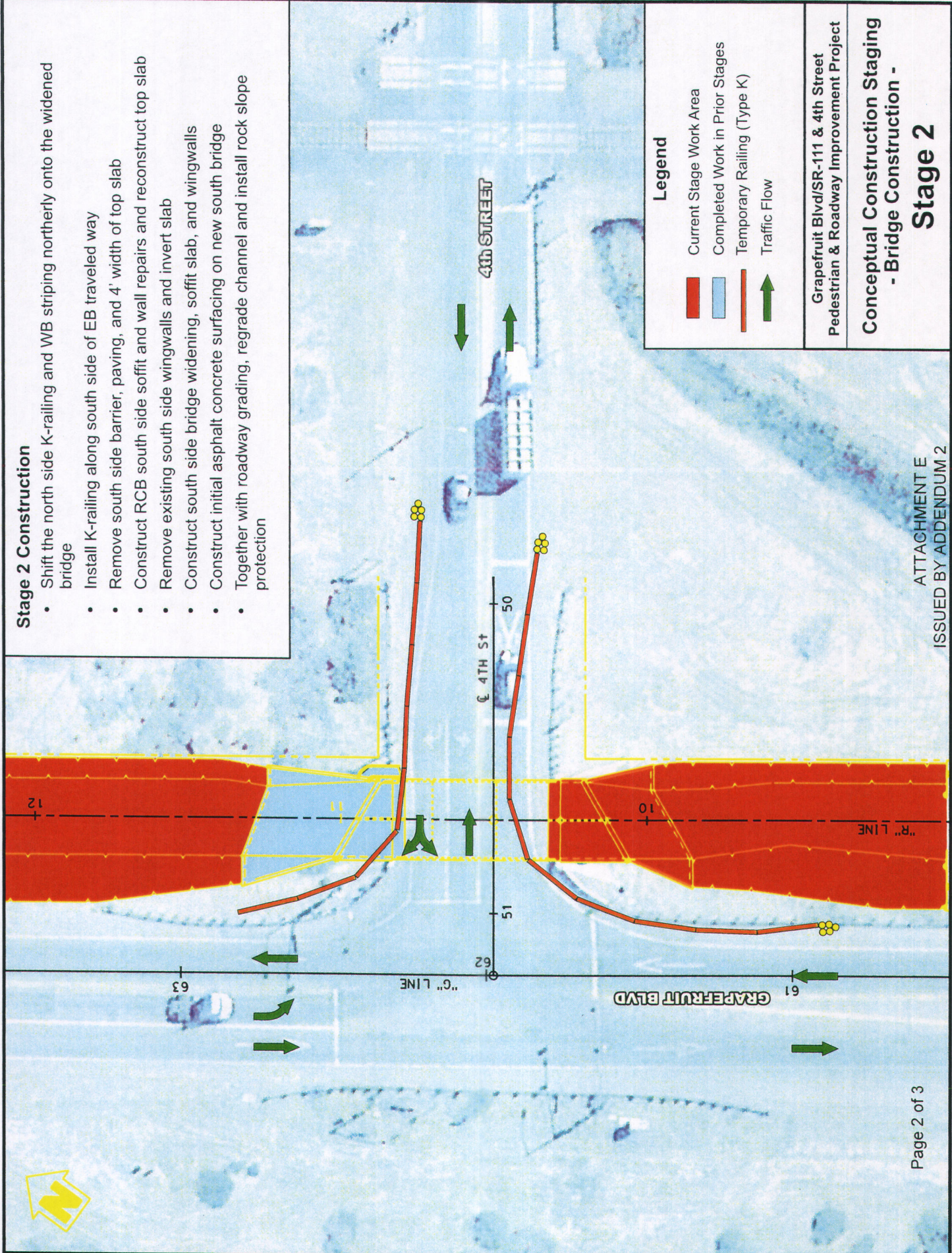

Legend

- Current Stage Work Area
- Completed Work in Prior Stages
- Temporary Railing (Type K)
- Traffic Flow

Grapefruit Blvd/SR-111 & 4th Street
Pedestrian & Roadway Improvement Project

Conceptual Construction Staging -
- Bridge Construction -
Stage 2

Stage 3 Construction

- Close 4th Street at Grapefruit Blvd and at Hammond Road. Use portable traffic delineators to close SB left turn pocket. Closure to be limited to weekends only.
- Detour traffic to Grapefruit Blvd/62nd (north) and SR-111/Thobe Road (south)
- Remove asphalt concrete pavement from existing RCB surface. Remove unsound concrete, patch with rapid setting concrete, treat surface with methacrylate resin
- Lay initial asphalt concrete pavement onto treat surface.
- Restripe and open 4th Street to traffic.

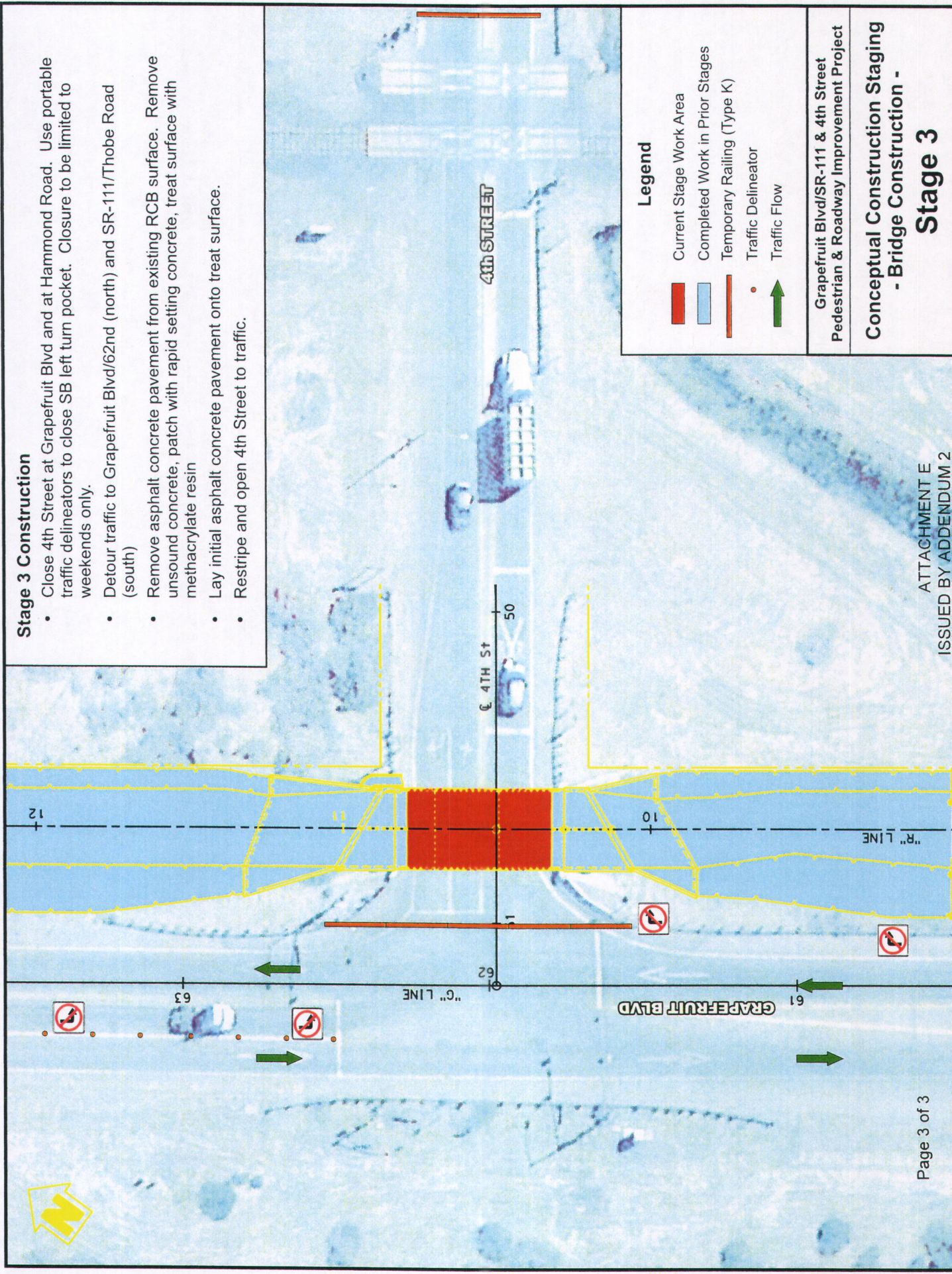

Legend

- Current Stage Work Area
- Completed Work in Prior Stages
- Temporary Railing (Type K)
- Traffic Delineator
- ➔ Traffic Flow

Grapefruit Blvd/SR-111 & 4th Street
Pedestrian & Roadway Improvement Project

Conceptual Construction Staging -
- Bridge Construction -
Stage 3

ATTACHMENT E
ISSUED BY ADDENDUM 2

Pavement Construction Staging Notes

- Restripe NB and SB lanes along SR-111 & Grapefruit Blvd.
- Install K-Railing along the west side of the SB lane.
- Construct Extended Pavement Section and HMA Overlay.
- Cold plane and place overlay along Grapefruit Blvd.

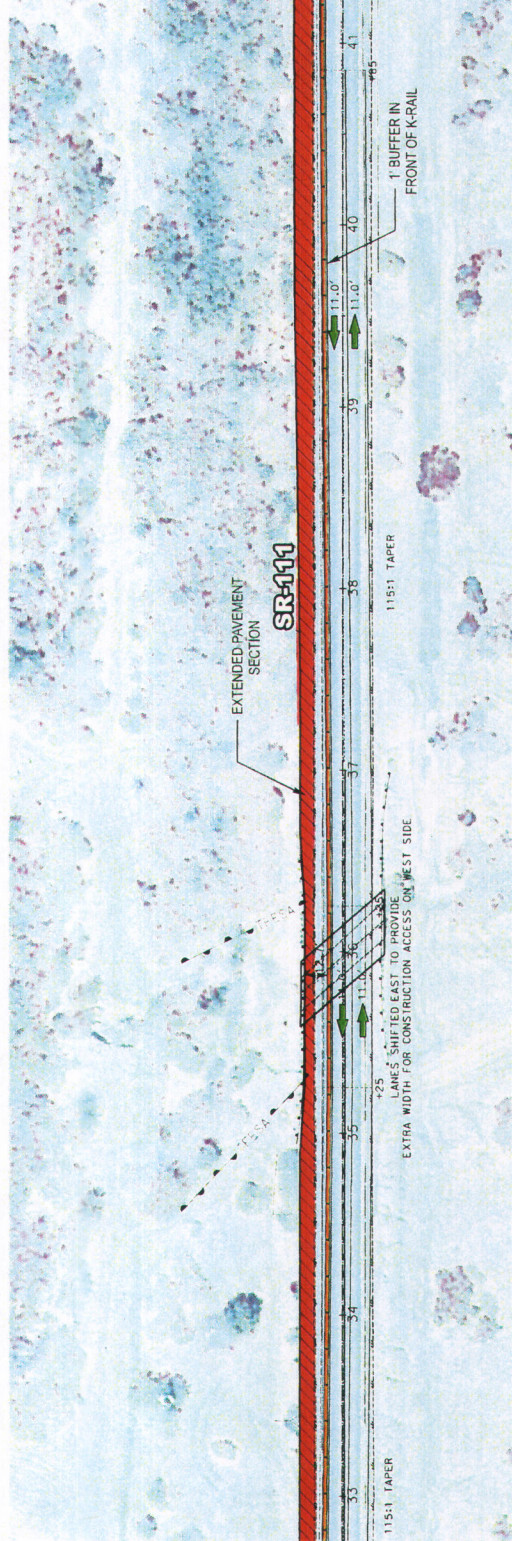
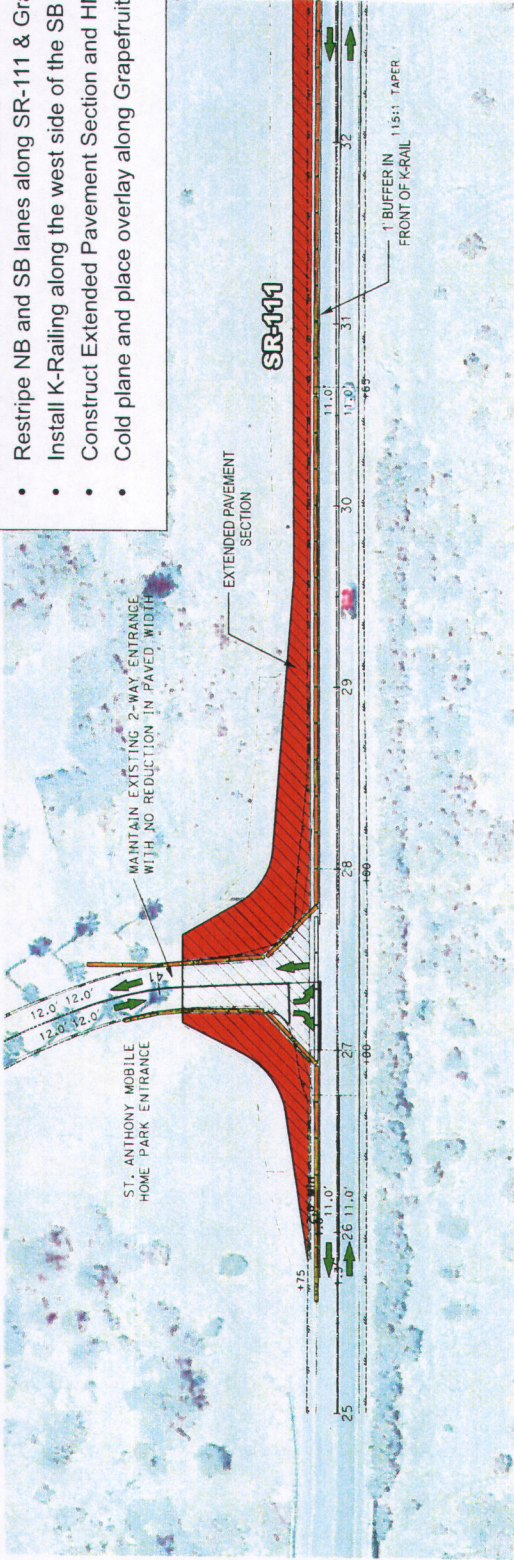

Legend

- Current Stage Work Area
- Completed Work in Prior Stages
- Temporary Railing (Type K)
- Traffic Delineator
- Traffic Flow

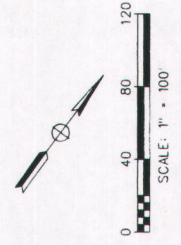

ATTACHMENT F
ISSUED BY ADDENDUM 2

Grapefruit Blvd/SR-111 & 4th Street
Pedestrian & Roadway Improvement Project

**Conceptual Construction Staging -
- Pavement Construction -**



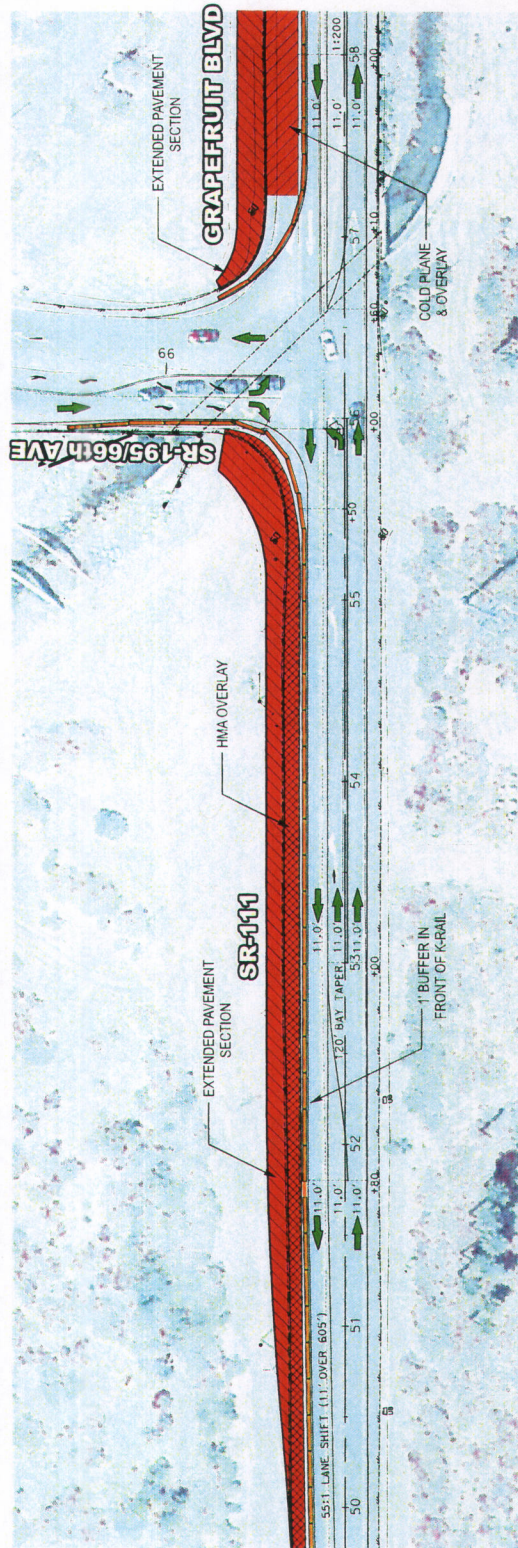
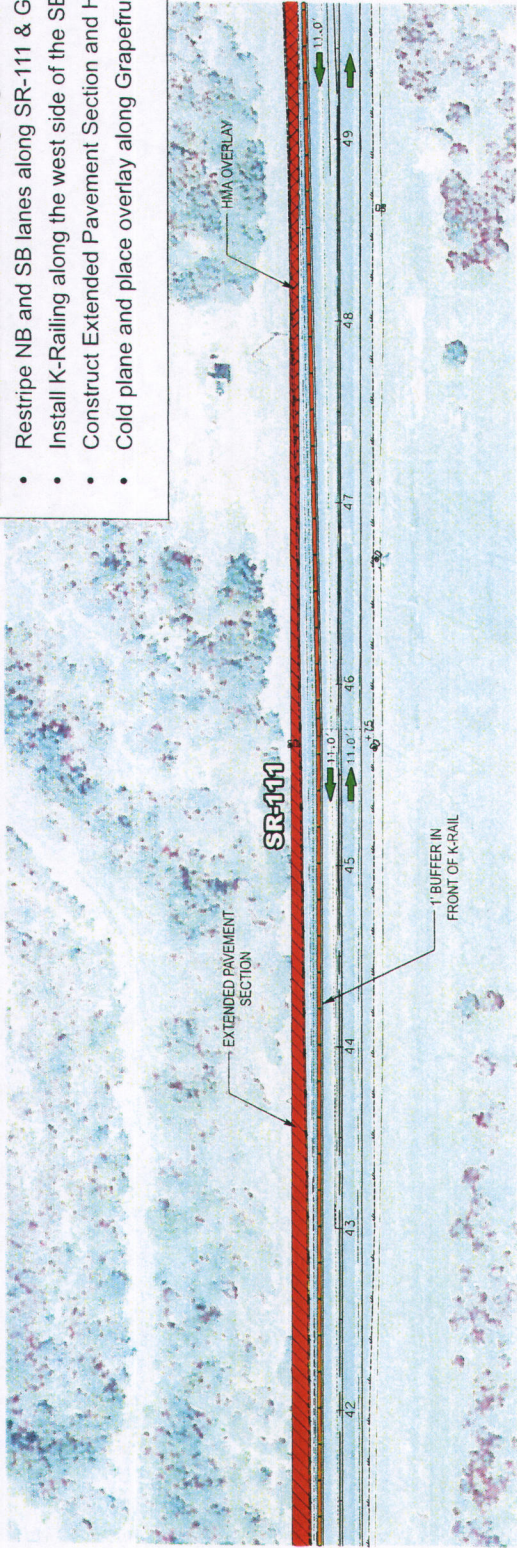

Stage 1

Pavement Construction Staging Notes

- Restripe NB and SB lanes along SR-111 & Grapefruit Blvd.
- Install K-Railing along the west side of the SB lane.
- Construct Extended Pavement Section and HMA Overlay.
- Cold plane and place overlay along Grapefruit Blvd.



Legend

-  Current Stage Work Area
-  Completed Work in Prior Stages
-  Temporary Railing (Type K)
-  Traffic Delineator
-  Traffic Flow

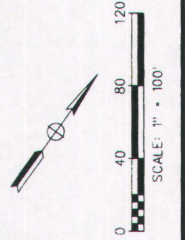

ATTACHMENT F
ISSUED BY ADDENDUM 2

Grapefruit Blvd/SR-111 & 4th Street
Pedestrian & Roadway Improvement Project

Conceptual Construction Staging -
- Pavement Construction -

Stage 1

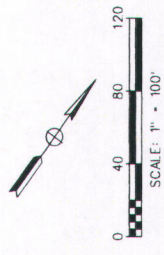
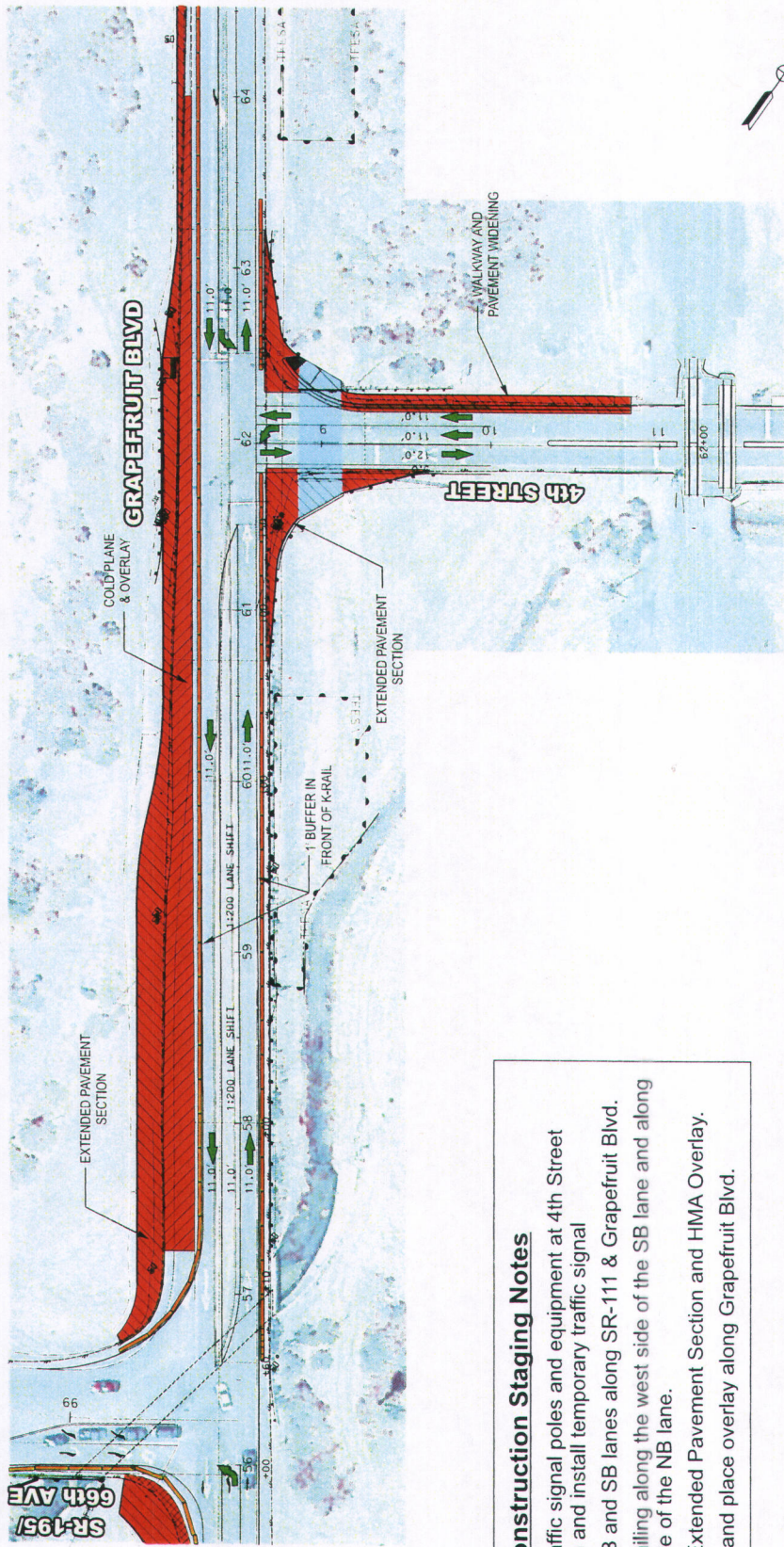

Legend

█	Current Stage Work Area
█	Completed Work in Prior Stages
█	Temporary Railing (Type K)
●	Traffic Delineator
→	Traffic Flow

Grapefruit Blvd/SR-111 & 4th Street
 Pedestrian & Roadway Improvement Project

**Conceptual Construction Staging -
 - Pavement Construction -
 Stage 1**

- Pavement Construction Staging Notes**
- Remove traffic signal poles and equipment at 4th Street intersection and install temporary traffic signal
 - Restripe NB and SB lanes along SR-111 & Grapefruit Blvd.
 - Install K-Railing along the west side of the SB lane and along the east side of the NB lane.
 - Construct Extended Pavement Section and HMA Overlay.
 - Cold plane and place overlay along Grapefruit Blvd.

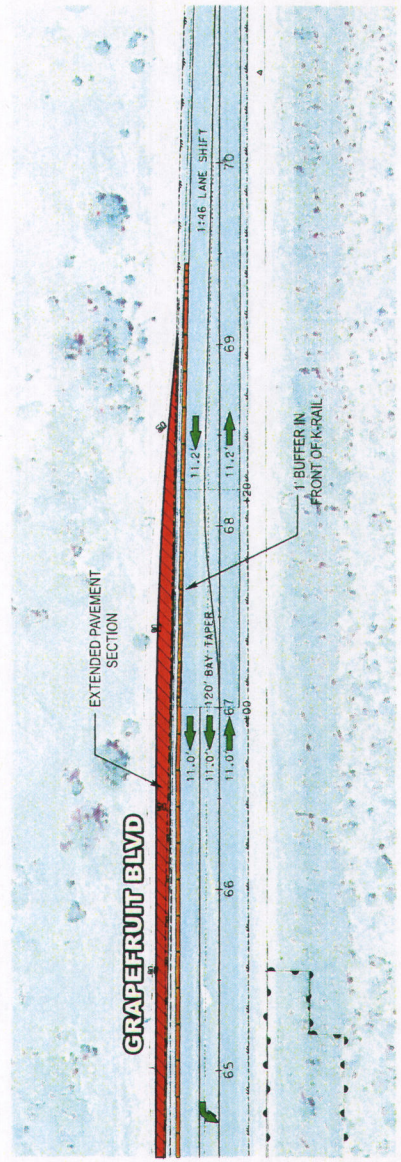

Pavement Construction Staging Notes

- Close the mobile home park entrance. Closure to be limited to one weekend only.
- Detour traffic to and from the mobile home park to 68th Avenue and Lincoln Street.
- Complete remaining pavement at the mobile home park entrance.

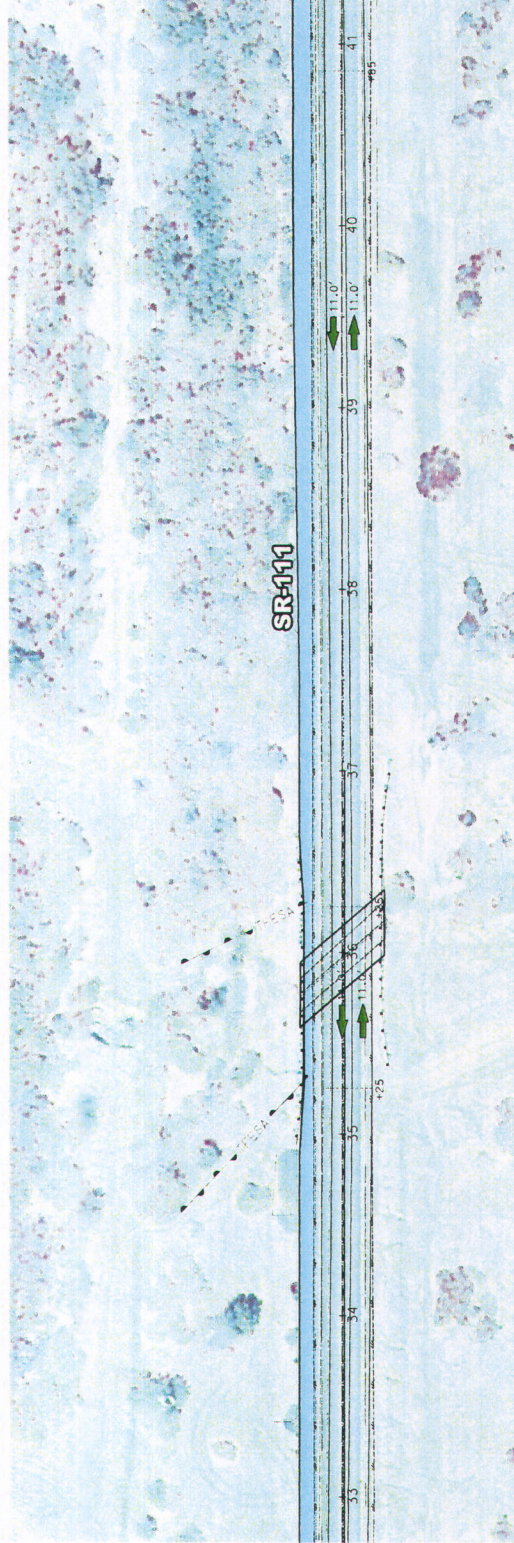
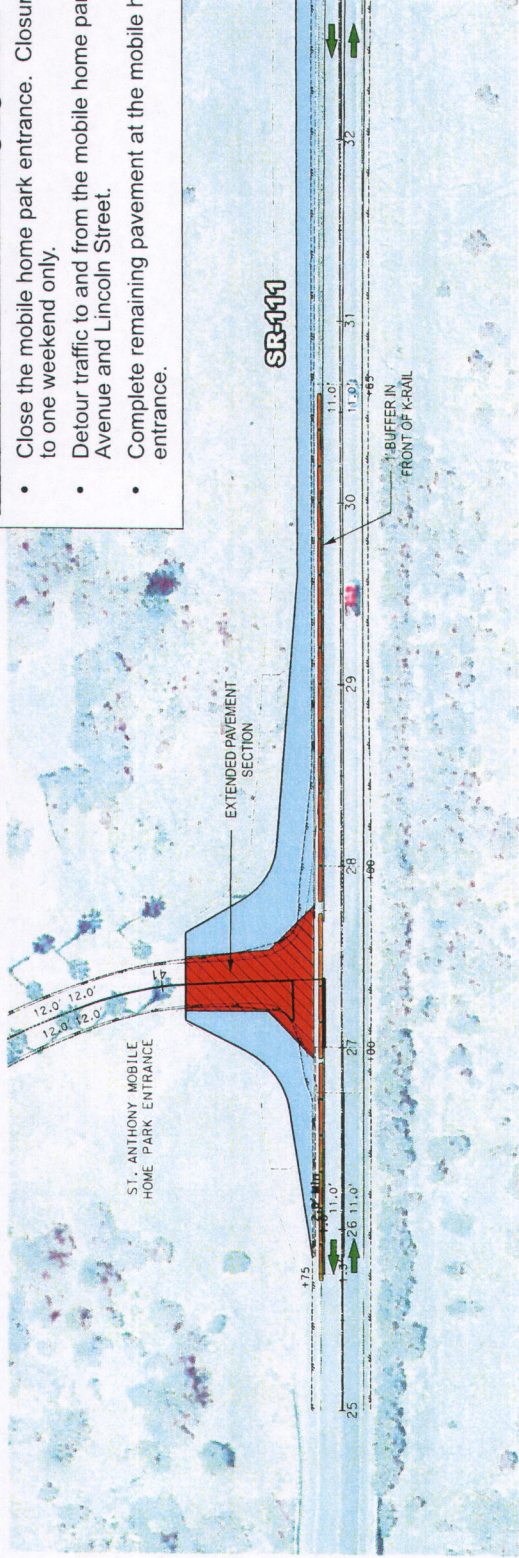

Legend

- Current Stage Work Area
- Completed Work in Prior Stages
- Temporary Railing (Type K)
- Traffic Delineator
- ➔ Traffic Flow

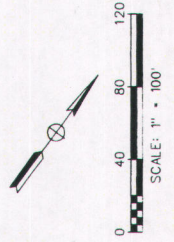

ATTACHMENT F
ISSUED BY ADDENDUM 2

Grapefruit Blvd/SR-111 & 4th Street
Pedestrian & Roadway Improvement Project

**Conceptual Construction Staging -
- Pavement Construction -**

Stage 2A

Pavement Construction Staging Notes

- Remove K-Railing, install temporary striping, and shift SB traffic to median and close SB lane with portable delineators during one night-time closure using one-way-reversing traffic-control.
- Cold plane and place overlay for SB lane along Grapefruit Blvd. Complete entire SB lane in one shift.

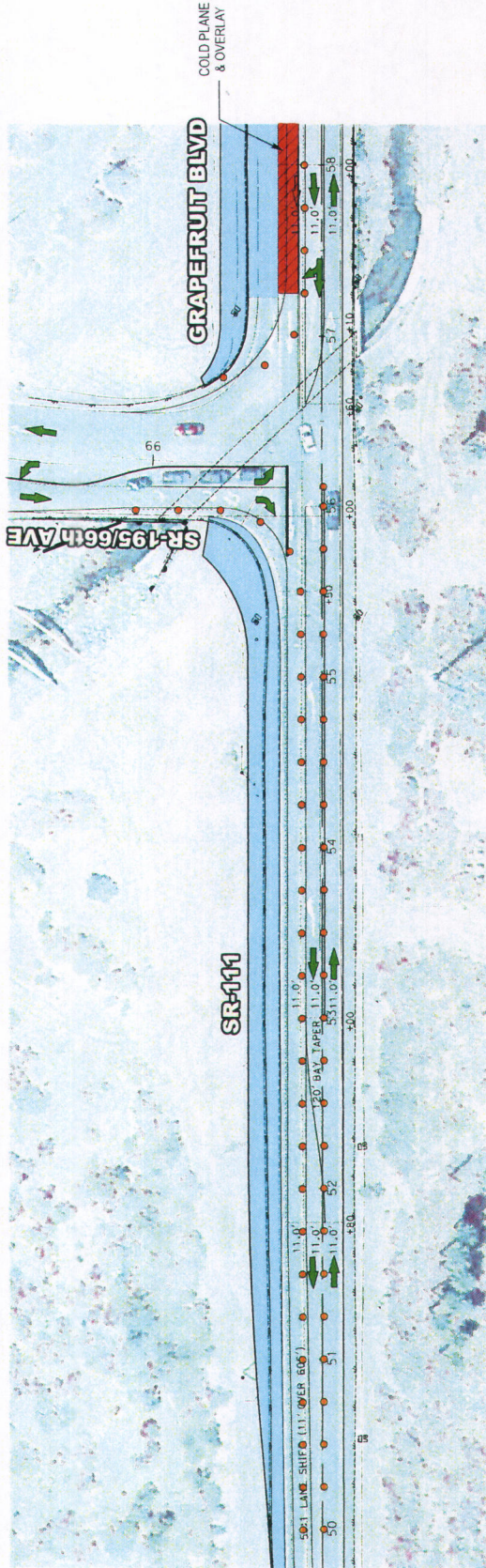
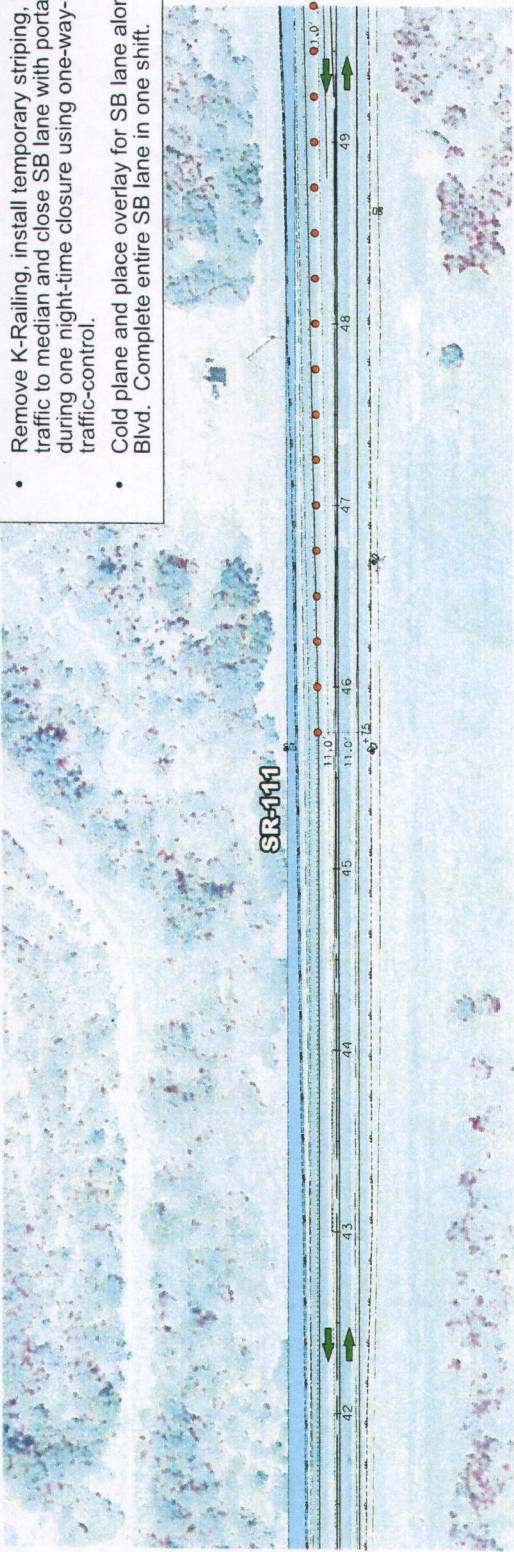

Legend

- Current Stage Work Area
- Completed Work in Prior Stages
- Temporary Railing (Type K)
- Traffic Delineator
- Traffic Flow

Grapefruit Blvd/SR-111 & 4th Street
Pedestrian & Roadway Improvement Project

Conceptual Construction Staging - Pavement Construction -

Stage 2A

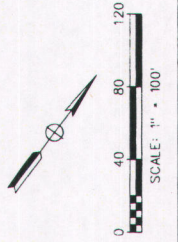

ATTACHMENT F
ISSUED BY ADDENDUM 2

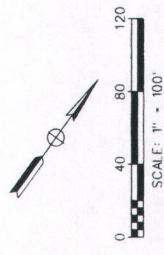
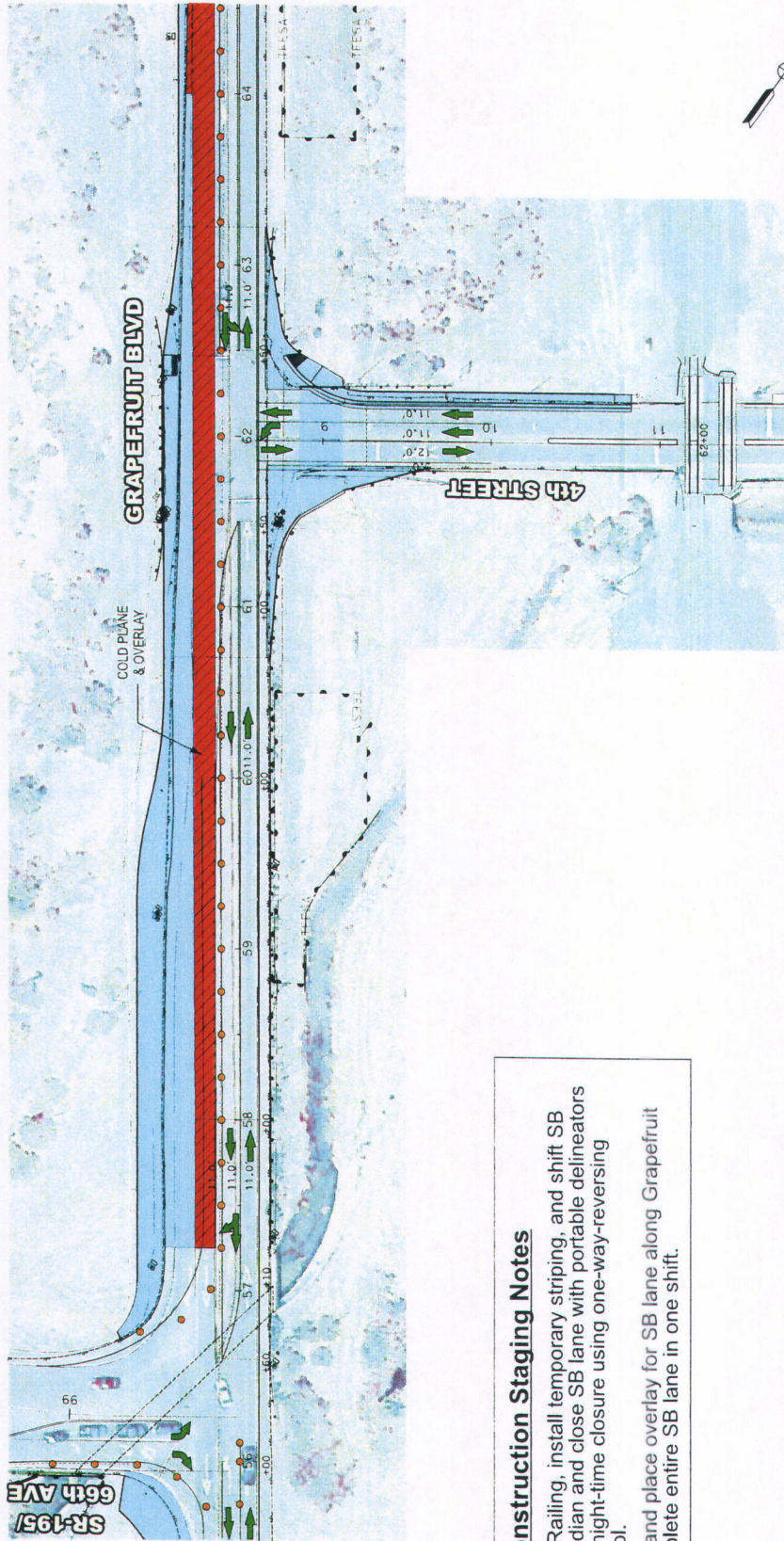

Pavement Construction Staging Notes

- Remove K-Railing, install temporary striping, and shift SB traffic to median and close SB lane with portable delineators during one night-time closure using one-way-reversing traffic-control.
- Cold plane and place overlay for SB lane along Grapefruit Blvd. Complete entire SB lane in one shift.

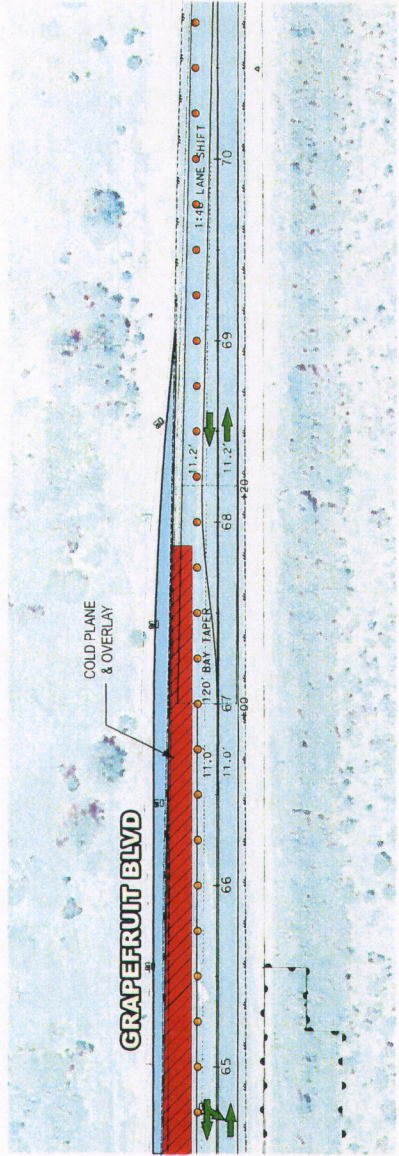

Legend

- Current Stage Work Area
- Completed Work in Prior Stages
- Temporary Railing (Type K)
- Traffic Delineator
- Traffic Flow

Grapefruit Blvd/SR-111 & 4th Street
Pedestrian & Roadway Improvement Project

**Conceptual Construction Staging -
- Pavement Construction -**



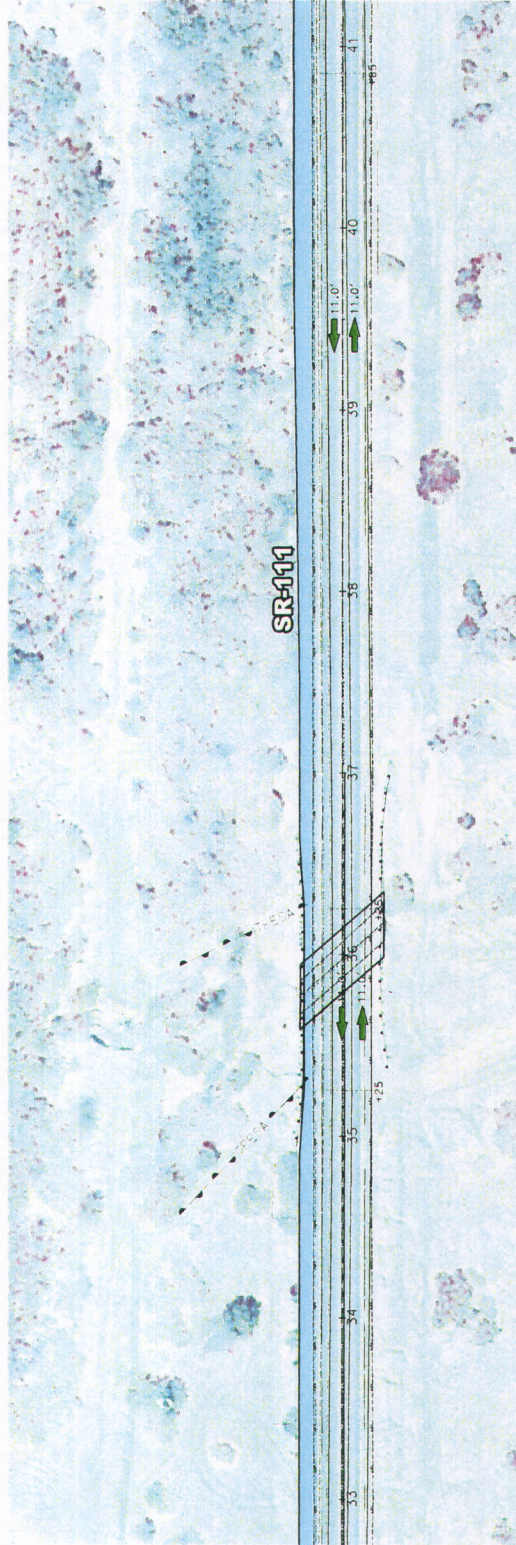
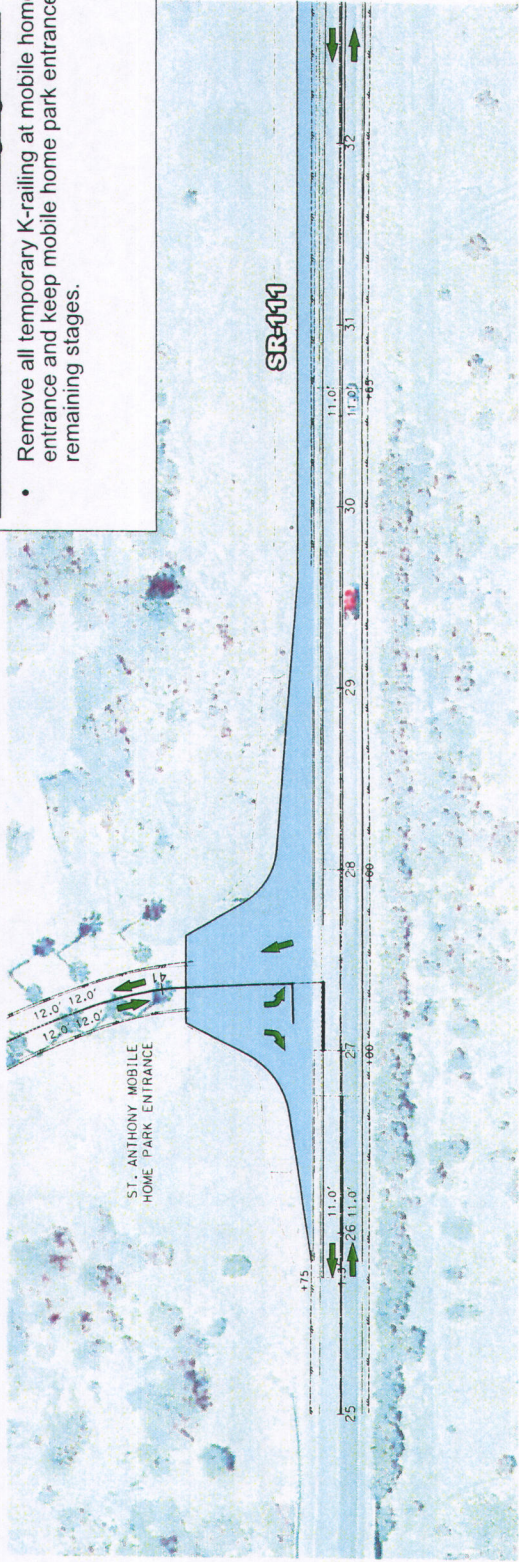

Stage 2A

Pavement Construction Staging Notes

- Remove all temporary K-railing at mobile home park entrance and keep mobile home park entrance open for all remaining stages.

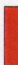

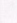
Legend

-  Current Stage Work Area
-  Completed Work in Prior Stages
-  Temporary Railing (Type K)
-  Traffic Delineator
-  Traffic Flow

Grapefruit Blvd/SR-111 & 4th Street
Pedestrian & Roadway Improvement Project

Conceptual Construction Staging
- Pavement Construction -

Stage 2B

ATTACHMENT F
ISSUED BY ADDENDUM 2

Pavement Construction Staging Notes

- Install temporary striping, and shift all traffic to SB and NB lanes and close median with portable delineators during one night-time closure using one-way-reversing traffic-control.
- SB left turn onto 4th street will be prohibited. Detour traffic to Grapefruit Blvd/62nd (north) and SR-111/Thobe Road (south).
- Cold plane and place overlay for median area. Complete entire median area in one shift.

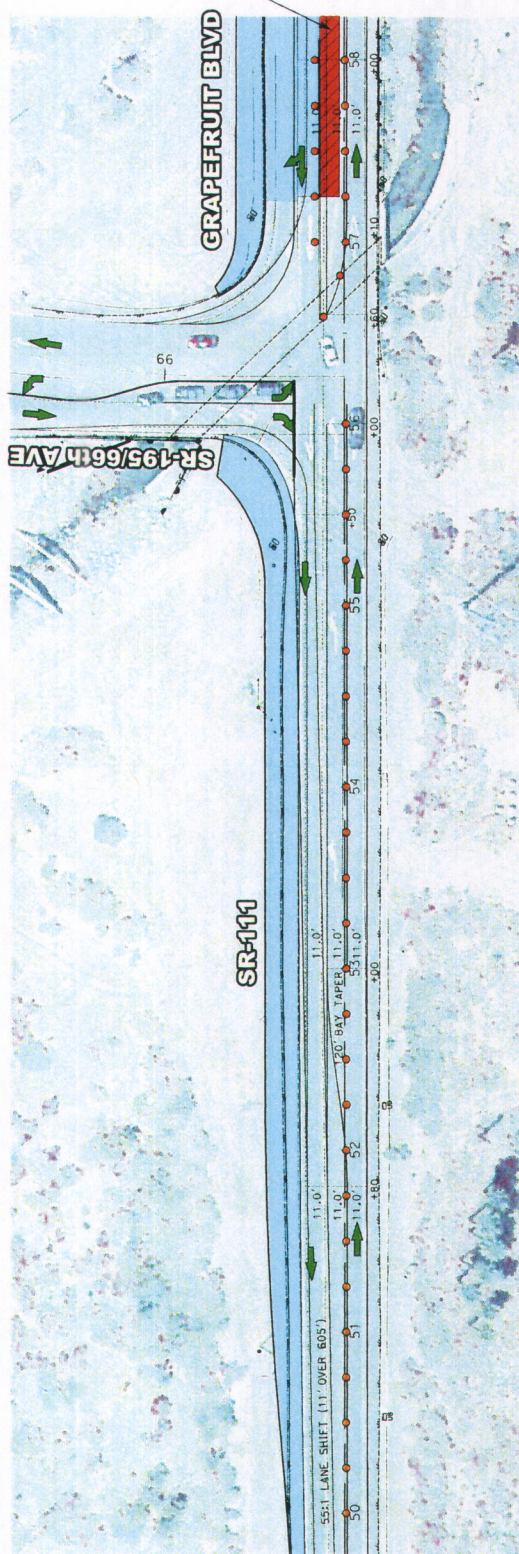
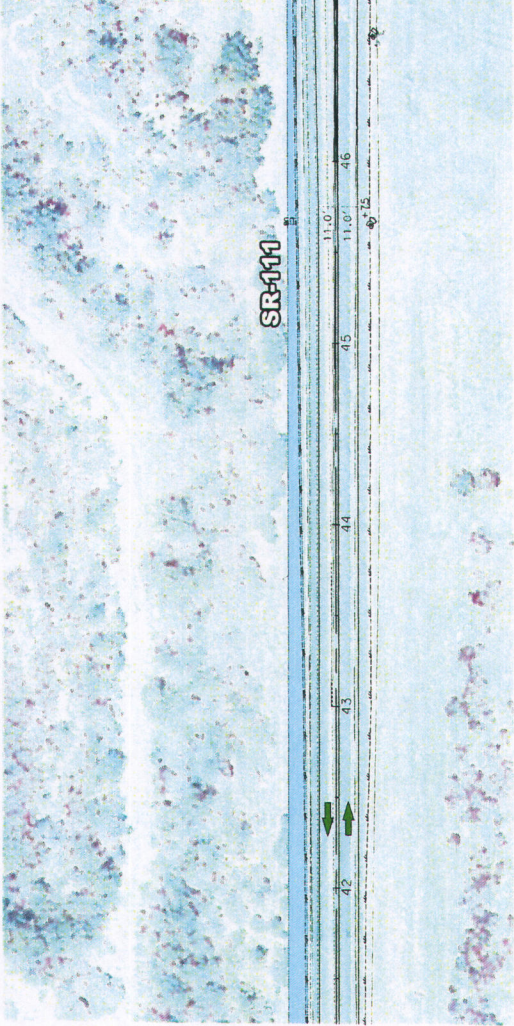

- Legend**
- Current Stage Work Area
 - Completed Work in Prior Stages
 - Temporary Railing (Type K)
 - Traffic Delineator
 - Traffic Flow

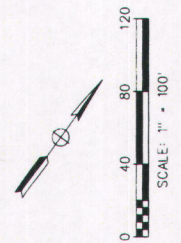

ATTACHMENT F
ISSUED BY ADDENDUM 2

Grapefruit Blvd/SR-111 & 4th Street
Pedestrian & Roadway Improvement Project



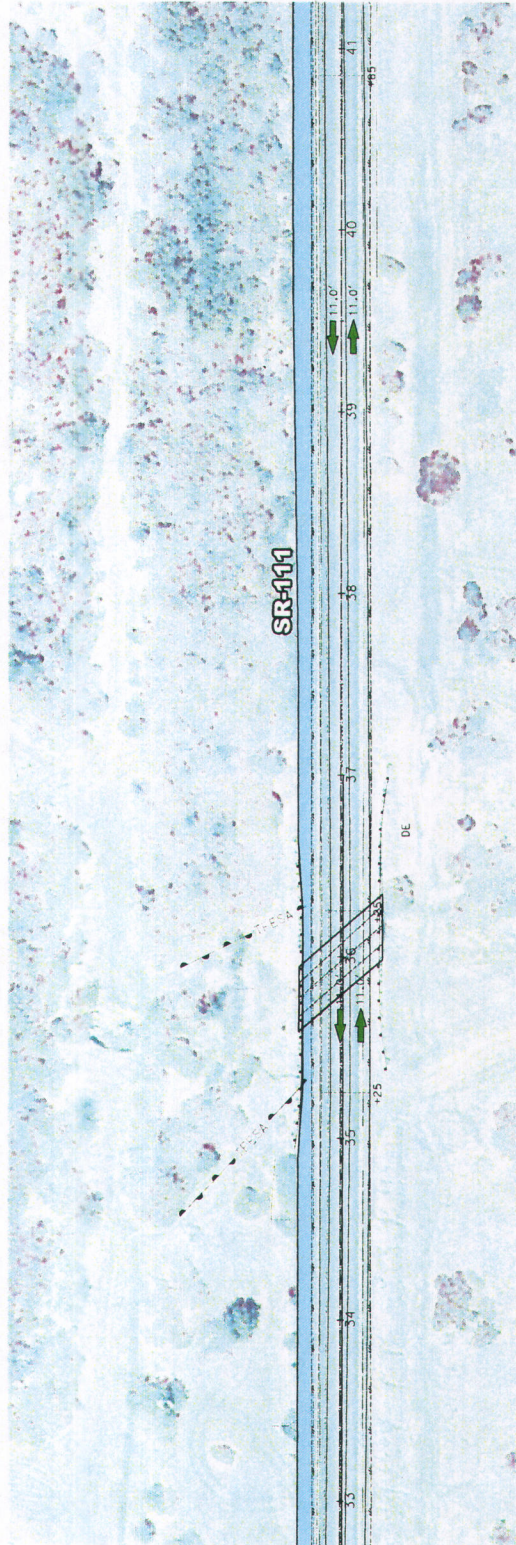
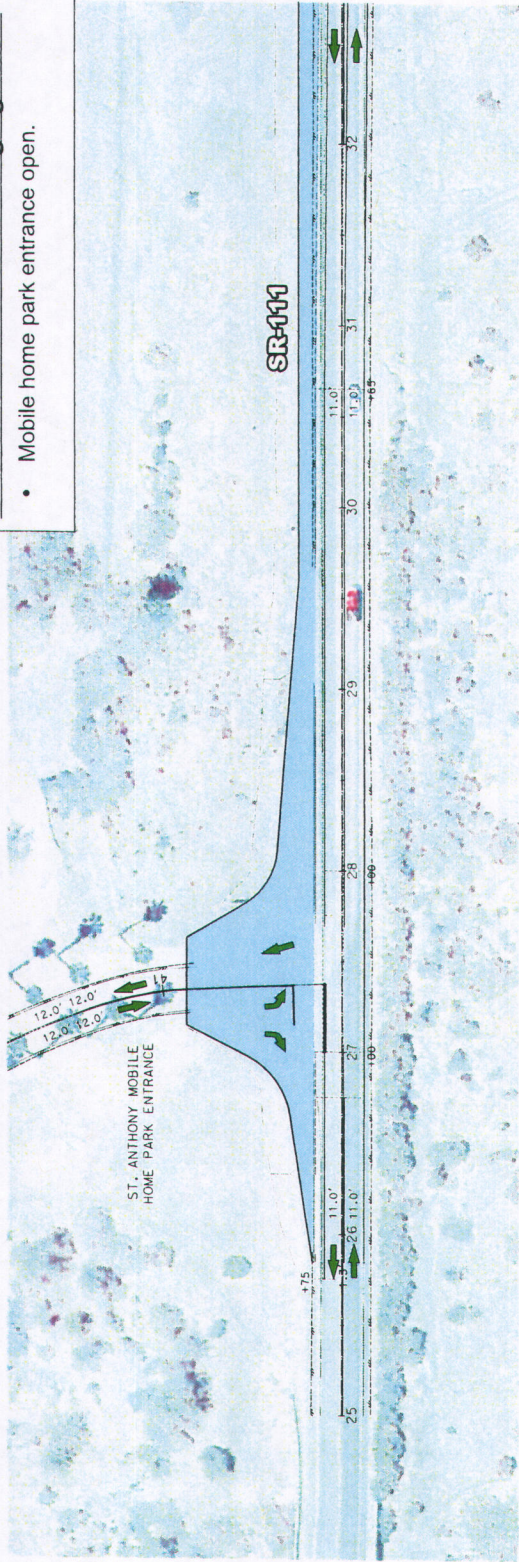

**Conceptual Construction Staging -
- Pavement Construction -
Stage 2B**

Pavement Construction Staging Notes

- Mobile home park entrance open.



Legend

-  Current Stage Work Area
-  Completed Work in Prior Stages
-  Temporary Railing (Type K)
-  Traffic Delineator
-  Traffic Flow

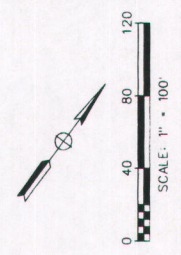

ATTACHMENT F
ISSUED BY ADDENDUM 2

Grapefruit Blvd/SR-111 & 4th Street
Pedestrian & Roadway Improvement Project

**Conceptual Construction Staging -
- Pavement Construction -**

Stage 2C

Pavement Construction Staging Notes

- Install temporary striping, and shift NB traffic to median and close NB Lane with portable delineators during one night-time closure using one-way-reversing traffic-control.
- SB left turn onto 4th street will be prohibited. Detour traffic to Grapefruit Blvd/62nd (north) and SR-111/Thobe Road (south).
- Cold plane and place overlay for NB lane. Complete entire NB lane in one shift.
- Place micro-surfacing between Sta. 67+87 and 72+68 using a one-way-reversing traffic-control lane closure.
- Construct shoulder rumble strip and place final striping.

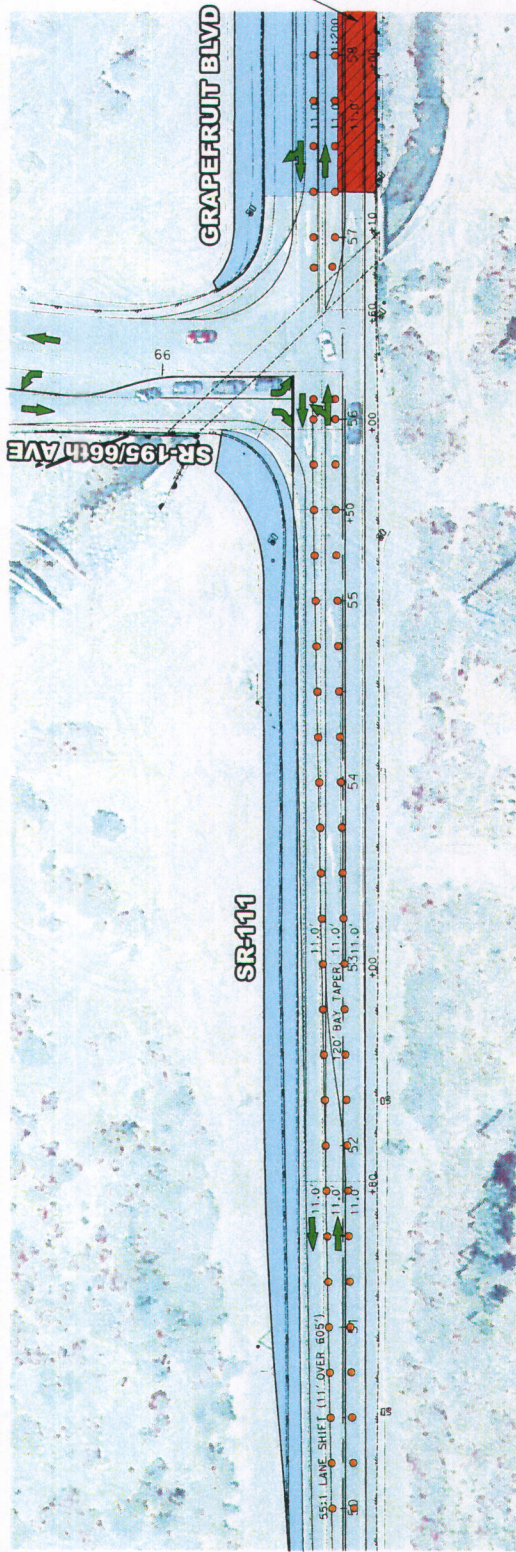

- Legend**
- Current Stage Work Area
 - Completed Work in Prior Stages
 - Temporary Railing (Type K)
 - Traffic Delineator
 - ➔ Traffic Flow

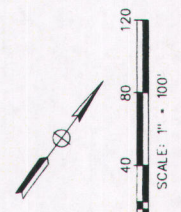

ATTACHMENT F
ISSUED BY ADDENDUM 2



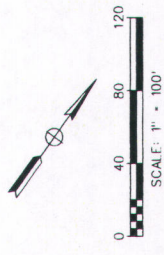
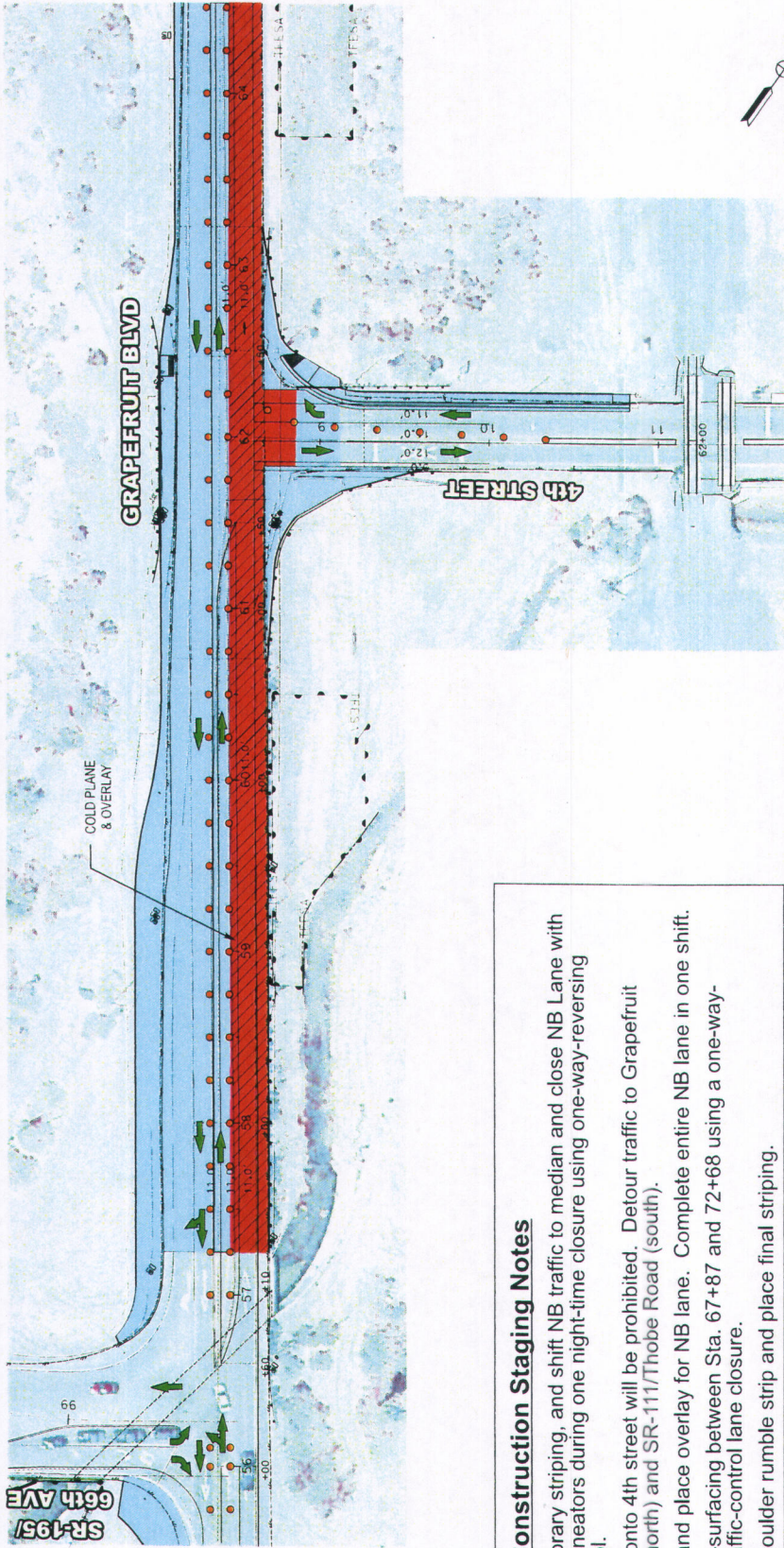

Grapefruit Blvd/SR-111 & 4th Street
Pedestrian & Roadway Improvement Project

**Conceptual Construction Staging -
- Pavement Construction -**

Stage 2C



Legend

	Current Stage Work Area
	Completed Work in Prior Stages
	Temporary Railing (Type K)
	Traffic Delineator
	Traffic Flow

Grapefruit Blvd/SR-111 & 4th Street
 Pedestrian & Roadway Improvement Project

**Conceptual Construction Staging -
 - Pavement Construction -
 Stage 2C**

- Pavement Construction Staging Notes**
- Install temporary striping, and shift NB traffic to median and close NB Lane with portable delineators during one night-time closure using one-way-reversing traffic-control.
 - SB left turn onto 4th street will be prohibited. Detour traffic to Grapefruit Blvd/62nd (north) and SR-111/Thobe Road (south).
 - Cold plane and place overlay for NB lane. Complete entire NB lane in one shift.
 - Place micro-surfacing between Sta. 67+87 and 72+68 using a one-way-reversing traffic-control lane closure.
 - Construct shoulder rumble strip and place final striping.

