

**SUBMITTAL TO THE BOARD OF SUPERVISORS
COUNTY OF RIVERSIDE, STATE OF CALIFORNIA**



ITEM
3.37
(ID # 4627)

MEETING DATE:

Tuesday, December 5, 2017

FROM : TLMA-TRANSPORTATION:

SUBJECT: TRANSPORTATION AND LAND MANAGEMENT AGENCY/ TRANSPORTATION:
State Route 60 Freeway Agreement between the County of Riverside and the
State of California Department of Transportation (State). District 4; [\$0]
(Companion Item to MT Item #4629)

RECOMMENDED MOTION: That the Board of Supervisors:

1. Approve the Freeway Agreement between the County of Riverside and the State of California Transportation Department; and
2. Authorize the Chairman of the Board to execute the same.

ACTION: Policy

Patricia Romo, Director of Transportation 10/23/2017

MINUTES OF THE BOARD OF SUPERVISORS

On motion of Supervisor Ashley, seconded by Supervisor Perez and duly carried by unanimous vote, IT WAS ORDERED that the above matter is approved as recommended.

Ayes: Jeffries, Tavaglione, Washington, Perez and Ashley
Nays: None
Absent: None
Date: December 5, 2017
xc: Transp.

Kecia Harper-Ihem
Clerk of the Board
By:
Deputy

**SUBMITTAL TO THE BOARD OF SUPERVISORS COUNTY OF RIVERSIDE,
STATE OF CALIFORNIA**

FINANCIAL DATA	Current Fiscal Year:	Next Fiscal Year:	Total Cost:	Ongoing Cost
COST	\$ 0	\$ 0	\$ 0	\$ 0
NET COUNTY COST	\$ 0	\$ 0	\$ 0	\$ 0
SOURCE OF FUNDS: N/A			Budget Adjustment: No	
			For Fiscal Year: FY 17/18	

C.E.O. RECOMMENDATION: Approve

BACKGROUND:

Summary

On July 2, 1956 a Freeway Agreement was executed between the County of Riverside (County) and the State of California Department of Transportation (Caltrans), for the portion of State Route 60 (SR-60) between Theodore Street and Interstate 10 (I-10). The freeway agreement documented the understanding between Caltrans and the County related to the planned traffic circulation features of the freeway and the location of local roads to maintain traffic circulation to the freeway.

Due to annexation of certain areas by the City of Beaumont (City) including portions of SR-60 covered by the original Freeway Agreement and the proposal to construct a new Interchange at Potrero Boulevard, a new Freeway Agreement is needed. Exhibit A of the attached Freeway Agreement identifies the location covered by the new Freeway Agreement. This new freeway agreement is specific to the portion of SR60 from 0.4 miles west of Potrero Boulevard to 0.3 miles west of Potrero Boulevard. The new freeway agreement identifies the location of the new Potrero Interchange on SR-60 and defines the obligations of the County with respect to construction and maintenance of future improvements to SR-60 and reconstruction or construction of local roads constructed as part of improvements to SR-60.

A separate Freeway Maintenance Agreement between the County and Caltrans is required to establish maintenance responsibilities of the future Potrero Boulevard interchange improvement and local road improvements. The Freeway Maintenance Agreement appears on this agenda as a separate item.

Impact on Residents and Businesses

This action does not have any impact to residents and businesses.

Additional Fiscal Information

No County funds are being used. Local road improvements, and subsequent on-going operation and maintenance, within the County jurisdiction will become the responsibility of the transportation department, upon acceptance.

SUBMITTAL TO THE BOARD OF SUPERVISORS COUNTY OF RIVERSIDE,
STATE OF CALIFORNIA

ATTACHMENTS

Vicinity Map
Freeway Agreement



Melissa Noone, Associate Management Analyst 11/27/2017

Gregory V. Priamos, Director County Counsel 11/17/2017

COUNTY OF RIVERSIDE
TRANSPORTATION DEPARTMENT

SR-60 FREEWAY AGREEMENT

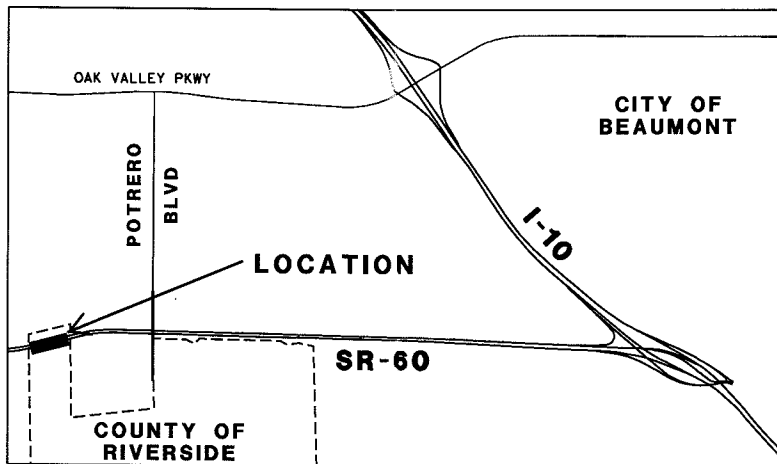
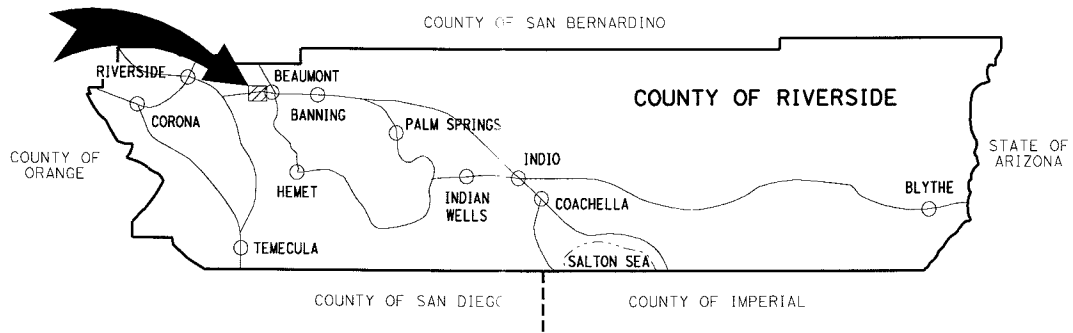
BEAUMONT AREA



VICINITY MAP

TOWNSHIP 3S RANGE 1W SECTION 7 & 8
COUNTY ROAD BOOK PAGE No. 92

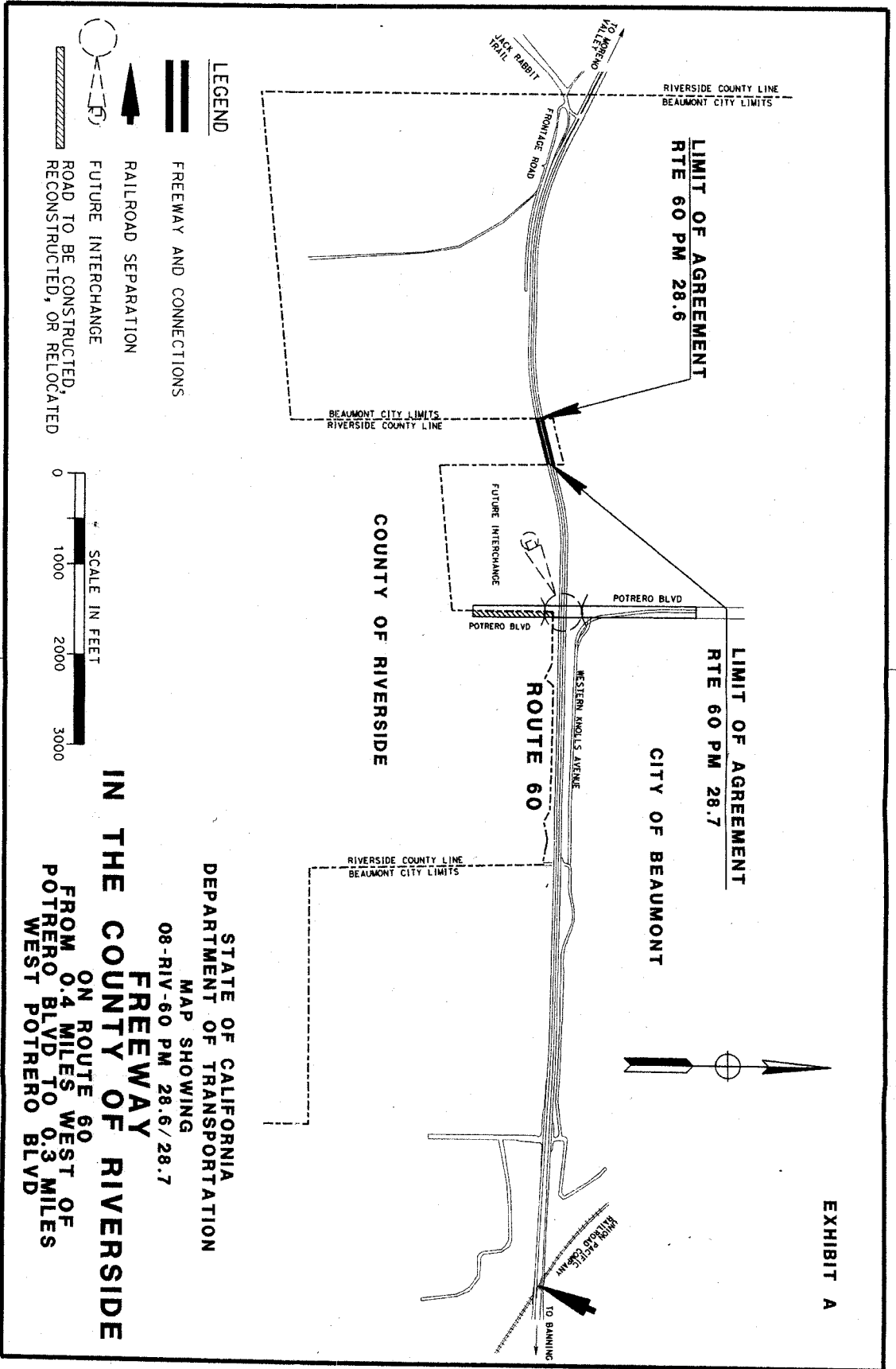

STATE OF CALIFORNIA
 DEPARTMENT OF TRANSPORTATION
 MAP SHOWING
 08-RIV-60 PM 28.6/28.7
FREWAY
IN THE COUNTY OF RIVERSIDE
 ON ROUTE 60
 FROM 0.4 MILES WEST OF
 POTRERO BLVD TO 0.3 MILES
 WEST POTRERO BLVD

IN RIVERSIDE CO., PM 28.6/28.7

QUEST COPY

to Riverside County Board of Supervisors, Room 1010
Post Office Box 1147, Riverside, Ca 92502-1147
Thank you

08-Riv-60-28.6/28.7
In the County of Riverside
From 0.4 Miles West of Potrero Blvd.
to 0.3 Miles West Potrero Blvd.

FREEWAY AGREEMENT

THIS AGREEMENT, made and entered into on this 5th day of December, 2017, by and between the STATE OF CALIFORNIA, acting by and through the Department of Transportation (herein referred to as "STATE") and the County of Riverside (herein referred to as "COUNTY"),

WITNESSETH:

WHEREAS, the highway described above has been declared to be a freeway by Resolutions of the California Highway Commission on August 19, 1953 and August 16, 1955; and

WHEREAS, STATE and COUNTY have entered into a Freeway Agreement dated July 2, 1956, pertaining to that portion of State Highway Route 60 between Theodore Street and Interstate 10 (previously Route 26); and

WHEREAS, a revised plan map for such freeway has been prepared showing the proposed plan of the STATE as it affects streets of the COUNTY; and

WHEREAS, it is the mutual desire of the parties hereto to enter into a new Freeway Agreement in accordance with the revised plan of said freeway.

NOW, THEREFORE, IT IS AGREED:

1. This Agreement supersedes that portion of said Freeway Agreement dated July 2, 1956, from 0.4 miles west of Potrero Boulevard to 0.3 miles west of Potrero Boulevard.
2. COUNTY agrees and consents to the closing of COUNTY roads, relocation of COUNTY roads, construction of frontage roads and other local roads, and other construction affecting COUNTY roads, all as shown on the plan map attached hereto marked Exhibit A, and made a part hereof by this reference.
3. The obligations of STATE and COUNTY with respect to the funding and construction of the freeway project will always be dealt with in separate Cooperative Agreement(s) between the parties, and any amendments thereto, or Encroachment Permits issued to COUNTY. The parties responsible for the construction of the freeway shall make any changes affecting COUNTY roads only in accordance with the plan map attached hereto, marked Exhibit A.
4. The obligations of STATE and COUNTY with respect to the acquisition of the rights of way required for the construction, reconstruction, or alteration of the freeway and COUNTY roads, frontage roads, and other local roads will always be dealt with in separate Cooperative Agreement(s) between the parties, and any amendments thereto or Encroachment Permits issued to COUNTY.

DEC 05 2017 3.37

08-Riv-60-28.6/28.7
In the County of Riverside
From 0.4 Miles West of Potrero Blvd.
to 0.3 Miles West Potrero Blvd.

5. It is understood between the parties that the rights of way may be acquired in sections or units, and that both as to the acquisition of right of way and the construction of the freeway project, the obligations of STATE and COUNTY hereunder shall be carried out at such time and for such unit or units of the project as funds are budgeted and made lawfully available for such expenditures.

6. COUNTY will accept control and maintenance over each of the relocated or reconstructed COUNTY roads, any frontage roads, and other local roads constructed as part of the project on receipt of written confirmation that the work thereon has been completed, except for any portion which is adopted by STATE as a part of the freeway proper. If acquired by STATE, COUNTY will accept title to the portions of such roads lying outside the freeway limits upon relinquishment by STATE.

7. This Agreement may be modified at any time by the mutual consent of the parties hereto, as needed to best accomplish, through STATE and COUNTY cooperation, the completion of the whole freeway project for the benefit of the people of the STATE and of the COUNTY.

IN WITNESS WHEREOF, the parties hereto have caused this Agreement to be executed by their respective duly authorized officers.

STATE OF CALIFORNIA
Department of Transportation

MALCOLM DOUGHERTY
Director of Transportation

By: _____
JOHN BULINSKI
District Director

APPROVED AS TO FORM:

By: _____
Attorney (State)

THE COUNTY OF RIVERSIDE

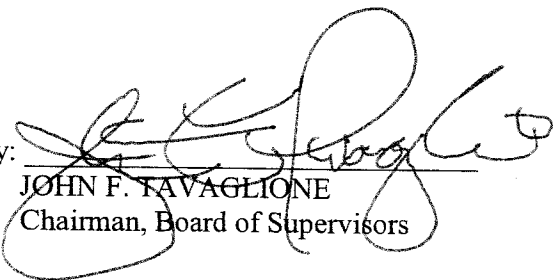
By: 
JOHN F. FAVAGLIONE
Chairman, Board of Supervisors

APPROVED AS TO FORM:

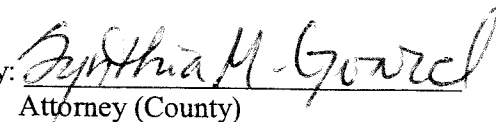
By: 
Attorney (County)

SYNTHIA M. GUNZEL

ATTEST:
KECIA HARPER-JHEM, Clerk

By: 
DEPUTY