

SUBMITTAL TO THE BOARD OF SUPERVISORS  
COUNTY OF RIVERSIDE, STATE OF CALIFORNIA



ITEM  
3.39  
(ID # 5388)

**MEETING DATE:**

Tuesday, December 5, 2017

**FROM :** TLMA-TRANSPORTATION:

**SUBJECT:** TRANSPORTATION AND LAND MANAGEMENT AGENCY/TRANSPORTATION:

Introduction of Ordinance No. 452.243 to Establish Speed Zones Enforceable by Radar Speed Detection Equipment in the Riverside, Lake Mathews, Highgrove, Temecula, French Valley, Thousand Palms, and Perris Areas. 1st, 2nd, 3rd, 4th, and 5th Districts; [\$2,500 - Total Cost]; Local Funds 100%

**RECOMMENDED MOTION:** That the Board of Supervisors:

1. Introduce and adopt, on successive meetings, Ordinance 452.243, Amending Ordinance No. 452 relating to prima facie speed limits to establish various speed zones in the above-referenced areas of Riverside County.

**ACTION:** Policy

  
Patricia Romo, Director of Transportation 12/20/2017

---

**MINUTES OF THE BOARD OF SUPERVISORS**

On motion of Supervisor Ashley, seconded by Supervisor Perez and duly carried by unanimous vote, IT WAS ORDERED that the above matter is approved as recommended and that the above Ordinance is approved as introduced with a waiver of reading.

Ayes: Jeffries, Tavaglione, Washington, Perez and Ashley  
Nays: None  
Absent: None  
Date: December 5, 2017  
xc: Transp., Co.Co., COB

Kecia Harper-Ihem  
Clerk of the Board  
By:   
Deputy

**SUBMITTAL TO THE BOARD OF SUPERVISORS COUNTY OF RIVERSIDE,  
STATE OF CALIFORNIA**

<b>FINANCIAL DATA</b>	<b>Current Fiscal Year:</b>	<b>Next Fiscal Year:</b>	<b>Total Cost:</b>	<b>Ongoing Cost</b>
<b>COST</b>	\$ 2,500	\$ 0	\$ 2,500	\$ 0
<b>NET COUNTY COST</b>	\$ 0	\$ 0	\$ 0	\$ 0
<b>SOURCE OF FUNDS:</b> Gas Tax (100%). There are no General Funds used in this project.			<b>Budget Adjustment:</b>	No
			<b>For Fiscal Year:</b>	17/18

**C.E.O. RECOMMENDATION:** Approve

**BACKGROUND:**

**Summary**

The County of Riverside Transportation Department (Transportation Department) staff has conducted Engineering and Traffic Surveys (E&TS) in accordance with the California Vehicle Code (CVC), Sections 627 and 40802, for various county-maintained roads in the Riverside, Lake Mathews, Highgrove, Temecula, French Valley, Thousand Palms, and Perris areas of Riverside County. (See attached Vicinity Maps)

Based upon the results of the E&TS for these roads, the radar-enforceable speed limits recommended by the Transportation Department are summarized in the attached tables and have been determined to be appropriate to facilitate the safe and orderly movement of vehicular traffic.

Transportation Department staff has contacted the Riverside, Temecula, San Geronio Pass, and Indio area offices of the California Highway Patrol (CHP) regarding the recommended speed zones.

**Impact on Residents and Businesses**

The establishing and posting of appropriate speed limits promote safe and orderly movements of vehicular traffic and enable the CHP to use radar equipment to enforce the posted speed limits. Since the recommended speed limits were determined based on actual speed surveys, the majority of the motorists are already driving at or below the recommended speed limits. Posted speed limits also guide motorists to drive at a reasonable speed in unfamiliar locations.

**SUPPLEMENTAL:**

**Additional Fiscal Information**

The cost for establishing the recommended speed limits is primarily for the installation of speed limit signs, which estimated at approximately \$2,500. There are no General Funds used in this project.

**Contract History and Price Reasonableness**

N/A

SUBMITTAL TO THE BOARD OF SUPERVISORS COUNTY OF RIVERSIDE,  
STATE OF CALIFORNIA

**ATTACHMENTS:**

**Vicinity Maps**

**List of Speed Zones**

**Ordinance No. 452.243**

**Speed Zone Diagrams**

  
Melissa Noone, Associate Management Analyst 11/27/2017

  
Gregory V. Priapos, Director County Counsel 10/30/2017

1 ORDINANCE NO. 452.243

2 AN ORDINANCE OF THE COUNTY OF RIVERSIDE

3 AMENDING ORDINANCE NO. 452

4 RELATING TO PRIMA FACIE SPEED LIMITS

5 The Board of Supervisors of the County of Riverside ordains as follows:

6 Section 1. Section 2.3 of Ordinance No. 452, entitled “Thirty-five miles per hour,” is  
7 hereby amended to add new subsection 134 to read as follows:

8 “134. On Citrus Street from Northgate Street to a point 800 feet west of  
9 Northgate Street, a total distance of approximately 0.15 miles, in the  
10 Highgrove area.”

11 Section 2. Section 2.4 of Ordinance No. 452, entitled “Forty miles per hour,” is hereby  
12 amended to add new subsection 152 to read as follows:

13 “152. On Morgan Hill Drive between El Chimisal Road and a point 260 feet  
14 north of Coppola Street, a total distance of approximately 1.50 miles,  
15 in the Temecula area.”

16 Section 3. Section 2.5 of Ordinance No. 452, entitled “Forty-five miles per hour,” is  
17 hereby amended to add new subsections 174, 175, 176, 177, and 178 to read as follows:

18 “174. On Barton Street between Nandina Avenue and Mariposa Avenue,  
19 a total distance of approximately 0.50 miles, in the Riverside area.

20 175. On Pourroy Road between Murrieta Hot Springs Road and Auld  
21 Road, a total distance of approximately 2.20 miles, in the French  
22 Valley area.

23 176. On Ramon Road between Desert Moon Drive and a point 1,900 feet  
24 west of Varner Road, a total distance of approximately 1.55 miles,  
25 in the Thousand Palms area.

26 177. On Dunlap Drive between Nuevo Road and Orange Avenue, a total  
27 distance of approximately 1.0 mile, in the Perris area.

28 178. On Citrus Heights Drive between McAllister Street and a point

1    2,450 feet north of McAllister Street, a total distance of  
2    approximately 0.43 miles, in the Riverside area.”

3                    Section 4.    Section 2.6 of Ordinance No. 452, entitled “Fifty miles per hour,” is hereby  
4 amended to add new subsection 90 to read as follows:

5    “90.    On Washington Street between Harley John Road and Mariposa  
6    Avenue, a total distance of approximately 1.50 miles, in the Lake  
7    Mathews area.”

8                    Section 5.    Subsection 115 of Section 2.4 of Ordinance 452 adopted on October 05,  
9 2010, pursuant to Ordinance No. 452.228, is repealed in its entirety. Subsection 115 of Section 2.4  
10 established a forty miles per hour speed limit on Morgan Hill Drive between El Chimisal Road and Villa  
11 Helena Street.

12                    Section 6.    Subsection 123 of Section 2.4 of Ordinance 452 adopted on May 03, 2011,  
13 pursuant to Ordinance No. 452.229, is repealed in its entirety. Subsection 123 of Section 2.4 established a  
14 forty miles per hour speed limit on Morgan Hill Drive between El Chimisal Road and Villa Helena Street.

15                    Section 7.    Subsection 138 of Section 2.4 of Ordinance 452 adopted on August 20, 2013,  
16 pursuant to Ordinance No. 452.234, is repealed in its entirety. Subsection 138 of Section 2.4 established a  
17 forty miles per hour speed limit on Morgan Hill Drive between Villa Helena Street and 260 feet north of  
18 Coppola Street.

19                    Section 8.    Subsection 95 of Section 2.5 of Ordinance 452 adopted on May 11,  
20 2004, pursuant to Ordinance No. 452.218, is repealed in its entirety. Subsection 95 of Section 2.5  
21 established a forty-five miles per hour speed limit on Ramon Road between Bob Hope Drive and  
22 Monterey Avenue.

23                    Section 9.    Subsection 105 of Section 2.5 of Ordinance 452 adopted on March 29, 2005,  
24 pursuant to Ordinance No. 452.220, is repealed in its entirety. Subsection 105 of Section 2.5 established a  
25 forty-five miles per hour speed limit on Ramon Road between Monterey Avenue and Desert Moon Drive.

26                    Section 10.    Subsection 104 of Section 2.5 of Ordinance 452 adopted on March 29, 2005,  
27 pursuant to Ordinance No. 452.220, is repealed in its entirety. Subsection 104 of Section 2.5 established a  
28 forty-five miles per hour speed limit on Pourroy Road between Murrieta Hot Springs Road and Serrento

1 Drive.

2           Section 11.    Subsection 39 of Section 2.6 of Ordinance 452 adopted on May 11, 2004,  
3 pursuant to Ordinance No. 452.218, is repealed in its entirety. Subsection 39 of Section 2.6 established a  
4 fifty miles per hour speed limit on Washington Street between Harley John Road and Markham Street.

5           Section 12.    Subsection 44 of Section 2.6 of Ordinance 452 adopted on March 29, 2005,  
6 pursuant to Ordinance No. 452.220, is repealed in its entirety. Subsection 44 of Section 2.6 established a  
7 fifty miles per hour speed limit on Washington Street between Markham Street and Mariposa Avenue.

8           Section 13.    Subsection 46 of Section 2.6 of Ordinance 452 adopted on March 29, 2005,  
9 pursuant to Ordinance No. 452.220, is repealed in its entirety. Subsection 46 of Section 2.6 established a  
10 fifty miles per hour speed limit on Pourroy Road between Serrento Drive and Auld Road.

11           Section 14.    Subsection 13 of Section 2.7 of Ordinance 452 adopted on May 11, 2004,  
12 pursuant to Ordinance No. 452.218, is repealed in its entirety. Subsection 13 of Section 2.7 established a  
13 fifty-five miles per hour speed limit on Ramon Road between Los Alamos Road and Bod Hope Drive.

14           Section 15.    This ordinance shall take effect 30 days after its adoption.

15  
16  
17  
18  
19  
20  
21  
22  
23  
24  
25  
26  
27  
28

BOARD OF SUPERVISORS OF THE COUNTY  
OF RIVERSIDE, STATE OF CALIFORNIA

BY: \_\_\_\_\_  
SUPERVISOR JOHN F. TAVAGLIONE, Chairman

ATTEST:  
KECIA HARPER-IHEM, Clerk of the Board

By: \_\_\_\_\_  
Deputy

APPROVED AS TO FORM:  
GREGORY P. PRIAMOS, County Counsel

1 By:

*Bill Walden*  
Deputy

2 LTT:sa

3 Y:\Traffic\Ord 452 Speed Zones\Ord. 452.243\Ord. 452.243.Docx

4

5

6

7

8

9

10

11

12

13

14

15

16

17

18

19

20

21

22

23

24





25

26

27

28

# BARTON STREET (#1700)

- LEGEND:**
-  CITY LIMITS
  -  RADAR ZONE
  -  SURVEY STATION
  -  OTHER STREET OR ROAD

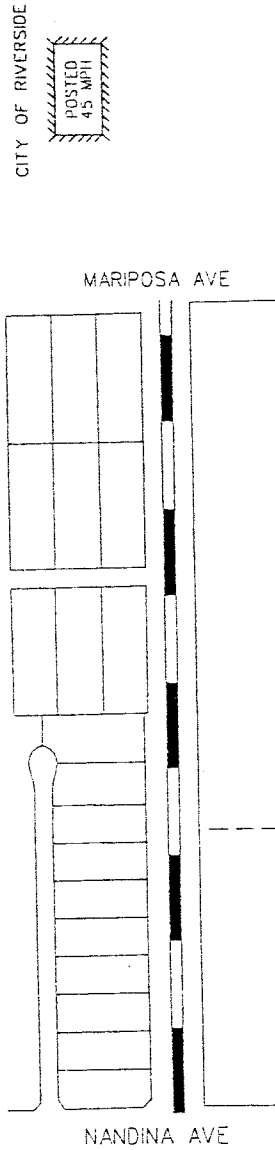

SURVEY STA S1358  
N/O MANDINA AVE

BEGIN ZONE

END ZONE



NO SCALE

RECOMMENDED SPEED LIMIT	45 MPH
PREVAILING SPEED (85%)	48 MPH
VEHICLES IN 24 HR (2 WAY)	6865
SEGMENT LENGTH	0.50 MILE
ALL ACCIDENTS IN 2 YRS.	0
ACCIDENT RATE ☆	0.00 ACC/MVM
EXISTING SPEED LIMIT	NOT POSTED

☆ RATE =  $\frac{\text{ACCIDENT} \times 1,000,000}{\text{VEH} \times .565 \times 2 \times \text{MILE}}$

APPROVED BY:

*Lawrence T. Tai*  
DATE: 5/23/2017

LAWRENCE T. TAI, P.E.  
COUNTY TRAFFIC ENGINEER

SURVEY DATE: MAY 15, 2017  
MAP DATE: MAY 22, 2017  
DRAWN BY: J VALADEZ  
CAD FILE: BARTON.DGN

COUNTY AREA: RIVERSIDE  
COUNTY MAP PAGE: 55  
SUPERVISOR DISTRICT: 1/1



# CITRUS STREET (#1704)

**LEGEND:**

- ////// CITY LIMITS
- ▬ RADAR ZONE
- SURVEY STATION
- OTHER STREET OR ROAD

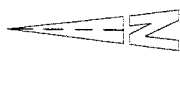
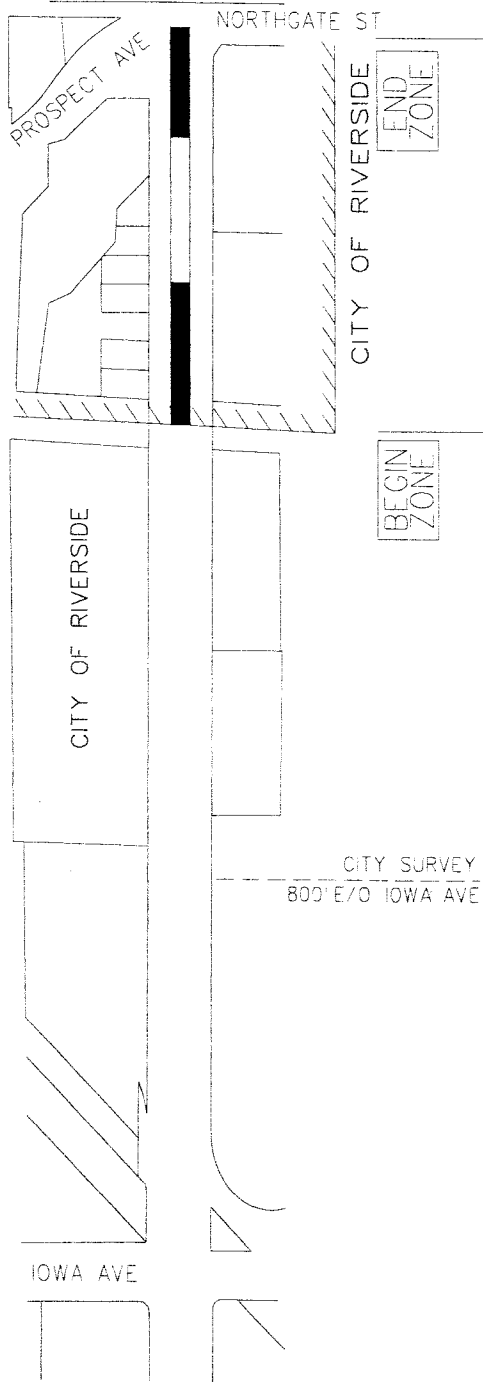

RECOMMENDED SPEED LIMIT	35 MPH (RECOMMENDED BY CITY)	35 MPH (CITY DATA)
PREVAILING SPEED (85%)	40 MPH (CITY DATA)	40 MPH (CITY DATA)
VEHICLES IN 24 HR (2 WAY)	N/A	N/A
SEGMENT LENGTH	0.33 MILE	0.15 MILE
ALL ACCIDENTS IN 2 YRS.	N/A	0
ACCIDENT RATE ☆	N/A	0.00 ACC/MVM
EXISTING SPEED LIMIT	NOT POSTED	NOT POSTED

☆ RATE - ACCIDENT x 1,000,000  
VEH x 365 x 2 x MILE

COUNTY AREA:	HIGHGROVE	SURVEY DATE:	AUG 03, 2017
COUNTY MAP PAGE:	44A, 44B	MAP DATE:	AUG 09, 2017
SUPERVISOR DISTRICT:	1/2	DRAWN BY:	J VALADEZ
		CAD FILE:	CITRUS ST.SHT

APPROVED BY:

*Lawrence T. Tai*  
DATE: 8/24/2017  
LAWRENCE T. TAI, P.E.  
COUNTY TRAFFIC ENGINEER



COUNTY OF RIVERSIDE  
TRANSPORTATION DEPARTMENT  
TRAFFIC ENGINEERING SECTION

ENGINEERING AND TRAFFIC SURVEY  
AT  
**CITRUS ST**

PAGE  
1 OF 1

# CITRUS HEIGHTS DRIVE (#1703)

- LEGEND:**
- ////// CITY LIMITS
  - ▬ RADAR ZONE
  - - - SURVEY STATION
  - ▬ OTHER STREET OR ROAD

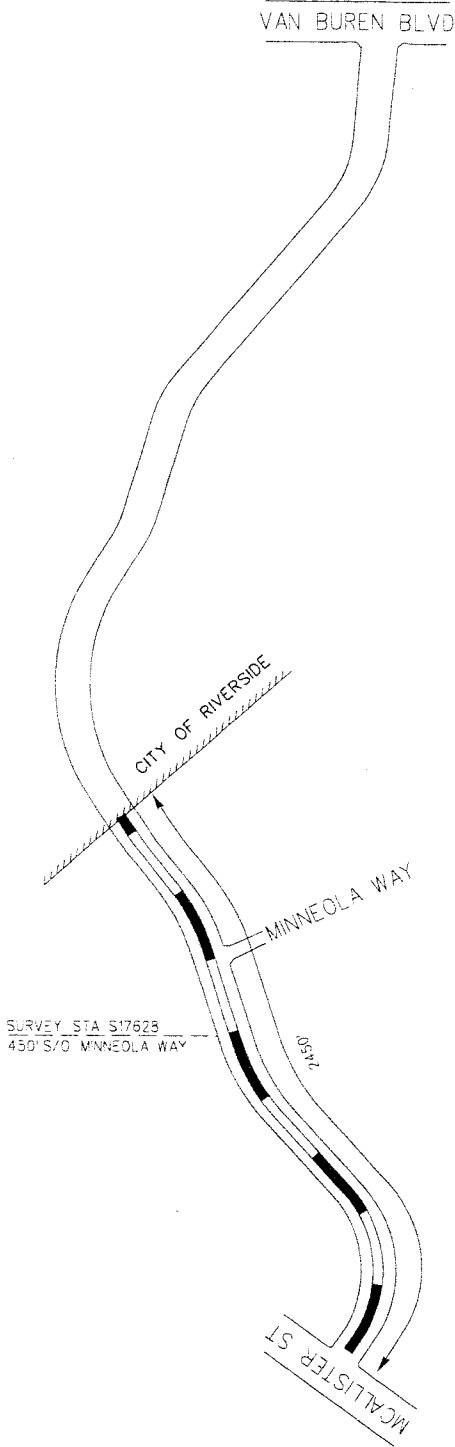

NO SCALE

BEGIN  
ZONE

END  
ZONE

RECOMMENDED SPEED LIMIT	45 MPH	45 MPH (RECOMMENDED BY CITY)
PREVAILING SPOED (85%)	48.6 MPH	52 MPH (CITY DATA)
VEHICLES IN 24 HR (2 WAY)	1860	N/A
SEGMENT LENGTH	0.43 MILE	0.57 MILE
ALL ACCIDENTS IN 2 YRS.	0	N/A
ACCIDENT RATE ☆	0.00 ACC/MVM	N/A
EXISTING SPEED LIMIT	NOT POSTED	NOT POSTED

☆ RATE =  $\frac{\text{ACCIDENT} \times 1,000,000}{\text{VEH} \times 365 \times 2 \times \text{MILE}}$

SURVEY DATE:	AUG 21, 2017
MAP DATE:	JUL 03, 2017
DRAWN BY:	J VALADEZ
CAD FILE:	CITRUS HEIGHTS.DGN

APPROVED BY:  
*Lawrence T. Tai*  
DATE: 8/24/2017  
LAWRENCE T. TAI, P.E.  
COUNTY TRAFFIC ENGINEER

# DUNLAP DRIVE

(#1702)

- LEGEND:**
- ////// CITY LIMITS
  - ===== RADAR ZONE
  - - - - SURVEY STATION
  - ===== OTHER STREET OR ROAD

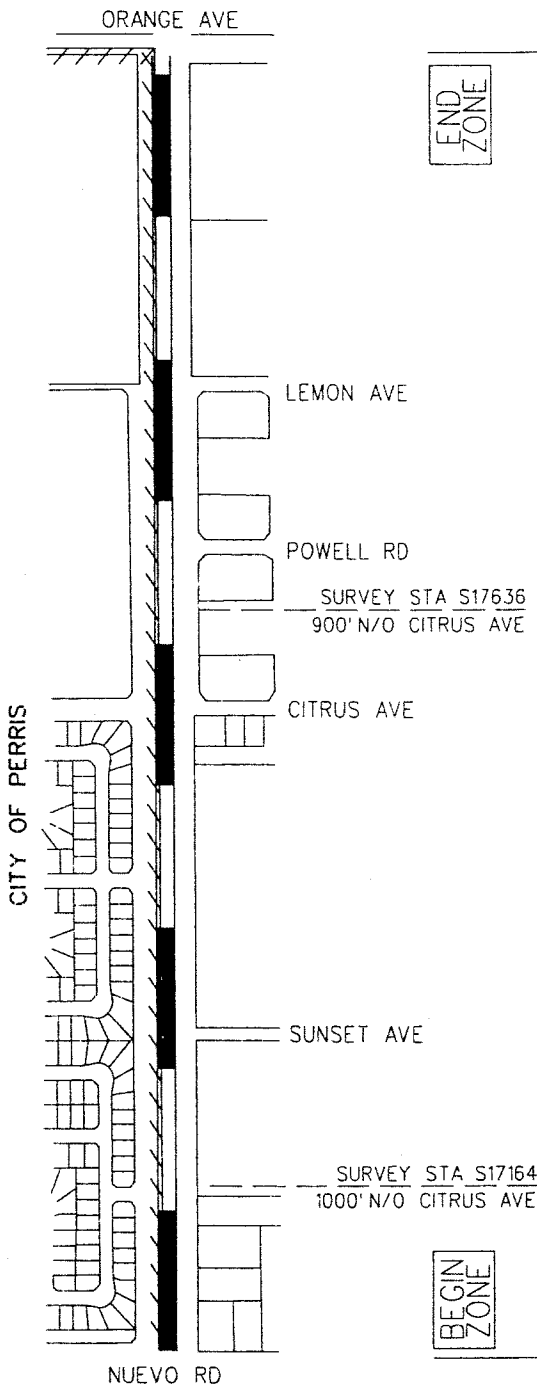

END ZONE

BEGIN ZONE



NO SCALE

RESIDENTIAL AREA - SIDEWALKS - DIRT SHOULDERS - VARYING ROADWAY WIDTHS - HIDDEN DRIVEWAYS - REDUCE TO 45 MPH.	45 MPH
RECOMMENDED SPEED LIMIT	51.7 MPH (AVG OF TWO SIMILAR STA OF 53 & 50.4 MPH)
PREVAILING SPEED (85%)	3500
VEHICLES IN 24 HR (2 WAY)	1.00 MILE
SEGMENT LENGTH	3
ALL ACCIDENTS IN 2 YRS.	1.17 ACC/MVM
ACCIDENT RATE ☆	NOT POSTED
EXISTING SPEED LIMIT	

☆ RATE =  $\frac{\text{ACCIDENT} \times 1,000,000}{\text{VEH} \times 365 \times 2 \times \text{MILE}}$

APPROVED BY:

*Lawrence T. Tai*  
DATE: 7/19/17

LAWRENCE T. TAI, P.E.  
COUNTY TRAFFIC ENGINEER

COUNTY OF RIVERSIDE  
TRANSPORTATION DEPARTMENT  
TRAFFIC ENGINEERING SECTION

ENGINEERING AND TRAFFIC SURVEY

AT  
DUNLAP DRIVE

PAGE  
1 OF 1

COUNTY AREA:	PERRIS	SURVEY DATE:	MAY 25, 2017
COUNTY MAP PAGE:	62	MAP DATE:	JUN 20, 2017
SUPERVISOR DISTRICT:	5/5	DRAWN BY:	J VALADEZ
		CAD FILE:	DUNLAP DR.DGN

# MORGAN HILL DRIVE

(#1466)

**LEGEND:**

- ////// CITY LIMITS
- ▬ RADAR ZONE
- - - SURVEY STATION
- OTHER STREET OR ROAD
- ▲ SCHOOL

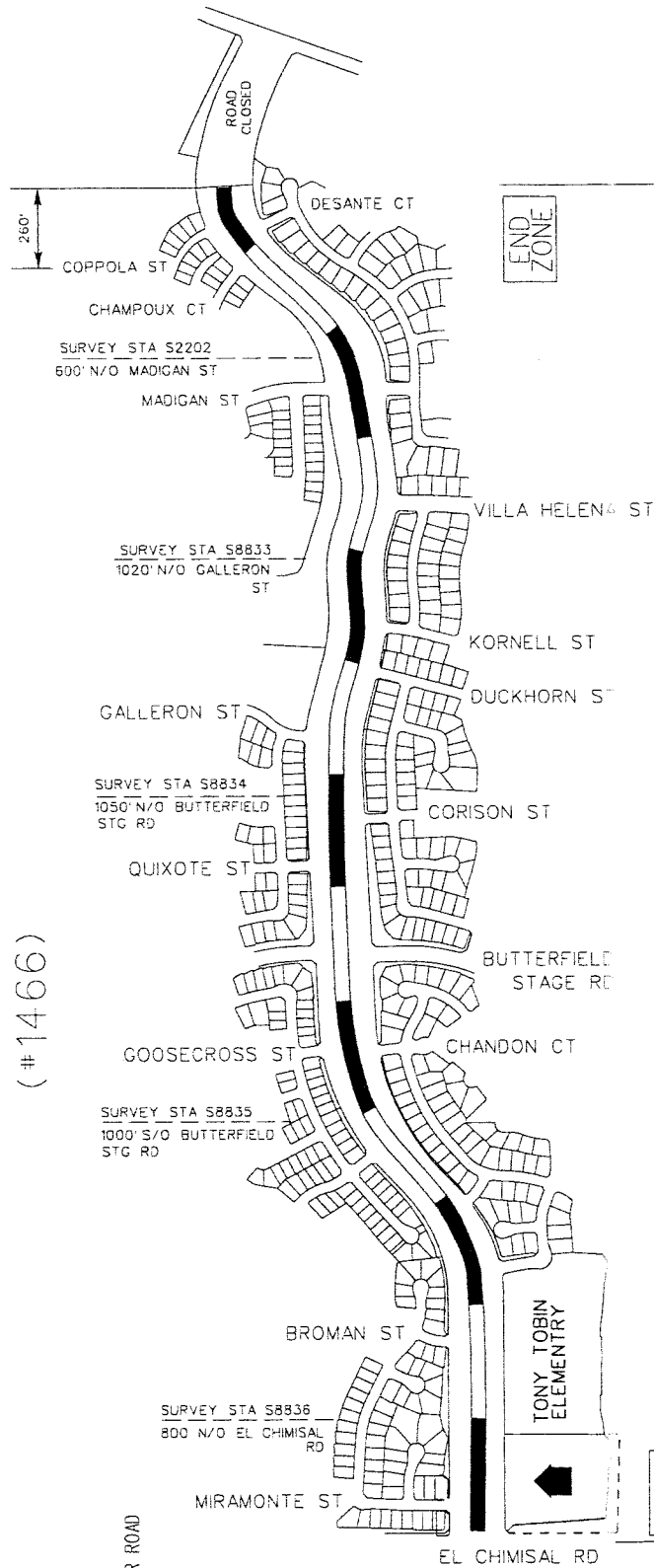

RECOMMENDED SPEED LIMIT	40 MPH
85th/75th TILE SPEED	39.4 MPH (Average of five similar stations of 38, 40, 40, 42 & 37 MPH)
VEHICLES IN 24 HR (2 WAY)	2,600
SEGMENT LENGTH	1.5 MILE
ALL ACCIDENTS IN 2 YRS.	0
ACCIDENT RATE ☆	0 ACC/MVM
EXISTING SPEED LIMIT	40 MPH (Ord. 452.228 Sec. 2.4 No. 115)

(Ord. 452.234 Sec. 2.4 No. 138)

☆ RATE =  $\frac{\text{NO. OF ACCIDENT} \times 1,000,000}{\text{VEH} \times 365 \times 2 \times \text{MILE}}$

COUNTY AREA:	TEMECULA	SURVEY DATE:	NOVEMBER 9, 2016
COUNTY MAP:	135C, 133F	MAP DATE:	MARCH 28, 2017
SUPERVISOR DISTRICT:	3/3	DRAWN BY:	J VALDEZ
		CAD FILE:	MORGANHILL.DGN

APPROVED BY: *Lawrence T. Tai*  
 DATE: 4/19/2017  
 LAWRENCE T. TAI, P.E.  
 COUNTY TRAFFIC ENGINEER

# POURROY ROAD

(#1396)

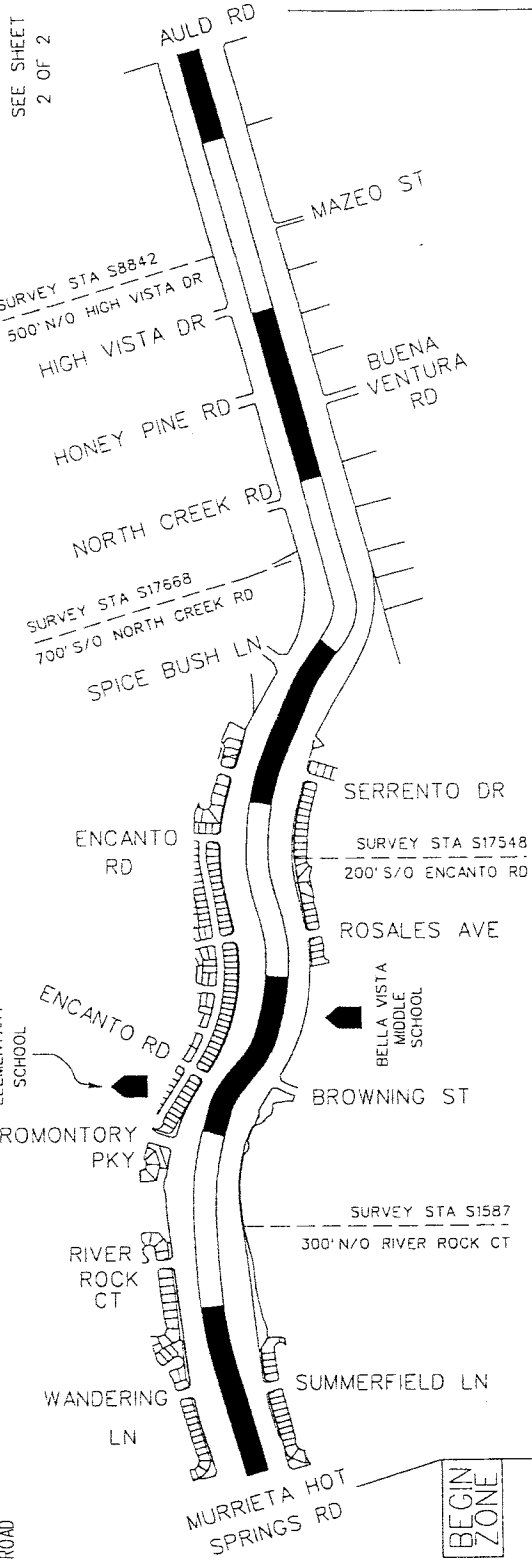

SEE SHEET  
2 OF 2

- LEGEND:**
- ////// CITY LIMITS
  - ▬ RADAR ZONE
  - - - SURVEY STATION
  - ▬ OTHER STREET OR ROAD
  - SCHOOL

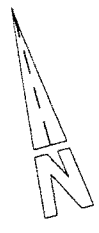

HORIZONTAL ALIGNMENT, SCHOOL ZONES, MULTIPLE TURNING, MOVEMENTS, REDUCE SPEED LIMIT TO 45 MPH	
RECOMMENDED SPEED LIMIT	51.95 MPH (AVG OF FOUR SIMILAR STA OF 53 & 52 & 49.8 & 53 MPH)
PREVAILING SPEED (85%)	45 MPH
VEHICLES IN 24 HR (2 WAY)	22,500
SEGMENT LENGTH	2.2 MILE
ALL ACCIDENTS IN 2 YRS.	17
ACCIDENT RATE ☆	0.47 ACC/MVM
EXISTING SPEED LIMIT	45 MPH (Ord. 452.220 Sec. 2.5 No. 104)
	50 MPH (Ord. 452.220 Sec. 2.6 No. 46)

☆ RATE =  $\frac{\text{ACCIDENT} \times 1,000,000}{\text{VEH} \times 365 \times 2 \times \text{MILE}}$

APPROVED BY: *Lawrence T. Tal, P.E.*  
DATE: 7/10/2017  
LAWRENCE T. TAL, P.E.  
COUNTY TRAFFIC ENGINEER

COUNTY OF RIVERSIDE  
TRANSPORTATION DEPARTMENT  
TRAFFIC ENGINEERING DIVISION  
ENGINEERING AND TRAFFIC SURVEY  
AT  
**POURROY ROAD**

SURVEY DATE: MAY 16, 2017  
MAP DATE: JUN 19, 2017  
DRAWN BY: J VALADEZ  
CAD FILE: POURROY.DGN

COUNTY AREA: FRENCH VALLEY  
COUNTY MAP PAGE: 124C, 125D  
SUPERVISOR DISTRICT: 3/3

**LEGEND:**

- CITY LIMITS
- RADAR ZONE
- SURVEY STATION
- OTHER STREET OR ROAD

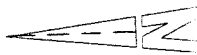

NO SCALE

**RAMON ROAD**  
(# 1017)

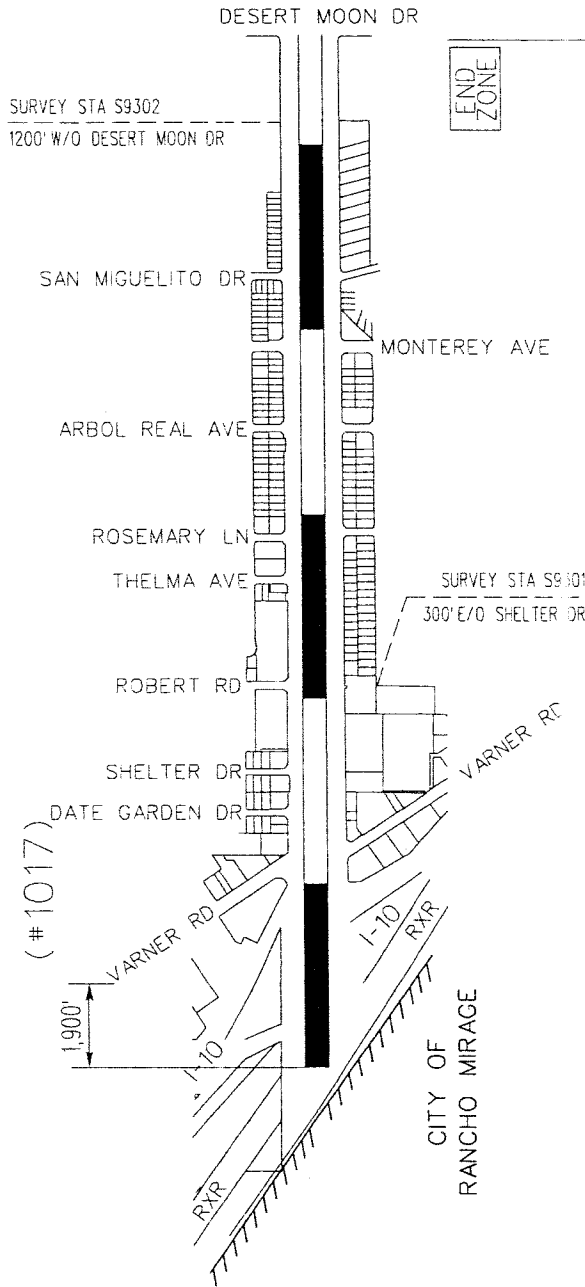

BEGIN ZONE

END ZONE

RECOMMENDED SPEED LIMIT	45 MPH
PREVAILING SPEED (85%)	50 MPH (AVERAGE OF TWO SIMILAR SEGMENTS OF 46.0 & 54.0 MPH)
VEHICLES IN 24 HR (2 WAY)	11,800
SEGMENT LENGTH	1.55 MILE
ALL ACCIDENTS IN 2 YRS.	22
ACCIDENT RATE ☆	1.65 ACC/MVM
EXISTING SPEED LIMIT	45 MPH (Ord. 452.218 Sec. 2.5 No. 95)
	45 MPH

(Ord. 452.220 Sec. 2.5 No. 105)

☆ RATE =  $\frac{\text{ACCIDENT} \times 1,000,000}{\text{VEH} \times 365 \times 2 \times \text{MILE}}$

APPROVED BY: <i>Lawrence T. Talpe</i> DATE: 4/19/2017		CITY OF RIVERSIDE TRANSPORTATION DEPARTMENT TRAFFIC ENGINEERING DIVISION	
SURVEY DATE: NOV 01, 2016	MAP DATE: MAR 28, 2017	ENGINEERING AND TRAFFIC SURVEY AT	
THOUSAND PALMS	186, 183A	RAMON ROAD	
COUNTY MAP:	4/4	PAGE 1 OF 1	
SUPERVISOR DISTRICT:	RAMON.DGN	COUNTY TRAFFIC ENGINEER	

# WASHINGTON STREET

(#1228)

- LEGEND:**
- CITY LIMITS
  - RADAR ZONE
  - SURVEY STATION
  - OTHER STREET OR ROAD
  - SCHOOL

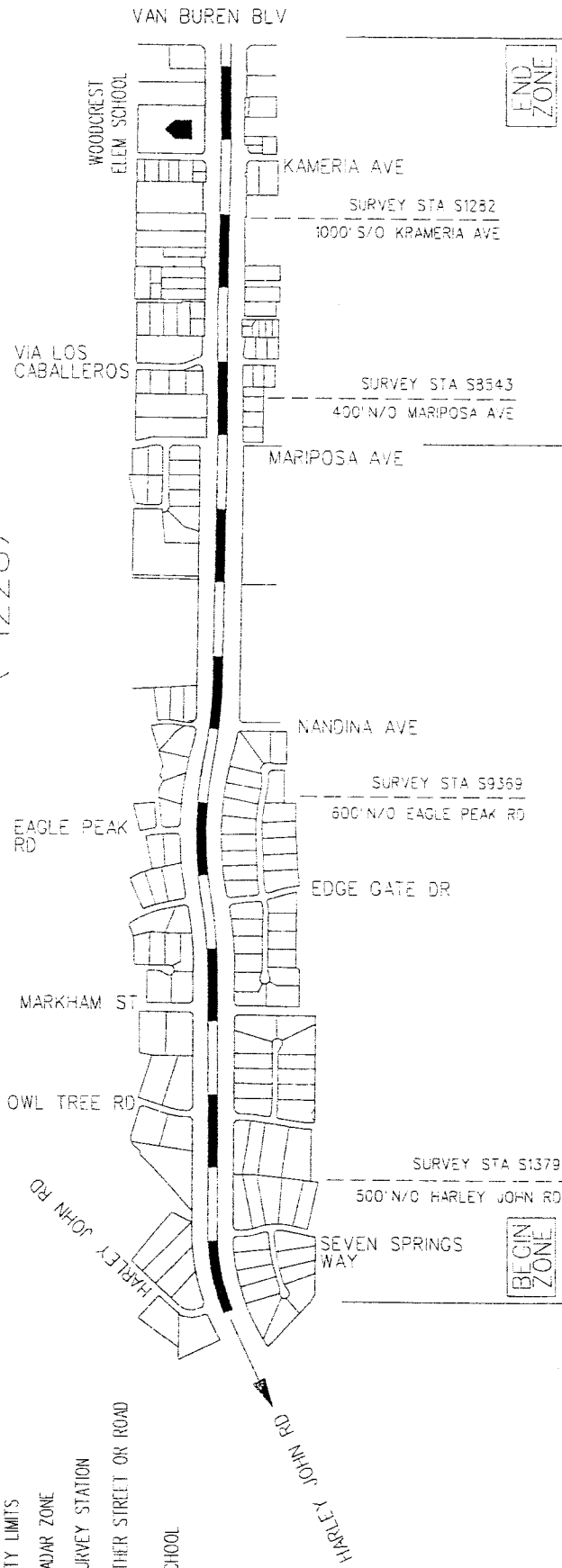

END ZONE

BEGIN ZONE



NO SCALE

RECOMMENDED SPEED LIMIT	50 MPH	35 MPH
PREVAILING SPEED (85%)	54.5 MPH (AVERAGE OF TWO SIMILAR SEGMENTS OF 58 & 51 MPH)	39.5 MPH (AVERAGE OF TWO SIMILAR SEGMENTS OF 37 & 42 MPH)
VEHICLES IN 24 HR (2 WAY)	6,630	8,340
SEGMENT LENGTH	1.5 MILE	0.68 MILE
ALL ACCIDENTS IN 2 YRS.	1	4
ACCIDENT RATE ☆	0.14 ACC/MVM	0.97 ACC/MVM
EXISTING SPEED LIMIT	50 MPH (Ord. 452.220 Sec. 2.6 No. 39)	35 MPH

(Ord. 452.218 Sec. 2.6 No. 39) (Ord. 452.220 Sec. 2.3 No. 77)

☆ RATE:  $\frac{\text{ACCIDENT} \times 1,000,000}{\text{VEH} \times 365 \times 2 \times \text{MILE}}$

COUNTY AREA:	LAKE MATHEWS	SURVEY DATE:	OCT 26, 2016
COUNTY MAP PAGE:	27, 28, 57A	MAP DATE:	MAR 31, 2017
SUPERVISOR DISTRICT:	1/1	DRAWN BY:	J VALADEZ
		CAD FILE:	WASHINGTON.DGN

APPROVED BY: *Lawrence T. Talpe*  
 DATE: 4/19/2017  
 LAWRENCE T. TALPE,  
 COUNTY TRAFFIC ENGINEER

COUNTY OF RIVERSIDE  
**TRANSPORTATION DEPARTMENT**  
 TRAFFIC ENGINEERING DIVISION

ENGINEERING AND TRAFFIC SURVEY  
 AI  
**WASHINGTON STREET**

PAGE 1 OF 1

ORDINANCE 452.243 DISTRICT 1 SPEED ZONE VICINITY MAP

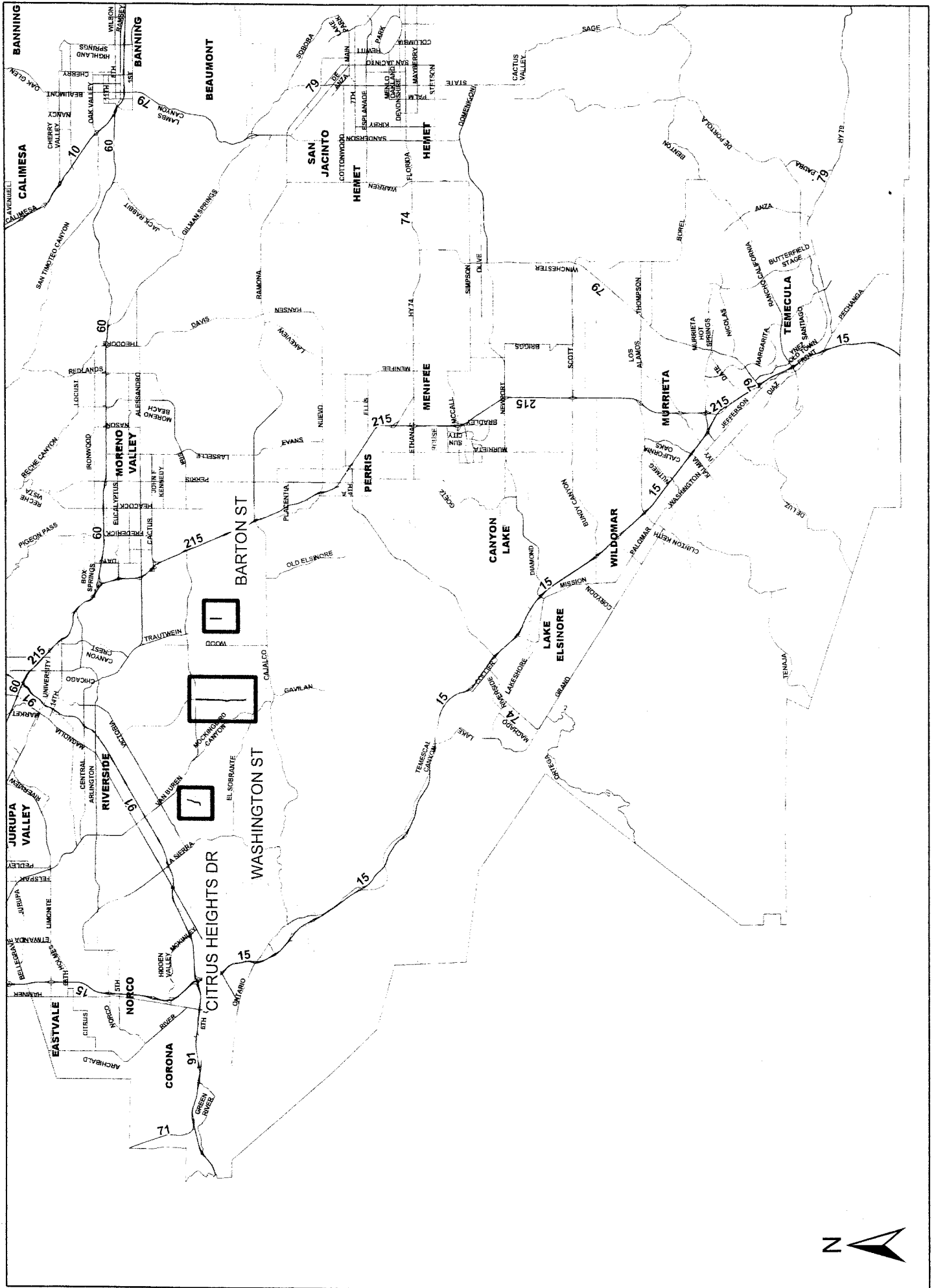



ORDINANCE 452.243 DISTRICT 2 SPEED ZONE VICINITY MAP

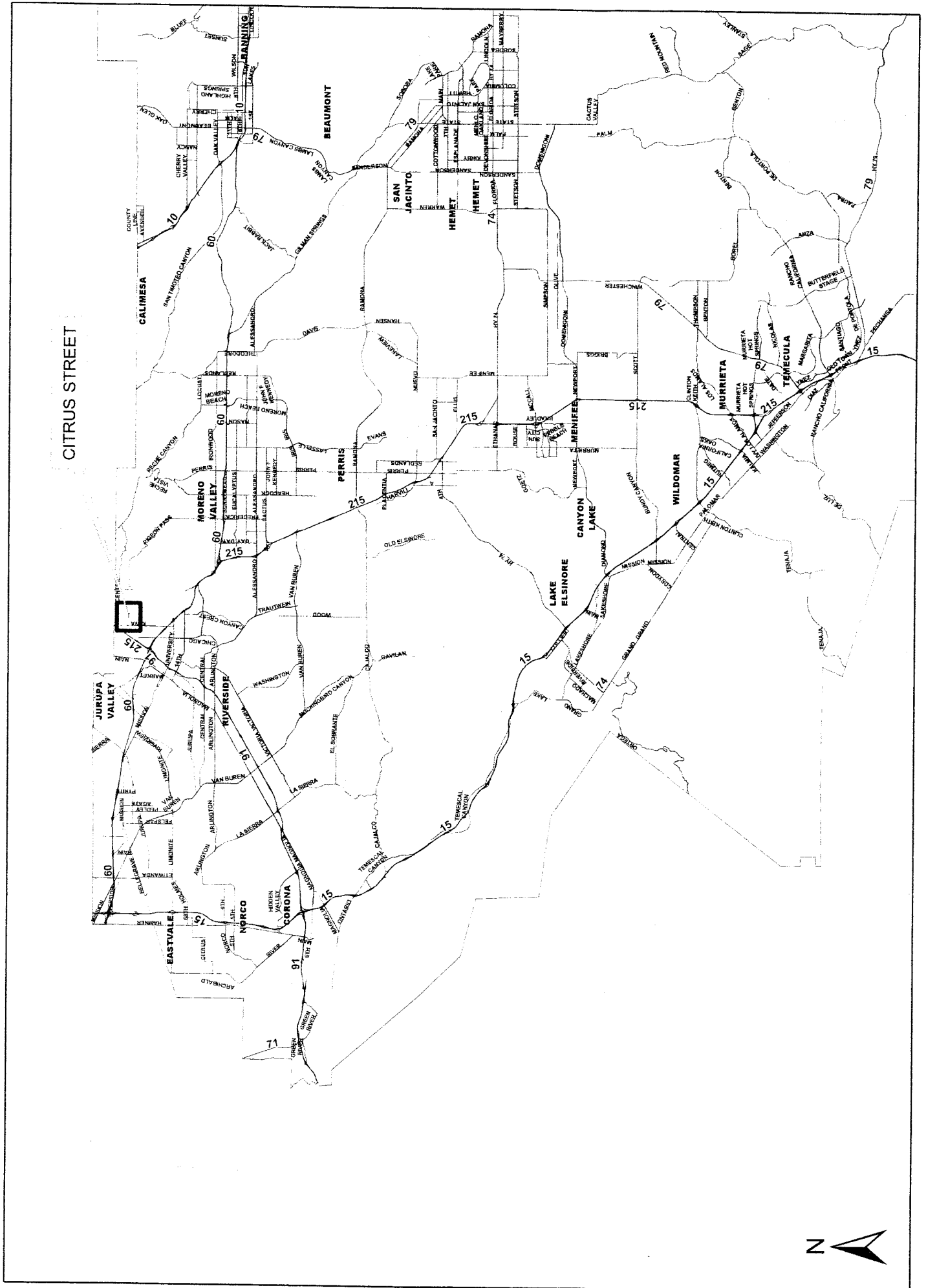



ORDINANCE 452.243 DISTRICT 4 SPEED ZONE VICINITY MAP

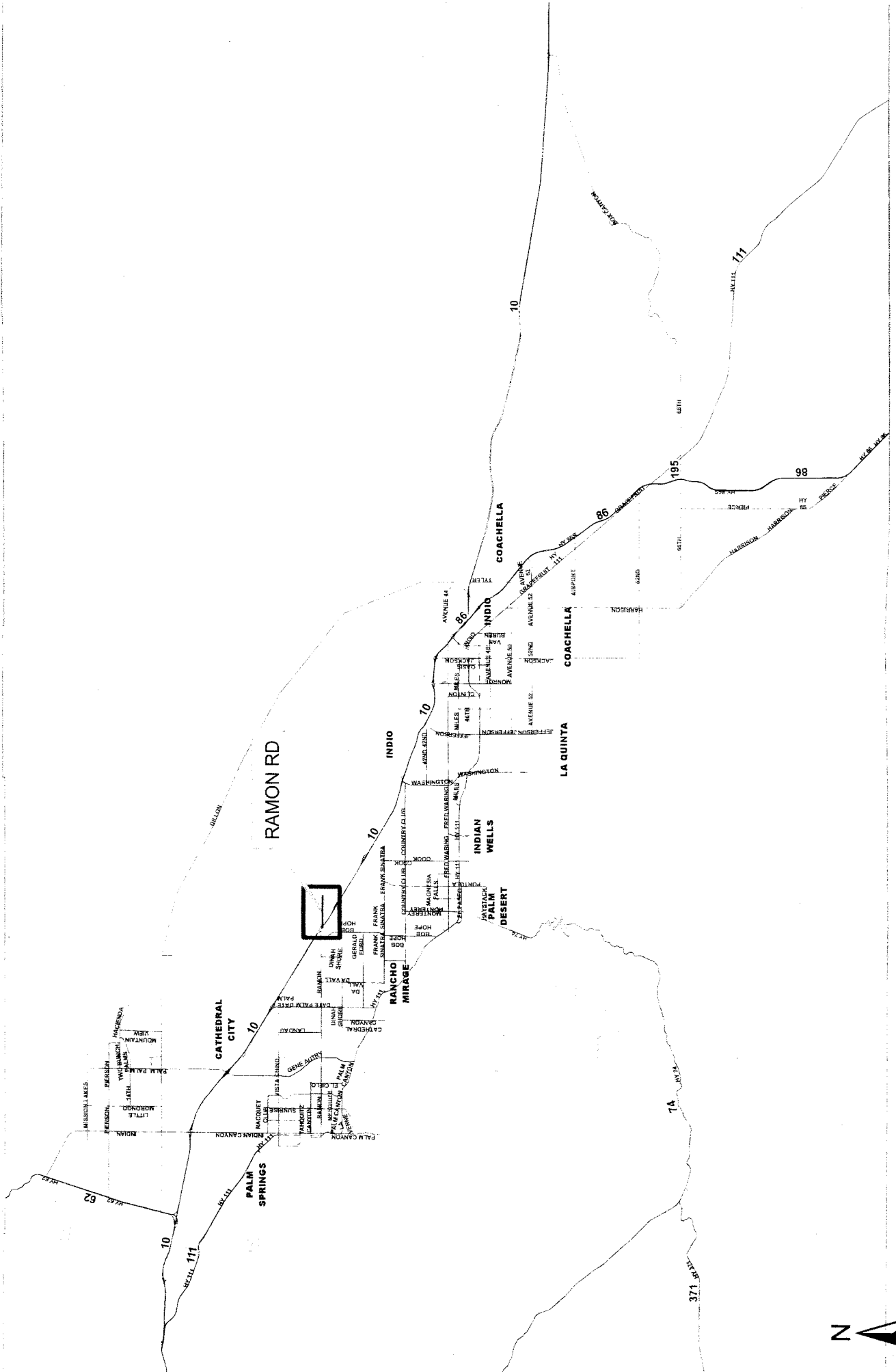

ORDINANCE 452.243 DISTRICT 5 SPEED ZONE VICINITY MAP

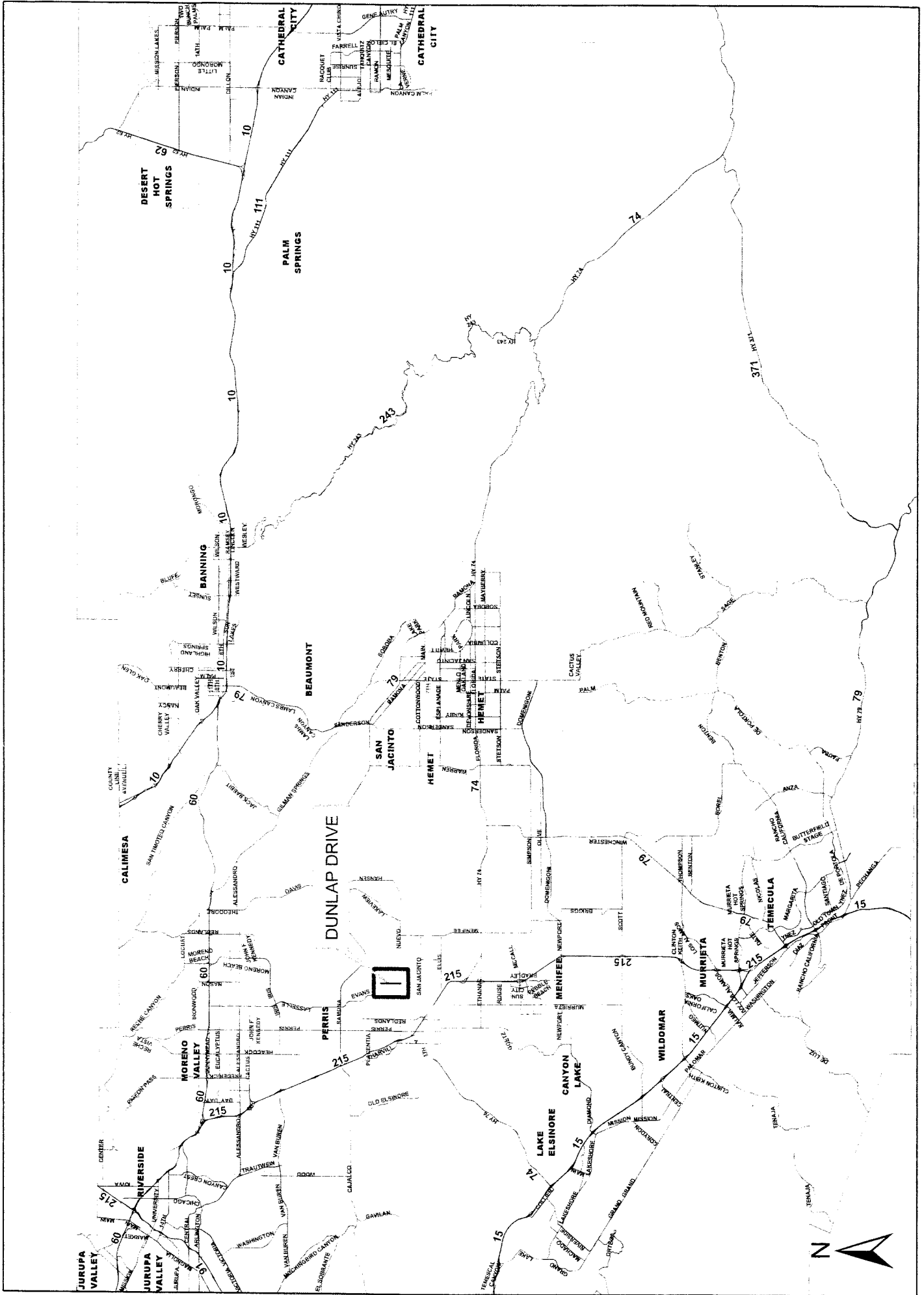

**LIST OF SPEED ZONE SUBMITTALS  
ORDINANCE AMENDMENT NO 452.243  
SUPERVISORIAL DISTRICT NO. 1**

AREA	ROAD NAME/ LIMITS	EXISTING SPEED LIMIT	PROPOSED SPEED LIMIT	NOTES
RIVERSIDE	<b>BARTON STREET</b> Between Nandina Ave and Mariposa Ave	Not Posted*	45	NEW SPEED ZONE
RIVERSIDE	<b>CITRUS HEIGHTS DRIVE</b> Between McAllister St and 2450' N/O McAllister St (City Limit)	Not Posted*	45	NEW SPEED ZONE Coordinated with The City of Riverside for the 45 mph speed limit in the city's portion.
LAKE MATHEWS	<b>WASHINGTON STREET</b> Between Harley John Rd and Mariposa Ave	50***	50	BOUNDARY CHANGE. Consolidation of two existing 50 mph speed zones. No change to existing speed limit.

\* Maximum allowable speed limit for a two-lane highway is 55 mph  
 \*\*Maximum allowable speed limit for a multi-lane highway is 65 mph  
 \*\*\*Change in speed zone boundary

**LIST OF SPEED ZONE SUBMITTALS  
ORDINANCE AMENDMENT NO 452.243  
SUPERVISORIAL DISTRICT NO. 2**

AREA	ROAD NAME/ LIMITS	EXISTING SPEED LIMIT	PROPOSED SPEED LIMIT	NOTES
HIGHGROVE	<b>CITRUS STREET</b> Between 800' W/O Northgate St easterly to Northgate St	Not Posted*	35	<b>NEW SPEED ZONE</b> Coordinated with The City of Riverside for 35 mph speed limit in the city's portion.

\* Maximum allowable speed limit for a two-lane highway is 55 mph  
 \*\*\*Maximum allowable speed limit for a multi-lane highway is 65 mph  
 \*\*\*Change in speed zone boundary

**LIST OF SPEED ZONE SUBMITTALS  
ORDINANCE AMENDMENT NO 452.243  
SUPERVISORIAL DISTRICT NO. 3**

AREA	ROAD NAME/ LIMITS	EXISTING SPEED LIMIT	PROPOSED SPEED LIMIT	NOTES
TEMECULA	<b>MORGAN HILL DRIVE</b> Between El Chamisal Rd and 260' N/O Coppola St	40***	40	BOUNDARY CHANGE. Consolidation of two existing 40mph speed zones. No change to existing speed limit.
FRENCH VALLEY	<b>POURROY ROAD</b> Between Murrieta Hot Springs Rd and Auld Rd	50***	45	SPEED LIMIT REDUCTION. BOUNDARY CHANGE, for existing 45mph speed zone.

- \* Maximum allowable speed limit for a two-lane highway is 55 mph
- \*\*\*Maximum allowable speed limit for a multi-lane highway is 65 mph
- \*\*\*Change in speed zone boundary

**LIST OF SPEED ZONE SUBMITTALS  
ORDINANCE AMENDMENT NO 452.243  
SUPERVISORIAL DISTRICT NO. 4**

AREA	ROAD NAME/ LIMITS	EXISTING SPEED LIMIT	PROPOSED SPEED LIMIT	NOTES
THOUSAND PALMS	<b>RAMON ROAD</b> Between 1900' W/O Varner Rd and Desert Moon Dr	45***	45	<b>BOUNDARY CHANGE.</b> Consolidation of two existing 45mph speed zones. No change to existing speed limit.

- \* Maximum allowable speed limit for a two-lane highway is 55 mph
- \*\* Maximum allowable speed limit for a multi-lane highway is 65 mph
- \*\*\* Change in speed zone boundary



**LIST OF SPEED ZONE SUBMITTALS  
ORDINANCE AMENDMENT NO 452.243  
SUPERVISORIAL DISTRICT NO. 5**

AREA	ROAD NAME/ LIMITS	EXISTING SPEED LIMIT	PROPOSED SPEED LIMIT	NOTES
PERRIS	<b>DUNLAP DRIVE</b> Between Nuevo Rd and Orange Ave	Not Posted*	45	<b>NEW SPEED ZONE</b> Coordinated with The City of Perris for the 45 mph speed limit for the city's portion.

- \* Maximum allowable speed limit for a two-lane highway is 55 mph
- \*\*Maximum allowable speed limit for a multi-lane highway is 65 mph
- \*\*\*Change in speed zone boundary