

**SUBMITTAL TO THE BOARD OF SUPERVISORS
COUNTY OF RIVERSIDE, STATE OF CALIFORNIA**

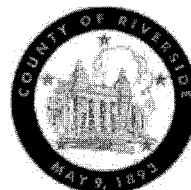

**ITEM
1.5
(ID # 6450)**

MEETING DATE:

Tuesday, March 13, 2018

FROM : TLMA-PLANNING:

SUBJECT: TRANSPORTATION & LAND MANAGEMENT AGENCY/PLANNING: RECEIVE AND FILE THE PLANNING COMMISSION'S DECISION TO APPROVE THE SECOND EXTENSION OF TIME for TENTATIVE TRACT MAP NO. 34466 – Applicant: Darren Chin – Third Supervisorial District – Rancho California Zoning Area – Southwest Area Plan: Rural: Rural Residential (R:RR) (5 Acre Minimum), Open Space: Conservation Habitat (OS:CH) – Location: Northerly of Buck Road, southerly of Borel Road, and westerly of Warren Road – 1,099.3 Acres – Zoning: Residential Agricultural (R-A), Open Area Combining Zone-Residential Developments (R-5), and Citrus/Vineyard (C/V) – APPROVED PROJECT DESCRIPTION: Schedule B subdivision of 1,099.3 acres into 236 lots that consists of 216 single family residential lots (128 with a 1/2-acre minimum lot size in the R-A zone and 88 with a 1-acre minimum lot size in the C/V zone), eight (8) winery production lots with a 15-acre minimum lot size, 12 open space lots, which total 96.59 gross acres, and a 574.99 acre MSHCP conservation lot. In addition, the project proposes and a 1.5-acre lot for a future fire station – REQUEST: SECOND EXTENSION OF TIME REQUEST for TENTATIVE TRACT MAP NO. 34466, extending the expiration date to April 3, 2021. [Applicant Fees 100%.]

RECOMMENDED MOTION: That the Board of Supervisors:

1. **RECEIVE AND FILE** the Planning Commission's Notice of Decision for the above referenced case acted on by the Planning Commission on January 17, 2018. The Tentative Tract Map No. 34466 will now expire on April 3, 2021.

ACTION: Consent



Charissa Leach, Assistant TLMA Director

3/5/2018

MINUTES OF THE BOARD OF SUPERVISORS

On motion of Supervisor Jeffries, seconded by Supervisor Perez and duly carried by unanimous vote, IT WAS ORDERED that the above matter of approval is received and filed as recommended.

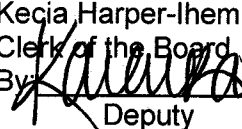
Ayes: Jeffries, Tavaglione, Washington, Perez and Ashley
Nays: None
Absent: None
Date: March 13, 2018
xc: Planning, Applicant

Kecia Harper-Ihem
Clerk of the Board
By: 
Deputy

**SUBMITTAL TO THE BOARD OF SUPERVISORS COUNTY OF RIVERSIDE,
STATE OF CALIFORNIA**

FINANCIAL DATA	Current Fiscal Year:	Next Fiscal Year:	Total Cost:	Ongoing Cost
COST	\$ N/A	\$ N/A	\$ N/A	\$ N/A
NET COUNTY COST	\$ N/A	\$ N/A	\$ N/A	\$ N/A
SOURCE OF FUNDS: Applicant fees 100%			Budget Adjustment: N/A	
			For Fiscal Year: N/A	

C.E.O. RECOMMENDATION: Approve

BACKGROUND:

Summary

Tentative Tract Map No. 34466 was originally approved by the Planning Commission on February 7, 2007. It proceeded to the Board of Supervisors along with Change of Zone No. 7275 where both applications were approved on April 3, 2007.

The Second Extension of Time was received on October 13, 2017, ahead of the expiration date of April 3, 2018. The applicant and the County discussed conditions of approval and reached consensus on November 22, 2017.

The County Planning Department, as part of the review of this Extension of Time request, recommends the addition of seven (7) new conditions of approval, in order to be able to make a determination that the project does not adversely affect the general health, safety, and welfare of the public. The applicant was informed of these recommended conditions and has agreed to accept them.

The Tentative Tract Map also benefited from Senate Bill No. 1185 (SB1185), Assembly Bill No. 333 (AB333), Assembly Bill No. 208 (AB208), and Assembly Bill No. 116 (AB116), which granted statutory extensions of time for tentative maps statewide.

The Planning Commission heard the second extension of time for Tentative Tract Map No. 34466 on January 17, 2018. The Planning Commission approved the project by a 5-0 vote.

Board Action

The Planning Commission's decision is final and no action by the Board of Supervisors is required unless the applicant or an interested person files a complete appeal application within 10 days of this notice appearing on the Board's agenda.

Impact on Citizens and Businesses

The impacts of this project have been evaluated through the environmental review and public hearing process by the Planning Department and the Planning Commission.

Supplemental

**SUBMITTAL TO THE BOARD OF SUPERVISORS COUNTY OF RIVERSIDE,
STATE OF CALIFORNIA**

Additional Fiscal Information

All fees are paid by the applicant. There is no General Fund obligation.

ATTACHMENTS:

- A. **PLANNING COMMISSION MINUTES**
- B. **PLANNING COMMISSION STAFF REPORT**

Scott Bruckner 3/6/2018



**PLANNING COMMISSION
MINUTE ORDER
JANUARY 17, 2018**

I. AGENDA ITEM 1.2

SECOND EXTENSION OF TIME REQUEST for TENTATIVE TRACT MAP NO. 34466 – Applicant: Darren Chin – Third Supervisorial District – Rancho California Zoning Area – Southwest Area Plan: Rural: Rural Residential (R-RR) (5 Acre Minimum) – Open Space: Conservation Habitat (OS-CH) – Location: Northerly of Buck Road, southerly of Borel Road, and westerly of Warren Road – 1,099.3 Acres – Zoning: Residential Agricultural (R-A) – Open Area Combining Zone-Residential Developments (R-5) – Citrus/Vineyard (C/V) – Approved Project Description: Schedule "B" Subdivision of 1,099.3 acres into 236 lots consisting of 216 single family residential lots (128 with ½ acre minimum lot size – R-A zoning and 88 with 1 acre minimum lot size – C/V zone), eight (8) winery production lots with a 15-acre minimum lot size, 12 open space lots, which total 96.59 gross acres, and a 574.99 acre MSHCP conservation lot. The project also proposes a 1.5-acre lot for a future fire station.

II. PROJECT DESCRIPTION:

Second Extension of Time Request for Tentative Tract Map No. 34466, extending the expiration date to April 3, 2021.

III. PLANNING COMMISSION ACTION:

Motion by Commissioner Shaffer, 2nd by Commissioner Taylor-Berger
A vote of 5-0

APPROVED - Second Extension of Time Request for Tentative Tract Map No. 34466, extending the expiration date to April 3, 2021.

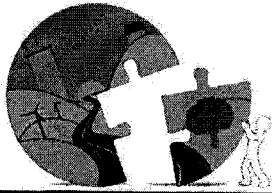

**COUNTY OF RIVERSIDE
PLANNING DEPARTMENT
EXTENSION OF TIME REPORT**

Agenda Item No.:

1.2

Planning Commission Hearing: January 17, 2018

PROPOSED PROJECT

Case Number(s): TR34466

Applicant(s):

Area Plan: Southwest

Darren Chin

Zoning Area/District: Rancho California Area

Representative(s):

Supervisory District: Third District

Project Planner: Gabriel Villalobos

Charissa Leach, P.E.
Assistant TLMA Director

PROJECT DESCRIPTION AND LOCATION

The applicant of the subject case has requested an extension of time to allow for the recordation of the final map to subdivide 1,099.3 acres into 236 lots that consists of 216 single family residential lots (128 with a 1/2 acre minimum lot size in the R-A zone and 88 with a 1 acre minimum lot size in the C/V zone), 8 winery production lots with a 15-acre minimum lot size, 12 open space lots, which total 96.59 gross acres, and a 574.99 acre MSHCP conservation lot. In addition, the project proposes and a 1.5-acre lot for a future fire station

PROJECT RECOMMENDATION

APPROVAL of the SECOND EXTENSION OF TIME REQUEST for TENTATIVE TRACT MAP NO. 34466, extending the expiration date and to reflect SB1185, AB333, AB208, and AB116 benefits to April 3, 2021, subject to all the previously approved and amended Conditions of Approval, with the applicant's consent.

PROJECT LOCATION MAP

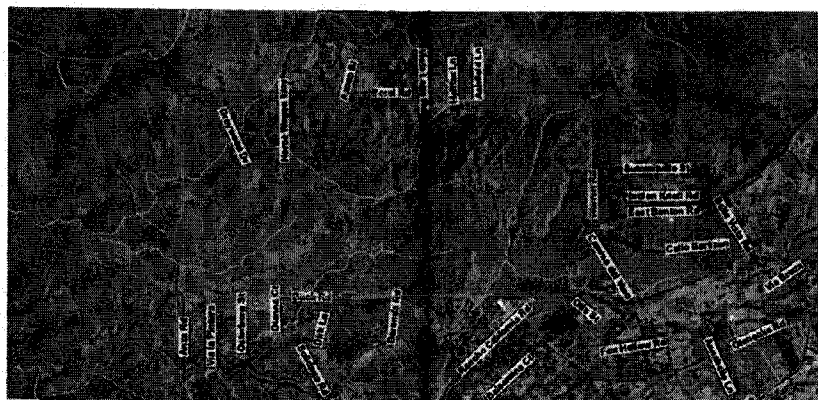

Figure 1: Project Location Map

PROJECT BACKGROUND AND ANALYSIS

Background

Tentative Tract Map No. 34466 was originally approved at Planning Commission on February 7, 2007. It proceeded to the Board of Supervisors along with Change of Zone No. 7275 where both applications were approved on April 3, 2007.

The Second Extension of Time was received October 13, 2017, ahead of the expiration date of April 3, 2018. The applicant and the County discussed conditions of approval and reached consensus on November 22, 2017.

The County Planning Department, as part of the review of this Extension of Time request, recommends the addition of seven (7) new conditions of approval, in order to be able to make a determination that the project does not adversely affect the general health, safety, and welfare of the public. The applicant was informed of these recommended conditions and has agreed to accept them. Included in this staff report package are the recommended conditions of approval, and the correspondence from the Extension of Time applicant (November 22, 2017) indicating the acceptance of the seven (7) recommended conditions.

Unless specifically requested by the applicant, this Extension of Time request will not be discussed at the time it is presented to the Planning Commission as a consent calendar item.

State Bills

EFFECT OF Senate Bill No. 1185 (SB1185): On July 15, 2008, AB208 was signed into law, which grants a one-time extension of existing subdivision maps so developers can build immediately when the demand for housing goes up. It gives developers an automatic 12 month extension on previously approved subdivision maps set to expire between July 15, 2008 and January 1, 2011.

EFFECT OF Assembly Bill No. 333 (AB333): On July 15, 2009, AB333 was signed into law, which grants a one-time extension of existing subdivision maps so developers can build immediately when the demand for housing goes up. It gives developers an automatic 24 month extension on previously approved subdivision maps set to expire between July 15, 2009 and January 1, 2012.

EFFECT OF Assembly Bill No. 208 (AB208): On July 13, 2011, AB208 was signed into law, which grants a one-time extension of existing subdivision maps so developers can build immediately when the demand for housing goes up. It gives developers an automatic 24 month extension on previously approved subdivision maps set to expire between July 13, 2011 and January 1, 2014.

EFFECT OF Assembly Bill No. 116 (AB116): On July 11, 2013, AB116 was signed into law, which grants a one-time extension of existing subdivision maps so developers can build immediately when the demand for housing goes up. It gives developers an automatic 24 month extension on previously approved subdivision maps set to expire between January 1, 2000 and July 11, 2013.

Therefore, upon an approval action by the Planning Commission,, subsequent receive and file action by the Board of Supervisors, and the conclusion of the 10-day appeal period, the tentative map's expiration date will become April 3, 2021. If a final map has not been recorded prior this date, the next extension of time request must be filed 30-days prior to map expiration.

Riverside County Map Extensions

Pursuant to County of Riverside Ordinance No. 460 (Subdivision Regulations), tentative tract and parcel maps have an initial life-span approval of 3-years. In addition, a maximum of 5, 1-year extensions may be

approved, upon a timely filed extension request, allowing for a total tentative map life-span approval of 8-years. On September 12, 2017, the Board of Supervisors approved an amendment to Ordinance 460, replacing the extension time frames to allow for 2, 3-year extensions, for a total tentative map life-span of 9-years.

As a result, the total number years a map may be extended is 6 years. The 1st extension of time granted 1 year. Upon an approval action by the Planning Commission, subsequent receive and file action by the Board of Supervisors, and the conclusion of the 10-day appeal period, this second extension of time will grant another 3 years, pushing the tentative tract map's expiration date to April 3, 2021. If a final map has not been recorded prior this date, the third extension of time request must be filed 30-days prior to map expiration. The third extension of time will grant another 2 years, pushing the final expiration date of the tentative tract map to April 3, 2023.

ENVIRONMENTAL REVIEW

The subject case has conformed to the requirements of the California Environmental Quality Act ("CEQA"), and all impacts have been analyzed in order to protect the public health, safety, and welfare. No changes to the approved map are proposed and as a result, no new environmental documentation is required prior to an Extension of Time approval.

FINDINGS

In order for the County to approve a proposed project, the following findings are required to be made:

Extension of Time Findings

1. This Tentative Tract Map has been found to be consistent with the Riverside County General Plan, pursuant to the originally approved findings and conditions of approval. This Extension of Time proposes no changes to the map design and is therefore still found to be consistent.
2. This Tentative Tract Map has been found to be consistent with Ordinance No. 348 (Zoning Code) and Ordinance No. 460 (Subdivision Regulations), pursuant to the originally approved findings and conditions of approval. This Extension of Time proposes no changes to the map design and is therefore still found to be consistent.
3. No changes to the approved map are proposed in conjunction with this Extension of Time. All impacts have been analyzed in order to protect the public health, safety, and welfare.

Vicinity Map

2nd EOT for TR34466

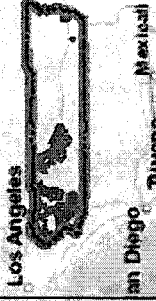

Legend

- County Centerlines
- Blueline Streams
- City Areas



0 3 6,019 Feet



"IMPORTANT" Maps and data are to be used for reference purposes only. Map features are approximate, and are not necessarily accurate to surveying or engineering standards. The County of Riverside makes no warranty or guarantee as to the content (the source is often third party), accuracy, timeliness, or completeness of any of the data provided, and assumes no legal responsibility for the information contained on this map. Any use of this product with respect to accuracy and precision shall be the sole responsibility of the user.

REPORT PRINTED ON... 11/30/2017 3:38:13 PM

© Riverside County GIS

Notes

COUNTY OF RIVERSIDE
TENTATIVE TRACT No. 34466
AMENDED MAP No. 2

PORTIONS OF SECTIONS 13 AND 14, TOWNSHIP 7 SOUTH, RANGE 2 WEST, SAN BERNARDINO MERIDIAN,
COUNTY OF RIVERSIDE, CALIFORNIA
AUGUST 21, 2004
REVISED DECEMBER 4, 2004

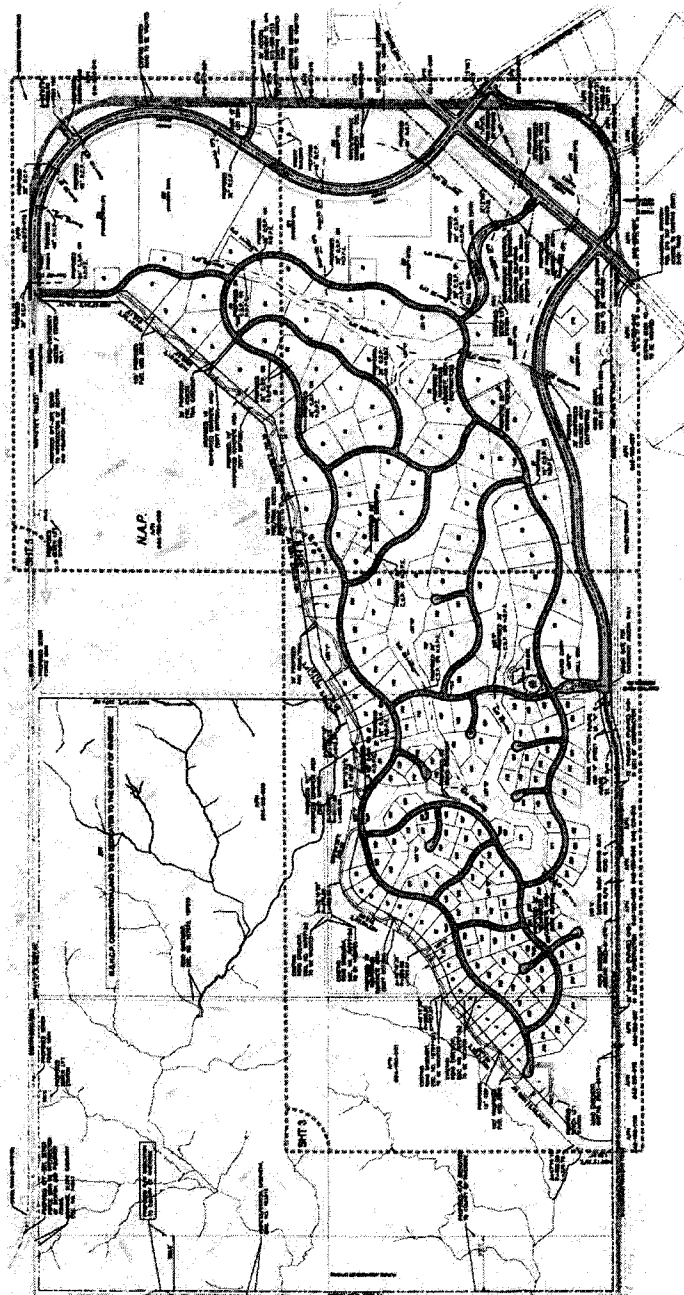
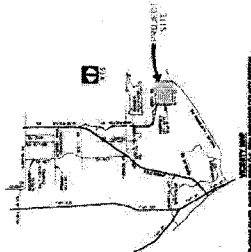
[illegible]

Extension of Time Environmental Determination

Project Case Number: TR34466
Original E.A. Number: EA40635
Extension of Time No.: 2nd EOT
Original Approval Date: April 3, 2007

Project Location: North of Buck Road, south of Borel Road, and west of Warren Road

Project Description: Schedule B subdivision of 1,099.3 acres into 236 lots that consists of 216 single family residential lots (128 with a 1/2 acre minimum lot size in the R-A zone and 88 with a 1 acre minimum lot size in the C/V zone), 8 winery production lots with a 15-acre minimum lot size, 12 open space lots, which total 96.59 gross acres, and a 574.99 acre MSHCP conservation lot. In addition, the project proposes and a 1.5-acre lot for a future fire station.

On April 3, 2007, this Tentative Tract Map and its original environmental assessment/environmental impact report was reviewed to determine: 1) whether any significant or potentially significant changes in the original proposal have occurred; 2) whether its environmental conditions or circumstances affecting the proposed development have changed. As a result of this evaluation, the following determination has been made:

<input type="checkbox"/>	I find that although the proposed project could have a significant effect on the environment, NO NEW ENVIRONMENTAL DOCUMENTATION IS REQUIRED PRIOR TO APPROVAL OF THE EXTENSION OF TIME, because all potentially significant effects (a) have been adequately analyzed in an earlier EIR or Negative Declaration pursuant to applicable legal standards and (b) have been avoided or mitigated pursuant to that earlier EIR or Negative Declaration and the project's original conditions of approval.
<input checked="" type="checkbox"/>	I find that although the proposed project could have a significant effect on the environment, and there are one or more potentially significant environmental changes or other changes to the circumstances under which the project is undertaken, NO NEW ENVIRONMENTAL DOCUMENTATION IS REQUIRED PRIOR TO APPROVAL OF THE EXTENSION OF TIME, because all potentially significant effects (a) have been adequately analyzed in an earlier EIR or Negative Declaration pursuant to applicable legal standards and (b) have been avoided or mitigated pursuant to that earlier EIR or Negative Declaration and revisions to the project's original conditions of approval which have been made and agreed to by the project proponent.
<input type="checkbox"/>	I find that there are one or more potentially significant environmental changes or other changes to the circumstances under which the project is undertaken, which the project's original conditions of approval may not address, and for which additional required mitigation measures and/or conditions of approval cannot be determined at this time. Therefore, AN ENVIRONMENTAL ASSESSMENT/INITIAL STUDY IS REQUIRED in order to determine what additional mitigation measures and/or conditions of approval, if any, may be needed, and whether or not at least one of the conditions described in California Code of Regulations, Section 15162 (necessitating a Supplemental or Subsequent E.I.R.) exist. Additionally, the environmental assessment/initial study shall be used to determine WHETHER OR NOT THE EXTENSION OF TIME SHOULD BE RECOMMENDED FOR APPROVAL.
<input type="checkbox"/>	I find that the original project was determined to be exempt from CEQA, and the proposed project will not have a significant effect on the environment, therefore NO NEW ENVIRONMENTAL DOCUMENTATION IS REQUIRED PRIOR TO APPROVAL OF THE EXTENSION OF TIME.

Signature: Gabriel Villalobos
Gabriel Villalobos, Project Planner

Date: November 30, 2017
For Charissa Leach, Assistant TLMA Director

Villalobos, Gabriel

From: Andrea Arcilla <andrea@epdsolutions.com>
Sent: Wednesday, November 22, 2017 11:59 AM
To: Villalobos, Gabriel
Cc: Wheeler, Timothy
Subject: RE: 2nd EOT TR34466 Recommended Conditions
Attachments: 2nd EOT TR34466 COA.PDF

Hi Gabriel,

We accept the additional conditions for EOT TR34466. Please let me know what the next steps are to complete the map extension.

Thanks!

Andrea Arcilla
E|P|D Solutions, Inc.

andrea@epdsolutions.com
949.278.5413 cell
2030 Main St., Ste. 1200
Irvine, CA 92614
www.epdsolutions.com

From: Wheeler, Timothy [mailto:TWHEELER@RIVCO.ORG]
Sent: Wednesday, November 8, 2017 9:26 AM
To: Andrea Arcilla <andrea@epdsolutions.com>
Cc: Villalobos, Gabriel <GVillalo@rivco.org>
Subject: FW: 2nd EOT TR34466 Recommended Conditions

Here you go Andrea...

Just reply to Gabriel with your acceptance of the recommended COA.

Tim Wheeler
Urban Regional Planner III
4080 Lemon St - 12th floor
Riverside, CA 92501
951-955-6060

How are we doing? Click the Link and tell us

From: Ortuno, Arturo
Sent: Tuesday, October 17, 2017 11:02 AM
To: 'darrenc@standardportfolios.com' <darrenc@standardportfolios.com>
Subject: 2nd EOT TR34466 Recommended Conditions

Attn: Darren Chin
Standard Temecula, LLC
488 E. Santa Clara Street, Suite 304
Arcadia, CA 91006

RE: SECOND EXTENSION OF TIME REQUEST for TENTATIVE TRACT MAP No. 34466.

The County Planning Department has determined it necessary to recommend the addition of seven (7) new conditions of approval in order to be able to make a determination that the project does not adversely affect the general health, safety and welfare of the public.

Please review the proposed conditions of approval attached in this correspondence. If these conditions are acceptable, then submit a short written letter/memo/email that clearly references this case, the acceptance of each condition by name and number, and clearly state that you, the Extension of Time Applicant, accept these conditions. This documentation will then be included in the staff report package. The attached document is a copy of the recommended conditions which are identified as follows:

50. REQ E HEALTH DOCUMENTS 80. WQMP AND MAINTENANCE
50. FINAL ACCESS AND MAINT 90. WQMP REQUIRED
60. REQ BMP SWPPP WQMP 90. WQMP COMP AND BNS REG
60. FINAL WQMP FOR GRADING

If the addition of the conditions is not acceptable, please notify me so we can discuss your concerns. If the issue cannot be resolved, then I will direct you to contact the individual Department representative to discuss this matter further.

Once the conditions have been accepted, I will begin preparing the staff report package for a Planning Commission hearing as a consent item. County Ordinance requires that conditions added thru the extension of time process are presented to and accepted by the applicant. If you, the EOT applicant, is unable to accept these conditions, the Planning Department will recommend denial of this extension of time request. An opportunity will, if requested, be provided for arguments to be made to the hearing body justifying why this request should be approved without the recommended conditions of approval.

I am eager to move this case forward and continue the extension of time process. If you have not contacted me within thirty (30) days, I will begin preparing this case with a recommendation of denial. I need one of two items to proceed:

- 1) Correspondence from you, the EOT applicant, accepting the recommended conditions per the directions provided above; or,
- 2) Correspondence from you, the EOT applicant, advising me of the concerns with the recommended conditions. If the concern still exists after our discussion, then direction on how to approach the issue will be given and additional time will be provided until the issue is resolved.

If you have any questions, comments, or concerns regarding this email, please feel free to contact me as indicated below.

Arturo Ortuño
Riverside County Planning Dept.
4080 Lemon Street – 12th Floor
Riverside, CA 92501
951-955-0314



COUNTY OF RIVERSIDE
PLANNING DEPARTMENT

How are we doing? Click the Link and tell us

Confidentiality Disclaimer

This email is confidential and intended solely for the use of the individual(s) to whom it is addressed. The information contained in this message may be privileged and confidential and protected from disclosure.

If you are not the author's intended recipient, be advised that you have received this email in error and that any use, dissemination, forwarding, printing, or copying of this email is strictly prohibited. If you have received this email in error please delete all copies, both electronic and printed, and contact the author immediately.

County of Riverside California

10/17/17
10:32

Riverside County LMS
CONDITIONS OF APPROVAL

Page: 1

TRACT MAP Tract #: TR34466

Parcel: 964-190-008

50. PRIOR TO MAP RECORDATION

E HEALTH DEPARTMENT

50.E HEALTH. 10-10-10 EOT2 - REQ E HEALTH DOCUMENTS

RECOMMND

Prior to map recordation, provide the following documents to the Riverside County Environmental Health Department:

1. Provide current documentation from the appropriate purveyor(s) for the establishment of water and/or sewer service for this project.
2. Provide documentation from an approved waste hauler in regards to solid waste service. Please call (951) 955-8980 for additional details.
3. Provide written clearance from DEH Environmental Cleanup Programs. Please note that an Environmental Site Assessment, Phase 1 study may be required at their discretion. For further information, please contact (951) 955-8982.

(This Extension of Time condition may be considered "Met" if it duplicates another similar condition issued by this department)

TRANS DEPARTMENT

50.TRANS. 40

EOT2 - FINAL ACCESS AND MAINT

RECOMMND

Prior to the map recordation, the applicant shall submit a Water Quality Management Plan (WQMP) subject to the State Regional Water Quality Board Order No. (See watershed below) to Transportation Department for review and approval. However, the applicant may be required to comply with the latest version of the WQMP manual if required by the State Regional Water Quality Board. All water quality features shall be included on the grading plan. WQMP applicability checklist, templates, LID design requirements, and guidance can be found on-line at: www.rcflood.org/npdes. For any questions, please contact (951) 712-5494.

Watersheds: Santa Ana No. R8-2013-0024 / Santa Margarita No. R9-2010-0016 / Whitewater No. R7-2013-0011

Additionally, prior to the map recordation, the applicant shall ensure that BMP facilities are placed in dedicated easements and that sufficient legal access to the BMPs are

10/17/17
10:32

Riverside County LMS
CONDITIONS OF APPROVAL

Page: 2

TRACT MAP Tract #: TR34466

Parcel: 964-190-008

50. PRIOR TO MAP RECORDATION

50.TRANS. 40

EOT2 - FINAL ACCESS AND MAINT (cont.)

RECOMMND

provided. This requirement is for both onsite and offsite property.

(This Extension of Time condition may be considered "Met" if it duplicates another similar condition issued by this department)

60. PRIOR TO GRADING PRMT ISSUANCE

BS GRADE DEPARTMENT

60.BS GRADE. 18

EOT2 - REQ BMP SWPPP WQMP

RECOMMND

Prior to the issuance of a grading permit, the owner / applicant shall obtain a BMP (Best Management Practices) Permit for the monitoring of the erosion and sediment control BMPs for the site. The Department of Building and Safety will conduct NPDES (National Pollutant Discharge Elimination System) inspections of the site based on Risk Level to verify compliance with the Construction General Permit, Stormwater ordinances and regulations until completion of the construction activities, permanent stabilization of the site and permit final.

Grading and construction sites of "ONE" acre or larger required to develop a STORM WATER POLLUTION PREVENTION PLAN (SWPPP) - the owner/applicant shall submit the SWPPP to the Building and Safety Department Environmental Compliance Division for review and approval prior to issuance of a grading permit.

If a Water Quality Management Plan (WQMP) is required, the owner / applicant shall submit to the Building & Safety Department, the approved project - specific Water Quality Management Plan (WQMP) and ensure that all approved water quality treatment control BMPs have been included on the grading plan.

(This Extension of Time condition may be considered "Met" if it duplicates another similar condition issued by this department)

10/17/17
10:32

Riverside County LMS
CONDITIONS OF APPROVAL

Page: 3

TRACT MAP Tract #: TR34466

Parcel: 964-190-008

60. PRIOR TO GRADING PRMT ISSUANCE

TRANS DEPARTMENT

60. TRANS. 1

EOT2 - FINAL WQMP FOR GRADING.

RECOMMND

This condition would apply when grading occurs before map recordation. Prior to the issuance of a grading permit, the applicant shall submit a Water Quality Management Plan (WQMP) subject to the State Regional Water Quality Board Order No. (See watershed below) to Transportation Department for review and approval. However, the applicant may be required to comply with the latest version of the WQMP manual if required by the State Regional Water Quality Board. All water quality features shall be included on the grading plan. WQMP applicability checklist, templates, LID design requirements, and guidance can be found on-line at: www.rcflood.org/npdes. For any questions, please contact (951) 712-5494.

atersheds: Santa Ana No. R8-2013-0024 / Santa Margarita No. R9-2010-0016 / Whitewater No. R7-2013-0011

(This Extension of Time condition may be considered "Met" if it duplicates another similar condition issued by this department)

80. PRIOR TO BLDG PRMT ISSUANCE

TRANS DEPARTMENT

80. TRANS. 4

EOT2 -WQMP AND MAINTENANCE

RECOMMND

The project shall begin constructing and installing the BMP facilities described in the approved Final WQMP. The project shall be responsible for performing all activities described in the WQMP and that copies of the approved Final WQMP are available for the future owners/occupants.

A maintenance plan and signed maintenance agreement shall be submitted to the Transportation Department for review and approval prior to issuance of occupancy permits. A maintenance organization will be established with a funding source for the permanent maintenance. The maintenance plan shall require that all BMP facilities are inspected, if required, cleaned no later than October 15 each year.

(This Extension of Time condition may be considered "Met" if it duplicates another similar condition issued by this department)

10/17/17
10:32

Riverside County LMS
CONDITIONS OF APPROVAL

Page: 4

TRACT MAP Tract #: TR34466

Parcel: 964-190-008

90. PRIOR TO BLDG FINAL INSPECTION

BS GRADE DEPARTMENT

90.BS GRADE. 8 EOT2 - WQMP REQUIRED

RECOMMND

Prior to final building inspection, the applicant shall comply with the following:

1. Obtain inspection of all treatment control BMPs and/or clearance from the Building and Safety Department. All structural BMPs described in the project - specific WQMP and indicated on the approved grading plan shall be constructed and installed in conformance with the approved plans and specifications.
2. The applicant/owner shall submit a "Wet Signed" copy of the Water Quality Management Plan (WQMP) Certification from a Registered Civil Engineer certifying that the project - specific WQMP treatment control BMPs have been installed in accordance with the approved WQMP.
3. The applicant/owner shall provide the Department of Building Safety with GPS coordinates for the location of the project - specific WQMP treatment control BMPs.
4. The applicant/owner shall register the project - specific WQMP treatment control BMPs with the Department of Building Safety Business Registration Division. Any person or entity that owns or operates a commercial and/or industrial facility shall register such facility for annual inspections.
5. The applicant shall make payment to the Building and Safety Department for the Water Quality Management Plan (WQMP) Annual Inspection.

(This Extension of Time condition may be considered "Met" if it duplicates another similar condition issued by this department)

TRANS DEPARTMENT

90.TRANS. 8 EOT2 - WQMP COMP AND BNS REG

RECOMMND

Prior to Building Final Inspection, the applicant will be required to hand out educational materials regarding water quality, provide a engineered WQMP certification, inspection of BMPs, GPS location of BMPs, and ensure that the requirements for inspection and cleaning the BMPs are

10/17/17
10:32

Riverside County LMS
CONDITIONS OF APPROVAL

Page: 5

TRACT MAP Tract #: TR34466

Parcel: 964-190-008

90. PRIOR TO BLDG FINAL INSPECTION

90.TRANS. 8

EOT2 - WQMP COMP AND ENS REG (cont.)

RECOMMND

established. Additionally, the applicants will be required to register BMPs with the Transportation Department's Business Registration Division.

(This Extension of Time condition may be considered "Met" if it duplicates another similar condition issued by this department)