

**SUBMITTAL TO THE BOARD OF SUPERVISORS
COUNTY OF RIVERSIDE, STATE OF CALIFORNIA**



ITEM
12.1
(ID # 7173)

MEETING DATE:

Tuesday, June 12, 2018

FROM : DEPARTMENT OF WASTE RESOURCES:

SUBJECT: DEPARTMENT OF WASTE RESOURCES: Contract Change Order for the Daily Cover Excavation and On-Call Site Improvements (Excavation, Hauling, Stockpiling & NPDES Maintenance) at the Badlands and Lamb Canyon Sanitary Landfills, District 5. [\$611,584.00 – Department of Waste Resources Enterprise Funds] (CEQA Finding of Nothing Further Required)

RECOMMENDED MOTION: That the Board of Supervisors:

1. Find that nothing further is required pursuant to the California Environmental Quality Act (CEQA), whereas on July 25, 2017, the Board of Supervisors approved contract documents for the Construction of the Daily Cover Excavation and On-Call Site Improvements (Excavation, Hauling, Stockpiling & National Pollutant Discharge Elimination System (NPDES) Maintenance) at the Badlands and Lamb Canyon Sanitary Landfills (Project), for which the Project was determined to be categorically exempt pursuant to sections 15301 (Existing Facilities), 15304 (Minor Alterations To Land), as well as exempt under State CEQA Guidelines Section 15061(b)(3) (General Rule for Exemption); and

Continued on page 2

ACTION: Change Order, Policy

Hans Kelnkamp, General Manager - Chief Engineer 5/29/2018

MINUTES OF THE BOARD OF SUPERVISORS

On motion of Supervisor Jeffries, seconded by Supervisor Tavaglione and duly carried by unanimous vote, IT WAS ORDERED that the above matter is approved as recommended.

Ayes: Jeffries, Tavaglione, Washington, Perez and Ashley
Nays: None
Absent: None
Date: June 12, 2018
xc: Waste

Kecia Harper-Ihem
Clerk of the Board

By:
Deputy

**SUBMITTAL TO THE BOARD OF SUPERVISORS COUNTY OF RIVERSIDE,
STATE OF CALIFORNIA**

RECOMMENDED MOTION: That the Board of Supervisors:

2. Approve Contract Change Order No.1 (CCO No.1) in the amount of \$611,584.00, to the Contract with Road Builders, Inc. (Contractor) for implementing additional site improvements in preparation for the upcoming 2018-2019 rainy season at the Badlands and Lamb Canyon sanitary landfill sites, and authorize the Chairman of the Board to execute it on behalf of the County.

Prev. Agn. Ref.: 7/25/2017 (12.1)
9/12/2017 (12.1)

FINANCIAL DATA	Current Fiscal Year:	Next Fiscal Year:	Total Cost:	Ongoing Cost
COST	\$ 611,584.00	\$ 0	\$ 611,584.00	\$ 0
NET COUNTY COST	\$ 0	\$ 0	\$ 0	\$ 0
SOURCE OF FUNDS: Department of Waste Resources Enterprise Funds			Budget Adjustment:	No
			For Fiscal Year:	17/18

C.E.O. RECOMMENDATION: Approve

BACKGROUND:

Summary

On July 25, 2017, the Board approved the contract documents for the Excavation, Hauling, and Stockpiling Daily Cover Material and NPDES Maintenance and Improvements at the Badlands and Lamb Canyon Landfills. A total of two (2) bids were received, with Contractor submitting the lowest responsible bid. On September 12, 2017, the Board awarded the contract to Contactor. The duration of the project is one year and the total contract amount for this project is \$1,716,135.00.

The Department's engineering staff has identified additional site improvements that will need to be implemented at both landfill sites in preparation for the upcoming 2018/2019 rainy season. The main work items for the additional improvements include expansion of the wet-weather disposal pad and associated access roads and drainage structures, relocation of the composting area to improve wastewater runoff management and site operations, and implementation of additional grading, drainage and erosion control measures within various work areas at both sites (refer to Attachment A – Contract Change Order No.1).

Based on previous and similar work performed under this contract, the estimated cost for the additional site improvements is \$611,584.00 which will increase the total original contract amount from \$1,716,135.00 to \$2,327,719.00.

**SUBMITTAL TO THE BOARD OF SUPERVISORS COUNTY OF RIVERSIDE,
STATE OF CALIFORNIA**

CEQA Findings

On July 25, 2017, the Board approved contract documents for Excavation, Hauling, and Stockpiling Daily Cover Material and NPDES Maintenance and Improvements at the Badlands and Lamb Canyon Landfills. As such, a Notice of Exemption (NOE) was filed, identifying that the Project was exempt from CEQA pursuant to the State CEQA Guidelines Section 15061(b)(3) (General Rule for Exemption), and categorically exempt from CEQA pursuant to Section 15301 Existing Facilities and Section 15304 Minor Alterations of Land. The 35-day statute of limitations for review and comment has expired, with no comments or challenges to the NOE received. Since the proposed motion in this Form-11 simply involves the award to change contract terms to allow the approved contractor to complete the work already environmentally assessed in compliance with CEQA, no further environmental documentation is required pursuant to the provisions of CEQA (Public Resources Code, § 21000 et seq.).

Impact on Residents and Businesses

The work requested by this change order will improve public safety and landfill operations within the wet-weather disposal pads and other work areas at both landfill sites.

Additional Fiscal Information

The final cost for the additional site improvements will be determined based on combination of contract unit prices and force account (Time and Material - T&M). T&M will be tracked and agreed upon at the end of each work day by the Department engineering staff and the Contractor. All equipment rates will be in accordance with those published by Caltrans "Labor Surcharge and Equipment Rental Rates". All labor rates will be obtained from the California Prevailing Wage determination by the Director of Industrial Relations for a number of localities including Riverside County.

Budget for this additional work will be provided from Fund 40200, Department ID – 4500100000.

Contract History and Price Reasonableness

The final cost for the additional site improvements will be determined based on combination of contract unit prices and force account (Time and Material - T&M) as described in the Contract Documents. This ensures that the total final cost is fair and reasonable.

**SUBMITTAL TO THE BOARD OF SUPERVISORS COUNTY OF RIVERSIDE,
STATE OF CALIFORNIA**

CHANGE ORDER REPORT

NUMBER	AMOUNT	PERCENT	DESCRIPTION
	\$ 1,716,135.00		Original Contract Amount
CCO#1	\$ 611,584.00	35.6 %	Additional site improvements need to be implemented at the Badlands and Lamb Canyon Landfill sites in preparation for the upcoming 2018/2019 rainy season. This Change Order is initiated by county.
	\$ 2,327,719.00	35.6 %	New contract total

The Department desires to improve access and drainage within the wet-weather disposal areas at Badlands and Lamb Canyon landfills in preparation for the upcoming 2018/2019 rainy season. These improvements include re-grade landfill access road and install aggregate base material, install drainage pipes, construct shotcrete inlet structures for drainage pipes, place processed greenwaste on landfill slopes for erosion control, install 25-foot tall litter fence along landfill boundary, construct earthen diversion berms, and customer access road striping to enhance traffic control measures.

ATTACHMENT

ATTACHMENT A – Badlands Landfill and Lamb Canyon Landfill - Contract Change Order No.1



Gregory V. Priamos, Director County Counsel 5/31/2018

RIVERSIDE COUNTY DEPARTMENT OF WASTE RESOURCES

Project: Daily Cover Excavation and On-Call Site Improvements Sheet 1 of 3
at the Badlands and Lamb Canyon Sanitary Landfills

CONTRACT CHANGE ORDER NO. 1

To: Road Builders, Inc., Contractor, you are hereby directed to make the herein described changes from the plans and specifications or to do the following described work not included in the plans and specifications.

NOTE: THIS CHANGE ORDER IS NOT EFFECTIVE UNTIL APPROVED BY THE GENERAL MANAGER-CHIEF ENGINEER OF THE DEPARTMENT OF WASTE RESOURCES.

Description of work to be done, estimate of quantities, and prices to be paid. Unless otherwise stated, rates for rental of equipment cover only such time as equipment is actually used and no allowance will be made for idle time. Change requested by Riverside County:

Additional Site Improvements at the Lamb Canyon Landfill:

The Department plans to relocate the current composting facility from its current location within the landfill footprint to a new area located immediately west of the Waste Recycle Park (WRP). Prior to relocation, the Department has requested Road Builders, Inc. (RBI) to implement some grading, drainage, and access improvements in the new area. These improvements include: re-grading the new composting pad to establish a positive drainage pattern towards an existing percolation basin (Bid Item 27); construction of reinforced shotcrete drainage structures (Bid Item 14); construction of earthen diversion berms (Bid Item 27); construction of reinforce concrete pad for a 10,000-gallon water supply tank (Bid Item 27); relocation of an existing 10,000-gallon water supply tank from its current location to the new concrete pad and installation of all tank apparatus such as piping, valves, and stub-outs (Bid Item 27). Refer to Attachment No.1 for the layout and construction details of all proposed improvements within the new composting facility location.

The Department has also requested RBI to improve access and drainage within the wet-weather disposal area in preparation for the upcoming 2018/2019 rainy season. These improvements consist of the following work items: re-grade landfill access road and install aggregate base material (Bid Item 27); re-align the two existing 8-inch HDPE pipes (Bid Item 27); construct shotcrete inlet structure for HDPE pipes (Bid Item 14); and construct earthen diversion berms (Bid Item 27). Refer to Attachment No.1 for the layout and construction details of all the proposed improvements within the wet weather disposal area.

The Department has also requested RBI to grade a pad (excavation and engineered fill) for a future flare station at the location and to the design grades shown in Attachment No.1 (Bid Item 27).

Cost: Decrease - \$ 0 or Increase \$ 611,584.00

An additional sixty (60) work days will be added to this contract.

Submitted by: _____ Date: _____

Approved by: _____ Date: _____

General Manager-Chief Engineer
Department of Waste Resources

We, the undersigned Contractor, have given careful consideration to the change proposed and hereby agree, if this proposal is approved, that we will provide all equipment, furnish all materials, except as may be otherwise noted above, and perform all services necessary for the work above specified, and will accept as full payment therefore the prices shown above.

Accepted: _____ Date: _____ Contractor: _____
By: _____ Title: _____

If the Contractor does not sign acceptance of this order, his attention is directed to the requirements of the specifications as to the proceeding with the ordered work and filing a written protest within the time therein specified.

JUN 12 2018 12.10

RIVERSIDE COUNTY DEPARTMENT OF WASTE RESOURCES

Project: Daily Cover Excavation and On-Call Site Improvements Sheet 2 of 3
at the Badlands and Lamb Canyon Sanitary Landfills

CONTRACT CHANGE ORDER NO. 1

To: Road Builders, Inc., Contractor, you are hereby directed to make the herein described changes from the plans and specifications or to do the following described work not included in the plans and specifications.

NOTE: THIS CHANGE ORDER IS NOT EFFECTIVE UNTIL APPROVED BY THE GENERAL MANAGER-CHIEF ENGINEER OF THE DEPARTMENT OF WASTE RESOURCES.

Description of work to be done, estimate of quantities, and prices to be paid. Unless otherwise stated, rates for rental of equipment cover only such time as equipment is actually used and no allowance will be made for idle time. Change requested by Riverside County:

In addition, the Department may request RBI to implement additional miscellaneous grading, drainage and erosion control measures within various work areas at the site.

Additional Site Improvements at the Badlands Landfill:

The Department plans to construct a new commercial access road to the Badlands C4P3 fill area. This new road has approximately 9,122 cubic yards of engineered fill (Bid Item 6) and 275 cubic yards of refuse excavation (Bid Item 5); bench 2 will be re-graded to establish a positive longitudinal drainage towards an existing drainage channel (Bid Item 27); construction of earthen diversion berms throughout the site (Bid Item 27); customer access road striping (Bid Item 27); additional placement of processed greenwaste on landfill slopes (Bid Item 23) and installation of approximately 1,000 feet of a 25-foot tall litter fence along the south landfill boundary (Bid Item 27).

The Department has also requested RBI to improve access and drainage within the wet-weather disposal area in preparation for the upcoming 2018/2019 rainy season. These improvements consist of the following work items: re-grade landfill access road and install aggregate base material (Bid Item 27).

The Department and Contractor have agreed that the measurement and compensation to the Contractor for implementing all above-described improvements shall be determined based on combination of contract unit prices and force account (Time and Material - T&M) as applicable and described in the Contract Documents.

Cost: Decrease - \$ 0 or Increase \$ 611,584.00

An additional sixty (60) work days will be added to this contract.

Submitted by: _____

Date: _____

Approved by: _____

Date: _____

General Manager-Chief Engineer
Department of Waste Resources

We, the undersigned Contractor, have given careful consideration to the change proposed and hereby agree, if this proposal is approved, that we will provide all equipment, furnish all materials, except as may be otherwise noted above, and perform all services necessary for the work above specified, and will accept as full payment therefore the prices shown above.

Accepted: _____ Date: _____

Contractor: _____

By: _____

Title: _____

If the Contractor does not sign acceptance of this order, his attention is directed to the requirements of the specifications as to the proceeding with the ordered work and filing a written protest within the time therein specified.

RIVERSIDE COUNTY DEPARTMENT OF WASTE RESOURCES

Project: Daily Cover Excavation and On-Call Site Improvements Sheet 3 of 3
at the Badlands and Lamb Canyon Sanitary Landfills

CONTRACT CHANGE ORDER NO. 1

To: **Road Builders, Inc.**, Contractor, you are hereby directed to make the herein described changes from the plans and specifications or to do the following described work not included in the plans and specifications.

NOTE: THIS CHANGE ORDER IS NOT EFFECTIVE UNTIL APPROVED BY THE GENERAL MANAGER-CHIEF ENGINEER OF THE DEPARTMENT OF WASTE RESOURCES.

Description of work to be done, estimate of quantities, and prices to be paid. Unless otherwise stated, rates for rental of equipment cover only such time as equipment is actually used and no allowance will be made for idle time. Change requested by Riverside County:

Cost Impact:

The following table is a cost breakdown for all items included in this contract change order no. 1:

Table 1: Quantity and Cost

Bid Item	Description	Unit	Quantity	Unit Cost	Total Cost
5	Refuse Excavation and Haul to Active Face	CY	275	\$18.00	\$4,950.00
6	Engineered Fill	CY	9,662	\$7.00	\$67,634.00
14	4" thick Reinforced Shotcrete Drainage Structures	SF	750	\$12.00	\$9,000.00
23	Greenwaste Slopes	SF	300,000	\$0.10	\$30,000.00
27	Authorized Time and Material	LS	1	\$500,000.00	\$500,000.00

Total: \$611,584.00

This Contract Change Order will increase the total contract amount by \$611,584.00 (increase of original contract amount from \$1,716,135.00 to \$2,327,719.00). All other terms and conditions of the Contract Documents shall remain unchanged.

Attachments:

Attachment No.1 – Lamb Canyon Landfill Contract Change Order No.1 Maps and Details

PD#223853v1 (word)
 PD#223854v1 (pdf)

Cost: Decrease - \$ 0 or Increase \$ 611,584.00

An additional sixty (60) work days will be added to this contract.

Approved by:

 Chairman, Board of Supervisors
 CHUCK WASHINGTON

Date: JUN 12 2018

ATTEST:

KECIA HARPER-IHEM, Clerk
 By:  DEPUTY

~~We, the undersigned Contractor, have given careful consideration to the change proposed and hereby agree, if this proposal is approved, that we will provide all equipment, furnish all materials, except as may be otherwise noted above, and perform all services necessary for the work above specified, and will accept as full payment therefore the prices shown above.~~

~~Accepted: _____ Date: _____ Contractor: _____
 By: _____ Title: _____~~

~~If the Contractor does not sign acceptance of this order, his attention is directed to the requirements of the specifications as to the proceeding with the ordered work and filing a written protest within the time therein specified.~~

FORM APPROVED COUNTY COUNSEL
 BY:  DATE: 5-31-18
 CYNTHIA M. GUNZEL

RIVERSIDE COUNTY DEPARTMENT OF WASTE RESOURCES

Project: Daily Cover Excavation and On-Call Site Improvements Sheet 3 of 3
at the Badlands and Lamb Canyon Sanitary Landfills

CONTRACT CHANGE ORDER NO. 1

To: Road Builders, Inc., Contractor, you are hereby directed to make the herein described changes from the plans and specifications or to do the following described work not included in the plans and specifications.

NOTE: THIS CHANGE ORDER IS NOT EFFECTIVE UNTIL APPROVED BY THE GENERAL MANAGER-CHIEF ENGINEER OF THE DEPARTMENT OF WASTE RESOURCES.

Description of work to be done, estimate of quantities, and prices to be paid. Unless otherwise stated, rates for rental of equipment cover only such time as equipment is actually used and no allowance will be made for idle time. Change requested by Riverside County:

Cost Impact:

The following table is a cost breakdown for all items included in this contract change order no. 1:

Table 1: Quantity and Cost

Bid Item	Description	Unit	Quantity	Unit Cost	Total Cost
5	Refuse Excavation and Haul to Active Face	CY	275	\$18.00	\$4,950.00
6	Engineered Fill	CY	9,662	\$7.00	\$67,634.00
14	4" thick Reinforced Shotcrete Drainage Structures	SF	750	\$12.00	\$9,000.00
23	Greenwaste Slopes	SF	300,000	\$0.10	\$30,000.00
27	Authorized Time and Material	LS	1	\$500,000.00	\$500,000.00
Total:					\$611,584.00

This Contract Change Order will increase the total contract amount by \$611,584.00 (increase of original contract amount from \$1,716,135.00 to \$2,327,719.00). All other terms and conditions of the Contract Documents shall remain unchanged.

Attachments:

Attachment No.1 – Lamb Canyon Landfill Contract Change Order No.1 Maps and Details
 PD#223853v1 (word)
 PD#223854v1 (pdf)

Cost: Decrease - \$ 0 or Increase \$ 611,584.00

An additional sixty (60) work days will be added to this contract.

Submitted by: [Signature] Date: 5/29/18
 Approved by: [Signature] Date: 5/29/18
 General Manager-Chief Engineer
 Department of Waste Resources

We, the undersigned Contractor, have given careful consideration to the change proposed and hereby agree, if this proposal is approved, that we will provide all equipment, furnish all materials, except as may be otherwise noted above, and perform all services necessary for the work above specified, and will accept as full payment therefore the prices shown above.

Accepted: By: [Signature] Date: 5.29.18 Contractor: [Signature] Title: President

If the Contractor does not sign acceptance of this order, his attention is directed to the requirements of the specifications as to the proceeding with the ordered work and filing a written protest within the time therein specified.

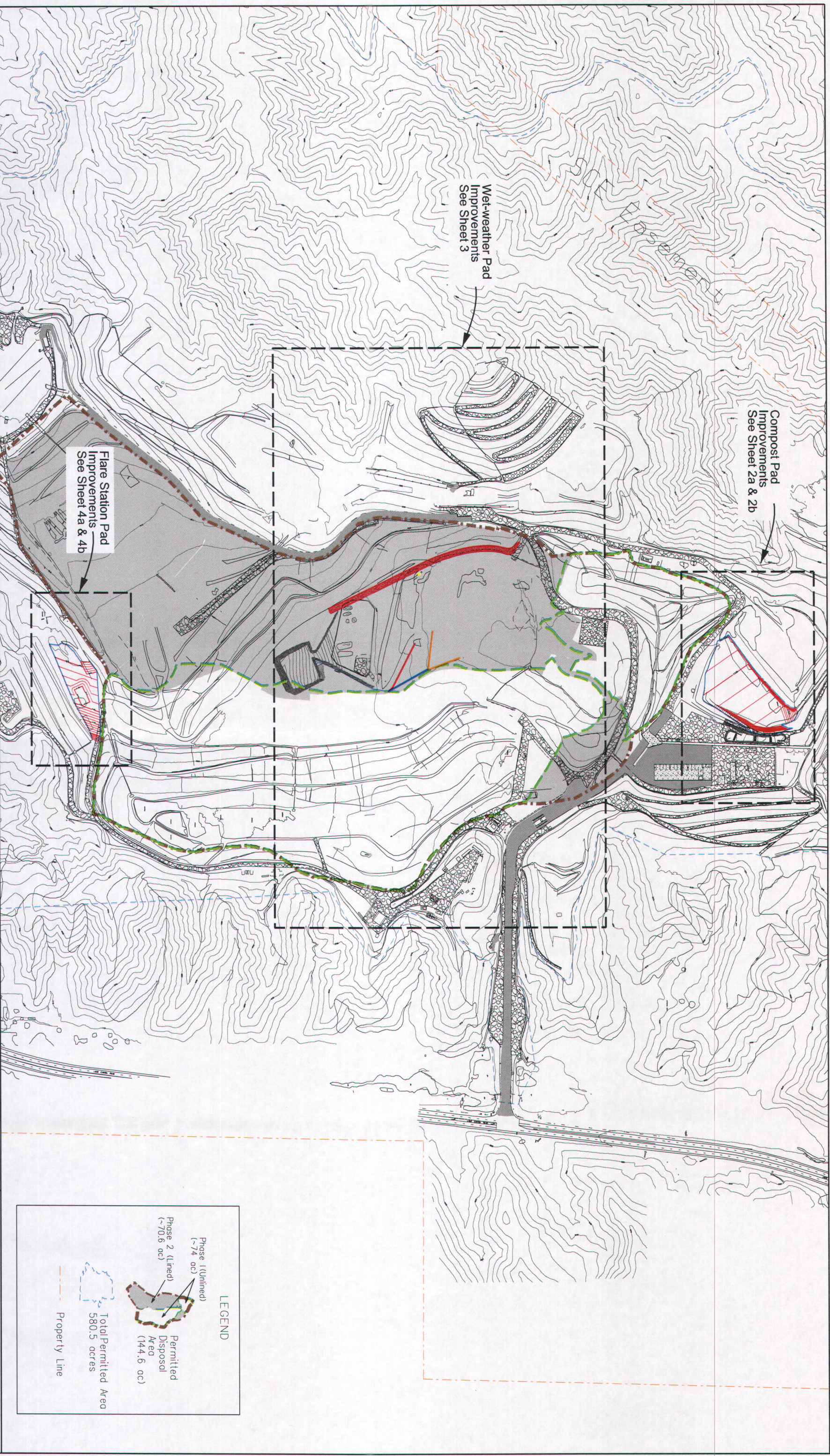

NO.	REVISIONS	BY	APPROVED	DATE

Harris County
DEPARTMENT OF WASTE RESOURCES
 Horia Kernekamp, General Manager/Chief Engineer

Scale: 1" = 500' (1/4" x 7")
 0 250 500 750 1000
 Datum: Is mean sea level

DESIGNED BY:	EC
DRAWN BY:	FM
CHECKED BY:	
DRAWING DATE:	May 2018
TOPOG DATE:	Dec 2016 Aerial & Apr 2018 1000
SCALE:	1" = 500'
PATH:	engineering\shelton\Site F1\1
PATH:	201_Site Improvement\contractchange order
PATH/FILE:	LC DocId 3071 0001_4 Site Map.dwg

LEGEND

- Phase 1 (Unlined) (~74 ac)
- Phase 2 (Lined) (~70.6 ac)
- Permitted Disposal Area (144.6 ac)
- Total Permitted Area 580.5 acres
- Property Line

Lamb Canyon Sanitary Landfill
 Daily Cover Excavation and On-Call Site Improvements
Contract Change Order No.1
Attachment No.1
Site Map
 SHEET 1 OF 6

Legend:

- Grading Limit = 3.7 ac
- Earthwork Quantities
Cut: 25,205 CY
Fill: 335 CY
- 2305 Design Contours
- Earthen Diversion Berm
- 2" HDPE pipe (buried in trench)
- 2" HDPE pipe (above ground)
- Flow Direction
- Cut Depth
- 5' Fill Height
- 5' Pipe Stub Out

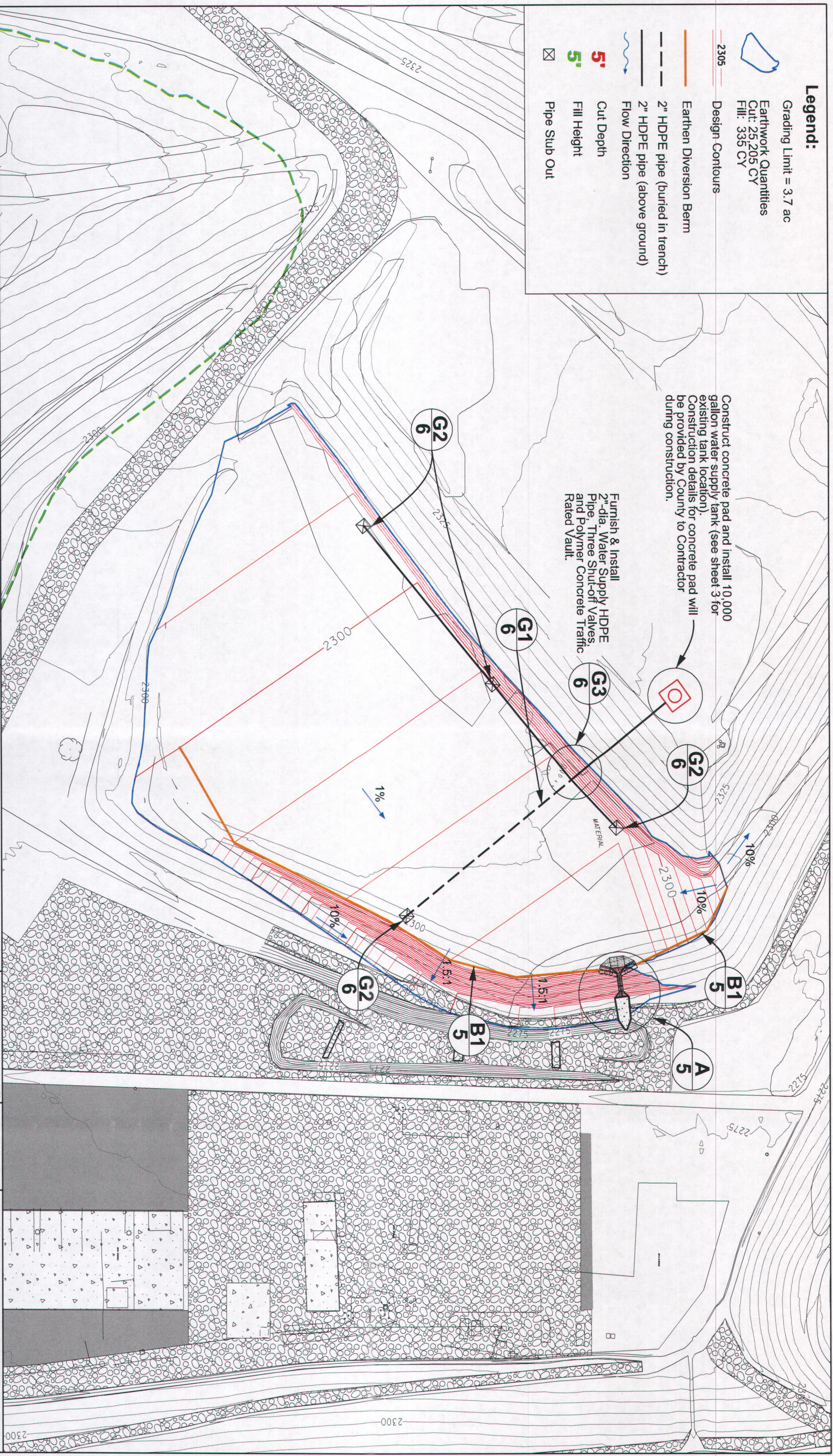

Construct concrete pad and install 10,000 gallon water supply tank (see sheet 3 for existing tank location). Construction details for concrete pad will be provided by County to Contractor during construction.

Furnish & Install 2" dia. Water Supply HDPE Pipe, Three Shut-off Valves, and Polymer Concrete Traffic Rated Vault.

NO.	REVISIONS	BY	APPROVED	DATE



RIVERSIDE COUNTY
DEPARTMENT OF
WASTE RESOURCES
Hans Kernkamp, General Manager / Chief Engineer

DESIGNED BY:	EC
DRAWN BY:	FM
CHECKED BY:	
DRAWING DATE:	May 2008
TOPO DATE:	Dec 2006 April & Apr 2008 1990
SCALE:	1" = 80'
DATE:	
FILE:	LC-DW011-2007-1200-SSA-CompstrValdgr

Lamb Canyon Sanitary Landfill
Daily Cover Excavation and On-Call Site Improvements
Contract Change Order No.1
Attachment No.1
Grading Plan for Composting Facility

Legend:

- Grading Limit = 3.7 ac
- Earthwork Quantities
Cut: 25,205 CY
Fill: 335 CY
- 2305 Design Contours
- Earthen Diversion Berm
- 2" HDPE pipe (buried in trench)
- 2" HDPE pipe (above ground)
- Flow Direction
- Cut Depth
- 5' Fill Height
- 5' Pipe Stub Out

Construct concrete pad and install 10,000 gallon water supply tank (see sheet 3 for existing tank location). Construction details for concrete pad will be provided by County to Contractor during construction.

Furnish & Install
2"-dia. Water Supply HDPE
Pipe, Three Shut-off Valves,
and Polymer Concrete Traffic
Rated Vault.

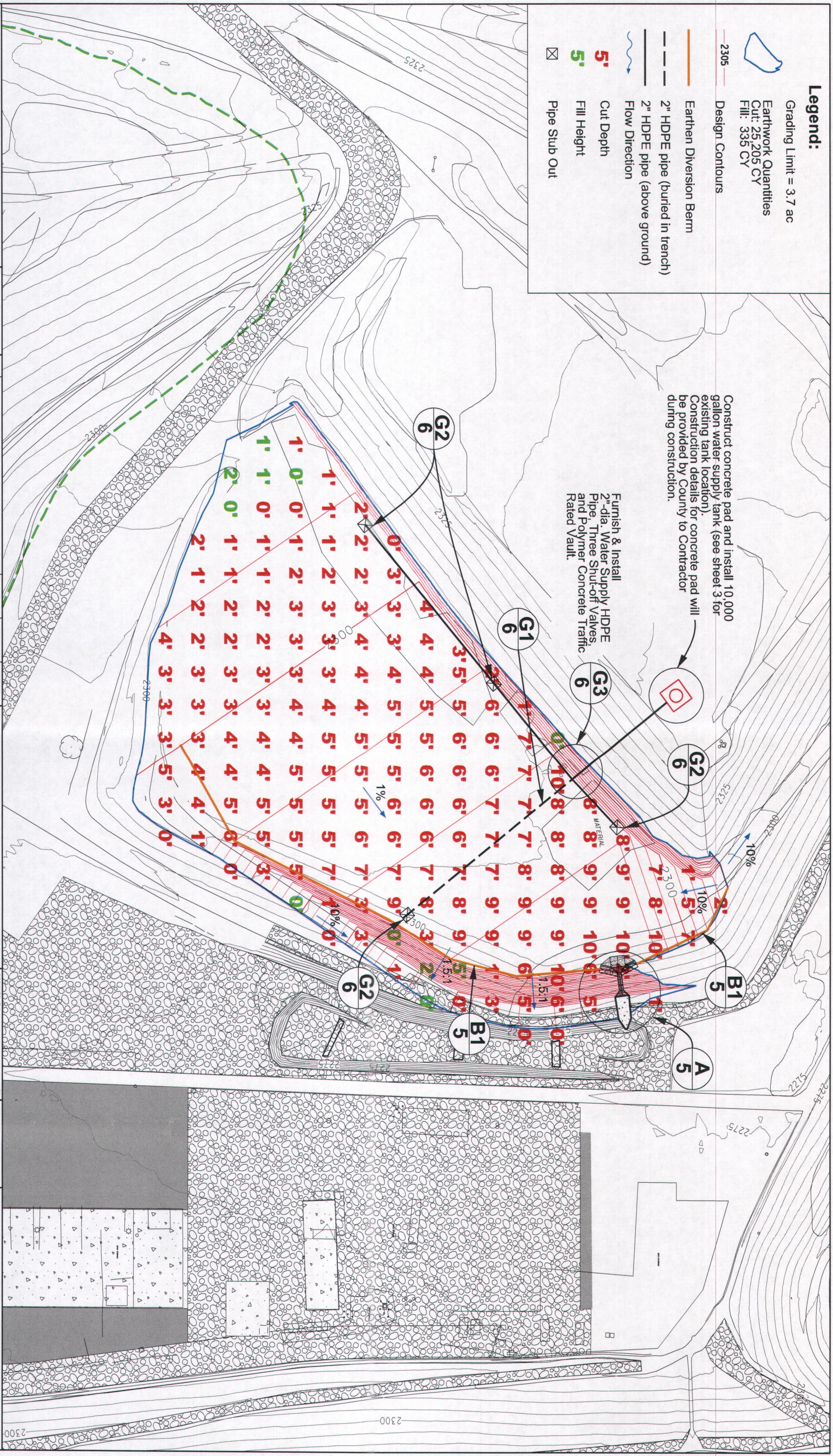

NO.	REVISIONS	BY	APPROVED	DATE

DESIGNED BY: EC
 DRAWN BY: EC
 CHECKED BY: FM
 DRAWING DATE: May 2008
 TPO DATE: Dec 2006, Mar 08 & Apr 2008
 SCALE: 1" = 80'
 PATH: 207 Site Improvements/Attachment No. 1
 FILE: LC:\000\2007_C01_207_CompPost\01.dwg

AMERICAN COUNTY
 DEPARTMENT OF
WASTE RESOURCES
 Hones, Kernkamp, General Manager/Chief Engineer

Lamb Canyon Sanitary Landfill
 Daily Cover Excavation and On-Call Site Improvements
Contract Change Order No.1
Attachment No.1
Grading Plan for Composting Facility

Legend:

- Grading Limit = 2.0 ac.
- Earthwork Quantities
Cut: 6,365 CY
Fill: 3,863 CY
- 2305 — Design Contours
- ~ Flow Direction
- 5' Cut Depth
- 5' Fill Height

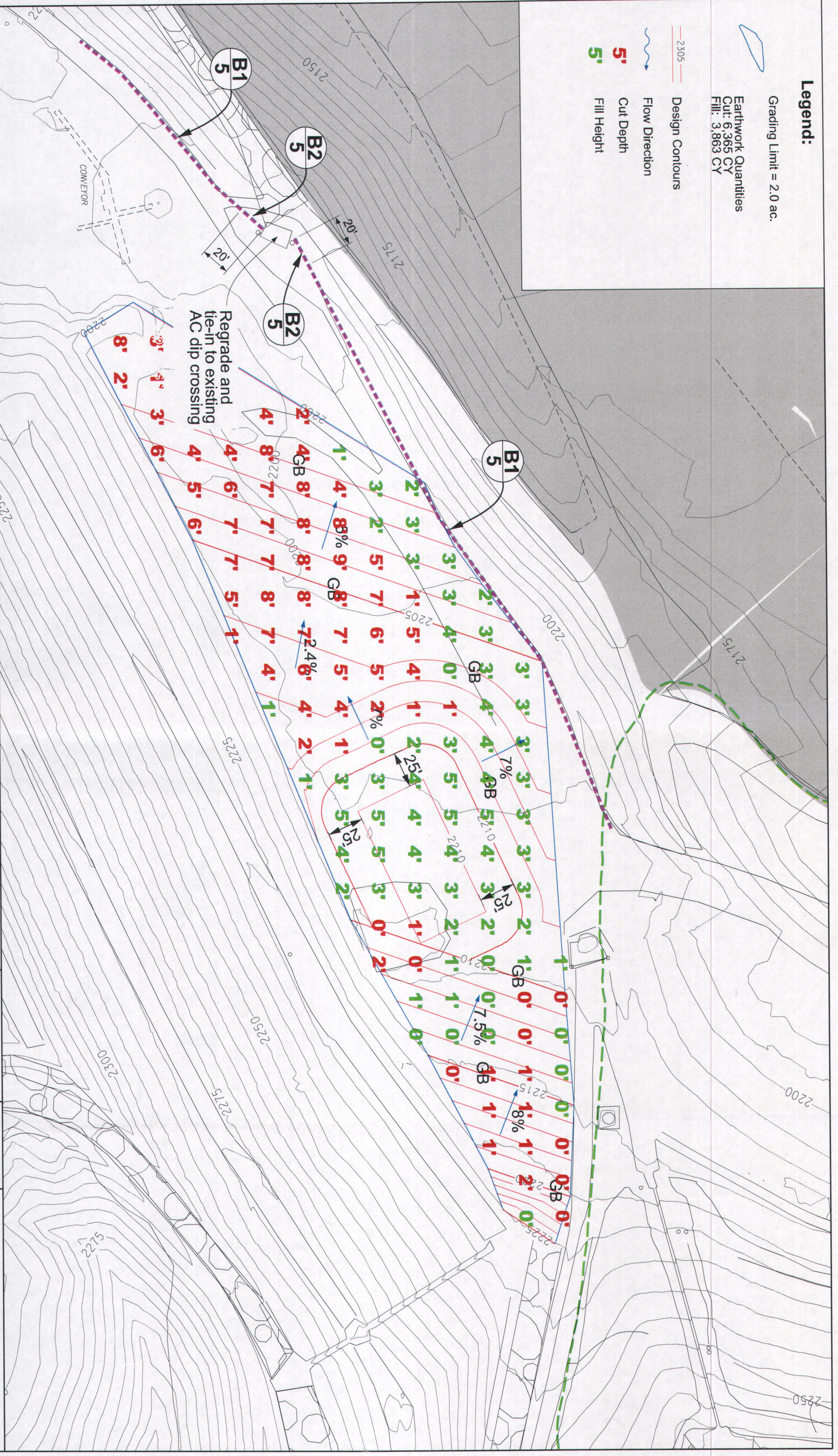

NO.	REVISIONS	BY	APPROVED	DATE



INVESTING COUNTY WASTE RESOURCES
Hans Kernkamp, General Manager / Chief Engineer

Scale: 1" = 60' (1/4" x 17")
Datum is mean sea level

DESIGNED BY:	EC
DRAWN BY:	EC
CHECKED BY:	FI
DRAWING DATE:	May 2018
TORQ DATE:	Dec 2016 Initial
SCALE:	engineer/1/8" = 1 foot/1" = 60'
PATH:	2017 Site Improvement/Stationing/Flare Station Pad
PATH/FILE:	IC:\0001\2017\CC01_04_FlareStationPad.dwg

Lamb Canyon Sanitary Landfill
Daily Cover Excavation and On-Call Site Improvements
Contract Change Order No. 1
Attachment No. 1
Grading Plan for Flare Station Pad

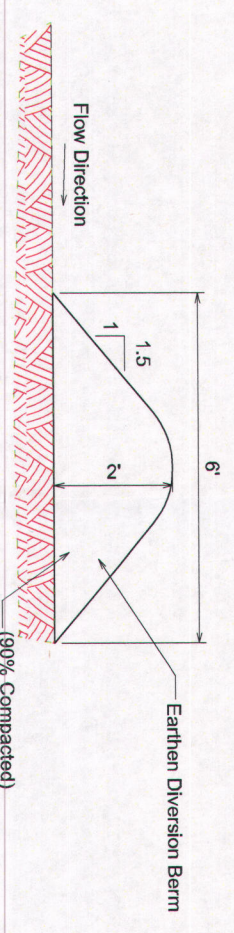
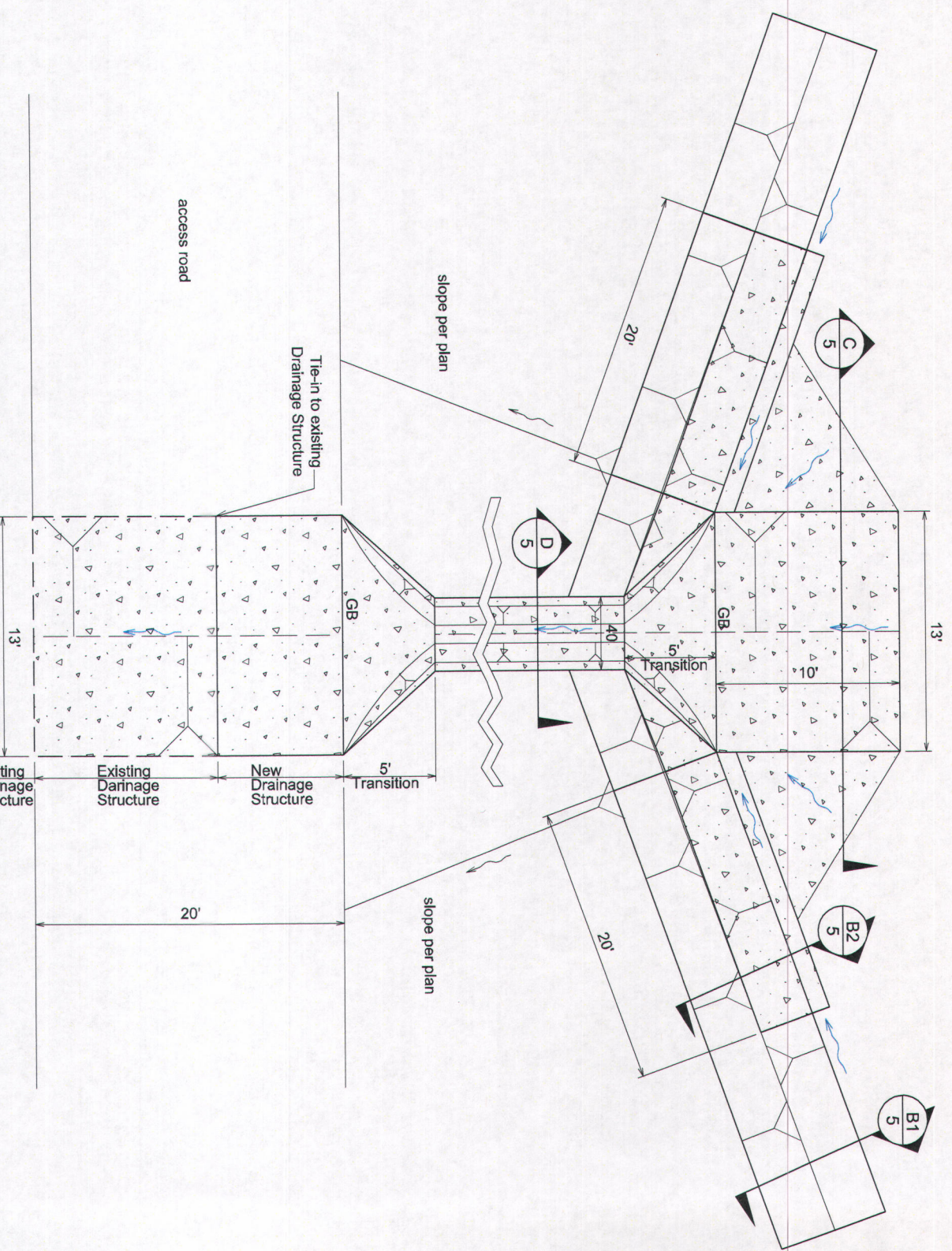

B1 Earthen Diversion Berm Detail
Not To Scale

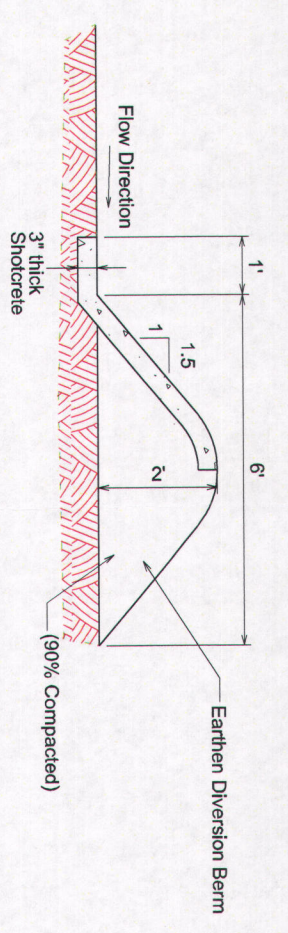

B2 Shotcrete Diversion Berm Detail
Not To Scale

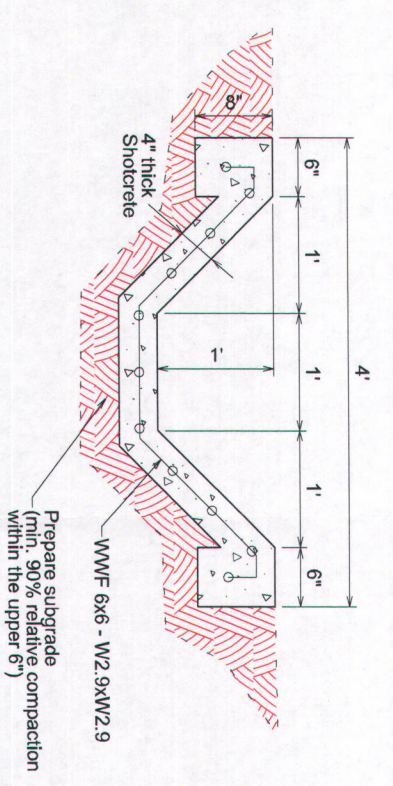

D Shotcrete Channel Detail
Not To Scale

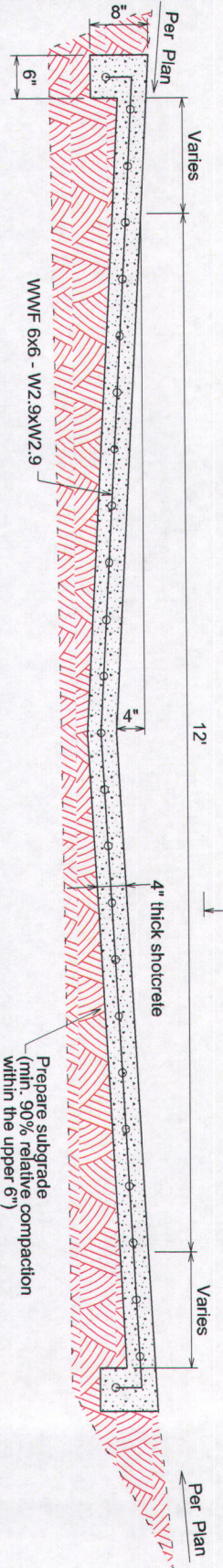

C Shotcrete V-Ditch Crossing Detail
Not To Scale

NO.	REVISIONS	BY	APPROVED	DATE

<p>INVESTOR COUNTY DEPARTMENT OF WASTE RESOURCES</p> <p>Homa Ketrinamp, General Manager/Chief Engineer</p> <p>M/S</p>	DESIGNED BY:	EC
	DRAWN BY:	EC
	CHECKED BY:	FH
	DRAWING DATE:	May 2018
	TOPO DATE:	-
	SCALE:	M/S
	PATH:	engineer\h\sharma\Spec Pr\A
	PATH:	207 Site Improvement\Construction\George ardn
	PATH/FILE:	LC_09011_2017_CD01_55_1amb\150p

<p>Lamb Canyon Sanitary Landfill Daily Cover Excavation and On-Call Site Improvements</p> <p>Contract Change Order No.1 Attachment No.1 Drainage Details</p>	<p>SHEET 5 OF 6</p>
---	---------------------

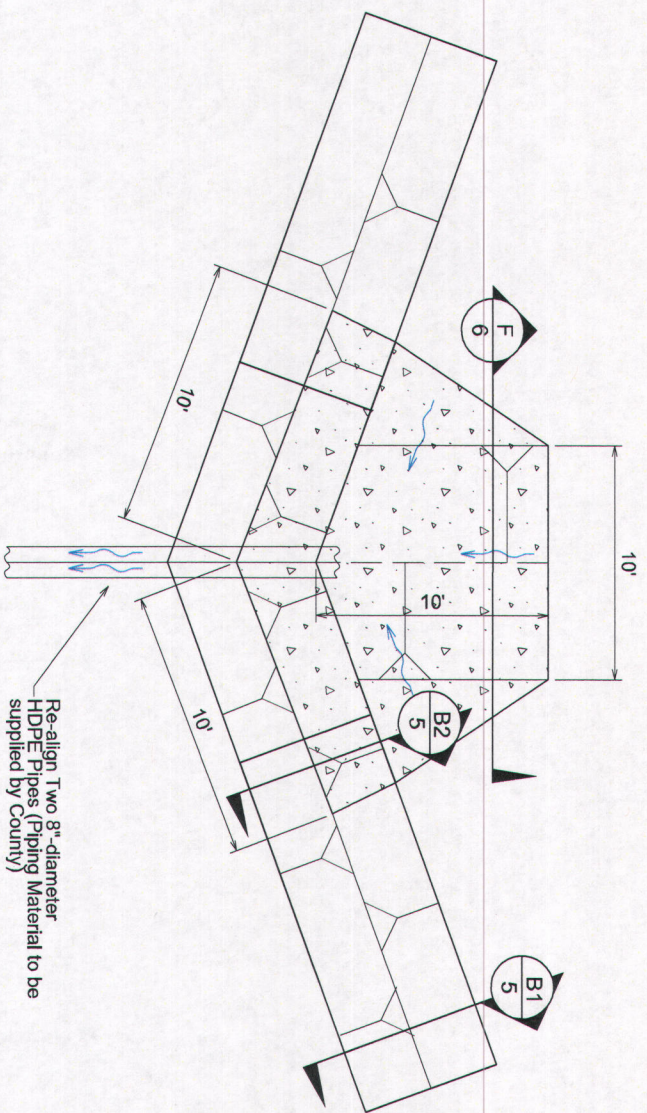

E Shotcrete Pipe Inlet Detail
Not To Scale

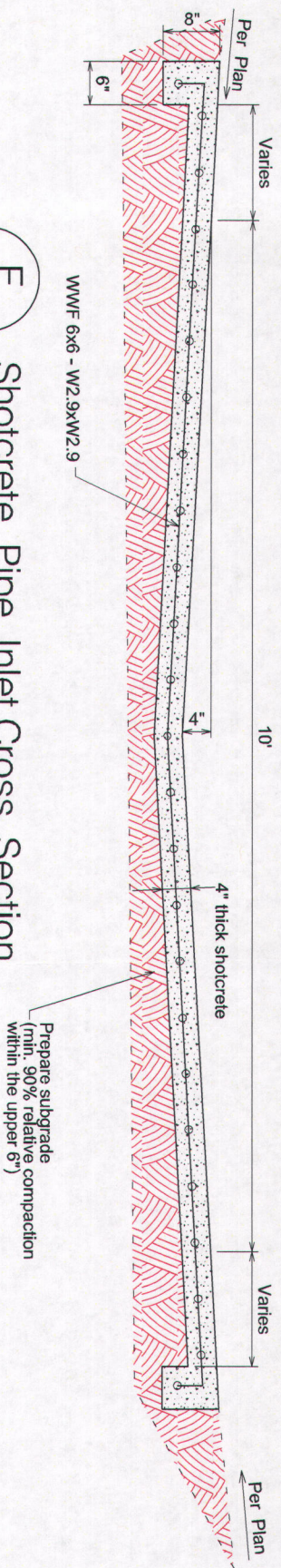

F Shotcrete Pipe Inlet Cross Section
Not To Scale

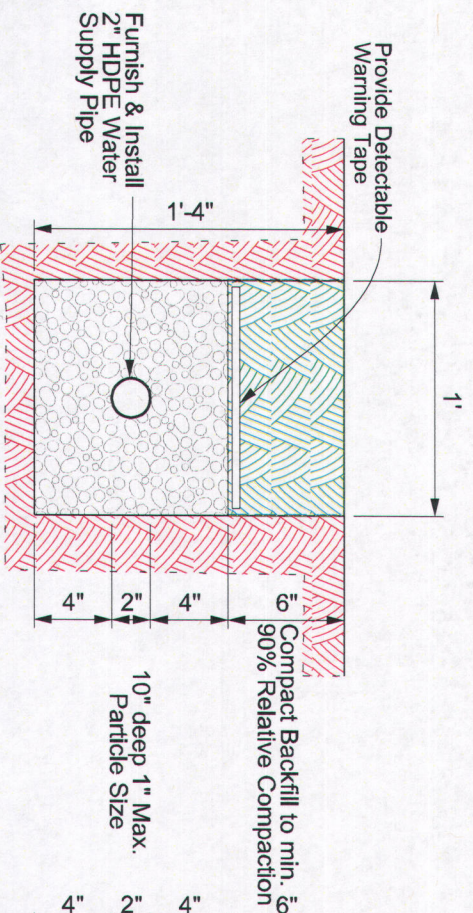

G1 HDPE Pipe Trench Cross Section
Not To Scale

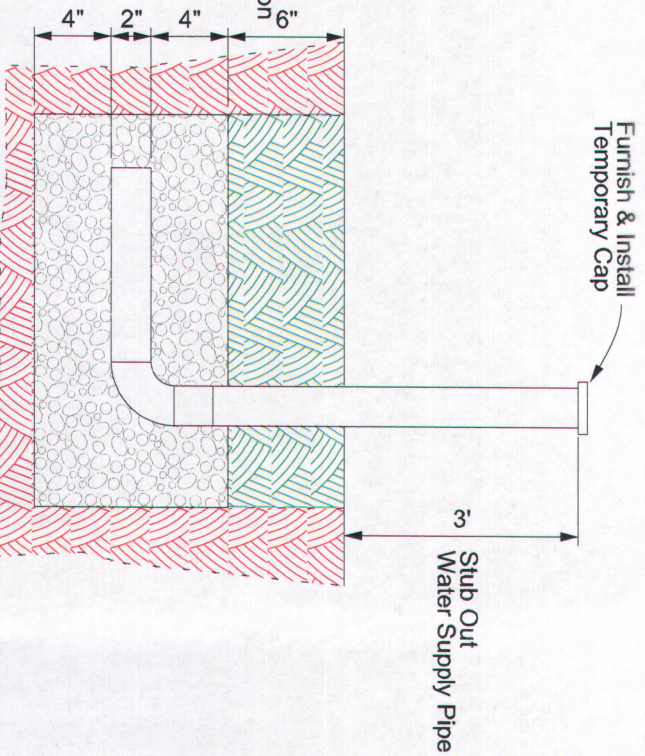

G2 HDPE Pipe Stubout Detail
Not To Scale

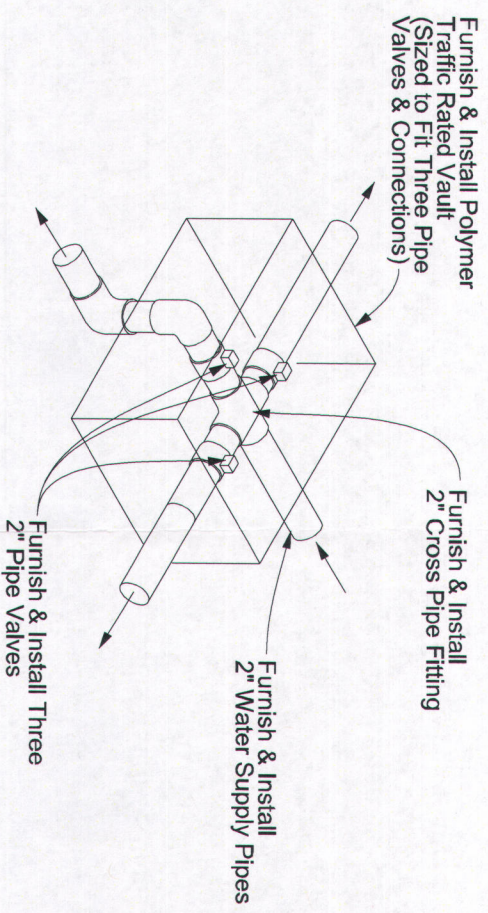

G3 HDPE Pipe Valves Detail
Not To Scale

NO.	REVISIONS	BY	APPROVED	DATE



Horns, Kernkamp, General Manager/Chief Engineer

M/S

DESIGNED BY:	EC
DRAWN BY:	EC
CHECKED BY:	FM
DRAWING DATE:	May 2008
TOPD DATE:	-
SCALE:	N/S
PATH:	engineering\shishun\Spec P7A
PAH/FILE:	LC_OCR01_2007_C001_55_A6_Arch\Islapm

Lamb Canyon Sanitary Landfill
Daily Cover Excavation and On-Call Site Improvements
Contract Change Order No.1
Attachment No.1
Drainage Details