

**SUBMITTAL TO THE BOARD OF SUPERVISORS
COUNTY OF RIVERSIDE, STATE OF CALIFORNIA**



**ITEM
3.59
(ID # 7456)**

MEETING DATE:
Tuesday, July 31, 2018

FROM : TLMA-TRANSPORTATION:

SUBJECT: TRANSPORTATION AND LAND MANAGEMENT AGENCY/TRANSPORTATION:
Introduction of Ordinance No. 452.244 to Establish Speed Zones Enforceable by Radar Speed Detection Equipment in the Desert Edge, French Valley, Hemet, Highgrove, and Mead Valley Areas. 1st, 2nd, 3rd, and 4th Districts;. [\$4,000 - Total Cost]; Gas Tax 100%

RECOMMENDED MOTION: That the Board of Supervisors:

1. Introduce, Read Title, Adopt on Successive Weeks, and Waive Further Reading of Ordinance No. 452.244, Amending Ordinance No. 452 relating to Prima Facie Speed Limits to Establish Various Speed Zones Enforceable by Radar Speed Detection Equipment in the Desert Edge, French Valley, Hemet, Highgrove, and Mead Valley Areas of Riverside County.

ACTION: Policy

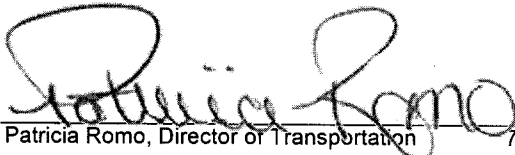
Patricia Romo, Director of Transportation 7/9/2018

MINUTES OF THE BOARD OF SUPERVISORS

On motion of Supervisor Jeffries, seconded by Supervisor Tavaglione and duly carried, IT WAS ORDERED that the above matter is approved as recommended and that the above Ordinance is approved as introduced with a waiver of reading.

Ayes: Jeffries, Tavaglione, Washington and Perez
Nays: None
Absent: Ashley
Date: July 31, 2018
xc: TLMA-Transp., Co.Co., COB

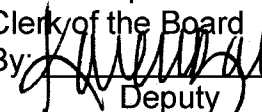
Kecia Harper-Ihem
Clerk of the Board
By: 
Deputy

**SUBMITTAL TO THE BOARD OF SUPERVISORS COUNTY OF RIVERSIDE,
STATE OF CALIFORNIA**

FINANCIAL DATA	Current Fiscal Year:	Next Fiscal Year:	Total Cost:	Ongoing Cost
COST	\$ 4,000	\$ 0	\$ 4,000	\$ 0
NET COUNTY COST	\$ 0	\$ 0	\$ 0	\$ 0
SOURCE OF FUNDS: Gas Tax (100%). There are no General Funds used in this project.			Budget Adjustment: No	
			For Fiscal Year: 18/19	

C.E.O. RECOMMENDATION: Approve

BACKGROUND:

Summary

The County of Riverside Transportation Department conducted Engineering and Traffic Surveys (E&TS) in accordance with California Vehicle Code (CVC), Sections 627 and 40802, for various county-maintained roads in the Desert Edge, French Valley, Hemet, Highgrove, and Mead Valley areas of Riverside County.

Based upon the results of the E&TS for these roads, the Transportation Department recommends the introduction of designated radar-enforceable speed limits along the road segments summarized in the list of Speed Zones, and have determined these speed limits to be appropriate to facilitate the safe and orderly movement of vehicular traffic. The Transportation Department intends to recommend adoption of these designated radar-enforceable speed limits successively at the August 28 Board of Supervisors meeting.

The Transportation Department has contacted and notified the Indio, Riverside, and Temecula area offices of the California Highway Patrol (CHP) regarding the recommended speed zones.

Impact on Residents and Businesses

The establishing and posting of appropriate speed limits promote the safe and orderly movement of vehicular traffic, and enable the CHP to use radar equipment to enforce the posted speed limits. Since the recommended speed limits were determined based on actual speed surveys, the majority of motorists are already driving at or below the recommended speed limits. Posted speed limits also guide motorists to drive at a reasonable speed in unfamiliar locations.

SUPPLEMENTAL:

Additional Fiscal Information

The cost for establishing the recommended speed limits is primarily for the installation of speed limit signs, estimated to be \$4,000.

ATTACHMENTS:

Vicinity Maps

**SUBMITTAL TO THE BOARD OF SUPERVISORS COUNTY OF RIVERSIDE,
STATE OF CALIFORNIA**

List of Speed Zones
Ordinance No. 452.244
Speed Zone Diagrams



Gregory V. Priapros, Director County Counsel 7/20/2018

1
2
3
4
5
6
7
8
9
10
11
12
13
14
15
16
17
18
19
20
21
22
23
24
25
26
27
28

ORDINANCE NO. 452.244

AN ORDINANCE OF THE COUNTY OF RIVERSIDE

AMENDING ORDINANCE NO. 452

RELATING TO PRIMA FACIE SPEED LIMITS

The Board of Supervisors of the County of Riverside ordains as follows:

Section 1. Section 2.2 of Ordinance No. 452, entitled "Thirty miles per hour," is hereby amended to add new subsection 34 to read as follows:

"34. On Rawlings Road between Patrisha Lane and Vista Del Valle, a total distance of approximately 0.60 miles, in the Hemet area."

Section 2. Section 2.4 of Ordinance No. 452, entitled "Forty miles per hour," is hereby amended to add new subsection 153 to read as follows:

"153. On Langlois Road between 18th Avenue and Dillon Road, a total distance of approximately 0.50 miles, in the Desert Edge area."

Section 3. Section 2.5 of Ordinance No. 452, entitled "Forty-five miles per hour," is hereby amended to add new subsections 179, 180, and 181 to read as follows:

"179. On Alexander Street between Cajalco Road and Nandina Avenue, a total distance of approximately 1.98 miles, in the Mead Valley area.

180. On Jean Nicholas Road between Leon Road and State Highway 79/ Winchester Road, a total distance of approximately 0.94 miles, in the French Valley area.

181. On Spring Street between a point 360 feet east of Prospect Avenue and Prairie Drive, a total distance of approximately 1.28 miles, in the Highgrove area."

//
//
//
//

1
2
3
4
5
6
7
8
9
10
11
12
13
14
15
16
17
18
19
20
21
22
23
24
25
26
27
28

Section 4. This ordinance shall take effect 30 days after its adoption.

BOARD OF SUPERVISORS OF THE COUNTY
OF RIVERSIDE, STATE OF CALIFORNIA

BY: _____
Chairman

ATTEST:

KECIA HARPER-IHEM, Clerk of the Board

By: _____
Deputy

(SEAL)

APPROVED AS TO FORM:

July 20, 2018

By: 
WESLEY W. STANFIELD
Deputy County Counsel

LTT:sa

Y:\Traffic\Ord 452 Speed Zones\Ord. 452.244\Ord. 452.244.Docx

ALEXANDER ST (#1808)

- LEGEND:
- ////// CITY LIMITS
 - ▬ RADAR ZONE
 - SURVEY STATION
 - ||| OTHER STREET OR ROAD

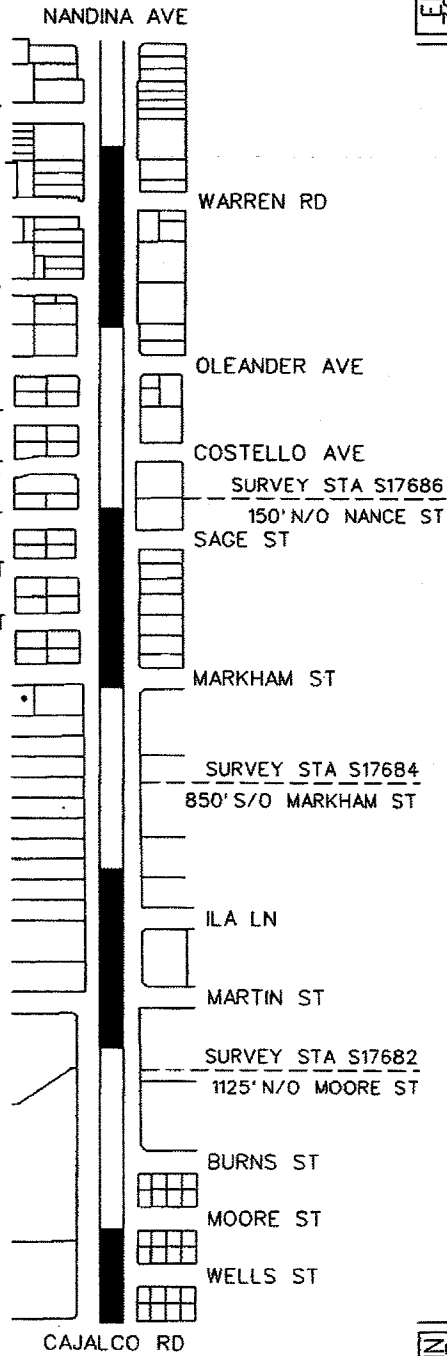

BEGIN ZONE

END ZONE



NO SCALE

RECOMMENDED SPEED LIMIT	45 MPH
85th% TILE SPEED	51.5 MPH (AVERAGE OF FOUR SIMILAR STATIONS OF 54.0, 50.0, 52.0, & 50.0 MPH)
VEHICLES IN 24 HR (2 WAY)	3,500
SEGMENT LENGTH	1.98 MILE
ALL ACCIDENTS IN 2 YRS.	7
ACCIDENT RATE ★	1.38 ACC/MVM
EXISTING SPEED LIMIT	NOT POSTED

RURAL RESIDENTIAL, HIDDEN DRIVEWAYS, NO SIDEWALKS, DIRT SHOULDERS, REDUCE TO 45 MPH.

★ RATE - NO. OF ACCIDENT x 1,000,000
VEH x 365 x 2 x MILE

APPROVED BY: *Lawrence T. Talpe*
DATE: 4/17/2018
LAWRENCE T. TALPE,
COUNTY TRAFFIC ENGINEER

COUNTY OF RIVERSIDE
TRANSPORTATION DEPARTMENT
TRAFFIC ENGINEERING DIVISION
ENGINEERING AND TRAFFIC SURVEY
AT
ALEXANDER ST

SURVEY DATE: SEP 21, 2017
MAP DATE: MAR 30, 2018
DRAWN BY: R LAREZ
CAD FILE: ALEXANDER ST.DGN

COUNTY AREA: MEAD VALLEY
COUNTY MAP: 55,58A
SUPERVISOR DISTRICT: 1/1

JEAN NICHOLAS RD (#1810)

- LEGEND:**
- ////// CITY LIMITS
 - ▬ RADAR ZONE
 - - - SURVEY STATION
 - ▬ OTHER STREET OR ROAD

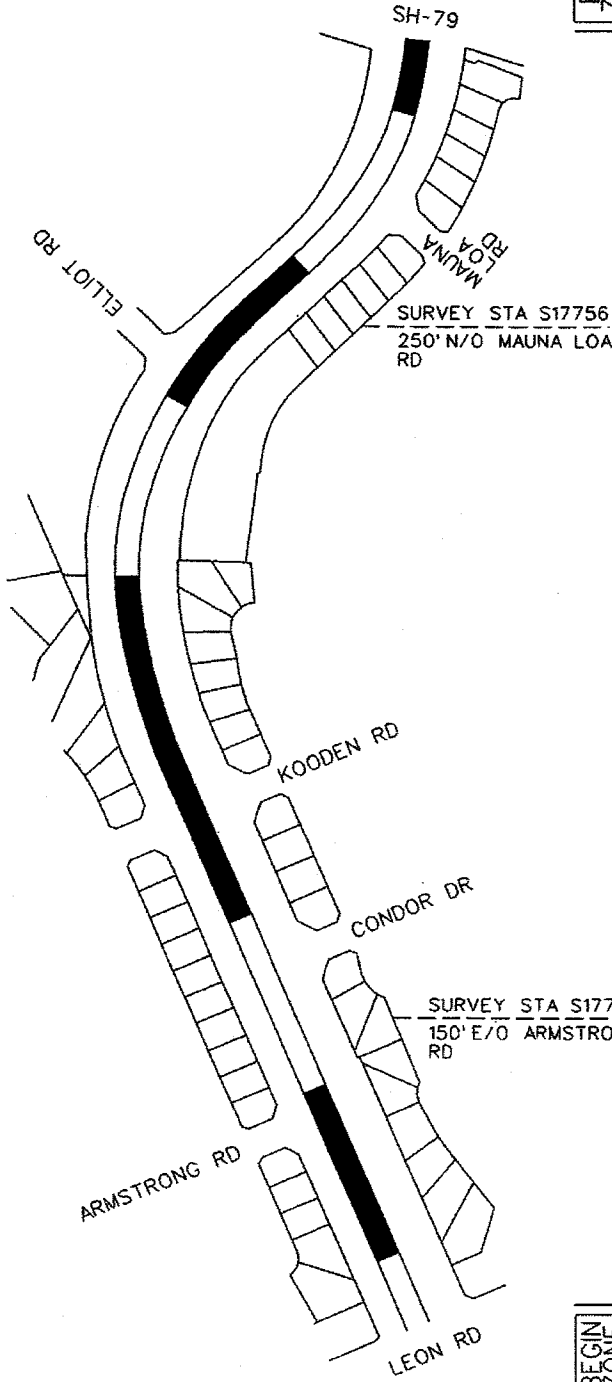

BEGIN ZONE

END ZONE

RECOMMENDED SPEED LIMIT	45 MPH
85th/75th TILE SPEED	46.5 MPH (AVERAGE OF TWO SIMILAR STATIONS OF 48.0 & 45.0 MPH)
VEHICLES IN 24 HR (2 WAY)	5,700
SEGMENT LENGTH	0.94 MILE
ALL ACCIDENTS IN 2 YRS.	0
ACCIDENT RATE ☆	0.00 ACC/MVM
EXISTING SPEED LIMIT	NOT POSTED

☆ RATE: NO. OF ACCIDENT x 1,000,000
VEH x 365 x 2 x MILE

APPROVED BY: *Lawrence T. Taipe*
DATE: 4/18/2018
LAWRENCE T. TAIPE,
COUNTY TRAFFIC ENGINEER

SURVEY DATE: DEC 13, 2017
MAP DATE: APR 4, 2018
DRAWN BY: R LAREZ
CAD FILE: JEAN NICHOLAS.DGN

COUNTY AREA: FRENCH VALLEY
COUNTY MAP: 121E
SUPERVISOR DISTRICT: 3/3

COUNTY OF RIVERSIDE
TRANSPORTATION DEPARTMENT
TRAFFIC ENGINEERING DIVISION
ENGINEERING AND TRAFFIC SURVEY
AT
STREET NAME
PAGE 1 OF 1

LANGLOIS RD (#1806)

- LEGEND:
- ////// CITY LIMITS
 - ▬ RADAR ZONE
 - - - SURVEY STATION
 - ==== OTHER STREET OR ROAD

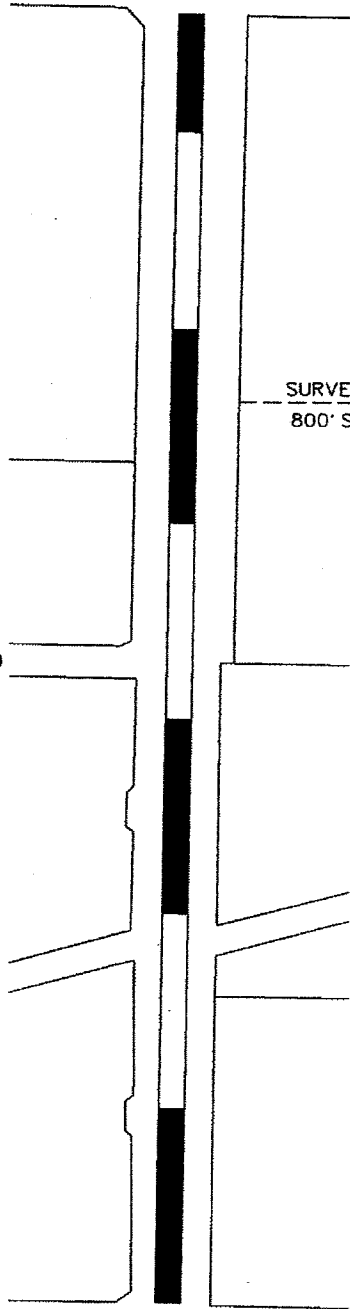

18TH AVE

DILLON RD

SURVEY STA S18540
800' S/O DILLON RD



NO SCALE

BEGIN ZONE

END ZONE

RECOMMENDED SPEED LIMIT	40 MPH
85th/TILE SPEED	42.0 MPH
VEHICLES IN 24 HR (2 WAY)	1,700
SEGMENT LENGTH	0.50 MILE
ALL ACCIDENTS IN 2 YRS.	0
ACCIDENT RATE ☆	0.00 ACC/MVM
EXISTING SPEED LIMIT	NOT POSTED

☆ RATE = NO. OF ACCIDENT x 1,000,000
VEH x 365 x 2 x MILE

APPROVED BY:

Lawrence T. Tai, P.E.
DATE: 4/24/2018

LAWRENCE T. TAI, P.E.
COUNTY TRAFFIC ENGINEER

SURVEY DATE:	FEB 21, 2018
MAP DATE:	MAR 26, 2018
DRAWN BY:	R LAREZ
CAD FILE:	LANGLOIS RD.DGN

COUNTY AREA:	DESERT EDGE
COUNTY MAP:	174
SUPERVISOR DISTRICT:	4/4

COUNTY OF RIVERSIDE
TRANSPORTATION DEPARTMENT
TRAFFIC ENGINEERING DIVISION



ENGINEERING AND TRAFFIC SURVEY
AT

LANGLOIS RD

RAWLINGS ROAD (#1800)

SURVEY STA S18520
2800' S/O VISTA DEL VALLE

SURVEY STA S18516
600' S/O VISTA DEL VALLE

MESA GRANDE
DR

SURVEY STA S18518
1200' S/O VISTA
DEL VALLE

PATRISHA LN

VISTA DEL VALLE

- LEGEND:
- ////// CITY LIMITS
 - ▬ RADAR ZONE
 - - - SURVEY STATION
 - ▬ OTHER STREET OR ROAD

BEGIN
ZONE



NO SCALE

END
ZONE

RECOMMENDED SPEED LIMIT	30 MPH
85th/7ILE SPEED	32.66 MPH (AVERAGE OF THREE SIMILAR STATIONS OF 36, 26 & 36 MPH)
VEHICLES IN 24 HR (2 WAY)	500
SEGMENT LENGTH	0.60 MILE
ALL ACCIDENTS IN 2 YRS.	1
ACCIDENT RATE ☆	4.57 ACC/MVM
EXISTING SPEED LIMIT	NOT POSTED

☆ RATE = $\frac{\text{NO. OF ACCIDENT} \times 1000}{\text{VEH} \times 365 \times 2 \times \text{MILE}}$

APPROVED BY:

Lawrence T. Tai, P.E.
DATE: 3/14/2018

LAWRENCE T. TAI, P.E.
COUNTY TRAFFIC ENGINEER

SURVEY DATE: JAN 23, 2018
MAP DATE: MAR 06, 2018
DRAWN BY: J VALADEZ
CAD FILE: VISTA DEL.DGN

COUNTY AREA: HEMET
COUNTY MAP: 116B
SUPERVISOR DISTRICT: 3/3

COUNTY OF RIVERSIDE
TRANSPORTATION DEPARTMENT
TRAFFIC ENGINEERING DIVISION

ENGINEERING AND TRAFFIC SURVEY
AT

RAWLINGS ROAD



SPRING ST (#1802)

- LEGEND:
- CITY LIMITS
 - RADAR ZONE
 - SURVEY STATION
 - OTHER STREET OR ROAD
 - RESIDENTIAL ZONE
 - SCHOOL
 - CENTERLINE

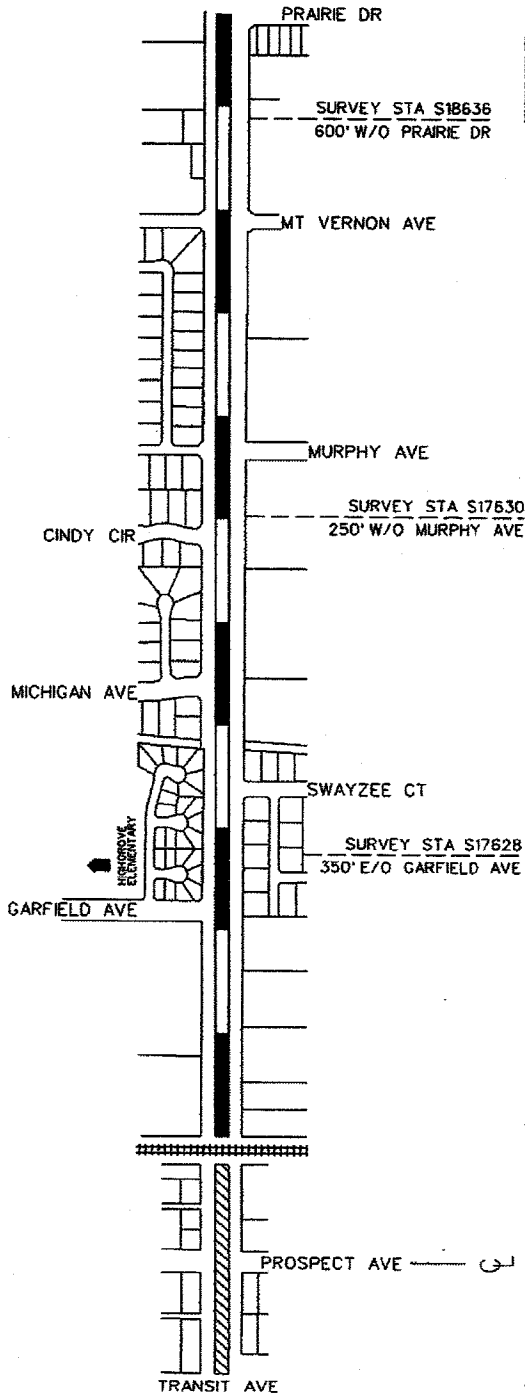

BEGIN ZONE

END ZONE



NO SCALE

RECOMMENDED SPEED LIMIT	*25 MPH	45 MPH
85th/TILE SPEED		48.23 MPH (AVERAGE OF THREE SIMILAR STATIONS OF 51.0 & 52.0 & 41.7 MPH)
VEHICLES IN 24 HR (2 WAY)		1150
SEGMENT LENGTH		1.28 MILE
ALL ACCIDENTS IN 2 YRS.		1
ACCIDENT RATE ☆		0.93 ACC/MVM
EXISTING SPEED LIMIT	*PER CVC 515	NOT POSTED

☆ RATE: NO. OF ACCIDENT x 1,000,000
VEH x 365 x 2 x MILE

APPROVED BY:

Lawrence T. Tai
DATE: 6/13/2018

LAWRENCE T. TAI, P.E.
COUNTY TRAFFIC ENGINEER

SURVEY DATE:	MAY 25 2017
MAP DATE:	MAR 20 2018
DRAWN BY:	R LAREZ
CAD FILE:	SPRING ST.DGN

COUNTY AREA:	HIGHGROVE
COUNTY MAP:	44B
SUPERVISOR DISTRICT:	5/2

COUNTY OF RIVERSIDE
TRANSPORTATION DEPARTMENT
TRAFFIC ENGINEERING DIVISION

ENGINEERING AND TRAFFIC SURVEY
AT

SPRING ST



PAGE 1 OF 1

**LIST OF SPEED ZONE SUBMITTALS
ORDINANCE AMENDMENT NO 452.244
SUPERVISORIAL DISTRICT NO. 1**

AREA	ROAD NAME/ LIMITS	EXISTING SPEED LIMIT	PROPOSED SPEED LIMIT	ACTION
MEAD VALLEY	ALEXANDER STREET Between Cajalco Rd and Nandina Ave	Not Posted*	45	NEW SPEED ZONE

- * Maximum allowable speed limit for a two-lane highway is 55 mph
- **Maximum allowable speed limit for a multi-lane highway is 65 mph
- ***Change in speed zone boundary

**LIST OF SPEED ZONE SUBMITTALS
ORDINANCE AMENDMENT NO 452.244
SUPERVISORIAL DISTRICT NO. 2**

AREA	ROAD NAME/ LIMITS	EXISTING SPEED LIMIT	PROPOSED SPEED LIMIT	NOTES
HIGHGROVE	SPRING STREET Between 360' E/O Prospect Ave and Prairie Dr	Not Posted*	45	NEW SPEED ZONE

- * Maximum allowable speed limit for a two-lane highway is 55 mph
- **Maximum allowable speed limit for a multi-lane highway is 65 mph
- ***Change in speed zone boundary

**LIST OF SPEED ZONE SUBMITTALS
ORDINANCE AMENDMENT NO 452.244
SUPERVISORIAL DISTRICT NO. 3**

AREA	ROAD NAME/ LIMITS	EXISTING SPEED LIMIT	PROPOSED SPEED LIMIT	NOTES
FRENCH VALLEY	JEAN NICHOLAS ROAD Between Leon Rd and SH-79	Not Posted*	45	NEW SPEED ZONE
HEMET	RAWLINGS ROAD Between Patrisha Ln and Vista Del Valle	Not Posted*	30	NEW SPEED ZONE

* Maximum allowable speed limit for a two-lane highway is 55 mph
 **Maximum allowable speed limit for a multi-lane highway is 65 mph
 ***Change in speed zone boundary

**LIST OF SPEED ZONE SUBMITTALS
ORDINANCE AMENDMENT NO 452.244
SUPERVISORIAL DISTRICT NO. 4**

AREA	ROAD NAME/ LIMITS	EXISTING SPEED LIMIT	PROPOSED SPEED LIMIT	NEW SPEED ZONE
DESERT EDGE	LANGLOIS ROAD Between 18 th Ave and Dillon Rd	Not Posted*	40	NEW SPEED ZONE

- * Maximum allowable speed limit for a two-lane highway is 55 mph
- **Maximum allowable speed limit for a multi-lane highway is 65 mph
- ***Change in speed zone boundary

ORDINANCE 452.244 DISTRICT 1 SPEED ZONE VICINITY MAP

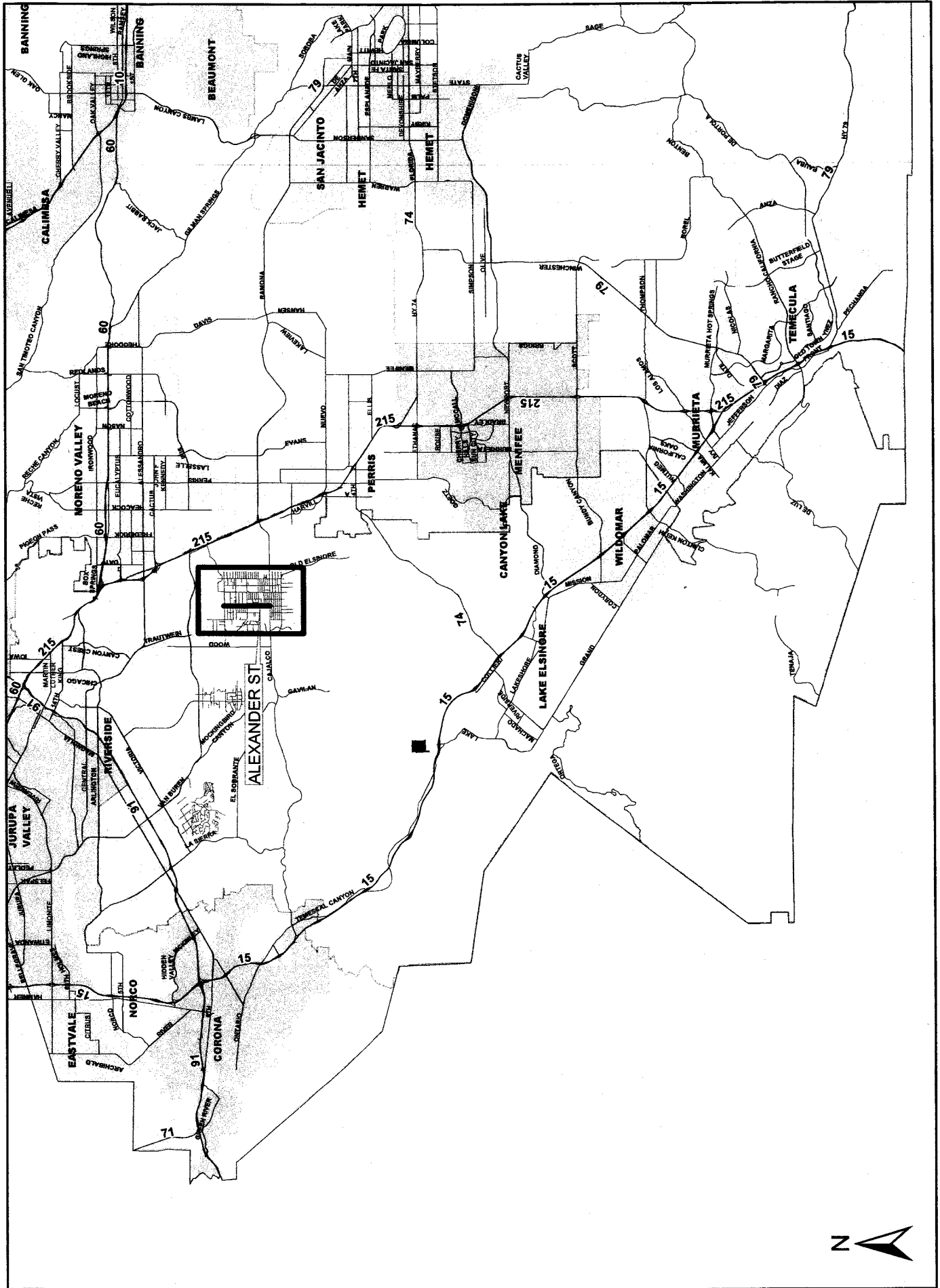

ORDINANCE 452.244 DISTRICT 2 SPEED ZONE VICINITY MAP

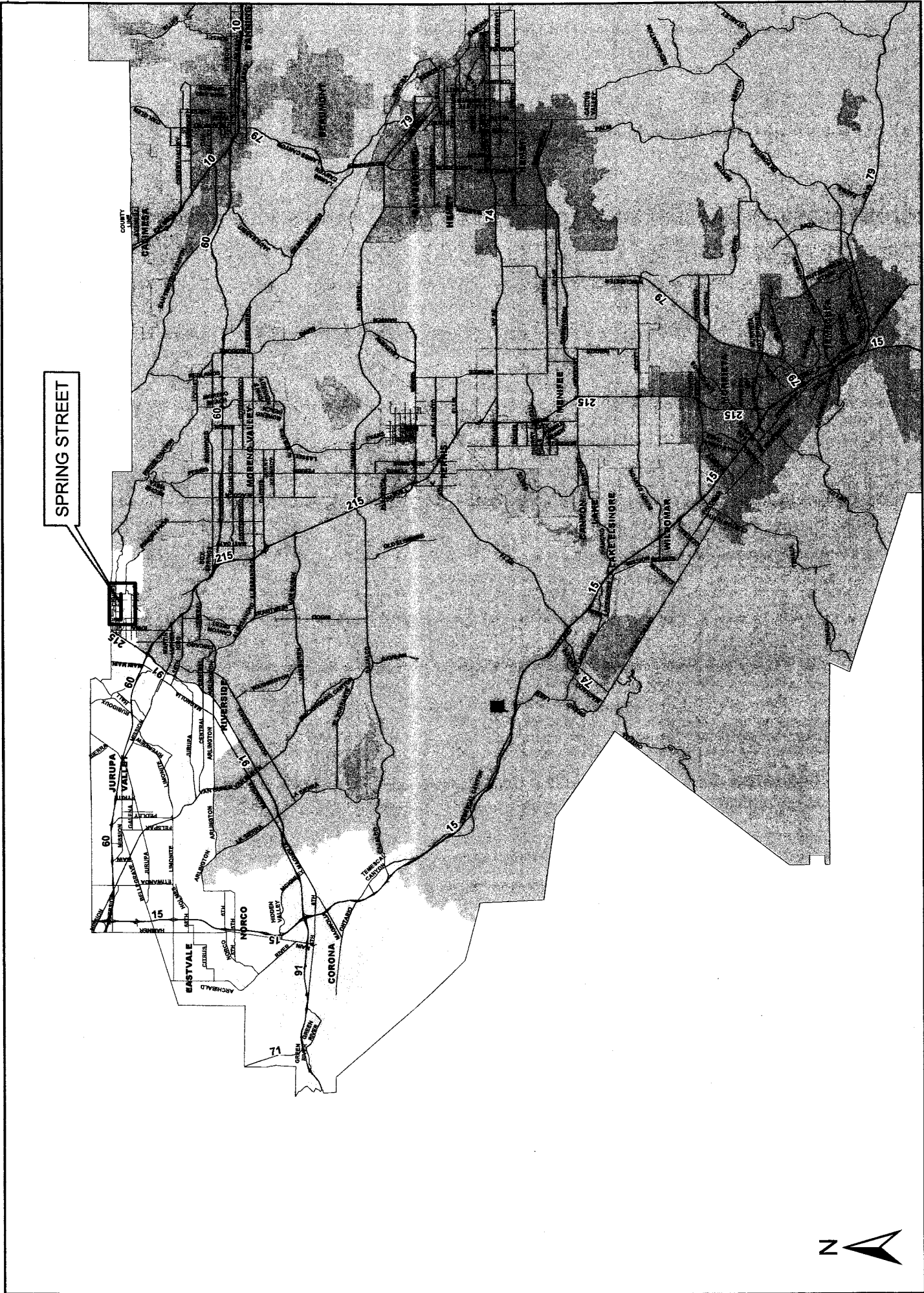

ORDINANCE 452.244 DISTRICT 3 SPEED ZONE VICINITY MAP

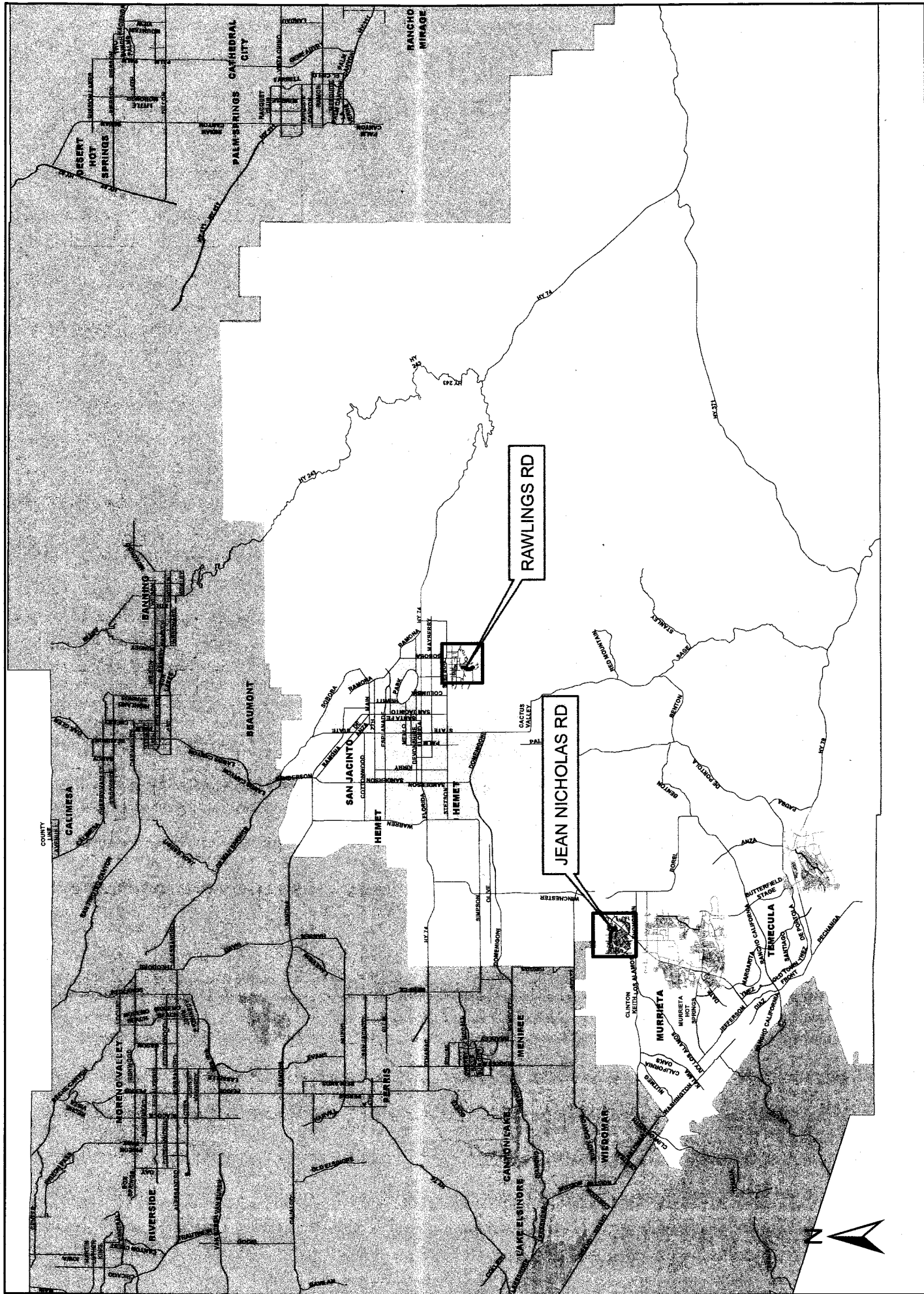

ORDINANCE 452.244 DISTRICT 4 SPEED ZONE VICINITY MAP

