

**SUBMITTAL TO THE BOARD OF SUPERVISORS
COUNTY OF RIVERSIDE, STATE OF CALIFORNIA**



ITEM
3.29
(ID # 8031)

MEETING DATE:

Tuesday, November 6, 2018

FROM : TLMA-TRANSPORTATION:

SUBJECT: TRANSPORTATION AND LAND MANAGEMENT AGENCY/TRANSPORTATION:

Approve the Thermal Area, Hemet Area Anza Area and Mead Valley Area Force Account Construction Project. 1st, 3rd and 4th Districts; [\$3,832,000 - State Funds 68% Local Funds 32%]

RECOMMENDED MOTION: That the Board of Supervisors:

1. Approve the Director of Transportation and Land Management, or his designee, to conduct force account work in the Thermal Area, Hemet Area, Anza Area and Mead Valley Area utilizing the Transportation Department's in-house construction crews as set forth in Attachment A-1 hereto.

ACTION:

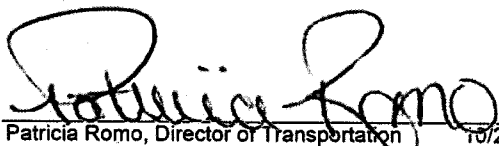

Patricia Romo, Director of Transportation 10/23/2018

MINUTES OF THE BOARD OF SUPERVISORS

On motion of Supervisor Jeffries, seconded by Supervisor Perez and duly carried by unanimous vote, IT WAS ORDERED that the above matter is approved as recommended.

Ayes: Jeffries, Tavaglione, Washington, Perez and Ashley
Nays: None
Absent: None
Date: November 6, 2018
xc: Transp.

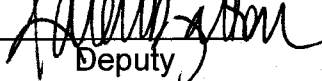
Kecia Harper-Ihem
Clerk of the Board

By: 
Deputy

**SUBMITTAL TO THE BOARD OF SUPERVISORS COUNTY OF RIVERSIDE,
STATE OF CALIFORNIA**

FINANCIAL DATA	Current Fiscal Year:	Next Fiscal Year:	Total Cost:	Ongoing Cost
COST	\$ 3,832,000	\$ 0	\$ 3,832,000	\$ 0
NET COUNTY COST	\$ 0	\$ 0	\$ 0	\$ 0
SOURCE OF FUNDS: Gas Tax/HUTA (68%), Measure A/Coachella Valley (32%) There are no General Funds used in this project.			Budget Adjustment:	No
			For Fiscal Year:	18/19

C.E.O. RECOMMENDATION: Approve

BACKGROUND:

Summary

The County Transportation Department (Transportation Department) is planning on overlaying or reconstructing several existing paved roads in the Thermal Area, Hemet Area, Anza area and Mead Valley area using the department's in-house construction crews.

This work can be efficiently and cost effectively completed using Transportation Department crews, compared to the traditional bidding process. It should be noted that the Transportation Department contracts out the vast majority of its construction work to private contractors (over 90% last year).

Certain projects that are less complex and of a maintenance nature can be more efficiently and quickly accomplished using Department road crews, due to the time and cost savings realized through not having to generate engineered plans and contract specifications, surveying, and inspection costs.

The following roads will be paved in the Thermal area (4th District):

<u>Name</u>	<u>From</u>	<u>To</u>
66 th Ave	Grant St	Hayes St
70 th Ave	Harrison St	5,037' W/O Harrison St
Calhoun St	54 th Ave	630' S/O 52 nd Ave
Polk St	76 th Ave	70 th Ave
59 th Ave	Polk St	Fillmore St
Wheeler St	70 th Ave	68 th Ave

The following roads will be paved in the Hemet area (3rd District):

<u>Name</u>	<u>From</u>	<u>To</u>
Barnhill Road	Pleasant St	500' E/O Pleasant St
Old Agency Road	Whittier Ave	550' N/O Whittier Ave
Partridge Ranch Road	Pleasant St	425' E/O Pleasant St

**SUBMITTAL TO THE BOARD OF SUPERVISORS COUNTY OF RIVERSIDE,
STATE OF CALIFORNIA**

Pleasant St

Whittier Ave

Mayberry Ave

The following road will be paved in the Anza area (3rd District):

<u>Name</u>	<u>From</u>	<u>To</u>
Hernley Road* Road	Tule Valley Road	2,640' E/O Tule Valley

The following road will be paved in the Mead Valley area (1st District):

<u>Name</u>	<u>From</u>	<u>To</u>
Brown St	Oleander St	1,065' N/O Oleander St

*New Construction

Assembly Bill 720 (AB720) sets forth modified requirements by which new road construction and road reconstruction can be performed by employees of a public agency. Under AB720, an agency may elect to utilize public employees to perform force account work, provided this work does not exceed 30% of the total value of all work performed by force account other than maintenance, as reported in the State Controller's Streets and Roads Annual Report as of January 1 of each year. The intent to use this authority must be declared prior to commencing the work.

The proposed projects with their associated construction budgets are listed in Attachment A-1. The total cost of the work is \$3,832,000.

Impact on Residents and Businesses

The proposed projects will reduce dust and erosion, and improve access to local residents.

Additional Fiscal Information

The Thermal area paving will be funded by Gas Tax/HUTA funds (\$1,685,000) and Measure A/Coachella Valley funds (\$1,229,000).

The Hemet area paving will be funded by Gas Tax/HUTA funds (\$433,000).

The Anza area paving will be funded by Gas Tax/HUTA funds (\$252,000).

The Mead Valley area paving will be funded by Gas Tax/HUTA funds (\$233,000)

ATTACHMENTS:

Vicinity Maps

SUBMITTAL TO THE BOARD OF SUPERVISORS COUNTY OF RIVERSIDE,
STATE OF CALIFORNIA

Attachment A-1

Scott Bruekner 10/29/2018

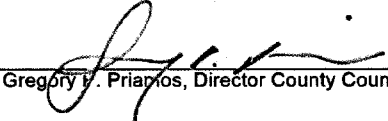
Gregory V. Priamos, Director County Counsel 10/25/2018

ATTACHMENT A -1

I. Thermal Area

Project No.	Road Name	From	To	Construction Cost (\$)
ZC80034	66TH AVE	Grant St	Hayes St	473,000
ZC90013	70TH AVE	Harrison St	5,037' W/O Harrison St	227,000
ZC90012	CALHOUN ST	54th Ave	630' S/O 52nd Ave	544,000
ZC90014	POLK ST	76th Ave	70th Ave	650,000
TBD	59TH AVE	POLK ST	FILLMORE ST	600,000
TBD	WHEELER ST	70TH AVE	68TH AVE	420,000

Subtotal 2,914,000

II. Hemet Area

Project No.	Road Name	From	To	Construction Cost (\$)
ZC50028	BARNHILL ROAD	Pleasant St	500' E/O Pleasant St	53,000
ZC50029	OLD AGENCY ROAD	Whittier Ave	550' N/O Whittier Ave	93,000
ZC50030	PARTRIDGE RANCH ROAD	Pleasant St	425' E/O Pleasant St	93,000
ZC50031	PLEASANT ST	Whittier Ave	Mayberry Ave	194,000

Subtotal 433,000

III. Anza Area

Project No.	Road Name	From	To	Construction Cost (\$)
ZC90011	HERNLEY ROAD	Tule Valley Road	2,640' E/O Tule Valley Road	252,000

Subtotal 252,000

IV. Mead Valley Area

Project No.	Road Name	From	To	Construction Cost (\$)
ZC80011	BROWN ST	Oleander St	1,065' N/O Oleander ST	233,000

Subtotal 233,000

Total 3,832,000

COUNTY OF RIVERSIDE TRANSPORTATION DEPARTMENT

MEAD VALLEY AREA RECONSTRUCTION PROJECT

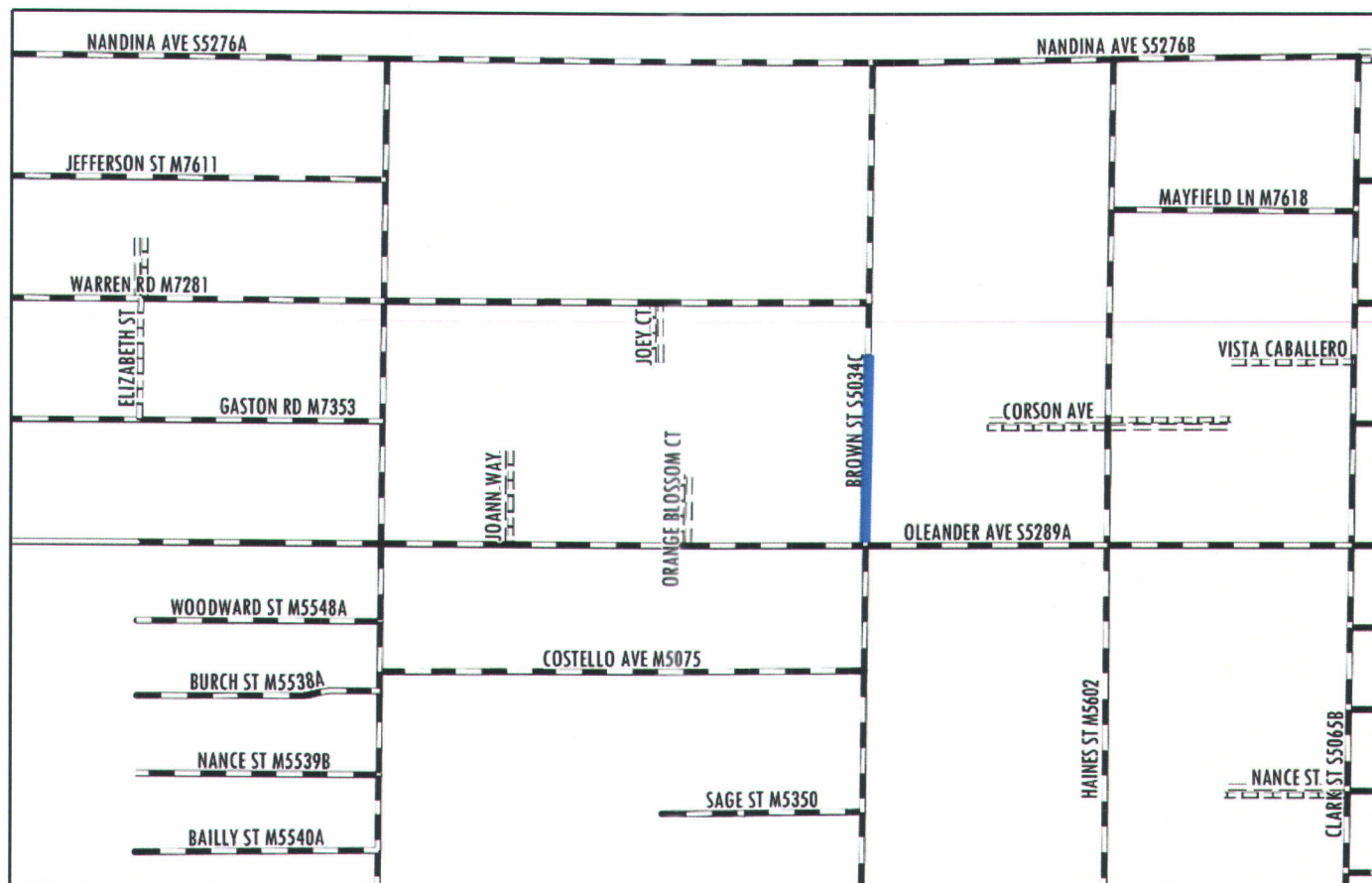
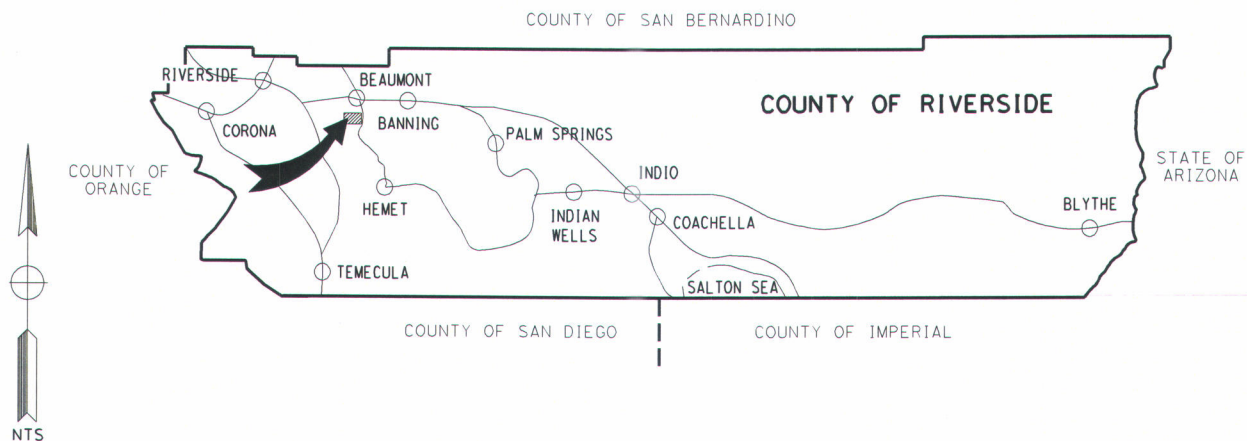

TOWNSHIP 3S RANGE 4W
COUNTY ROADBOOK PAGE No. 55

VICINITY MAP

COUNTY OF RIVERSIDE
TRANSPORTATION DEPARTMENT

THERMAL AREA
RECONSTRUCTION PROJECT

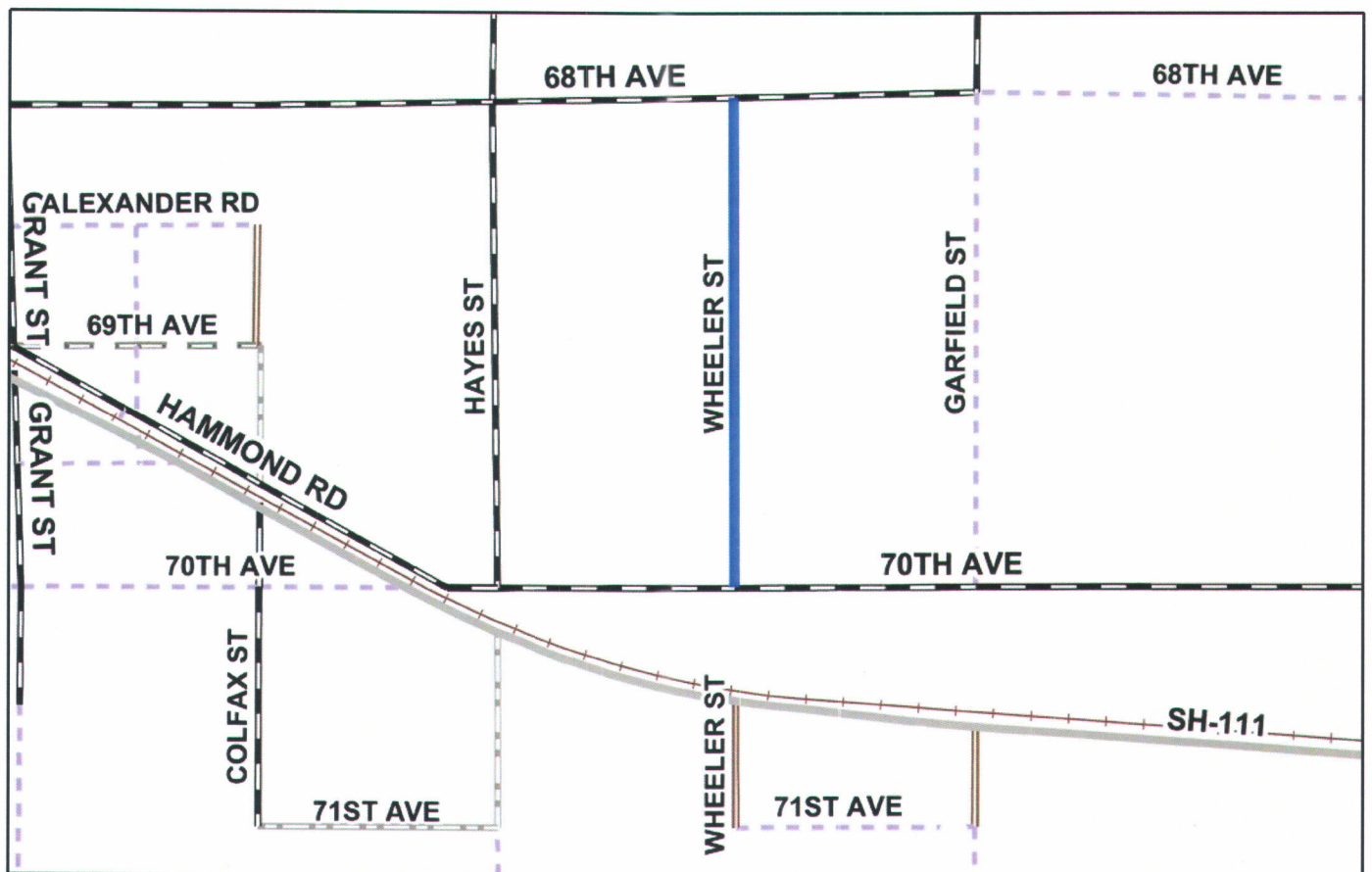
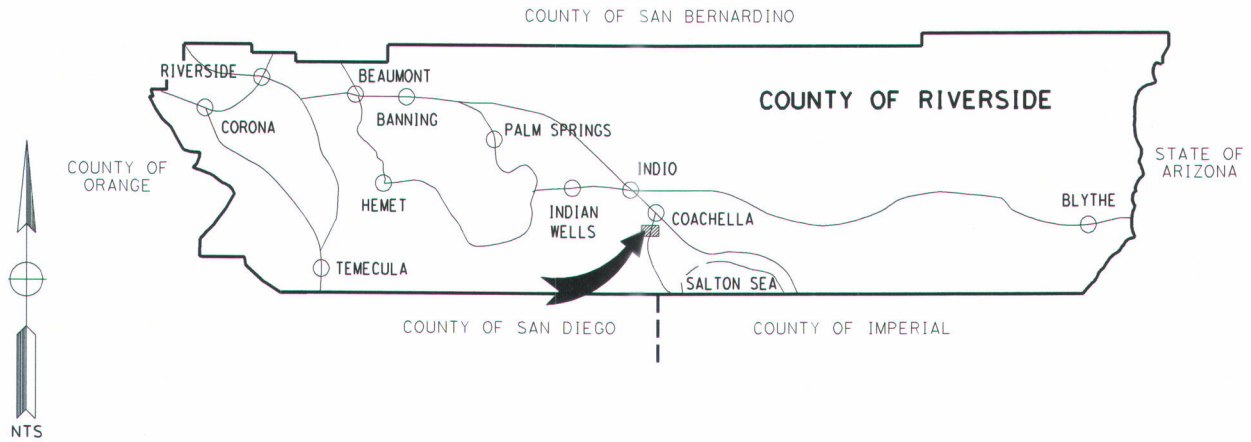

TOWNSHIP 7S RANGE 9E
COUNTY ROADBOOK PAGE No. 235

VICINITY MAP

**COUNTY OF RIVERSIDE
TRANSPORTATION DEPARTMENT**

**THERMAL AREA
RECONSTRUCTION PROJECT**

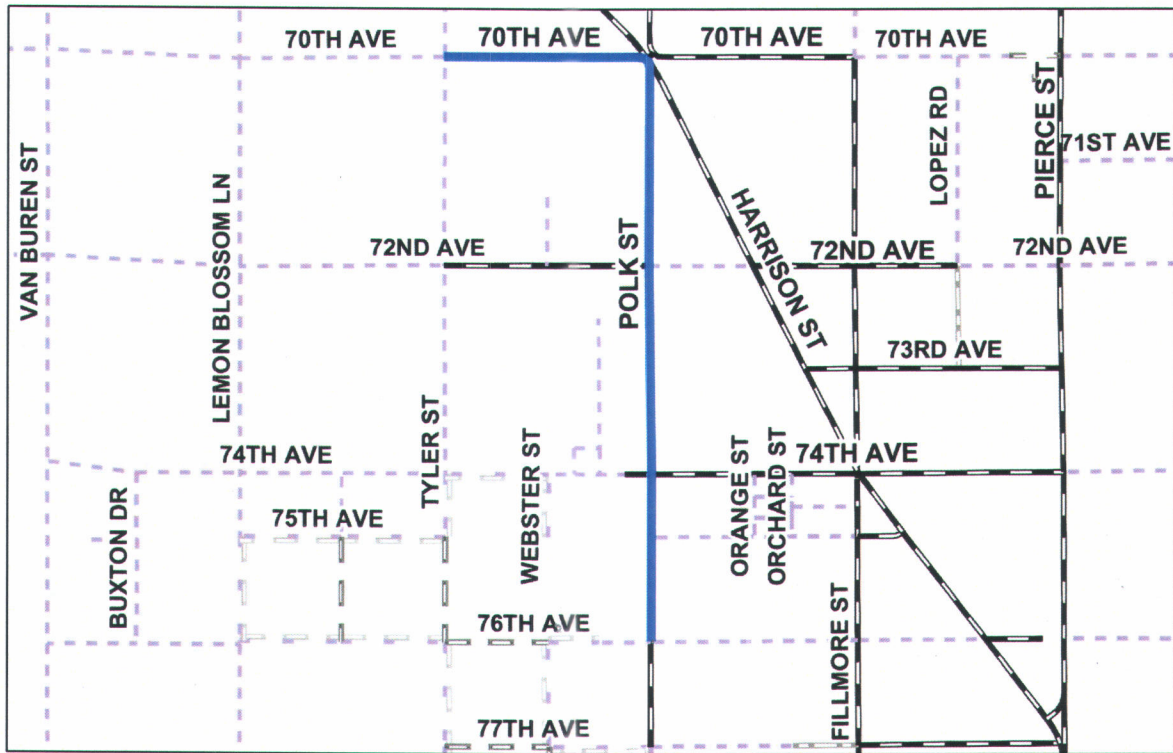
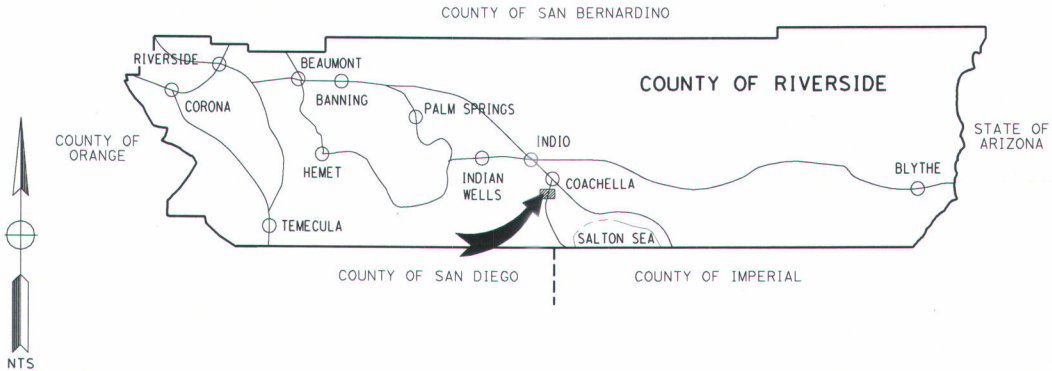

TOWNSHIP 7S RANGE 8E
COUNTY ROADBOOK PAGE No. 233

VICINITY MAP

COUNTY OF RIVERSIDE
TRANSPORTATION DEPARTMENT

THERMAL AREA
RECONSTRUCTION PROJECT

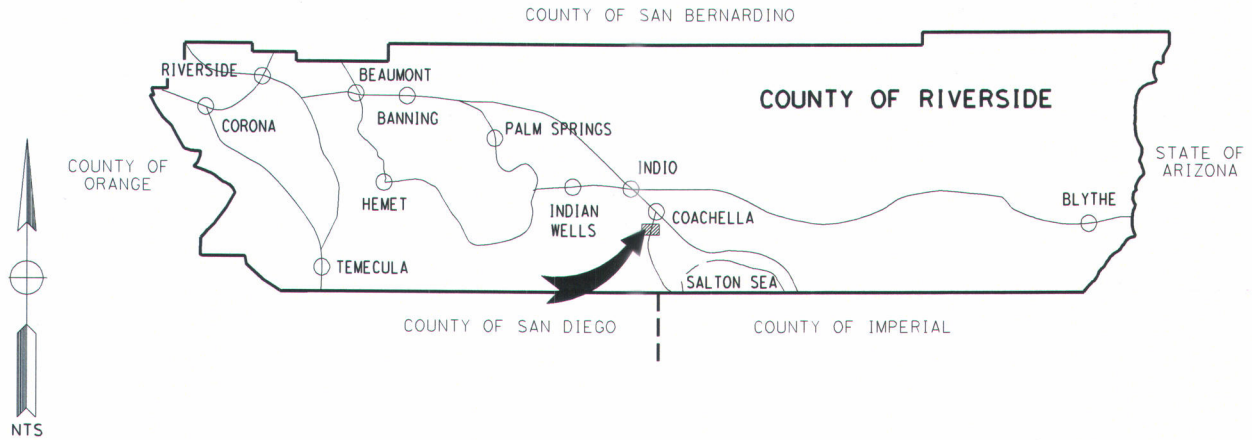

TOWNSHIP 7S RANGE 9E
COUNTY ROADBOOK PAGE No. 231

VICINITY MAP

COUNTY OF RIVERSIDE
TRANSPORTATION DEPARTMENT

THERMAL AREA
RECONSTRUCTION PROJECT

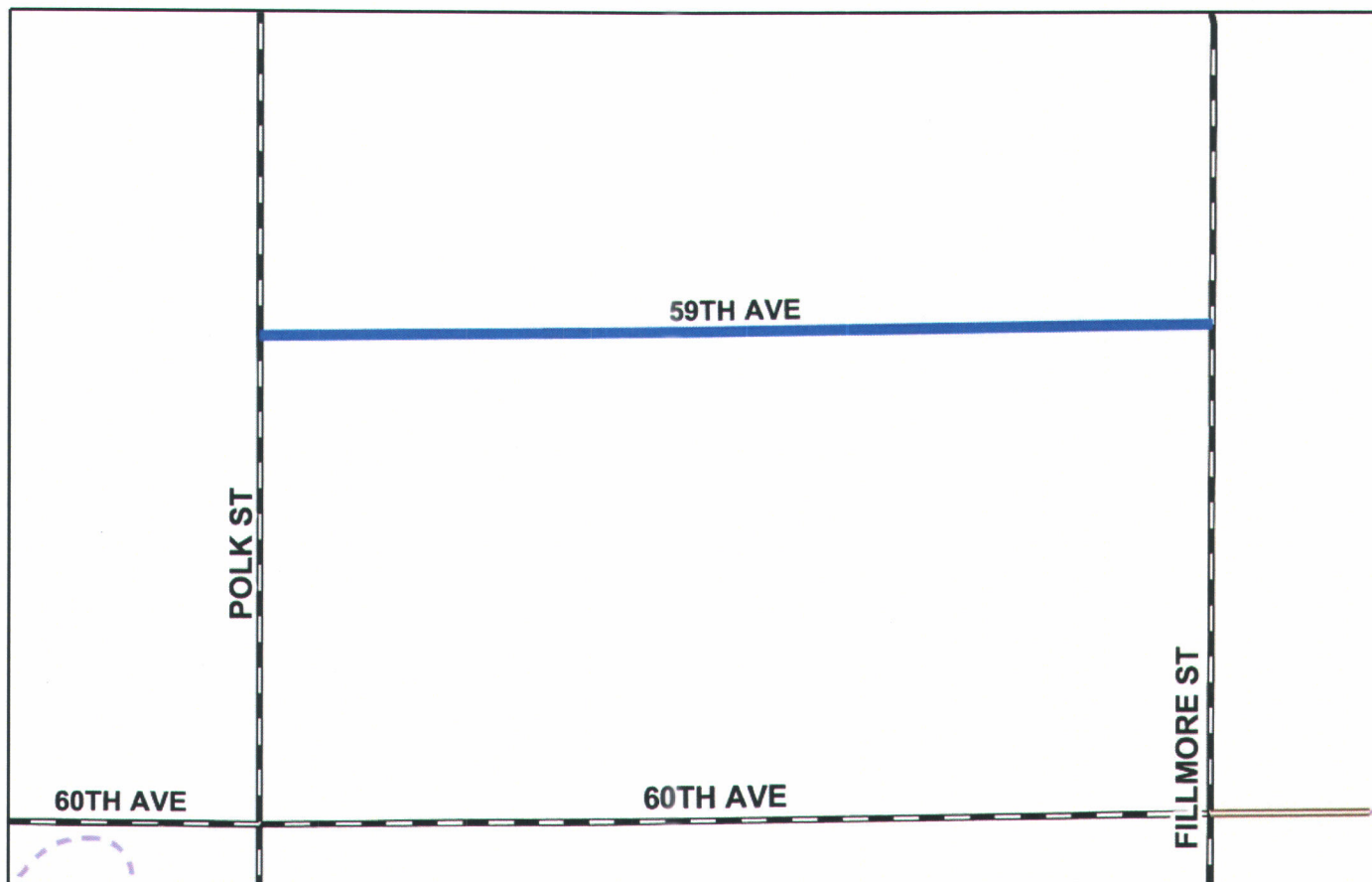
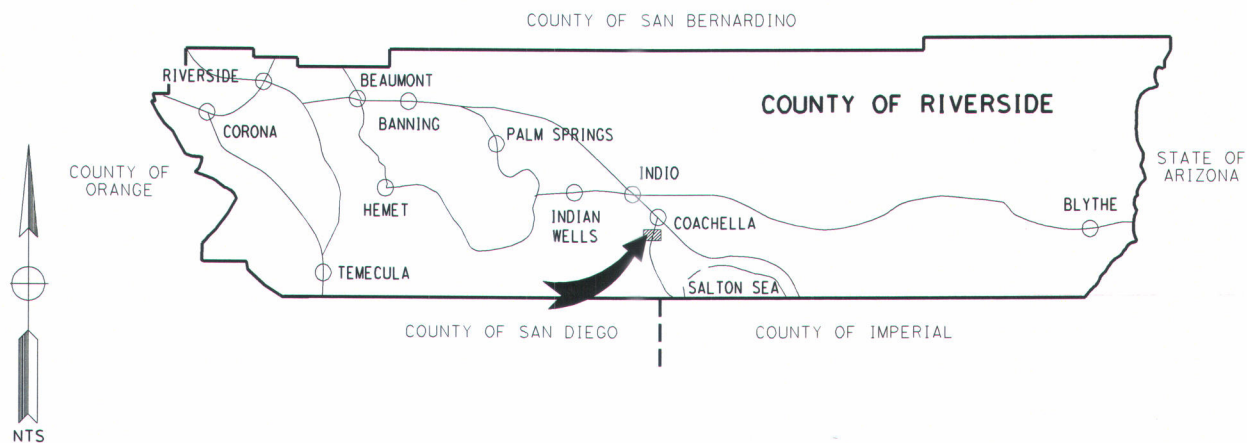

TOWNSHIP 6S RANGE 8E
COUNTY ROADBOOK PAGE No. 223

VICINITY MAP

COUNTY OF RIVERSIDE
TRANSPORTATION DEPARTMENT

THERMAL AREA
RECONSTRUCTION PROJECT

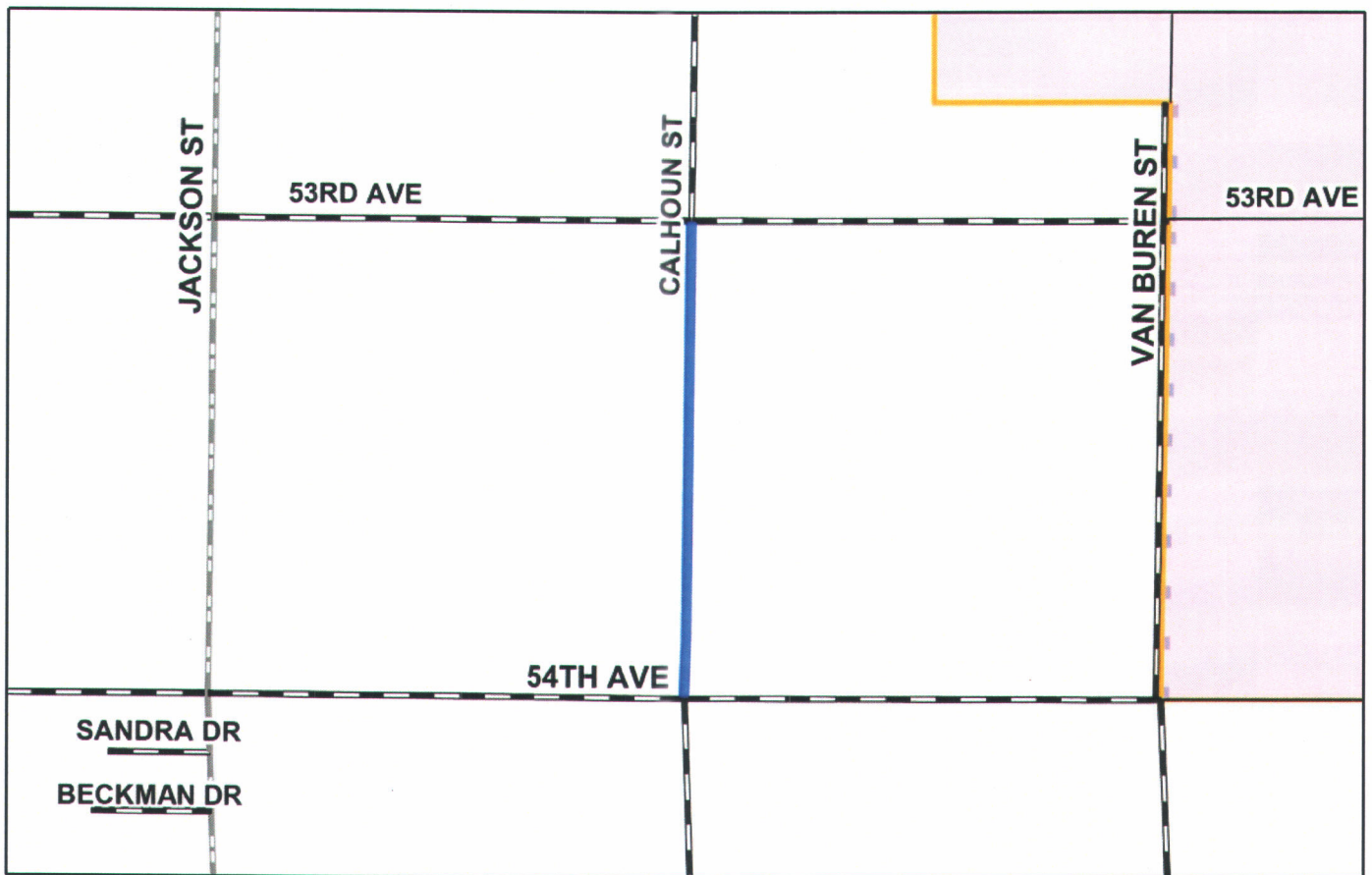
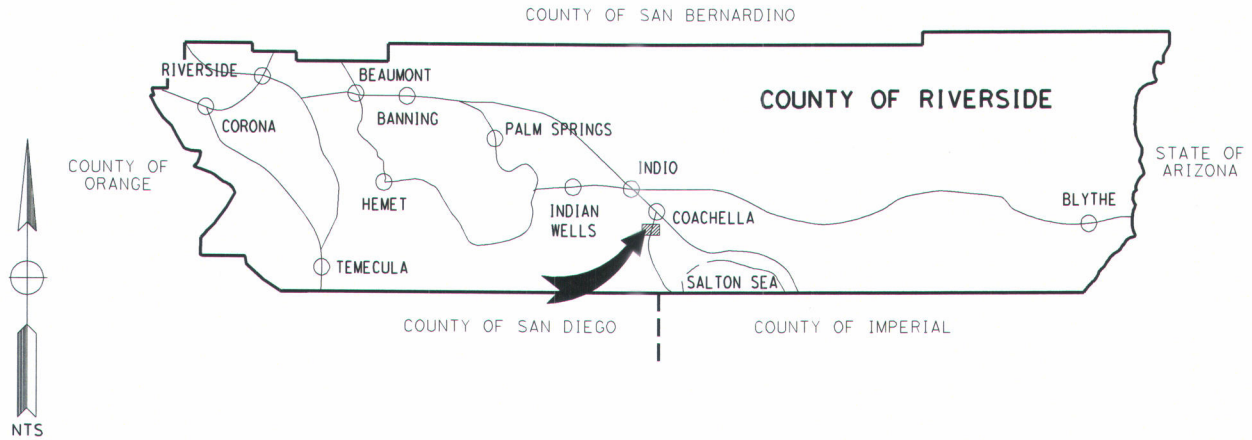

TOWNSHIP 6S RANGE 7E
COUNTY ROADBOOK PAGE No. 218

VICINITY MAP

COUNTY OF RIVERSIDE
TRANSPORTATION DEPARTMENT

ANZA AREA
RECONSTRUCTION PROJECT

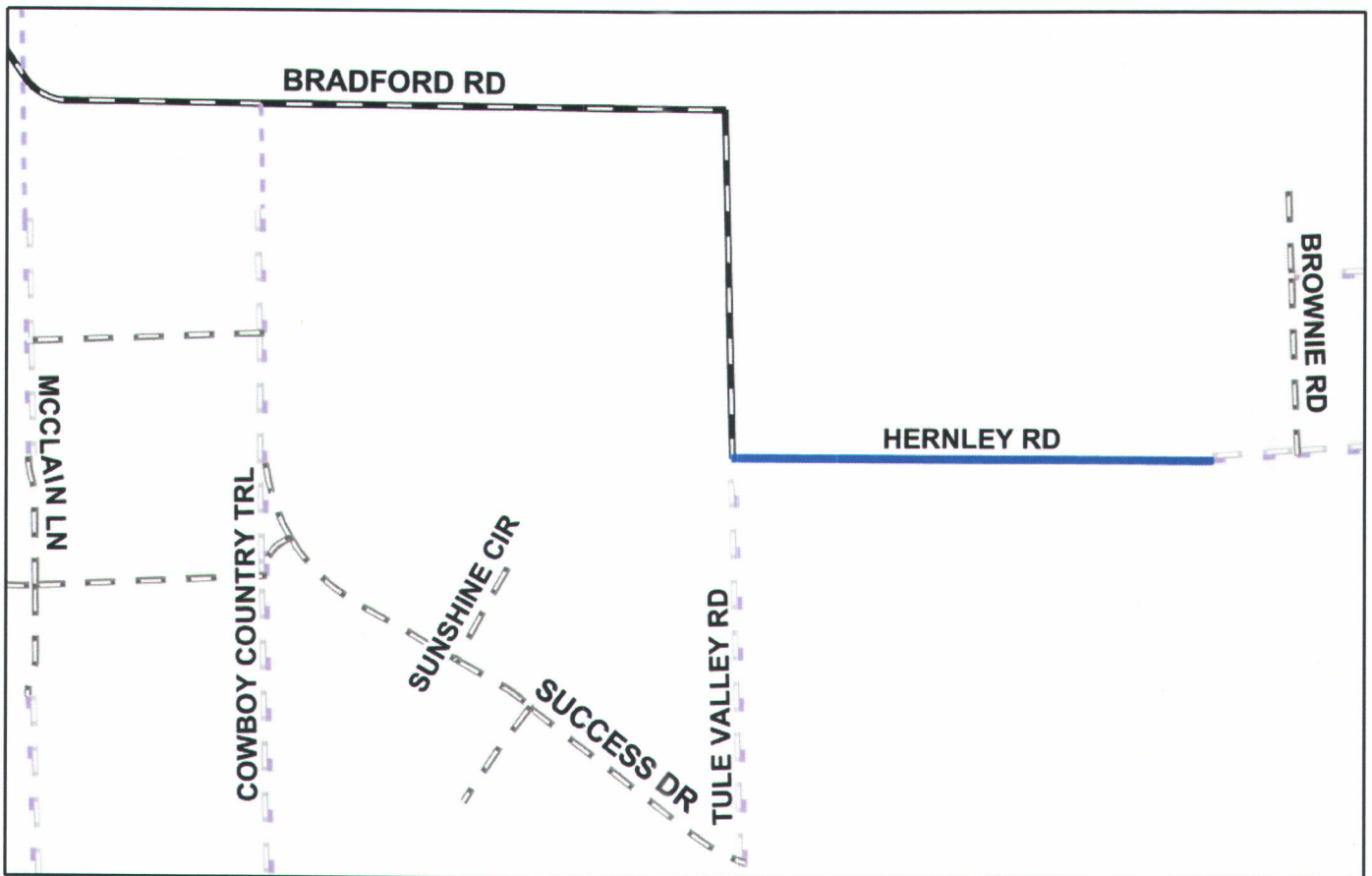
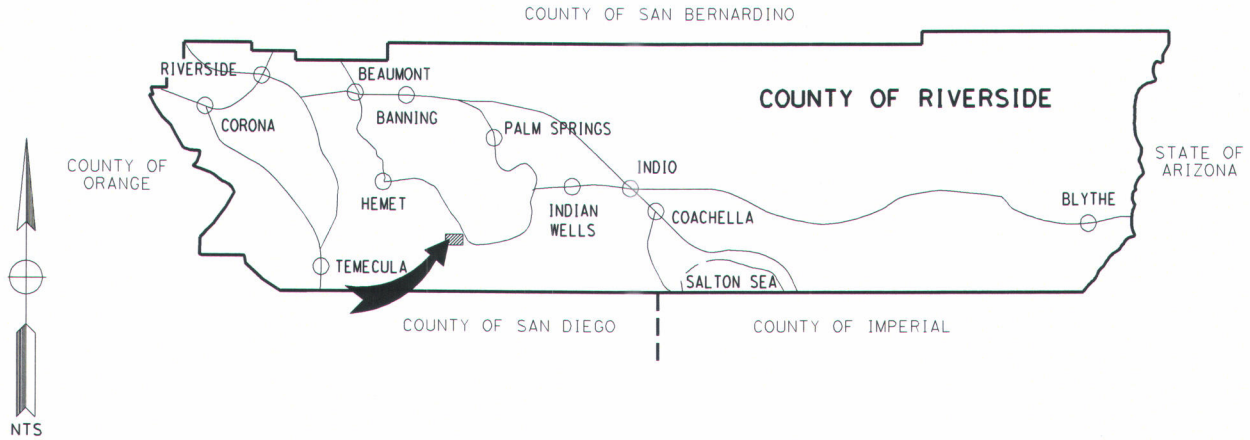

TOWNSHIP 8S RANGE 2E
COUNTY ROADBOOK PAGE No. 163A

VICINITY MAP

COUNTY OF RIVERSIDE
TRANSPORTATION DEPARTMENT

HEMET AREA
RECONSTRUCTION PROJECT

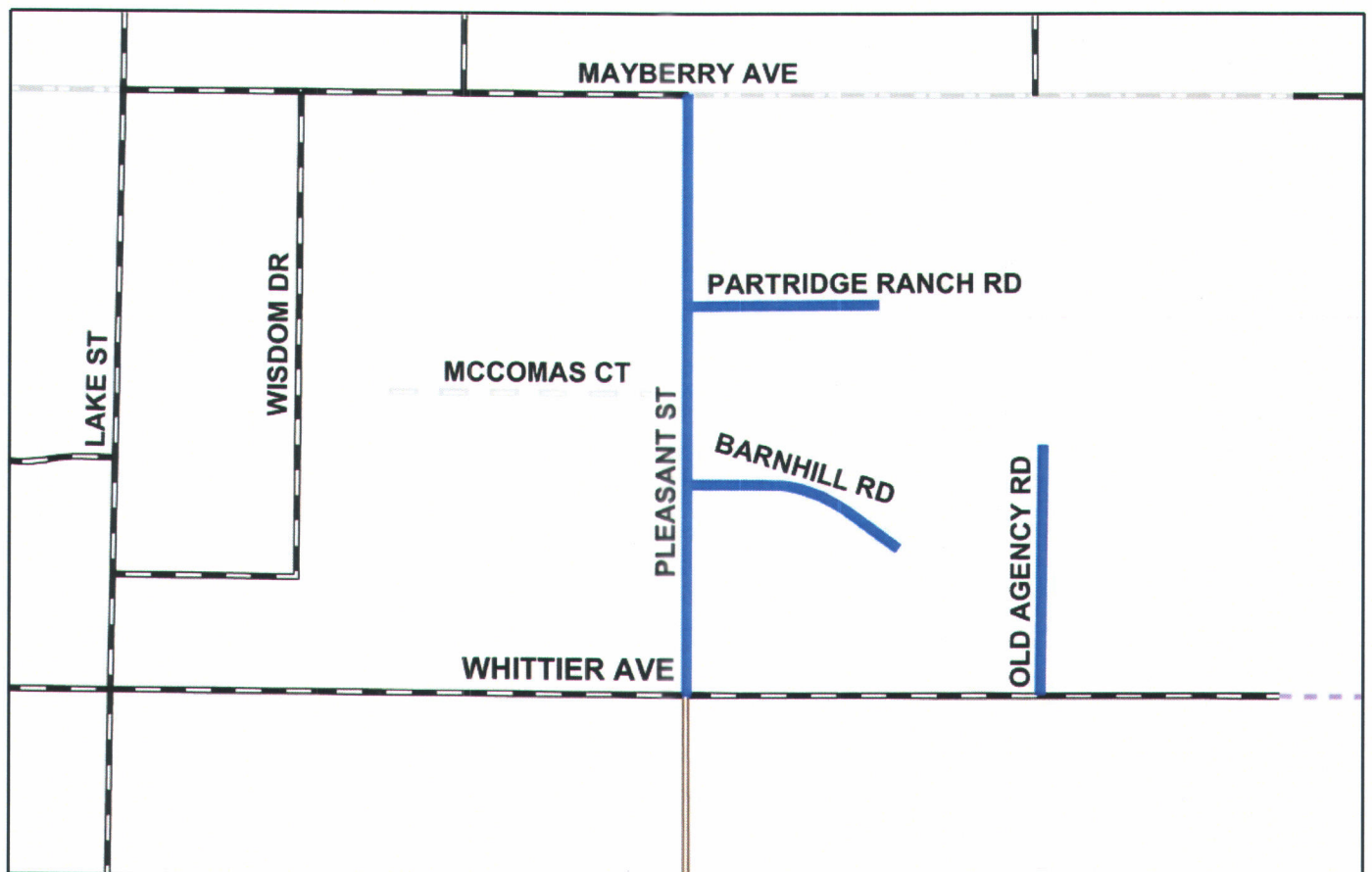
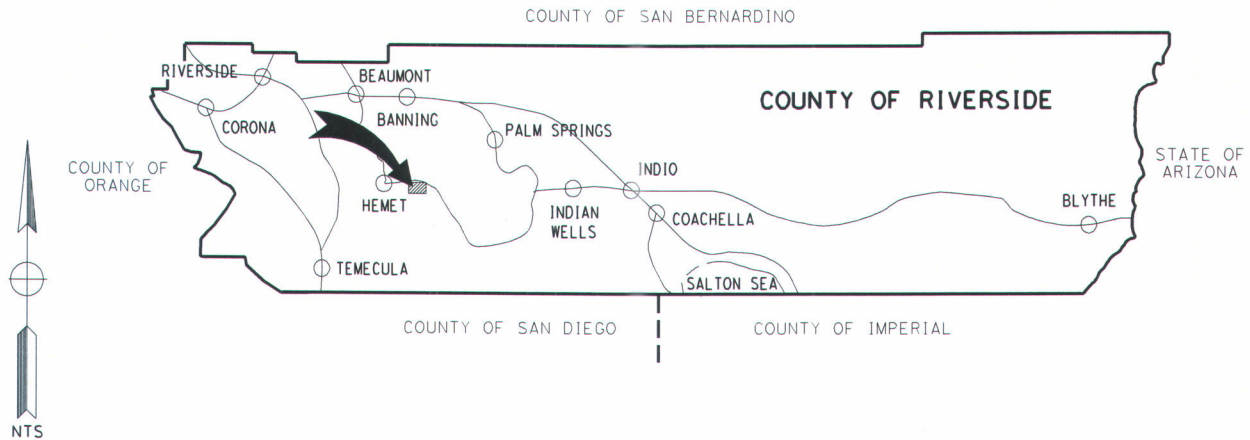

TOWNSHIP 5S RANGE 1E
COUNTY ROADBOOK PAGE No. 112

VICINITY MAP