

markers, as specified in the Standard Specifications and these special provisions, and as directed by the Engineer. No additional compensation will be allowed therefor.

MODIFICATIONS / CLARIFICATIONS TO THE PLANS

Item 39: Plan sheet revisions and additions. The following Plan sheets are added by **Attachment "B"** and made a part hereby:

The following nineteen (19) plan sheets are added by **Attachment "B"** and are made a part hereby:

- | | |
|------------------------------------|-------------------------------|
| 1. Plan sheet 1 of 19, Title Sheet | 11. Plan sheet 11 of 19, L-9 |
| 2. Plan sheet 2 of 19, X-1 | 12. Plan sheet 12 of 19, L-10 |
| 3. Plan sheet 3 of 19, L-1 | 13. Plan sheet 13 of 19, L-11 |
| 4. Plan sheet 4 of 19, L-2 | 14. Plan sheet 14 of 19, L-12 |
| 5. Plan sheet 5 of 19, L-3 | 15. Plan sheet 15 of 19, L-13 |
| 6. Plan sheet 6 of 19, L-4 | 16. Plan sheet 16 of 19, L-14 |
| 7. Plan sheet 7 of 19, L-5 | 17. Plan sheet 17 of 19, L-15 |
| 8. Plan sheet 8 of 19, L-6 | 18. Plan sheet 18 of 19, C-1 |
| 9. Plan sheet 9 of 19, L-7 | 19. Plan sheet 19 of 19, DE-1 |
| 10. Plan sheet 10 of 19, L-8 | |

Note: All revised plan sheets are posted on the County website and are available for download during the advertisement period.

<http://rctlma.org/trans/Contractors-Corner/Notices-Inviting-Bids>

ATTACHMENTS

A – Revised Proposal (5 pages)

B – Added Plan Sheets (19 sheets)

Addendum No. 3
North Indian Canyon Drive, Widening Project Phase 1, 20th Avenue to 18th Avenue
Cities of Palm Springs and Desert Hot Springs, Project No. C6-0089; and
Gilman Springs Road, Resurfacing Project, Moreno Valley City Limit to State Highway 79
Gilman Hot Springs Area, Project No. C9-0059
February 28, 2019
Page 34 of 34

This addendum has been prepared under the direction of the following registered Civil Engineer(s):

Recommended by:



Alfredo Martinez, PE
Senior Civil Engineer

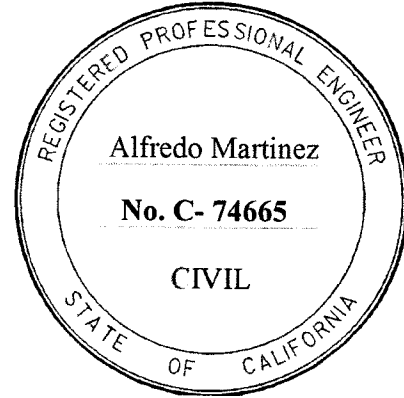

Concurrence:

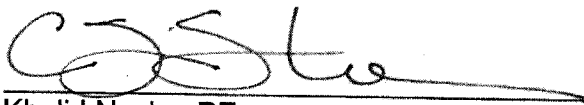

Khalid Nasim, PE
Engineering Division Manager
Per Charles Scott Staley
Engineering Project Manager

Acknowledged: _____ **Date:** _____
(Contractor)

JRJ: jrj:rr

Note: Refer to Instruction to Bidders Item No. 8, "Addenda". Submission of all addendum pages and non-bidding document attachments of addendum are not necessary for Bid submittal. Submittal of this acknowledgement page is adequate for Bid reception. Bidders are reminded to list addendum number(s) received on the first page of the Bid form (Proposal).

**North Indian Canyon Drive
Widening Project Phase 1
20th Avenue to 18th Avenue
Cities of Palm Springs and Desert Hot Springs
Project No. C6-0089; and**

**Gilman Springs Road
Resurfacing Project
Moreno Valley City Limit to State Highway 79
Gilman Hot Springs Area
Project No. C9-0059**

REVISED PROPOSAL

ITEM No.	ITEM CODE	ITEM	Like Bid Item*	UNIT	ESTIMATED QUANTITY	ITEM PRICE (IN FIGURES)	TOTAL (IN FIGURES)
BASE BID SCHEDULE: North Indian Canyon Drive, Widening Project							
1	100100	DEVELOP WATER SUPPLY		LS	1		
2	120100	TRAFFIC CONTROL SYSTEM		LS	1		
3	130200	PREPARE WATER POLLUTION CONTROL PROGRAM		LS	1		
4	170103	CLEARING AND GRUBBING		LS	1		
5	066012	DUST ABATEMENT		LS	1		
6	190101	ROADWAY EXCAVATION	Like 1	CY	2,410		
7	190185	SHOULDER BACKING	Like 2	LF	3,110		
8	260203	CLASS 2 AGGREGATE BASE	Like 3	CY	1,301		
9	390132	HOT MIX ASPHALT (TYPE A)	Like 4	TON	2,430		
10	017304	MINOR CONCRETE (CURB AND GUTTER) (CRS 200)		LF	470		
11	810230	PAVEMENT MARKER (RETROREFLECTIVE)	Like 5	EA	510		
12	820410	SALVAGE ROADSIDE SIGN		EA	3		
13	820840	ROADSIDE SIGN - ONE POST	Like 6	EA	4		
14	820850	ROADSIDE SIGN - TWO POST		EA	5		
15	840501	THERMOPLASTIC TRAFFIC STRIPE	Like 7	LF	12,700		
16	840515	THERMOPLASTIC PAVEMENT MARKING	Like 8	SQFT	380		
17	846020	REMOVE PAINTED TRAFFIC STRIPE	Like 9	LF	6,190		
18	846035	REMOVE THERMOPLASTIC PAVEMENT MARKING		SQFT	710		
19	010602	MISCELLANEOUS WORK (AS DIRECTED)		FA	1	60,000.00	60,000.00

ADDENDUM No. 3, Page 35 of 58

BASE BID SCH. 1

SUB-TOTAL: _____ \$ _____

ITEMS 1-19 "WORDS"

* NOTE: See Instructions to Bidders, Section 16 "Like Bid Items", on page A9; corrections will apply if Like Bid items cost discrepancies are submitted. Applicable to Base Bid Schedule 1 and Alternate Bid Schedule 1 only.

REVISED PROPOSAL

ITEM No.	ITEM CODE	ITEM	Like Bid Item*	UNIT	ESTIMATED QUANTITY	ITEM PRICE (IN FIGURES)	TOTAL (IN FIGURES)
ALTERNATIVE BID SCHEDULE 1: Coachilling Development							
20	190101	ROADWAY EXCAVATION	Like 1	CY	1,380		
21	190185	SHOULDER BACKING	Like 2	LF	2,640		
22	260203	CLASS 2 AGGREGATE BASE	Like 3	CY	745		
23	390132	HOT MIX ASPHALT (TYPE A)	Like 4	TON	1,390		
24	810230	PAVEMENT MARKER (RETROREFLECTIVE)	Like 5	EA	180		
25	820840	ROADSIDE SIGN - ONE POST	Like 6	EA	3		
26	840501	THERMOPLASTIC TRAFFIC STRIPE	Like 7	LF	5,890		
27	840515	THERMOPLASTIC PAVEMENT MARKING	Like 8	SQFT	130		
28	846020	REMOVE PAINTED TRAFFIC STRIPE	Like 9	LF	3,660		

ALT. BID SCH. 1

SUB-TOTAL: _____ \$

ITEMS 20-28 "WORDS"

* NOTE: See Instructions to Bidders, Section 16 "Like Bid Items", on page A9; corrections will apply if Like Bid items cost discrepancies are submitted. Applicable to Base Bid Schedule 1 and Alternate Bid Schedule 1 only.

ALTERNATIVE BID SCHEDULE 2: Mission Springs Water District Facilities Adjustments

29	000003	ADJUST WATER VALVE WITH CONCRETE COLLAR	-----	EA	6		
30	202027	RELOCATE WATER METER (MSWD)	-----	EA	2		

ALT. BID SCH. 2

SUB-TOTAL: _____ \$

ITEMS 29-30 "WORDS"

ALTERNATIVE BID SCHEDULE 3 – Gilman Springs Road Resurfacing Project, Full Road Closure

31	066102	DUST ABATEMENT	-----	LS	1		
32	100100	DEVELOP WATER SUPPLY	-----	LS	1		
33	120100	TRAFFIC CONTROL SYSTEM	-----	LS	1		
34	130200	PREPARE WATER POLLUTION CONTROL PROGRAM	-----	LS	1		
35	170103	CLEARING AND GRUBBING (LS)	-----	LS	1		
36	190101	ROADWAY EXCAVATION	-----	CY	1,010		
37	190185	SHOULDER BACKING	-----	LF	38,720		
38	390137	RUBBERIZED HOT MIX ASPHALT (GAP GRADED)	-----	TON	17,700		
39	013902	ASPHALT CONCRETE OVERSIDE DRAIN (CRS 306)	-----	EA	45		

REVISED PROPOSAL

ITEM No.	ITEM CODE	ITEM	Like Bid Item*	UNIT	ESTIMATED QUANTITY	ITEM PRICE (IN FIGURES)	TOTAL (IN FIGURES)
40	013903	PLACE ASPHALT CONCRETE DIKE (CRS 212) (6") AND [TYPE C AND E]	-----	LF	24,175		
41	390132	HOT MIX ASPHALT (TYPE A) [3/4" MIX]	-----	TON	3,310		
42	390132	HOT MIX ASPHALT (TYPE A) [1" MIX]	-----	TON	1,470		
43	390135	HOT MIX ASPHALT (LEVELING)	-----	TON	10,280		
44	394090	PLACE HOT MIX ASPHALT (MISCELLANEOUS AREA)	-----	SQYD	2,700		
45	398200	COLD PLANE ASPHALT CONCRETE PAVEMENT [0.50' DEEP]	-----	SQYD	7,030		
46	398200	COLD PLANE ASPHALT CONCRETE PAVEMENT [0.27' DEEP]	-----	SQYD	1,190		
47	398200	COLD PLANE ASPHALT CONCRETE PAVEMENT [0.17' DEEP]	-----	SQYD	1,860		
48	690110	12" CORRUGATED STEEL PIPE DOWNDRAIN	-----	EA	9		
49	810230	PAVEMENT MARKER (RETROREFLECTIVE)	-----	EA	115,000		
50	832007	MIDWEST GUARDRAIL SYSTEM (WOOD POST)	-----	LF	2,280		
51	839584	ALTERNATIVE IN-LINE TERMINAL SYSTEM	-----	EA	18		
52	839585	ALTERNATIVE FLARED TERMINAL SYSTEM	-----	EA	6		
53	839752	REMOVE GUARDRAIL	-----	LF	3,370		
54	840515	THERMOPLASTIC PAVEMENT MARKING	-----	SQFT	700		
55	840656	PAINT TRAFFIC STRIPE (2-COAT)	-----	LF	136,000		
56	846051	12" RUMBLE STRIP (ASPHALT CONCRETE PAVEMENT)	-----	LF	34,000		
57	010602	MISCELLANEOUS WORK (AS DIRECTED)	-----	FA	1	185,000.00	185,000.00

ADDENDUM No. 3, Page 37 of 58

ALT. BID SCH. 3

SUB-TOTAL: _____ \$ _____

ITEMS 31-57 "WORDS"

* NOTE: Like Bid Items requirements are not applicable to bid items in Alternate Bid Schedules 2, 3, 4, and 5.

ALTERNATIVE BID SCHEDULE 4 – Gilman Springs Road Resurfacing Project, One Lane Closure

58	066102	DUST ABATEMENT	-----	LS	1		
59	100100	DEVELOP WATER SUPPLY	-----	LS	1		
60	120100	TRAFFIC CONTROL SYSTEM	-----	LS	1		
61	130200	PREPARE WATER POLLUTION CONTROL PROGRAM	-----	LS	1		
62	170103	CLEARING AND GRUBBING (LS)	-----	LS	1		
63	190101	ROADWAY EXCAVATION	-----	CY	1,010		

REVISED PROPOSAL

ITEM No.	ITEM CODE	ITEM	Like Bid Item*	UNIT	ESTIMATED QUANTITY	ITEM PRICE (IN FIGURES)	TOTAL (IN FIGURES)
64	190185	SHOULDER BACKING	-----	LF	38,720		
65	390137	RUBBERIZED HOT MIX ASPHALT (GAP GRADED)	-----	TON	17,700		
66	013902	ASPHALT CONCRETE OVERSIDE DRAIN (CRS 306)	-----	EA	45		
67	013903	PLACE ASPHALT CONCRETE DIKE (CRS 212) (6") AND [TYPE C AND E]	-----	LF	24,175		
68	390132	HOT MIX ASPHALT (TYPE A) [3/4" MIX]	-----	TON	3,310		
69	390132	HOT MIX ASPHALT (TYPE A) [1" MIX]	-----	TON	1,470		
70	390135	HOT MIX ASPHALT (LEVELING)	-----	TON	10,280		
71	394090	PLACE HOT MIX ASPHALT (MISCELLANEOUS AREA)	-----	SQYD	2,700		
72	398200	COLD PLANE ASPHALT CONCRETE PAVEMENT [0.50' DEEP]	-----	SQYD	7,030		
73	398200	COLD PLANE ASPHALT CONCRETE PAVEMENT [0.27' DEEP]	-----	SQYD	1,190		
74	398200	COLD PLANE ASPHALT CONCRETE PAVEMENT [0.17' DEEP]	-----	SQYD	1,860		
75	690110	12" CORRUGATED STEEL PIPE DOWNDRAIN	-----	EA	9		
76	810230	PAVEMENT MARKER (RETROREFLECTIVE)	-----	EA	115,000		
77	832007	MIDWEST GUARDRAIL SYSTEM (WOOD POST)	-----	LF	2,280		
78	839584	ALTERNATIVE IN-LINE TERMINAL SYSTEM	-----	EA	18		
79	839585	ALTERNATIVE FLARED TERMINAL SYSTEM	-----	EA	6		
80	839752	REMOVE GUARDRAIL	-----	LF	3,370		
81	840515	THERMOPLASTIC PAVEMENT MARKING	-----	SQFT	700		
82	840656	PAINT TRAFFIC STRIPE (2-COAT)	-----	LF	136,000		
83	846051	12" RUMBLE STRIP (ASPHALT CONCRETE PAVEMENT)	-----	LF	34,000		
84	010602	MISCELLANEOUS WORK (AS DIRECTED)	-----	FA	1	395,000.00	395,000.00

ADDENDUM No. 3, Page 38 of 58

ALT. BID SCH. 4

SUB-TOTAL:

ITEMS 58-84

"WORDS"

\$

* NOTE: Like Bid Items requirements are not applicable to bid items in Alternate Bid Schedules 2, 3, 4, and 5.

REVISED PROPOSAL

ITEM No.	ITEM CODE	ITEM	Like Bid Item*	UNIT	ESTIMATED QUANTITY	ITEM PRICE (IN FIGURES)	TOTAL (IN FIGURES)
ALTERNATIVE BID SCHEDULE 5 – Gilman Springs Road, Micro-surfacing Treatment							
85	120100	TRAFFIC CONTROL SYSTEM	-----	LS	1		
86	374207	CRACK TREATMENT	-----	LS	1		
87	374002	ASPHALTIC EMULSION (FOG SEAL COAT)	-----	SQYD	27,550		
88	378000	MICRO-SURFACING	-----	TON	480		
89	810230	PAVEMENT MARKER (RETROREFLECTIVE)	-----	EA	5,400		
90	840515	THERMOPLASTIC PAVEMENT MARKING	-----	SQFT	200		
91	840656	PAINT TRAFFIC STRIPE (2-COAT)	-----	LF	64,000		
92	010602	MISCELLANEOUS WORK (AS DIRECTED)	-----	FA	1	24,000.00	24,000.00

ALT. BID SCH. 5

SUB-TOTAL: _____ \$ _____

ITEMS 85-92 "WORDS"

* NOTE: Like Bid Items requirements are not applicable to bid items in Alternate Bid Schedules 2, 3, 4, and 5.

BASE BID SCHEDULE and ALTERNATIVE BID SCHEDULES 1, 2, 3, 4 and 5

PROJECT TOTAL: _____ \$ _____

ITEMS 1-92 "WORDS"

ADDENDUM No. 3, Page 39 of 58

COUNTY OF RIVERSIDE
TRANSPORTATION DEPARTMENT

GILMAN SPRINGS ROAD
RESURFACING

SR-79 SB ON-RAMP TO MORENO VALLEY CITY LIMITS
COMMUNITY OF GILMAN HOT SPRINGS / GLEN EDEN SPRINGS

WO No. C9-0059

ABBREVIATIONS & LEGEND

AC ASPHALT CONCRETE
AP ANGLE POINT
AVC AVENUE
BEG BEGIN
BLVD BOULEVARD
CMT CEMENT
CMT RECALLED RELEASE
CMT TERMINAL
DET DETAIL
DRY DRIVEWAY
EP EDGE OF PAVEMENT
EXIST EXISTING
EXP EXPRESSWAY
GR GRAVEL
HMA HOT MIX ASPHALT
L LENGTH
LT LEFT
MKS MARKS
MICRO MICRO SURFACING
MIN MINIMUM
MP NORTH BOUND
NO. NUMBER
NTS NOT TO SCALE
PED PEDESTAL
RBL RUMBLE
RD ROAD
RESURF RESURFACING
RT RIGHT
R/W RIGHT OF WAY
SHLD SHOULDER
SMA SURFACE MIX ASPHALT
SR STATE ROUTE
ST STREET

SVA STATION
STD STANDARD
STP STRIPE
TRANS TRANSITION
TYP TYPICAL

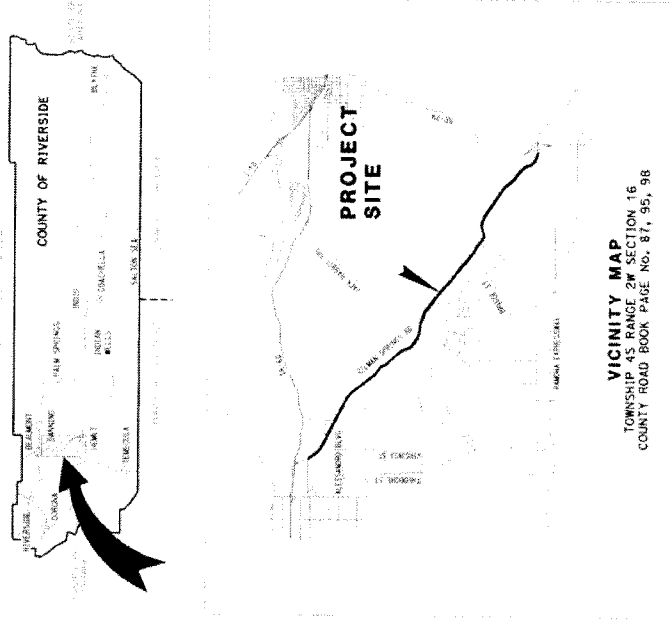

VICINITY MAP
TOWNSHIP 4S RANGE 2M SECTION 16
COUNTY ROAD BOOK PAGE NO. 87, 95, 98

INDEX OF SHEETS

SHEET NO.	DESCRIPTION
1	TYPICAL
2	TYPICAL CROSS SECTIONS
3 - 17	LAYOUT
18	CONSTRUCTION DETAILS
19	DETOUR PLAN

<p>CONCURRED BY: _____</p> <p>PREPARED UNDER THE SUPERVISION OF: _____</p> <p>DATE: _____</p> <p>COUNTY OF RIVERSIDE</p>		<p>TITLE</p> <p>GILMAN SPRINGS ROAD RESURFACING NO. SCALE</p>	<p>SHEET NO.</p> <p>Sheet 1 of 19</p>
--	--	--	---------------------------------------

THE CONTRACTOR SHALL NOTIFY UNDERGROUND SERVICE ALERT, (800) 227-2600, AND ALL CONCERNED UTILITY COMPANIES AT LEAST TWO WORKING DAYS IN ADVANCE OF EXCAVATION.

ISSUANCE OF THIS PERMIT IS SUBJECT TO THE STATE OF CALIFORNIA PERMITS ACT, CHAPTER 654, DIVISION 9, PUBLIC RESOURCES CODE, SECTION 26100.

WO C9-0059

COUNTY FILE NO.

966-QQ

CONSTRUCTION NOTES:

1. PROTECT
2. MATCH EXISTING
3. REMOVE GUARDRAIL AND END TREATMENTS
4. REMOVE EXISTING DIKE
5. RECONSTRUCT DOWN DRAIN PER CALTRANS STD DB274, INCLUDING OBJECT MARKER
6. RECONSTRUCT ASPHALT CONCRETE OVERSIDE DRAIN PER SUB, INCLUDING OBJECT MARKER
7. PLACE TYPE E DIME PER CALTRANS STD 487B
8. PLACE TYPE F DIME PER CALTRANS STD 487B
9. PLACE SHOULDER BACKING AND CONSTRUCT ASPHALT CONCRETE
10. CONSTRUCT 10' ASPHALT CONCRETE DIKE TRANSITION AND TREATMENT (FLARED)
11. CONSTRUCT CALTRANS APPROVE MIDWEST GUARDRAIL END TREATMENT (IN-LINE)
12. CONSTRUCT CALTRANS APPROVE MIDWEST GUARDRAIL END TREATMENT (FLARED)
13. CONSTRUCT GUARDRAIL SYSTEM PER CALTRANS STD 487C WITH 15' END TREATMENT PER CALTRANS STD ATTACH. TO BE PLACED EVERY OTHER POST
14. PLACE 0.10" NMA TYPE A 13/24" MIX LEVELING COURSE AND OVERLAY WITH 0.17" NMA TYPE C (1 1/2" MIX) ASPHALT CONCRETE PER CALTRANS STD 487C. STRIPE CENTER MEDIAN AND SHOULDERS
15. COLD PLACE DRIVE LANE 0.50" MIN AND INLAY WITH 0.50" NMA TYPE A 13/24" MIX
16. RECONSTRUCT EXISTING ASPHALT CONCRETE DRIVEWAY
17. RECONSTRUCT EXISTING ASPHALT CONCRETE DRIVEWAY
18. RECONSTRUCT EXISTING ASPHALT CONCRETE DRIVEWAY
19. RECONSTRUCT EXISTING ASPHALT CONCRETE DRIVEWAY
20. RECONSTRUCT EXISTING ASPHALT CONCRETE DRIVEWAY
21. RECONSTRUCT EXISTING ASPHALT CONCRETE DRIVEWAY
22. RECONSTRUCT EXISTING ASPHALT CONCRETE DRIVEWAY
23. RECONSTRUCT EXISTING ASPHALT CONCRETE DRIVEWAY
24. RECONSTRUCT EXISTING ASPHALT CONCRETE DRIVEWAY
25. RECONSTRUCT EXISTING ASPHALT CONCRETE DRIVEWAY
26. RECONSTRUCT EXISTING ASPHALT CONCRETE DRIVEWAY
27. RECONSTRUCT EXISTING ASPHALT CONCRETE DRIVEWAY
28. RECONSTRUCT EXISTING ASPHALT CONCRETE DRIVEWAY
29. RECONSTRUCT EXISTING ASPHALT CONCRETE DRIVEWAY
30. RECONSTRUCT EXISTING ASPHALT CONCRETE DRIVEWAY
31. RECONSTRUCT EXISTING ASPHALT CONCRETE DRIVEWAY
32. RECONSTRUCT EXISTING ASPHALT CONCRETE DRIVEWAY
33. RECONSTRUCT EXISTING ASPHALT CONCRETE DRIVEWAY
34. RECONSTRUCT EXISTING ASPHALT CONCRETE DRIVEWAY
35. RECONSTRUCT EXISTING ASPHALT CONCRETE DRIVEWAY
36. RECONSTRUCT EXISTING ASPHALT CONCRETE DRIVEWAY
37. RECONSTRUCT EXISTING ASPHALT CONCRETE DRIVEWAY
38. RECONSTRUCT EXISTING ASPHALT CONCRETE DRIVEWAY
39. RECONSTRUCT EXISTING ASPHALT CONCRETE DRIVEWAY
40. RECONSTRUCT EXISTING ASPHALT CONCRETE DRIVEWAY
41. RECONSTRUCT EXISTING ASPHALT CONCRETE DRIVEWAY
42. RECONSTRUCT EXISTING ASPHALT CONCRETE DRIVEWAY
43. RECONSTRUCT EXISTING ASPHALT CONCRETE DRIVEWAY
44. RECONSTRUCT EXISTING ASPHALT CONCRETE DRIVEWAY
45. RECONSTRUCT EXISTING ASPHALT CONCRETE DRIVEWAY
46. RECONSTRUCT EXISTING ASPHALT CONCRETE DRIVEWAY
47. RECONSTRUCT EXISTING ASPHALT CONCRETE DRIVEWAY
48. RECONSTRUCT EXISTING ASPHALT CONCRETE DRIVEWAY
49. RECONSTRUCT EXISTING ASPHALT CONCRETE DRIVEWAY
50. RECONSTRUCT EXISTING ASPHALT CONCRETE DRIVEWAY

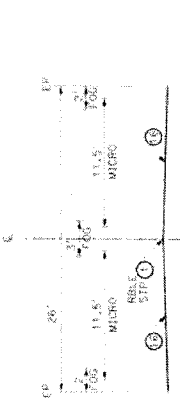

GILMAN SPRINGS RD
STA 692+71 TO STA 716+16

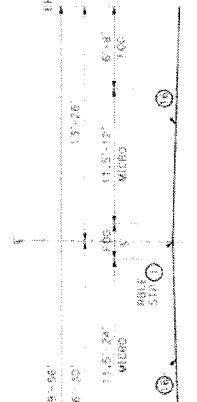

GILMAN SPRINGS RD
STA 763+40 TO STA 763+71

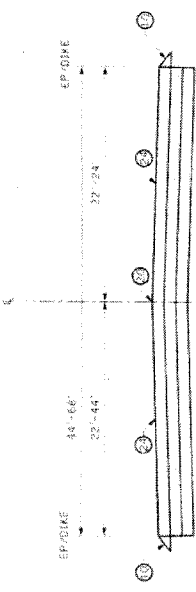

GILMAN SPRINGS RD
STA 389+91 TO STA 392+28

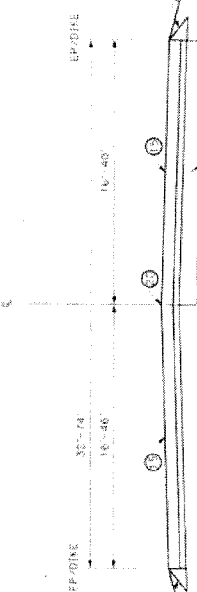

GILMAN SPRINGS RD
STA 244+15 TO STA 245+91

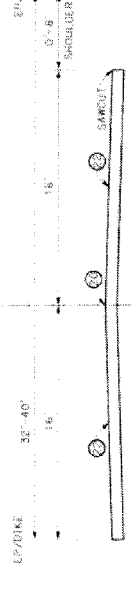

GILMAN SPRINGS RD
STA 244+25 TO STA 244+75

TYPICAL CROSS SECTIONS	SHEET NO.
GILMAN SPRINGS ROAD RESURFACING NO SCALE	X-1 2 of 19

PREPARED BY: **ALFRED A. MATHIAS**
DATE: **7/28/18**
REGISTERED PROFESSIONAL ENGINEER
COUNTY OF INDIANA

ISSUED BY ADDENDUM NO. 3, ATTACHMENT B

CONSTRUCTION NOTES:

1. PROTECT EXISTING
2. REMOVE QUADRANT AND END TREATMENTS
3. REMOVE EXISTING DIKE
4. RECONSTRUCT EXISTING DIKE PER CALTRANS STD DB/A, INCLUDING OBJECT MARKERS
5. RECONSTRUCT ASPHALT CONCRETE OVERSIDE DRAIN PER JOB, INCLUDING OBJECT MARKER
6. PLACE 6" ASPHALT CONCRETE DIKE PER STD 212
7. PLACE TYPE K DIKE PER CALTRANS STD AR78
8. PLACE SHOULDER BACKING AND CONSTRUCT ASPHALT CONCRETE SAFETY EDGE
9. CONSTRUCT TO ASPHALT CONCRETE DIKE TRANSITION
10. END TREATMENT APPROVE MIDWEST QUADRANT
11. CONSTRUCT CALTRANS APPROVE MIDWEST QUADRANT END TREATMENT (IN-LINE)
12. CONSTRUCT MIDWEST QUADRANT SYSTEM WITH CALTRANS STD AT754, TO BE PLACED EVERY OTHER CROSSING
13. PLACE 0.10" HMA TYPE A (3/8" MIX) LAYING COURSE AND OVERLAY WITH 0.17" HMA TYPE C (1 1/2" MIX)
14. MICROSURFACE EXISTING TRAVEL LANE, AND 100% OF
15. COLD PLANE DRIVE LANE 0.40" MIN AND 0.50" MAX
16. HMA 7 PPS, A (3/4" MIX) MIN AND 1.50" MAX
17. HEADER CUT EXISTING ASPHALT CONCRETE DRIVEWAY
18. PLACE 0.27" DEEP FOR 60' LONG 75'-IN
19. OPEN CENTERLINE NUMBER STRIPE
20. SET QUADRANT POST AND INSTALL CTR POST PER DETAIL ON SHEET 2
21. CSDD PAVE TO A DEPTH OF 0.27"
22. CONSTRUCT ASPHALT CONCRETE DRIVEWAY 0.33" HMA OVER NATIVE
23. REMOVE EXISTING ASPHALT CONCRETE TO A DEPTH OF 0.20" HMA 18" MIN, 14" MAX OVER 2 LITS OF 0.20" HMA 18" MIN, 14" MAX
24. REMOVE EXISTING STRIPING, MARKERS, AND MARKINGS BY SANDBLASTING PRIOR TO PAVEMENT
25. REMOVE EXISTING STRIPING, MARKERS, AND MARKINGS BY SANDBLASTING PRIOR TO PAVEMENT
26. SANDBLASTING PRIOR TO LEVELING COURSE

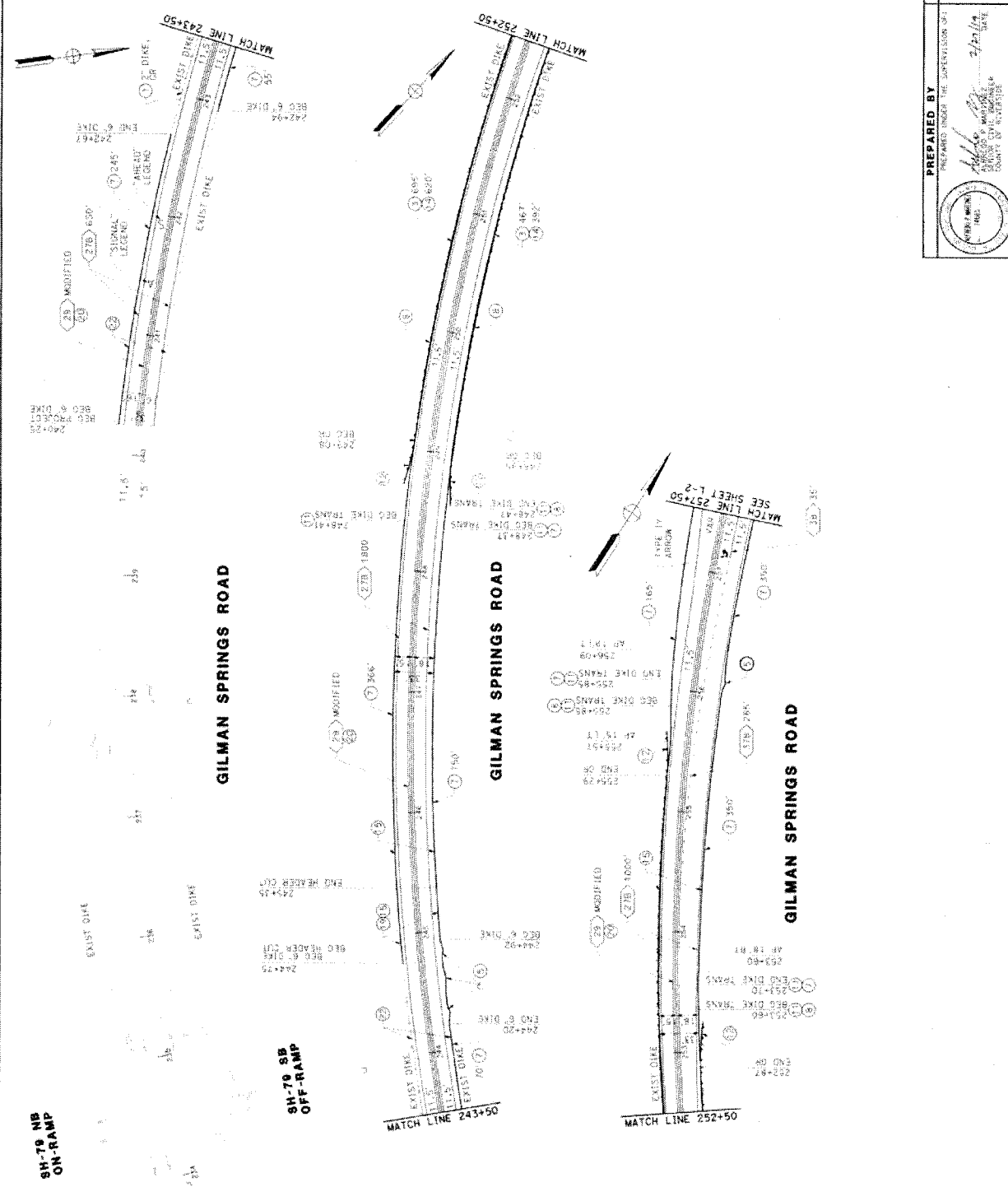

<p>PREPARED BY</p> <p>PREPARED UNDER THE SUPERVISION OF</p> <p><i>[Signature]</i></p> <p>STATE OF CALIFORNIA</p> <p>COUNTY OF SACRAMENTO</p>	<p>LAYOUT</p>	SHEET NO.
		<p>GILMAN SPRINGS ROAD</p> <p>RESURFACING</p> <p>240+25 TO 257+50</p>

ISSUANCE: 08/14/2013 10:00 AM
 COUNTY: SACRAMENTO
 FILE NO.: 966 - QQ

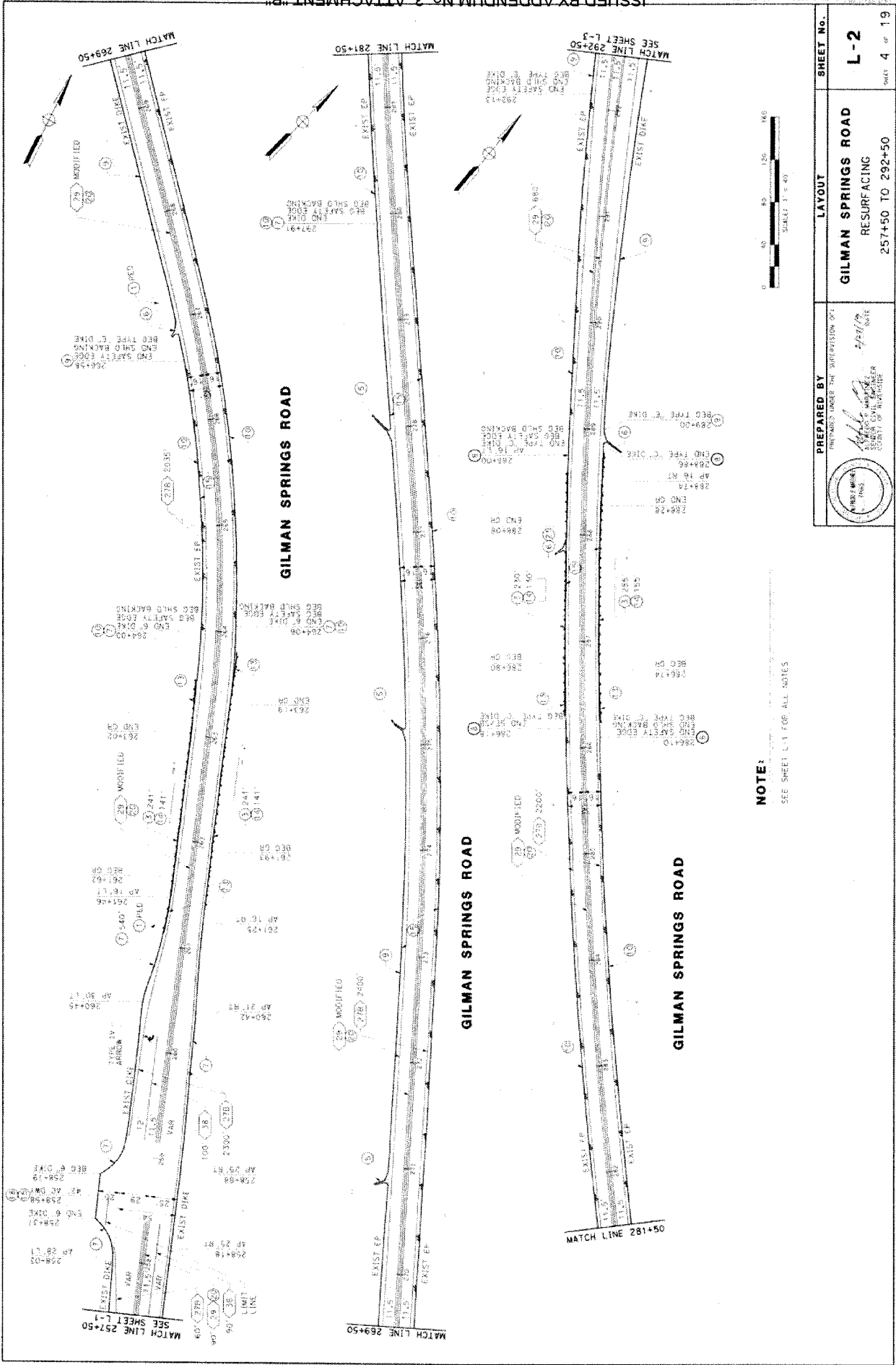

NOTE:
SEE SHEET L-1 FOR ALL NOTES

	PREPARED BY DAVID L. SMITH CIVIL ENGINEER STATE OF MISSOURI	LAYOUT GILMAN SPRINGS ROAD RESURFACING 257+50 TO 292+50	SHEET NO. L-2 SHEET 4 OF 19
	APPROVED UNDER THE SUPERVISION OF: 	PROJECT NO. 2009-0059 DATE: 11/11/09	DRAWN BY: J. H. [unclear] CHECKED BY: [unclear]

ISSUED BY ADDENDUM NO. 3, ATTACHMENT "B"

ISSUED BY ADDENDUM NO. 3, ATTACHMENT B

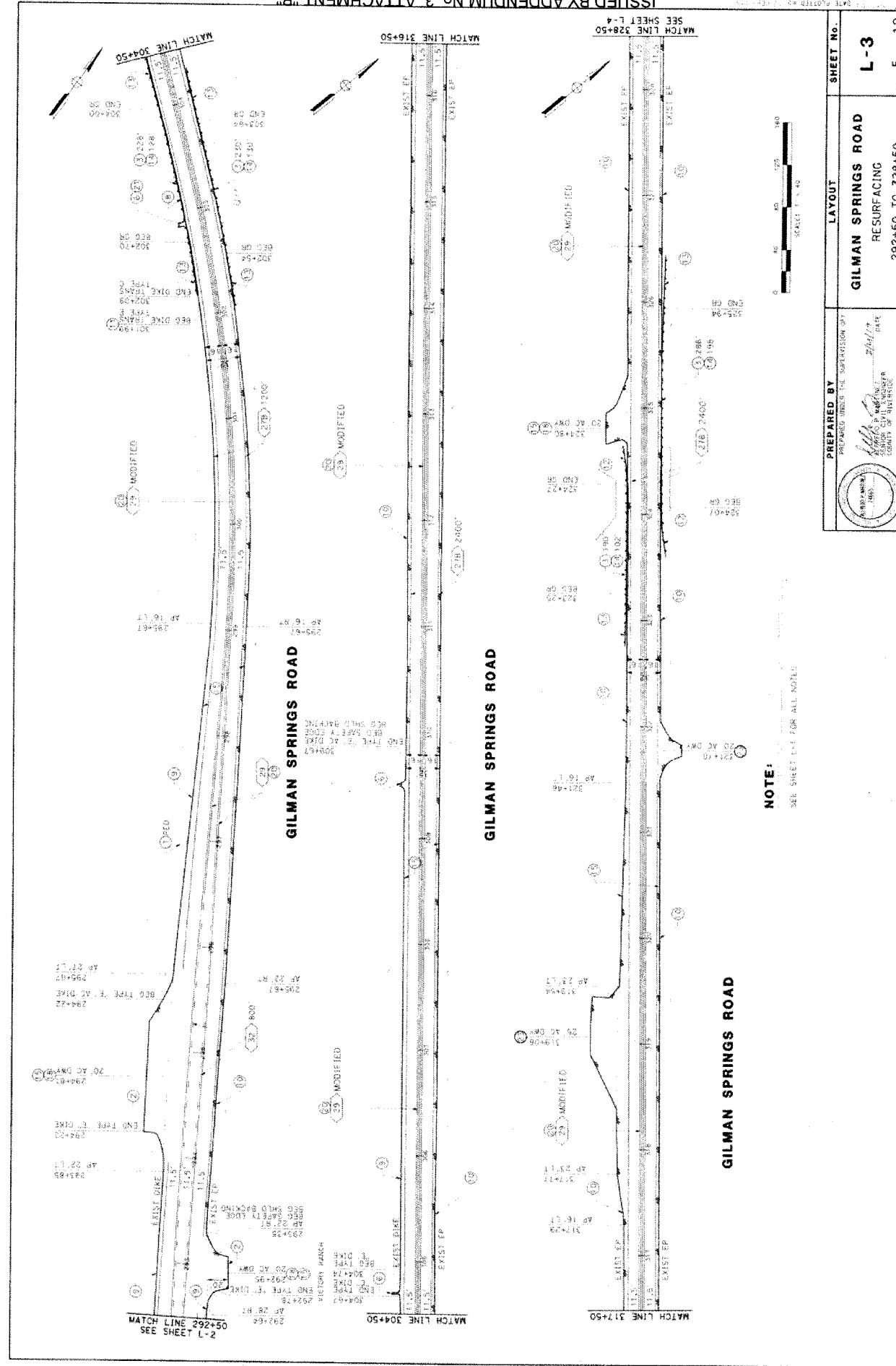

PREPARED BY
 PROJECT UNDER THE SUPERVISION OF
 [Signature]
 SENIOR CIVIL ENGINEER
 COUNTY OF ALABAMA

LAYOUT
GILMAN SPRINGS ROAD
 RESURFACING
 292+50 TO 328+50

SHEET NO.
L-3
 OF 5

WG 09-0059
 COUNTY FILE NO. 966-QQ

NOTE:
 SEE SHEET L-4 FOR ALL NOTES

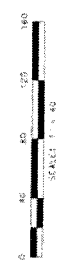

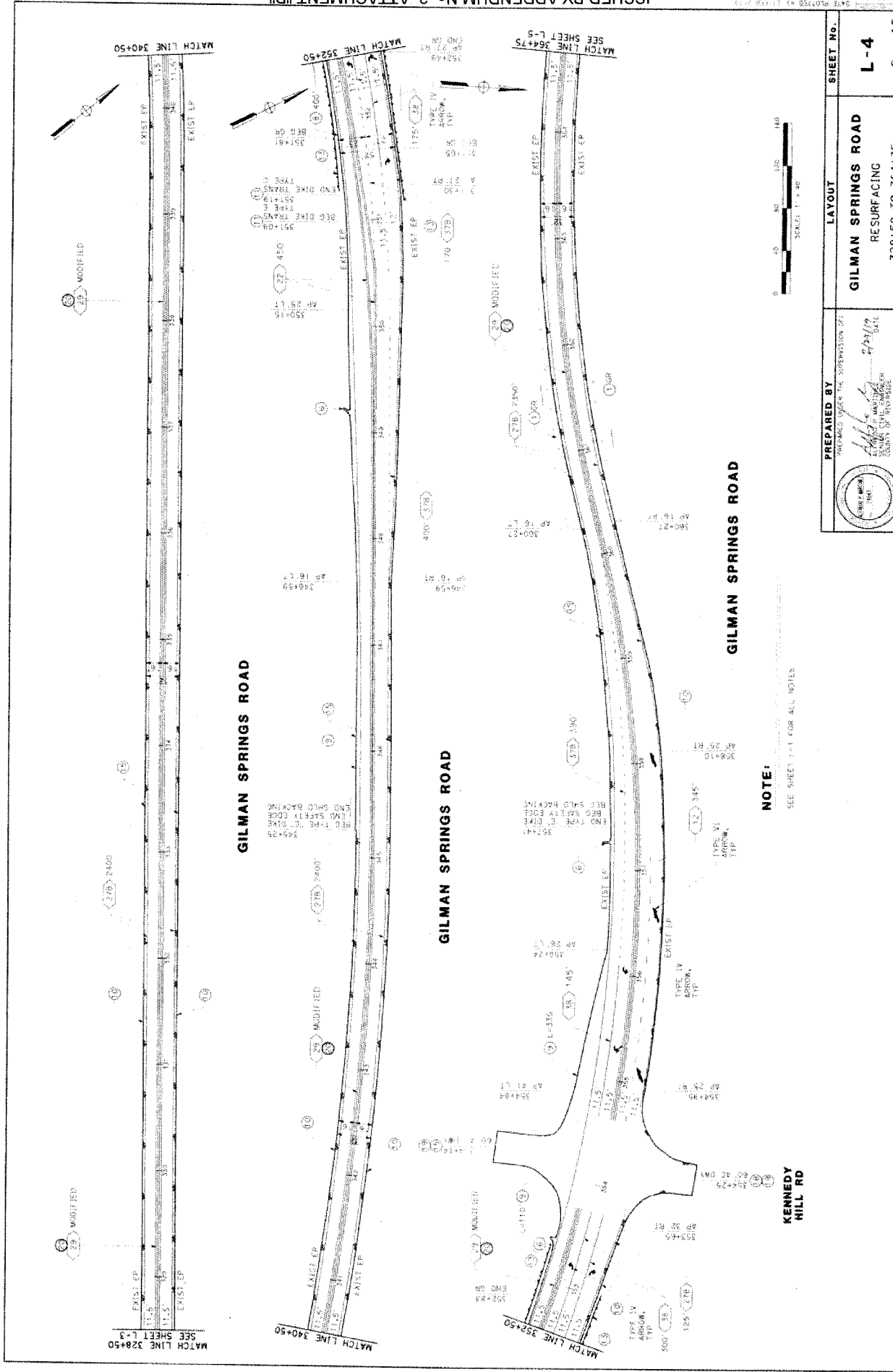

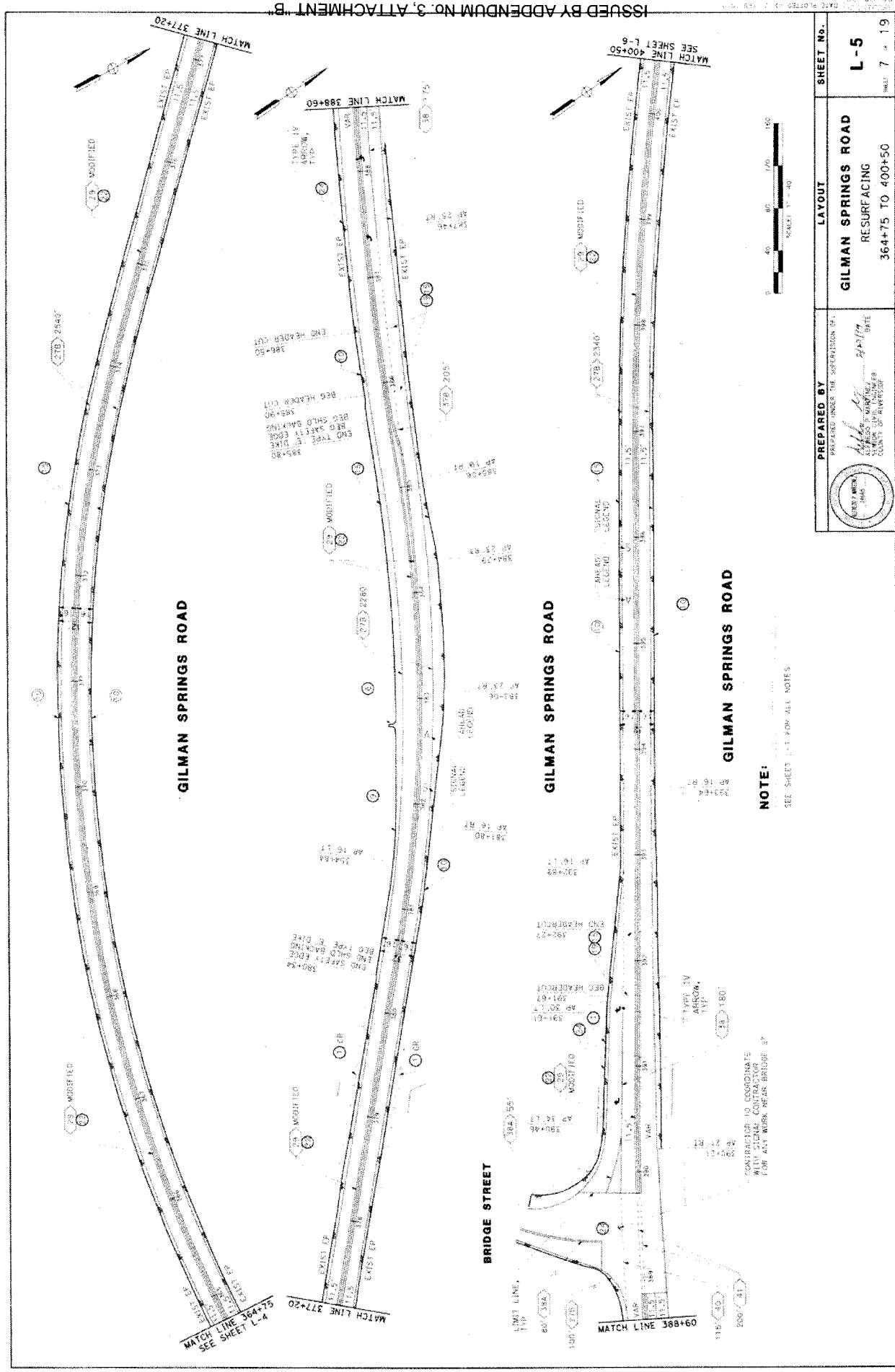

ISSUED BY ADDENDUM NO. 3, ATTACHMENT B

	PREPARED BY PREPARED UNDER THE SUPERVISION OF GARY L. MARKLEY LICENSED PROFESSIONAL ENGINEER STATE OF TENNESSEE COUNTY OF ANDEWER	LAYOUT GILMAN SPRINGS ROAD RESURFACING 364+75 TO 400+50	SHEET No. L-5 SHEET 7 OF 19	
	PROJECT NO. 40 09-0069 COUNTY FILE NO. 666-QQ	DATE: 11/19/19 DRAWN BY: J. H. [unreadable]	CHECKED BY: [unreadable]	SCALE: 1" = 40' 0 20 40 60 80 100 120 140 160 180
	NOTE: SEE SHEET L-1 FOR ALL NOTES			CONTRACTOR TO COORDINATE WITH TIDAKA CONSULTING ENGINEERS FOR ANY WORK NEAR BRIDGE #7

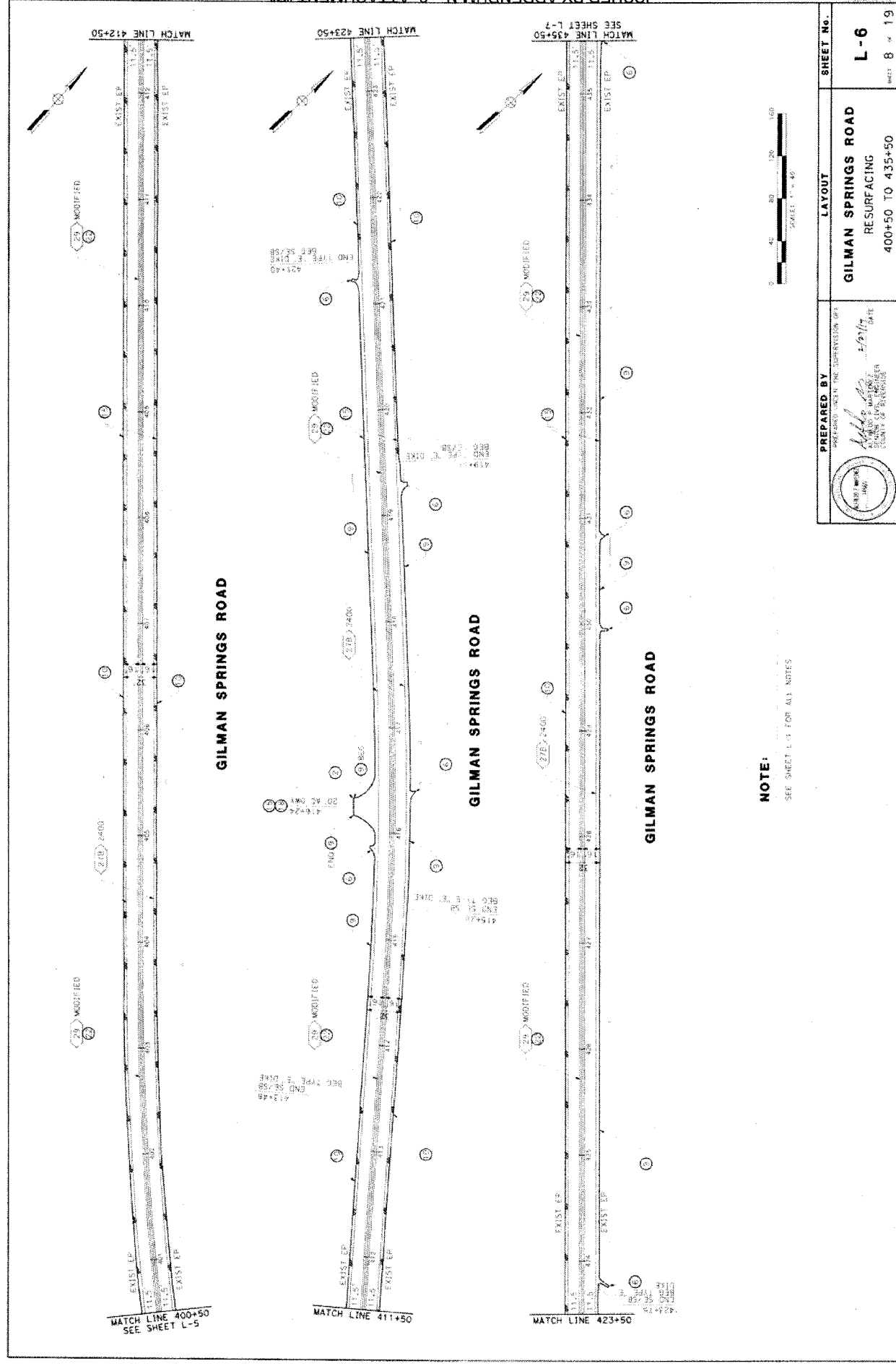

PREPARED BY: [Signature]
 CHECKED BY: [Signature]
 COUNTY OF HENRICO
 COUNTY ENGINEER

LAYOUT

GILMAN SPRINGS ROAD
 RESURFACING
 400+50 TO 435+50

SHEET NO.
 L-6
 SHEET 8 OF 19

PROJECT NO. 99-0259
 FILE NO. 966-QQ

NOTE:
SEE SHEET L-1 FOR ALL NOTES

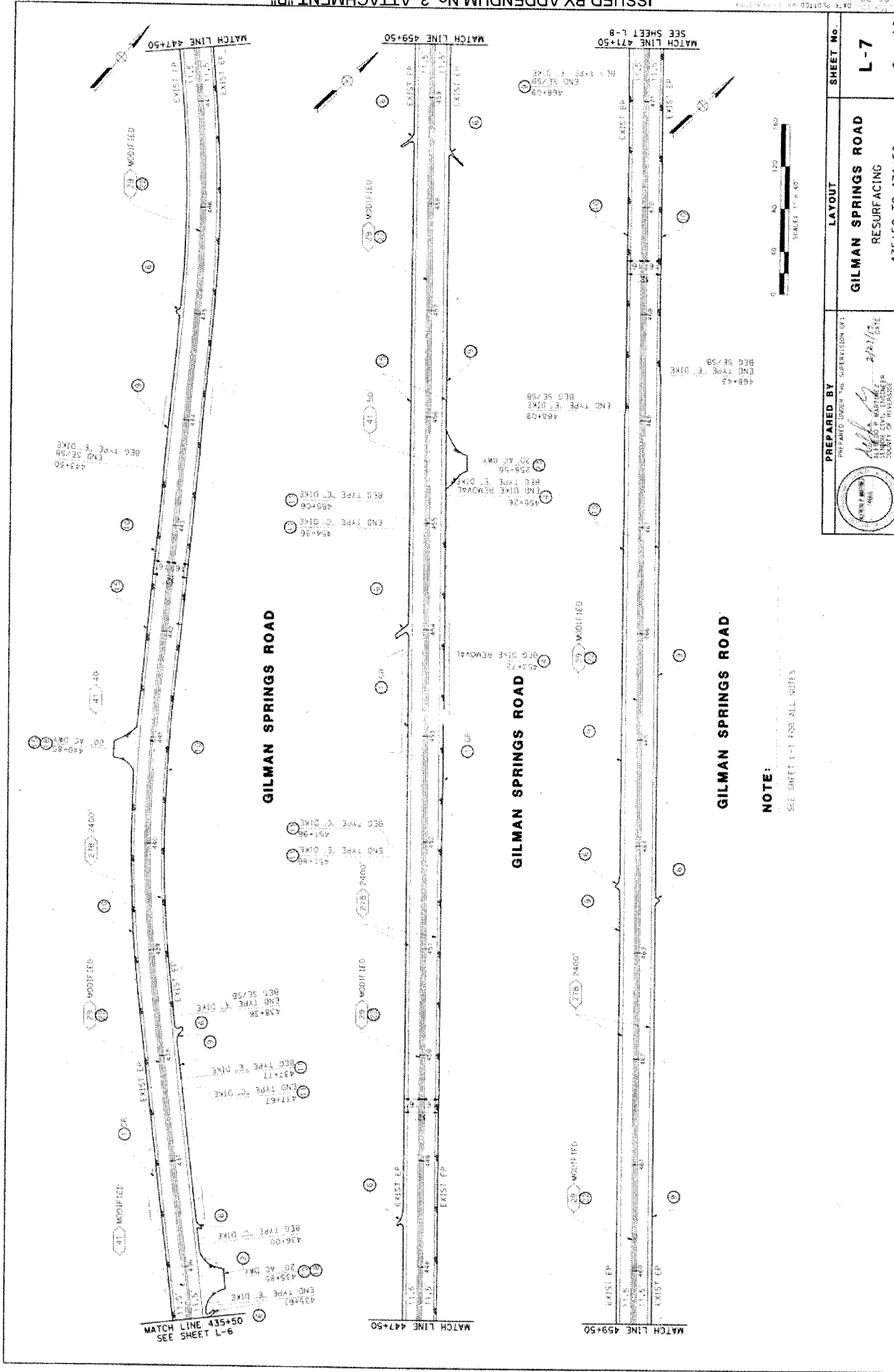

NOTE:
SEE SHEET 1-1 FOR ALL NOTES

	PREPARED BY PROPERTY OWNER'S SUPERVISOR (PT)	SHEET NO. L-7
	LAYOUT GILMAN SPRINGS ROAD RESURFACING 435+50 TO 471+50	DATE 2/21/12

COUNTY FILE NO. 966-QQ
 PROJECT FILE NO. 100-0059

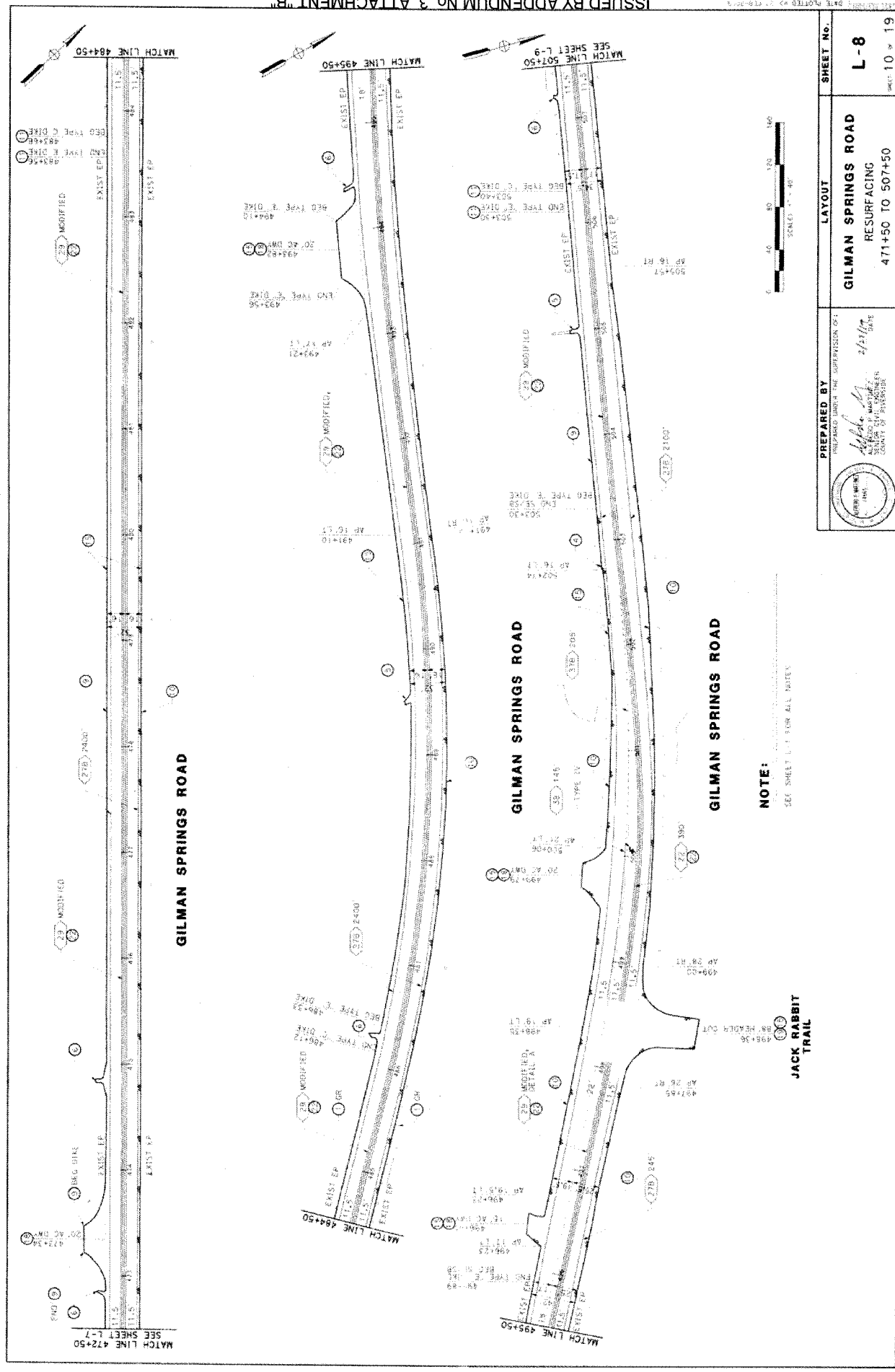

	PREPARED BY THE SUPERVISOR OF: David L. Smith SUPERVISOR COUNTY OF MISSOURI	LAYOUT	SHEET No.
	GILMAN SPRINGS ROAD RESURFACING 471+50 TO 507+50		L-8

COUNTY FILE No. 966 - QQ
 DRAWING FILE NO. 200-0059
 SHEET 10 OF 19

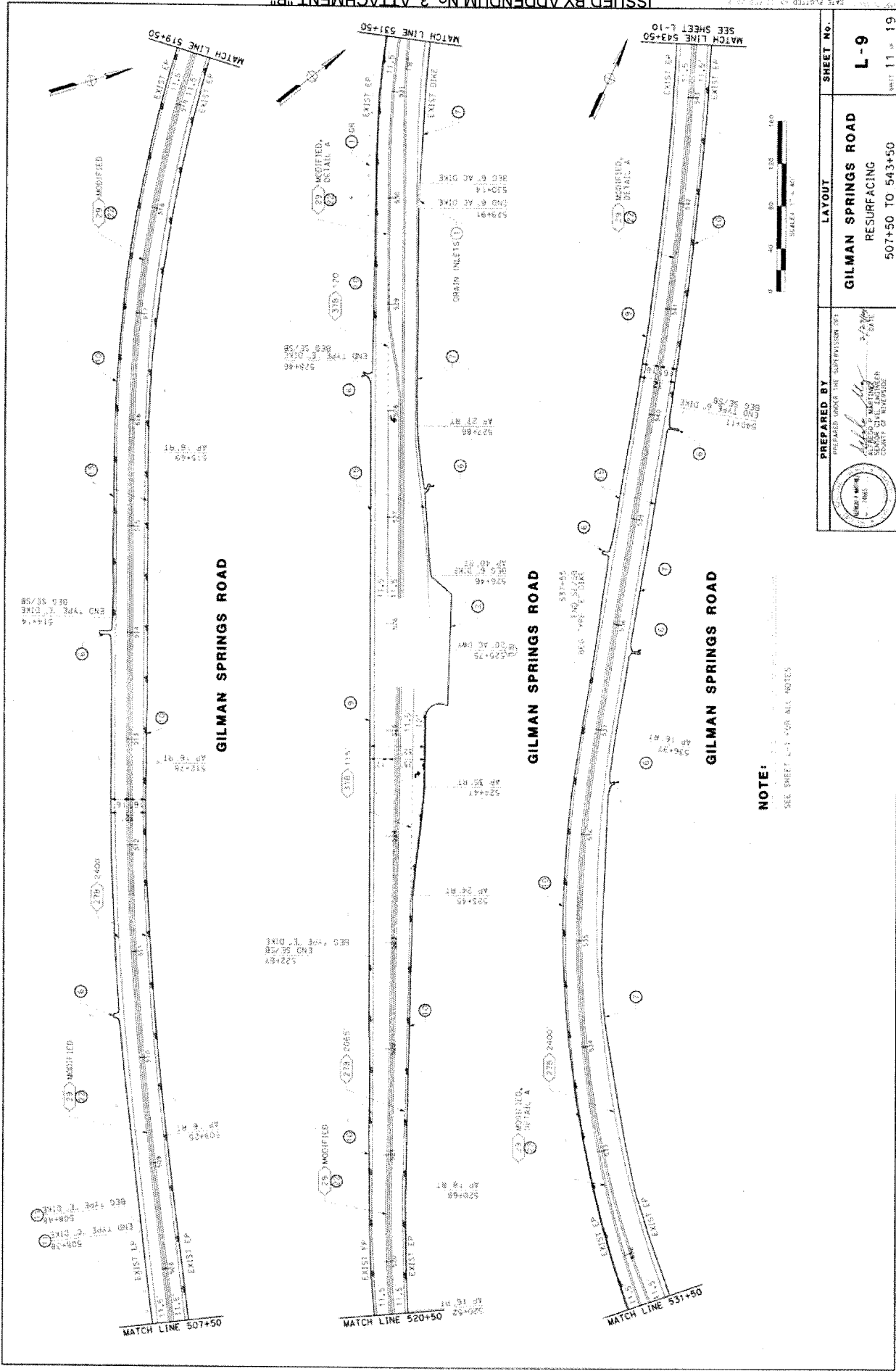

	PREPARED BY PREPARED UNDER THE SUPERVISION OF JAMES H. ... SENIOR CIVIL ENGINEER COUNTY OF TENNESSEE	LAYOUT GILMAN SPRINGS ROAD RESURFACING 507+50 TO 543+50	SHEET NO. L-9 OF 11
	PROJECT NO. 966-QQ DATE PLOTTED 11/19/19	COUNTY OF TENNESSEE FILE NO. 966-QQ	SHEET 11 OF 19

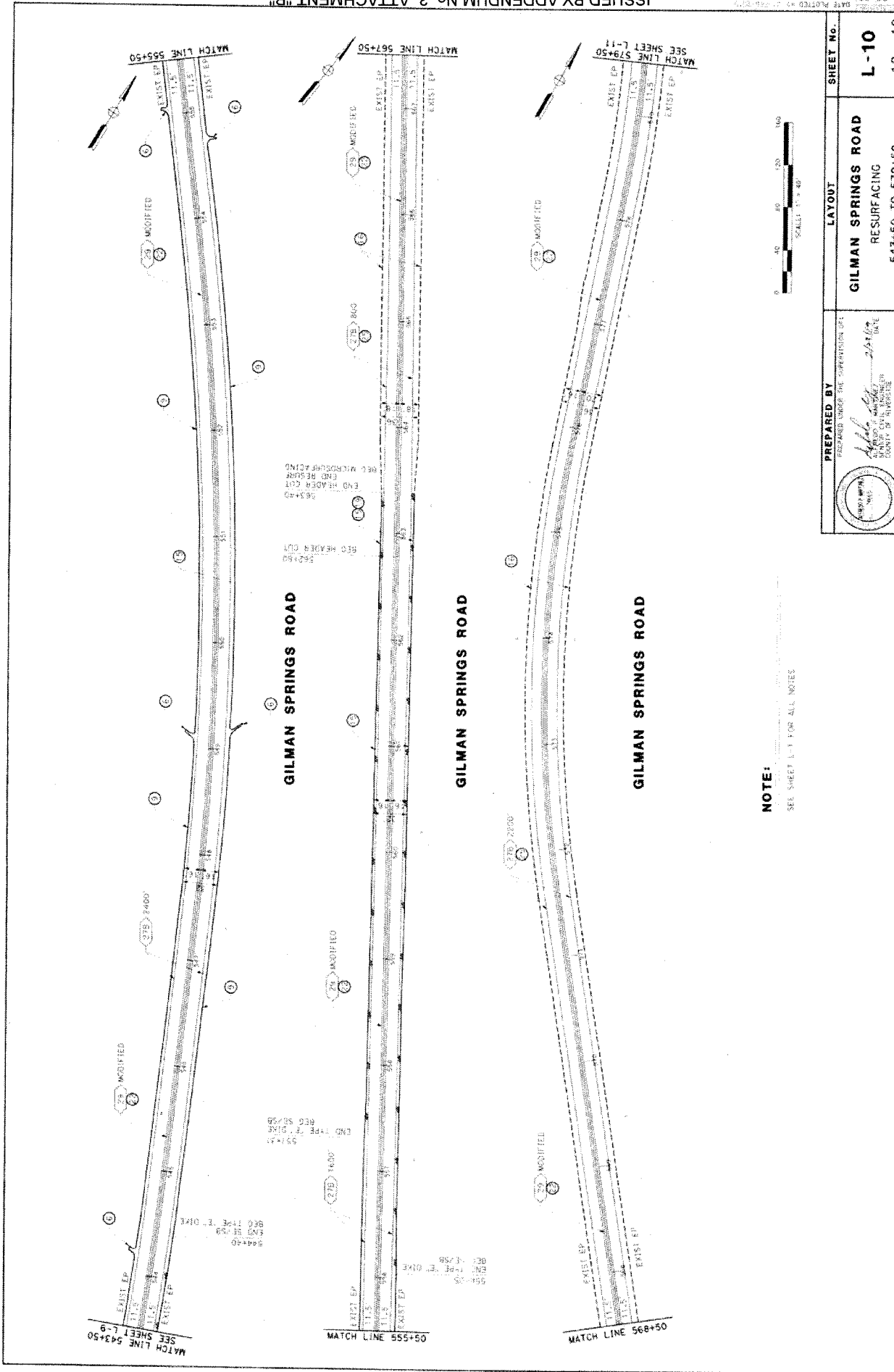

PREPARED BY [Signature] STATE OF NEW JERSEY COUNTY OF MERCER COUNTY OF PLUMMER	LAYOUT	SHEET NO.
	GILMAN SPRINGS ROAD RESURFACING 543+50 TO 579+50	L-10 Sheet 12 of 19

CONTRACT NO. 96B-09-RUS9
 COUNTY FILE NO. 96B-09-RUS9
 COUNTY FILE NO. 96B-09-RUS9

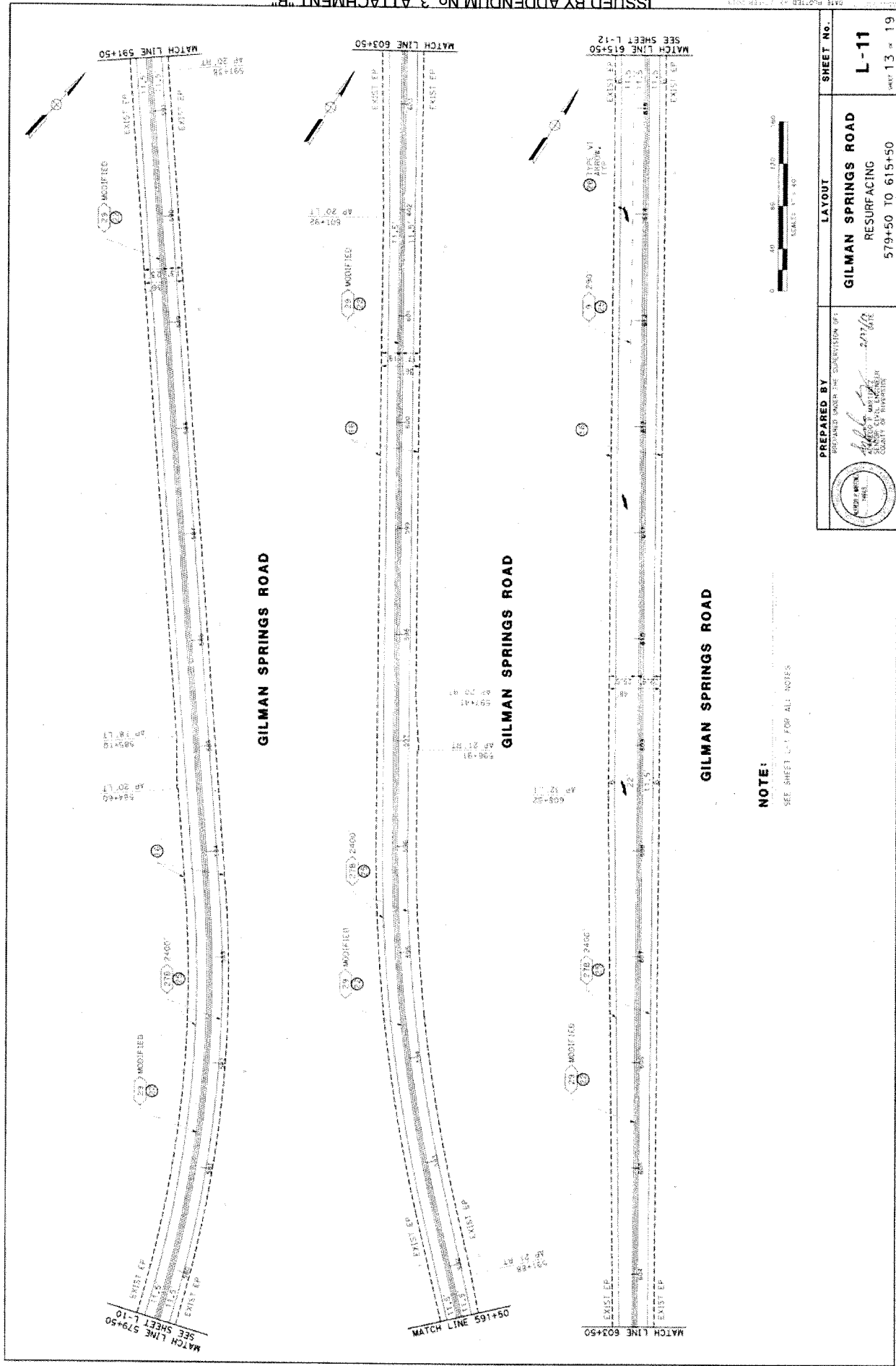

NOTE:
SEE SHEET L-1 FOR ALL NOTES

	PREPARED BY JAMES L. LINDER SENIOR CIVIL ENGINEER COUNTY OF HENDEKE	LAYOUT GILMAN SPRINGS ROAD RESURFACING 579+50 TO 615+50	SHEET NO. L-11 OF 13
	PROJECT NO. 27-0059 DON FILE # 17-0559 (01/11/03)		COUNTY FILE NO. 966 - QQ

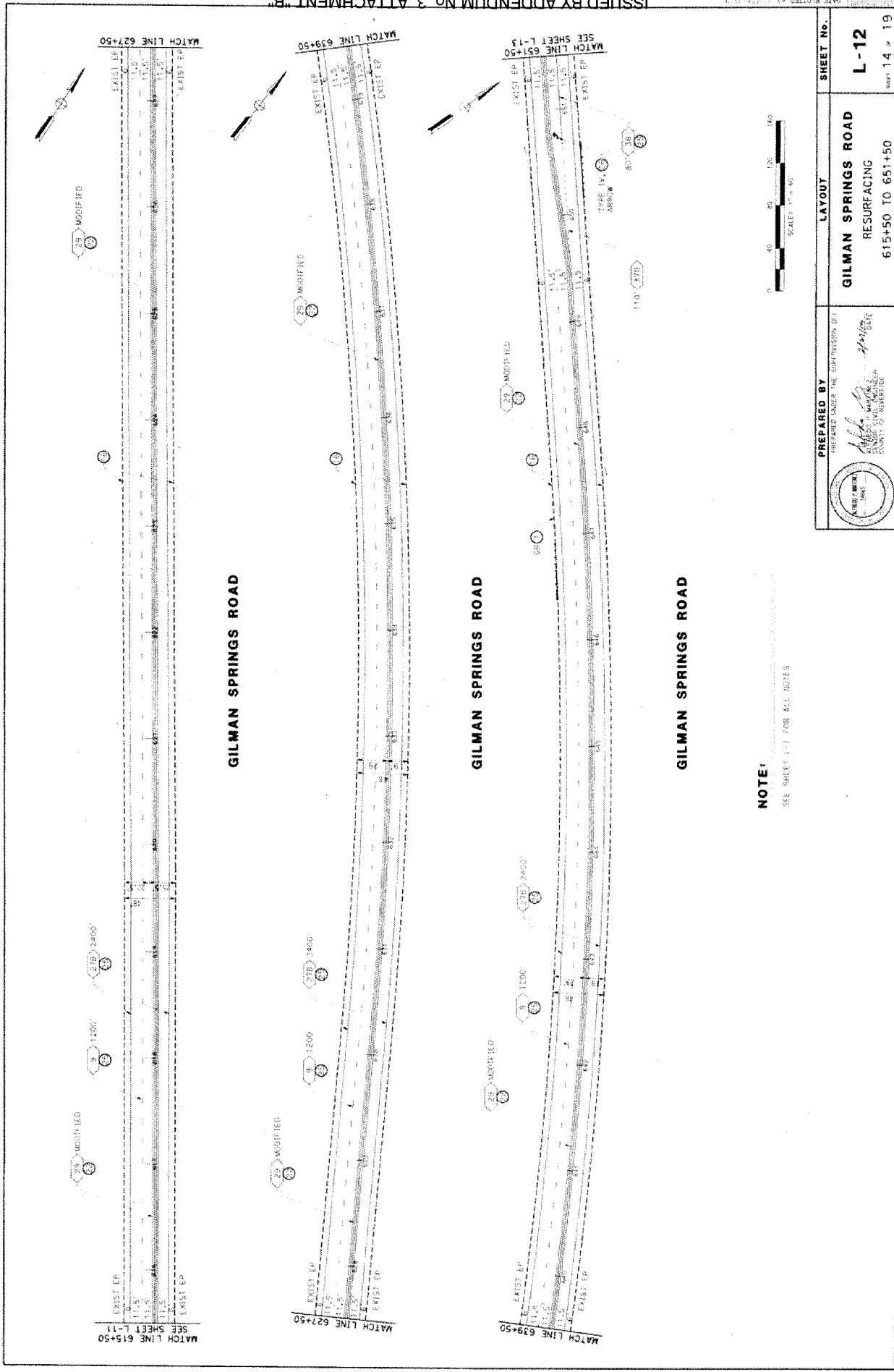

NOTE:
SEE SHEET L-1 FOR ALL NOTES

 PREPARED BY ROBERT J. GALT PROFESSIONAL ENGINEER STATE OF TENNESSEE LICENSE NO. 22547	LAYOUT GILMAN SPRINGS ROAD RESURFACING 615+50 TO 651+50	SHEET No.
		L-12

DATE PLOTTED: 03/11/10
 FILE NO.: 966-QQ
 SHEET 14 OF 19
 PROJECT NO.: 09-0059

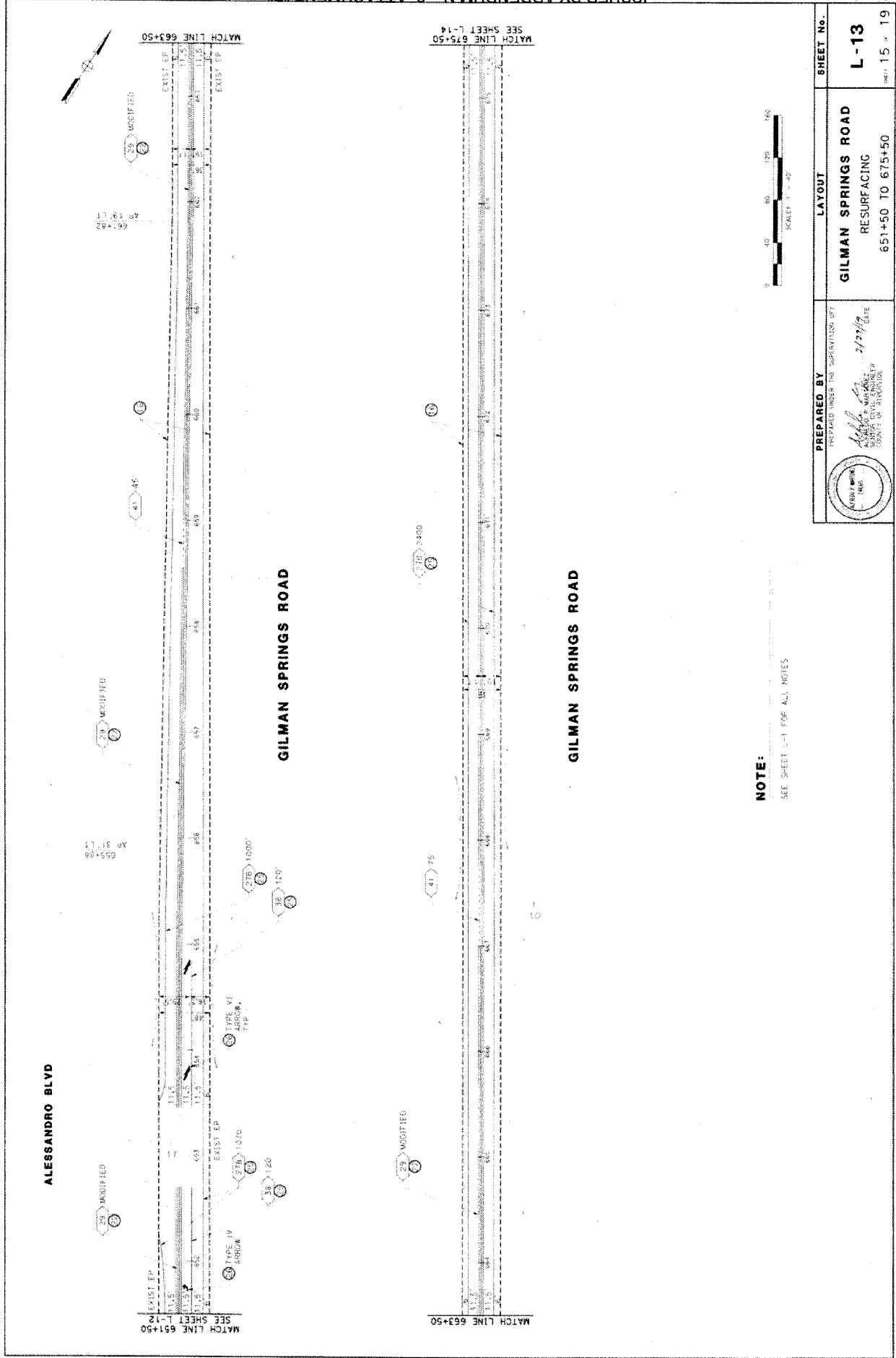

NOTE:
SEE SHEET L-1 FOR ALL NOTES

PREPARED BY
 PREPARED UNDER THE SUPERVISION OF
 [Signature]
 [Stamp]
 COUNTY OF [Blank]
 STATE OF [Blank]

LAYOUT
GILMAN SPRINGS ROAD
 RESURFACING
 651+50 TO 675+50

SHEET No.
L-13
 SHEET 15 OF 19

PROJECT NO. 966 - QQ

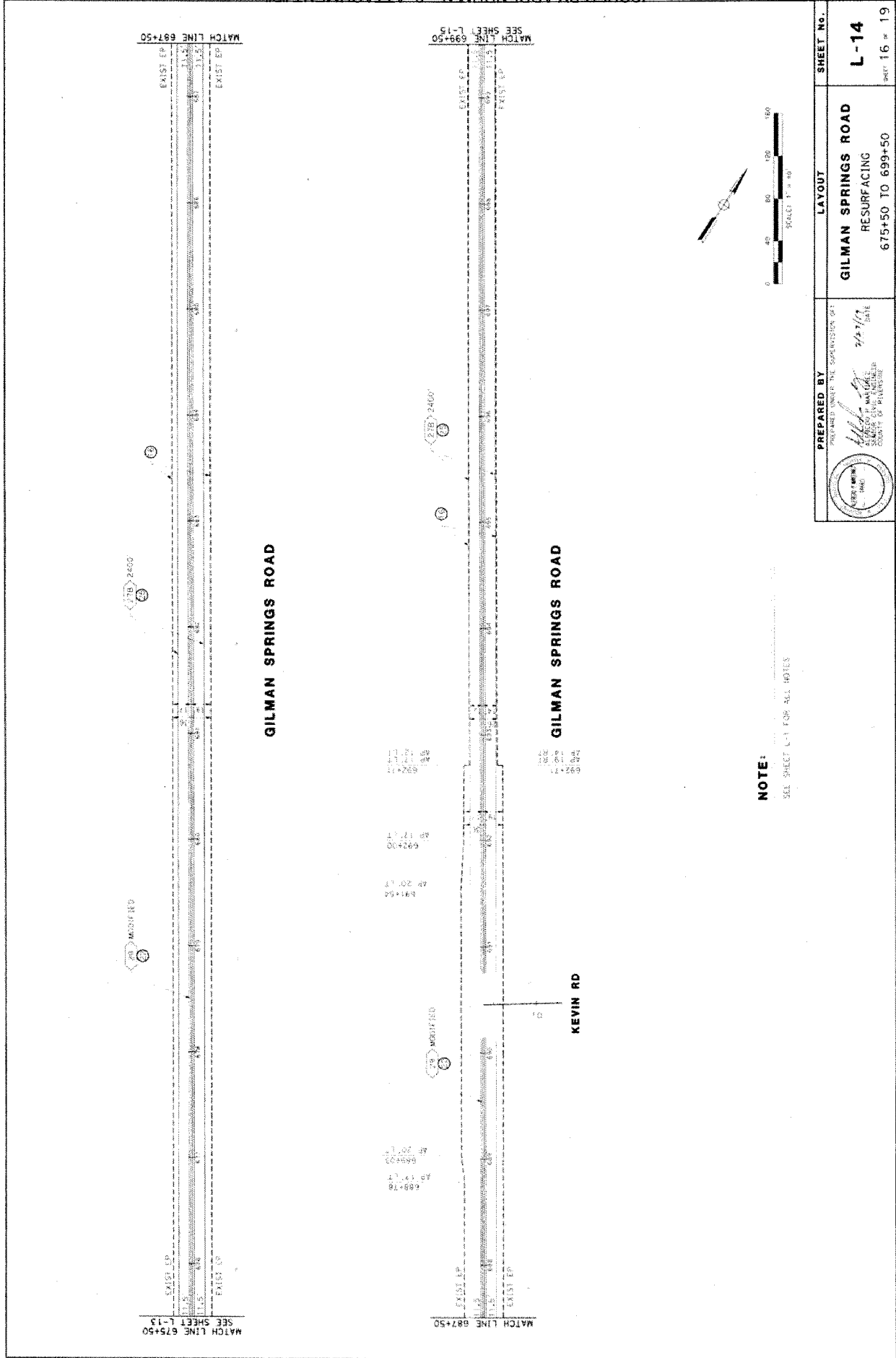

NOTE:
 SEE SHEET L-1 FOR ALL NOTES

	PREPARED BY KEVIN J. ... STATE OF MISSOURI COUNTY OF ...	DATE 11/11/10	PREPARED UNDER THE SUPERVISION OF ... DATE ...	SHEET NO. L-14 OF 19
	LAYOUT GILMAN SPRINGS ROAD RESURFACING 675+50 TO 699+50			PROJECT NO. 966-QQ

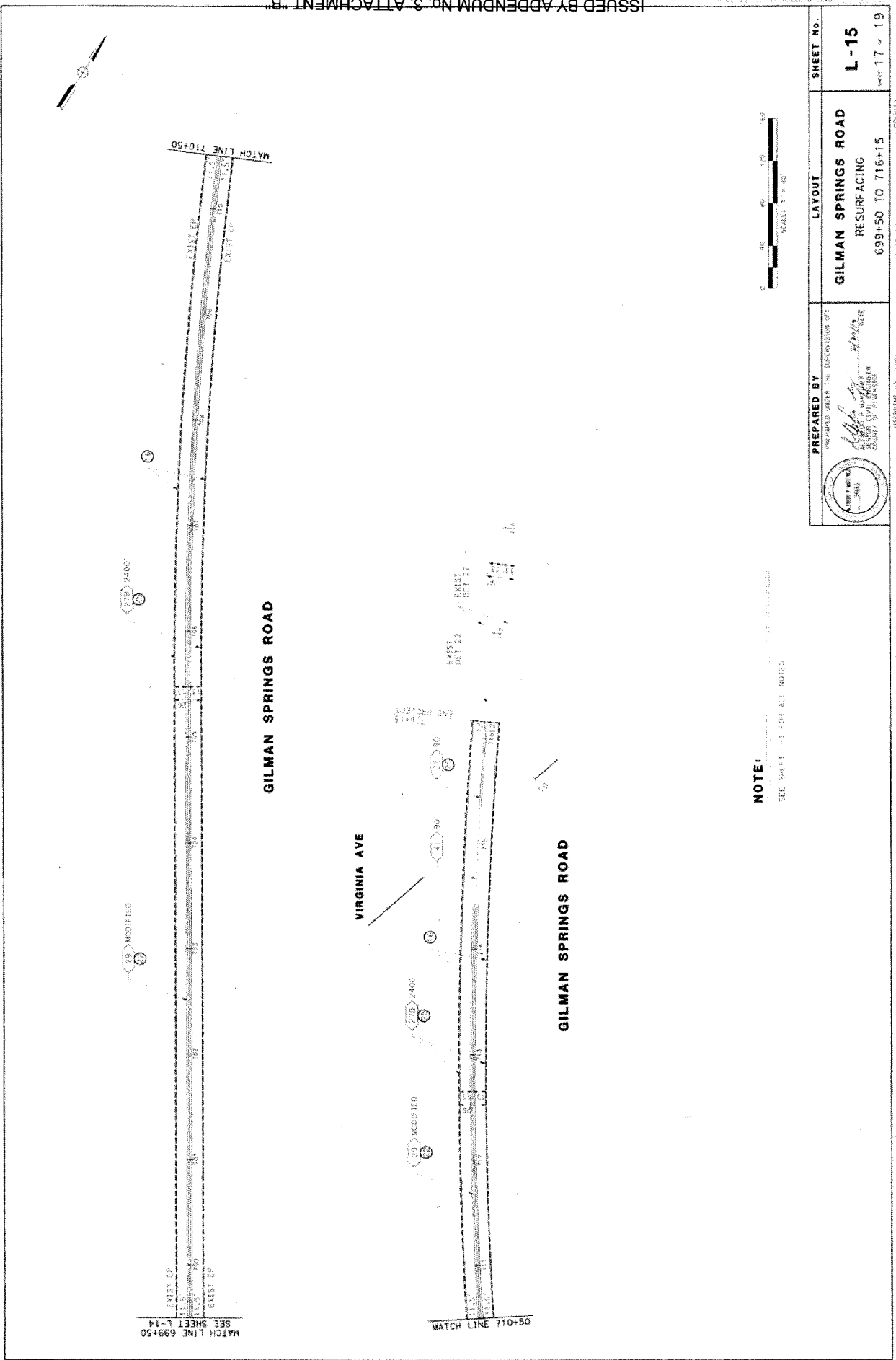

PREPARED BY

 DAVID J. HINKLE
 STATE OF TENNESSEE
 LICENSE NO. 28174

LAYOUT
 GILMAN SPRINGS ROAD
 RESURFACING
 699+50 TO 716+15

SHEET NO.
 L-15
 SHEET 17 OF 19

PROJECT NO. 966-008
 COUNTY FILE NO. 966-QQ

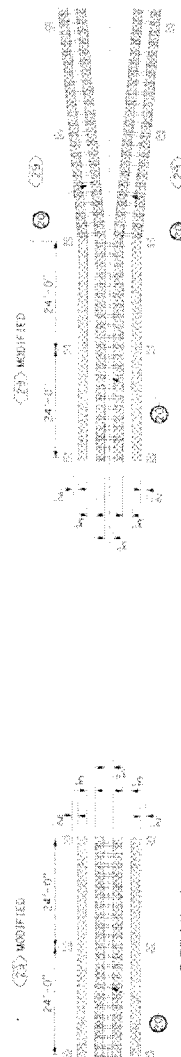

DETAIL A

STRIPING TRANSITION DETAIL B

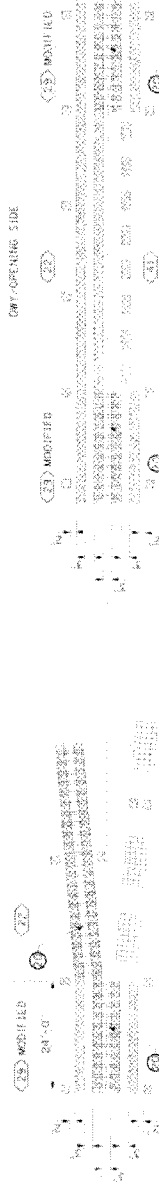

STRIPING TRANSITION DETAIL C

DRIVEWAY OPENING STRIPING DETAIL D



OMIT POSTS DETAIL

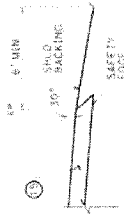

SAFETY EDGE AND SHOULDER BACKING DETAIL

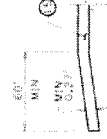

HEADER CUT DETAIL ALONG DRAIN AND SIDE STREETS

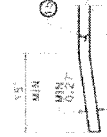

HEADER CUT DETAIL PARADES



PREPARED BY: THE SUPERVISOR OF HIGHWAYS
 COUNTY OF HENRICO
 COUNTY OF RESURFACING

CONSTRUCTION DETAILS
 GILMAN SPRINGS ROAD
 RESURFACING
 NO SCALE

SHEET NO.
 C-1
 SHEET 18 OF 19

PROJECT FILE NO. 966 - QQ
 WDC 09-0008

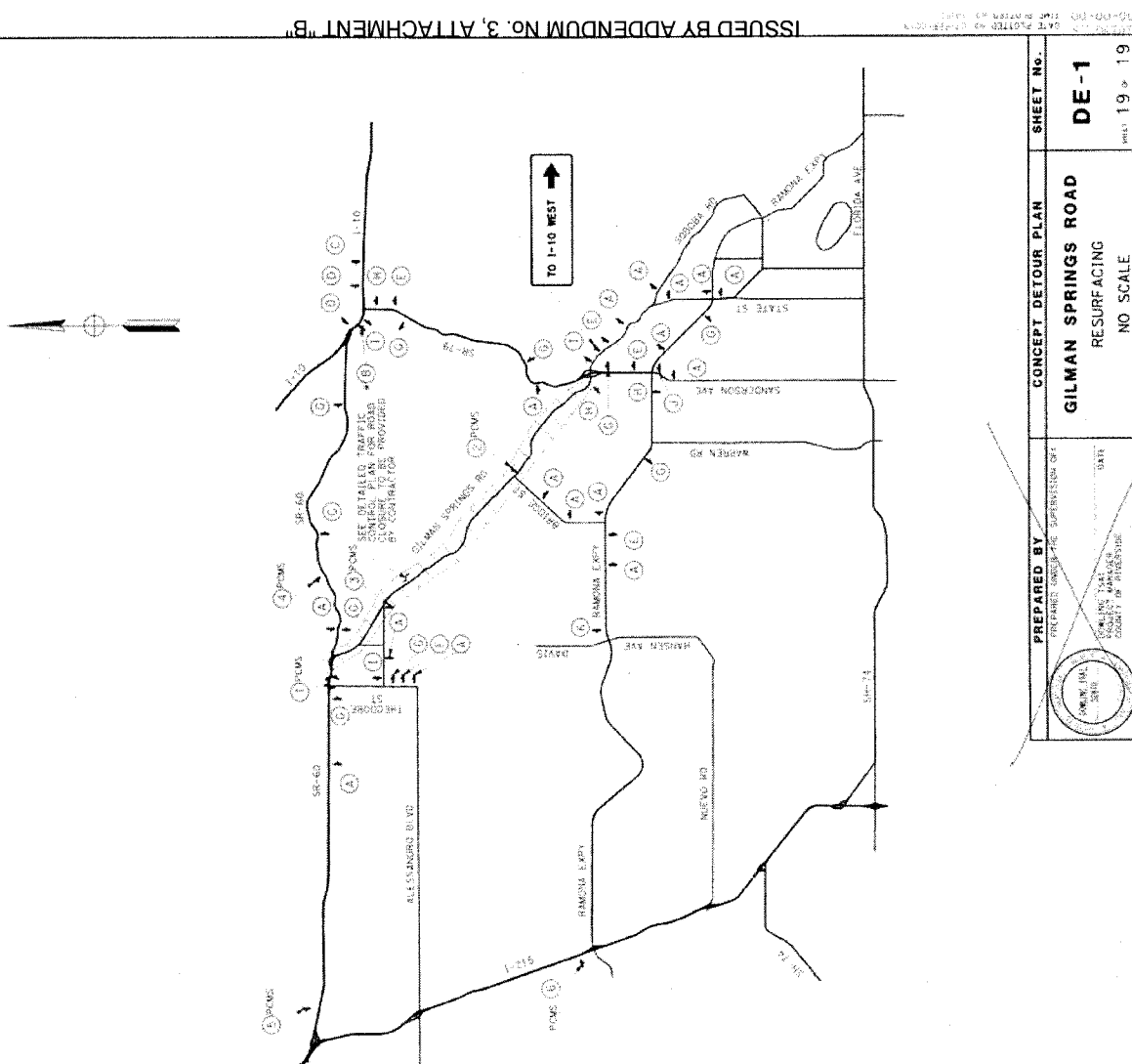

- 6. GILMAN SPR RD CLOSED
SR-60
LOCAL TRAFFIC ONLY
SPECIAL "A"
- 8. GILMAN SPRINGS RD
DETOUR NEXT EXIT
SPECIAL "B"
- 8. GILMAN SPRINGS RD
WEST OF ROUTE 79
CLOSED
SPECIAL "C"
- 5. GILMAN SPRINGS RD
DETOUR
USE RTE 66 WEST
SPECIAL "D"
- 5. GILMAN SPRINGS RD
DETOUR
USE I-10 WEST
SPECIAL "E"
- 5. GILMAN SPRINGS RD
DETOUR
LOCAL TRAFFIC ONLY
SPECIAL "F"
- 5. GILMAN SPRINGS RD
DETOUR
USE I-10 (RT)
M4-10 (RT)
SPECIAL "G"
- 5. GILMAN SPRINGS RD
DETOUR
SPECIAL "H"
M4-10 (LT)
- 5. GILMAN SPRINGS RD
DETOUR
SPECIAL "I"
M4-10 (RT)
- 5. GILMAN SPRINGS RD
DETOUR
SPECIAL "J"
M4-10 (LT)
- 5. GILMAN SPRINGS RD
DETOUR
SPECIAL "K"

NOTES:
1. SIGNED CHANGEABLE MESSAGE SIGN 14 DAYS PRIOR TO ROAD CLOSURE.
2. SIGN SHOULD STATE CLOSURE DATES.

- LOCATION 1: GILMAN SPRINGS RD, EASTBOUND TRAFFIC
- LOCATION 2: GILMAN SPRINGS RD, SOUTH OF BRIDGE TRAFFIC
- LOCATION 3: ALESSANDRO BLVD, WEST OF GILMAN SPRINGS RD, EASTBOUND TRAFFIC
- LOCATION 4: SR 60, EAST OF GILMAN SPRINGS RD, EASTBOUND TRAFFIC
- LOCATION 5: SR 60, EAST OF GILMAN SPRINGS RD, WESTBOUND TRAFFIC
- LOCATION 6: I-210, NORTH OF I-210, WESTBOUND TRAFFIC
- LOCATION 7: I-210, SOUTH OF I-210, SOUTHBOUND TRAFFIC

- 2. MINIMUM LETTER SIZE FOR SPECIAL SIGNS ON LOCAL STREETS SHALL BE 6 INCHES. SERIES "A" BLACK LETTERS ON WHITE BACKGROUND.
- 3. MINIMUM LETTER SIZE FOR SPECIAL SIGNS ON SR-79, I-115, SR-60 SHALL BE 10 INCHES. SERIES "B" BLACK LETTERS ON BLACK BACKGROUND.
- 4. EXCEPT WHERE SHOWN OTHERWISE, ALL SIGN LETTERS SHALL BE 1/8" HIGH.
- 5. ALL SIGNS SHALL CONFORM WITH 2014 CEA MUTCD.

PREPARED BY: [Redacted]
 CHECKED BY: [Redacted]
 DATE: [Redacted]
 COUNTY: [Redacted]

CONCEPT DETOUR PLAN SHEET NO. DE-1
 GILMAN SPRINGS ROAD RESURFACING
 NO SCALE

ISSUED BY APPENDUM NO. 3, ATTACHMENT B

DATE PLOTTED: 03/12/2014 10:00:00 AM
 FILE: I:\PROJECTS\2014\2014_03_12\GILMAN SPRINGS RD\GILMAN SPRINGS RD_DETOUR_PLAN_DE-1.dwg



Patricia Romo, P.E.
Director of Transportation

COUNTY OF RIVERSIDE

TRANSPORTATION AND LAND MANAGEMENT AGENCY

Mojahed Salama, P.E.
Deputy for Transportation/Capital Projects
Richard Lantis, P.L.S.
Deputy for Transportation/Planning and
Development

Transportation Department

ADDENDUM NUMBER 4

Dated March 7, 2019

to the
Specifications and Contract Documents
for the construction of

North Indian Canyon Drive
Widening Project Phase 1
20th Avenue to 18th Avenue
Cities of Palm Springs and Desert Hot Springs
Project No. C6-0089; and

Gilman Springs Road
Resurfacing Project
Moreno Valley City Limit to State Highway 79
Gilman Hot Springs Area
Project No. C9-0059

Bids Due: Wednesday, March 13, 2019; 2:00 p.m.
14th Street Transportation Annex
3525 14th Street; Riverside, CA 92501
(951) 955-6780

This Addendum is issued pursuant to the Instructions to Bidders, Item No. 8, of the Contract Documents for the reference project. This Addendum is issued as a supplement to the specification and special provisions for the referenced project. The revisions to the specifications shall become a part of the Contract Documents, and each bidder shall acknowledge receipt thereof on the Bid (Proposal). Bidders are directed to sign this addendum as acknowledged and attach the signed addendum to the contractor's submitted proposal.

Note: During the advertisement period of this project, this document and attachments (if any) are available upon request at the office of the Transportation Department, and are available as a free download at the Transportation Department's website:

<http://rctlma.org/trans/Contractors-Corner/Notices-Inviting-Bids>

MODIFICATIONS / CLARIFICATIONS TO THE PLANS

Item 1: Plan sheet revision. Refer to Gilman Springs Road plans, sheet 19 of 19, DE-1, Concept Detour Plan, issued by Addendum No. 3, Item No. 39. Delete plan sheet 19 of 19 (DE-1) and replace it with revised plan sheet 19 of 19 incorporated by **Attachment "A"** and made a part hereby.

Note: All revised plan sheets are posted on the County website and are available for download during the advertisement period.

<http://rctlma.org/trans/Contractors-Corner/Notices-Inviting-Bids>

ATTACHMENTS

A – Revised Plan Sheet, 19 of 19, DE-1, Concept Detour Plan

Addendum No. 4
North Indian Canyon Drive, Widening Project Phase 1, 20th Avenue to 18th Avenue
Cities of Palm Springs and Desert Hot Springs, Project No. C6-0089; and
Gilman Springs Road, Resurfacing Project, Moreno Valley City Limit to State Highway 79
Gilman Hot Springs Area, Project No. C9-0059
March 7, 2019
Page 2 of 2

This addendum has been prepared under the direction of the following registered Civil Engineer(s):

Recommended by:

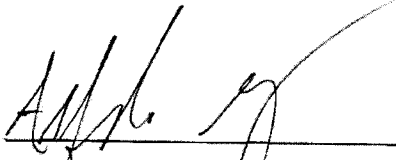

Alfredo Martinez, PE
Senior Civil Engineer

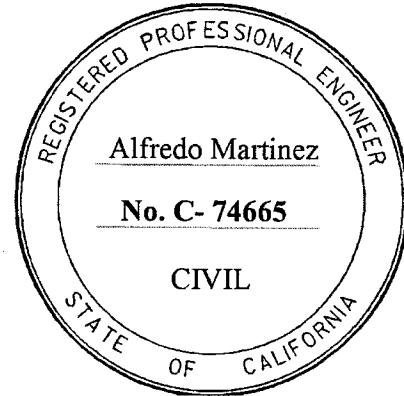

Concurrence:

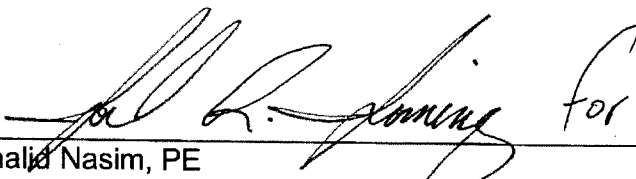

Khalid Nasim, PE
Engineering Division Manager

Acknowledged: _____ **Date:** _____
(Contractor)

JRJ: jrj:rr

Note: Refer to Instruction to Bidders Item No. 8, "Addenda". Submission of all addendum pages and non-bidding document attachments of addendum are not necessary for Bid submittal. Submittal of this acknowledgement page is adequate for Bid reception. Bidders are reminded to list addendum number(s) received on the first page of the Bid form (Proposal).

NOTES:
 1. DEPLOY, CHANGEABLE MESSAGE SIGN 14 DAYS PRIOR TO ROAD CLOSURE.
 1. SIGN SHOULD STATE CLOSURE DATES.

- LOCATION ①
 GILMAN SPRINGS RD
 EASTBOUND TRAFFIC
- LOCATION ②
 GILMAN SPRINGS RD
 SOUTH OF BRIDGE FACING
 NORTHBOUND TRAFFIC
- LOCATION ③
 ALESSANDRO BLVD WEST OF
 GILMAN SPRINGS RD FACING
 EASTBOUND TRAFFIC
- LOCATION ④
 SR 60 EAST OF
 BRIDGE FACING
 WESTBOUND TRAFFIC
- LOCATION ⑤
 SR 60 EAST OF
 I-215 FACING
 WESTBOUND TRAFFIC
- LOCATION ⑥
 I-215 NORTH OF
 BRIDGE FACING
 SOUTHBOUND TRAFFIC

2. MINIMUM LETTER SIZE FOR SPECIAL SIGNS ON LOCAL STREETS SHALL BE 6 INCHES,
 SERIES C, BLACK LEGEND ON ORANGE BACKGROUND.
 3. SERIES C, BLACK LEGEND ON ORANGE BACKGROUND.
 4. EXACT SIGN LOCATION TO BE DETERMINED BY THE ENGINEER.
 5. ALL SIGNS SHALL CONFORM WITH 2014 CA MUTCD.

8' GILMAN SPR RD USE SR-60 TO SR-79 SPECIAL "A" 10" FONTS ONLY	8' BRIDGE ST CLOSED LOCAL TRAFFIC ONLY SPECIAL "E"	8' GILMAN SPR RD WEST OF BRIDGE USE SR-79 SPECIAL "B" 10" FONTS ONLY	8' TO BRIDGE ST USE RAMONA EXPY SPECIAL "E"	8' GILMAN SPR RD WEST SR-60 USE SR-79 SPECIAL "J" 10" FONTS ONLY	8' BRIDGE ST DETOUR SPECIAL "N" M4-10 (ST)	8' TO ALESSANDRO BL THEODORE EXIT USE SPECIAL "D"	8' EAST ALESSANDRO BL CLOSED LOCAL TRAFFIC ONLY SPECIAL "C"	8' WEST SR-60 USE SR-79 SPECIAL "J" 10" FONTS ONLY	8' BRIDGE ST DETOUR SPECIAL "N" M4-10 (ST)	8' GILMAN SPR RD USE THEODORE EXIT SPECIAL "H" M4-10 (RT)	8' SR-60 DETOUR SPECIAL "K" M4-10 (ST)	8' BRIDGE ST DETOUR SPECIAL "P" M4-10 (LT)
--	--	---	---	---	--	---	---	--	--	--	--	--

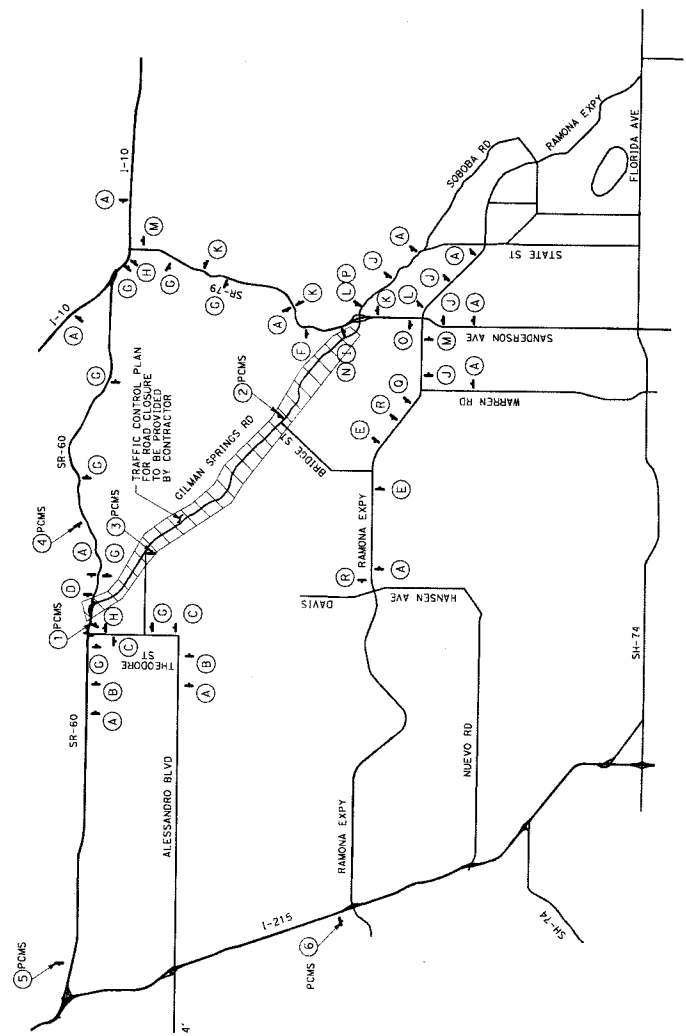
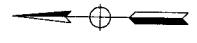

CONCEPT

DETOUR PLAN	SHEET NO.
GILMAN SPRINGS ROAD RESURFACING	DE-1
NO SCALE	SHEET 19 OF 19
WO C9-0069	COUNTY FILE NO. 966-QQ

RELATIVE BORDER SCALE
 15 IN INCHES
 0 1 2 3
 USERNAME → GRAMMS
 DGN FILE → C9-0069 mg DE-01.dwg

Bid

Date: 03/13/2019

To: County of Riverside, hereafter called "County";

Bidder: Granite Construction Company
(hereafter called "Contractor")

The undersigned, Contractor, having carefully examined the site and the Contract Documents for the construction of North Indian Canyon Drive, Widening Project Phase 1, 20th Avenue to 18th Avenue, Cities of Palm Springs and Desert Hot Springs, Project No. C6-0089 hereby proposes to construct the work in accordance with the Contract Documents, including **Addenda Number(s)** 1,2,3,4 (Fill in addenda numbers if addenda have been issued.) for the amount stated in this Bid.

By submitting this Bid, Contractor agrees with County:

1. That unless withdrawn in person by Contractor or some person authorized in writing by Contractor (not by telephone or facsimile) before the time specified in the Notice Inviting Bids for the public opening of bids, this Bid constitutes an irrevocable offer for 90 calendar days after that date.
2. County has the right to reject any or all Bids and to waive any irregularities or informalities contained in a Bid.
3. To execute the Contract and deliver the Performance Bond, Payment Bond and Insurance Certificate with endorsements, that comply with the requirements set forth in the Instruction to Bidders and General Conditions within ten (10) business days of the date of the Notice of Acceptance of Bid and Intent to Award as issued by the County.
4. That the contract shall be awarded upon a resolution or minute order to that effect duly adopted by the governing body of County; and that execution of the Contract shall constitute a written memorial thereof.
5. To submit to the County such information as County may require determining whether a particular Bid is the lowest responsible bid submitted.
6. That the accompanying Bid Bond, certified check or cashier's check is in an amount not less than 10% of the total bid submitted and constitutes a guarantee that if awarded the contract, Contractor will execute the Contract and deliver the required bonds within ten (10) business days after notice of award. If Contractor fails to execute and deliver said documents, the bond or check is to be charged with the costs of the resultant damages to the County, including but not limited to: publication costs, the difference in money between the amount bid and the amount in excess of the bid which it costs County to do or cause to be done for the work involved, lease and rental costs, additional salaries and overhead, increased interest and costs of funding the project, attorney expense, additional engineering and architectural expense and cost of maintaining or constructing alternate facilities occasioned by the failure to execute and deliver said documents.
7. By signing this Bid the Contractor certifies that the representations made therein are made under penalty of perjury.

North Indian Canyon Drive
Widening Project Phase 1
20th Avenue to 18th Avenue
Cities of Palm Springs and Desert Hot Springs
Project No. C6-0089; and

Gilman Springs Road
Resurfacing Project
Moreno Valley City Limit to State Highway 79
Gilman Hot Springs Area
Project No. C9-0059

REVISED PROPOSAL

ITEM No.	ITEM CODE	ITEM	Like Bid Item*	UNIT	ESTIMATED QUANTITY	ITEM PRICE (IN FIGURES)	TOTAL (IN FIGURES)
BASE BID SCHEDULE: North Indian Canyon Drive, Widening Project							
1	100100	DEVELOP WATER SUPPLY		LS	1	37,000 ⁹⁰	37,000 ⁹⁰
2	120100	TRAFFIC CONTROL SYSTEM		LS	1	80,000 ⁰⁰	80,000 ⁰⁰
3	130200	PREPARE WATER POLLUTION CONTROL PROGRAM		LS	1	5,000 ⁰⁰	5,000 ⁰⁰
4	170103	CLEARING AND GRUBBING		LS	1	10,000 ⁰⁰	10,000 ⁰⁰
5	066012	DUST ABATEMENT		LS	1	25,000 ⁰⁰	25,000 ⁰⁰
6	190101	ROADWAY EXCAVATION	Like 1	CY	2,410	39 ⁰⁰	93,990 ⁰⁰
7	190185	SHOULDER BACKING	Like 2	LF	3,110	2 ⁰⁰	6,220 ⁰⁰
8	260203	CLASS 2 AGGREGATE BASE	Like 3	CY	1,301	45 ⁰⁰	58,545 ⁰⁰
9	390132	HOT MIX ASPHALT (TYPE A)	Like 4	TON	2,430	100 ⁰⁰	243,000 ⁰⁰
10	017304	MINOR CONCRETE (CURB AND GUTTER) (CRS 200)		LF	470	60 ⁰⁰	28,200 ⁰⁰
11	810230	PAVEMENT MARKER (RETROREFLECTIVE)	Like 5	EA	510	6 ⁰⁰	3,060 ⁰⁰
12	820410	SALVAGE ROADSIDE SIGN		EA	3	192 ⁰⁰	576 ⁰⁰
13	820840	ROADSIDE SIGN - ONE POST	Like 6	EA	4	550 ⁰⁰	2,200 ⁰⁰
14	820850	ROADSIDE SIGN - TWO POST		EA	5	750 ⁰⁰	3,750 ⁰⁰
15	840501	THERMOPLASTIC TRAFFIC STRIPE	Like 7	LF	12,700	0 ⁷⁴	9,398 ⁰⁰
16	840515	THERMOPLASTIC PAVEMENT MARKING	Like 8	SQFT	380	7 ⁵⁰	2,850 ⁰⁰
17	846020	REMOVE PAINTED TRAFFIC STRIPE	Like 9	LF	6,190	1 ⁰⁰	6,809 ⁰⁰
18	846035	REMOVE THERMOPLASTIC PAVEMENT MARKING		SQFT	710	1 ⁵⁰	1,065 ⁰⁰
19	010602	MISCELLANEOUS WORK (AS DIRECTED)		FA	1	60,000.00	60,000.00

BASE BID SCH. 1

SUB-TOTAL:

ITEMS 1-19

Six Hundred Seventy-six Thousand, Six Hundred Sixty-⁹⁰ \$676,663⁹⁰
Three^{Dollars} and ⁹⁰/₁₀₀. "WORDS"

* NOTE: See Instructions to Bidders, Section 16 "Like Bid Items", on page A9; corrections will apply if Like Bid items cost discrepancies are submitted. Applicable to Base Bid Schedule 1 and Alternate Bid Schedule 1 only.

REVISED PROPOSAL

ITEM No.	ITEM CODE	ITEM	Like Bid Item*	UNIT	ESTIMATED QUANTITY	ITEM PRICE (IN FIGURES)	TOTAL (IN FIGURES)
----------	-----------	------	----------------	------	--------------------	-------------------------	--------------------

ALTERNATIVE BID SCHEDULE 1: Coachilling Development

20	190101	ROADWAY EXCAVATION	Like 1	CY	1,380	39 ⁰⁰	53,820 ⁰⁰
21	190185	SHOULDER BACKING	Like 2	LF	2,640	2 ⁰⁰	5,280 ⁰⁰
22	260203	CLASS 2 AGGREGATE BASE	Like 3	CY	745	45 ⁰⁰	33,525 ⁰⁰
23	390132	HOT MIX ASPHALT (TYPE A)	Like 4	TON	1,390	100 ⁰⁰	139,000 ⁰⁰
24	810230	PAVEMENT MARKER (RETROREFLECTIVE)	Like 5	EA	180	6 ⁰⁰	1,080 ⁰⁰
25	820840	ROADSIDE SIGN - ONE POST	Like 6	EA	3	550 ⁰⁰	1,650 ⁰⁰
26	840501	THERMOPLASTIC TRAFFIC STRIPE	Like 7	LF	5,890	0 ⁷⁴	4,358 ⁶⁰
27	840515	THERMOPLASTIC PAVEMENT MARKING	Like 8	SQFT	130	7 ⁵⁰	975 ⁰⁰
28	846020	REMOVE PAINTED TRAFFIC STRIPE	Like 9	LF	3,660	1 ⁰⁰	4,026 ⁰⁰

ALT. BID SCH. 1

SUB-TOTAL: Two Hundred Forty-three Thousand, Seven Hundred Fourteen, and ^{Dollars} "WORDS" ^{60/100} \$ 243,714⁶⁰
ITEMS 20-28

* NOTE: See Instructions to Bidders, Section 16 "Like Bid Items", on page A9; corrections will apply if Like Bid items cost discrepancies are submitted. Applicable to Base Bid Schedule 1 and Alternate Bid Schedule 1 only.

ALTERNATIVE BID SCHEDULE 2: Mission Springs Water District Facilities Adjustments

29	000003	ADJUST WATER VALVE WITH CONCRETE COLLAR	-----	EA	6	1,400 ⁰⁰	8,400 ⁰⁰
30	202027	RELOCATE WATER METER (MSWD)	-----	EA	2	2,500 ⁰⁰	5,000 ⁰⁰

ALT. BID SCH. 2

SUB-TOTAL: THIRTEEN THOUSAND FOUR HUNDRED DOLLARS AND ZERO \$ 13,400⁰⁰
ITEMS 29-30 "WORDS" CENTS

ALTERNATIVE BID SCHEDULE 3 - Gilman Springs Road Resurfacing Project, Full Road Closure

31	066102	DUST ABATEMENT	-----	LS	1	27,000 ⁰⁰	27,000 ⁰⁰
32	100100	DEVELOP WATER SUPPLY	-----	LS	1	20,000 ⁰⁰	20,000 ⁰⁰
33	120100	TRAFFIC CONTROL SYSTEM	-----	LS	1	100,000 ⁰⁰	100,000 ⁰⁰
34	130200	PREPARE WATER POLLUTION CONTROL PROGRAM	-----	LS	1	10,000 ⁰⁰	10,000 ⁰⁰
35	170103	CLEARING AND GRUBBING (LS)	-----	LS	1	15,000 ⁰⁰	15,000 ⁰⁰
36	190101	ROADWAY EXCAVATION	-----	CY	1,010	40 ⁰⁰	40,400 ⁰⁰
37	190185	SHOULDER BACKING	-----	LF	38,720	0 ⁶⁵	25,168 ⁰⁰
38	390137	RUBBERIZED HOT MIX ASPHALT (GAP GRADED)	-----	TON	17,700	105 ⁰⁰	1,858,500 ⁰⁰
39	013902	ASPHALT CONCRETE OVERSIDE DRAIN (CRS 306)	-----	EA	45	180 ⁰⁰	8,100 ⁰⁰

REVISED PROPOSAL

ITEM No.	ITEM CODE	ITEM	Like Bid Item*	UNIT	ESTIMATED QUANTITY	ITEM PRICE (IN FIGURES)	TOTAL (IN FIGURES)
40	013903	PLACE ASPHALT CONCRETE DIKE (CRS 212) (6") AND [TYPE C AND E]	-----	LF	24,175	1 ⁵⁰	36,262 ⁵⁰
41	390132	HOT MIX ASPHALT (TYPE A) [3/4" MIX]	-----	TON	3,310	85 ⁰⁰	281,350 ⁰⁰
42	390132	HOT MIX ASPHALT (TYPE A) [1" MIX]	-----	TON	1,470	85 ⁰⁰	124,950 ⁰⁰
43	390135	HOT MIX ASPHALT (LEVELING)	-----	TON	10,280	85 ⁰⁰	873,800 ⁰⁰
44	394090	PLACE HOT MIX ASPHALT (MISCELLANEOUS AREA)	-----	SQYD	2,700	6 ⁰⁰	16,200 ⁰⁰
45	398200	COLD PLANE ASPHALT CONCRETE PAVEMENT [0.50' DEEP]	-----	SQYD	7,030	6 ⁰⁰	42,180 ⁰⁰
46	398200	COLD PLANE ASPHALT CONCRETE PAVEMENT [0.27' DEEP]	-----	SQYD	1,190	8 ⁰⁰	9,520 ⁰⁰
47	398200	COLD PLANE ASPHALT CONCRETE PAVEMENT [0.17' DEEP]	-----	SQYD	1,860	8 ⁰⁰	14,880 ⁰⁰
48	690110	12" CORRUGATED STEEL PIPE DOWNDRAIN	-----	EA	9	2,200 ⁰⁰	19,800 ⁰⁰
49	810230	PAVEMENT MARKER (RETROREFLECTIVE)	-----	EA	115,000	2 ⁴⁵	281,750 ⁰⁰
50	832007	MIDWEST GUARDRAIL SYSTEM (WOOD POST)	-----	LF	2,280	5 ⁰⁰	11,400 ⁰⁰
51	839584	ALTERNATIVE IN-LINE TERMINAL SYSTEM	-----	EA	18	1,000 ⁰⁰	18,000 ⁰⁰
52	839585	ALTERNATIVE FLARED TERMINAL SYSTEM	-----	EA	6	1,000 ⁰⁰	6,000 ⁰⁰
53	839752	REMOVE GUARDRAIL	-----	LF	3,370	5 ⁰⁰	16,850 ⁰⁰
54	840515	THERMOPLASTIC PAVEMENT MARKING	-----	SQFT	700	4 ⁵⁰	3,150 ⁰⁰
55	840656	PAINT TRAFFIC STRIPE (2-COAT)	-----	LF	136,000	0 ²⁵	34,000 ⁰⁰
56	846051	12" RUMBLE STRIP (ASPHALT CONCRETE PAVEMENT)	-----	LF	34,000	0 ¹⁷	5,780 ⁰⁰
57	010602	MISCELLANEOUS WORK (AS DIRECTED)	-----	FA	1	185,000.00	185,000.00

ALT. BID SCH. 3
SUB-TOTAL:
ITEMS 31-57

Four Million, Eighty Five Thousand, Forty Dollars and 50/100

4,095,040⁵⁰
~~\$4,850~~
ON

"WORDS"

* NOTE: Like Bid Items requirements are not applicable to bid items in Alternate Bid Schedules 2, 3, 4, and 5.

ALTERNATIVE BID SCHEDULE 4 – Gilman Springs Road Resurfacing Project, One Lane Closure

58	066102	DUST ABATEMENT	-----	LS	1	7,137 ⁰⁰	7,137 ⁰⁰
59	100100	DEVELOP WATER SUPPLY	-----	LS	1	20,000 ⁰⁰	20,000 ⁰⁰
60	120100	TRAFFIC CONTROL SYSTEM	-----	LS	1	300,000 ⁰⁰	300,000 ⁰⁰
61	130200	PREPARE WATER POLLUTION CONTROL PROGRAM	-----	LS	1	10,000 ⁰⁰	10,000 ⁰⁰
62	170103	CLEARING AND GRUBBING (LS)	-----	LS	1	15,000 ⁰⁰	15,000 ⁰⁰
63	190101	ROADWAY EXCAVATION	-----	CY	1,010	50 ⁰⁰	50,500 ⁰⁰

REVISED PROPOSAL

ITEM No.	ITEM CODE	ITEM	Like Bid Item*	UNIT	ESTIMATED QUANTITY	ITEM PRICE (IN FIGURES)	TOTAL (IN FIGURES)
64	190185	SHOULDER BACKING	-----	LF	38,720	0 ⁶⁵	25,168 ⁰⁰
65	390137	RUBBERIZED HOT MIX ASPHALT (GAP GRADED)	-----	TON	17,700	100 ⁰⁰	1,770,000 ⁰⁰
66	013902	ASPHALT CONCRETE OVERSIDE DRAIN (CRS 306)	-----	EA	45	365 ⁰⁰	16,425 ⁰⁰
67	013903	PLACE ASPHALT CONCRETE DIKE (CRS 212) (6") AND [TYPE C AND E]	-----	LF	24,175	1 ⁵⁰	36,262 ⁵⁰
68	390132	HOT MIX ASPHALT (TYPE A) [3/4" MIX]	-----	TON	3,310	81 ⁰⁰	268,110 ⁰⁰
69	390132	HOT MIX ASPHALT (TYPE A) [1" MIX]	-----	TON	1,470	81 ⁰⁰	119,070 ⁰⁰
70	390135	HOT MIX ASPHALT (LEVELING)	-----	TON	10,280	81 ⁰⁰	832,680 ⁰⁰
71	394090	PLACE HOT MIX ASPHALT (MISCELLANEOUS AREA)	-----	SQYD	2,700	6 ⁰⁰	16,200 ⁰⁰
72	398200	COLD PLANE ASPHALT CONCRETE PAVEMENT [0.50' DEEP]	-----	SQYD	7,030	5 ⁰⁰	35,150 ⁰⁰
73	398200	COLD PLANE ASPHALT CONCRETE PAVEMENT [0.27' DEEP]	-----	SQYD	1,190	5 ⁰⁰	5,950 ⁰⁰
74	398200	COLD PLANE ASPHALT CONCRETE PAVEMENT [0.17' DEEP]	-----	SQYD	1,860	8 ⁰⁰	14,880 ⁰⁰
75	690110	12" CORRUGATED STEEL PIPE DOWNDRAIN	-----	EA	9	2,200 ⁰⁰	19,800 ⁰⁰
76	810230	PAVEMENT MARKER (RETROREFLECTIVE)	-----	EA	115,000	3 ⁵⁵	408,250 ⁰⁰
77	832007	MIDWEST GUARDRAIL SYSTEM (WOOD POST)	-----	LF	2,280	5 ⁰⁰	11,400 ⁰⁰
78	839584	ALTERNATIVE IN-LINE TERMINAL SYSTEM	-----	EA	18	1,000 ⁰⁰	18,000 ⁰⁰
79	839585	ALTERNATIVE FLARED TERMINAL SYSTEM	-----	EA	6	1,000 ⁰⁰	6,000 ⁰⁰
80	839752	REMOVE GUARDRAIL	-----	LF	3,370	5 ⁰⁰	16,850 ⁰⁰
81	840515	THERMOPLASTIC PAVEMENT MARKING	-----	SQFT	700	7 ⁵⁰	5,306 ⁰⁰
82	840656	PAINT TRAFFIC STRIPE (2-COAT)	-----	LF	136,000	0 ³⁵	47,600 ⁰⁰
83	846051	12" RUMBLE STRIP (ASPHALT CONCRETE PAVEMENT)	-----	LF	34,000	0 ¹⁷	5,780 ⁰⁰
84	010602	MISCELLANEOUS WORK (AS DIRECTED)	-----	FA	1	395,000.00	395,000.00

ALT. BID SCH. 4
SUB-TOTAL:
ITEMS 58-84

Four Million, Four Hundred Seventy-Six Thousand
Five Hundred Eighteen Dollars and 50/100 \$4,476,518⁵⁰
"WORDS"

* NOTE: Like Bid Items requirements are not applicable to bid items in Alternate Bid Schedules 2, 3, 4, and 5.

REVISED PROPOSAL

ITEM No.	ITEM CODE	ITEM	Like Bid Item*	UNIT	ESTIMATED QUANTITY	ITEM PRICE (IN FIGURES)	TOTAL (IN FIGURES)
ALTERNATIVE BID SCHEDULE 5 – Gilman Springs Road, Micro-surfacing Treatment							
85	120100	TRAFFIC CONTROL SYSTEM	-----	LS	1	5,000 ⁰⁰ 85⁰⁰	5,000 ⁰⁰
86	374207	CRACK TREATMENT	-----	LS	1	15,000 ⁰⁰	15,000 ⁰⁰
87	374002	ASPHALTIC EMULSION (FOG SEAL COAT)	-----	SQYD	27,550	0 ³³	99 9,091 ⁵⁰
88	378000	MICRO-SURFACING	-----	TON	480	235 ⁰⁰	112,800 ⁰⁰
89	810230	PAVEMENT MARKER (RETROREFLECTIVE)	-----	EA	5,400	4 ²⁵	22,950 ⁰⁰
90	840515	THERMOPLASTIC PAVEMENT MARKING	-----	SQFT	200	7 ⁰⁰	1,400 ⁰⁰
91	840656	PAINT TRAFFIC STRIPE (2-COAT)	-----	LF	64,000	0 ⁴⁰	25,600 ⁰⁰
92	010602	MISCELLANEOUS WORK (AS DIRECTED)	-----	FA	1	24,000.00	24,000.00

ALT. BID SCH. 5
SUB-TOTAL:
ITEMS 85-92

Two Hundred Fifteen Thousand, Eight Hundred
Forty-one Dollars and ⁵⁰/₁₀₀ — \$215,841⁵⁰
"WORDS"

* NOTE: Like Bid Items requirements are not applicable to bid items in Alternate Bid Schedules 2, 3, 4, and 5.

BASE BID SCHEDULE and ALTERNATIVE BID SCHEDULES 1, 2, 3, 4 and 5

PROJECT TOTAL:
ITEMS 1-92

Nine Million, Seven Hundred Eleven Thousand
One Hundred Seventy-Nine Dollars and ^{NO}/₁₀₀ \$9,711,179⁰⁰
"WORDS"

Bidder Data and Signature

Name of Bidder: Granite Construction Company

Type of organization: Corporation

Person(s) authorized to sign for Bidder: _____

See Appendix A1

Joseph P. Richardson

Note:

If Bidder is a **Corporation**, state legal name of Corporation and also names of the president, vice-president, secretary, treasurer and manager thereof.

If Bidder is a **Co-Partnership**, state true name of firm and also names of all individual co-partners composing firm.

If Bidder is a sole proprietorship or an **Individual**, state first and last name(s) in full.

If Bid is signed by an agent other than an owner, partner or corporate officer, Bid shall be accompanied by a power-of-attorney.

Business Street Address: 38000 Monroe Street
(Please include business address even if P.O. Box is used.)

Business City, State, Zip Code: Indio, CA 92203

P.O. Box- Number: N/A

P.O. Box- City, State, Zip Code: _____

Phone: (760) 775-7500

Facsimile: (760) 775-8229

E-mail: joe.richardson@gcinc.com

Contractor's license number: 89

License Classification(s): A,B

Expiration date: 05/31/2019

Department of Industrial Relations Registration Number: 1000000085



CONTRACTORS
STATE LICENSE BOARD
ACTIVE LICENSE



License Number **89**

Entity **CORP**

Business Name **GRANITE CONSTRUCTION COMPANY**

Classification: **C36 C10 A B C57 C-2 C-8 C12
C21 C27 C29 C35 C42 C45 C39
C50 C51 C31**

Expiration Date **05/31/2019**

www.cslb.ca.gov



Registration Complete! Thank you for your payment.

Your PWCR registration and payment were submitted on 05/29/2018 at 08:47 AM. If you paid by credit card, payment confirmation and registration processing will take up to 24 hours. If you paid by ACH/EFT, payment confirmation and registration processing will take up to 10 calendar days.

Registration for Fiscal Year: 2019

PWC Registration Number: 1000000085

Contractor Legal Name: GRANITE CONSTRUCTION COMPANY

Contractor Legal Entity: Corporation

Payment Amount: \$400.00

Payment Method: MASTERCARD

Payment Confirmation Number: F0A0NWNTCZPC5

Bidder Data and Signature (continued)

Accompanying this Bid is a certified check, cashier check or bid bond in an amount equal to at least ten (10) percent of the total bid for:

**North Indian Canyon Drive
Widening Project Phase 1
20th Avenue to 18th Avenue
Cities of Palm Springs and Desert Hot Springs
Project No. C6-0089**

By my signature on this Bid, I certify, under penalty of perjury under the laws of the State of California, that all the information on this form is true and correct.

IN WITNESS WHERE OF Bidder/Contractor executed this Bid as of the date set forth on page **B1** of this Bid.

Signature:



Name (printed):

Joseph P. Richardson

Title:

Regional Chief Estimator

"Contractor"

GRANITE CONSTRUCTION COMPANY

CERTIFICATE OF SECRETARY

RESOLVED, that, effective January 1, 2019 through December 31, 2019, the individuals named on the attached Exhibit 1 are authorized to negotiate, execute and/or attest electronic and paper documents and contracts necessary for the conduct of the Company's affairs with respect to the submission and execution of construction project bids, bid proposals, bid addenda and all other bid-related documents prepared and submitted on behalf of the Company not to exceed \$25 million, relating to any and all domestic construction projects arising out of the Company's operations.

RESOLVED, that, effective January 1, 2019 through December 31, 2019, the individuals named on the attached Exhibit 2 are authorized to negotiate, execute and attest electronic and paper documents and contracts necessary for the conduct of the Company's affairs with respect to the submission and execution of construction project bids, bid proposals, bid addenda and all other bid-related documents prepared and submitted on behalf of the Company not to exceed \$75 million, relating to any and all domestic construction projects arising out of the Company's operations.

RESOLVED FURTHER, that the authority provided for herein shall be in accordance with applicable policies, procedures and limits of authority previously approved and the Granite Construction Incorporated Delegation of Authority and Policy then in effect.

I, M. Craig Hall, do hereby certify that I am duly qualified as Secretary of GRANITE CONSTRUCTION COMPANY, a California corporation (the "Company"); that the foregoing is a true and correct copy of resolutions duly adopted effective January 1, 2019 by unanimous written consent of the Executive Committee of the Board of Directors, held without a meeting in accordance with the provisions of Article III, Section 9 of the Bylaws of the Company; that the Directors acting were duly and regularly elected; and that the resolution adopted has not been modified or repealed and is still in full force and effect.

Dated: January 1, 2019

M. Craig Hall

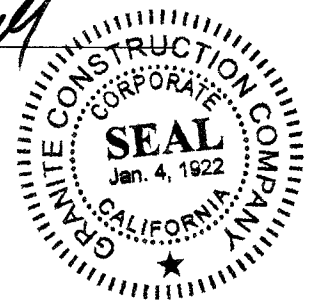

EXHIBIT 1

AUTHORIZED SIGNERS
Granite Construction Company
California Group
Desert Cities Region

AUTHORIZED SIGNERS

Brad J. Williams, VP Desert Cities Region
Brian Caris, Senior Project Manager
Joseph P. Richardson, Regional Chief Estimator
Jeff J. Mercer, Region Construction Manager
Ralph M. Pipkin, Project Manager
Fausto Gonzalez, Project Manager
Rudy Barela, Regional Controller

ATTESTORS

Brian Caris, Senior Project Manager
Joseph P. Richardson, Regional Chief Estimator
Jeff J. Mercer, Regional Construction Manager
Ralph M. Pipkin, Project Manager
Carley L. Cechin, Project Manager
Fausto Gonzalez, Project Manager
Rudy Barela, Regional Controller
Carolyn Maness, Estimating Assistant

EXHIBIT 2

AUTHORIZED SIGNERS

**Granite Construction Company
California Group**

AUTHORIZED SIGNERS

Jim Radich, VP Coastal Region
Michael Tatusko, VP Valley Region
Brent Fogg, VP Central Region
Richard Scott McArthur, VP Northern Los Angeles Region
John Boies, VP South Coast Region
Brad J. Williams, VP Desert Cities Region
Bradly Estes, VP Construction Materials



Granite Construction Company
List of Officers

Name	Present Office Position
Roberts, James H.	President Chief Executive Officer
Desai, Jigisha (NMN)	Senior Vice President Chief Financial Officer Assistant Secretary
Alegre, Carlos F.	Senior Vice President of Operations Services Assistant Secretary
DeCocco, Philip M.	Senior Vice President of Human Resources Assistant Secretary
Hall, M. Craig	Senior Vice President General Counsel Corporate Compliance Officer Secretary
Larkin, Kyle T.	Senior Vice President Group Manager Assistant Secretary
Rantala, Richard M.	Senior Vice President Business Development Assistant Secretary
Richards, James D.	Senior Vice President Group Manager Assistant Secretary
Swanberg, Dale A.	Senior Vice President Group Manager Assistant Secretary
Tyler, Mathew C.	Senior Vice President Federal Group Operations Assistant Secretary
Watts, Richard A.	Senior Vice President General Manager Assistant Secretary
Barker, Michael W.	Vice President Controller Assistant Financial Officer Assistant Secretary
Olson, Kenneth B.	Vice President Treasurer Assistant Financial Officer Assistant Secretary
Blackburn, Nicholas B.	Director of Corporate Taxation Assistant Secretary

(NMN) = No Middle Name

Subcontractor List

Bidder/Contractor submits the following complete list of each Subcontractor who will perform work, labor or render service in or about the construction in an amount in excess of 1/2 of 1% of the total bid or \$10,000 whichever is greater.

Check box on right side of row if any construction item, for the listed Subcontractor, is partial work. If partial work is to be performed within a certain construction item or trade, the Bidder/Contractor shall specify the portion(s) of the work to be performed by the different subcontractors or Bidder/Contractor will be subject to provisions of Public Contract Code Section 4106.

Name of Bidder (Prime/General Contractor): Granite Construction Company

	Subcontractor Name	License Number	DIR Registration Number	Business Address (City, State)	Construction Item(s) [Item Number and Description]	Check if Partial Work
1.	Pavement Coatings Company	303609	1000003382	Jurupa Valley, CA	88 Microsurfacing	<input checked="" type="checkbox"/>
2.	Danny C Hubs Construction, Inc	509249	1000012296	Yucaipa, CA	50-53, 77-80 Guardrail	<input checked="" type="checkbox"/>
3.	BC Traffic Specialist	877686	1000005503	Orange, CA	11-18, 24-28, 49, 54-55, 76, 81-82, 89-91 Striping	<input checked="" type="checkbox"/>
4.	Aprco	283095	1000004858	Goshen, CA	40, 67 AC Dike	<input checked="" type="checkbox"/>
5.	Pavement Recycling Systems, Inc	569352	1000003363	Jurupa Valley, CA	45-47, 56, 72-74, 83 Cold Plane Rumble Strip	<input checked="" type="checkbox"/>
6.	Statewide Traffic Safety AND Sign, Inc	975518	1000001109	Irvine, CA	60 Flagging and Pilot Car	<input checked="" type="checkbox"/> on

Additional Subcontractor List(s) may be attached to the Bid.
(A copy of this form may be attached with additional Subcontractor information.)

Percent of work to be performed by Subcontractors: 13.5 %

Note: A minimum of 50% of the work is required to be performed by the prime/general Contractor.

Non-Collusion Declaration

To be executed by bidder and submitted with bid.
(Title 23 United States Code Section 112 and Public Contract Code Section 7106)

The undersigned declares:

I am the Regional Chief Estimator (Title) of Granite Construction Company (Company),
the party making the foregoing bid.

The bid is not made in the interest of, or on behalf of, any undisclosed person, partnership, company, association, organization, or corporation. The bid is genuine and not collusive or sham. The bidder has not directly or indirectly induced or solicited any other bidder to put in a false or sham bid. The bidder has not directly or indirectly colluded, conspired, connived, or agreed with any bidder or anyone else to put in a sham bid, or that anyone shall refrain from bidding. The bidder has not in any manner, directly or indirectly, sought by agreement, communication, or conference with anyone to fix the bid price of the bidder or any other bidder, or to fix any overhead, profit, or cost element of the bid price, or of that of any other bidder.

All statements contained in the bid are true. The bidder has not, directly or indirectly, submitted his or her bid price of any breakdown thereof, or the contents thereof, or divulged information or data relative thereto, to any corporation, partnership, company, association, organization, bid depository, or to any member or agent thereof to effectuate a collusive or sham bid, and has not paid, and will not pay, any person or entity for such purpose.

Any person executing this declaration on behalf of a bidder that is a corporation, partnership, joint venture, limited liability company, limited liability partnership, or any other entity, hereby represents that he or she has full power to execute, and does execute, this declaration on behalf of the bidder.

I declare under penalty of perjury under the applicable laws that the foregoing is true and correct and that this declaration is executed on

March (Month) 13th (Day) of 2019 (Year),

at Indio (City), CA (State).

Signature of Declarant:



Printed name of Declarant:

Joseph P. Richardson

Name of Bidder (Company):

Granite Construction Company

Title or Office:

Regional Chief Estimator

Note: Notarization of signature required.
 Check box if attachment is included.

A notary public or other officer completing this certificate verifies only the identity of the individual who signed the document to which this certificate is attached, and not the truthfulness, accuracy, or validity of that document.

ACKNOWLEDGMENT

State of California
County of Riverside)

On March 13, 2019 before me, Carolyn Maness, Notary Public
(insert name and title of the officer)

personally appeared Joseph P. Richardson,
who proved to me on the basis of satisfactory evidence to be the person(s) whose name(s) is/are
subscribed to the within instrument and acknowledged to me that he/she/they executed the same in
his/her/their authorized capacity(ies), and that by his/her/their signature(s) on the instrument the
person(s), or the entity upon behalf of which the person(s) acted, executed the instrument.

I certify under PENALTY OF PERJURY under the laws of the State of California that the foregoing
paragraph is true and correct.

WITNESS my hand and official seal.

Signature Carolyn Maness (Seal)
Carolyn Maness, Notary Public





Iran Contracting Act
(Public Contract Code sections 2200-2208)

Prior to bidding on, submitting a proposal or executing a contract or renewal for a County of Riverside contract for goods or services of **\$1,000,000 or more**, a Contractor must either:

- a) Certify it is not on the current list of persons engaged in investment activities in Iran created by the California Department of General Services ("DGS") pursuant to Public Contract Code section 2203(b) and is not a financial institution extending twenty million dollars (\$20,000,000) or more in credit to another person, for 45 days or more, if that other person will use the credit to provide goods or services in the energy sector in Iran and is identified on the current list of persons engaged in investment activities in Iran created by DGS; or
- b) Demonstrate it has been exempted from the certification requirement for that solicitation or contract pursuant to Public Contract Code section 2203(c) or (d).

To comply with this requirement, please insert your Contractor or financial institution name and Federal ID Number (if available) and complete one of the options below. Please note: California law establishes penalties for providing false certifications, including civil penalties equal to the greater of \$250,000 or twice the amount of the contract for which the false certification was made; contract termination; and three-year ineligibility to bid on contracts. (Public Contract Code section 2205.)

Option #1 – Certification

I, the official named below, certify I am duly authorized to execute this certification on behalf of the vendor/financial institution identified below, and the vendor/financial institution identified below is **not** on the current list of persons engaged in investment activities in Iran created by DGS and is not a financial institution extending twenty million dollars (\$20,000,000) or more in credit to another person/vendor, for 45 days or more, if that other person/vendor will use the credit to provide goods or services in the energy sector in Iran and is identified on the current list of persons engaged in investment activities in Iran created by DGS.

<i>Contractor Name/Financial Institution (Printed)</i> Granite Construction Company	<i>Federal ID Number (or n/a)</i> 94-0519552
<i>By (Authorized Signature)</i> 	
<i>Printed Name and Title of Person Signing</i> Joseph P. Richardson, Regional Chief Estimator	
<i>Date Executed</i> 03/13/2019	<i>Executed in</i> Indio, CA

Option #2 – Exemption

Pursuant to Public Contract Code sections 2203(c) and (d), a public entity may permit a Contractor/financial institution engaged in investment activities in Iran, on a case-by-case basis, to be eligible for, or to bid on, submit a proposal for, or enters into or renews, a contract for goods and services.

If you have obtained an exemption from the certification requirement under the Iran Contracting Act, please fill out the information below, and **attach documentation demonstrating the exemption approval.**

<i>Contractor Name/Financial Institution (Printed)</i>	<i>Federal ID Number (or n/a)</i>
<i>By (Authorized Signature)</i>	
<i>Printed Name and Title of Person Signing</i>	
<i>Date Executed</i>	<i>Executed in</i>

COPY

Bid Bond

ISSUED BY ADDENDUM No. 2, ATTACHMENT A

Recitals:

1. Granite Construction Company "Contractor", has submitted his/her Contractor's Proposal to County of Riverside, "County", for the construction of public work for North Indian Canyon Drive, Widening Project Phase 1, 20th Avenue to 18th Avenue, Cities of Palm Springs and Desert Hot Springs, Project No. C6-0089; and Gilman Springs Road, Resurfacing Project, Moreno Valley City Limit to State Highway 79, Gilman Hot Springs Area, Project No. C9-0059 in accordance with a Notice Inviting Bids from the County.
2. Travelers Casualty and Surety Company of America a Connecticut corporation, hereafter called "Surety", is the surety of this bond.

Agreement:

We, Contractor as Principal and Surety as Surety, jointly and severally agree and state as follows:

1. The amount of the obligation of this bond is 10% of the amount of the Contractor's Proposal, including bid alternates, and inures to the benefit of County.
2. This Bond is exonerated by (1) County rejecting said Proposal or, in the alternate, (2) if said Proposal is accepted, Contractor executes the Contract and furnishes the Bonds as agreed to in its Proposal, otherwise it remains in full force and effect for the recovery of loss, damage and expense of County resulting from failure of Contractor to act as agreed to in its Proposal. Some types of possible loss, damage and expense are specified in the Contractor's Proposal.
3. Surety, for value received, stipulates and agrees that its obligations hereunder shall not be waived, impaired or affected by any extension of time within which County may accept the Proposal and waives notice of any such extension.
4. This Bond is binding on our heirs, executors, administrators, successors and assigns.

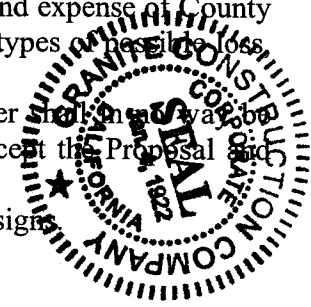

Dated: February 15, 2019

Signatures:

Travelers Casualty and Surety Company of America

Granite Construction Company

By: [Signature]
Isabel Barron, Attorney-In-Fact

By: [Signature]

Title: Attorney in Fact
"Surety"

Title: Joseph P. Richardson
Regional Chief Estimator
"Contractor"

STATE OF _____
COUNTY _____
OF _____

} ss. SURETY'S ACKNOWLEDGEMENT

On _____ before me, _____
personally appeared, _____ known to me, or proved to me on the basis
of satisfactory evidence, to be the person whose name is subscribed to the within instrument and
acknowledged to me that he/she executed the same in his/her authorized capacities, and that by his/her
signature on the instrument the person, or the entity upon behalf of which the person acted, executed the
instrument

WITNESS my hand and official seal.

SEE ATTACHED ACKNOWLEDGEMENT

Signature of Notary Public

Notary Public (Seal)

Note: This Bond must be executed by both Contractor and Surety with corporate seal affixed. All signatures must be notarized. (Attach acknowledgements).

COPY

A notary public or other officer completing this certificate verifies only the identity of the individual who signed the document to which this certificate is attached, and not the truthfulness, accuracy, or validity of that document.

ACKNOWLEDGMENT

State of California
County of Riverside)

On March 13, 2019 before me, Carolyn Maness, Notary Public
(insert name and title of the officer)

personally appeared Joseph P. Richardson,
who proved to me on the basis of satisfactory evidence to be the person(s) whose name(s) is/are subscribed to the within instrument and acknowledged to me that he/she/they executed the same in his/her/their authorized capacity(ies), and that by his/her/their signature(s) on the instrument the person(s), or the entity upon behalf of which the person(s) acted, executed the instrument.

I certify under PENALTY OF PERJURY under the laws of the State of California that the foregoing paragraph is true and correct.

WITNESS my hand and official seal.

Signature Carolyn Maness (Seal)
Carolyn Maness, Notary Public

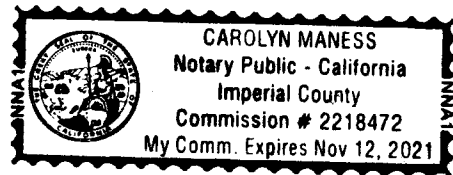

COPY

A notary public or other officer completing this certificate verifies only the identity of the individual who signed the document to which this certificate is attached, and not the truthfulness, accuracy, or validity of that document.

ACKNOWLEDGMENT

State of California
County of Santa Cruz)

On February 15, 2019 before me, Maria Gomez, Notary Public
(insert name and title of the officer)

personally appeared Isabel Barron,
who proved to me on the basis of satisfactory evidence to be the person(s) whose name(s) is/are subscribed to the within instrument and acknowledged to me that he/she/they executed the same in his/her/their authorized capacity(ies), and that by his/her/their signature(s) on the instrument the person(s), or the entity upon behalf of which the person(s) acted, executed the instrument.

I certify under PENALTY OF PERJURY under the laws of the State of California that the foregoing paragraph is true and correct.

WITNESS my hand and official seal.

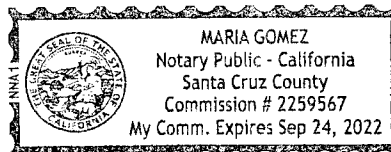

Signature *Maria Gomez* (Seal)
Maria Gomez, Notary Public

COPY

TRAVELERS

**Travelers Casualty and Surety Company of America
Travelers Casualty and Surety Company
St. Paul Fire and Marine Insurance Company**

POWER OF ATTORNEY

KNOW ALL MEN BY THESE PRESENTS: That Travelers Casualty and Surety Company of America, Travelers Casualty and Surety Company, and St. Paul Fire and Marine Insurance Company are corporations duly organized under the laws of the State of Connecticut (herein collectively called the "Companies"), and that the Companies do hereby make, constitute and appoint **Isabel Barron** of **WATSONVILLE California**, their true and lawful Attorney-in-Fact to sign, execute, seal and acknowledge any and all bonds, recognizances, conditional undertakings and other writings obligatory in the nature thereof on behalf of the Companies in their business of guaranteeing the fidelity of persons, guaranteeing the performance of contracts and executing or guaranteeing bonds and undertakings required or permitted in any actions or proceedings allowed by law.
IN WITNESS WHEREOF, the Companies have caused this instrument to be signed, and their corporate seals to be hereto affixed, this 3rd day of February, 2017.



State of Connecticut

City of Hartford ss.

By: *Robert L. Raney*
Robert L. Raney, Senior Vice President

On this the 3rd day of February, 2017, before me personally appeared **Robert L. Raney**, who acknowledged himself to be the Senior Vice President of Travelers Casualty and Surety Company of America, Travelers Casualty and Surety Company, and St. Paul Fire and Marine Insurance Company, and that he, as such, being authorized so to do, executed the foregoing instrument for the purposes therein contained by signing on behalf of the corporations by himself as a duly authorized officer.

In Witness Whereof, I hereunto set my hand and official seal.

My Commission expires the 30th day of June, 2021



Marie C. Tetreault
Marie C. Tetreault, Notary Public

This Power of Attorney is granted under and by the authority of the following resolutions adopted by the Boards of Directors of Travelers Casualty and Surety Company of America, Travelers Casualty and Surety Company, and St. Paul Fire and Marine Insurance Company, which resolutions are now in full force and effect, reading as follows:

RESOLVED, that the Chairman, the President, any Vice Chairman, any Executive Vice President, any Senior Vice President, any Vice President, any Second Vice President, the Treasurer, any Assistant Treasurer, the Corporate Secretary or any Assistant Secretary may appoint Attorneys-in-Fact and Agents to act for and on behalf of the Company and may give such appointee such authority as his or her certificate of authority may prescribe to sign with the Company's name and seal with the Company's seal bonds, recognizances, contracts of indemnity, and other writings obligatory in the nature of a bond, recognizance, or conditional undertaking, and any of said officers or the Board of Directors at any time may remove any such appointee and revoke the power given him or her; and it is

FURTHER RESOLVED, that the Chairman, the President, any Vice Chairman, any Executive Vice President, any Senior Vice President or any Vice President may delegate all or any part of the foregoing authority to one or more officers or employees of this Company, provided that each such delegation is in writing and a copy thereof is filed in the office of the Secretary; and it is

FURTHER RESOLVED, that any bond, recognizance, contract of indemnity, or writing obligatory in the nature of a bond, recognizance, or conditional undertaking shall be valid and binding upon the Company when (a) signed by the President, any Vice Chairman, any Executive Vice President, any Senior Vice President or any Vice President, any Second Vice President, the Treasurer, any Assistant Treasurer, the Corporate Secretary or any Assistant Secretary and duly attested and sealed with the Company's seal by a Secretary or Assistant Secretary; or (b) duly executed (under seal, if required) by one or more Attorneys-in-Fact and Agents pursuant to a written delegation of authority; and it is

FURTHER RESOLVED, that the signature of each of the following officers: President, any Executive Vice President, any Senior Vice President, any Vice President, any Assistant Vice President, any Secretary, any Assistant Secretary, and the seal of the Company may be affixed by facsimile to any Power of Attorney or to any certificate relating thereto appointing Resident Vice Presidents, Resident Assistant Secretaries or Attorneys-in-Fact for purposes only of executing and attesting bonds and undertakings and other writings obligatory in the nature thereof, and any such Power of Attorney or certificate bearing such facsimile signature or facsimile seal shall be valid and binding upon the Company and any such power so executed and certified by such facsimile signature and facsimile seal shall be valid and binding on the Company in the future with respect to any bond or understanding to which it is attached.

I, **Kevin E. Hughes**, the undersigned, Assistant Secretary of Travelers Casualty and Surety Company of America, Travelers Casualty and Surety Company, and St. Paul Fire and Marine Insurance Company, do hereby certify that the above and foregoing is a true and correct copy of the Power of Attorney executed by said Companies, which remains in full force and effect.

Dated this February 15, 2019



Kevin E. Hughes
Kevin E. Hughes, Assistant Secretary

**To verify the authenticity of this Power of Attorney, please call us at 1-800-421-3880.
Please refer to the above-named Attorney-in-Fact and the details of the bond to which the power is attached.**



COPY

- Company Profile
- Company Search
- Company Information
- Old Company Names
- Agent for Service
- Reference Information
- NAIC Group List
- Lines of Business
- Workers' Compensation Complaint and Request for Action/Appeals Contact Information
- Financial Statements PDF's
- Annual Statements
- Quarterly Statements
- Company Complaint
- Company Performance & Comparison Data
- Company Enforcement Action
- Composite Complaints Studies
- Additional Info
- Find A Company Representative In Your Area
- View Financial Disclaimer

COMPANY PROFILE

Company Information

TRAVELERS CASUALTY AND SURETY COMPANY OF AMERICA

**ONE TOWER SQUARE
HARTFORD, CT 06183**

Old Company Names

Effective Date

AETNA CASUALTY & SURETY COMPANY OF AMERICA 07/01/1997

Agent For Service

KARISSA LOWRY
2710 GATEWAY OAKS DRIVE
SUITE 150N
SACRAMENTO CA 95833

Reference Information

NAIC #:	31194
California Company ID #:	2444-8
Date Authorized in California:	07/31/1981
License Status:	UNLIMITED-NORMAL
Company Type:	Property & Casualty
State of Domicile:	CONNECTICUT

back to top

NAIC Group List

NAIC Group #: 3548 Travelers Grp

Lines Of Business

The company is authorized to transact business within these lines of insurance. For an explanation of any of these terms, please refer to the glossary.

- AIRCRAFT
- AUTOMOBILE
- BOILER AND MACHINERY
- BURGLARY
- COMMON CARRIER LIABILITY
- CREDIT
- DISABILITY
- FIRE
- LIABILITY
- MARINE
- MISCELLANEOUS
- PLATE GLASS
- SPRINKLER
- SURETY
- TEAM AND VEHICLE
- WORKERS' COMPENSATION

back to top



Patricia Romo, P.E.
Director of Transportation

COUNTY OF RIVERSIDE

TRANSPORTATION AND LAND MANAGEMENT AGENCY

Mojahed Salama, P.E.
Deputy for Transportation/Capital Projects
Richard Lantis, P.L.S.
Deputy for Transportation/Planning and
Development

Transportation Department

ADDENDUM NUMBER 1

Dated February 1, 2019

to the
Specifications and Contract Documents
for the construction of

North Indian Canyon Drive
Widening Project Phase 1
20th Avenue to 18th Avenue
Cities of Palm Springs and Desert Hot Springs
Project No. C6-0089

Bids Due: (Revised)
Wednesday, February 20, 2019; 2:00 p.m.
14th Street Transportation Annex
3525 14th Street; Riverside, CA 92501
(951) 955-6780

This Addendum is issued pursuant to the Instructions to Bidders, Item No. 8, of the Contract Documents for the reference project. This Addendum is issued as a supplement to the specification and special provisions for the referenced project. The revisions to the specifications shall become a part of the Contract Documents, and each bidder shall acknowledge receipt thereof on the Bid (Proposal). Bidders are directed to sign this addendum as acknowledged, and attach the signed addendum to the contractor's submitted proposal.

Note: During the advertisement period of this project, this document and attachments (if any) are available upon request at the office of the Transportation Department, and are available as a free download at the Transportation Department's website:

<http://rctlma.org/trans/Contractors-Corner/Notices-Inviting-Bids>

MODIFICATIONS / CLARIFICATIONS TO SPECIAL PROVISIONS:

Item 1: The new designated date and time for the receipt and opening of bids is revised as follows:

Wednesday, February 20, 2019; 2:00 p.m.
14th Street Transportation Annex
3525 14th Street; Riverside, CA 92501
(951) 955-6780

Prepared by:

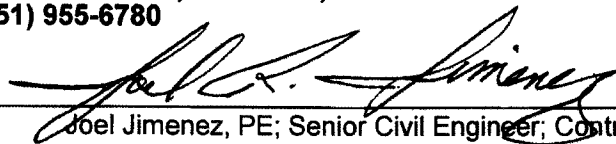
Joel Jimenez, PE; Senior Civil Engineer; Contracts/Bidding Unit

Acknowledged:



Joseph P. Richardson
Regional Chief Estimator Date: 02/04/2019

JRJ:rr

(Contractor) Granite Construction Company

ATTACHMENTS

A – Revised Bid Bond

This addendum has been prepared under the direction of the following registered Civil Engineer(s):

Recommended by:

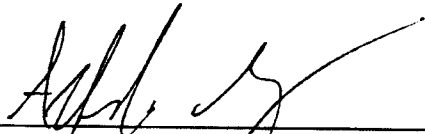

Alfredo Martinez, PE
County Project Manager

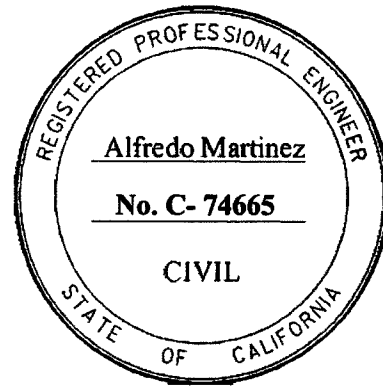

Concurrence:

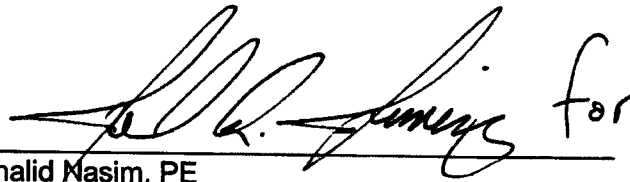

Khalid Masim, PE
Engineering Division Manager

Acknowledged:

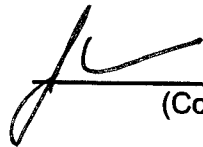

Joseph P. Richardson
Regional Chief Estimator

Date: 02/14/2019

(Contractor) Granite Construction Company

JRJ:jrj:rr

Note: Refer to Instruction to Bidders Item No. 8, "Addenda". Submission of all addendum pages and non-bidding document attachments of addendum are not necessary for Bid submittal. Submittal of this acknowledgement page is adequate for Bid reception. Bidders are reminded to list addendum number(s) received on the first page of the Bid form (Proposal).

This addendum has been prepared under the direction of the following registered Civil Engineer(s):

Recommended by:

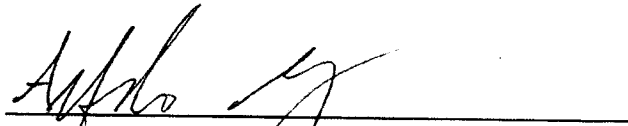

Alfredo Martinez, PE
Senior Civil Engineer

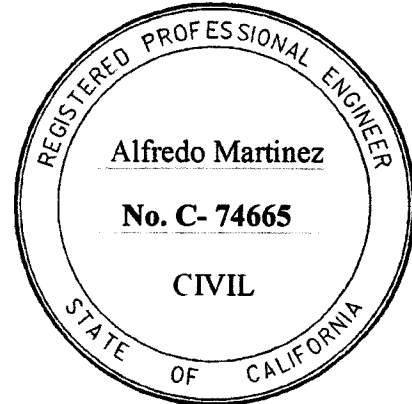

Concurrence:

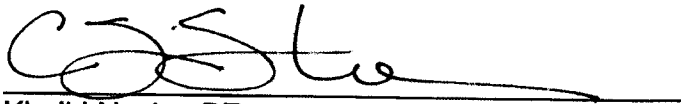

Khalid Nasim, PE
Engineering Division Manager

Bar → Charles Scott Staley
Engineering Project Manager

Acknowledged:



Joseph P. Richardson
Regional Chief Estimator

Date: 02/28/2019

(Contractor)

JRJ: jrj:rr

Note: Refer to Instruction to Bidders Item No. 8, "Addenda". Submission of all addendum pages and non-bidding document attachments of addendum are not necessary for Bid submittal. Submittal of this acknowledgement page is adequate for Bid reception. Bidders are reminded to list addendum number(s) received on the first page of the Bid form (Proposal).

Addendum No. 4
North Indian Canyon Drive, Widening Project Phase 1, 20th Avenue to 18th Avenue
Cities of Palm Springs and Desert Hot Springs, Project No. C6-0089; and
Gilman Springs Road, Resurfacing Project, Moreno Valley City Limit to State Highway 79
Gilman Hot Springs Area, Project No. C9-0059
March 7, 2019
Page 2 of 2

This addendum has been prepared under the direction of the following registered Civil Engineer(s):

Recommended by:

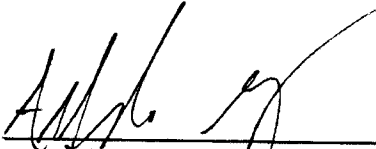

Alfredo Martinez, PE
Senior Civil Engineer

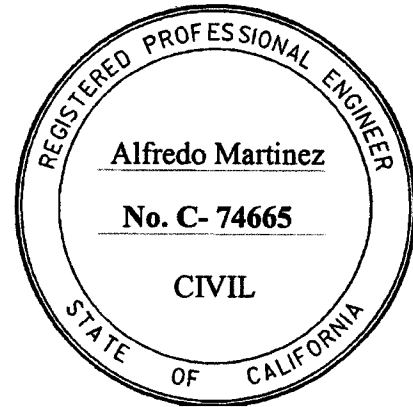

Concurrence:

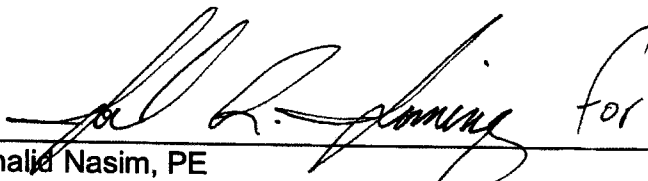

Khalid Nasim, PE
Engineering Division Manager

Acknowledged:



Joseph P. Richardson
Regional Chief Estimator

(Contractor)

Date: 03/07/2019

JRJ: jrj:rr

Note: Refer to Instruction to Bidders Item No. 8, "Addenda". Submission of all addendum pages and non-bidding document attachments of addendum are not necessary for Bid submittal. Submittal of this acknowledgement page is adequate for Bid reception. Bidders are reminded to list addendum number(s) received on the first page of the Bid form (Proposal).

COUNTY OF RIVERSIDE
TRANSPORTATION AND
LAND MANAGEMENT AGENCY

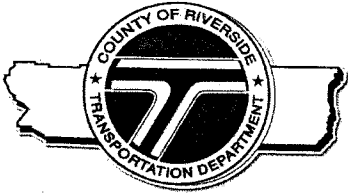

Patricia Romo, P.E.
Director of Transportation

Transportation Department

Mojahed Salama, P.E.
Deputy for Transportation/Capital Projec.
Richard Lantis, P.L.S.
Deputy for Transportation/Planning and
Development

DATE: February 28, 2019

TO: Mary Ann Meyer, Office of the County Clerk

FROM: *MZambon*
Mary Zambon, Environmental Division Manager

Original Negative Declaration/Notice of
Determination was routed to County
Clerks for posting on.

5/2/19
Date

kb
Initial

RE: **Gilman Springs Road Resurfacing: Moreno Valley City Limits to SR-79**
W.O.#ZC90059C, Task Code #Z1530

The Riverside County Transportation Department is requesting that you post the attached Notice of Exemption per County Implementing Resolution No. 82-213, Division 11, Section 205C. Attached you will find an authorization to bill by journal voucher in the amount of \$50.00 for your posting fee.

After posting, please return the document to Mail Stop #2136, Attention: Mohamed Eissa. If you have any questions, please contact me at (951) 955-1506.

Attachment

cc: file

APR 30 2019

3.36

COUNTY OF RIVERSIDE

TRANSPORTATION AND LAND MANAGEMENT AGENCY

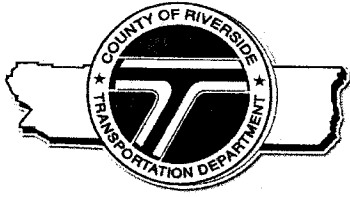

Patricia Romo, P.E.
Director of Transportation

Transportation Department NOTICE OF EXEMPTION

Mojahed Salama, P.E.
Deputy for Transportation/Capital Projec
Richard Lantis, P.L.S.
Deputy for Transportation/Planning and
Development

February 28, 2019

PROJECT TITLE: Gilman Springs Road Resurfacing: Moreno Valley City Limits to SR-79
Work Order #C90059, Task Code #Z1530

PROJECT SPONSOR: Riverside County Transportation Department

PROJECT LOCATION: Gilman Hot Springs Community

SUPERVISORIAL DISTRICT: 5th

PROJECT DESCRIPTION: The Riverside County Transportation Department (RCTD) is proposing to rehabilitate approximately 9 miles of Gilman Springs Road from Moreno Valley City Limits to State Route 79 (SR-79). Gilman Springs Road is a two lane facility that is approximately 32 feet wide consisting of two 12 foot lanes and 4 foot paved shoulders and is classified as an Arterial Highway in the County of Riverside's General Plan. The proposed project will include resurfacing the roadway by overlaying the entire roadway width with Asphalt and Asphalt Rubber. The project will also include the following:

- Mill and fill areas severely distressed
- Crack seal and microsurface areas with minimal distress
- Replacement of existing thermoplastic markings, painted stripes, and reflective markers
- Reconstruction of driveways, driveway tie-ins, and side street tie-ins
- Construction of driveways
- Reconstruction of asphalt concrete over-side drains and downdrains
- Reconstruction of existing asphalt dikes
- Placement of asphalt concrete dike and shoulder backing
- Replacement of guardrails
- Replacement of sign and detector loops

ENVIRONMENTAL ANALYSIS:

The proposed project will be constructed within existing County right of way. Temporary construction easements will not be required for the proposed improvements.

This project is subject to compliance with the Western Riverside County Multiple Species Habitat Conservation Plan (MSHCP). In accordance with Section 7 of the Western Riverside County MSHCP, necessary operation and maintenance activities along existing roadways are considered covered activities within and outside of cell criteria areas. The proposed project is an operation and maintenance activity conducted for safety purposes that is located within and outside of cell criteria areas, therefore it is a covered activity under the Western Riverside County MSHCP. The project will comply with the construction guidelines provided in Section 7.5.3, as well as Best Management Practices (BMPs) outlined in Appendix C.

If tree and/or vegetation removal takes place during the migratory bird breeding season (February 15th – September 1st), a preconstruction nesting survey will be conducted pursuant to the Migratory Bird Treaty Act (MBTA).

The Riverside County Transportation Department has found that the above-described project is exempt from the provisions of the California Environmental Quality Act (CEQA), based on the following:

Section 15301 (c) – Existing Facilities – The project proposes to rehabilitate Gilman Springs Road from State Route 79 to the Moreno Valley City Limits by resurfacing approximately 9 miles of the roadway. Furthermore, the project proposes additional improvements such as constructing driveways and asphalt dikes, and replacing guardrails, end treatments, signs, and detector loops. The proposed project is exempt from CEQA under Section 15301 (c) because the resurfacing of the road and additional safety improvements do not create additional automobiles lanes and involve negligible or no expansion of existing or former use of the existing roadway and associated facilities.

By: Mohamed Eissa, Assistant Transportation Planner

Signed: Mary Zambon
Mary Zambon, Environmental Division Manager

RIVERSIDE COUNTY CLERK & RECORDER

**AUTHORIZATION
TO BILL
BY JOURNAL VOUCHER**

-TO BE FILLED IN BY SUBMITTING AGENCY-
537280-20000-3130500000 ZC90059C Z1530

AUTHORIZATION NUMBER: W.O.#ZC90059C, Task Code Z1530

AMOUNT: \$50.00

DATE: February 28, 2019

AGENCY: Riverside County Transportation Department

THIS AUTHORIZES THE COUNTY CLERK & RECORDER TO ISSUE A VOUCHER FOR PAYMENT OF ALL FILING AND HANDLING FEES FOR THE ACCOMPANYING DOCUMENT(S).

NUMBER OF DOCUMENTS INCLUDED: One (1)

AUTHORIZED BY: Mary Zambon, Environmental Division Manager

Signature: MZambon

PRESENTED BY: Mohamed Eissa

-TO BE FILLED IN BY COUNTY CLERK-

ACCEPTED BY: -

DATE: -

RECEIPT # (S) -

Gilman Springs Road Resurfacing Project

