

SUBMITTAL TO THE BOARD OF SUPERVISORS  
COUNTY OF RIVERSIDE, STATE OF CALIFORNIA



ITEM  
3.32  
(ID # 9654)

MEETING DATE:  
Tuesday, May 21, 2019

FROM : TLMA-TRANSPORTATION:

SUBJECT: TRANSPORTATION AND LAND MANAGEMENT AGENCY/TRANSPORTATION  
DEPARTMENT: Approve Addenda to the Plans and Specifications, Accept the  
Low Bid and Award the Contract for the Grapefruit Boulevard and 62nd Avenue  
Traffic Signal and Safety Lighting Project, in the Community of Mecca. 4th  
District. [\$996,000 Total Cost - \$5,500 Ongoing Cost - Local Funds 100%]

RECOMMENDED MOTION: That the Board of Supervisors:

1. Approve three addenda to the plans and specifications issued prior to the February 27, 2019, bid opening;
2. Accept the low bid of Granite Construction Company (Granite) of Indio, California in the amount of \$996,000;
3. Award the contract to Granite and authorize the Chairman of the Board to execute the contract documents; and
4. Approve the project's proposed budget as shown on Attachment "A".

ACTION: Policy

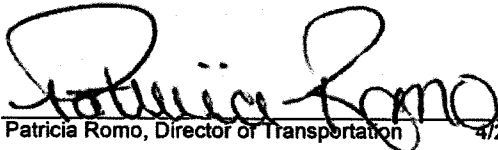
  
Patricia Romo, Director of Transportation 4/22/2019

---

MINUTES OF THE BOARD OF SUPERVISORS

On motion of Supervisor Perez, seconded by Supervisor Jeffries and duly carried by unanimous vote, IT WAS ORDERED that the above matter is approved as recommended.

Ayes: Jeffries, Spiegel, Washington, Perez and Hewitt  
Nays: None  
Absent: None  
Date: May 21, 2019  
xc: Transp.

Kepia Harper  
Clerk of the Board  
By:   
Deputy

**SUBMITTAL TO THE BOARD OF SUPERVISORS COUNTY OF RIVERSIDE,  
STATE OF CALIFORNIA**

<b>FINANCIAL DATA</b>	<b>Current Fiscal Year:</b>	<b>Next Fiscal Year:</b>	<b>Total Cost:</b>	<b>Ongoing Cost</b>
<b>COST</b>	\$ 200,000	\$ 796,000	\$ 996,000	\$ 5,500
<b>NET COUNTY COST</b>	\$ 0	\$ 0	\$ 0	\$ 0
<b>SOURCE OF FUNDS:</b> HSIP-Highway Safety Improvement Program (41%), East County DIF Signal Mitigation Fund (59%). No General Funds will be used on this project.			<b>Budget Adjustment: No</b>	
			<b>For Fiscal Year: 18/19-19/20</b>	

**C.E.O. RECOMMENDATION:** Approve

**BACKGROUND:**

**Summary**

By Minute Order dated January 29, 2019 (Agenda Item 3.32), the County of Riverside (County) Board of Supervisors authorized the Clerk of the Board to advertise for the Grapefruit Boulevard and 62nd Avenue Traffic Signal and Safety Lighting Project, in the Community of Mecca in the County of Riverside.

Grapefruit Boulevard is a two lane road that travels in the north-south direction and 62nd Avenue is a two lane road that travels in the east-west direction.

The work includes widening the intersection for the installation of turning lanes, traffic signal and at-grade improvements at the Union Pacific Railroad (UPRR) crossing.

On February 6, 2018 under minute item 3.14, the County of Riverside approved an agreement with Union Pacific Railroad Company to reimburse them for work they will perform that is necessary for this project. The UPRR costs are included in Attachment A.

During the advertisement period, three addenda were issued to all registered plan holders as a supplement to the plans and specifications. Bidders were required to acknowledge and take into account all issued addenda on their contractor's Bid in order to be considered for award. The Addenda were issued to extend the bid receipt and to modify the approved contract documents to include the UPRR agreement with the County for work that UPRR will be performing during construction. The addenda are attached and designated as Addendum No. 1, 2 and 3.

Granite is qualified to perform the work as outlined in the bid, has executed the contract, and has provided bonds and insurance documents which meet the requirements of the Contract.

Project No.: C3-0084, Federal Aid No. HSIP-5956(236)

**Impact on Residents and Businesses**

**SUBMITTAL TO THE BOARD OF SUPERVISORS COUNTY OF RIVERSIDE,  
STATE OF CALIFORNIA**

The proposed traffic signal and safety lightings, including Americans with Disability Act (ADA) compliant curb ramps, will improve traffic and pedestrian safety by providing controlled traffic movements and intersection visibility.

The work will be phased to keep the road open during construction as much as possible and will take approximately three months to complete. Construction is expected to begin in June and finish in August.

**SUPPLEMENTAL:**

**Additional Fiscal Information**

The contract is recommended to be awarded to Granite for the total amount of \$996,000.

The project will be funded with East County DIF Signal Mitigation Funds and HSIP-Highway Safety Improvement Program.

The Development Impact Fee (DIF) program, which is governed under Ordinance 659, allows for the use of DIF funds for traffic signal facilities, and HSIP – Highway Safety Improvement Program funds were successfully competed for.

The proposed budget shown on Attachment "A" includes the contract award amount and other associated costs.

Annual traffic signal operation and maintenance costs are estimated at \$5,500 to be funded from gas tax.

There are no General Funds being used on this project.

**Contract History and Price Reasonableness**

Three bids were received on Wednesday February 27, 2019 ranging from \$996,000 to \$1,217,081. All bids were responsive but higher than the Engineers Estimate. The two lowest bids were tied between Onyx Paving Company, Inc. (Onyx) and Granite.

Per contract documents Instruction to Bidders Section 28, "Award of Contract," the County may select one of any number of tied bids by its desired choice (Public Contract Code § 22038.b).

Since this project is federally funded, the Disadvantaged Business Enterprise (DBE) contract goal of 12% was considered in evaluating the two tied bids.

Both companies submitted Exhibit 15G Construction Contract DBE Commitment and Good Faith Efforts DBE Information. After reviewing and verifying Exhibit 15G for each company, Granite claims 34% DBE Commitment and Onyx claims 16% commitment. Even though both companies met the DBE contract goal, the County selected the contractor who provided the higher percentage of DBE Commitment.

**SUBMITTAL TO THE BOARD OF SUPERVISORS COUNTY OF RIVERSIDE,  
STATE OF CALIFORNIA**

The bid received from Granite is in the amount of \$996,000 which is \$83,215 (9%) above the Engineer's Estimate.

The Transportation Department recommends the award of the contract to Granite Construction Company.

**ATTACHMENTS:**

Vicinity Map

Attachment A

Summary of Bids

Addendum No. 1, 2 and 3

Contract/Bonds/Insurance

Contractor's Bid Proposal

Exhibit 15G Construction Contract DBE Commitment

  
\_\_\_\_\_  
Gregory V. Priaplos, Director County Counsel 5/8/2019

COUNTY OF RIVERSIDE  
TRANSPORTATION DEPARTMENT

**Grapefruit Boulevard and 62nd Avenue  
Traffic Signal and Safety Lighting Project**

In the Community of Mecca

Project No. C3-0084  
Federal Project No. HSIP-5956(236)

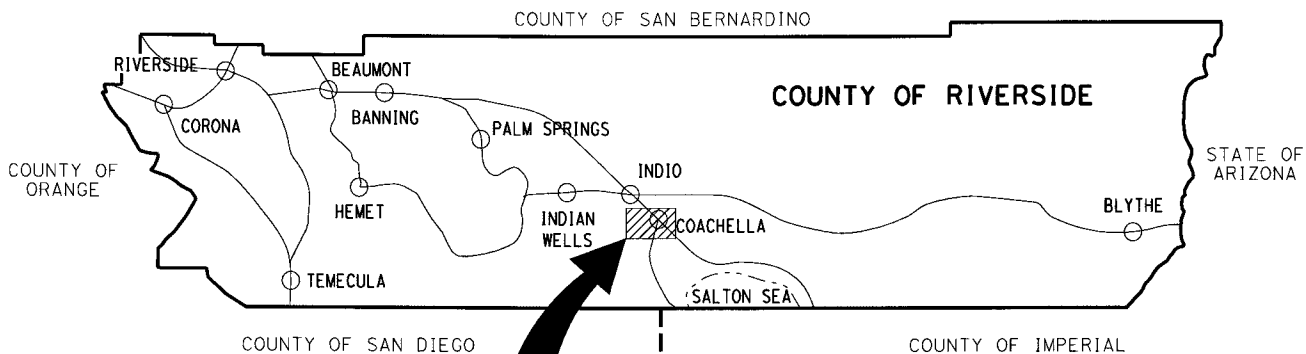

**VICINITY MAP**

TOWNSHIP 7S RANGE 8E SECTION 1  
COUNTY ROAD BOOK PAGE No. 230

# Attachment "A"

Riverside County Transportation Department

Project: **GRAPEFRUIT BLVD & 62ND AVE  
TRAFFIC SIGNAL PROJECT**

Project No.(s) **C3-0084**

Expenses as of: **3/13/2019**

## Project Costs and Budget

Activity	Incurring Costs	Projected Costs	Total Costs	Existing Budget	Proposed Budget
Preliminary Survey	55,570		56,000	50,000	56,000
Environmental	171,732	2,000	174,000	170,000	174,000
Design	433,230	2,000	436,000	390,000	436,000
Right-of-way	73,256		74,000	77,000	74,000
Utilities					
Construction		996,000			
Construction Contingency 10%		99,600			
Construction by UPRR	158,560	906,876	2,268,000	1,773,000	2,268,000
UPRR Construction Contingency 10%		106,544			
Construction Engineering & Inspection 20%	12,335	187,665	200,000	200,000	200,000
Construction Survey 2%		20,000	20,000	66,000	20,000
<b>Totals:</b>	<b>904,683</b>	<b>2,320,685</b>	<b>3,228,000</b>	<b>2,726,000</b>	<b>3,228,000</b>

## Project Funding

Code	Name	Existing Budget	Proposed Budget
134	HSIP - Highway Safety Improvement Program	1,222,000	1,222,000
370	East County DIF Signal Mitigation Fund	1,504,000	2,006,000
<b>Totals</b>		<b>2,726,000</b>	<b>3,228,000</b>

## Comments

Design cost included the following:

1. Coordinated railroad track improvements, acquired easement and secured construction agreements with Union Pacific Railroad Company for the at-garde crossing improvements,
2. Coordinating with Imperial Irrigation District on raising existing power lines to provide aerial clearance.
3. Consultant Fee.

**Riverside County Transportation Department  
Summary of Bids**

**PROJECT: Grapefruit Boulevard and 62nd Avenue  
Traffic Signal and Safety Lighting Project  
In the Community of Mecca  
Project No. C3-0084  
Federal Aid No. HSIP-5956(236)**

Advertised: January 29, 2019 (Agenda Item: 3.32)  
Addenda: 1 (2/7/2019), 2 (2/14/2019), 3 (2/19/2019)  
Bids Open: 2 pm Date: Wednesday, February 27, 2019

BASE BID ITEM NO.	ITEM CODE	CONTRACT ITEM	UNITS	QUANTITY	COUNTY'S ESTIMATE			1 (Bid Tie)* Onyx Paving Company, Inc. Anaheim, CA 92806	
					UNIT PRICE	ENG ESTIMATE	BID UNIT PRICE	BID ESTIMATE	
1	066102	DUST ABATMENT	LS	1	5,000.00	5,000.00	5,000.00	5,000.00	
2	074020	WATER POLLUTION CONTROL	LS	1	5,000.00	5,000.00	5,000.00	5,000.00	
3	120100	TRAFFIC CONTROL SYSTEM	LS	1	20,000.00	20,000.00	41,000.00	41,000.00	
4	100100	DEVELOP WATER SUPPLY	LS	1	3,000.00	3,000.00	7,000.00	7,000.00	
5	170103	CLEARING AND GRUBBING	LS	1	8,000.00	8,000.00	69,000.00	69,000.00	
6	190101 (F)	ROADWAY EXCAVATION (INCLUDE SAWCUT AND REMOVE AC PAVEMENT TO 0.4' DEEP)	CY	850	50.00	42,500.00	45.00	38,250.00	
7	260203	CLASS 2 AGGREGATE BASE	CY	157	45.00	7,065.00	100.00	15,700.00	
8	390132	HOT MIX ASPHALT (TYPE A)	TON	1,900	110.00	209,000.00	96.00	182,400.00	
9	377501	SLURRY SEAL (TYPE 3)	TON	80	240.00	19,200.00	600.00	48,000.00	
10	398200	COLD PLANE ASPHALT CONCRETE PAVEMENT (0.12)	SQYD	625	20.00	12,500.00	9.00	5,625.00	
11	017316	MINOR CONCRETE (CURB RAMP) (CRS 403 - CASE B)	EA	2	4,000.00	8,000.00	5,500.00	11,000.00	
12	731623	MINOR CONCRETE (CURB RAMP) [CALTRANS STD PLAN A88A CASE C]	EA	1	4,000.00	4,000.00	5,500.00	5,500.00	
13	017304	MINOR CONCRETE (CURB AND GUTTER) (CRS 200)	LF	510	32.00	16,320.00	50.00	25,500.00	
14	731504	MINOR CONCRETE (CURB AND GUTTER) [CALTRANS STD PLAN A87A]	LF	85	32.00	2,720.00	50.00	4,250.00	
15	017309	MINOR CONCRETE (TYPE D 6" CURB) (CRS 204)	LF	420	22.00	9,240.00	30.00	12,600.00	
16	017309	MINOR CONCRETE (TYPE D 8" CURB) (CRS 204)	LF	1,235	24.00	29,640.00	32.00	39,520.00	
17	510502	MINOR CONCRETE (MINOR STRUCTURE) [CONCRETE COLLAR RFCF & WCD STD. M803]	EA	4	600.00	2,400.00	1,000.00	4,000.00	
18	731519	MINOR CONCRETE (STAMPED CONCRETE)	SQFT	1,550	16.00	24,800.00	13.00	20,150.00	
19	641113	24" PLASTIC PIPE	LF	30	160.00	4,800.00	400.00	12,000.00	
20	665025	24" CORRUGATED STEEL PIPE (.138" THICK)	LF	52	200.00	10,400.00	400.00	20,800.00	
21	870400	SIGNAL AND LIGHTING SYSTEM	LS	1	290,000.00	290,000.00	331,000.00	331,000.00	

**Riverside County Transportation Department  
Summary of Bids**

**PROJECT: Grapefruit Boulevard and 62nd Avenue  
Traffic Signal and Safety Lighting Project  
In the Community of Mecca  
Project No. C3-0084  
Federal Aid No. HSIP-5956(236)**

Advertised: January 29, 2019 (Agenda Item: 3.32)  
Addenda: 1 (2/7/2019), 2 (2/14/2019), 3 (2/19/2019)  
Bids Open: 2 pm Date: Wednesday, February 27, 2019

BASE BID		COUNTY'S ESTIMATE				1 (Bid Tie)* Onyx Paving Company, Inc. Anaheim, CA 92806		
ITEM NO.	ITEM CODE	CONTRACT ITEM	UNITS	QUANTITY	UNIT PRICE	ENG ESTIMATE	BID UNIT PRICE	BID ESTIMATE
22	038400	REMOVE TRAFFIC STRIPING AND PAVEMENT MARKING	SQFT	8,500	1.25	10,625.00	0.77	6,545.00
23	840515	THERMOPLASTIC PAVEMENT MARKING	SQFT	1,300	5.00	6,500.00	10.00	13,000.00
24	840501	THERMOPLASTIC TRAFFIC STRIPE	LF	16,500	0.85	14,025.00	0.88	14,520.00
25	820230	REMOVE SIGN	EA	15	150.00	2,250.00	66.00	990.00
26	820840	ROADSIDE SIGN - ONE POST	EA	11	250.00	2,750.00	420.00	4,620.00
27	810230	PAVEMENT MARKER (RETROREFLECTIVE)	EA	410	5.00	2,050.00	5.00	2,050.00
28	015602	FUNDING AWARENESS SIGN	EA	2	1,500.00	3,000.00	1,500.00	3,000.00
29	999991	MOBILIZATION, DEMOBILIZATION, AND FINAL CLEANUP WORKING WITHIN RAILROAD RIGHT OF WAY, RELATIONS WITH RAILROAD [INCLUDING FLAGGING]	LS	1	50,000.00	50,000.00	37,000.00	37,000.00
30	066020		LS	1	88,000.00	88,000.00	10,980.00	10,980.00

<b>PROJECT TOTAL ITEMS 1 - 30</b>	<b>912,785.00</b>	<b>996,000.00 *</b>
---------------------------------------	-------------------	---------------------

**\* Note: Selection of lowest bidder is pending. Per Public Contract Code, section 22038.b, if two or more bids are the same and the lowest, the County of Riverside may accept the one it chooses.**



**Riverside County Transportation Department  
Summary of Bids**

**PROJECT: Grapefruit Boulevard and 62nd Avenue  
Traffic Signal and Safety Lighting Project  
In the Community of Mecca  
Project No. C3-0084  
Federal Aid No. HSIP-5956(236)**

Advertised: January 29, 2019 (Agenda Item: 3.32)  
Addenda: 1 (2/7/2019), 2 (2/14/2019), 3 (2/19/2019)  
Bids Open: 2 pm Date: Wednesday, February 27, 2019

BASE BID		1 (Bid Tie)*			2			
ITEM NO.	ITEM CODE	CONTRACT ITEM	UNITS	QUANTITY	BID UNIT PRICE	BID ESTIMATE	BID UNIT PRICE	BID ESTIMATE
1	066102	DUST ABATMENT	LS	1	20,000.00	20,000.00	5,000.00	5,000.00
2	074020	WATER POLLUTION CONTROL	LS	1	5,000.00	5,000.00	5,000.00	5,000.00
3	120100	TRAFFIC CONTROL SYSTEM	LS	1	20,000.00	20,000.00	30,000.00	30,000.00
4	100100	DEVELOP WATER SUPPLY	LS	1	3,000.00	3,000.00	5,000.00	5,000.00
5	170103	CLEARING AND GRUBBING	LS	1	8,000.00	8,000.00	10,000.00	10,000.00
6	190101 (F)	ROADWAY EXCAVATION (INCLUDE SAWCUT AND REMOVE AC PAVEMENT TO 0.4' DEEP)	CY	850	70.00	59,500.00	48.50	41,225.00
7	260203	CLASS 2 AGGREGATE BASE	CY	157	80.00	12,560.00	48.00	7,536.00
8	390132	HOT MIX ASPHALT (TYPE A)	TON	1,900	105.00	199,500.00	180.00	342,000.00
9	377501	SLURRY SEAL (TYPE 3)	TON	80	675.00	54,000.00	1,200.00	96,000.00
10	398200	COLD PLANE ASPHALT CONCRETE PAVEMENT (0.12')	SQYD	625	8.00	5,000.00	9.00	5,625.00
11	017316	MINOR CONCRETE (CURB RAMP) (CRS 403 - CASE B)	EA	2	4,200.00	8,400.00	3,800.00	7,600.00
12	731623	MINOR CONCRETE (CURB RAMP) [CALTRANS STD PLAN A88A CASE C]	EA	1	2,800.00	2,800.00	3,400.00	3,400.00
13	017304	MINOR CONCRETE (CURB AND GUTTER) (CRS 200)	LF	510	50.00	25,500.00	35.00	17,850.00
14	731504	MINOR CONCRETE (CURB AND GUTTER) [CALTRANS STD PLAN A87A]	LF	85	55.00	4,675.00	40.00	3,400.00
15	017309	MINOR CONCRETE (TYPE D 6" CURB) (CRS 204)	LF	420	25.00	10,500.00	18.00	7,560.00
16	017309	MINOR CONCRETE (TYPE D 8" CURB) (CRS 204)	LF	1,235	30.00	37,050.00	20.00	24,700.00
17	510502	MINOR CONCRETE (MINOR STRUCTURE) [CONCRETE COLLAR RCFC & WCD STD. M803]	EA	4	1,400.00	5,600.00	2,500.00	10,000.00
18	731519	MINOR CONCRETE (STAMPED CONCRETE)	SQFT	1,550	16.00	24,800.00	8.00	12,400.00
19	641113	24" PLASTIC PIPE	LF	30	145.00	4,350.00	250.00	7,500.00
20	665025	24" CORRUGATED STEEL PIPE (.138" THICK)	LF	52	200.00	10,400.00	300.00	15,600.00
21	870400	SIGNAL AND LIGHTING SYSTEM	LS	1	369,000.00	369,000.00	459,950.00	459,950.00

**Riverside County Transportation Department  
Summary of Bids**

**PROJECT: Grapefruit Boulevard and 62nd Avenue  
Traffic Signal and Safety Lighting Project  
In the Community of Mecca  
Project No. C3-0084  
Federal Aid No. HSIP-5956(236)**

Advertised: January 29, 2019 (Agenda Item: 3.32)  
Addenda: 1 (2/7/2019), 2 (2/14/2019), 3 (2/19/2019)  
Bids Open: 2 pm Date: Wednesday, February 27, 2019

BASE BID ITEM NO.	ITEM CODE	CONTRACT ITEM	UNITS	QUANTITY	1 (Bid Tie)* Granite Construction Company Indio, CA 92203		2 Desert Concepts Construction, Inc. Indio, CA 92203	
					BID UNIT PRICE	BID ESTIMATE	BID UNIT PRICE	BID ESTIMATE
22	038400	REMOVE TRAFFIC STRIPING AND PAVEMENT MARKING	SQFT	8,500	1.40	11,900.00	1.00	8,500.00
23	840515	THERMOPLASTIC PAVEMENT MARKING	SQFT	1,300	5.00	6,500.00	6.00	7,800.00
24	840501	THERMOPLASTIC TRAFFIC STRIPE	LF	16,500	0.80	13,200.00	1.10	18,150.00
25	820230	REMOVE SIGN	EA	15	100.00	1,500.00	170.00	2,550.00
26	820840	ROADSIDE SIGN - ONE POST	EA	11	450.00	4,950.00	300.00	3,300.00
27	810230	PAVEMENT MARKER (RETROREFLECTIVE)	EA	410	3.00	1,230.00	3.50	1,435.00
28	015602	FUNDING AWARENESS SIGN	EA	2	1,500.00	3,000.00	1,000.00	2,000.00
29	999991	MOBILIZATION, DEMOBILIZATION, AND FINAL CLEANUP WORKING WITHIN RAILROAD RIGHT OF WAY, RELATIONS WITH RAILROAD [INCLUDING FLAGGING]	LS	1	50,000.00	50,000.00	28,000.00	28,000.00
30	066020		LS	1	14,085.00	14,085.00	28,000.00	28,000.00

<b>PROJECT TOTAL ITEMS 1 - 30</b>	<b>996,000.00 *</b>	<b>1,217,081.00</b>
---------------------------------------	---------------------	---------------------

**\* Note: Selection of lowest bidder is pending. Per Public Contract Code, section 22038.b, if two or more bids are the same and the lowest, the County of Riverside may accept the one it chooses.**

## EXHIBIT 15-G CONSTRUCTION CONTRACT DBE COMMITMENT

1. Local Agency: County of Riverside 2. Contract DBE Goal: 12 %  
 3. Project Description: Grapefruit Boulevard and 62nd Avenue Traffic Signal and Safety Lighting Project  
 4. Project Location: In the Community of Mecca  
 5. Bidder's Name: Granite Construction Company 6. Prime Certified DBE:  7. Bid Amount: \$996,000.00  
 8. Total Dollar Amount for ALL Subcontractors: \$449,350.00 9. Total Number of ALL Subcontractors: Three (3)

10. Bid Item Number	11. Description of Work, Service, or Materials Supplied	12. DBE Certification Number	13. DBE Contact Information (Must be certified on the date bids are opened)	14. DBE Dollar Amount
21	Electrical	31277	California Professional Engineering, Inc. 929 Otterbein Avenue, Unit E La Puente, CA 91748 (626) 810-1336	\$343,000.00
<b>Local Agency to Complete this Section</b>				
21. Local Agency Contract Number: _____			<b>15. TOTAL CLAIMED DBE PARTICIPATION</b>	<b>\$ 343,000.00</b>
22. Federal-Aid Project Number: _____				<b>34.44 %</b>
23. Bid Opening Date: _____			IMPORTANT: Identify all DBE firms being claimed for credit, regardless of tier. Names of the First Tier DBE Subcontractors and their respective item(s) of work listed above must be consistent, where applicable with the names and items of the work in the "Subcontractor List" submitted with your bid. Written confirmation of each listed DBE is required.	
24. Contract Award Date: _____				
Local Agency certifies that all DBE certifications are valid and information on this form is complete and accurate.				
25. Local Agency Representative's Signature _____		26. Date _____	16. Preparer's Signature 	02/27/2019
27. Local Agency Representative's Name _____		28. Phone _____	Joseph P. Richardson	760-391-6247
29. Local Agency Representative's Title _____			18. Preparer's Name Chief Estimator	19. Phone _____
			20. Preparer's Title	

**DISTRIBUTION:** 1. Original – Local Agency  
 2. Copy – Caltrans District Local Assistance Engineer (DLAE). Failure to submit to DLAE within 30 days of contract execution may result in de-obligation of federal funds on contract. Include additional copy with award package.

**ADA Notice:** For individuals with sensory disabilities, this document is available in alternate formats. For information call (916) 654-6410 or TDD (916) 654-3880 or write Records and Forms Management, 1120 N Street, MS-89, Sacramento, CA 95814.

## INSTRUCTIONS – CONSTRUCTION CONTRACT DBE COMMITMENT

### CONTRACTOR SECTION

1. **Local Agency** - Enter the name of the local or regional agency that is funding the contract.
2. **Contract DBE Goal** - Enter the contract DBE goal percentage as it appears on the project advertisement.
3. **Project Location** - Enter the project location as it appears on the project advertisement.
4. **Project Description** - Enter the project description as it appears on the project advertisement (Bridge Rehab, Seismic Rehab, Overlay, Widening, etc).
5. **Bidder's Name** - Enter the contractor's firm name.
6. **Prime Certified DBE** - Check box if prime contractor is a certified DBE.
7. **Bid Amount** - Enter the total contract bid dollar amount for the prime contractor.
8. **Total Dollar Amount for ALL Subcontractors** - Enter the total dollar amount for all subcontracted contractors. SUM = (DBEs + all Non-DBEs). Do not include the prime contractor information in this count.
9. **Total number of ALL subcontractors** - Enter the total number of all subcontracted contractors. SUM = (DBEs + all Non-DBEs). Do not include the prime contractor information in this count.
10. **Bid Item Number** - Enter bid item number for work, services, or materials supplied to be provided.
11. **Description of Work, Services, or Materials Supplied** - Enter description of work, services, or materials to be provided. Indicate all work to be performed by DBEs including work performed by the prime contractor's own forces, if the prime is a DBE. If 100% of the item is not to be performed or furnished by the DBE, describe the exact portion to be performed or furnished by the DBE. See LAPM Chapter 9 to determine how to count the participation of DBE firms.
12. **DBE Certification Number** - Enter the DBE's Certification Identification Number. All DBEs must be certified on the date bids are opened.
13. **DBE Contact Information** - Enter the name, address, and phone number of all DBE subcontracted contractors. Also, enter the prime contractor's name and phone number, if the prime is a DBE.
14. **DBE Dollar Amount** - Enter the subcontracted dollar amount of the work to be performed or service to be provided. Include the prime contractor if the prime is a DBE. See LAPM Chapter 9 for how to count full/partial participation.
15. **Total Claimed DBE Participation - \$:** Enter the total dollar amounts entered in the "DBE Dollar Amount" column. **%:** Enter the total DBE participation claimed ("Total Claimed DBE Participation Dollars" divided by item "Bid Amount"). If the total % claimed is less than item "Contract DBE Goal," an adequately documented Good Faith Effort (GFE) is required (see Exhibit 15-H DBE Information - Good Faith Efforts of the LAPM).
16. **Preparer's Signature** - The person completing the DBE commitment form on behalf of the contractor's firm must sign their name.
17. **Date** - Enter the date the DBE commitment form is signed by the contractor's preparer.
18. **Preparer's Name** - Enter the name of the person preparing and signing the contractor's DBE commitment form.
19. **Phone** - Enter the area code and phone number of the person signing the contractor's DBE commitment form.
20. **Preparer's Title** - Enter the position/title of the person signing the contractor's DBE commitment form.

### LOCAL AGENCY SECTION

21. **Local Agency Contract Number** - Enter the Local Agency contract number or identifier.
22. **Federal-Aid Project Number** - Enter the Federal-Aid Project Number.
23. **Bid Opening Date** - Enter the date contract bids were opened.
24. **Contract Award Date** - Enter the date the contract was executed.
25. **Local Agency Representative's Signature** - The person completing this section of the form for the Local Agency must sign their name to certify that the information in this and the Contractor Section of this form is complete and accurate.
26. **Date** - Enter the date the DBE commitment form is signed by the Local Agency Representative.
27. **Local Agency Representative's Name** - Enter the name of the Local Agency Representative certifying the contractor's DBE commitment form.
28. **Phone** - Enter the area code and phone number of the person signing the contractor's DBE commitment form.
29. **Local Agency Representative Title** - Enter the position/title of the Local Agency Representative certifying the contractor's DBE commitment form.

**PLEASE NOTE:** This information may be submitted with your bid. If it is not, and you are the apparent low bidder or the second or third low bidder, it must be submitted and received as specified in the Special Provisions. Failure to submit the required DBE commitment will be grounds for finding the bid nonresponsive.



Patricia Romo, P.E.  
Director of Transportation

# COUNTY OF RIVERSIDE

## TRANSPORTATION AND LAND MANAGEMENT AGENCY

Mojahed Salama, P.E.  
Deputy for Transportation/Capital Projects  
Richard Lantis, P.L.S.  
Deputy for Transportation/Planning and  
Development

### Transportation Department

#### ADDENDUM NUMBER 1

Dated February 7, 2019

to the  
Specifications and Contract Documents  
for the construction of

Grapefruit Boulevard and 62nd Avenue  
Traffic Signal and Safety Lighting Project  
In the Community of Mecca

Project No. C3-0084  
Federal Project No. HSIP-5956(236)

**Bids Due:** (Revised)  
**Wednesday, February 20, 2019; 2:00 p.m.**  
14<sup>th</sup> Street Transportation Annex  
3525 14<sup>th</sup> Street; Riverside, CA 92501  
(951) 955-6780

This Addendum is issued pursuant to the Instructions to Bidders, Item No. 8, of the Contract Documents for the reference project. This Addendum is issued as a supplement to the specification and special provisions for the referenced project. The revisions to the specifications shall become a part of the Contract Documents, and each bidder shall acknowledge receipt thereof on the Bid (Proposal). Bidders are directed to sign this addendum as acknowledged, and attach the signed addendum to the contractor's submitted proposal.

Note: During the advertisement period of this project, this document and attachments (if any) are available upon request at the office of the Transportation Department, and are available as a free download at the Transportation Department's website:

<http://rctlma.org/trans/Contractors-Corner/Notices-Inviting-Bids>

#### MODIFICATIONS / CLARIFICATIONS TO SPECIAL PROVISIONS:

**Item 1: Bid Proposal Correction.** Refer to bid Proposal pages B2 through B3 in the contract documents. Bidders are instructed to add the letter (F) after the item code 190101, for bid item No. 6, ROADWAY EXCAVATION on proposal page B2. This item of work is a fixed cost. In the event that a bidding contractor fails to make this correction on the Proposal, the letter (F) will be added to the Proposal (and Contract) for this item to reflect the updated item code.

**Item 2: Working Within or Adjacent to the Railroad Right of Way:** Refer to Section 00-1.26, "Working Within or Adjacent to the Railroad Right of Way," on pages 14 through 16 of the special provisions. The following special provisions are added and made a part hereby:

- Delete the first paragraph of Section 00-1.26, on page 14, and replace it with the following paragraph:

In addition to these special provisions, the Contractor shall comply with the applicable provisions found in Appendix "E" –Union Pacific Railroad Company Public Highway At-Grade Crossing Agreement, and with the provisions found in the Union Pacific Railroad Company Wireline Crossing Agreement.

- Delete the last paragraph of Section 00-1.26, on page 16, and replace it with the following paragraph:

Full compensation for coordination, compliance, the actual costs of the railroad flagging and all other aspects of working within the UPRR right of way including obtaining required permits from UPRR, conform to UPRR Public Highway At-Grade Crossing Agreement and UPRR Wireline Crossing Agreement requirements, cooperation with UPRR, protection of railroad facilities, shall be considered as included in the contract lump sum price paid for Working Within Railroad Right of Way, Relations with Railroad [Including Flagging] and no additional compensation will be allowed therefor.

**Item 3: Union Pacific Railroad Company- Wireline Crossing Agreement.**

The Union Pacific Railroad Company- Wireline Crossing Agreement is included with this Addendum No. 1 as **Attachment A**.

For any discrepancies between the UPRR Public Highway At-Grade Crossing Agreement and the UPRR Wireline Crossing Agreement, the Contractor shall conform to the strictest requirements found in either of the documents.

**ATTACHMENTS**

**A – Union Pacific Railroad Company, Wireline Crossing Agreement (18 Pages)**

Addendum No. 1  
Grapefruit Boulevard and 62nd Avenue, Traffic Signal and Safety Lighting Project, In the Community of Mecca  
Project No. C3-0084, Federal Project No. HSIP-5956(236)  
February 7, 2019  
Page 3 of 3

---

This addendum has been prepared under the direction of the following registered Civil Engineer(s):

**Recommended by:**



---

Dowling Tsai, P.E.  
County Project Manager

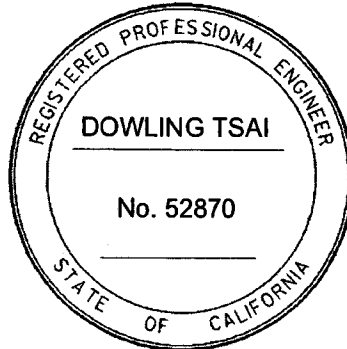

**Concurrence:**



---

Khalid Nasim, P.E.  
Engineering Division Manager

**Acknowledged:** \_\_\_\_\_ **Date:** \_\_\_\_\_  
(Contractor)

JRJ:jrj:rr

Note: Refer to Instruction to Bidders Item No. 8, "Addenda". Submission of all addendum pages and non-bidding document attachments of addendum are not necessary for Bid submittal. Submittal of this acknowledgement page is adequate for Bid reception. Bidders are reminded to list addendum number(s) received on the first page of the Bid form (Proposal).



Folder: 02960-82  
3/1/2018

MONICA TIAXCALA  
COUNTY OF RIVERSIDE  
3525 14TH STREET  
RIVERSIDE CA 92501

RE: Proposed Construction of a 120 Volt Wireline Crossing at Mile Post 621.65 on the Yuma Subdivision/Branch at or near Indio, Riverside County, California

Monica Tiaxcala:

Attached is your original copy of our Agreement, fully executed on behalf of the Railroad Company. When you or your representative enters the Railroad Company's property, a copy of this fully-executed document must be available at the site to be shown on request to any Railroad employee or official.

In accordance with the terms of the Agreement, you are required to notify the following Railroad Company's Manager of Track Maintenance, Manager of Signal Maintenance, and the Telecommunications ("Call Before You Dig") number at least 10 days in advance of the date you plan on entering the right of way for further instructions and approval to commence construction.

Railpros Flagging  
Upflag@railprosfs.com  
877-315-0513 x 116

**Telecommunications ("Call Before You Dig"): 1-800-336-9193**

As an additional note, the top of the casing must be a minimum of two feet below any existing fiber optic cable. Any open excavation required within five feet of the fiber optic cable must be dug by hand.

All future insurance notices should be forwarded to my attention per the address below with the Folder number identified:

Real Estate Department  
Folder No: 02960-82



ADIT 288183

Wireline Crossing 080808  
Last Modified: 03/29/10  
Form Approved, AVP-Law

WHEN DOCUMENT IS FULLY EXECUTED RETURN  
CLERK'S COPY  
County Clerk of the Board, Stop 1010  
P.O. Office Box 1147, Riverside, Ca 92502-1147  
Thank you.

Folder No. 02960-82

## WIRELINE CROSSING AGREEMENT

Mile Post: 621.65, Yuma Subdivision/Branch  
Location: Indio, Riverside County, California

**THIS AGREEMENT ("Agreement")** is made and entered into as of August 29, 2017, ("Effective Date") by and between **UNION PACIFIC RAILROAD COMPANY**, a Delaware corporation, ("Licensor") and **COUNTY OF RIVERSIDE**, addressed at 3525 14th Street, Riverside, California 92501 ("Licensee").

**IT IS MUTUALLY AGREED BY AND BETWEEN THE PARTIES HERETO AS FOLLOWS:**

**Article 1. LICENSOR GRANTS RIGHT.**

In consideration of the covenants and agreements herein contained to be by the Licensee kept, observed and performed, the Licensor hereby grants to the Licensee the right to construct and thereafter, during the term hereof, to maintain and operate

one underground 120 volt wireline

across Licensor's track(s) and property (the "Wireline") in the location shown and in conformity with the dimensions and specifications indicated on the attached print dated November 17, 2015, marked Exhibit "A" attached hereto and hereby made a part hereof. Under no circumstances shall Licensee modify the use of the Wireline for a purpose other than for the purpose set forth in this Article I, and the Wireline shall not be used for any other use, whether such use is currently technologically possible, or whether such use may come into existence during the life of this Agreement.

For the purposes of Exhibit A, Licensee acknowledges that if it or its contractor provides to Railroad digital imagery depicting the Wireline crossing, Licensee authorizes Railroad to use the Digital Imagery in preparing the print attached as an exhibit hereto. Licensee represents and warrants that through a license or otherwise, it has the right to use the Digital Imagery and to permit Railroad to use the Digital Imagery in said manner.

**Article 2. LICENSE FEE.**

Upon execution of this Agreement, the Licensee shall pay to the Licensor a one-time License Fee of **Two Thousand Eight Hundred Dollars (\$2,800.00)**.

**Article 3. ADMINISTRATIVE HANDLING CHARGE.**

Upon execution and delivery of this Agreement, the Licensee shall pay to the Licensor an License Fee of **Five Hundred Five DOLLARS (\$505.00)** for clerical, administrative and handling expense in connection with processing this Agreement.

ISSUED BY ADDENDUM No. 1, ATTACHMENT "A", Page 2 of 18

**Article 4. CONSTRUCTION, MAINTENANCE AND OPERATION.**

The grant of right herein made to the Licensee is subject to each and all of the terms, provisions, conditions, limitations and covenants set forth herein and in **Exhibit B**, attached hereto and hereby made a part hereof.

**Article 5. DEFINITION OF LICENSEE.**

For purposes of this Agreement, all references in this Agreement to the Licensee shall include the Licensee's contractors, subcontractors, officers, agents and employees, and others acting under its or their authority. If a contractor is hired by the Licensee for any work performed on the Wireline (including initial construction and subsequent relocation or maintenance and repair work), then the Licensee shall provide a copy of this Agreement to its contractor and require its contractor to comply with all the terms and provisions hereof relating to the work to be performed. Any contractor or subcontractor shall be deemed an agent of Licensee for the purpose of this Agreement, and Licensee shall require such contractor or subcontractor to release, defend and indemnify Licensor to the same extent and under the same terms and conditions as Licensee is required to release, defend and indemnify Licensor herein.

**Article 6. INSURANCE.**

A. During the life of this Agreement, Licensee shall fully comply with insurance requirements described in **Exhibit C**.

B. Failure to maintain insurance as required shall entitle, but not require, Licensor to terminate this License immediately.

C. If the Licensee is subject to statute(s) limiting its insurance liability and/or limiting its ability to obtain insurance in compliance with **Exhibit C** of this license, those statutes shall apply.

D. Licensee hereby acknowledges that it has reviewed the requirements of **Exhibit C**, including without limitation the requirement for Railroad Protective Liability Insurance during construction, maintenance, installation, repair or removal of the wireline which is the subject of this Agreement.

**Article 7. TERM.**

This Agreement shall take effect as of the Effective Date first herein written and shall continue in full force and effect until terminated as herein provided.

**IN WITNESS WHEREOF**, the parties hereto have caused this Agreement to be executed as of the date first herein written.

**UNION PACIFIC RAILROAD COMPANY**

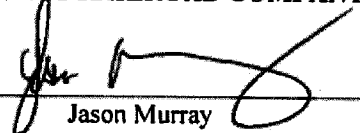
By:   
Jason Murray  
Asst. Manager - Real Estate

**COUNTY OF RIVERSIDE**

By:   
Name Printed: Chuck Washington  
Title: Chairman  
Board of Supervisors

**APPROVED AS TO FORM:**

Gregory P. Priamos, County Counsel

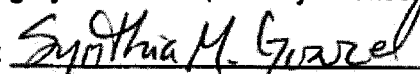
By:   
CYNTHIA M. GUNZEL  
Deputy County Counsel

ATTEST:  
KECIA HARPER-JHEM, Clerk  
By:   
DEPUTY

ISSUED BY ADDENDUM No. 1, ATTACHMENT "A", Page 3 of 18

PLACE ARROW INDICATING NORTH DIRECTION RELATIVE TO CROSSING

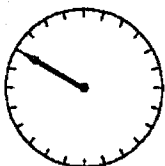

# UNDERGROUND WIRELINE CROSSING

## 750 VOLTS OR LESS

NOTE: ALL AVAILABLE DIMENSIONS MUST BE FILLED IN TO PROCESS THIS APPLICATION.

FORM DR-0404-F

REV 10-26-2007

www.uprr.com

NO SCALE

(OR LEGAL SURVEY LINE, WHERE APPLICABLE)  
 LINE SECTION \_\_\_\_\_ TOWNSHIP \_\_\_\_\_ RANGE \_\_\_\_\_ MERIDIAN \_\_\_\_\_

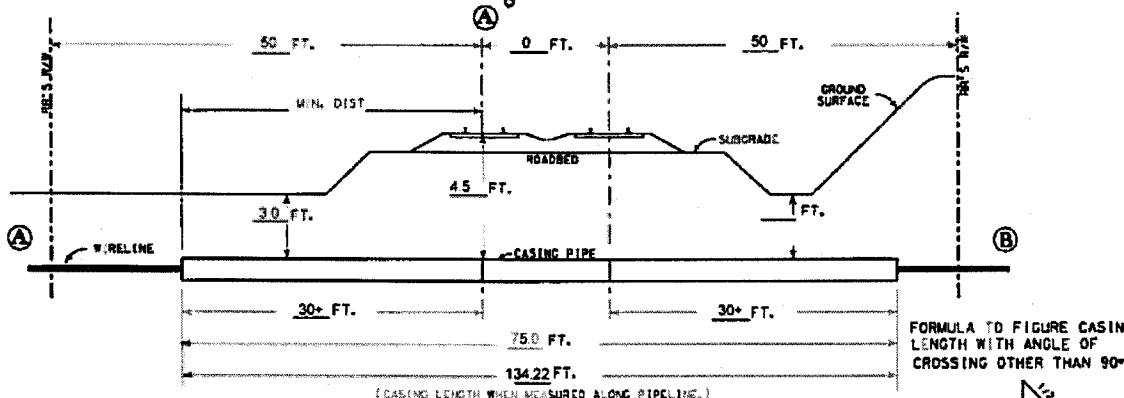
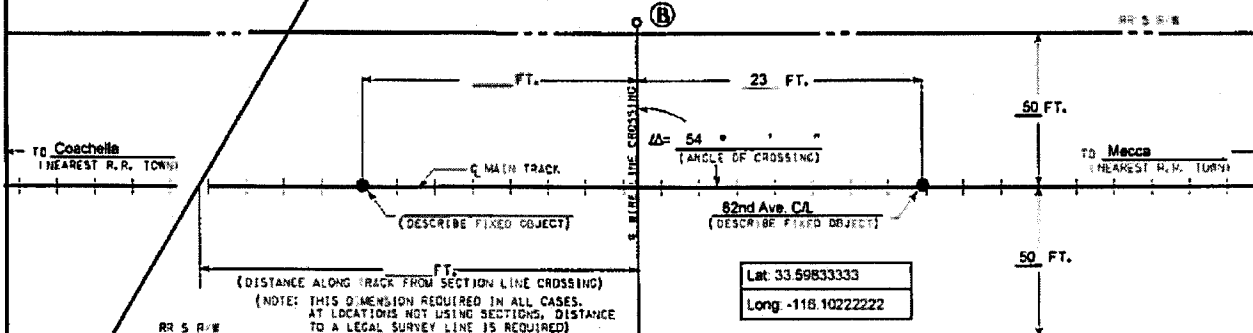

NOTES :

- A) TYPE WIRELINE CROSSING: Electric
- B) VOLTAGE TO BE CARRIED UNDER TRACK 120 NO. OF WIRES 4
- C) CASING TYPE TO BE INSTALLED Metallic Conduit
- D) METHOD OF INSTALLING CASING PIPE UNDER TRACK(S):  
 (WET BORE NOT PERMITTED); Dry Bore and Jack
- E) DISTANCE FROM CENTER LINE OF TRACK TO NEAR FACE OF BORING AND JACKING PITS WHEN MEASURED AT RIGHT ANGLES TO TRACK 30.0  
 (30° MIN.)
- F) DISTANCE TO NEAREST ROAD CROSSING WITH SIGNAL LIGHTS OR GATES (IF LESS THAN ONE MILE) 23.0
- G) APPLICANT HAS CONTACTED 800-336-9193, U. P. COMMUNICATION DEPARTMENT, AND HAS DETERMINED FIBER OPTIC CABLE does EXIST IN VICINITY OF WORK TO BE PERFORMED. TICKET NO. 20151116053

**EXHIBIT "A"**  
FOR RAILROAD USE ONLY - DO NOT WRITE IN THIS BOX

**UNION PACIFIC RAILROAD CO.**

Yuma Sub.  
(SUBDIVISION)

M. P. 621.65 E. S. 8466+75

**UNDERGROUND WIRELINE CROSSING**

INDIO Riverside CA  
(NEAREST RR STATION) (COUNTY) (STATE)

FOR COUNTY OF RIVERSIDE  
(APPLICANT)

RR FILE NO. 0296082 DATE 11/17/2015

**WARNING**

IN ALL OCCASIONS, U. P. COMMUNICATIONS DEPARTMENT MUST BE CONTACTED IN ADVANCE OF ANY WORK TO DETERMINE EXISTENCE AND LOCATION OF FIBER OPTIC CABLE.  
 PHONE 1-800-336-9193

ISSUED BY ADDENDUM No. 1, ATTACHMENT "A", Page 4 of 18

**EXHIBIT B**

**Section 1. LIMITATION AND SUBORDINATION OF RIGHTS GRANTED.**

The foregoing grant of right is subject and subordinate to the prior and continuing right and obligation of the Licensor to use and maintain its entire property including the right and power of the Licensor to construct, maintain, repair, renew, use, operate, change, modify or relocate railroad tracks, signal, communication, fiber optics, or other wirelines, pipelines and other facilities upon, along or across any or all parts of its property, all or any of which may be freely done at any time or times by the Licensor without liability to the Licensee or to any other party for compensation or damages.

The foregoing grant is also subject to all outstanding superior rights (including those in favor of licensees and lessees of the Licensor's property, and others) and the right of the Licensor to renew and extend the same, and is made without covenant of title or for quiet enjoyment.

**Section 2. CONSTRUCTION, MAINTENANCE AND OPERATION.**

A. The Wireline shall be designed, constructed, operated, maintained, repaired, renewed, modified and/or reconstructed by the Licensee in strict conformity with (i) Licensor's current standards and specifications ("UP Specifications"), except for variances approved in advance in writing by the Licensor's Assistant Vice President Engineering - Design, or his authorized representative; (ii) such other additional safety standards as the Licensor, in its sole discretion, elects to require, including, without limitation, American Railway Engineering and Maintenance-of-Way Association ("AREMA") standards and guidelines (collectively, "UP Additional Requirements"), and (iii) all applicable laws, rules and regulations ("Laws"). If there is any conflict between the requirements of any Law and the UP Specifications or the UP Additional Requirements, the most restrictive will apply.

All work performed on property of the Licensor in connection with the design, construction, maintenance, repair, renewal, modification or reconstruction of the Wireline shall be done to the satisfaction of the Licensor.

B. If the Wireline is an existing one not conforming in its construction to the above provisions of this Section 2, the Licensee shall, within ninety (90) days after the date hereof, reconstruct it so as to conform therewith.

C. The Wireline shall be designed, constructed, maintained and operated by the Licensee in such manner as not to be or constitute a hazard to aviation. With respect to the Wireline the Licensee, without expense to the Licensor, will comply with all requirements of law and of public authority, whether federal, state or local, including but not limited to aviation authorities.

D. In the operation of the Wireline, the Licensee shall not transmit electric current at a difference of potential in excess of the voltage indicated on Exhibit A. If the voltage indicated is in excess of seven hundred fifty (750) volts, and the Wireline is, or is to be, buried at any location on the property of the Licensor outside track ballast sections or roadbed, the Licensee shall install metallic conduit, or non-metallic conduit encased in a minimum of three (3) inches of concrete with a minimum of four (4) feet of ground cover the entire length of the Wireline on the property of the Licensor. A Wireline buried by removal of the soil shall have, at a depth of one (1) foot beneath the surface of the ground

directly above the Wireline, a six (6) inch wide warning tape bearing the warning, "Danger-High Voltage", or equivalent wording. A Wireline encased in conduit, jacked or bored under the property of the Licensor, must be identified by placing warning signs, to be installed and properly maintained at the expense of the Licensee, at each edge of the Licensor's property. The Licensee shall not utilize the signs in lieu of the warning tape where portions of the casing are installed by direct burial.

E. Prior to the commencement of any work in connection with the design, construction, maintenance, repair, renewal, modification, relocation, reconstruction or removal of the Wireline, the Licensee shall submit to the Licensor plans setting out the method and manner of handling the work, including the shoring and cribbing, if any, required to protect the Licensor's operations, and shall not proceed with the work until such plans have been approved by the Licensor's Assistant Vice President Engineering Design, or his authorized representative, and then the work shall be done to the satisfaction of the Licensor's Assistant Vice President Engineering Design or his authorized representative. The Licensor shall have the right, if it so elects, to provide such support as it may deem necessary for the safety of its track or tracks during the time of construction, maintenance, repair, renewal, modification, relocation, reconstruction or removal of the Wireline, and, in the event the Licensor provides such support, the Licensee shall pay to the Licensor, within fifteen (15) days after bills shall have been rendered therefore, all expenses incurred by the Licensor in connection therewith, which expenses shall include all assignable costs.

F. The Licensee shall keep and maintain the soil over the Wireline thoroughly compacted and the grade even with the adjacent surface of the ground.

G. In the prosecution of any work covered by this Agreement, Licensee shall secure any and all necessary permits and shall comply with all applicable federal, state and local laws, regulations and enactments affecting the work including, without limitation, all applicable Federal Railroad Administration regulations.

**Section 3. NOTICE OF COMMENCEMENT OF WORK / LICENSOR REPRESENTATIVE / SUPERVISION / FLAGGING / SAFETY.**

A. If an emergency should arise requiring immediate attention, the Licensee shall provide as much notice as practicable to Licensor before commencing any work. In all other situations, the Licensee shall notify the Licensor at least ten (10) days (or such other time as the Licensor may allow) in advance of the commencement of any work upon property of the Licensor in connection with the construction, maintenance, repair, renewal, modification, reconstruction, relocation or removal of the Wireline. All such work shall be prosecuted diligently to completion. The Licensee will coordinate its initial, and any subsequent work with the following employee of Licensor or his or her duly authorized representative (hereinafter "Licensor Representative" or "Railroad Representative"):

**SMITH, Charlie J.**  
MANAGER OF TRACK MAINTENANCE  
909/ 685-2154  
cjsmith@up.com  
PO BOX ZZ45-050 PACIFIC  
INDIO, CA 92202

**CHAVEZ, Marc A.**  
MANAGER OF SIGNAL MAINTENANCE  
909/ 685-2269  
machavez@up.com  
235 Luis Estrada St  
Beaumont, CA 92223

B. Licensee, at its own expense, shall adequately police and supervise all work to be performed. The responsibility of Licensee for safe conduct and adequate policing and supervision of work shall not be lessened or otherwise affected by Licensor's approval of plans and specifications involving the work, or by Licensor's collaboration in performance of any work, or by the presence at the work site

of a Licensor Representative, or by compliance by Licensee with any requests or recommendations made by the Licensor Representative.

C. At the request of Licensor, Licensee shall remove from Licensor's property any employee who fails to conform to the instructions of the Licensor Representative in connection with the work on Licensor's property. Licensee shall indemnify Licensor against any claims arising from the removal of any such employee from Licensor's property.

D. Licensee shall notify the Licensor Representative at least ten (10) working days in advance of proposed performance of any work in which any person or equipment will be within twenty-five (25) feet of any track, or will be near enough to any track that any equipment extension (such as, but not limited to, a crane boom) will reach to within twenty-five (25) feet of any track. No work of any kind shall be performed, and no person, equipment, machinery, tool(s), material(s), vehicle(s), or thing(s) shall be located, operated, placed, or stored within twenty-five (25) feet of any of Licensor's track(s) at any time, for any reason, unless and until a railroad flagman is provided to watch for trains. Upon receipt of such ten (10) day notice, the Licensor Representative will determine and inform Licensee whether a flagman need be present and whether any special protective or safety measures need to be implemented. If flagging or other special protective or safety measures are performed by Licensor, Licensor will bill Licensee for such expenses incurred by Licensor, unless Licensor and a federal, state or local governmental entity have agreed that Licensor is to bill such expenses to the federal, state or local governmental entity. If Licensor will be sending the bills to Licensee, Licensee shall pay such bills within thirty (30) days of receipt of billing. If Licensor performs any flagging, or other special protective or safety measures are performed by Licensor, Licensee agrees that Licensee is not relieved of any of responsibilities or liabilities set forth in this Agreement.

E. The rate of pay per hour for each flagman will be the prevailing hourly rate in effect for an eight-hour day for the class of flagmen used during regularly assigned hours and overtime in accordance with Labor Agreements and Schedules in effect at the time the work is performed. In addition to the cost of such labor, a composite charge for vacation, holiday, health and welfare, supplemental sickness, Railroad Retirement and unemployment compensation, supplemental pension, Employees Liability and Property Damage and Administration will be included, computed on actual payroll. The composite charge will be the prevailing composite charge in effect at the time the work is performed. One and one-half times the current hourly rate is paid for overtime, Saturdays and Sundays, and two and one-half times current hourly rate for holidays. Wage rates are subject to change, at any time, by law or by agreement between Licensor and its employees, and may be retroactive as a result of negotiations or a ruling of an authorized governmental agency. Additional charges on labor are also subject to change. If the wage rate or additional charges are changed, Licensee (or the governmental entity, as applicable) shall pay on the basis of the new rates and charges.

F. Reimbursement to Licensor will be required covering the full eight-hour day during which any flagman is furnished, unless the flagman can be assigned to other railroad work during a portion of such day, in which event reimbursement will not be required for the portion of the day during which the flagman is engaged in other railroad work. Reimbursement will also be required for any day not actually worked by the flagman following the flagman's assignment to work on the project for which Licensor is required to pay the flagman and which could not reasonably be avoided by Licensor by assignment of such flagman to other work, even though Licensee may not be working during such time. When it becomes necessary for Licensor to bulletin and assign an employee to a flagging position in compliance with union collective bargaining agreements, Licensee must provide Licensor a minimum of five (5) days notice prior to the cessation of the need for a flagman. If five (5) days notice of cessation is not given, Licensee will still be required to pay flagging charges for the five (5) day notice period required by union agreement to be given to the employee, even though flagging is not required for that period. An

additional ten (10) days notice must then be given to Licensor if flagging services are needed again after such five day cessation notice has been given to Licensor.

G. Safety of personnel, property, rail operations and the public is of paramount importance in the prosecution of the work performed by Licensee or its contractor. Licensee shall be responsible for initiating, maintaining and supervising all safety, operations and programs in connection with the work. Licensee and its contractor shall at a minimum comply with Licensor's safety standards listed in Exhibit D, hereto attached, to ensure uniformity with the safety standards followed by Licensor's own forces. As a part of Licensee's safety responsibilities, Licensee shall notify Licensor if it determines that any of Licensor's safety standards are contrary to good safety practices. Licensee and its contractor shall furnish copies of Exhibit D to each of its employees before they enter the job site.

H. Without limitation of the provisions of paragraph G above, Licensee shall keep the job site free from safety and health hazards and ensure that their employees and contractors and subcontractors are competent and adequately trained in all safety and health aspects of the job.

I. Licensee shall have proper first aid supplies available on the job site so that prompt first aid services may be provided to any person injured on the job site. Prompt notification shall be given to Licensor of any U.S. Occupational Safety and Health Administration reportable injuries. Licensee shall have a non-delegable duty to control its employees while they are on the job site or any other property of Licensor, and to be certain they do not use, be under the influence of, or have in their possession any alcoholic beverage, drug or other substance that may inhibit the safe performance of any work.

J. If and when requested by Licensor, Licensee shall deliver to Licensor a copy of its safety plan for conducting the work (the "Safety Plan"). Licensor shall have the right, but not the obligation, to require Licensee to correct any deficiencies in the Safety Plan. The terms of this Agreement shall control if there are any inconsistencies between this Agreement and the Safety Plan.

**Section 4. LICENSEE TO BEAR ENTIRE EXPENSE.**

The Licensee shall bear the entire cost and expense incurred in connection with the design, construction, maintenance, repair and renewal and any and all modification, revision, relocation, removal or reconstruction of the Wireline, including any and all expense which may be incurred by the Licensor in connection therewith for supervision, inspection, flagging, or otherwise.

**Section 5. REINFORCEMENT, RELOCATION OR REMOVAL OF WIRELINE.**

A. The license herein granted is subject to the needs and requirements of the Licensor in the safe and efficient operation of its railroad and in the improvement and use of its property. The Licensee shall, at the sole expense of the Licensee, reinforce or otherwise modify the Wireline, or move all or any portion of the Wireline to such new location, or remove the Wireline from the Licensor's property, as the Licensor may designate, whenever, in the furtherance of its needs and requirements, the Licensor, at its sole election, finds such action necessary or desirable.

B. All the terms, conditions and stipulations herein expressed with reference to the Wireline on property of the Licensor in the location hereinbefore described shall, so far as the Wireline remains on the property, apply to the Wireline as modified, changed or relocated within the contemplation of this section.

**Section 6. NO INTERFERENCE WITH LICENSOR'S OPERATION.**

A. The Wireline and all parts thereof within and outside of the limits of the property of the Licensor shall be designed, constructed and, at all times, maintained, repaired, renewed and operated in such manner as to cause no interference whatsoever with the constant, continuous and uninterrupted use of the tracks, property and facilities of the Licensor (including without limitation, its tracks, pole lines, communication lines, radio equipment, wayside and/or cab based train signal systems, advanced train control systems, positive train separation systems, and grade crossing systems), and nothing shall be done or suffered to be done by the Licensee at any time that would in any manner impair the safety thereof.

B. In the operation and maintenance of the Wireline the Licensee shall take all suitable precaution to prevent any interference (by induction, leakage of electricity, or otherwise) with the operation of the signal, communication lines or other installations or facilities of the Licensor or of its tenants; and if, at any time, the operation or maintenance of the Wireline results in any electrostatic effects which the Licensor deems undesirable or harmful, or causes interference with the operation of the signal, communication lines or other installations or facilities, as now existing or which may hereafter be provided by the Licensor and/or its tenants, the Licensee shall, at the sole expense of the Licensee, immediately make such modifications or take such action as may be necessary to eliminate such interference. Licensee agrees to pay for any reasonable modifications, design changes, or increased costs that may be necessary now or in the future to ensure safe and reliable maintenance and operation of the facilities of Licensor and/or its tenants because of interference from the Wireline.

C. Explosives or other highly flammable substances shall not be stored on Licensor's property without the prior written approval of Licensor.

D. No additional vehicular crossings (including temporary Licensee haul roads) or pedestrian crossings over Licensor's trackage shall be installed or used by Licensee or its contractors without the prior written permission of Licensor.

E. When not in use, any machinery and materials of Licensee or its contractors shall be kept at least fifty (50) feet from the centerline of Licensor's nearest track.

F. Operations of Licensor and work performed by Licensor's personnel may cause delays in the work to be performed by Licensee. Licensee accepts this risk and agrees that Licensor shall have no liability to Licensee or any other person or entity for any such delays. Licensee shall coordinate its activities with those of Licensor and third parties so as to avoid interference with railroad operations. The safe operation of Licensor's train movements and other activities by Licensor take precedence over any work to be performed by Licensee.

**Section 7. PROTECTION OF FIBER OPTIC CABLE SYSTEMS.**

A. Fiber optic cable systems may be buried on the Licensor's property. Protection of the fiber optic cable systems is of extreme importance since any break could disrupt service to users resulting in business interruption and loss of revenue and profits. Licensee shall telephone the Licensor during normal business hours (7:00 a.m. to 9:00 p.m. Central Time, Monday through Friday, except for holidays) at 1-800-336-9193 (also a 24-hour, 7-day number for emergency calls) to determine if fiber optic cable is buried anywhere on the Licensor's premises to be used by the Licensee. If it is, Licensee will telephone the telecommunications company(ies) involved, arrange for a cable locator, make arrangements for relocation or other protection of the fiber optic cable, all at Licensee's expense, and will commence no work on the Licensor's property until all such protection or relocation has been accomplished. Licensee shall indemnify and hold the Licensor harmless from and against all costs, liability and expense



whatsoever (including, without limitation, attorneys' fees, court costs and expenses) arising out of or caused in any way by Licensee's failure to comply with the provisions of this paragraph.

**B. IN ADDITION TO OTHER INDEMNITY PROVISIONS IN THIS AGREEMENT, THE LICENSEE SHALL, AND SHALL CAUSE ITS CONTRACTOR TO, RELEASE, INDEMNIFY, DEFEND AND HOLD THE LICENSOR HARMLESS FROM AND AGAINST ALL COSTS, LIABILITY AND EXPENSE WHATSOEVER (INCLUDING, WITHOUT LIMITATION, ATTORNEYS' FEES, COURT COSTS AND EXPENSES) CAUSED BY THE NEGLIGENCE OF THE LICENSEE, ITS CONTRACTORS, AGENTS AND/OR EMPLOYEES, RESULTING IN (1) ANY DAMAGE TO OR DESTRUCTION OF ANY TELECOMMUNICATIONS SYSTEM ON LICENSOR'S PROPERTY, AND/OR (2) ANY INJURY TO OR DEATH OF ANY PERSON EMPLOYED BY OR ON BEHALF OF ANY TELECOMMUNICATIONS COMPANY, AND/OR ITS CONTRACTOR, AGENTS AND/OR EMPLOYEES, ON LICENSOR'S PROPERTY, EXCEPT IF SUCH COSTS, LIABILITY OR EXPENSES ARE CAUSED SOLELY BY THE DIRECT ACTIVE NEGLIGENCE OF THE LICENSOR. LICENSEE FURTHER AGREES THAT IT SHALL NOT HAVE OR SEEK RECOURSE AGAINST LICENSOR FOR ANY CLAIM OR CAUSE OF ACTION FOR ALLEGED LOSS OF PROFITS OR REVENUE OR LOSS OF SERVICE OR OTHER CONSEQUENTIAL DAMAGE TO A TELECOMMUNICATION COMPANY USING LICENSOR'S PROPERTY OR A CUSTOMER OR USER OF SERVICES OF THE FIBER OPTIC CABLE ON LICENSOR'S PROPERTY.**

**Section 8. CLAIMS AND LIENS FOR LABOR AND MATERIAL; TAXES.**

**A.** The Licensee shall fully pay for all materials joined or affixed to and labor performed upon property of the Licensor in connection with the construction, maintenance, repair, renewal, modification or reconstruction of the Wireline, and shall not permit or suffer any mechanic's or materialman's lien of any kind or nature to be enforced against the property for any work done or materials furnished thereon at the instance or request or on behalf of the Licensee. The Licensee shall indemnify and hold harmless the Licensor against and from any and all liens, claims, demands, costs and expenses of whatsoever nature in any way connected with or growing out of such work done, labor performed, or materials furnished.

**B.** The Licensee shall promptly pay or discharge all taxes, charges and assessments levied upon, in respect to, or on account of the Wireline, to prevent the same from becoming a charge or lien upon property of the Licensor, and so that the taxes, charges and assessments levied upon or in respect to such property shall not be increased because of the location, construction or maintenance of the Wireline or any improvement, appliance or fixture connected therewith placed upon such property, or on account of the Licensee's interest therein. Where such tax, charge or assessment may not be separately made or assessed to the Licensee but shall be included in the assessment of the property of the Licensor, then the Licensee shall pay to the Licensor an equitable proportion of such taxes determined by the value of the Licensee's property upon property of the Licensor as compared with the entire value of such property.

**Section 9. RESTORATION OF LICENSOR'S PROPERTY.**

In the event the Licensee in any manner moves or disturbs any of the property of the Licensor in connection with the construction, maintenance, repair, renewal, modification, reconstruction, relocation or removal of the Wireline, then in that event the Licensee shall, as soon as possible and at Licensee's sole expense, restore property to the same condition as the same were in before such property was moved or disturbed, and the Licensee shall indemnify and hold harmless the Licensor, its officers, agents and employees, against and from any and all liability, loss, damages, claims, demands, costs and expenses of

whatsoever nature, including court costs and attorneys' fees, which may result from injury to or death of persons whomsoever, or damage to or loss or destruction of property whatsoever, when such injury, death, damage, loss or destruction grows out of or arises from the moving or disturbance of any property of the Licensor.

**Section 10. INDEMNITY.**

A. As used in this Section, "Licensor" includes other railroad companies using the Licensor's property at or near the location of the Licensee's installation and their officers, agents, and employees; "Loss" includes loss, damage, claims, demands, actions, causes of action, penalties, costs, and expenses of whatsoever nature, including court costs and attorneys' fees, which may result from: (a) injury to or death of persons whomsoever (including the Licensor's officers, agents, and employees, the Licensee's officers, agents, and employees, as well as any other person); and/or (b) damage to or loss or destruction of property whatsoever (including Licensee's property, damage to the roadbed, tracks, equipment, or other property of the Licensor, or property in its care or custody).

B. AS A MAJOR INDUCEMENT AND IN CONSIDERATION OF THE LICENSE AND PERMISSION HEREIN GRANTED, TO THE FULLEST EXTENT PERMITTED BY LAW, THE LICENSEE SHALL, AND SHALL CAUSE ITS CONTRACTOR TO, RELEASE, INDEMNIFY, DEFEND AND HOLD HARMLESS THE LICENSOR FROM ANY LOSS OF ANY KIND, NATURE OR DESCRIPTION ARISING OUT OF, RESULTING FROM OR RELATED TO (IN WHOLE OR IN PART):

1. THE PROSECUTION OF ANY WORK CONTEMPLATED BY THIS AGREEMENT INCLUDING THE INSTALLATION, CONSTRUCTION, MAINTENANCE, REPAIR, RENEWAL, MODIFICATION, RECONSTRUCTION, RELOCATION, OR REMOVAL OF THE WIRELINE OR ANY PART THEREOF;
2. ANY RIGHTS OR INTERESTS GRANTED PURSUANT TO THIS LICENSE;
3. THE PRESENCE, OPERATION, OR USE OF THE WIRELINE OR ELECTRICAL INTERFERENCE OR OTHER TYPES OF INTERFERENCE CREATED OR CAUSED BY THE WIRELINE OR ESCAPING FROM THE WIRELINE;
4. THE ENVIRONMENTAL STATUS OF THE PROPERTY CAUSED BY OR CONTRIBUTED BY LICENSEE;
5. ANY ACT OR OMISSION OF LICENSEE OR LICENSEE'S OFFICERS, AGENTS, INVITEES, EMPLOYEES, OR CONTRACTORS OR ANYONE DIRECTLY OR INDIRECTLY EMPLOYED BY ANY OF THEM, OR ANYONE THEY CONTROL OR EXERCISE CONTROL OVER; OR
6. LICENSEE'S BREACH OF THIS AGREEMENT,

EXCEPT WHERE THE LOSS IS CAUSED BY THE SOLE DIRECT AND ACTIVE NEGLIGENCE OF THE LICENSOR, AS DETERMINED IN A FINAL JUDGMENT BY A COURT OF COMPETENT JURISDICTION, IT BEING THE INTENTION OF THE PARTIES THAT THE ABOVE INDEMNITY

WILL OTHERWISE APPLY TO LOSSES CAUSED BY OR ARISING FROM, IN WHOLE OR IN PART, LICENSOR'S NEGLIGENCE.

C. Upon written notice from Licensor, Licensee agrees to assume the defense of any lawsuit of proceeding brought against any indemnitee by any entity, relating to any matter covered by this License for which Licensee has an obligation to assume liability for and/or save and hold harmless any indemnitee. Licensee shall pay all costs incident to such defense, including, but not limited to, reasonable attorney's fees, investigators' fees, litigation and appeal expenses, settlement payments and amounts paid in satisfaction of judgments.

**Section 11. REMOVAL OF WIRELINE UPON TERMINATION OF AGREEMENT.**

Prior to the termination of this Agreement howsoever, the Licensee shall, at Licensee's sole expense, remove the Wireline from those portions of the property not occupied by the roadbed and track or tracks of the Licensor and shall restore, to the satisfaction of the Licensor, such portions of such property to as good a condition as they were in at the time of the construction of the Wireline. If the Licensee fails to do the foregoing, the Licensor may, but is not obligated, perform such work of removal and restoration at the cost and expense of the Licensee. In the event of the removal by the Licensor of the property of the Licensee and of the restoration of the roadbed and property as herein provided, the Licensor shall in no manner be liable to the Licensee for any damage sustained by the Licensee for or on account thereof, and such removal and restoration shall in no manner prejudice or impair any right of action for damages, or otherwise, that the Licensor may have against the Licensee.

**Section 12. WAIVER OF BREACH.**

The waiver by the Licensor of the breach of any condition, covenant or agreement herein contained to be kept, observed and performed by the Licensee shall in no way impair the right of the Licensor to avail itself of any remedy for any subsequent breach thereof.

**Section 13. TERMINATION.**

A. If the Licensee does not use the right herein granted or the Wireline for one (1) year, or if the Licensee continues in default in the performance of any covenant or agreement herein contained for a period of thirty (30) days after written notice from the Licensor to the Licensee specifying such default, the Licensor may, at its option, forthwith immediately terminate this Agreement by written notice.

B. In addition to the provisions of subparagraph (a) above, this Agreement may be terminated by written notice given by either party hereto to the other on any date in such notice stated, not less, however, than thirty (30) days subsequent to the date upon which such notice shall be given.

C. Notice of default and notice of termination may be served personally upon the Licensee or by mailing to the last known address of the Licensee. Termination of this Agreement for any reason shall not affect any of the rights or obligations of the parties hereto which may have accrued, or liabilities, accrued or otherwise, which may have arisen prior thereto.

**Section 14. AGREEMENT NOT TO BE ASSIGNED.**

The Licensee shall not assign this Agreement, in whole or in part, or any rights herein granted, without the written consent of the Licensor, and it is agreed that any transfer or assignment or attempted transfer or assignment of this Agreement or any of the rights herein granted, whether voluntary, by operation of law, or otherwise, without such consent in writing, shall be absolutely void and, at the option

of the Licensor, shall terminate this Agreement.

**Section 15. SUCCESSORS AND ASSIGNS.**

Subject to the provisions of Section 14 hereof, this Agreement shall be binding upon and inure to the benefit of the parties hereto, their heirs, executors, administrators, successors and assigns.

**Section 16. SEVERABILITY.**

Any provision of this Agreement which is determined by a court of competent jurisdiction to be invalid or unenforceable shall be invalid or unenforceable only to the extent of such determination, which shall not invalidate or otherwise render ineffective any other provision of this Agreement.

ISSUED BY ADDENDUM No. 1, ATTACHMENT "A", Page 13 of 18

**EXHIBIT C**

**Union Pacific Railroad Company  
Contract Insurance Requirements**

Licensee shall, at its sole cost and expense, procure and maintain during the life of this Agreement (except as otherwise provided in this Agreement) the following insurance coverage:

- A. **Commercial General Liability** insurance. Commercial general liability (CGL) with a limit of not less than \$2,000,000 each occurrence and an aggregate limit of not less than \$4,000,000. CGL insurance must be written on ISO occurrence form CG 00 01 12 04 (or a substitute form providing equivalent coverage).

The policy must also contain the following endorsement, WHICH MUST BE STATED ON THE CERTIFICATE OF INSURANCE: "Contractual Liability Railroads" ISO form CG 24 17 10 01 (or a substitute form providing equivalent coverage) showing "Union Pacific Railroad Company Property" as the Designated Job Site.

- B. **Business Automobile Coverage** insurance. Business auto coverage written on ISO form CA 00 01 10 01 (or a substitute form providing equivalent liability coverage) with a limit of not less \$2,000,000 for each accident, and coverage must include liability arising out of any auto (including owned, hired, and non-owned autos).

The policy must contain the following endorsements, WHICH MUST BE STATED ON THE CERTIFICATE OF INSURANCE: "Coverage For Certain Operations In Connection With Railroads" ISO form CA 20 70 10 01 (or a substitute form providing equivalent coverage) showing "Union Pacific Property" as the Designated Job Site.

- C. **Workers Compensation and Employers Liability** insurance. Coverage must include but not be limited to:

Licensee's statutory liability under the workers' compensation laws of the state(s) affected by this Agreement.

Employers' Liability (Part B) with limits of at least \$500,000 each accident, \$500,000 disease policy limit \$500,000 each employee.

If Licensee is self-insured, evidence of state approval and excess workers compensation coverage must be provided. Coverage must include liability arising out of the U. S. Longshoremen's and Harbor Workers' Act, the Jones Act, and the Outer Continental Shelf Land Act, if applicable.

- D. **Railroad Protective Liability** insurance. Licensee must maintain "Railroad Protective Liability" insurance written on ISO occurrence form CG 00 35 12 04 (or a substitute form providing equivalent coverage) on behalf of Railroad only as named insured, with a limit of not less than \$2,000,000 per occurrence and an aggregate of \$6,000,000.

The definition of "JOB LOCATION" and "WORK" on the declaration page of the policy shall

refer to this Agreement and shall describe all WORK or OPERATIONS performed under this agreement

- E. **Umbrella or Excess** insurance. If Licensee utilizes umbrella or excess policies, and these policies must "follow form" and afford no less coverage than the primary policy.

**Other Requirements**

- F. All policy(ies) required above (except worker's compensation and employers liability) must include Railroad as "Additional Insured" using ISO Additional Insured Endorsements CG 20 26, and CA 20 48 (or substitute forms providing equivalent coverage). The coverage provided to Railroad as additional insured shall, to the extent provided under ISO Additional Insured Endorsement CG 20 26, and CA 20 48 provide coverage for Railroad's negligence whether sole or partial, active or passive, and shall not be limited by Licensee's liability under the indemnity provisions of this Agreement.
- G. Punitive damages exclusion, if any, must be deleted (and the deletion indicated on the certificate of insurance), unless (a) insurance coverage may not lawfully be obtained for any punitive damages that may arise under this agreement, or (b) all punitive damages are prohibited by all states in which this agreement will be performed.
- H. Licensee waives all rights of recovery, and its insurers also waive all rights of subrogation of damages against Railroad and its agents, officers, directors and employees for damages covered by the workers compensation and employers liability or commercial umbrella or excess liability obtained by Licensee required in this agreement, where permitted by law This waiver must be stated on the certificate of insurance.
- I. All insurance policies must be written by a reputable insurance company acceptable to Railroad or with a current Best's Insurance Guide Rating of A- and Class VII or better, and authorized to do business in the state(s) in which the work is to be performed.
- J. The fact that insurance is obtained by Licensee or by Railroad on behalf of Licensee will not be deemed to release or diminish the liability of Licensee, including, without limitation, liability under the indemnity provisions of this Agreement. Damages recoverable by Railroad from Licensee or any third party will not be limited by the amount of the required insurance coverage.

**EXHIBIT D**  
**SAFETY STANDARDS**

**MINIMUM SAFETY REQUIREMENTS**

The term "employees" as used herein refer to all employees of Licensee or its contractors, subcontractors, or agent of Licensee.

**I. Clothing**

- A. All employees of Licensee will be suitably dressed to perform their duties safely and in a manner that will not interfere with their vision, hearing, or free use of their hands or feet.

Specifically, Licensee's employees must wear:

- (i) Waist-length shirts with sleeves.
- (ii) Trousers that cover the entire leg. If flare-legged trousers are worn, the trouser bottoms must be tied to prevent catching.
- (iii) Footwear that covers their ankles and has a defined heel. Employees working on bridges are required to wear safety-toed footwear that conforms to the American National Standards Institute (ANSI) and FRA footwear requirements.

- B. Employees shall not wear boots (other than work boots), sandals, canvas-type shoes, or other shoes that have thin soles or heels that are higher than normal.

- C. Employees must not wear loose or ragged clothing, neckties, finger rings, or other loose jewelry while operating or working on machinery.

**II. Personal Protective Equipment**

Licensee shall require its employee to wear personal protective equipment as specified by Railroad rules, regulations, or recommended or requested by the Railroad Representative.

- (i) Hard hat that meets the American National Standard (ANSI) Z89.1 – latest revision. Hard hats should be affixed with Licensee's company logo or name.
- (ii) Eye protection that meets American National Standard (ANSI) for occupational and educational eye and face protection, Z87.1 – latest revision. Additional eye protection must be provided to meet specific job situations such as welding, grinding, etc.
- (iii) Hearing protection, which affords enough attenuation to give protection from noise levels that will be occurring on the job site. Hearing protection, in the form of plugs or muffs, must be worn when employees are within:

100 feet of a locomotive or roadway/work equipment

15 feet of power operated tools  
150 feet of jet blowers or pile drivers  
150 feet of retarders in use (when within 10 feet, employees must wear dual ear protection – plugs and muffs)

Other types of personal protective equipment, such as respirators, fall protection equipment, and face shields, must be worn as recommended or requested by the Railroad Representative.

### III. On Track Safety

Licensee and its contractor are responsible for compliance with the Federal Railroad Administration's Roadway Worker Protection regulations – 49CFR214, Subpart C and Railroad's On-Track Safety rules. Under 49CFR214, Subpart C, railroad contractors are responsible for the training of their employees on such regulations. In addition to the instructions contained in Roadway Worker Protection regulations, all employees must:

- (i) Maintain a minimum distance of at least twenty-five (25) feet to any track unless the Railroad Representative is present to authorize movements.
- (ii) Wear an orange, reflectorized work wear approved by the Railroad Representative.
- (iii) Participate in a job briefing that will specify the type of On-Track Safety for the type of work being performed. Licensee must take special note of limits of track authority, which tracks may or may not be fouled, and clearing the track. Licensee will also receive special instructions relating to the work zone around machines and minimum distances between machines while working or traveling.

### IV. Equipment

- A. It is the responsibility of Licensee to ensure that all equipment is in a safe condition to operate. If, in the opinion of the Railroad Representative, any of Licensee's equipment is unsafe for use, Licensee shall remove such equipment from Railroad's property. In addition, Licensee must ensure that the operators of all equipment are properly trained and competent in the safe operation of the equipment. In addition, operators must be:

Familiar and comply with Railroad's rules on lockout/tagout of equipment.  
Trained in and comply with the applicable operating rules if operating any hy-rail equipment on-track.  
Trained in and comply with the applicable air brake rules if operating any equipment that moves rail cars or any other rail bound equipment.

- B. All self-propelled equipment must be equipped with a first-aid kit, fire extinguisher, and audible back-up warning device.
- C. Unless otherwise authorized by the Railroad Representative, all equipment must be parked a minimum of twenty-five (25) feet from any track. Before leaving any equipment unattended, the operator must stop the engine and properly secure the equipment against movement.
- D. Cranes must be equipped with three orange cones that will be used to mark the working area of the crane and the minimum clearances to overhead powerlines.



**V. General Safety Requirements**

- A. Licensee shall ensure that all waste is properly disposed of in accordance with applicable federal and state regulations.
- B. Licensee shall ensure that all employees participate in and comply with a job briefing conducted by the Railroad Representative, if applicable. During this briefing, the Railroad Representative will specify safe work procedures, (including On-Track Safety) and the potential hazards of the job. If any employee has any questions or concerns about the work, the employee must voice them during the job briefing. Additional job briefings will be conducted during the work as conditions, work procedures, or personnel change.
- C. All track work performed by Licensee meets the minimum safety requirements established by the Federal Railroad Administration's Track Safety Standards 49CFR213.
- D. All employees comply with the following safety procedures when working around any railroad track:
  - (i) Always be on the alert for moving equipment. Employees must always expect movement on any track, at any time, in either direction.
  - (ii) Do not step or walk on the top of the rail, frog, switches, guard rails, or other track components.
  - (iii) In passing around the ends of standing cars, engines, roadway machines or work equipment, leave at least 20 feet between yourself and the end of the equipment. Do not go between pieces of equipment if the opening is less than one car length (50 feet).
  - (iv) Avoid walking or standing on a track unless so authorized by the employee in charge.
  - (v) Before stepping over or crossing tracks, look in both directions first.
  - (vi) Do not sit on, lie under, or cross between cars except as required in the performance of your duties and only when track and equipment have been protected against movement.
- E. All employees must comply with all federal and state regulations concerning workplace safety.



Patricia Romo, P.E.  
Director of Transportation

# COUNTY OF RIVERSIDE

## TRANSPORTATION AND LAND MANAGEMENT AGENCY

Mojahed Salama, P.E.  
Deputy for Transportation/Capital Projects  
Richard Lantis, P.L.S.  
Deputy for Transportation/Planning and  
Development

### Transportation Department

#### ADDENDUM NUMBER 2

Dated February 14, 2019

to the  
Specifications and Contract Documents  
for the construction of

Grapefruit Boulevard and 62nd Avenue  
Traffic Signal and Safety Lighting Project  
In the Community of Mecca

Project No. C3-0084  
Federal Project No. HSIP-5956(236)

**Bids Due: Wednesday, February 20, 2019; 2:00 p.m.**  
14<sup>th</sup> Street Transportation Annex  
3525 14<sup>th</sup> Street; Riverside, CA 92501  
(951) 955-6780

This Addendum is issued pursuant to the Instructions to Bidders, Item No. 8, of the Contract Documents for the reference project. This Addendum is issued as a supplement to the specification and special provisions for the referenced project. The revisions to the specifications shall become a part of the Contract Documents, and each bidder shall acknowledge receipt thereof on the Bid (Proposal). Bidders are directed to sign this addendum as acknowledged, and attach the signed addendum to the contractor's submitted proposal.

Note: During the advertisement period of this project, this document and attachments (if any) are available upon request at the office of the Transportation Department, and are available as a free download at the Transportation Department's website:

<http://rctlma.org/trans/Contractors-Corner/Notices-Inviting-Bids>

#### **MODIFICATIONS / CLARIFICATIONS TO SPECIAL PROVISIONS:**

**Item 1: Update - Federal Prevailing Wages Decision**

Refer to Appendix C entitled "Federal Prevailing Wages Decision", pages 1 through 21. Delete and replace these pages with the following:

Federal wage determination, General Decision No. **CA190025 02/01/2019 CA25**, Modification No. 1, attached herewith as **Attachment "A,"** shall apply to this project. This document is available upon request from the Transportation Department: (951) 955-6780, and also posted on following County website:

<http://rctlma.org/trans/Contractors-Corner/Notices-Inviting-Bids>

**ATTACHMENTS**

**A – Federal Prevailing Wage Decision (21 Pages)**

Prepared by: \_\_\_\_\_

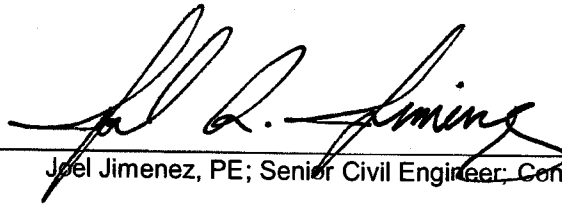

Joel Jimenez, PE; Senior Civil Engineer, Contracts/Bidding Unit

Acknowledged: \_\_\_\_\_

Date: \_\_\_\_\_

(Contractor)

JRJ:rr

Note: Refer to Instruction to Bidders Item No. 8, "Addenda". Submission of all addendum pages and non-bidding document attachments of addendum are not necessary for Bid submittal. Submittal of this acknowledgement page is adequate for Bid reception. Bidders are reminded to list addendum number(s) received on the first page of the Bid form (Proposal).

**APPENDIX C**  
**Federal Prevailing Wage Decision**

General Decision Number: CA190025 02/01/2019 CA25

Superseded General Decision Number: CA20180036

State: California

Construction Types: Building, Heavy (Heavy and Dredging) and Highway

County: Riverside County in California.

BUILDING CONSTRUCTION PROJECTS; DREDGING PROJECTS (does not include hopper dredge work); HEAVY CONSTRUCTION PROJECTS (does not include water well drilling); HIGHWAY CONSTRUCTION PROJECTS

Note: Under Executive Order (EO) 13658, an hourly minimum wage of \$10.60 for calendar year 2019 applies to all contracts subject to the Davis-Bacon Act for which the contract is awarded (and any solicitation was issued) on or after January 1, 2015. If this contract is covered by the EO, the contractor must pay all workers in any classification listed on this wage determination at least \$10.60 per hour (or the applicable wage rate listed on this wage determination, if it is higher) for all hours spent performing on the contract in calendar year 2019. If this contract is covered by the EO and a classification considered necessary for performance of work on the contract does not appear on this wage determination, the contractor must pay workers in that classification at least the wage rate determined through the conformance process set forth in 29 CFR 5.5(a)(1)(ii) (or the EO minimum wage rate, if it is higher than the conformed wage rate). The EO minimum wage rate will be adjusted annually. Please note that this EO applies to the above-mentioned types of contracts entered into by the federal government that are subject to the Davis-Bacon Act itself, but it does not apply to contracts subject only to the Davis-Bacon Related Acts, including those set forth at 29 CFR 5.1(a)(2)-(60). Additional information on contractor requirements and worker protections under the EO is available at [www.dol.gov/whd/govcontracts](http://www.dol.gov/whd/govcontracts).

Modification Number	Publication Date
0	01/04/2019
1	02/01/2019

ASBE0005-002 07/01/2018

	Rates	Fringes
Asbestos Workers/Insulator (Includes the application of all insulating materials, protective coverings, coatings, and finishes to all types of mechanical systems).....	\$ 39.72	20.81
Fire Stop Technician (Application of Firestopping Materials for wall openings and penetrations in walls, floors, ceilings and curtain walls).....	\$ 27.92	18.31

ASBE0005-004 07/02/2018

Rates	Fringes
-------	---------

ISSUED BY ADDENDUM No. 2, ATTACHMENT "A"

Asbestos Removal  
 worker/hazardous material  
 handler (Includes  
 preparation, wetting,  
 stripping, removal,  
 scrapping, vacuuming, bagging  
 and disposing of all  
 insulation materials from  
 mechanical systems, whether  
 they contain asbestos or not)....\$ 19.93                      11.72

-----  
 BOIL0092-003 03/01/2018

	Rates	Fringes
BOILERMAKER.....	\$ 44.07	33.52

-----  
 \* BRCA0004-011 05/01/2018

	Rates	Fringes
BRICKLAYER; MARBLE SETTER.....	\$ 40.39	13.65

\*The wage scale for prevailing wage projects performed in Blythe, China lake, Death Valley, Fort Irwin, Twenty-Nine Palms, Needles and 1-15 corridor (Barstow to the Nevada State Line) will be Three Dollars (\$3.00) above the standard San Bernardino/Riverside County hourly wage rate

-----  
 BRCA0018-004 07/01/2017

	Rates	Fringes
MARBLE FINISHER.....	\$ 30.93	12.95
TILE FINISHER.....	\$ 25.98	11.23
TILE LAYER.....	\$ 37.76	16.37

-----  
 BRCA0018-010 09/01/2017

	Rates	Fringes
TERRAZZO FINISHER.....	\$ 29.75	12.91
TERRAZZO WORKER/SETTER.....	\$ 36.75	13.82

-----  
 CARP0409-001 07/01/2018

	Rates	Fringes
CARPENTER		
(1) Carpenter, Cabinet Installer, Insulation Installer, Hardwood Floor Worker and acoustical installer.....	\$ 41.84	19.17
(2) Millwright.....	\$ 42.91	19.17
(3) Piledrivermen/Derrick Bargeman, Bridge or Dock Carpenter, Heavy Framer, Rock Bargeman or Scowman, Rockslinger, Shingler (Commercial).....	\$ 42.54	19.17

(4) Pneumatic Nailer, Power Stapler.....	\$ 40.09	19.17
(5) Sawfiler.....	\$ 39.83	19.17
(6) Scaffold Builder.....	\$ 31.60	19.17
(7) Table Power Saw Operator.....	\$ 40.93	19.17

FOOTNOTE: Work of forming in the construction of open cut sewers or storm drains, on operations in which horizontal lagging is used in conjunction with steel H-Beams driven or placed in pre- drilled holes; for that portion of a lagged trench against which concrete is poured, namely, as a substitute for back forms (which work is performed by piledrivers): \$0.13 per hour additional.

-----  
CARP0409-002 07/01/2016

	Rates	Fringes
Diver		
(1) Wet.....	\$ 712.48	17.03
(2) Standby.....	\$ 356.24	17.03
(3) Tender.....	\$ 348.24	17.03
(4) Assistant Tender.....	\$ 324.24	17.03

Amounts in "Rates" column are per day

-----  
CARP0409-005 07/01/2015

	Rates	Fringes
Drywall		
DRYWALL INSTALLER/LATHER....	\$ 37.35	11.08
STOCKER/SCRAPPER.....	\$ 10.00	7.17

-----  
CARP0409-008 08/01/2010

	Rates	Fringes
Modular Furniture Installer.....	\$ 17.00	7.41

-----  
ELEC0440-001 01/01/2018

	Rates	Fringes
ELECTRICIAN		
INSIDE ELECTRICIAN.....	\$ 39.77	23.24
INTELLIGENT TRANSPORTATION SYSTEMS		
Electrician.....	\$ 36.99	3%+23.18
Technician.....	\$ 27.75	3%+23.18

ZONE PAY: Zone A: Free travel zone for all contractors performing work in Zone A.  
Zone B: Any work performed in Zone (B) shall add \$12.00 per hour to the current wage scale. Zone (B) shall be the area from the eastern perimeter of Zone (A) to a line which runs north and south beginning at Little Morongo Canyon (San Bernardino/Riverside County Line), Southeast along the Coachella Tunnels, Colorado River Aqueduct and Mecca Tunnels to Pinkham Wash then South to Box Canyon Road, then southwest along Box Canyon Road to Highway 195 west onto 195 south to Highway 86 to Riverside/Imperial County Line.

\* ELEC0440-004 12/31/2018

COMMUNICATIONS AND SYSTEMS WORK

	Rates	Fringes
Communications System		
Installer.....	\$ 33.09	15.89
Technician.....	\$ 33.09	15.89

SCOPE OF WORK:

Installation, testing, service and maintenance of systems utilizing the transmission and/or transference of voice, sound, vision and digital for commercial, educational, security and entertainment purposes for the following: TV monitoring and surveillance, background-foreground music, intercom and telephone interconnect, inventory control systems, microwave transmission, multi-media, multiplex, nurse call systems, radio page, school intercom and sound, burglar alarms, fire alarms, and low voltage master clock systems in commercial buildings. Communication Systems that transmit or receive information and/or control systems that are intrinsic to the above listed systems; inclusion or exclusion of terminations and testings of conductors determined by their function; excluding all other data systems or multiple systems which include control function or power supply; excluding installation of raceway systems, conduit systems, line voltage work, and energy management systems. Does not cover work performed at China Lake Naval Ordnance Test Station.

-----  
 ELEC1245-001 06/01/2018

	Rates	Fringes
LINE CONSTRUCTION		
(1) Lineman; Cable splicer..	\$ 56.79	17.91
(2) Equipment specialist (operates crawler tractors, commercial motor vehicles, backhoes, trenchers, cranes (50 tons and below), overhead & underground distribution line equipment).....	\$ 45.36	16.74
(3) Groundman.....	\$ 34.68	16.36
(4) Powderman.....	\$ 49.55	3%+17.65

HOLIDAYS: New Year's Day, M.L. King Day, Memorial Day, Independence Day, Labor Day, Veterans Day, Thanksgiving Day and day after Thanksgiving, Christmas Day

-----  
 \* ELEV0018-001 01/01/2019

	Rates	Fringes
ELEVATOR MECHANIC.....	\$ 55.58	34.125

FOOTNOTE:

PAID VACATION: Employer contributes 8% of regular hourly rate as vacation pay credit for employees with more than 5 years of service, and 6% for 6 months to 5 years of service. PAID HOLIDAYS: New Years Day, Memorial Day, Independence Day, Labor Day, Veterans Day, Thanksgiving Day, Friday after Thanksgiving, and Christmas Day.

	Rates	Fringes
OPERATOR: Power Equipment (All Other Work)		
GROUP 1.....	\$ 45.30	25.25
GROUP 2.....	\$ 46.08	25.25
GROUP 3.....	\$ 46.37	25.25
GROUP 4.....	\$ 47.86	25.25
GROUP 5.....	\$ 48.96	25.25
GROUP 6.....	\$ 48.08	25.25
GROUP 8.....	\$ 48.19	25.25
GROUP 9.....	\$ 49.29	25.25
GROUP 10.....	\$ 48.31	25.25
GROUP 11.....	\$ 49.41	25.25
GROUP 12.....	\$ 48.48	25.25
GROUP 13.....	\$ 48.58	25.25
GROUP 14.....	\$ 48.61	25.25
GROUP 15.....	\$ 48.69	25.25
GROUP 16.....	\$ 48.81	25.25
GROUP 17.....	\$ 48.98	25.25
GROUP 18.....	\$ 49.08	25.25
GROUP 19.....	\$ 49.19	25.25
GROUP 20.....	\$ 49.31	25.25
GROUP 21.....	\$ 49.48	25.25
GROUP 22.....	\$ 49.58	25.25
GROUP 23.....	\$ 49.69	25.25
GROUP 24.....	\$ 49.81	25.25
GROUP 25.....	\$ 49.98	25.25
OPERATOR: Power Equipment (Cranes, Piledriving & Hoisting)		
GROUP 1.....	\$ 46.65	25.25
GROUP 2.....	\$ 47.43	25.25
GROUP 3.....	\$ 47.72	25.25
GROUP 4.....	\$ 47.86	25.25
GROUP 5.....	\$ 48.08	25.25
GROUP 6.....	\$ 48.19	25.25
GROUP 7.....	\$ 48.31	25.25
GROUP 8.....	\$ 48.48	25.25
GROUP 9.....	\$ 48.65	25.25
GROUP 10.....	\$ 49.65	25.25
GROUP 11.....	\$ 50.65	25.25
GROUP 12.....	\$ 51.65	25.25
GROUP 13.....	\$ 52.65	25.25
OPERATOR: Power Equipment (Tunnel Work)		
GROUP 1.....	\$ 47.15	25.25
GROUP 2.....	\$ 47.93	25.25
GROUP 3.....	\$ 48.22	25.25
GROUP 4.....	\$ 48.39	25.25
GROUP 5.....	\$ 48.58	25.25
GROUP 6.....	\$ 48.69	25.25
GROUP 7.....	\$ 48.81	25.25

PREMIUM PAY:

\$3.75 per hour shall be paid on all Power Equipment Operator work on the following Military Bases: China Lake Naval Reserve, Vandenberg AFB, Point Arguello, Seely



Naval Base, Fort Irwin, Nebo Annex Marine Base, Marine Corp Logistics Base Yermo, Edwards AFB, 29 Palms Marine Base and Camp Pendleton

Workers required to suit up and work in a hazardous material environment: \$2.00 per hour additional. Combination mixer and compressor operator on gunite work shall be classified as a concrete mobile mixer operator.

SEE ZONE DEFINITIONS AFTER CLASSIFICATIONS

#### POWER EQUIPMENT OPERATORS CLASSIFICATIONS

GROUP 1: Bargeman; Brakeman; Compressor operator; Ditch Witch, with seat or similar type equipment; Elevator operator-inside; Engineer Oiler; Forklift operator (includes loed, lull or similar types under 5 tons; Generator operator; Generator, pump or compressor plant operator; Pump operator; Signalman; Switchman

GROUP 2: Asphalt-rubber plant operator (nurse tank operator); Concrete mixer operator-skip type; Conveyor operator; Fireman; Forklift operator (includes loed, lull or similar types over 5 tons; Hydrostatic pump operator; oiler crusher (asphalt or concrete plant); Petromat laydown machine; PJU side dum jack; Screening and conveyor machine operator (or similar types); Skiploader (wheel type up to 3/4 yd. without attachment); Tar pot fireman; Temporary heating plant operator; Trenching machine oiler

GROUP 3: Asphalt-rubber blend operator; Bobcat or similar type (Skid steer); Equipment greaser (rack); Ford Ferguson (with dragtype attachments); Helicopter radioman (ground); Stationary pipe wrapping and cleaning machine operator

GROUP 4: Asphalt plant fireman; Backhoe operator (mini-max or similar type); Boring machine operator; Boxman or mixerman (asphalt or concrete); Chip spreading machine operator; Concrete cleaning decontamination machine operator; Concrete Pump Operator (small portable); Drilling machine operator, small auger types (Texoma super economatic or similar types - Hughes 100 or 200 or similar types - drilling depth of 30' maximum); Equipment greaser (grease truck); Guard rail post driver operator; Highline cableway signalman; Hydra-hammer-aero stomper; Micro Tunneling (above ground tunnel); Power concrete curing machine operator; Power concrete saw operator; Power-driven jumbo form setter operator; Power sweeper operator; Rock Wheel Saw/Trencher; Roller operator (compacting); Screed operator (asphalt or concrete); Trenching machine operator (up to 6 ft.); Vacuum or much truck

GROUP 5: Equipment Greaser (Grease Truck/Multi Shift).

GROUP 6: Articulating material hauler; Asphalt plant engineer; Batch plant operator; Bit sharpener; Concrete joint machine operator (canal and similar type); Concrete planer operator; Dandy digger; Deck engine operator; Derrickman (oilfield type); Drilling machine operator, bucket or auger types (Calweld 100 bucket or similar types - Watson 1000 auger or similar types - Texoma 330, 500 or 600 auger or similar types - drilling depth of 45' maximum); Drilling machine operator; Hydrographic seeder machine operator (straw, pulp or seed), Jackson track maintainer, or similar type; Kalamazoo Switch tamper, or similar type; Machine tool operator; Maginnis internal full slab vibrator, Mechanical berm, curb or gutter (concrete or asphalt); Mechanical finisher operator (concrete, Clary-Johnson-Bidwell or similar); Micro tunnel system (below ground); Pavement breaker operator (truck mounted); Road oil mixing machine operator; Roller operator (asphalt or finish), rubber-tired earth moving equipment (single engine, up to and including 25 yds. struck); Self-propelled tar pipelining machine operator; Skiploader operator (crawler and wheel type, over 3/4 yd. and up to and including 1-1/2 yds.); Slip form pump operator (power driven hydraulic lifting device for concrete forms); Tractor operator-bulldozer, tamper-scraper (single engine, up to 100 h.p. flywheel and similar types, up to and including D-5 and similar types); Tugger hoist

operator (1 drum); Ultra high pressure waterjet cutting tool system operator; Vacuum blasting machine operator

GROUP 8: Asphalt or concrete spreading operator (tamping or finishing); Asphalt paving machine operator (Barber Greene or similar type); Asphalt-rubber distribution operator; Backhoe operator (up to and including 3/4 yd.), small ford, Case or similar; Cast-in-place pipe laying machine operator; Combination mixer and compressor operator (gunite work); Compactor operator (self-propelled); Concrete mixer operator (paving); Crushing plant operator; Drill Doctor; Drilling machine operator, Bucket or auger types (Calweld 150 bucket or similar types - Watson 1500, 2000 2500 auger or similar types - Texoma 700, 800 auger or similar types - drilling depth of 60' maximum); Elevating grader operator; Grade checker; Gradall operator; Grouting machine operator; Heavy-duty repairman; Heavy equipment robotics operator; Kalamazoo balliste regulator or similar type; Kolman belt loader and similar type; Le Tourneau blob compactor or similar type; Loader operator (Athey, Euclid, Sierra and similar types); Mobark Chipper or similar; Ozzie padder or similar types; P.C. slot saw; Pneumatic concrete placing machine operator (Hackley-Presswell or similar type); Pumpcrete gun operator; Rock Drill or similar types; Rotary drill operator (excluding caisson type); Rubber-tired earth-moving equipment operator (single engine, caterpillar, Euclid, Athey Wagon and similar types with any and all attachments over 25 yds. up to and including 50 cu. yds. struck); Rubber-tired earth-moving equipment operator (multiple engine up to and including 25 yds. struck); Rubber-tired scraper operator (self-loading paddle wheel type-John Deere, 1040 and similar single unit); Self-propelled curb and gutter machine operator; Shuttle buggy; Skiploader operator (crawler and wheel type over 1-1/2 yds. up to and including 6-1/2 yds.); Soil remediation plant operator; Surface heaters and planer operator; Tractor compressor drill combination operator; Tractor operator (any type larger than D-5 - 100 flywheel h.p. and over, or similar-bulldozer, tamper, scraper and push tractor single engine); Tractor operator (boom attachments), Traveling pipe wrapping, cleaning and bending machine operator; Trenching machine operator (over 6 ft. depth capacity, manufacturer's rating); trenching Machine with Road Miner attachment (over 6 ft depth capacity): Ultra high pressure waterjet cutting tool system mechanic; Water pull (compaction) operator

GROUP 9: Heavy Duty Repairman

GROUP 10: Drilling machine operator, Bucket or auger types (Calweld 200 B bucket or similar types-Watson 3000 or 5000 auger or similar types-Texoma 900 auger or similar types-drilling depth of 105' maximum); Dual drum mixer, dynamic compactor LDC350 (or similar types); Monorail locomotive operator (diesel, gas or electric); Motor patrol-blade operator (single engine); Multiple engine tractor operator (Euclid and similar type-except Quad 9 cat.); Rubber-tired earth-moving equipment operator (single engine, over 50 yds. struck); Pneumatic pipe ramming tool and similar types; Prestressed wrapping machine operator; Rubber-tired earth-moving equipment operator (single engine, over 50 yds. struck); Rubber tired earth moving equipment operator (multiple engine, Euclid, caterpillar and similar over 25 yds. and up to 50 yds. struck), Tower crane repairman; Tractor loader operator (crawler and wheel type over 6-1/2 yds.); Woods mixer operator (and similar Pugmill equipment)

GROUP 11: Heavy Duty Repairman - Welder Combination, Welder - Certified.

GROUP 12: Auto grader operator; Automatic slip form operator; Drilling machine operator, bucket or auger types (Calweld, auger 200 CA or similar types - Watson, auger 6000 or similar types - Hughes Super Duty, auger 200 or similar types - drilling depth of 175' maximum); Hoe ram or similar with compressor; Mass excavator operator less tha 750 cu. yards; Mechanical finishing machine operator; Mobile form traveler operator; Motor patrol operator (multi-engine); Pipe mobile machine operator; Rubber-tired earth- moving equipment operator (multiple engine, Euclid, Caterpillar and similar type, over 50 cu. yds. struck); Rubber-tired self-loading scraper operator (paddle-wheel-auger type self-loading - two (2) or more units)

GROUP 13: Rubber-tired earth-moving equipment operator operating equipment with push-pull system (single engine, up to and including 25 yds. struck)

GROUP 14: Canal liner operator; Canal trimmer operator; Remote-control earth-moving equipment operator (operating a second piece of equipment: \$1.00 per hour additional); Wheel excavator operator (over 750 cu. yds.)

GROUP 15: Rubber-tired earth-moving equipment operator, operating equipment with push-pull system (single engine, Caterpillar, Euclid, Athey Wagon and similar types with any and all attachments over 25 yds. and up to and including 50 yds. struck); Rubber-tired earth-moving equipment operator, operating equipment with push-pull system (multiple engine-up to and including 25 yds. struck)

GROUP 16: Rubber-tired earth-moving equipment operator, operating equipment with push-pull system (single engine, over 50 yds. struck); Rubber-tired earth-moving equipment operator, operating equipment with push-pull system (multiple engine, Euclid, Caterpillar and similar, over 25 yds. and up to 50 yds. struck)

GROUP 17: Rubber-tired earth-moving equipment operator, operating equipment with push-pull system (multiple engine, Euclid, Caterpillar and similar, over 50 cu. yds. struck); Tandem tractor operator (operating crawler type tractors in tandem - Quad 9 and similar type)

GROUP 18: Rubber-tired earth-moving equipment operator, operating in tandem (scrapers, belly dumps and similar types in any combination, excluding compaction units - single engine, up to and including 25 yds. struck)

GROUP 19: Rotex concrete belt operator (or similar types); Rubber-tired earth-moving equipment operator, operating in tandem (scrapers, belly dumps and similar types in any combination, excluding compaction units - single engine, Caterpillar, Euclid, Athey Wagon and similar types with any and all attachments over 25 yds. and up to and including 50 cu. yds. struck); Rubber-tired earth-moving equipment operator, operating in tandem (scrapers, belly dumps and similar types in any combination, excluding compaction units - multiple engine, up to and including 25 yds. struck)

GROUP 20: Rubber-tired earth-moving equipment operator, operating in tandem (scrapers, belly dumps and similar types in any combination, excluding compaction units - single engine, over 50 yds. struck); Rubber-tired earth-moving equipment operator, operating in tandem (scrapers, belly dumps, and similar types in any combination, excluding compaction units - multiple engine, Euclid, Caterpillar and similar, over 25 yds. and up to 50 yds. struck)

GROUP 21: Rubber-tired earth-moving equipment operator, operating in tandem (scrapers, belly dumps and similar types in any combination, excluding compaction units - multiple engine, Euclid, Caterpillar and similar type, over 50 cu. yds. struck)

GROUP 22: Rubber-tired earth-moving equipment operator, operating equipment with the tandem push-pull system (single engine, up to and including 25 yds. struck)

GROUP 23: Rubber-tired earth-moving equipment operator, operating equipment with the tandem push-pull system (single engine, Caterpillar, Euclid, Athey Wagon and similar types with any and all attachments over 25 yds. and up to and including 50 yds. struck); Rubber-tired earth-moving equipment operator, operating with the tandem push-pull system (multiple engine, up to and including 25 yds. struck)

GROUP 24: Rubber-tired earth-moving equipment operator, operating equipment with the tandem push-pull system (single engine, over 50 yds. struck); Rubber-tired earth-moving equipment operator, operating equipment with the tandem push-pull

system (multiple engine, Euclid, Caterpillar and similar, over 25 yds. and up to 50 yds. struck)

GROUP 25: Concrete pump operator-truck mounted; Rubber-tired earth-moving equipment operator, operating equipment with the tandem push-pull system (multiple engine, Euclid, Caterpillar and similar type, over 50 cu. yds. struck)

#### CRANES, PILEDIVING AND HOISTING EQUIPMENT CLASSIFICATIONS

GROUP 1: Engineer oiler; Fork lift operator (includes loed, lull or similar types)

GROUP 2: Truck crane oiler

GROUP 3: A-frame or winch truck operator; Ross carrier operator (jobsite)

GROUP 4: Bridge-type unloader and turntable operator; Helicopter hoist operator

GROUP 5: Hydraulic boom truck; Stinger crane (Austin-Western or similar type); Tugger hoist operator (1 drum)

GROUP 6: Bridge crane operator; Cretor crane operator; Hoist operator (Chicago boom and similar type); Lift mobile operator; Lift slab machine operator (Vagtborg and similar types); Material hoist and/or manlift operator; Polar gantry crane operator; Self Climbing scaffold (or similar type); Shovel, backhoe, dragline, clamshell operator (over 3/4 yd. and up to 5 cu. yds. mrc); Tugger hoist operator

GROUP 7: Pedestal crane operator; Shovel, backhoe, dragline, clamshell operator (over 5 cu. yds. mrc); Tower crane repair; Tugger hoist operator (3 drum)

GROUP 8: Crane operator (up to and including 25 ton capacity); Crawler transporter operator; Derrick barge operator (up to and including 25 ton capacity); Hoist operator, stiff legs, Guy derrick or similar type (up to and including 25 ton capacity); Shovel, backhoe, dragline, clamshell operator (over 7 cu. yds., M.R.C.)

GROUP 9: Crane operator (over 25 tons and up to and including 50 tons mrc); Derrick barge operator (over 25 tons up to and including 50 tons mrc); Highline cableway operator; Hoist operator, stiff legs, Guy derrick or similar type (over 25 tons up to and including 50 tons mrc); K-crane operator; Polar crane operator; Self erecting tower crane operator maximum lifting capacity ten tons

GROUP 10: Crane operator (over 50 tons and up to and including 100 tons mrc); Derrick barge operator (over 50 tons up to and including 100 tons mrc); Hoist operator, stiff legs, Guy derrick or similar type (over 50 tons up to and including 100 tons mrc), Mobile tower crane operator (over 50 tons, up to and including 100 tons M.R.C.); Tower crane operator and tower gantry

GROUP 11: Crane operator (over 100 tons and up to and including 200 tons mrc); Derrick barge operator (over 100 tons up to and including 200 tons mrc); Hoist operator, stiff legs, Guy derrick or similar type (over 100 tons up to and including 200 tons mrc); Mobile tower crane operator (over 100 tons up to and including 200 tons mrc)

GROUP 12: Crane operator (over 200 tons up to and including 300 tons mrc); Derrick barge operator (over 200 tons up to and including 300 tons mrc); Hoist operator, stiff legs, Guy derrick or similar type (over 200 tons, up to and including 300 tons mrc); Mobile tower crane operator (over 200 tons, up to and including 300 tons mrc)

GROUP 13: Crane operator (over 300 tons); Derrick barge operator (over 300 tons); Helicopter pilot; Hoist operator, stiff legs, Guy derrick or similar type (over 300 tons); Mobile tower crane operator (over 300 tons)

#### TUNNEL CLASSIFICATIONS

GROUP 1: Skiploader (wheel type up to 3/4 yd. without attachment)

GROUP 2: Power-driven jumbo form setter operator

GROUP 3: Dinkey locomotive or motorperson (up to and including 10 tons)

GROUP 4: Bit sharpener; Equipment greaser (grease truck); Slip form pump operator (power-driven hydraulic lifting device for concrete forms); Tugger hoist operator (1 drum); Tunnel locomotive operator (over 10 and up to and including 30 tons)

GROUP 5: Backhoe operator (up to and including 3/4 yd.); Small Ford, Case or similar; Drill doctor; Grouting machine operator; Heading shield operator; Heavy-duty repairperson; Loader operator (Athey, Euclid, Sierra and similar types); Mucking machine operator (1/4 yd., rubber-tired, rail or track type); Pneumatic concrete placing machine operator (Hackley-Presswell or similar type); Pneumatic heading shield (tunnel); Pumpcrete gun operator; Tractor compressor drill combination operator; Tugger hoist operator (2 drum); Tunnel locomotive operator (over 30 tons)

GROUP 6: Heavy Duty Repairman

GROUP 7: Tunnel mole boring machine operator

#### ENGINEERS ZONES

\$1.00 additional per hour for all of IMPERIAL County and the portions of KERN, RIVERSIDE & SAN BERNARDINO Counties as defined below:

That area within the following Boundary: Begin in San Bernardino County, approximately 3 miles NE of the intersection of I-15 and the California State line at that point which is the NW corner of Section 1, T17N, R14E, San Bernardino Meridian. Continue W in a straight line to that point which is the SW corner of the northwest quarter of Section 6, T27S, R42E, Mt. Diablo Meridian. Continue North to the intersection with the Inyo County Boundary at that point which is the NE corner of the western half of the northern quarter of Section 6, T25S, R42E, MDM. Continue W along the Inyo and San Bernardino County boundary until the intersection with Kern County, as that point which is the SE corner of Section 34, T24S, R40E, MDM. Continue W along the Inyo and Kern County boundary until the intersection with Tulare County, at that point which is the SW corner of the SE quarter of Section 32, T24S, R37E, MDM. Continue W along the Kern and Tulare County boundary, until that point which is the NW corner of T25S, R32E, MDM. Continue S following R32E lines to the NW corner of T31S, R32E, MDM. Continue W to the NW corner of T31S, R31E, MDM. Continue S to the SW corner of T32S, R31E, MDM. Continue W to SW corner of SE quarter of Section 34, T32S, R30E, MDM. Continue S to SW corner of T11N, R17W, SBM. Continue E along south boundary of T11N, SBM to SW corner of T11N, R7W, SBM. Continue S to SW corner of T9N, R7W, SBM. Continue E along south boundary of T9N, SBM to SW corner of T9N, R1E, SBM. Continue S along west boundary of R1E, SBM to Riverside County line at the SW corner of T1S, R1E, SBM. Continue E along south boundary of T1S, SBM (Riverside County Line) to SW corner of T1S, R10E, SBM. Continue S along west boundary of R10E, SBM to Imperial County line at the SW corner of T8S, R10E, SBM. Continue W along Imperial and Riverside county line to NW corner of T9S, R9E, SBM. Continue S along the boundary between Imperial and San Diego Counties, along the west edge of R9E, SBM to the south boundary of Imperial County/California state line. Follow the California state line west to Arizona state line, then north to Nevada state line, then

continuing NW back to start at the point which is the NW corner of Section 1, T17N, R14E, SBM

\$1.00 additional per hour for portions of SAN LUIS OBISPO, KERN, SANTA BARBARA & VENTURA as defined below:

That area within the following Boundary: Begin approximately 5 miles north of the community of Cholame, on the Monterey County and San Luis Obispo County boundary at the NW corner of T25S, R16E, Mt. Diablo Meridian. Continue south along the west side of R16E to the SW corner of T30S, R16E, MDM. Continue E to SW corner of T30S, R17E, MDM. Continue S to SW corner of T31S, R17E, MDM. Continue E to SW corner of T31S, R18E, MDM. Continue S along West side of R18E, MDM as it crosses into San Bernardino Meridian numbering area and becomes R30W. Follow the west side of R30W, SBM to the SW corner of T9N, R30W, SBM. Continue E along the south edge of T9N, SBM to the Santa Barbara County and Ventura County boundary at that point which is the SW corner of Section 34.T9N, R24W, SBM, continue S along the Ventura County line to that point which is the SW corner of the SE quarter of Section 32, T7N, R24W, SBM. Continue E along the south edge of T7N, SBM to the SE corner to T7N, R21W, SBM. Continue N along East side of R21W, SBM to Ventura County and Kern County boundary at the NE corner of T8N, R21W. Continue W along the Ventura County and Kern County boundary to the SE corner of T9N, R21W. Continue North along the East edge of R21W, SBM to the NE corner of T12N, R21W, SBM. Continue West along the north edge of T12N, SBM to the SE corner of T32S, R21E, MDM. [T12N SBM is a think strip between T11N SBM and T32S MDM]. Continue North along the East side of R21E, MDM to the Kings County and Kern County border at the NE corner of T25S, R21E, MDM, continue West along the Kings County and Kern County Boundary until the intersection of San Luis Obispo County. Continue west along the Kings County and San Luis Obispo County boundary until the intersection with Monterey County. Continue West along the Monterey County and San Luis Obispo County boundary to the beginning point at the NW corner of T25S, R16E, MDM.

\$2.00 additional per hour for INYO and MONO Counties and the Northern portion of SAN BERNARDINO County as defined below:

That area within the following Boundary: Begin at the intersection of the northern boundary of Mono County and the California state line at the point which is the center of Section 17, T10N, R22E, Mt. Diablo Meridian. Continue S then SE along the entire western boundary of Mono County, until it reaches Inyo County at the point which is the NE corner of the Western half of the NW quarter of Section 2, T8S, R29E, MDM. Continue SSE along the entire western boundary of Inyo County, until the intersection with Kern County at the point which is the SW corner of the SE 1/4 of Section 32, T24S, R37E, MDM. Continue E along the Inyo and Kern County boundary until the intersection with San Bernardino County at that point which is the SE corner of section 34, T24S, R40E, MDM. Continue E along the Inyo and San Bernardino County boundary until the point which is the NE corner of the Western half of the NW quarter of Section 6, T25S, R42E, MDM. Continue S to that point which is the SW corner of the NW quarter of Section 6, T27S, R42E, MDM. Continue E in a straight line to the California and Nevada state border at the point which is the NW corner of Section 1, T17N, R14E, San Bernardino Meridian. Then continue NW along the state line to the starting point, which is the center of Section 18, T10N, R22E, MDM.

REMAINING AREA NOT DEFINED ABOVE RECIEVES BASE RATE

-----  
ENGI0012-004 08/01/2015

Rates                      Fringes

OPERATOR: Power Equipment  
(DREDGING)

ISSUED BY ADDENDUM No. 2, ATTACHMENT "A"

(1) Leverman.....	\$ 49.50	23.60
(2) Dredge dozer.....	\$ 43.53	23.60
(3) Deckmate.....	\$ 43.42	23.60
(4) Winch operator (stern winch on dredge).....	\$ 42.87	23.60
(5) Fireman-Oiler, Deckhand, Bargeman, Leveehand.....	\$ 42.33	23.60
(6) Barge Mate.....	\$ 42.94	23.60

\* IRON0377-002 01/01/2019

	Rates	Fringes
Ironworkers:		
Fence Erector.....	\$ 32.58	23.41
Ornamental, Reinforcing and Structural.....	\$ 39.00	32.05

PREMIUM PAY:

\$6.00 additional per hour at the following locations:

China Lake Naval Test Station, Chocolate Mountains Naval Reserve-Niland, Edwards AFB, Fort Irwin Military Station, Fort Irwin Training Center-Goldstone, San Clemente Island, San Nicholas Island, Susanville Federal Prison, 29 Palms - Marine Corps, U.S. Marine Base - Barstow, U.S. Naval Air Facility - Sealey, Vandenberg AFB

\$4.00 additional per hour at the following locations:

Army Defense Language Institute - Monterey, Fallon Air Base, Naval Post Graduate School - Monterey, Yermo Marine Corps Logistics Center

\$2.00 additional per hour at the following locations:

Port Hueneme, Port Mugu, U.S. Coast Guard Station - Two Rock

LABO0300-005 01/01/2018

	Rates	Fringes
Asbestos Removal Laborer.....	\$ 33.19	17.78

SCOPE OF WORK: Includes site mobilization, initial site cleanup, site preparation, removal of asbestos-containing material and toxic waste, encapsulation, enclosure and disposal of asbestos-containing materials and toxic waste by hand or with equipment or machinery; scaffolding, fabrication of temporary wooden barriers and assembly of decontamination stations.

LABO0345-001 07/01/2018

	Rates	Fringes
LABORER (GUNITE)		
GROUP 1.....	\$ 42.18	18.27
GROUP 2.....	\$ 41.23	18.27
GROUP 3.....	\$ 37.69	18.27

FOOTNOTE: GUNITE PREMIUM PAY: Workers working from a

Bosn'n's Chair or suspended from a rope or cable shall receive 40 cents per hour above the foregoing applicable classification rates. Workers doing gunite and/or shotcrete work in a tunnel shall receive 35 cents per hour above the foregoing applicable classification rates, paid on a portal-to-portal basis. Any work performed on, in or above any smoke stack, silo, storage elevator or similar type of structure, when such structure is in excess of 75'-0" above base level and which work must be performed in whole or in part more than 75'-0" above base level, that work performed above the 75'-0" level shall be compensated for at 35 cents per hour above the applicable classification wage rate.

GUNITE LABORER CLASSIFICATIONS

GROUP 1: Rodmen, Nozzlemen

GROUP 2: Gunmen

GROUP 3: Reboundmen

-----  
LABO1184-001 07/01/2018

	Rates	Fringes
Laborers: (HORIZONTAL DIRECTIONAL DRILLING)		
(1) Drilling Crew Laborer...\$	35.70	14.03
(2) Vehicle Operator/Hauler.\$	35.87	14.03
(3) Horizontal Directional Drill Operator.....\$	37.72	14.03
(4) Electronic Tracking Locator.....\$	39.72	14.03
Laborers: (STRIPING/SLURRY SEAL)		
GROUP 1.....\$	35.86	16.21
GROUP 2.....\$	37.16	16.21
GROUP 3.....\$	39.17	16.21
GROUP 4.....\$	40.91	16.21

LABORERS - STRIPING CLASSIFICATIONS

GROUP 1: Protective coating, pavement sealing, including repair and filling of cracks by any method on any surface in parking lots, game courts and playgrounds; carstops; operation of all related machinery and equipment; equipment repair technician

GROUP 2: Traffic surface abrasive blaster; pot tender - removal of all traffic lines and markings by any method (sandblasting, waterblasting, grinding, etc.) and preparation of surface for coatings. Traffic control person: controlling and directing traffic through both conventional and moving lane closures; operation of all related machinery and equipment

GROUP 3: Traffic delineating device applicator: Layout and application of pavement markers, delineating signs, rumble and traffic bars, adhesives, guide markers, other traffic delineating devices including traffic control. This category includes all traffic related surface preparation (sandblasting, waterblasting, grinding) as part of the application process. Traffic protective delineating system installer: removes, relocates, installs, permanently affixed roadside and parking delineation barricades, fencing, cable anchor, guard rail, reference signs, monument markers; operation of all related machinery and equipment; power broom sweeper



GROUP 4: Striper: layout and application of traffic stripes and markings; hot thermo plastic; tape traffic stripes and markings, including traffic control; operation of all related machinery and equipment

-----  
LABO1184-002 07/01/2018

	Rates	Fringes
LABORER (TUNNEL)		
GROUP 1.....	\$ 40.19	19.07
GROUP 2.....	\$ 40.51	19.07
GROUP 3.....	\$ 40.97	19.07
GROUP 4.....	\$ 41.66	19.07
LABORER		
GROUP 1.....	\$ 34.24	19.07
GROUP 2.....	\$ 34.79	19.07
GROUP 3.....	\$ 35.34	19.07
GROUP 4.....	\$ 36.89	19.07
GROUP 5.....	\$ 37.24	19.07

LABORER CLASSIFICATIONS

GROUP 1: Cleaning and handling of panel forms; Concrete screeding for rough strike-off; Concrete, water curing; Demolition laborer, the cleaning of brick if performed by a worker performing any other phase of demolition work, and the cleaning of lumber; Fire watcher, limber, brush loader, piler and debris handler; Flag person; Gas, oil and/or water pipeline laborer; Laborer, asphalt-rubber material loader; Laborer, general or construction; Laborer, general clean-up; Laborer, landscaping; Laborer, jetting; Laborer, temporary water and air lines; Material hose operator (walls, slabs, floors and decks); Plugging, filling of shee bolt holes; Dry packing of concrete; Railroad maintenance, repair track person and road beds; Streetcar and railroad construction track laborers; Rigging and signaling; Scaler; Slip form raiser; Tar and mortar; Tool crib or tool house laborer; Traffic control by any method; Window cleaner; Wire mesh pulling - all concrete pouring operations

GROUP 2: Asphalt shoveler; Cement dumper (on 1 yd. or larger mixer and handling bulk cement); Cesspool digger and installer; Chucktender; Chute handler, pouring concrete, the handling of the chute from readymix trucks, such as walls, slabs, decks, floors, foundation, footings, curbs, gutters and sidewalks; Concrete curer, impervious membrane and form oiler; Cutting torch operator (demolition); Fine grader, highways and street paving, airport, runways and similar type heavy construction; Gas, oil and/or water pipeline wrapper - pot tender and form person; Guinea chaser; Headerboard person - asphalt; Laborer, packing rod steel and pans; Membrane vapor barrier installer; Power broom sweeper (small); Riprap stonepaver, placing stone or wet sacked concrete; Roto scraper and tiller; Sandblaster (pot tender); Septic tank digger and installer(lead); Tank scaler and cleaner; Tree climber, faller, chain saw operator, Pittsburgh chipper and similar type brush shredder; Underground laborer, including caisson bellower

GROUP 3: Buggymobile person; Concrete cutting torch; Concrete pile cutter; Driller, jackhammer, 2-1/2 ft. drill steel or longer; Dri-pak-it machine; Gas, oil and/or water pipeline wrapper, 6-in. pipe and over, by any method, inside and out; High scaler (including drilling of same); Hydro seeder and similar type; Impact wrench multi-plate; Kettle person, pot person and workers applying asphalt, lay-kold, creosote, lime caustic and similar type materials ("applying" means applying, dipping, brushing or handling of such materials for pipe wrapping and waterproofing); Operator of pneumatic, gas, electric tools, vibrating machine, pavement breaker, air blasting, come-alongs, and similar mechanical tools not separately classified herein; Pipelayer's backup person, coating, grouting, making

of joints, sealing, caulking, diapering and including rubber gasket joints, pointing and any and all other services; Rock slinger; Rotary scarifier or multiple head concrete chipping scarifier; Steel headerboard and guideline setter; Tamper, Barko, Wacker and similar type; Trenching machine, hand-propelled

GROUP 4: Asphalt raker, lute person, ironer, asphalt dump person, and asphalt spreader boxes (all types); Concrete core cutter (walls, floors or ceilings), grinder or sander; Concrete saw person, cutting walls or flat work, scoring old or new concrete; Cribber, shorer, lagging, sheeting and trench bracing, hand-guided lagging hammer; Head rock slinger; Laborer, asphalt- rubber distributor boot person; Laser beam in connection with laborers' work; Oversize concrete vibrator operator, 70 lbs. and over; Pipelayer performing all services in the laying and installation of pipe from the point of receiving pipe in the ditch until completion of operation, including any and all forms of tubular material, whether pipe, metallic or non-metallic, conduit and any other stationary type of tubular device used for the conveying of any substance or element, whether water, sewage, solid gas, air, or other product whatsoever and without regard to the nature of material from which the tubular material is fabricated; No-joint pipe and stripping of same; Prefabricated manhole installer; Sandblaster (nozzle person), water blasting, Porta Shot-Blast

GROUP 5: Blaster powder, all work of loading holes, placing and blasting of all powder and explosives of whatever type, regardless of method used for such loading and placing; Driller: All power drills, excluding jackhammer, whether core, diamond, wagon, track, multiple unit, and any and all other types of mechanical drills without regard to the form of motive power; Toxic waste removal

TUNNEL LABORER CLASSIFICATIONS

GROUP 1: Batch plant laborer; Changehouse person; Dump person; Dump person (outside); Swamper (brake person and switch person on tunnel work); Tunnel materials handling person; Nipper; Pot tender, using mastic or other materials (for example, but not by way of limitation, shotcrete, etc.)

GROUP 2: Chucktender, cabletender; Loading and unloading agitator cars; Vibrator person, jack hammer, pneumatic tools (except driller); Bull gang mucker, track person; Concrete crew, including rodder and spreader

GROUP 3: Blaster, driller, powder person; Chemical grout jet person; Cherry picker person; Grout gun person; Grout mixer person; Grout pump person; Jackleg miner; Jumbo person; Kemper and other pneumatic concrete placer operator; Miner, tunnel (hand or machine); Nozzle person; Operating of troweling and/or grouting machines; Powder person (primer house); Primer person; Sandblaster; Shotcrete person; Steel form raiser and setter; Timber person, retimber person, wood or steel; Tunnel Concrete finisher

GROUP 4: Diamond driller; Sandblaster; Shaft and raise work

-----  
LABO1184-004 07/01/2018

	Rates	Fringes
Brick Tender.....	\$ 32.26	18.40

-----  
LABO1414-001 08/08/2018

	Rates	Fringes
LABORER PLASTER CLEAN-UP LABORER....	\$ 33.82	19.40

PLASTER TENDER.....\$ 36.37 19.40

Work on a swing stage scaffold: \$1.00 per hour additional.

-----  
PAIN0036-001 07/01/2018

Rates Fringes

Painters: (Including Lead Abatement)

(1) Repaint (excludes San Diego County).....\$ 27.59 14.92  
(2) All Other Work.....\$ 31.12 15.04

REPAINT of any previously painted structure. Exceptions: work involving the aerospace industry, breweries, commercial recreational facilities, hotels which operate commercial establishments as part of hotel service, and sports facilities.

-----  
PAIN0036-008 10/01/2018

Rates Fringes

DRYWALL FINISHER/TAPER.....\$ 40.18 19.22

-----  
PAIN0036-015 06/01/2018

Rates Fringes

GLAZIER.....\$ 42.20 25.50

FOOTNOTE: Additional \$1.25 per hour for work in a condor, from the third (3rd) floor and up Additional \$1.25 per hour for work on the outside of the building from a swing stage or any suspended contrivance, from the ground up

-----  
PAIN1247-002 05/01/2018

Rates Fringes

SOFT FLOOR LAYER.....\$ 33.85 14.56

-----  
PLAS0200-009 08/01/2018

Rates Fringes

PLASTERER.....\$ 36.86 18.00

-----  
PLAS0500-002 07/01/2018

Rates Fringes

CEMENT MASON/CONCRETE FINISHER...\$ 35.75 22.48

-----  
PLUM0016-001 09/01/2018

Rates Fringes

PLUMBER/PIPEFITTER  
Plumber and Pipefitter  
All other work except

ISSUED BY ADDENDUM No. 2, ATTACHMENT "A"

work on new additions and remodeling of bars, restaurant, stores and commercial buildings not to exceed 5,000 sq. ft. of floor space and work on strip malls, light commercial, tenant improvement and remodel work.....	\$ 50.13	22.16
Work ONLY on new additions and remodeling of bars, restaurant, stores and commercial buildings not to exceed 5,000 sq. ft. of floor space.....	\$ 48.58	21.18
Work ONLY on strip malls, light commercial, tenant improvement and remodel work.....	\$ 37.10	19.51

PLUM0078-001 07/01/2016

	Rates	Fringes
PLUMBER		
Landscape/Irrigation Fitter..	\$ 44.16	25.19
Sewer & Storm Drain Work....	\$ 44.16	25.19

ROOF0036-002 08/01/2018

	Rates	Fringes
ROOFER.....	\$ 38.12	16.97

FOOTNOTE: Pitch premium: Work on which employees are exposed to pitch fumes or required to handle pitch, pitch base or pitch impregnated products, or any material containing coal tar pitch, the entire roofing crew shall receive \$1.75 per hour "pitch premium" pay.

SFCA0669-002 04/01/2018

	Rates	Fringes
SPRINKLER FITTER.....	\$ 39.73	21.90

\* SHEE0105-003 01/01/2019

LOS ANGELES (South of a straight line drawn between Gorman and Big Pines) and Catalina Island, INYO, KERN (Northeast part, East of Hwy 395), MONO ORANGE, RIVERSIDE, AND SAN BERNARDINO COUNTIES

	Rates	Fringes
SHEET METAL WORKER		
(1) Commercial - New Construction and Remodel work.....	\$ 44.28	28.46
(2) Industrial work including air pollution		

control systems, noise  
 abatement, hand rails,  
 guard rails, excluding  
 aritechtrual sheet metal  
 work, excluding A-C,  
 heating, ventilating  
 systems for human comfort...\$ 44.28 28.46

-----  
 TEAM0011-002 07/01/2018

	Rates	Fringes
TRUCK DRIVER		
GROUP 1.....	\$ 30.59	28.59
GROUP 2.....	\$ 30.74	28.59
GROUP 3.....	\$ 30.87	28.59
GROUP 4.....	\$ 31.06	28.59
GROUP 5.....	\$ 31.09	28.59
GROUP 6.....	\$ 31.12	28.59
GROUP 7.....	\$ 31.37	28.59
GROUP 8.....	\$ 31.62	28.59
GROUP 9.....	\$ 31.82	28.59
GROUP 10.....	\$ 32.12	28.59
GROUP 11.....	\$ 32.62	28.59
GROUP 12.....	\$ 33.05	28.59

WORK ON ALL MILITARY BASES:

PREMIUM PAY: \$3.00 per hour additional.

[29 palms Marine Base, Camp Roberts, China Lake, Edwards AFB, El Centro Naval Facility, Fort Irwin, Marine Corps Logistics Base at Nebo & Yermo, Mountain Warfare Training Center, Bridgeport, Point Arguello, Point Conception, Vandenberg AFB]

TRUCK DRIVERS CLASSIFICATIONS

GROUP 1: Truck driver

GROUP 2: Driver of vehicle or combination of vehicles - 2 axles; Traffic control pilot car excluding moving heavy equipment permit load; Truck mounted broom

GROUP 3: Driver of vehicle or combination of vehicles - 3 axles; Boot person; Cement mason distribution truck; Fuel truck driver; Water truck - 2 axle; Dump truck, less than 16 yds. water level; Erosion control driver

GROUP 4: Driver of transit mix truck, under 3 yds.; Dumpcrete truck, less than 6-1/2 yds. water level

GROUP 5: Water truck, 3 or more axles; Truck greaser and tire person (\$0.50 additional for tire person); Pipeline and utility working truck driver, including winch truck and plastic fusion, limited to pipeline and utility work; Slurry truck driver

GROUP 6: Transit mix truck, 3 yds. or more; Dumpcrete truck, 6-1/2 yds. water level and over; Vehicle or combination of vehicles - 4 or more axles; Oil spreader truck; Dump truck, 16 yds. to 25 yds. water level

GROUP 7: A Frame, Swedish crane or similar; Forklift driver; Ross carrier driver

GROUP 8: Dump truck, 25 yds. to 49 yds. water level; Truck repair person; Water pull - single engine; Welder

GROUP 9: Truck repair person/welder; Low bed driver, 9 axles or over

GROUP 10: Dump truck - 50 yds. or more water level; Water pull - single engine with attachment

GROUP 11: Water pull - twin engine; Water pull - twin engine with attachments; Winch truck driver - \$1.25 additional when operating winch or similar special attachments

GROUP 12: Boom Truck 17K and above

-----  
WELDERS - Receive rate prescribed for craft performing operation to which welding is incidental.  
=====

Note: Executive Order (EO) 13706, Establishing Paid Sick Leave for Federal Contractors applies to all contracts subject to the Davis-Bacon Act for which the contract is awarded (and any solicitation was issued) on or after January 1, 2017. If this contract is covered by the EO, the contractor must provide employees with 1 hour of paid sick leave for every 30 hours they work, up to 56 hours of paid sick leave each year. Employees must be permitted to use paid sick leave for their own illness, injury or other health-related needs, including preventive care; to assist a family member (or person who is like family to the employee) who is ill, injured, or has other health-related needs, including preventive care; or for reasons resulting from, or to assist a family member (or person who is like family to the employee) who is a victim of, domestic violence, sexual assault, or stalking. Additional information on contractor requirements and worker protections under the EO is available at [www.dol.gov/whd/govcontracts](http://www.dol.gov/whd/govcontracts).

Unlisted classifications needed for work not included within the scope of the classifications listed may be added after award only as provided in the labor standards contract clauses (29CFR 5.5 (a) (1) (ii)).  
-----

The body of each wage determination lists the classification and wage rates that have been found to be prevailing for the cited type(s) of construction in the area covered by the wage determination. The classifications are listed in alphabetical order of "identifiers" that indicate whether the particular rate is a union rate (current union negotiated rate for local), a survey rate (weighted average rate) or a union average rate (weighted union average rate).

Union Rate Identifiers

A four letter classification abbreviation identifier enclosed in dotted lines beginning with characters other than "SU" or "UAVG" denotes that the union classification and rate were prevailing for that classification in the survey. Example:

PLUM0198-005 07/01/2014. PLUM is an abbreviation identifier of the union which prevailed in the survey for this classification, which in this example would be Plumbers. 0198 indicates the local union number or district council number where applicable, i.e., Plumbers Local 0198. The next number, 005 in the example, is an internal number used in processing the wage determination. 07/01/2014 is the effective date of the most current negotiated rate, which in this example is July 1, 2014.

Union prevailing wage rates are updated to reflect all rate changes in the collective bargaining agreement (CBA) governing this classification and rate.

Survey Rate Identifiers

Classifications listed under the "SU" identifier indicate that no one rate prevailed for this classification in the survey and the published rate is derived by computing a weighted average rate based on all the rates reported in the survey for that classification. As this weighted average rate includes all rates reported in the survey, it may include both union and non-union rates. Example: SULA2012-007 5/13/2014. SU indicates the rates are survey rates based on a weighted average calculation of rates and are not majority rates. LA indicates the State of Louisiana. 2012 is the year of survey on which these classifications and rates are based. The next number, 007 in the example, is an internal number used in producing the wage determination. 5/13/2014 indicates the survey completion date for the classifications and rates under that identifier.

Survey wage rates are not updated and remain in effect until a new survey is conducted.

Union Average Rate Identifiers

Classification(s) listed under the UAVG identifier indicate that no single majority rate prevailed for those classifications; however, 100% of the data reported for the classifications was union data. EXAMPLE: UAVG-OH-0010 08/29/2014. UAVG indicates that the rate is a weighted union average rate. OH indicates the state. The next number, 0010 in the example, is an internal number used in producing the wage determination. 08/29/2014 indicates the survey completion date for the classifications and rates under that identifier.

A UAVG rate will be updated once a year, usually in January of each year, to reflect a weighted average of the current negotiated/CBA rate of the union locals from which the rate is based.

-----  
WAGE DETERMINATION APPEALS PROCESS

1.) Has there been an initial decision in the matter? This can be:

- \* an existing published wage determination
- \* a survey underlying a wage determination
- \* a Wage and Hour Division letter setting forth a position on a wage determination matter
- \* a conformance (additional classification and rate) ruling

On survey related matters, initial contact, including requests for summaries of surveys, should be with the Wage and Hour Regional Office for the area in which the survey was conducted because those Regional Offices have responsibility for the Davis-Bacon survey program. If the response from this initial contact is not satisfactory, then the process described in 2.) and 3.) should be followed.

With regard to any other matter not yet ripe for the formal process described here, initial contact should be with the Branch of Construction Wage Determinations. Write to:

Branch of Construction Wage Determinations  
Wage and Hour Division  
U.S. Department of Labor  
200 Constitution Avenue, N.W.  
Washington, DC 20210

2.) If the answer to the question in 1.) is yes, then an interested party (those affected by the action) can request review and reconsideration from the Wage and Hour Administrator (See 29 CFR Part 1.8 and 29 CFR Part 7). Write to:

Wage and Hour Administrator  
U.S. Department of Labor  
200 Constitution Avenue, N.W.  
Washington, DC 20210

The request should be accompanied by a full statement of the interested party's position and by any information (wage payment data, project description, area practice material, etc.) that the requestor considers relevant to the issue.

3.) If the decision of the Administrator is not favorable, an interested party may appeal directly to the Administrative Review Board (formerly the Wage Appeals Board). Write to:

Administrative Review Board  
U.S. Department of Labor  
200 Constitution Avenue, N.W.  
Washington, DC 20210

4.) All decisions by the Administrative Review Board are final.

=====

END OF GENERAL DECISION

ISSUED BY ADDENDUM No. 2, ATTACHMENT "A"





Patricia Romo, P.E.  
Director of Transportation

# COUNTY OF RIVERSIDE

## TRANSPORTATION AND LAND MANAGEMENT AGENCY

Mojahed Salama, P.E.  
Deputy for Transportation/Capital Projects  
Richard Lantis, P.L.S.  
Deputy for Transportation/Planning and  
Development

### Transportation Department

#### ADDENDUM NUMBER 3

Dated February 19, 2019

to the  
Specifications and Contract Documents  
for the construction of

Grapefruit Boulevard and 62nd Avenue  
Traffic Signal and Safety Lighting Project  
In the Community of Mecca

Project No. C3-0084  
Federal Project No. HSIP-5956(236)

**Bids Due: (Revised)**  
**Wednesday, February 27, 2019; 2:00 p.m.**  
14<sup>th</sup> Street Transportation Annex  
3525 14<sup>th</sup> Street; Riverside, CA 92501  
(951) 955-6780

This Addendum is issued pursuant to the Instructions to Bidders, Item No. 8, of the Contract Documents for the reference project. This Addendum is issued as a supplement to the specification and special provisions for the referenced project. The revisions to the specifications shall become a part of the Contract Documents, and each bidder shall acknowledge receipt thereof on the Bid (Proposal). Bidders are directed to sign this addendum as acknowledged, and attach the signed addendum to the contractor's submitted proposal.

Note: During the advertisement period of this project, this document and attachments (if any) are available upon request at the office of the Transportation Department, and are available as a free download at the Transportation Department's website:

<http://rctlma.org/trans/Contractors-Corner/Notices-Inviting-Bids>

#### MODIFICATIONS / CLARIFICATIONS TO SPECIAL PROVISIONS:

**Item 1:** The new designated date and time for the receipt and opening of bids is revised as follows:

**Wednesday, February 27, 2019; 2:00 p.m.**  
**14<sup>th</sup> Street Transportation Annex**  
**3525 14<sup>th</sup> Street; Riverside, CA 92501**  
**(951) 955-6780**

**Item 2: Update - Federal Prevailing Wages Decision**

Refer to updated "Federal Prevailing Wages Decision", pages 1 through 21, issued by Addendum No. 2 (Item 1), Attachment A. Delete and replace these pages with the following:

Federal wage determination, General Decision No. **CA190025 02/15/2019 CA25, Modification No. 2**, attached herewith as **Attachment "A,"** shall apply to this project. This document is available upon request from the Transportation Department: (951) 955-6780, and also posted on following County website:

<http://rctlma.org/trans/Contractors-Corner/Notices-Inviting-Bids>

**ATTACHMENTS**

**A – Federal Prevailing Wage Decision (21 Pages)**

Prepared by: \_\_\_\_\_

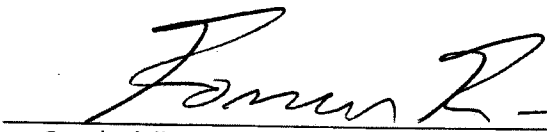
  
*for* Joel Jimenez, PE; Senior Civil Engineer; Contracts/Bidding Unit

Acknowledged: \_\_\_\_\_

Date: \_\_\_\_\_

(Contractor)

JRJ:rr

Note: Refer to Instruction to Bidders Item No. 8, "Addenda". Submission of all addendum pages and non-bidding document attachments of addendum are not necessary for Bid submittal. Submittal of this acknowledgement page is adequate for Bid reception. Bidders are reminded to list addendum number(s) received on the first page of the Bid form (Proposal).

**APPENDIX C  
Federal Prevailing Wage Decision**

General Decision Number: CA190025 02/15/2019 CA25

Superseded General Decision Number: CA20180036

State: California

Construction Types: Building, Heavy (Heavy and Dredging) and Highway

County: Riverside County in California.

BUILDING CONSTRUCTION PROJECTS; DREDGING PROJECTS (does not include hopper dredge work); HEAVY CONSTRUCTION PROJECTS (does not include water well drilling); HIGHWAY CONSTRUCTION PROJECTS

Note: Under Executive Order (EO) 13658, an hourly minimum wage of \$10.60 for calendar year 2019 applies to all contracts subject to the Davis-Bacon Act for which the contract is awarded (and any solicitation was issued) on or after January 1, 2015. If this contract is covered by the EO, the contractor must pay all workers in any classification listed on this wage determination at least \$10.60 per hour (or the applicable wage rate listed on this wage determination, if it is higher) for all hours spent performing on the contract in calendar year 2019. If this contract is covered by the EO and a classification considered necessary for performance of work on the contract does not appear on this wage determination, the contractor must pay workers in that classification at least the wage rate determined through the conformance process set forth in 29 CFR 5.5(a)(1)(ii) (or the EO minimum wage rate, if it is higher than the conformed wage rate). The EO minimum wage rate will be adjusted annually. Please note that this EO applies to the above-mentioned types of contracts entered into by the federal government that are subject to the Davis-Bacon Act itself, but it does not apply to contracts subject only to the Davis-Bacon Related Acts, including those set forth at 29 CFR 5.1(a)(2)-(60). Additional information on contractor requirements and worker protections under the EO is available at [www.dol.gov/whd/govcontracts](http://www.dol.gov/whd/govcontracts).

Modification Number	Publication Date
0	01/04/2019
1	02/01/2019
2	02/15/2019

ASBE0005-002 07/01/2018

	Rates	Fringes
Asbestos Workers/Insulator (Includes the application of all insulating materials, protective coverings, coatings, and finishes to all types of mechanical systems).....	\$ 39.72	20.81
Fire Stop Technician (Application of Firestopping Materials for wall openings and penetrations in walls, floors, ceilings and curtain walls).....	\$ 27.92	18.31

ASBE0005-004 07/02/2018

ISSUED BY ADDENDUM No. 3, ATTACHMENT "A"

Asbestos Removal  
 worker/hazardous material  
 handler (Includes  
 preparation, wetting,  
 stripping, removal,  
 scrapping, vacuuming, bagging  
 and disposing of all  
 insulation materials from  
 mechanical systems, whether  
 they contain asbestos or not)....\$ 19.93                      11.72

-----  
 BOIL0092-003 03/01/2018

	Rates	Fringes
BOILERMAKER.....	\$ 44.07	33.52

-----  
 \* BRCA0004-011 05/01/2018

	Rates	Fringes
BRICKLAYER; MARBLE SETTER.....	\$ 40.39	13.65

\*The wage scale for prevailing wage projects performed in Blythe, China lake, Death Valley, Fort Irwin, Twenty-Nine Palms, Needles and 1-15 corridor (Barstow to the Nevada State Line) will be Three Dollars (\$3.00) above the standard San Bernardino/Riverside County hourly wage rate

-----  
 BRCA0018-004 07/01/2017

	Rates	Fringes
MARBLE FINISHER.....	\$ 30.93	12.95
TILE FINISHER.....	\$ 25.98	11.23
TILE LAYER.....	\$ 37.76	16.37

-----  
 BRCA0018-010 09/01/2017

	Rates	Fringes
TERRAZZO FINISHER.....	\$ 29.75	12.91
TERRAZZO WORKER/SETTER.....	\$ 36.75	13.82

-----  
 CARP0409-001 07/01/2018

	Rates	Fringes
CARPENTER		
(1) Carpenter, Cabinet Installer, Insulation Installer, Hardwood Floor Worker and acoustical installer.....	\$ 41.84	19.17
(2) Millwright.....	\$ 42.91	19.17
(3) Piledrivermen/Derrick Bargeman, Bridge or Dock Carpenter, Heavy Frammer, Rock Bargeman or Scowman, Rockslinger, Shingler		

(Commercial).....	\$ 42.54	19.17
(4) Pneumatic Nailer, Power Stapler.....	\$ 40.09	19.17
(5) Sawfiler.....	\$ 39.83	19.17
(6) Scaffold Builder.....	\$ 31.60	19.17
(7) Table Power Saw Operator.....	\$ 40.93	19.17

FOOTNOTE: Work of forming in the construction of open cut sewers or storm drains, on operations in which horizontal lagging is used in conjunction with steel H-Beams driven or placed in pre- drilled holes, for that portion of a lagged trench against which concrete is poured, namely, as a substitute for back forms (which work is performed by piledrivers): \$0.13 per hour additional.

-----  
CARP0409-002 07/01/2016

	Rates	Fringes
Diver		
(1) Wet.....	\$ 712.48	17.03
(2) Standby.....	\$ 356.24	17.03
(3) Tender.....	\$ 348.24	17.03
(4) Assistant Tender.....	\$ 324.24	17.03

Amounts in "Rates" column are per day

-----  
CARP0409-005 07/01/2015

	Rates	Fringes
Drywall		
DRYWALL INSTALLER/LATHER....	\$ 37.35	11.08
STOCKER/SCRAPPER.....	\$ 10.00	7.17

-----  
CARP0409-008 08/01/2010

	Rates	Fringes
Modular Furniture Installer.....	\$ 17.00	7.41

-----  
ELEC0440-001 01/01/2018

	Rates	Fringes
ELECTRICIAN		
INSIDE ELECTRICIAN.....	\$ 39.77	23.24
INTELLIGENT TRANSPORTATION SYSTEMS		
Electrician.....	\$ 36.99	3%+23.18
Technician.....	\$ 27.75	3%+23.18

ZONE PAY: Zone A: Free travel zone for all contractors performing work in Zone A.  
Zone B: Any work performed in Zone (B) shall add \$12.00 per hour to the current wage scale. Zone (B) shall be the area from the eastern perimeter of Zone (A) to a line which runs north and south beginning at Little Morongo Canyon (San Bernardino/Riverside County Line), Southeast along the Coachella Tunnels, Colorado River Aqueduct and Mecca Tunnels to Pinkham Wash then South to Box Canyon Road, then southwest along Box Canyon Road to Highway 195 west onto 195 south to Highway 86 to Riverside/Imperial County Line.

-----  
ELEC0440-004 12/31/2018

COMMUNICATIONS AND SYSTEMS WORK

	Rates	Fringes
Communications System		
Installer.....	\$ 33.09	15.89
Technician.....	\$ 33.09	15.89

SCOPE OF WORK:

Installation, testing, service and maintenance of systems utilizing the transmission and/or transference of voice, sound, vision and digital for commercial, educational, security and entertainment purposes for the following: TV monitoring and surveillance, background-foreground music, intercom and telephone interconnect, inventory control systems, microwave transmission, multi-media, multiplex, nurse call systems, radio page, school intercom and sound, burglar alarms, fire alarms, and low voltage master clock systems in commercial buildings. Communication Systems that transmit or receive information and/or control systems that are intrinsic to the above listed systems; inclusion or exclusion of terminations and testings of conductors determined by their function; excluding all other data systems or multiple systems which include control function or power supply; excluding installation of raceway systems, conduit systems, line voltage work, and energy management systems. Does not cover work performed at China Lake Naval Ordnance Test Station.

-----  
\* ELEC1245-001 01/01/2019

	Rates	Fringes
LINE CONSTRUCTION		
(1) Lineman; Cable splicer..	\$ 56.79	17.41
(2) Equipment specialist (operates crawler tractors, commercial motor vehicles, backhoes, trenchers, cranes (50 tons and below), overhead & underground distribution line equipment).....	\$ 45.36	16.24
(3) Groundman.....	\$ 34.68	15.86
(4) Powderman.....	\$ 49.55	3%+17.65

HOLIDAYS: New Year's Day, M.L. King Day, Memorial Day, Independence Day, Labor Day, Veterans Day, Thanksgiving Day and day after Thanksgiving, Christmas Day

-----  
ELEV0018-001 01/01/2019

	Rates	Fringes
ELEVATOR MECHANIC.....	\$ 55.58	34.125

FOOTNOTE:

PAID VACATION: Employer contributes 8% of regular hourly rate as vacation pay credit for employees with more than 5 years of service, and 6% for 6 months to 5 years of service. PAID HOLIDAYS: New Years Day, Memorial Day, Independence Day, Labor Day, Veterans Day, Thanksgiving Day, Friday after Thanksgiving, and Christmas Day.

	Rates	Fringes
OPERATOR: Power Equipment		
(All Other Work)		
GROUP 1.....	\$ 45.30	25.25
GROUP 2.....	\$ 46.08	25.25
GROUP 3.....	\$ 46.37	25.25
GROUP 4.....	\$ 47.86	25.25
GROUP 5.....	\$ 48.96	25.25
GROUP 6.....	\$ 48.08	25.25
GROUP 8.....	\$ 48.19	25.25
GROUP 9.....	\$ 49.29	25.25
GROUP 10.....	\$ 48.31	25.25
GROUP 11.....	\$ 49.41	25.25
GROUP 12.....	\$ 48.48	25.25
GROUP 13.....	\$ 48.58	25.25
GROUP 14.....	\$ 48.61	25.25
GROUP 15.....	\$ 48.69	25.25
GROUP 16.....	\$ 48.81	25.25
GROUP 17.....	\$ 48.98	25.25
GROUP 18.....	\$ 49.08	25.25
GROUP 19.....	\$ 49.19	25.25
GROUP 20.....	\$ 49.31	25.25
GROUP 21.....	\$ 49.48	25.25
GROUP 22.....	\$ 49.58	25.25
GROUP 23.....	\$ 49.69	25.25
GROUP 24.....	\$ 49.81	25.25
GROUP 25.....	\$ 49.98	25.25
OPERATOR: Power Equipment		
(Cranes, Piledriving & Hoisting)		
GROUP 1.....	\$ 46.65	25.25
GROUP 2.....	\$ 47.43	25.25
GROUP 3.....	\$ 47.72	25.25
GROUP 4.....	\$ 47.86	25.25
GROUP 5.....	\$ 48.08	25.25
GROUP 6.....	\$ 48.19	25.25
GROUP 7.....	\$ 48.31	25.25
GROUP 8.....	\$ 48.48	25.25
GROUP 9.....	\$ 48.65	25.25
GROUP 10.....	\$ 49.65	25.25
GROUP 11.....	\$ 50.65	25.25
GROUP 12.....	\$ 51.65	25.25
GROUP 13.....	\$ 52.65	25.25
OPERATOR: Power Equipment		
(Tunnel Work)		
GROUP 1.....	\$ 47.15	25.25
GROUP 2.....	\$ 47.93	25.25
GROUP 3.....	\$ 48.22	25.25
GROUP 4.....	\$ 48.39	25.25
GROUP 5.....	\$ 48.58	25.25
GROUP 6.....	\$ 48.69	25.25
GROUP 7.....	\$ 48.81	25.25

PREMIUM PAY:

\$3.75 per hour shall be paid on all Power Equipment Operator work on the following Military Bases: China Lake Naval Reserve, Vandenberg AFB, Point Arguello, Seely

Naval Base, Fort Irwin, Nebo Annex Marine Base, Marine Corp Logistics Base Yermo, Edwards AFB, 29 Palms Marine Base and Camp Pendleton

Workers required to suit up and work in a hazardous material environment: \$2.00 per hour additional. Combination mixer and compressor operator on gunite work shall be classified as a concrete mobile mixer operator.

SEE ZONE DEFINITIONS AFTER CLASSIFICATIONS

#### POWER EQUIPMENT OPERATORS CLASSIFICATIONS

GROUP 1: Bargeman; Brakeman; Compressor operator; Ditch Witch, with seat or similar type equipment; Elevator operator-inside; Engineer Oiler; Forklift operator (includes loed, lull or similar types under 5 tons; Generator operator; Generator, pump or compressor plant operator; Pump operator; Signalman; Switchman

GROUP 2: Asphalt-rubber plant operator (nurse tank operator); Concrete mixer operator-skip type; Conveyor operator; Fireman; Forklift operator (includes loed, lull or similar types over 5 tons; Hydrostatic pump operator; oiler crusher (asphalt or concrete plant); Petromat laydown machine; PJU side dum jack; Screening and conveyor machine operator (or similar types); Skiploader (wheel type up to 3/4 yd. without attachment); Tar pot fireman; Temporary heating plant operator; Trenching machine oiler

GROUP 3: Asphalt-rubber blend operator; Bobcat or similar type (Skid steer); Equipment greaser (rack); Ford Ferguson (with dragtype attachments); Helicopter radioman (ground); Stationary pipe wrapping and cleaning machine operator

GROUP 4: Asphalt plant fireman; Backhoe operator (mini-max or similar type); Boring machine operator; Boxman or mixerman (asphalt or concrete); Chip spreading machine operator; Concrete cleaning decontamination machine operator; Concrete Pump Operator (small portable); Drilling machine operator, small auger types (Texoma super economatic or similar types - Hughes 100 or 200 or similar types - drilling depth of 30' maximum); Equipment greaser (grease truck); Guard rail post driver operator; Highline cableway signalman; Hydra-hammer-aero stomper; Micro Tunneling (above ground tunnel); Power concrete curing machine operator; Power concrete saw operator; Power-driven jumbo form setter operator; Power sweeper operator; Rock Wheel Saw/Trencher; Roller operator (compacting); Screed operator (asphalt or concrete); Trenching machine operator (up to 6 ft.); Vacuum or much truck

GROUP 5: Equipment Greaser (Grease Truck/Multi Shift).

GROUP 6: Articulating material hauler; Asphalt plant engineer; Batch plant operator; Bit sharpener; Concrete joint machine operator (canal and similar type); Concrete planer operator; Dandy digger; Deck engine operator; Derrickman (oilfield type); Drilling machine operator, bucket or auger types (Calweld 100 bucket or similar types - Watson 1000 auger or similar types - Texoma 330, 500 or 600 auger or similar types - drilling depth of 45' maximum); Drilling machine operator; Hydrographic seeder machine operator (straw, pulp or seed), Jackson track maintainer, or similar type; Kalamazoo Switch tamper, or similar type; Machine tool operator; Maginnis internal full slab vibrator, Mechanical berm, curb or gutter(concrete or asphalt); Mechanical finisher operator (concrete, Clary-Johnson-Bidwell or similar); Micro tunnel system (below ground); Pavement breaker operator (truck mounted); Road oil mixing machine operator; Roller operator (asphalt or finish), rubber-tired earth moving equipment (single engine, up to and including 25 yds. struck); Self-propelled tar pipelining machine operator; Skiploader operator (crawler and wheel type, over 3/4 yd. and up to and including 1-1/2 yds.); Slip form pump operator (power driven hydraulic lifting device for concrete forms); Tractor operator-bulldozer, tamper-scraper (single engine, up to 100 h.p. flywheel and similar types, up to and including D-5 and similar types); Tugger hoist



operator (1 drum); Ultra high pressure waterjet cutting tool system operator; Vacuum blasting machine operator

GROUP 8: Asphalt or concrete spreading operator (tamping or finishing); Asphalt paving machine operator (Barber Greene or similar type); Asphalt-rubber distribution operator; Backhoe operator (up to and including 3/4 yd.), small ford, Case or similar; Cast-in-place pipe laying machine operator; Combination mixer and compressor operator (gunite work); Compactor operator (self-propelled); Concrete mixer operator (paving); Crushing plant operator; Drill Doctor; Drilling machine operator, Bucket or auger types (Calweld 150 bucket or similar types - Watson 1500, 2000 2500 auger or similar types - Texoma 700, 800 auger or similar types - drilling depth of 60' maximum); Elevating grader operator; Grade checker; Gradall operator; Grouting machine operator; Heavy-duty repairman; Heavy equipment robotics operator; Kalamazoo balliste regulator or similar type; Kolman belt loader and similar type; Le Tourneau blob compactor or similar type; Loader operator (Athey, Euclid, Sierra and similar types); Mobark Chipper or similar; Ozzie padder or similar types; P.C. slot saw; Pneumatic concrete placing machine operator (Hackley-Presswell or similar type); Pumpcrete gun operator; Rock Drill or similar types; Rotary drill operator (excluding caisson type); Rubber-tired earth-moving equipment operator (single engine, caterpillar, Euclid, Athey Wagon and similar types with any and all attachments over 25 yds. up to and including 50 cu. yds. struck); Rubber-tired earth-moving equipment operator (multiple engine up to and including 25 yds. struck); Rubber-tired scraper operator (self-loading paddle wheel type-John Deere, 1040 and similar single unit); Self-propelled curb and gutter machine operator; Shuttle buggy; Skiploader operator (crawler and wheel type over 1-1/2 yds. up to and including 6-1/2 yds.); Soil remediation plant operator; Surface heaters and planer operator; Tractor compressor drill combination operator; Tractor operator (any type larger than D-5 - 100 flywheel h.p. and over, or similar-bulldozer, tamper, scraper and push tractor single engine); Tractor operator (boom attachments), Traveling pipe wrapping, cleaning and bending machine operator; Trenching machine operator (over 6 ft. depth capacity, manufacturer's rating); trenching Machine with Road Miner attachment (over 6 ft depth capacity): Ultra high pressure waterjet cutting tool system mechanic; Water pull (compaction) operator

GROUP 9: Heavy Duty Repairman

GROUP 10: Drilling machine operator, Bucket or auger types (Calweld 200 B bucket or similar types-Watson 3000 or 5000 auger or similar types-Texoma 900 auger or similar types-drilling depth of 105' maximum); Dual drum mixer, dynamic compactor LDC350 (or similar types); Monorail locomotive operator (diesel, gas or electric); Motor patrol-blade operator (single engine); Multiple engine tractor operator (Euclid and similar type-except Quad 9 cat.); Rubber-tired earth-moving equipment operator (single engine, over 50 yds. struck); Pneumatic pipe ramming tool and similar types; Prestressed wrapping machine operator; Rubber-tired earth-moving equipment operator (single engine, over 50 yds. struck); Rubber tired earth moving equipment operator (multiple engine, Euclid, caterpillar and similar over 25 yds. and up to 50 yds. struck), Tower crane repairman; Tractor loader operator (crawler and wheel type over 6-1/2 yds.); Woods mixer operator (and similar Pugmill equipment)

GROUP 11: Heavy Duty Repairman - Welder Combination, Welder - Certified.

GROUP 12: Auto grader operator; Automatic slip form operator; Drilling machine operator, bucket or auger types (Calweld, auger 200 CA or similar types - Watson, auger 6000 or similar types - Hughes Super Duty, auger 200 or similar types - drilling depth of 175' maximum); Hoe ram or similar with compressor; Mass excavator operator less tha 750 cu. yards; Mechanical finishing machine operator; Mobile form traveler operator; Motor patrol operator (multi-engine); Pipe mobile machine operator; Rubber-tired earth- moving equipment operator (multiple engine, Euclid, Caterpillar and similar type, over 50 cu. yds. struck); Rubber-tired self- loading scraper operator (paddle-wheel-auger type self-loading - two (2) or more units)

GROUP 13: Rubber-tired earth-moving equipment operator operating equipment with push-pull system (single engine, up to and including 25 yds. struck)

GROUP 14: Canal liner operator; Canal trimmer operator; Remote-control earth-moving equipment operator (operating a second piece of equipment: \$1.00 per hour additional); Wheel excavator operator (over 750 cu. yds.)

GROUP 15: Rubber-tired earth-moving equipment operator, operating equipment with push-pull system (single engine, Caterpillar, Euclid, Athey Wagon and similar types with any and all attachments over 25 yds. and up to and including 50 yds. struck); Rubber-tired earth-moving equipment operator, operating equipment with push-pull system (multiple engine-up to and including 25 yds. struck)

GROUP 16: Rubber-tired earth-moving equipment operator, operating equipment with push-pull system (single engine, over 50 yds. struck); Rubber-tired earth-moving equipment operator, operating equipment with push-pull system (multiple engine, Euclid, Caterpillar and similar, over 25 yds. and up to 50 yds. struck)

GROUP 17: Rubber-tired earth-moving equipment operator, operating equipment with push-pull system (multiple engine, Euclid, Caterpillar and similar, over 50 cu. yds. struck); Tandem tractor operator (operating crawler type tractors in tandem - Quad 9 and similar type)

GROUP 18: Rubber-tired earth-moving equipment operator, operating in tandem (scrapers, belly dumps and similar types in any combination, excluding compaction units - single engine, up to and including 25 yds. struck)

GROUP 19: Rotex concrete belt operator (or similar types); Rubber-tired earth-moving equipment operator, operating in tandem (scrapers, belly dumps and similar types in any combination, excluding compaction units - single engine, Caterpillar, Euclid, Athey Wagon and similar types with any and all attachments over 25 yds. and up to and including 50 cu. yds. struck); Rubber-tired earth-moving equipment operator, operating in tandem (scrapers, belly dumps and similar types in any combination, excluding compaction units - multiple engine, up to and including 25 yds. struck)

GROUP 20: Rubber-tired earth-moving equipment operator, operating in tandem (scrapers, belly dumps and similar types in any combination, excluding compaction units - single engine, over 50 yds. struck); Rubber-tired earth-moving equipment operator, operating in tandem (scrapers, belly dumps, and similar types in any combination, excluding compaction units - multiple engine, Euclid, Caterpillar and similar, over 25 yds. and up to 50 yds. struck)

GROUP 21: Rubber-tired earth-moving equipment operator, operating in tandem (scrapers, belly dumps and similar types in any combination, excluding compaction units - multiple engine, Euclid, Caterpillar and similar type, over 50 cu. yds. struck)

GROUP 22: Rubber-tired earth-moving equipment operator, operating equipment with the tandem push-pull system (single engine, up to and including 25 yds. struck)

GROUP 23: Rubber-tired earth-moving equipment operator, operating equipment with the tandem push-pull system (single engine, Caterpillar, Euclid, Athey Wagon and similar types with any and all attachments over 25 yds. and up to and including 50 yds. struck); Rubber-tired earth-moving equipment operator, operating with the tandem push-pull system (multiple engine, up to and including 25 yds. struck)

GROUP 24: Rubber-tired earth-moving equipment operator, operating equipment with the tandem push-pull system (single engine, over 50 yds. struck); Rubber-tired earth-moving equipment operator, operating equipment with the tandem push-pull

system (multiple engine, Euclid, Caterpillar and similar, over 25 yds. and up to 50 yds. struck)

GROUP 25: Concrete pump operator-truck mounted; Rubber-tired earth-moving equipment operator, operating equipment with the tandem push-pull system (multiple engine, Euclid, Caterpillar and similar type, over 50 cu. yds. struck)

#### CRANES, PILEDRIVING AND HOISTING EQUIPMENT CLASSIFICATIONS

GROUP 1: Engineer oiler; Fork lift operator (includes loed, lull or similar types)

GROUP 2: Truck crane oiler

GROUP 3: A-frame or winch truck operator; Ross carrier operator (jobsite)

GROUP 4: Bridge-type unloader and turntable operator; Helicopter hoist operator

GROUP 5: Hydraulic boom truck; Stinger crane (Austin-Western or similar type); Tugger hoist operator (1 drum)

GROUP 6: Bridge crane operator; Cretor crane operator; Hoist operator (Chicago boom and similar type); Lift mobile operator; Lift slab machine operator (Vagtborg and similar types); Material hoist and/or manlift operator; Polar gantry crane operator; Self Climbing scaffold (or similar type); Shovel, backhoe, dragline, clamshell operator (over 3/4 yd. and up to 5 cu. yds. mrc); Tugger hoist operator

GROUP 7: Pedestal crane operator; Shovel, backhoe, dragline, clamshell operator (over 5 cu. yds. mrc); Tower crane repair; Tugger hoist operator (3 drum)

GROUP 8: Crane operator (up to and including 25 ton capacity); Crawler transporter operator; Derrick barge operator (up to and including 25 ton capacity); Hoist operator, stiff legs, Guy derrick or similar type (up to and including 25 ton capacity); Shovel, backhoe, dragline, clamshell operator (over 7 cu. yds., M.R.C.)

GROUP 9: Crane operator (over 25 tons and up to and including 50 tons mrc); Derrick barge operator (over 25 tons up to and including 50 tons mrc); Highline cableway operator; Hoist operator, stiff legs, Guy derrick or similar type (over 25 tons up to and including 50 tons mrc); K-crane operator; Polar crane operator; Self erecting tower crane operator maximum lifting capacity ten tons

GROUP 10: Crane operator (over 50 tons and up to and including 100 tons mrc); Derrick barge operator (over 50 tons up to and including 100 tons mrc); Hoist operator, stiff legs, Guy derrick or similar type (over 50 tons up to and including 100 tons mrc), Mobile tower crane operator (over 50 tons, up to and including 100 tons M.R.C.); Tower crane operator and tower gantry

GROUP 11: Crane operator (over 100 tons and up to and including 200 tons mrc); Derrick barge operator (over 100 tons up to and including 200 tons mrc); Hoist operator, stiff legs, Guy derrick or similar type (over 100 tons up to and including 200 tons mrc); Mobile tower crane operator (over 100 tons up to and including 200 tons mrc)

GROUP 12: Crane operator (over 200 tons up to and including 300 tons mrc); Derrick barge operator (over 200 tons up to and including 300 tons mrc); Hoist operator, stiff legs, Guy derrick or similar type (over 200 tons, up to and including 300 tons mrc); Mobile tower crane operator (over 200 tons, up to and including 300 tons mrc)

ISSUED BY ADDENDUM No. 3, ATTACHMENT "A"

GROUP 13: Crane operator (over 300 tons); Derrick barge operator (over 300 tons); Helicopter pilot; Hoist operator, stiff legs, Guy derrick or similar type (over 300 tons); Mobile tower crane operator (over 300 tons)

#### TUNNEL CLASSIFICATIONS

GROUP 1: Skiploader (wheel type up to 3/4 yd. without attachment)

GROUP 2: Power-driven jumbo form setter operator

GROUP 3: Dinkey locomotive or motorperson (up to and including 10 tons)

GROUP 4: Bit sharpener; Equipment greaser (grease truck); Slip form pump operator (power-driven hydraulic lifting device for concrete forms); Tugger hoist operator (1 drum); Tunnel locomotive operator (over 10 and up to and including 30 tons)

GROUP 5: Backhoe operator (up to and including 3/4 yd.); Small Ford, Case or similar; Drill doctor; Grouting machine operator; Heading shield operator; Heavy-duty repairperson; Loader operator (Athey, Euclid, Sierra and similar types); Mucking machine operator (1/4 yd., rubber-tired, rail or track type); Pneumatic concrete placing machine operator (Hackley-Presswell or similar type); Pneumatic heading shield (tunnel); Pumpcrete gun operator; Tractor compressor drill combination operator; Tugger hoist operator (2 drum); Tunnel locomotive operator (over 30 tons)

GROUP 6: Heavy Duty Repairman

GROUP 7: Tunnel mole boring machine operator

#### ENGINEERS ZONES

\$1.00 additional per hour for all of IMPERIAL County and the portions of KERN, RIVERSIDE & SAN BERNARDINO Counties as defined below:

That area within the following Boundary: Begin in San Bernardino County, approximately 3 miles NE of the intersection of I-15 and the California State line at that point which is the NW corner of Section 1, T17N, R14E, San Bernardino Meridian. Continue W in a straight line to that point which is the SW corner of the northwest quarter of Section 6, T27S, R42E, Mt. Diablo Meridian. Continue North to the intersection with the Inyo County Boundary at that point which is the NE corner of the western half of the northern quarter of Section 6, T25S, R42E, MDM. Continue W along the Inyo and San Bernardino County boundary until the intersection with Kern County, at that point which is the SE corner of Section 34, T24S, R40E, MDM. Continue W along the Inyo and Kern County boundary until the intersection with Tulare County, at that point which is the SW corner of the SE quarter of Section 32, T24S, R37E, MDM. Continue W along the Kern and Tulare County boundary, until that point which is the NW corner of T25S, R32E, MDM. Continue S following R32E lines to the NW corner of T31S, R32E, MDM. Continue W to the NW corner of T31S, R31E, MDM. Continue S to the SW corner of T32S, R31E, MDM. Continue W to SW corner of SE quarter of Section 34, T32S, R30E, MDM. Continue S to SW corner of T11N, R17W, SBM. Continue E along south boundary of T11N, SBM to SW corner of T11N, R7W, SBM. Continue S to SW corner of T9N, R7W, SBM. Continue E along south boundary of T9N, SBM to SW corner of T9N, R1E, SBM. Continue S along west boundary of R1E, SBM to Riverside County line at the SW corner of T1S, R1E, SBM. Continue E along south boundary of T1S, SBM (Riverside County Line) to SW corner of T1S, R10E, SBM. Continue S along west boundary of R10E, SBM to Imperial County line at the SW corner of T8S, R10E, SBM. Continue W along Imperial and Riverside county line to NW corner of T9S, R9E, SBM. Continue S along the boundary between Imperial and San Diego Counties, along the west edge of R9E, SBM to the south boundary of Imperial County/California state line. Follow the California state line west to Arizona state line, then north to Nevada state line, then

continuing NW back to start at the point which is the NW corner of Section 1, T17N, R14E, SBM

\$1.00 additional per hour for portions of SAN LUIS OBISPO, KERN, SANTA BARBARA & VENTURA as defined below:

That area within the following Boundary: Begin approximately 5 miles north of the community of Cholame, on the Monterey County and San Luis Obispo County boundary at the NW corner of T25S, R16E, Mt. Diablo Meridian. Continue south along the west side of R16E to the SW corner of T30S, R16E, MDM. Continue E to SW corner of T30S, R17E, MDM. Continue S to SW corner of T31S, R17E, MDM. Continue E to SW corner of T31S, R18E, MDM. Continue S along West side of R18E, MDM as it crosses into San Bernardino Meridian numbering area and becomes R30W. Follow the west side of R30W, SBM to the SW corner of T9N, R30W, SBM. Continue E along the south edge of T9N, SBM to the Santa Barbara County and Ventura County boundary at that point which is the SW corner of Section 34.T9N, R24W, SBM, continue S along the Ventura County line to that point which is the SW corner of the SE quarter of Section 32, T7N, R24W, SBM. Continue E along the south edge of T7N, SBM to the SE corner to T7N, R21W, SBM. Continue N along East side of R21W, SBM to Ventura County and Kern County boundary at the NE corner of T8N, R21W. Continue W along the Ventura County and Kern County boundary to the SE corner of T9N, R21W. Continue North along the East edge of R21W, SBM to the NE corner of T12N, R21W, SBM. Continue West along the north edge of T12N, SBM to the SE corner of T32S, R21E, MDM. [T12N SBM is a think strip between T11N SBM and T32S MDM]. Continue North along the East side of R21E, MDM to the Kings County and Kern County border at the NE corner of T25S, R21E, MDM, continue West along the Kings County and Kern County Boundary until the intersection of San Luis Obispo County. Continue west along the Kings County and San Luis Obispo County boundary until the intersection with Monterey County. Continue West along the Monterey County and San Luis Obispo County boundary to the beginning point at the NW corner of T25S, R16E, MDM.

\$2.00 additional per hour for INYO and MONO Counties and the Northern portion of SAN BERNARDINO County as defined below:

That area within the following Boundary: Begin at the intersection of the northern boundary of Mono County and the California state line at the point which is the center of Section 17, T10N, R22E, Mt. Diablo Meridian. Continue S then SE along the entire western boundary of Mono County, until it reaches Inyo County at the point which is the NE corner of the Western half of the NW quarter of Section 2, T8S, R29E, MDM. Continue SSE along the entire western boundary of Inyo County, until the intersection with Kern County at the point which is the SW corner of the SE 1/4 of Section 32, T24S, R37E, MDM. Continue E along the Inyo and Kern County boundary until the intersection with San Bernardino County at that point which is the SE corner of section 34, T24S, R40E, MDM. Continue E along the Inyo and San Bernardino County boundary until the point which is the NE corner of the Western half of the NW quarter of Section 6, T25S, R42E, MDM. Continue S to that point which is the SW corner of the NW quarter of Section 6, T27S, R42E, MDM. Continue E in a straight line to the California and Nevada state border at the point which is the NW corner of Section 1, T17N, R14E, San Bernardino Meridian. Then continue NW along the state line to the starting point, which is the center of Section 18, T10N, R22E, MDM.

REMAINING AREA NOT DEFINED ABOVE RECIEVES BASE RATE

-----  
ENGI0012-004 08/01/2015

Rates                      Fringes

OPERATOR: Power Equipment  
(DREDGING)

(1) Leverman.....	\$ 49.50	23.60
(2) Dredge dozer.....	\$ 43.53	23.60
(3) Deckmate.....	\$ 43.42	23.60
(4) Winch operator (stern winch on dredge).....	\$ 42.87	23.60
(5) Fireman-Oiler, Deckhand, Bargeman, Leveehand.....	\$ 42.33	23.60
(6) Barge Mate.....	\$ 42.94	23.60

IRON0377-002 01/01/2019

	Rates	Fringes
Ironworkers:		
Fence Erector.....	\$ 32.58	23.41
Ornamental, Reinforcing and Structural.....	\$ 39.00	32.05

PREMIUM PAY:

\$6.00 additional per hour at the following locations:

China Lake Naval Test Station, Chocolate Mountains Naval Reserve-Niland, Edwards AFB, Fort Irwin Military Station, Fort Irwin Training Center-Goldstone, San Clemente Island, San Nicholas Island, Susanville Federal Prison, 29 Palms - Marine Corps, U.S. Marine Base - Barstow, U.S. Naval Air Facility - Sealey, Vandenberg AFB

\$4.00 additional per hour at the following locations:

Army Defense Language Institute - Monterey, Fallon Air Base, Naval Post Graduate School - Monterey, Yermo Marine Corps Logistics Center

\$2.00 additional per hour at the following locations:

Port Hueneme, Port Mugu, U.S. Coast Guard Station - Two Rock

LABO0300-005 01/01/2018

	Rates	Fringes
Asbestos Removal Laborer.....	\$ 33.19	17.78

SCOPE OF WORK: Includes site mobilization, initial site cleanup, site preparation, removal of asbestos-containing material and toxic waste, encapsulation, enclosure and disposal of asbestos- containing materials and toxic waste by hand or with equipment or machinery; scaffolding, fabrication of temporary wooden barriers and assembly of decontamination stations.

LABO0345-001 07/01/2018

	Rates	Fringes
LABORER (GUNITE)		
GROUP 1.....	\$ 42.18	18.27
GROUP 2.....	\$ 41.23	18.27
GROUP 3.....	\$ 37.69	18.27

FOOTNOTE: GUNITE PREMIUM PAY: Workers working from a Bosn'n's Chair or suspended from a rope or cable shall receive 40 cents per hour above the foregoing applicable classification rates. Workers doing gunite and/or shotcrete work in a tunnel shall receive 35 cents per hour above the foregoing applicable classification rates, paid on a portal-to-portal basis. Any work performed on, in or above any smoke stack, silo, storage elevator or similar type of structure, when such structure is in excess of 75'-0" above base level and which work must be performed in whole or in part more than 75'-0" above base level, that work performed above the 75'-0" level shall be compensated for at 35 cents per hour above the applicable classification wage rate.

GUNITE LABORER CLASSIFICATIONS

GROUP 1: Rodmen, Nozzlemen

GROUP 2: Gunmen

GROUP 3: Reboundmen

-----  
LABO1184-001 07/01/2018

	Rates	Fringes
Laborers: (HORIZONTAL DIRECTIONAL DRILLING)		
(1) Drilling Crew Laborer...\$	35.70	14.03
(2) Vehicle Operator/Hauler.\$	35.87	14.03
(3) Horizontal Directional Drill Operator.....\$	37.72	14.03
(4) Electronic Tracking Locator.....\$	39.72	14.03
Laborers: (STRIPING/SLURRY SEAL)		
GROUP 1.....\$	35.86	16.21
GROUP 2.....\$	37.16	16.21
GROUP 3.....\$	39.17	16.21
GROUP 4.....\$	40.91	16.21

LABORERS - STRIPING CLASSIFICATIONS

GROUP 1: Protective coating, pavement sealing, including repair and filling of cracks by any method on any surface in parking lots, game courts and playgrounds; carstops; operation of all related machinery and equipment; equipment repair technician

GROUP 2: Traffic surface abrasive blaster; pot tender - removal of all traffic lines and markings by any method (sandblasting, waterblasting, grinding, etc.) and preparation of surface for coatings. Traffic control person: controlling and directing traffic through both conventional and moving lane closures; operation of all related machinery and equipment

GROUP 3: Traffic delineating device applicator: Layout and application of pavement markers, delineating signs, rumble and traffic bars, adhesives, guide markers, other traffic delineating devices including traffic control. This category includes all traffic related surface preparation (sandblasting, waterblasting, grinding) as part of the application process. Traffic protective delineating system installer: removes, relocates, installs, permanently affixed roadside and parking delineation barricades, fencing, cable anchor, guard rail, reference signs, monument markers; operation of all related machinery and equipment; power broom sweeper

GROUP 4: Striper: layout and application of traffic stripes and markings; hot thermo plastic; tape traffic stripes and markings, including traffic control; operation of all related machinery and equipment

-----  
 LABO1184-002 07/01/2018

	Rates	Fringes
LABORER (TUNNEL)		
GROUP 1.....	\$ 40.19	19.07
GROUP 2.....	\$ 40.51	19.07
GROUP 3.....	\$ 40.97	19.07
GROUP 4.....	\$ 41.66	19.07
LABORER		
GROUP 1.....	\$ 34.24	19.07
GROUP 2.....	\$ 34.79	19.07
GROUP 3.....	\$ 35.34	19.07
GROUP 4.....	\$ 36.89	19.07
GROUP 5.....	\$ 37.24	19.07

LABORER CLASSIFICATIONS

GROUP 1: Cleaning and handling of panel forms; Concrete screeding for rough strike-off; Concrete, water curing; Demolition laborer, the cleaning of brick if performed by a worker performing any other phase of demolition work, and the cleaning of lumber; Fire watcher, limber, brush loader, piler and debris handler; Flag person; Gas, oil and/or water pipeline laborer; Laborer, asphalt-rubber material loader; Laborer, general or construction; Laborer, general clean-up; Laborer, landscaping; Laborer, jetting; Laborer, temporary water and air lines; Material hose operator (walls, slabs, floors and decks); Plugging, filling of shee bolt holes; Dry packing of concrete; Railroad maintenance, repair track person and road beds; Streetcar and railroad construction track laborers; Rigging and signaling; Scaler; Slip form raiser; Tar and mortar; Tool crib or tool house laborer; Traffic control by any method; Window cleaner; Wire mesh pulling - all concrete pouring operations

GROUP 2: Asphalt shoveler; Cement dumper (on 1 yd. or larger mixer and handling bulk cement); Cesspool digger and installer; Chucktender; Chute handler, pouring concrete, the handling of the chute from readymix trucks, such as walls, slabs, decks, floors, foundation, footings, curbs, gutters and sidewalks; Concrete curer, impervious membrane and form oiler; Cutting torch operator (demolition); Fine grader, highways and street paving, airport, runways and similar type heavy construction; Gas, oil and/or water pipeline wrapper - pot tender and form person; Guinea chaser; Headerboard person - asphalt; Laborer, packing rod steel and pans; Membrane vapor barrier installer; Power broom sweeper (small); Riprap stonepaver, placing stone or wet sacked concrete; Roto scraper and tiller; Sandblaster (pot tender); Septic tank digger and installer(lead); Tank scaler and cleaner; Tree climber, faller, chain saw operator, Pittsburgh chipper and similar type brush shredder; Underground laborer, including caisson bellower

GROUP 3: Buggymobile person; Concrete cutting torch; Concrete pile cutter; Driller, jackhammer, 2-1/2 ft. drill steel or longer; Dri-pak-it machine; Gas, oil and/or water pipeline wrapper, 6-in. pipe and over, by any method, inside and out; High scaler (including drilling of same); Hydro seeder and similar type; Impact wrench multi-plate; Kettle person, pot person and workers applying asphalt, lay-kold, creosote, lime caustic and similar type materials ("applying" means applying, dipping, brushing or handling of such materials for pipe wrapping and waterproofing); Operator of pneumatic, gas, electric tools, vibrating machine, pavement breaker, air blasting, come-alongs, and similar mechanical tools not



separately classified herein; Pipelayer's backup person, coating, grouting, making of joints, sealing, caulking, diapering and including rubber gasket joints, pointing and any and all other services; Rock slinger; Rotary scarifier or multiple head concrete chipping scarifier; Steel headerboard and guideline setter; Tamper, Barko, Wacker and similar type; Trenching machine, hand-propelled

GROUP 4: Asphalt raker, lute person, ironer, asphalt dump person, and asphalt spreader boxes (all types); Concrete core cutter (walls, floors or ceilings), grinder or sander; Concrete saw person, cutting walls or flat work, scoring old or new concrete; Cribber, shorer, lagging, sheeting and trench bracing, hand-guided lagging hammer; Head rock slinger; Laborer, asphalt- rubber distributor boot person; Laser beam in connection with laborers' work; Oversize concrete vibrator operator, 70 lbs. and over; Pipelayer performing all services in the laying and installation of pipe from the point of receiving pipe in the ditch until completion of operation, including any and all forms of tubular material, whether pipe, metallic or non-metallic, conduit and any other stationary type of tubular device used for the conveying of any substance or element, whether water, sewage, solid gas, air, or other product whatsoever and without regard to the nature of material from which the tubular material is fabricated; No-joint pipe and stripping of same; Prefabricated manhole installer; Sandblaster (nozzle person), water blasting, Porta Shot-Blast

GROUP 5: Blaster powder, all work of loading holes, placing and blasting of all powder and explosives of whatever type, regardless of method used for such loading and placing; Driller: All power drills, excluding jackhammer, whether core, diamond, wagon, track, multiple unit, and any and all other types of mechanical drills without regard to the form of motive power; Toxic waste removal

TUNNEL LABORER CLASSIFICATIONS

GROUP 1: Batch plant laborer; Changehouse person; Dump person; Dump person (outside); Swamper (brake person and switch person on tunnel work); Tunnel materials handling person; Nipper; Pot tender, using mastic or other materials (for example, but not by way of limitation, shotcrete, etc.)

GROUP 2: Chucktender, cabetender; Loading and unloading agitator cars; Vibrator person, jack hammer, pneumatic tools (except driller); Bull gang mucker, track person; Concrete crew, including rodder and spreader

GROUP 3: Blaster, driller, powder person; Chemical grout jet person; Cherry picker person; Grout gun person; Grout mixer person; Grout pump person; Jackleg miner; Jumbo person; Kemper and other pneumatic concrete placer operator; Miner, tunnel (hand or machine); Nozzle person; Operating of troweling and/or grouting machines; Powder person (primer house); Primer person; Sandblaster; Shotcrete person; Steel form raiser and setter; Timber person, retimber person, wood or steel; Tunnel Concrete finisher

GROUP 4: Diamond driller; Sandblaster; Shaft and raise work

-----  
LABO1184-004 07/01/2018

	Rates	Fringes
Brick Tender.....	\$ 32.26	18.40

-----  
LABO1414-001 08/08/2018

	Rates	Fringes
--	-------	---------

LABORER

PLASTER CLEAN-UP LABORER....	\$ 33.82	19.40
PLASTER TENDER.....	\$ 36.37	19.40

Work on a swing stage scaffold: \$1.00 per hour additional.

-----  
PAIN0036-001 07/01/2018

	Rates	Fringes
Painters: (Including Lead Abatement)		
(1) Repaint (excludes San Diego County).....	\$ 27.59	14.92
(2) All Other Work.....	\$ 31.12	15.04

REPAINT of any previously painted structure. Exceptions: work involving the aerospace industry, breweries, commercial recreational facilities, hotels which operate commercial establishments as part of hotel service, and sports facilities.

-----  
PAIN0036-008 10/01/2018

	Rates	Fringes
DRYWALL FINISHER/TAPER.....	\$ 40.18	19.22

-----  
PAIN0036-015 06/01/2018

	Rates	Fringes
GLAZIER.....	\$ 42.20	25.50

FOOTNOTE: Additional \$1.25 per hour for work in a condor, from the third (3rd) floor and up Additional \$1.25 per hour for work on the outside of the building from a swing stage or any suspended contrivance, from the ground up

-----  
PAIN1247-002 05/01/2018

	Rates	Fringes
SOFT FLOOR LAYER.....	\$ 33.85	14.56

-----  
PLAS0200-009 08/01/2018

	Rates	Fringes
PLASTERER.....	\$ 36.86	18.00

-----  
PLAS0500-002 07/01/2018

	Rates	Fringes
CEMENT MASON/CONCRETE FINISHER...	\$ 35.75	22.48

-----  
PLUM0016-001 09/01/2018

	Rates	Fringes
PLUMBER/PIPEFITTER Plumber and Pipefitter		

ISSUED BY ADDENDUM No. 3, ATTACHMENT "A"

All other work except work on new additions and remodeling of bars, restaurant, stores and commercial buildings not to exceed 5,000 sq. ft. of floor space and work on strip malls, light commercial, tenant improvement and remodel work.....	\$ 50.13	22.16
Work ONLY on new additions and remodeling of bars, restaurant, stores and commercial buildings not to exceed 5,000 sq. ft. of floor space.....	\$ 48.58	21.18
Work ONLY on strip malls, light commercial, tenant improvement and remodel work.....	\$ 37.10	19.51

PLUM0078-001 07/01/2016

	Rates	Fringes
PLUMBER		
Landscape/Irrigation Fitter.....	\$ 44.16	25.19
Sewer & Storm Drain Work....	\$ 44.16	25.19

ROOF0036-002 08/01/2018

	Rates	Fringes
ROOFER.....	\$ 38.12	16.97

FOOTNOTE: Pitch premium: Work on which employees are exposed to pitch fumes or required to handle pitch, pitch base or pitch impregnated products, or any material containing coal tar pitch, the entire roofing crew shall receive \$1.75 per hour "pitch premium" pay.

SFCA0669-002 04/01/2018

	Rates	Fringes
SPRINKLER FITTER.....	\$ 39.73	21.90

SHEE0105-003 01/01/2019

LOS ANGELES (South of a straight line drawn between Gorman and Big Pines) and Catalina Island, INYO, KERN (Northeast part, East of Hwy 395), MONO ORANGE, RIVERSIDE, AND SAN BERNARDINO COUNTIES

	Rates	Fringes
SHEET METAL WORKER		
(1) Commercial - New Construction and Remodel work.....	\$ 44.28	28.46
(2) Industrial work		

including air pollution control systems, noise abatement, hand rails, guard rails, excluding aritechtrual sheet metal work, excluding A-C, heating, ventilating systems for human comfort...\$ 44.28 28.46

-----  
TEAM0011-002 07/01/2018

	Rates	Fringes
TRUCK DRIVER		
GROUP 1.....	\$ 30.59	28.59
GROUP 2.....	\$ 30.74	28.59
GROUP 3.....	\$ 30.87	28.59
GROUP 4.....	\$ 31.06	28.59
GROUP 5.....	\$ 31.09	28.59
GROUP 6.....	\$ 31.12	28.59
GROUP 7.....	\$ 31.37	28.59
GROUP 8.....	\$ 31.62	28.59
GROUP 9.....	\$ 31.82	28.59
GROUP 10.....	\$ 32.12	28.59
GROUP 11.....	\$ 32.62	28.59
GROUP 12.....	\$ 33.05	28.59

WORK ON ALL MILITARY BASES:

PREMIUM PAY: \$3.00 per hour additional.

[29 palms Marine Base, Camp Roberts, China Lake, Edwards AFB, El Centro Naval Facility, Fort Irwin, Marine Corps Logistics Base at Nebo & Yermo, Mountain Warfare Training Center, Bridgeport, Point Arguello, Point Conception, Vandenberg AFB]

TRUCK DRIVERS CLASSIFICATIONS

GROUP 1: Truck driver

GROUP 2: Driver of vehicle or combination of vehicles - 2 axles; Traffic control pilot car excluding moving heavy equipment permit load; Truck mounted broom

GROUP 3: Driver of vehicle or combination of vehicles - 3 axles; Boot person; Cement mason distribution truck; Fuel truck driver; Water truck - 2 axle; Dump truck, less than 16 yds. water level; Erosion control driver

GROUP 4: Driver of transit mix truck, under 3 yds.; Dumpcrete truck, less than 6-1/2 yds. water level

GROUP 5: Water truck, 3 or more axles; Truck greaser and tire person (\$0.50 additional for tire person); Pipeline and utility working truck driver, including winch truck and plastic fusion, limited to pipeline and utility work; Slurry truck driver

GROUP 6: Transit mix truck, 3 yds. or more; Dumpcrete truck, 6-1/2 yds. water level and over; Vehicle or combination of vehicles - 4 or more axles; Oil spreader truck; Dump truck, 16 yds. to 25 yds. water level

GROUP 7: A Frame, Swedish crane or similar; Forklift driver; Ross carrier driver

GROUP 8: Dump truck, 25 yds. to 49 yds. water level; Truck repair person; Water pull - single engine; Welder

GROUP 9: Truck repair person/welder; Low bed driver, 9 axles or over

GROUP 10: Dump truck - 50 yds. or more water level; Water pull - single engine with attachment

GROUP 11: Water pull - twin engine; Water pull - twin engine with attachments; Winch truck driver - \$1.25 additional when operating winch or similar special attachments

GROUP 12: Boom Truck 17K and above

-----  
WELDERS - Receive rate prescribed for craft performing operation to which welding is incidental.  
=====

Note: Executive Order (EO) 13706, Establishing Paid Sick Leave for Federal Contractors applies to all contracts subject to the Davis-Bacon Act for which the contract is awarded (and any solicitation was issued) on or after January 1, 2017. If this contract is covered by the EO, the contractor must provide employees with 1 hour of paid sick leave for every 30 hours they work, up to 56 hours of paid sick leave each year. Employees must be permitted to use paid sick leave for their own illness, injury or other health-related needs, including preventive care; to assist a family member (or person who is like family to the employee) who is ill, injured, or has other health-related needs, including preventive care; or for reasons resulting from, or to assist a family member (or person who is like family to the employee) who is a victim of, domestic violence, sexual assault, or stalking. Additional information on contractor requirements and worker protections under the EO is available at [www.dol.gov/whd/govcontracts](http://www.dol.gov/whd/govcontracts).

Unlisted classifications needed for work not included within the scope of the classifications listed may be added after award only as provided in the labor standards contract clauses (29CFR 5.5 (a) (1) (ii)).

-----  
The body of each wage determination lists the classification and wage rates that have been found to be prevailing for the cited type(s) of construction in the area covered by the wage determination. The classifications are listed in alphabetical order of "identifiers" that indicate whether the particular rate is a union rate (current union negotiated rate for local), a survey rate (weighted average rate) or a union average rate (weighted union average rate).

Union Rate Identifiers

A four letter classification abbreviation identifier enclosed in dotted lines beginning with characters other than "SU" or "UAVG" denotes that the union classification and rate were prevailing for that classification in the survey. Example:

PLUM0198-005 07/01/2014. PLUM is an abbreviation identifier of the union which prevailed in the survey for this classification, which in this example would be Plumbers. 0198 indicates the local union number or district council number where applicable, i.e., Plumbers Local 0198. The next number, 005 in the example, is an internal number used in processing the wage determination. 07/01/2014 is the effective date of the most current negotiated rate, which in this example is July 1, 2014.

Union prevailing wage rates are updated to reflect all rate changes in the collective bargaining agreement (CBA) governing this classification and rate.

Survey Rate Identifiers

Classifications listed under the "SU" identifier indicate that no one rate prevailed for this classification in the survey and the published rate is derived by computing a weighted average rate based on all the rates reported in the survey for that classification. As this weighted average rate includes all rates reported in the survey, it may include both union and non-union rates. Example: SULA2012-007 5/13/2014. SU indicates the rates are survey rates based on a weighted average calculation of rates and are not majority rates. LA indicates the State of Louisiana. 2012 is the year of survey on which these classifications and rates are based. The next number, 007 in the example, is an internal number used in producing the wage determination. 5/13/2014 indicates the survey completion date for the classifications and rates under that identifier.

Survey wage rates are not updated and remain in effect until a new survey is conducted.

Union Average Rate Identifiers

Classification(s) listed under the UAVG identifier indicate that no single majority rate prevailed for those classifications; however, 100% of the data reported for the classifications was union data. EXAMPLE: UAVG-OH-0010 08/29/2014. UAVG indicates that the rate is a weighted union average rate. OH indicates the state. The next number, 0010 in the example, is an internal number used in producing the wage determination. 08/29/2014 indicates the survey completion date for the classifications and rates under that identifier.

A UAVG rate will be updated once a year, usually in January of each year, to reflect a weighted average of the current negotiated/CBA rate of the union locals from which the rate is based.

-----  
WAGE DETERMINATION APPEALS PROCESS

1.) Has there been an initial decision in the matter? This can be:

- \* an existing published wage determination
- \* a survey underlying a wage determination
- \* a Wage and Hour Division letter setting forth a position on a wage determination matter
- \* a conformance (additional classification and rate) ruling

On survey related matters, initial contact, including requests for summaries of surveys, should be with the Wage and Hour Regional Office for the area in which the survey was conducted because those Regional Offices have responsibility for the Davis-Bacon survey program. If the response from this initial contact is not satisfactory, then the process described in 2.) and 3.) should be followed.

With regard to any other matter not yet ripe for the formal process described here, initial contact should be with the Branch of Construction Wage Determinations. Write to:

Branch of Construction Wage Determinations  
Wage and Hour Division  
U.S. Department of Labor  
200 Constitution Avenue, N.W.  
Washington, DC 20210

2.) If the answer to the question in 1.) is yes, then an interested party (those affected by the action) can request review and reconsideration from the Wage and Hour Administrator (See 29 CFR Part 1.8 and 29 CFR Part 7). Write to:

Wage and Hour Administrator  
U.S. Department of Labor  
200 Constitution Avenue, N.W.  
Washington, DC 20210

The request should be accompanied by a full statement of the interested party's position and by any information (wage payment data, project description, area practice material, etc.) that the requestor considers relevant to the issue.

3.) If the decision of the Administrator is not favorable, an interested party may appeal directly to the Administrative Review Board (formerly the Wage Appeals Board). Write to:

Administrative Review Board  
U.S. Department of Labor  
200 Constitution Avenue, N.W.  
Washington, DC 20210

4.) All decisions by the Administrative Review Board are final.

=====

END OF GENERAL DECISION

ISSUED BY ADDENDUM No. 3, ATTACHMENT "A"

## Bid

Date: 02/27/2019

To: County of Riverside, hereafter called "County";

Bidder: Granite Construction Company  
(hereafter called "Contractor")

The undersigned, Contractor, having carefully examined the site and the Contract Documents for the construction of Grapefruit Boulevard and 62nd Avenue Traffic Signal and Safety Lighting Project. In the Community of Mecca, Prolect No. C3-0084, Federal Prolect No. HSIP-5956(236) hereby proposes to construct the work in accordance with the Contract Documents, including **Addenda Number(s)** 1, 2, 3 (Fill in addenda numbers if addenda have been issued.) for the amount stated in this Bid.

By submitting this Bid, Contractor agrees with County:

1. That unless withdrawn in person by Contractor or some person authorized in writing by Contractor (not by telephone or facsimile) before the time specified in the Notice Inviting Bids for the public opening of bids, this Bid constitutes an irrevocable offer for 90 calendar days after that date.
2. County has the right to reject any or all Bids and to waive any irregularities or informalities contained in a Bid.
3. To execute the Contract and deliver the Performance Bond, Payment Bond and Insurance Certificate with endorsements, that comply with the requirements set forth in the Instruction to Bidders and General Conditions, within ten (10) business days of the date of the Notice of Acceptance of Bid and Intent to Award as issued by the County.
4. That the contract shall be awarded upon a resolution or minute order to that effect duly adopted by the governing body of County; and that execution of the Contract shall constitute a written memorial thereof.
5. To submit to the County such information as County may require determining whether a particular Bid is the lowest responsible bid submitted.
6. That the accompanying Bid Bond, certified check or cashier's check is in an amount not less than 10% of the total bid submitted and constitutes a guarantee that if awarded the contract, Contractor will execute the Contract and deliver the required bonds within ten (10) business days after notice of award. If Contractor fails to execute and deliver said documents, the bond or check is to be charged with the costs of the resultant damages to the County, including but not limited to: publication costs, the difference in money between the amount bid and the amount in excess of the bid which it costs County to do or cause to be done for the work involved, lease and rental costs, additional salaries and overhead, increased interest and costs of funding the project, attorney expense, additional engineering and architectural expense and cost of maintaining or constructing alternate facilities occasioned by the failure to execute and deliver said documents.
7. By signing this Bid the Contractor certifies that the representations made therein are made under penalty of perjury.



**Grapefruit Boulevard and 62nd Avenue  
Traffic Signal and Safety Lighting Project  
In the Community of Mecca  
Project No. C3-0084  
Federal Project No. HSIP-5956(236)**

**PROPOSAL**

**BASE BID**

ITEM No.	ITEM CODE	ITEM	UNIT	ESTIMATED QUANTITY	ITEM PRICE (IN FIGURES)	TOTAL (IN FIGURES)
1	066102	DUST ABATMENT	LS	1	20,000 <sup>00</sup>	20,000 <sup>00</sup>
2	074020	WATER POLLUTION CONTROL	LS	1	5,000 <sup>00</sup>	5,000 <sup>00</sup>
3	120100	TRAFFIC CONTROL SYSTEM	LS	1	20,000 <sup>00</sup>	20,000 <sup>00</sup>
4	100100	DEVELOP WATER SUPPLY	LS	1	3,000 <sup>00</sup>	3,000 <sup>00</sup>
5	170103	CLEARING AND GRUBBING	LS	1	8,000 <sup>00</sup>	8,000 <sup>00</sup>
6	190101	ROADWAY EXCAVATION (INCLUDE SAWCUT AND REMOVE AC PAVEMENT TO 0.4' DEEP)	CY	850	70 <sup>00</sup>	59,500 <sup>00</sup>
7	260203	CLASS 2 AGGREGATE BASE	CY	157	80 <sup>00</sup>	12,560 <sup>00</sup>
8	390132	HOT MIX ASPHALT (TYPE A)	TON	1,900	105 <sup>00</sup>	199,500 <sup>00</sup>
9	377501	SLURRY SEAL (TYPE 3)	TON	80	675 <sup>00</sup>	54,000 <sup>00</sup>
10	398200	COLD PLANE ASPHALT CONCRETE PAVEMENT (0.12')	SQYD	625	8 <sup>00</sup>	5,000 <sup>00</sup>
11	017316	MINOR CONCRETE (CURB RAMP) (CRS 403 - CASE B)	EA	2	4,200 <sup>00</sup>	8,400 <sup>00</sup>
12	731623	MINOR CONCRETE (CURB RAMP) [CALTRANS STD PLAN A88A CASE C]	EA	1	2,800 <sup>00</sup>	2,800 <sup>00</sup>
13	017304	MINOR CONCRETE (CURB AND GUTTER) (CRS 200)	LF	510	50 <sup>00</sup>	25,500 <sup>00</sup>
14	731504	MINOR CONCRETE (CURB AND GUTTER) [CALTRANS STD PLAN A87A]	LF	85	55 <sup>00</sup>	4,675 <sup>00</sup>
15	017309	MINOR CONCRETE (TYPE D 6" CURB) (CRS 204)	LF	420	25 <sup>00</sup>	10,500 <sup>00</sup>
16	017309	MINOR CONCRETE (TYPE D 8" CURB) (CRS 204)	LF	1,235	30 <sup>00</sup>	37,050 <sup>00</sup>
17	510502	MINOR CONCRETE (MINOR STRUCTURE) [CONCRETE COLLAR RCFC & WCD STD. M803]	EA	4	1,400 <sup>00</sup>	5,600 <sup>00</sup>
18	731519	MINOR CONCRETE (STAMPED CONCRETE)	SQFT	1,550	16 <sup>00</sup>	24,800 <sup>00</sup>
19	641113	24" PLASTIC PIPE	LF	30	145 <sup>00</sup>	4,350 <sup>00</sup>
20	665025	24" CORRUGATED STEEL PIPE (.138" THICK)	LF	52	200 <sup>00</sup>	10,400 <sup>00</sup>

**PROPOSAL**

**BASE BID**

ITEM No.	ITEM CODE	ITEM	UNIT	ESTIMATED QUANTITY	ITEM PRICE (IN FIGURES)	TOTAL (IN FIGURES)
21	870400	SIGNAL AND LIGHTING SYSTEM	LS	1	369,000 <sup>00</sup>	369,000 <sup>00</sup>
22	038400	REMOVE TRAFFIC STRIPING AND PAVEMENT MARKING	SQFT	8,500	1 <sup>40</sup>	11,900 <sup>00</sup>
23	840515	THERMOPLASTIC PAVEMENT MARKING	SQFT	1,300	5 <sup>00</sup>	6,500 <sup>00</sup>
24	840501	THERMOPLASTIC TRAFFIC STRIPE	LF	16,500	0 <sup>80</sup>	13,200 <sup>00</sup>
25	820230	REMOVE SIGN	EA	15	100 <sup>00</sup>	1,500 <sup>00</sup>
26	820840	ROADSIDE SIGN - ONE POST	EA	11	450 <sup>00</sup>	4,950 <sup>00</sup>
27	810230	PAVEMENT MARKER (RETROREFLECTIVE)	EA	410	3 <sup>00</sup>	1,230 <sup>00</sup>
28	015602	FUNDING AWARENESS SIGN	EA	2	1,500 <sup>00</sup>	3,000 <sup>00</sup>
29	999991	MOBILIZATION, DEMOBILIZATION, AND FINAL CLEANUP	LS	1	50,000 <sup>00</sup>	50,000 <sup>00</sup>
30	066020	WORKING WITHIN RAILROAD RIGHT OF WAY, RELATIONS WITH RAILROAD (INCLUDING FLAGGING)	LS	1	14,085 <sup>00</sup>	14,085 <sup>00</sup>

PROJECT TOTAL: Nine Hundred Ninety-six Thousand \$996,000<sup>00</sup>  
 ITEMS 1-30 AND NO/100 "WORDS"

## Bidder Data and Signature

Name of Bidder: Granite Construction Company

Type of organization: Corporation

Person(s) authorized to sign for Bidder: \_\_\_\_\_

See Appendix A1

Joseph P. Richardson

Note:

If Bidder is a **Corporation**, state legal name of Corporation and also names of the president, vice-president, secretary, treasurer and manager thereof.

If Bidder is a **Co-Partnership**, state true name of firm and also names of all individual co-partners composing firm.

If Bidder is a sole proprietorship or an **Individual**, state first and last name(s) in full.

If Bid is signed by an agent other than an owner, partner or corporate officer, Bid shall be accompanied by a power-of-attorney.

Business Street Address: 38000 Monroe Street  
(Please include business address even if P.O. Box is used.)

Business City, State, Zip Code: Indio, CA 92203

P.O. Box- Number: N/A

P.O. Box- City, State, Zip Code: \_\_\_\_\_

Phone: ( 760 ) 775-7500

Facsimile: ( 760 ) 775-8229

E-mail: joe.richardson@gcinc.com

Contractor's license number: 89

License Classification(s): A,B

Expiration date: 05/31/2019

Department of Industrial Relations Registration Number: 1000000085



CONTRACTORS  
STATE LICENSE BOARD  
ACTIVE LICENSE



License Number **89**

Entity **CORP**

Business Name **GRANITE CONSTRUCTION COMPANY**

Classifications: **C36 C10 A B C57 C-2 C-8 C12  
C21 C27 C29 C35 C42 C45 C39  
C50 C51 C31**

Expiration Date **05/31/2019**

[www.cslb.ca.gov](http://www.cslb.ca.gov)



**Registration Complete! Thank you for your payment.**

Your PWCR registration and payment were submitted on 05/29/2018 at 08:47 AM. If you paid by credit card, payment confirmation and registration processing will take up to 24 hours. If you paid by ACH/EFT, payment confirmation and registration processing will take up to 10 calendar days.

**Registration for Fiscal Year:** 2019

**PWC Registration Number:** 1000000085

**Contractor Legal Name:** GRANITE CONSTRUCTION COMPANY

**Contractor Legal Entity:** Corporation

**Payment Amount:** \$400.00

**Payment Method:** MASTERCARD

**Payment Confirmation Number:** F0A0NWNTCZPC5

**Bidder Data and Signature (continued)**

Accompanying this Bid is a certified check, cashier check or bid bond in an amount equal to at least ten (10) percent of the total bid for:

**Grapefruit Boulevard and 62nd Avenue  
Traffic Signal and Safety Lighting Project  
In the Community of Mecca  
Project No. C3-0084  
Federal Project No. HSIP-5956(236)**

By my signature on this Bid, I certify, under penalty of perjury under the laws of the State of California, that all the information on this form is true and correct.

By my signature on this Bid, I certify, under penalty of perjury under the laws of the State of California, that the foregoing Statements and Questionnaire are true and correct and that the Bidder has complied with the requirements of Section 8103 of the Fair Employment and Housing Commission regulations (Chapter 5, Title 2 of the California Administrative Code).

By my signature on this Bid, I certify, under penalty of perjury under the laws of the State of California and the United States of America, that the Title 23 United States Code, Section 112 Non-Collusion Affidavit and Title 49 code of Federal Regulations, part 29 Debarment and Suspension Certification, and Disclosure of Lobbying Activities are true and correct.

IN WITNESS WHERE OF Bidder/Contractor executed this Bid as of the date set forth on page **B1** of this Bid.

Signature:



Name (printed):

Joseph P. Richardson

Title:

Regional Chief Estimator  
"Contractor"

**GRANITE CONSTRUCTION COMPANY**

**CERTIFICATE OF SECRETARY**

**RESOLVED**, that, effective January 1, 2019 through December 31, 2019, the individuals named on the attached Exhibit 1 are authorized to negotiate, execute and/or attest electronic and paper documents and contracts necessary for the conduct of the Company's affairs with respect to the submission and execution of construction project bids, bid proposals, bid addenda and all other bid-related documents prepared and submitted on behalf of the Company not to exceed \$25 million, relating to any and all domestic construction projects arising out of the Company's operations.

**RESOLVED**, that, effective January 1, 2019 through December 31, 2019, the individuals named on the attached Exhibit 2 are authorized to negotiate, execute and attest electronic and paper documents and contracts necessary for the conduct of the Company's affairs with respect to the submission and execution of construction project bids, bid proposals, bid addenda and all other bid-related documents prepared and submitted on behalf of the Company not to exceed \$75 million, relating to any and all domestic construction projects arising out of the Company's operations.

**RESOLVED FURTHER**, that the authority provided for herein shall be in accordance with applicable policies, procedures and limits of authority previously approved and the Granite Construction Incorporated Delegation of Authority and Policy then in effect.

I, M. Craig Hall, do hereby certify that I am duly qualified as Secretary of GRANITE CONSTRUCTION COMPANY, a California corporation (the "Company"); that the foregoing is a true and correct copy of resolutions duly adopted effective January 1, 2019 by unanimous written consent of the Executive Committee of the Board of Directors, held without a meeting in accordance with the provisions of Article III, Section 9 of the Bylaws of the Company; that the Directors acting were duly and regularly elected; and that the resolution adopted has not been modified or repealed and is still in full force and effect.

Dated: January 1, 2019

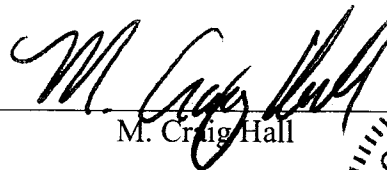
  
M. Craig Hall



**EXHIBIT 1**

**AUTHORIZED SIGNERS**  
**Granite Construction Company**  
**California Group**  
**Desert Cities Region**

**AUTHORIZED SIGNERS**

Brad J. Williams, VP Desert Cities Region  
Brian Caris, Senior Project Manager  
Joseph P. Richardson, Regional Chief Estimator  
Jeff J. Mercer, Region Construction Manager  
Ralph M. Pipkin, Project Manager  
Fausto Gonzalez, Project Manager  
Rudy Barela, Regional Controller

**ATTESTORS**

Brian Caris, Senior Project Manager  
Joseph P. Richardson, Regional Chief Estimator  
Jeff J. Mercer, Regional Construction Manager  
Ralph M. Pipkin, Project Manager  
Carley L. Cechin, Project Manager  
Fausto Gonzalez, Project Manager  
Rudy Barela, Regional Controller  
Carolyn Maness, Estimating Assistant



**EXHIBIT 2**

**AUTHORIZED SIGNERS**  
**Granite Construction Company**  
**California Group**

**AUTHORIZED SIGNERS**  
Jim Radich, VP Coastal Region  
Michael Tatusko, VP Valley Region  
Brent Fogg, VP Central Region  
Richard Scott McArthur, VP Northern Los Angeles Region  
John Boies, VP South Coast Region  
Brad J. Williams, VP Desert Cities Region  
Bradly Estes, VP Construction Materials

### Subcontractor List

Bidder/Contractor submits the following complete list of each Subcontractor who will perform work, labor or render service in or about the construction in an amount in excess of 1/2 of 1% of the total bid or \$10,000 whichever is greater.

Check box on right side of row if any construction item, for the listed Subcontractor, is partial work. If partial work is to be performed within a certain construction item or trade, the Bidder/Contractor shall specify the portion(s) of the work to be performed by the different subcontractors or Bidder/Contractor will be subject to provisions of Public Contract Code Section 4106.

Name of Bidder (Prime/General Contractor): Granite Construction Company

	Subcontractor Name	License Number	DIR Registration Number	Business Address (City, State)	Construction Item(s) [Item Number and Description]	Check if Partial Work
1.	California Professional Engineering Inc	793967	1000001980	La Puente, CA	21 Electrical	<input checked="" type="checkbox"/>
2.	Chrisp Company	374600	1000000306	Fremont, CA	22, 23, 24, 25, 26, 27, 29 Striping and Signs	<input checked="" type="checkbox"/>
3.	Pavement Coatings Company	303609	1000003382	Jurupa, Valley, CA	9, 29 Slurry Seal	<input checked="" type="checkbox"/>
4.						<input type="checkbox"/>
5.						<input type="checkbox"/>
6.						<input type="checkbox"/>

Additional Subcontractor List(s) may be attached to the Bid.  
(A copy of this form may be attached with additional Subcontractor information.)

Percent of work to be performed by Subcontractors: 45.1 %

Note: A minimum of 50% of the work is required to be performed by the prime/general Contractor.

## Non-Collusion Declaration

To be executed by bidder and submitted with bid.  
(Title 23 United States Code Section 112 and Public Contract Code Section 7106)

The undersigned declares:

I am the Regional Chief Estimator (Title) of Granite Construction Company (Company),  
the party making the foregoing bid.

The bid is not made in the interest of, or on behalf of, any undisclosed person, partnership, company, association, organization, or corporation. The bid is genuine and not collusive or sham. The bidder has not directly or indirectly induced or solicited any other bidder to put in a false or sham bid. The bidder has not directly or indirectly colluded, conspired, connived, or agreed with any bidder or anyone else to put in a sham bid, or that anyone shall refrain from bidding. The bidder has not in any manner, directly or indirectly, sought by agreement, communication, or conference with anyone to fix the bid price of the bidder or any other bidder, or to fix any overhead, profit, or cost element of the bid price, or of that of any other bidder.

All statements contained in the bid are true. The bidder has not, directly or indirectly, submitted his or her bid price of any breakdown thereof, or the contents thereof, or divulged information or data relative thereto, to any corporation, partnership, company, association, organization, bid depository, or to any member or agent thereof to effectuate a collusive or sham bid, and has not paid, and will not pay, any person or entity for such purpose.

Any person executing this declaration on behalf of a bidder that is a corporation, partnership, joint venture, limited liability company, limited liability partnership, or any other entity, hereby represents that he or she has full power to execute, and does execute, this declaration on behalf of the bidder.

I declare under penalty of perjury under the applicable laws that the foregoing is true and correct and that this declaration is executed on

February (Month) 27 (Day) of 2019 (Year),

at Indio (City), CA (State).

Signature of Declarant: \_\_\_\_\_

Printed name of Declarant: Joseph P. Richardson

Name of Bidder (Company): Granite Construction Company

Title or Office: Regional Chief Estimator

Note: Notarization of signature required.

Check box if attachment is included.

A notary public or other officer completing this certificate verifies only the identity of the individual who signed the document to which this certificate is attached, and not the truthfulness, accuracy, or validity of that document.

## ACKNOWLEDGMENT

State of California  
County of Riverside )

On February 27, 2019 before me, Carolyn Maness, Notary Public  
(insert name and title of the officer)

personally appeared Joseph P. Richardson,  
who proved to me on the basis of satisfactory evidence to be the person(s) whose name(s) is/are subscribed to the within instrument and acknowledged to me that he/she/they executed the same in his/her/their authorized capacity(ies), and that by his/her/their signature(s) on the instrument the person(s), or the entity upon behalf of which the person(s) acted, executed the instrument.

I certify under PENALTY OF PERJURY under the laws of the State of California that the foregoing paragraph is true and correct.

WITNESS my hand and official seal.

Signature Carolyn Maness (Seal)  
Carolyn Maness, Notary Public



**Iran Contracting Act**  
(Public Contract Code sections 2200-2208)

Prior to bidding on, submitting a proposal or executing a contract or renewal for a County of Riverside contract for goods or services of \$1,000,000 or more, a Contractor must either:

- a) Certify it is not on the current list of persons engaged in investment activities in Iran created by the California Department of General Services ("DGS") pursuant to Public Contract Code section 2203(b) and is not a financial institution extending twenty million dollars (\$20,000,000) or more in credit to another person, for 45 days or more, if that other person will use the credit to provide goods or services in the energy sector in Iran and is identified on the current list of persons engaged in investment activities in Iran created by DGS; or
- b) Demonstrate it has been exempted from the certification requirement for that solicitation or contract pursuant to Public Contract Code section 2203(c) or (d).

To comply with this requirement, please insert your Contractor or financial institution name and Federal ID Number (if available) and complete one of the options below. Please note: California law establishes penalties for providing false certifications, including civil penalties equal to the greater of \$250,000 or twice the amount of the contract for which the false certification was made; contract termination; and three-year ineligibility to bid on contracts. (Public Contract Code section 2205.)

**Option #1 – Certification**

I, the official named below, certify I am duly authorized to execute this certification on behalf of the vendor/financial institution identified below, and the vendor/financial institution identified below is **not** on the current list of persons engaged in investment activities in Iran created by DGS and is not a financial institution extending twenty million dollars (\$20,000,000) or more in credit to another person/vendor, for 45 days or more, if that other person/vendor will use the credit to provide goods or services in the energy sector in Iran and is identified on the current list of persons engaged in investment activities in Iran created by DGS.

<i>Contractor Name/Financial Institution (Printed)</i> <b>Granite Construction Company</b>	<i>Federal ID Number (or n/a)</i> <b>94-0519552</b>
<i>By (Authorized Signature)</i> 	
<i>Printed Name and Title of Person Signing</i> <b>Joseph P. Richardson, Regional Chief Estimator</b>	
<i>Date Executed</i> <b>02/27/2019</b>	<i>Executed in</i> <b>Indio, CA</b>

**Option #2 – Exemption**

Pursuant to Public Contract Code sections 2203(c) and (d), a public entity may permit a Contractor/financial institution engaged in investment activities in Iran, on a case-by-case basis, to be eligible for, or to bid on, submit a proposal for, or enters into or renews, a contract for goods and services.

**If you have obtained an exemption** from the certification requirement under the Iran Contracting Act, please fill out the information below, and **attach documentation demonstrating the exemption approval.**

<i>Contractor Name/Financial Institution (Printed)</i>	<i>Federal ID Number (or n/a)</i>
<i>By (Authorized Signature)</i>	
<i>Printed Name and Title of Person Signing</i>	
<i>Date Executed</i>	<i>Executed in</i>

### Equal Employment Opportunity Certification

\* Granite Construction Company

The bidder \* \_\_\_\_\_, proposed subcontractor \_\_\_\_\_, hereby certifies that he has  X , has not \_\_\_\_\_, participated in a previous contract or subcontract subject to the equal opportunity clauses, as required by Executive Orders 10925, 11114, or 11246, and that, where required, he has filed with the Joint Reporting Committee, the Director of the Office of Federal Contract Compliance, a Federal Government contracting or administering agency, or the former President's Committee on Equal Employment Opportunity, all reports due under the applicable filing requirements.

Granite Construction Company

(Company name)

By:

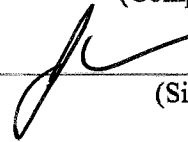

(Signature)

Joseph P. Richardson

(Name, print)

Regional Chief Estimator

(Title)

02/27/2019

(Date)

#### Note:

The above certification is required by the Equal Employment Opportunity Regulations of the Secretary of Labor (41 CFR 60-1.7(b) (1)), and must be submitted by bidders and proposed subcontractors only in connection with contracts and subcontracts which are subject to the equal opportunity clause. Contracts and subcontracts which are exempt from the equal opportunity clause are set forth in 41 CFR 60-1.5. (Generally only contracts or subcontracts of \$10,000 or under are exempt.)

Currently, Standard Form 100 (EEO-1) is the only report required by the Executive Orders or their implementing regulations.

Proposed prime contractors and subcontractors who have participated in a previous contract or subcontract subject to the Executive Orders and have not filed the required reports should note that 41 CFR 60-1.7(b) (1) prevents the award of contracts and subcontracts unless such Contractor submits a report covering the delinquent period or such other period specified by the Federal Highway Administration or by the Director, Office of Federal Contract Compliance, U.S. Department of Labor.

**Equal Employment Opportunity Certification**

The bidder \_\_\_\_\_, proposed subcontractor Chrisp Company hereby certifies that he has X, has not \_\_\_\_\_, participated in a previous contract or subcontract subject to the equal opportunity clauses, as required by Executive Orders 10925, 11114, or 11246, and that, where required, he has filed with the Joint Reporting Committee, the Director of the Office of Federal Contract Compliance, a Federal Government contracting or administering agency, or the former President's Committee on Equal Employment Opportunity, all reports due under the applicable filing requirements.

Chrisp Company  
(Company name)  
By: [Signature]  
(Signature)  
Coda Oesterblad  
(Name, print)  
Estimator  
(Title)  
2/27/19  
(Date)

**Note:**

The above certification is required by the Equal Employment Opportunity Regulations of the Secretary of Labor (41 CFR 60-1.7(b) (1)), and must be submitted by bidders and proposed subcontractors only in connection with contracts and subcontracts which are subject to the equal opportunity clause. Contracts and subcontracts which are exempt from the equal opportunity clause are set forth in 41 CFR 60-1.5. (Generally only contracts or subcontracts of \$10,000 or under are exempt.)

Currently, Standard Form 100 (EEO-1) is the only report required by the Executive Orders or their implementing regulations.

Proposed prime contractors and subcontractors who have participated in a previous contract or subcontract subject to the Executive Orders and have not filed the required reports should note that 41 CFR 60-1.7(b) (1) prevents the award of contracts and subcontracts unless such Contractor submits a report covering the delinquent period or such other period specified by the Federal Highway Administration or by the Director, Office of Federal Contract Compliance, U.S. Department of Labor.

**Equal Employment Opportunity Certification**

GRANITE CONSTRUCTION CO.                      PAVEMENT COATINGS CO.  
The bidder   A  , proposed subcontractor   A  ,  
hereby certifies that he has   ✓  , has not       , participated in a previous contract or  
subcontract subject to the equal opportunity clauses, as required by Executive Orders 10925,  
11114, or 11246, and that, where required, he has filed with the Joint Reporting Committee, the  
Director of the Office of Federal Contract Compliance, a Federal Government contracting or  
administering agency, or the former President's Committee on Equal Employment Opportunity,  
all reports due under the applicable filing requirements.

PAVEMENT COATINGS CO.

(Company name)

By:

    A Aaron Fox    

(Signature)

AARON FOX

(Name, print)

ESTIMATOR

(Title)

FEBRUARY 27, 2019

(Date)

**Note:**

The above certification is required by the Equal Employment Opportunity Regulations of the Secretary of Labor (41 CFR 60-1.7(b) (1)), and must be submitted by bidders and proposed subcontractors only in connection with contracts and subcontracts which are subject to the equal opportunity clause. Contracts and subcontracts which are exempt from the equal opportunity clause are set forth in 41 CFR 60-1.5. (Generally only contracts or subcontracts of \$10,000 or under are exempt.)

Currently, Standard Form 100 (EEO-1) is the only report required by the Executive Orders or their implementing regulations.

Proposed prime contractors and subcontractors who have participated in a previous contract or subcontract subject to the Executive Orders and have not filed the required reports should note that 41 CFR 60-1.7(b) (1) prevents the award of contracts and subcontracts unless such Contractor submits a report covering the delinquent period or such other period specified by the Federal Highway Administration or by the Director, Office of Federal Contract Compliance, U.S. Department of Labor.



**Equal Employment Opportunity Certification**

The bidder   \*  , proposed subcontractor   \*  , hereby certifies that he has   X  , has not           , participated in a previous contract or subcontract subject to the equal opportunity clauses, as required by Executive Orders 10925, 11114, or 11246, and that, where required, he has filed with the Joint Reporting Committee, the Director of the Office of Federal Contract Compliance, a Federal Government contracting or administering agency, or the former President's Committee on Equal Employment Opportunity, all reports due under the applicable filing requirements.

\* Bidder: Granite Construction Company  
Sub: California Professional Engineering Inc  
(Company name)

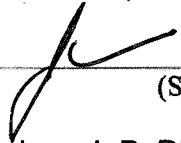
By:   
(Signature)  
Joseph P. Richardson  
(Name, print)

Regional Chief Estimator  
(Title)

02/27/2019  
(Date)

**Note:**

The above certification is required by the Equal Employment Opportunity Regulations of the Secretary of Labor (41 CFR 60-1.7(b) (1)), and must be submitted by bidders and proposed subcontractors only in connection with contracts and subcontracts which are subject to the equal opportunity clause. Contracts and subcontracts which are exempt from the equal opportunity clause are set forth in 41 CFR 60-1.5. (Generally only contracts or subcontracts of \$10,000 or under are exempt.)

Currently, Standard Form 100 (EEO-1) is the only report required by the Executive Orders or their implementing regulations.

Proposed prime contractors and subcontractors who have participated in a previous contract or subcontract subject to the Executive Orders and have not filed the required reports should note that 41 CFR 60-1.7(b) (1) prevents the award of contracts and subcontracts unless such Contractor submits a report covering the delinquent period or such other period specified by the Federal Highway Administration or by the Director, Office of Federal Contract Compliance, U.S. Department of Labor.