

SUBMITTAL TO THE BOARD OF SUPERVISORS
COUNTY OF RIVERSIDE, STATE OF CALIFORNIA



ITEM
3.20
(ID # 10774)

MEETING DATE:

Tuesday, October 1, 2019

FROM : TLMA-TRANSPORTATION:

SUBJECT: TRANSPORTATION AND LAND MANAGEMENT AGENCY/TRANSPORTATION
DEPARTMENT: Ordinance 452.246 - Introduction of Ordinance No. 452.246 to
Establish Speed Zones Enforceable by Radar Speed Detection Equipment in the
Murrieta, Perris, San Jacinto, and Winchester Areas. Districts 1, 3 and 5. [\$3,000
Total Cost - Gas Tax 100%]

RECOMMENDED MOTION: That the Board of Supervisors:

1. Introduce, Read Title, and Waive Further Reading of Ordinance No. 452.246, Amending Ordinance No. 452 relating to Prima Facie Speed Limits to Establish Various Speed Zones Enforceable by Radar Speed Detection Equipment in the Murrieta, Perris, San Jacinto, and Winchester Areas of Riverside County.

ACTION: Policy

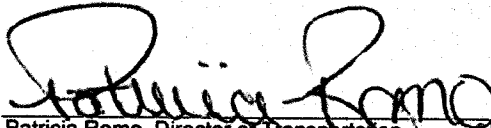
Patricia Romo, Director of Transportation 9/12/2019

MINUTES OF THE BOARD OF SUPERVISORS

On motion of Supervisor Perez, seconded by Supervisor Hewitt and duly carried, IT WAS ORDERED that the above matter is approved as recommended and Ordinance No. 452.246 is approved as introduced with waiver of the reading.

Ayes: Jeffries, Washington, Perez and Hewitt
Nays: None
Absent: Spiegel
Date: October 1, 2019
xc: Transp., COB

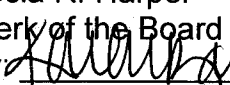
Kecia R. Harper
Clerk of the Board
By: 
Deputy

**SUBMITTAL TO THE BOARD OF SUPERVISORS COUNTY OF RIVERSIDE,
STATE OF CALIFORNIA**

FINANCIAL DATA	Current Fiscal Year:	Next Fiscal Year:	Total Cost:	Ongoing Cost
COST	\$ 3,000	\$ 0	\$ 3,000	\$ 0
NET COUNTY COST	\$ 0	\$ 0	\$ 0	\$ 0
SOURCE OF FUNDS: Gas Tax (100%). There are no General Funds used in this project.			Budget Adjustment: No	
			For Fiscal Year: 19/20	

C.E.O. RECOMMENDATION: Approve

BACKGROUND:

Summary

The County of Riverside Transportation Department conducted Engineering and Traffic Surveys (E&TS) in accordance with the California Vehicle Code (CVC), Sections 627 and 40802, for various county-maintained roads in the Murrieta, Perris, San Jacinto and Winchester areas of Riverside County.

Based upon the results of the E&TS for these roads, the Transportation Department recommends the introduction of designated radar-enforceable speed limits along the road segments summarized in the List of Speed Zones, and has determined these speed limits to be appropriate to facilitate the safe and orderly movement of traffic. The Transportation Department intends to recommend adoption of these designated radar-enforceable speed limits at the October 8, 2019 Board of Supervisors meeting.

Transportation Department staff has contacted the Riverside, San Geronio and Temecula area offices of the California Highway Patrol (CHP) regarding the recommended speed zones.

Impact on Residents and Businesses

The establishing and posting of appropriate speed limits promote safe and orderly movements of vehicular traffic and enable the CHP to use radar equipment to enforce the posted speed limits. Since the recommended speed limits are based on actual speed surveys, the majority of motorists are already driving at or below the recommended speed limits. Posted speed limits also guide motorists to drive at a reasonable speed in unfamiliar locations.

SUPPLEMENTAL:

Additional Fiscal Information

The cost for establishing the recommended speed limits is primarily for the installation of speed limit signs, which is estimated at about \$ 3,000.

Contract History and Price Reasonableness

N/A

SUBMITTAL TO THE BOARD OF SUPERVISORS COUNTY OF RIVERSIDE,
STATE OF CALIFORNIA

ATTACHMENTS:

Ord 452.246 Vicinity Map

Ord 452.246

Ord 452.246 List of Speed Zones

Ord 452.246 Speed Zone Diagrams

Jason Farin, Senior Management Analyst

9/24/2019

Gregory V. Priaplos, Director County Counsel

9/18/2019

1
2
3
4
5
6
7
8
9
10
11
12
13
14
15
16
17
18
19
20
21
22
23
24
25
26
27
28

ORDINANCE NO. 452.246

AN ORDINANCE OF THE COUNTY OF RIVERSIDE

AMENDING ORDINANCE NO. 452

RELATING TO PRIMA FACIE SPEED LIMITS

The Board of Supervisors of the County of Riverside ordains as follows:

Section 1. Section 2.3 of Ordinance No. 452, entitled "Thirty-five miles per hour," is hereby amended to add new subsections 135 and 136 to read as follows:

"135. On Elliot Road between Jean Nicholas Road and Pat Road, a total distance of approximately 0.63 miles, in the Winchester area.

136. On Pat Road between Elliot Road and Pourroy Road, a total distance of approximately 0.57 miles, in the Winchester area."

Section 2. Section 2.4 of Ordinance No. 452, entitled "Forty miles per hour," is hereby amended to add new subsections 154, 155, and 156 to read as follows:

"154. On Calistoga Drive between Murrieta Hot Springs Road and Richmond Way/Greenhaven Way, a total distance of approximately 1.14 miles, in the Murrieta area.

155. On Promontory Parkway between Richmond Way/Greenhaven Way and Pourroy Road, a total distance of 0.80 miles, in the Murrieta area.

156. On Whisper Heights Parkway between Elliot Road and SH-79/Winchester Road, a total distance of approximately 0.40 miles, in the Winchester area."

Section 3. Section 2.6 of Ordinance No. 452, entitled "Fifty miles per hour," is hereby amended to add new subsection 92 to read as follows:

"92. On Lake Mathews Drive, between Cajalco Road and Gavilan Road, a total distance of approximately 5.11 miles, in the Perris area."

\\
\\

1 Section 4. Section 2.7 of Ordinance No. 452, entitled "Fifty-five miles per hour," is
2 hereby amended to add new subsection 30 to read as follows:

3 "30. On Gilman Springs Road, between 200 feet north of Kevin Road and
4 SH-79, a total distance of approximately 8.80 miles, in the San Jacinto
5 area."

6 Section 5. EFFECTIVE DATE. This ordinance shall take effect thirty (30) days after
7 its adoption.

8
9 BOARD OF SUPERVISORS OF THE COUNTY
10 OF RIVERSIDE, STATE OF CALIFORNIA

11 BY: _____
12 SUPERVISOR KEVIN JEFFRIES, Chairman

13 ATTEST:
14 KECIA HARPER-IHEM,
15 CLERK OF THE BOARD

16 By: _____
17 Deputy

18
19 APPROVED AS TO FORM:

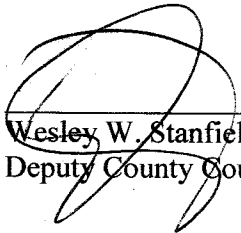
20
21 By:  _____
22 Wesley W. Stanfield
23 Deputy County Counsel

24 DA:sa

25 Y:\TRAFFIC\ORD 452 SPEED ZONES\ORD. 452.246\Ord. 452.246.docx

ORDINANCE 452.246 DISTRICT 3 SPEED ZONE VICINITY MAP

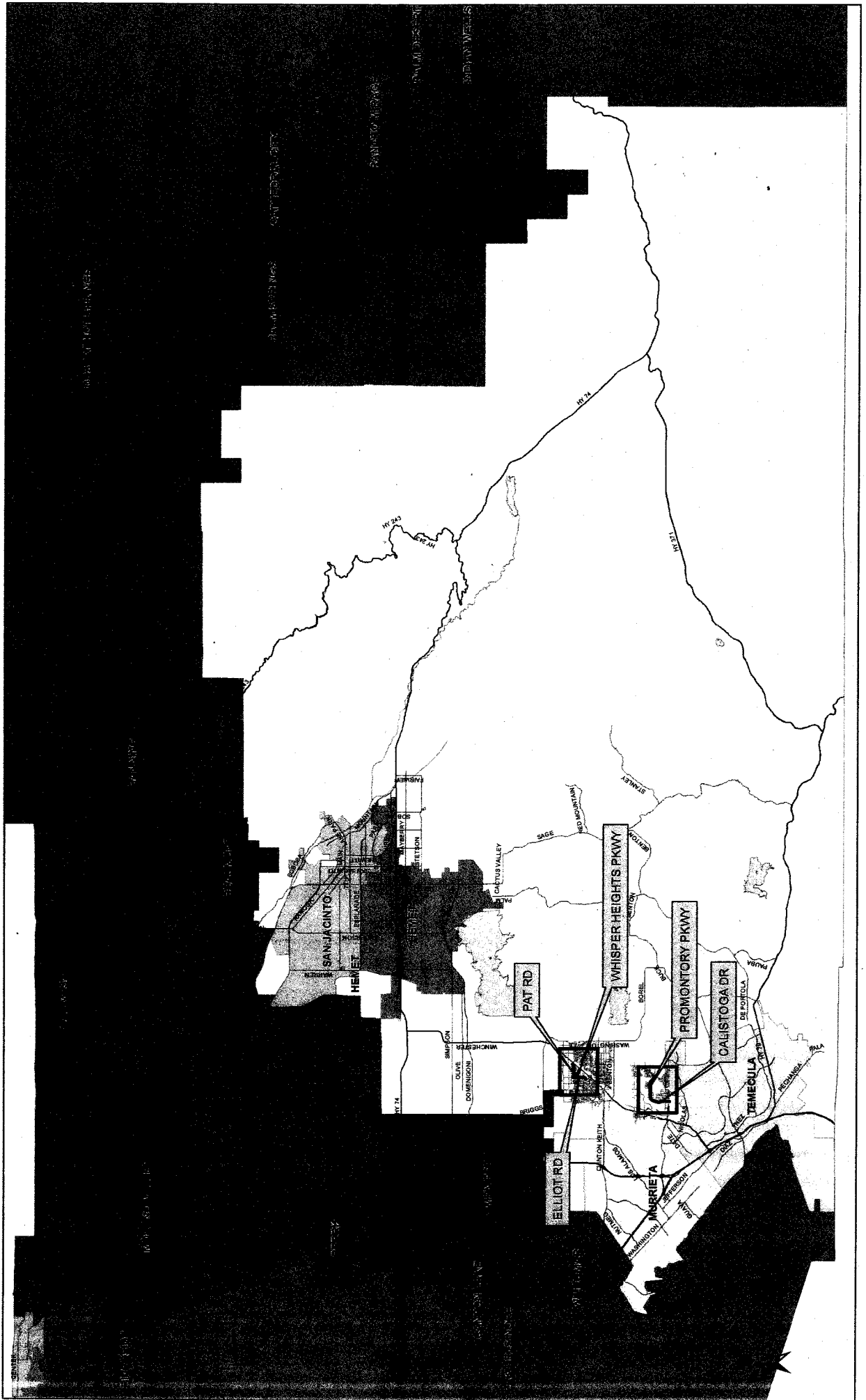

ORDINANCE 452.246 DISTRICT 5 SPEED ZONE VICINITY MAP

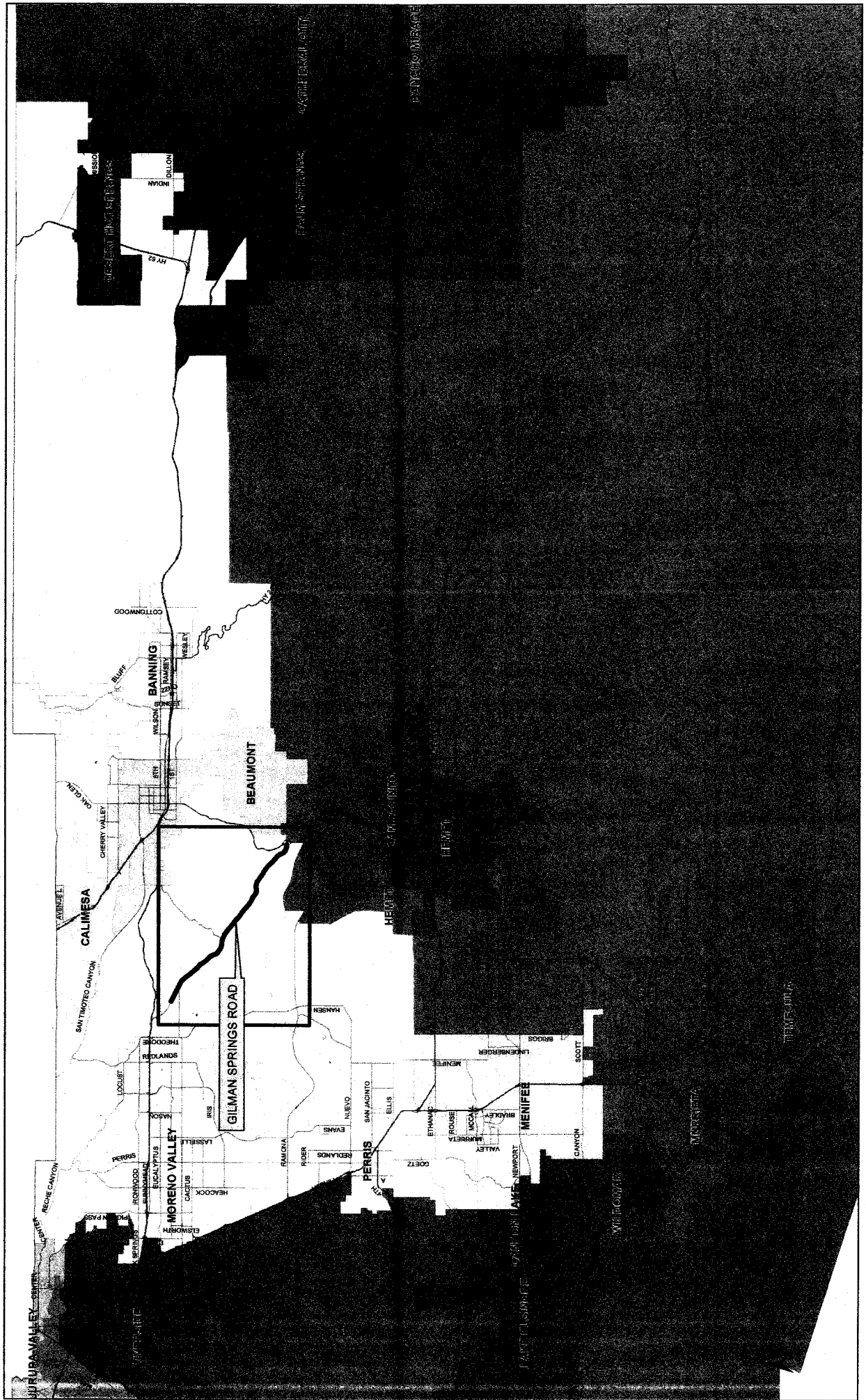

**LIST OF SPEED ZONE SUBMITTALS
ORDINANCE AMENDMENT NO 452.246
SUPERVISORIAL DISTRICT NO. 1**

AREA	ROADNAME/ LIMITS	EXISTING SPEED LIMIT	PROPOSED SPEED LIMIT	NOTES
PERRIS	LAKE MATHEWS DRIVE Between Cajalco Rd and Gavilan Rd	Not Posted*	50	NEW SPEED ZONE

* Maximum allowable speed limit for a two-lane highway is 55 mph (California Vehicle Code Section 22349)
 **Maximum allowable speed limit for a multi-lane highway is 65 mph (California Vehicle Code Section 22349)
 ***Change in speed zone boundary

**LIST OF SPEED ZONE SUBMITTALS
ORDINANCE AMENDMENT NO 452.246
SUPERVISORIAL DISTRICT NO. 3**

AREA	ROAD NAME MILES	EXISTING SPEED LIMIT	PROPOSED SPEED LIMIT	NOTES
MURRIETA	CALISTOGA DRIVE Between Murrieta Hot Springs and Richmond Way/Greenhaven Way	Not Posted**	40	NEW SPEED ZONE
WINCHESTER	ELLIOT ROAD Between Jean Nicholas Rd and Pat Rd	Not Posted*	35	NEW SPEED ZONE
WINCHESTER	PAT ROAD Between Elliot Rd and Pourroy Rd	Not Posted*	35	NEW SPEED ZONE
MURRIETA	PROMONTORY PARKWAY Between Richmond Way/Greenhaven Way and Pourroy Road	Not Posted**	40	NEW SPEED ZONE
WINCHESTER	WHISPER HEIGHTS PARKWAY Between Elliot Rd and SH-79/Winchester Rd	Not Posted*	40	NEW SPEED ZONE

* Maximum allowable speed limit for a two-lane highway is 55 mph (California Vehicle Code Section 22349)
 **Maximum allowable speed limit for a multi-lane highway is 65 mph (California Vehicle Code Section 22349)
 ***Change in speed zone boundary

**LIST OF SPEED ZONE SUBMITTALS
ORDINANCE AMENDMENT NO 452.246
SUPERVISORIAL DISTRICT NO. 5**

AREA	ROADNAME / LIMITS	EXISTING SPEED LIMIT	PROPOSED SPEED LIMIT	NOTES
SAN JACINTO	GILMAN SPRINGS ROAD Between 200 feet north of Kevin Road and SH-79	55	55	NEW SPEED ZONE

- * Maximum allowable speed limit for a two-lane highway is 55 mph (California Vehicle Code Section 22349)
- **Maximum allowable speed limit for a multi-lane highway is 65 mph (California Vehicle Code Section 22349)
- ***Change in speed zone boundary

CALISTOGA DRIVE

(#1910)

- LEGEND:**
- ////// CITY LIMITS
 - ▬ RADAR ZONE
 - - - SURVEY STATION
 - ▬ OTHER STREET OR ROAD

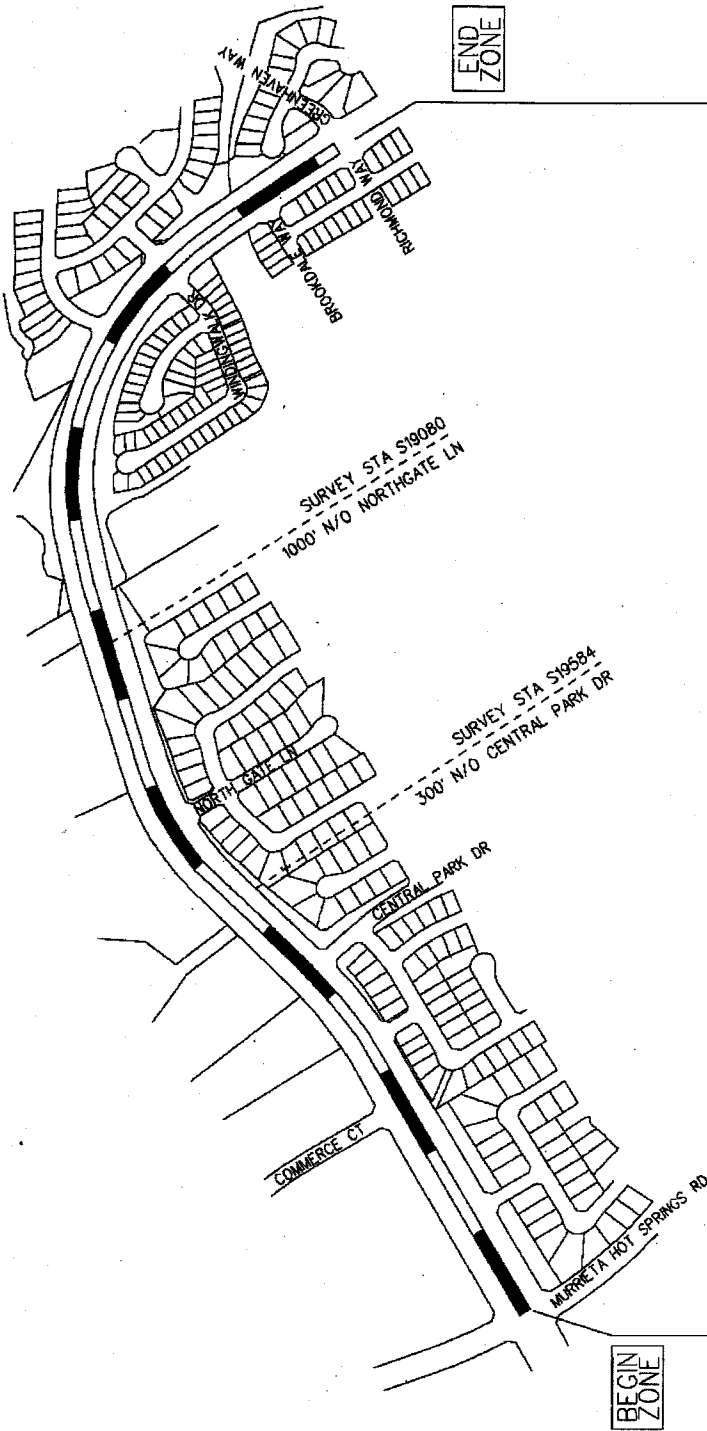

END ZONE

BEGIN ZONE

★ RATE - NO. OF ACCIDENT x 1000.000
VEH x 365 x 2 x MILE

RECOMMENDED SPEED LIMIT	40 MPH
85th/TILE SPEED	43.5 MPH (AVERAGE OF TWO SIMILAR STATIONS OF 36 & 51 MPH)
VEHICLES IN 24 HR (2 WAY)	2680
SEGMENT LENGTH	1.14 MILE
ALL ACCIDENTS IN 2 YRS.	1
ACCIDENT RATE ★	0.45 ACC/MVM
EXISTING SPEED LIMIT	NOT POSTED

COUNTY AREA:	MURRIETA	SURVEY DATE:	MAY 22 2019
COUNTY MAP:	124-C, 128D	MAP DATE:	JUL 08 2019
SUPERVISOR DISTRICT:	3	DRAWN BY:	J VALADEZ
		CAD FILE:	CALISTOGA DR.DGN

APPROVED BY: *[Signature]* **DENNIS ACUNA, P.E., T.E.** COUNTY TRAFFIC ENGINEER

DATE: 7/15/2019

COUNTY OF RIVERSIDE
TRANSPORTATION DEPARTMENT
TRAFFIC ENGINEERING DIVISION
ENGINEERING AND TRAFFIC SURVEY
CALISTOGA DRIVE

PAGE 1 OF 1

ELLIOT ROAD (#1904)

- LEGEND:**
- ////// CITY LIMITS
 - ▬ RADAR ZONE
 - - - SURVEY STATION
 - ▬ OTHER STREET OR ROAD

SURVEY STA S18774
1000' N/O JEAN
NICHOLAS RD

SURVEY STA S18772
400' N/O WHISPER
HEIGHTS PKWY

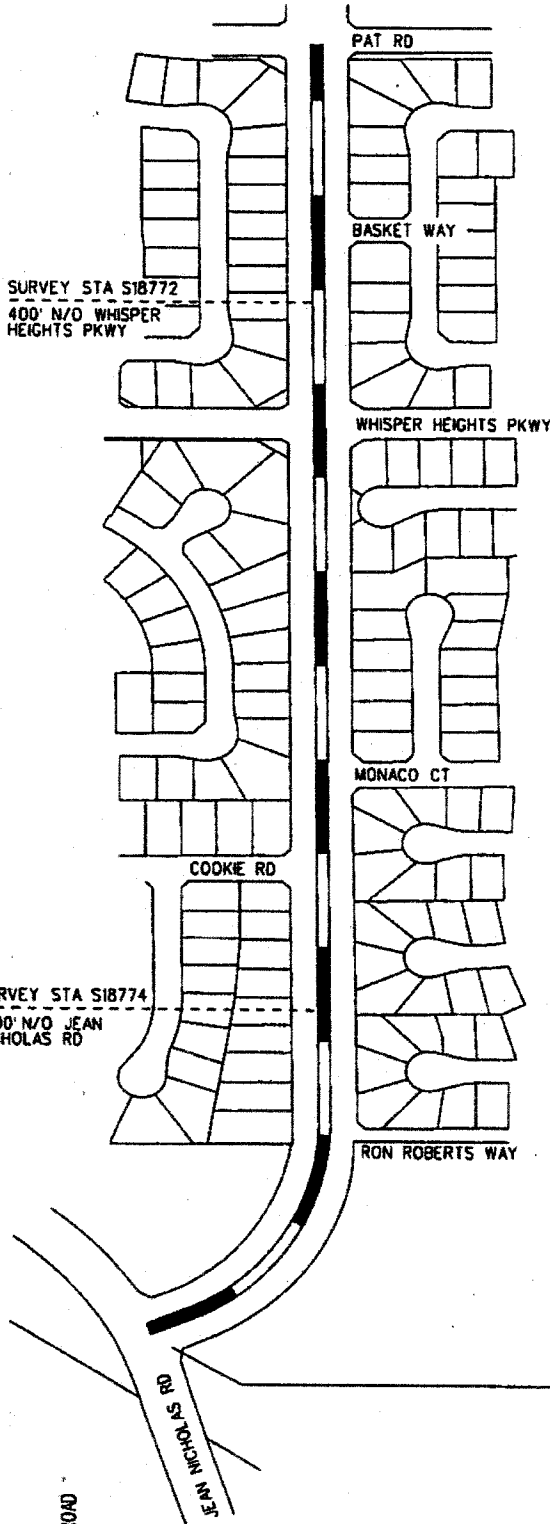

NO SCALE

★ RATE: $\frac{\text{NO. OF ACCIDENT} \times 1,000,000}{\text{VEH} \times 365 \times 2 \times \text{MILE}}$

BEGIN ZONE

END ZONE

RECOMMENDED SPEED LIMIT	35 MPH
85th/TILE SPEED	37 MPH (AVG OF TWO SIMILAR STATIONS OF 39 & 35 MPH)
VEHICLES IN 24 HR (2 WAY)	2800
SEGMENT LENGTH	0.63 MILE
ALL ACCIDENTS IN 2 YRS.	0
ACCIDENT RATE ★	0.00 ACC/MVM
EXISTING SPEED LIMIT	NOT POSTED

COUNTY AREA:	WINCHESTER	SURVEY DATE:	OCT 16 2018
COUNTY MAP:	12IE	MAP DATE:	APR 03 2019
SUPERVISOR DISTRICT:	3	DRAWN BY:	J VALADEZ
		CAD FILE:	ELLIOT RD.DGN

APPROVED BY:

J Valadez
4/16/19
DATE
J VALADEZ
COUNTY TRAFFIC ENGINEER

COUNTY OF RIVERSIDE
TRANSPORTATION DEPARTMENT
TRAFFIC ENGINEERING DIVISION
ENGINEERING AND TRAFFIC SURVEY
AT
ELLIOT ROAD

GILMAN SPRINGS ROAD (#1916)

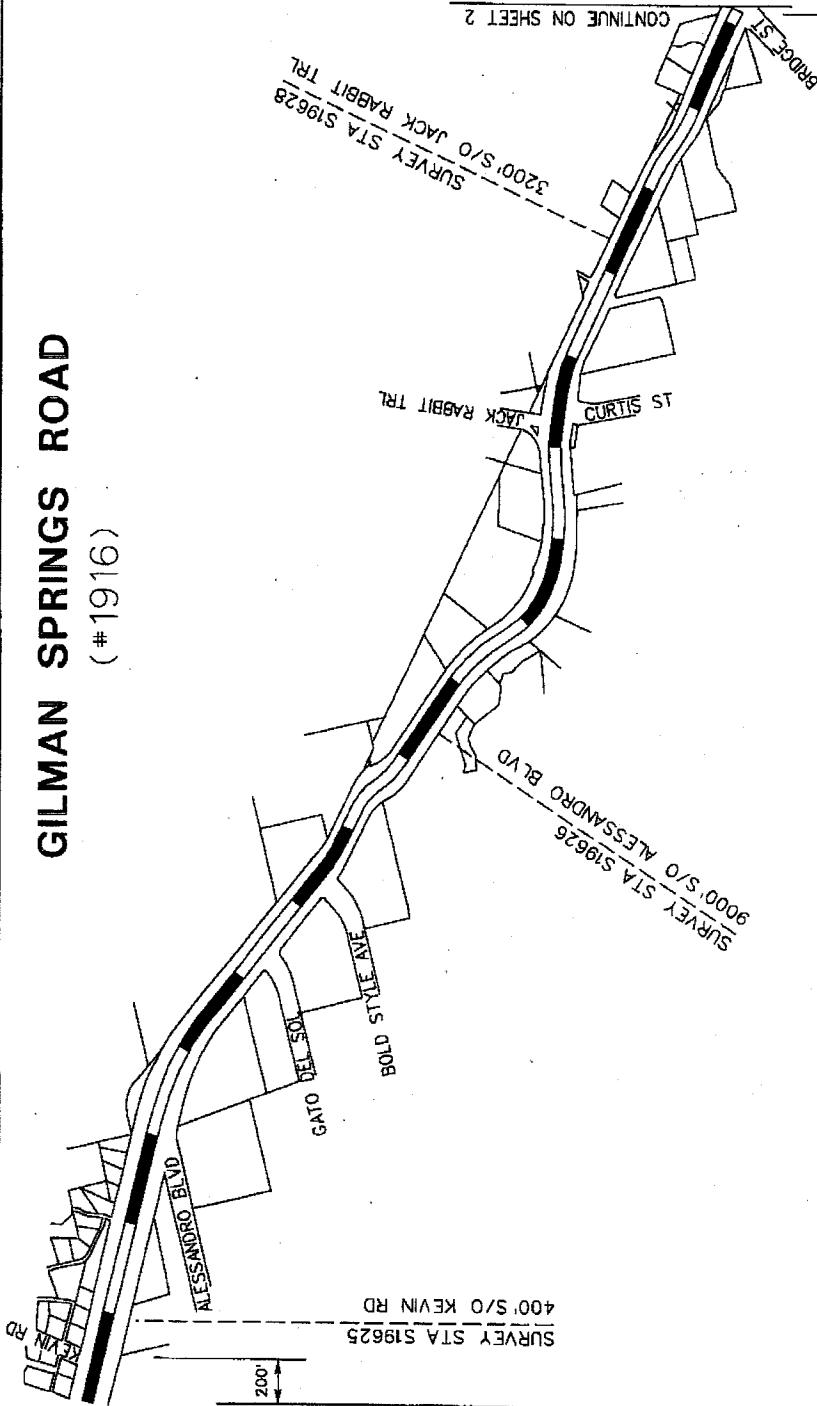

LEGEND:

- //// CITY LIMITS
- ▬ RADAR ZONE
- - - SURVEY STATION
- OTHER STREET OR ROAD

BEGIN ZONE

NO SCALE

*PER CVC 22349

★ RATE - $\frac{\text{NO. OF ACCIDENT} \times 1000000}{\text{VEH} \times 365 \times 2 \times \text{MILE}}$

RECOMMENDED SPEED LIMIT	55 MPH
85th/71LE SPEED	56.74 MPH (AVERAGE OF 5 SIMILAR STATIONS OF 57.8, 56.9, 57.4, 54.6 & 57.0 MPH)
VEHICLES IN 24 HR (2 WAY)	23,100
SEGMENT LENGTH	8.80 MILES (SHEET 1 - 5.70 MILES; SHEET 2 - 3.10 MILES)
ALL ACCIDENTS IN 2 YRS.	89
ACCIDENT RATE ★	0.60 ACC/MVM
EXISTING SPEED LIMIT	55 MPH★

(DATA APPLIES TO SHEET 1 & 2 UNLESS OTHERWISE NOTED)

COUNTY AREA:	SAN JACINTO	SURVEY DATE:	AUG 07 2019
COUNTY MAP:	95.98	MAP DATE:	AUG 08 2019
SUPERVISOR DISTRICT:	5	DRAWN BY:	J VALADEZ
		CAD FILE:	GIMAN SPRINGS RD.DGN

APPROVED BY:

BENNIS AGONA, P.E., T.E.
COUNTY TRAFFIC ENGINEER



COUNTY OF RIVERSIDE
TRANSPORTATION DEPARTMENT
TRAFFIC ENGINEERING DIVISION
ENGINEERING AND TRAFFIC SURVEY
AT
GILMAN SPRINGS ROAD

GILMAN SPRINGS ROAD (#1916)

- LEGEND:**
- ////// CITY LIMITS
 - ▬ RADAR ZONE
 - - - SURVEY STATION
 - ▬ OTHER STREET OR ROAD

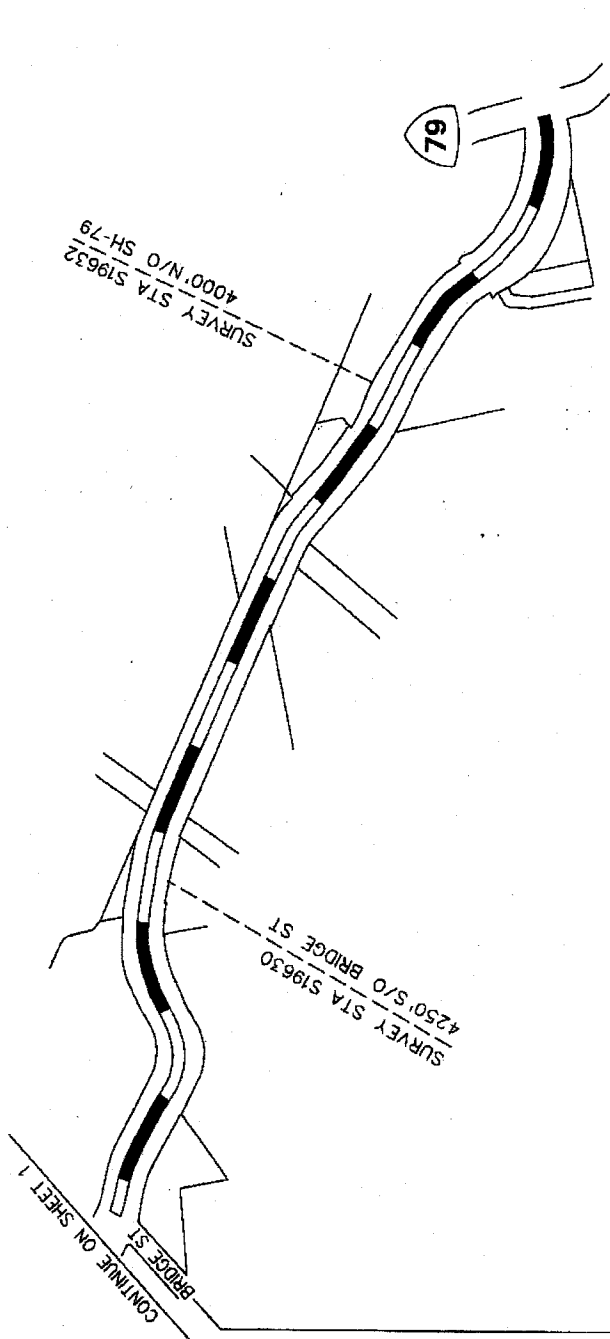

NO SCALE

*PER CVC 22349

★ RATE - NO. OF ACCIDENT x 1,000,000
VEH x 365 x 2 x MILE

END ZONE

(DATA APPLIES TO SHEET 1 & 2 UNLESS OTHERWISE NOTED)

RECOMMENDED SPEED LIMIT	55 MPH
85th/7ILE SPEED	SEE SHEET 1 OF 2
VEHICLES IN 24 HR (2 WAY)	SEE SHEET 1 OF 2
SEGMENT LENGTH	8.80 MILES (SHEET 1 - 5.70 MILES; SHEET 2 - 3.10 MILES)
ALL ACCIDENTS IN 2 YRS.	SEE SHEET 1 OF 2
ACCIDENT RATE ★	SEE SHEET 1 OF 2
EXISTING SPEED LIMIT	55 MPH*

COUNTY AREA:	SAN JACINTO	SURVEY DATE:	AUG 07 2019
COUNTY MAP:	95, 98	MAP DATE:	AUG 08 2019
SUPERVISOR DISTRICT:	5	DRAWN BY:	J VALADEZ
		CAD FILE:	GIMAN SPRINGS RD.DGN

APPROVED BY:

[Signature]
DENNIS ACUNA, P.E., T.E.
COUNTY TRAFFIC ENGINEER

COUNTY OF RIVERSIDE
TRANSPORTATION DEPARTMENT
TRAFFIC ENGINEERING DIVISION
ENGINEERING AND TRAFFIC SURVEY

GILMAN SPRINGS ROAD

LAKE MATHEWS DRIVE (#1900)

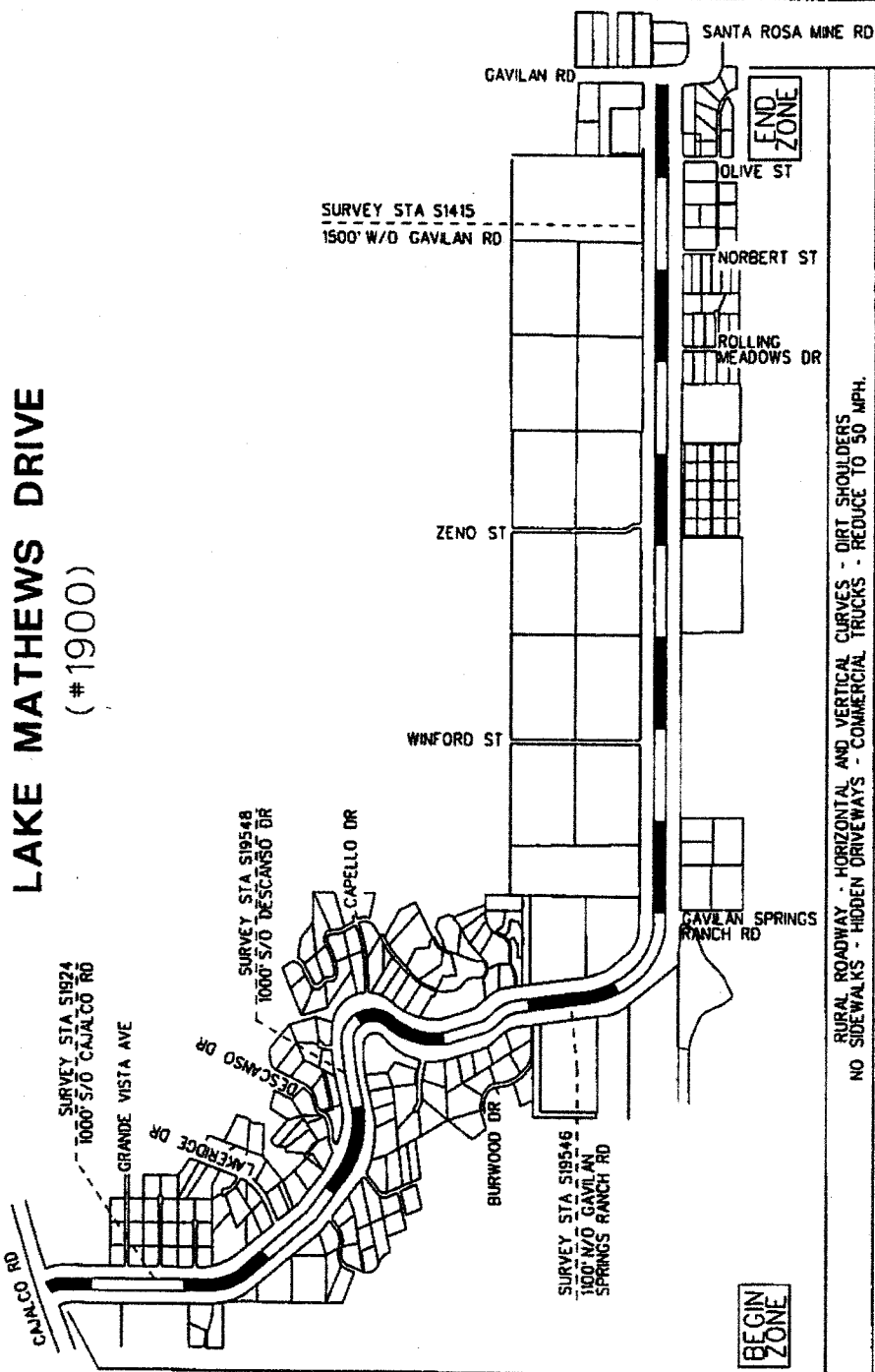

- LEGEND:
- ////// CITY LIMITS
 - ▬ RADAR ZONE
 - - - SURVEY STATION
 - ▬ OTHER STREET OR ROAD



NO SCALE

☆ RATE - $\frac{\text{NO. OF ACCIDENT} \times 1,000,000}{\text{VEH} \times 365 \times 2 \times \text{MILE}}$

RURAL ROADWAY - HORIZONTAL AND VERTICAL CURVES - DIRT SHOULDERS
NO SIDEWALKS - HIDDEN DRIVEWAYS - COMMERCIAL TRUCKS - REDUCE TO 50 MPH.

RECOMMENDED SPEED LIMIT	50 MPH
85th/TILE SPEED	56.2 MPH (AVG OF FOUR SIMILAR STATIONS OF 59 & 52 & 58 & 57 MPH)
VEHICLES IN 24 HR (2 WAY)	2375
SEGMENT LENGTH	5.11 MILE
ALL ACCIDENTS IN 2 YRS.	8
ACCIDENT RATE ☆	0.90 ACC/MVM
EXISTING SPEED LIMIT	NOT POSTED

COUNTY OF RIVERSIDE
TRANSPORTATION DEPARTMENT
TRAFFIC ENGINEERING DIVISION
ENGINEERING AND TRAFFIC SURVEY

LAKE MATHEWS DRIVE

PAGE 1 OF 1

APPROVED BY: *[Signature]* 4/19/2019
DENNIS ACUNA, P.E.
COUNTY TRAFFIC ENGINEER

SURVEY DATE:	SEP 26 2018
MAP DATE:	APR 02 2019
DRAWN BY:	J VALADEZ
CAD FILE:	LAKEMATHEWS.DGN

PAT ROAD (#1902)

- LEGEND:**
- CITY LIMITS
 - RADAR ZONE
 - SURVEY STATION
 - OTHER STREET OR ROAD
 - SCHOOL

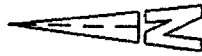
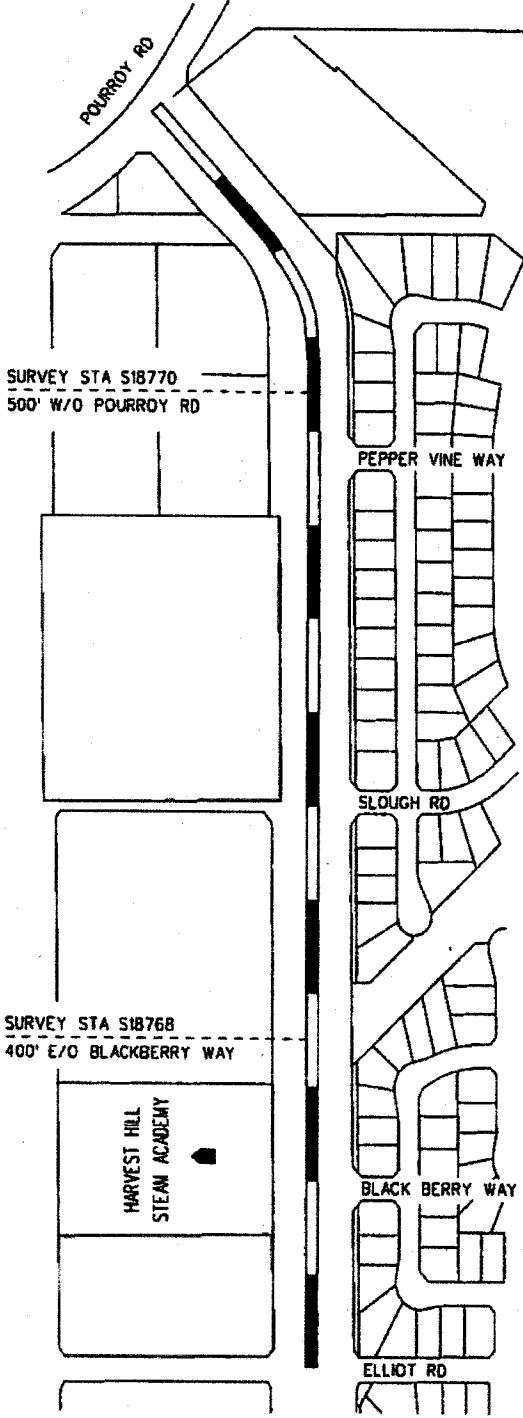

NO SCALE

★ RATE - $\frac{\text{NO. OF ACCIDENT} \times 1,000,000}{\text{VEH} \times 365 \times 2 \times \text{MILE}}$

BEGIN ZONE

END ZONE

RECOMMENDED SPEED LIMIT	35 MPH
85th/TILE SPEED	37.5 MPH (AVG OF TWO SIMILAR STATIONS OF 37 & 38 MPH)
VEHICLES IN 24 HR (2 WAY)	1250
SEGMENT LENGTH	0.57 MILE
ALL ACCIDENTS IN 2 YRS.	1
ACCIDENT RATE ★	1.92 ACC/MVM
EXISTING SPEED LIMIT	NOT POSTED

		COUNTY OF RIVERSIDE TRANSPORTATION DEPARTMENT TRAFFIC ENGINEERING DIVISION <small>ENGINEERING AND TRAFFIC SURVEY</small>		PAGE 1 OF 1
APPROVED BY:		DATE: 4/19/2019		PAT ROAD
SURVEY DATE:	OCT 16 2018			
COUNTY AREA:	WINCHESTER	MAP DATE:	APR 03 2019	
COUNTY MAP:	121E	DRAWN BY:	J VALADEZ	
SUPERVISOR DISTRICT:	3	CAD FILE:	PAT RD.DGN	

PROMONTORY PARKWAY

(#1912)

- LEGEND:
- //// CITY LIMITS
 - ▬ RADAR ZONE
 - - - SURVEY STATION
 - ▬ OTHER STREET OR ROAD

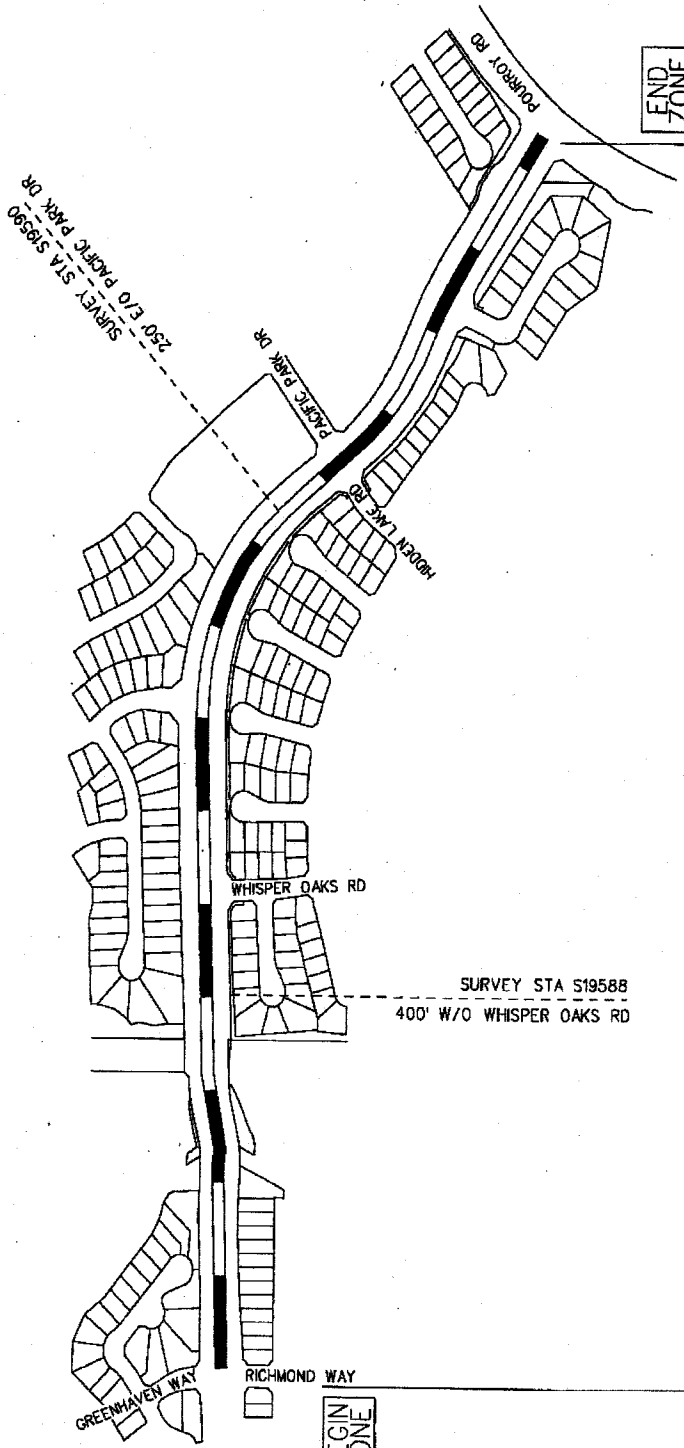

END ZONE

BEGIN ZONE

★ RATE = $\frac{\text{NO. OF ACCIDENT} \times 1,000,000}{\text{VEH} \times 365 \times 2 \times \text{MILE}}$

RECOMMENDED SPEED LIMIT	40 MPH
85th%TILE SPEED	40.5 MPH (AVERAGE OF TWO SIMILAR STATIONS OF 43 & 38 MPH)
VEHICLES IN 24 HR (2 WAY)	2400
SEGMENT LENGTH	0.80 MILE
ALL ACCIDENTS IN 2 YRS.	0
ACCIDENT RATE ★	0.00 ACC/MVM
EXISTING SPEED LIMIT	NOT POSTED

COUNTY AREA:	MURRIETA	SURVEY DATE:	MAY 22 2019
COUNTY MAP:	124C	MAP DATE:	JUL 08 2019
SUPERVISOR DISTRICT:	3	DRAWN BY:	J VALADEZ
		CAD FILE:	PROMONTORY PKWY.DGN

APPROVED BY: *[Signature]* DATE: *[Date]*

DENNIS AGUIAR, P.E., T.E.
COUNTY TRAFFIC ENGINEER

COUNTY OF RIVERSIDE
TRANSPORTATION DEPARTMENT
TRAFFIC ENGINEERING DIVISION
ENGINEERING AND TRAFFIC SURVEY

PROMONTORY PARKWAY

PAGE 1 OF 1

WHISPER HEIGHTS PARKWAY (#1906)

SURVEY STA 518776
400' W/O GROTTO
HILLS DRIVE

- LEGEND:
- ////// CITY LIMITS
 - ▬ RADAR ZONE
 - - - SURVEY STATION
 - ▬ OTHER STREET OR ROAD

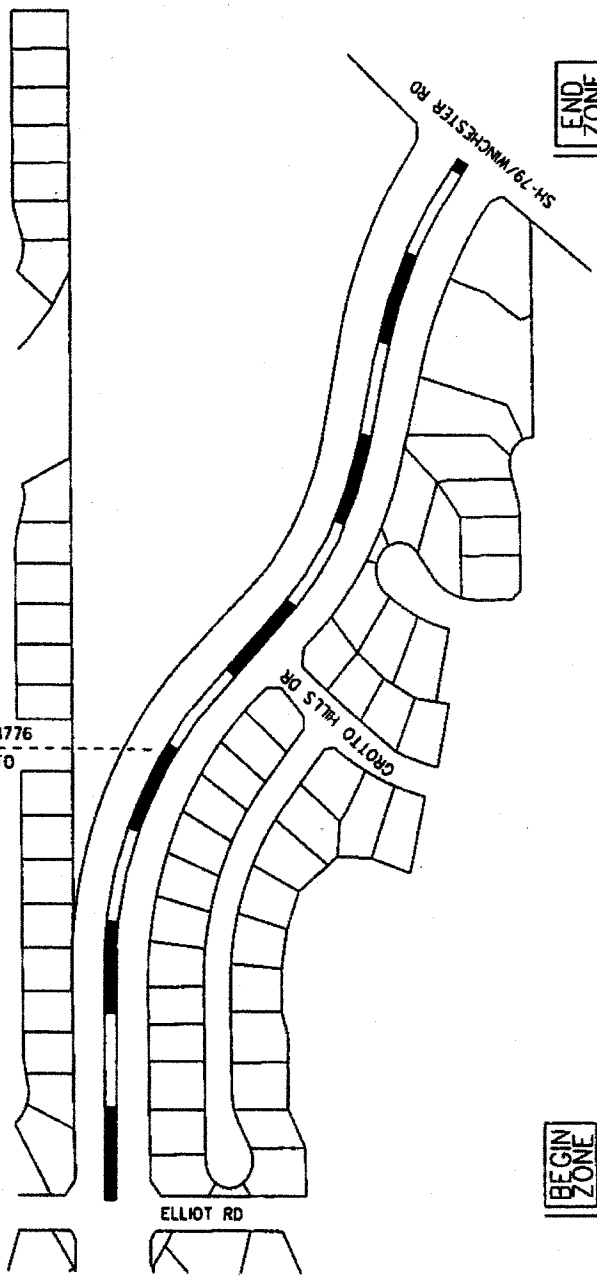



BEGIN ZONE

END ZONE

NO SCALE

★ RATE = $\frac{\text{NO. OF ACCIDENT} \times 1,000,000}{\text{VEH} \times 365 \times 2 \times \text{MILE}}$

RECOMMENDED SPEED LIMIT	40 MPH
85th/THILE SPEED	44 MPH
VEHICLES IN 24 HR (2 WAY)	750
SEGMENT LENGTH	0.40 MILE
ALL ACCIDENTS IN 2 YRS.	0
ACCIDENT RATE ★	0.00 ACC/MVM
EXISTING SPEED LIMIT	NOT POSTED

		COUNTY OF RIVERSIDE TRANSPORTATION DEPARTMENT TRAFFIC ENGINEERING DIVISION ENGINEERING AND TRAFFIC SURVEY		PAGE 1 OF 1
APPROVED BY:	 DENNIS ACUNA, P.E. COUNTY TRAFFIC ENGINEER	DATE:	4/9/2019	
SURVEY DATE:	OCT 16 2018	MAP DATE:	APR 04 2019	
COUNTY AREA:	WINCHESTER	DRAWN BY:	J VALADEZ	
COUNTY MAP:	121E	CAD FILE:	WHISPER HEIGHTS.DGN	
SUPERVISOR DISTRICT:	3			