

**SUBMITTAL TO THE BOARD OF SUPERVISORS
COUNTY OF RIVERSIDE, STATE OF CALIFORNIA**



ITEM: 3.47
(ID # 11257)

MEETING DATE:

Tuesday, December 10, 2019

FROM : TLMA-TRANSPORTATION:

SUBJECT: TRANSPORTATION AND LAND MANAGEMENT AGENCY/TRANSPORTATION
DEPARTMENT: Approval of the Integrated Mitigation Project Pre-Qualification
for General Contractors; CEQA Finding of Nothing Further is Required, District 3.
[\$0 Total Cost] (Clerk to Advertise)

RECOMMENDED MOTION: That the Board of Supervisors:

1. Find that nothing further is required pursuant to the California Environmental Quality Act (CEQA);
2. Approve and authorize the Transportation Department to issue the Pre-Qualification Package for Licensed General Contractors for the Integrated Mitigation Project; and
3. Authorize the Clerk of the Board to advertise for Pre-Qualification documents to be received by the office of the Director of Transportation and Land Management at the Transportation Annex located at 3525 14th Street, Riverside, California 92501. All submittals must be received up to the hour of 4:00 p.m., Wednesday, January 8, 2020.

ACTION:Policy

Patricia Romo, Director of Transportation 11/15/2019

MINUTES OF THE BOARD OF SUPERVISORS

On motion of Supervisor Jeffries, seconded by Supervisor Washington and duly carried by unanimous vote, IT WAS ORDERED that the above matter is approved as recommended.

Ayes: Jeffries, Spiegel, Washington, Perez and Hewitt
Nays: None
Absent: None
Date: December 10, 2019
xc: Transp.

Kecia R. Harper
Clerk of the Board
By:
Deputy

**SUBMITTAL TO THE BOARD OF SUPERVISORS COUNTY OF RIVERSIDE,
STATE OF CALIFORNIA**

FINANCIAL DATA	Current Fiscal Year:	Next Fiscal Year:	Total Cost:	Ongoing Cost
COST	\$ 0	\$ 0	\$ 0	\$ 0
NET COUNTY COST	\$ 0	\$ 0	\$ 0	\$ 0
SOURCE OF FUNDS: There are no General Funds used in this project.			Budget Adjustment: No	
			For Fiscal Year: 19/20	

C.E.O. RECOMMENDATION: Approve

BACKGROUND:

Summary

The Riverside County Transportation Department (COUNTY) is moving forward to implement off-site mitigation in accordance with the permit requirements of the State Route 79 (Winchester Road) Widening Project, Interstate 15 at Clinton Keith Road Interchange Improvements Project, Clinton Keith Road Extension Project, State Route 79 Widening, and the State Route 371 (SR-371) Shoulder Widening project.

The proposed Integrated Mitigation Project site is located south of Scott Road and west of Briggs Road. It is owned by the Western Riverside County Regional Conservation Authority (RCA) and consists of roughly 74-acres.

The contractor will implement stream and wetlands creation, riparian habitat enhancement and preservation of existing habitat for specific habitat losses due to the I-15/Clinton Keith Road Interchange, SR-79 Widening, and Clinton Keith Extension projects. The contractor will construct a new stream channel, enhance vegetated streambed and construct seasonal wetlands and maintain plant establishment for five years. The long term maintenance will be handled by RCA.

The Local Agency Public Construction Act (Public Contract Code Section 20101 et seq) allows pre-qualification of contractors for public works projects.

The Board of Supervisors had previously approved and authorized the Transportation Department to advertise and solicit pre-qualification bids at the October 25, 2016 board meeting, as Agenda Item 3-23. The contract advertisement and award process was postponed to provide for revised construction plans and specifications, which are now ready for advertisement.

It is recommended that the Board approve the pre-qualification package for general contractors. The process for selecting a pool of qualified contractors will help ensure the bids received from these entities reflect a track record of experience in wetland and streambed restoration, ecosystem enhancement and riparian mitigation.

Project No. C7-0032

Environmental Findings

**SUBMITTAL TO THE BOARD OF SUPERVISORS COUNTY OF RIVERSIDE,
STATE OF CALIFORNIA**

On October 25, 2016 (Agenda Item 3-23), the proposed integrated mitigation action was reviewed and determined by the Board of Supervisors that nothing further is required because all potentially significant effects have been fully analyzed in the earlier environmental documents for the Clinton Keith Extension Project, State Route 79 Widening Project and Interstate 15/Clinton Keith Road Interchange Project has been documented in a Notice of Determination.

Impact on Citizens and Businesses

The project will restore and enhance the RCA conservation land by improving existing conditions by:

- Reduction in downstream flooding;
- Decreasing erosion;
- Increasing soil moisture retention;
- Removing non-native plants; and
- Increasing native vegetation and habitat for dependent flora and fauna within the watershed.

These improvements will enhance water quality in the watershed and biological efficacy, and ultimately restore and protect the environment for local residents and future generations.

SUPPLEMENTAL:

Additional Fiscal Information:

N/A

Contract History and Price Reasonableness

N/A

ATTACHMENTS:

1. Vicinity Map
2. Public Notice
3. Pre- Qualification Requirements Package

Jason Farin, Senior Management Analyst

12/4/2019

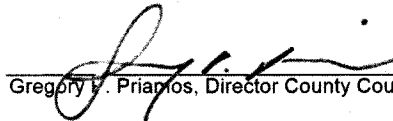
Gregory L. Priamos, Director County Counsel

11/27/2019

COUNTY OF RIVERSIDE
TRANSPORTATION DEPARTMENT

Channel Grading, Wetland Creation
and Riparian Habitat Enhancement
Integrated Mitigation Project

Located Southwest of Briggs Road and Golden Jay Lane
In the French Valley Community

Project No. C7-0032

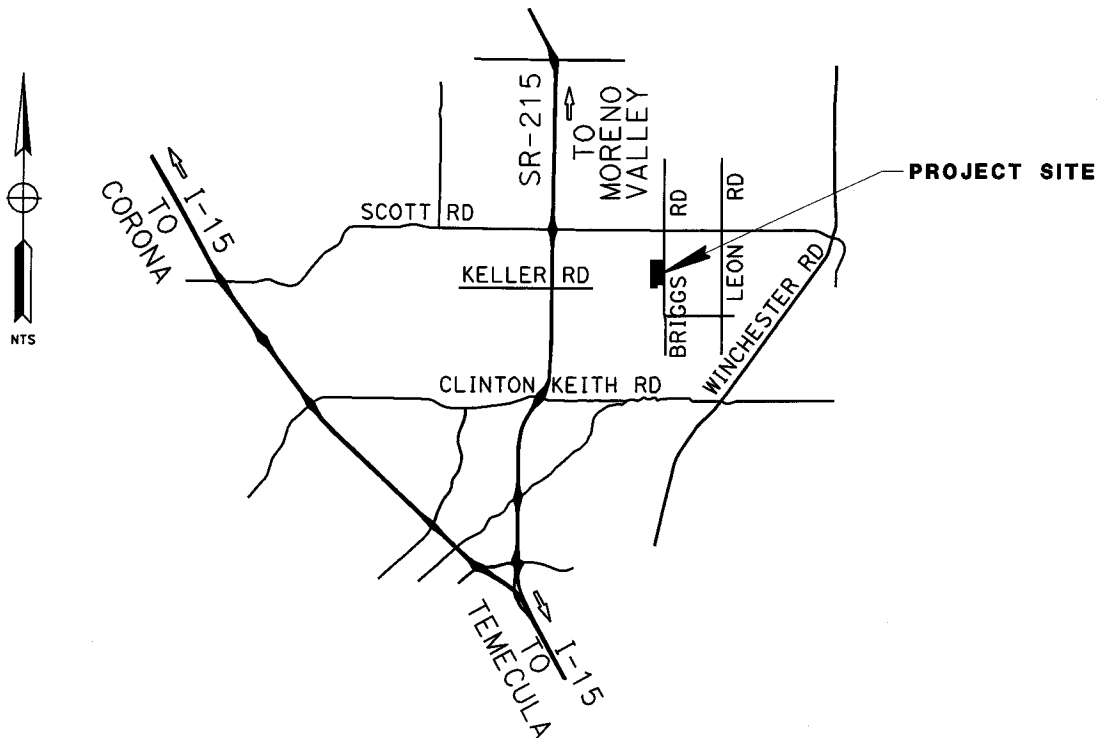
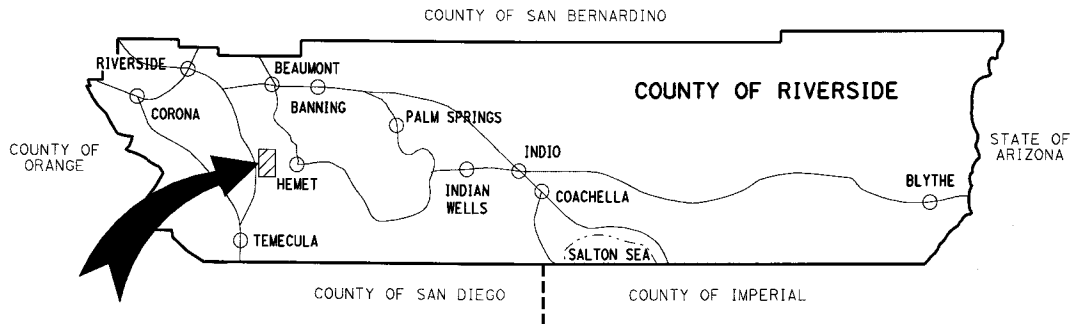

VICINITY MAP

TOWNSHIP 6S RANGE 3W SECTION 24
COUNTY ROAD BOOK PAGE No. 121A

Public Notice

The Riverside County Transportation Department is seeking pre-qualification packages from qualified contractors to construct the Integrated Mitigation Project which consists of the enhancement and creation of stream, wetland and riparian habitat.

Pre-Qualifications documents can be obtained from the County of Riverside Transportation Department web page located at the following web site address:

<https://www.rctlma.org/trans/Engineering-Services/Requests-for-Qualifications>

The closing date for submission of pre-qualifications in response to this request is **January 8, 2020 at 4:00 PM.**

THE COUNTY OF RIVERSIDE TRANSPORTATION DEPARTMENT (RCTD)
CONTRACTOR PRE-QUALIFICATION PACKAGE FOR STREAM, WETLAND,
AND RIPARIAN HABITAT CREATION/ENHANCEMENT GENERAL
ENGINEERING/LANDSCAPING CONTRACTORS
FOR THE
RIVERSIDE COUNTY TRANSPORTATION DEPARTMENT'S
INTEGRATED MITIGATION PROJECT:
CLINTON KEITH EXTENSION, STATE ROUTE 79 WIDENING,
INTERSTATE-15/CLINTON KEITH INTERCHANGE & STATE ROUTE 371
SHOULDER WIDENING PROJECTS

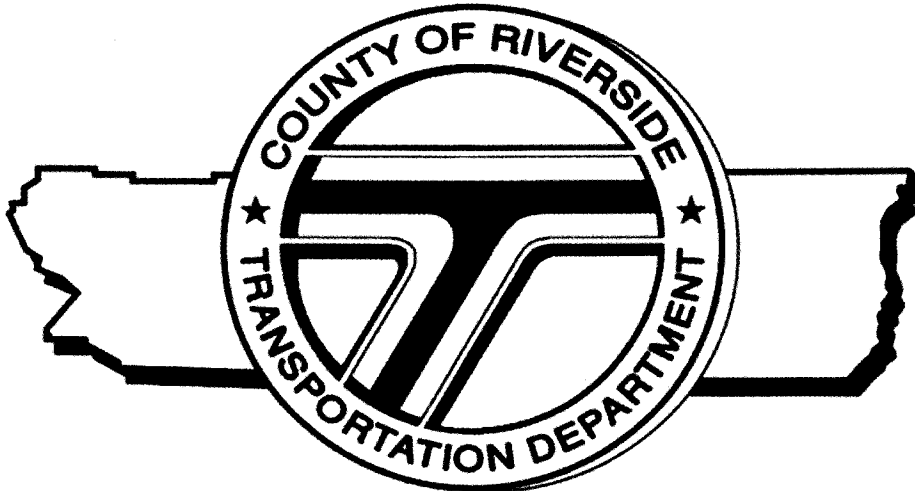

Issuer: Benjie Cho, P.E.

Senior Civil Engineer
Riverside County Transportation Department
4080 Lemon Street, 8th Floor
Riverside, CA 92501
Phone: (951) 955-6736
bcho@rivco.org

Design Team Manager: Mujahid Chandoo

Associate Engineer
Michael Baker International
14725 Alton Parkway
Irvine, CA 92618
[O] 949-855-7006
mchandoo@mbakerintl.com
www.mbakertnl.com

FORM APPROVED COUNTY COUNSEL

BY: Synthia M. Gunzel 11-27-19
SYNTHIA M. GUNZEL DATE

RIVERSIDE COUNTY TRANSPORTATION DEPARTMENT'S INTEGRATED MITIGATION PROJECT CONTRACTOR PRE-QUALIFICATION PACKAGE: CLINTON KEITH EXTENSION, STATE ROUTE 79 WIDENING, INTERSTATE 15/CLINTON KEITH INTERCHANGE, & STATE ROUTE 371 SHOULDER WIDENING PROJECTS

CONTENTS OF PRE-QUALIFICATION PACKAGE

1. General Instructions and Information
2. Project Overview
3. Evaluation Criteria
4. Application for Pre-Qualification [documents to submit]
 - A. Part I - Organization Information and Affidavit
 - B. Part II - Essential Requirements for Pre-Qualification
 - C. Part III- Organization, History, Organizational Performance, Compliance with Civil and Criminal Laws
 - D. Part IV - Organization's Statement of Experience and Recent Construction Projects Completed
 - E. Part V - Organization's Financial Statements, Surety and Bonding Requirements and
 - F. Insurance Requirements
 - G. Part VI -Attachments Required

**PRE-QUALIFICATION:
OF STREAMBED, WETLAND, AND RIPARIAN HABITAT
CREATION/ENHANCEMENT for GENERAL
ENGINEERING/LANDSCAPING CONTRACTORS**

**RIVERSIDE COUNTY TRANSPORTATION DEPARTMENT'S INTEGRATED MITIGATION
PROJECT:
CLINTON KEITH EXTENSION, STATE ROUTE 79 WIDENING
INTERSTATE-15/CLINTON KEITH INTERCHANGE and STATE ROUTE 371 SHOULDER
WIDENING PROJECTS**

Located at the Briggs Road Site (APNs: 388-270-015, 388-270-009, 388-270-010)
owned by the Western Riverside Conservation Authority (RCA), RIVERSIDE, CA

COUNTY OF RIVERSIDE TRANSPORTATION DEPARTMENT
3525 14TH STREET
RIVERSIDE, CA 92501

The following Contractor Application for Pre-Qualification (AFP) package is distributed by the County of Riverside Transportation Department (RCTD) with the intent to pre-qualify General Contractors, possessing current California contractor's license type C-27 (landscaping contractor). Additionally, in order to perform grading work, the contractor either have license type C-12 (Earthwork Contractors) or hire a subcontractor with license type C-12 (Earthwork Contractors) [the Contractors] for implementation of the public works project entitled *The Riverside County Transportation Department's Integrated Mitigation Project: for Clinton Keith Extension, State Route 79 Widening, Interstate-15/Clinton Keith Interchange & State Route 371 Shoulder Widening Project* (the Project), on a facility located at the Western Riverside County Resource Conservation Agency's (RCA) Briggs Road Site, located between Golden Jay Lane and Keller Road in Riverside, California. The key goals of the Project are the following:

1. Mitigate for habitat losses and temporary disturbances incurred by the I-15/Clinton Keith Road Interchange, SR-79 Widening, and SR-371 Shoulder Widening projects (i.e., intermittent drainage, coast live oak woodland, quino checkerspot butterfly habitat, southern willow scrub, and wetlands) through habitat preservation, restoration (re-establish), enhancement (rehabilitate), and establishment (creation);
2. Protect existing onsite habitats (e.g., southern willow scrub, Diegan coastal sage scrub, wetlands, ephemeral drainages and creek) from further deterioration due to erosion, sedimentation and non-native plant infestations; and
3. Improve onsite habitat functions and values (e.g., flood attenuation, wildlife habitat, aesthetics) within the Project area; while safeguarding that effect to aquatic and wetland resources to fully compensate for project impacts according to permit/discretionary approval obligations. The mitigation regime is designed to meet or exceed permit/ discretionary approval obligations.

In order to accomplish these goals, please see the following objectives, which detail the methods of mitigation (i.e., restored [re-established], enhanced [rehabilitated], established [created], and/or preserved) in which resource functions and values of the Project area will be improved:

❖ Preserve

- Existing southern willow scrub, Diegan coastal sage scrub, wetland, saltgrass dry meadow, ephemeral drainage and creek habitats will be maintained in their natural condition – thus reducing any further degradation and fragmentation;

Ensure suitable habitat for quino checkerspot butterfly and other special-status species that are known to occur in the region, but that are not presently known to occur at the Project site are being well maintained; and

RIVERSIDE COUNTY TRANSPORTATION DEPARTMENT'S INTEGRATED MITIGATION PROJECT CONTRACTOR PRE-QUALIFICATION PACKAGE: CLINTON KEITH EXTENSION, STATE ROUTE 79 WIDENING, INTERSTATE 15/CLINTON KEITH INTERCHANGE, & STATE ROUTE 371 SHOULDER WIDENING PROJECTS

Ensure large areas of upland habitats (i.e., Diegan coastal sage scrub), which are an important and integral part of the wetland ecosystem (e.g., precipitation buffering capacity, contributing to hydrologic inputs, and habitat for dependent species [e.g., the federally threatened Coastal California gnatcatcher (*Polioptila californica californica*)] are being preserved.

❖ Restore [Re-establish]

- Southern willow scrub and ephemeral drainages habitats that have been lost from historic agricultural activities will be replanted with native willows and other associated species. "Filled" channels will be re-contoured to re-connect lost segments of habitats which will directly improve wildlife linkages / corridors with the natural hydrology.

❖ Enhance [Rehabilitate]

- Primary disturbances will be eliminated (i.e., bare ground that may erode and non-native species), and simultaneously the natural hydrology will be restored (e.g., wetlands and drainages) to southern willow scrub, Diegan coastal sage scrub, wetlands, and creek habitats; within the Project; thus increasing the mitigation site's overall functionality and value to dependent plants and wildlife.

❖ Establish [Create]

- Intermittent channels (i.e., high flow) and seasonal wetlands will be installed at the Project site to reduce creek degradation, and improve hydrologic pathways (e.g., flood attenuation, groundwater recharge); and; Oak woodland habitats - on the appropriate landforms and soil substrates, will be installed adjacent to existing stream and riparian habitats at the Project site. This will be accomplished by relying on natural hydrology and establishing habitats that mimic the natural environmental conditions in the region. This will support long-term viability and resilience, thus increasing ecosystem services and habitat connectivity to the maximum extent practicable within this portion of the watershed.

❖ Monitor

-The restored, enhanced, established, and/or preserved habitats at the Project site will be assessed for an interim period of five years as specified within permits and approvals issued by the RCA, CDFW, USFWS, RWQCB, and USACE for the County's various transportation projects.

❖ Protect

-Onsite biological resources will be well-looked-after and cared for in perpetuity, because the Project site is RCA owned conservation land - which is protected for its' ecological importance indefinitely through the implementation of appropriate legal and physical mechanisms. Therefore, guarantees for long-term protection of the Project, financial assurances, and identification of parties responsible for specific short and long maintenance and monitoring tasks are already in place as well.

The Project will restore and enhance the lost functions of the site. Implementation is expected to improve existing conditions (functional lift) by:

- ❖ Reducing downstream flooding; Decreasing erosion;
- ❖ Increasing soil moisture retention;
- ❖ Removing non-native plants; and
- ❖ Increasing native vegetation and habitat for dependent flora and fauna within the watershed.

The overall effect will be a net increase in habitat functions and values. As such, the specific functions and values improved are listed below in alphabetical order:

- ❖ Aesthetics;
- ❖ Biological productivity;

- ❖ Chemical nutrient absorption;
- ❖ Flood water attenuation;
- ❖ Flood water retention/detention;
- ❖ Food-chain dynamics;
- ❖ Ground water recharge;
- ❖ Nutrient cycling;
- ❖ Oxygen production;
- ❖ Passive recreation (e.g., bird-watching and photography);
- ❖ Pollutant filtering by chemical nutrient absorption, and sediment control;
- ❖ Scientific studies and education activities (i.e., geological and biological values);
- ❖ Sediment-erosion control;
- ❖ Stream flow maintenance;
- ❖ Watershed integrity;
- ❖ Water quality maintenance by deterring nutrients, retaining sediments and processing organic matter; and
- ❖ Wildlife and fish habitat.

The Project will be implemented by the Contractor, in which the Contractor will accomplish the listed mitigation in the *Table 1: Summary of the Mitigation Habitats Proposed*.

The Project is funded by the County of Riverside. Your firm is invited to review the AFP and respond to all items. Your responses will enable the County to pre-select contractors to bid on the Project based on experience and qualifications. The AFP will be opened and evaluated by the County after submittal date and time noted below..

Please complete all parts of this AFP and return one (1) original with attachments in a sealed envelope marked "CONFIDENTIAL" to:

Joel Jimenez, P.E
 Senior Civil Engineer
 COUNTY OF RIVERSIDE
 14th Street Annex
 3525 14th Street
 Riverside, CA 92501

AFPs are due **Wednesday, January 8, 2020 at 4:00 P.M.** No fax or e-mail copies will be accepted. Submittals received after the specified time and date will not be considered and will be returned unopened to the sender. **THIS SUBMISSION DEADLINE WILL BE STRICTLY ENFORCED.**

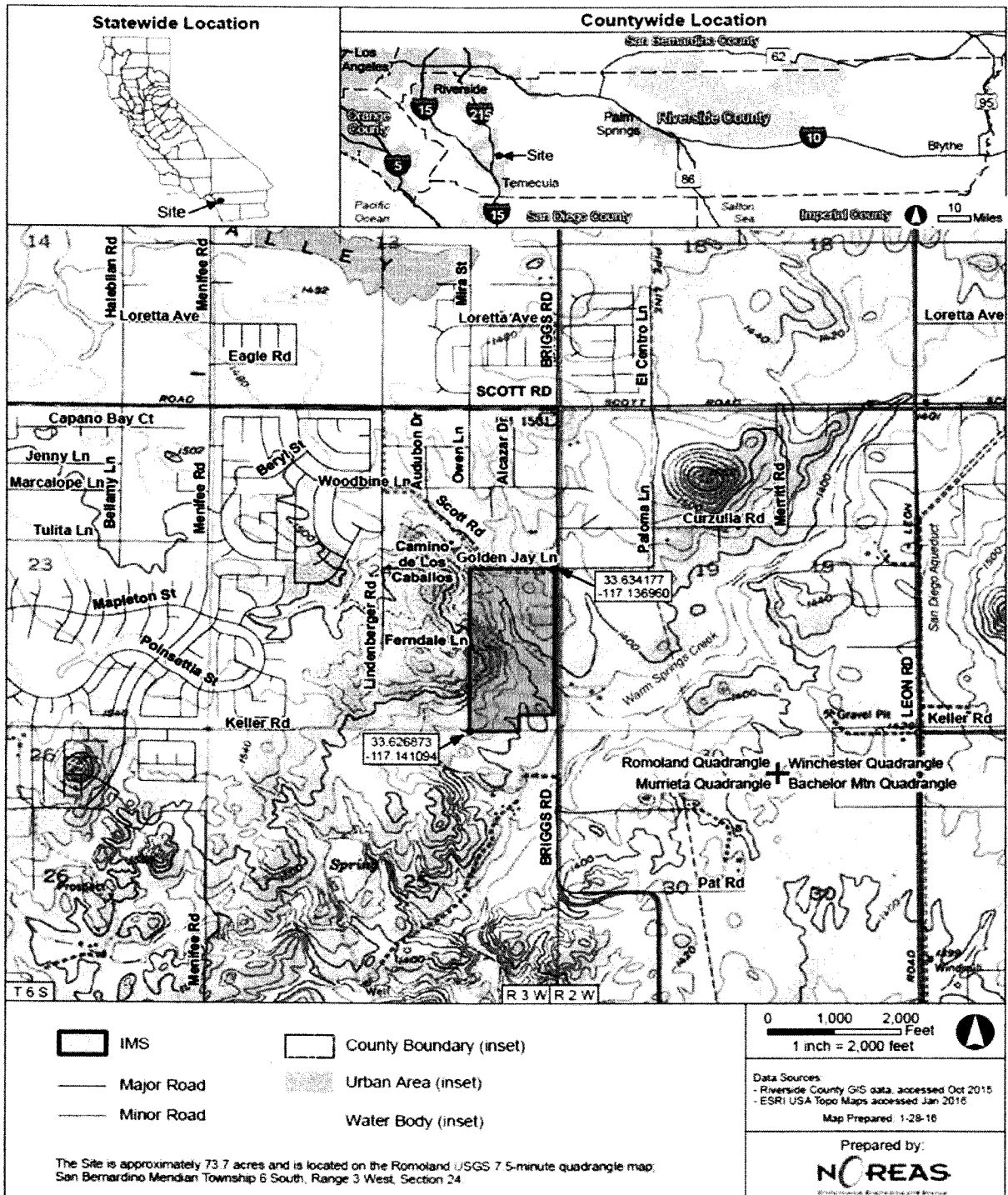

Figure 1. Regional Location

RIVERSIDE COUNTY TRANSPORTATION DEPARTMENT'S INTEGRATED MITIGATION PROJECT CONTRACTOR PRE-QUALIFICATION PACKAGE: CLINTON KEITH EXTENSION, STATE ROUTE 79 WIDENING, INTERSTATE 15/CLINTON KEITH INTERCHANGE, & STATE ROUTE 371 SHOULDER WIDENING PROJECTS

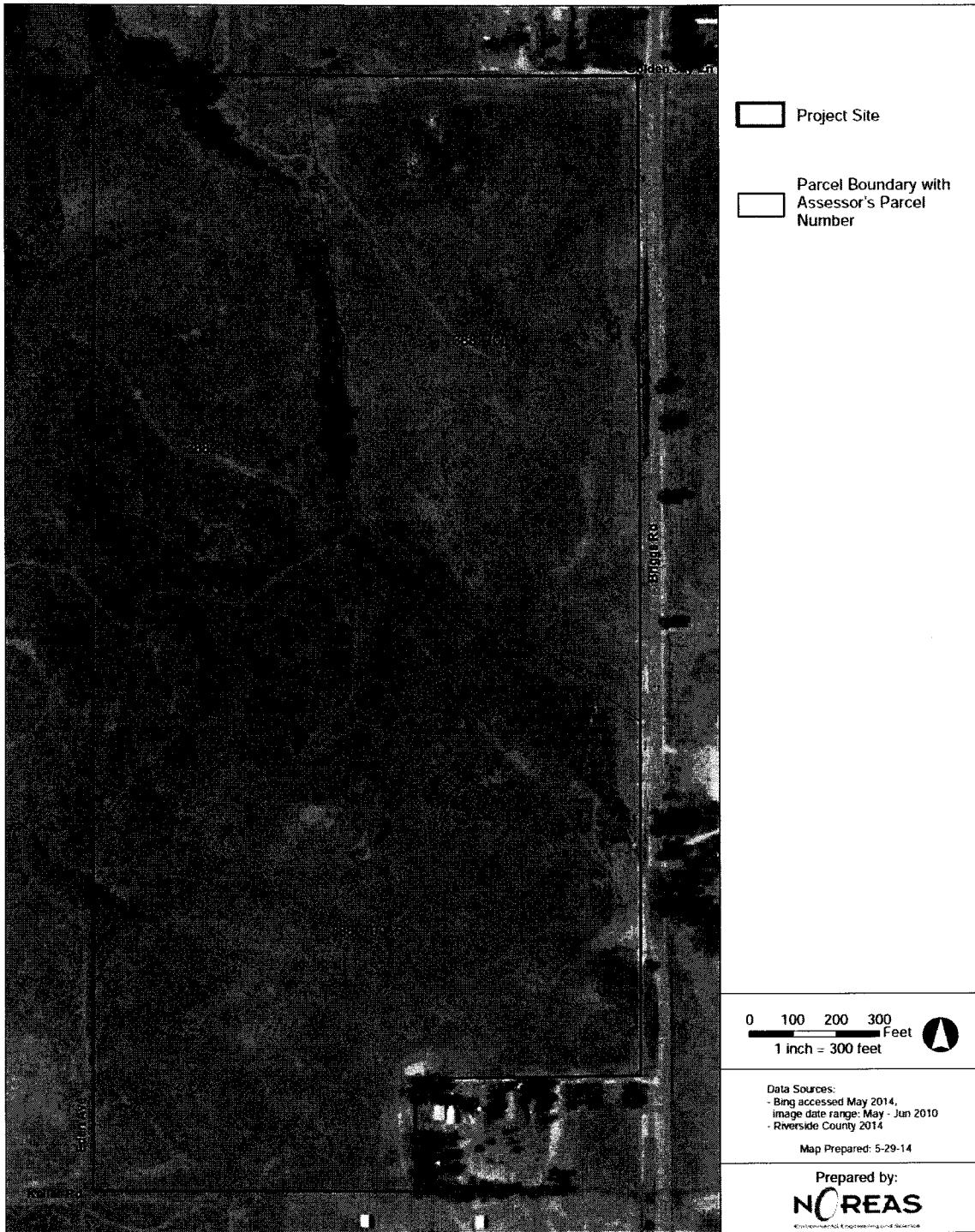

Figure 2. Parcels

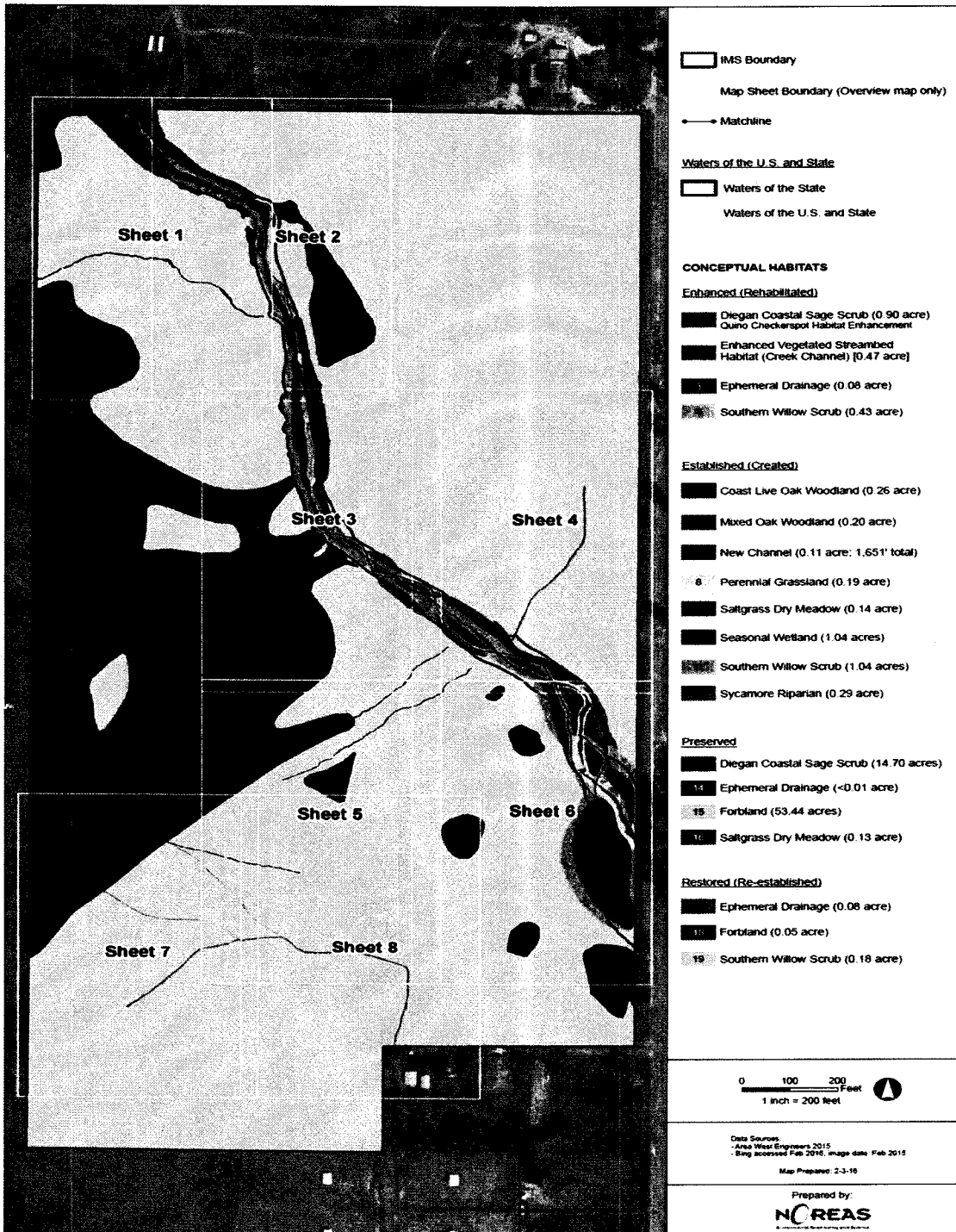

Figure 3. Proposed Conceptual

Habitat

RIVERSIDE COUNTY TRANSPORTATION DEPARTMENT'S INTEGRATED MITIGATION PROJECT CONTRACTOR PRE-QUALIFICATION PACKAGE: CLINTON KEITH EXTENSION, STATE ROUTE 79 WIDENING, INTERSTATE 15/CLINTON KEITH INTERCHANGE, & STATE ROUTE 371 SHOULDER WIDENING PROJECTS

Item	Proposed Habitat	State Route 79 Widening Project		Interstate 15/Clinton Keith Road Interchange Project		Clinton Keith Road Extension Project		State Route 371 Shoulder Widening Project		Mitigation Per Milehead Maker Inc/ Restoration Plan		As-Built	
		Neuroscience Permit Authorization No. SFL-2011-00128-SJH	Water Quality Certification No. 11C-067	Agreement Modification No. 1000-2018-0105-06	New Regulatory Nationwide Permit Authorization	Water Quality Certification No. 110C-103 WQCD-3 000002375	Agreement Modification No. 1600-2018-0115-06 Revision 1	Agreement Modification No. 1600-2018-0224-06, 16719000 3	Water Quality Certification No. WS-2014-0039	Acres	Linear Feet / # Trees	Acres	Linear Feet / # Trees
1	Advanced Orange Gumbo Limbo Scrub								0.08		0.67		
2	Advanced Oak Channel							0.07	0.67		0.48		
3	Advanced Palmwood Thicket										0.00	319	
4	Advanced Southern White Scrub								0.75		0.46		
5	Advanced Open Pine Oak Woodland										0.76	21 Trees	
6	Advanced Oak Woodland										0.78	130 Trees	
7	Advanced New Thicket	0.10 Acres/130 LU	131 LU	0.10							0.13	218 LU	
8	Advanced Wetland										0.05	1.48	
9	Advanced Submerged Dry Woodland										0.06	0.06	
10	Advanced Seasonal Wetland										0.18	0.13	
11	Advanced Southern White Scrub										0.14	1.27	
12	Advanced Open Pine										0.71	1.65	
13	Advanced Open Pine										0.31	0.31	
14	Advanced Open Pine										0.03	0.03	
15	Advanced Open Pine										0.07	218	
16	Advanced Open Pine										0.05	5194	
17	Advanced Open Pine										0.04	0.11	
18	Advanced Open Pine										0.00	0.00	717
19	Advanced Open Pine										0.00	0.00	
20	Advanced Open Pine										0.00	0.00	
21	Advanced Open Pine										0.00	0.00	

* Although the amount of habitat is calculated in acres, this category is calculated in an arbitrary high value based on the amount of habitat in each cell. The total amount of habitat is 1.13 acres of the proposed habitat.

** Linear feet of habitat is calculated in an arbitrary high value based on the amount of habitat in each cell. The total amount of habitat is 1.13 acres of the proposed habitat.

*** Linear feet of habitat is calculated in an arbitrary high value based on the amount of habitat in each cell. The total amount of habitat is 1.13 acres of the proposed habitat.

**** Linear feet of habitat is calculated in an arbitrary high value based on the amount of habitat in each cell. The total amount of habitat is 1.13 acres of the proposed habitat.

***** Linear feet of habitat is calculated in an arbitrary high value based on the amount of habitat in each cell. The total amount of habitat is 1.13 acres of the proposed habitat.

1. GENERAL INSTRUCTIONS AND INFORMATION

A. General Information

The Prime Contractor must have current California contractor's license type C-27 (Landscaping). Additionally the prime may have current California contractor's licenses types C-12 (Earthwork) or hire a subcontractor with current California Contractor's license type C-12 (Earthwork). This Pre-Qualification to bid on the Riverside County Transportation Department (RCTD) Integrated Mitigation Project: for Clinton Keith Extension, State Route 79 Widening Interstate-15/Clinton Keith Interchange, State Route 371 Shoulder Widening Project (the Project), located at Briggs Road Site, Riverside, California, is required regardless of, and in addition to, any pre-qualification for the County of Riverside (County) work which a contractor may already have on file.

Pre-Qualification by the County, for this Project, shall remain valid until the contract for construction is awarded or until responding firms are notified in writing by the County in the unexpected event that no construction contract is awarded. It is mandatory that all General Contractors (Contractors) who intend to submit a bid fully complete the pre-qualification questionnaire, provide all materials requested, and be approved by the County to be on the final Qualified Bidders List. No bid will be accepted from a Contractor that has failed to comply with these requirements. If two or more business entities submit a bid as part of a Joint Venture, or expect to submit a bid as part of a Joint Venture, each entity within the Joint Venture must be separately qualified to bid.

NOTES:

1. Each partner of joint venture proposals must individually meet the conditions of Contractor's Evaluation Form and meet the condition that neither Contractor's License has NOT been suspended, put on probation or revoked at any time in the last five (5) years.
2. Limited Liability Corporations (LLC) will be required to comply with a Guarantee of Obligations.

Answers to questions contained in the attached questionnaire, information about current bonding capacity, notarized statement from surety, and the previous fiscal year copy of a CPA reviewed or CPA audited financial statement, with accompanying notes and supplemental information, are required. The County will use these documents as the basis of rating Contractors in respect to whether a Contractor is qualified to bid on the Project.

The County reserves the right to check other sources available. The County's decision will be based on objective evaluation criteria as described in the prequalification package. The County reserves the right to adjust, increase, limit, suspend or rescind the pre-qualification rating based on subsequently learned information. Contractors, whose rating changes sufficient to disqualify them will be notified, and given an opportunity for a hearing consistent with the hearing procedures described below for appealing a prequalification rating. While it is the intent of the AFP and required documents to assist the County in determining bidder responsibility prior to bid and to aid the County in selecting the lowest responsible bidder, neither the fact of pre-qualification, nor any pre-qualification rating, will preclude the County from a post-bid consideration and determination of whether a bidder has the quality, fitness, capacity and experience to satisfactorily perform the proposed work, and has demonstrated the requisite trustworthiness to be awarded a contract pursuant to California Public Contract Code.

This Project is subject to Labor Compliance per Labor Code Section 1771.3. Contractor's on the project will be required to comply with the provisions of the California Labor Code, including, without limitation, Sections 1773.1, 1774, 1775, 1776, 1813 and 1815 of the California Labor Code and including, without limitation, the obligations to pay the general prevailing rates of wages in the locality in which the Work is to be performed and comply with Section 1777.5 of the California Labor Code governing employment of apprentices.

B. Data Required

All portions of AFP, Parts I through VI, should be completed with additional information attached if the space provided does not suffice. Failure to include the information called for may result in disqualification. It is essential that construction experience of the Contractor be demonstrated, as such experience is considered in establishing prequalification.

NOTE: The pre-qualification packages (questionnaire answers and financial statements) submitted by Contractors are not public records and are not open to public inspection. All information provided will be kept confidential to the extent permitted by law. However, the contents may be disclosed to third parties for purpose of verification, or investigation of substantial allegations, or in the appeal hearing. State law requires that the names of Contractors applying for pre-qualification status shall be public records subject to disclosure, and the first page of the questionnaire will be used for that purpose.

Each questionnaire must be signed under penalty of perjury in the manner designated at the end of the form, by an individual who has the legal authority to bind the Contractor on whose behalf that person is signing. If any information provided by a Contractor becomes inaccurate, the Contractor must immediately notify the County and provide updated accurate information in writing, under penalty of perjury. The County reserves the right to waive minor irregularities and omissions in the information contained in the AFP submitted, to make all final determinations, and to determine at any time that the pre-qualification procedures will not be applied to a specific future County project. Contractors shall submit pre-qualification packages during regular working hours on any day that the offices of the County of Riverside Transportation Department (RCTD) are open up to the **deadline of 4:00P.M., Wednesday, January 8, 2020.**

The County may refuse to grant pre-qualification where the requested information and materials are not provided by the submittal deadline. There is no appeal from a refusal for an incomplete or late application. The closing time for bids will not be changed in order to accommodate supplementation of incomplete submissions, or late submissions.

C. Current Financial Information

Contractor shall provide the previous fiscal year's copy of a CPA reviewed or CPA audited financial statement with accompanying notes and supplemental information attached. The County reserves the right to reject financial statements in which the financial condition reported is of a date 12 months or more prior to the date the AFP is due to County.

D. Affidavits

The appropriate affidavit must be completely executed or the application will be disqualified.

E. Questions

General Contractors are required to submit any questions regarding the prequalification process or the contents of the prequalification package in writing no later than **4:00 P.M., Pacific Standard Time January 2, 2020.** Questions submitted after the deadline will not be accepted or answered. Only written inquiries will be permitted. Questions must be submitted in writing, by mail or email.

RFIs should be addressed and sent to:

County of Riverside
Transportation Department
Attention: Contracts/Bidding Unit
3525 14th Street
Riverside, CA 92501

Facsimile: (951) 955-3164
Electronic mail: jjimenez@rivco.org

Only written inquiries will be responded to. Under no circumstance are any prospective general contractors or anyone receiving the prequalification package to contact, discuss with, or inquire of any County consultant, employee, or elected official on any matter relating to this solicitation process. This requirement is to ensure that the same information is communicated to all parties and that no inconsistent, incomplete, or inaccurate information is transmitted separately. County will issue an addendum providing answers/clarifications to all written questions to all parties who have officially obtained/requested the AFP from RCTD.

F. Appeal Rights

Where a timely and completed application results in a rating below that necessary to pre-qualify, a Contractor may request a hearing to appeal the decision. An appeal is begun by the Contractor delivering written notice to the County of Contractor's appeal of the decision with respect to its pre-qualification rating, no later than five business days following the date of written notification from the County that the Contractor does not meet the rating established by the County. Without a timely appeal, the Contractor waives any and all rights to challenge the decision of the County, whether by administrative process, judicial process or any other legal process or proceeding. All requests for an appeal hearing must be addressed as follows:

COUNTY OF RIVERSIDE

Attn: Joel Jimenez

"CONFIDENTIAL- Bidder Prequalification"

Project:

Request for Appeal Hearing

TIME SENSITIVE MATERIAL

14th Street Annex, 3525 14th Street, Riverside, CA 92501

If the Contractor gives the required notice of appeal and requests a hearing, the hearing shall be conducted so that it is concluded no later than ten (10) business days after the County's receipt of the notice of appeal. The hearing shall be an informal process conducted by an Appeals Panel to which the County has delegated responsibility to hear such appeals. At or prior to the hearing, the Contractor will be advised of the basis for the County's pre-qualification determination. The Contractor will be given the opportunity to present information and present reasons to refute the prequalification rating and the reasons therefore. The Contractor may be represented by a person of its choosing. The hearing shall not be conducted according to technical rules relating to evidence and witnesses applicable to judicial proceedings. Any relevant evidence, including hearsay, may be received and considered if it is the sort of evidence on which reasonable persons are accustomed to rely on in the conduct of serious business affairs. The submission of documentary evidence is encouraged. The Appeals Panel shall have the power to limit oral testimony given

at the hearing. Within five business days after the conclusion of the hearing, the Appeals Panel will render its decision. A copy of the written decision will be provided the Contractor, either by regular mail or electronic mail if requested in writing by the Contractor. The determination of the Appeals Panel shall be final and not subject to further appeal. It is the intention of the County that the date for the submission and opening of bids will not be delayed or postponed to allow for completion of an appeal process.

Note: A contractor may be found not pre-qualified for either:

- (1) Omission of requested information
- (2) Falsification of information

2. PROJECT OVERVIEW

A. Project Location and Delivery Method

The Riverside County Transportation Department (COUNTY) is proposing to implement off-site mitigation for the Clinton Keith Extension, State Route 79 Widening, Interstate 15 (I-15)/Clinton Keith Road Interchange and the SR 371 Shoulder Widening Projects. The mitigation will be implemented in accordance with the permit approvals associated with each of the above-referenced projects issued by the California Department of Fish and Wildlife (CDFW), Regional Water Quality Control Board (RWQCB), and U.S. Army Corps of Engineers (USACE).

The hired contractor will be expected to construct the Project based on engineering plans and specifications. Plans and specifications will reflect the mitigation concept outlined in the *Riverside County Transportation Department's Integrated Migration Site Final Conceptual Mitigation Design Report (February 2016)* produced by NOREAS Inc., which contains synthesized soil testing and topographic analysis, as well as the migration conceptual layout for the Clinton Keith Extension, State Route 79 Widening, and Interstate 15 (I-15)/Clinton Keith Road Interchange, and SR 371 Shoulder Widening projects on the Briggs Road Site (Figures 1 and 2).

The Site's three parcels (APN's 388270010, 388270009, and 388270015) are located in the Santa Margarita watershed and total approximately 74 acres. An unnamed tributary to Warm Springs Creek generally follows the boundaries between APN 388270010 and the other two parcels. The Site is located at elevations above mean sea level range from 1,540 ft. to 1,384 ft. A substantial wildfire occurred at the Site in 2012, which converted much of the existing Diegan coastal sage scrub and southern willow scrub habitats to disturbed annual grassland. In general, the soils within the vicinity of the Site's existing water conveyance features are sandy loams with clay loams. Loams are well-suited for riparian and wetlands restoration due to their drainage and moisture retention properties. The drainage features within the Briggs Road Site consists of narrow, deeply incised, fairly straight watercourse that generally flows during major storm events and for short durations thereafter (intermittent). Water is typically discharged from the channel during moderate to large precipitation events.

The project delivery method for Riverside County Transportation Department's Integrated Mitigation Project: for Clinton Keith Extension, State Route 79 Widening, Interstate-15/Clinton Keith Interchange, and the SR 371 Shoulder Widening Projects will be processed through a single prime contract awarded through a Lump Sum bid package. The Project is expected to bid early 2020 and the anticipated construction duration is 6 months.

B. Project Description

The Contractor will implement stream and wetlands creation, riparian habitat enhancement and preservation of existing habitat for specific habitat losses (i.e., intermittent drainage, coast live oak woodland, quino

checkerspot butterfly habitat, southern willow scrub, and wetlands) incurred by the I-15/Clinton Keith Road Interchange, SR-79 Widening, and Clinton Keith Extension projects. The contractor will construct approximately 0.10 acres (1631 linear feet) of new stream channel, enhance approximately 0.25 acres of vegetated streambed through southern willow scrub planting, and construct approximately 1 acre of seasonal wetlands in the form of creation of numerous small seasonal wetlands. The Contractor will plant several Coast Live Oaks and enhance Quino checkerspot butterfly habitat by seeding *Plantago erecta* and *Castilleja exserta* (the species' host plants) within separate patches of Diegan coastal sage scrub habitat. The Contractor will protect existing onsite habitats (e.g., southern willow scrub, Diegan coastal sage scrub, wetlands, and intermittent drainage features) from further deterioration due to erosion, sedimentation, non-native plant infestations, and unwanted access. The Contractor will be required to protect large areas of upland habitats (i.e., Diegan coastal sage scrub), which are an important and integral part of the wetland ecosystem, by buffering habitat for dependent species [e.g., the federally threatened coastal California gnatcatcher (*Polioptila californica*)] from construction effects and ensuring its preservation.

The Project will be constructed in the following stages:

1. Invasive plant removal (e.g., Tamarisk);
2. Fencing, posting, and flagging;
3. Earthwork and Grading (grubbing, excavation, stock piling, contouring, boulder collection and placement);
4. Planting and seeding;
5. Irrigation installation;
6. Erosion control installation;
7. Hydroseeding;
8. Post development monitoring and maintenance.

The Integrated Mitigation Site Final Conceptual Mitigation Design Report (July 2016) will be available to download during advertisement period from following website:

<https://www.rctlma.org/trans/Engineering-Services/Requests-for-Qualifications>

The Project will be funded by local transportation funds.

3. Evaluation Criteria

Qualifications will include:

- Evaluation and verification of General Contractor's or entity's current ability and history to secure Liability and Workers' Compensation insurance
- Evidence and history of proper licensing
- Ability to secure required bonding
- Financial ability
- History of litigation and claims; or other adverse actions
- Safety record

Experience to be evaluated will include:

- History of firm/entity

RIVERSIDE COUNTY TRANSPORTATION DEPARTMENT'S INTEGRATED MITIGATION PROJECT CONTRACTOR PRE-QUALIFICATION PACKAGE: CLINTON KEITH EXTENSION, STATE ROUTE 79 WIDENING, INTERSTATE 15/CLINTON KEITH INTERCHANGE, & STATE ROUTE 371 SHOULDER WIDENING PROJECTS

- Organization of firm/entity
- Relevant experience of firm/entity
- Proposed management team for Project and proposed key personnel
- Experience of proposed key personnel to be assigned to Project
- Firm's/entity's experience in successfully completing public works projects or other projects of similar size, scope and complexity, such that the selected contractor must have expertise in the following:
 1. Erosion Control Pre-Grading
 2. Grading & Earthwork
 3. Erosion Control-Grading
 4. Non- native plant removal, control and maintenance
 5. Upland Native Species Seeding
 6. Upland and Wetland Native Species Planting
 7. Wetland creation & enhancement and stream corridor restoration
 8. Stream & Natural Channel Construction
 9. Irrigation Installation and Maintenance
 10. Pest Management

Evaluation of Comparable Project Experience

In addition to above criteria, the Contractor shall provide information for comparable projects, as defined in this AFP.

The Contractor will submit the firm's recent (within the last 10 years) specialized experience in the successful completion of projects that are related to this AFP. The Contractor will submit Exhibit A, detailing experience and contracts that have been completed or substantially completed (at least 80%) within five (5) years of the AFP closing date. In evaluating past performance RCTD will use Exhibit B - Past Performance Questionnaires submitted for the project provided in Exhibit A. Exhibit B Forms shall be sequentially numbered to correspond to the appropriate projects submitted under Exhibit A. Firms shall complete Items 1 through 4 of Exhibit B and forward the pre-filled Exhibit B to the project reference, who will complete the client portion of Exhibit B and return it to your firm. RCTD reserves the right to contact and verify past performance information with references that have provided completed Exhibit B forms, and to use any other past performance information available on the firm. Other past performance information may be obtained from past and present customers, other agencies, current or former subcontractors that are considered relevant to this AFP.

NOTE: Scoring will be based on submitted comparable projects that meet as many of the following components as possible:

- Project Management;
- Grading and Earthwork;
- Procurement of Planting Materials;
- Erosional Control Pre-Grading;
- Nonnative Plant Removal, Control and Maintenance;
- Stream & Natural Channel Construction
- Wetland and Riparian Habitat Creation and Enhancement;
- Stream Channel Creation and Enhancement;
- Upland Native Species Seeding;
- Upland and Wetland Native Species Planting and Maintenance;

- Irrigation System Design, Installation, Operation and Maintenance;
- Upland and Wetland Native Species Seeding and Pest Management;

The contract will be awarded based on competitive bidding process among pre-qualified contractors.

Contractors will be evaluated on the quality of their past performance on the specified projects submitted in **Exhibit A (Project Data Sheet)** and associated past performance information provided in **Exhibit B (Past Performance Questionnaire)** of the AFP. The basis of evaluation will focus on the quality of each contractor's performance on contracts and/or task orders of similar size, scope, and complexity to that described in the AFP. Contractors may include projects with the Federal Government, state and local governments, and/or commercial customers. RCTD will evaluate the contractors in terms of extent of experience as well as relative size and complexity of past projects. Examples cited should demonstrate a full range of project experience with similar projects in California.

Evaluation of Financial Information

In addition to above criteria, the Contractor shall provide financial information, as defined in this AFP.

4. Application for Pre-Qualification

The specific documents that must be submitted are attached:

- Part I - Organization Information and Affidavit
- Part II - Essential Requirements for Pre-Qualification
- Part III- Organization, History, Organizational Performance, Compliance with Civil and Criminal Laws
- Part IV- Organization's Statement of Experience and Recent Construction Projects Completed
- Part V - Organization's Financial Capability, Surety and Bonding Requirements and Insurance Requirements
- Part VI - Attachments Required
- Exhibit A (Project Data Sheet)
- Exhibit B (Past Performance Questionnaire)

ATTACHMENTS

- 1- Pre-Qualification Questionnaire**
- 2. Exhibit A (Project Data Sheet)**
- 3. Exhibit B (Past Performance Questionnaire)**

PRE-QUALIFICATION QUESTIONNAIRE

PART I. ORGANIZATION INFORMATION, DECLARATION and AFFIDAVIT

The following documents, Prequalification Application, Parts I through VI, are to be filed with the County of Riverside by the Organization requesting pre-qualification, in accordance with the Public Contract Code, for the aforementioned Project:

Firm Name: _____ Check One: Corporation
(as it appears on license) Partnership
 Sole Prop.

Contact Person: _____

Address: _____

Phone: _____ Fax: _____

If firm is a sole proprietor or partnership:

Owner(s) of Company _____

California Contractor's License Number(s) with Classifications:

License #	Classification	Expiration (MM/DD/YYYY)

DECLARATION

1. Acknowledgement and Release. By signature and date on this page, the Contractor authorizes any financial institution, legal firm, or any other type of business, agency or individual named within this document to release to County and/or its designated representatives, any and all information as that information relates, or could relate, to its ability to evaluate the background, stability and general worthiness of this Contractor to perform construction activities if prequalified and awarded a contract by County. In addition, County may request information from references, provided:

- a. A photocopy of this document shall be deemed as valid as an original document.
- b. This acknowledgement and release shall remain in effect until such time as the Contractor requests, in writing, that County cease any attempt to evaluate it and its agents as a potential prequalified bidder for construction for the Project.

2. Reserved Right. County reserves the right, for the sole purpose of evaluating a potential prequalification candidate (Contractor), to make other inquiries as permitted by law. Furthermore, County reserves the right to reject any or all prequalification applications.

AFFIDAVIT

I, _____ the undersigned, certify and declare that I have read all the answers to this prequalification questionnaire and know their contents. The matters stated in the questionnaire answers are true of my own knowledge and belief, except as to those matters stated on information and belief, and as to those matters I believe them to be true. I declare under penalty of perjury under the laws of the State of California, that the foregoing is correct.

Dated _____ **Signature** _____

Printed Name _____

Title _____

PART II. ESSENTIAL REQUIREMENTS FOR PRE-QUALIFICATION

Contractor will be immediately disqualified if the answer to any of questions 1 through 5 is "no."¹

Contractor will be immediately disqualified if the answer to any of questions 6, 7, 8 or 9 is "yes."² If the answer to question 8 is "yes," and if debarment would be the sole reason for denial of pre-qualification, any pre-qualification issued will exclude the debarment period.

1. Contractor possesses a valid and current California Contractor's license for the project or projects for which it intends to submit a bid.
 Yes No
2. Contractor has a liability insurance policy with a policy limit of at least \$1,000,000 per occurrence and \$2,000,000 aggregate.
 Yes No
3. Contractor has current workers' compensation insurance policy as required by the Labor Code or is legally self-insured pursuant to Labor Code section 3700 et. seq.
 Yes No Contractor is exempt from this requirement, because it has no employees
4. Have you attached your latest copy of a reviewed or audited financial statement with accompanying notes and supplemental information.³
 Yes No

NOTE: A financial statement that is not either reviewed or audited is not acceptable. A letter verifying availability of a line of credit may also be attached; however, it will be considered as supplemental information only, and is not a substitute for the required financial statement.

5. Have you attached a notarized statement from an admitted surety insurer approved by the California Department of Insurance and authorized to issue bonds in the State of California, which states: (a) that your current bonding capacity is sufficient for the project for which you seek pre-qualification if you are seeking pre-

¹ A "no" answer to Question 4 will not be disqualifying if the contractor is exempt from complying with Question 4, for reasons explained in footnote 7.

² A contractor disqualified solely because of a "Yes" answer given to question 6, 7, or 9 may appeal the disqualification and provide an explanation of the relevant circumstances during the appeal procedure.

³ Public Contract Code section 20101(e) exempts from this requirement a contractor who has qualified as a small business pursuant to Government Code section 14837(d)(1), if the bid is "no more than 25 per cent of the qualifying amount provided in section 14837(d)(1)." As of January 1, 2001, the qualifying amount is \$10 million, and 25 per cent of that amount, therefore, is \$2.5 million.

qualification for a single project; or (if you are seeking pre-qualification valid for a year) (b) your current available bonding capacity?⁴

Yes No

NOTE: Notarized statement must be from the surety company, not an agent or broker.

6. Has your contractor's license been revoked at any time in the last five years?

Yes No

7. Has a surety firm completed a contract on your behalf, or paid for completion because your firm was default terminated by the project owner within the last five (5) years?

Yes No

8. At the time of submitting this pre-qualification form, is your firm ineligible to bid on or be awarded a public works contract, or perform as a subcontractor on a public works contract, pursuant to either Labor Code section 1777.1 or Labor Code section 1777.7?

Yes No

If the answer is "Yes," state the beginning and ending dates of the period of debarment:

9. At any time during the last five years, has your firm, or any of its owners or officers been convicted of a crime involving the awarding of a contract of a government construction project, or the bidding or performance of a government contract?

Yes No

⁴ An additional notarized statement from the surety may be requested by *Public Entity* at the time of submission of a bid, if this pre-qualification package is submitted more than 60 days prior to submission of the bid.

**PART III. ORGANIZATION, HISTORY, ORGANIZATIONAL PERFORMANCE,
COMPLIANCE WITH CIVIL AND CRIMINAL LAWS**

A. Current Organization and Structure of the Business

For Firms That Are Corporations:

- 1a. Date incorporated : _____
 1b. Under the laws of what state: _____
 1c. Provide all the following information for each person who is either (a) an officer of the corporation (president, vice president, secretary, treasurer), or (b) the owner of at least ten per cent of the corporation's stock.

Name	Position	Years with Co.	% Ownership	Social Security #

- 1d. Identify every construction firm that any person listed above has been associated with (as owner, general partner, limited partner or officer) at any time during the last five years.

NOTE: For this question, "owner" and "partner" refer to ownership of ten per cent or more of the business, or 10 per cent or more of its stock, if the business is a corporation.

Person's Name	Construction Firm	Dates of Person's Participation with Firm

For Firms That Are Partnerships:

- 1a. Date of formation: _____
 1b. Under the laws of what state: _____
 1c. Provide all the following information for each partner who owns 10 per cent or more of the firm.

Name	Position	Years with Co.	% Ownership	Social Security #

- 1d. Identify every construction company that any partner has been associated with (as owner, general partner, limited partner or officer) at any time during the last five years.

NOTE: For this question, "owner" and "partner" refer to ownership of ten per cent or more of the business, or ten per cent or more of its stock, if the business is a corporation.

Person's Name	Construction Company	Dates of Person's Participation with Company

For Firms That Are Sole Proprietorships:

- 1a. Date of commencement of business. _____
 1b. Social security number of company owner. _____
 1c. Identify every construction firm that the business owner has been associated with (as owner, general partner, limited partner or officer) at any time during the last five years.

NOTE: For this question, "owner" and "partner" refer to ownership of ten per cent or more of the business, or ten per cent or more of its stock, if the business is a corporation.

Person's Name	Construction Company	Dates of Person's Participation with Company

For Firms That Intend to Make a Bid as Part of a Joint Venture:

- 1a. Date of commencement of joint venture. _____
 1b. Provide all of the following information for each firm that is a member of the joint venture that expects to bid on one or more projects:

Name of firm	% Ownership of Joint Venture

B. History of the Business and Organizational Performance

2. Has there been any change in ownership of the firm at any time during the last three years?

NOTE: A corporation whose shares are publicly traded is not required to answer this question.

Yes No

If "yes," explain on a separate signed page.

3. Is the firm a subsidiary, parent, holding company or affiliate of another construction firm?

NOTE: Include information about other firms if one firm owns 50 per cent or more of another, or if an owner, partner, or officer of your firm holds a similar position in another firm.

Yes No

If "yes," explain on a separate signed page.

4. Are any corporate officers, partners or owners connected to any other construction firms.

NOTE: Include information about other firms if an owner, partner, or officer of your firm holds a similar position in another firm.

Yes No

If "yes," explain on a separate signed page.

5. State your firm's gross revenues for each of the last three years:

6. How many years has your organization been in business in California as a contractor under your present business name and license number? _____ years

7. Is your firm currently the debtor in a bankruptcy case?

Yes No

If "yes," please attach a copy of the bankruptcy petition, showing the case number, and the date on which the petition was filed.

8. Was your firm in bankruptcy at any time during the last five years? (This question refers only to a bankruptcy action that was not described in answer to question 7, above)

Yes No

If "yes," please attach a copy of the bankruptcy petition, showing the case number and the date on which the petition was filed, and a copy of the Bankruptcy Court's discharge order, or of any other document that ended the case, if no discharge order was issued.

Licenses

9. List all California construction license numbers, classifications and expiration dates of the California contractor licenses held by your firm:
- _____
- _____
10. If any of your firm's license(s) are held in the name of a corporation or partnership, list below the names of the qualifying individual(s) listed on the CSLB records who meet(s) the experience and examination requirements for each license.
- _____
11. Has your firm changed names or license number in the past five years?
 Yes No
If "yes," explain on a separate signed page, including the reason for the change.
12. Has any owner, partner or (for corporations:) officer of your firm operated a construction firm under any other name in the last five years?
 Yes No
If "yes," explain on a separate signed page, including the reason for the change.
13. Has any CSLB license held by your firm or its Responsible Managing Employee (RME) or Responsible Managing Officer (RMO) been suspended within the last five years?
 Yes No
If "yes," please explain on a separate signed sheet.

Disputes

14. At any time in the last five years has your firm been assessed and paid liquidated damages after completion of a project under a construction contract with either a public or private owner?
 Yes No
If yes, explain on a separate signed page, identifying all such projects by owner, owner's address, the date of completion of the project, amount of liquidated damages assessed and all other information necessary to fully explain the assessment of liquidated damages.
15. In the last five years has your firm, or any firm with which any of your company's owners, officers or partners was associated, been debarred, disqualified, removed or otherwise prevented from bidding on, or completing, any government agency or public works project for any reason?

NOTE: "Associated with" refers to another construction firm in which an owner, partner or officer of your firm held a similar position, and which is listed in response to question 1c or 1d on this form.

Yes No

If "yes," explain on a separate signed page. State whether the firm involved was the firm applying for pre-qualification here or another firm. Identify by name of the company, the name of the person within your firm who was associated with that company, the year of the event, the owner of the project, the project and the basis for the action.

16. In the last five years has your firm been denied an award of a public works contract based on a finding by a public agency that your company was not a responsible bidder?

Yes No

If "yes," explain on a separate signed page. Identify the year of the event, the owner, the project and the basis for the finding by the public agency.

* * * * *

NOTE: The following two questions refer only to disputes between your firm and the owner of a project. You need not include information about disputes between your firm and a supplier, another contractor, or subcontractor. Also, you may omit reference to all disputes about amounts of less than \$50,000.

17. In the past five years has any claim **against** your firm concerning your firm's work on a construction project been **filed in court or arbitration**?

Yes No

If "yes," on separate signed sheets of paper identify the claim(s) by providing the project name, date of the claim, name of the claimant, a brief description of the nature of the claim, the court in which the case was filed and a brief description of the status of the claim (pending or, if resolved, a brief description of the resolution).

18. In the past five years has your firm made any claim against a project owner concerning work on a project or payment for a contract and **filed that claim in court or arbitration**?

Yes No

If "yes," on separate signed sheets of paper identify the claim by providing the project name, date of the claim, name of the entity (or entities) against whom the claim was filed, a brief description of the nature of the claim, the court in which the case was filed and a brief description of the status of the claim (pending, or if resolved, a brief description of the resolution).

* * * * *

19. At any time during the past five years, has any surety company made any payments on your firm's behalf as a result of a default, to satisfy any claims

made against a performance or payment bond issued on your firm's behalf, in connection with a construction project, either public or private?

Yes No

If "yes," explain on a separate signed page the amount of each such claim, the name and telephone number of the claimant, the date of the claim, the grounds for the claim, the present status of the claim, the date of resolution of such claim if resolved, the method by which such was resolved if resolved, the nature of the resolution and the amount, if any, at which the claim was resolved.

20. In the last five years has any insurance carrier, for any form of insurance, refused to renew the insurance policy for your firm?

Yes No

If "yes," explain on a separate signed page. Name the insurance carrier, the form of insurance and the year of the refusal.

Criminal Matters and Related Civil Suits

21. Has your firm or any of its owners, officers or partners ever been found liable in a civil suit or found guilty in a criminal action for making any false claim or material misrepresentation to any public agency or entity?

Yes No

If "yes," explain on a separate signed page, including identifying who was involved, the name of the public agency, the date of the investigation and the grounds for the finding.

22. Has your firm or any of its owners, officers or partners ever been convicted of a crime involving any federal, state, or local law related to construction?

Yes No

If "yes," explain on a separate signed page, including identifying who was involved, the name of the public agency, the date of the conviction and the grounds for the conviction.

23. Has your firm or any of its owners, officers or partners ever been convicted of a federal or state crime of fraud, theft, or any other act of dishonesty?

Yes No

If "yes," identify on a separate signed page the person or persons convicted, the court (the county if a state court, the district or location of the federal court), the year and the criminal conduct.

Bonding

24. Bonding capacity: Provide documentation from your surety identifying the following:

Name of bonding company/surety: _____

Name of surety agent, address and telephone number:

25. If your firm was required to pay a premium of more than one per cent for a performance and payment bond on any project(s) on which your firm worked at any time during the last three years, state the percentage that your firm was required to pay. You may provide an explanation for a percentage rate higher than one per cent, if you wish to do so.

26. List all other sureties (name and full address) that have written bonds for your firm during the last five years, including the dates during which each wrote the bonds:

27. During the last five years, has your firm ever been denied bond coverage by a surety company, or has there ever been a period of time when your firm had no surety bond in place during a public construction project when one was required?

Yes No

If yes, provide details on a separate signed sheet indicating the date when your firm was denied coverage and the name of the company or companies which denied coverage; and the period during which you had no surety bond in place.

C. Compliance with Occupational Safety and Health Laws and with Other Labor Legislation Safety

28. Has CAL OSHA cited and assessed penalties against your firm for any "serious," "willful" or "repeat" violations of its safety or health regulations in the past five years?

NOTE: If you have filed an appeal of a citation, and the Occupational Safety and Health Appeals Board has not yet ruled on your appeal, you need not include information about it.

Yes No

If "yes," attached a separate signed page describing the citations, including information about the dates of the citations, the nature of the violation, the project on which the citation(s) was or were issued, the amount of penalty paid, if any. If the citation was appealed to the Occupational Safety and Health Appeals Board and a decision has been issued, state the case number and the date of the decision.

29. Has the federal Occupational Safety and Health Administration cited and assessed penalties against your firm in the past five years?

NOTE: If you have filed an appeal of a citation and the Appeals Board has not yet ruled on your appeal, or if there is a court appeal pending, you need not include information about the citation.

Yes No

If "yes," attach a separate signed page describing each citation.

30. Has the EPA or any Air Quality Management District or any Regional Water Quality Control Board cited and assessed penalties against either your firm or the owner of a project on which your firm was the contractor, in the past five years?

NOTE: If you have filed an appeal of a citation and the Appeals Board has not yet ruled on your appeal, or if there is a court appeal pending, you need not include information about the citation.

Yes No

If "yes," attach a separate signed page describing each citation.

31. How often do you require documented safety meetings to be held for construction employees and field supervisors during the course of a project?

32. List your firm's Experience Modification Rate (EMR) (California workers' compensation insurance) for each of the past three premium years:

NOTE: An Experience Modification Rate is issued to your firm annually by your workers' compensation insurance carrier.

Current year: _____

Previous year: _____

Year prior to previous year: _____

If your EMR for any of these three years is or was 1.00 or higher you may, if you wish, attach a letter of explanation.

33. Within the last five years has there ever been a period when your firm had employees but was without workers' compensation insurance or state-approved self-insurance?

Yes No

If "yes," please explain the reason for the absence of workers' compensation insurance on a separate signed page. If "No," please provide a statement by your current workers' compensation insurance carrier that verifies periods of workers' compensation insurance coverage for the last five years. (If your firm has been in the construction business for less than five years, provide a statement by your workers' compensation insurance carrier verifying continuous workers' compensation insurance coverage for the period that your firm has been in the construction business.)

Prevailing Wage and Apprenticeship Compliance Record

34. Has there been more than one occasion during the last five years in which your firm was required to pay either back wages or penalties for your own firm's failure to comply with the **state's** prevailing wage laws?

NOTE: This question refers only to your own firm's violation of prevailing wage laws, not to violations of the prevailing wage laws by a subcontractor.

Yes No

If "yes," attach a separate signed page or pages, describing the nature of each violation, identifying the name of the project, the date of its completion, the public agency for which it was constructed; the number of employees who were initially underpaid and the amount of back wages and penalties that you were required to pay.

35. During the last five years, has there been more than one occasion in which your own firm has been penalized or required to pay back wages for failure to comply with the **federal** Davis-Bacon prevailing wage requirements?

Yes No

If "yes," attach a separate signed page or pages describing the nature of the violation, identifying the name of the project, the date of its completion, the public agency for which it was constructed; the number of employees who were initially underpaid, the amount of back wages you were required to pay along with the amount of any penalty paid.

36. Provide the **name, address and telephone number** of the apprenticeship program (approved by the California Apprenticeship Council) from whom you intend to request the dispatch of apprentices to your company for use on any public work project for which you are awarded a contract by *[Public Entity]*.

37. If your firm operates its own State-approved apprenticeship program:
- (a) Identify the craft or crafts in which your firm provided apprenticeship training in the past year.
 - (b) State the year in which each such apprenticeship program was approved, and attach evidence of the most recent California Apprenticeship Council approval(s) of your apprenticeship program(s).
 - (c) State the number of individuals who were employed by your firm as apprentices at any time during the past three years in each apprenticeship and the number of persons who, during the past three years, completed apprenticeships in each craft while employed by your firm.
-

38. At any time during the last five years, has your firm been found to have violated any provision of California apprenticeship laws or regulations, or the laws pertaining to use of apprentices on public works?

NOTE: You may omit reference to any incident that occurred prior to January 1, 1998, if the violation was by a subcontractor and your firm, as general contractor on a project, had no knowledge of the subcontractor's violation at the time they occurred.

Yes No

If "yes," provide the date(s) of such findings, and attach copies of the Department's final decision(s).

PART IV. RECENT CONSTRUCTION PROJECTS COMPLETED

39. Contractor shall provide information about its four most recently completed wetlands or streambed restoration projects, as well as landscape restoration/earthwork works projects. Demonstration of both public and private projects within the last three years is preferred.⁵ Names and references must be current and verifiable. Use separate sheets of paper that contain all of the following information:

Project Name: _____

Location: _____

Owner: _____

Owner Contact (name and current phone number):

Architect or Engineer: _____

Architect or Engineer Contact (name and current phone number):

Construction Manager (name and current phone number):

Description of Project, Scope of Work Performed:

Total Value of Construction (including change orders): _____

Original Scheduled Completion Date: _____

Time Extensions Granted (number of days): _____

Actual Date of Completion: _____

⁵ If you wish, you may, using the same format, also provide information about other projects that you have completed that are similar to the project(s) for which you expect to bid.

* * * * *

I, the undersigned, certify and declare that I have read all the foregoing answers to this prequalification questionnaire and know their contents. The matters stated in the questionnaire answers are true of my own knowledge and belief, except as to those matters stated on information and belief, and as to those matters I believe them to be true. I declare under penalty of perjury under the laws of the State of California, that the foregoing is correct.

Dated:

(Name)

PART V. ORGANIZATION'S FINANCIAL STATEMENT

Name of Organization (Name must correspond exactly with Contractor's License)

Surety and Bonding Requirements

- A. Attach a notarized statement from the bonding company your firm proposes to use indicating their commitment to provide a 2% Performance and Payment Bond up to at least \$500,000.00 dollars.
- B. List the names of the Bonding firms utilized by your organization in the last five (5) years, for projects \$ 500,000.00 and above.

Name of Bonding Company No. 1 _____
Address: _____

Contact Name: _____ Telephone: _____ Fax: _____

Project Name: _____
Amount Bonded: _____ % Completed _____

Project Name: _____
Amount Bonded: _____ % Completed _____

Project Name: _____
Amount Bonded: _____ % Completed _____

Name of Bonding Company No. 2 _____
Address: _____

Contact Name: _____ Telephone: _____ Fax: _____

Project Name: _____
Amount Bonded: _____ % Completed _____

Project Name: _____
Amount Bonded: _____ % Completed _____

Project Name: _____
Amount Bonded: _____ % Completed _____

Name of Bonding Company No. 3 _____
Address: _____

Contact Name: _____ Telephone: _____ Fax: _____

Project Name: _____
Amount Bonded: _____ % Completed _____

Project Name: _____
Amount Bonded: _____ % Completed _____

PART V. ORGANIZATION'S FINANCIAL STATEMENT

Name of Organization (Name must correspond exactly with Contractor's License)

Insurance Requirements

Each policy of insurance carried by the successful bidder for this project shall be issued by an insurance company licensed to do business in the State of California with a rating of "A" or better and a financial size category of "VIII" or better according to the latest edition of "Bests".

- A. Attach a notarized statement from the Worker's Compensation carrier specifying organization's current Experience Modification rating for Worker's Compensation in the State of California and Occupational Safety and Health Administration 300 Forms for the last 3 years.

- B. List the names of the insurance firms utilized by your organization in the last five (5) years, for projects over \$ 500,000.00.

- C. Within 15 days of receipt of a contract award, furnish a current copy of Consultant's Certificate of Insurance verifying the following specified coverage: Workers' Compensation insurance as required by the Labor Code of the State of California; Comprehensive General Liability (\$2,000,000.00) combined single limit per occurrence for bodily injury, personal injury and property damage; Automobile Liability (\$2,000,000.00) combined single limit per accident for bodily injury and property damage; and Workers' Compensation and Employers Liability (\$1,000,000.00) per accident.

Name of Insurance Company No. 1 _____

Address: _____

Contact Name: _____ Telephone: _____ Fax: _____

Rating: _____

Name of Insurance Company No. 2 _____

Address: _____

Contact Name: _____ Telephone: _____ Fax: _____

Rating: _____

Name of Insurance Company No. 3 _____

Address: _____

Contact Name: _____ Telephone: _____ Fax: _____

Rating: _____

PART VI. ATTACHMENTS REQUIRED

Name of Organization (Name must correspond exactly with Contractor's License)

The following documents, Attachments 1 through 6, are to be filed with the County of Riverside by the Organization requesting Prequalification, in accordance with the Public Contract Code, for the aforementioned project.

Failure to provide all these attachments will be cause for disqualification for this project.

- **Exhibit A** -- Project Data Sheet
- **Exhibit B** -- Past Performance Questionnaire
- **Attachment 1** – Notarized Statement from Bonding Company
- **Attachment 2** – Notarized Statement from Worker's Compensation Insurance Carrier
- **Attachment 3**– Current Copy of Organization's California Contractor's License(s)
- **Attachment 4** – Certification declaring that the applying Organization has not had a surety company finish work on any project within the last **five (5) years**.
- **Attachment 5** – Certification declaring that the applying Organization, in the last **five (5) years** has not been found by a judge, arbitrator, jury, or a nolo contendere plea to have submitted a false or fraudulent claim to a public agency
- **Attachment 6** – Certification declaring that the applying Organization has not been disqualified, removed, or otherwise prevented from bidding on, or completing a federal, state, or local government project because of violations of law or a safety regulation, pursuant to Public Contract Code, Section 10162

Exhibit A PROJECT DATA SHEET

Exhibit B PAST PERFORMANCE QUESTIONNAIRE

Attachment 1 – Notarized Statement from the Bonding Company

Exchange this page for a notarized statement from the bonding company that your organization proposes to use, indicating their commitment to provide Performance and Payment bonds for the full amount of the contract.

Attachment 2 – Notarized Statement from the Worker's Compensation Carrier

Exchange this page for a notarized statement from the Worker's Compensation carrier that your organization proposes to use, specifying Subcontractor's current Experience Modification Rating for Workers' Compensation for the State of California.

Attachment 3 – Current Copy Organization's California Contractor's License(s)

Exchange this page for a current copy of your organization's California Contractor's License(s).

Attachment 4 – Certification Declaring Applying Organization Has Not Had Surety Finish Work on any Project within last Five Years

Certification declaring that the applying Organization has not had a surety company finish work on any project within the last five (5) years.

(Sample)

(Declaration)

_____ authorized agent of _____
(Name of Organization)

hereby certify, under penalty of perjury under the laws of the State of California, that the organization has not had surety company finish work on any project within the last five (5) years.

Signed: _____

Dated: _____

Attachment 5 – False or Fraudulent Claim

Certification declaring that the applying Organization, in the last five (5) years has not been found by a judge, arbitrator, jury, or a nolo contendere plea to have submitted a false or fraudulent claim to a public agency.

*(Sample
Declaration)*

_____ authorized agent of _____
(Name of Organization)

hereby certify, under penalty of perjury under the laws of the State of California, that the foregoing is true and correct. In the last five (5) years that the organization, any affiliate, parent or subsidiary company has not been found by a judge, arbitrator, jury, or nolo contendere plea to have submitted a false or fraudulent claim to a public agency.

Signed: _____

Dated: _____

Attachment 6 – Disqualification or Removal

Certification declaring that the applying Organization has not been disqualified, removed, or otherwise prevented from bidding on, or completing a federal, state, or local government project because of violations of law or a safety regulation, pursuant to Public Contract Code, Section 10162.

*Sample
Declaration*

----- authorized agent of
(Name of Organization)

I hereby certify, under penalty of perjury under the laws of the State of California, that the organization has not been disqualified, removed, or otherwise prevented from bidding on, or completing a federal, state or local government project because of violations of law or a safety regulation, pursuant to State of California, Public Contract Code, Section 10162.

EXHIBIT A
PROJECT DATA SHEET (Page 1 of 2)

Project # _____

Identify the contractor's Past Performance and Specialized Experience with respect to this solicitation. Include Government and/or commercial projects.

Contract/Project Number/Task Order Number/Contract Title/Location (Government or Commercial):

Actual Completion Date or Projected Completion Date (if at least 80% physically complete) (Date shall include Month and Year): _____

Were you the Prime Contractor _____ or Sub Contractor _____

Award Date (Mo & Yr) _____ Original Completion Date (Mo & Yr) _____

Award Amount: \$ _____ Final Contract Price: _____

Firm that accomplished this work:

Firm's Name: _____

Point of Contact (POC): _____

Address: _____

City/State _____

Phone Number: _____

Fax Number: _____

E-mail Address: _____

If subcontractor, list prime contractor

Firm's Name: _____

Point of Contact (POC): _____

Address: _____

City/State _____

Phone Number: _____

Fax Number: _____

E-mail Address: _____

Customer Name: _____

Point of Contact #1: _____

Phone Number: _____

Fax Number: _____

E-mail Address: _____

Point of Contact #2: _____

Phone Number: _____

Fax Number: _____

E-mail Address: _____

Project description, relevancy of work performed by your firm and how it demonstrates the quality of work as it relates to this solicitation. Include type of contract (e.g., fixed price, cost, etc.) Identify any value added services.

EXHIBIT A
PROJECT DATA SHEET (Page 2 of 2)

Continuation sheet

Contract/Project Number/Contract Title/Location: _____

Firm's Name: _____

Project Description Continued:

Problems encountered and corrective action taken:

Industry Awards/Special Recognition Received for project listed.

EXHIBIT B

PAST PERFORMANCE QUESTIONNAIRE

CONTRACT INFORMATION

1. Contractor Information:

Firm Name:

Address:

Phone Number:

Point of Contact:

Contact Phone Number:

2. Work Performed as: Prime Contractor Sub Contractor Joint Venture Other (Explain)

Percent of project work performed:

If subcontractor, who was prime (Name/Phone #):

3. Contract Information

Contract Number:

Delivery/Task Order Number (if applicable):

Title:

Location:

Award Date (mm/dd/yy):

Completion Date (mm/dd/yy):

Award Amount:

Final Price:

4. Project Description:

CLIENT INFORMATION

5. Client Information

Name:

Title:

Phone Number:

Email Address:

6. Describe the client's role in the project:

7. Date Questionnaire was completed:

8. contractor's Signature:



OFFICE OF THE
CLERK OF THE BOARD OF SUPERVISORS
1st FLOOR, COUNTY ADMINISTRATIVE CENTER
P.O. BOX 1147, 4080 LEMON STREET
RIVERSIDE, CA 92502-1147
PHONE: (951) 955-1060 FAX: (951) 955-1071

KECIA R. HARPER
Clerk of the Board of Supervisors

KIMBERLY A. RECTOR
Assistant Clerk of the Board

December 16, 2019

THE PRESS ENTERPRISE
ATTN: LEGALS
PO BOX 792
RIVERSIDE, CA 92501

TEL: (951) 368-9268
E-MAIL: legals@pe.com

RE: NOTICE INVITING PRE-QUALIFICATION DOCUMENTS

To Whom It May Concern:

Attached is a copy for publication in your newspaper for **TEN (10) TIMES:**

Monday	- December 23, 2019	Saturday	-December 28, 2019
Tuesday	- December 24, 2019	Sunday	-December 29, 2019
Wednesday	- December 25, 2019	Monday	-December 30, 2019
Thursday	- December 26, 2019	Tuesday	-December 31, 2019
Friday	- December 27, 2019	Wednesday	-January 1, 2019

We require your affidavit of publication immediately upon completion of the last publication.

Your invoice must be submitted to this office, WITH TWO CLIPPINGS OF THE PUBLICATION.

NOTE: PLEASE COMPOSE THIS PUBLICATION INTO A SINGLE COLUMN FORMAT.

Thank you in advance for your assistance and expertise.

Sincerely,

Karen Barton

Deputy Clerk of the Board to:
KECIA R. HARPER, CLERK OF THE BOARD

Public Notice

The Riverside County Transportation Department is seeking pre-qualification packages from qualified contractors to construct the Integrated Mitigation Project which consists of the enhancement and creation of stream, wetland and riparian habitat.

Pre-Qualifications documents can be obtained from the County of Riverside Transportation Department web page located at the following web site address:

<https://www.rctlma.org/trans/Engineering-Services/Requests-for-Qualifications>

The closing date for submission of pre-qualifications in response to this request is **January 8, 2020 at 4:00 PM.**

Alternative formats available upon request to individuals with disabilities.

Dated: December 16, 2019 KECIA R. HARPER
Clerk of the Board of Supervisors
By: Karen Barton, Deputy Clerk of the Board



CALL (951) 368-9222
EMAIL legal@pe.com

THE PRESS-ENTERPRISE

DATE	ORDER NUMBER	PONumber	PRODUCT	SIZE	Amount
12/23/19	0011346530		PE Riverside	4 x 25 Li	130.00
12/24/19	0011346530		PE Riverside	4 x 25 Li	120.00
12/25/19	0011346530		PE Riverside	4 x 25 Li	120.00
12/26/19	0011346530		PE Riverside	4 x 25 Li	120.00
12/27/19	0011346530		PE Riverside	4 x 25 Li	120.00
12/28/19	0011346530		PE Riverside	4 x 25 Li	120.00
12/29/19	0011346530		PE Riverside	4 x 25 Li	120.00
12/30/19	0011346530		PE Riverside	4 x 25 Li	120.00
12/31/19	0011346530		PE Riverside	4 x 25 Li	120.00
1/1/20	0011346530		PE Riverside	4 x 25 Li	120.00

Invoice text: Pre-Qualification list

*Transp.
12/10/19 3.47*

Placed by: Karen Lynn Barton

Legal Advertising Memo Invoice

BALANCE DUE

1,210.00

SALES/CONTACT INFORMATION	ADVERTISER INFORMATION			
Nick Eller 951-368-9229	BILLING DATE	BILLED ACCOUNT NUMBER	ADVERTISER/CLIENT NUMBER	ADVERTISER/CLIENT NAME
	01/01/2020	5209148	5209148	BOARD OF SUPERVISORS

PLEASE DETACH AND RETURN THIS PORTION WITH YOUR REMITTANCE



THE PRESS-ENTERPRISE

Legal Advertising Memo Invoice

ADVERTISER/CLIENT NAME		
BOARD OF SUPERVISORS		
BILLING DATE	BILLED ACCOUNT NUMBER	ADVERTISER/CLIENT NUMBER
01/01/2020	5209148	5209148
BALANCE DUE	ORDER NUMBER	TERMS OF PAYMENT
1,210.00	0011346530	DUE UPON RECEIPT

BILLING ACCOUNT NAME AND ADDRESS

REMITTANCE ADDRESS

BOARD OF SUPERVISORS
COUNTY OF RIVERSIDE
'PO BOX 1147'
RIVERSIDE, CA 92502

CALIFORNIA NEWSPAPER PARTNERSHIP
dba The Press-Enterprise
PO Box 65210
Colorado Springs, CO 80962-5210

THE PRESS-ENTERPRISE

1825 Chicago Ave, Suite 100
Riverside, CA 92507
951-684-1200
951-368-9018 FAX

PROOF OF PUBLICATION (2010, 2015.5 C.C.P)

Publication(s): The Press-Enterprise

PROOF OF PUBLICATION OF

Ad Desc.: Pre-Qualification list /

I am a citizen of the United States. I am over the age of eighteen years and not a party to or interested in the above entitled matter. I am an authorized representative of THE PRESS-ENTERPRISE, a newspaper in general circulation, printed and published daily in the County of Riverside, and which newspaper has been adjudicated a newspaper of general circulation by the Superior Court of the County of Riverside, State of California, under date of April 25, 1952, Case Number 54446, under date of March 29, 1957, Case Number 65673, under date of August 25, 1995, Case Number 267864, and under date of September 16, 2013, Case Number RIC 1309013; that the notice, of which the annexed is a printed copy, has been published in said newspaper in accordance with the instructions of the person(s) requesting publication, and not in any supplement thereof on the following dates, to wit:

**12/23, 12/24, 12/25, 12/26, 12/27, 12/28, 12/29, 12/30, 12/31,
01/01/2020**

I certify (or declare) under penalty of perjury that the foregoing is true and correct.

Date: January 01, 2020
At: Riverside, California



Legal Advertising Representative, The Press-Enterprise

BOARD OF SUPERVISORS
COUNTY OF RIVERSIDE
PO BOX 1147
RIVERSIDE, CA 92502

Ad Number: 0011346530-01

P.O. Number:

Ad Copy:

Public Notice

The Riverside County Transportation Department is seeking pre-qualification packages from qualified contractors to construct the Integrated Mitigation Project which consists of the enhancement and creation of stream, wetland and riparian habitat.

Pre-Qualifications documents can be obtained from the County of Riverside Transportation Department web page located at the following web site address:

<https://www.rctlma.org/trans/Engineering-Services/Requests-for-Qualifications>

The closing date for submission of pre-qualifications in response to this request is **January 8, 2020 at 4:00 PM.**

Alternative formats available upon request to individuals with disabilities.

Dated: December 16, 2019

KECIA R. HARPER
Clerk of the Board of Supervisors
By: Karen Barton, Deputy Clerk of the Board

12/23 - 01/01