

**SUBMITTAL TO THE BOARD OF SUPERVISORS
COUNTY OF RIVERSIDE, STATE OF CALIFORNIA**



ITEM: 3.18
(ID # 11383)

MEETING DATE:

Tuesday, January 7, 2020

FROM : TLMA-TRANSPORTATION:

SUBJECT: TRANSPORTATION AND LAND MANAGEMENT AGENCY/TRANSPORTATION:
Notice of Completion – Grand Avenue Resurfacing Project, Community of West
Lake Elsinore. District 1. [\$0]

RECOMMENDED MOTION: That the Board of Supervisors:

1. Accept as complete the Construction of the Grand Avenue Resurfacing Project, Community of West Lake Elsinore;
2. Authorize the Chairman of the Board to execute the Notice of Completion on behalf of the County; and
3. Direct the Clerk of the Board to record the Notice of Completion.

ACTION:Policy

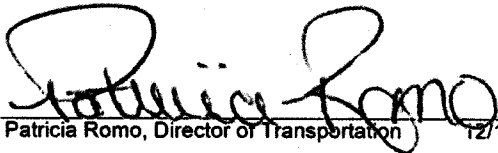
Patricia Romo, Director of Transportation 12/18/2019

MINUTES OF THE BOARD OF SUPERVISORS

On motion of Supervisor Jeffries, seconded by Supervisor Spiegel and duly carried by unanimous vote, IT WAS ORDERED that the above matter is approved as recommended.

Ayes: Jeffries, Spiegel, Washington, Perez and Hewitt
Nays: None
Absent: None
Date: January 7, 2020
xc: Transp.

Kecia R. Harper
Clerk of the Board
By: 
Deputy

**SUBMITTAL TO THE BOARD OF SUPERVISORS COUNTY OF RIVERSIDE,
STATE OF CALIFORNIA**

FINANCIAL DATA	Current Fiscal Year:	Next Fiscal Year:	Total Cost:	Ongoing Cost
COST	\$ 0	\$ 0	\$ 0	\$ 0
NET COUNTY COST	\$ 0	\$ 0	\$ 0	\$ 0
SOURCE OF FUNDS: N/A			Budget Adjustment:	N/A
			For Fiscal Year:	19/20

C.E.O. RECOMMENDATION: Approve

BACKGROUND:

Summary

By Minute Order 3.62 of July 31, 2018, the Board of Supervisors entered into a contract with Frank and Son Paving, Inc. of Chula Vista, California for the construction of the Grand Avenue Resurfacing Project from Machado Street to Plumas Street, in the Community of West Lake Elsinore.

The original authorized amount of the contract was \$351,515. The total price of the contract came in at \$252,980 which is 28.0% less than the original authorized amount. The reduction of the total cost was the result of using less quantities than anticipated to complete the work.

The work was completed in conformance with the plans and specifications and the contractor was granted relief of maintenance on November 30, 2018.

Project No. C8-0052

Impact on Residents and Businesses

The road improvements have increased safety and efficiency of vehicular traffic by providing the public with a smooth paved roadway.

Additional Fiscal Information

Budget		
Original Contract Amount		\$351,515
Total Change Orders Authorized	0.0%	\$0
Estimated Pending Change Orders	0.0%	\$0
Authorized Contract Amount		\$351,515
* Quantity Adjustments	-28.0%	(\$98,535)
+ CCO FA Adjustments	0.0%	\$0
Total Amended Contract Amount	72.0%	<u>\$252,980</u>
Expenditures		
Total Progress Payments		\$252,980
Estimated Pending Payments		<u>\$0</u>
Total Expenditures		<u>\$252,980</u>
(Over)/Under Contract Amount		<u><u>\$0</u></u>

**SUBMITTAL TO THE BOARD OF SUPERVISORS COUNTY OF RIVERSIDE,
STATE OF CALIFORNIA**

+ Change Orders using the Force Account method of payment issued prior to the work being completed generally do not use the total authorized amount.

* CAL-Trans Standard Specifications 4-1.03B. Increases or decreases in the quantity of a contract item of work will be determined by comparing the total pay quantity of such item of work with the Engineer's Estimate. If the total pay quantity of any item of work required under the contract varies from the Engineer's Estimate by 25 percent or less, payment will be made for the quantity of work of said item performed at the contract unit price, unless eligible for adjustment pursuant to Section 4-1.03C, "Changes in Character of Work."

This project was funded with \$252,145 of Gas Tax funds, \$632 of EVMWD funds, and \$202 of Frontier funds.

Contract History and Price Reasonableness

Six bids were received ranging from \$351,515 to \$529,925. The basis for the selection of a contractor is the lowest responsive and responsible bid. The lowest responsible bid was submitted by Frank and Son Paving, Inc. in the amount of \$351,515, which was \$70,035 (16%) below the Engineer's Estimate.

ATTACHMENTS:

Vicinity Map

Progress Estimate Report

Notice of Completion



Jason Farin, Senior Management Analyst 12/30/2019



Gregory V. Priaplos, Director County Counsel 12/20/2019



**PETER ALDANA
COUNTY OF RIVERSIDE
ASSESSOR-COUNTY CLERK-RECORDER**

Recorder
P.O. Box 751
Riverside, CA 92502-0751
(951) 486-7000

www.riversideacr.com

CERTIFICATION

Pursuant to the provisions of Government Code 27361.7, I certify under the penalty of perjury that the following is a true copy of illegible wording found in the attached document:

(Print or type the page number(s) and wording below):

Clarification of the Seal for the Riverside County Board of Supervisors
(embossed on the document)

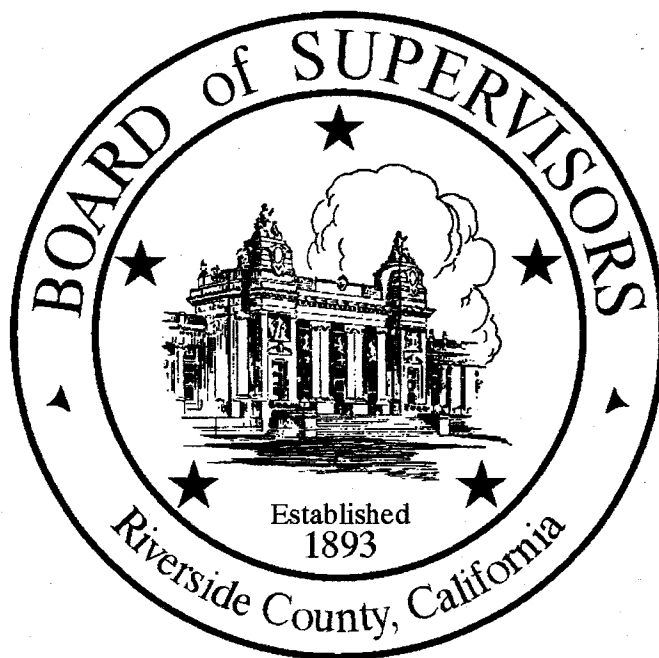

Date:

1-7-2020

Signature:

Karen Barton

Print Name:

Karen Barton, Secretary Clerk of the Board

COUNTY OF RIVERSIDE
TRANSPORTATION DEPARTMENT

GRAND AVENUE

RESURFACING
MACHADO ST TO PLUMAS ST
COMMUNITY OF WEST ELSINORE

WO# C8-0052

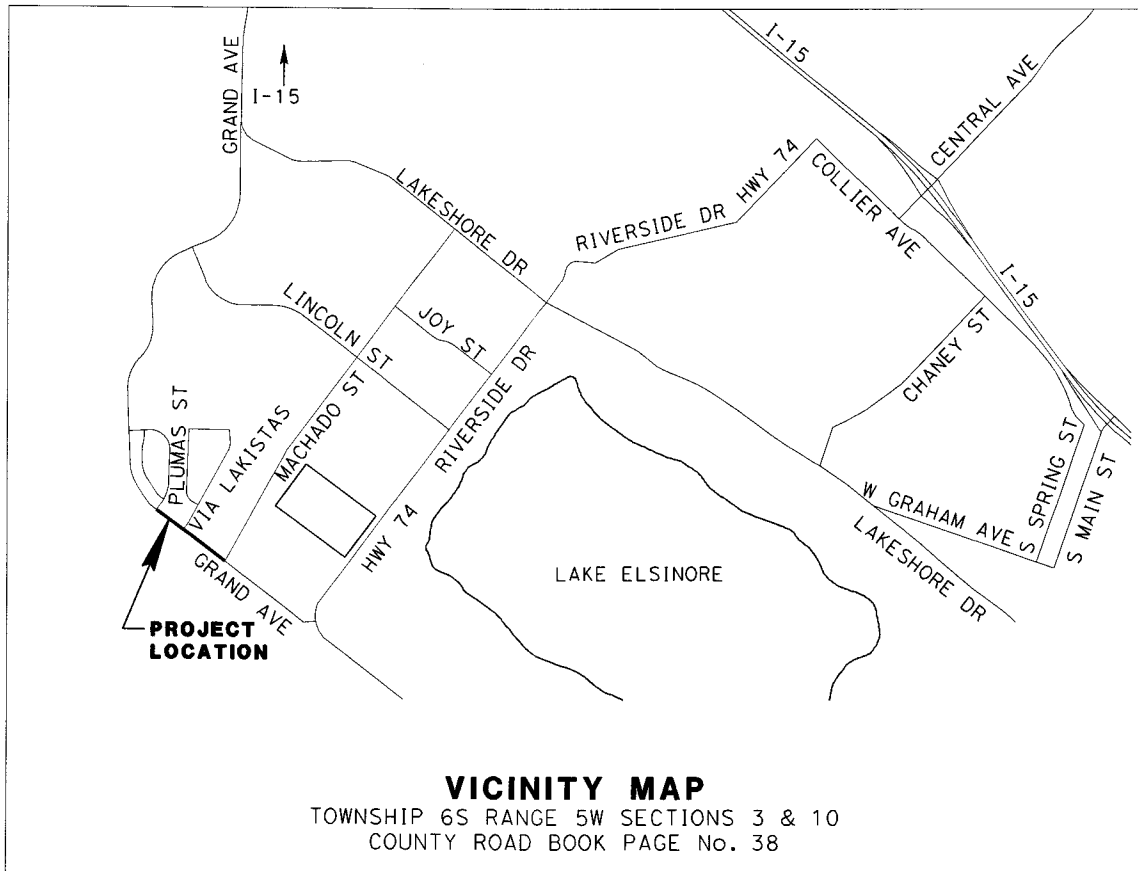
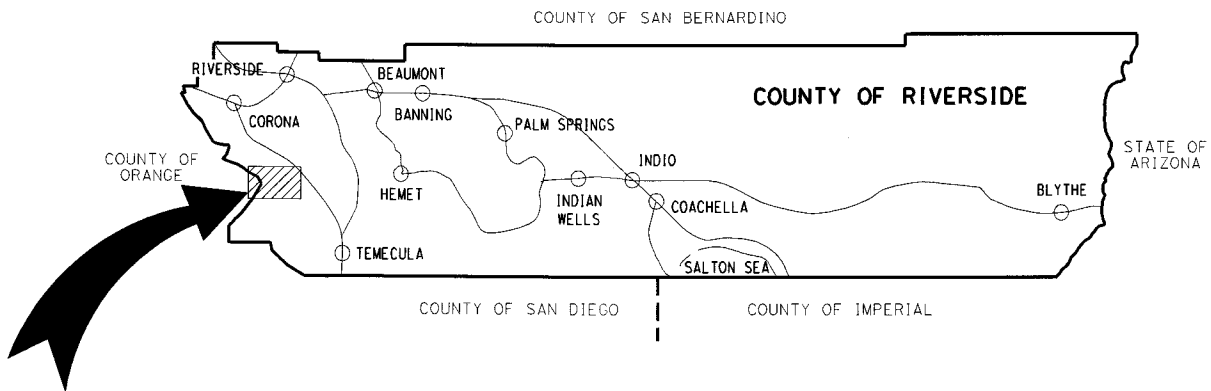



Contractor: Frank & Son Paving, Inc.
 Address: P.O. Box 688
 City, State, Zip: Ct Bonita, CA 91911

Estimate No. 3 Final
 From: November 26, 2018
 To: April 25, 2019

Item No.	Item Description	Units	Quantity	Unit Price	Original Contract Amount	Change Authorized Quantity	Total Authorized Quantity	This Estimate Quantity	Amount	Previous Quantity	Total Estimate To Date Quantity	Amount	% Am.
PROJECT TOTAL													
	Made by: David Hylkeberg				351,515.00	0.00	351,515.00	(950.28)	351,515.00		252,979.76		
	Checked by: <i>[Signature]</i>												
	OK Const. Supv. <i>[Signature]</i>												
	Working Days: 10-1-18												
	Days Added: 11-30-18												
	Subtotal: 72%												
	Days Used: 38												
	% Time Elapsed: 95%												
	TOTAL VALUE OF WORK TO DATE:											\$252,979.76	
	LESS RETENTION:											12,648.99	5%
	TOTAL DUE TO DATE:											\$240,330.77	
	LESS PREVIOUSLY INVOICED:											221,233.54	
	TOTAL DUE TO DATE:											19,097.23	
	RELEASE LABOR NON COMPLIANCE - 5 DAYS @ \$2,000 PER DAY - \$10,000:											10,000.00	
	LESS WPCP COMPLIANCE 20 DAYS @ \$500 PER DAY-\$10,000:											\$9,097.23	
	TOTAL DUE THIS PAYMENT:												

This Estimate Approved *[Signature]* Date: 8/22/19 for: Patricia Romo, Director of Transportation

Quantities on This Estimate Approved *[Signature]* Date: 8/22/19
 Frank & Son Paving, Inc.

Received by Accounts Payable: _____
 By: _____

PAYMENT APPROVAL

Fund 20000
 Dept ID 31305
 Account 527480
 Project ZC8-0052E
 Activity ID Z3500
 Resource Type CNT
 Signature *[Signature]*
 Date 8/27/19

TRANSPARENCY APPROVED
 By: Lon Conrad 8-28-19
 SEP 03 2019



Contractor: Frank & Son Paving, Inc.
 Address: P.O. Box 688
 City, State, Zip: Ch Bonita, CA 91911

Estimate No. 3 Final
 From: November 25, 2018
 To: April 25, 2019

Item No.	Item Description	Units	Quantity	Unit Price	Original Contract Amount	Change Authorized Quantity	Change Authorized Amount	Total Authorized Quantity	Total Authorized Amount	This Estimate Quantity	This Estimate Amount	Previous Quantity	Total Estimate To Date Quantity	Total Estimate To Date Amount	% Auth.
1	DEVELOP WATER SUPPLY	LS	1	2,000.00	2,000.00			1.00	2,000.00	1.00		1.00	1.00	2,000.00	100%
2	TRAFFIC CONTROL SYSTEM	LS	1	20,000.00	20,000.00			1.00	20,000.00	0.10	2,000.00	0.90	1.00	20,000.00	100%
3	PREPARE WATER POLLUTION CONTROL PROGRAM	LS	1	4,000.00	4,000.00			1.00	4,000.00	0.25	1,000.00	0.75	1.00	4,000.00	100%
4	CLEARING AND GRUBBING (LS)	LS	1	10,000.00	10,000.00			1.00	10,000.00	1.00	10,000.00		1.00	10,000.00	100%
5	DUST CONTROL	LS	1	6,000.00	6,000.00			1.00	6,000.00	0.25	1,500.00	0.75	1.00	6,000.00	100%
6	CRACK TREATMENT	LS	1	10,000.00	10,000.00			1.00	10,000.00				1.00	10,000.00	100%
7	WEDGE PLANE ASPHALT CONCRETE	LF	1,750	5.76	10,080.00			1,750.00	10,080.00				1,750.00	10,080.00	70%
8	ROADWAY EXCAVATION	CY	180	62.00	11,160.00			180.00	11,160.00				180.00	11,160.00	87%
9	SHOULDER BACKING	LF	2,850	3.80	10,830.00			2,850.00	10,830.00				2,850.00	10,830.00	82%
10	PLACE ASPHALT CONCRETE DIKE (CRS 212) (8")	LF	350	11.32	3,962.00			350.00	3,962.00				350.00	3,962.00	109%
11	ASPHALT CONCRETE DRIVEWAY	SQFT	355	14.40	5,112.00			355.00	5,112.00				355.00	5,112.00	94%
12	HOT MIX ASPHALT (TYPE A)	TON	960	68.00	65,280.00			960.00	65,280.00	-388.01	-26,384.68	683.45	296.44	20,089.92	31%
13	RUBBERIZED HOT MIX ASPHALT (GAP GRADED)	TON	1,450	78.00	113,100.00			1,450.00	113,100.00				1,358.80	105,988.40	94%
14	ADJUST MANHOLE TO GRADE [SD MANHOLE]	EA	3	300.00	900.00			3.00	900.00	3.00	900.00		3.00	900.00	100%
15	MINOR CONCRETE (SPANDREL) (CRS 209)	SQFT	880	7.00	6,160.00			880.00	6,160.00				812.00	5,684.00	92%
16	MINOR CONCRETE (CURB RAMP) (CRS 403 - CASE A)	EA	3	3,800.00	11,400.00			3.00	11,400.00				3.00	11,400.00	100%
17	PAVEMENT MARKER (RETROREFLECTIVE)	EA	300	6.00	1,800.00			300.00	1,800.00	220.00	1,320.00		220.00	1,320.00	73%
18	REMOVE SIGN	EA	8	169.00	1,352.00			8.00	1,352.00	8.00	1,352.00		8.00	1,352.00	100%
19	ROADSIDE SIGN - ONE POST	EA	7	407.00	2,849.00			7.00	2,849.00	7.00	2,849.00		7.00	2,849.00	100%
20	THERMOPLASTIC PAVEMENT MARKING	SQFT	460	10.00	4,600.00			460.00	4,600.00	68.00	680.00	409.00	477.00	4,770.00	104%
21	PAINT TRAFFIC STRIPE (2-COAT)	LF	6,950	1.40	9,730.00			6,950.00	9,730.00	1,881.00	2,633.40	5,730.00	7,611.00	10,655.40	110%
22	MISCELLANEOUS WORK (AS DIRECTED)	FA	1	40,000.00	40,000.00			1.00	40,000.00				1.00	40,000.00	0%
23	ADJUST MANHOLE TO GRADE	EA	3	300.00	900.00			3.00	900.00	3.00	900.00		3.00	900.00	100%
24	ADJUST MANHOLE TO GRADE	EA	1	300.00	300.00			1.00	300.00	1.00	300.00		1.00	300.00	100%