

SUBMITTAL TO THE BOARD OF SUPERVISORS
COUNTY OF RIVERSIDE, STATE OF CALIFORNIA

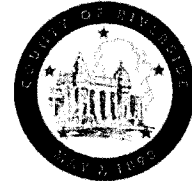

ITEM: 3.13
(ID # 11263)

MEETING DATE:
Tuesday, January 14, 2020

FROM : TLMA-TRANSPORTATION:

SUBJECT: TRANSPORTATION AND LAND MANAGEMENT AGENCY/TRANSPORTATION:
Notice of Completion – Mecca Area Sidewalks Project, in the Community of
Mecca. District 4. [\$0]

RECOMMENDED MOTION: That the Board of Supervisors:

1. Accept as complete the Mecca Area Sidewalks Project, in the Community of Mecca;
2. Authorize the Chairman of the Board to execute the Notice of Completion on behalf of the County; and
3. Direct the Clerk of the Board to record the Notice of Completion.

ACTION: Policy

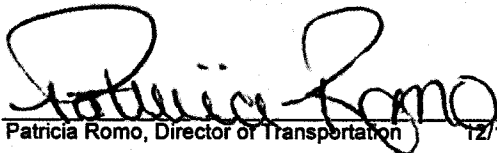
Patricia Romo, Director of Transportation 12/18/2019

MINUTES OF THE BOARD OF SUPERVISORS

On motion of Supervisor Washington, seconded by Supervisor Jeffries and duly carried, IT WAS ORDERED that the above matter is approved as recommended.

Ayes: Jeffries, Washington, Perez and Hewitt
Nays: None
Absent: Spiegel
Date: January 14, 2020
xc: Transp.

Kecia R. Harper
Clerk of the Board
By: 
Deputy

**SUBMITTAL TO THE BOARD OF SUPERVISORS COUNTY OF RIVERSIDE,
STATE OF CALIFORNIA**

FINANCIAL DATA	Current Fiscal Year:	Next Fiscal Year:	Total Cost:	Ongoing Cost
COST	\$ 0	\$ 0	\$ 0	\$ 0
NET COUNTY COST	\$ 0	\$ 0	\$ 0	\$ 0
SOURCE OF FUNDS: N/A			Budget Adjustment:	N/A
			For Fiscal Year:	19/20

C.E.O. RECOMMENDATION: Approve

BACKGROUND:

Summary

By Minute Order 3.34 of April 10, 2018, the Board of Supervisors entered into a contract with CT&T Concrete Paving, Inc. of Brea, California for the construction of the Mecca Area Sidewalks Project, 6th Street (Date Palm Street to Dale Kiler Road), Brown Street (5th Street to 6th Street) and Dale Kiler Road (5th Street to 7th Street) in the Community of Mecca.

The original authorized amount of the contract was \$536,546. The total price of the contract came in at \$526,247 which is 1.9% less than the originally authorized amount. The reduction of the total cost was the result of using less quantities than anticipated to complete work.

The work was completed in conformance with the plans and specifications and the contractor was granted relief of maintenance on October 12, 2018.

Project No. C6-0069
State Project No. ATPL-5956(258)

Impact on Residents and Businesses

The improvements benefit the project area by enhancing public health, increasing mobility for non-motorized users and increasing public safety.

Additional Fiscal Information

**SUBMITTAL TO THE BOARD OF SUPERVISORS COUNTY OF RIVERSIDE,
STATE OF CALIFORNIA**

Budget

Original Contract Amount		\$536,546
Total Change Orders Authorized	0.0%	\$0
Estimated Pending Change Orders	0.0%	\$0
Authorized Contract Amount		\$536,546
* Quantity Adjustments	-1.9%	(\$10,299)
+ CCO FA Adjustments	0.0%	\$0
Total Amended Contract Amount	98.1%	<u>\$526,247</u>

Expenditures

Total Progress Payments		\$526,247
Estimated Pending Payments		<u>\$0</u>
Total Expenditures		<u>\$526,247</u>

(Over)/Under Contract Amount \$0

+ Change Orders using the Force Account method of payment issued prior to the work being completed generally do not use the total authorized amount.

* Caltrans Standard Specifications 4-1.03B. Increases or decreases in the quantity of a contract item of work will be determined by comparing the total pay quantity of such item of work with the Engineer's Estimate. If the total pay quantity of any item of work required under the contract varies from the Engineer's Estimate by 25 percent or less, payment will be made for the quantity of work of said item performed at the contract unit price, unless eligible for adjustment pursuant to Section 4-1.03C, "Changes in Character of Work."

This project was funded with \$52,625 of Gas Tax/HUTA funds and \$473,622 of Active Transportation Plan ATP funds.

Contract History and Price Reasonableness

Six bids were received ranging from \$536,546 to \$948,827. The basis for the selection of a contractor is the lowest responsive and responsible bid. The lowest responsible bid was submitted by CT&T, Inc. in the amount of \$536,546, which is \$13,866 (2.5%) lower than the Engineer's Estimate.

ATTACHMENTS:

- Vicinity Map
- Progress Estimate Report
- Notice of Completion

SUBMITTAL TO THE BOARD OF SUPERVISORS COUNTY OF RIVERSIDE,
STATE OF CALIFORNIA



Jason Farin, Senior Management Analyst

1/8/2020



Gregory V. Prietas, Director County Counsel

12/24/2019



**PETER ALDANA
COUNTY OF RIVERSIDE
ASSESSOR-COUNTY CLERK-RECORDER**

Recorder
P.O. Box 751
Riverside, CA 92502-0751
(951) 486-7000

www.riversideacr.com

CERTIFICATION

Pursuant to the provisions of Government Code 27361.7, I certify under the penalty of perjury that the following is a true copy of illegible wording found in the attached document:

(Print or type the page number(s) and wording below):

Clarification of the Seal for the Riverside County Board of Supervisors
(embossed on the document)

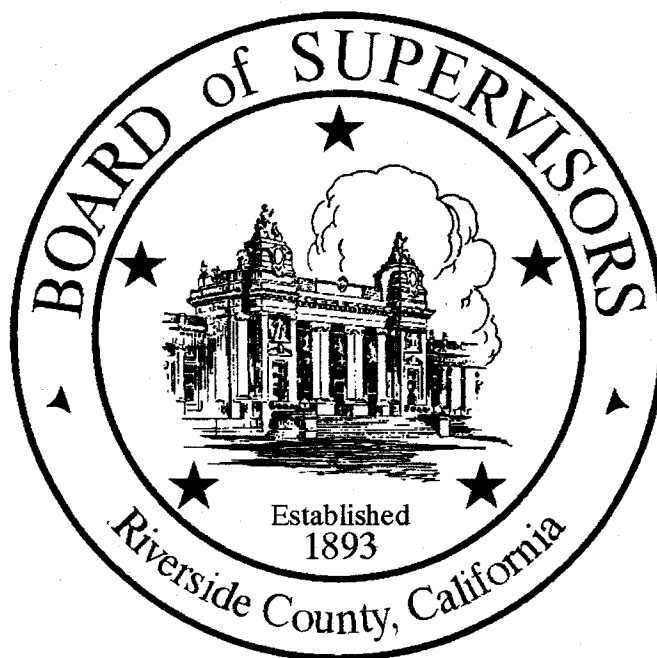

Date:

1-14-2020

Signature:

Karen Barton

Print Name:

Karen Barton, Deputy Clerk of the Board

COUNTY OF RIVERSIDE
TRANSPORTATION DEPARTMENT

MECCA AREA

SIDEWALKS

**6TH ST FROM DATE PALM ST TO DALE KILER RD
BROWN ST FROM 5TH ST TO 6TH ST
DALE KILER RD FROM 5TH ST TO 7TH ST**

COMMUNITY OF MECCA

WO No. C6-0069

TO BE SUPPLEMENTED BY CALTRANS STANDARD PLANS DATED 2015 AND
COUNTY OF RIVERSIDE ROAD IMPROVEMENT STANDARDS DATED 12-20-2007

STATE PROJECT No. ATPL-5956 (258)

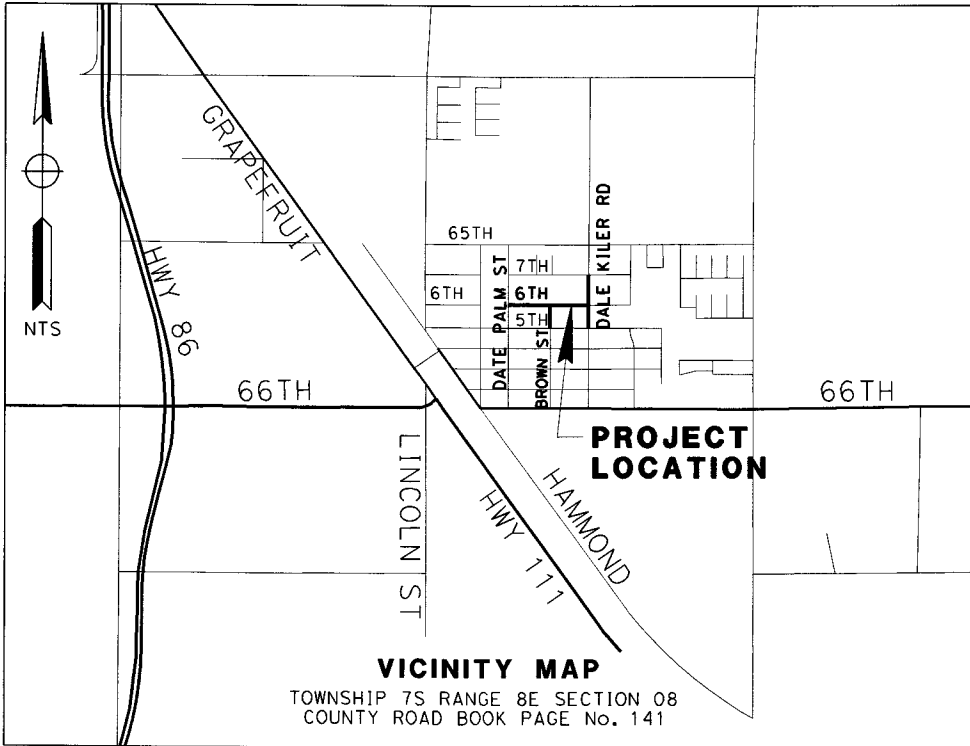
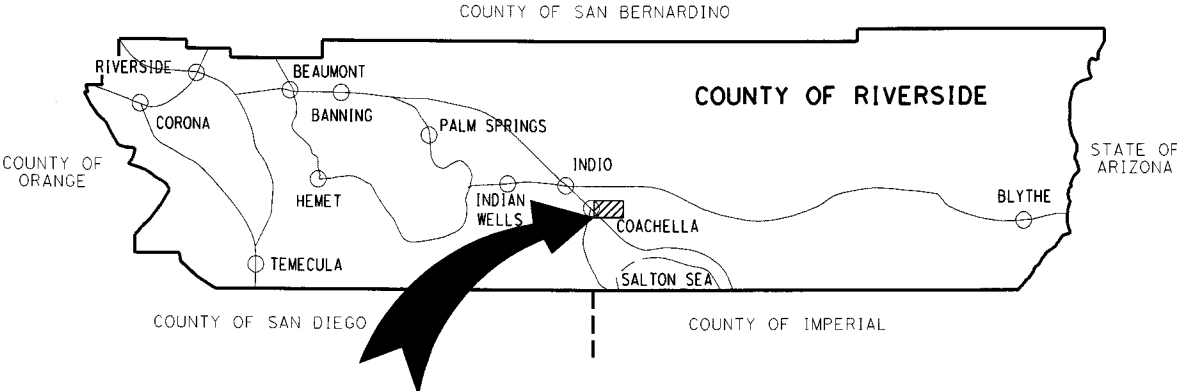

PROGRESS ESTIMATE RECORD - COUNTY OF RIVERSIDE
 PROJECT: Mecca Area Sidewalks Project
 County Project No.: C6-0068, State Project No. ATPL-5956(258)
 Contract No. 18-03-004

Contractor: CT & T Concrete Paving, Inc.
 Address: 324 S Diamond Bar Blvd.
 City, State, Zip: Diamond Bar, CA 91785

Estimate No. 6 Final
 From: December 26, 2018
 To: April 25, 2019



Item No.	Item Description	Units	Quantity	Unit Price	Original Contract		Change Orders		Amended Contract		This Estimate		Previous Quantity		Total Estimate To Date		% Auth.
					Amount	Quantity	Amount	Quantity	Amount	Quantity	Amount	Quantity	Amount	Quantity	Amount	Quantity	
23	PAINT TRAFFIC STRIPE (2-COAT)	LF	1,110	1.10	1,221.00				1,110.00	1,221.00	1,066.00	1,172.60	1,066.00	1,172.60	1,172.60	98%	
24	MISCELLANEOUS WORK (AS DIRECTED)	FA	1	35,000.00	35,000.00			1.00	35,000.00	0.8805288	30,818.51	0.8805288	30,818.51	0.8805288	30,818.51	88%	
PROJECT TOTAL						536,546.00	0.00			536,546.00	59,951.96	526,246.88			526,246.88		

Made by: Gabriel Munoz
 Checked by:
 OK Const. Supv.

Working Days: 40 Start Date: 7-27-18
 Days Added: 12 End Date: 10-12-18
 Subtotal: 52 % Complete: 98%
 Days Used: 68 Original Contract: \$536,546.00
 % Time Elapsed: 131% Amended Contract: \$536,546.00

TOTAL VALUE OF WORK TO DATE: \$526,246.88
 LESS RETENTION: 5% 26,312.35
 TOTAL DUE TO DATE: \$499,934.53
 LESS PREVIOUSLY INVOICED: 338,980.17
 LESS LABOR NON COMPLIANCE: 0.00
 TOTAL DUE THIS PAYMENT: \$128,954.36

Received by Accounts Payable: _____
 By: _____

PAYMENT APPROVAL

Fund 20000
 Dept ID 31305
 Account 521870
 Project 206-0069E
 Activity ID 23500
 Resource Type CNT
 Signature
 Date 10/22/19

This Estimate Approved _____ Date: 10-17-19 for: _____
 Patricia Romo, Director of Transportation
 Quantities on This Estimate Approved _____
 CT & T Concrete Paving Inc.

PROJECT: Mecca Area Sidewalks Project
 County Project No.: C6-0089, State Project No. ATPL-5956(258)
 Contract No. 18-03-004

Contractor: CT & T Concrete Paving, Inc.
 Address: 324 S Diamond Bar Blvd.
 City, State, Zip: Diamond Bar, CA 91765

Estimate No. 6 Final
 From: December 26, 2018
 To: April 25, 2019



Item No.	Units	Item Description	Quantity	Unit Price	Original Contract Amount	Change Orders Quantity	Change Orders Amount	Amended Contract Quantity	Amended Contract Amount	This Estimate Quantity	This Estimate Amount	Previous Quantity	Total Estimate To Date Quantity	Total Estimate To Date Amount	% Auth.
1	LS	DUST ABATEMENT	1	5,000.00	5,000.00			1.00	5,000.00	0.05	250.00	0.95	1.00	5,000.00	100%
2	LS	WATER POLLUTION CONTROL	1	2,000.00	2,000.00			1.00	2,000.00	0.10	200.00	0.90	1.00	2,000.00	100%
3	LS	DEVELOP WATER SUPPLY	1	4,500.00	4,500.00			1.00	4,500.00	0.05	225.00	0.95	1.00	4,500.00	100%
4	LS	TRAFFIC CONTROL SYSTEM	1	6,000.00	6,000.00			1.00	6,000.00	0.05	300.00	0.95	1.00	6,000.00	100%
5	LS	CLEARING AND GRUBBING	1	8,000.00	8,000.00			1.00	8,000.00	0.05	400.00	0.95	1.00	8,000.00	100%
6	EA	UNDER SIDEWALK DRAIN CAST IN PLACE (CRS 309)	6	200.00	1,200.00			6.00	1,200.00	6.00	1,200.00		6.00	1,200.00	100%
7	CY	ROADWAY EXCAVATION	180	79.00	14,220.00			180.00	14,220.00	10.00	790.00	170.00	180.00	14,220.00	100%
8	CY	CLASS 2 AGGREGATE BASE	1,880	25.00	47,000.00			1,880.00	47,000.00	482.45	12,061.25	1,852.24	2,334.69	58,367.25	124%
9	TON	HOT MIX ASPHALT	390	112.00	43,680.00			390.00	43,680.00			410.16	410.16	45,937.92	105%
10	EA	FUNDING AWARENESS SIGN	5	750.00	3,750.00			5.00	3,750.00	2.00	1,500.00	3.00	5.00	3,750.00	100%
11	SQFT	MINOR CONCRETE (CROSS-GUTTER) (CRS 209)	1,000	12.00	12,000.00			1,000.00	12,000.00			1,000.00	1,000.00	12,000.00	100%
12	SQFT	MINOR CONCRETE (SPANDREL) (CRS 209)	2,000	14.00	28,000.00			2,000.00	28,000.00	262.00	3,668.00	1,574.00	1,836.00	25,704.00	92%
13	LF	MINOR CONCRETE (CURB AND GUTTER) (CRS 200)	3,500	40.00	140,000.00			3,500.00	140,000.00			3,584.00	3,584.00	143,360.00	102%
14	SQFT	MINOR CONCRETE (DRIVEWAY APPROACH) (CRS 207)	6,000	7.00	42,000.00			6,000.00	42,000.00			5,317.00	5,317.00	37,219.00	89%
15	EA	MINOR CONCRETE (CURB RAMP) (CRS 403 - CASE A)	3	3,000.00	9,000.00			3.00	9,000.00			3.00	3.00	9,000.00	100%
16	EA	MINOR CONCRETE (CURB RAMP) (CRS 403 - CASE B)	4	3,400.00	13,600.00			4.00	13,600.00	1.00	3,400.00	3.00	4.00	13,600.00	100%
17	SQFT	MINOR CONCRETE (DRIVEWAY)	2,035	7.00	14,245.00			2,035.00	14,245.00			1,662.00	1,662.00	11,634.00	82%
18	SQFT	MINOR CONCRETE (SIDEWALK)	16,000	5.65	90,400.00			16,000.00	90,400.00			14,180.00	14,180.00	80,117.00	89%
19	LF	REMOVE (AND REPLACE) CHAIN LINK FENCE	275	40.00	11,000.00			275.00	11,000.00			217.00	217.00	8,680.00	79%
20	EA	PAVEMENT MARKER (RETROREFLECTIVE)	6	99.00	594.00			6.00	594.00	7.00	693.00		7.00	693.00	117%
21	EA	RELOCATE ROAD SIGN	10	242.00	2,420.00			10.00	2,420.00	6.00	1,452.00		6.00	1,452.00	60%
22	SQFT	THERMOPLASTIC CROSSWALK AND PAVEMENT MARKING	260	6.60	1,716.00			260.00	1,716.00	276.00	1,821.60		276.00	1,821.60	106%