

**SUBMITTAL TO THE BOARD OF SUPERVISORS
COUNTY OF RIVERSIDE, STATE OF CALIFORNIA**



ITEM: 3.70
(ID # 13069)

MEETING DATE:

Tuesday, August 25, 2020

FROM: TLMA-TRANSPORTATION:

SUBJECT: TRANSPORTATION AND LAND MANAGEMENT AGENCY/TRANSPORTATION:
Approve the Force Account Construction Projects in the Unincorporated Areas of Anza, Cherry Valley, Perris, Homeland, Riverside, and Temecula. Districts 1, 3, and 5. [\$4,477,000 Total Cost - Gas Tax 100%]

RECOMMENDED MOTION: That the Board of Supervisors:

1. Approve the Director of Transportation, or designee, to conduct force account work (per AB720) in the unincorporated areas of Anza, Cherry Valley, Perris, Homeland, Riverside, and Temecula, utilizing the Transportation Department's in-house construction crews as set forth in Attachment A-1 hereto.

ACTION: Policy

Patricia Romo, Director of Transportation 8/10/2020

MINUTES OF THE BOARD OF SUPERVISORS

On motion of Supervisor Spiegel, seconded by Supervisor Hewitt and duly carried, IT WAS ORDERED that the above matter is approved as recommended.

Ayes: Spiegel, Washington, Perez and Hewitt
Nays: None
Absent: Jeffries
Date: August 25, 2020
xc: Transp.

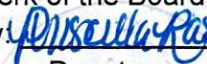
Kecia R. Harper
Clerk of the Board
By: 
Deputy

**SUBMITTAL TO THE BOARD OF SUPERVISORS COUNTY OF RIVERSIDE,
STATE OF CALIFORNIA**

FINANCIAL DATA	Current Fiscal Year:	Next Fiscal Year:	Total Cost:	Ongoing Cost
COST	\$ 4,477,000	\$ 0	\$ 4,477,000	\$ 0
NET COUNTY COST	\$ 0	\$ 0	\$ 0	\$ 0
SOURCE OF FUNDS: Gas Tax 100%. No General Funds will be used on this project.			Budget Adjustment: No	
			For Fiscal Year: 20/21	

C.E.O. RECOMMENDATION: Approve

BACKGROUND:

Summary

The County Transportation Department (Transportation Department) is planning on overlaying or reconstructing several existing paved roads in the Temecula area, Riverside area, Cherry Valley area, Perris area and Homeland area using the department's in-house construction crews.

This work can be efficiently and cost effectively completed using Transportation Department crews, compared to the traditional bidding process. It should be noted that the Transportation Department contracts out the vast majority of its construction work to private contractors (over 90% last year).

Certain projects that are less complex and of a maintenance nature can be more efficiently and quickly accomplished using our road crews, due to the time and cost savings realized through not having to generate engineered plans and contract specifications, surveying, and inspection costs.

The following road will be paved in Perris area (1st District):

<u>Name</u>	<u>From</u>	<u>To</u>
Deprad Street	Marshall Street	Cowie Street
Deprad Street	Cowie Street	Cox Street
Deprad Street	Cox Street	660' East of Cox Street

The following road(s) will be constructed in the Riverside area (1st District):

<u>Name</u>	<u>From</u>	<u>To</u>
*Sage Avenue	Washington Street	Olive Avenue
*Capella Street	Van Buren Blvd	Summit Crest Drive
*Extravaganza Lane	Cajalco Road	N'LY End

**SUBMITTAL TO THE BOARD OF SUPERVISORS COUNTY OF RIVERSIDE,
STATE OF CALIFORNIA**

****New Construction, these streets will become County Maintained and will have a dedicated right of way for public use.***

The following road(s) will be reconstructed in the Anza area (3rd District):

<u>Name</u>	<u>From</u>	<u>To</u>
Bohlen Road	N'LY Mitchell Road .15 mi	N'LY Mitchell Rd .78 mi
Bohlen Road	Mitchell Road	N'LY Mitchell Rd .16 mi

The following road(s) will be constructed in the Homeland area (3rd District):

<u>Name</u>	<u>From</u>	<u>To</u>
Allen Avenue	Olson Avenue	White Avenue
Naumann Avenue	Allen Avenue	N'LY Allen Avenue .15mi
Naumann Avenue	N'LY Allen Avenue .15mi	SH 74
Ritter Avenue	SH 74	N'LY SH 74 .22mi

The following road will be paved in the Temecula area (3rd District):

<u>Name</u>	<u>From</u>	<u>To</u>
Monte De Oro Road	Rancho California Road	S. Camino Vino .09 mi

The following road will be paved in the Cherry Valley area (5th District):

<u>Name</u>	<u>From</u>	<u>To</u>
Jonathan Avenue	Brookside Avenue	N'LY Brookside Avenue 1.12 mi

Assembly Bill 720 (AB720) sets forth modified requirements by which new road construction and road reconstruction can be performed by employees of a public agency. Under AB720, an agency may elect to utilize public employees to perform force account work, provided this work does not exceed 30% of the total value of all work performed by force account other than maintenance, as reported in the State Controller's Streets and Roads Annual Report as of January 1 of each year. The intent to use this authority must be declared prior to commencing the work.

The proposed projects with their associated construction budgets are listed in Attachment A-1. The total cost of the work is \$4,477,000.

Impact on Residents and Businesses

The proposed projects will reduce dust and erosion, improve access to local residents, and increase public safety.

SUBMITTAL TO THE BOARD OF SUPERVISORS COUNTY OF RIVERSIDE,
STATE OF CALIFORNIA

Additional Fiscal Information

All projects will be funded by 100% Gas Tax (\$4,477,000).

ATTACHMENTS:

Vicinity Maps

Attachment A-1



Jason Farin, Principal Management Analyst 8/19/2020



Gregory T. Priamos, Director County Counsel 8/17/2020

COUNTY OF RIVERSIDE
TRANSPORTATION DEPARTMENT

ANZA AREA
RESURFACING PROJECT

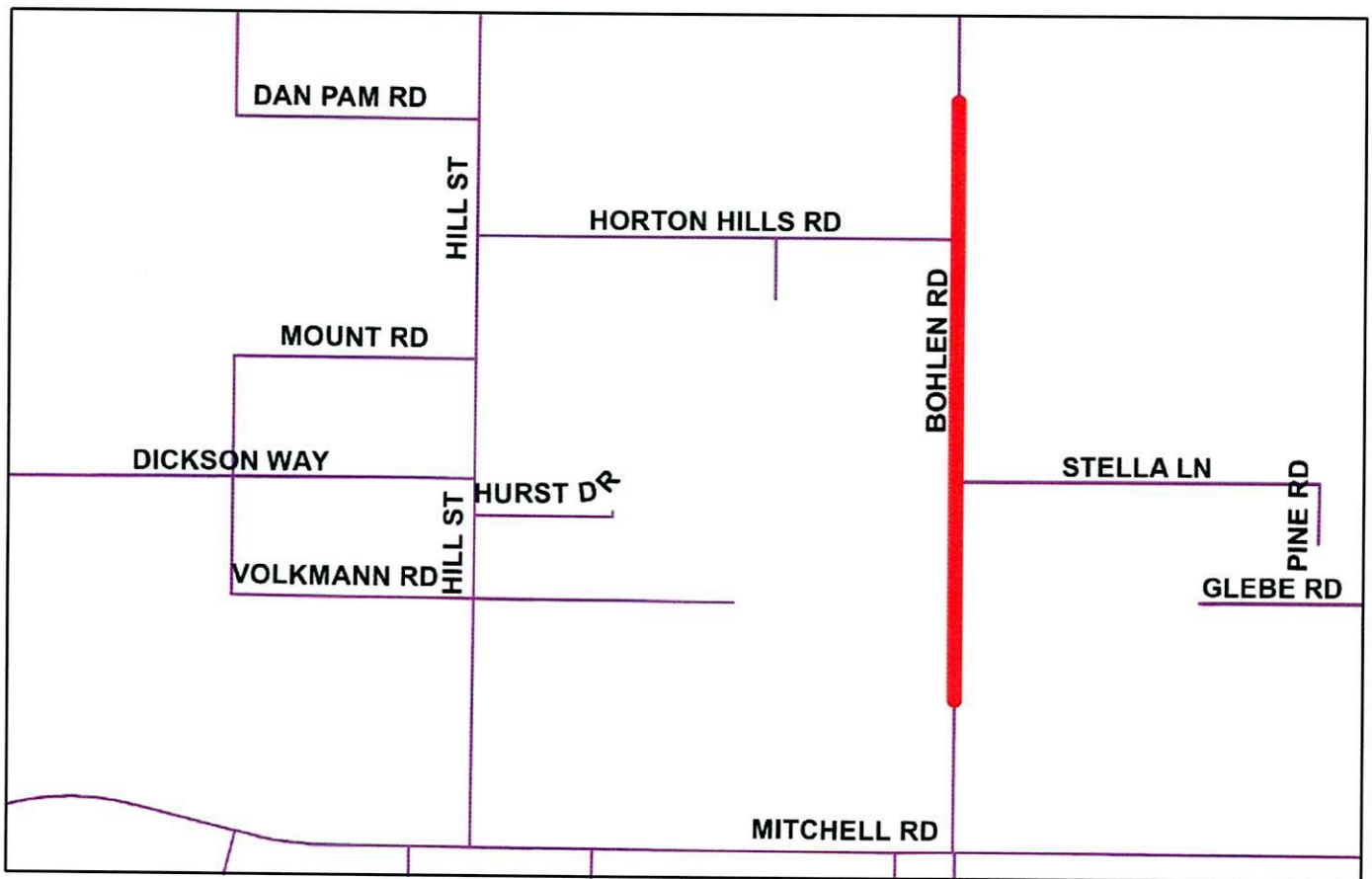
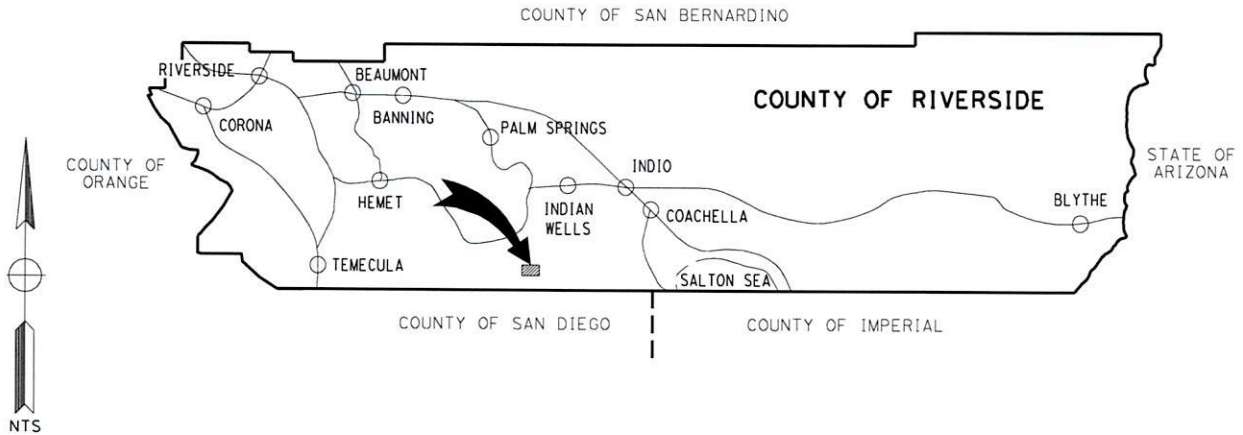

TOWNSHIP 7S RANGE 3E
COUNTY ROADBOOK PAGE No. 162A

VICINITY MAP

COUNTY OF RIVERSIDE TRANSPORTATION DEPARTMENT

PERRIS AREA RESURFACING PROJECT

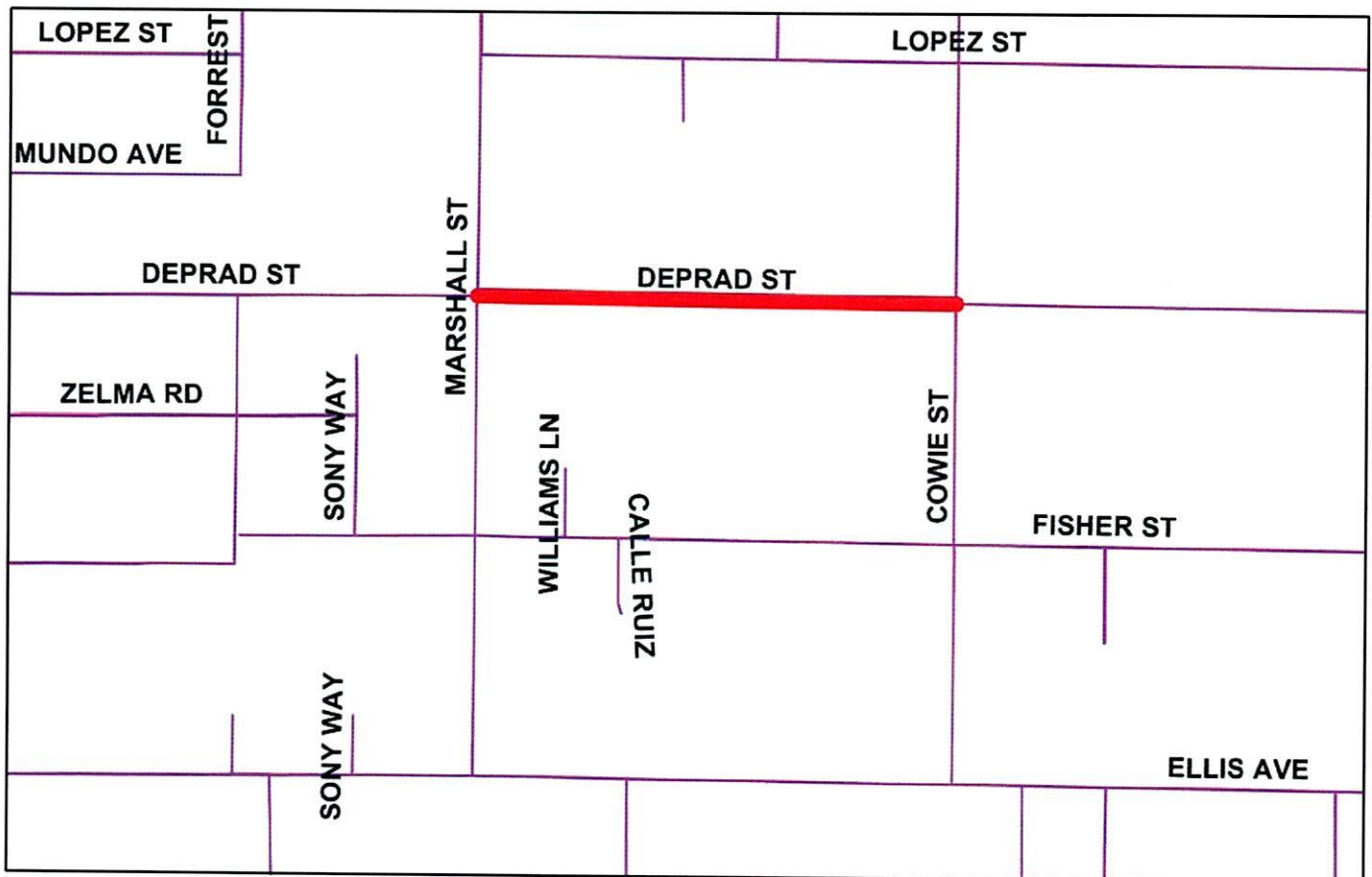
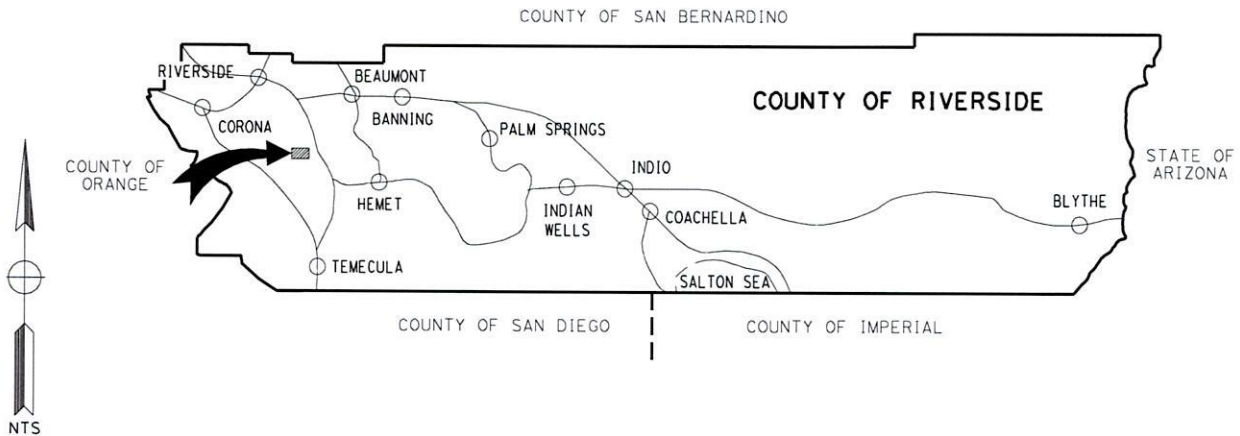

TOWNSHIP 4S RANGE 4W
COUNTY ROADBOOK PAGE No. 61

VICINITY MAP

COUNTY OF RIVERSIDE
TRANSPORTATION DEPARTMENT

PERRIS AREA
RESURFACING PROJECT

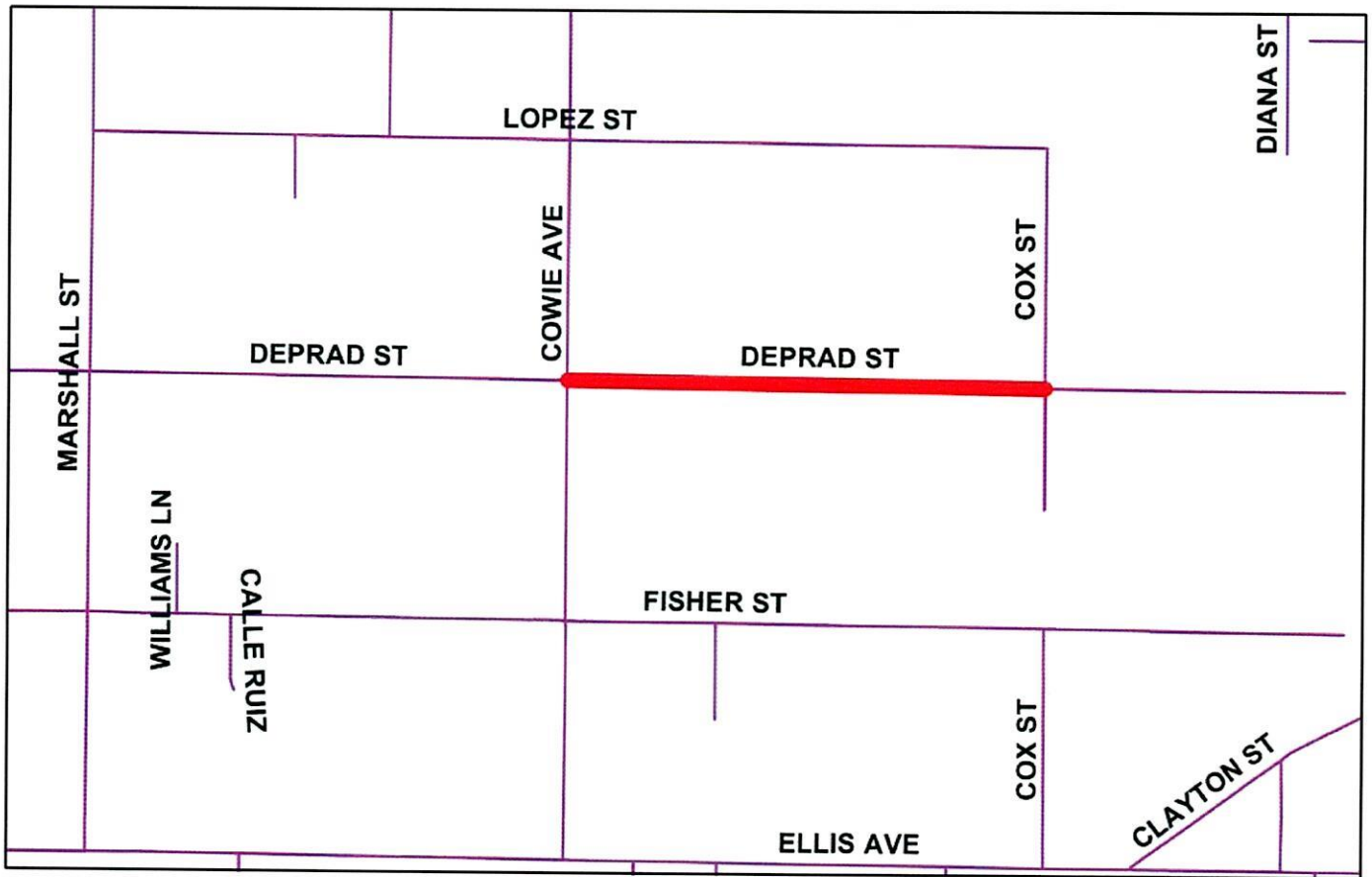
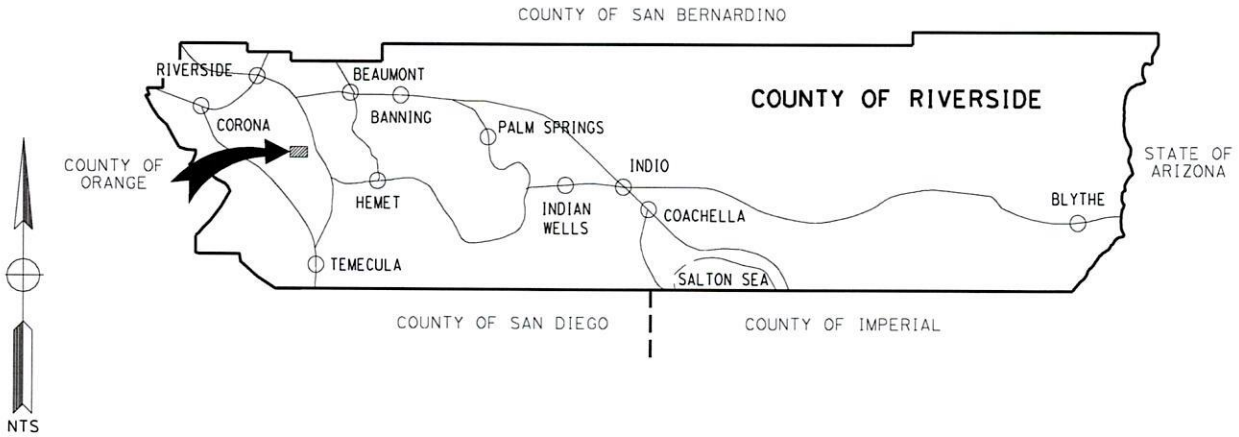

TOWNSHIP 4S RANGE 4W
COUNTY ROADBOOK PAGE No. 61

VICINITY MAP

COUNTY OF RIVERSIDE
TRANSPORTATION DEPARTMENT

PERRIS AREA
RESURFACING PROJECT

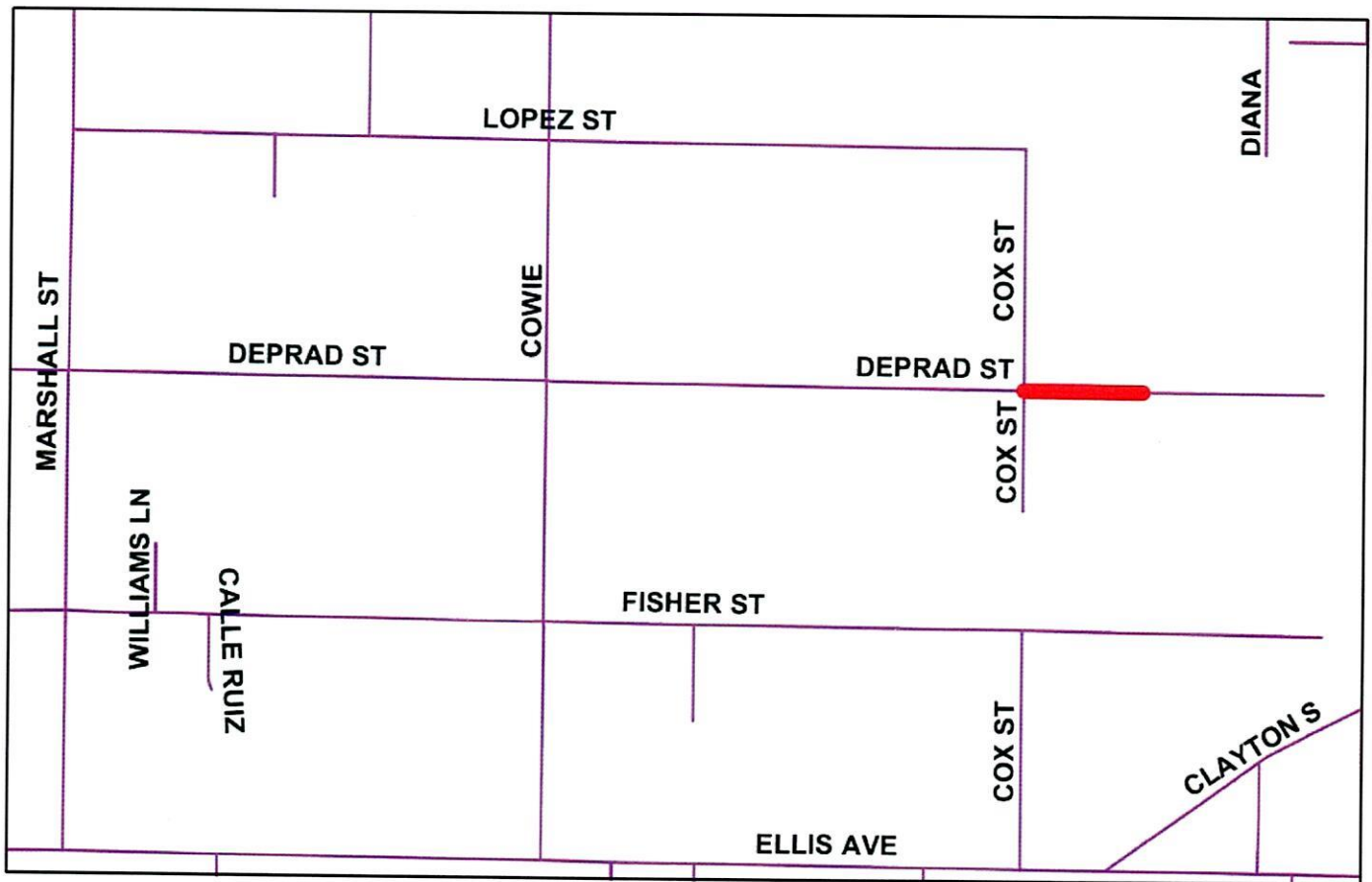
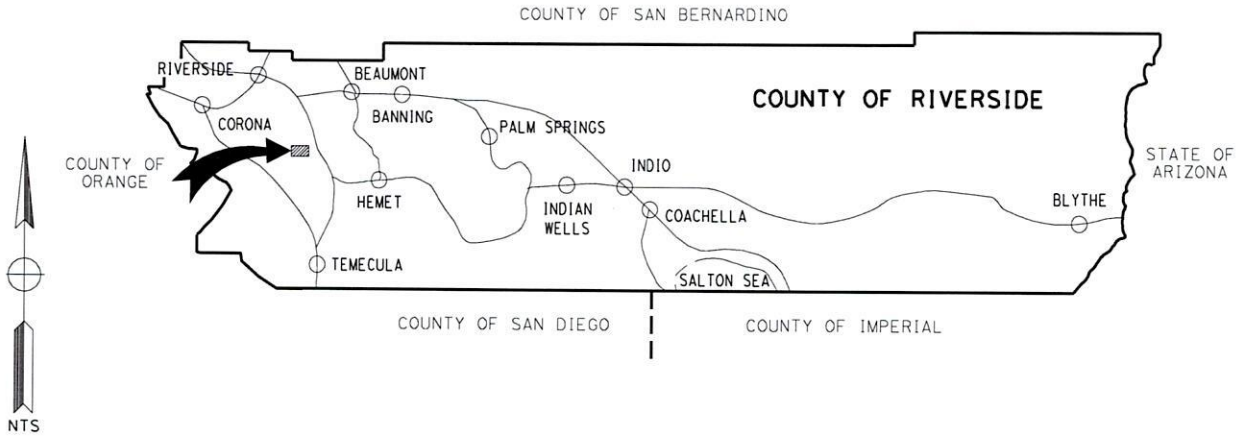

TOWNSHIP 4S RANGE 4W
COUNTY ROADBOOK PAGE No. 61

VICINITY MAP

COUNTY OF RIVERSIDE
TRANSPORTATION DEPARTMENT

CHERRY VALLEY AREA
RESURFACING PROJECT

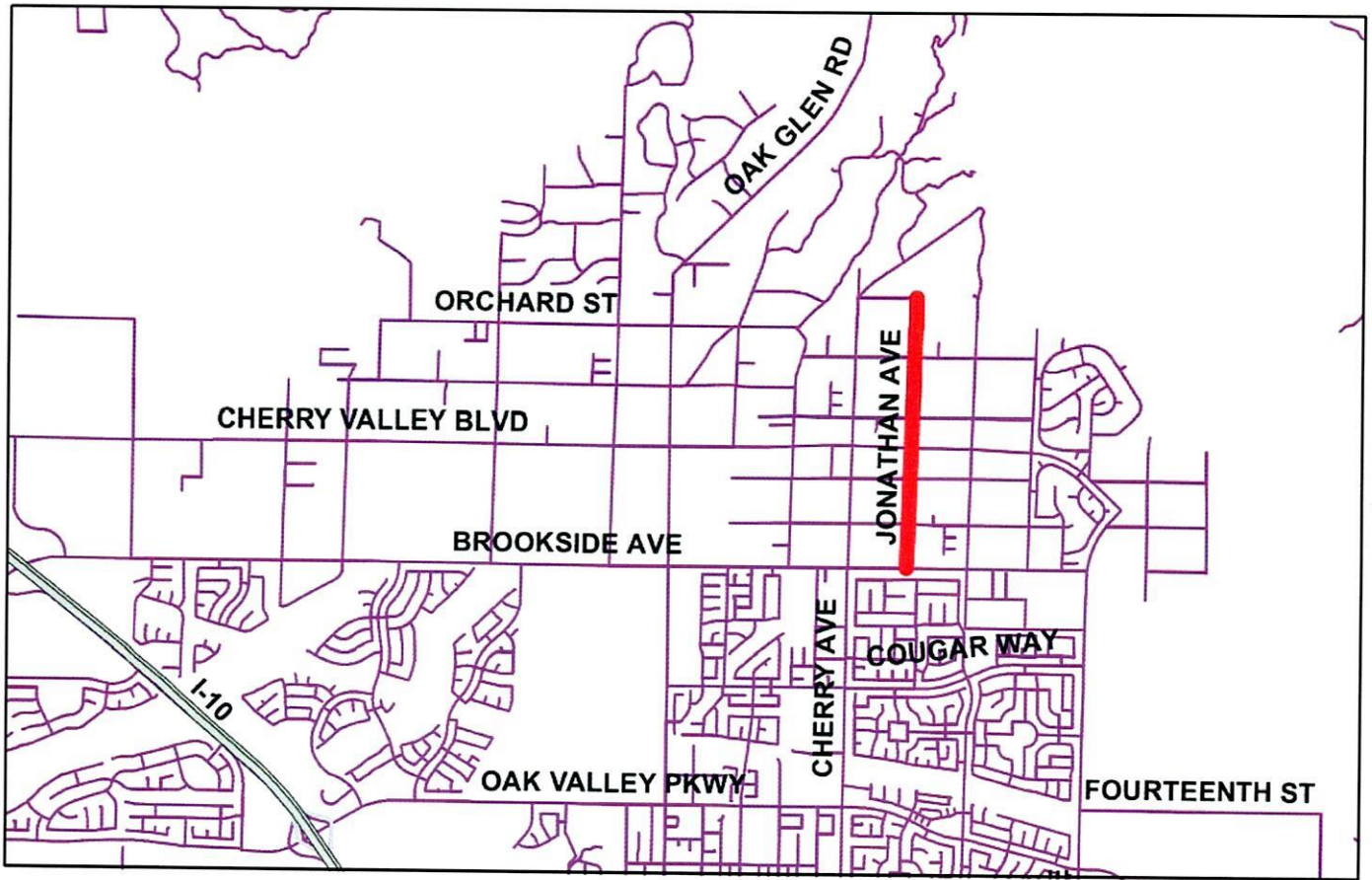
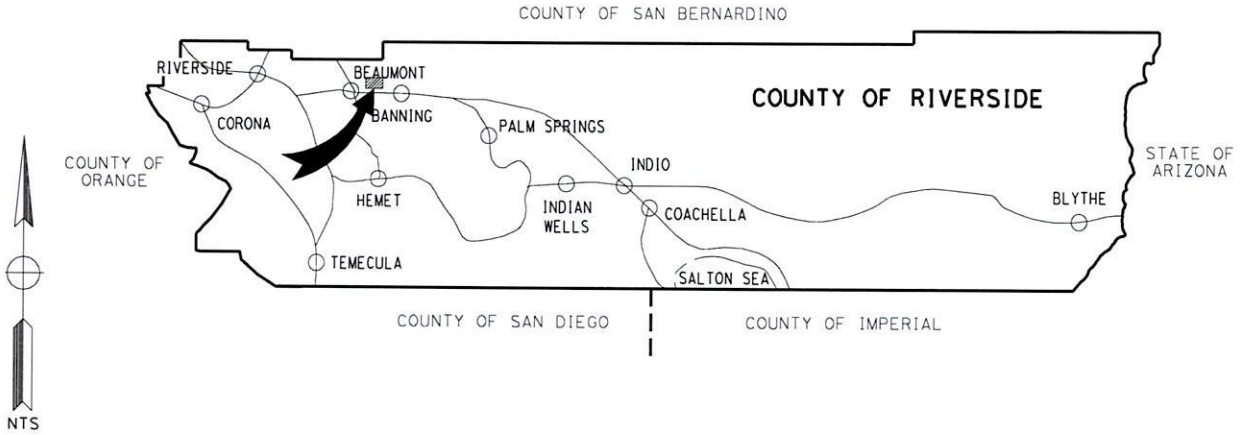

TOWNSHIP 2S RANGE 1W
COUNTY ROADBOOK PAGE No. 90

VICINITY MAP

COUNTY OF RIVERSIDE
TRANSPORTATION DEPARTMENT

HOMELAND AREA
RESURFACING PROJECT

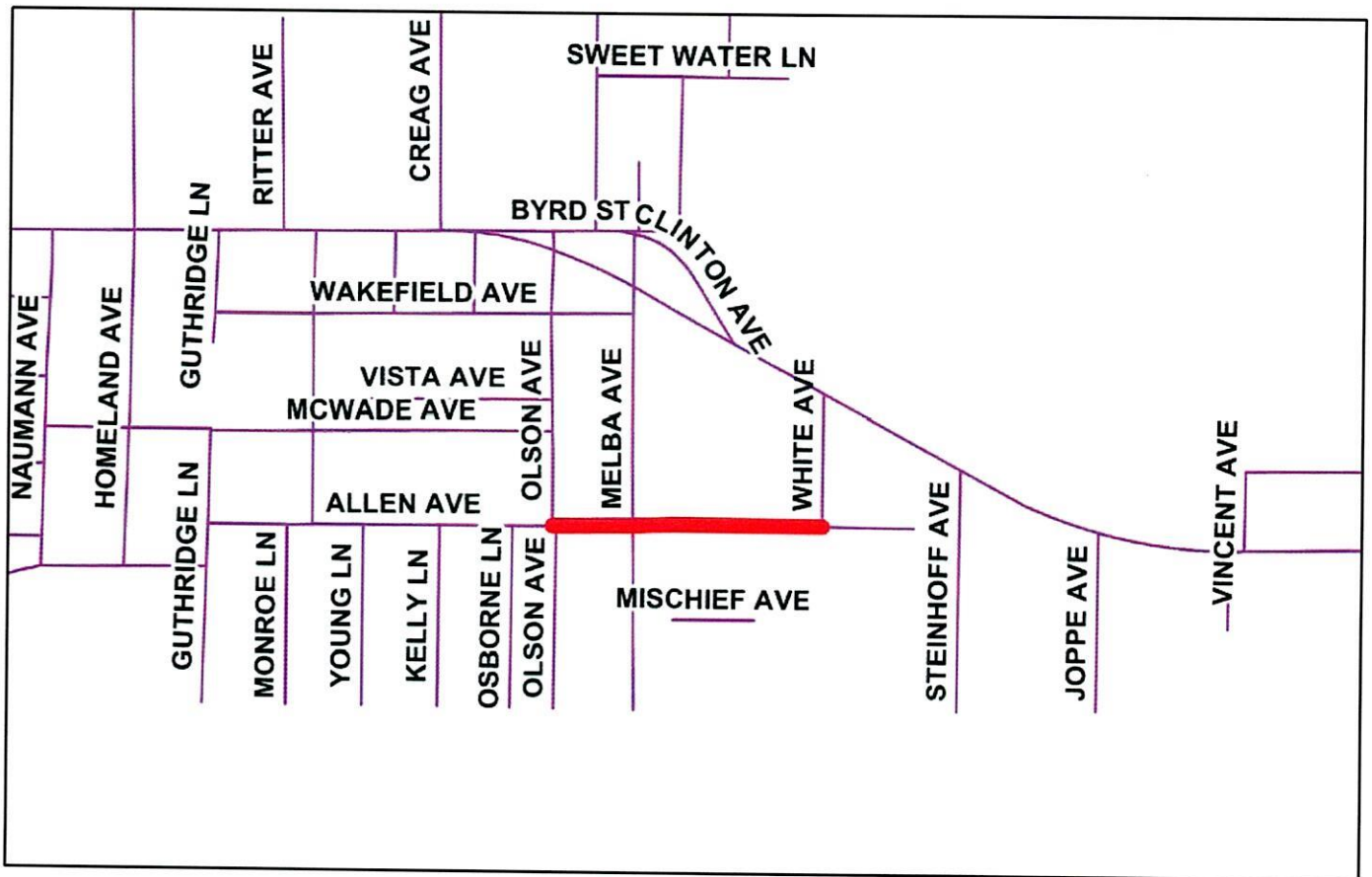
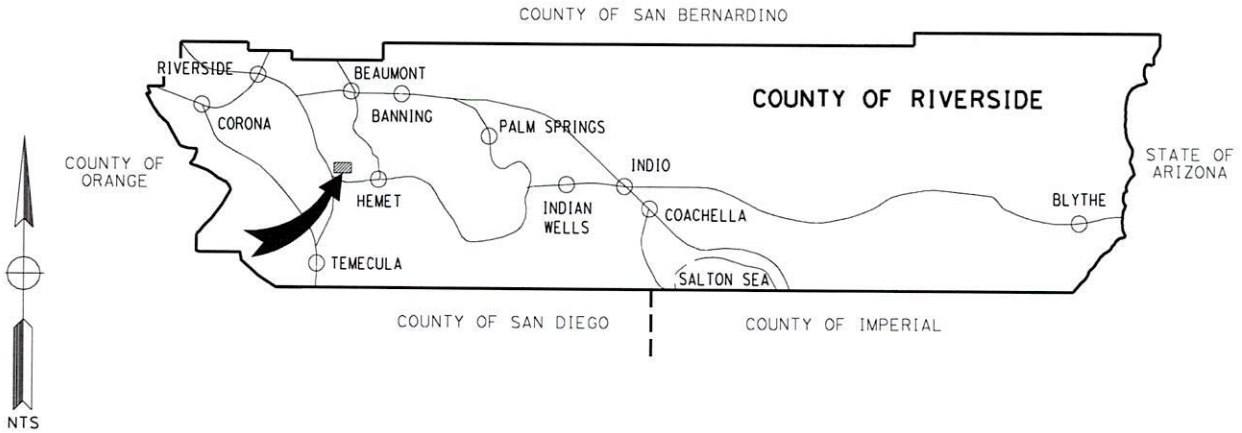

TOWNSHIP 5S RANGE 2W
COUNTY ROADBOOK PAGE No. 103B

VICINITY MAP

COUNTY OF RIVERSIDE TRANSPORTATION DEPARTMENT

HOMELAND AREA RESURFACING PROJECT

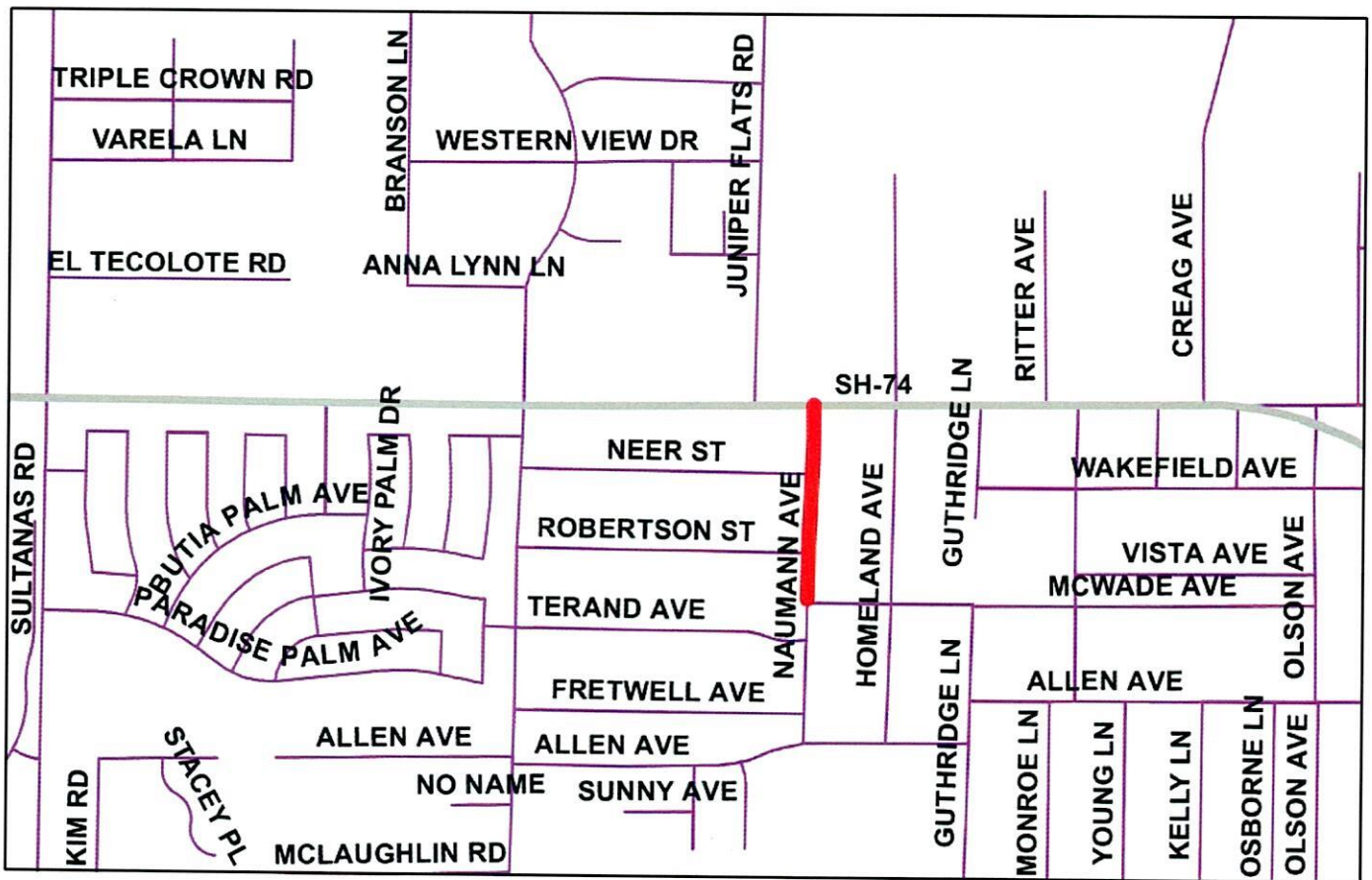
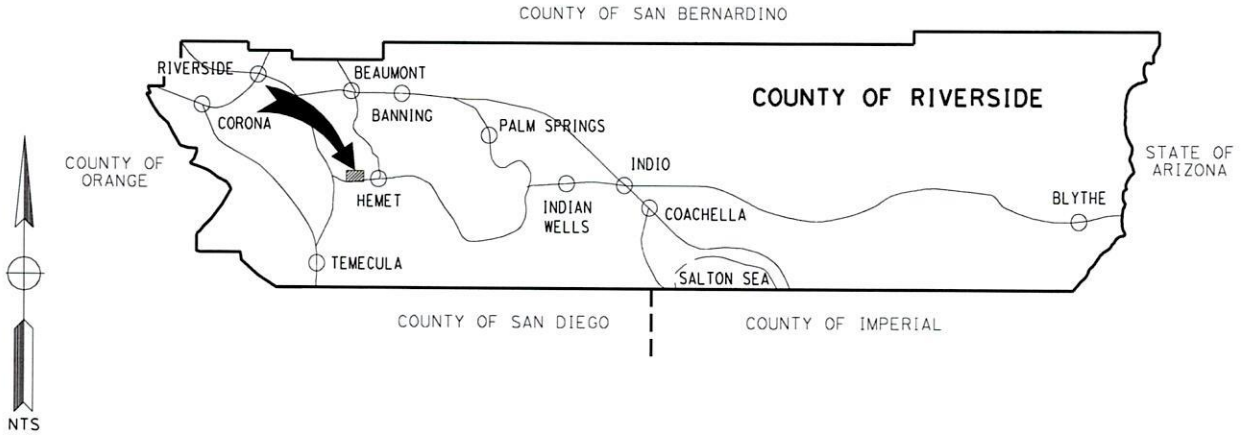

TOWNSHIP 5S RANGE 2W
COUNTY ROADBOOK PAGE No. 103B

VICINITY MAP

COUNTY OF RIVERSIDE
TRANSPORTATION DEPARTMENT

HOMELAND AREA
RESURFACING PROJECT

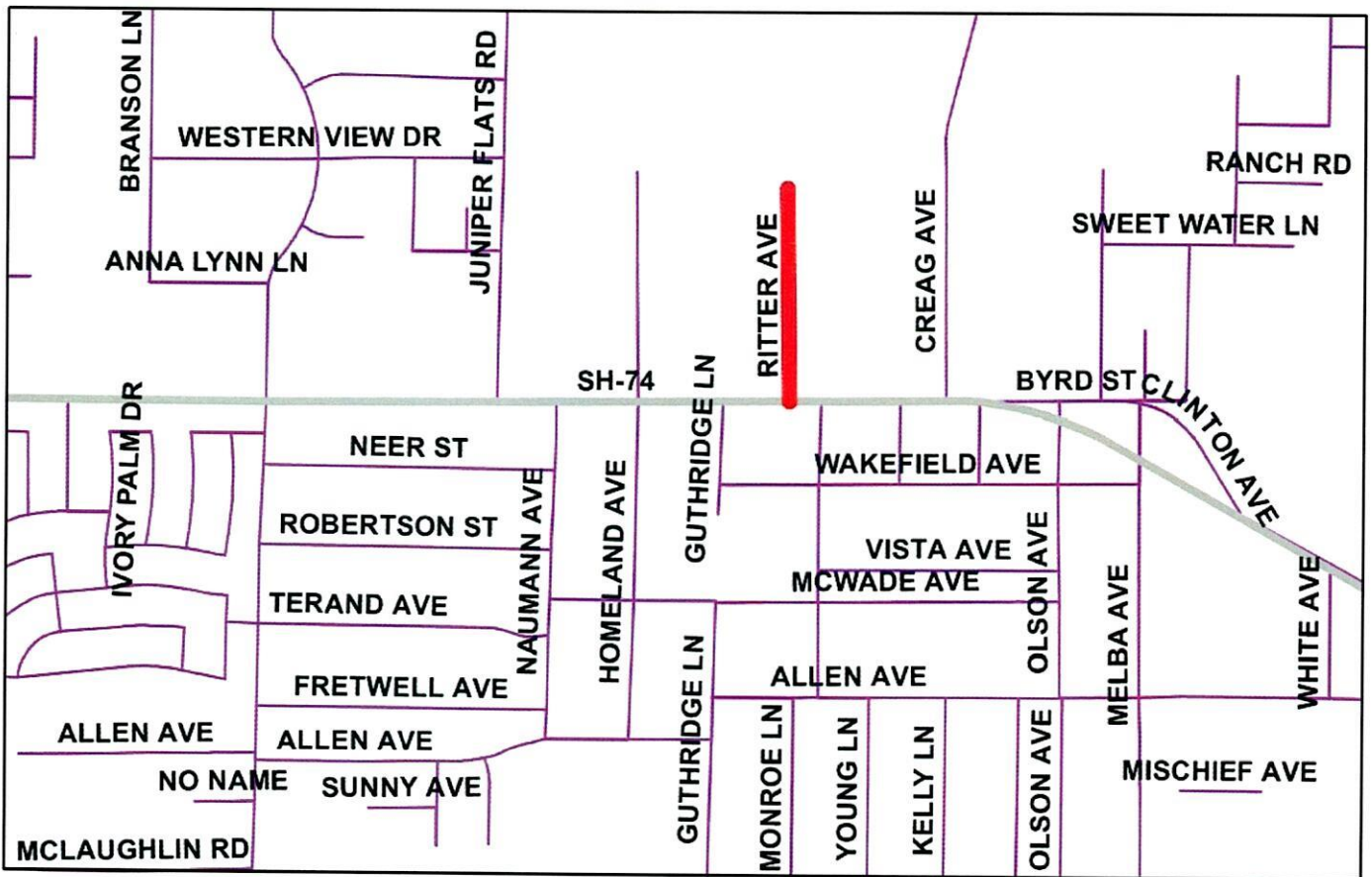
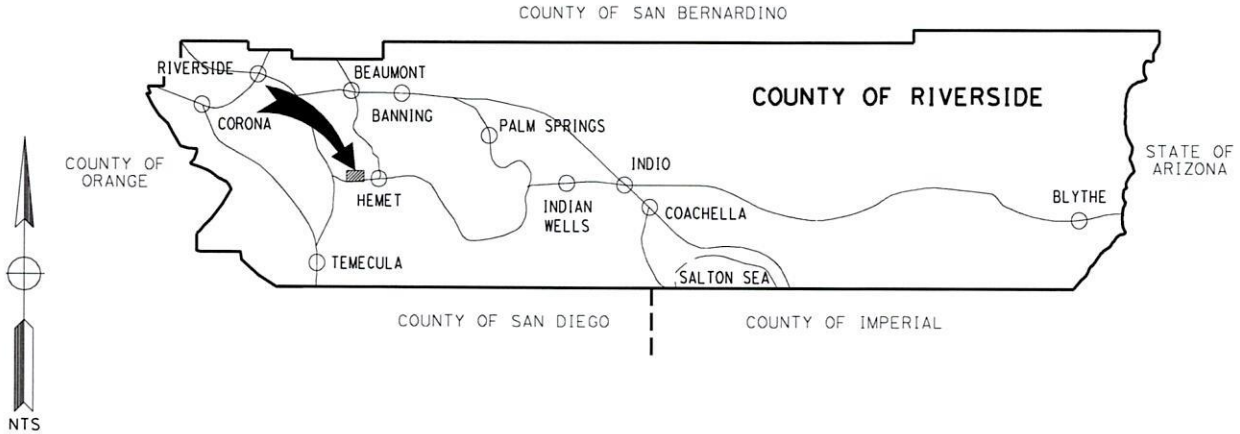

TOWNSHIP 5S RANGE 2W
COUNTY ROADBOOK PAGE No. 103B

VICINITY MAP

COUNTY OF RIVERSIDE TRANSPORTATION DEPARTMENT

HOMELAND AREA RESURFACING PROJECT

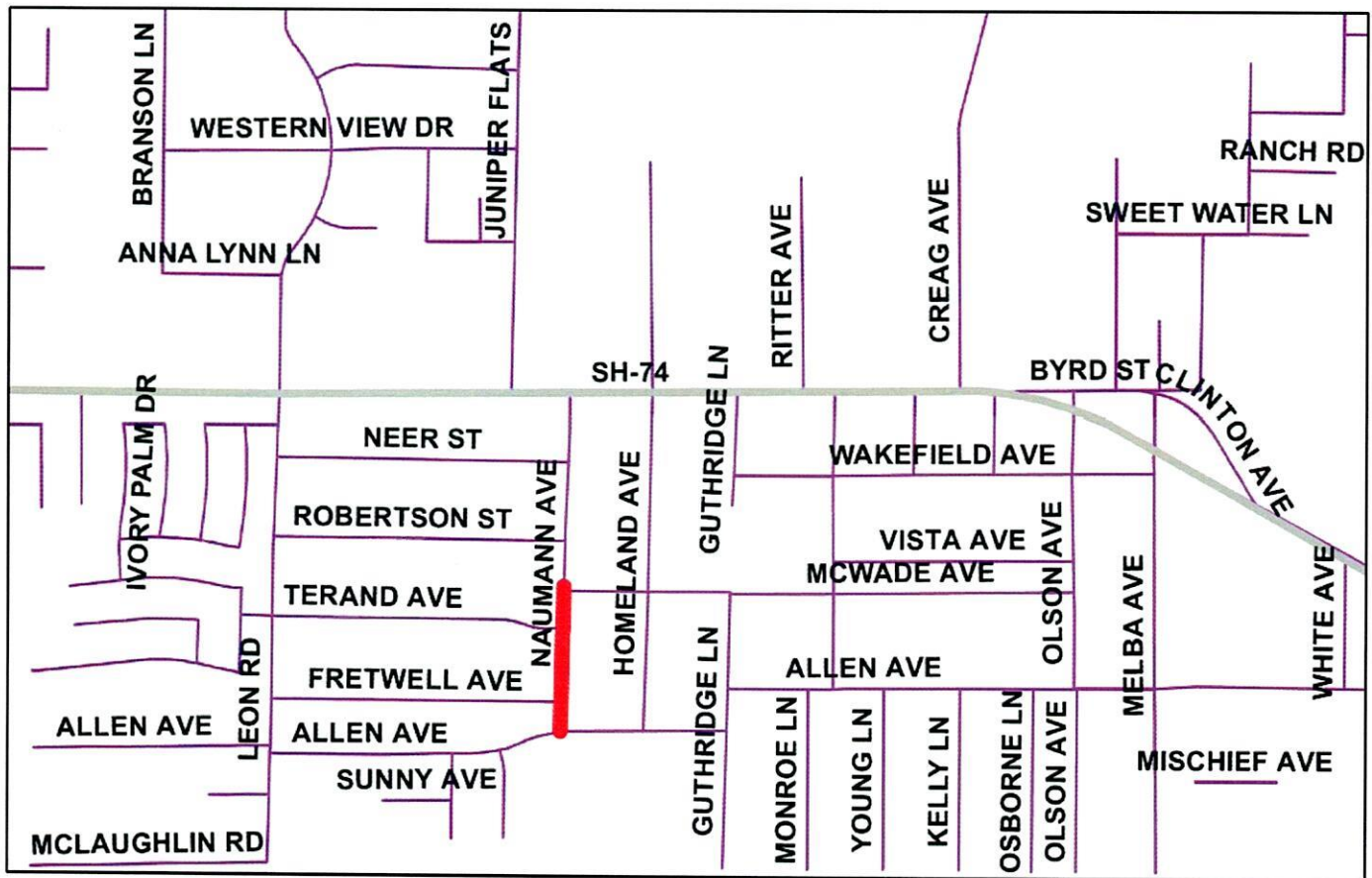
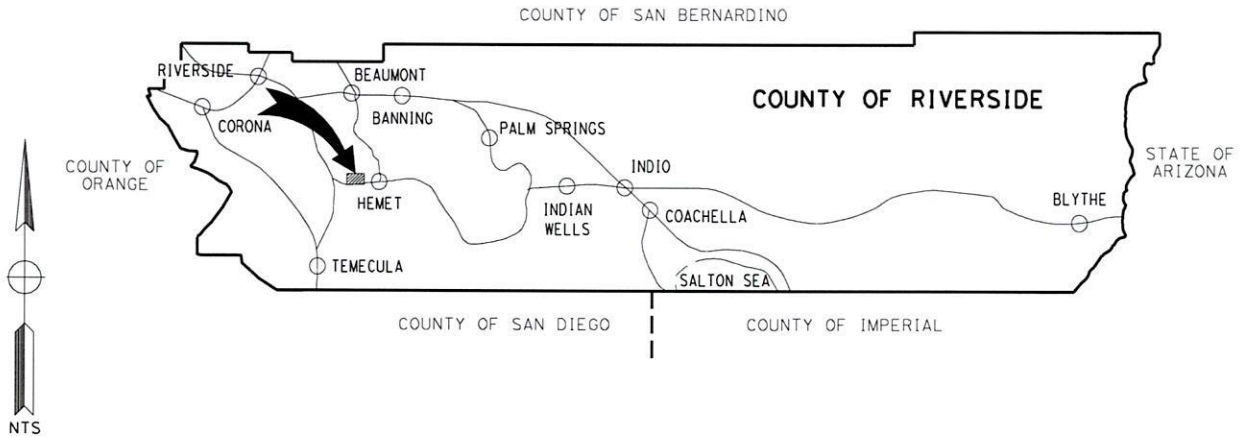

TOWNSHIP 5S RANGE 2W
COUNTY ROADBOOK PAGE No. 103B

VICINITY MAP

COUNTY OF RIVERSIDE TRANSPORTATION DEPARTMENT

ANZA AREA RESURFACING PROJECT

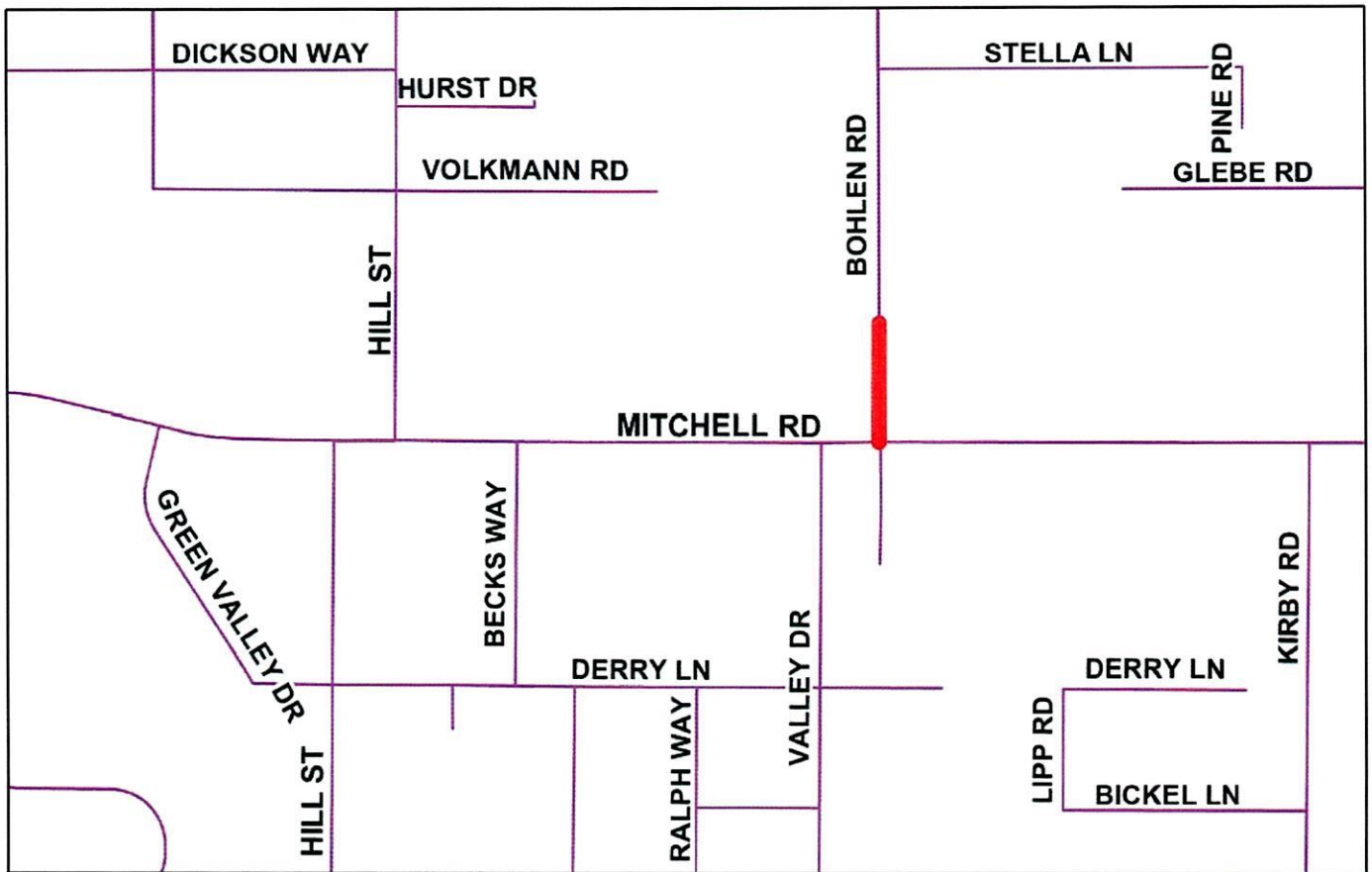
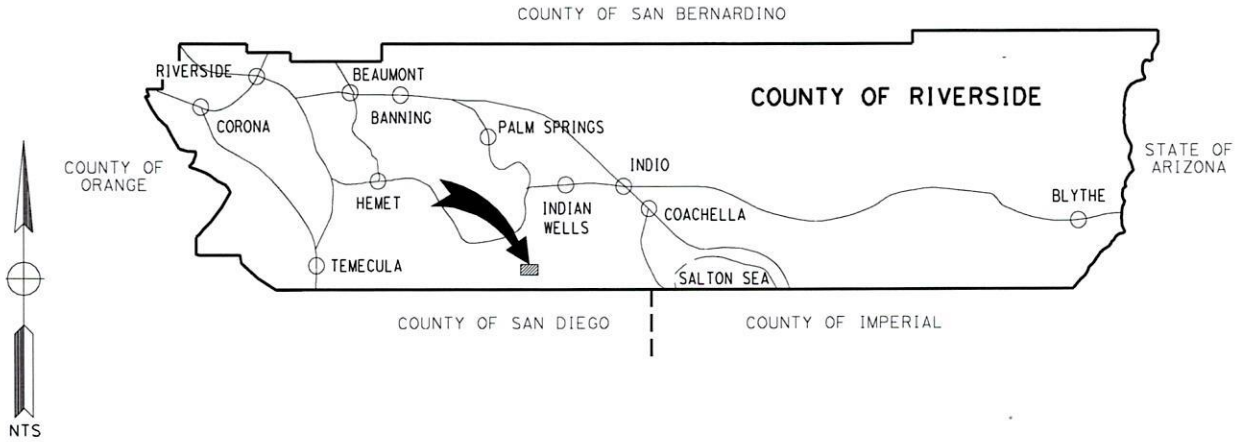

TOWNSHIP 7S RANGE 3E
COUNTY ROADBOOK PAGE No. 162A

VICINITY MAP

COUNTY OF RIVERSIDE
TRANSPORTATION DEPARTMENT

WOODCRESS AREA
RESURFACING PROJECT

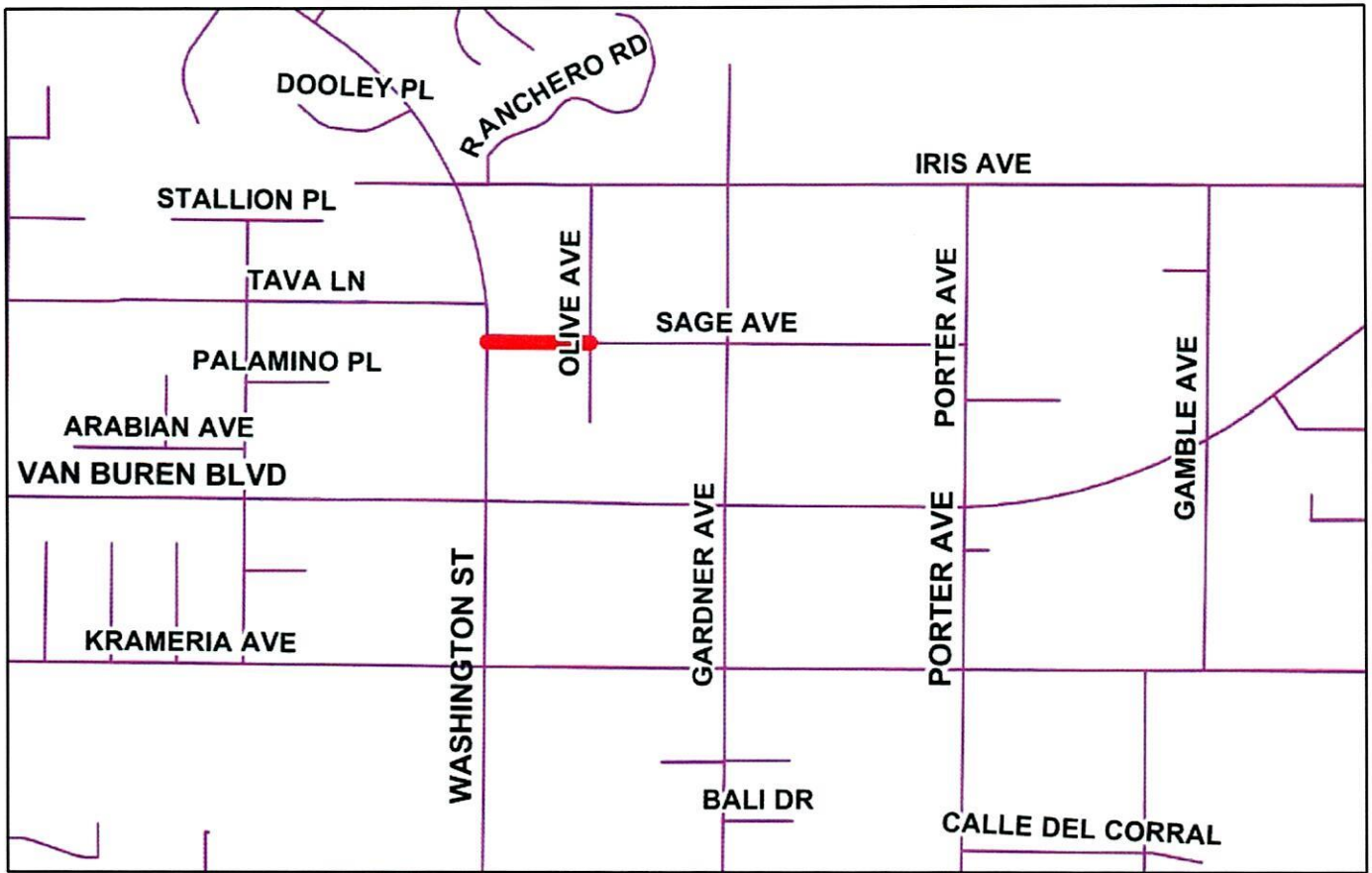
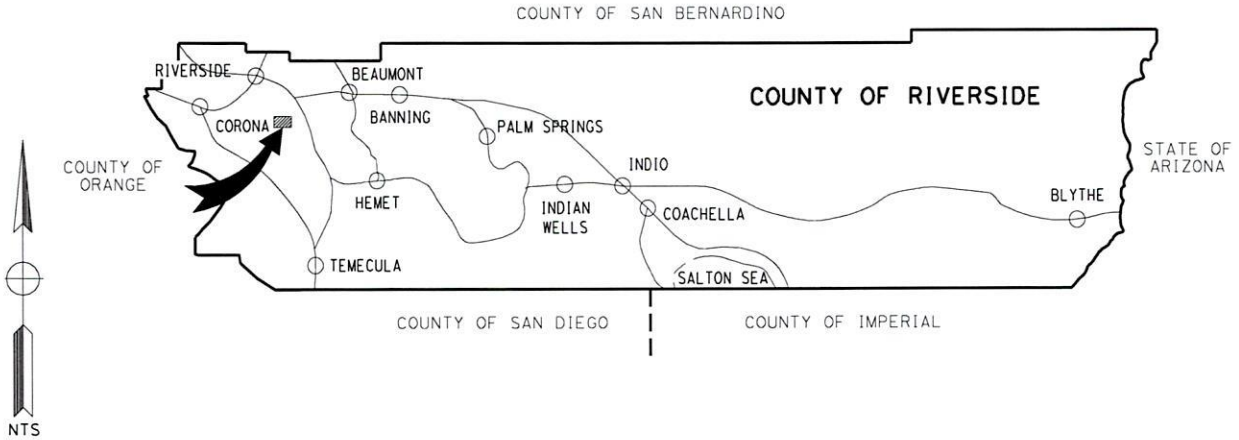

TOWNSHIP 3S RANGE 5W
COUNTY ROADBOOK PAGE No. 27

VICINITY MAP

COUNTY OF RIVERSIDE
TRANSPORTATION DEPARTMENT

PERRIS AREA
RESURFACING PROJECT

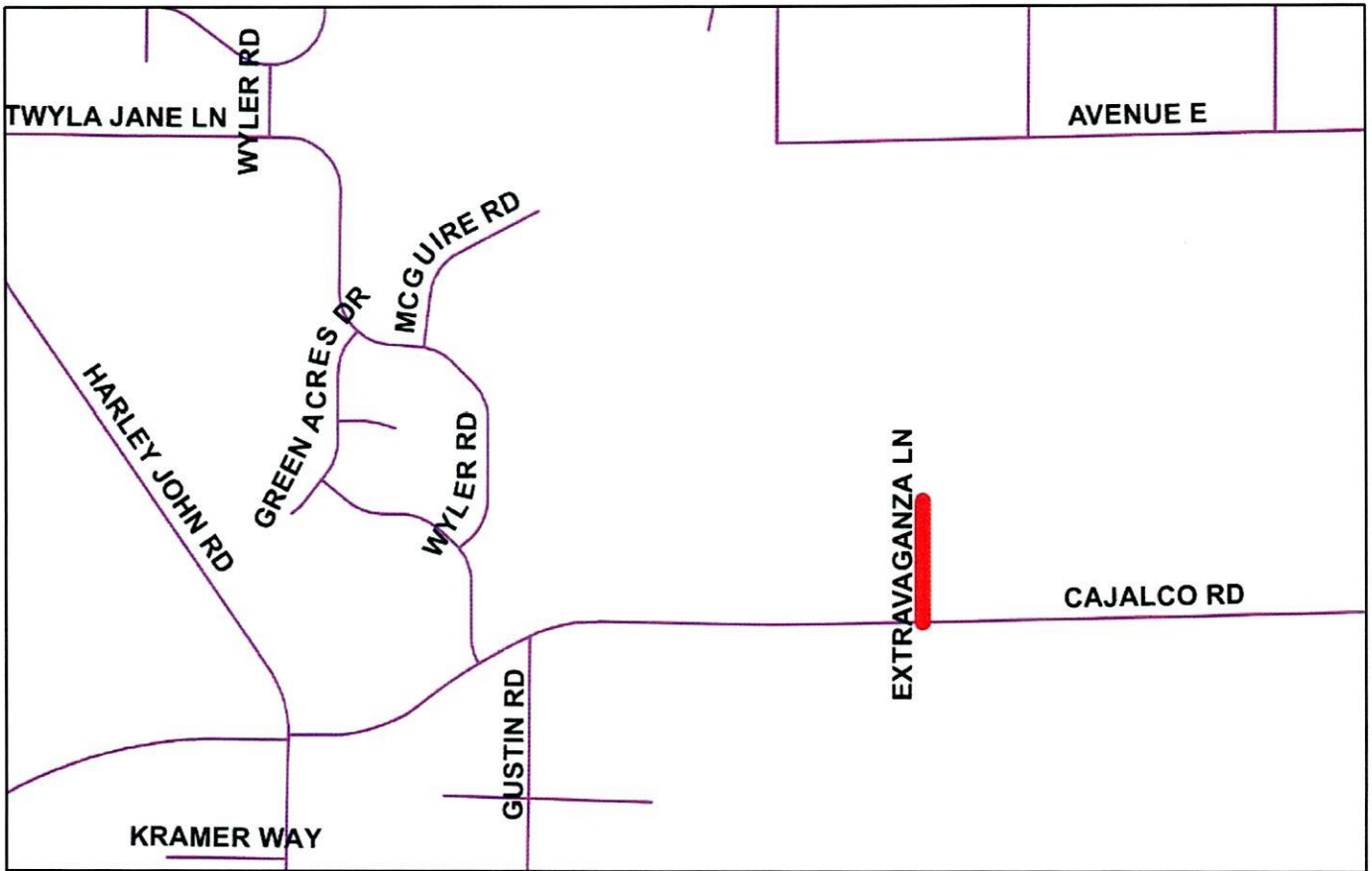
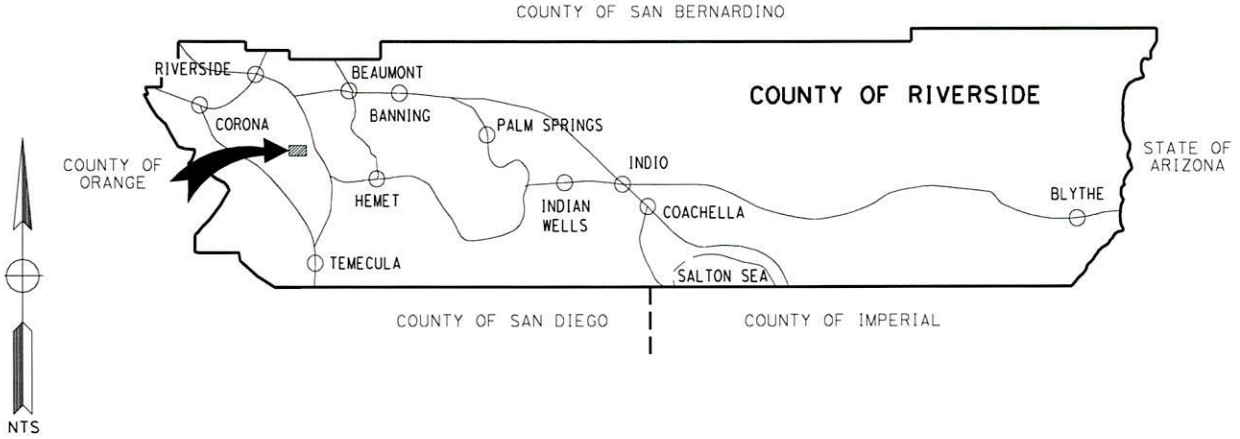

TOWNSHIP 4S RANGE 4W
COUNTY ROADBOOK PAGE No. 57B

VICINITY MAP

COUNTY OF RIVERSIDE
TRANSPORTATION DEPARTMENT

WOODCREST AREA
RESURFACING PROJECT

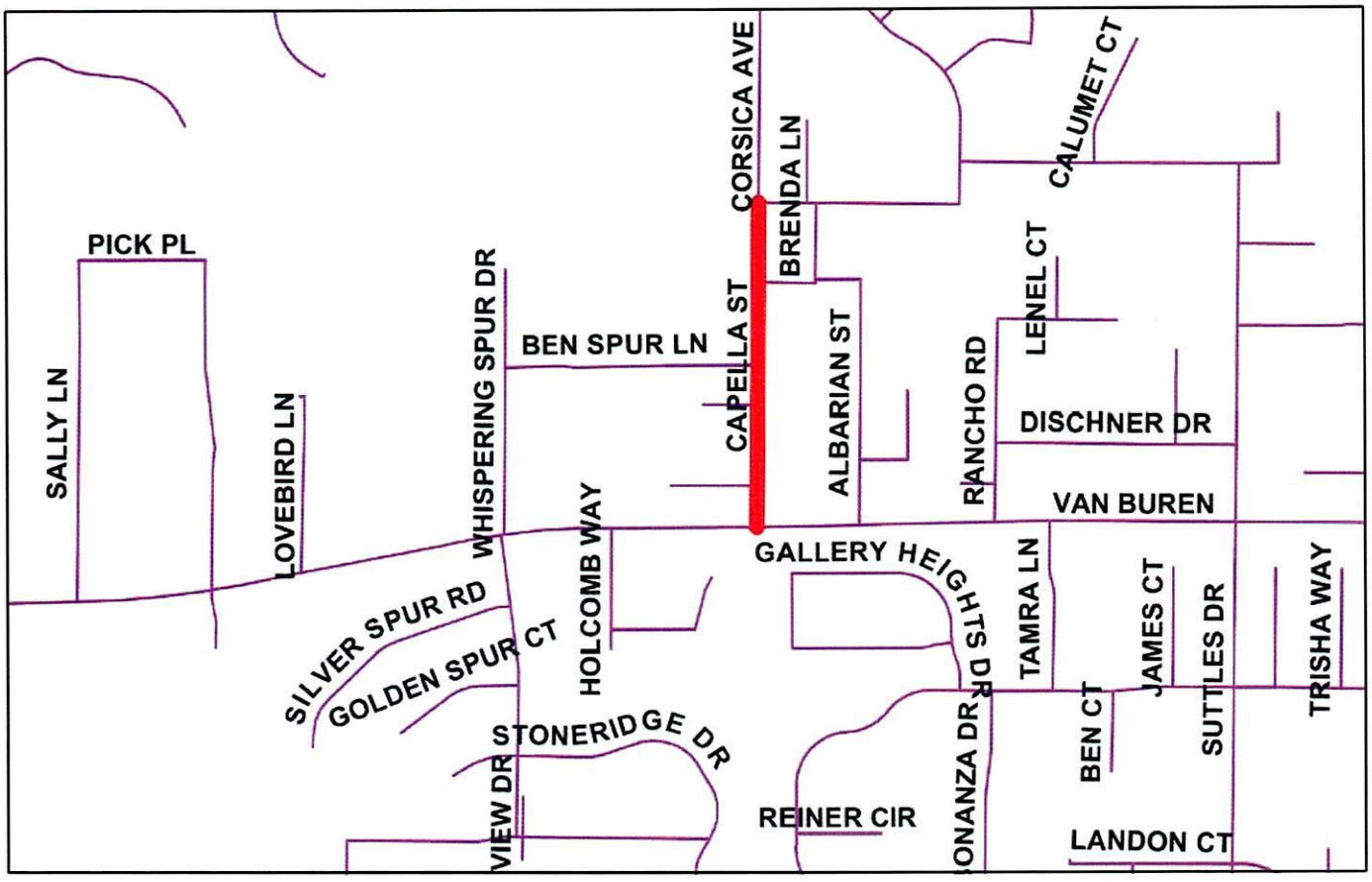
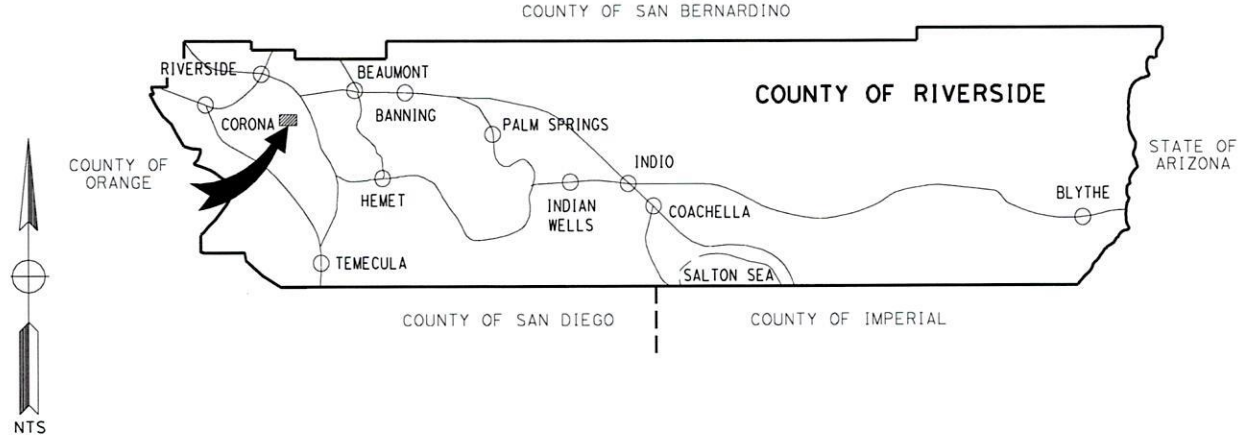

TOWNSHIP 3S RANGE 5W
COUNTY ROADBOOK PAGE No. 27

VICINITY MAP

COUNTY OF RIVERSIDE
TRANSPORTATION DEPARTMENT

**TEMECULA AREA
RESURFACING PROJECT**

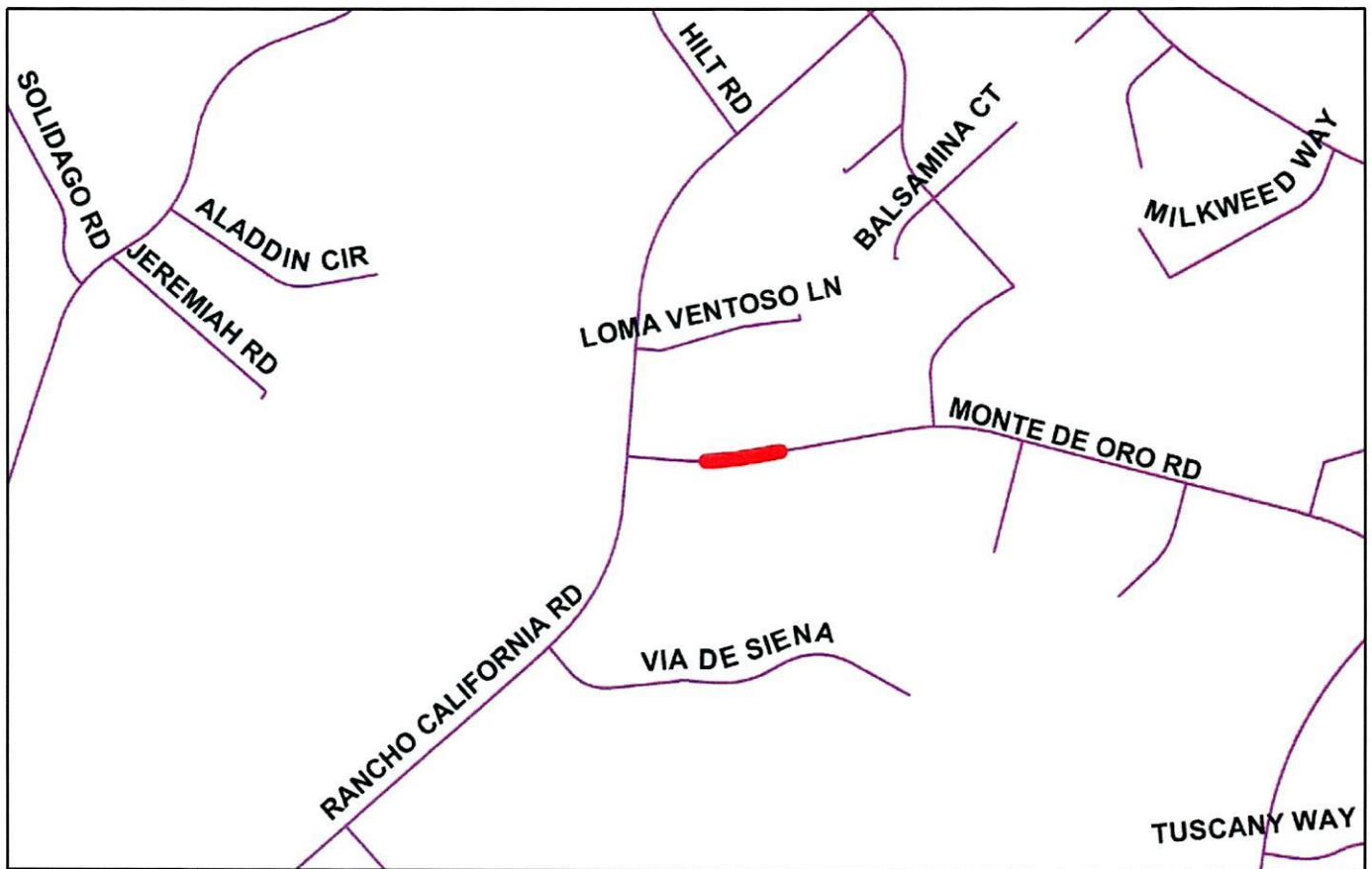
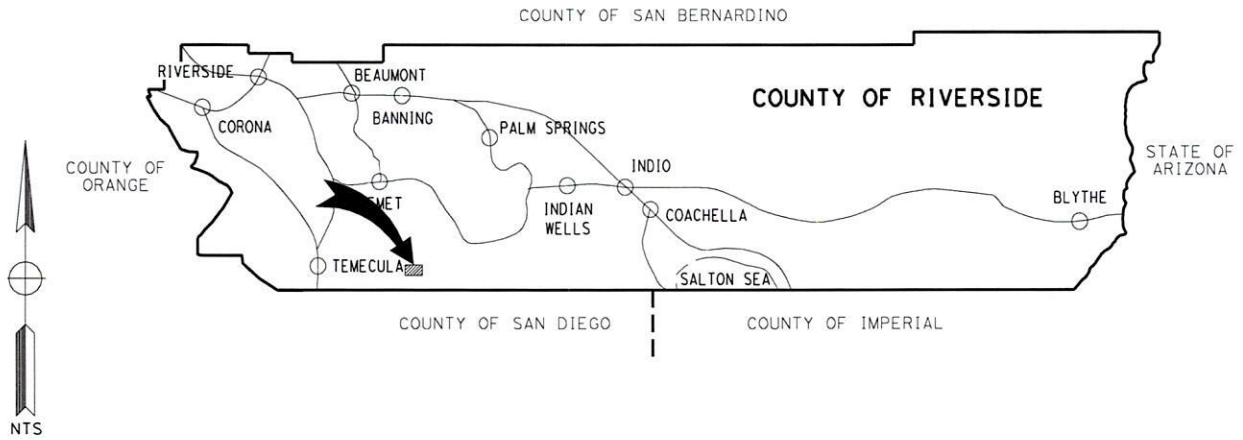

TOWNSHIP 7S RANGE 2W
COUNTY ROADBOOK PAGE No. 129

VICINITY MAP

COUNTY OF RIVERSIDE
TRANSPORTATION DEPARTMENT

WOODCRESS AREA
RESURFACING PROJECT

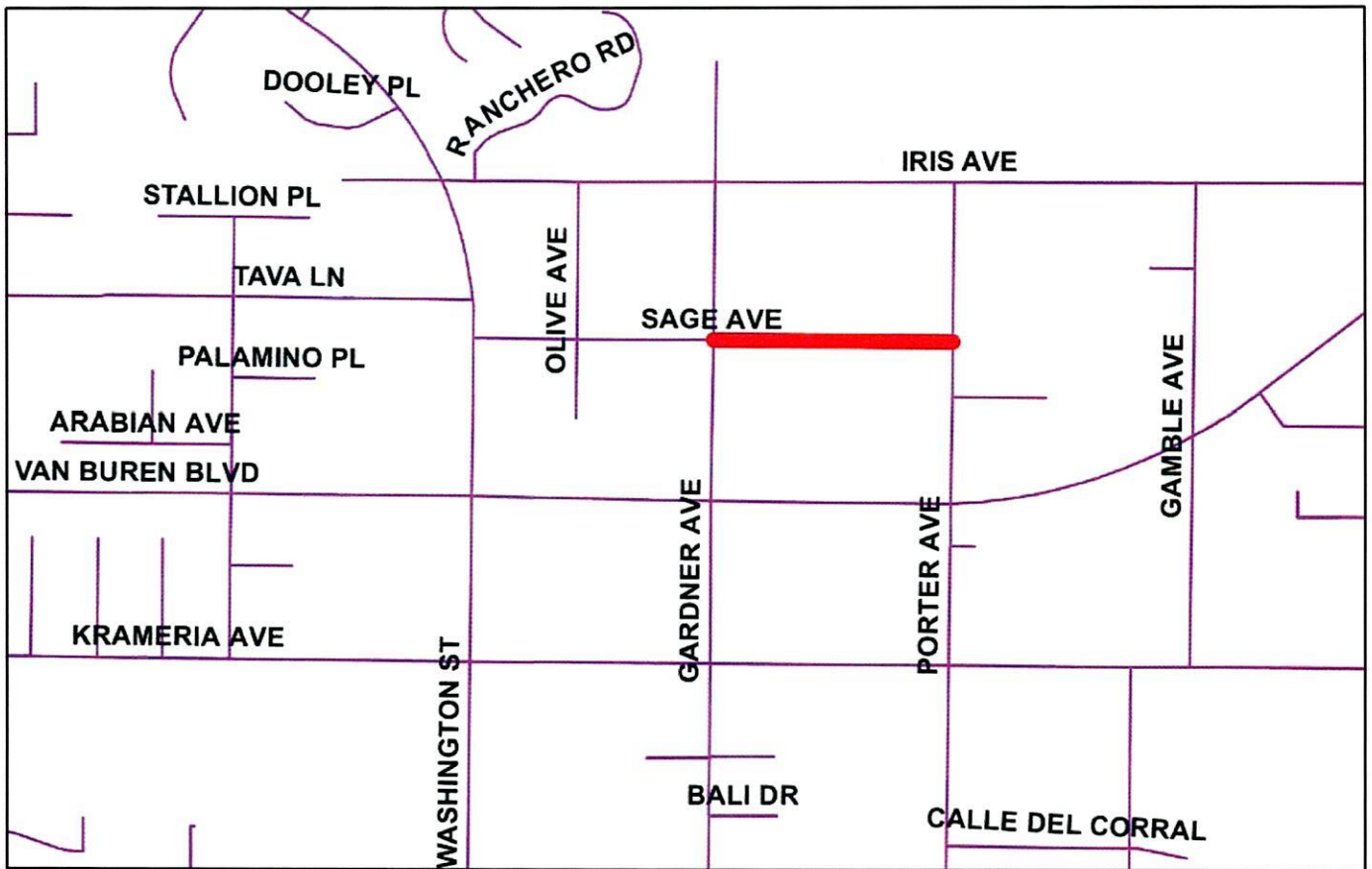
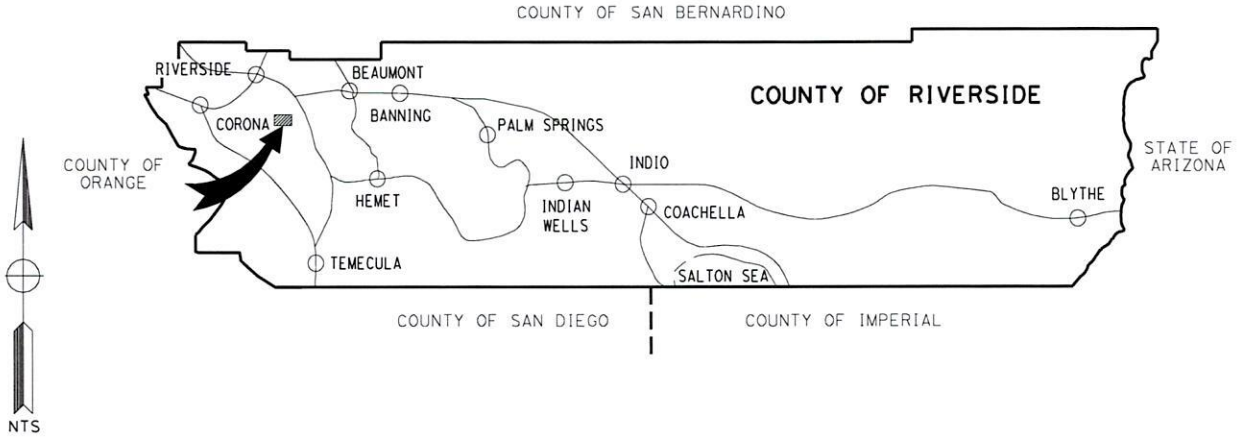

TOWNSHIP 3S RANGE 5W
COUNTY ROADBOOK PAGE No. 27

VICINITY MAP

I. Homeland Area

Project No.	Road Name	From	To	Construction Cost (\$)
D00046	Allen Avenue	Olson Avenue	White Avenue	225000
D00047	Naumann Avenue	Allen Avenue	N'LY Allen Avenue 0.15 mi	141000
D00049	Naumann Avenue	N'LY Allen Avenue 0.15 mi	S.H. 74	187000
D00048	Ritter Avenue	S.H. 74	N'LY S.H. 74 0.22mi	186,000
				739000

Gas Tax	CDBG	Totals
739,000	0	739,000

II Riverside Area

Project No.	Road Name	From	To	Construction Cost (\$)
D00094	Sage Avenue	Washington Street	Olive Avenue	250000
D10098	Sage Avenue	Gardner Avenue	Porter Avenue	300000
D00097	Capella Street	Van Buren Blvd	Summit Crest Drive	350000
D00095	Extravaganza Lane	Cajalco Road	N'LY End	248000
				Subtotal 1,148,000

Gas Tax	CDBG	Totals
1,148,000	0	1,148,000

III. Anza Area

Project No.	Road Name	From	To	Construction Cost (\$)
A20149	Bohlen Road	N'LY Mitchell Road 0.15mi	N'LY Mitchwell Road .78 mi	529000
D00051	Bohlen Road	Mitchell Road	N'LY Mitchell Road 0.16mi	137,000
				Subtotal 666,000

Gas Tax	CDBG	Totals
666,000	0	666,000

IV. Temecula Area

Project No.	Road Name	From	To	Construction Cost (\$)
D10040	Monte De Oro Road	Rancho California Road	S. Camino Vino 0.09 mi	725,000
				725,000

Gas Tax	CDBG	Totals
725,000	0	725,000

V. Cherry Valley Area

Project No.	Road Name	From	To	Construction Cost (\$)
D00045	Jonathan Avenue	Brookside Avenue	N'LY Brookside Avenue 1.12 mi	750000
				Subtotal 750,000

Gas Tax	CDBG	Totals
750,000	0	750,000

VI. Parris Area

Project No.	Road Name	From	To	Construction Cost (\$)
C90028	Deprad Street	Marshall Street	Cowie Street	328000
C90029	Deprad Street	Cowie Street	Cox Street	341000
C90030	Depard Street	Cox Street	660' East of Cox Street	80000
				Subtotal 749,000

Gas Tax	CDBG	Totals
749,000	0	749,000

Grand Total 4,777,000

Fund Source	4,777,000	0	4,777,000
Percent %	100.00%	0.00%	100.00%