

**SUBMITTAL TO THE BOARD OF SUPERVISORS  
COUNTY OF RIVERSIDE, STATE OF CALIFORNIA**



**ITEM: 3.21  
(ID # 13466)**

**MEETING DATE:**  
Tuesday, October 06, 2020

**FROM :** TLMA-TRANSPORTATION:

**SUBJECT:** TRANSPORTATION AND LAND MANAGEMENT AGENCY/TRANSPORTATION:  
Notice of Completion – Curb Ramp Accessibility Project, in the Communities of Mecca and Bermuda Dunes. District 4. [\$0]

**RECOMMENDED MOTION:** That the Board of Supervisors:

1. Accept as complete the construction of Curb Ramp Accessibility Project, in the Communities of Mecca and Bermuda Dunes;
2. Authorize the Chairman of the Board to execute the Notice of Completion on behalf of the County; and
3. Direct the Clerk of the Board to record the Notice of Completion.

**ACTION:Policy**

Patricia Romo, Director of Transportation 9/17/2020

---

**MINUTES OF THE BOARD OF SUPERVISORS**

On motion of Supervisor Jeffries, seconded by Supervisor Perez and duly carried by unanimous vote, IT WAS ORDERED that the above matter is approved as recommended.

Ayes: Jeffries, Spiegel, Washington, Perez and Hewitt  
Nays: None  
Absent: None  
Date: October 06, 2020  
xc: Transp.

Kecia R. Harper  
Clerk of the Board  
By:   
Deputy

**SUBMITTAL TO THE BOARD OF SUPERVISORS COUNTY OF RIVERSIDE,  
STATE OF CALIFORNIA**

<b>FINANCIAL DATA</b>	<b>Current Fiscal Year:</b>	<b>Next Fiscal Year:</b>	<b>Total Cost:</b>	<b>Ongoing Cost</b>
<b>COST</b>	\$ 0	\$ 0	\$ 0	\$ 0
<b>NET COUNTY COST</b>	\$ 0	\$ 0	\$ 0	\$ 0
<b>SOURCE OF FUNDS: N/A</b>			<b>Budget Adjustment:</b>	NA
			<b>For Fiscal Year:</b>	20/21

**C.E.O. RECOMMENDATION:** Approve

**BACKGROUND:**

**Summary**

On February 11, 2020, agenda item 3.38, the Board of Supervisors entered into a contract with LC Paving and Sealing, Inc. of Escondido, California for the Curb Ramp Accessibility Project in the Communities of Mecca and Bermuda Dunes.

The original authorized amount of the contract was \$468,595. The total price of the contract came in at \$440,358 which is 6% less than the originally authorized amount. The reduction of the total cost was the result of using less quantities than anticipated to complete the work.

The work was completed in conformance with the plans and specifications and the contractor was granted relief of maintenance on July 6, 2020.

D0-0009 – Ramp Upgrades Fiscal Year 2019-2020, Community of Mecca and Bermuda Dunes  
C4-0052 – ADA Ramp Upgrades, Community of Mecca

**Impact on Residents and Businesses**

The curb ramp accessibility project has brought the curb ramps up to current accessibility standards, as required by Title II of the Americans with Disabilities Act; therefore, improving access and safety of pedestrians with disabilities.

**Additional Fiscal Information**

**SUBMITTAL TO THE BOARD OF SUPERVISORS COUNTY OF RIVERSIDE,  
STATE OF CALIFORNIA**

**Budget**

Original Contract Amount		\$468,595
Total Change Orders Authorized	0.0%	\$0
Estimated Pending Change Orders	0.0%	\$0
Authorized Contract Amount		\$468,595
* Quantity Adjustments	-6.0%	(\$28,237)
+ CCO FA Adjustments	0.0%	\$0
Total Amended Contract Amount	94.0%	\$440,358

**Expenditures**

Total Progress Payments		\$440,358
Estimated Pending Payments		\$0
Total Expenditures		\$440,358

**(Over)/Under Contract Amount** \$0

+ Change Orders using the Force Account method of payment issued prior to the work being completed generally do not use the total authorized amount.

\* Caltrans Standard Specifications 9-1.06 (Changed Quantity Payment Adjustments). Increases or decreases in the quantity of a contract item of work will be determined by comparing the total pay quantity of such item of work with the Engineer's Estimate. If the total pay quantity of any item of work required under the contract varies from the Engineer's Estimate by 25 percent or less, payment will be made for the quantity of work of said item performed at the contract unit price, unless eligible for adjustment pursuant to Section 9-1.15, "Work-Character Changes."

This project was funded with \$202,565 of Gas Tax/HUTA funds, \$167,336 of SB 821 (Local Transportation Funds) funds and \$70,457 of Measure A/Coachella Valley funds.

**Contract History and Price Reasonableness**

Eight bids were received on November 20, 2019 ranging from \$468,595 to \$945,074. The basis for the selection of a contractor is the lowest responsive and responsible bid. The lowest responsible bid was submitted by LC paving and Sealing, Inc. in the amount of \$468,494, which is \$134,505 (22.3%) lower than the Engineer's Estimate.

**ATTACHMENTS:**

- Vicinity Map
- Progress Estimate Report
- Notice of Completion
- List of Curb Ramps

SUBMITTAL TO THE BOARD OF SUPERVISORS COUNTY OF RIVERSIDE,  
STATE OF CALIFORNIA



Jason Farin, Principal Management Analyst 9/30/2020



Gregory V. Priamos, Director County Counsel 9/25/2020



PETER ALDANA  
COUNTY OF RIVERSIDE  
ASSESSOR-COUNTY CLERK-RECORDER

Recorder  
P.O. Box 751  
Riverside, CA 92502-0751  
(951) 486-7000

www.riversideacr.com

**CERTIFICATION**

Pursuant to the provisions of Government Code 27361.7, I certify under the penalty of perjury that the following is a true copy of illegible wording found in the attached document:

(Print or type the page number(s) and wording below):

CLARIFICATION FOR SEAL for the Riverside County Board of Supervisors  
(EMBOSSSED ON DOCUMENT)



Date:

October 6, 2020

Signature:

Priscilla Rasso

Print Name: Priscilla Rasso, Board Assistant



**Peter Aldana**  
**Riverside County**  
**Assessor-County Clerk-Recorder**  
2724 Gateway Drive  
Riverside, CA 92507  
(951) 486-7000  
www.riversideacr.com

Receipt: 20-353399

Product	Name	Extended
126	NOTICE COMPLETION	\$0.00
	Document #	2020-0490084
	# Pages	2
<b>Total</b>		\$0.00
Change (Cash)		\$0.00

COUNTY OF RIVERSIDE  
TRANSPORTATION DEPARTMENT

**CURB RAMP  
ACCESSIBILITY PROJECT**

COMMUNITIES OF MECCA  
AND BERMUDA DUNES

PROJECT No. C4-0052, D0-0009

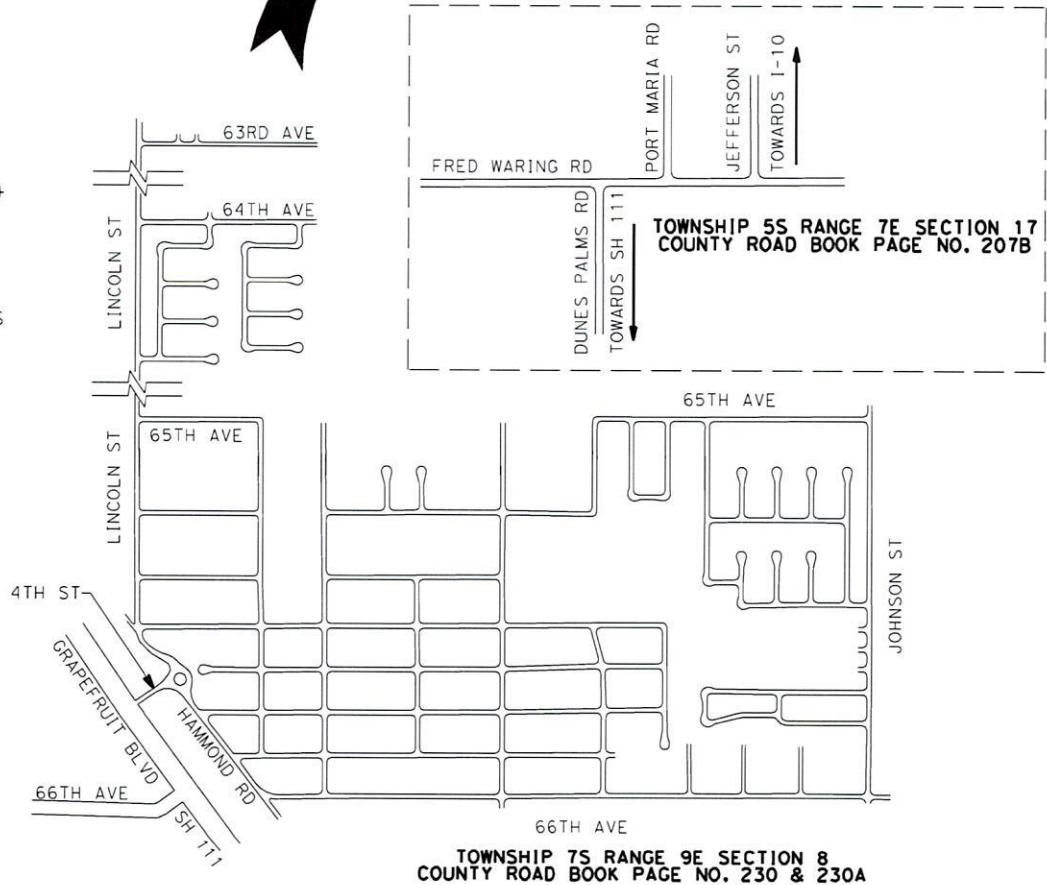
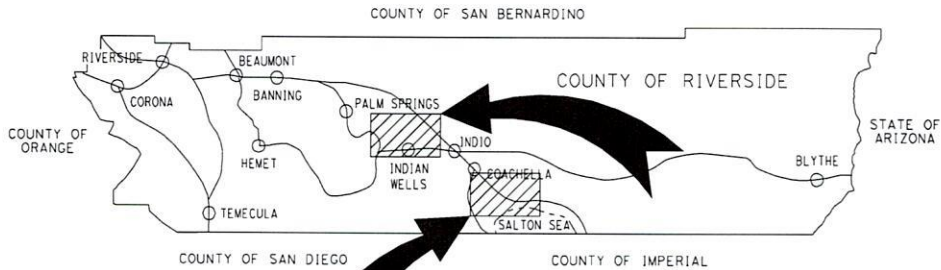

**VICINITY MAP**



**PROJECT:** Curb Ramp Accessibility Project, Communities of Mecca and Bermuda Dunes  
**County Project No.:** C4-0052 and D0-0009  
**Contract No.** 20-01-004

**Contractor:** LC Paving & Sealing, Inc.  
**Address:** 620 Alpine Way  
**City, State, Zip:** Escondido, CA 92029



**Estimate No.** 5 Final  
**From:** July 26, 2020  
**To:** August 25, 2020

Item No.	Item Description	Units	Quantity	Unit Price	Original Contract Amount	Change Orders		Amended Contract		This Estimate		Previous Quantity	Total Estimate To Date		% Auth.
						Quantity	Amount	Quantity	Amount	Quantity	Amount		Quantity	Amount	
<b>Project No. D0-0009</b>															
1	DUST CONTROL	LS	1	1,000.00	1,000.00			1.00	1,000.00			1.00	1.00	1,000.00	100%
2	PREPARE WATER POLLUTION CONTROL PROGRAM	LS	1	2,000.00	2,000.00			1.00	2,000.00			1.00	1.00	2,000.00	100%
3	TRAFFIC CONTROL SYSTEM	LS	1	8,500.00	8,500.00			1.00	8,500.00			1.00	1.00	8,500.00	100%
4	REMOVE ASPHALT CONCRETE	SQYD	220	22.70	4,994.00			220.00	4,994.00			273.60	273.60	6,210.72	124%
5	HOT MIX ASPHALT (TYPE A)	TON	78	160.00	12,480.00			78.00	12,480.00			59.18	59.18	9,468.80	76%
6	MINOR CONCRETE (SPANDREL) (CRS 209)	SQFT	160	17.00	2,720.00			160.00	2,720.00			110.80	110.80	1,883.60	69%
7	MINOR CONCRETE (CURB RAMP) (CRS 403 - CASE A)	EA	1	4,800.00	4,800.00			1.00	4,800.00			1.00	1.00	4,800.00	100%
8	MINOR CONCRETE (CURB RAMP) (CRS 403 - CASE B)	EA	5	4,165.00	20,825.00			5.00	20,825.00			4.00	4.00	16,660.00	80%
9	MINOR CONCRETE (MISCELLANEOUS CONSTRUCTION) [PARTIAL]	SQFT	480	16.00	7,680.00			480.00	7,680.00			574.60	574.60	9,193.60	120%
10	MINOR CONCRETE (CURB AND GUTTER)	LF	850	42.00	35,700.00			850.00	35,700.00			880.50	880.50	36,981.00	104%
11	MISCELLANEOUS DIRECTED WORK	FA	1	12,500.00	12,500.00			1.00	12,500.00			0.250	0.250	3,125.00	25%
<b>Project No. C4-0052</b>															
12	DUST CONTROL	LS	1	1,000.00	1,000.00			1.00	1,000.00			1.00	1.00	1,000.00	100%
13	PREPARE WATER POLLUTION CONTROL PROGRAM	LS	1	5,000.00	5,000.00			1.00	5,000.00			1.00	1.00	5,000.00	100%
14	TRAFFIC CONTROL SYSTEM	LS	1	25,000.00	25,000.00			1.00	25,000.00			1.00	1.00	25,000.00	100%
15	REMOVE ASPHALT CONCRETE	SQYD	50	22.70	1,135.00			50.00	1,135.00			60.00	60.00	1,362.00	120%
16	HOT MIX ASPHALT (TYPE A)	TON	15	160.00	2,400.00			15.00	2,400.00			9.04	9.04	1,446.40	60%
17	MINOR CONCRETE (SPANDREL) (CRS 209)	SQFT	280	17.00	4,760.00			280.00	4,760.00			171.80	171.80	2,920.60	61%
18	MINOR CONCRETE (CURB RAMP) (CRS 403 - CASE A)	EA	57	4,800.00	273,600.00			57.00	273,600.00			56.00	56.00	268,800.00	98%
19	MINOR CONCRETE (CURB RAMP) (CRS 403 - CASE B)	EA	1	4,165.00	4,165.00			1.00	4,165.00			1.00	1.00	4,165.00	100%
20	MINOR CONCRETE (MISCELLANEOUS CONSTRUCTION) [PARTIAL]	SQFT	256	16.00	4,096.00			256.00	4,096.00			320.00	320.00	5,120.00	125%

PROJECT: Curb Ramp Accessibility Project, Communities of Mecca and Bermuda Dunes  
 County Project No.: C4-0052 and D0-0009  
 Contract No. 20-01-004

Contractor: LC Paving & Sealing, Inc.  
 Address: 620 Alpine Way  
 City, State, Zip: Escondido, CA 92029

Estimate No. 5 Final  
 From: July 26, 2020  
 To: August 25, 2020



Item No.	Item Description	Units	Quantity	Unit Price	Original Contract Amount	Change Orders		Amended Contract		This Estimate		Previous Quantity	Total Estimate To Date		% Auth.
						Quantity	Amount	Quantity	Amount	Quantity	Amount		Quantity	Amount	
21	MINOR CONCRETE (CURB AND GUTTER)	LF	120	42.00	5,040.00			120.00	5,040.00			42.00	42.00	1,764.00	35%
22	MINOR CONCRETE (CURB RAMP) (CASE C)	EA	1	2,500.00	2,500.00			1.00	2,500.00			1.00	1.00	2,500.00	100%
23	CURB RAMP DETECTABLE WARNING SURFACE	EA	7	600.00	4,200.00			7.00	4,200.00			7.00	7.00	4,200.00	100%
24	MISCELLANEOUS DIRECTED WORK	FA	1	22,500.00	22,500.00			1.00	22,500.00			0.767	0.767	17,257.50	77%
Project No. D0-0009					113,199.00		0.00	113,199.00		0.00				99,822.72	
Project No. C4-0052					355,396.00		0.00	355,396.00		0.00				340,535.50	
<b>PROJECT TOTAL</b>					468,595.00		0.00	468,595.00		0.00				440,358.22	

Made by: <u>Jim Bonelli</u>	Working Days: 40	Start Date: 4-3-20	
Checked by: <u>TN</u>	Days Added: 22	End Date: 7-6-20	TOTAL VALUE OF WORK TO DATE: \$440,358.22
OK Const. Supv. <u>HD</u>	Subtotal: 62	% \$ Complete: 94%	LESS RETENTION: 5% 22,017.92
	Days Used: 62	Original Contract: \$468,595.00	TOTAL DUE TO DATE: \$418,340.30
	% Time Elapsed: 100%	Amended Contract: \$468,595.00	LESS PREVIOUSLY INVOICED: 418,340.30
			LESS LABOR NON COMPLIANCE: 0.00
			TOTAL DUE THIS PAYMENT: \$0.00

This Estimate Approved: *Patricia Romo* Date: 8/27/2020 for: \$0.00  
 Patricia Romo, Director of Transportation

Received by Accounts Payable: \_\_\_\_\_  
 By: \_\_\_\_\_

Quantities on This Estimate Approved: *LC Paving and Sealing Inc.* Date: 08/26/2020  
 LC Paving and Sealing Inc.

**Payment Approval**

FUND: 20000

DEPT. ID.: 31305

ACCOUNT: 527980

PROJECT: ZC4-0052E, ZD0-0009E

ACTIVITY ID.: Z3500

RESOURCE CNT: \_\_\_\_\_

SIGNATURE: *Lendi A. Wachter*

DATE: 08/26/2020

*ya*  
 08/26/20

Transfiscal Approved  
 By: Lori Conrad 5\*3461  
 Aug 27, 2020

**MECCA CURB RAMP ACESSIBILITY PROJECT  
LIST OF CURB RAMPS**

No.	RAMP #	MAJOR STREET	MINOR STREET	CORNER	TREATMENT
1	230A - 007B	66TH AVE	CROSS WALK	S	PROTECT IN PLACE
2	230A - 011A	2ND ST	DALE KILER RD	NW	PROTECT IN PLACE
3	230A - 011B	2ND ST	DALE KILER RD	NE	PARTIAL RECONSTRUCTION
4	230A - 011C	2ND ST	DALE KILER RD	SE	PARTIAL RECONSTRUCTION
5	230A - 011D	2ND ST	DALE KILER RD	SW	PROTECT IN PLACE
6	230A - 012C	2ND ST	BROWN ST	S	PROTECT IN PLACE
7	230A - 013B	2ND ST	DALE PALM ST	NW	PARTIAL RECONSTRUCTION
8	230A - 015B	2ND ST	HAMMOND ST	S	PARTIAL RECONSTRUCTION
9	230A - 016B	HAMMOND ST	3RD ST	S	PROTECT IN PLACE
10	230A - 017A	3rd ST	COAHUILLA ST	SW	PROTECT IN PLACE
11	230A - 017D	3RD ST	COAHUILLA ST	SE	PARTIAL RECONSTRUCTION
12	230A - 018B	3RD ST	DATE PALM ST	NW	PROTECT IN PLACE
13	230A - 018D	3RD ST	DATE PALM ST	SE	PARTIAL RECONSTRUCTION
14	230A - 019C	3RD ST	BROWN ST	SW	PROTECT IN PLACE
15	230A - 020C	3RD ST	DALE KILER RD	NE	PARTIAL RECONSTRUCTION
16	230A - 021C	4TH ST	DALE KILER RD	NW	PROTECT IN PLACE
17	230A - 021D	4TH ST	DALE KILER RD	SW	PROTECT IN PLACE
18	230A - 022B	4TH ST	BROWN ST	NW	PROTECT IN PLACE
19	230A - 022C	4TH ST	BROWN ST	SW	PROTECT IN PLACE
20	230A - 023C	4TH ST	DALE PALM ST	SE	PROTECT IN PLACE
21	230A-006B	66TH AVE	DALE KILER RD	NW	PROTECT IN PLACE
22	230A - 016A	HAMMOND ST	3RD ST	N	FULL RECONSTRUCTION
23	230A - 019B	3RD ST	BROWN ST	NW	FULL RECONSTRUCTION
24	230A - 010A	2ND ST	HOME AVE	NW	PROTECT IN PLACE
25	230A - 010B	2ND ST	HOME AVE	SW	FULL RECONSTRUCTION
26	230A - 001A	66TH AVE	JOHNSON ST	NW	FULL RECONSTRUCTION
27	230A - 002A	66TH AVE	JOHNSON ST	E	FULL RECONSTRUCTION
28	230A - 002B	66TH AVE	JOHNSON ST	W	FULL RECONSTRUCTION
29	230A - 003A	66TH AVE	MECCA II	E	FULL RECONSTRUCTION
30	230A - 003B	66TH AVE	MECCA II	W	FULL RECONSTRUCTION
31	230A - 004A	66TH AVE	THUNDERBIRD APT HOMES	E	FULL RECONSTRUCTION
32	230A - 004B	66TH AVE	THUNDERBIRD APT HOMES	W	FULL RECONSTRUCTION
33	230A - 005A	66TH AVE	HOME AVE	NW	FULL RECONSTRUCTION
34	230A - 052A	THELMA CIR	PLONSKI RD	NE	FULL RECONSTRUCTION
35	230A - 052B	THELMA CIR	PLONSKI RD	NW	FULL RECONSTRUCTION
36	230A - 053B	PALOMARES CIR	PLONSKI RD	NW	FULL RECONSTRUCTION
37	230A - 054A	DONOVAN CIR	PLONSKI RD	NE	FULL RECONSTRUCTION
38	230A - 055A	PLONSKI RD	JOHNSON ST	SW	FULL RECONSTRUCTION
39	230A - 055B	PLONSKI RD	JOHNSON ST	NW	FULL RECONSTRUCTION

**MECCA CURB RAMP ACESSIBILITY PROJECT  
LIST OF CURB RAMPS**

<b>No.</b>	<b>RAMP #</b>	<b>MAJOR STREET</b>	<b>MINOR STREET</b>	<b>CORNER</b>	<b>TREATMENT</b>
40	230A - 057A	JOHNSON ST	NORTH DRIVEWAY	N	FULL RECONSTRUCTION
41	230A - 057B	JOHNSON ST	NORTH DRIVEWAY	S	FULL RECONSTRUCTION
42	230A - 058A	JOHNSON ST	SCHOOL DRIVEWAY	N	FULL RECONSTRUCTION
43	230A - 058B	JOHNSON ST	SCHOOL DRIVEWAY	S	FULL RECONSTRUCTION
44	230A - 058C	JOHNSON ST	SOUTH DRIVEWAY	N	FULL RECONSTRUCTION
45	230A - 058D	JOHNSON ST	SOUTH DRIVEWAY	S	FULL RECONSTRUCTION
46	230A - 059A	JOHNSON ST	KATHERINE DR	SW	FULL RECONSTRUCTION
47	230A - 059B	JOHNSON ST	KATHERINE DR	NW	FULL RECONSTRUCTION
48	230A - 060A	TERESA WAY	PATRICIA LN	SW	PROTECT IN PLACE
49	230A - 061A	KATHERINE DR	PATRICIA LN	SW	FULL RECONSTRUCTION
50	230A - 061B	KATHERINE DR	PATRICIA LN	N	PROTECT IN PLACE
51	230A - 061C	KATHERINE DR	PATRICIA LN	SE	FULL RECONSTRUCTION
52	230A - 062A	TERESA WAY	PATRICIA LN	NE	FULL RECONSTRUCTION
53	230A - 062B	TERESA WAY	PATRICIA LN	NW	FULL RECONSTRUCTION
54	230A - 063A	REBECA RD	JOHNSON ST	NW	FULL RECONSTRUCTION
55	230A - 063B	REBERA RD	JOHNSON ST	SW	FULL RECONSTRUCTION
56	230A - 064A	FRANK VALDOVINO	SOUTH DRIVEWAY	NW	FULL RECONSTRUCTION
57	230A - 064B	FRANK VALDOVINO	SOUTH DRIVEWAY	SW	FULL RECONSTRUCTION
58	230A - 064C	FRANK VALDOVINO	SOUTH DRIVEWAY	SE	FULL RECONSTRUCTION
59	230A - 064D	FRANK VALDOVINO	SOUTH DRIVEWAY	NE	FULL RECONSTRUCTION
60	NO #	2ND ST	HOME AVE	NE	FULL RECONSTRUCTION
61	230A - 026A	5TH ST	BROWN ST	SW	PROTECT IN PLACE
62	230A - 026D	5TH ST	BROWN ST	NW	PROTECT IN PLACE
63	230A - 028C	5TH ST	COAHUILLA ST	NE	PARTIAL RECONSTRUCTION
64	230A - 029A	5TH ST	HAMMOND ST	SE	PARTIAL RECONSTRUCTION
65	230A - 033B	7TH ST	COAHUILLA ST	NW	PROTECT IN PLACE
66	230A - 035A	6TH ST	COAHUILLA ST	NW	PROTECT IN PLACE
67	230A - 035B	6TH ST	COAHUILLA ST	SW	PARTIAL RECONSTRUCTION
68	230A - 037A	DATE PALM ST	7TH ST	W	PROTECT IN PLACE
69	230A - 037B	DATE PALM ST	7TH ST	SE	PROTECT IN PLACE
70	230A - 038B	DATE PALM ST	6TH ST	W	PROTECT IN PLACE
71	230A - 039A	DATE PALM ST	7TH ST	NE	PROTECT IN PLACE
72	230A - 025A	5TH ST	DATE PALM ST	NE	PARTIAL RECONSTRUCTION
73	230A - 031A	LINCOLN ST	65TH AVE	SE	FULL RECONSTRUCTION
74	230A - 034A	COAHUILLA ST	6TH ST	E	PARTIAL RECONSTRUCTION
75	230A - 036A	CALLE SOR JUANA	7TH ST	NE	FULL RECONSTRUCTION
76	230A - 036B	CALLE SOR JUANA	7TH ST	NW	FULL RECONSTRUCTION
77	230A - 036C	CALLE PABLO NERUDA	7TH ST	NE	FULL RECONSTRUCTION
78	230A - 036D	CALLE PABLO NERUDA	7TH ST	NW	FULL RECONSTRUCTION

**MECCA CURB RAMP ACESSISIBILITY PROJECT  
LIST OF CURB RAMPS**

<b>No.</b>	<b>RAMP #</b>	<b>MAJOR STREET</b>	<b>MINOR STREET</b>	<b>CORNER</b>	<b>TREATMENT</b>
79	230A - 065A	CALLE RAMOS	65TH AVE	SE	PROTECT IN PLACE
80	230A - 040A	HOME AVE	65TH AVE	SE	PROTECT IN PLACE
81	230A - 042A	7TH ST	HOME AVE	NW	PROTECT IN PLACE
82	230A - 044A	65TH AVE	JOHNSON ST	SW	FULL RECONSTRUCTION
83	230A - 045A	WOLFF DR	65TH AVE	SW	PROTECT IN PLACE
84	230A - 046B	MONTENEGRO RD	DONOVAN CIR	SW	FULL RECONSTRUCTION
85	230A - 047A	FERNANDO CIR	MONTENEGRO RD	NW	FULL RECONSTRUCTION
86	230A - 048A	MARIO CIR	MONTENEGRO RD	NW	FULL RECONSTRUCTION
87	230A - 049B	GLORIA CIR	MONTENEGRO RD	NE	FULL RECONSTRUCTION
88	230A - 050A	MONTENEGRO RD	WOLFF DR	NE	FULL RECONSTRUCTION
89	230A - 050B	MONTENEGRO RD	WOLFF DR	SE	PROTECT IN PLACE
90	230A - 065B	CALLE RAMOS	65TH AVE	SW	FULL RECONSTRUCTION
91	207B - 005A	FRED WARING DR	PORT MARIA RD	NW	FULL RECONSTRUCTION
92	NO #	63RD AVE	EAST DRIVEWAY	NW	FULL RECONSTRUCTION
93	NO #	63RD AVE	EAST DRIVEWAY	NE	FULL RECONSTRUCTION
94	NO #	63RD AVE	MIDDLE DRVEWAY	NW	FULL RECONSTRUCTION
95	NO #	63RD AVE	MIDDLE DRVEWAY	NE	FULL RECONSTRUCTION
96	230 - 001A	GARDENIA CT	LINCOLN ST	NE	PROTECT IN PLACE
97	230 - 001B	GARDENIA CT	LINCOLN ST	SE	FULL RECONSTRUCTION
98	230 - 002A	MIRAVILLA WAY	GARDENIA CT	NW	PROTECT IN PLACE
99	230 - 002B	MIRAVILLA WAY	GARDENIA CT	NE	PROTECT IN PLACE
100	230 - 003A	LUNARIA CT	MIRAVILLA WAY	SE	PROTECT IN PLACE
101	230 - 003B	LUNARIA CT	MIRAVILLA WAY	NE	PROTECT IN PLACE
102	230 - 004A	FUCHSIA CT	MIRAVILLA WAY	SE	FULL RECONSTRUCTION
103	230 - 004B	FUCHSIA CT	MIRAVILLA WAY	NE	FULL RECONSTRUCTION
104	230 - 005A	LAS FLORES WAY	64TH AVE	SW	FULL RECONSTRUCTION
105	230 - 005B	LAS FLORES WAY	64TH AVE	SE	FULL RECONSTRUCTION
106	230 - 006A	VISTA CT	SONRISA WAY	SE	FULL RECONSTRUCTION
107	230 - 006B	VISTA CT	SONRISA WAY	NE	FULL RECONSTRUCTION
108	230 - 007A	CIELO CT	SONRISA WAY	SE	FULL RECONSTRUCTION
109	230 - 007B	CIELO CT	SONRISA WAY	NE	FULL RECONSTRUCTION
110	230 - 008A	LAS SERENAS	64TH AVE	SW	FULL RECONSTRUCTION
111	230 - 008B	LAS SERENAS	64TH AVE	SE	FULL RECONSTRUCTION
112	230 - 009A	64TH AVE	LINCOLN ST	SE	FULL RECONSTRUCTION
113	207B - 005A	FRED WARING DR	PORT MARIA RD	NW	FULL RECONSTRUCTION