

MINUTES OF THE BOARD OF SUPERVISORS
COUNTY OF RIVERSIDE, STATE OF CALIFORNIA



1.1

On motion of Supervisor Spiegel, seconded by Supervisor Perez and duly carried by unanimous vote, IT WAS ORDERED, FOUND AND DETERMINED that the following ordinances were duly published:

<u>ORDINANCE</u>	<u>DATE</u>	<u>NEWSPAPER</u>
No. 348.4938	August 25, 2020	The Press-Enterprise

Roll Call:

Ayes: Jeffries, Spiegel, Washington, Perez and Hewitt
Nays: None
Absent: None

I hereby certify that the foregoing is a full, true and correct copy of an order made and entered on November 3, 2020 of Supervisors Minutes.

WITNESS my hand and the seal of the Board of Supervisors
Dated: November 3, 2020
Kecia R. Harper, Clerk of the Board of Supervisors, in and for
the County of Riverside, State of California.

(seal)

By: Roseella Rost, Deputy

AGENDA NO.

1.1

ATTACHMENTS FILED WITH
THE CLERK OF THE BOARD

THE PRESS-ENTERPRISE

Ad Copy:

1825 Chicago Ave, Suite 100
Riverside, CA 92507
951-684-1200
951-368-9018 FAX

PROOF OF PUBLICATION (2010, 2015.5 C.C.P)

Publication(s): The Press-Enterprise

PROOF OF PUBLICATION OF

Ad Desc.: NOH - Ordinance No. 348.4938 /

I am a citizen of the United States. I am over the age of eighteen years and not a party to or interested in the above entitled matter. I am an authorized representative of THE PRESS-ENTERPRISE, a newspaper in general circulation, printed and published daily in the County of Riverside, and which newspaper has been adjudicated a newspaper of general circulation by the Superior Court of the County of Riverside, State of California, under date of April 25, 1952, Case Number 54446, under date of March 29, 1957, Case Number 65673, under date of August 25, 1995, Case Number 267864, and under date of September 16, 2013, Case Number RIC 1309013; that the notice, of which the annexed is a printed copy, has been published in said newspaper in accordance with the instructions of the person(s) requesting publication, and not in any supplement thereof on the following dates, to wit:

09/07/2020

I certify (or declare) under penalty of perjury that the foregoing is true and correct.

Date: September 07, 2020
At: Riverside, California



Legal Advertising Representative, The Press-Enterprise

BOARD OF SUPERVISORS
COUNTY OF RIVERSIDE
PO BOX 1147
RIVERSIDE, CA 92502

Ad Number: 0011409288-01

P.O. Number:

*TMA / Planning
Item 21.1 of
08/25/20*

BOARD OF SUPERVISORS OF THE COUNTY OF RIVERSIDE, STATE OF CALIFORNIA

ORDINANCE NO. 348.4938
AN ORDINANCE OF THE COUNTY OF RIVERSIDE
AMENDING ORDINANCE NO. 348 RELATING TO ZONING

The Board of Supervisors of the County of Riverside ordains as follows:
 Section 1. Section 4.1 of Ordinance No. 348, and official Zoning Plan Map No. 2, as amended, are further amended by pl zone or zones as shown on the map entitled "Change of Official Zoning Plan Amending Ordinance No. 348, Map No. 2.2449, Change of Zo this ordinance.
 Section 2. This ordinance shall take effect 30 days after its adoption.

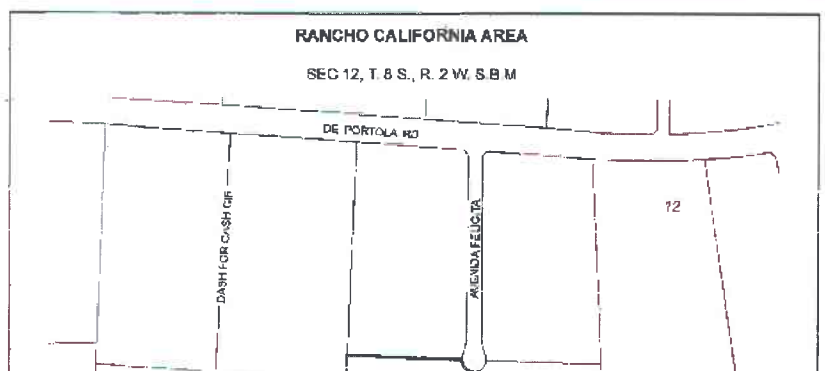
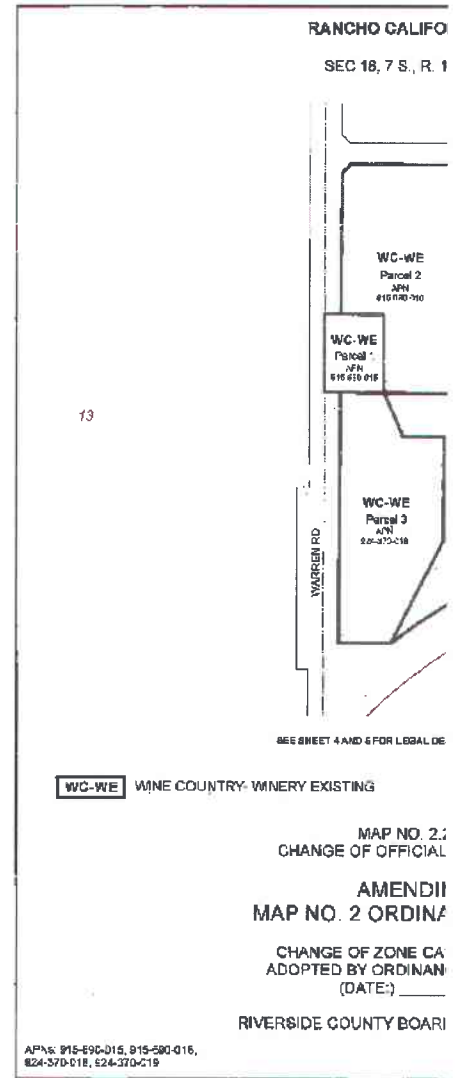
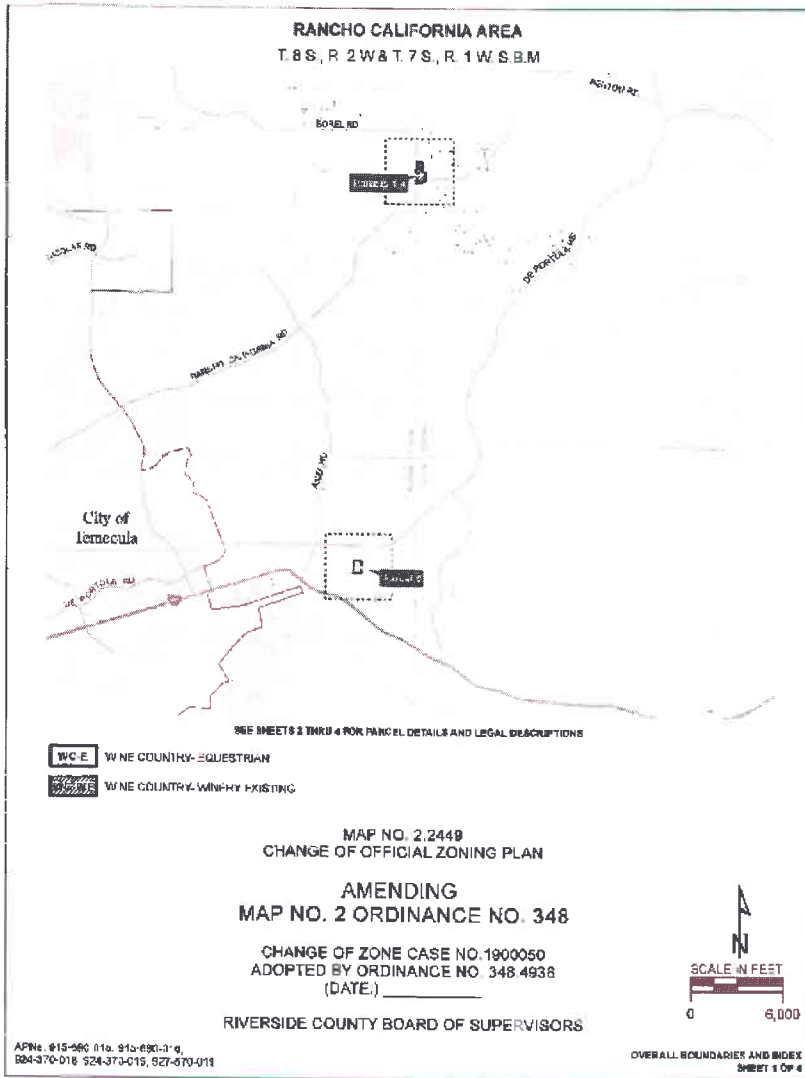

RANCHO CALIFORNIA AREA PARCEL LEGAL DESCRIPTIONS (SEE SHEET 1, 2 & 3)

**PARCEL 1
APN: 915-690-015**

THAT PORTION OF GOVERNMENT LOT 3 IN FRACTIONAL SECTION 18, TOWNSHIP 7 SOUTH, RANGE 1 WEST, SAN BERNARDINO MERIDIAN, AS SHOWN BY UNITED STATES GOVERNMENT SURVEY, DESCRIBED AS FOLLOWS:

BEGINNING AT THE INTERSECTION OF THE SOUTH LINE OF SAID SECTION AND THE EAST SIDE OF THE PUBLIC HIGHWAY WHICH EXTENDS ALONG THE WEST BOUNDARY OF SAID SECTION, SAID POINT BEING 25 FEET EAST OF THE SOUTHWEST CORNER OF SAID SECTION; THENCE EAST ON THE SOUTH LINE OF SAID SECTION, 165 FEET MORE OR LESS TO THE SOUTHWEST CORNER OF THE SOUTHERLY 220 FEET OF LOT 24 OF TRACT 12316 IN BOOK 137, PAGES 44 AND 45 OF MAPS;
THENCE NORTH, PARALLEL WITH THE WEST LINE OF SAID SECTION, 220 FEET;
THENCE WEST, PARALLEL WITH THE SOUTH LINE OF SAID SECTION, 165 FEET, MORE OR LESS, TO A POINT ON THE EAST SIDE OF SAID PUBLIC HIGHWAY, DISTANCE 25 FEET EAST FROM THE WEST LINE OF SAID SECTION;
THENCE SOUTH ON THE EAST SIDE OF SAID PUBLIC HIGHWAY AND PARALLEL WITH AND 25 FEET DISTANT FROM THE WEST LINE OF SAID SECTION, 220 FEET TO THE POINT OF BEGINNING;

ALSO EXCEPTING THEREFROM ANY PORTION THEREOF INCLUDED IN PUBLIC HIGHWAY.

**PARCEL 2
APN: 915-690-016**

BEING A PORTION OF LOT 24 AS SHOWN ON MAP OF TRACT 12316 ON FILE IN BOOK 137, PAGE 45 OF MAPS, LYING WITHIN FRACTIONAL SECTION 18, TOWNSHIP 7 SOUTH, RANGE 1 WEST; TOGETHER WITH A PORTION OF PARCEL 4 OF PARCEL MAP NO 27819, AS SHOWN BY MAP ON FILE IN BOOK 186, PAGE 5 OF PARCEL MAPS, LYING WITHIN A PORTION OF RANCHO PAUBA, ALL RECORDS OF RIVERSIDE COUNTY, CALIFORNIA DESCRIBED AS FOLLOWS:

BEGINNING AT THE SOUTHEAST CORNER OF SAID LOT 24;

THENCE ALONG THE NORTH LINE OF SAID OF SAID PARCEL 4 SOUTH 89° 39' 03" EAST, 200.71 FEET TO THE NORTHEAST CORNER OF SAID PARCEL 4;

THENCE ALONG THE EAST LINE OF SAID PARCEL 4 SOUTH 00° 21' 57" WEST, 48.00 FEET; THENCE SOUTH 00° 52' 46" EAST, 440.87 FEET;

THENCE SOUTH 19° 19' 50" EAST 55.00 FEET TO THE MOST EASTERLY CORNER OF SAID PARCEL 4 AND A POINT ON THE CENTERLINE OF OLD BENTON ROAD AS SHOWN ON SAID PARCEL MAP, ALSO BEING A POINT ON THE ARC OF A NON-TANGENT CURVE CONCAVE SOUTHEASTERLY HAVING A RADIUS OF 1400.00 FEET, A RADIAL LINE TO SAID POINT BEARS NORTH 19° 19' 50" WEST;

THENCE LEAVING SAID EAST LINE SOUTHWESTERLY ALONG THE ARC OF SAID CURVE THROUGH A CENTRAL ANGLE OF 17° 49' 36", A DISTANCE OF 435.59 FEET;

THENCE LEAVING SAID CURVE AND SAID CENTERLINE NORTH 37° 09' 26" WEST 55.00 FEET;

THENCE NORTH 215° 55' 49" EAST, 324.35 FEET;

THENCE NORTH 00° 13' 31" EAST, 289.90 FEET;

THENCE NORTH 88° 57' 55" WEST 117.62 FEET;

THENCE NORTH 23° 20' 07" WEST, 134.64 FEET TO THE MOST SOUTHWEST CORNER OF SAID LOT 24;

THENCE ALONG THE BOUNDARY OF SAID LOT 24 THE FOLLOWING COURSES, NORTH 8° 13' 06" EAST 220.00 FEET.

NORTH 82° 38' 03" WEST, 165.00 FEET TO THE CENTERLINE OF WARREN ROAD AS SHOWN ON SAID MAP NO. 12316;

THENCE ALONG SAID CENTERLINE NORTH 00° 13' 06" EAST, 451.83 FEET TO THE INTERSECTION OF THE CENTERLINE OF WARREN ROAD AND THE CENTERLINE OF SUMMITVILLE STREET, ALSO BEING THE NORTHWEST CORNER OF SAID LOT 24.

THENCE ALONG THE CENTERLINE OF SAID SUMMITVILLE STREET, SOUTH 89° 46' 54" EAST, 377.93 FEET.

THENCE LEAVING SAID CENTERLINE AND ALONG THE EAST LINE OF SAID LOT 24, SOUTH 00° 13' 06" WEST, 672.80 FEET TO THE POINT OF BEGINNING.

PARCEL 3

PARCEL 3 (Continued)

THENCE ALONG THE NORTH LINE OF SAID PARCEL 4, SOUTH 23° 20' 07" WEST, 134.64 FEET TO THE MOST SOUTHWEST CORNER OF SAID LOT 24;
THENCE LEAVING SAID NORTH LINE, SOUTH 23° 20' 07" WEST, 134.64 FEET TO THE MOST SOUTHWEST CORNER OF SAID LOT 24;
THENCE SOUTH 88° 57' 55" EAST, 117.82 FEET;

THENCE SOUTH 00° 13' 31" WEST, 289.90 FEET;

THENCE SOUTH 26° 55' 49" WEST, 324.35 FEET.

THENCE SOUTH 37° 09' 26" EAST, 55.00 FEET TO THE CENTERLINE OF OLD BENTON ROAD AS SHOWN ON SAID PARCEL MAP NO. 27819 ALSO BEING THE CENTERLINE OF A CURVE CONCAVE NORTHWESTERLY HAVING A RADIUS OF 1400.00 FEET, SAID POINT BEARS NORTH 37° 09' 26" WEST;

THENCE WESTERLY ALONG THE CENTERLINE OF OLD BENTON ROAD THROUGH A CENTRAL ANGLE OF 37° 31' 09", A DISTANCE OF 435.59 FEET TO THE CENTERLINE OF OLD BENTON ROAD AND THE CENTERLINE OF WARREN ROAD AS SHOWN ON SAID PARCEL MAP;
THENCE LEAVING THE CENTERLINE OF OLD BENTON ROAD AND THE CENTERLINE OF WARREN ROAD NORTH 00° 27' 52" EAST, 451.83 FEET TO THE INTERSECTION OF THE CENTERLINE OF WARREN ROAD AND THE CENTERLINE OF SUMMITVILLE STREET, ALSO BEING THE NORTHWEST CORNER OF SAID LOT 24;

THENCE ALONG THE BOUNDARY OF SAID LOT 24 THE FOLLOWING COURSES, NORTH 8° 13' 06" EAST 220.00 FEET.

NORTH 82° 38' 03" WEST, 165.00 FEET TO THE CENTERLINE OF WARREN ROAD AS SHOWN ON SAID MAP NO. 12316;

**PARCEL 4
APN: 924470-019**

BEING A PORTION OF LOT 24 AS SHOWN ON MAP OF TRACT 12316 ON FILE IN BOOK 137, PAGE 45 OF MAPS, LYING WITHIN FRACTIONAL SECTION 18, TOWNSHIP 7 SOUTH, RANGE 1 WEST; TOGETHER WITH A PORTION OF PARCEL 4 OF PARCEL MAP NO 27819, AS SHOWN BY MAP ON FILE IN BOOK 186, PAGE 5 OF PARCEL MAPS, LYING WITHIN A PORTION OF RANCHO PAUBA, ALL RECORDS OF RIVERSIDE COUNTY, CALIFORNIA DESCRIBED AS FOLLOWS:

BEGINNING AT THE SOUTHEAST CORNER OF SAID LOT 24;

THENCE ALONG THE NORTH LINE OF SAID OF SAID PARCEL 4 SOUTH 89° 39' 03" EAST, 200.71 FEET TO THE NORTHEAST CORNER OF SAID PARCEL 4;

THENCE ALONG THE EAST LINE OF SAID PARCEL 4 SOUTH 00° 21' 57" WEST, 48.00 FEET; THENCE SOUTH 00° 52' 46" EAST, 440.87 FEET;

THENCE SOUTH 19° 19' 50" EAST 55.00 FEET TO THE MOST EASTERLY CORNER OF SAID PARCEL 4 AND A POINT ON THE CENTERLINE OF OLD BENTON ROAD AS SHOWN ON SAID PARCEL MAP, ALSO BEING A POINT ON THE ARC OF A NON-TANGENT CURVE CONCAVE SOUTHEASTERLY HAVING A RADIUS OF 1400.00 FEET, SAID POINT BEARS NORTH 19° 19' 50" WEST;

THENCE LEAVING SAID EAST LINE SOUTHWESTERLY ALONG THE ARC OF SAID CURVE THROUGH A CENTRAL ANGLE OF 17° 49' 36", A DISTANCE OF 435.59 FEET;

THENCE LEAVING SAID CURVE AND SAID CENTERLINE NORTH 37° 09' 26" WEST 55.00 FEET;

THENCE NORTH 215° 55' 49" EAST, 324.35 FEET;

THENCE NORTH 00° 13' 31" EAST, 289.90 FEET;

THENCE NORTH 88° 57' 55" WEST 117.62 FEET;

THENCE NORTH 23° 20' 07" WEST, 134.64 FEET TO THE MOST SOUTHWEST CORNER OF SAID LOT 24;

THENCE ALONG THE BOUNDARY OF SAID LOT 24 THE FOLLOWING COURSES, NORTH 8° 13' 06" EAST 220.00 FEET.

NORTH 82° 38' 03" WEST, 165.00 FEET TO THE CENTERLINE OF WARREN ROAD AS SHOWN ON SAID MAP NO. 12316;

THENCE ALONG SAID CENTERLINE NORTH 00° 13' 06" EAST, 451.83 FEET TO THE INTERSECTION OF THE CENTERLINE OF WARREN ROAD AND THE CENTERLINE OF SUMMITVILLE STREET, ALSO BEING THE NORTHWEST CORNER OF SAID LOT 24;

THENCE ALONG THE CENTERLINE OF SAID SUMMITVILLE STREET, SOUTH 89° 46' 54" EAST, 377.93 FEET.

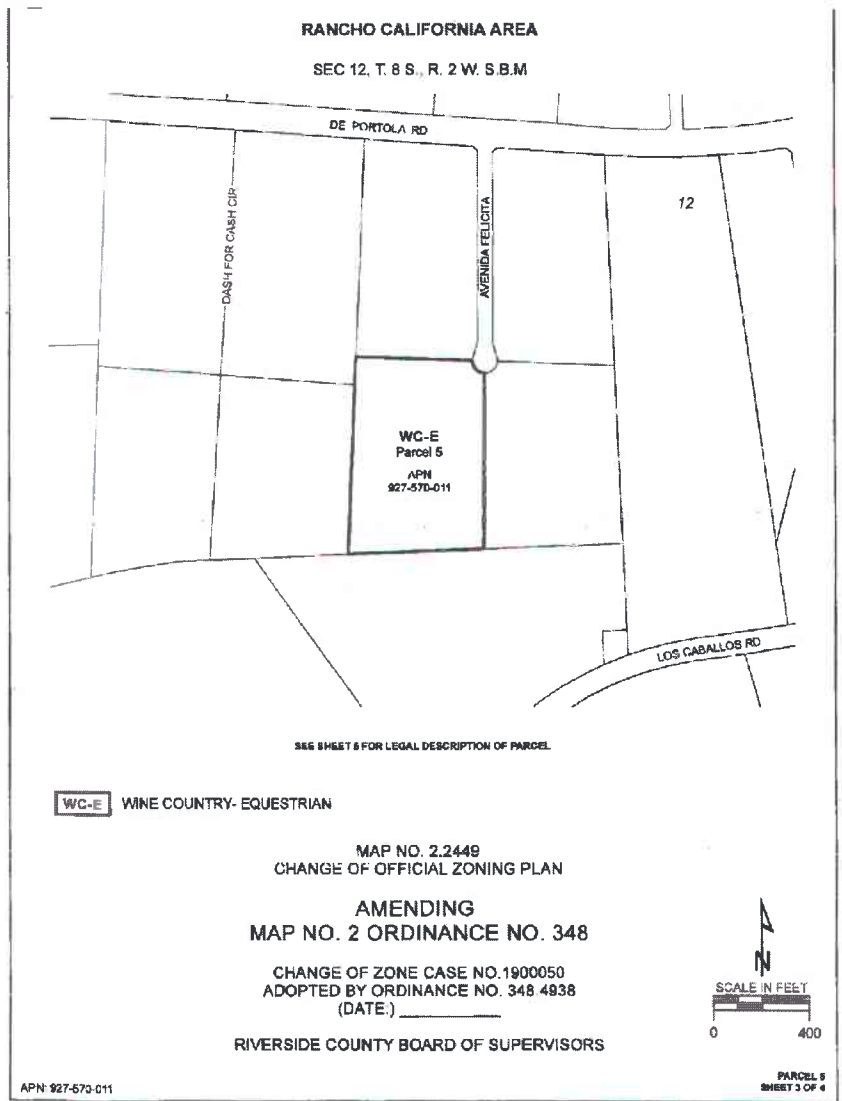

RANCHO CALIFORNIA AREA PARCEL LEGAL DESCRIPTIONS (SEE SHEET 1, 2 & 3)

PARCEL 1
APN: 915-690-016

THAT PORTION OF GOVERNMENT LOT 3 IN FRACTIONAL SECTION 18, TOWNSHIP 7 SOUTH, RANGE 1 WEST, SAN BERNARDINO MERIDIAN, AS SHOWN BY UNITED STATES GOVERNMENT SURVEY, DESCRIBED AS FOLLOWS:

BEGINNING AT THE INTERSECTION OF THE SOUTH LINE OF SAID SECTION AND THE EAST SIDE OF THE PUBLIC HIGHWAY WHICH EXTENDS ALONG THE WEST BOUNDARY OF SAID SECTION, SAID POINT BEING 25 FEET EAST OF THE SOUTHWEST CORNER OF SAID SECTION; THENCE EAST ON THE SOUTH LINE OF SAID SECTION, 165 FEET MORE OR LESS TO THE SOUTHWEST CORNER OF THE SOUTHERLY 220 FEET OF LOT 24 OF TRACT 12316 IN BOOK 137, PAGES 44 AND 45 OF MAPS; THENCE NORTH, PARALLEL WITH THE WEST LINE OF SAID SECTION, 220 FEET;

PARCEL 3 (Continued)

THENCE ALONG THE NORTH LINE OF SAID PARCEL 4, SOUTH 81° 00' 00" WEST, 117.62 FEET;
THENCE LEAVING SAID NORTH LINE, SOUTH 23° 20' 00" EAST, 117.62 FEET;
THENCE SOUTH 88° 57' 65" EAST, 117.62 FEET;
THENCE SOUTH 00° 13' 31" WEST, 289.90 FEET;
THENCE SOUTH 243° 55' 49" WEST, 324.35 FEET.
THENCE SOUTH 37° 02' 26" EAST, 55.00 FEET TO THE CENTER.

BOARD OF SUPERVISORS OF THE COUNTY OF RIVERSIDE, STATE OF CALIFORNIA

ORDINANCE NO. 348.4938
AN ORDINANCE OF THE COUNTY OF RIVERSIDE
AMENDING ORDINANCE NO. 348 RELATING TO ZONING

The Board of Supervisors of the County of Riverside ordains as follows:
 Section 1. Section 4.1 of Ordinance No. 348, and official Zoning Plan Map No. 2, as amended, are further amended by pl zone or zones as shown on the map entitled "Change of Official Zoning Plan Amending Ordinance No. 348, Map No. 2.2449, Change of Zo this ordinance.
 Section 2. This ordinance shall take effect 30 days after its adoption.

