

**SUBMITTAL TO THE BOARD OF SUPERVISORS
COUNTY OF RIVERSIDE, STATE OF CALIFORNIA**



ITEM: 19.2
(ID # 14572)

MEETING DATE:
Tuesday, March 23, 2021

FROM: TLMA-TRANSPORTATION:

SUBJECT: TRANSPORTATION AND LAND MANAGEMENT AGENCY/TRANSPORTATION:
Public Hearing on the Annexation of Street Lighting Zone 149 to Landscaping and Lighting Maintenance District No. 89-1-Consolidated, French Valley, District 3. [\$723 Ongoing Cost - L&LMD No. 89-1-C 100%]

RECOMMENDED MOTION: That the Board of Supervisors:

1. With regard to the annexation of Street Lighting Zone 149 to Landscaping and Lighting Maintenance District No. 89-1-Consolidated, conduct the public hearing and, after closing the public hearing, direct the Director of Transportation, or their designee, who the Board of Supervisors finds to be an impartial person as that term is used in Section 53753(e) of the Government Code, to tabulate all assessment ballots received prior to the close of the public hearing. All assessment ballots received prior to the close of the public hearing will be tabulated at 10:00 a.m. on Wednesday, March 24, 2021 in Conference Room C on the 8th Floor of the County Administrative Center, 4080 Lemon Street, Riverside, California. Staff is directed to cause the appropriate resolution, based on the proceeding tabulation, to be prepared and returned to the Board of Supervisors for its consideration.

ACTION: Policy

Mark Lancaster, Director of Transportation 2/16/2021

MINUTES OF THE BOARD OF SUPERVISORS

On motion of Supervisor Washington, seconded by Supervisor Hewitt and duly carried by unanimous vote, IT WAS ORDERED that the above matter is approved as recommended.

Ayes: Jeffries, Spiegel, Washington, Perez, and Hewitt
Nays: None
Absent: None
Date: March 23, 2021
xc: Transp.

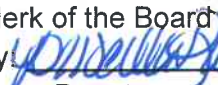
Kecia R. Harper
Clerk of the Board
By: 
Deputy

**SUBMITTAL TO THE BOARD OF SUPERVISORS COUNTY OF RIVERSIDE,
STATE OF CALIFORNIA**

FINANCIAL DATA	Current Fiscal Year:	Next Fiscal Year:	Total Cost:	Ongoing Cost
COST	\$ 0	\$ 723	\$ 0	\$ 723
NET COUNTY COST	\$ 0	\$ 0	\$ 0	\$ 0
SOURCE OF FUNDS: L&LMD No. 89-1-C – 100% There are no General Funds used in this project.			Budget Adjustment: N/A	
			For Fiscal Year: 21/22	

C.E.O. RECOMMENDATION: Approve

BACKGROUND:

Summary

Pursuant to the Landscaping and Lighting Act of 1972 and Resolution No. 2021-012 adopted January 26, 2021, the Board of Supervisors gave notice of a public hearing for March 23, 2021, to receive testimony regarding the Annexation of Street Lighting Zone 149 to Landscaping and Lighting Maintenance District No. 89-1-Consolidated (L&LMD No. 89-1-C). Annexation of Street Lighting Zone 149 will fund the maintenance and servicing of streetlights within public rights-of-way located southeasterly of Winchester Road and in the French Valley area and includes 2 commercial parcels totalling 2.07 acres.

The annexation of territory to an existing assessment district formed under the Landscaping and Lighting Act is a change of organization that requires a public hearing as part of the annexation process per Streets & Highways Code §§ 22605(a), 22607, 22588; Gov't. Code § 53753(d).

On January 27, 2021 a notice of the public hearing and information sheet, a mail-in assessment ballot, an impartial analysis, and a copy of Resolution No. 2021-012 was mailed to all property owners within Street Lighting Zone 149, proposed for annexation to L&LMD No. 89-1-C. Pursuant to the notice, all assessment ballots must be returned prior to the conclusion of the public hearing.

Notice of the public hearing was also given by publication of a certified copy of Resolution No. 2021-012 in an appropriate newspaper at least ten (10) days prior to the public hearing date and by posting a certified copy of Resolution No. 2021-012 on the official bulletin board customarily used by the Board of Supervisors for the posting of notices and in two (2) other public locations within the County.

Impact on Residents and Businesses

The new assessment is for the purpose of providing the maintenance and servicing of streetlights within public right-of-way.

Only the commercial property owners within the proposed boundaries of Street Lighting Zone 149, which are represented by Plot Plan No. 25793, as described in the attached Exhibit

**SUBMITTAL TO THE BOARD OF SUPERVISORS COUNTY OF RIVERSIDE,
STATE OF CALIFORNIA**

"A" (a two-page exhibit containing a description and diagram) are impacted by the cost of this annexation. The property owners within the proposed boundaries of Street Lighting Zone 149 have petitioned the County of Riverside to annex their property to L&LMD No. 89-1-C and understand that this annexation will result in an assessment on their property to fund the maintenance and servicing of the aforementioned improvements (streetlights).

SUPPLEMENTAL:

Additional Fiscal Information

The proposed budget for fiscal year 2021-22 for Street Lighting Zone 149 is \$723. This will result in an assessment for fiscal year 2021-22 within Street Lighting Zone 149 of \$350 per acre. The annual assessment may be adjusted annually by the greater of 2% or the cumulative percentage increase in the Consumer Price Index for all Urban Consumers for electricity (CPI-U_Electricity), if any, as it stands as of March of each year over the base index for March of 2021.

Contract History and Price Reasonableness

N/A

ATTACHMENTS:

Exhibit A

	
Jason Farin, Principal Management Analyst	Gregory V. Priantos, Director County Counsel
3/16/2021	3/9/2021

EXHIBIT "A"

DESCRIPTION OF BOUNDARIES

The boundaries of Street Lighting Zone 149 to be annexed into Landscaping and Lighting Maintenance District No. 89-1-Consolidated, of the County of Riverside, are coterminous with the boundaries of APN 963-060-070 & 963-060-071 as shown on Assessment Roll in the County of Riverside, State of California in Fiscal Year 2021-22.

LANDSCAPING AND LIGHTING MAINTENANCE DISTRICT NO. 89-1 CONSOLIDATED

STREET LIGHT ZONE 149
PORTION(S) OF SECTION 6, T.7S., R.2W.
PLOT PLAN NO. 25793
2 PARCELS

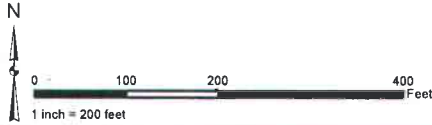

The County of Riverside assumes no warranty or legal responsibility for the information contained on this map. Data and information represented on this map is subject to updates, modifications and may not be complete or appropriate for all purposes. County GIS and other sources should be queried for the most current information. Do not copy or resell this map. Printed by bhahn on 4/1/2020

ASSESSMENT DIAGRAM

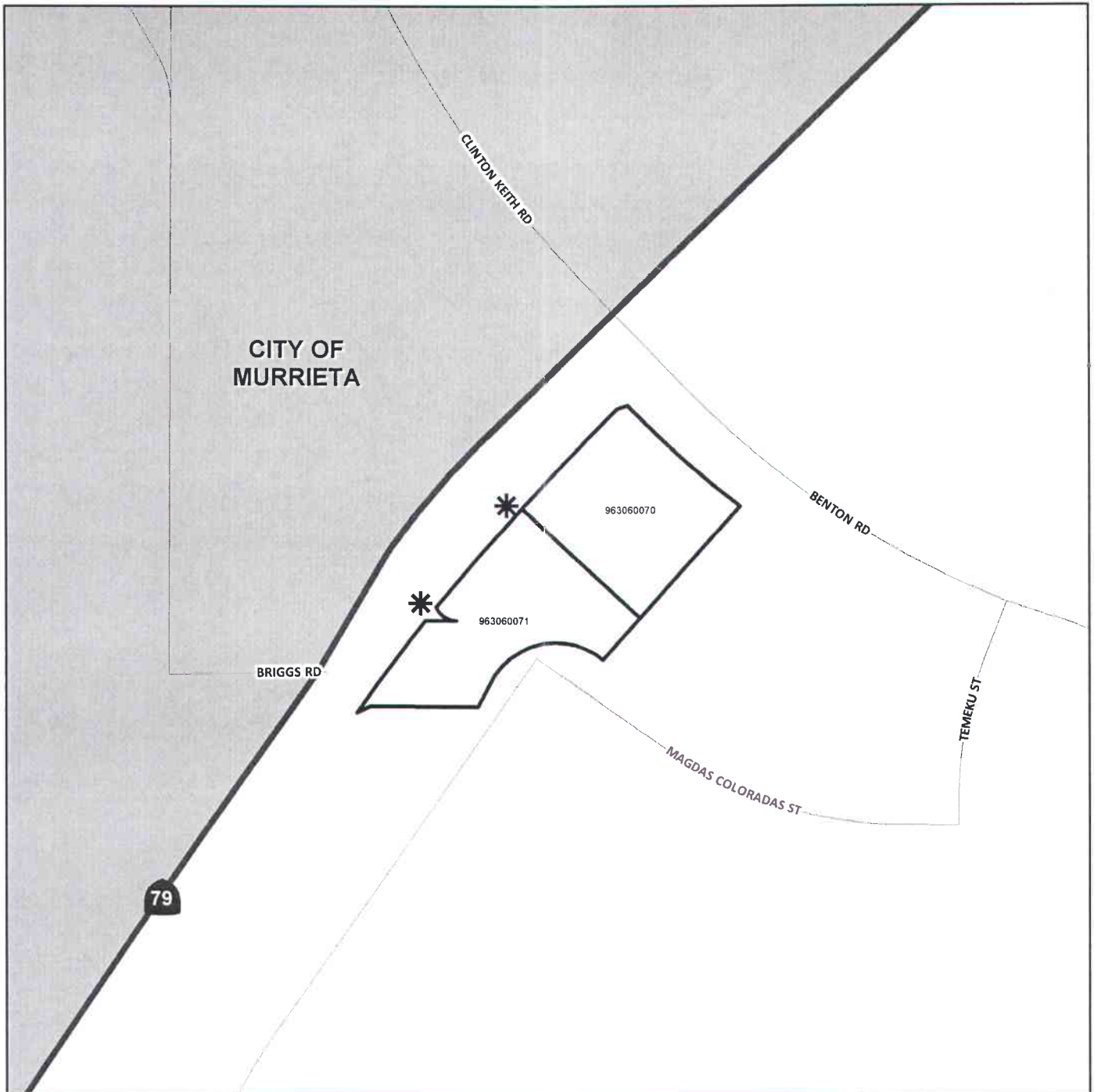

- * DENOTES MAINTAINED ROW STREETLIGHT
-  DENOTES ZONE BOUNDARY