

**SUBMITTAL TO THE BOARD OF SUPERVISORS
COUNTY OF RIVERSIDE, STATE OF CALIFORNIA**



**ITEM: 3.25
(ID # 17125)**

MEETING DATE:
Tuesday, October 26, 2021

FROM : TLMA-TRANSPORTATION:

SUBJECT: TRANSPORTATION AND LAND MANAGEMENT AGENCY/TRANSPORTATION:
Approve Contract Change Order Nos. 1 and 2 – Between the County of Riverside and Onyx Paving Company, Inc., for the Construction of Grand Avenue Resurfacing Project, Community of West Elsinore, District 1. [\$695,179 Total Cost – City of Lake Elsinore 70%, Unincorporated Community Initiative Funds 30%]

RECOMMENDED MOTION: That the Board of Supervisors:

1. Approve Contract Change Order Nos. 1 and 2 with Onyx Paving Company, Inc., on the Grand Avenue Resurfacing Project, from Plumas Street to Patrick Court and authorize the Chair of the Board to execute the same; and
2. Authorize the Transportation Department to issue Contract Change Order Nos. 1 and 2 with Onyx Paving Company, Inc., on the Grand Avenue Resurfacing Project, from Plumas Street to Patrick Court.

ACTION:Policy

Mark Lancaster, Director of Transportation 9/21/2021

MINUTES OF THE BOARD OF SUPERVISORS

On motion of Supervisor Washington, seconded by Supervisor Jeffries and duly carried, IT WAS ORDERED that the above matter is approved as recommended.

Ayes: Jeffries, Spiegel, Washington and Perez
Nays: None
Absent: Hewitt
Date: October 26, 2021
xc: Transp.

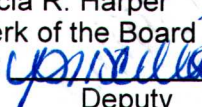
Kecia R. Harper
Clerk of the Board
By: 
Deputy

**SUBMITTAL TO THE BOARD OF SUPERVISORS COUNTY OF RIVERSIDE,
STATE OF CALIFORNIA**

FINANCIAL DATA	Current Fiscal Year:	Next Fiscal Year:	Total Cost:	Ongoing Cost
COST	\$ 695,179	\$ 0	\$ 695,179	\$ 0
NET COUNTY COST	\$ 0	\$ 0	\$ 0	\$ 0
SOURCE OF FUNDS: City of Lake Elsinore (70%), Unincorporated Community Initiative Funds (30%)			Budget Adjustment:	No
			For Fiscal Year:	21/22

C.E.O. RECOMMENDATION: Approve

BACKGROUND:

Summary

By Minute Order 3.34 of May 11, 2021, the Board of Supervisors entered into a contract with Onyx Paving Company, Inc. of Anaheim, California for the Construction of Grand Avenue Resurfacing Project, from Plumas Street to Patrick Court in the Community of West Elsinore.

The authorized amount of the contract was \$1,431,000. The total amount of the Contract Change Orders is \$695,179 (48.6% of the original contract amount) which exceeds the maximum change order amount that can be authorized by the Director of Transportation and requires Board of Supervisors approval in accordance with Resolution No. 2019-035.

Additional street improvements are at the request of the City of Lake Elsinore. The County of Riverside entered into an agreement with the City of Lake Elsinore (Minute Order 3.44 of August 17, 2021) to perform the additional street improvements on Grand Avenue from Machado Street to Riverside Drive and Bonnie Lea Drive to Ortega Highway.

Sidewalk Improvements were added to the project along the east side of Grand Avenue between Alvarado Street and Patrick Court in order to enhance pedestrian safety and increase access to the school in the community.

Impact on Residents and Businesses

The street improvements provide the public with a smooth paved roadway that will improve efficiency of vehicular traffic and the sidewalk improvements increase pedestrian safety.

Additional Fiscal Information

Contract Change Order Nos. 1 and 2 brings the total current authorized contract amount to \$2,126,179, which is 48.6% over the originally authorized contract amount of \$1,431,000. The cost increase will be funded by a combination of City of Lake Elsinore and Unincorporated Community Initiative Funds.

Contract History and Price Reasonableness

N/A

**SUBMITTAL TO THE BOARD OF SUPERVISORS COUNTY OF RIVERSIDE,
STATE OF CALIFORNIA**

ATTACHMENTS:

Vicinity Map

Contract Change Order 1

Contract Change Order 2

Change Order Report



Jason Farin, Principal Management Analyst 10/19/2021



Gregory V. Priamos, Director County Counsel 10/14/2021

GRAND AVENUE

RESURFACING

PLUMAS ST. TO PATRICK CT.

COMMUNITY OF WEST ELSINORE

PROJECT No. C6-0073

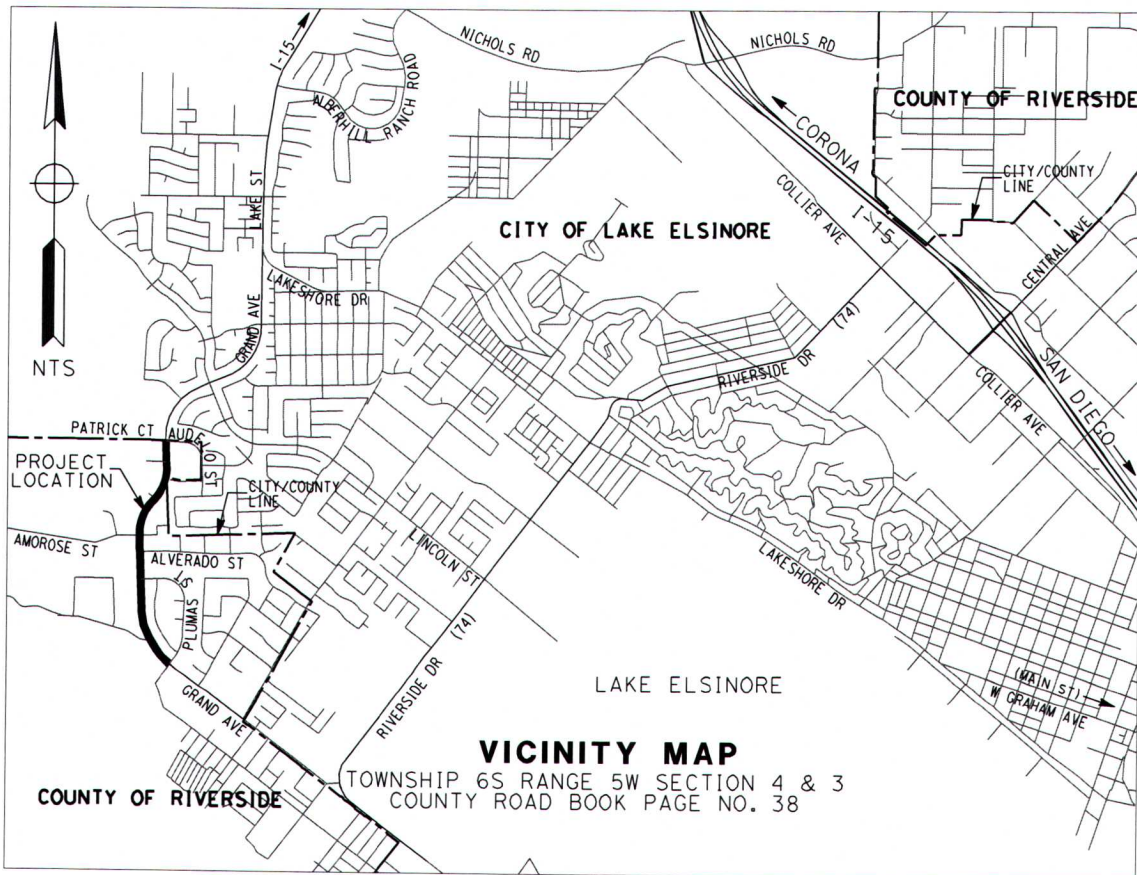
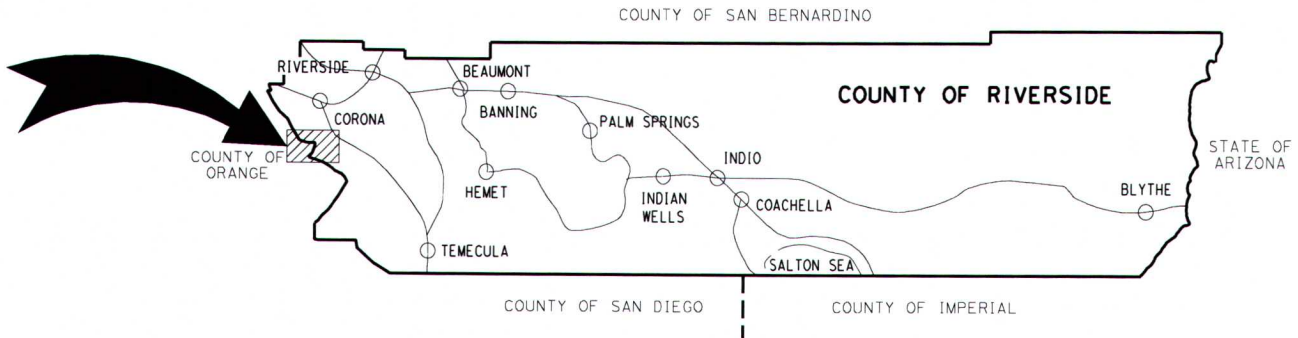

GRAND AVENUE

RESURFACING

MACHADO ST TO RIVERSIDE DR.

BONNIE LEA ST TO APPROX. 350' S. OF ORTEGA HWY

CITY OF LAKE ELSINORE

PROJECT No. C6-0073

COUNTY OF SAN BERNARDINO

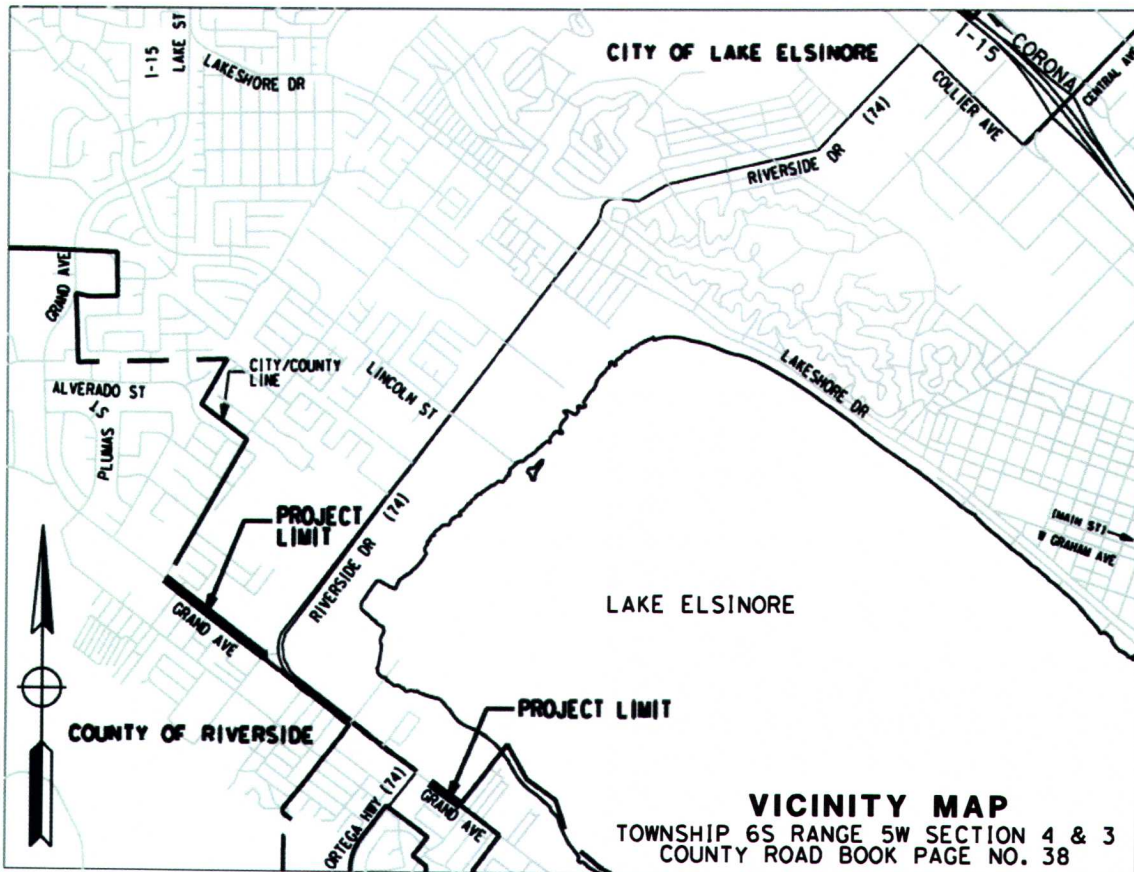
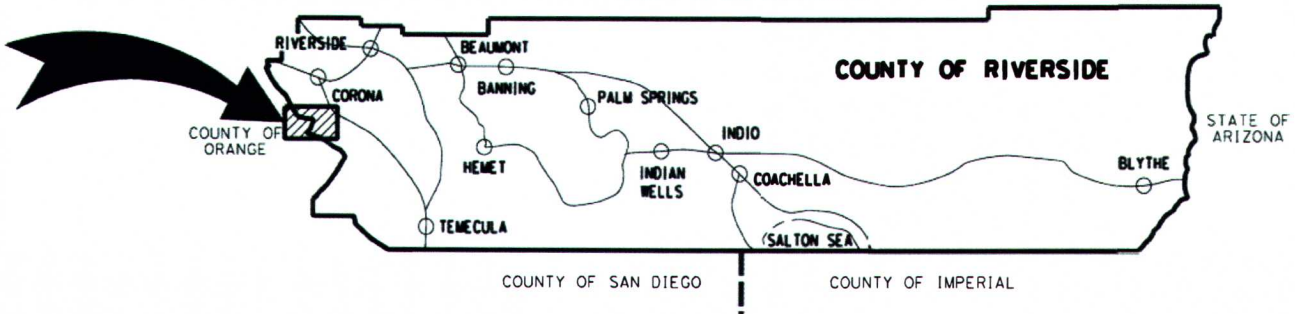

CHANGE ORDER REPORT
(Grand Avenue Resurfacing Project)

CCO #	Amount	Percent	Description
	Original Contract Amount \$1,431,000		
1	487,534	34.1%	The City of Lake Elsinore requested additional street improvements on Grand Avenue from Machado Street to Riverside Drive and Bonnie Lea Drive to Ortega Highway.
2	207,645	14.5%	Sidewalk improvements were added to the project to enhance public safety by improving routes and access to schools in the area.
Authorized Change Orders	\$0.00	0.00%	
Total Change Orders	\$695,179	48.6%	
Revised Contract Amount	\$2,126,179		

LETTER OF TRANSMITTAL

**Local Agency: County of Riverside
Transportation Department**

DATE: August 26, 2021

**File: Grand Avenue Resurfacing Project,
Plumas St. to Patrick Ct.**

W.O. No.: C6-0073

C.C.O.: 1

TO: Mark Lancaster

From: Cindi Wachi

\$487,533.90 (34.1% of the original contract amount of \$1,431,000.00)

This contract change order compensates the contractor for the construction of additional street improvements on Grand Avenue.

The City of Lake Elsinore requested to partner with the County of Riverside on the project after the construction contract was awarded on May 11, 2021.

The County of Riverside entered into an agreement with City of Lake Elsinore on August 17, 2021 to perform additional street improvements on Grand Avenue from Machado Street to Riverside Drive and Bonnie Lea Drive to Ortega Highway per the attached approved project plans.

The amount of this Contract Change Order is \$487,533.90. The accumulation of all Contract Change Orders thus far, including this one, is \$487,533.90.

Previous Contract Change Order Amounts Approved:

See C.C.O. History
(attached)

\$0.00

OCT 26 2021 3.25

File: Grand Avenue Resurfacing Project, Plumas St. to Patrick Ct.
W.O. No.: C6-0073
C.C.O. No. 1
Page 2

This Contract Change Order was discussed with County Staff and they gave their concurrence to this change.

Adjustment of Time: 20 working days

ESTIMATE OF COST

Items
 Force Account
 Agreed Price \$487,533.90
 Adjustment

TOTAL \$487,533.90

Cindi A. Wachi

Cindi Wachi
 Engineering Division Manger

CCO	Amount	Funding Source
1	\$487,533.90	City of Lake Elsinore (100%)

CCO Category		
AFA	Anticipated Force Account	
CFC	Changed Field Condition	
CME	Contract Management Error	
DO	Design Omission	
OAM	Outside Agency Mandate	X
RWO	Right-of-Way Obligation	
SE	Survey Error	
UB	Upgrade/Betterment	
UI	Utility Interference	



COUNTY OF RIVERSIDE
TRANSPORTATION DEPARTMENT

SHEET 1 OF 9 SHEETS

Contract Change Order No. 1

CONTRACT: Grand Avenue Resurfacing, Plumas St. to Patrick Ct.

WORK ORDER NO. C6-0073
CALTRANS EA NO.
LOCAL-FED AID NO.
STATE-FED AID NO.

TO: Onyx Paving Company, Inc. CONTRACTOR: YOU ARE HEREBY DIRECTED TO MAKE THE HEREIN DESCRIBED CHANGES FROM THE PLANS AND SPECIFICATIONS OR DO THE FOLLOWING DESCRIBED WORK NOT INCLUDED IN THE PLANS AND SPECIFICATIONS ON THIS CONTRACT.

Description of work to be done, estimate of quantities and prices to be paid. Segregated between additional work at contract price, agreed price and force account. Unless otherwise stated, rates for rental of equipment cover only such time as equipment is actually used and no allowance will be made for idle time.

Estimate of Extra Work at Agreed Unit Price

As directed by the Engineer and attached plans and in accordance with the applicable sections of the Special Provisions; contractor is to perform the following contract items at agreed unit price:

Table with 5 columns: Item Description, Quantity, Unit, Unit Price, and Total Price. Items include PLACE HOT MIX ASPHALT DIKE, ROADWAY EXCAVATION, PLACE ASPHALT CONCRETE DIKE, etc.

Total Estimate of Extra Work at Agreed Unit Price \$487,533.90

Estimated Cost: Decrease \$ Increase \$487,533.90

Participating: Yes: [] No: [] N/A: [x]

WE, the undersigned contractor, have given careful consideration to the change proposed and hereby agree that we will provide all equipment, furnish all materials, except as may otherwise be noted above, and perform all services necessary for the work above specified, and will accept as full payment therefor the prices shown above. By reason of this proposed change 20 days adjustment of time will be allowed.

Accepted Vivian Tran 8/18/2021
Onyx Paving Company, Inc. Date

NOTE: This change order is not effective until approved by County. If the Contractor does not sign acceptance of this order, his attention is directed to the requirements of the specifications as to proceeding with the ordered work and filing a written protest with the time therein specified.

Cindi A. Wachi 8/18/2021

Approval Recommended Cindi Wachi, Engineering Division Manager Date

Mark Lancaster 8-26-21

Approved Mark Lancaster, Director of Transportation Date

Karen S. Spiegel 10-26-2021
Approved Karen S. Spiegel, Chairman, Riverside County Board of Supervisors Date

KAREN SPIEGEL

FORM APPROVED COUNTY COUNSEL

BY: DANIELLE D. MALAND

ATTEST: KECIA R. HARPER, Clerk BY: [Signature]

**COUNTY OF RIVERSIDE
TRANSPORTATION DEPARTMENT**

**GRAND AVENUE
RESURFACING
MACHADO ST TO RIVERSIDE DR.
BONNIE LEA ST TO APPROX. 350' S. OF ORTEGA HWY
CITY OF LAKE ELSINORE
PR No. C6-0073**

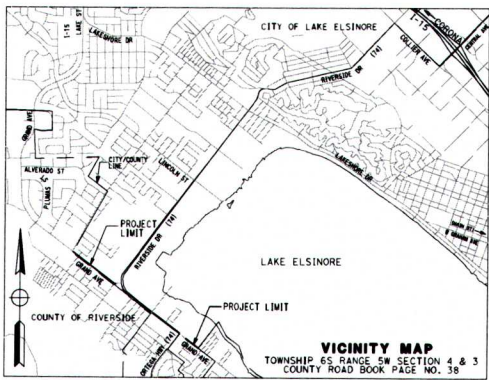
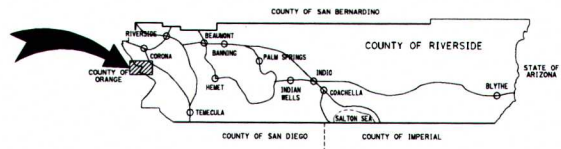

ABBREVIATIONS & LEGEND

AB	AGGREGATE BASE	R/W	RIGHT OF WAY
AC	ASPHALT CONCRETE	SHLD	SHOULDER
AP	ANGLE POINT	STA	STATION
ARHM	ASPHALT RUBBER HOT MIX	STD	STANDARD
BCR	BEGIN CURB RETURN	TBM	TEMPORARY BENCHMARK
BEG	BEGIN	TC	TOP OF CURB
BLDG	BUILDING	UB	UTILITY BOX
CB	CATCH BASIN	VAR	VARIES
CIR	COLD IN PLACE RECYCLING	W	WIDTH
CL	CENTER LINE	∅	CLEAN OUT
CMP	CORRUGATED METAL PIPE	∅	DRAIN INLET RECTANGULAR
CONC	CONCRETE	∅	DRAIN INLET ROUND
C&G	CURB AND GUTTER	∅	FIRE HYDRANT
DWY	DRIVEWAY	∅	GAS VALVE
ECR	END CURB RETURN	—	GUY WIRE
EP	EDGE OF PAVEMENT	∅	LIGHT
ETW	EDGE OF TRAVEL WAY	∅	MAIL BOX(S)
EX	EXISTING	∅	MANHOLE
FH	FIRE HYDRANT	∅	POWER POLE
FL	FLOWLINE	—	SLOPE - PROPOSED
FS	FINISHED SURFACE	∅	TRAFFIC SIGNAL
HMA	HOT MIX ASPHALT	∅	WATER METER
L	LENGTH	∅	WATER VALVE
LT	LEFT		
MOD	MODIFICATION, MODIFIED		
NAP	NOT A PART		
NO.	NUMBER		
PCC	PORTLAND CEMENT CONCRETE		
PIF	POINT OF INTERSECTING GUTTER FLOWLINES		
PP	POWER POLE		
R	RADIUS		
RAP	RUBBERIZED HOT MIX ASPHALT		
RHMA	REINFORCED CONCRETE PIPE		
RT	RIGHT		
RW	RETAINING WALL		

INDEX OF SHEETS

SHEET No.	DESCRIPTION
2	TYPICAL CROSS SECTIONS
3 - 5	LAYOUT
6 - 8	PAVEMENT DELINEATION

C6-0073 GRAND AVE RESURF.

CONCURRED BY <i>Devin Habel</i> 6-10-2021 CITY ENGINEER CITY OF LAKE ELSINORE	CONCURRED BY <i>Mark Lancaster</i> 6/14/2021 DIRECTOR OF TRANSPORTATION COUNTY OF RIVERSIDE	PREPARED BY <i>Alfredo P. Martinez</i> 6/3/2021 PROJECT MANAGER COUNTY OF RIVERSIDE	TITLE GRAND AVE RESURFACING 12+69 TO 34+92 261+80 TO 268+40	SHEET No. T-1 SHEET 1 of 8
--	--	--	--	--

THE CONTRACTOR SHALL NOTIFY UNDERGROUND SERVICE ALERT, (800) 227-2600, AND ALL CONCERNED UTILITY COMPANIES AT LEAST TWO WORKING DAYS IN ADVANCE OF EXCAVATION
BORDER LAST REVISED 07/21/2015

PR C6-00743 COUNTY FILE No.

CONSTRUCTION NOTES:

- 1 PROTECT
- 2 MATCH EXISTING
- 3 SANCUIT
- 4 ADJUST WATER VALVE COVER TO GRADE BY CONTRACTOR
- 5 ADJUST GAS VALVE COVER TO GRADE BY CONTRACTOR
- 6 ADJUST MANHOLE TO GRADE BY OWNER (PER PLAN)
- 7 RECONSTRUCT 6" AC DIKE PER COUNTY STD. NO. 212
- 8 CONSTRUCT 4" HOT MIX ASPHALT DIKE, TYPE "E" PER CALTRANS STD. PLAN AB78
- 9 COLDFRAME EX AC PAVEMENT DOWN 0.2' AND PLACE BACK 0.2' HMA, TYPE A, PG 64-10, 1/2" MIX
- 10 EXCAVATED TO DEPTH OF 1.50' MOISTURE CONDITION AND COMPACT TO 95%. PLACE 0.50' OF HMA, TYPE A PG 64-10, 1/2" MIX, OVER 1.13' OF CLASS II AGGREGATE BASE
- 11 EXCAVATED TO DEPTH OF 0.5' MOISTURE CONDITION AND COMPACT TO 95%. PLACE 0.5' OF HMA, TYPE "A" PG 64-10, 1/2" MIX.
- 12 RECONSTRUCT CROSS GUTTER AND SPANDREL PER COUNTY STD. NO. 209 AND 209A
- 13 RECONSTRUCT CURB RAMP CASE "B" PER CALTRANS STD. PLAN AB8A (WITH RETAINING CURB IF SHOWN ON PLAN)
- 14 RECONSTRUCT CURB RAMP CASE "C" PER CALTRANS STD. PLAN AB8A (MODIFY TO FIT CURB RETURN)
- 15 EXCAVATE TO DEPTH OF 0.3' MOISTURE CONDITION AND COMPACT TO 95%. PLACE 0.3' OF HMA, TYPE "A" PGO-10, 1/2" MIX

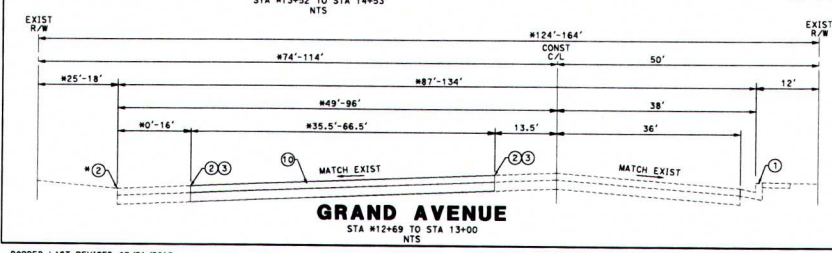
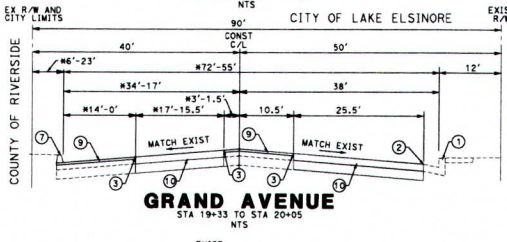
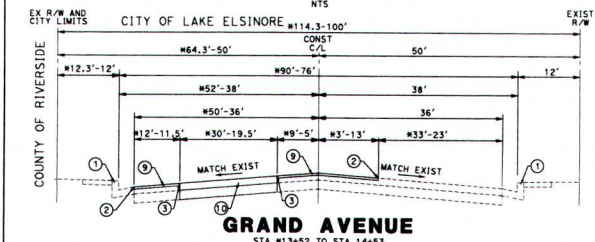
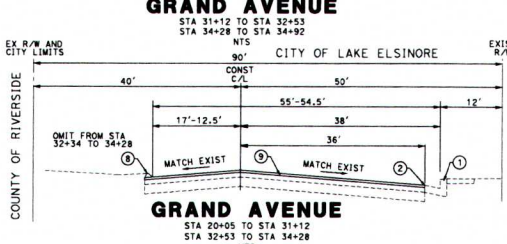
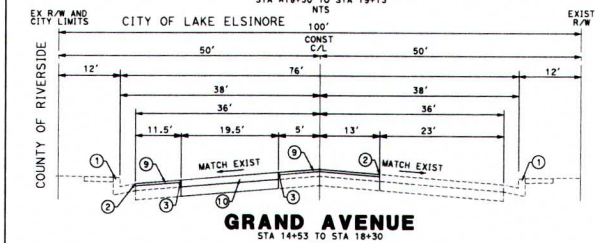
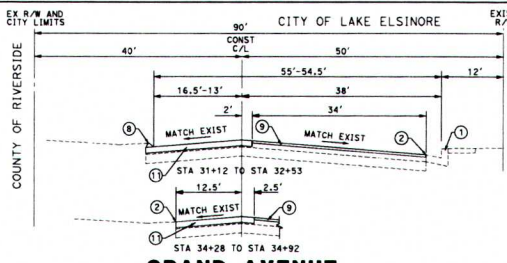
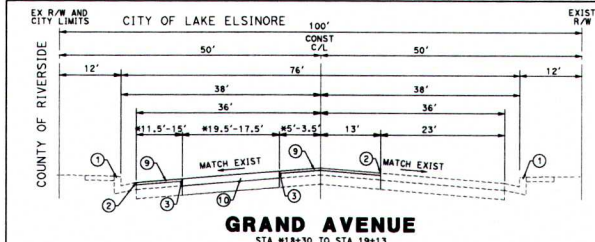

PREPARED BY
PREPARED UNDER THE SUPERVISION OF:
APPROVED: P. VARTINEZ
PROJECT NUMBER: 13+52 TO 34+92
COUNTY OF RIVERSIDE
DATE: 6/9/2021

CROSS-SECTION	SHEET No.
GRAND AVENUE RESURFACING	X-1
13+52 to 34+92	SHEET 2 of 8

BORDER LAST REVISED 07/21/2015

USERNAME => BUSER
DIR FILE => REQUEST

PR C6-0073

COUNTY FILE NO.

DATE PLOTTED => 6/9/2021 10:00:00 AM

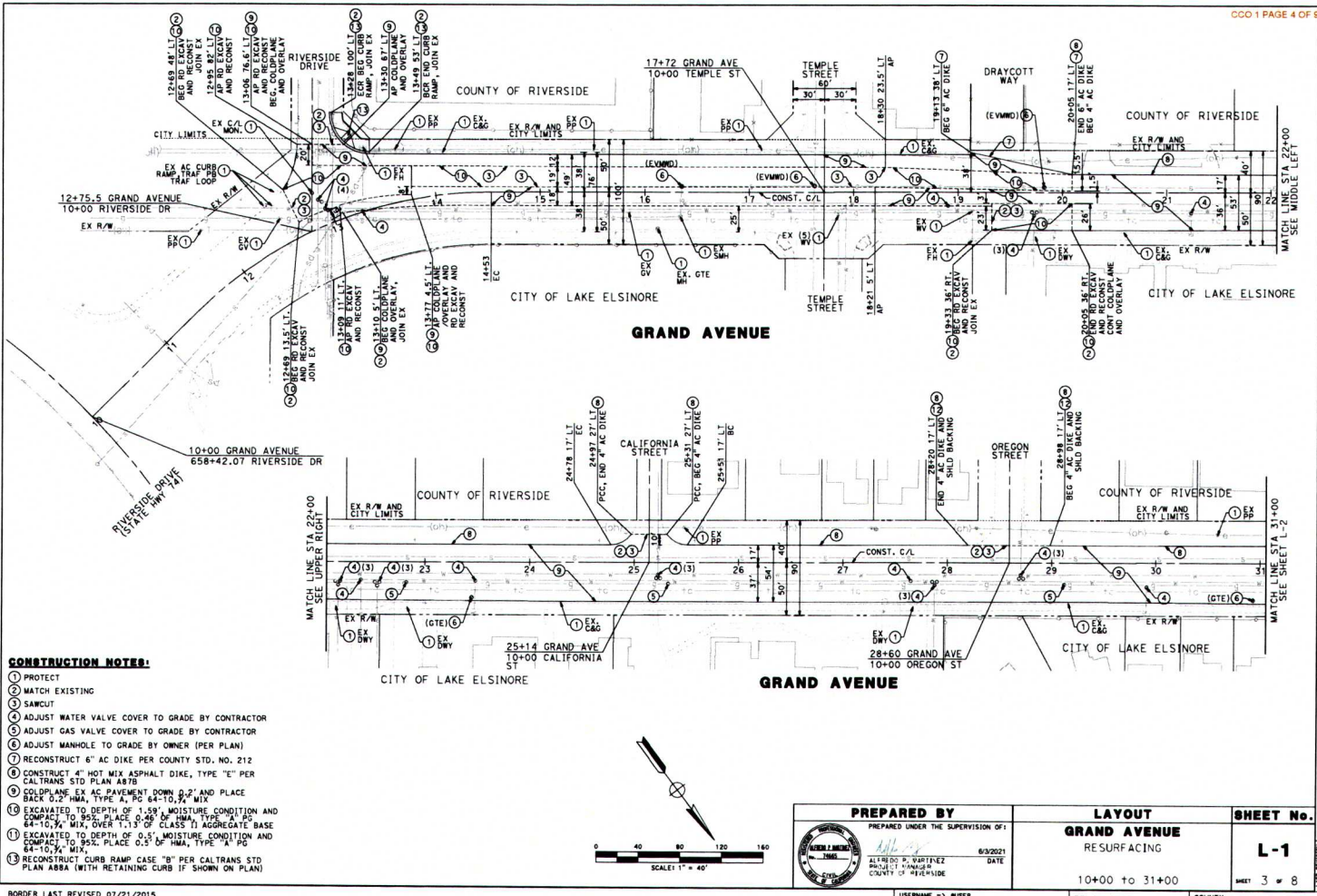

CONSTRUCTION NOTES:

- ① PROTECT
- ② MATCH EXISTING
- ③ SAWCUT
- ④ ADJUST WATER VALVE COVER TO GRADE BY CONTRACTOR
- ⑤ ADJUST GAS VALVE COVER TO GRADE BY CONTRACTOR
- ⑥ ADJUST MANHOLE TO GRADE BY OWNER (PER PLAN)
- ⑦ RECONSTRUCT 6" AC DIKE PER COUNTY STD. NO. 212
- ⑧ CONSTRUCT 4" HOT MIX ASPHALT DIKE, TYPE "E" PER CALTRANS STD PLAN AB7B
- ⑨ COLDRANE EX AC PAVEMENT DOWN 0.2' AND PLACE BACK 0.2' HMA, TYPE A, PG 64-10, 94 MIX
- ⑩ EXCAVATED TO DEPTH OF 1.5', MOISTURE CONDITION AND COMPACT TO 95%. PLACE 0.45' OF HMA, TYPE A, PG 64-10, 94 MIX OVER 1.1' OF CLASS 71 AGGREGATE BASE
- ⑪ EXCAVATED TO DEPTH OF 0.5', MOISTURE CONDITION AND COMPACT TO 95%. PLACE 0.5' OF HMA, TYPE "A" PG 64-10, 94 MIX
- ⑬ RECONSTRUCT CURB RAMP CASE "B" PER CALTRANS STD PLAN AB8A (WITH RETAINING CURB IF SHOWN ON PLAN)

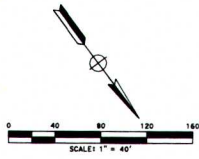

<p>PREPARED BY</p> <p>PREPARED UNDER THE SUPERVISION OF:</p> <p>ALVARO R. VAZQUEZ PROJECT MANAGER COUNTY OF RIVERSIDE</p>	<p>LAYOUT</p> <p>GRAND AVENUE</p> <p>RESURFACING</p>	<p>SHEET No.</p> <p>L-1</p>
	<p>10+00 to 31+00</p> <p>PR C6-0073</p>	<p>DATE: 6/3/2021</p> <p>COUNTY FILE No.</p>

BORDER LAST REVISED 07/21/2015

USERNAME => RUSIA
DON FILE => REQUEST

DATE PLOTTED => DATE PLOTTED => TIME PLOTTED => TIME

PREPARED BY
 PREPARED UNDER THE SUPERVISION OF:
 DATE: _____
 COUNTY OF WASHINGTON
 FILE NO. _____
 PROJECT: _____



EXHIBIT	PR C6-0073
GRAND AVENUE RESURFACING	31+00 TO 35+53.5
SHEET NO. L-2	SHEET 4 OF 8

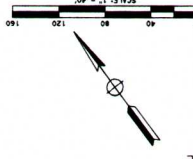
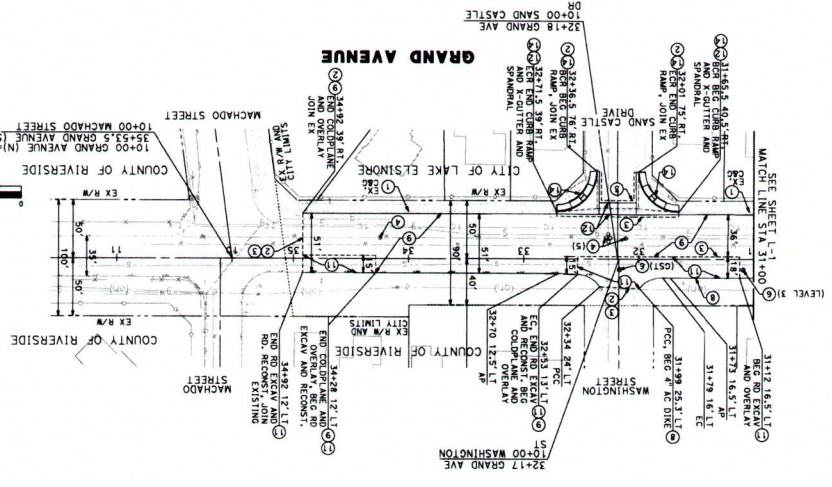

CONSTRUCTION NOTES:

1. PROTECT
2. MATCH EXISTING
3. SAND
4. ADJUST WATER VALVE COVER TO GRADE BY CONTRACTOR
5. ADJUST GAS VALVE COVER TO GRADE BY CONTRACTOR
6. ADJUST MANHOLE TO GRADE BY OWNER (PER PLAN)
7. CONSTRUCT 6\"/>

CONSTRUCTION NOTES:

- 1 PROTECT
- 2 MATCH EXISTING
- 3 SAWCUT
- 4 ADJUST WATER VALVE COVER TO GRADE BY CONTRACTOR
- 5 ADJUST GAS VALVE COVER TO GRADE BY CONTRACTOR
- 6 ADJUST MANHOLE TO GRADE BY OWNER (PER PLAN)
- 7 COLDFLAME EX AC PAVEMENT DOWN 0.2" AND PLACE BACK 0.2" HMA, TYPE A, PG 64-10, 1/2" MIX
- 8 RECONSTRUCT CROSS GUTTER AND SPANDREL PER COUNTY STD. NO. 209 AND 209A
- 9 RECONSTRUCT CURB RAMP CASE "B" PER CALTRANS STD PLAN AREA (WITH RETAINING CURB IF SHOWN ON PLAN)
- 10 EXCAVATE TO DEPTH OF 0.3', MOISTURE CONDITION AND COMPACT TO 95% PLACE 0.3" OF HMA, TYPE "A" PGO-10, 1/2" MIX

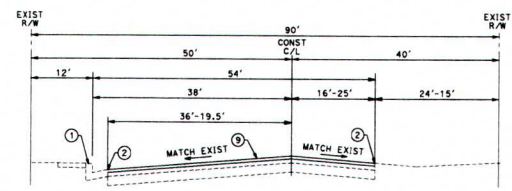
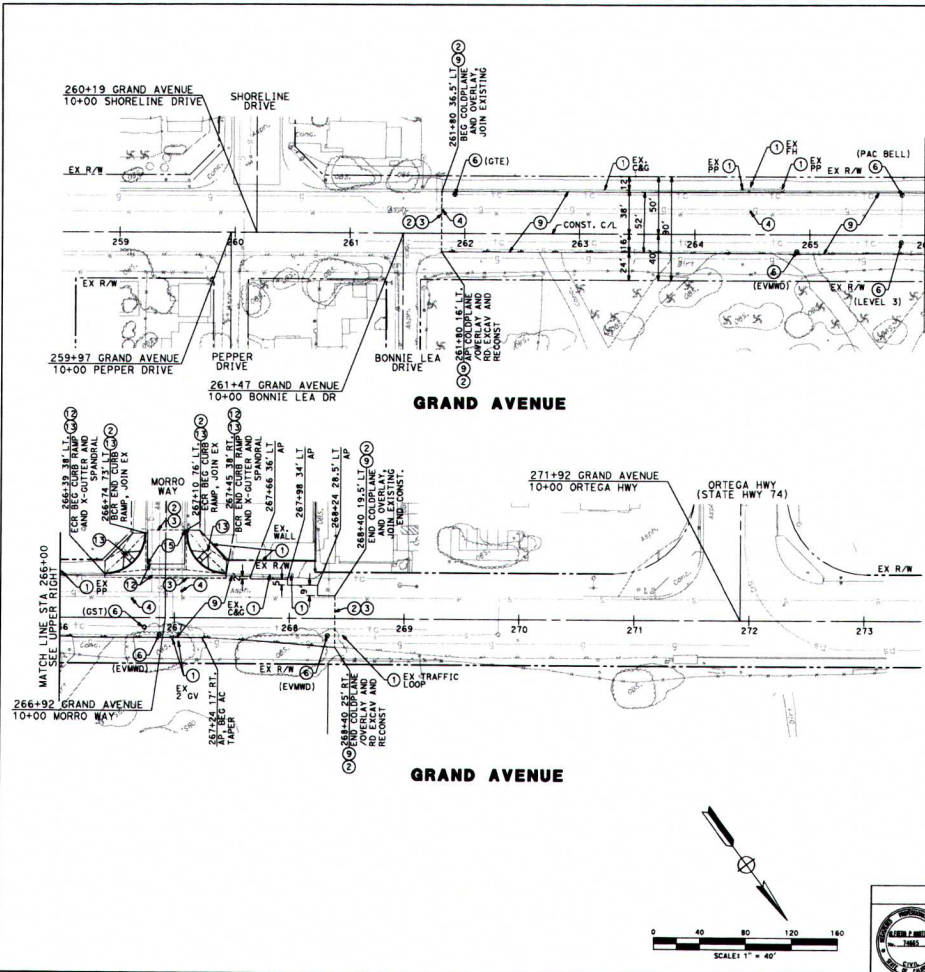

GRAND AVENUE
STA 267+24 TO STA 268+40

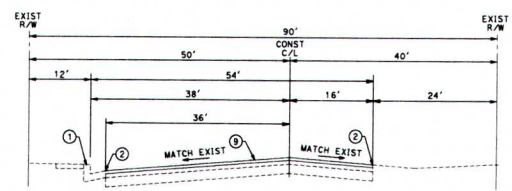

GRAND AVENUE
STA 261+80 TO STA 267+24

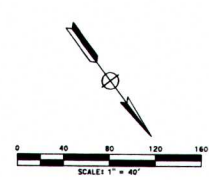

PREPARED BY PREPARED UNDER THE SUPERVISION OF: DON MARTINEZ CIVIL ENGINEER COUNTY OF RIVERSIDE	LAYOUT/X-SECTIONS GRAND AVENUE RESURFACING 261+80 TO 268+40	SHEET No. L-3 SHEET 5 OF 8
		USERNAME => BUZER DON FILE => WREKST PR C6-0073 COUNTY FILE NO.

BORDER LAST REVISED 07/21/2015

LAYOUTS
 DATE PLOTTED =>
 TIME PLOTTED =>
 06-01-21

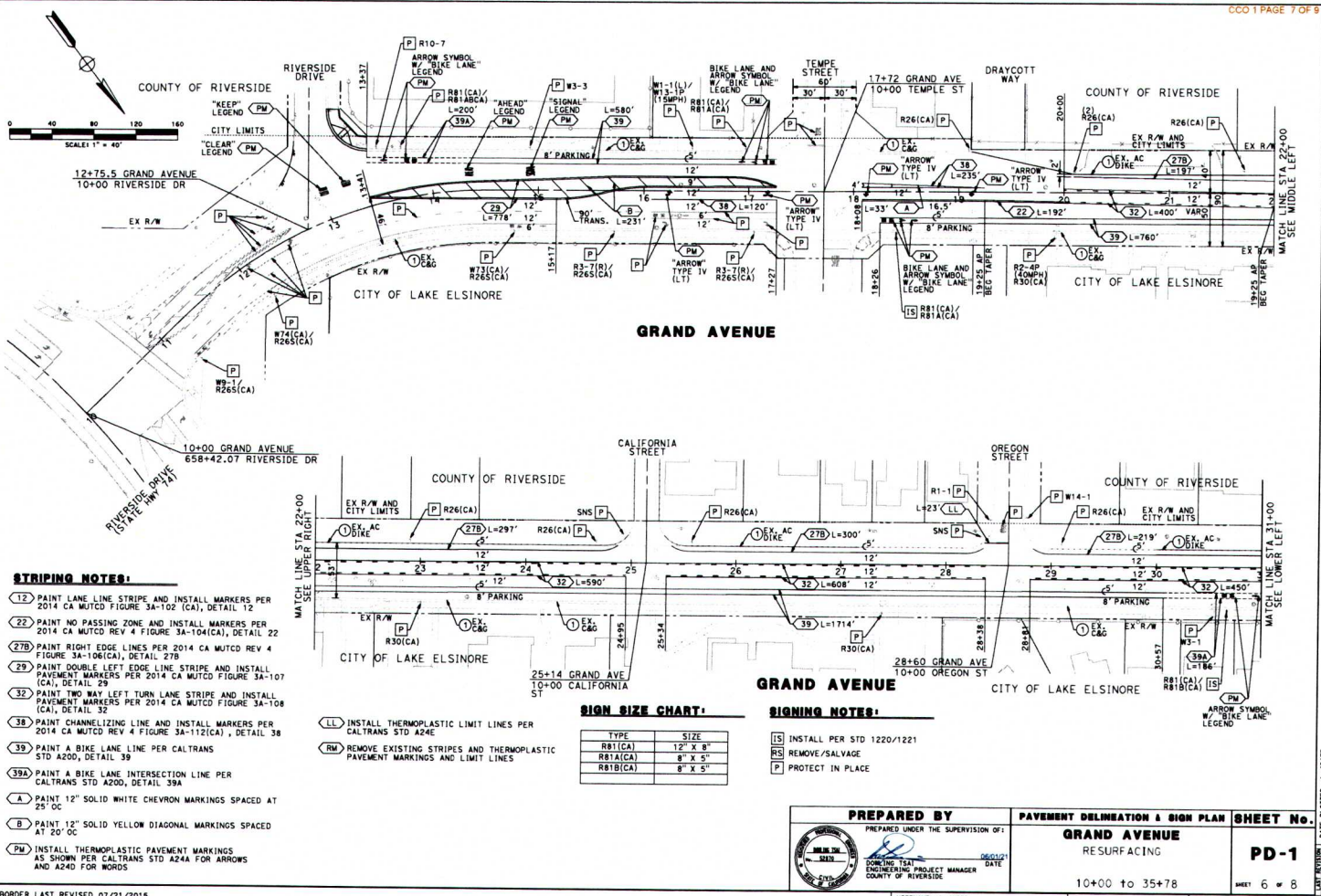

- STRIPING NOTES:**
- 12 PAINT LANE LINE STRIPE AND INSTALL MARKERS PER 2014 CA MUTCD FIGURE 3A-102 (CA), DETAIL 12
 - 22 PAINT NO PASSING ZONE AND INSTALL MARKERS PER 2014 CA MUTCD REV 4 FIGURE 3A-104(CA), DETAIL 22
 - 27B PAINT RIGHT EDGE LINES PER 2014 CA MUTCD REV 4 FIGURE 3A-106(CA), DETAIL 27B
 - 29 PAINT DOUBLE LEFT EDGE LINE STRIPE AND INSTALL PAVEMENT MARKERS PER 2014 CA MUTCD FIGURE 3A-107 (CA), DETAIL 29
 - 32 PAINT TWO WAY LEFT TURN LANE STRIPE AND INSTALL PAVEMENT MARKERS PER 2014 CA MUTCD FIGURE 3A-108 (CA), DETAIL 32
 - 38 PAINT CHANNELIZING LINE AND INSTALL MARKERS PER 2014 CA MUTCD REV 4 FIGURE 3A-112(CA), DETAIL 38
 - 39 PAINT A BIKE LANE LINE PER CALTRANS STD A200, DETAIL 39
 - 39A PAINT A BIKE LANE INTERSECTION LINE PER CALTRANS STD A200, DETAIL 39A
 - A PAINT 12" SOLID WHITE CHEVRON MARKINGS SPACED AT 25' OC
 - B PAINT 12" SOLID YELLOW DIAGONAL MARKINGS SPACED AT 20' OC
 - PM INSTALL THERMOPLASTIC PAVEMENT MARKINGS AS SHOWN PER CALTRANS STD A24A FOR ARROWS AND A24D FOR WORDS

- LL INSTALL THERMOPLASTIC LIMIT LINES PER CALTRANS STD A24E
- RM REMOVE EXISTING STRIPES AND THERMOPLASTIC PAVEMENT MARKINGS AND LIMIT LINES

SIGN SIZE CHART:

TYPE	SIZE
R81(CA)	12" X 8"
R81A(CA)	8" X 5"
R81B(CA)	8" X 5"

- SIGNING NOTES:**
- IS INSTALL PER STD 1220/1221
 - RS REMOVE/SALVAGE
 - P PROTECT IN PLACE

<p>PREPARED BY</p> <p>PREPARED UNDER THE SUPERVISION OF:</p> <p><i>[Signature]</i></p> <p>DATE: 06/11/21</p> <p>ENGINEERING PROJECT MANAGER</p> <p>COUNTY OF RIVERSIDE</p>	<p>PAVEMENT DELINEATION & SIGN PLAN SHEET No.</p> <p>GRAND AVENUE</p> <p>RESURFACING</p> <p>10+00 to 35+78</p> <p>PD-1</p> <p>SHEET 6 of 8</p>
---	---

BORDER LAST REVISED 07/21/2015

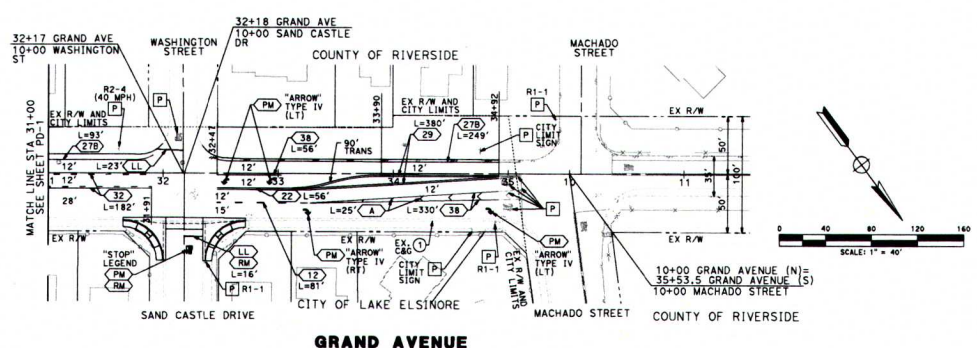

- STRIPING NOTES:**
- (12) PAINT LANE LINE STRIPE AND INSTALL MARKERS PER 2014 CA MUTCD FIGURE 3A-102 (CA), DETAIL 12
 - (22) PAINT NO PASSING ZONE AND INSTALL MARKERS PER 2014 CA MUTCD REV 4 FIGURE 3A-104(CA), DETAIL 22
 - (27B) PAINT RIGHT EDGE LINES PER 2014 CA MUTCD REV 4 FIGURE 3A-104(CA), DETAIL 27B
 - (29) PAINT DOUBLE LEFT EDGE LINE STRIPE AND INSTALL PAVEMENT MARKERS PER 2014 CA MUTCD FIGURE 3A-107 (CA), DETAIL 29
 - (32) PAINT TWO WAY LEFT TURN LANE STRIPE AND INSTALL PAVEMENT MARKERS PER 2014 CA MUTCD FIGURE 3A-108 (CA), DETAIL 32
 - (38) PAINT CHANNELIZING LINE AND INSTALL MARKERS PER 2014 CA MUTCD REV 4 FIGURE 3A-112(CA), DETAIL 38
 - (A) PAINT 12" SOLID WHITE CHEVRON MARKINGS SPACED AT 25' OC
 - (PM) INSTALL THERMOPLASTIC PAVEMENT MARKINGS AS SHOWN PER CALTRANS STD A24A FOR ARROWS AND A240 FOR WORDS
 - (LL) INSTALL THERMOPLASTIC LIMIT LINES PER CALTRANS STD A24E
 - (RM) REMOVE EXISTING STRIPES AND THERMOPLASTIC PAVEMENT MARKINGS AND LIMIT LINES

- SIGNING NOTES:**
- (S) INSTALL PER STD 1220/1221
 - (RS) REMOVE/SALVAGE
 - (P) PROTECT IN PLACE

BORDER LAST REVISED 07/21/2015

<p>PREPARED BY</p> <p>PREPARED UNDER THE SUPERVISION OF:</p> <p>DATE: 06/11/15</p> <p>ENGINEERING PROJECT MANAGER COUNTY OF RIVERSIDE</p>	<p>PAVEMENT DELINEATION & SIGN PLAN</p> <p>GRAND AVENUE</p> <p>RESURFACING</p> <p>31+00 to 35+53.5</p>	<p>SHEET No.</p> <p>PD-2</p> <p>SHEET 7 OF 8</p>
		<p>USERNAME => RWZER DON FILE => WREQUEST</p>

SHEET NUMBER: DATE PLOTTED => DATE PLOTTED => TIME

STRIPING NOTES:

- (22) PAINT NO PASSING ZONE AND INSTALL MARKERS PER 2014 CA MUTCD REV 4 FIGURE 3A-104(CA), DETAIL 22
- (27B) PAINT RIGHT EDGE LINES PER 2014 CA MUTCD REV 4 FIGURE 3A-106(CA), DETAIL 27B
- (32) PAINT TWO WAY LEFT TURN LANE STRIPE AND INSTALL PAVEMENT MARKERS PER 2014 CA MUTCD FIGURE 3A-108(CA), DETAIL 32
- (38) PAINT CHANNELIZING LINE AND INSTALL MARKERS PER 2014 CA MUTCD REV 4 FIGURE 3A-112(CA), DETAIL 38
- (PM) INSTALL THERMOPLASTIC PAVEMENT MARKINGS AS SHOWN PER CALTRANS STD A24A FOR ARROWS AND A24D FOR WORDS
- (LL) INSTALL THERMOPLASTIC LIMIT LINES PER CALTRANS STD A24E

SIGNING NOTES:

- (P) PROTECT IN PLACE

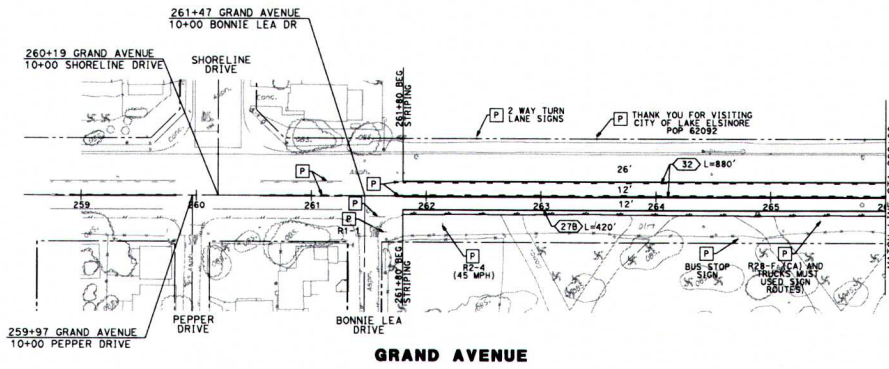
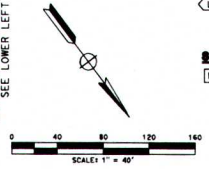

GRAND AVENUE

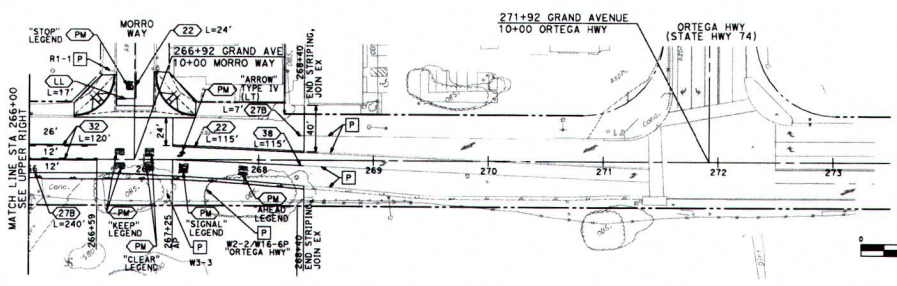

GRAND AVENUE

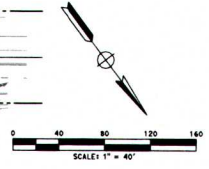

<p>PREPARED BY</p> <p>PREPARED UNDER THE SUPERVISION OF:</p> <p>DOUGLAS TSAI ENGINEERING PROJECT MANAGER COUNTY OF RIVERSIDE</p>	<p>PAVEMENT DELINEATION & SIGN PLAN</p>	<p>SHEET No.</p>
	<p>GRAND AVENUE</p> <p>RESURFACING</p> <p>259+50 to 273+50</p>	<p>PD-3</p> <p>SHEET 8 of 8</p>

BORDER LAST REVISED 07/21/2015

USERNAME => RUSER
DON FILE => RREQUEST
PR C6-0073
COUNTY FILE No.

DATE PLOTTED => DATE
 TIME PLOTTED => TIME
 06-01-21

Grand Avenue Resurfacing , Plumas St. to Patrick Ct.

Contract CCO History

Contract No. C6-0073
 Work Order No. C6-0073
 Contract Amount \$1,431,000.00

Single Maximum CCO \$84,050.00
 Maximum CCO's \$143,100.00

CCO Category Legend	
AFA	Anticipated Force Account
CFC	Changed Field Conditon
CME	Contract Management Error
DO	Design Omission
OAM	Outside Agency Mandate
RWO	Right-of-Way Obligation
SE	Survey Error
UB	Upgrade/Betterment
UI	Utility Interference

CCO No.	Amount This CCO	Authority	Cumulative CCO's	% Original Authorized	Cumulative CCO %	CCO Category	Classification
1	\$487,533.90	Board	\$487,533.90	34.07%	34.07%	OAM	Unavoidable
	\$487,533.90			34.07%			

New Authorized Contract Total	\$1,918,533.90
Total CCO Dollars To Date	\$487,533.90
Total % Increased by CCO's	34.07%

LETTER OF TRANSMITTAL

**Local Agency: County of Riverside
Transportation Department**

DATE: August 24, 2021

**File: Grand Avenue Resurfacing Project,
Plumas St. to Patrick Ct.**

W.O. No.: C6-0073

C.C.O.: 2

TO: Mark Lancaster

From: Cindi Wachi

\$207,645.00 (14.5% of the original contract amount of \$1,431,000.00)

This contract change order compensates the contractor for the construction of sidewalk improvements.

These sidewalk improvements were added to the project to enhance public safety by improving pedestrian routes and access to schools in the area.

The amount of this Contract Change Order is \$207,645.00 The accumulation of all Contract Change Orders thus far, including this one, is \$695,178.90.

Previous Contract Change Order Amounts Approved:

See C.C.O. History
(attached

\$487,533.90

File: Grand Avenue Resurfacing Project, Plumas St. to Patrick Ct.

W.O. No.: C6-0073

C.C.O. No. 2

Page 2

This Contract Change Order was discussed with County Staff and they gave their concurrence to this change.

Adjustment of Time: 15 working days

ESTIMATE OF COST

Items

Force Account

Agreed Price \$207,645.00

Adjustment

TOTAL \$207,645.00

Cindi A. Wachi

Cindi Wachi

Engineering Division Manger

CCO	Amount	Funding Source
2	\$207,645.00	Unincorporated Community Initiative Funds (100%)

CCO Category		
AFA	Anticipated Force Account	
CFC	Changed Field Condition	
CME	Contract Management Error	
DO	Design Omission	
OAM	Outside Agency Mandate	
RWO	Right-of-Way Obligation	
SE	Survey Error	
UB	Upgrade/Betterment	√
UI	Utility Interference	



COUNTY OF RIVERSIDE
TRANSPORTATION DEPARTMENT

SHEET 1 OF 5 SHEETS

Contract Change Order No. 2

CONTRACT: Grand Avenue Resurfacing, Plumas St. to Patrick Ct. WORK ORDER NO. C6-0073
CALTRANS EA NO.
LOCAL-FED AID NO.
STATE-FED AID NO.

TO: Onyx Paving Company, Inc. CONTRACTOR: YOU ARE HEREBY DIRECTED TO MAKE THE HEREIN DESCRIBED CHANGES FROM THE PLANS AND SPECIFICATIONS OR DO THE FOLLOWING DESCRIBED WORK NOT INCLUDED IN THE PLANS AND SPECIFICATIONS ON THIS CONTRACT.

Description of work to be done, estimate of quantities and prices to be paid. Segregated between additional work at contract price, agreed price and force account. Unless otherwise stated, rates for rental of equipment cover only such time as equipment is actually used and no allowance will be made for idle time.

Estimate of Extra Work at Agreed Unit Price

As directed by the Engineer and attached plans and in accordance with the applicable sections of the Special Provisions; contractor is to perform the following contract items at agreed unit price:

Table with 5 columns: Item Description, Quantity, Unit, Rate, and Total Price. Items include Minor Concrete (Driveway Approach), Minor Concrete (Sidewalk), Minor Concrete (Curb Ramp), Salvage Roadside Sign, Roadside Sign - One Post, Develop Water Supply, Traffic Control System, Clearing and Grubbing, Remove Fence, Fence [Split Rail Vinyl], and Remove Tree.

Total Estimate of Extra Work at Agreed Unit Price \$207,645.00

Estimated Cost: Decrease \$ Increase \$207,645.00

Participating: Yes: [] No: [] N/A: [X]

WE, the undersigned contractor, have given careful consideration to the change proposed and hereby agree that we will provide all equipment, furnish all materials, except as may otherwise be noted above, and perform all services necessary for the work above specified, and will accept as full payment therefor the prices shown above. By reason of this proposed change 15 days adjustment of time will be allowed.

Accepted Vivian Tran 8/18/2021 Onyx Paving Company, Inc. Date

NOTE: This change order is not effective until approved by County. If the Contractor does not sign acceptance of this order, his attention is directed to the requirements of the specifications as to proceeding with the ordered work and filing a written protest with the time therein specified.

Cindi A. Wachi 8/18/2021

Approval Recommended Cindi Wachi, Engineering Division Manager Date

Mark Lancaster 8-26-21

Approved Mark Lancaster, Director of Transportation Date

Karen S. Spiegel 10/26/21

Approved Karen Spiegel, Chairman, Riverside County Board of Supervisors Date

FOR APPROVED COUNTY COUNSEL BY: DANIELLE D. MALAND

ATTEST: KECIA R. HARPER, Clerk By: [Signature]

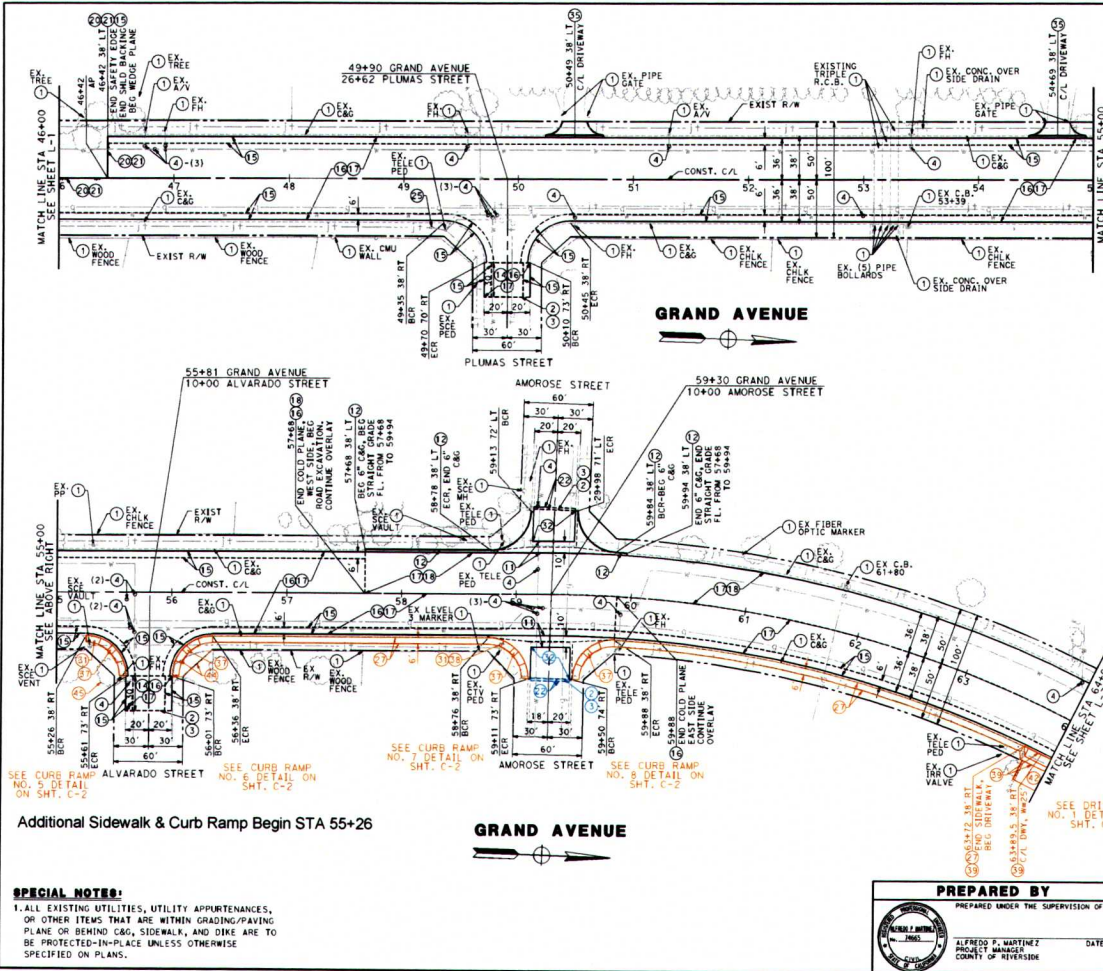

- CONSTRUCTION NOTES:**
- 1 PROTECT
 - 2 MATCH EXISTING
 - 3 SANQUIT
 - 4 ADJUST WATER VALVE COVER TO GRADE BY CONTRACTOR PER COUNTY STD. NO. 209 AND 209A
 - 5 RECONSTRUCT TYPE A-E CURB PER COUNTY STD. NO. 200
 - 6 GOLD PLANE TRANSITION TO MATCH EXISTING FINISH SURFACE PER DETAIL ON SHEET C-01
 - 7 WEDGE PLANE ASPHALT CONCRETE TO THE DEPTH OF 0.15" (6" WEDGE). SEE DETAIL ON SHEET C-01
 - 8 GOLD PLANE EXISTING AC PAVEMENT DOWN 0.20" AND PLACE BACK 0.20" HMA, TYPE 1, PG 64-10, 1/2" MIX
 - 9 OVERLAY 0.15" OF RMA TYPE "C" PC 64-16, 1/2" MIX
 - 10 EXCAVATE TO DEPTH OF 0.25'-0.40" MOISTURE CONDITION AND COMPACT TO 95%. PLACE 0.25" OF HMA, TYPE 1A PG 65-10, 1" MIX
 - 11 PLACE SAFETY EDGE PER DETAIL ON SHEET C-01
 - 12 GRADE SHOULDER AND PLACE 6" MIN SHOULDER BACKING SEE DETAIL ON SHEET C-01
 - 13 HEADER CUT AND OVERLAY EXISTING AC PAVEMENT DOWN (0.15" MIN.), 2" WIDE, PER DETAIL ON SHEET C-1
 - 14 REMOVE AND REPLACE EXISTING SEE PULLBOX BY OWNER
 - 15 RECONSTRUCT/CONSTRUCT SIDEWALK PER COUNTY STD. NO. 401
 - 16 RELOCATE EXISTING PEDESTAL BY OWNER (SPECTRUM)
 - 17 EXCAVATE TO DEPTH OF 0.31" MOISTURE CONDITION AND COMPACT TO 95%. PLACE 0.3" OF HMA, TYPE 1A PG 70-10, 1/2" MIX
 - 18 CONSTRUCT COMMERCIAL DRIVEWAY (MODIFIED), OMIT SIDEWALK, R=15', W=20' PER COUNTY STD. NO. 207A
 - 19 RECONSTRUCT CURB RAMP CASE B PER COUNTY STD. NO. 403, PER DETAIL SHOWN ON THE SHEET C-2
 - 20 REMOVE, REPLACE AND ADJUST TO GRADE EX SPECTRUM PULL BOX WITH TRAFFIC RATED PULL BOX AND LID.
 - 21 RECONSTRUCT RESIDENTIAL DRIVEWAY WITH SIDEWALK AT R/W PER COUNTY STD. NO. 213, (MODIFIED) PER DETAIL SHOWN ON THE SHEET C-2
 - 22 RELOCATE EXISTING MAILBOX BY CONTRACTOR
 - 23 RECONSTRUCT 6" TYPE D CURB PER COUNTY STD. NO. 204
 - 24 RECONSTRUCT 6" THICK CONCRETE DRIVEWAY PER DETAIL SHOWN ON THE SHEET C-2
 - 25 REMOVE, REPLACE AND ADJUST TO GRADE EX W.M. WITH TRAFFIC RATED W.M. BOX AND LID.
 - 26 REMOVE AND REPLACE EXISTING VINYL RAIL TYPE FENCING
 - 27 REMOVE EXISTING TREE

SEE CURB RAMP ALVARADO STREET NO. 5, DETAIL ON SHT. C-2
 SEE CURB RAMP AMOROZE STREET NO. 7, DETAIL ON SHT. C-2
 SEE CURB RAMP AMOROZE STREET NO. 8, DETAIL ON SHT. C-2
 SEE CURB RAMP AMOROZE STREET NO. 9, DETAIL ON SHT. C-2

Additional Sidewalk & Curb Ramp Begin STA 55+26

SPECIAL NOTES:
 1. ALL EXISTING UTILITIES, UTILITY APPURTENANCES, OR OTHER ITEMS THAT ARE WITHIN GRADING/PAVING PLANE OR BEHIND C&G, SIDEWALK, AND DIKE ARE TO BE PROTECTED-IN-PLACE UNLESS OTHERWISE SPECIFIED ON PLANS.

BORDER LAST REVISED 07/21/2015



PREPARED BY  ALFREDO P. MARTINEZ PROJECT MANAGER COUNTY OF REVERSHIDE	PREPARED UNDER THE SUPERVISION OF: _____ DATE _____	LAYOUT GRAND AVENUE RESURFACING	SHEET No. L-2R
	USERNAME = RBER DON FILE = WREQUEST	NO C6-0073	COUNTY FILE No. _____

DATE PLOTTED: 03/11/2015
 TIME PLOTTED: 09:15 AM
 07-30-21

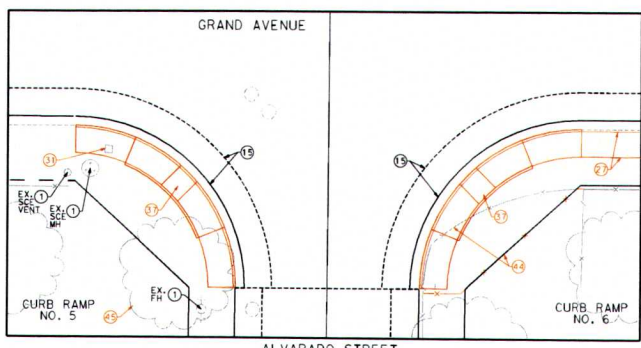

CURB RAMP NO. 5 AND NO. 6 DETAIL 13

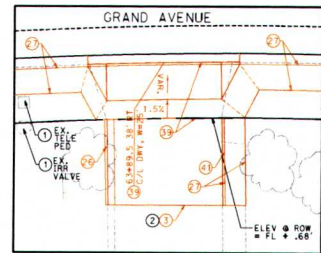

DRIVEWAY NO. 1 DETAIL 19

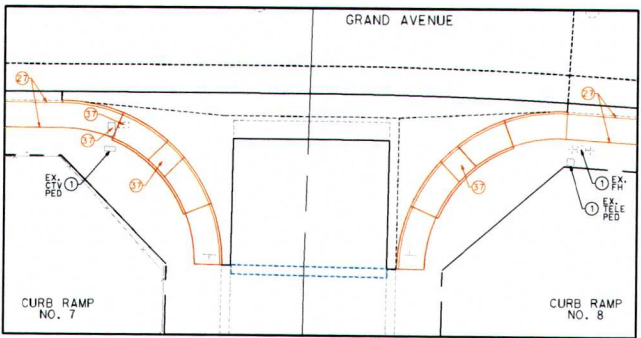

CURB RAMP NO. 7 AND NO. 8 DETAIL 13

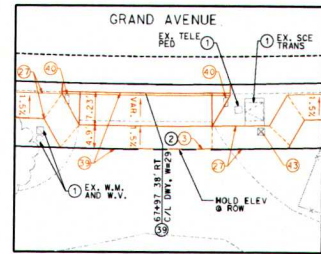

DRIVEWAY NO. 1 DETAIL 19

- CONSTRUCTION NOTES:**
- 1 PROTECT
 - 2 MATCH EXISTING
 - 3 SAWCUT
 - 4 ADJUST WATER VALVE COVER TO GRADE BY CONTRACTOR
 - 5 ADJUST TO GRADE BY CONTRACTOR
 - 6 RELOCATE EXISTING TYPE "A" SIGNAL POST TO BE 3.5' CLEAR FROM RAMP AND REPLACE EX. PEDESTRIAN BUTTON WITH A NEW ACCESSIBLE PEDESTRIAN SIGNAL UNIT PER SPECIAL PROVISIONS
 - 7 RECONSTRUCT 10' WIDE CROSS CUTTER AND SPANDREL PER COUNTY STD. NO. 209 AND 209A
 - 8 RECONSTRUCT CURB RAMP CASE "A" PER CALTRANS STD. PLAN AB3A WITH RETAINING CURB WHERE SHOWN ON THE ON SHEET C-1
 - 9 PULVERIZE TRANSITION TO MATCH EXISTING FINISH SURFACE PER DETAIL ON SHEET C-01
 - 10 WEDGE PLANE ASPHALT CONCRETE TO THE DEPTH OF 0.15' (6" WIDE). SEE DETAIL ON SHEET C-01.
 - 11 GRIND EXISTING AC PAVEMENT DOWN 0.20" AND PLACE BACK 0.20" HMA, TYPE A, PG 64-10, 1/2" MIX
 - 12 OVERLAY 0.15" OF HMA TYPE "C" PG 64-16, 1/2" MIX
 - 13 EXCAVATE TO DEPTH OF 0.40' MOISTURE CONDITION AND COMPACT TO 95%. PLACE 0.75" OF HMA TYPE "A", PG-10, 1" MIX, OVERLAY 0.15" HMA TYPE "C" 64-16, 1/2" MIX.
 - 14 PLACE SAFETY EDGE PER DETAIL ON SHEET C-01
 - 15 GRADE SHOULDER AND PLACE 6" MIN SHOULDER BACKING SEE DETAIL ON SHEET C-01
 - 16 HEADER CUT AND OVERLAY EXISTING AC PAVEMENT DOWN (0.15" MIN.), 2" WIDE, PER DETAIL ON SHEET C-1.
 - 17 RECONSTRUCT CURB RAMP CASE "B" PER CALTRANS STD. PLAN AB3A WITH RETAINING CURB WHERE SHOWN ON THE ON SHEET C-1
 - 18 CONSTRUCT 15' LONG, 6" TO 8" CURB AND CUTTER TRANSITION
 - 19 RECONSTRUCT TYPE A-B CURB PER COUNTY STD. NO. 201
 - 20 RECONSTRUCT/CONSTRUCT SIDEWALK PER COUNTY STD. NO. 401
 - 21 REMOVE EXISTING PEDESTRIAN CROSSING BUTTON
 - 22 INSTALL PEDESTRIAN PUSH BUTTON POST PER CALTRANS STD. NO. 55-7A AND INSTALL NEW ACCESSIBLE PEDESTRIAN SIGNAL UNIT PER SPECIAL PROVISIONS
 - 23 RELOCATE EX. TRAFFIC PULLBOX OUT OF PROPOSED CURB RAMP FLARED TRANSITION AREA
 - 24 RELOCATE EXISTING PEDESTAL BY OWNER (SPECTRUM)
 - 25 EXCAVATE TO DEPTH OF 0.3'. MOISTURE CONDITION AND COMPACT TO 95%. PLACE 0.3" OF HMA, TYPE "A", PG-10, 1/2" MIX
 - 26 INSTALL COMBINATION VIDEO/RADAR DETECTION CAMERA PRIOR TO ANY ROAD CONSTRUCTION. SET UP DETECTION ZONES PER STD. NO. 1204
 - 27 REMOVE EXISTING PEDESTRIAN CROSSING BUTTON AND INSTALL NEW ACCESSIBLE PEDESTRIAN SIGNAL UNIT PER SPECIAL PROVISIONS
 - 28 INSTALL VIDEO DETECTION CAMERA WITH 6' EXTENSIONS PRIOR TO ANY ROAD CONSTRUCTION. SETUP DETECTION ZONES PER STD. NO. 1204
 - 29 RECONSTRUCT CURB RAMP CASE B PER COUNTY STD. NO. 403, PER DETAIL SHOWN ON THE SHEET C-2
 - 30 RECONSTRUCT CURB RAMP CASE "B" PER CALTRANS STD. PLAN AB3A WITH RETAINING CURB WHERE SHOWN ON THE ON SHEET C-1
 - 31 RECONSTRUCT RESIDENTIAL DRIVEWAY WITH SIDEWALK AT R/W PER COUNTY STD. NO. 213, (MODIFIED) PER DETAIL SHOWN ON THE SHEET C-2
 - 32 RELOCATE EXISTING MAILBOX BY CONTRACTOR
 - 33 RECONSTRUCT 6" TYPE B CURB PER COUNTY STD. NO. 204
 - 34 RECONSTRUCT 6" THICK CONCRETE DRIVEWAY PER DETAIL SHOWN ON THE SHEET C-2
 - 35 REMOVE, REPLACE AND ADJUST TO GRADE EX. W.M. WITH TRAFFIC RATED W.W. BOX AND LID.
 - 36 REMOVE AND REPLACE EXISTING VINYL RAIL TYPE FENCING
 - 37 REMOVE EXISTING TREE

SPECIAL NOTES:
 1. ALL EXISTING UTILITIES, UTILITY APPURTENANCES, OR OTHER ITEMS THAT ARE WITHIN GRADING/PAVING PLANE OR BEHIND C&G, SIDEWALK, AND DIKE ARE TO BE PROTECTED-IN-PLACE UNLESS OTHERWISE SPECIFIED ON PLANS.

<p>PREPARED BY</p> <p>PREPARED UNDER THE SUPERVISION OF:</p> <p>ALFREDO F. MARTINEZ PROJECT MANAGER COUNTY OF RIVERSIDE</p>	<p>CONSTRUCTION DETAILS</p> <p>GRAND AVENUE RESURFACING</p>	<p>SHEET NO.</p> <p>C-2</p> <p>SHEET 6A OF 9</p>
	<p>DATE FILED: 12-11-2010</p> <p>TIME PLOTTED: 9:07 AM</p>	<p>DATE PLOTTED: 12-11-2010</p> <p>TIME PLOTTED: 9:07 AM</p>

Grand Avenue Resurfacing , Plumas St. to Patrick Ct.

Contract CCO History

Contract No. C6-0073
 Work Order No. C6-0073
 Contract Amount \$1,431,000.00

Single Maximum CCO \$84,050.00
 Maximum CCO's \$143,100.00

CCO Category Legend	
AFA	Anticipated Force Account
CFC	Changed Field Conditon
CME	Contract Management Error
DO	Design Omission
OAM	Outside Agency Mandate
RWO	Right-of-Way Obligation
SE	Suney Error
UB	Upgrade/Betterment
UI	Utility Interference

CCO No.	Amount This CCO	Authority	Cumulative CCO's	% Original Authorized	Cumulative CCO %	CCO Category	Classification
1	\$487,533.90	Board	\$487,533.90	34.07%	34.07%	OAM	Unavoidable
2	\$207,645.00	Board	\$695,178.90	14.51%	48.58%	OAM	Unavoidable
	<u>\$695,178.90</u>				48.58%		

New Authorized Contract Total \$2,126,178.90
 Total CCO Dollars To Date \$695,178.90
 Total % Increased by CCO's 48.58%