

**SUBMITTAL TO THE BOARD OF SUPERVISORS  
COUNTY OF RIVERSIDE, STATE OF CALIFORNIA**



ITEM: 3.21  
(ID # 18620)

**MEETING DATE:**  
Tuesday, May 10, 2022

**FROM :** TLMA-TRANSPORTATION:

**SUBJECT:** TRANSPORTATION AND LAND MANAGEMENT AGENCY/TRANSPORTATION:  
Notice of Completion – Fisher Street Resurfacing Project, Community of Good Hope. District 1.  
[\$0]

**RECOMMENDED MOTION:** That the Board of Supervisors:

1. Accept as complete the Construction of Fisher Street Resurfacing Project, District 1;
2. Authorize the Chair of the Board to execute the Notice of Completion on behalf of the County; and
3. Direct the Clerk of the Board to record the Notice of Completion.

**ACTION:Policy**

  
Mark Lancaster, Director of Transportation 4/14/2022

---

**MINUTES OF THE BOARD OF SUPERVISORS**

On motion of Supervisor Washington seconded by Supervisor Jeffries and duly carried by unanimous vote, IT WAS ORDERED that the above matter is approved as recommended.

Ayes: Jeffries, Spiegel, Washington, Perez, and Hewitt  
Nays: None  
Absent: None  
Date: May 10, 2022  
xc: Trans., Recorder

Kecia R. Harper  
Clerk of the Board

By:   
Deputy

**SUBMITTAL TO THE BOARD OF SUPERVISORS COUNTY OF RIVERSIDE,  
STATE OF CALIFORNIA**

| <b>FINANCIAL DATA</b>       | <b>Current Fiscal Year:</b> | <b>Next Fiscal Year:</b> | <b>Total Cost:</b>        | <b>Ongoing Cost</b> |
|-----------------------------|-----------------------------|--------------------------|---------------------------|---------------------|
| <b>COST</b>                 | \$ 0                        | \$ 0                     | \$ 0                      | \$ 0                |
| <b>NET COUNTY COST</b>      | \$ 0                        | \$ 0                     | \$ 0                      | \$ 0                |
| <b>SOURCE OF FUNDS: N/A</b> |                             |                          | <b>Budget Adjustment:</b> | No                  |
|                             |                             |                          | <b>For Fiscal Year:</b>   | 21/22               |

**C.E.O. RECOMMENDATION:** Approve

**BACKGROUND:**

**Summary**

By Minute Order 3.41 of January 11, 2022, the Board of Supervisors entered into a contract with Hardy & Harper, Inc. of Lake Forest, California for the Construction of Fisher Street Resurfacing Project, to resurface approximately one mile between Marshall Street to Cox Street, in the Community of Good Hope, District 1.

The original authorized amount of the contract was \$785,560. The total price of the contract came in at \$629,153 which is 19.9% less than the originally authorized amount. The reduction of the total cost was the result of using less quantities than anticipated to complete the work.

The work was completed in conformance with the plans and specifications and the contractor was granted relief of maintenance on March 1, 2022.

Project Number C9-0033

**Impact on Residents and Businesses**

The improvements benefit the project area by providing the public with a smooth paved roadway, significantly improving the safety and efficiency of vehicular traffic

**Additional Fiscal Information**

# COUNTY OF RIVERSIDE TRANSPORTATION DEPARTMENT

## FISHER STREET RESURFACING PROJECT MARSHALL STREET TO COX STREET COMMUNITY OF GOOD HOPE

PROJECT No. C9-0033

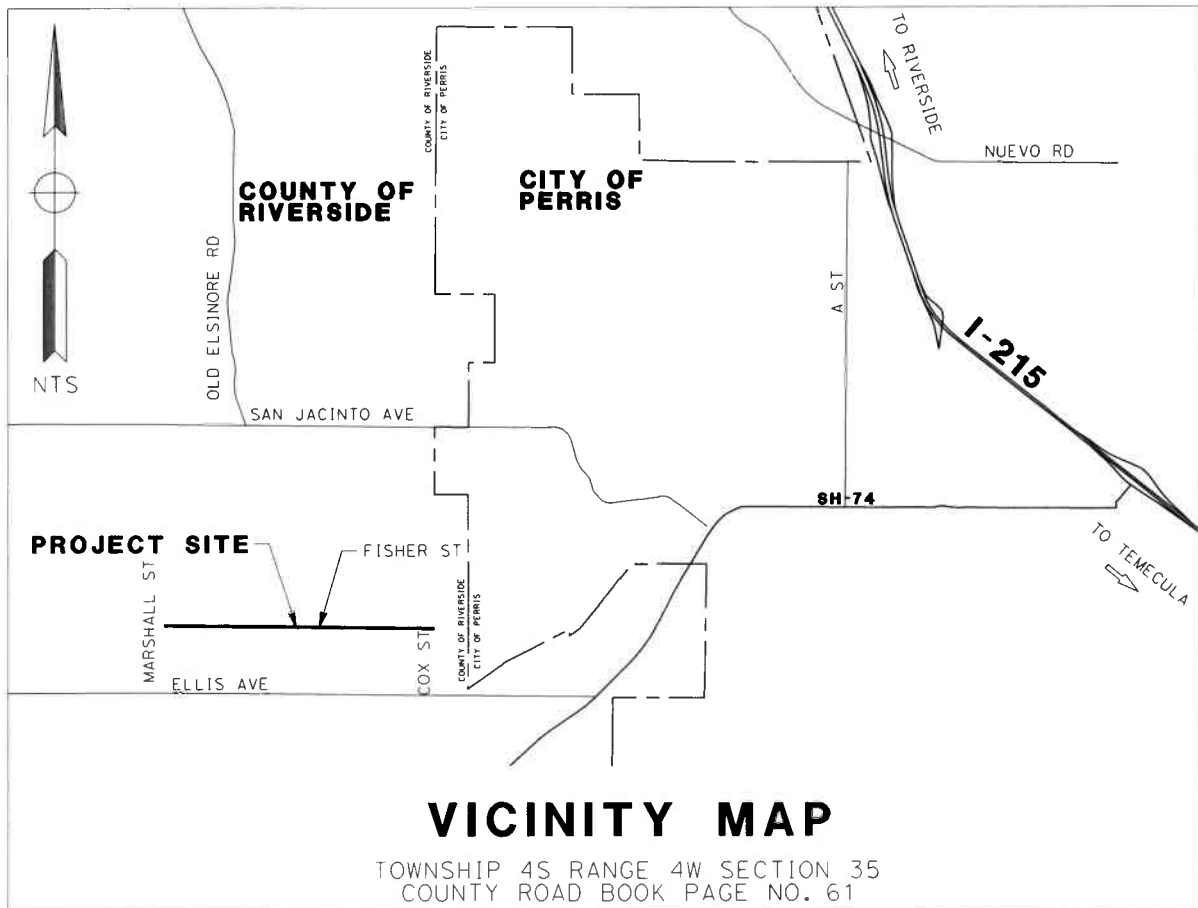
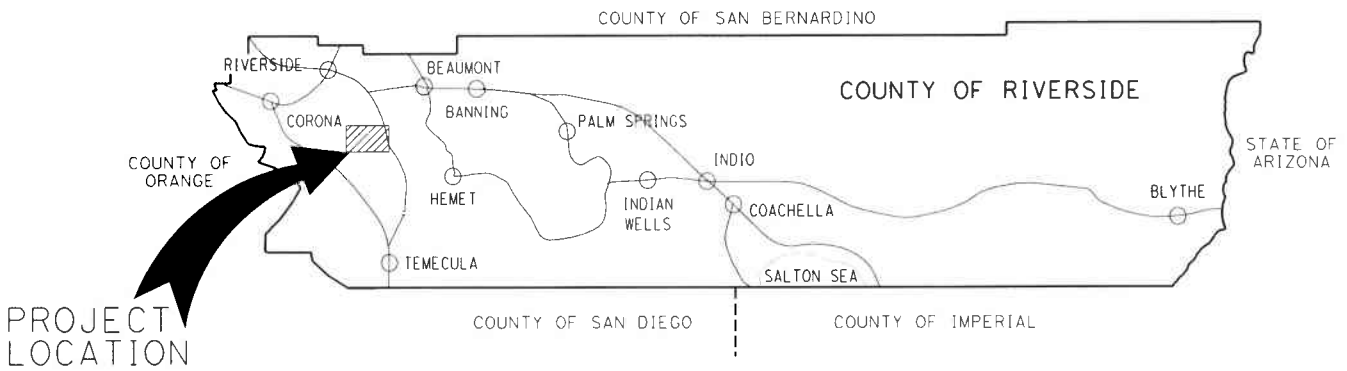

PROJECT: Fisher Street Resurfacing Project, Marshall Street to Cox Street  
 County Project No.: C9-0033  
 Contract No. 21-10-002



Contractor: Hardy & Harper, Inc.  
 Address: 32 Rancho Circle  
 City, State, Zip: Lake Forest, CA 92830

Estimate No. 1 Final  
 From: January 31, 2022  
 To: March 1, 2022

| Item No. | Item Description                           | Units | Quantity | Unit Price | Original Contract Amount | Change Orders Quantity | Change Orders Amount | Amended Contract Quantity | Amended Contract Amount | This Estimate Quantity | This Estimate Amount | Previous Quantity | Total Estimate To Date Quantity | Total Estimate To Date Amount | % Auth. |
|----------|--|-------|----------|------------|--------------------------|------------------------|----------------------|---------------------------|-------------------------|------------------------|----------------------|-------------------|---------------------------------|-------------------------------|---------|
|          |  |       |          |            |                          |                        |                      |                           |                         |                        |                      |                   |                                 |                               |         |
| 1        | DEVELOP WATER SUPPLY                       | LS    | 1        | 5,200.00   | 5,200.00                 |                        |                      | 1.00                      | 5,200.00                | 1.00                   | 5,200.00             |                   | 1.00                            | 5,200.00                      | 100%    |
| 2        | TRAFFIC CONTROL SYSTEM                     | LS    | 1        | 43,365.00  | 43,365.00                |                        |                      | 1.00                      | 43,365.00               | 1.00                   | 43,365.00            |                   | 1.00                            | 43,365.00                     | 100%    |
| 3        | PREPARE STORM WATER POLLUTION PREVENTION   | LS    | 1        | 5,200.00   | 5,200.00                 |                        |                      | 1.00                      | 5,200.00                | 1.00                   | 5,200.00             |                   | 1.00                            | 5,200.00                      | 100%    |
| 4        | CLEARING AND GRUBBING                      | LS    | 1        | 44,340.00  | 44,340.00                |                        |                      | 1.00                      | 44,340.00               | 1.00                   | 44,340.00            |                   | 1.00                            | 44,340.00                     | 100%    |
| 5        | DUST ABATEMENT                             | LS    | 1        | 15,600.00  | 15,600.00                |                        |                      | 1.00                      | 15,600.00               | 1.00                   | 15,600.00            |                   | 1.00                            | 15,600.00                     | 100%    |
| 6        | ROADWAY EXCAVATION                         | CY    | 2,500    | 35.00      | 87,500.00                |                        |                      | 2,500.00                  | 87,500.00               | 2,253.79               | 78,882.65            |                   | 2,253.79                        | 78,882.65                     | 90%     |
| 7        | PLACE ASPHALT CONCRETE DIKE (GRS 212) (8") | LF    | 860      | 14.00      | 12,040.00                |                        |                      | 860.00                    | 12,040.00               | 886.00                 | 12,404.00            |                   | 886.00                          | 12,404.00                     | 103%    |
| 8        | ASPHALT CONCRETE DRIVEWAY                  | SQFT  | 13,200   | 4.56       | 60,192.00                |                        |                      | 13,200.00                 | 60,192.00               | 13,832.25              | 63,075.06            |                   | 13,832.25                       | 63,075.06                     | 105%    |
| 9        | HOT MIX ASPHALT (TYPE A)                   | TON   | 5,860    | 67.00      | 392,620.00               |                        |                      | 5,860.00                  | 392,620.00              | 4,665.36               | 312,579.12           |                   | 4,665.36                        | 312,579.12                    | 80%     |
| 10       | PLACE HOT MIX ASPHALT DIKE (TYPE E)        | LF    | 150      | 8.84       | 1,326.00                 |                        |                      | 150.00                    | 1,326.00                | 146.00                 | 1,290.64             |                   | 146.00                          | 1,290.64                      | 97%     |
| 11       | MINOR CONCRETE (DRIVEWAY)                  | SQFT  | 2,000    | 13.85      | 27,700.00                |                        |                      | 2,000.00                  | 27,700.00               | 1,830.75               | 25,355.89            |                   | 1,830.75                        | 25,355.89                     | 92%     |
| 12       | RELOCATE MAILBOX                           | EA    | 40       | 300.00     | 12,000.00                |                        |                      | 40.00                     | 12,000.00               | 41.00                  | 12,300.00            |                   | 41.00                           | 12,300.00                     | 103%    |
| 13       | PAVEMENT MARKER (RETROREFLECTIVE)          | EA    | 20       | 20.00      | 400.00                   |                        |                      | 20.00                     | 400.00                  | 25.00                  | 500.00               |                   | 25.00                           | 500.00                        | 125%    |
| 14       | SALVAGE ROADSIDE SIGN                      | EA    | 16       | 78.00      | 1,248.00                 |                        |                      | 16.00                     | 1,248.00                | 16.00                  | 1,248.00             |                   | 16.00                           | 1,248.00                      | 100%    |
| 15       | ROADSIDE SIGN - ONE POST                   | EA    | 21       | 239.00     | 5,019.00                 |                        |                      | 21.00                     | 5,019.00                | 20.00                  | 4,780.00             |                   | 20.00                           | 4,780.00                      | 95%     |
| 16       | THERMOPLASTIC PAVEMENT MARKING             | SQFT  | 110      | 11.00      | 1,210.00                 |                        |                      | 110.00                    | 1,210.00                | 137.50                 | 1,512.50             |                   | 137.50                          | 1,512.50                      | 125%    |
| 17       | PAINT TRAFFIC STRIPE (2-COAT)              | LF    | 200      | 3.00       | 600.00                   |                        |                      | 200.00                    | 600.00                  | 216.00                 | 648.00               |                   | 216.00                          | 648.00                        | 108%    |
| 18       | MISCELLANEOUS WORK (AS DIRECTED)           | FA    | 1        | 70,000.00  | 70,000.00                |                        |                      | 1.00                      | 70,000.00               | 0.01245800             | 872.06               |                   | 0.01245800                      | 872.06                        | 1%      |

PROJECT: Fisher Street Resurfacing Project, Marshall Street to Cox Street  
 County Project No.: C9-0033  
 Contract No. 21-10-002

Contractor: Hardy & Harper, Inc.  
 Address: 32 Rancho Circle  
 City, State, Zip: Lake Forest, CA 92630

Estimate No. 1 Final  
 From: January 31, 2022  
 To: March 1, 2022



| Item No.             | Item Description | Units | Quantity | Unit Price | Original Contract Amount | Change Orders Quantity | Change Orders Amount | Amended Contract Quantity | Amended Contract Amount | This Estimate Quantity | This Estimate Amount | Previous Quantity | Previous Amount | Total Estimate To Date Quantity | Total Estimate To Date Amount | % Auth. |
|----------------------|------------------|-------|----------|------------|--------------------------|------------------------|----------------------|---------------------------|-------------------------|------------------------|----------------------|-------------------|-----------------|---------------------------------|-------------------------------|---------|
|                      |                  |       |          |            | 785,560.00               |                        | 0.00                 |                           | 785,560.00              |                        | 629,152.92           |                   |                 |                                 | 629,152.92                    |         |
| <b>PROJECT TOTAL</b> |                  |       |          |            |                          |                        |                      |                           |                         |                        |                      |                   |                 |                                 |                               |         |

Made by Raquel Larez  
 Checked by TN  
 OK Const. Supv. HD

Working Days: 1-31-22  
 Days Added: 0  
 Subtotal: 30  
 Days Used: 21  
 % Time Elapsed: 70%

Start Date: 3-1-22  
 End Date: 3-1-22  
 % \$ Complete: 80%  
 Original Contract: \$785,560.00  
 Amended Contract: \$785,560.00

TOTAL VALUE OF WORK TO DATE: \$629,152.92  
 LESS RETENTION: 5% 31,457.65  
 TOTAL DUE TO DATE: \$597,695.27  
 LESS PREVIOUSLY INVOICED: 0.00  
 LESS LABOR NON COMPLIANCE: 0.00  
 TOTAL DUE THIS PAYMENT: \$597,695.27

This Estimate Approved Mojahed Salama Date: 3/31/2022 for: \$597,695.27  
 Mark Lancaster, Director of Transportation

Received by Accounts Payable \_\_\_\_\_  
 By: \_\_\_\_\_

Quantities on This Estimate Approved Megan Maulo Date: 3/31/22  
 Hardy & Harper, Inc.

**Payment Approval**  
 FUND: 20000  
 DEPT. ID.: 31305  
 ACCOUNT: 527980  
 PROJECT: ZC9-0033E  
 ACTIVITY ID.: Z3500

RESOURCE CNT  
 SIGNATURE: Lindi Ch. Wachu  
 DATE: 3/31/2022

Transfiscal Approved  
 By: Lori Conrad 5'3461  
 April 1, 2022

