

**SUBMITTAL TO THE BOARD OF SUPERVISORS
COUNTY OF RIVERSIDE, STATE OF CALIFORNIA**



ITEM: 19.6
(ID # 21680)

MEETING DATE:
Tuesday, June 27, 2023

FROM : TLMA-TRANSPORTATION:

SUBJECT: TRANSPORTATION AND LAND MANAGEMENT AGENCY/TRANSPORTATION:
Public Hearing on the Annexation of Zone 225 to Landscaping and Lighting Maintenance
District Number 89-1-Consolidated, Winchester, District 3. [\$7,752 Ongoing Cost - L&LMD
Number 89 1 C 100%]

RECOMMENDED MOTION: That the Board of Supervisors:

1. With regard to the annexation of Zone 225 to Landscaping and Lighting Maintenance District Number 89-1-Consolidated, conduct the public hearing and, after closing the public hearing, direct the Director of Transportation, or their designee, who the Board of Supervisors finds to be an impartial person as that term is used in Section 53753(e) of the Government Code, to tabulate all assessment ballots received prior to the close of the public hearing. All assessment ballots received prior to the close of the public hearing will be tabulated at 10:00 a.m. on Wednesday, June 28, 2023 in Conference Room B on the 8th Floor of the County Administrative Center, 4080 Lemon Street, Riverside, California. Staff is directed to cause the appropriate resolution, based on the proceeding tabulation, to be prepared and returned to the Board of Supervisors for its consideration.

ACTION:Policy



Mark Lancaster, Director of Transportation 5/24/2023

MINUTES OF THE BOARD OF SUPERVISORS

On motion of Supervisor Gutierrez, seconded by Supervisor Jeffries and duly carried, IT WAS ORDERED that the above matter is approved as recommended.

Ayes: Jeffries, Washington, Perez and Gutierrez
Nays: None
Absent: Spiegel
Date: June 27, 2023
xc: Trans.

Kimberly A. Rector
Clerk of the Board

By: 
Deputy

**SUBMITTAL TO THE BOARD OF SUPERVISORS COUNTY OF RIVERSIDE,
STATE OF CALIFORNIA**

FINANCIAL DATA	Current Fiscal Year:	Next Fiscal Year:	Total Cost:	Ongoing Cost
COST	\$ 0	\$ 7,752	\$ 0	\$ 7,752
NET COUNTY COST	\$ 0	\$ 0	\$ 0	\$ 0
SOURCE OF FUNDS: L&LMD No. 89-1-C – 100% There are no General Funds used in this project.			Budget Adjustment: N/A	
			For Fiscal Year: 23/24	

C.E.O. RECOMMENDATION: Approve

BACKGROUND:

Summary

Pursuant to the Landscaping and Lighting Act of 1972 and Resolution Number 2023-099 adopted May 9, 2023 as item 3.43, the Board of Supervisors gave notice of a public hearing for June 27, 2023, to receive testimony regarding the Annexation of Zone 225 to Landscaping and Lighting Maintenance District Number 89-1-Consolidated (L&LMD Number 89-1-C). Annexation of Zone 225 will fund the maintenance and servicing of fossil filters within public rights-of-way located south of Olive Avenue, east of La Ventana Road and west of Leon Road in the Winchester area and includes 228 single-family residences.

The annexation of territory to an existing assessment district formed under the Landscaping and Lighting Act is a change of organization that requires a public hearing as part of the annexation process. Str. & H. Code §§ 22605(a), 22607, 22588; Gov't. Code § 53753(d).

On May 10, 2023 a notice of the public hearing and information sheet, a mail-in assessment ballot, an impartial analysis, and a copy of Resolution Number 2023-099 was mailed to all property owners within Zone 225, proposed for annexation to L&LMD Number 89-1-C. Pursuant to the notice, all assessment ballots must be returned prior to the conclusion of the public hearing.

Notice of the public hearing was also given by publication of a certified copy of Resolution Number 2023-099 in an appropriate newspaper at least ten (10) days prior to the public hearing date and by posting a certified copy of Resolution Number 2023-099 on the official bulletin board customarily used by the Board of Supervisors for the posting of notices and in two (2) other public locations within the County.

Impact on Residents and Businesses

The new assessment is for the purpose of providing the maintenance and servicing of fossil filters within public right-of-way.

Only the commercial property owners within the proposed boundaries of Zone 225, which are represented by Tract Number 36417 (TR36417), as described in the attached Exhibit "A" (a two-page exhibit containing a description and diagram) are impacted by the cost of this annexation. The property owners within the proposed boundaries of Zone 225 have petitioned the County of

**SUBMITTAL TO THE BOARD OF SUPERVISORS COUNTY OF RIVERSIDE,
STATE OF CALIFORNIA**

Riverside to annex their property to L&LMD Number 89-1-C and understand that this annexation will result in an assessment on their property to fund the maintenance and servicing of the aforementioned improvements (fossil filters).

SUPPLEMENTAL:

Additional Fiscal Information

The proposed budget for fiscal year 2023-24 for Zone 225 is \$7,752. This will result in an assessment for fiscal year 2023-24 within Zone 225 of \$34 per parcel. The annual assessment may be adjusted annually by the greater of 2% or the cumulative percentage increase in the Consumer Price Index for all Urban Consumers for electricity (CPI-U), if any, as it stands as of March of each year over the base index for March of 2023.

Contract History and Price Reasonableness

N/A

ATTACHMENTS:

Exhibit A



Jason Farin, Principal Management Analyst 6/21/2023



Aaron Gettis, Deputy County Counsel 6/15/2023

EXHIBIT "A"

DESCRIPTION OF BOUNDARIES

The boundaries of Zone 225 to be annexed into Landscaping and Lighting Maintenance District No. 89-1-Consolidated, of the County of Riverside, are coterminous with the boundaries of APN 461-160-029 as shown on Assessment Roll in the County of Riverside, State of California in Fiscal Year 2023-24.

1
2
3
4
5
6
7
8
9
10
11
12
13
14
15
16
17
18
19
20
21
22
23
24

LANDSCAPING AND LIGHTING MAINTENANCE DISTRICT NO. 89-1 CONSOLIDATED

ZONE 225

PORTION(S) OF SECTION 31, T.5S., R.2W.
TRACT MAP NO. 36417
1 PARCEL

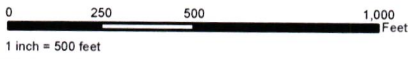

The County of Riverside assumes no warranty or legal responsibility for the information contained on this map. Data and information represented on this map is subject to updates, modifications and may not be complete or appropriate for all purposes. County GIS and other sources should be queried for the most current information. Do not copy or resell this map. Printed by BHAHN on 4/1/2022

ASSESSMENT DIAGRAM

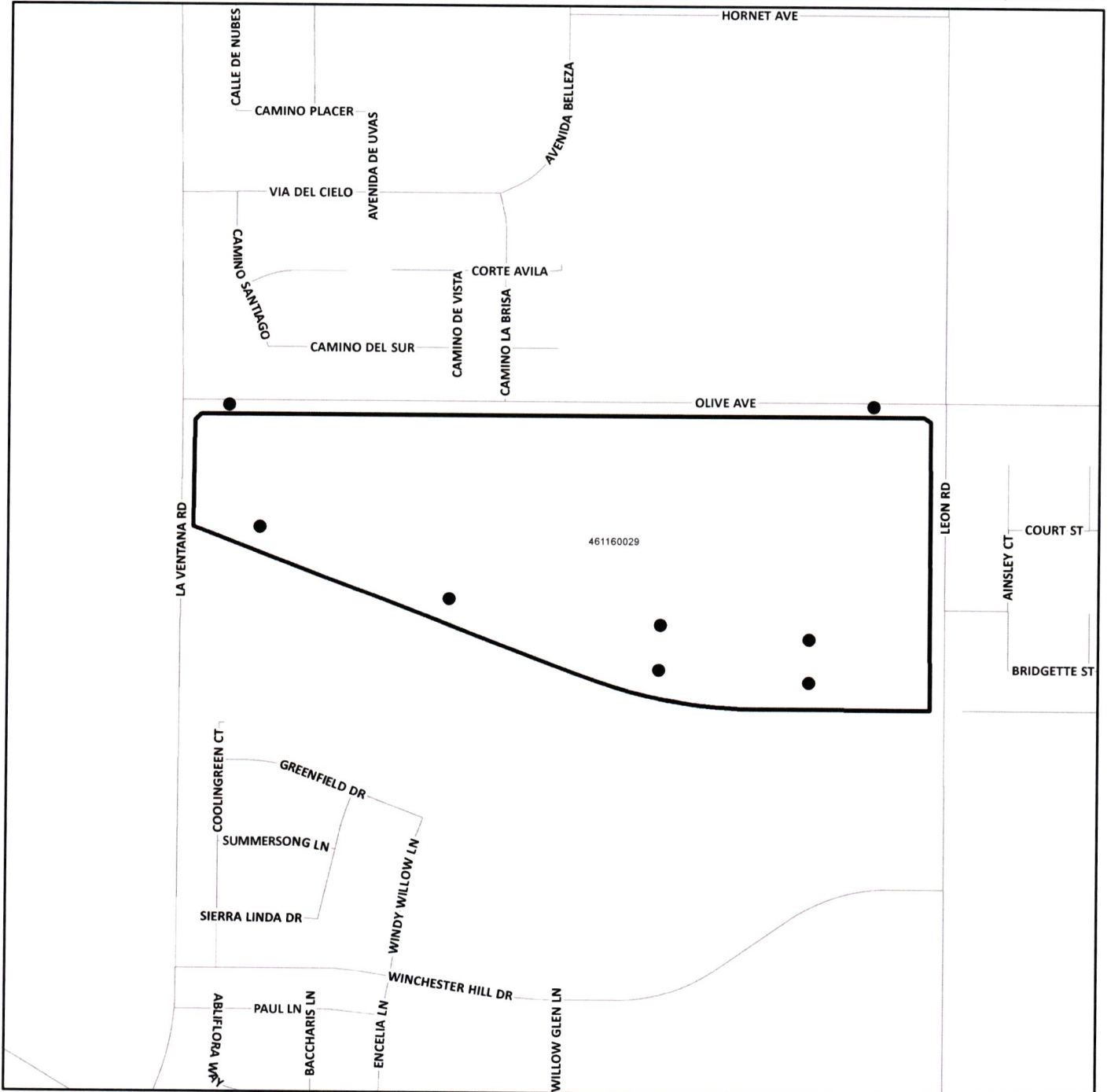

- DENOTES MAINTAINED STORMWATER RUNOFF CATCH BASIN FILTER
- ▭ DENOTES ZONE BOUNDARY