

MINUTES OF THE BOARD OF SUPERVISORS  
COUNTY OF RIVERSIDE, STATE OF CALIFORNIA



1.1

On motion of Supervisor Perez, seconded by Supervisor Jeffries and duly carried, IT WAS ORDERED, FOUND AND DETERMINED that the following ordinances were duly published:

<u>ORDINANCE</u>	<u>DATE</u>	<u>NEWSPAPER</u>
No. 348.5000	May 8, 2023	The Press Enterprise
No. 664.98	May 16, 2023	The Press Enterprise

Roll Call:

Ayes: Jeffries, Spiegel, Washington and Perez  
Nays: None  
Absent: Gutierrez

I hereby certify that the foregoing is a full, true and correct copy of an order made and entered on November 7, 2023, of Supervisors Minutes.

WITNESS my hand and the seal of the Board of Supervisors  
Dated: November 7, 2023  
Kimberly A. Rector, Clerk of the Board of Supervisors, in and  
for the County of Riverside, State of California.

(seal)

By: , Deputy

AGENDA NO.

1.1

ATTACHMENTS FILED WITH  
THE CLERK OF THE BOARD

# THE PRESS-ENTERPRISE

1825 Chicago Ave, Suite 100  
Riverside, CA 92507  
951-684-1200  
951-368-9018 FAX

**PROOF OF PUBLICATION  
(2010, 2015.5 C.C.P)**

Publication(s): The Press-Enterprise

PROOF OF PUBLICATION OF

Ad Desc.: Ordinance No. 348.5000 /

I am a citizen of the United States. I am over the age of eighteen years and not a party to or interested in the above entitled matter. I am an authorized representative of THE PRESS-ENTERPRISE, a newspaper in general circulation, printed and published daily in the County of Riverside, and which newspaper has been adjudicated a newspaper of general circulation by the Superior Court of the County of Riverside, State of California, under date of April 25, 1952, Case Number 54446, under date of March 29, 1957, Case Number 65673, under date of August 25, 1995, Case Number 267864, and under date of September 16, 2013, Case Number RIC 1309013; that the notice, of which the annexed is a printed copy, has been published in said newspaper in accordance with the instructions of the person(s) requesting publication, and not in any supplement thereof on the following dates, to wit:

**05/08/2023**

I certify (or declare) under penalty of perjury that the foregoing is true and correct.

Date: May 08, 2023  
At: Riverside, California



Legal Advertising Representative, The Press-Enterprise

BOARD OF SUPERVISORS  
COUNTY OF RIVERSIDE  
PO BOX 1147  
RIVERSIDE, CA 92502

Ad Number: 0011601350-01

P.O. Number:

## Ad Copy:

BOARD OF SUPERVISORS OF THE COUNTY OF RIVERSIDE,  
STATE OF CALIFORNIA

ORDINANCE NO. 348.5000  
AN ORDINANCE OF THE COUNTY OF RIVERSIDE  
AMENDING ORDINANCE NO. 348 RELATING TO ZONING

The Board of Supervisors of the County of Riverside ordains as follows:

Section 1. Section 4.1 of Ordinance No. 348, and official Zoning Plan Map No. 2, as amended, are further amended by placing in effect in the Winchester Area, the zone or zones as shown on the map entitled "Change of Official Zoning Plan Amending Ordinance No. 348, Map No. 2.2488, Change of Zone Case No. 2100123" which map is made a part of this ordinance.

Section 2. This ordinance shall take effect 30 days after its adoption.

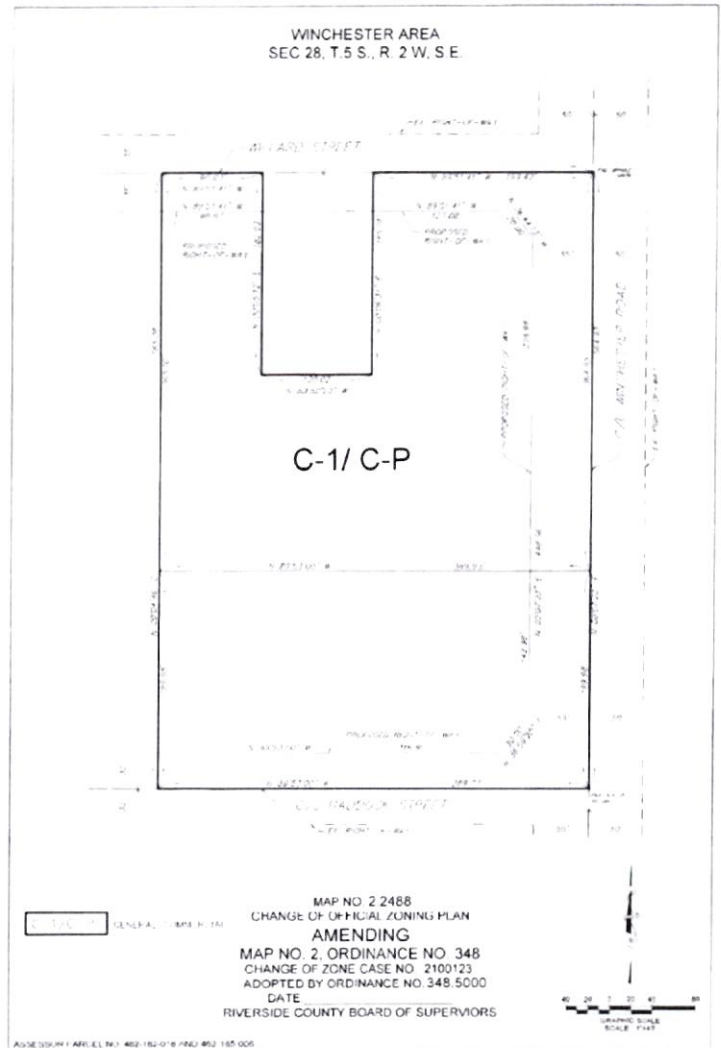

K. Jeffries, Chair of the Board

I HEREBY CERTIFY that at a regular meeting of the Board of Supervisors of said County, held on **May 2, 2023**, the foregoing Ordinance was adopted by said Board by the following vote:

AYES: Jeffries, Spiegel, Washington, Perez, and Gutierrez  
NAYS: None  
ABSENT: None

Kimberly A. Rector, Clerk of the Board  
By: Cindy Fernandez, Clerk of the Board Assistant  
**Press-Enterprise**  
**Published: 5/8/23**

*Planning  
5/2/23*

# THE PRESS-ENTERPRISE

Ad Copy:

1825 Chicago Ave, Suite 100  
Riverside, CA 92507  
951-684-1200  
951-368-9018 FAX

## PROOF OF PUBLICATION (2010, 2015.5 C.C.P)

Publication(s): The Press-Enterprise

### PROOF OF PUBLICATION OF

Ad Desc.: Ordinance No. 779.24 Publication /

I am a citizen of the United States. I am over the age of eighteen years and not a party to or interested in the above entitled matter. I am an authorized representative of THE PRESS-ENTERPRISE, a newspaper in general circulation, printed and published daily in the County of Riverside, and which newspaper has been adjudicated a newspaper of general circulation by the Superior Court of the County of Riverside, State of California, under date of April 25, 1952, Case Number 54446, under date of March 29, 1957, Case Number 65673, under date of August 25, 1995, Case Number 267864, and under date of September 16, 2013, Case Number RIC 1309013; that the notice, of which the annexed is a printed copy, has been published in said newspaper in accordance with the instructions of the person(s) requesting publication, and not in any supplement thereof on the following dates, to wit:

**05/16/2023**

I certify (or declare) under penalty of perjury that the foregoing is true and correct.

Date: May 16, 2023  
At: Riverside, California



Legal Advertising Representative, The Press-Enterprise

BOARD OF SUPERVISORS  
COUNTY OF RIVERSIDE  
PO BOX 1147  
RIVERSIDE, CA 92502

Ad Number: 0011602961-01

P.O. Number:

5/19/23  
waste  
12.1

ORDINANCE NO. 779.24  
AN ORDINANCE OF THE COUNTY OF RIVERSIDE  
AMENDING ORDINANCE NO. 779 RELATING TO  
COUNTY SOLID WASTE FACILITIES AND ESTABLISHING FEES

The Board of Supervisors of the County of Riverside ordains as follows:

Section 1. ATTACHMENTS. Section 11 of Ordinance No. 779 is amended to read as follows:

"Section 11. ATTACHMENTS. The following attachments as referenced above in this Ordinance are attached hereto and by this reference incorporated herein:

**APPENDIX A: Appendix A to the Riverside County Ordinance No. 779.24 Schedule of Waste Disposal Fees for Riverside County Department of Waste Resources**

**APPENDIX B: Appendix B to Ordinance No. 779.24 Residential Self Haul Cards and Other Fees - Oasis Landfill for Riverside County Department of Waste Resources**

**APPENDIX C: Appendix C to Ordinance No. 779.24 Rural Site Access - Commercial Cards - Oasis Landfill for Riverside County Department of Waste Resources**

**APPENDIX D: Appendix D to Ordinance No. 779.24 Schedule of Miscellaneous Fees for Riverside County Department of Waste Resources**  
**EXHIBIT 1: Rural Site Service Area # 1 & Rural Site Service Area #2"**

APPENDIX A TO RIVERSIDE COUNTY ORDINANCE NO. 779.24 SCHEDULE OF WASTE DISPOSAL FEES FOR RIVERSIDE COUNTY DEPARTMENT OF WASTE RESOURCES Effective July 1, 2023	
The following gate fees will be applicable at Badlands, Blythe, Lamb Canyon, and El Sobrante Landfills and Idylwild Grinding Facility.	
WASTE GROUP DESCRIPTIONS	RATE
1. Direct Haul/Non-Contracted - Routine	\$ 49.75 /ton
2. Direct Haul/Non-Contracted - Hard to Handle	
a) All Front-Load Vehicles	\$ 66.34 /ton
b) Any Load Requiring Immediate Deval or Special Handling	\$ 66.34 /ton
3. Clean Green Waste (less than 1% contamination) - Lamb Canyon Landfill Only	\$ 44.75 /ton
a) Acceptable: Grass, tree trimmings, bushes	
b) Unacceptable: Soil, soil, cactus, yucca, tumbleweeds, lumberwood, concrete, glass, plastic, metal, trash, palm fronds	
c) Processed (chipped) Green Material - Commercial/In-Contracted Solid Waste Haulers Only - Badlands, Lamb Canyon Only	\$ 15.00 /ton
4. Flat Rate Vehicles**	
a) Routine Refuse	
i) Cars/Sedans/Van/SUV	\$ 15.00 /load
ii) Pickup Truck or Trailer (up to 8ft bed)	\$ 15.00 /load
iii) Pickup Truck and Trailer (up to 8ft bed, up to 4ft high)	\$ 41.00 /load
b) Hard to Handle	
i) Cars/Sedans/Van/SUV	\$ 20.00 /load
ii) Pickup Truck or Trailer (up to 8ft bed)	\$ 20.00 /load
iii) Pickup Truck and Trailer (up to 8ft bed, up to 4ft high)	\$ 54.00 /load
c) Mixed Green	
i) Cars/Sedans/Van/SUV	\$ 19.00 /load
ii) Pickup Truck or Trailer (up to 8ft bed)	\$ 19.00 /load
iii) Pickup Truck and Trailer (up to 8ft bed, up to 4ft high)	\$ 50.00 /load
d) Clean Green (less than 1% contamination) - Lamb Canyon Landfill Only	
i) Cars/Sedans/Van/SUV	\$ 14.00 /load
ii) Pickup Truck or Trailer (up to 8ft bed)	\$ 14.00 /load
iii) Pickup Truck and Trailer (up to 8ft bed, up to 4ft high)	\$ 35.00 /load
5. Minimum Load Fees (Applies to All Non Flat Rate Vehicle Types)	
a) Routine Refuse (81 tons or less)	\$ 41.00 /load
b) Hard-to-handle Refuse (81 tons or less)	\$ 54.00 /load
c) Mixed Green Refuse (81 tons or less)	\$ 50.00 /load
d) Clean Green (81 tons or less)	\$ 35.00 /load
6. Surcharges (added to the charges listed herein):	
a) Passenger Light Duty Truck (less than 8,000 lbs) from Businesses/Customers Only. No oversized or semi-truck loads. Limited to Five (5) Tires Per Residential Customer Per Day	\$ 6.00 /tire
b) Any Unknow/Unmeasured Load of Refuse Which Has Exposed Material Which is the Concern of the General Manager, Chief Engineer or Staff Engineer May Utilize Ramps to the Landfill or Along Landfill Roads to the Dumping Pad. Loads must arrive to the scale covered and/or faststrapped down. Customer may not cover or tentap their load at the scale to avoid paying the surcharge	\$ 25.00 /load
c) Mixed Green Waste Loads - Green waste with greater than 1% contamination of unacceptable material including soil, soil, cactus, yucca, tumbleweeds, lumberwood, concrete, glass, plastic, metal, trash, palm fronds	\$ 12.27 /ton
d) Incidental (Non-Contract Customer) Out-of-County Refuse	\$ 6.14 /ton
e) Surcharge Rate Per Appliance Requiring Special Handling (including but Not Limited To: Washer, Dryer, Refrigerator, Stove, Water Heater, Air Conditioner, Microwave) Limited To Four (4) Appliances Per Customer Per Day	\$ 6.00 /item
7. No Charge Loads:	
a) Any Residential Customer Hauling Two (2) or Less Large Trash Bags Per Day	
b) Up To Two (2) Cardboard Ray Tube (CRT) Devices (e.g. TV's or computer monitors) Per Residential Customer Per Day	
c) Up To Three (3) Holiday Trees Per Residential Customer Through the Second Weekend Following the Christmas Holiday	
d) Material Pre-Approved By the General Manager/Chief Engineer Or Designer As Needed for Beneficial Reuse (concrete/asphalt for wet weather, etc.)	
e) Mattresses/box springs at no charge if hauled separately from other waste in the following quantities per site: Badlands - Maximum Five (5) Free/Day; Maximum Five (5) Disposed/Day Lamb Canyon - Maximum Five (5) Free/Day; Maximum Five (5) Disposed/Day Blythe - Maximum Two (2) Free/Day; Maximum Two (2) Disposed/Day El Sobrante - Maximum Two (2) Free/Day; Maximum Five (5) Disposed/Day Oasis - Maximum Two (2) Free/Day; Maximum Two (2) Disposed/Day Desert Center - Maximum Two (2) Free/Day; Maximum Two (2) Disposed/Day	
Any quantity of mattresses and box springs commingled with trash at the Blythe and El Sobrante landfills will be charged the full to handle rate.	
Any quantity of mattresses/box springs commingled with green waste at the Blythe and El Sobrante landfills will be charged the full-to-handle rate plus the green waste surcharge.	
*El Sobrante accepts up to five (5) mattresses/box springs per day. Quantities over two are charged "hard-to-handle" if hauled separately. Quantities over two are charged "hard-to-handle" plus the green waste surcharge if commingled with green waste.	No Charge
8. Emergency Towing Services	
a) 10 Minutes or Less	\$ 20.00
b) Over 10 Minutes	\$ 35.00
9. ***Late Staying Customer Fees	
Every 15 Minutes After Closing	\$ 60.00
***Arrival to pay window (outbound)	
10. Erosion Control Material	
Any vehicle hauling Processed Green Waste Approved By the General Manager, Chief Engineer or Designer As Needed for Beneficial Reuse (Erosion Control) and Sorted by County	\$ 10.00 /ton
11. Very Small Quantity Generator Waste (a.k.a. Conditionally Exempt Small Quantity Generator Waste) - Fees based on a Pass Through of the Department's Contracted Household Hazardous Waste Disposal Fee Added To 149% of the hourly rate of self approved waste disposal	Varies
12. Idylwild Grinding Facility Disposal Fee	
Wood waste/Berke checked wood, Green waste, Pine needles, and Associated slash Only	\$ 35.30 /ton
13. Restrictions	
a) Two (2) appliance limit per residential customer per day. Appliances are not accepted from business/commercial customers.	
b) Five (5) tire limit per residential customer per day. No semi-truck tires. Tires are not accepted from business/commercial customers.	
c) Mattresses (Blythe, Oasis, Desert Center) - No more than two (2) mattresses/box springs per residential customer per day. Two (2) mattresses/box springs are only accepted for free when hauled separately from trash loads. Mattresses/box springs are not accepted from business/commercial customers.	
d) Mattress (El Sobrante) - Two (2) mattresses/box springs per customer per day will be accepted for free when hauled separately from trash loads. Loads carrying three (3) to five (5) mattresses/box springs will be weighed and charged for entire load based on unit type as stated in section 7e above. Loads carrying more than five (5) mattresses/box springs will not be accepted.	
e) Mattresses (Badlands and Lamb Canyon) - Five (5) mattresses/box springs per customer per day will be accepted for free when hauled separately from trash loads. Loads carrying mattresses/box springs will be weighed and charged for entire load at the routine refuse rate.	

NOTES:  
1) Rate for Transfer Trucks determined by individual contracts.  
2) Due to health and safety risks in the vast open canal system in the area, loads of dead sheep or small calves from the Blythe service area separated from other waste will be received at no charge at the Blythe Landfill (only from Blythe to Blythe).  
3) Certified loads of energy-stored non-hazardous municipal solid waste retrieved using open towing ingestion canals, which are delivered by the agency responsible for maintaining the canals, shall be received at no charge at the Blythe Landfill.  
4) The General Manager/Chief Engineer is authorized to recoup costs associated with the segregation of unauthorized waste commingled with routine refuse.  
\* Cash customers ordered to the nearest \$0.25  
\*\*\* Late Hours are extended to nearest \$1.00  
Exception - El Sobrante Landfill: Incidental Out-of-County (IOC) rates established by Waste Management, Inc.

**APPENDIX B TO ORDINANCE NO. 779.24  
RESIDENTIAL SELF-HAUL CARDS AND OTHER FEES - OASIS LANDFILL  
FOR  
RIVERSIDE COUNTY DEPARTMENT OF WASTE RESOURCES  
Effective July 1, 2023**

The Residential Self-Haul Card shall be necessary for admittance to the Oasis Landfill for all residential haulers. For use by residents of Oasis, Mecca, North Shore, and Thermal only. Residential address and proof of residency must be provided at time of residential self-haul card purchase.

**RESIDENTIAL CARD REGULATIONS:**

**Authority:** Riverside County Ordinance No. 745 requires that "Every tenant, occupier, operator, or owner of a residence - not less than once a week all Solid Waste created, produced or brought upon the property shall be moved to an approved disposal facility."

- Number of Uses** - Monthly Residential Self-Haul Card allows up to 4,400 lb. standard load uses per month.
- Expiration Date** - The expiration date for the yearly card is the last day of the fiscal year, June 30. The expiration date for monthly cards is the last day of the month. Any unused punches in a month will expire on the last day of that month.
- No Refunds** - There will be no refunds on partially used cards.
- Standard Load** - The maximum load allowed access to the landfill with one use of the Residential Self-Haul Card will be four hundred (400) pounds, which is equivalent to one punch on the card. If the Gate Services Assistant judges a load to be over the Standard Load limit, two or more punches will be made to the card.
- Cost** - The Residential Self-Haul Card discounted rate is eighteen dollars and ninety nine cents (\$18.99) per month.
- Payment for Card** - Residential cards may only be purchased at the landfill. Acceptable forms of payment include money order or cashier's check in the exact amount of purchase and credit/debit card. Credit/debit card payments include a processing fee of 1.5% of the transaction amount.
- Payment Options - Cards may be purchased:**

Period	Cost	Number of Punches (One Punch Per 400 lb. Standard Load. Additional Punches Applied in Excess of Standard Load.)
Monthly	\$ 18.99	4
Advance Sale - Annual (purchased on or before June 30th)	\$ 189.90	52
Multiple Months	\$ x number of months	4 x number of months

- Lost Cards** - Lost cards are to be reported immediately. The customer will not be responsible for unauthorized use of a card after it is reported lost to the Waste Resources business office located at 14310 Freedom Street, Moreno Valley, CA 92553 (951) 486-3200.
- Uncovered/Unsecured Load Fee** - A fee of \$10 will be assessed per uncovered/unsecured load of refuse which has exposed material which in the opinion of the General Manager/Chief Engineer or his/her designee may litter roadways to the landfill or along landfill roads to the dumping pad. Load must arrive to the pay window covered and/or tied-downed down.
- Passenger/Light Duty Tires** - Limited to five (5) tires per residential customer per day. No semi-trailers. \$0.50/fee per tire.
- Restrictions on Use of Card** - Household hazardous waste, other hard-to-handle waste, or commercial/business waste will not be accepted on this card. Card may only be used by persons residing at the purchaser's address on file.
- Alternative Riverside County Landfill Usage** - In the event that the Oasis landfill is unable to accept waste on a normal operating day, customers will be directed to a scaled Riverside County landfill and may use their Residential Self-Haul Card.

**APPENDIX C TO ORDINANCE NO. 779.24  
RURAL SITE ACCESS - COMMERCIAL CARDS - OASIS LANDFILL  
FOR  
RIVERSIDE COUNTY DEPARTMENT OF WASTE RESOURCES  
Effective July 1, 2023**

The Rural Site Access Commercial Card shall be necessary for admittance to the Oasis Landfill for all non-permitted/contractor entities hauling commercial waste. For use by commercial entities of Oasis, Mecca, North Shore, and Thermal. Business address must be provided at time of commercial card purchase.

**COMMERCIAL CARD REGULATIONS:**

A Rural Site Access Commercial Card provides for disposal of commercial waste generated within the remote service areas and is required unless a permitted waste hauler or other large commercial users have negotiated a separate contract for disposal access to rural landfills with the County.

- Number of Uses** - The Commercial Card allows twenty-four (24) uses for analytical uses.
- Expiration Date** - There is no expiration date for the Commercial Card.
- No Refunds** - There are no refunds on partially used cards. If a commercial operator goes out of business, there shall be no refund for the unused card punches.
- Cost** - The Commercial Card fee is five hundred ninety-six dollars and eighty-eight cents (\$596.88).
- Payment for Card** - The card shall be purchased in advance of usage. Cards may be purchased at any time of the year. Acceptable forms of payment at the landfill include money order, cashier's check, and credit/debit card. Credit/debit card payments include a processing fee of 1.5% of the transaction amount. Additional terms of payment, including cash and personal/business checks, are accepted at the Department's business office.
- Lost Cards** - Lost cards are to be reported immediately. The customer will not be responsible for unauthorized use of a card after it is reported lost to the Waste Resources business office located at 14310 Freedom St., Moreno Valley, CA (951) 486-3200.
- Uncovered/Unsecured Load Fee** - A fee of \$10.00 will be assessed per uncovered/unsecured load of refuse which has exposed material which in the opinion of the General Manager/Chief Engineer or his/her designee may litter roadways to the landfill or along landfill roads to the dumping pad. Load must arrive at the pay window covered and/or tied-downed down.
- Restrictions on Use of Card** - Hazardous waste, tires, or other hard-to-handle waste will not be accepted at the Oasis landfill from commercial haulers.
- Alternative Riverside County Landfill Usage** - In the event that the Oasis landfill is unable to accept waste on a normal operating day, customers will be directed to a scaled Riverside County landfill and may use their Rural Site Access Commercial Card.

**APPENDIX D TO RIVERSIDE COUNTY ORDINANCE NO. 779.24  
SCHEDULE F OF RURAL LANDFILL FEES  
FOR  
RIVERSIDE COUNTY DEPARTMENT OF WASTE RESOURCES  
Effective July 1, 2023**

FEES FOR DEPARTMENT PUBLICATIONS		
Document Name	Document Fee	Mailing/Handling Cost
Comprehensive Integrated Waste Management Plan (CIWM) (see also Department Recycling Element (RDE) and the City of Riverside Waste Element (WEL))	\$60.00	\$10.00
Recycling Element (RDE)	\$60.00	\$10.00
Waste Element (WEL)	\$10.00	\$5.00
Countywide Single-Use Package Recycling System (SUSPRS) Recycling Manual	\$50.00	\$10.00
Copy Service		
Note: All map copies are on bond unless special request is made. Extra charge for special materials.		
Microfilm - 35mm, Dupes		Copy Fee
3 1/2" x 5"		\$4.00
8 1/2" x 11"		15 per set
11" x 14"		15 per set
11" x 17"		30 per set
Some Copies		
8 1/2" x 11"		\$1.00 per set
8 1/2" x 14"		\$1.00 per set
11" x 17"		\$2.00 per set
Request for Rate Sheet Copies		Storage w/ \$1.00 minimum
Request for Rate Book (Digital and Paper Copies)		Storage w/ \$1.00 minimum
Request for Department Calendar (Digital and Paper Copies)	\$1.75/line + \$1.25 for postage & handling	
OTHER FEES		
Service	Fee	
Registration of Self-Haul or Rural Site Access Card	\$10.00	
Annual Renewal Site Access Fee (if a Renewal Fee is assessed on the Card)	\$1.00 each	
Registration Access Card (CA, Oklahoma, and the Fuel Access Manual)	\$50.00	
Printing Fee for Field-Produced Recycling Manual	1.13% per billing period on unpaid balance if payment is not made within 10 days from billing	
Administrative Charge for Damaged Data or Missing Payment	\$20.00 per occurrence	
Check Returned for Lack of Funds Fee - NSF	\$25.00 per occurrence	
Account Connection User to Paper Reporting from Other Site or Fee Component to an Other Reporting System or Reported Violation in the Other Reporting System (occurs at time of Publication of Reported Account Number - Multiple Occurrences)	\$25.00 per occurrence	
Self-Haul Self-Hauler or Operator in the 2019 Reporting Manual	\$75.00 per day	
Recycling Card Processing Fee	Percentage of transaction fee per County of Riverside Resolution No. 2016-18	
Self-Haul Self-Hauler Processing by Recycle Surcharge	\$10.00	

APPENDIX D TO RIVERSIDE COUNTY ORDINANCE NO. 179-24  
 SCHEDULE OF MISCELLANEOUS FEES  
 FOR  
 RIVERSIDE COUNTY DEPARTMENT OF WASTE RESOURCES  
 (Effective July 1, 2023)

Base Hourly Rates for Services Rendered	Actual Hourly Cost of Personnel
Departmental overhead (100% applied to base hourly rates)	40%
Rate of 100% (plus 20% for Northridge Renewable)	\$1.00 for the first page, \$1.50 for each additional page
Rate of 100% (plus 20% for Northridge Renewable)	No charge within 30 days of assessment date; \$1.50 per page requested past 30 days
Rate of 100% (plus 20% for Northridge Renewable)	\$0.00
Rate of 100% (plus 20% for Northridge Renewable)	\$0.75
Rate of 100% (plus 20% for Northridge Renewable)	\$10.00
Rate of 100% (plus 20% for Northridge Renewable)	\$15.00
Landfill Program Fees (must provide a valid credit/debit card if time bin is shared)	
Landfill Permit Fee	\$21.00
Site Cleanup Fee	\$14.00
Inspection Fee	\$14.00

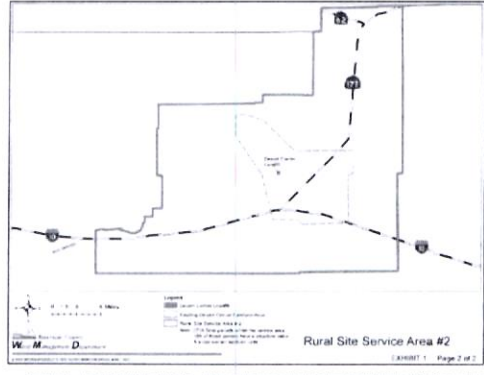
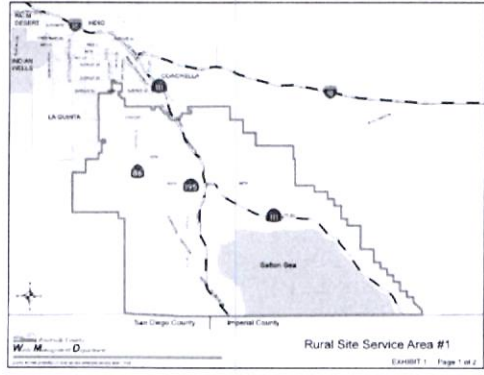

Section 2. EFFECTIVE DATE: This ordinance shall take effect thirty (30) days after its adoption.

K. Jeffries, Chair of the Board

I HEREBY CERTIFY that at a regular meeting of the Board of Supervisors of said County, held on May 9, 2023, the foregoing Ordinance was adopted by said Board by the following vote:

AYES: Jeffries, Spiegel, Washington, Perez and Gutierrez  
 NAYS: None  
 ABSENT: None

Kimberly A. Rector, Clerk of the Board  
 By: Cindy Fernandez, Clerk of the Board Assistant  
 Press-Enterprise  
 Published: 5/16/23