

**SUBMITTAL TO THE BOARD OF SUPERVISORS  
COUNTY OF RIVERSIDE, STATE OF CALIFORNIA**



**ITEM: 3.45  
(ID # 24624)**

**MEETING DATE:**  
Tuesday, June 04, 2024

**FROM :** TLMA-TRANSPORTATION

**SUBJECT:** TRANSPORTATION AND LAND MANAGEMENT AGENCY/TRANSPORTATION: Approval and execution of the Partial Assignment and Assumption of Improvement Credit Agreement between Copper Skye – Menifee, L.P., Tri Pointe Homes IE-SD, Inc., and the County of Riverside associated with Unit Nos. 1 through 7, 83 through 97, 130 through 136, and 167 through 196 of Tract No. 33145. Not a project under CEQA pursuant to Section 15378 (b)(5) of the State CEQA Guidelines. District 3. [\$0]

**RECOMMENDED MOTION:** That the Board of Supervisors:

1. Find the Partial Assignment and Assumption of Improvement Credit Agreement not a project pursuant to State CEQA Guidelines Section 15378 (b)(5);
2. Approve and execute the Partial Assignment and Assumption of Improvement Credit Agreement between Copper Skye – Menifee, L.P., Tri Pointe Homes IE-SD, Inc., and the County of Riverside associated with Unit Nos. 1 through 7, 83 through 97, 130 through 136, and 167 through 196 of Tract No. 33145; and
3. Authorize the Chairman of the Board of Supervisors to execute the same.

**ACTION:Policy**

Dennis Acuna, Director of Transportation 4/25/2024

---

**MINUTES OF THE BOARD OF SUPERVISORS**

On motion of Supervisor Gutierrez, seconded by Supervisor Perez and duly carried by unanimous vote, IT WAS ORDERED that the above matter is approved as recommended.

Ayes: Jeffries, Spiegel, Washington, Perez and Gutierrez  
Nays: None  
Absent: None  
Date: June 4, 2024  
xc: Trans.

Kimberly A. Rector  
Clerk of the Board

By:   
Deputy

**SUBMITTAL TO THE BOARD OF SUPERVISORS COUNTY OF RIVERSIDE,  
STATE OF CALIFORNIA**

<b>FINANCIAL DATA</b>	<b>Current Fiscal Year:</b>	<b>Next Fiscal Year:</b>	<b>Total Cost:</b>	<b>Ongoing Cost</b>
<b>COST</b>	\$ 0	\$ 0	\$ 0	\$ 0
<b>NET COUNTY COST</b>	\$ 0	\$ 0	\$ 0	\$ 0
<b>SOURCE OF FUNDS:</b> Developer funded 100%. No General Funds will be used on this project.			<b>Budget Adjustment:</b> No	
			<b>For Fiscal Year:</b> 23/24	

**C.E.O. RECOMMENDATION:** Approve

**BACKGROUND:**

**Summary**

Tri Pointe Homes IE-SD, Inc. (Assignee) acquired Unit Nos. 1 through 7, 83 through 97, 130 through 136, and 167 through 196 of Tract No. 33145 (Assigned Property) from Copper Skye – Menifee, L.P. (Assignor). The Assigned Property consists of fifty-nine (59) multi-family residential units and is located within the boundaries of the Newport Road Community Facilities District No. 03-1 (Newport Road CFD), which is administered by the County of Riverside (County).

On September 13, 2022 (Agenda Item 3-19), the County Board of Supervisors approved the Newport Road CFD Transportation Uniform Mitigation Fee (TUMF) Program Improvement Credit Agreement (TUMF Agreement) between Copper Skye – Menifee, L.P., and the County which made the developed lots of the Assigned Property within the Newport Road CFD eligible for fee credit against the applicable TUMF fee.

Copper Skye – Menifee, L.P. now desires to assign to Tri Pointe Homes IE-SD, Inc. certain rights to TUMF credits under the TUMF Agreement relating to the Assigned Property. Each dwelling unit within the Assigned Property will be eligible to receive TUMF credit in an amount set forth in this Partial Assignment and Assumption of Improvement Credit Agreement (Assignment Agreement).

Assignee desires to assume all of the Assignor's rights and obligations under the TUMF Agreement relating to the Assigned Property.

The Assignment Agreement is not a "project" pursuant to Section 15378(b)(5) of the State CEQA Guidelines, which states that a "project" does not include "organizational or administrative activities of governments that will not result in direct or indirect physical changes in the environment." The Assignment Agreement merely transfers all rights and obligations from the Assignor to the Assignee and does not modify any of the terms of the TUMF Agreement for the Assigned Property. This transfer of rights and obligations will not, in and of itself, result in a significant environmental effect and does not authorize to any extent whatsoever actual physical development. Any future development, if it occurs at all, will be the result of subsequent actions subject to further CEQA review. Therefore, the Assignment Agreement is not a project under CEQA.

SUBMITTAL TO THE BOARD OF SUPERVISORS COUNTY OF RIVERSIDE,  
STATE OF CALIFORNIA

**Impact on Residents and Businesses**

This Assignment Agreement represents a change in real property ownership and will have no impact on local residents and businesses.

**Additional Fiscal Information**

N/A

**ATTACHMENTS:**

Vicinity Map

Assignment Agreement



Jason Farin, Principal Management Analyst 5/29/2024



Aaron Gettis, Chief of Deputy County Counsel 5/21/2024

**PARTIAL ASSIGNMENT AND ASSUMPTION OF  
IMPROVEMENT CREDIT AGREEMENT**

This Partial Assignment and Assumption of Improvement Credit Agreement (the "Assignment Agreement") is made as of June 04, 2024, by and between Copper Skye-Meniffee, L.P. ("Assignor"), Tri Pointe Homes IE-SD, Inc. ("Assignee") and the County of Riverside ("County").

**RECITALS**

A. Assignor is a "Developer" under that certain agreement titled "Community Facilities District No. 03-1 (Newport Road CFD) Improvement Credit Agreement, Transportation Uniform Mitigation Fee Program" dated as of September 13, 2022 (Contract No. 22-03-003) (the "TUMF Agreement") with respect to that certain real property described on Exhibit A attached hereto, which includes Unit Nos. 1 through 7, 83 through 97, 130 through 136, and 167 through 196 of Tract No. 33145 (the "Assigned Property"). The Assigned Property contains fifty-nine (59) multi-family residential units. Any capitalized term used but not otherwise defined herein shall have the meaning ascribed thereto in the TUMF Agreement.

B. Assignor and Assignee are parties to that Real Estate Purchase and Sale Contract (the "Contract") dated as of December 15, 2020, respecting the sale of the Assigned Property. The ownership of said Assigned Property of Tract No. 33145 was transferred to Assignee by Assignor via Grant Deed dated January 19, 2024 (DOC#2024-0018303).

C. Assignor desires to assign to Assignee all of Assignor's rights to credit against the TUMF obligation under the TUMF Agreement relating to the Assigned Property, and Assignee desires to assume all of Assignor's obligations thereunder relating to the Assigned Property and such Credit, all on the terms and conditions set forth below.

D. County is an express intended beneficiary of the rights, duties and obligations undertaken by Assignor and Assignee.

**AGREEMENT**

NOW, THEREFORE, for valuable consideration, the receipt and sufficiency of which is hereby acknowledged, Assignor and Assignee hereby agree as follows:

1. Assignor hereby assigns to Assignee all of Assignor's rights, title, interest, and obligations in and under the TUMF Agreement to the extent relating to the Assigned Property, including, without limitation, the TUMF Credit amount of up to \$1,775 ("TUMF Credit") for each residential unit developed within the Assigned Property.

2. Assignee hereby accepts this Assignment Agreement and agrees to be bound by all applicable provisions of the TUMF Agreement with respect to the Assigned Property.

3. Assignor hereby covenants that it will, at any time and from time to time upon written request therefor, but at no out-of-pocket cost to Assignor, execute and deliver to Assignee, its nominees, successor and/or permitted assigns, any new or confirmatory instructions

JUN 04 2024 3.45



and do and perform any other acts which Assignee, its nominees, successors and/or assigns, may reasonably request in order to fully transfer and assign the rights of Assignor in and under the TUMF Agreement and the TUMF Credit Amount with respect to the Assigned Property.

4. This Assignment Agreement shall be binding upon and inure to the benefit of the successors and assignees of all respective parties hereto. All rights, title, and interest to all benefits accruing under this Assignment shall only be assigned to a subsequent assignee pursuant to the execution of an assignment and assumption agreement among the subsequent assignor, the subsequent assignee, and the County, in a form acceptable to the County, whereby the parties consent to such assignment and the subsequent assignee expressly agrees to assume all duties, liabilities, obligations or responsibilities under the TUMF Agreement and to be bound thereby.

5. This Assignment Agreement shall be governed by and construed in accordance with the laws of the State of California.

6. This Assignment Agreement may be executed in counterparts, each of which shall constitute an original and which collectively shall constitute one instrument.

**[Signatures on following page]**

IN WITNESS WHEREOF, Assignor, Assignee, and the County have executed and delivered this Assignment Agreement as of the day and year first above written.

**ASSIGNOR:**

Copper Skye-Menifee, L.P., a Delaware limited partnership

By: Cal Hearthstone PBLO GP, LLC, a Delaware limited liability company, its General Partner

By: Cal Hearthstone Public Builder Lot Option, LLC, a Delaware limited company, its Member Manager

By: Hearthstone Professional – CS, L.P., a Delaware limited partnership, its Manager

By: Hearthstone, Inc., a California corporation, its General Partner

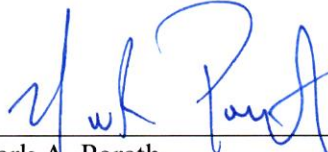
By:   
Mark A. Porath  
Authorized Person

By:   
Steven C. Porath  
Authorized Person

**ASSIGNEE:**

Tri Pointe Homes, IE-SD, Inc., a California corporation

By:   
Matt Sauls  
Senior Vice President

**[Signatures continued on next page]**

**CALIFORNIA ALL-PURPOSE ACKNOWLEDGMENT**

**CIVIL CODE § 1189**

A notary public or other officer completing this certificate verifies only the identity of the individual who signed the document to which this certificate is attached, and not the truthfulness, accuracy, or validity of that document.

State of California }  
County of Los Angeles

On March 21, 2024 before me, Karen S. Hornback, Notary Public  
*Date Here Insert Name and Title of the Officer*

personally appeared Mark A. Porath and Steven C. Porath  
*Name(s) of Signer(s)*

who proved to me on the basis of satisfactory evidence to be the person(s) whose name(s) is/are subscribed to the within instrument and acknowledged to me that he/she/they executed the same in his/her/their authorized capacity(ies), and that by his/her/their signature(s) on the instrument the person(s), or the entity upon behalf of which the person(s) acted, executed the instrument.



I certify under PENALTY OF PERJURY under the laws of the State of California that the foregoing paragraph is true and correct.

WITNESS my hand and official seal.

Signature Karen S. Hornback  
*Signature of Notary Public*

Place Notary Seal and/or Stamp Above

**OPTIONAL**

*Completing this information can deter alteration of the document or fraudulent reattachment of this form to an unintended document.*

**Description of Attached Document**

Title or Type of Document: \_\_\_\_\_

Document Date: \_\_\_\_\_ Number of Pages: \_\_\_\_\_

Signer(s) Other Than Named Above: \_\_\_\_\_

**Capacity(ies) Claimed by Signer(s)**

Signer's Name: \_\_\_\_\_

Corporate Officer – Title(s): \_\_\_\_\_

Partner –  Limited  General

Individual  Attorney in Fact

Trustee  Guardian of Conservator

Other: \_\_\_\_\_

Signer is Representing: \_\_\_\_\_

Signer's Name: \_\_\_\_\_

Corporate Officer – Title(s): \_\_\_\_\_

Partner –  Limited  General

Individual  Attorney in Fact

Trustee  Guardian of Conservator

Other: \_\_\_\_\_

Signer is Representing: \_\_\_\_\_

## ACKNOWLEDGMENT

A notary public or other officer completing this certificate verifies only the identity of the individual who signed the document to which this certificate is attached, and not the truthfulness, accuracy, or validity of that document.

State of California  
County of Riverside )

On 03/25/2024 before me, Olinda E. Rodriguez / Notary Public  
(insert name and title of the officer)

personally appeared Matt Sauls,  
who proved to me on the basis of satisfactory evidence to be the person(s) whose name(s) is/are subscribed to the within instrument and acknowledged to me that he/she/they executed the same in his/her/their authorized capacity(ies), and that by his/her/their signature(s) on the instrument the person(s), or the entity upon behalf of which the person(s) acted, executed the instrument.

I certify under PENALTY OF PERJURY under the laws of the State of California that the foregoing paragraph is true and correct.

WITNESS my hand and official seal.

Signature Olinda Rodriguez (Seal)





**COUNTY OF RIVERSIDE:**

By:   
CHUCK WASHINGTON  
Chairman, County Board of Supervisors

**APPROVED AS TO FORM:**

Minh C. Tran  
County Counsel

By:   
Stephanie K. Nelson  
Deputy County Counsel

**ATTEST:**  
Kimberly Rector  
Clerk of the Board

By:   
Deputy

**EXHIBIT A**

**DESCRIPTION OF PROPERTY**

Real property in the City of Hemet, County of Riverside, State of California, described as follows:

PARCEL 1:

CONDOMINIUMS COMPRISED OF:

PARCEL A:

RESIDENTIAL UNITS 1 THROUGH 7, INCLUSIVE, AND ASSOCIATION PROPERTY LOCATED WITHIN MODULE A (“MODULE A”) LOCATED ON A PORTION OF LOT 1 OF TRACT NO. 33145, IN THE COUNTY OF RIVERSIDE, STATE OF CALIFORNIA, AS PER MAP FILED IN BOOK 483, PAGES 76 THROUGH 79, INCLUSIVE, OF MAPS, IN THE OFFICE OF THE COUNTY RECORDER OF SAID COUNTY, AS SHOWN AND DESCRIBED ON THE AMENDED, RESTATED AND SUPERSEDING CONDOMINIUM PLAN FOR OUTLOOK 1 (OPAL SKYE RESIDENTIAL UNITS 1-26 AND 43-58 AND COPPER SKYE RESIDENTIAL UNITS 207-246 AND 267-276) RECORDED IN THE OFFICE OF THE COUNTY RECORDER OF RIVERSIDE COUNTY ON SEPTEMBER 22, 2022 AS INSTRUMENT NO. 2022-0403804 (“CONDOMINIUM PLAN”) (COLLECTIVELY, THE “MODULE A TAKEDOWN 10 PROPERTY”).

PARCEL B:

EACH RESIDENTIAL UNIT IN MODULE A SHALL HAVE AN UNDIVIDED ONE-SEVENTH (1/7TH) FEE SIMPLE INTEREST AS A TENANT IN COMMON TO THE COMMON AREA LOCATED WITHIN MODULE A AS SHOWN AND DESCRIBED ON THE CONDOMINIUM PLAN. THE MODULE A TAKEDOWN 10 PROPERTY INCLUDES SEVEN (7) RESIDENTIAL CONDOMINIUMS WITHIN MODULE A AND THEREFORE, INCLUDES AN UNDIVIDED SEVEN-SEVENTHS (7/7THS) INTEREST IN THE COMMON AREA LOCATED WITHIN MODULE A.

PARCEL 2:

CONDOMINIUMS COMPRISED OF:

PARCEL A:

RESIDENTIAL UNITS 83 THROUGH 90, INCLUSIVE, AND ASSOCIATION PROPERTY LOCATED WITHIN MODULE D (“MODULE D”) LOCATED ON A PORTION OF LOT 2 OF TRACT NO. 33145, IN THE COUNTY OF RIVERSIDE, STATE OF CALIFORNIA, AS PER MAP FILED IN BOOK 483, PAGES 76 THROUGH 79, INCLUSIVE, OF MAPS, IN THE OFFICE OF THE COUNTY RECORDER OF SAID COUNTY, AS SHOWN AND DESCRIBED ON THE CONDOMINIUM PLAN FOR OUTLOOK 1 (OPAL SKYE RESIDENTIAL UNITS 59-136 AND COPPER SKYE RESIDENTIAL UNITS 137-206)

CFD 03-1 (Newport Rd CFD)  
Assignment Agreement  
Copper Skye-Meniffee, L.P. & Tri Pointe Homes IE-SD, Inc.  
Tract No. 33415 Unit Nos. 1-7, 83-97, 130-136, & 167-196

RECORDED IN THE OFFICE OF THE COUNTY RECORDER OF RIVERSIDE COUNTY ON AUGUST 30, 2022 AS INSTRUMENT NO. 2022-0376961 ("CONDOMINIUM PLAN") (COLLECTIVELY, THE "MODULE D TAKEDOWN 10 PROPERTY").

PARCEL B:

EACH RESIDENTIAL UNIT IN MODULE D SHALL HAVE AN UNDIVIDED ONE-EIGHTH (1/8TH) FEE SIMPLE INTEREST AS A TENANT IN COMMON TO THE COMMON AREA LOCATED WITHIN MODULE D AS SHOWN AND DESCRIBED ON THE CONDOMINIUM PLAN. THE MODULE D TAKEDOWN 10 PROPERTY INCLUDES EIGHT (8) RESIDENTIAL CONDOMINIUMS WITHIN MODULE D AND THEREFORE, INCLUDES AN UNDIVIDED EIGHT-EIGHTHS (8/8THS) INTEREST IN THE COMMON AREA LOCATED WITHIN MODULE D.

PARCEL 3:

CONDOMINIUMS COMPRISED OF:

PARCEL A:

RESIDENTIAL UNITS 91 THROUGH 97, INCLUSIVE, AND ASSOCIATION PROPERTY LOCATED WITHIN MODULE E ("MODULE E") LOCATED ON A PORTION OF LOT 2 OF TRACT NO. 33145, IN THE COUNTY OF RIVERSIDE, STATE OF CALIFORNIA, AS PER MAP FILED IN BOOK 483, PAGES 76 THROUGH 79, INCLUSIVE, OF MAPS, IN THE OFFICE OF THE COUNTY RECORDER OF SAID COUNTY, AS SHOWN AND DESCRIBED ON THE CONDOMINIUM PLAN FOR OUTLOOK 1 (OPAL SKYE RESIDENTIAL UNITS 59-136 AND COPPER SKYE RESIDENTIAL UNITS 137-206) RECORDED IN THE OFFICE OF THE COUNTY RECORDER OF RIVERSIDE COUNTY ON AUGUST 30, 2022 AS INSTRUMENT NO. 2022-0376961 ("CONDOMINIUM PLAN") (COLLECTIVELY, THE "MODULE E TAKEDOWN 10 PROPERTY").

PARCEL B:

EACH RESIDENTIAL UNIT IN MODULE E SHALL HAVE AN UNDIVIDED ONE-SEVENTH (1/7TH) FEE SIMPLE INTEREST AS A TENANT IN COMMON TO THE COMMON AREA LOCATED WITHIN MODULE E AS SHOWN AND DESCRIBED ON THE CONDOMINIUM PLAN. THE MODULE E TAKEDOWN 10 PROPERTY INCLUDES SEVEN (7) RESIDENTIAL CONDOMINIUMS WITHIN MODULE E AND THEREFORE, INCLUDES AN UNDIVIDED SEVEN-SEVENTHS (7/7THS) INTEREST IN THE COMMON AREA LOCATED WITHIN MODULE E.

PARCEL 4:

CONDOMINIUMS COMPRISED OF:

PARCEL A:

CFD 03-1 (Newport Rd CFD)  
Assignment Agreement  
Copper Skye-Menifée, L.P. & Tri Pointe Homes IE-SD, Inc.  
Tract No. 33415 Unit Nos. 1-7, 83-97, 130-136, & 167-196

RESIDENTIAL UNITS 130 THROUGH 136, INCLUSIVE, AND ASSOCIATION PROPERTY LOCATED WITHIN MODULE J ("MODULE J") LOCATED ON A PORTION OF LOT 2 OF TRACT NO. 33145, IN THE COUNTY OF RIVERSIDE, STATE OF CALIFORNIA, AS PER MAP FILED IN BOOK 483, PAGES 76 THROUGH 79, INCLUSIVE, OF MAPS, IN THE OFFICE OF THE COUNTY RECORDER OF SAID COUNTY, AS SHOWN AND DESCRIBED ON THE CONDOMINIUM PLAN FOR OUTLOOK 1 (OPAL SKYE RESIDENTIAL UNITS 59-136 AND COPPER SKYE RESIDENTIAL UNITS 137-206) RECORDED IN THE OFFICE OF THE COUNTY RECORDER OF RIVERSIDE COUNTY ON AUGUST 30, 2022 AS INSTRUMENT NO. 2022-0376961 ("CONDOMINIUM PLAN") (COLLECTIVELY, THE "MODULE J TAKEDOWN 10 PROPERTY").

PARCEL B:

EACH RESIDENTIAL UNIT IN MODULE J SHALL HAVE AN UNDIVIDED ONE-SEVENTH (1/7TH) FEE SIMPLE INTEREST AS A TENANT IN COMMON TO THE COMMON AREA LOCATED WITHIN MODULE J AS SHOWN AND DESCRIBED ON THE CONDOMINIUM PLAN. THE MODULE J TAKEDOWN 10 PROPERTY INCLUDES SEVEN (7) RESIDENTIAL CONDOMINIUMS WITHIN MODULE J AND THEREFORE, INCLUDES AN UNDIVIDED SEVEN-SEVENTHS (7/7THS) INTEREST IN THE COMMON AREA LOCATED WITHIN MODULE J.

PARCEL 5:

CONDOMINIUMS COMPRISED OF:

PARCEL A:

RESIDENTIAL UNITS 167 THROUGH 176, INCLUSIVE, AND ASSOCIATION PROPERTY LOCATED WITHIN MODULE N ("MODULE N") LOCATED ON A PORTION OF LOT 2 OF TRACT NO. 33145, IN THE COUNTY OF RIVERSIDE, STATE OF CALIFORNIA, AS PER MAP FILED IN BOOK 483, PAGES 76 THROUGH 79, INCLUSIVE, OF MAPS, IN THE OFFICE OF THE COUNTY RECORDER OF SAID COUNTY, AS SHOWN AND DESCRIBED ON THE CONDOMINIUM PLAN FOR OUTLOOK 1 (OPAL SKYE RESIDENTIAL UNITS 59-136 AND COPPER SKYE RESIDENTIAL UNITS 137-206) RECORDED IN THE OFFICE OF THE COUNTY RECORDER OF RIVERSIDE COUNTY ON AUGUST 30, 2022 AS INSTRUMENT NO. 2022-0376961 ("CONDOMINIUM PLAN") (COLLECTIVELY, THE "MODULE N TAKEDOWN 10 PROPERTY").

PARCEL B:

EACH RESIDENTIAL UNIT IN MODULE N SHALL HAVE AN UNDIVIDED ONE-TENTH (1/10TH) FEE SIMPLE INTEREST AS A TENANT IN COMMON TO THE COMMON AREA LOCATED WITHIN MODULE N AS SHOWN AND DESCRIBED ON THE CONDOMINIUM PLAN. THE MODULE N TAKEDOWN 10 PROPERTY INCLUDES TEN (10) RESIDENTIAL CONDOMINIUMS WITHIN MODULE N AND THEREFORE, INCLUDES AN UNDIVIDED TEN-TENTHS (10/10THS) INTEREST IN THE COMMON AREA LOCATED WITHIN MODULE N.

CFD 03-1 (Newport Rd CFD)  
Assignment Agreement  
Copper Skye-Menifee, L.P. & Tri Pointe Homes IE-SD, Inc.  
Tract No. 33415 Unit Nos. 1-7, 83-97, 130-136, & 167-196

EXHIBIT A



PARCEL 6:

CONDOMINIUMS COMPRISED OF:

PARCEL A:

RESIDENTIAL UNITS 177 THROUGH 186, INCLUSIVE, AND ASSOCIATION PROPERTY LOCATED WITHIN MODULE O ("MODULE O") LOCATED ON A PORTION OF LOT 2 OF TRACT NO. 33145, IN THE COUNTY OF RIVERSIDE, STATE OF CALIFORNIA, AS PER MAP FILED IN BOOK 483, PAGES 76 THROUGH 79, INCLUSIVE, OF MAPS, IN THE OFFICE OF THE COUNTY RECORDER OF SAID COUNTY, AS SHOWN AND DESCRIBED ON THE CONDOMINIUM PLAN FOR OUTLOOK 1 (OPAL SKYE RESIDENTIAL UNITS 59-136 AND COPPER SKYE RESIDENTIAL UNITS 137-206) RECORDED IN THE OFFICE OF THE COUNTY RECORDER OF RIVERSIDE COUNTY ON AUGUST 30, 2022 AS INSTRUMENT NO. 2022-0376961 ("CONDOMINIUM PLAN") (COLLECTIVELY, THE "MODULE O TAKEDOWN 10 PROPERTY").

PARCEL B:

EACH RESIDENTIAL UNIT IN MODULE O SHALL HAVE AN UNDIVIDED ONE-TENTH (1/10TH) FEE SIMPLE INTEREST AS A TENANT IN COMMON TO THE COMMON AREA LOCATED WITHIN MODULE O AS SHOWN AND DESCRIBED ON THE CONDOMINIUM PLAN. THE MODULE O TAKEDOWN 10 PROPERTY INCLUDES TEN (10) RESIDENTIAL CONDOMINIUMS WITHIN MODULE O AND THEREFORE, INCLUDES AN UNDIVIDED TEN-TENTHS (10/10THS) INTEREST IN THE COMMON AREA LOCATED WITHIN MODULE O.

PARCEL 7:

CONDOMINIUMS COMPRISED OF:

PARCEL A:

RESIDENTIAL UNITS 187 THROUGH 196, INCLUSIVE, AND ASSOCIATION PROPERTY LOCATED WITHIN MODULE P ("MODULE P") LOCATED ON A PORTION OF LOT 2 OF TRACT NO. 33145, IN THE COUNTY OF RIVERSIDE, STATE OF CALIFORNIA, AS PER MAP FILED IN BOOK 483, PAGES 76 THROUGH 79, INCLUSIVE, OF MAPS, IN THE OFFICE OF THE COUNTY RECORDER OF SAID COUNTY, AS SHOWN AND DESCRIBED ON THE CONDOMINIUM PLAN FOR OUTLOOK 1 (OPAL SKYE RESIDENTIAL UNITS 59-136 AND COPPER SKYE RESIDENTIAL UNITS 137-206) RECORDED IN THE OFFICE OF THE COUNTY RECORDER OF RIVERSIDE COUNTY ON AUGUST 30, 2022 AS INSTRUMENT NO. 2022-0376961 ("CONDOMINIUM PLAN") (COLLECTIVELY, THE "MODULE P TAKEDOWN 10 PROPERTY").

PARCEL B:

EACH RESIDENTIAL UNIT IN MODULE P SHALL HAVE AN UNDIVIDED ONE-TENTH (1/10TH) FEE SIMPLE INTEREST AS A TENANT IN COMMON TO THE COMMON AREA LOCATED WITHIN MODULE P AS SHOWN AND DESCRIBED ON THE CONDOMINIUM PLAN. THE MODULE P TAKEDOWN 10 PROPERTY INCLUDES TEN (10) RESIDENTIAL CONDOMINIUMS WITHIN MODULE P AND THEREFORE, INCLUDES AN UNDIVIDED TEN-TENTHS (10/10THS) INTEREST IN THE COMMON AREA LOCATED WITHIN MODULE P.

PARCEL 8:

LOTS 112 THROUGH 117, INCLUSIVE, 160 AND 161 OF TRACT NO. 30807, IN THE COUNTY OF RIVERSIDE, STATE OF CALIFORNIA, AS PER MAP RECORDED IN BOOK 474, PAGES 38 THROUGH 48, INCLUSIVE, OF MAPS, IN THE OFFICE OF THE COUNTY RECORDER OF SAID COUNTY.

0 335 670 1,340 Feet  
1 inch = 667 feet  
Orthophotos Flown 2016  
Printed by CSegarra on 3/5/2024

# Vicinity Map

## Tract No. 33145

### Unit Nos. 1-7, 83-97, 130-136, and 167-196

The County of Riverside assumes no warranty or legal responsibility for the information contained on this map. Data and information represented on this map is subject to updates, modifications and may not be complete or appropriate for all purposes. County GIS and other sources should be queried for the most current information. Do not copy or resell this map.

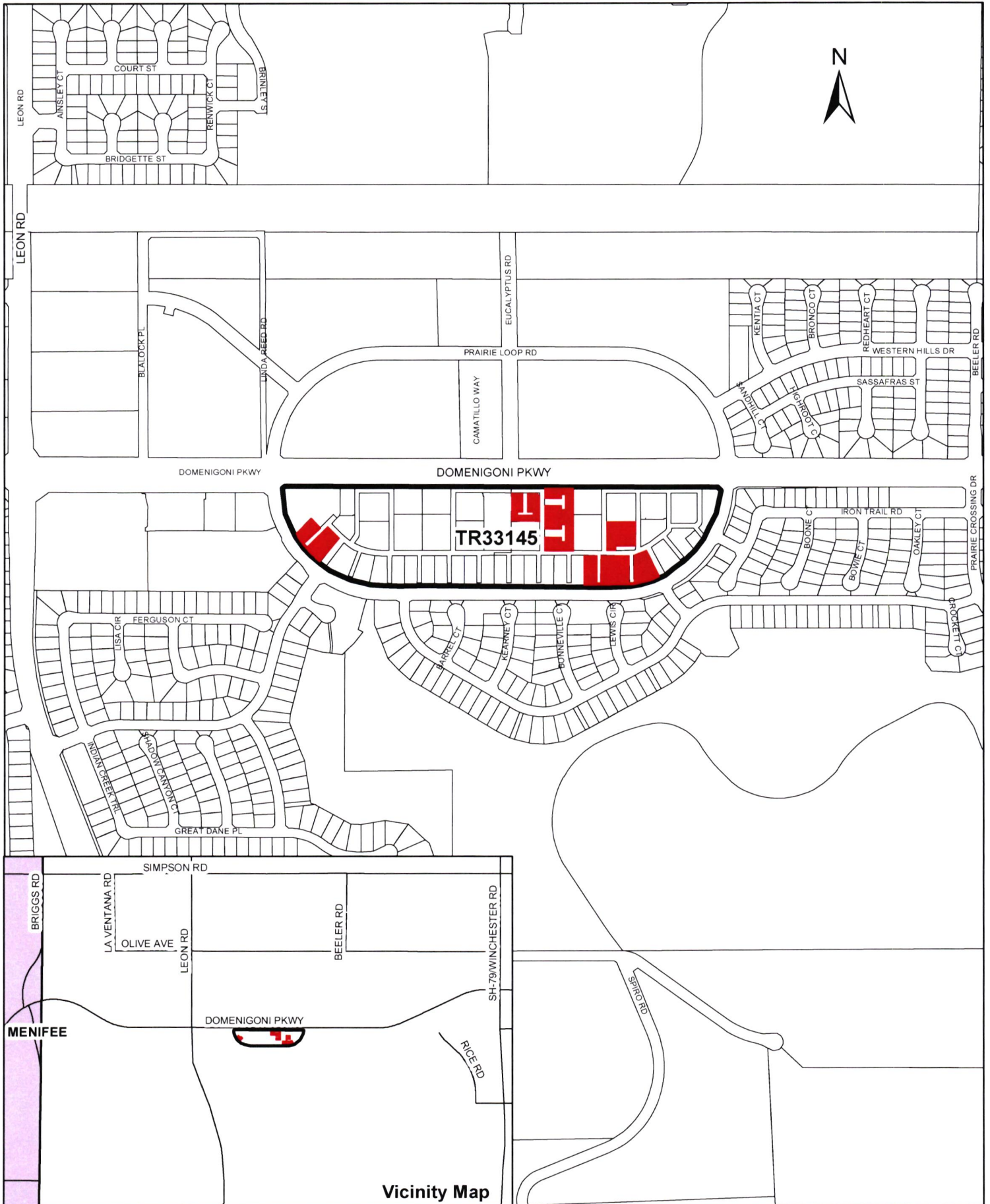

0 335 670 1,340 Feet

1 inch = 667 feet  
Orthophotos Flown 2016  
Printed by CSegarra on 3/5/2024

# Vicinity Map

## Tract No. 33145

### Unit Nos. 1-7, 83-97, 130-136, and 167-196

The County of Riverside assumes no warranty or legal responsibility for the information contained on this map. Data and information represented on this map is subject to updates, modifications and may not be complete or appropriate for all purposes. County GIS and other sources should be queried for the most current information. Do not copy or resell this map.

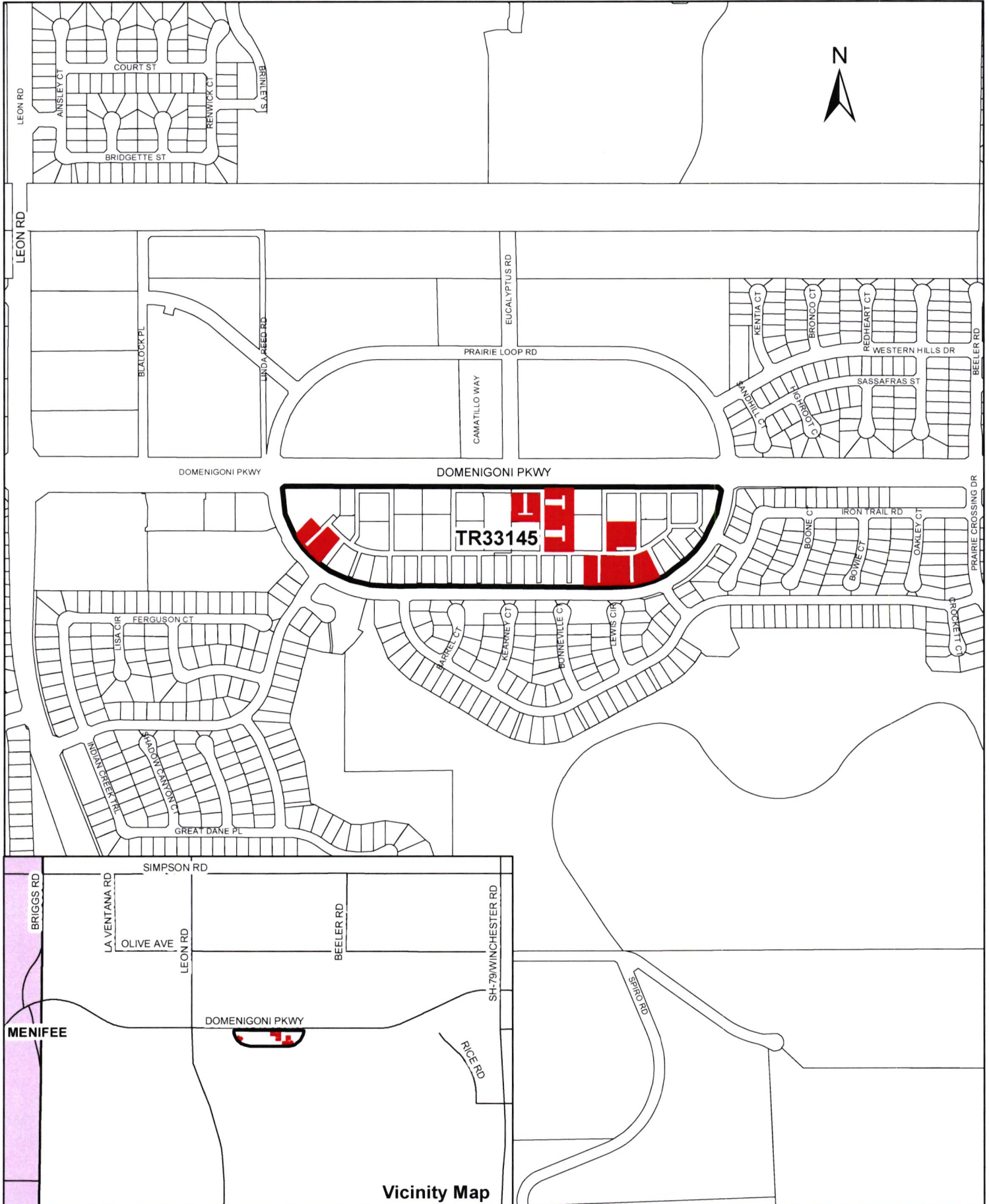

Vicinity Map