

**SUBMITTAL TO THE BOARD OF SUPERVISORS
COUNTY OF RIVERSIDE, STATE OF CALIFORNIA**



ITEM: 3.47
(ID # 27959)

MEETING DATE:
Tuesday, June 10, 2025

FROM : OFFICE OF ECONOMIC DEVELOPMENT

SUBJECT: OFFICE OF ECONOMIC DEVELOPMENT: Adoption of Resolution No. 2025-127 Intention to Institute Change Proceedings for Community Facilities District No. 19-1M (La Ventana) TR 31100 and TR 38586. District 3. [\$235,352 - Ongoing Cost; CFD 19-1M (La Ventana) – 100%] (Clerk to Set for Public Hearing on July 29, 2025, at 9:30 a.m. or as soon as possible thereafter - and to Advertise)

RECOMMENDED MOTION: That the Board of Supervisors:

1. Adopt Resolution No. 2025-127 a Resolution of the Board of Supervisors of the County of Riverside of Intention to Institute Change Proceedings for Community Facilities District 19-1M (La Ventana) and to Authorize the Levy of Special Taxes and Setting a Date and Time for a Public Hearing Thereon; and
2. Set a public hearing concerning Change Proceeding of Community Facilities District 19-1M (La Ventana) for 9:30 a.m. on July 29, 2025, and direct the Clerk of the Board to publish notice of the public hearing in accordance with California Government Code Section 53322.

ACTION:Policy, Clerk to Advertise, Set for Hearing

Suzanne Holland, Director of Office of Economic Development 5/29/2025

MINUTES OF THE BOARD OF SUPERVISORS

On motion of Supervisor Gutierrez, seconded by Supervisor Washington and duly carried by unanimous vote, IT WAS ORDERED that the above matter is approved as recommended and is set for public hearing on Tuesday, July 29, 2025, at 9:30 a.m. or as soon as possible thereafter.

Ayes: Medina, Spiegel, Washington, Perez and Gutierrez
Nays: None
Absent: None
Date: June 10, 2025
xc: OED, COBNS

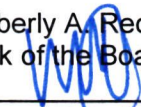
Kimberly A. Rector
Clerk of the Board
By: 
Deputy

**SUBMITTAL TO THE BOARD OF SUPERVISORS COUNTY OF RIVERSIDE,
STATE OF CALIFORNIA**

FINANCIAL DATA	Current Fiscal Year:	Next Fiscal Year:	Total Cost:	Ongoing Cost
COST	\$ 0	\$ 235,352	\$ 0	\$ 235,352
NET COUNTY COST	\$ 0	\$ 0	\$ 0	\$ 0
SOURCE OF FUNDS: 100% CFD 19-1M (La Ventana)			Budget Adjustment: N/A	
			For Fiscal Year: 25/26	

C.E.O. RECOMMENDATION: Approve

BACKGROUND:

Summary

The State legislature enacted the Mello-Roos Community Facilities Act of 1982 to assist public agencies in financing certain public services and maintenance requirements. On January 27, 2015, the Board of Supervisors revised Board Policy B-12 entitled "Land Secured Financing Districts" to include "Service and Maintenance CFDs" to fund the ongoing maintenance of landscape, street lighting, or other similar improvements and set goals and policies concerning Community Facilities Districts (CFD).

D.R. Horton Los Angeles Holdings Company Inc. is the Owner of Tracts 31100 and 38586 and has petitioned that the County of Riverside Office of Economic Development assist them in amending the Rate and Method of Apportionment, to cover costs associated with additional maintenance and servicing of public improvements within the established district. D.R. Horton Los Angeles Holdings Company Inc. owns 100% of the area subject to the Special Tax Rate. The boundaries of CFD 19-1M (La Ventana) encompasses Tracts 31100 and 38586, which are projected to include 292 assessable single-family dwelling units. The proposed amendment includes increasing the Special Tax Rate beginning Fiscal Year 2024-2025.

As approved by voters, a special tax is to be levied on each individual parcel located within the boundary of the CFD, to fund the costs associated with services necessary to meet the increased demands placed by development upon the County, as listed in Exhibit A attached herein.

The special tax is levied according to the Amended and Restated Rate and Method of Apportionment (RMA) which is developed with respect to the specific features of the residential development within the District and a which is approved by the eligible voters and later adopted by an ordinance. The special tax is annually placed on the tax roll for each Assessor Parcel Number (APN) noted in the CFD Boundary Map, both attached herein.

On May 7, 2019, the County of Riverside Board of Supervisors approved agenda item 3.10 Resolution No. 2019-070, a resolution of intention as the initial step for forming the CFD and declared the intention of the Board of Supervisors as required by the Mello-Roos Act of 1982 to levy a special tax to fund the service and maintenance functions requested by the Developer.

On June 11, 2019 (Agenda Item 19.2), the County of Riverside Board of Supervisors held a public hearing to receive public comments and conduct a majority protest hearing concerning

**SUBMITTAL TO THE BOARD OF SUPERVISORS COUNTY OF RIVERSIDE,
STATE OF CALIFORNIA**

the establishment of the CFD and the levy of the special tax. At the conclusion of the public hearing, the Board of Supervisors adopted Resolution No. 2019-112, the Resolution of Formation of the CFD, which also authorized the levy of a special tax within the CFD subject to voter approval during a duly called election held that same day.

On July 23, 2019 (Agenda Item 3.21), the Board of Supervisors adopted Resolution No. 2019-161 declaring the results of the election regarding the proposed special tax and finding that 100% of the votes cast were in favor of the levy of the special tax. In addition, the Board introduced Riverside County Ordinance No. 953 authorizing the levy of the special tax pursuant to the Rate and Method of Apportionment approved by the voters.

On September 10, 2019 (Agenda Item 3.15), the Board of Supervisors adopted Ordinance No. 953, an Ordinance of the County of Riverside Authorizing the Levy of a Special Tax Within Community Facilities District No. 19-1M (La Ventana).

Approval of proposed Resolution No. 2025-127 by the Board of Supervisors is the initial step for Instituting Change Proceedings for CFD 19-1M (La Ventana) and declares the intention of the Board of Supervisors, as required by the Mello-Roos Community Facilities Act of 1982, to levy a special tax to fund the service and maintenance functions requested by the Developer. The Resolution also requires the Board of Supervisors to hold a public hearing and submit the change proceedings of CFD 19-1M (La Ventana) to the landowners at a special election to be conducted by mailed ballot if a majority protest does not occur.

Reference

The CFD Amended and Restated Rate and Method of Apportionment (RMA) are consistent with the Mello-Roos Community Facilities Act of 1982. In November 1996, California voters passed Proposition 218, Right to Vote on Taxes Act which added Articles XIII C and XIII D to the California Constitution. The County may levy special taxes within this proposed CFD after complying with the requirements of the Mello-Roos Community Facilities Act of 1982 and the provisions of Proposition 218 Right to Vote on Taxes Act. The formation of the proposed CFD adheres to Board Policy B-12 entitled "Land Secured Financing Districts" which was revised on January 27, 2015, to include "Service and Maintenance CFDs" to fund the ongoing maintenance of landscape, storm water, street and pedestal lighting or other similar improvements and set goals and policies concerning CFDs.

Impact on Residents and Businesses

Only the parcels with Assessor Parcel Numbers within the proposed boundaries of the CFD which are represented by the proposed Boundary Map (inclusive of Tract Map Nos. 31100 and 38586) are impacted by the proposed special tax. By setting up a special tax for the maintenance of certain infrastructure required by the development, the County requires that the development pay for its maintenance impact, rather than the obligation falling upon declining

**SUBMITTAL TO THE BOARD OF SUPERVISORS COUNTY OF RIVERSIDE,
STATE OF CALIFORNIA**

public funding sources. By specifically collecting and using the special tax revenue within the boundary of the proposed CFD, there is a financial mechanism in place to ensure the infrastructure is maintained. This CFD does not propose to fund the repayment of any bonds or bond obligations and is solely for the purposes of funding the service and maintenance of Developer-installed and County-required infrastructure, particularly those listed in Exhibit A attached herein. The Developer shall, and is obligated to, provide disclosure statements to potential buyers which outline the associated tax rate of a new home.

Additional Fiscal Information

The amended budget for maintenance of \$235,352 for fiscal year 2025-2026 will result in \$806 per taxable parcel, pursuant to the Amended and Restated Rate and Method of Apportionment. The annual special tax shall be increased by the minimum of 2% or up to the cumulative percentage increase in the Consumer Price Index for all Urban Consumers (CPI-U), as it stands as of March of each year over the base index of previous fiscal year.

**SUBMITTAL TO THE BOARD OF SUPERVISORS COUNTY OF RIVERSIDE,
STATE OF CALIFORNIA**

ATTACHMENTS:

- Exhibit A: Description of Services
- Petition
- Resolution No. 2025-127
- Amended and Restated Rate and Method of Apportionment (RMA)
- CFD 19-1M Boundary Map
- Notice of Public Hearing
- Sample Ballot

Jacqueline Ruiz, Principal Analyst 5/29/2025

Aaron Gettis, Chief of Deputy County Counsel 5/29/2025

2 RESOLUTION NO. 2025-127

3
4 A RESOLUTION OF THE BOARD OF SUPERVISORS OF THE COUNTY OF RIVERSIDE OF
5 INTENTION TO DECLARE ITS INTENTION TO CONSIDER AMENDING THE RATE AND
6 METHOD OF APPORTIONMENT OF SPECIAL TAX FOR COMMUNITY FACILITIES DISTRICT
7 NO. 19-1M (LA VENTANA) AND TO AUTHORIZE THE LEVY OF SPECIAL TAXES AND
8 SETTING A DATE AND TIME FOR A PUBLIC HEARING THEREON
9

10 **WHEREAS**, a community facilities district may be established under the Mello-Roos Community
11 Facilities Act of 1982 (the "Act") in order to finance certain public capital facilities and services;

12 **WHEREAS**, proceedings for the establishment of a community facilities district under the Act may
13 be instituted following the receipt of a petition by the landowners of at least 10% of the area of land proposed
14 to be included within the territory of the community facilities district (a "Qualifying Petition") and the
15 furnishing of a deposit by the petitioners pursuant to Section 53318(d) of the Act ("Deposit");

16 **WHEREAS**, the Board of Supervisors of the County of Riverside constitutes the legislative body
17 of a local agency for purposes of the Act; and

18 **WHEREAS**, the Board of Supervisors has received both a Qualifying Petition and the Deposit
19 pursuant to the Act and therefore institutes change proceedings to amend Community Facilities District 19-
20 1M (La Ventana) (the "Community Facilities District" "CFD") and to authorize the levy of special taxes
21 therein in order to finance services described in Exhibit A attached hereto.

22 **WHEREAS**, on May 7, 2019, the County of Riverside Board of Supervisors approved, Resolution
23 No. 2019-070, a Resolution of Intention as the initial step for forming the CFD and declaring the intention
24 of the Board of Supervisors as required by the Mello-Roos Act of 1982 to levy a special tax to fund the
25 service and maintenance functions requested by the developer.

26 **WHEREAS**, on June 11, 2019, the County of Riverside Board of Supervisors held a public hearing
27 to receive public comments and conduct a majority protest hearing concerning the establishment of the CFD
28 and the levy of the special tax. At the conclusion of the public hearing, the Board of

FORM APPROVED COUNTY COUNSEL
BY: *Stephanie K Nelson* 5/29/25
STEPHANIE K NELSON DATE

1 Supervisors adopted Resolution No. 2019-112, the Resolution of Formation of the CFD, which also
2 authorized the levy of a special tax within the CFD subject to voter approval during a duly called election
3 held the same day;

4 **WHEREAS**, on July 23, 2019, the Board of Supervisors adopted 2019-161 declaring the results of
5 the election regarding the proposed special tax and finding that 100% of the votes cast were in favor of the
6 levy of the special tax. In addition, the Board introduced Riverside County Ordinance No. 953 authorizing
7 the levy of the special tax pursuant to the Rate and Method of Apportionment approved by the voters;

8 **WHEREAS**, on September 10, 2019, the Board of Supervisors adopted Ordinance No. 953, an
9 Ordinance of the County of Riverside Authorizing the Levy of a Special Tax Within Community Facilities
10 District No. 19-1M (La Ventana).

11 **NOW, THEREFORE, BE IT RESOLVED, DETERMINED AND ORDERED BY** the Board
12 of Supervisors of the County of Riverside, State of California (the “Board of Supervisors”) in regular
13 session assembled on June 10, 2025 at 9:30 a.m. or soon thereafter, in the meeting room of the Board of
14 Supervisors, located on the first floor of the County Administrative Center, 4080 Lemon Street, Riverside,
15 California as follows:

16 **Section 1.** The Board of Supervisors declares its intention to institute change proceedings pursuant
17 to Article 3.5 of the Mello-Roos Community Facilities Act of 1982, as amended, commencing with Section
18 53311 of the Government Code (the “Act”) for the proposed amendment to the Original Rate and Method
19 of Apportionment of the CFD in the form of the Amended and Restated Rate and Method of Apportionment.

20 **Section 2.** The proposed Amended and Restated Rate and Method of Apportionment and manner
21 of collection of the special tax is described in detail in Exhibit B.

22 **Section 3.** The services (the “Services”) proposed to be financed by the Community
23 Facilities District pursuant to the Act are described in Exhibit A attached hereto. The cost of providing the
24 Services includes “incidental expenses,” which include costs associated with the creation of CFD No. 19-
25 1M, determination of the amount of special taxes, collection or payment of special taxes, or costs otherwise
26 incurred in order to carry out the authorized purposes of CFD No. 19-1M.

27 **Section 4.** Except where funds are otherwise available, a special tax sufficient to pay for all Services,
28 secured by recordation of a continuing lien against all nonexempt real property in the Community Facilities
District, will be annually levied within the Community Facilities District. The amended and restated rate

1 and method of apportionment of the special tax (the “Amended and Restated Rate and Method of
2 Apportionment”), in sufficient detail to allow each landowner within the proposed Community Facilities
3 District to estimate the maximum amount that he or she will have to pay, is described in Exhibit B attached
4 hereto, which is by this reference incorporated herein. The special tax will be collected in the same manner
5 as ordinary *ad valorem* property taxes or in such other manner as the Board of Supervisors shall determine,
6 including direct billing of the affected property owners. The special tax shall be levied annually until
7 terminated by the Board of Supervisors as specified in the Amended and Restated Rate and Method of
8 Apportionment.

9 **Section 5.** The Board of Supervisors hereby sets the matter for public hearing on July 29, 2025, at
10 9:30 am, or as soon thereafter as the Board of Supervisors will consider the matter, at the meeting room of
11 the Board of Supervisors, located on the first floor of the County Administrative Center, 4080 Lemon Street,
12 1st Floor, Riverside, California, as the time and place when and where the Board of Supervisors will conduct
13 a public hearing on the amendment of the Original Rate and Method of Apportionment in accordance with
14 the proposed Amended and Restated Rate and Method of Apportionment of the Community Facilities
15 District and the levy of the special tax therein.

16 **Section 6.** The Clerk is hereby directed to publish, or cause to be published, a notice of said public
17 hearing, as prepared and approved by County Counsel, one time in *The Press Enterprise*, a
18 newspaper of general circulation published in the area of the Community Facilities District. The publication
19 of said notice shall be completed at least seven days prior to the date set for public hearing. Said notice
20 shall contain the information prescribed by Section 53322 of the Government Code.

21 The Clerk is hereby further directed to give notice of said public hearing, as prepared and approved
22 by County Counsel, by first-class mail to each registered voter and to each landowner within the
23 Community Facilities District. Said notice shall be mailed at least 15 days prior to the date set for public
24 hearing and shall contain the same information as is required to be contained in the notice published
25 pursuant to Section 53322 of the Government Code.

26 **Section 7.** The levy of said proposed special tax shall be subject to the approval of the qualified
27 electors of the Community Facilities District at a special election. The proposed voting procedure shall be
28

1 by mailed or hand-delivered ballot among the landowners in the Community Facilities District, with each
2 owner having one vote for each acre or portion of an acre such owner owns in the Community Facilities
3 District.

4 **Section 8.** Each officer of the County of Riverside who is or will be responsible for providing one
5 or more of the proposed types of Services is hereby directed to study, or cause to be studied, the proposed
6 Community Facilities District and, at or before said public hearing, file a report with the Board of
7 Supervisors containing a brief description of the Services by type which will in his or her opinion be
8 required to adequately meet the needs of the Community Facilities District, and his or her estimate of the
9 cost of providing the Services. Such officers are hereby also directed to estimate the fair and reasonable
10 cost of the incidental expenses proposed to be paid. Such report shall be made a part of the record of said
11 public hearing.

12 **Section 9.** In the opinion of the Board of Supervisors, the public interest will not be served by
13 allowing the property owners within the proposed Community Facilities District to enter into a contract in
14 accordance with subdivision (a) of Section 53329.5 of the Government Code and, accordingly, the Board
15 of Supervisors hereby provides that such property owners may not enter into a contract in accordance with
16 said subdivision.

17 **Section 10.** The officers of the County of Riverside are, and each of them is, hereby authorized and
18 directed to do any and all things, and to execute and deliver any and all documents which said officers may
19 deem necessary or advisable in order to accomplish the purposes of this resolution and not inconsistent with
20 the provisions hereof.

21
22
23 **ADOPTED, SIGNED AND APPROVED** this 10TH day of June, 2025, by the Board of
24 Supervisors of the County of Riverside.

25 //

26 //

27

28



Chair of the Board of Supervisors

V. MANUEL PEREZ

1
2
3
4
5
6
7
8
9
10
11
12
13
14
15
16
17
18
19
20
21
22
23
24
25
26
27
28

ATTEST:

Kimberley A. Rector

Clerk of the Board of Supervisors

By: 

Deputy

JUN 10 2025 3.47

2
3 RESOLUTION NO. 2025-127

4 A RESOLUTION OF THE BOARD OF SUPERVISORS OF THE COUNTY OF RIVERSIDE
5 OF INTENTION TO CONSIDER AMENDING THE RATE AND METHOD OF
6 APPORTIONMENT OF SPECIAL TAX FOR COMMUNITY FACILITIES DISTRICT NO.
7 19-1M (LA VENTANA) AND TO AUTHORIZE THE LEVY OF SPECIAL TAXES AND
8 SETTING A DATE AND TIME FOR A PUBLIC HEARING THEREON

9 ROLL CALL:

10 Ayes: Medina, Spiegel, Washington, Perez, and Gutierrez

11 Nays: None

12 Absent: None

13
14 The foregoing is certified to be a true copy of a resolution duly adopted by said Board of
15 Supervisors on the date therein set forth.

16
17 KIMBERLY A. RECTOR, Clerk of said Board

18
19 By:  _____

20 Deputy

1 EXHIBIT A

2
3 SERVICES AND INCIDENTAL EXPENSES

4
5 **Services**

6 The services which may be funded with proceeds of the special tax of CFD No. 19-1M, as provided by
7 Section 53313 of the Act, will include all costs attributable to maintaining, servicing, cleaning, repairing,
8 and/or replacing landscaped areas (may include reserves for replacement) in public street rights-of-way,
9 public landscaping, public open spaces, and other similar landscaped areas officially dedicated for public
10 use. These services include the following:

- 11 i) Maintenance of landscape improvements in the public right of way to include
12 replacement and repair of irrigation system, fencing, graffiti abatement of a retaining
13 wall; and
- 14 ii) Street and pedestal lighting energy charges, maintenance, repair, and replacement of
15 lighting located within the designated boundaries of the CFD No. 19-1M; and
- 16 iii) Traffic signal maintenance, including energy charges, operation, maintenance, and
17 administrative costs of traffic signals within the boundaries of the CFD; and
- 18 iv) Administration inspection, and maintenance of all stormwater facilities and BMPs to
19 include: water quality basins, fossil filters, basin forebays, and all other
20 NPDES/WQMP/BMP related devices and structures as approved and accepted by
21 the Community Facilities District; administration includes, but is not limited to,
22 quality control and assurance of inspections and maintenance, general contract
23 management, scheduling of inspections and maintenance, and general oversight of
24 all NPDES/WQMP/BMP operations; inspection includes, but is not limited to, travel
25 time, visual inspection process and procedures for functionality, GPS location
26 recording, assurance of proper vegetation, functioning irrigation, and citing
27 operational or structural deficiencies, erosion, trash, silt and sediment build-up; and
28 maintenance includes, but is not limited to, repair or replacement of any deficiencies

1 noted during inspection, weed control and abatement, trash removal, and healthy
2 upkeep of required plant materials.

3
4 **Incidental Expenses**

5 The incidental expenses proposed to be incurred include the following:

- 6 (i) The cost associated with the creation of the Community Facilities District, determination of
7 the amount of taxes, collection of taxes, including litigation expenses, if any, costs for
8 processing payment of taxes, or other administrative costs otherwise incurred in order to
9 carry out the authorized purposes of the Community Facilities District; and
- 10 (ii) Any other expenses incidental to the performance and inspection of the authorized Services.

1
2
3
4
5
6
7
8
9
10
11
12
13
14
15
16
17
18
19
20
21
22
23
24
25
26
27
28

EXHIBIT B

**PROPOSED AMENDED AND RESTATED RATE AND METHOD OF APPORTIONMENT OF
SPECIAL TAX**

(See Attached)

**AMENDED AND RESTATED
RATE AND METHOD OF APPORTIONMENT OF SPECIAL TAX FOR
COMMUNITY FACILITIES DISTRICT 19-1M (LA VENTANA)
OF THE COUNTY OF RIVERSIDE
STATE OF CALIFORNIA**

A Special Tax (all capitalized terms are defined in Section A. Definitions, below) shall be applicable to each Parcel of Taxable Property located within the boundaries of Community Facilities District (CFD) 19-1M (La Ventana). The amount of Special Tax to be levied on each Parcel in each Improvement Area in each Fiscal Year, commencing in Fiscal Year 2025-2026 shall be determined by the Riverside County Board of Supervisors, acting in its capacity as the legislative body of the CFD by applying the appropriate Special Tax as set forth in Sections B., C., and D., below. All of the real property within the CFD, unless exempted by law or by the provisions of Section E., below, shall be taxed for the purposes, to the extent, and in the manner herein provided.

A. DEFINITIONS

The terms hereinafter set forth have the following meanings:

“Accessory Dwelling Unit(s)” means a residential unit of limited size, as defined in California Government Code Section 65852.2 that shares an Assessor’s Parcel Number with Single Family Residential Property.

“Acre” or “Acreage” means the land area of a Parcel as shown on the most recent Assessor’s Parcel Map, or if the land area is not shown on the Assessor’s Parcel Map, the land area shown on the applicable Final Map, condominium plan, or other recorded County map. If the preceding maps are not available, the Acreage of an Assessor’s Parcel Number may be determined utilizing Geographic Information System. The square footage of a Parcel is equal to the Acreage of such Parcel multiplied by 43,560.

“Act” means the Mello-Roos Community Facilities Act of 1982, as amended, being Chapter 2.5 of Part 1 of Division 2 of Title 5 of the Government Code of the State of California.

“Administrative Expenses” means all actual or reasonably estimated costs and expenses of the CFD that are chargeable or allocable to carry out the duties of the Administrator of the CFD as allowed by the Act, which shall include without limitation, all costs and expenses arising out of or resulting from the annual levy and collection of the Special Tax (whether by the County or designee thereof, or both), any litigation or appeal involving the CFD, and other administrative expenses of the County or designee thereof, or both, directly related to the CFD. Administrative Expenses shall also include amounts estimated or advanced by the County or CFD for attorney’s fees and other costs related to commencing and pursuing to completion any foreclosure as a result of delinquent Special Taxes.

“Administrator” means an official of the County, or designee thereof, responsible for determining the Special Tax Requirement and providing for the levy and collection of the Special Taxes.

“Approved Property” means all Parcels of Taxable Property: (i) that are included in a Final Map that was recorded prior to the January 1st preceding the Fiscal Year in which the Special Tax is being levied, and (ii) that have not been issued a Building Permit(s) prior to the April 1st preceding the Fiscal Year in which the Special Tax is being levied.

“Assessor” means the Assessor of the County.

“Assessor’s Parcel Map” means an official map of the Assessor of the County designating Parcels by Assessor’s Parcel Number.

“Assessor’s Parcel Number” means the number assigned to a lot or Parcel for purposes of identification as determined from an Assessor Parcel Map or the applicable assessment roll.

“Base Year” means the Fiscal Year ending June 30, 2026.

“Board” means Riverside County Board of Supervisors, acting in its capacity as the legislative body of the CFD.

“Boundary Map” means a recorded map of the CFD which indicates by a boundary line the extent of the territory of each Improvement Area within the CFD identified to be subject to the levy of Special Taxes.

“Building Permit(s)” means a legal document(s) issued by a local agency that allows for new vertical construction of a building or buildings.

“Certificate of Occupancy” means a certificate of occupancy issued by the County in accordance with all applicable ordinances, regulations, and rule of the County and State law.

“CFD” or **“CFD 19-1M”** means Community Facilities District 19-1M (La Ventana) of the County of Riverside.

“Consumer Price Index” means the cumulative percentage increase in the Consumer Price Index (CPI) published by the U.S. Bureau of Labor Statistics for All Urban Consumers in the Riverside-San Bernardino-Ontario Area, as it stands in March of each year over the preceding Fiscal Year. In the event this index ceases to be published, the Consumer Price Index shall be another index as determined by the Administrator that is reasonably comparable to the Consumer Price Index for the Riverside-San Bernardino-Ontario Area. In the event that the percentage change in the annualized CPI is negative, the Special Tax shall not be decreased.

“County” means the County of Riverside, California.

“Developed Property” means for each Fiscal Year, all Parcels of Taxable Property: (i) that are included in a Final Map that was recorded prior to January 1st preceding the Fiscal Year in which the Special Tax is being levied, and (ii) for which a Building Permit(s) for vertical construction has been issued prior to April 1st preceding the Fiscal Year in which the Special Tax is being levied.

“Development Class” means either Developed Property, Approved Property, Taxable Property Owner’s Association Property, Taxable Public Property, or Undeveloped property.

“Dwelling Unit(s)” or **“(DU)”** means a residential building(s) that is used or intended to be used as a domicile by one or more persons, as determined by the Administrator.

“Exempt Property” means any Parcel which is exempt from Special Taxes pursuant to Section E., below.

“Final Map” means a subdivision of property by recordation of a tract map, parcel map or lot line adjustment, pursuant to the Subdivision Map Act (California Government Code Section 66410 *et seq.*) or recordation of a condominium plan pursuant to California Civil Code 4200 that creates individual lots for which Building Permit(s) may be issued without further subdivision.

“Fiscal Year” means the 12-month period starting on July 1 of any calendar year and ending the following June 30.

“Maximum Special Tax” means for each Parcel in each Fiscal Year, the greatest amount of Special Tax, determined in accordance with Section C., below, which may be levied on such Parcel in each Fiscal Year.

“Multi-family Residential Property” means all Parcels of Residential Property that consist of a two or more buildings comprised of attached Dwelling Units available for rental by the general public, not for sale to an end user, and under common management.

“Non-Residential Property” means all Parcels of Developed Property for which a Building Permit(s) was issued permitting the construction of one or more non-residential structures.

“Parcel” means a lot or parcel within the CFD shown on an Assessor’s Parcel Map with an assigned Assessor’s Parcel Number valid as of July 1st for the Fiscal Year for which the Special Tax is being levied.

“Property Owner’s Association Property” means all Parcels which have been conveyed, dedicated to, or irrevocably offered for dedication to a home-owner’s association, condominium owner’s association or any master or sub-association, prior to April 1st preceding the Fiscal Year in which the Special Tax is being levied.

“Proportionately” means for each Parcel of Taxable Property that are Developed Property, Approved Property, Taxable Property Owner’s Association Property, Taxable Public Property or Undeveloped Property, that the ratio of the actual Special Tax levy to Maximum Special Tax is the same for all Parcels assigned within each Development Class.

“Public Property” means all Parcels which, as of April 1st preceding the Fiscal Year in which the Special Tax is being levied, are (i) used for rights-of-way or any other purpose and is owned by, dedicated to, or irrevocably offered for dedication to the federal government, the State, the County, City or any other public agency, provided, however, that any property leased by a public agency to a private entity and subject to taxation under Section 53340.1 of the Act shall be taxed and classified according to its use; or (ii) encumbered by an unmanned utility easement making impractical its utilization for other than the purpose set forth in the easement.

“Residential Property” means all Parcels of Developed Property for which a Building Permit(s) has been issued permitting the construction of one or more residential Dwelling Units.

“Single Family Residential Property” means all Parcels of Residential Property, other than Multi-family Residential Property.

“Special Tax(es)” means the special tax to be levied in each Fiscal Year on each Parcel of Taxable Property in accordance with Section D. to fund the Special Tax Requirement.

“Special Tax Requirement(s)” means that amount required in any Fiscal Year to: (i) pay the estimated cost of Special Tax Services such Fiscal Year as determined by the County; (ii) fund the Special Tax Reserve Fund to the extent that the inclusion of such amount does not increase the Special Tax for Undeveloped Property unless requested by the developer or the amount needed to fund the Special Tax Reserve Fund up to the Special Tax Reserve Fund Requirement; (iii) pay Administrative Expenses; (iv) pay any

anticipated Special Tax delinquencies based on actual delinquencies from the prior Fiscal Year outstanding at the time the annual Special Tax levy is determined; and (v) less a credit for funds available to reduce the annual Special Tax levy at the sole discretion of the Administrator.

“Special Tax Reserve Fund Requirement” means an amount up to 150% of the anticipated annual cost of Special Tax Services of \$235,352. The Special Tax Reserve Fund Requirement shall be increased annually, commencing July 1, 2026, by the amount equal to the greater of two percent (2%) or up to the percentage increase in the Consumer Price Index of the corresponding Maximum Special Tax in effect in the previous Fiscal Year at the sole discretion of the Administrator.

“Special Tax Services” means services permitted under the Mello-Roos Community Facilities Act of 1982 including, without limitation, those services authorized to be funded by CFD 19-1M as set forth in the documents adopted by the Board at the time the CFD was formed.

“State” means the State of California.

“Taxable Property” means all Parcels within the boundary of the CFD pursuant to the Boundary Map which are not exempt from the Special Tax pursuant to Section E., below.

“Taxable Property Owner’s Association Property” means all Parcels of Property Owner’s Association Property that satisfies both of the following conditions: (i) based on reference to the maps used during the formation of the district, the Parcel was not anticipated to be Property Owner’s Association Property, as determined by the Administrator, and (ii) if the Parcel were to be exempt from the Special Tax because it is Property Owner’s Association Property, the County has determined that there would be a reduction in Special Tax revenues that would create a deficit in funding the Special Tax Requirement.

“Taxable Public Property” means all Parcels of Public Property that satisfies both of the following conditions: (i) based on reference to the maps used during the formation of the district, the Parcel was not anticipated to be Public Property, as determined by the Administrator, and (ii) if the Parcel were to be exempt from the Special Tax because it is Public Property, the County has determined that there would be a reduction in Special Tax revenues that would create a deficit in funding the Special Tax Requirement.

“Taxable Unit” means either a Dwelling Unit(s) or an Acre.

“Undeveloped Property” means all Parcels of Taxable Property not classified as Developed Property, Approved Property, Taxable Property Owner’s Association Property or Taxable Public Property.

B. ASSIGNMENT TO DEVELOPMENT CLASS

Each Fiscal Year, commencing with Fiscal Year 2025-2026, all Parcels of Taxable Property shall be classified as either Developed Property, Approved Property, Taxable Property Owner’s Association Property, Taxable Public Property, or Undeveloped Property, and subject to the levy of Special Taxes in accordance with this Amended and Restated Rate and Method of Apportionment as determined pursuant to Sections C. and D., below.

Parcels of Developed Property shall further be classified as Residential Property or Non-Residential Property. Parcels of Residential Property shall further be classified as Single Family Residential Property or Multi-family Residential Property.

C. MAXIMUM SPECIAL TAX

1. Developed Property

The Maximum Special Tax that may be levied and escalated, as explained further in Section C.1. (a) below, in each Fiscal Year for each Parcel classified as Developed Property shall be determined by reference to Table 1 below.

**TABLE 1
MAXIMUM SPECIAL TAX RATES
DEVELOPED PROPERTY
FOR FISCAL YEAR 2025-2026**

Development Class	Taxable Unit	Maximum Special Tax
Single Family Residential Property	DU	\$806
Multi-family Residential Property	Acre	\$4,044
Non-Residential Property	Acre	\$4,044

(a) Increase in the Maximum Special Tax

On each July 1, the Maximum Special Tax identified in Table 1 above, shall be increased annually, commencing July 1, 2026, by the amount equal to the greater of two percent (2%) or up to the percentage increase in the Consumer Price Index of the corresponding Maximum Special Tax in effect in the previous Fiscal Year at the sole discretion of the Administrator.

(b) Multiple Land Use Classes

In some instances, a Parcel of Developed Property may contain more than one Development Class. The Maximum Special Tax that may be levied on such Parcel shall be the sum of the Maximum Special Tax that can be levied for each Development Class located on that Parcel. For a Parcel that contains two or more different Development Classes or the Acreage of such Parcel shall be allocated to each type of property based on the amount of Acreage designated for each land use as determined by reference to the site plan approved for such Parcel. The Administrator's allocation to each Development Class shall be final.

Once a Maximum Special Tax has been assigned to a Parcel of Developed Property, the Maximum Special Tax shall not be reduced in future Fiscal Years regardless of changes in Development Class, Square Footage, or Acreage, unless a reduction in the Maximum Special Tax is approved by the Board for the entire CFD.

(c) Accessory Dwelling Unit(s)

Where an Accessory Dwelling Unit(s) is on the same Assessor Parcel Number as another Taxable Unit, the Accessory Dwelling Unit(s) is not considered a separate Taxable Unit and will not be added to the calculation of the Maximum Special Tax for a Parcel.

2. Approved Property

The Maximum Special Tax for each Parcel of Approved Property shall be equal to the product of the applicable Undeveloped Property Maximum Special Tax per Acre times the Acreage of such Parcel; provided, however, for a Parcel of Approved Property that is expected to become Single Family Residential Property as reasonably determined by the Administrator based on the Final Map for such Parcel, the Maximum Special Tax for such Parcel of Approved Property shall be calculated pursuant to Section C.1., as if such Parcel were already designated as Developed Property and classified as Single Family Residential Property.

The Maximum Special Tax for Approved Property shall be increased annually, commencing July 1, 2026, by the amount equal to the greater of two percent (2%) or up to the percentage increase in the Consumer Price Index of the corresponding Maximum Special Tax in effect in the previous Fiscal Year at the sole discretion of the Administrator.

3. Taxable Property Owner's Association Property and Taxable Public Property

The Maximum Special Tax for each Parcel of Taxable Property Owner's Association Property or Taxable Public Property shall be equal to the product of the applicable Undeveloped Property Maximum Special Tax per Acre times the Acreage of such Parcel.

The Maximum Special Tax for Taxable Property Owner's Association Property and Taxable Public Property shall be increased annually, commencing July 1, 2026, by the amount equal to the greater of two percent (2%) or up to the percentage increase in the Consumer Price Index of the corresponding Maximum Special Tax in effect in the previous Fiscal Year at the sole discretion of the Administrator.

4. Undeveloped Property

The Maximum Special Tax that may be levied and escalated for each Parcel classified as Undeveloped Property for each Parcel shall be \$4,044 per Acre.

The Maximum Special Tax for Undeveloped Property shall be increased annually, commencing July 1, 2026, by the amount equal to the greater of two percent (2%) or up to the percentage increase in the Consumer Price Index of the corresponding Maximum Special Tax in effect in the previous Fiscal Year at the sole discretion of the Administrator.

5. Public Property and/or Property Owners Association Property

The Maximum Special Tax that may be levied and escalated for each Parcel classified as Property Owner's Association Property and/or Public Property shall be \$0.00 per Acre. There shall be no levy on Property Owner's Association Property and/or Public Property.

D. METHOD OF APPORTIONMENT OF THE SPECIAL TAX

Commencing with Fiscal Year 2025-2026 and for each following Fiscal Year, the Administrator shall levy the Special Tax in each Improvement Area on all Taxable Property until the amount of Special Tax equals the Special Tax Requirement for each Improvement Area in accordance with the following steps:

First: The Special Tax shall be levied Proportionately on each Parcel of Developed Property at up to 100% of the applicable Maximum Special Tax as needed to satisfy the Special Tax Requirement;

Second: If additional moneys are needed to satisfy the Special Tax Requirement after the first step has been completed, the Special Tax shall be levied Proportionately on each Parcel of Approved Property at up to 100% of the Maximum Special Tax for Approved Property.

Third: If additional moneys are needed to satisfy the Special Tax Requirement after the first two steps have been completed, the Special Tax shall be levied Proportionately on each Parcel of Taxable Property Owner's Associations Property up to 100% of the applicable Maximum Special Tax for Taxable Property Owner's Association.

Fourth: If additional moneys are needed to satisfy the Special Tax requirement after the first three steps have been completed, the Special Tax shall be levied Proportionately on each Parcel of Taxable Public Property at up to 100% of the applicable Maximum Special Tax for Taxable Public Property.

Fifth: If additional moneys are needed to satisfy the Special Tax Requirement after the first four steps have been completed, the Special Tax shall be levied Proportionately on each Parcel of Undeveloped Property at up to 100% of the applicable Maximum Special Tax for Undeveloped Property.

Notwithstanding the above, under no circumstances will the Special Taxes levied in any Fiscal Year against any Parcel of Residential Property for which a Certificate of Occupancy has been issued be increased by more than ten percent (10%) as a result of a delinquency in the payment of the Special Tax applicable to any other Parcel above the amount that would have been levied in that Fiscal Year had there never been any such delinquency or default of the CFD.

E. EXEMPTIONS

The CFD shall not levy Special Taxes on Property Owner's Association Property (except Taxable Property Owner's Association Property) or Public Property (except Taxable Public Property) within the CFD.

F. MANNER OF COLLECTION

The Special Tax shall be collected in the same manner and at the same time as ordinary ad valorem property taxes and shall be subject to the same penalties, the same procedure, sale and lien priority in the case of delinquency; provided, however, that the Administrator may directly bill the Special Tax, may collect Special Taxes at a different time or in a different manner if necessary to meet the financial obligations of the CFD, and provided further that the CFD may covenant to foreclose and may actually foreclose on Parcels having delinquent Special Taxes as permitted by the Act.

G. APPEALS

Any taxpayer may file a written appeal of the Special Tax on his/her Parcel(s) with the Administrator, provided that the appellant is current in his/her payments of Special Taxes. During pendency of an appeal, all Special Taxes must be paid on or before the payment due date established when the levy was

made. The appeal must specify the reasons why the appellant claims the Special Tax is in error. The Administrator shall review the appeal, meet with the appellant if the Administrator deems necessary, and advise the appellant of its determination. If the Administrator agrees with the appellant, the Administrator shall grant a credit to eliminate or reduce future Special Taxes on the appellant's Parcel(s). No refunds of previously paid Special Taxes shall be made.

The Administrator shall interpret this Amended and Restated Rate and Method of Apportionment and make determinations relative to the annual levy and administration of the Special Tax and any taxpayer who appeals, as herein specified.

H. PREPAYMENT OF SPECIAL TAX

The Special Tax may not be prepaid.

I. TERM OF THE SPECIAL TAX

The Special Tax shall be levied annually in perpetuity unless terminated earlier by the County.

EXHIBIT A

SERVICES AND INCIDENTAL EXPENSES

Services

The types of services to be finance by the Community Facilities District are:

- i. Maintenance of landscape improvements in the public right of way to include replacement and repair of irrigation system, fencing, graffiti abatement of a retaining wall; and
- ii. Street and pedestal lighting energy charges, maintenance, repair and replacement of lighting located within the designated boundaries of the CFD; and
- iii. Traffic signal maintenance, including energy charges, operation, maintenance, and administrative costs of traffic signals within the boundaries of the CFD; and
- iv. Administration, inspection, and maintenance of all stormwater facilities and BMPs to include: water quality basins, fossil filters, basin forebays, and all other NPDES/WQMP/BMP related devices and structures as approved and accepted by the Community Facilities District; administration includes, but is not limited to, quality control and assurance of inspections and maintenance, general contract management, scheduling of inspections and maintenance, and general oversight of all NPDES/WQMP/BMP operations; inspection includes, but is not limited to, travel time, visual inspection process and procedures for functionality, GPS location recording, assurance of proper vegetation, functioning irrigation, and citing operational or structural deficiencies, erosion, trash, silt and sediment build-up; and maintenance includes, but is not limited to, repair or replacement of any deficiencies noted during inspection, weed control and abatement, trash removal, and healthy upkeep of required plant materials.

Incidental Expenses

The incidental expenses proposed to be incurred include the following:

- i. The cost associated with the creation of the Community Facilities District, determination of the amount of taxes, collection of taxes, including litigation expenses, if any, costs for processing payment of taxes, or other administrative costs otherwise incurred in order to carry out the authorized purposes of the Community Facilities District; and
- ii. Any other expenses incidental to the performance and inspection of the authorized Services.

PETITION, WAIVER AND CONSENT

Date: 5/14/25

Board of Supervisors of the
County of Riverside
4080 Lemon Street
Riverside, California 92506

Members of the Board:

This Petition, Waiver and Consent ("**Petition**") is (i) a petition submitted pursuant to the Mello-Roos Community Facilities Act of 1982 (Section 53311 and following of the California Government Code) (the "**Act**") to amend community facilities district No 19-1M (La Ventana) to fund certain maintenance and services, and (ii) a waiver and consent of certain election formalities and procedures.

1. Petitioners. This Petition is submitted pursuant to the Act to the County of Riverside (the "**County**") by the undersigned owner (the "**Property Owner**") of 100% of the fee simple interest in the following parcels of land identified by Assessor Parcel Numbers (the "**Property**"):

See AP list attached				

The Property is further shown on the map attached hereto as Exhibit B. The Property Owner warrants to the County with respect to the Property that the signatories are authorized to execute this Petition.

2. Request to change Proceedings. The Board of Supervisors is hereby requested to do all of the following:

- a. Pursuant to the Act, the Property owner requests the Board of Supervisors to amend a community facilities district to be designated "Community Facilities District No. 19-1M (La Ventana) of the County of Riverside" (the "CFD"), which CFD shall include only the Property; and
- b. Conduct a landowner-voter election in accordance with the Act to obtain authorization to levy a special tax within the CFD.

3. Boundaries of CFD. The Property Owner hereby asks that the territory within the boundaries of the CFD be as shown on the map attached hereto as Exhibit B.

4. Purpose of CFD. The CFD shall be amended for the purpose to fund the costs associated with the undersigned requests that the community facilities district provide any services that are permitted under the Act including, but not limited to, all necessary service, operations, administration and maintenance required to keep the landscape, lighting, street lighting, traffic signals, park maintenance, NPDES/WQMP/BMP flood control facilities, ground cover, shrubs, plants and trees, irrigation systems, graffiti abatement, masonry walls, fencing, and entry monuments.

5. Elections. The Property Owner hereby asks that the special election to be held under the Act to authorize the special taxes and to establish an appropriations limit for the CFD be consolidated into a single election and that the election be conducted by the County and its officials, using mailed or hand-delivered ballots, and that such ballots be opened and canvassed and the results certified at the same meeting of the Board of Supervisors as the public hearings on the CFD under the Act or as soon thereafter as possible.

6. Waivers. To expedite the completion of the proceedings for the CFD and to hold the elections on the date described in paragraph 5 above, the Property Owner makes all of the following waivers:

- The Property Owner hereby waives any and all minimum time periods relative to the election pursuant to Government Code Section 53326(a).
- The Property Owner hereby waives the preparation and distribution of an impartial analysis of the ballot measure, as well as arguments in favor and against, under the authority of Government Code Section 53327(b).
- The Property Owner hereby waives the requirement to publish notice of the election under Government Code Section 53352.
- The Property Owner hereby waives the requirements regarding the time to mail ballots to the qualified electors under Elections Code Section 4101 and agrees that either mailed service or personal service of the ballot will be sufficient.
- The Property Owner hereby waives any requirement as to the specific form of the ballot to be used for the election, whether under the Act, the California Elections Code or otherwise
- The Property Owner hereby waives the requirements regarding identification envelopes for the return of mailed ballots contained in Government Code Section 53327.5.

7. Deposits. Compliance with the provisions of subsection (d) of Section 53318 of the Act has been accomplished previous deposit of funds by the Property Owner with the County.

By executing this Petition, the Property Owner agrees to all of the above.

The name of the owner of record of such property and the petitioner and its mailing address is:

D.R. Horton Los Angeles Holding Company, Inc.
a California corporation

By: 

Name: Jennifer O'Leary

Title: Vice President of Forward Planning

Mailing Address:

980 Montecito Drive, Suite 300
Corona, CA 92879

Tract No. 31100

<u>APNs</u>	<u>APNs</u>	<u>APNs</u>	<u>APNs</u>	<u>APNs</u>	<u>APNs</u>
461-450-001	461-451-031	461-460-007	461-470-009	461-471-024	461-472-002
461-450-002	461-451-032	461-460-008	461-470-010	461-471-025	461-472-003
461-450-003	461-451-033	461-460-009	461-470-011	461-471-026	461-472-004
461-450-004	461-451-034	461-460-010	461-470-012	461-471-027	461-472-005
461-450-005	461-451-035	461-460-011	461-470-013	461-471-028	461-472-006
461-450-006	461-451-036	461-460-012	461-470-014	461-471-029	461-472-007
461-450-007	461-451-037	461-460-013	461-470-015	461-471-030	461-472-008
461-450-008	461-451-038	461-460-014	461-470-016	461-471-031	461-472-009
461-450-009	461-451-039	461-460-015	461-470-017	461-471-032	461-472-010
461-450-010	461-451-040	461-460-016	461-470-018	461-471-033	461-480-001
461-450-011	461-451-041	461-460-017	461-470-019	461-471-034	461-480-002
461-450-012	461-451-042	461-460-018	461-470-020	461-471-035	461-480-003
461-450-013	461-451-043	461-460-019	461-470-021	461-471-036	461-480-004
461-451-001	461-451-044	461-460-020	461-470-022	461-471-037	461-480-005
461-451-002	461-451-045	461-461-001	461-470-023	461-471-038	461-481-001
461-451-003	461-451-046	461-461-002	461-470-024	461-471-039	461-481-002
461-451-004	461-451-047	461-461-003	461-470-025	461-471-040	461-481-003
461-451-005	461-451-048	461-461-004	461-470-026	461-471-041	461-482-001
461-451-006	461-452-001	461-461-005	461-470-027	461-471-042	
461-451-007	461-452-002	461-461-006	461-471-001	461-471-043	
461-451-008	461-452-003	461-461-007	461-471-002	461-471-044	
461-451-009	461-452-004	461-461-008	461-471-003	461-471-045	
461-451-010	461-452-005	461-461-009	461-471-004	461-471-046	
461-451-011	461-452-006	461-461-010	461-471-005	461-471-047	
461-451-012	461-452-007	461-461-011	461-471-006	461-471-048	
461-451-013	461-452-008	461-461-012	461-471-007	461-471-049	
461-451-014	461-452-009	461-461-013	461-471-008	461-471-050	
461-451-015	461-452-010	461-461-014	461-471-009	461-471-051	
461-451-016	461-452-011	461-461-015	461-471-010	461-471-052	
461-451-017	461-452-012	461-461-016	461-471-011	461-471-053	
461-451-018	461-452-013	461-461-017	461-471-012	461-471-054	
461-451-019	461-452-014	461-461-018	461-471-013	461-471-055	
461-451-020	461-452-015	461-461-019	461-471-014	461-471-056	
461-451-021	461-452-016	461-461-020	461-471-015	461-471-057	
461-451-022	461-452-017	461-461-021	461-471-016	461-471-058	
461-451-023	461-452-018	461-470-001	461-471-017	461-471-059	
461-451-024	461-452-019	461-470-002	461-471-018	461-471-060	
461-451-025	461-460-001	461-470-003	461-471-019	461-471-061	
461-451-026	461-460-002	461-470-004	461-471-020	461-471-062	
461-451-027	461-460-003	461-470-005	461-471-021	461-471-063	
461-451-028	461-460-004	461-470-006	461-471-022	461-471-064	
461-451-029	461-460-005	461-470-007	461-471-023	461-472-001	
461-451-030	461-460-006	461-470-008	461-471-024	461-472-002	

Tract No. 38586

APN

461-482-002

EXHIBIT A

SERVICES AND INCIDENTAL EXPENSES

Services

The types of services to be finance by the Community Facilities District are:

- i. Maintenance of landscape improvements in the public right of way to include replacement and repair of irrigation system, fencing, graffiti abatement of a retaining wall; and
- ii. Street and pedestal lighting energy charges, maintenance, repair and replacement of lighting located within the designated boundaries of the CFD; and
- iii. Traffic signal maintenance, including energy charges, operation, maintenance, and administrative costs of traffic signals within the boundaries of the CFD; and
- iv. Administration, inspection, and maintenance of all stormwater facilities and BMPs to include: water quality basins, fossil filters, basin forebays, and all other NPDES/WQMP/BMP related devices and structures as approved and accepted by the Community Facilities District; administration includes, but is not limited to, quality control and assurance of inspections and maintenance, general contract management, scheduling of inspections and maintenance, and general oversight of all NPDES/WQMP/BMP operations; inspection includes, but is not limited to, travel time, visual inspection process and procedures for functionality, GPS location recording, assurance of proper vegetation, functioning irrigation, and citing operational or structural deficiencies, erosion, trash, silt and sediment build-up; and maintenance includes, but is not limited to, repair or replacement of any deficiencies noted during inspection, weed control and abatement, trash removal, and healthy upkeep of required plant materials.

Incidental Expenses

The incidental expenses proposed to be incurred include the following:

- i. The cost associated with the creation of the Community Facilities District, determination of the amount of taxes, collection of taxes, including litigation expenses, if any, costs for processing payment of taxes, or other administrative costs otherwise incurred in order to carry out the authorized purposes of the Community Facilities District; and
- ii. Any other expenses incidental to the performance and inspection of the authorized Services.

copy 83/87

PROPOSED BOUNDARY COMMUNITY FACILITIES DISTRICT 19-1M (LA VENTANA) COUNTY OF RIVERSIDE, STATE OF CALIFORNIA SEC. 30 T. 5S., R. 2W

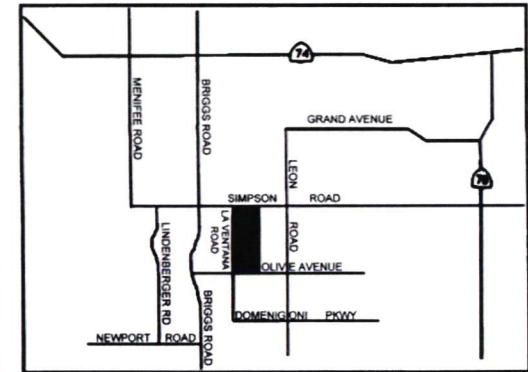
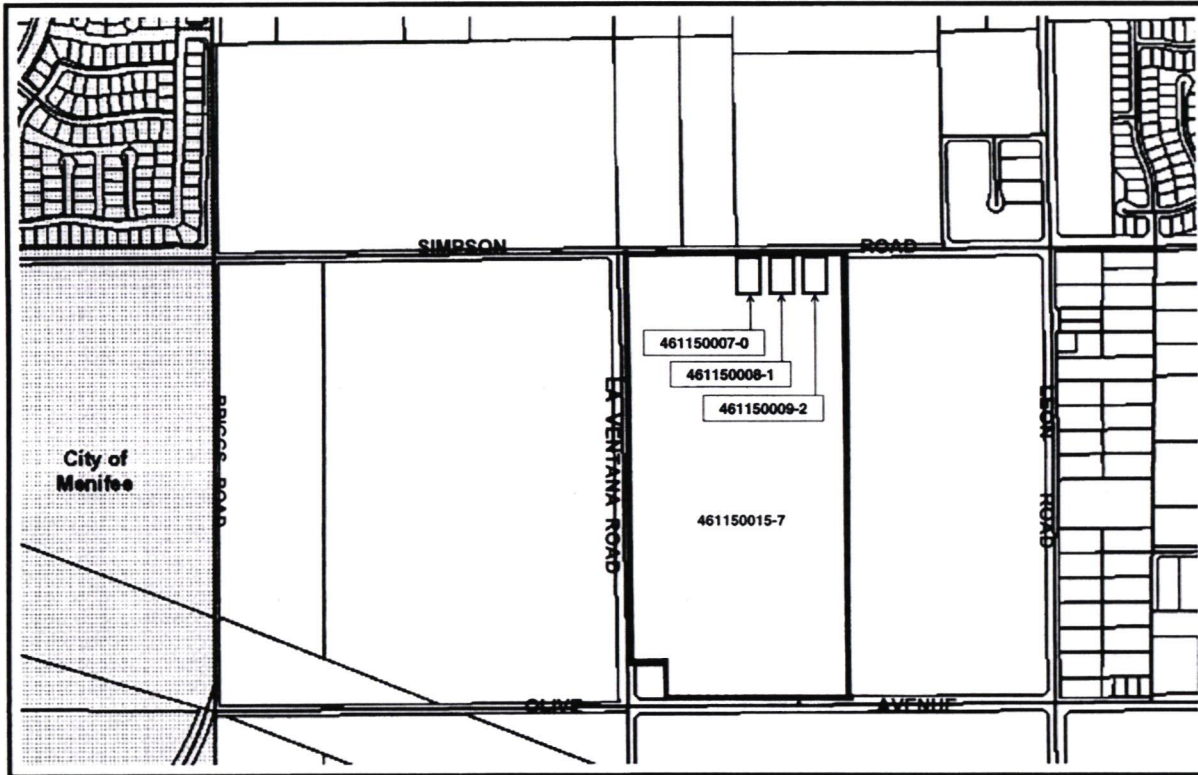

VICINITY MAP

Proposed Boundary

ASSESSOR PARCEL NUMBERS LOCATED
WITHIN PROPOSED BOUNDARIES OF
CFD 19-1M (LA VENTANA) AS OF
FISCAL YEAR 2018-2019:

- 461150007-0
- 461150008-1
- 461150009-2
- 461150015-7

FILED IN THE OFFICE OF THE COUNTY CLERK OF RIVERSIDE,
STATE OF CALIFORNIA THIS 7th DAY OF May 2019.

Donna Williams, Deputy
CLERK OF THE BOARD OF SUPERVISORS
COUNTY OF RIVERSIDE

I HEREBY CERTIFY THAT THE WITHIN MAP SHOWING THE PROPOSED
BOUNDARIES OF COMMUNITY FACILITIES DISTRICT 19-1M (LA
VENTANA) OF THE COUNTY OF RIVERSIDE, STATE OF CALIFORNIA, WAS
APPROVED BY THE BOARD OF SUPERVISORS AT A REGULAR MEETING
THEREOF, HELD ON THE 7th DAY OF May 2019, BY ITS
RESOLUTION NO. 2019-070

Donna Williams, Deputy
CLERK OF THE BOARD OF SUPERVISORS
COUNTY OF RIVERSIDE

RECORDED THIS 16th DAY OF May 2019.

AT THE HOUR OF 10:53 O'CLOCK A. M IN BOOK 83 OF MAPS OF
ASSESSMENT AND COMMUNITY FACILITIES DISTRICTS AT PAGE 87
IN THE OFFICE OF THE COUNTY RECORDER IN THE COUNTY OF
RIVERSIDE, STATE OF CALIFORNIA
FEE \$9.00 DOCUMENT NO. 2019-0171364

PETER ALDANA, RIVERSIDE COUNTY ASSESSOR-CLERK-RECORDER

DEPUTY *Alphia Perry*

REFERENCE IS HEREBY MADE TO THE ASSESSOR
MAPS OF THE COUNTY OF RIVERSIDE, FOR FISCAL
YEAR 2018-2019, FOR AN EXACT DESCRIPTION OF
THE LINES AND DIMENSIONS OF EACH LOT/PARCEL.

Prepared By:
COUNTY OF RIVERSIDE
EDA, CCSD
3403 Tenth Street, Ste. 400 Riverside, CA 92501
951-955-8916 Phone



RIVERSIDE COUNTY
OFFICE OF ECONOMIC DEVELOPMENT

COMMUNITY FACILITIES DISTRICT NO. 19-1M
(LA VENTANA)
OF THE COUNTY OF RIVERSIDE, STATE OF CALIFORNIA

Consolidated Special Elections with Respect to
Authorizing the Levy of a Special Tax,
and Establishing an Appropriations Limit for said District

July 29, 2025

Ballot Pamphlet and Instructions to Voter

Dear Voter:

The Board of Supervisors of the County of Riverside, acting as the legislative body of Community Facilities District No. 19-1M (La Ventana) of the County of Riverside, State of California (the "District"), has called a consolidated special election for the District on July 29, 2025. This is an all-mailed ballot landowner-voter election. The ballots are being mailed to the persons or entities listed on the Riverside County Assessor's latest equalized assessment roll as owners of the property in the District or based on more current ownership information available to the Election Official.

The ballots will be distributed based on the names and addresses designated on the assessment roll or obtained from such other information. Any parcels with a common name and address were combined for voting purposes. Each qualified voter has been issued one ballot which entitles that voter to vote his, her or its total acreage of land. Each ballot is allotted a specified number of votes depending on acreage. Each acre or portion of an acre is worth one vote.

Please note that your voted ballot must be received by the Director of Office of Economic Development of the County of Riverside (the "Election Official") not later than 9:00 a.m. on July 29, 2025. A POSTMARK DATE IS NOT ACCEPTABLE. You must use the enclosed envelope for returning your ballot to the office of the Director of Office of Economic Development, County of Riverside, Attn: Michael Franklin, at 3403 10th Street, Suite 400, Riverside, California 92501.

Contained in this Ballot Pamphlet and Instructions to Voter are Instructions to Landowner Voter, a Sample Ballot, and a copy of Resolution No. 2025-127 of the Board of Supervisors of the County of Riverside which contains as Exhibit "B" the Rate and Method of Apportionment of Special Tax for the District which is referenced in Proposition A on the official ballot for the special elections.

If you have any questions, please contact the Special Districts Administrator, Spicer Consulting Group, 41880 Kalmia St., Suite 145, Murrieta, CA at telephone number (866) 504-2067.

Best regards,

SUZANNE HOLLAND
DIRECTOR OF OFFICE OF
ECONOMIC DEVELOPMENT
COUNTY OF RIVERSIDE
ELECTION OFFICIAL

INSTRUCTIONS TO LANDOWNER VOTER

Name & Address of Property Owner:	Assessor's Parcel Number(s):
D.R. Horton Los Angeles Holdings Company Inc Attn: Ryan LaVigne 2280 Wardlow Circle, Ste. 100 Corona, CA, 92878	See Attached

HOW TO VOTE YOUR BALLOT

Vote your official ballot by placing a cross (+) in the voting square opposite your choice with a pen or pencil and by completing, dating and signing the Certificate of Authorization attached thereto.

SPOILING YOUR BALLOT

If you tear your ballot or make an error in voting you may secure another by surrendering the ballot you spoiled, in person or by mail at the address below, or by executing an affidavit to the effect that you lost your ballot, and you will be given another ballot.

RETURNING YOUR BALLOT

Enclose your ballot and the Certificate of Authorization in the Identification Envelope provided. Supply ALL information requested on the Identification Envelope. YOUR VOTE WILL BE DISQUALIFIED IF YOU DO NOT FILL IN ALL THE INFORMATION.

LAST DAY TO RETURN TO THE ELECTION OFFICIAL

Your ballot and Certificate of Authorization must be returned to the office of the Election Official-Director of Office of Economic Development of the County of Riverside **not later than 9:00 a.m. on July 29, 2025**, for it to be counted. YOUR BALLOT CANNOT BE ACCEPTED BEYOND THIS DEADLINE.

Your ballot and Certificate of Authorization must be mailed in the envelope provided for this purpose, or it may be delivered in the envelope to the Election Official-Director of Office of Economic Development, Attn: Michael Franklin at 3403 10th Street, Suite 400, Riverside, California 92501.

SAMPLE BALLOT - DO NOT VOTE

OFFICIAL BALLOT

SPECIAL ELECTION FOR
COMMUNITY FACILITIES DISTRICT NO. 19-1M
(LA VENTANA)
OF THE COUNTY OF RIVERSIDE, STATE OF CALIFORNIA

July 19, 2025

This Ballot has been assigned 59 votes based on acreage owned by the qualified elector.

To vote, mark a cross (+) in the voting square after the word "YES" or after the word "NO."
All marks otherwise made are forbidden.

If you wrongly mark, tear, or deface this ballot, return it to the Election Official, Director of Office of Economic Development of the County of Riverside and obtain another.

PROPOSITION A: Shall special taxes be levied annually on taxable property at the rates and apportioned as set forth in the following table:

Development Class	Taxable Unit	Maximum Special Tax
Single Family Residential Property	DU	\$806

YES	
NO	

plus an annual increase on each July 1, the Maximum Special Tax shall be increased annually, commencing July 1, 2026, by the amount equal to the greater of two percent (2%) or up to the percentage increase in the Consumer Price Index (All Items) for Riverside – San Bernardino - Ontario to finance certain services within Community Facilities District No. 19-1M (La Ventana) of the County of Riverside to fund, pay for, and finance maintenance of certain services (as specified and reflected in the Resolution of Intention, the Resolution of Formation, and the Rate and Method of Apportionment of Special Tax) and to pay expenses incidental thereto and incidental to the levy and collection of the special taxes, so long as the special taxes are needed to fund such services, at the special tax rates and pursuant to the method of apportioning the special taxes set forth in Exhibit B to Resolution No. 2025-127 adopted by the Board of Supervisors of said County on June 10, 2025?

PROPOSITION B: For each year commencing fiscal year 2025-2026 shall an appropriations limit, as defined by subdivision (h) of Section 8 of Article XIII B of the California Constitution, be established for Community Facilities District No. 19-1M (La Ventana) of the County of Riverside in the amount of \$4,000,000?

YES	
NO	

APNs:

461-450-001	461-451-020	461-452-004	461-460-017	461-470-008	461-471-013	461-471-045	461-480-003
461-450-002	461-451-021	461-452-005	461-460-018	461-470-009	461-471-014	461-471-046	461-480-004
461-450-003	461-451-022	461-452-006	461-460-019	461-470-010	461-471-015	461-471-047	461-480-005
461-450-004	461-451-023	461-452-007	461-460-020	461-470-011	461-471-016	461-471-048	461-481-001
461-450-005	461-451-024	461-452-008	461-461-001	461-470-012	461-471-017	461-471-049	461-481-002
461-450-006	461-451-025	461-452-009	461-461-002	461-470-013	461-471-018	461-471-050	461-481-003
461-450-007	461-451-026	461-452-010	461-461-003	461-470-014	461-471-019	461-471-051	461-482-001
461-450-008	461-451-027	461-452-011	461-461-004	461-470-015	461-471-020	461-471-052	461-482-002
461-450-009	461-451-028	461-452-012	461-461-005	461-470-016	461-471-021	461-471-053	
461-450-010	461-451-029	461-452-013	461-461-006	461-470-017	461-471-022	461-471-054	
461-450-011	461-451-030	461-452-014	461-461-007	461-470-018	461-471-023	461-471-055	
461-450-012	461-451-031	461-452-015	461-461-008	461-470-019	461-471-024	461-471-056	
461-450-013	461-451-032	461-452-016	461-461-009	461-470-020	461-471-025	461-471-057	
461-451-001	461-451-033	461-452-017	461-461-010	461-470-021	461-471-026	461-471-058	
461-451-002	461-451-034	461-452-018	461-461-011	461-470-022	461-471-027	461-471-059	
461-451-003	461-451-035	461-452-019	461-461-012	461-470-023	461-471-028	461-471-060	
461-451-004	461-451-036	461-460-001	461-461-013	461-470-024	461-471-029	461-471-061	
461-451-005	461-451-037	461-460-002	461-461-014	461-470-025	461-471-030	461-471-062	
461-451-006	461-451-038	461-460-003	461-461-015	461-470-026	461-471-031	461-471-063	
461-451-007	461-451-039	461-460-004	461-461-016	461-470-027	461-471-032	461-471-064	
461-451-008	461-451-040	461-460-005	461-461-017	461-471-001	461-471-033	461-472-001	
461-451-009	461-451-041	461-460-006	461-461-018	461-471-002	461-471-034	461-472-002	
461-451-010	461-451-042	461-460-007	461-461-019	461-471-003	461-471-035	461-472-003	
461-451-011	461-451-043	461-460-008	461-461-020	461-471-004	461-471-036	461-472-004	
461-451-012	461-451-044	461-460-009	461-461-021	461-471-005	461-471-037	461-472-005	
461-451-013	461-451-045	461-460-010	461-470-001	461-471-006	461-471-038	461-472-006	
461-451-014	461-451-046	461-460-011	461-470-002	461-471-007	461-471-039	461-472-007	
461-451-015	461-451-047	461-460-012	461-470-003	461-471-008	461-471-040	461-472-008	
461-451-016	461-451-048	461-460-013	461-470-004	461-471-009	461-471-041	461-472-009	
461-451-017	461-452-001	461-460-014	461-470-005	461-471-010	461-471-042	461-472-010	
461-451-018	461-452-002	461-460-015	461-470-006	461-471-011	461-471-043	461-480-001	
461-451-019	461-452-003	461-460-016	461-470-007	461-471-012	461-471-044	461-480-002	



July 29, 2025

To: Property Owners as indicated on Exhibit A hereto

Dear Sir or Madam:

You are hereby notified of a public hearing called by Resolution No. 2025-127 (the "Resolution") of the County of Riverside, acting with respect to Community Facilities District No. 19-1M (La Ventana) of the County of Riverside (the "District") declaring its intent to amend and levy a special tax to pay the cost of certain authorized services related to maintenance of landscaping, street and pedestal lighting, traffic signals, and drainage. The Board of Supervisors has set a date and time of the public hearing regarding such matters as follows:

Public Hearing

Date: July 29, 2025
Time: 9:30 A.M.
Place: Board Chambers of the County Administrative Center
4080 Lemon Street, 1st Floor
Riverside, California 92501-3651

This notice is being sent to you because your property is currently within the boundaries of the proposed District and may be affected by the foregoing proceedings if approved by the Board of Supervisors and if the proceedings are approved by the qualified voters within the District. Please contact the County Office of Economic Development to determine if your property is within the District and to obtain specific information concerning the proposed proceedings.

Enclosed please find a copy of the Resolution. The Resolution sets forth the matters to be heard at the hearing, the effect of protests to the proceedings regarding the rate and method of apportionment of special tax, and the procedures for the election relating thereto.

If you have any questions regarding the Resolution, the boundaries of the District, the rate and method of apportionment of special tax, the public hearing or the election process, please contact Michael Franklin, County of Riverside Office of Economic Development, 3403 Tenth Street, Ste. 400 Riverside, California 92501 or by telephone at (951) 955-6652.

Sincerely,

Michael Franklin
Development Manager
Office of Economic Development

EXHIBIT A

LIST OF OWNERS AND APNs

Tract Map Nos. 31100 & 38586

D.R. Horton Los Angeles Holdings Company Inc.

APNs:

461-450-001	461-451-020	461-452-004	461-460-017	461-470-008	461-471-013	461-471-045	461-480-003
461-450-002	461-451-021	461-452-005	461-460-018	461-470-009	461-471-014	461-471-046	461-480-004
461-450-003	461-451-022	461-452-006	461-460-019	461-470-010	461-471-015	461-471-047	461-480-005
461-450-004	461-451-023	461-452-007	461-460-020	461-470-011	461-471-016	461-471-048	461-481-001
461-450-005	461-451-024	461-452-008	461-461-001	461-470-012	461-471-017	461-471-049	461-481-002
461-450-006	461-451-025	461-452-009	461-461-002	461-470-013	461-471-018	461-471-050	461-481-003
461-450-007	461-451-026	461-452-010	461-461-003	461-470-014	461-471-019	461-471-051	461-482-001
461-450-008	461-451-027	461-452-011	461-461-004	461-470-015	461-471-020	461-471-052	
461-450-009	461-451-028	461-452-012	461-461-005	461-470-016	461-471-021	461-471-053	
461-450-010	461-451-029	461-452-013	461-461-006	461-470-017	461-471-022	461-471-054	
461-450-011	461-451-030	461-452-014	461-461-007	461-470-018	461-471-023	461-471-055	
461-450-012	461-451-031	461-452-015	461-461-008	461-470-019	461-471-024	461-471-056	
461-450-013	461-451-032	461-452-016	461-461-009	461-470-020	461-471-025	461-471-057	
461-451-001	461-451-033	461-452-017	461-461-010	461-470-021	461-471-026	461-471-058	
461-451-002	461-451-034	461-452-018	461-461-011	461-470-022	461-471-027	461-471-059	
461-451-003	461-451-035	461-452-019	461-461-012	461-470-023	461-471-028	461-471-060	
461-451-004	461-451-036	461-460-001	461-461-013	461-470-024	461-471-029	461-471-061	
461-451-005	461-451-037	461-460-002	461-461-014	461-470-025	461-471-030	461-471-062	
461-451-006	461-451-038	461-460-003	461-461-015	461-470-026	461-471-031	461-471-063	
461-451-007	461-451-039	461-460-004	461-461-016	461-470-027	461-471-032	461-471-064	
461-451-008	461-451-040	461-460-005	461-461-017	461-471-001	461-471-033	461-472-001	
461-451-009	461-451-041	461-460-006	461-461-018	461-471-002	461-471-034	461-472-002	
461-451-010	461-451-042	461-460-007	461-461-019	461-471-003	461-471-035	461-472-003	
461-451-011	461-451-043	461-460-008	461-461-020	461-471-004	461-471-036	461-472-004	
461-451-012	461-451-044	461-460-009	461-461-021	461-471-005	461-471-037	461-472-005	
461-451-013	461-451-045	461-460-010	461-470-001	461-471-006	461-471-038	461-472-006	
461-451-014	461-451-046	461-460-011	461-470-002	461-471-007	461-471-039	461-472-007	
461-451-015	461-451-047	461-460-012	461-470-003	461-471-008	461-471-040	461-472-008	
461-451-016	461-451-048	461-460-013	461-470-004	461-471-009	461-471-041	461-472-009	
461-451-017	461-452-001	461-460-014	461-470-005	461-471-010	461-471-042	461-472-010	
461-451-018	461-452-002	461-460-015	461-470-006	461-471-011	461-471-043	461-480-001	
461-451-019	461-452-003	461-460-016	461-470-007	461-471-012	461-471-044	461-480-002	

Resolution of Intention

EXHIBIT A

SERVICES AND INCIDENTAL EXPENSES

Services

The types of services to be finance by the Community Facilities District are:

- i. Maintenance of landscape improvements in the public right of way to include replacement and repair of irrigation system, fencing, graffiti abatement of a retaining wall; and
- ii. Street and pedestal lighting energy charges, maintenance, repair and replacement of lighting located within the designated boundaries of the CFD; and
- iii. Traffic signal maintenance, including energy charges, operation, maintenance, and administrative costs of traffic signals within the boundaries of the CFD; and
- iv. Administration, inspection, and maintenance of all stormwater facilities and BMPs to include: water quality basins, fossil filters, basin forebays, and all other NPDES/WQMP/BMP related devices and structures as approved and accepted by the Community Facilities District; administration includes, but is not limited to, quality control and assurance of inspections and maintenance, general contract management, scheduling of inspections and maintenance, and general oversight of all NPDES/WQMP/BMP operations; inspection includes, but is not limited to, travel time, visual inspection process and procedures for functionality, GPS location recording, assurance of proper vegetation, functioning irrigation, and citing operational or structural deficiencies, erosion, trash, silt and sediment build-up; and maintenance includes, but is not limited to, repair or replacement of any deficiencies noted during inspection, weed control and abatement, trash removal, and healthy upkeep of required plant materials.

Incidental Expenses

The incidental expenses proposed to be incurred include the following:

- i. The cost associated with the creation of the Community Facilities District, determination of the amount of taxes, collection of taxes, including litigation expenses, if any, costs for processing payment of taxes, or other administrative costs otherwise incurred in order to carry out the authorized purposes of the Community Facilities District; and
- ii. Any other expenses incidental to the performance and inspection of the authorized Services.

copy 83/87

PROPOSED BOUNDARY
COMMUNITY FACILITIES DISTRICT 19-1M (LA VENTANA)
COUNTY OF RIVERSIDE, STATE OF CALIFORNIA
SEC. 30 T. 5S., R. 2W

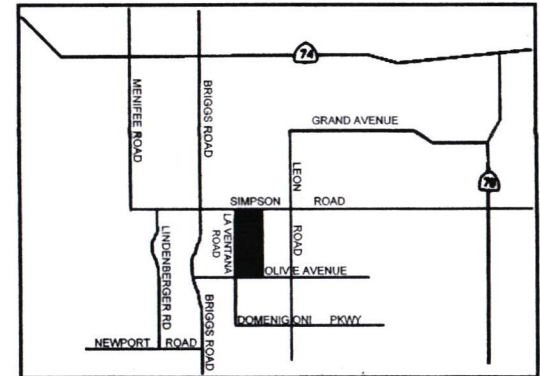
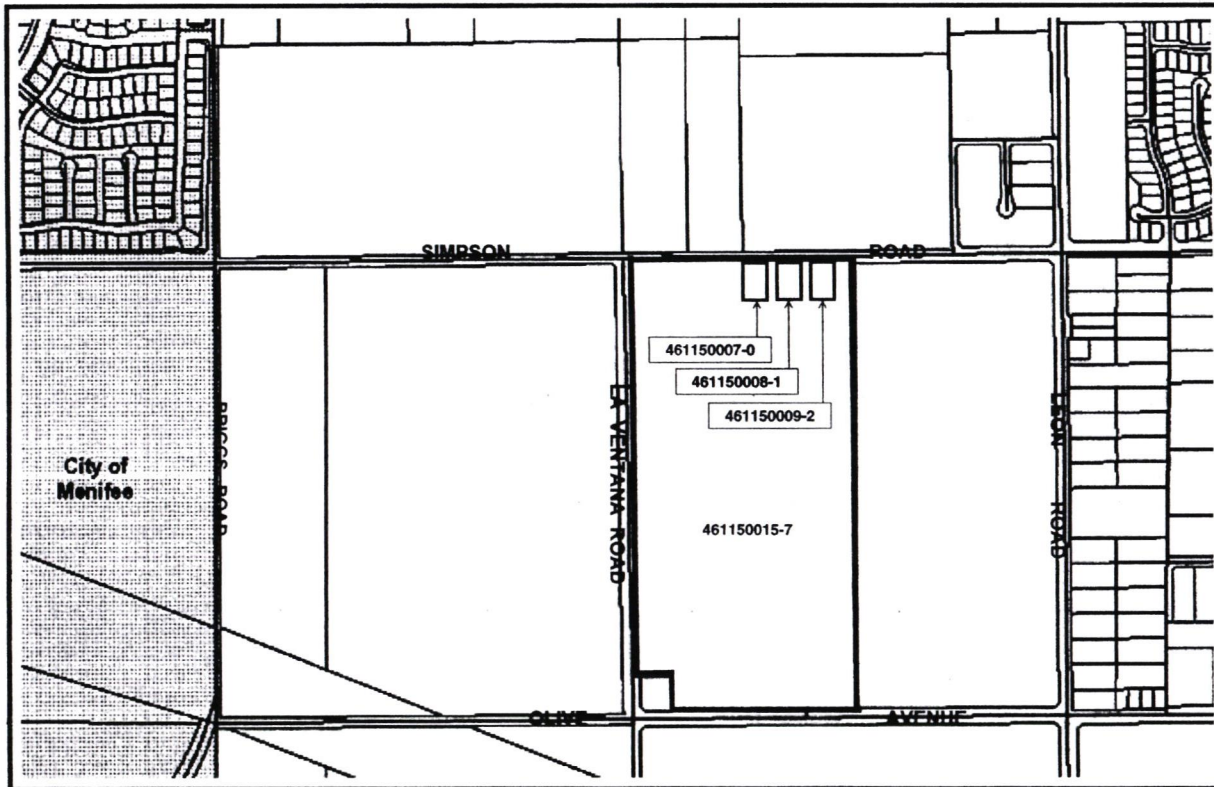

VICINITY MAP

Proposed Boundary

ASSESSOR PARCEL NUMBERS LOCATED
WITHIN PROPOSED BOUNDARIES OF
CFD 19-1M (LA VENTANA) AS OF
FISCAL YEAR 2018-2019:

- 461150007-0
- 461150008-1
- 461150009-2
- 461150015-7

FILED IN THE OFFICE OF THE COUNTY CLERK OF RIVERSIDE,
STATE OF CALIFORNIA THIS 7th DAY OF May 2019.

Dominae Williams, Deputy
CLERK OF THE BOARD OF SUPERVISORS
COUNTY OF RIVERSIDE

I HEREBY CERTIFY THAT THE WITHIN MAP SHOWING THE PROPOSED
BOUNDARIES OF COMMUNITY FACILITIES DISTRICT 19-1M (LA
VENTANA) OF THE COUNTY OF RIVERSIDE, STATE OF CALIFORNIA, WAS
APPROVED BY THE BOARD OF SUPERVISORS AT A REGULAR MEETING
THEREOF, HELD ON THE 7th DAY OF May 2019, BY ITS
RESOLUTION NO. 2019-070

Dominae Williams, Deputy
CLERK OF THE BOARD OF SUPERVISORS
COUNTY OF RIVERSIDE

RECORDED THIS 16th DAY OF May 2019.

AT THE HOUR OF 10:53 O'CLOCK A.M. IN BOOK 83 OF MAPS OF
ASSESSMENT AND COMMUNITY FACILITIES DISTRICTS AT PAGE 87
IN THE OFFICE OF THE COUNTY RECORDER IN THE COUNTY OF
RIVERSIDE, STATE OF CALIFORNIA.
FEE \$9.00 DOCUMENT NO. 2019-017364

PETER ALDANA, RIVERSIDE COUNTY ASSESSOR-CLERK-RECORDER

DEPUTY *Peter Aldana*

REFERENCE IS HEREBY MADE TO THE ASSESSOR
MAPS OF THE COUNTY OF RIVERSIDE, FOR FISCAL
YEAR 2018-2019, FOR AN EXACT DESCRIPTION OF
THE LINES AND DIMENSIONS OF EACH LOT/PARCEL.

Prepared By:
COUNTY OF RIVERSIDE
EDA, CCSD
3403 Tenth Street, Ste. 400 Riverside, CA 92501
951-955-8916 Phone

THE PRESS-ENTERPRISE

KEEP YOUR EYES ON THE 'PRISE
pe.com

3512 14 Street
Riverside, California 92501
(951) 368-9229
neller@scng.com

County of Riverside - Clerk of the Board
PO Box 1147
Riverside, California 92502

<i>Account Number:</i>	5209148
<i>Ad Order Number:</i>	0011739983
<i>Customer's Reference/PO Number:</i>	
<i>Publication:</i>	The Press-Enterprise
<i>Publication Dates:</i>	06/16/2025
<i>Total Amount:</i>	\$889.12
<i>Payment Amount:</i>	\$0.00
<i>Amount Due:</i>	\$889.12
<i>Notice ID:</i>	AQtLlqlx9Xp1oqlvU1oh
<i>Invoice Text:</i>	<p>NOTICE OF PUBLIC HEARING BEFORE THE BOARD OF SUPERVISORS OF RIVERSIDE COUNTY NOTICE IS HEREBY GIVEN that a public hearing at which all interested persons will be heard, will be held before the Board of Supervisors of Riverside County, California, on the 1st Floor Board Chambers, County Administrative Center, 4080 Lemon Street, Riverside, on June 24, 2025 at 9:30 a.m., or as soon as possible thereafter, to consider the following: SUMMARY OF RESOLUTION NO. 2025-127 A RESOLUTION OF THE BOARD OF SUPERVISORS OF THE COUNTY OF RIVERSIDE OF INTENTION TO DECLARE ITS INTENTION TO CONSIDER AMENDING THE RATE AND METHOD OF APPORTIONMENT OF SPECIAL TAXES AND SETTING A DATE AND TIME FOR A PUBLIC HEARING THEREON This summary is presented pursuant to California Government Code Section 53322. A certified copy of the full text of Resolution No. 2025-127, including a description of services and incidental expenses proposed to be financed and the proposed Amended and Restated Rate and Method of Apportionment, may be examined at the Office of the Clerk of the Board of Supervisors of the County of Riverside, located at 4080 Lemon Street, 1st Floor, Riverside, California. Resolution No. 2025-127 sets a public hearing on the Board of Supervisor's intent to consider amendment of the original Rate and Method of Apportionment of special tax for Community Facilities District No. 19-1M (La Ventana) ("District"). The public hearing will be held on June 24, 2025, at 9:30 a.m., or as soon thereafter as the Board will consider the matter, at the meeting room of the Board of Supervisors, located on the first floor of the County Administrative Center, 4080 Lemon Street, 1st Floor, Riverside, California. At the</p>

THE PRESS-ENTERPRISE

KEEP YOUR EYES ON THE 'PRISE
pe.com

The Press-Enterprise
3512 14 Street
Riverside, California 92501
(951) 368-9229

County of Riverside - Clerk of the Board
PO Box 1147
Riverside, California 92502

Publication: The Press-Enterprise

PROOF OF PUBLICATION OF

Ad Desc: 0011739983

FILE NO. 0011739983

PROOF OF PUBLICATION

I am a citizen of the United States. I am over the age of eighteen years and not party to or interested in the above-entitled matter. I am an authorized representative of THE PRESS-ENTERPRISE, a newspaper of general circulation, printed and published daily in the County of Riverside, and which newspaper has been adjudicated a newspaper of general circulation by the Superior Court of the County of Riverside, State of California, under date of April 25, 1952, Case Number 54446, under date of March 29, 1957, Case Number 65673, under date of August 25, 1995, Case Number 267864, and under date of September 16, 2013, Case Number RIC 1309013; that the notice, of which the annexed is a printed copy, has been published in said newspaper in accordance with the instructions of the person(s) requesting publication, and not in any supplement thereof on the following dates, to wit:

06/16/2025

I certify (or declare) under the penalty of perjury that the foregoing is true and correct.

Date: June 16, 2025.

At: Riverside, California



Signature

NOTICE OF PUBLIC HEARING BEFORE THE BOARD OF SUPERVISORS OF RIVERSIDE COUNTY

NOTICE IS HEREBY GIVEN that a public hearing at which all interested persons will be heard, will be held before the Board of Supervisors of Riverside County, California, on the 1st Floor Board Chambers, County Administrative Center, 4080 Lemon Street, Riverside, on **June 24, 2025 at 9:30 a.m.**, or as soon as possible thereafter, to consider the following:

SUMMARY OF RESOLUTION NO. 2025-127

A RESOLUTION OF THE BOARD OF SUPERVISORS OF THE COUNTY OF RIVERSIDE OF INTENTION TO DECLARE ITS INTENTION TO CONSIDER AMENDING THE RATE AND METHOD OF APPORTIONMENT OF SPECIAL TAXES AND SETTING A DATE AND TIME FOR A PUBLIC HEARING THEREON

This summary is presented pursuant to California Government Code Section 53322. A certified copy of the full text of Resolution No. 2025-127, including a description of services and incidental expenses proposed to be financed and the proposed Amended and Restated Rate and Method of Apportionment, may be examined at the Office of the Clerk of the Board of Supervisors of the County of Riverside, located at 4080 Lemon Street, 1st Floor, Riverside, California.

Resolution No. 2025-127 sets a public hearing on the Board of Supervisor's intent to consider amendment of the original Rate and Method of Apportionment of special tax for Community Facilities District No. 19-1M (La Ventana) ("District"). The public hearing will be held on June 24, 2025, at 9:30 a.m., or as soon thereafter as the Board will consider the matter, at the meeting room of the Board of Supervisors, located on the first floor of the County Administrative Center, 4080 Lemon Street, 1st Floor, Riverside, California.

At the public hearing, testimony of all interested persons or taxpayers for or against the establishment of the District, the extent of the District, or the furnishing of specified types of public facilities or services will be heard. At the hearing, protests against the establishment of the District, the extent of the District, or the furnishing of specified types of public facilities or services may be made orally, or in writing by any interested person. Any protests pertaining to the regularity or sufficiency of the proceedings shall be in writing and shall clearly set forth the irregularities or defects to which objection is made. All written protests not personally presented by the author thereof at the hearing shall be filed with the Clerk of the Board at or before the time fixed for

the hearing. The Board may waive any irregularities in the form or content of any written protest and at the hearing may correct minor defects in the proceedings. Written protests may be withdrawn in writing at any time before the conclusion of the hearing.

If 50 percent or more of the registered voters, or six registered voters, whichever is more, residing within the District, or the owners of one-half or more of the area of the land in the territory included in the District and not exempt from the special tax, file written protests against the establishment of the District, and protests are not withdrawn so as to reduce the value of the protests to less than a majority, no further proceedings to create the District or to authorize the specified special tax lien shall be taken for a period of one year from the date of the decision of the legislative body. If the majority protests of the landowners are only against the furnishing of a specified type or types of facilities or services within the district, or against levying a specified special tax, those types of facilities or services or the specified special tax shall be eliminated from the resolution of formation.

The proposed voting procedure for the proposal shall be by mailed or hand-delivered ballot among the landowners in the District, with each owner having one vote for each acre or portion of an acre such owner owns in the District.

Please send all written correspondence to: Clerk of the Board, 4080 Lemon Street, 1st Floor, Post Office Box 1147, Riverside, CA 92502-1147 or email cob@rlvco.org.

Alternative formats available upon request to individuals with disabilities. If you require reasonable accommodation, please contact Clerk of the Board at (951) 955-1069.

Dated: June 5, 2025
Kimberly A. Rector, Clerk of the Board
BY: Naomi Sicra, Clerk of the Board Assistant
The Press-Enterprise
Published: 6/16/25

THE PRESS-ENTERPRISE

KEEP YOUR EYES ON THE 'PRISE

pe.com

3512 14 Street
Riverside, California 92501
(951) 368-9229
cgonzales@scng.com

County of Riverside - Clerk of the Board
PO Box 1147
Riverside, California 92502

<i>Account Number:</i>	5209148
<i>Ad Order Number:</i>	0011741589
<i>Customer's Reference/PO Number:</i>	
<i>Publication:</i>	The Press-Enterprise
<i>Publication Dates:</i>	07/17/2025
<i>Total Amount:</i>	\$894.42
<i>Payment Amount:</i>	\$0.00
<i>Amount Due:</i>	\$894.42
<i>Notice ID:</i>	1bmwm0UAtn9OwWAlot6T
<i>Invoice Text:</i>	<p>NOTICE OF PUBLIC HEARING BEFORE THE BOARD OF SUPERVISORS OF RIVERSIDE COUNTY NOTICE IS HEREBY GIVEN that a public hearing at which all interested persons will be heard, will be held before the Board of Supervisors of Riverside County, California, on the 1st Floor Board Chambers, County Administrative Center, 4080 Lemon Street, Riverside, on Tuesday, July 29, 2025 at 9:30 a.m., or as soon as possible thereafter, to consider the following: SUMMARY OF RESOLUTION NO. 2025-127 A RESOLUTION OF THE BOARD OF SUPERVISORS OF THE COUNTY OF RIVERSIDE OF INTENTION TO DECLARE ITS INTENTION TO CONSIDER AMENDING THE RATE AND METHOD OF APPORTIONMENT OF SPECIAL TAXES AND SETTING A DATE AND TIME FOR A PUBLIC HEARING THEREON This summary is presented pursuant to California Government Code Section 53322. A certified copy of the full text of Resolution No. 2025-127, including a description of services and incidental expenses proposed to be financed and the proposed Amended and Restated Rate and Method of Apportionment, may be examined at the Office of the Clerk of the Board of Supervisors of the County of Riverside, located at 4080 Lemon Street, 1st Floor, Riverside, California. Resolution No. 2025-127 sets a public hearing on the Board of Supervisor's intent to consider amendment of the original Rate and Method of Apportionment of special tax for Community Facilities District No. 19-1M (La Ventana) ("District"). The public hearing will be held on July 29, 2025, at 9:30 a.m., or as soon thereafter as the Board will consider the matter, at the meeting room of the Board of Supervisors, located on the first floor of the County Administrative Center, 4080 Lemon Street, 1st Floor,</p>

THE PRESS-ENTERPRISE

KEEP YOUR EYES ON THE 'PRISE
pe.com

The Press-Enterprise
3512 14 Street
Riverside, California 92501
(951) 368-9229

County of Riverside - Clerk of the Board
PO Box 1147
Riverside, California 92502

Publication: The Press-Enterprise

PROOF OF PUBLICATION OF

Ad Desc: 0011741589

FILE NO. 0011741589

PROOF OF PUBLICATION

I am a citizen of the United States. I am over the age of eighteen years and not party to or interested in the above-entitled matter. I am an authorized representative of THE PRESS-ENTERPRISE, a newspaper of general circulation, printed and published daily in the County of Riverside, and which newspaper has been adjudicated a newspaper of general circulation by the Superior Court of the County of Riverside, State of California, under date of April 25, 1952, Case Number 54446, under date of March 29, 1957, Case Number 65673, under date of August 25, 1995, Case Number 267864, and under date of September 16, 2013, Case Number RIC 1309013; that the notice, of which the annexed is a printed copy, has been published in said newspaper in accordance with the instructions of the person(s) requesting publication, and not in any supplement thereof on the following dates, to wit:

07/17/2025

I certify (or declare) under the penalty of perjury that the foregoing is true and correct.

Date: July 17, 2025.

At: Riverside, California



Signature

NOTICE OF PUBLIC HEARING BEFORE THE BOARD OF SUPERVISORS OF RIVERSIDE COUNTY

NOTICE IS HEREBY GIVEN that a public hearing at which all interested persons will be heard, will be held before the Board of Supervisors of Riverside County, California, on the 1st Floor Board Chambers, County Administrative Center, 4080 Lemon Street, Riverside, on **Tuesday, July 29, 2025 at 9:30 a.m.**, or as soon as possible thereafter, to consider the following:

SUMMARY OF RESOLUTION NO. 2025-127

A RESOLUTION OF THE BOARD OF SUPERVISORS OF THE COUNTY OF RIVERSIDE OF INTENTION TO DECLARE ITS INTENTION TO CONSIDER AMENDING THE RATE AND METHOD OF APPORTIONMENT OF SPECIAL TAXES AND SETTING A DATE AND TIME FOR A PUBLIC HEARING THEREON

This summary is presented pursuant to California Government Code Section 53322. A certified copy of the full text of Resolution No. 2025-127, including a description of services and incidental expenses proposed to be financed and the proposed Amended and Restated Rate and Method of Apportionment, may be examined at the Office of the Clerk of the Board of Supervisors of the County of Riverside, located at 4080 Lemon Street, 1st Floor, Riverside, California.

Resolution No. 2025-127 sets a public hearing on the Board of Supervisor's intent to consider amendment of the original Rate and Method of Apportionment of special tax for Community Facilities District No. 19-1M (La Ventana) ("District"). The public hearing will be held on July 29, 2025, at 9:30 a.m., or as soon thereafter as the Board will consider the matter, at the meeting room of the Board of Supervisors, located on the first floor of the County Administrative Center, 4080 Lemon Street, 1st Floor, Riverside, California.

At the public hearing, testimony of all interested persons or taxpayers for or against the establishment of the District, the extent of the District, or the furnishing of specified types of public facilities or services will be heard. At the hearing, protests against the establishment of the District, the extent of the District, or the furnishing of specified types of public facilities or services may be made orally, or in writing by any interested person. Any protests pertaining to the regularity or sufficiency of the proceedings shall be in writing and shall clearly set forth the irregularities or defects to which objection is made. All written protests not personally presented by the author thereof at the hearing shall be filed with the Clerk of the Board at or before the time fixed for

the hearing. The Board may waive any irregularities in the form or content of any written protest and at the hearing may correct minor defects in the proceedings. Written protests may be withdrawn in writing at any time before the conclusion of the hearing.

If 50 percent or more of the registered voters, or six registered voters, whichever is more, residing within the District, or the owners of one-half or more of the area of the land in the territory included in the District and not exempt from the special tax, file written protests against the establishment of the District, and protests are not withdrawn so as to reduce the value of the protests to less than a majority, no further proceedings to create the District or to authorize the specified special tax lien shall be taken for a period of one year from the date of the decision of the legislative body. If the majority protests of the landowners are only against the furnishing of a specified type or types of facilities or services within the district, or against levying a specified special tax, those types of facilities or services or the specified special tax shall be eliminated from the resolution of formation.

The proposed voting procedure for the proposal shall be by mailed or hand-delivered ballot among the landowners in the District, with each owner having one vote for each acre or portion of an acre such owner owns in the District.

Alternative formats available upon request to individuals with disabilities. If you require reasonable accommodation, please contact Clerk of the Board at (951) 955-1069.

Please send all written correspondence to: Clerk of the Board, 4080 Lemon Street, 1st Floor, Post Office Box 1147, Riverside, CA 92502-1147 or email cob@rlvco.org

Dated: June 16, 2025
Kimberly A. Rector, Clerk of the Board

By:
Naomy Sicra, Clerk of the Board
Assistant
The Press-Enterprise
Published: 7/17/25