

**ASSESSOR-COUNTY CLERK-RECORDER, RIVERSIDE COUNTY
RECORDS MANAGEMENT PROGRAM
RECORDS TRANSFER LIST, part 1**

1. Work Order #

1. Page — of —

INSTRUCTIONS: Fax completed form to (909) 358-6961 and submit original form to the Records Center with the records being transferred.

DEPARTMENTAL INFORMATION					
3. DEPARTMENT Clerk of the Board of Supervisors			8. ORG.#		10. DATE 07/14/2025
4. ORGANIZATION County of Riverside			9. ACCOUNT #		11. MEDIA CODE
5. ADDRESS 4080 Lemon St., Room 127			12. NO. OF BOXES TRANSFERRED		
CITY Riverside, Ca. 92501			13. RECORDS TRANSFERRED BY:		
6. MAIL STOP 1010		7. Name PHONE # FAX# Whitney Mayo 951-955-8092		14. RECORDS COORDINATOR (must be Authorized):	
15. BOX # (Temp)	16. DESCRIPTION OF RECORDS Must be the same as records series title on schedule	17. RANGE OF YEARS	18. DESTRUCTION DATE	19. RECORD SERIES TITLE CODE	20. PERMANENT BOX # (Barcode label)
	Boundaries of Community Facilities District No. 2013-01 (MARCH LIFECARE CAMPUS)				
	AMENDS THE BOUNDARY MAP FOR CFD NO. 2013-01 PRIOR RECORDED AT BOOK 76, P. 8-9				
21. RECORDS RECEIVED BY:			30. REMARKS		
22. TITLE		23. RECEIVED VIA:			
24. DATE RECEIVED:		25. TIME RECEIVED:			
26. BOXES VERIFIED BY:		27. DATE BOXES VERIFIED:			
28. NAME\DATE SCANNED TO HOLDING AREA:					
29. NAME\DATE SCANNED TO LOCATION:					

2025-7-162724

BOUNDARIES OF COMMUNITY FACILITIES DISTRICT NO. 2013-01 (MARCH LIFECARE CAMPUS)

COUNTY OF RIVERSIDE
STATE OF CALIFORNIA

VICINITY MAP

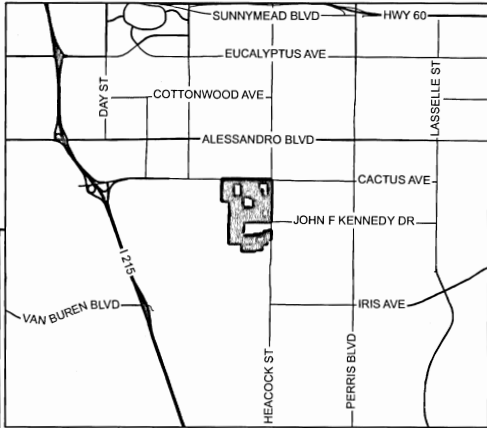

THIS BOUNDARY MAP AMENDS THE BOUNDARY MAP FOR COMMUNITY FACILITIES DISTRICT NO. 2013-01 (MARCH LIFECARE CAMPUS), MARCH JOINT POWERS AUTHORITY, COUNTY OF RIVERSIDE, STATE OF CALIFORNIA, PRIOR RECORDED AT BOOK 76 OF MAPS OF ASSESSMENT AND COMMUNITY FACILITIES DISTRICTS AT PAGES 8 - 9, IN THE OFFICE OF THE COUNTY RECORDER FOR THE COUNTY OF RIVERSIDE, STATE OF CALIFORNIA.

FILED IN THE OFFICE OF THE CLERK OF THE COUNTY OF RIVERSIDE BOARD OF SUPERVISORS THIS _____ DAY OF _____, 2025.

I HEREBY CERTIFY THAT THE WITHIN MAP SHOWING BOUNDARIES OF CFD NO. 2013-01 (MARCH LIFECARE CAMPUS), COUNTY OF RIVERSIDE, STATE OF CALIFORNIA, WAS APPROVED BY THE MARCH JOINT POWERS COMMISSION AT A REGULAR MEETING THEREOF, HELD ON THE 30TH DAY OF JUNE, 2025, BY ITS RESOLUTION NO. 25-23 AND THE BOARD OF SUPERVISORS OF THE COUNTY OF RIVERSIDE AT A REGULAR MEETING THEREOF, HELD ON THE 29TH DAY OF JULY, 2025, BY ITS RESOLUTION NO. 2025-185.

BY CLERK OF THE BOARD OF SUPERVISORS
COUNTY OF RIVERSIDE

FILED THIS _____ DAY OF _____, 2025, AT THE HOUR OF _____ M. IN BOOK _____ OF MAPS OF ASSESSMENT AND COMMUNITY FACILITIES DISTRICTS AT PAGES _____ IN THE OFFICE OF THE COUNTY RECORDER IN THE COUNTY OF RIVERSIDE, STATE OF CALIFORNIA.

FEE: _____
INSTRUMENT NO. _____
PETER ALDANA, ASSESSOR-COUNTY CLERK-RECORDER

BY DEPUTY
COUNTY RECORDER
COUNTY OF RIVERSIDE

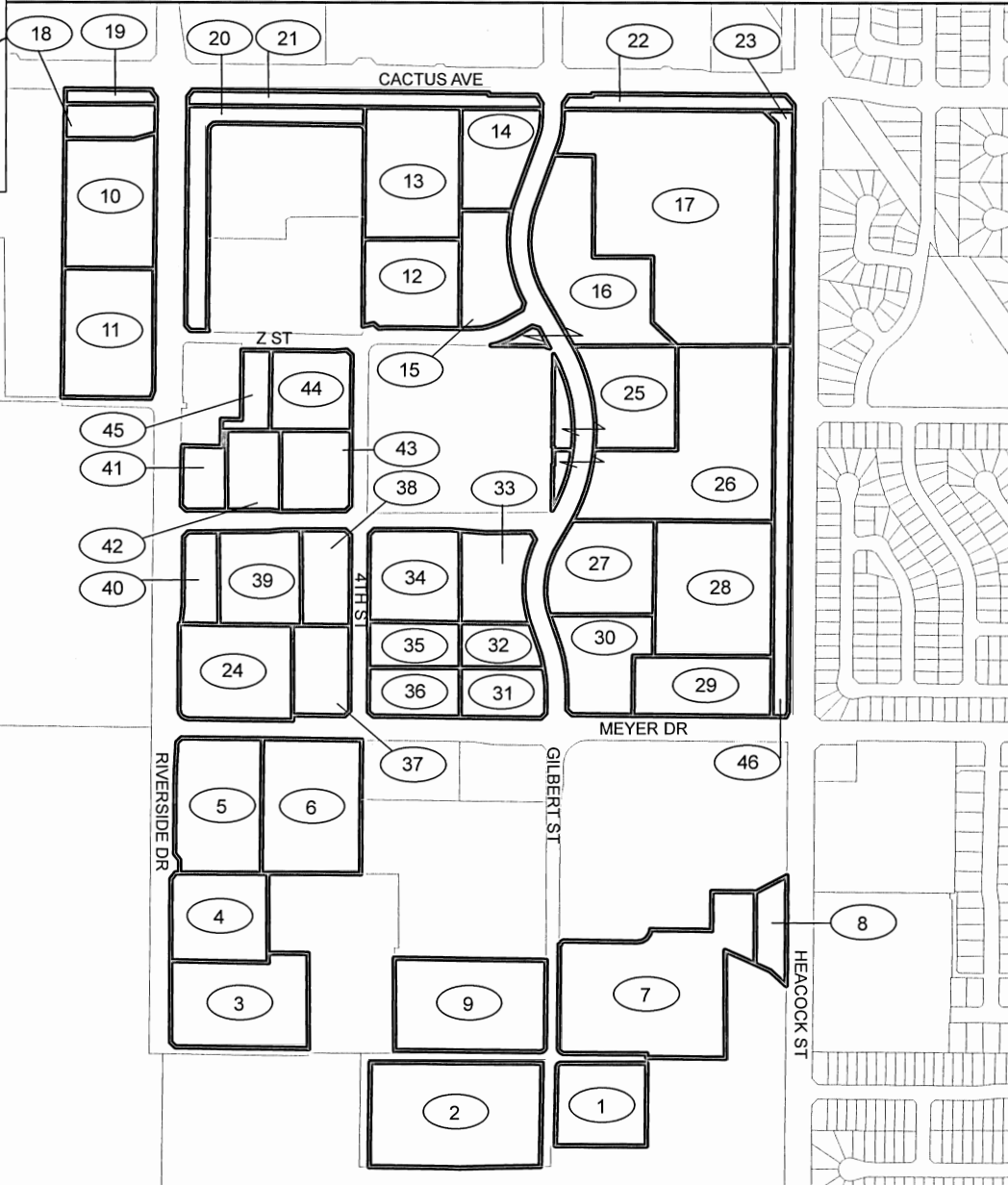

Legend

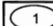
-  COMMUNITY FACILITIES DISTRICT 2013-01 (MARCH LIFECARE CAMPUS)
-  MAP REFERENCE NUMBER



27368 VIA INDUSTRIA, SUITE #200
TEMECULA, CA 92590
(951) 587-3500

BOUNDARIES OF COMMUNITY FACILITIES DISTRICT NO. 2013-01 (MARCH LIFECARE CAMPUS)

COUNTY OF RIVERSIDE
STATE OF CALIFORNIA

MAP REFERENCE NUMBER	ASSESSMENT PARCEL NUMBER
1	294-080-005
2	294-080-016
3	294-660-006
4	294-660-007
5	294-660-008
6	294-660-009
7	294-660-010
8	294-660-011
9	294-660-014
10	297-250-002
11	297-250-003
12	297-250-004
13	297-250-005
14	297-250-006
15	297-250-007
16	297-250-008

MAP REFERENCE NUMBER	ASSESSMENT PARCEL NUMBER
17	297-250-009
18	297-250-010
19	297-250-011
20	297-250-012
21	297-250-013
22	297-250-014
23	297-250-015
24	297-260-003
25	297-260-004
26	297-260-005
27	297-260-006
28	297-260-007
29	297-260-008
30	297-260-009
31	297-260-010
32	297-260-011

MAP REFERENCE NUMBER	ASSESSMENT PARCEL NUMBER
33	297-260-012
34	297-260-013
35	297-260-014
36	297-260-015
37	297-260-016
38	297-260-017
39	297-260-018
40	297-260-019
41	297-260-020
42	297-260-021
43	297-260-022
44	297-260-023
45	297-260-024
46	297-260-025



27368 VIA INDUSTRIA, SUITE #200
TEMECULA, CA 92590
(951) 587-3500