

MINUTES OF THE BOARD OF SUPERVISORS
COUNTY OF RIVERSIDE, STATE OF CALIFORNIA



1.1

On motion of Supervisor Washington, seconded by Supervisor Perez and duly carried by unanimous vote, IT WAS ORDERED, FOUND AND DETERMINED that the following ordinances were duly published:

<u>ORDINANCE</u>	<u>DATE</u>	<u>NEWSPAPER</u>
No. 449.254	March 11, 2025	Desert Sun
No. 734.17	April 1, 2025	Desert Sun

Roll Call:

Ayes: Medina, Spiegel, Washington, Perez and Gutierrez
Nays: None
Absent: None

I hereby certify that the foregoing is a full, true and correct copy of an order made and entered on October 21, 2025, of Supervisors Minutes.

WITNESS my hand and the seal of the Board of Supervisors
Dated: October 21, 2025
Kimberly A. Rector, Clerk of the Board of Supervisors, in and
for the County of Riverside, State of California.

(seal)

By: _____, Deputy

AGENDA NO.

1.1

ATTACHMENTS FILED WITH
THE CLERK OF THE BOARD

AFFIDAVIT OF PUBLICATION

Naomy Sicra
Riverside County-Board Of Sup.
Po Box 1147
Riverside CA 92502-1147

STATE OF WISCONSIN, COUNTY OF BROWN

The Desert Sun, a newspaper published in the city of Palm Springs, Riverside County, State of California, and personal knowledge of the facts herein state and that the notice hereto annexed was Published in said newspapers in the issue:

03/20/2025

and that the fees charged are legal.
Sworn to and subscribed before on 03/20/2025



Legal Clerk

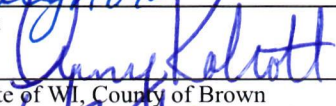

Notary, State of WI, County of Brown

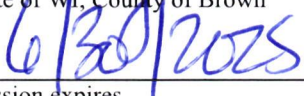

My commission expires

Publication Cost: \$1641.00
Tax Amount: \$0.00
Payment Cost: \$1641.00
Order No: 11133361 # of Copies:
Customer No: 1252599 1
PO #:

THIS IS NOT AN INVOICE!

Please do not use this form for payment remittance.

AMY KOKOTT
Notary Public
State of Wisconsin

RECEIVED RIVERSIDE COUNTY
CLERK/BOARD OF SUPERVISORS
2025 APR -8 AM 11:17

Planning
3/11/2025
3.35

ESTABLISHING A TEMPORARY MORATORIUM ON NEW SHORT TERM RENTALS WITHIN THE UNINCORPORATED COUNTY AREAS OF THOUSAND PALMS, AND B BAR H RANCH

The Board of Supervisors of the County of Riverside ordains as follows:

Section 1. PURPOSE AND AUTHORITY. The purpose of this urgency ordinance is to establish a temporary moratorium on new Short Term Rentals in residential neighborhoods within the unincorporated communities of Thousand Palms, and B Bar H Ranch, which are more precisely defined by Exhibits "A" and "B" to protect public safety, health, and welfare, while County staff evaluate the impacts of the Short Term Rentals in these areas, and reasonable regulations to mitigate such impacts. This urgency ordinance does not prohibit renewal of existing Short Term Rentals, which meet all of the requirements for renewal pursuant to Ordinance No. 927. This urgency ordinance is adopted pursuant to California Constitution Article 11, Section 7, and California Government Code sections 25123 and 65858, and will take effect immediately upon its approval by at least a four-fifths vote of the Board of Supervisors of the County of Riverside.

Section 2. FINDINGS. The Board of Supervisors of the County of Riverside makes the following findings to protect the public safety, health, and welfare in support of the immediate adoption and application of this urgency ordinance:

- A. Riverside County is experiencing an increase in privately owned residential dwellings being used as Short Term Rentals in the unincorporated areas of the County of Riverside, especially within the unincorporated areas of Thousand Palms, and B Bar H Ranch. While Short Term Rentals have been a staple in the County and provide a benefit by expanding the number and type of available lodging facilities, their exponential increase continues to cause adverse impacts which have the potential to endanger the health and safety of residents and guests, and the very environment and resources that attract visitors to the County. Adverse impacts to surrounding neighbors and properties include unpermitted large-scale events, excessive noise, disorderly conduct, traffic congestion, illegal vehicle parking, and accumulation of refuse. This urgency ordinance is necessary to ensure neighborhood compatibility and reduce conflicts within surrounding residential neighborhoods, to facilitate economic growth within the County, and to protect the health, safety, and general welfare of the County's residents.
- B. The unincorporated County area of Thousand Palms is located along Interstate 10 at the intersection of Ramon Road, and is characterized by mobile home subdivisions, single-family residential neighborhoods, and rural residential development. Infrastructure within the residential neighborhoods located north of Ramon Road remains rural in nature, exhibiting narrow roads and a lack of sidewalks and shoulder parking. Concentrations of Short Term Rentals in certain residential neighborhoods have resulted in increased complaints from residents in recent years, related to unpermitted large-scale events, excessive noise, and illegal parking. 31 Short Term Rental certifications are currently active, and 8 new applications for certifications have been received since 2023.
- C. B Bar H Ranch is an unincorporated community comprised of predominantly low-density residential, located between Palm Springs and Desert Hot Springs in the Seven Palms Valley. Similar to adjacent areas, the infrastructure in B Bar H Ranch remains rural in nature. This small unincorporated area is comprised of just 573 parcels on 240 acres. There are currently 37 actively certified Short Term Rentals in this small area, and 20 new applications for certification have been received since 2023.
- D. The County continues to receive complaints related to noise, refuse, parking, septic capabilities, and public safety related to Short Term Rentals in these areas, indicating a need for heightened operating standards and enforcement. Without proper regulations, continued concentration of Short Term Rentals in the identified areas neighborhoods may jeopardize the health, safety, and welfare of guests and the existing residential community.
- E. The County is currently in the process of studying and considering various legislative proposals to address issues associated with concentrations of Short Term Rentals to reduce risks to public safety, health, and welfare.
- F. Concentrations of Short Term Rentals in certain areas of the County can have an adverse impact on residential character, neighborhood stability, public safety, and quality of life, demonstrating the need to consider different processes or regulations, such as separating, eliminating, or capping the number of Short Term Rentals in certain areas of the County.
- G. The density of Short Term Rentals in the unincorporated areas of Thousand Palms, and B Bar H Ranch surpasses that of other unincorporated areas in the County.
- H. On December 12, 2023, the Board of Supervisors of the County of Riverside amended Ordinance No. 927, an Ordinance of the County of Riverside Regulating Short Term Rentals, through adoption of Ordinance No. 927.2. Development of Ordinance 927.2 entailed analysis of limits or caps for Short Term Rentals within the unincorporated areas of Inyarnet and Temecula Valley Wine Country, including establishment of boundary areas, determination of source of authority for a specific residential unit count, creation of an appropriate limit or cap, and a methodology for allowing new Short Term Rentals when capacity becomes available. Such analysis and regulatory measures could also be appropriate for Thousand Palms, and B Bar H Ranch.
- I. The unincorporated areas of Thousand Palms, and B Bar H Ranch currently include 68 active and pending Short Term Rental certificates. The County has also received 28 new applications for Short Term Rental certificates for these two small areas since 2023. This proliferation of Short Term Rental applications demonstrates a rush to obtain certificates that may be inconsistent with future licensing regulations, specifically, analysis of an amendment to Ordinance No. 927 to consider a limit or cap on Short Term Rentals in these areas.
- J. Issuing numerous Short Term Rental certificates in areas that may be subject to future limits, caps, or additional regulations would undermine the County's current effort to protect the public health, safety, and welfare from the negative impacts of Short Term Rentals that are improperly sited, over-concentrated, or under regulated.
- K. Issuing numerous Short Term Rental certificates in areas that may be subject to future limits, caps, or additional regulations would also create further confusion and potentially cause the need to unwind many Short Term Rental certificates.

Section 3. MONITORING. During the term of this urgency ordinance, no new Short Term Rentals shall be allowed on properties located within the unincorporated areas of Thousand Palms, or B Bar H Ranch. Renewals of existing Short Term Rentals which meet all of the requirements for renewal pursuant to Ordinance No. 927, are exempted from this moratorium.

Section 4. DEFINITIONS. Except as otherwise specified herein, all terms used herein shall have the same definition as in Ordinance No. 348 and Ordinance No. 927. Otherwise, as used in this ordinance, the following terms shall have the following meanings:

- A. County: County of Riverside
- B. Thousand Palms: Residential neighborhoods in the unincorporated area of Thousand Palms that include Short Term Rentals, the boundary of which is detailed as Exhibit A to this ordinance.
- C. B Bar H Ranch: Residential neighborhoods in the unincorporated area of B Bar H Ranch that include Short Term Rentals, the boundary of which is detailed as Exhibit B to this ordinance.

Section 5. DECLARATION OF URGENCY. Based on the findings set forth in Section 2 above, this ordinance is declared to be an urgency ordinance that shall be effective immediately upon adoption by the Board of Supervisors.

Section 6. SEVERABILITY. If any provision, clause, sentence, or paragraph of this ordinance or the application thereof to any person or circumstances shall be held invalid, such invalidity shall not affect the other provisions of this ordinance which can be given effect without the invalid provision or application; and to this end, the provisions of this ordinance are hereby declared to be severable.

Section 7. EFFECTIVE DATE AND TERM. In accordance with Government Code sections 25123 and 65858, this urgency ordinance shall become effective immediately upon its passage by at least a four-fifths vote of the Board of Supervisors and shall remain in effect for 45 days from the date of adoption. This urgency ordinance may be extended by the Board of Supervisors in accordance with Government Code section 65858.

EXHIBIT A
RESIDENTIAL NEIGHBORHOODS IN THE UNINCORPORATED AREA OF THOUSAND PALMS THAT INCLUDE SHORT TERM RENTALS
BOUNDARY MAP

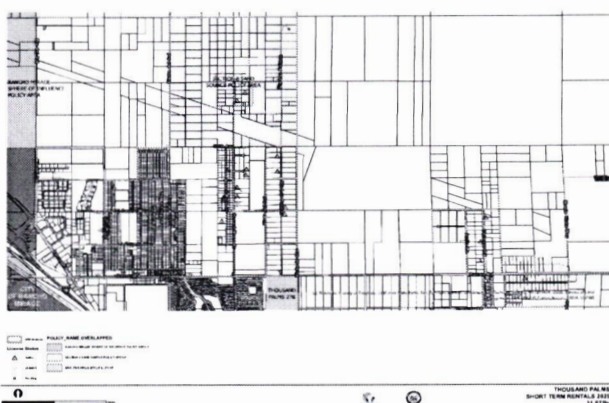
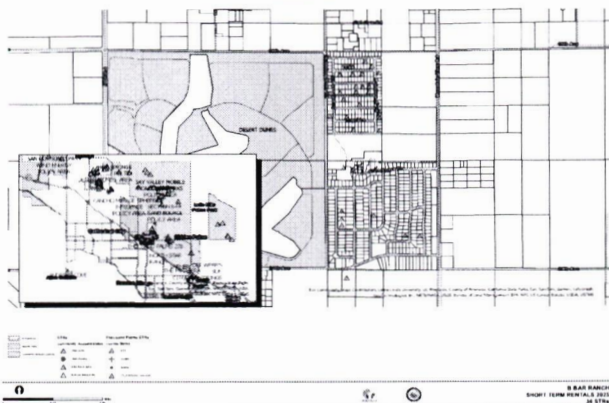

EXHIBIT B
RESIDENTIAL NEIGHBORHOODS IN THE UNINCORPORATED AREA OF B BAR H RANCH THAT INCLUDE SHORT TERM RENTALS
BOUNDARY MAP



V. Manuel Perez, Chair of the Board

I HEREBY CERTIFY that at a regular meeting of the Board of Supervisors of said County, held on March 11, 2025, the foregoing Ordinance was adopted by said Board by the following vote:

- AYES: Medina, Spiegel, Washington, Perez, and Gutierrez
- NAYS: None
- ABSENT: None

Kimberly A. Rector, Clerk of the Board
By: Naomy Sacra, Clerk of the Board Assistant

AN URGENCY INTERIM ORDINANCE OF THE COUNTY OF RIVERSIDE

ESTABLISHING A TEMPORARY MORATORIUM ON NEW SHORT TERM RENTALS WITHIN THE UNINCORPORATED COUNTY AREAS OF THOUSAND PALMS, AND B BAR H RANCH

The Board of Supervisors of the County of Riverside ordains as follows:

Section 1. PURPOSE AND AUTHORITY. The purpose of this urgency ordinance is to establish a temporary moratorium on new Short Term Rentals in residential neighborhoods within the unincorporated communities of Thousand Palms, and B Bar H Ranch, which are more precisely defined by Exhibits "A" and "B", to protect public safety, health, and welfare, while County staff evaluate the impacts of the Short Term Rentals in these areas; and reasonable regulations to mitigate such impacts. This urgency ordinance does not prohibit renewals of existing Short Term Rentals, which meet all of the requirements for renewal pursuant to Ordinance No. 927. This urgency ordinance is adopted pursuant to California Constitution Article 11, Section 7, and California Government Code sections 25123 and 65858, and will take effect immediately upon its approval by at least a four-fifths vote of the Board of Supervisors of the County of Riverside.

Section 2. FINDINGS. The Board of Supervisors of the County of Riverside makes the following findings to protect the public safety, health, and welfare in support of the immediate adoption and application of this urgency ordinance:

- A. Riverside County is experiencing an increase in privately owned residential dwellings being used as Short Term Rentals in the unincorporated areas of the County of Riverside, especially within the unincorporated areas of Thousand Palms, and B Bar H Ranch. While Short Term Rentals have been a staple in the County and provide a benefit by expanding the number and type of available lodging facilities, their exponential increase continues to cause adverse impacts which have the potential to endanger the health and safety of residents and guests, and the very environment and resources that attract visitors to the County. Adverse impacts to surrounding neighbors and properties include unpermitted large-scale events, excessive noise, disorderly conduct, traffic congestion, illegal vehicle parking, and accumulation of refuse. This urgency ordinance is necessary to ensure neighborhood compatibility and reduce conflicts within surrounding residential neighborhoods, to facilitate economic growth within the County, and to protect the health, safety, and general welfare of the County's residents.
- B. The unincorporated County area of Thousand Palms is located along Interstate 10 at the intersection of Ramon Road, and is characterized by mobile home subdivisions, single-family residential neighborhoods, and rural residential development. Infrastructure within the residential neighborhoods located north of Ramon Road remains rural in nature, exhibiting narrow roads and a lack of sidewalks and shoulder parking. Concentrations of Short Term Rentals in certain residential neighborhoods have resulted in increased complaints from residents in recent years, related to unpermitted large-scale events, excessive noise, and illegal parking. 31 Short Term Rental certifications are currently active, and 9 new applications for certifications have been received since 2023.
- C. B Bar H Ranch is an unincorporated community comprised of predominantly low-density residential, located between Palm Springs and Desert Hot Springs in the Seven Palms Valley. Similar to adjacent areas, the infrastructure in B Bar H Ranch remains rural in nature. This small unincorporated area is comprised of just 573 parcels on 240 acres. There are currently 37 actively certified Short Term Rentals in this small area, and 20 new applications for certification have been received since 2023.
- D. The County continues to receive complaints related to noise, refuse, parking, septic capabilities, and public safety related to Short Term Rentals in these areas, indicating a need for heightened operating standards and enforcement. Without proper regulation, continued concentration of Short Term Rentals in the identified area neighborhoods may jeopardize the health, safety, and welfare of guests and the existing residential community.
- E. The County is currently in the process of studying and considering various legislative proposals to address issues associated with concentrations of Short Term Rentals to reduce risks to public safety, health, and welfare.
- F. Concentrations of Short Term Rentals in certain areas of the County can have an adverse impact on residential character, neighborhood stability, public safety, and quality of life, demonstrating the need to consider different processes or regulations, such as separating, eliminating, or capping the number of Short Term Rentals in certain areas of the County.
- G. The density of Short Term Rentals in the unincorporated areas of Thousand Palms, and B Bar H Ranch surpasses that of other unincorporated areas in the County.
- H. On December 12, 2023, the Board of Supervisors of the County of Riverside amended Ordinance No. 927, an Ordinance of the County of Riverside Regulating Short Term Rentals, through adoption of Ordinance No. 927.2. Development of Ordinance 927.2 entailed analysis of limits or caps for Short Term Rentals within the unincorporated areas of Idyllwild and Temecula Valley Wine Country, including establishment of boundary areas, determination of source of authority for a specific residential unit count, creation of an appropriate limit or cap, and a methodology for allowing new Short Term Rentals when capacity becomes available. Such analyses and regulatory measures could also be appropriate for Thousand Palms, and B Bar H Ranch.
- I. The unincorporated areas of Thousand Palms, and B Bar H Ranch currently include 68 active and pending Short Term Rental certificates. The County has also received 29 new applications for Short Term Rental certificates for these two small areas since 2023. This proliferation of Short Term Rental applications demonstrates a rush to obtain certificates that may be inconsistent with future licensing regulations, specifically, analysis of an amendment to Ordinance No. 927 to consider a limit or cap on Short Term Rentals in these areas.
- J. Issuing numerous Short Term Rental certificates in areas that may be subject to future limits, caps, or additional regulations would undermine the County's current effort to protect the public health, safety, and welfare from the negative impacts of Short Term Rentals that are improperly sited, over-concentrated, or under regulated.
- K. Issuing numerous Short Term Rental certificates in areas that may be subject to future limits, caps, or additional regulations would also create further confusion and potentially cause the need to unwind many Short Term Rental certificates.

Section 3. MORATORIUM. During the term of this urgency ordinance, no new Short Term Rentals shall be allowed on properties located within the unincorporated areas of Thousand Palms, or B Bar H Ranch. Renewals of existing Short Term Rentals which meet all of the requirements for renewal pursuant to Ordinance No. 927, are exempted from this moratorium.

Section 4. DEFINITIONS. Except as otherwise specified herein, all terms used herein shall have the same definition as in Ordinance No. 348 and Ordinance No. 927. Otherwise, as used in this ordinance, the following terms shall have the following meanings:

- A. **County:** County of Riverside
- B. **Thousand Palms:** Residential neighborhoods in the unincorporated area of Thousand Palms that include Short Term Rentals, the boundary of which is detailed as Exhibit A to this ordinance.
- C. **B Bar H Ranch:** Residential neighborhoods in the unincorporated area of B Bar H Ranch that include Short Term Rentals, the boundary of which is detailed as Exhibit B to this ordinance.

Section 5. DECLARATION OF URGENCY. Based on the findings set forth in Section 2 above, this ordinance is declared to be an urgency ordinance that shall be effective immediately upon adoption by the Board of Supervisors.

Section 6. SEVERABILITY. If any provision, clause, sentence, or paragraph of this ordinance or the application thereof to any person or circumstances shall be held invalid, such invalidity shall not affect the other provisions of this ordinance which can be given effect without the invalid provision or application, and to this end, the provisions of this ordinance are hereby declared to be severable.

Section 7. EFFECTIVE DATE AND TERM. In accordance with Government Code sections 25123 and 65858, this urgency ordinance shall become effective immediately upon its passage by at least a four-fifths vote of the Board of Supervisors and shall remain in effect for 45 days from the date of adoption. This urgency ordinance may be extended by the Board of Supervisors in accordance with Government Code section 65858.

**EXHIBIT A
RESIDENTIAL NEIGHBORHOODS IN THE UNINCORPORATED AREA OF THOUSAND
PALMS THAT INCLUDE SHORT TERM RENTALS
BOUNDARY MAP**

AFFIDAVIT OF PUBLICATION

Naomy Siera
Riverside County-Board Of Sup.
Po Box 1147
Riverside CA 92502-1147

STATE OF WISCONSIN, COUNTY OF BROWN

The Desert Sun, a newspaper published in the city of Palm Springs, Riverside County, State of California, and personal knowledge of the facts herein state and that the notice hereto annexed was Published in said newspapers in the issue:

04/10/2025

and that the fees charged are legal.
Sworn to and subscribed before on 04/10/2025



Legal Clerk



Notary, State of WI, County of Brown

8-25-26

My commission expires

Publication Cost:	\$1906.85	
Tax Amount:	\$0.00	
Payment Cost:	\$1906.85	
Order No:	11210957	# of Copies:
Customer No:	1252599	1
PO #:		

THIS IS NOT AN INVOICE!

Please do not use this form for payment remittance.

MARIAH VERHAGEN
Notary Public
State of Wisconsin

RUAS-PH
4/11/2025
2101

**ORDINANCE NO. 734.17
AN ORDINANCE OF THE COUNTY OF RIVERSIDE
AMENDING ORDINANCE 734 RELATING TO ESTABLISHING FEES, CHARGES, AND
RATES FOR COUNTY PUBLIC HEALTH SERVICES AND SUPPLIES**

The Board of Supervisors of the County of Riverside ordains as follows:

Section 1. Purpose

The purpose of this Ordinance is to revise fees for certain services and supplies furnished by the County of Riverside in the field of health through Riverside University Health System – Public Health (RHHS-PH) in accordance with Centers for Medicare and Medicaid Services standards PY 24/25. RHHS-PH provides lab testing services to other local government agencies, such as Animal Control entities, as well as other Riverside County departments, including Riverside University Health System – Medical Center and Riverside University Health System – Community Health Centers. Additionally, RHHS-PH provides lab testing services to local area hospitals.

Section 2. Fees and Charges

Section 2 of Ordinance No. 734 is hereby amended in its entirety to read as follows:
"Riverside University Health System – Public Health fees and charges shall be listed on Schedule 1"

Section 3. Severability

Should any fee herein established be held to be invalid or otherwise unenforceable, such determination shall not affect the validity of all remaining fee provisions.

Section 4. Repeal of Ordinance 734.16

This Ordinance repeals Ordinance 734.16 in its entirety.

Section 5. Effective Date

This ordinance shall take effect thirty (30) days after its adoption.

**COUNTY OF RIVERSIDE
RIVERSIDE UNIVERSITY HEALTH SYSTEM - PUBLIC HEALTH FEES
Ordinance 734.17 Schedule 1**

Description of Activity/Service	Current Approved Fee	Proposed Fee:
Business Services:		
Certified Mail per item	\$ 3.45	\$ 4.35
Certified Mail (Registered) per item	\$ 12.70	\$ 16.80
Certified Mail (Receipt Requested) per item	\$ 2.80	\$ 3.55
Records Processing Fee (Subpoena/Records Request Clerical Fee)	\$ 15.00	\$ 15.00
Records Copying Fee per page	\$ 1.00	\$ 1.00
Returned Checks each	\$ 20.00	\$ 20.00
Medical Documents X-Rays & Images (CD included) per request	\$ -	\$ 25.00
Therapeutic Med ID Program (MMIC)	\$ 87.00	\$ 87.00
Therapeutic Med ID Program (MMIC) - Med-Cal patients	\$ 43.50	\$ 43.50
Dog Importation Health Certificate Administration Fee each	\$ -	\$ 26.00
Emergency Medical Services:		
Advanced Life Support (ALS) per year (1)	\$ 6,000.00	\$ 6,000.00
Ambulance Service Permit per yr (2)	\$ 3,000.00	\$ 3,000.00
Basic Life Support (BLS) per yr	\$ 250.00	\$ 250.00
Ambulance Service Permit per yr (2)	\$ 3,000.00	\$ 3,000.00
Each ambulance per yr	\$ 250.00	\$ 250.00
EMT-I Certification and Recertification every 2yrs	\$ 25.00	\$ 25.00
EMT-I Certification and Recertification - Late Fee	\$ 10.00	\$ 10.00
EMT-P Initial Accreditation	\$ 75.00	\$ 75.00
EMT-P Re-verification every 2yrs	\$ 50.00	\$ 50.00
EMPT-P (Paramedic) and MCN (Mobile Intensive Care Nurse) Late Fee	\$ 25.00	\$ 25.00
Fees for medical services and most laboratory - See clinical services.		
Initial Certification (MICN Challenge) Recertification every 2yrs	\$ 75.00	\$ 75.00
Lost Card Replacement	\$ 10.00	\$ 10.00
Mobile Intensive Care Nurse (MICN) Recertification every 2yrs	\$ 50.00	\$ 50.00
Epidemiology		
Special Data Request Fee per hour	\$ 100.00	\$ 100.00
Immunizations		
Mobile Team Vaccines		
Fluorix - Flu Vaccine CPT 90696	\$ -	\$ 20.00
Boostrix - TDAP Vaccine CPT 90715	\$ -	\$ 50.00
Covid Vaccine (Pfizer) 6 mos-4 yrs CPT 91318	\$ -	\$ 130.00
Covid Vaccine (Pfizer) 5-11 yrs CPT 91319	\$ -	\$ 130.00
Covid Vaccine (Pfizer) 12+ CPT 91320	\$ -	\$ 130.00
Covid Vaccine (Moderna) 6 mos-11 yrs CPT 91321	\$ -	\$ 130.00
Covid Vaccine (Moderna) 12+ CPT 91322	\$ -	\$ 130.00
Proxix - MMR (Pediatric & Adult) CPT 90707	\$ -	\$ 103.00
Varivax - Varicella (Pediatric & Adult) CPT 90716	\$ -	\$ 140.00
Shingrix - Zoster Vaccine CPT 90750	\$ -	\$ 199.00
Gardasil - HPV Human Papillomavirus 9-Valent CPT 90651	\$ -	\$ 330.00
MenQuadfi - Meningococcal Conjugate (Groups A,C,W and Y) CPT 90619	\$ -	\$ 198.00
Menveo - Meningococcal Conjugate one-val (Groups A,C,Y and W-135) CPT 90734	\$ -	\$ 198.00
Menveo - Meningococcal Conjugate two-val CPT 90734	\$ -	\$ 198.00
Vaccination Administration Fee*	\$ -	\$ 2.00 - \$90.00
*Sliding fee scale based on funding source and program used		
Injury Prevention Services:		
Bicycle Helmets* each	\$3.00 - \$10.00	\$3.00 - \$10.00
Regular Car Seats* each	\$20.00 - \$45.00	\$20.00 - \$45.00
Special Needs Car Seat* each	\$0.00 - \$50.00	\$0.00 - \$50.00
*Sliding fee scale based on income		
Description of Activity/Service	Current Approved Fee	Proposed Fee:
Non Clinical Laboratory:		
Fees for Registration of Non-Diagnostic General Health Assessment Program:		
Annual Operator/Organization Registration each	\$ 100.00	\$ 100.00
Additional Duties each	\$ 12.00	\$ 12.00
Additional Program each	\$ 43.00	\$ 43.00
Additional Site each	\$ 20.00	\$ 20.00
Personnel Addition each	\$ 12.00	\$ 12.00
Record Changes each	\$ 12.00	\$ 12.00
Review Procedural Changes each	\$ 20.00	\$ 20.00
Non Diagnostic General Health Assessment Consultation per hour	\$ 75.00	\$ 75.00
Spore Test - Instrument Sterilization (at 28 weeks) S	\$ 18.86	\$ 18.86
PH Laboratory Fees:		
Acid Fast Smear (Auramine) CPT 87206	\$ 11.00	\$ 11.00
Amplification Probe - Chlamydia CPT 87491	\$ 72.00	\$ 52.64
Amplification Probe - Gonorrhea CPT 87591	\$ 72.00	\$ 52.64
Concentrate CPT 87015	\$ 14.00	\$ 14.00
Culture 0157 E. coli (stool cult. bacteria each)/STEC CPT 87046	\$ 19.00	\$ 19.00
Culture Aerobic (culture bacteria - other) CPT 87070	\$ 18.00	\$ 18.00
Culture Bordetella pertussis (culture screen only) CPT 87081	\$ 15.00	\$ 15.00
Culture Campylobacter CPT 87046	\$ 19.00	\$ 19.00
Culture Enteric (feces culture bacterial) CPT 87045	\$ 18.00	\$ 19.00
Culture for Identification CPT 87077	\$ 17.00	\$ 50.00
Culture Fungus CPT 87102	\$ -	\$ 30.00
Culture Gonorrhea (GC) (culture screen only) CPT 87081	\$ 15.00	\$ 15.00
Culture Group A strep (Throat) (culture screen only) CPT 87081	\$ 15.00	\$ 15.00
Culture Group B strep (vaginal/rectal) (culture screen only) CPT 87045	\$ 19.00	\$ 19.00
Culture Salmonella/Shigella (feces culture bacterial) CPT 87116	\$ 20.00	\$ 50.00
Culture TB CPT 87272	\$ 38.00	\$ 38.00
FA Cryptosporidium (AG #) CPT 87269	\$ 38.00	\$ 38.00
FA Giardia (AG #) CPT 87281	\$ 19.00	\$ 19.00
FA Pneumocystis carinii (AG #) CPT N A	\$ 50.00	\$ 50.00
FA Rabies CPT N A	\$ 9.00	\$ 9.00
Fecal Leukocyte (smear gram stain) CPT 89055	\$ 9.00	\$ 9.00
Fungus ID Mold CPT 87107	\$ 50.00	\$ 50.00
Fungus ID Yeast CPT 87106	\$ 50.00	\$ 50.00
GenoXpert Assay (MTB /RIF) CPT 87556	\$ 75.00	\$ 100.00
Gram Stain (smear) CPT 87205	\$ 9.00	\$ 9.00
Hepatitis A IgM Antibody CPT 86709	\$ 23.00	\$ 23.00
Hepatitis A Total Antibody CPT 86708	\$ 25.00	\$ 25.00
Hepatitis B Core IgM Antibody CPT 86705	\$ 24.00	\$ 24.00
Hepatitis B Core Total Antibody CPT 86704	\$ 25.00	\$ 25.00
Hepatitis B Detection Test by Nucleic Acid (Quantification) CPT 87517	\$ -	\$ 64.26
Hepatitis B Surface Antibody CPT 86706	\$ 22.00	\$ 22.00
Hepatitis B Surface Antigen (AG EIA) CPT 87340	\$ 21.00	\$ 21.00
Hepatitis B Surface Antigen PLUS (Confirmatory) (AG EIA) CPT 87341	\$ 21.00	\$ 21.00
Hepatitis C Antibody CPT 86803	\$ 29.00	\$ 29.00
Hepatitis C Detection Test by Nucleic Acid (Quantification) CPT 87522	\$ -	\$ 64.26
Herpes Simplex Virus, Amplified Probe CPT 87529	\$ -	\$ 52.64

Description of Activity/Service	Current Approved Fee	Proposed Fee:
HIV Antigen/Antibody Screen (HIV-1/HIV-2 single assay) CPT 87389	\$ 28.00	\$ 36.12
HIV-1 and HIV-2 Genus Confirmation (2 shots total) CPT 86689	\$ 46.00	\$ 58.06
HIV-1 Detection Test by Nucleic Acid (Amplified Probe Technique) CPT 87535	\$ -	\$ 52.64
HIV-1 Detection Test by Nucleic Acid (Quantification) CPT 87536	\$ -	\$ 127.65
ID of Parasite: CPT 87169	\$ 9.00	\$ 6.47
Influenza SARS-CoV-2 Multiplex RT-PCR CPT 87636	\$ -	\$ 213.95
Kinoyou staining for TB ID CPT 87206	\$ -	\$ 8.09
Mass spectrometry (laboratory testing method) CPT 83789	\$ -	\$ 36.17
Measles Antibody IgG CPT 86765	\$ -	\$ 19.32
MonkeyPox CPT 87593	\$ -	\$ 35.09
Mumps Antibody IgG		
Mycoplasma Antibiotic sensitivities (TB AFP Sensi-EA drug X6) CPT 87188	\$ 60.00	\$ 25.00
Mycobacterium Species Identification CPT 87118	\$ -	\$ 75.00
Mycoplasma genitalium CPT 87563	\$ -	\$ 52.64
Ova & Parasite - Concentration (smears) CPT 87177	\$ 18.00	\$ 18.00
Ova & Parasite - Trichrome (smear complex stain) CPT 87209	\$ 37.00	\$ 37.00
PCR - Influenza A/B CPT 87502	\$ 41.00	\$ 143.70
PCR - Measles and Mumps CPT 87798	\$ 41.00	\$ 52.64
PCR - Norovirus CPT 87801	\$ 41.00	\$ 105.30
Pinworm CPT 87172	\$ 9.00	\$ 6.41
QuantIFERON-TB CPT 86480	\$ 40.00	\$ 92.97
Respiratory Panel 2.1 CPT 87633	\$ -	\$ 625.17
Rubella IgG Antibody CPT 86762	\$ 29.00	\$ 21.59
Salmonella serogrouping CPT 87147	\$ -	\$ 7.77
Shiga-toxin 1 IBA CPT 87427	\$ 19.00	\$ 17.97
Shiga-toxin 2 IBA CPT 87427	\$ 19.00	\$ 17.97
Syphilis (RPR) - Qualitative CPT 86592	\$ 9.00	\$ 9.00
Syphilis (RPR) - Quantitative CPT 86593	\$ 9.00	\$ 9.00
Syphilis (TPPA) Confirmation (treponema pallidum) CPT 86780	\$ 27.00	\$ 27.00
Syphilis Serum IBA Screen (non-trep qual) CPT 86592	\$ 9.00	\$ 9.00
Systemic Fungus Probe CPT 87797	\$ 100.00	\$ 140.00
Trichomonas vaginalis amplif CPT 87661	\$ -	\$ 52.64
VZV (Varicella) IgG Antibody CPT 86787	\$ -	\$ 19.32
West Nile Virus IgM Antibody Screen (prev. WNV IBA) CPT 86789	\$ 34.00	\$ 21.59
West Nile Virus IgM Confirmation CPT 86788	\$ 34.00	\$ 25.28
Disease Control:		
Fee for Provision of TB Skin Testing Group:		
Class Fee	\$ 500.00	\$ 500.00
Per Capita Student Fee	\$ 9.40	\$ 9.40
Tuberculosis (TB) Clearance	\$ 43.00	\$ 43.00
Nursing:		
Detention Facility Inspection (Site visit, analysis of menu, report issuance) per hour	\$ 116.00	\$ 116.00
HIV/STD		
Court-Ordered HIV Testing	\$ 123.00	\$ 123.00
Education Classes for Sex and Drug Offenders (set by Judge)	\$70.00 - \$300.00	\$70.00 - \$300.00
California Children's Services (CCS):		
CCS Assessment Fee (Depends on family size & adjusted gross income)	\$0 or \$20	\$0 or \$20
CCS Enrollment Fee (Depends on family size & adjusted gross income \$60 increments) Note: For incomes over \$39,999, for each subsequent income increment of \$5,000 increase the above fees by \$120 Family (1 or 2)	\$0 to \$1440	\$0 to \$1440
CCS Enrollment Fee (Depends on family size & adjusted gross income \$60 increments) Note: For incomes over \$39,999, for each subsequent income increment of \$5,000 increase the above fees by \$120 Family (3)	\$0 to \$1380	\$0 to \$1380
CCS Enrollment Fee (Depends on family size & adjusted gross income \$60 increments) Note: For incomes over \$39,999, for each subsequent income increment of \$5,000 increase the above fees by \$120 Family (4)	\$0 to \$1320	\$0 to \$1320
CCS Enrollment Fee (Depends on family size & adjusted gross income \$60 increments) Note: For incomes over \$39,999, for each subsequent income increment of \$5,000 increase the above fees by \$120 Family (5)	\$0 to \$1260	\$0 to \$1260
CCS Enrollment Fee (Depends on family size & adjusted gross income \$60 increments) Note: For incomes over \$39,999, for each subsequent income increment of \$5,000 increase the above fees by \$120 Family (6 or more)	\$0 to \$1200	\$0 to \$1200
Community Health Workers		
Description of Activity/Service	Current Approved Fee	Proposed Fee:
Self-management education and training, face-to-face 30 minutes (1 patient) CPT 98960	\$ -	\$25.66
Self-management education and training, face-to-face, 30 minutes (2-4 patients) CPT 98961	\$ -	\$12.66 per patient
Self-management education and training, face-to-face, 30 minutes (5-8 patients) CPT 98962	\$ -	\$9.46 per patient
Nutrition		
Community Education Presentation per hour	\$ 88.00	\$ 88.00
Detention Facility Inspection (Registered Dietitian) (Site visit, analysis of menu, report issuance) per hour	\$ 116.00	\$ 116.00
Lactation Counseling (Certified Lactation Educators - CLE) per hour	\$ 113.00	\$ 113.00
Professional Education Presentation by HEA per hour	\$ -	\$ 88.00
Registered Dietitian / Certified Diabetic Educator (RD/CDE) (consultation or presentation) per hour	\$ 116.00	\$ 116.00
International Board Certified Lactation Consultant (IBCLC) per hour	\$ 116.00	\$ 116.00
Staff Training (for non-County providers) per hour	\$ 80.00	\$ 88.00
Lactation Educator Course (20-hour course for health professionals taught by an IBCLC) per participant	\$ 380.00	\$ 469.00
Lactation Counselor Course (40-hour course for health professionals taught by an IBCLC) per participant	\$ -	\$ 930.00
Grow Our Own Lactation Consultant Course (105-hour IBCLC Prep Course) per participant	\$ 1,700.00	\$ 1,700.00
Healthy Eating Lunch & Learn with a Nutritionist (RD) and a Chef per class	\$ 665.00	\$ 665.00
* travel expenses charged separately for out of Riverside County classes		
Staff Development:		
CPR (Cardiopulmonary Resuscitation) Class per participant	\$ 64.00	\$ 74.00
CPR (Cardiopulmonary Resuscitation) Class - Blended per participant	\$ 66.00	\$ 77.00
Adult and Pediatric First Aid Class per participant	\$ 77.00	\$ 91.00
General Population Shelter Class per participant	\$ 40.00	\$ 47.00
Stop the Bleed Class per participant	\$ 25.00	\$ 26.00
Aerosol Transmissible Disease & Blood Borne Pathogens Class per participant	\$ 38.00	\$ 58.00
Fit Testing Class per participant	\$ 40.00	\$ 53.00
Vital Records:		
I. Certified Copies, Search, and Certification of No Public Record:		
AVSS Technical Support per hour	\$ 95.00	\$ 95.00
Birth - Government Agencies each	\$ 19.00	\$ 22.00
Birth - General Public each	\$ 28.00	\$ 29.00
Birth Certified Copies, Searches & Certification each	\$ 28.00	\$ 29.00
Death Certificate - Government Agency & General Public each	\$ 21.00	\$ 24.00
Death Certified Copies, Searches & Certification each	\$ 21.00	\$ 24.00
Death Listings - sent to mortuaries each	\$ 5.00	\$ 5.00
Admin Fee - Per Authorization Number each	\$ 1.00	\$ 1.00
Fetal Death Certificate - Government Agency & General Public each	\$ 18.00	\$ 21.00
Still Birth Certified Copies each	\$ 20.00	\$ 20.00
II. Permit for Disposition of Human Remains		
Regular Permit each	\$ 12.00	\$ 12.00
After Hours Permit each	\$ 12.00	\$ 12.00
III. Other Services		
Letter of Non-Contagious Disease each - max 2	\$ 10.00	\$ 10.00
Letter of Authentication each	\$ 10.00	\$ 10.00
Paternity Declaration (to DCSS only) each	\$ 10.00	\$ 10.00
V Manuel Perez, Chair of the Board		
I HEREBY CERTIFY that at a regular meeting of the Board of Supervisors of said County, held on April 1, 2025, the foregoing Ordinance was adopted by said Board by the following vote:		
AYES:	Medina, Spiegel and Perez	
NAYS:	None	
ABSENT:	Washington and Gutierrez	
Kimberly A. Rector, Clerk of the Board By: Naomy Siera, Clerk of the Board Assistant		

Your Source
Public Notices
for the latest...

Your Source
Public Notices
for the latest...

Your Source
Public Notices
for the latest...

Your Source
Public Notices
for the latest...

Your Source
Public Notices
for the latest...

Your Source
Public Notices
for the latest...

BOARD OF SUPERVISORS OF THE COUNTY OF RIVERSIDE, STATE OF CALIFORNIA

ORDINANCE NO. 734.17
AN ORDINANCE OF THE COUNTY OF RIVERSIDE
AMENDING ORDINANCE 734 RELATING TO ESTABLISHING FEES, CHARGES, AND
RATES FOR COUNTY PUBLIC HEALTH SERVICES AND SUPPLIES

The Board of Supervisors of the County of Riverside ordains as follows:

Section 1. Purpose

The purpose of this Ordinance is to revise fees for certain services and supplies furnished by the County of Riverside in the field of health through Riverside University Health System – Public Health (RUHS-PH) in accordance with Centers for Medicare and Medicaid Services standards FY 24/25. RUHS-PH provides lab testing services to other local government agencies, such as Animal Control entities, as well as other Riverside County departments, including Riverside University Health System – Medical Center and Riverside University Health System – Community Health Centers. Additionally, RUHS-PH provides lab testing services to local area hospitals.

Section 2. Fees and Charges

Section 2 of Ordinance No. 734 is hereby amended in its entirety to read as follows:
"Riverside University Health System – Public Health fees and charges shall be listed on Schedule 1"

Section 3. Severability

Should any fee herein established be held to be invalid or otherwise unenforceable, such determination shall not affect the validity of all remaining fee provisions.

Section 4. Repeal of Ordinance 734.16

This Ordinance repeals Ordinance 734.16 in its entirety.

Section 5. Effective Date

This ordinance shall take effect thirty (30) days after its adoption.

COUNTY OF RIVERSIDE
RIVERSIDE UNIVERSITY HEALTH SYSTEM - PUBLIC HEALTH FEES
Ordinance 734.17 Schedule 1

Description of Activity/Service	Current Approved Fee	Proposed Fee:
Business Services:		
Certified Mail	per item \$ 3.45	\$ 4.35
Certified Mail (Registered)	per item \$ 12.20	\$ 16.80
Certified Mail (Receipt Requested)	per item \$ 2.80	\$ 3.55
Records Processing Fee (Subpoena/Records Request Clerical Fee)	\$ 15.00	\$ 15.00
Records Copying Fee	per page \$ 1.00	\$ 1.00

HIV Antigen/Antibody Screen (HIV-1/HIV-2 single assay)	CPT 87389	\$ 28.00	\$ 36.12
HIV-1 and HIV-2 Genensis Confirmation (2 shots total)	CPT 86689	\$ 46.00	\$ 58.06
HIV-1 Detection Test by Nucleic Acid (Amplified Probe Technique)	CPT 87535	\$ -	\$ 52.64
HIV-1 Detection Test by Nucleic Acid (Quantification)	CPT 87536	\$ -	\$ 127.65
ID of Parasite	CPT 87169	\$ 9.00	\$ 6.47
Influenza SARS-CoV-2 Multiplex rRT-PCR	CPT 87636	\$ -	\$ 213.95
Kinyoun staining for TB ID	CPT 87206	\$ -	\$ 8.09
Mass spectrometry (laboratory testing method)	CPT 83789	\$ -	\$ 36.17
Measles Antibody IgG	CPT 86765	\$ -	\$ 19.32
MonkeyPox	CPT 87593	\$ -	\$ 35.09

Description of Activity/Service	Current Approved Fee	Proposed Fee:
Mumps Antibody IgG	CPT 86735	\$ - \$ 19.58
Mycobacteria Antibiotic sensitivities (TB AFB Sensi-EA drug X6)	CPT 87188	\$ 60.00 \$ 25.00
Mycobacterium Species Identification	CPT 87118	\$ - \$ 75.00
Mycoplasma genitalium	CPT 87563	\$ - \$ 52.64
Ova & Parasite - Concentration (smears)	CPT 87177	\$ 18.00 \$ 18.00
Ova & Parasite - Trichrome (smear complex stain)	CPT 87209	\$ 37.00 \$ 37.00
PCR - Influenza A/B	CPT 87502	\$ 41.00 \$ 143.70
PCR - Measles and Mumps	CPT 87798	\$ 41.00 \$ 52.64
PCR - Norovirus	CPT 87801	\$ 41.00 \$ 105.30
Pinworm	CPT 87172	\$ 9.00 \$ 6.41
QuantiferON-TB	CPT 86480	\$ 40.00 \$ 92.97
Respiratory Panel 2.1	CPT 87633	\$ - \$ 626.17
Rubella IgG Antibody	CPT 86762	\$ 29.00 \$ 21.59
Salmonella serogrouping	CPT 87147	\$ - \$ 7.77
Shiga-toxin 1 EIA	CPT 87427	\$ 19.00 \$ 17.97

Medical Documents, X-Rays & Images (CD included)	each	\$ 20.00	\$ 20.00
Therapeutic Med ID Program (MMIC)	per request	\$ 87.00	\$ 87.00
Therapeutic Med ID Program (MMIC) - Medi-Cal patients		\$ 43.50	\$ 43.50
Dog Importation Health Certificate Administration Fee	each	\$ -	\$ 26.00

Emergency Medical Services:

Advanced Life Support (ALS):			
Ambulance Service Permit	per year (1)	\$ 6,000.00	\$ 6,000.00
Basic Life Support (BLS):			
Ambulance Service Permit	per yr (2)	\$ 3,000.00	\$ 3,000.00
Each ambulance	per yr	\$ 250.00	\$ 250.00
EMT-I Certification and Recertification	every 2yrs	\$ 25.00	\$ 25.00
EMT-I Certification and Recertification - Late Fee		\$ 10.00	\$ 10.00
EMT-P Initial Accreditation		\$ 75.00	\$ 75.00
EMT-P Re-verification	every 2yrs	\$ 50.00	\$ 50.00
EMPT-P (Paramedic) and MICN (Mobile Intensive Care Nurse) Late Fee		\$ 25.00	\$ 25.00
Fees for medical services and most laboratory - See clinical services.			
Initial Certification (MICN Challenge) Recertification:	every 2yrs	\$ 75.00	\$ 75.00
Lost Card Replacement		\$ 10.00	\$ 10.00
Mobile Intensive Care Nurse (MICN) Recertification	every 2yrs	\$ 50.00	\$ 50.00

Epidemiology

Special Data Request Fee	per hour	\$ 100.00	\$ 100.00
--------------------------	----------	-----------	-----------

Immunizations

Mobile Team Vaccines			
Fluarix - Flu Vaccine	CPT 90686	\$ -	\$ 20.00
Boostrix - TDAP Vaccine	CPT 90715	\$ -	\$ 50.00
Covid Vaccine (Pfizer) 6 mos-4 yrs	CPT 91318	\$ -	\$ 130.00
Covid Vaccine (Pfizer) 5-11 yrs	CPT 91319	\$ -	\$ 130.00
Covid Vaccine (Pfizer) 12+	CPT 91320	\$ -	\$ 130.00
Covid Vaccine (Moderna) 6 mos-11 yrs	CPT 91321	\$ -	\$ 130.00
Covid Vaccine (Moderna) 12+	CPT 91322	\$ -	\$ 130.00
Priorix - MMR (Pediatric & Adult)	CPT 90707	\$ -	\$ 103.00
Varivax - Varicella (Pediatric & Adult)	CPT 90716	\$ -	\$ 140.00
Shingrix - Zoster Vaccine	CPT 90750	\$ -	\$ 199.00
Gardasil - HPV Human Papillomavirus 9-Valent	CPT 90651	\$ -	\$ 330.00
MenQuadfi - Meningococcal Conjugate (Groups A,C,W and Y)	CPT 90619	\$ -	\$ 198.00
Menveo - Meningococcal Conjugate one-vial (Groups A,C,Y and W-135)	CPT 90734	\$ -	\$ 198.00
Menveo - Meningococcal Conjugate two-vial	CPT 90734	\$ -	\$ 198.00
Vaccination Administration Fee*		\$ -	\$ 2.00 - \$90.00

*Sliding fee scale based on funding source and program used

Injury Prevention Services:

Bicycle Helmets*	each	\$ 3.00 - \$10.00	\$ 3.00 - \$10.00
------------------	------	-------------------	-------------------

Syphilis (RPR) - Qualitative	CPT 86592	\$ 9.00	\$ 9.00
Syphilis (RPR) - Quantitative	CPT 86593	\$ 9.00	\$ 9.00
Syphilis (TPPA) Confirmation (<i>treponema pallidum</i>)	CPT 86780	\$ 27.00	\$ 27.00
Syphilis Serum EIA Screen (<i>non-trep qual</i>)	CPT 86592	\$ 9.00	\$ 9.00
Systemic Fungus Probe	CPT 87797	\$ 100.00	\$ 140.00
Trichomonas vaginalis amplif	CPT 87661	\$ -	\$ 52.64
VZV (Varicella) IgG Antibody	CPT 86787	\$ -	\$ 19.32
West Nile Virus IgM Antibody Screen (prev. WNV EIA)	CPT 86789	\$ 34.00	\$ 21.59
West Nile Virus IgM Confirmation	CPT 86788	\$ 34.00	\$ 25.28

Disease Control:

Fee for Provision of TB Skin Testing Group:			
Class Fee	\$	500.00	\$ 500.00
Per Capita Student Fee	\$	9.40	\$ 9.40
Tuberculosis (TB) Clearance	\$	43.00	\$ 43.00

Nursing:

Detention Facility Inspection (Site visit, analysis of menu, report issuance)	per hour	\$ 116.00	\$ 116.00
---	----------	-----------	-----------

HIV/STD

Court-Ordered HIV Testing	\$	123.00	\$ 123.00
Education Classes for Sex and Drug Offenders (set by Judge)	\$70.00 - \$300.00		\$70.00 - \$300.00

California Children's Services (CCS):

CCS Assessment Fee: (Depends on family size & adjusted gross income)	\$0 or \$20	\$0 or \$20
CCS Enrollment Fee (Depends on family size & adjusted gross income \$60 increments) Note: For incomes over \$99,999, for each subsequent income increment of \$5,000 increase the above fees by \$120 Family (1 or 2)	\$0 to \$1440	\$0 to \$1440
CCS Enrollment Fee (Depends on family size & adjusted gross income \$60 increments) Note: For incomes over \$99,999, for each subsequent income increment of \$5,000 increase the above fees by \$120 Family (3)	\$0 to \$1380	\$0 to \$1380
CCS Enrollment Fee (Depends on family size & adjusted gross income \$60 increments) Note: For incomes over \$99,999, for each subsequent income increment of \$5,000 increase the above fees by \$120 Family (4)	\$0 to \$1320	\$0 to \$1320
CCS Enrollment Fee (Depends on family size & adjusted gross income \$60 increments) Note: For incomes over \$99,999, for each subsequent income increment of \$5,000 increase the above fees by \$120 Family (5)	\$0 to \$1260	\$0 to \$1260
CCS Enrollment Fee (Depends on family size & adjusted gross income \$60 increments) Note: For incomes over \$99,999, for each subsequent income increment of \$5,000 increase the above fees by \$120 Family (6 or more)	\$0 to \$1200	\$0 to \$1200

Community Health Workers

Description of Activity/Service	Current Approved Fee	Proposed Fee:
Self-management education and training, face-to-face, 30 minutes (1 patient)	CPT 98960	\$ - \$26.66
Self-management education and training, face-to-face, 30 minutes (2-4 patients)	CPT 98961	\$ - \$12.66 per patient
Self-management education and training, face-to-face, 30 minutes (5-8 patients)	CPT 98962	\$ - \$9.46 per patient

Special Needs Car Seat*	each	\$0.00 - \$50.00	\$0.00 - \$50.00
-------------------------	------	------------------	------------------

*Sliding fee scale based on Income

Description of Activity/Service	Current Approved Fee	Proposed Fee:
Non Clinical Laboratory:		
Fees for Registration of Non-Diagnostic General Health Assessment Program:		
Annual Operator/Organization Registration	each \$ 100.00	\$ 100.00
Additional Dates	each \$ 12.00	\$ 12.00
Additional Program	each \$ 43.00	\$ 43.00
Additional Site	each \$ 20.00	\$ 20.00
Personnel Addition	each \$ 12.00	\$ 12.00
Record Changes	each \$ 12.00	\$ 12.00
*Review Procedural Changes	each \$ 20.00	\$ 20.00
Non Diagnostic General Health Assessment Consultation	per hour \$ 75.00	\$ 75.00
Spore Test - Instrument Sterilization (at 28 weeks)	\$ 18.86	\$ 18.86

PH Laboratory Fees:

Acid Fast Smear (Auramine)	CPT 87206	\$ 11.00	\$ 11.00
Amplification Probe - Chlamydia	CPT 87491	\$ 72.00	\$ 52.64
Amplification Probe - Gonorrhea	CPT 87591	\$ 72.00	\$ 52.64
Concentrate	CPT 87015	\$ 14.00	\$ 14.00
Culture 0157 E. coli (stool cultr bacteria each) /STEC	CPT 87046	\$ 19.00	\$ 19.00
Culture Aerobic (culture bacteria - other)	CPT 87070	\$ 18.00	\$ 18.00
Culture Bordetella pertussis (culture screen only)	CPT 87081	\$ 15.00	\$ 15.00
Culture Campylobacter	CPT 87046	\$ 19.00	\$ 19.00
Culture Enteric (feces culture bacteria)	CPT 87045	\$ 19.00	\$ 19.00
Culture for Identification	CPT 87077	\$ 17.00	\$ 50.00
Culture Fungus	CPT 87102	\$ -	\$ 30.00
Culture Gonorrhea (GC) (culture screen only)	CPT 87081	\$ 15.00	\$ 15.00
Culture Group A strep (Throat) (culture screen only)	CPT 87081	\$ 15.00	\$ 15.00
Culture Group B strep (vaginal/rectal) (culture screen only)	CPT 87081	\$ 15.00	\$ 15.00
Culture Salmonella/Shigella (feces culture bacteria)	CPT 87045	\$ 19.00	\$ 19.00
Culture TB	CPT 87116	\$ 20.00	\$ 50.00
FA Cryptosporidium (AG IF)	CPT 87272	\$ 38.00	\$ 38.00
FA Giardia (AG IF)	CPT 87269	\$ 38.00	\$ 38.00
FA Pneumocystis carinii (AG IF)	CPT 87281	\$ 19.00	\$ 19.00
FA Rabies	CPT N/A	\$ 50.00	\$ 50.00
Fecal Leukocyte (smear gram stain)	CPT 89055	\$ 9.00	\$ 9.00
Fungus ID Mold	CPT 87107	\$ 50.00	\$ 50.00
Fungus ID Yeast	CPT 87106	\$ 50.00	\$ 50.00
GeneXpert Assay (MTB /RIF)	CPT 87556	\$ 75.00	\$ 100.00
Gram Stain (smear)	CPT 87205	\$ 9.00	\$ 9.00
Hepatitis A IgM Antibody	CPT 86709	\$ 23.00	\$ 23.00
Hepatitis A Total Antibody	CPT 86708	\$ 25.00	\$ 25.00
Hepatitis B Core IgM Antibody	CPT 86705	\$ 24.00	\$ 24.00
Hepatitis B Core Total Antibody	CPT 86704	\$ 25.00	\$ 25.00
Hepatitis B Detection Test by Nucleic Acid (Quantification)	CPT 87517	\$ -	\$ 64.26
Hepatitis B Surface Antibody	CPT 86706	\$ 22.00	\$ 22.00
Hepatitis B Surface Antigen (AG EIA)	CPT 87340	\$ 21.00	\$ 21.00
Hepatitis B Surface Antigen PLUS (Confirmatory) (AG EIA)	CPT 87341	\$ 21.00	\$ 21.00
Hepatitis C Antibody	CPT 86803	\$ 29.00	\$ 29.00
Hepatitis C Detection Test by Nucleic Acid (Quantification)	CPT 87522	\$ -	\$ 64.26
Herpes Simplex Virus, Amplified Probe	CPT 87529	\$ -	\$ 52.64

Community Education Presentation	per hour	\$ 88.00	\$ 88.00
Detention Facility Inspection (Registered Dietitian) (Site visit, analysis of menu, report issuance)	per hour	\$ 116.00	\$ 116.00
Lactation Counseling (Certified Lactation Educators - CLE)	per hour	\$ 113.00	\$ 113.00
Professional Education Presentation by HEA	per hour	\$ -	\$ 88.00
Registered Dietitian / Certified Diabetic Educator (RD/CDE) (consultation or presentation)	per hour	\$ 116.00	\$ 116.00
International Board Certified Lactation Consultant (IBCLC)	per hour	\$ 116.00	\$ 116.00
Staff Training (for non-County providers)	per hour	\$ 80.00	\$ 88.00
Lactation Educator Course (20-hour course for health professionals taught by an IBCLC)	per participant	\$ 380.00	\$ 469.00
Lactation Counselor Course (40-hour course for health professionals taught by an IBCLC)	per participant	\$ -	\$ 930.00
Grow Our Own Lactation Consultant Course (105-hour IBCLC Prep Course)	per participant	\$ 1,700.00	\$ 1,700.00
Healthy Eating Lunch & Learn with a Nutritionist (RD) and a Chef	per class	\$ 665.00	\$ 665.00

* travel expenses charged separately for out of Riverside County classes

Staff Development

CPR (Cardiopulmonary Resuscitation) Class	per participant	\$ 64.00	\$ 74.00
CPR (Cardiopulmonary Resuscitation) Class - Blended	per participant	\$ 66.00	\$ 77.00
Adult and Pediatric First Aid Class	per participant	\$ 77.00	\$ 91.00
General Population Shelter Class	per participant	\$ 40.00	\$ 47.00
Stop the Bleed Class	per participant	\$ 25.00	\$ 26.00
Aerosol Transmissible Disease & Blood Borne Pathogens Class	per participant	\$ 38.00	\$ 58.00
Fit Testing Class	per participant	\$ 40.00	\$ 53.00

Vital Records:

I. Certified Copies, Search, and Certification of No Public Record:

AVSS Technical Support	per hour	\$ 95.00	\$ 95.00
Birth - Government Agencies	each	\$ 19.00	\$ 22.00
Birth - General Public	each	\$ 28.00	\$ 29.00
Birth Certified Copies, Searches & Certification	each	\$ 28.00	\$ 29.00
Death Certificate - Government Agency & General Public	each	\$ 21.00	\$ 24.00
Death Certified Copies, Searches & Certification	each	\$ 21.00	\$ 24.00
Death Listings - sent to mortuaries	each	\$ 5.00	\$ 5.00
Admin Fee - Per Authorization Number	each	\$ 1.00	\$ 1.00
Fetal Death Certificate - Government Agency & General Public	each	\$ 18.00	\$ 21.00
Still Birth Certified Copies	each	\$ 20.00	\$ 20.00

II. Permit for Disposition of Human Remains

Regular Permit	each	\$ 12.00	\$ 12.00
After Hours Permit	each	\$ 12.00	\$ 12.00

III. Other Services

Letter of Non-Contagious Disease	each - max 2	\$ 10.00	\$ 10.00
Letter of Authentication	each	\$ 10.00	\$ 10.00
Paternity Declaration (to DCSS only)	each	\$ 10.00	\$ 10.00

V. Manuel Perez, Chair of the Board

I HEREBY CERTIFY that at a regular meeting of the Board of Supervisors of said County, held on April 1, 2025, the foregoing Ordinance was adopted by said Board by the following vote:

AYES: Medina, Spiegel, and Perez
 NAYS: None
 ABSENT: Washington and Gutierrez

Kimberly A. Rector, Clerk of the Board
 By: Naomi Sicra, Clerk of the Board Assistant