

**SUBMITTAL TO THE BOARD OF SUPERVISORS
COUNTY OF RIVERSIDE, STATE OF CALIFORNIA**



ITEM: 3.7
(ID # 29642)

MEETING DATE:

Tuesday, February 03, 2026

FROM : OFFICE OF ECONOMIC DEVELOPMENT

SUBJECT: OFFICE OF ECONOMIC DEVELOPMENT: Receive and File the Statement of the Election Official, Adoption of Resolution No. 2026-005 Declaring the Results of a Consolidated Special Election, Introduction of Ordinance No. 1007, an Ordinance of the County of Riverside Authorizing the Levy of a Special Tax within Community Facilities District 25-5M (Leon Ridge) TR 30806 of the County of Riverside. District 3. (Clerk of the Board to Record Notice of Special Tax)

RECOMMENDED MOTION: That the Board of Supervisors:

1. Receive and file the Statement of the Election Official regarding the Canvass of the Election for the Community Facilities District;
2. Adopt Resolution No. 2026-005, a Resolution of the Board of Supervisors of the County of Riverside Declaring the Results of Consolidated Special Elections within Community Facilities District No. 25-5M (Leon Ridge) of the County of Riverside;
3. Introduce, read title, waive reading of, and adopt on successive weeks proposed Ordinance No. 1007, an Ordinance of the County of Riverside Authorizing the Levy of a Special Tax within Community Facilities District No. 25-5M (Leon Ridge) of the County of Riverside; and,
4. Direct the Clerk of the Board to certify and record the Notice of Special Tax with the County Clerk.

ACTION:Policy

Suzanne Holland, Director of Office of Economic Development 1/12/2026

MINUTES OF THE BOARD OF SUPERVISORS

On motion of Supervisor Washington, seconded by Supervisor Gutierrez and duly carried, IT WAS ORDERED that the above matter is approved as recommended and that the above Ordinance is approved as introduced with a waiver of reading.

Ayes: Medina, Spiegel, Washington, Perez, and Gutierrez
Nays: None
Absent: None
Date: February 3, 2026
xc: OED, Recorder, COB/NS

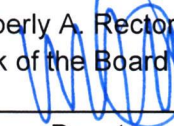
Kimberly A. Rector
Clerk of the Board
By: 
Deputy

**SUBMITTAL TO THE BOARD OF SUPERVISORS COUNTY OF RIVERSIDE,
STATE OF CALIFORNIA**

FINANCIAL DATA	Current Fiscal Year:	Next Fiscal Year:	Total Cost:	Ongoing Cost
COST	\$ 0	\$ 0	\$ 0	\$ 0
NET COUNTY COST	\$ 0	\$ 0	\$ 0	\$ 0
SOURCE OF FUNDS: N/A			Budget Adjustment: N/A	
			For Fiscal Year: 26/27	

C.E.O. RECOMMENDATION: Approve

BACKGROUND:

Summary

The State Legislature enacted the Mello-Roos Community Facilities Act of 1982, to assist public agencies in financing certain public services and maintenance requirements. On January 27, 2015, the Board of Supervisors revised Board Policy B-12 entitled “Land Secured Financing Districts” to include “Service and Maintenance CFDs” to fund the ongoing maintenance of landscaping, storm water Best Management Practice (BMP), street lighting, and or other similar improvements and set goals and policies concerning Community Facilities Districts (CFD).

GM Gabrych Family, L.P., and Leon Ridge – Winchester, L.P., are the Owners of Tract Map 30806 and has petitioned that the County of Riverside Office of Economic Development assist them in forming a district and include their property for the County of Riverside (County) to cover the costs associated with the maintenance of public improvements within the proposed district and have submitted an application and formation deposit. Subject to voter approval, a special tax is proposed to be levied on each individual parcel located within the boundary of the proposed CFD to fund the costs associated with services necessary to meet the increased demands placed by development upon the County, as listed in Exhibit A attached herein.

Each new CFD is created for a specific development or developments when similar facilities are requested to be maintained by the County. A special tax is levied according to a Rate and Method of Apportionment (RMA) developed to the specific features within that District, and a special tax levy is annually placed on the tax roll for each Assessor Parcel Number (APN) noted in the CFD Boundary Map.

The property owner of Tract Map No. 30806 has petitioned the County to include their property into proposed Community Facilities District 25-5M (Leon Ridge).

The boundaries of CFD No. 25-5M (Leon Ridge) will encompass the entire Tract No. 30806, which includes 182 single-family residential units, none of which are currently occupied.

On December 9, 2025 (Agenda Item 3.33), the County Board of Supervisors approved Resolution No. 2025-297, a Resolution of Intention as the initial step for forming the CFD and declaring the intention of the Board of Supervisors as required by the Mello-Roos Act of 1982 to levy a special tax to fund the service and maintenance functions requested by GM Gabrych Family L.P., and Leon Ridge – Winchester, L.P. The Resolution also requires the Board of

**SUBMITTAL TO THE BOARD OF SUPERVISORS COUNTY OF RIVERSIDE,
STATE OF CALIFORNIA**

Supervisors hold a public hearing and submit the formation of the proposed CFD 25-5M (Leon Ridge) to the landowners at a special election to be conducted by mailed ballot if a majority protest does not occur.

On January 27, 2026, the County of Riverside Board of Supervisors held a public hearing to receive public comments and conduct a majority protest hearing. At the conclusion of the public hearing, the Board of Supervisors adopted Resolution No. 2026-004, a Resolution of the Board of Supervisors of the County of Riverside of Formation of Community Facilities District No. 25-5M (Leon Ridge) of the County of Riverside, Authorizing the Levy of a Special Tax within Said District to Pay for authorized maintenance of Developer-installed and County-required infrastructure, particularly those listed in Exhibit A attached herein, Calling a Special Election to submit to the Respective Qualified Voters the Question of Levying Such Special Tax and Establishing an Appropriations Limit for Said District; and Designating the Election Official For Such Matters. Under the same agenda item, the required CFD report, Certificate of Registrar of Voters stating there are fewer than twelve registered voters, and Concurrence of Election Official in Date of Special Election were all received and filed.

The attached Statement of the Election Official regarding the Canvass of the Election declares the election results, which were 52 'YES' votes for Proposition A and Proposition B as described in Section 14 of Resolution No. 2026-004 (adopted on 1/27/2026). Adoption of proposed Resolution No. 2026-005, a Resolution of the Board of Supervisors of the County of Riverside, will declare the results of the Consolidated Special Election within the boundary of Community Facilities District 25-5M (Leon Ridge). Proposed County Ordinance No. 1007 would authorize and levy special taxes within the boundaries of Community Facilities District 25-5M (Leon Ridge).

Reference

The CFD Rate and Method of Apportionment (RMA) is consistent with the Mello-Roos Act of 1982. In November 1996, California voters passed Proposition 218, Right to Vote on Taxes Act which added Articles XIII C and XIII D to the California Constitution. The County may levy taxes on this proposed CFD after complying with the requirements of the Mello-Roos Community Facilities Act of 1982 and the provisions of Proposition 218 Right to Vote on Taxes Act. The formation of the proposed CFD adheres to Board Policy B-12 entitled "Land Secured Financing Districts", which was revised on January 27, 2015, to include "Service and Maintenance CFDs" to fund the ongoing maintenance of street lighting, or other similar improvements and set goals and policies concerning CFDs.

Impact on Residents and Businesses

Only the parcels with Assessor Parcel Numbers within the boundaries of the proposed CFD which are represented by the attached Recorded Boundary Map (inclusive of Tract Map No. 30806) are impacted by the special tax. By setting up this mechanism for the maintenance of certain infrastructure required by the development, the County requires that the development pay for its maintenance impact, rather than the obligation falling upon declining public funding

**SUBMITTAL TO THE BOARD OF SUPERVISORS COUNTY OF RIVERSIDE,
STATE OF CALIFORNIA**

sources. By specifically collecting and using the special tax revenue within the boundary of the CFD, there is a financial mechanism in place to ensure the infrastructure is maintained. This CFD does not propose to fund the repayment of any bonds or bond obligations and is solely for the purposes of funding the service and maintenance of Developer-installed, and County-required infrastructure, particularly those listed in Exhibit A attached herein. The Developer shall and is obligated to provide disclosure statements to potential buyers which outline the associated tax rate of a new home.

SUPPLEMENTAL:

Additional Fiscal Information

The budget for fiscal year 2025-2026, as reflected in the Rate and Method of Apportionment will result in \$73,892, which consists of a Special Tax A of \$406 per taxable unit (as defined in the Rate and Method of Apportionment attached as Exhibit A to the Ordinance). The Maximum Special tax amount may be adjusted by the minimum of 2% or up to the cumulative percentage increase in the Consumer Price Index for all Urban Consumers (CPI-U) in effect in the previous Fiscal Year, as it stands as of March of each year over the base index of the previous fiscal year. There are no General Funds used in this project.

ATTACHMENTS:

- Exhibit A: Description of Services
- Recorded CFD Boundary Map (reference only)
- Statement of the Election Official regarding the Canvass of the Election for the CFD
- Resolution No. 2026-005
- Proposed Ordinance No. 1007
- Rate and Method of Apportionment

Jacqueline Ruiz, Principal Analyst 1/26/2026

Aaron Gettis, Chief Deputy County Counsel 1/22/2026

2026-0034420

02/03/2026 04:31 PM Fee: \$ 0.00

Page 1 of 15

Recorded in Official Records
County of Riverside
Peter Aldana
Assessor-County Clerk-Recorder



RECORDING REQUESTED BY AND
WHEN RECORDED RETURN TO:

Spicer Consulting Group
Attn: Shane Spicer
41880 Kalmia St, Suite 145,
Murrieta, CA 92562

2148

NOTICE OF SPECIAL TAX LIEN

**COUNTY OF RIVERSIDE COMMUNITY FACILITIES DISTRICT NO. 25-5M
(LEON RIDGE)**

Pursuant to the requirements of Section 3114.5 of the California Streets and Highways Code and the Mello-Roos Community Facilities Act of 1982, as amended, commencing with Section 53311 of the California Government Code (the "Act"), the undersigned Clerk of the Board of Supervisors, County of Riverside, State of California, hereby gives notice (the "Notice") of the foregoing and that a lien to secure payment of a special tax is hereby imposed by the Board of Supervisors of the County of Riverside, State of California. The special tax secured by this lien is authorized to be levied for the purpose of providing the services, including incidental expenses, described in Exhibit A attached hereto and incorporated by this reference herein.

The special tax is authorized to be levied within the County of Riverside Community Facilities District No. 25-5M (Leon Ridge) (the "District"), which has now been officially formed and the lien of special tax is a continuing lien which shall secure each annual levy of the special tax and which shall continue in force and effect until the special tax ceases to be levied and a notice of cessation of special tax is recorded in accordance with the Section 53330.5 of the Act.

The rate, method of apportionment, and manner of collection of the authorized special tax are as set forth in the rate and method of apportionment of the special tax (the "Rate and Method") attached hereto as Exhibit B and by this reference incorporated herein. The Rate and Method does not provide for prepayment of the special tax obligation.

Notice is further given that upon the recording of this Notice in the office of the County Recorder of the County of Riverside, the obligation to pay the special tax levy shall become a lien upon all nonexempt real property within the District, in accordance with Section 3115.5 of the California Streets and Highways Code.

The names of the owners and the assessor's tax parcel numbers of the real property included within the District are as set forth in Exhibit C attached hereto and by this reference made a part hereof.

Reference is made to the boundary map of the District recorded on December 17th, 2025 in Book 98 of Maps of Assessment and Community Facilities Districts at Pages 37 and 38 in the office of the County Recorder for the County of Riverside, State of California, as Document #2025-0391475 which map is the final boundary map of the District.

For further information concerning the current and estimated future tax liability of owners or purchasers of real property subject to this special tax lien, interested persons should contact the Maintenance CFD Administrator at the County of Riverside Office of Economic Development, 3403 10th Street, Suite 400, Riverside, CA 92501, phone 951-955-3212.

Dated: FEB 0 3, 2026

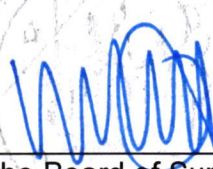
By: 
Clerk of the Board of Supervisors
DEPUTY

by DEPUTY Whitney Mayo

**PETER ALDANA
COUNTY OF RIVERSIDE
ASSESSOR-COUNTY CLERK-RECORDER**

Recorder
P.O. Box 751
Riverside, CA 92502-0751
(951) 486-7000

www.riversideacr.com

CERTIFICATION

Pursuant to the provisions of Government Code 27361.7, I certify under the penalty of perjury that the following is a true copy of illegible wording found in the attached document:

(Print or type the page number(s) and wording below):

CLARIFICATION FOR SEAL for the Riverside County Board of Supervisors
(EMBOSSSED ON DOCUMENT)



Date:

02/03/2026

Signature: _____

Print Name: Whitney Mayo, Clerk of the Board Assistant

EXHIBIT A

DESCRIPTION OF SERVICES

Services

The services which may be funded with proceeds of the special tax of CFD No. 25-5M, as provided by Section 53313 of the Act, will include all costs attributable to the following services:

- (i) Street light maintenance, which includes energy charges, operation, maintenance, and administration of street lighting located within the designated boundaries of the CFD; and
- (ii) Administration, inspection, and maintenance of all stormwater facilities and BMPs to include: water quality basins, fossil filters, basin forebays, and all other NPDES/WQMP/BMP related devices and structures as approved and accepted by the Community Facilities District; administration includes, but is not limited to, quality control and assurance of inspections and maintenance, general contract management, scheduling of inspections and maintenance, and general oversight of all NPDES/WQMP/BMP operations; inspection includes, but is not limited to, travel time, visual inspection process and procedures for functionality, GPS location recording, assurance of proper vegetation, functioning irrigation, and citing operational or structural deficiencies, erosion, trash, silt and sediment build-up; and maintenance includes, but is not limited to, repair or replacement of any deficiencies noted during inspection, weed control and abatement, trash removal, and healthy upkeep of required plant materials within the boundaries of the CFD.

Incidental Expenses

The incidental expenses proposed to be incurred include the following:

- (i) The cost associated with the creation of the Community Facilities District, determination of the amount of taxes, collection of taxes, including litigation expenses, if any, costs for processing payment of taxes, or other administrative costs otherwise incurred in order to carry out the authorized purposes of the Community Facilities District; and
- (ii) Any other expenses incidental to the performance and inspection of the authorized Services.

EXHIBIT B

RATE AND METHOD OF APPORTIONMENT OF SPECIAL TAX FOR COMMUNITY FACILITIES DISTRICT NO. 25-5M (LEON RIDGE) OF THE COUNTY OF RIVERSIDE STATE OF CALIFORNIA

A Special Tax (all capitalized terms are defined in Section A. Definitions, below) shall be applicable to each Parcel of Taxable Property located within the boundaries of Community Facilities District No. 25-5M (Leon Ridge) (the "CFD 25-5M" or "CFD"; defined below). The amount of Special Tax to be levied on a Parcel in each Fiscal Year, (defined below), commencing in Fiscal Year 2025-2026, shall be determined by the Riverside County Board of Supervisors, acting in its capacity as the legislative body of the CFD by applying the appropriate Special Tax as set forth in Sections B., C., and D., below. All property within the CFD, unless exempted by law or by the provisions of Section E., below, shall be taxed for the purposes, to the extent, and in the manner herein provided.

A. DEFINITIONS

The terms hereinafter set forth have the following meanings:

"Accessory Dwelling Unit(s)" means a residential unit of limited size, as defined in California Government Code Section 65852.2 that shares an Assessor's Parcel Number with Single Family Residential Property.

"Acre" or "Acreage" means the land area of a Parcel as shown on the most recent Assessor's Parcel Map, or if the land area is not shown on the Assessor's Parcel Map, the land area shown on the applicable Final Map, condominium plan, or other recorded County map. If the preceding maps are not available, the Acreage of an Assessor's Parcel Number may be determined utilizing Geographic Information System. The square footage of a Parcel is equal to the Acreage of such Parcel multiplied by 43,560.

"Act" means the Mello-Roos Community Facilities Act of 1982, as amended, being Chapter 2.5 of Part 1 of Division 2 of Title 5 of the Government Code of the State of California.

"Administrative Expenses" means all actual or reasonably estimated costs and expenses of the CFD that are chargeable or allocable to carry out the duties of the Administrator of the CFD as allowed by the Act, which shall include without limitation, all costs and expenses arising out of or resulting from the annual levy and collection of the Special Tax (whether by the County or designee thereof, or both), any litigation or appeal involving the CFD, and other administrative expenses of the County or designee thereof, or both, directly related to the CFD. Administrative Expenses shall also include amounts estimated or advanced by the County or CFD for attorney's fees and other costs related to commencing and pursuing to completion any foreclosure as a result of delinquent Special Taxes.

"Administrator" means an official of the County, or designee thereof, responsible for determining the Special Tax Requirement and providing for the levy and collection of the Special Taxes.

"Approved Property" means all Parcels of Taxable Property: (i) that are included in a Final Map that was recorded prior to the January 1st preceding the Fiscal Year in which the Special Tax is being levied, and (ii)

that have not been issued a Building Permit(s) prior to the April 1st preceding the Fiscal Year in which the Special Tax is being levied.

“Assessor” means the Assessor of the County.

“Assessor’s Parcel Map” means an official map of the Assessor of the County designating a Parcel by an Assessor’s Parcel Number.

“Assessor’s Parcel Number” means the number assigned to a lot or Parcel for purposes of identification as determined from an Assessor Parcel Map.

“Board” means Riverside County Board of Supervisors, acting in its capacity as the legislative body of the CFD.

“Boundary Map” means a recorded map of the CFD which indicates by a boundary line the extent of the territory within the CFD identified to be subject to the levy of Special Taxes.

“Building Permit(s)” means a legal document(s) issued by a local agency that allows for new vertical construction of a building or buildings.

“Certificate of Occupancy” means a certificate of occupancy issued by the County in accordance with all applicable ordinances, regulations, and rule of the County and State law.

“CFD” or **“CFD 25-5M”** means Community Facilities District No. 25-5M (Leon Ridge) of the County of Riverside.

“Consumer Price Index” means the cumulative percentage increase in the Consumer Price Index (CPI) published by the U.S. Bureau of Labor Statistics for All Urban Consumers in the Riverside-San Bernardino-Ontario Area, as it stands in March of each year over the preceding Fiscal Year. In the event this index ceases to be published, the Consumer Price Index shall be another index as determined by the Administrator that is reasonably comparable to the Consumer Price Index for the Riverside-San Bernardino-Ontario Area. In the event that the percentage change in the annualized CPI is negative, the Special Tax shall not be decreased.

“County” means the County of Riverside, California.

“Developed Property” means for each Fiscal Year, all Parcels of Taxable Property: (i) that are included in a Final Map that was recorded prior to January 1st preceding the Fiscal Year in which the Special Tax is being levied, and (ii) for which a Building Permit(s) for vertical construction has been issued prior to April 1st preceding the Fiscal Year in which the Special Tax is being levied.

“Development Class” means either Developed Property, Approved Property, Taxable Property Owner’s Association Property, Taxable Public Property, or Undeveloped property.

“Dwelling Unit(s)” or **“(DU)”** means a residential building(s) that is used or intended to be used as a domicile by one or more persons, as determined by the Administrator.

“Exempt Property” means any Parcel which is exempt from Special Taxes pursuant to Section E., below.

“Final Map” means a subdivision of property by recordation of a tract map, parcel map or lot line adjustment, pursuant to the Subdivision Map Act (California Government Code Section 66410 *et seq.*) or recordation of a condominium plan pursuant to California Civil Code 4200 that creates individual lots for which Building Permit(s) may be issued without further subdivision.

“Fiscal Year” means the 12-month period starting on July 1 of any calendar year and ending the following June 30.

“Maximum Special Tax” means for each Parcel in each Fiscal Year, the greatest amount of Special Tax, determined in accordance with Section C., below, which may be levied on such Parcel in each Fiscal Year.

“Multi-family Residential Property” means all Parcels of Residential Property that consist of a two or more buildings comprised of attached Dwelling Units available for rental by the general public, not for sale to an end user, and under common management.

“Non-Residential Property” means all Parcels of Developed Property for which a Building Permit(s) was issued permitting the construction of one or more non-residential structures.

“Parcel” means a lot or parcel within the CFD shown on an Assessor’s Parcel Map with an assigned Assessor’s Parcel Number valid as of July 1st for the Fiscal Year for which the Special Tax is being levied.

“Property Owner’s Association Property” means all Parcels which have been conveyed, dedicated to, or irrevocably offered for dedication to a home-owner’s association, condominium owner’s association or any master or sub-association, prior to April 1st preceding the Fiscal Year in which the Special Tax is being levied.

“Proportionately” means for each Parcel of Taxable Property that are Developed Property, Approved Property, Taxable Property Owner’s Association Property, Taxable Public Property or Undeveloped Property, that the ratio of the actual Special Tax levy to Maximum Special Tax is the same for all Parcels assigned within each Development Class.

“Public Property” means all Parcels which, as of April 1st preceding the Fiscal Year in which the Special Tax is being levied, are (i) used for rights-of-way or any other purpose and is owned by, dedicated to, or irrevocably offered for dedication to the federal government, the State, the County, City or any other public agency, provided, however, that any property leased by a public agency to a private entity and subject to taxation under Section 53340.1 of the Act shall be taxed and classified according to its use; or (ii) encumbered by an unmanned utility easement making impractical its utilization for other than the purpose set forth in the easement.

“Residential Property” means all Parcels of Developed Property for which a Building Permit(s) has been issued permitting the construction of one or more residential Dwelling Units.

“Single Family Residential Property” means all Parcels of Residential Property, other than Multi-family Residential Property.

“Special Tax(es)” means the amount to be levied in each Fiscal Year on each Parcel of Taxable Property in accordance with Section D., below to fund the Special Tax Requirement.

“Special Tax Requirement(s)” means that amount required in any Fiscal Year to: (i) pay the estimated cost of Special Tax Services such Fiscal Year as determined by the County; (ii) fund the Special Tax Reserve Fund to the extent that the inclusion of such amount does not increase the Special Tax for Undeveloped Property unless requested by the developer or the amount needed to fund the Special Tax Reserve Fund up to the Special Tax Reserve Fund Requirement; (iii) pay Administrative Expenses; (iv) pay any anticipated Special Tax delinquencies based on actual delinquencies from the prior Fiscal Year outstanding at the time the annual Special Tax levy is determined; and (v) less a credit for funds available to reduce the annual Special Tax levy at the sole discretion of the Administrator.

“Special Tax Reserve Fund Requirement” means an amount up to 150% of the anticipated annual cost of Special Tax Services of \$73,892. The Special Tax Reserve Fund Requirement shall be increased annually, commencing July 1, 2026, by the amount equal to the greater of two percent (2%) or up to the percentage increase in the Consumer Price Index of the corresponding Maximum Special Tax in effect in the previous Fiscal Year at the sole discretion of the Administrator.

“Special Tax Services” means services permitted under the Mello-Roos Community Facilities Act of 1982 including, without limitation, those services authorized to be funded by CFD 25-5M as set forth in the documents adopted by the Board at the time the CFD was formed.

“State” means the State of California.

“Taxable Property” means all Parcels within the boundary of the CFD pursuant to the Boundary Map which are not exempt from the Special Tax pursuant to Section E., below.

“Taxable Property Owner’s Association Property” means all Parcels of Property Owner’s Association Property that satisfies both of the following conditions: (i) based on reference to the maps used during the formation of the district, the Parcel was not anticipated to be Property Owner’s Association Property, as determined by the Administrator, and (ii) if the Parcel were to be exempt from the Special Tax because it is Property Owner’s Association Property, the County has determined that there would be a reduction in Special Tax revenues that would create a deficit in funding the Special Tax Requirement.

“Taxable Public Property” means all Parcels of Public Property that satisfies both of the following conditions: (i) based on reference to the maps used during the formation of the district, the Parcel was not anticipated to be Public Property, as determined by the Administrator, and (ii) if the Parcel were to be exempt from the Special Tax because it is Public Property, the County has determined that there would be a reduction in Special Tax revenues that would create a deficit in funding the Special Tax Requirement.

“Taxable Unit” means either a Dwelling Unit(s) or an Acre.

“Undeveloped Property” means all Parcels of Taxable Property not classified as Developed Property, Approved Property, Taxable Property Owner’s Association Property or Taxable Public Property.

B. ASSIGNMENT TO DEVELOPMENT CLASS

Each Fiscal Year, commencing with Fiscal Year 2025-2026, all Parcels of Taxable Property shall be classified as either Developed Property, Approved Property, Taxable Property Owner’s Association Property,

Taxable Public Property, or Undeveloped Property, and subject to the levy of Special Taxes in accordance with this Rate and Method of Apportionment as determined pursuant to Sections C. and D., below.

Parcels of Developed Property shall further be classified as Residential Property or Non-Residential Property. Parcels of Residential Property shall further be classified as Single Family Residential Property or Multi-family Residential Property.

C. MAXIMUM SPECIAL TAX RATES

1. Developed Property

The Maximum Special Tax that may be levied and escalated, as explained further in Section C.1. (a) below, in each Fiscal Year for each Parcel classified as Developed Property shall be determined by reference to Table 1 below.

**TABLE 1
MAXIMUM SPECIAL TAX RATES
DEVELOPED PROPERTY
FISCAL YEAR 2025-2026**

Development Class	Taxable Unit	Maximum Special Tax
Single Family Residential Property	DU	\$406
Multi-family Residential Property	Acre	\$1,987
Non-Residential Property	Acre	\$1,987

(a) Increase in the Maximum Special Tax

On each July 1, the Maximum Special Tax identified in Table 1 above, shall be increased annually, commencing July 1, 2026, by the amount equal to the greater of two percent (2%) or up to the percentage increase in the Consumer Price Index of the corresponding Maximum Special Tax in effect in the previous Fiscal Year at the sole discretion of the Administrator.

(b) Multiple Development Classes

In some instances, a Parcel of Developed Property may contain more than one Development Class. The Maximum Special Tax that may be levied on such Parcel shall be the sum of the Maximum Special Tax that can be levied for each Development Class located on that Parcel. For a Parcel that contains two or more different Development Classes or the Acreage of such Parcel shall be allocated to each type of property based on the amount of Acreage designated for each land use as determined by reference to the site plan approved for such Parcel. The Administrator's allocation to each Development Class shall be final.

Once a Maximum Special Tax has been assigned to a Parcel of Developed Property, the Maximum Special Tax shall not be reduced in future Fiscal Years regardless of changes in Development Class, Square Footage, or Acreage, unless a reduction in the Maximum Special Tax is approved by the Board for the entire CFD.

(c) Accessory Dwelling Unit(s)

Where an Accessory Dwelling Unit(s) is on the same Assessor Parcel Number as another Taxable Unit, the Accessory Dwelling Unit(s) is not considered a separate Taxable Unit and will not be added to the calculation of the Maximum Special Tax for a Parcel.

2. Approved Property

The Maximum Special Tax for each Parcel of Approved Property shall be equal to the product of the applicable Undeveloped Property Maximum Special Tax per Acre times the Acreage of such Parcel; provided, however, for a Parcel of Approved Property that is expected to become Single Family Residential Property as reasonably determined by the Administrator based on the Final Map for such Parcel, the Maximum Special Tax for such Parcel of Approved Property shall be calculated pursuant to Section C.1., as if such Parcel were already designated as Developed Property and classified as Single Family Residential Property.

The Maximum Special Tax for Approved Property shall be increased annually, commencing July 1, 2026, by the amount equal to the greater of two percent (2%) or up to the percentage increase in the Consumer Price Index of the corresponding Maximum Special Tax in effect in the previous Fiscal Year at the sole discretion of the Administrator.

3. Taxable Property Owner's Association Property and Taxable Public Property

The Maximum Special Tax for each Parcel of Taxable Property Owner's Association Property or Taxable Public Property shall be equal to the product of the applicable Undeveloped Property Maximum Special Tax per Acre times the Acreage of such Parcel.

The Maximum Special Tax for Taxable Property Owner's Association Property and Taxable Public Property shall be increased annually, commencing July 1, 2026, by the amount equal to the greater of two percent (2%) or up to the percentage increase in the Consumer Price Index of the corresponding Maximum Special Tax in effect in the previous Fiscal Year at the sole discretion of the Administrator.

4. Undeveloped Property

The Maximum Special Tax that may be levied and escalated for each Parcel classified as Undeveloped Property for each Parcel shall be \$1,987 per Acre.

The Maximum Special Tax for Undeveloped Property shall be increased annually, commencing July 1, 2026, by the amount equal to the greater of two percent (2%) or up to the percentage

increase in the Consumer Price Index of the corresponding Maximum Special Tax in effect in the previous Fiscal Year at the sole discretion of the Administrator.

5. Public Property and/or Property Owner's Association Property

The Maximum Special Tax that may be levied and escalated for each Parcel classified as Property Owner's Association Property and/or Public Property shall be \$0.00 per Acre. **There shall be no levy on Property Owner's Association Property and/or Public Property.**

D. METHOD OF APPORTIONMENT OF THE SPECIAL TAX

Commencing with Fiscal Year 2025-2026 and for each following Fiscal Year, the Administrator shall levy the Special Tax on all Taxable Property until the amount of Special Tax equals the Special Tax Requirement in accordance with the following steps:

First: The Special Tax shall be levied Proportionately on each Parcel of Developed Property at up to 100% of the applicable Maximum Special Tax as needed to satisfy the Special Tax Requirement;

Second: If additional moneys are needed to satisfy the Special Tax Requirement after the first step has been completed, the Special Tax shall be levied Proportionately on each Parcel of Approved Property at up to 100% of the Maximum Special Tax for Approved Property.

Third: If additional moneys are needed to satisfy the Special Tax Requirement after the first two steps have been completed, the Special Tax shall be levied Proportionately on each Parcel of Taxable Property Owner's Associations Property up to 100% of the applicable Maximum Special Tax for Taxable Property Owner's Association.

Fourth: If additional moneys are needed to satisfy the Special Tax requirement after the first three steps have been completed, the Special Tax shall be levied Proportionately on each Parcel of Taxable Public Property at up to 100% of the applicable Maximum Special Tax for Taxable Public Property.

Fifth: If additional moneys are needed to satisfy the Special Tax Requirement after the first four steps have been completed, the Special Tax shall be levied Proportionately on each Parcel of Undeveloped Property at up to 100% of the applicable Maximum Special Tax for Undeveloped Property.

Notwithstanding the above, under no circumstances will the Special Taxes levied in any Fiscal Year against any Parcel of Residential Property for which a Certificate of Occupancy has been issued be increased by more than ten percent (10%) as a result of a delinquency in the payment of the Special Tax applicable to any other Parcel above the amount that would have been levied in that Fiscal Year had there never been any such delinquency or default of the CFD.

E. EXEMPTIONS

The CFD shall not levy Special Taxes on Property Owner's Association Property (except Taxable Property Owner's Association Property) or Public Property (except Taxable Public Property) within the CFD.

F. MANNER OF COLLECTION

The Special Tax shall be collected in the same manner and at the same time as ordinary ad valorem property taxes and shall be subject to the same penalties, the same procedure, sale and lien priority in the case of delinquency; provided, however, that the Administrator may directly bill the Special Tax, may collect Special Taxes at a different time or in a different manner if necessary to meet the financial obligations of the CFD, and provided further that the CFD may covenant to foreclose and may actually foreclose on Parcels having delinquent Special Taxes as permitted by the Act.

G. APPEALS

Any taxpayer may file a written appeal of the Special Tax on his/her Parcel(s) with the Administrator, provided that the appellant is current in his/her payments of Special Taxes. During pendency of an appeal, all Special Taxes must be paid on or before the payment due date established when the levy was made. The appeal must specify the reasons why the appellant claims the Special Tax is in error. The Administrator shall review the appeal, meet with the appellant if the Administrator deems necessary, and advise the appellant of its determination. If the Administrator agrees with the appellant, the Administrator shall grant a credit to eliminate or reduce future Special Taxes on the appellant's Parcel(s). No refunds of previously paid Special Taxes shall be made.

The Administrator shall interpret this Rate and Method of Apportionment and make determinations relative to the annual levy and administration of the Special Tax and any taxpayer who appeals, as herein specified.

H. PREPAYMENT OF SPECIAL TAX

The Special Tax may not be prepaid.

I. TERM OF THE SPECIAL TAX

The Special Tax shall be levied annually in perpetuity unless terminated earlier by the County.

EXHIBIT C1

**NAMES OF THE OWNERS AND ASSESSOR'S PARCEL NUMBERS
OF THE REAL PROPERTY WITHIN DISTRICT**

GM Gabrych Family Limited Partnership

461-190-087	461-410-015	461-412-006	461-420-002	461-420-017	461-420-032	461-421-013	461-440-018
461-410-001	461-410-016	461-412-007	461-420-003	461-420-018	461-420-033	461-421-014	461-440-019
461-410-002	461-410-017	461-412-008	461-420-004	461-420-019	461-420-034	461-421-015	461-440-020
461-410-003	461-411-001	461-412-009	461-420-005	461-420-020	461-421-001	461-430-001	
461-410-004	461-411-002	461-412-010	461-420-006	461-420-021	461-421-002	461-430-002	
461-410-005	461-411-003	461-412-011	461-420-007	461-420-022	461-421-003	461-430-003	
461-410-006	461-411-004	461-412-012	461-420-008	461-420-023	461-421-004	461-430-004	
461-410-007	461-411-005	461-412-013	461-420-009	461-420-024	461-421-005	461-430-005	
461-410-008	461-411-006	461-412-014	461-420-010	461-420-025	461-421-006	461-430-006	
461-410-009	461-411-007	461-412-015	461-420-011	461-420-026	461-421-007	461-430-007	
461-410-010	461-412-001	461-412-016	461-420-012	461-420-027	461-421-008	461-430-008	
461-410-011	461-412-002	461-412-017	461-420-013	461-420-028	461-421-009	461-430-009	
461-410-012	461-412-003	461-412-018	461-420-014	461-420-029	461-421-010	461-430-010	
461-410-013	461-412-004	461-412-019	461-420-015	461-420-030	461-421-011	461-430-011	
461-410-014	461-412-005	461-420-001	461-420-016	461-420-031	461-421-012	461-440-017	

EXHIBIT C2

**NAMES OF THE OWNERS AND ASSESSOR'S PARCEL NUMBERS
OF THE REAL PROPERTY WITHIN DISTRICT**

Leon Ridge-Winchester L.P.

461-430-012	461-431-015	461-432-003	461-440-009	461-441-007	461-441-022
461-430-013	461-431-016	461-432-004	461-440-010	461-441-008	461-441-023
461-431-002	461-431-017	461-432-005	461-440-011	461-441-009	461-441-024
461-431-003	461-431-018	461-432-006	461-440-012	461-441-010	461-441-025
461-431-004	461-431-019	461-432-007	461-440-013	461-441-011	461-441-026
461-431-005	461-431-020	461-432-008	461-440-014	461-441-012	461-441-027
461-431-006	461-431-021	461-432-009	461-440-015	461-441-013	461-441-028
461-431-007	461-431-022	461-440-001	461-440-016	461-441-014	461-441-029
461-431-008	461-431-023	461-440-002	461-440-021	461-441-015	461-441-030
461-431-009	461-431-024	461-440-003	461-441-001	461-441-016	461-441-031
461-431-010	461-431-025	461-440-004	461-441-002	461-441-017	
461-431-011	461-431-026	461-440-005	461-441-003	461-441-018	
461-431-012	461-431-027	461-440-006	461-441-004	461-441-019	
461-431-013	461-432-001	461-440-007	461-441-005	461-441-020	
461-431-014	461-432-002	461-440-008	461-441-006	461-441-021	

3 RESOLUTION NO. 2026-005

4 A RESOLUTION OF THE BOARD OF SUPERVISORS OF THE COUNTY OF RIVERSIDE
5 DECLARING THE RESULTS OF CONSOLIDATED SPECIAL ELECTIONS WITHIN COMMUNITY
6 FACILITIES DISTRICT NO. 25-5M (LEON RIDGE)
7 OF THE COUNTY OF RIVERSIDE

8
9 WHEREAS, on January 27, 2026 the Board of Supervisors (the “Board of Supervisors”) of
10 the County of Riverside adopted Resolution No. 2026-004 forming Community Facilities District No. 25-
11 5M (Leon Ridge) of the County of Riverside (the “Community Facilities District”) and calling a special
12 election for submitting to the voters propositions with respect to the levy of an annual special tax within
13 the Community Facilities District and establishing an appropriations limit for the Community Facilities
14 District; and

15 WHEREAS, the Board of Supervisors has received a statement from the Director of the
16 Office of Economic Development, who was appointed to serve as the election official of the election (the
17 “Election Official”) pursuant to Resolution No. 2026-004, with respect to the canvass of the ballots
18 returned in and the results of the consolidated special elections, certifying that more than two-thirds of the
19 votes cast upon the propositions submitted to the voters within the Community Facilities District were
20 cast in favor of the propositions.

21 NOW, THEREFORE, BE IT RESOLVED, FOUND AND ORDERED by the Board of
22 Supervisors of the County of Riverside, in regular session assembled on February 3, 2026, as follows:

23 Section 1. All of the above recitals are true and correct.

24 Section 2. Findings. The Board of Supervisors finds that: (i) there were no persons
25 registered to vote within the boundaries of the Community Facilities District at the time of the close of the
26 public or protest hearing on January 27, 2026, and, pursuant to Section 53326 of the California
27 Government Code (“Section 53326”), the vote in the consolidated special elections for the Community
28 Facilities District was, therefore, to be by the landowners owning land within the Community Facilities

APPROVED COUNTY COUNSEL
STEPHANIE K. NELSON
DATE 1/27/26

1 District, with each landowner having one vote for each acre or portion of an acre of land that he or she
2 owned within the Community Facilities District which would have been subject to the special tax if levied
3 at the time of the consolidated special elections; (ii) pursuant to Section 53326 and Resolution No. 2026-
4 004, the Election Official caused the ballots for the consolidated special elections for the Community
5 Facilities District to be delivered to the owners of the property within the Community Facilities District
6 (the "Property Owners"); (iii) the Property Owners waived the time limits for holding the consolidated
7 special elections and the election dates specified in Section 53326, and consented to the calling and
8 holding of the consolidated special elections on January 27, 2026; (iv) the consolidated special elections
9 have been properly conducted in accordance with all statutory requirements and the provisions of
10 Resolution No. 2026-004; (v) pursuant to Section 53326, based on the acreage of their land ownership
11 within the Community Facilities District, the Property Owners, as the owners of all of the property within
12 such Community Facilities District, were entitled to 52 votes in the consolidated special elections; (vi) the
13 ballots for the consolidated special elections were returned by the Property Owners to the Election
14 Official prior to 9:00 a.m. on January 27, 2026; (vii) the ballots returned to the Election Official by the
15 Property Owners voted all votes to which they were entitled in favor of all propositions set forth therein;
16 (viii) more than two-thirds of the votes cast in the consolidated special elections on each proposition were
17 cast in favor thereof, and pursuant to Section 53328 of the California Government Code, all such
18 propositions carried; (ix) the Board of Supervisors, as the legislative body of the Community Facilities
19 District, is therefore authorized to annually levy special taxes on taxable property in the Community
20 Facilities District, in amounts sufficient to fund, pay for, and finance authorized maintenance of
21 Developer-installed and County-required infrastructure, particularly those listed in Exhibit A attached
22 herein (as specified and reflected in the Resolution of Intention, the Resolution of Formation, and the Rate
23 and Method of Apportionment of Special Tax) and to pay expenses incidental thereto and incidental to the
24 levy and collection of the special taxes, so long as the special taxes are needed to fund such services, at
25 the special tax rates and pursuant to the method of apportioning the special taxes set forth in Exhibit B to
26 Resolution No. 2025-297; and (x) an appropriations limit for the Community Facilities District has been
27 established in the amount of \$4,000,000.

1 Section 3. Declaration of Results. All votes voted in the consolidated special elections on
2 (i) the proposition with respect to the annual levy of special taxes on taxable property within the
3 Community Facilities District, consistent with the Rate and Method of Apportionment, in amounts
4 sufficient to fund, pay for, and finance authorized maintenance of Developer-installed and County-
5 required infrastructure, particularly those listed in Exhibit A attached herein, and to pay expenses
6 incidental thereto and expenses incidental to the levy and collection of the special taxes, so long as the
7 special taxes are needed to fund such services and (ii) the proposition with respect to establishing an
8 appropriations limit for the Community Facilities District in the amount of \$4,000,000 were voted in
9 favor thereof; and both such propositions carried.

10 Section 4. Effect of Elections. The effect of the results of the consolidated special
11 elections, as specified in Section 3 hereof, is that the Board of Supervisors, as the legislative body of the
12 Community Facilities District, is authorized to annually levy special taxes on taxable property within the
13 Community Facilities District in amounts sufficient to fund, pay for, and finance authorized maintenance
14 of Developer-installed and County-required infrastructure, particularly those listed in Exhibit A attached
15 herein, and to pay expenses incidental thereto and expenses incidental to the levy and collection of the
16 special taxes, so long as the special taxes are needed to fund such services in accordance with the Rate
17 and Method of Apportionment set forth in Exhibit B to Resolution No. 2026-004 adopted by the Board of
18 Supervisors on January 27, 2026; and that an appropriations limit of \$4,000,000 has been established for
19 the Community Facilities District.

20 Section 5. Notice of Special Tax Lien. The Clerk is authorized and directed to record a
21 notice of special tax lien as provided in Section 53328.3 of the California Government Code and Section
22 3114.5 of the California Streets and Highways Code.

23 ///

24 ///

25

26

27

28

1
2
3
4
5
6
7
8
9
10
11
12
13
14
15
16
17
18
19
20
21
22
23
24
25
26
27
28

ADOPTED, SIGNED AND APPROVED this 3rd day of February 2026, by the Board of Supervisors of the County of Riverside.

//
//

Karen S. Spiegel

Chair of the Board of Supervisors
KAREN SPIEGEL

ATTEST:
Kimberley A. Rector
Clerk to the Board of Supervisors

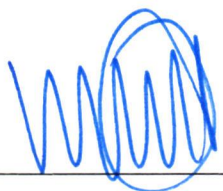
By:  _____
Deputy

2
3 RESOLUTION NO. 2026-005

4 A RESOLUTION OF THE BOARD OF SUPERVISORS OF THE COUNTY OF RIVERSIDE
5 DECLARING THE RESULTS OF CONSOLIDATED SPECIAL ELECTIONS
6 WITHIN COMMUNITY FACILITIES DISTRICT NO. 25-5M (LEON RIDGE)
7 OF THE COUNTY OF RIVERSIDE

8 ROLL CALL:

9 Ayes: Medina, Spiegel, Washington, Perez, and Gutierrez

10 Nays: None

11 Absent: None

12 Abstain: None

13
14 The foregoing is certified to be a true copy of a resolution duly adopted by said Board of
15 Supervisors on the date therein set forth.

16 KIMBERLY A. RECTOR, Clerk of said Board

17
18
19 By:  _____

20 Deputy

1 **EXHIBIT A**

2 **SERVICES AND INCIDENTAL EXPENSES**

3
4 **Services**

5 The services which may be funded with proceeds of the special tax of CFD No. 25-5M, as provided by
6 Section 53313 of the Act, will include all cost attributable to the following services:

- 7
- 8 i) Street light maintenance, which includes energy charges, operation, maintenance,
9 and administration of street lighting located within the designated boundaries of the
10 CFD; and
 - 11 ii) Administration, inspection, and maintenance of all stormwater facilities and BMPs
12 to include: water quality basins, fossil filters, basin forebays, and all other
13 NPDES/WQMP/BMP related devices and structures as approved and accepted by
14 the Community Facilities District; administration includes, but is not limited to,
15 quality control and assurance of inspections and maintenance, general contract
16 management, scheduling of inspections and maintenance, and general oversight of
17 all NPDES/WQMP/BMP operations; inspection includes, but is not limited to,
18 travel time, visual inspection process and procedures for functionality, GPS
19 location recording, assurance of proper vegetation, functioning irrigation, and
20 citing operational or structural deficiencies, erosion, trash, silt and sediment build-
21 up; and maintenance includes, but is not limited to, repair or replacement of any
22 deficiencies noted during inspection, weed control and abatement, trash removal,
23 and healthy upkeep of required plant materials within the boundaries of the CFD.
- 24
25
26
27
28

1 **Incidental Expenses**

2 The incidental expenses proposed to be incurred include the following:

3
4
5
6
7
8
9
10
11
12
13
14
15
16
17
18
19
20
21
22
23
24
25
26
27
28

- (i) The costs associated with the creation of the Community Facilities District, determination of the amount of taxes, collection of taxes, including litigation expenses, if any, costs for processing payment of taxes, or other administrative costs otherwise incurred in order to carry out the authorized purposes of the Community Facilities District; and
- (ii) Any other expenses incidental to the performance and inspection of the authorized Services.

1 of a special tax within the District to fund the Services, subject to voter approval, establishing an annual
2 appropriations limit of \$4,000,000 for the District, subject to voter approval, and calling a special election
3 for the District for January 27, 2026 on the propositions to levy a special tax within the District and to
4 establish an appropriations limit for the District.

5 d. Pursuant to the terms of the Resolution of Formation and the provisions of
6 the Act, said special election was held on January 27, 2026. Each of the propositions was approved by
7 more than two-thirds of the votes cast at said special election.

8 e. Pursuant to the Act, the Board of Supervisors is the *ex officio* legislative
9 body (the “Legislative Body”) of the District.

10 Section 2. PURPOSE. The purpose of this ordinance is to provide for the levy of a
11 special tax within the District.

12 Section 3. AUTHORITY. This ordinance is adopted pursuant to Sections 53328 and
13 53340 of the California Government Code, which authorizes counties to adopt ordinances to levy special
14 taxes at the rate and in accordance with the method of apportionment specified in the resolution of
15 formation of the community facilities district.

16 Section 4. LEVY OF SPECIAL TAXES.

17 a. By the passage of this Ordinance, the Board of Supervisors hereby
18 authorizes and levies special taxes within the District pursuant to Sections 53328 and 53340 of the
19 Government Code, at the rate and in accordance with the method of apportionment (the “Rate and
20 Method”) set forth in the Resolution of Formation and attached as Exhibit A hereto and made a part
21 hereof. The special taxes are hereby levied commencing in the fiscal year 2025-2026 and in each fiscal
22 year thereafter for the period necessary to satisfy the Special Tax Requirement (as defined in the Rate and
23 Method) and until action is taken by the Board of Supervisors, acting as the Legislative Body of the
24 District, to dissolve the District.

25 b. The Board of Supervisors, acting as the Legislative Body of the District, is
26 hereby authorized and directed each fiscal year to determine, or cause to be determined, the specific
27 special tax rate and amount to be levied for the next ensuing fiscal year for each parcel of real property
28

1 within the District, in the manner and as provided in the Rate and Method.

2 c. All of the collections of the special tax shall be used as provided for in the
3 Act, the Rate and Method and the Resolution of Formation, including, but not limited to, to fund, pay for,
4 and finance authorized administration, inspection, and maintenance of services described in Exhibit A
5 attached hereto, and to pay expenses incidental thereto, so long as the special taxes are needed to fund
6 such services; to replenish the reserve fund for the District; to pay the costs of administering the District,
7 and to pay the costs of collecting and administering the special tax.

8 d. The special taxes shall be collected from time to time as necessary to meet
9 the financial obligations of the District on the secured real property tax roll in the same manner as
10 ordinary *ad valorem* taxes are collected, or may be collected in such other manner as set forth in the Rate
11 and Method. The special taxes shall have the same lien priority, and shall be subject to the same penalties
12 and the same procedure and sale in cases of delinquency as provided for *ad valorem* taxes. The Board of
13 Supervisors, acting as the Legislative Body of the District, is hereby authorized and directed to take all
14 actions necessary in order to affect the proper billing and collection of the special tax, so that the special
15 tax shall be levied and collected in sufficient amounts and at the times necessary to satisfy the financial
16 obligations of the District in each fiscal year.

17 e. Notwithstanding the foregoing, the Board of Supervisors, acting as the
18 Legislative Body of the District, may collect, or cause to be collected, one or more installments of the
19 special taxes by means of direct billing by the District of the property owners within the District if, in the
20 judgment of the Legislative body, such means of collection will reduce the burden of administering the
21 District or is otherwise appropriate in the circumstances. In such event, the special taxes shall become
22 delinquent if not paid when due as set forth in any such respective billing to the property owners.

23 Section 5. EXEMPTIONS. Properties or entities of the state, federal or other local
24 governments shall be exempt from any levy of the special taxes, to the extent set forth in the Rate and
25 Method. In no event shall the special taxes be levied on any parcel within the District in excess of the
26 maximum tax specified in the Rate and Method.

27 Section 6. SEVERABILITY. If for any reason any portion of this ordinance is found
28 to be invalid, or if the special tax is found inapplicable to any particular parcel within the District, by a

1 court of competent jurisdiction, the balance of this ordinance and the application of the special tax to the
2 remaining parcels within the District shall not be affected.

3 Section 7. EFFECTIVE DATE. This ordinance relating to the levy and collection of
4 special taxes in the District shall take effect immediately upon its passage in accordance with the
5 provisions of Section 25123(c) of the Government Code. The Chair of the Board of Supervisors shall sign
6 this ordinance, and the Clerk of the Board of Supervisors shall attest to the Chair's signature and then
7 cause a summary of the same to be published within 15 days after its passage at least once in *The Press-*
8 *Enterprise*, a newspaper of general circulation published and circulated in the area of the District.

9
10 BOARD OF SUPERVISORS OF THE COUNTY
11 OF RIVERSIDE, STATE OF CALIFORNIA
12

13 By: _____

14 Chair of the Board of Supervisors

15 ATTEST:

16 CLERK OF THE BOARD:

17
18 By: _____

19 Deputy

20 (SEAL)

21
22 APPROVED AS TO FORM

23
24 By:  _____

25 Stephanie Nelson

26 Deputy County Counsel
27
28

1 **EXHIBIT A**

2
3 **SERVICES AND INCIDENTAL EXPENSES**

4
5 **Services**

6 The services which may be funded with proceeds of the special tax of CFD No. 25-5M, as provided by
7 Section 53313 of the Act, will include all costs attributable to the following services:

- 8 (i) Street lighting maintenance, which includes energy charges, operation, maintenance, and
9 administration of street lighting located within the designated boundaries of the CFD; and
10 (ii) Administration, inspection, and maintenance of all stormwater facilities and BMPs to
11 include: water quality basins, fossil filters, basin forebays, and all other
12 NPDES/WQMP/BMP related devices and structures as approved and accepted by the
13 Community Facilities District; administration includes, but is not limited to, quality control
14 and assurance of inspections and maintenance, general contract management, scheduling of
15 inspections and maintenance, and general oversight of all NPDES/WQMP/BMP
16 operations; inspection includes, but is not limited to, travel time, visual inspection process
17 and procedures for functionality, GPS location recording, assurance of proper vegetation,
18 functioning irrigation, and citing operational or structural deficiencies, erosion, trash, silt
19 and sediment build-up; and maintenance includes, but is not limited to, repair or
20 replacement of any deficiencies noted during inspection, weed control and abatement, trash
21 removal, and healthy upkeep of required plant materials within the boundaries of the CFD.
22
23
24
25
26
27
28

1 **Incidental Expenses**

2 The incidental expenses proposed to be incurred include the following:

- 3 (i) The cost associated with the creation of the Community Facilities District, determination
4 of the amount of taxes, collection of taxes, including litigation expenses, if any, costs for
5 processing payment of taxes, or other administrative costs otherwise incurred in order to
6 carry out the authorized purposes of the Community Facilities District; and
7 (ii) Any other expenses incidental to the performance and inspection of the authorized
8 Services.

9
10
11
12
13
14
15
16
17
18
19
20
21
22
23
24
25
26
27
28

**RATE AND METHOD OF APPORTIONMENT OF SPECIAL TAX FOR
COMMUNITY FACILITIES DISTRICT NO. 25-5M (LEON RIDGE)
OF THE COUNTY OF RIVERSIDE
STATE OF CALIFORNIA**

A Special Tax (all capitalized terms are defined in Section A. Definitions, below) shall be applicable to each Parcel of Taxable Property located within the boundaries of Community Facilities District No. 25-5M (Leon Ridge) (the “CFD 25-5M” or “CFD”; defined below). The amount of Special Tax to be levied on a Parcel in each Fiscal Year, (defined below), commencing in Fiscal Year 2025-2026, shall be determined by the Riverside County Board of Supervisors, acting in its capacity as the legislative body of the CFD by applying the appropriate Special Tax as set forth in Sections B., C., and D., below. All property within the CFD, unless exempted by law or by the provisions of Section E., below, shall be taxed for the purposes, to the extent, and in the manner herein provided.

A. DEFINITIONS

The terms hereinafter set forth have the following meanings:

“Accessory Dwelling Unit(s)” means a residential unit of limited size, as defined in California Government Code Section 65852.2 that shares an Assessor’s Parcel Number with Single Family Residential Property.

“Acre” or “Acreage” means the land area of a Parcel as shown on the most recent Assessor’s Parcel Map, or if the land area is not shown on the Assessor’s Parcel Map, the land area shown on the applicable Final Map, condominium plan, or other recorded County map. If the preceding maps are not available, the Acreage of an Assessor’s Parcel Number may be determined utilizing Geographic Information System. The square footage of a Parcel is equal to the Acreage of such Parcel multiplied by 43,560.

“Act” means the Mello-Roos Community Facilities Act of 1982, as amended, being Chapter 2.5 of Part 1 of Division 2 of Title 5 of the Government Code of the State of California.

“Administrative Expenses” means all actual or reasonably estimated costs and expenses of the CFD that are chargeable or allocable to carry out the duties of the Administrator of the CFD as allowed by the Act, which shall include without limitation, all costs and expenses arising out of or resulting from the annual levy and collection of the Special Tax (whether by the County or designee thereof, or both), any litigation or appeal involving the CFD, and other administrative expenses of the County or designee thereof, or both, directly related to the CFD. Administrative Expenses shall also include amounts estimated or advanced by the County or CFD for attorney’s fees and other costs related to commencing and pursuing to completion any foreclosure as a result of delinquent Special Taxes.

“Administrator” means an official of the County, or designee thereof, responsible for determining the Special Tax Requirement and providing for the levy and collection of the Special Taxes.

“Approved Property” means all Parcels of Taxable Property: (i) that are included in a Final Map that was recorded prior to the January 1st preceding the Fiscal Year in which the Special Tax is being levied, and (ii) that have not been issued a Building Permit(s) prior to the April 1st preceding the Fiscal Year in which the Special Tax is being levied.

“Assessor” means the Assessor of the County.

“Assessor’s Parcel Map” means an official map of the Assessor of the County designating a Parcel by an Assessor’s Parcel Number.

“Assessor’s Parcel Number” means the number assigned to a lot or Parcel for purposes of identification as determined from an Assessor Parcel Map.

“Board” means Riverside County Board of Supervisors, acting in its capacity as the legislative body of the CFD.

“Boundary Map” means a recorded map of the CFD which indicates by a boundary line the extent of the territory within the CFD identified to be subject to the levy of Special Taxes.

“Building Permit(s)” means a legal document(s) issued by a local agency that allows for new vertical construction of a building or buildings.

“Certificate of Occupancy” means a certificate of occupancy issued by the County in accordance with all applicable ordinances, regulations, and rule of the County and State law.

“CFD” or **“CFD 25-5M”** means Community Facilities District No. 25-5M (Leon Ridge) of the County of Riverside.

“Consumer Price Index” means the cumulative percentage increase in the Consumer Price Index (CPI) published by the U.S. Bureau of Labor Statistics for All Urban Consumers in the Riverside-San Bernardino-Ontario Area, as it stands in March of each year over the preceding Fiscal Year. In the event this index ceases to be published, the Consumer Price Index shall be another index as determined by the Administrator that is reasonably comparable to the Consumer Price Index for the Riverside-San Bernardino-Ontario Area. In the event that the percentage change in the annualized CPI is negative, the Special Tax shall not be decreased.

“County” means the County of Riverside, California.

“Developed Property” means for each Fiscal Year, all Parcels of Taxable Property: (i) that are included in a Final Map that was recorded prior to January 1st preceding the Fiscal Year in which the Special Tax is being levied, and (ii) for which a Building Permit(s) for vertical construction has been issued prior to April 1st preceding the Fiscal Year in which the Special Tax is being levied.

“Development Class” means either Developed Property, Approved Property, Taxable Property Owner’s Association Property, Taxable Public Property, or Undeveloped property.

“Dwelling Unit(s)” or **“(DU)”** means a residential building(s) that is used or intended to be used as a domicile by one or more persons, as determined by the Administrator.

“Exempt Property” means any Parcel which is exempt from Special Taxes pursuant to Section E., below.

“Final Map” means a subdivision of property by recordation of a tract map, parcel map or lot line adjustment, pursuant to the Subdivision Map Act (California Government Code Section 66410 *et seq.*) or recordation of a condominium plan pursuant to California Civil Code 4200 that creates individual lots for which Building Permit(s) may be issued without further subdivision.

“Fiscal Year” means the 12-month period starting on July 1 of any calendar year and ending the following June 30.

“Maximum Special Tax” means for each Parcel in each Fiscal Year, the greatest amount of Special Tax, determined in accordance with Section C., below, which may be levied on such Parcel in each Fiscal Year.

“Multi-family Residential Property” means all Parcels of Residential Property that consist of a two or more buildings comprised of attached Dwelling Units available for rental by the general public, not for sale to an end user, and under common management.

“Non-Residential Property” means all Parcels of Developed Property for which a Building Permit(s) was issued permitting the construction of one or more non-residential structures.

“Parcel” means a lot or parcel within the CFD shown on an Assessor’s Parcel Map with an assigned Assessor’s Parcel Number valid as of July 1st for the Fiscal Year for which the Special Tax is being levied.

“Property Owner’s Association Property” means all Parcels which have been conveyed, dedicated to, or irrevocably offered for dedication to a home-owner’s association, condominium owner’s association or any master or sub-association, prior to April 1st preceding the Fiscal Year in which the Special Tax is being levied.

“Proportionately” means for each Parcel of Taxable Property that are Developed Property, Approved Property, Taxable Property Owner’s Association Property, Taxable Public Property or Undeveloped Property, that the ratio of the actual Special Tax levy to Maximum Special Tax is the same for all Parcels assigned within each Development Class.

“Public Property” means all Parcels which, as of April 1st preceding the Fiscal Year in which the Special Tax is being levied, are (i) used for rights-of-way or any other purpose and is owned by, dedicated to, or irrevocably offered for dedication to the federal government, the State, the County, City or any other public agency, provided, however, that any property leased by a public agency to a private entity and subject to taxation under Section 53340.1 of the Act shall be taxed and classified according to its use; or (ii) encumbered by an unmanned utility easement making impractical its utilization for other than the purpose set forth in the easement.

“Residential Property” means all Parcels of Developed Property for which a Building Permit(s) has been issued permitting the construction of one or more residential Dwelling Units.

“Single Family Residential Property” means all Parcels of Residential Property, other than Multi-family Residential Property.

“Special Tax(es)” means the amount to be levied in each Fiscal Year on each Parcel of Taxable Property in accordance with Section D., below to fund the Special Tax Requirement.

“Special Tax Requirement(s)” means that amount required in any Fiscal Year to: (i) pay the estimated cost of Special Tax Services such Fiscal Year as determined by the County; (ii) fund the Special Tax Reserve Fund to the extent that the inclusion of such amount does not increase the Special Tax for Undeveloped Property unless requested by the developer or the amount needed to fund the Special Tax Reserve Fund up to the Special Tax Reserve Fund Requirement; (iii) pay Administrative Expenses; (iv) pay any anticipated Special Tax delinquencies based on actual delinquencies from the prior Fiscal Year outstanding at the time

the annual Special Tax levy is determined; and (v) less a credit for funds available to reduce the annual Special Tax levy at the sole discretion of the Administrator.

“Special Tax Reserve Fund Requirement” means an amount up to 150% of the anticipated annual cost of Special Tax Services of \$73,892. The Special Tax Reserve Fund Requirement shall be increased annually, commencing July 1, 2026, by the amount equal to the greater of two percent (2%) or up to the percentage increase in the Consumer Price Index of the corresponding Maximum Special Tax in effect in the previous Fiscal Year at the sole discretion of the Administrator.

“Special Tax Services” means services permitted under the Mello-Roos Community Facilities Act of 1982 including, without limitation, those services authorized to be funded by CFD 25-5M as set forth in the documents adopted by the Board at the time the CFD was formed.

“State” means the State of California.

“Taxable Property” means all Parcels within the boundary of the CFD pursuant to the Boundary Map which are not exempt from the Special Tax pursuant to Section E., below.

“Taxable Property Owner’s Association Property” means all Parcels of Property Owner’s Association Property that satisfies both of the following conditions: (i) based on reference to the maps used during the formation of the district, the Parcel was not anticipated to be Property Owner’s Association Property, as determined by the Administrator, and (ii) if the Parcel were to be exempt from the Special Tax because it is Property Owner’s Association Property, the County has determined that there would be a reduction in Special Tax revenues that would create a deficit in funding the Special Tax Requirement.

“Taxable Public Property” means all Parcels of Public Property that satisfies both of the following conditions: (i) based on reference to the maps used during the formation of the district, the Parcel was not anticipated to be Public Property, as determined by the Administrator, and (ii) if the Parcel were to be exempt from the Special Tax because it is Public Property, the County has determined that there would be a reduction in Special Tax revenues that would create a deficit in funding the Special Tax Requirement.

“Taxable Unit” means either a Dwelling Unit(s) or an Acre.

“Undeveloped Property” means all Parcels of Taxable Property not classified as Developed Property, Approved Property, Taxable Property Owner’s Association Property or Taxable Public Property.

B. ASSIGNMENT TO DEVELOPMENT CLASS

Each Fiscal Year, commencing with Fiscal Year 2025-2026, all Parcels of Taxable Property shall be classified as either Developed Property, Approved Property, Taxable Property Owner’s Association Property, Taxable Public Property, or Undeveloped Property, and subject to the levy of Special Taxes in accordance with this Rate and Method of Apportionment as determined pursuant to Sections C. and D., below.

Parcels of Developed Property shall further be classified as Residential Property or Non-Residential Property. Parcels of Residential Property shall further be classified as Single Family Residential Property or Multi-family Residential Property.

C. MAXIMUM SPECIAL TAX RATES

1. Developed Property

The Maximum Special Tax that may be levied and escalated, as explained further in Section C.1. (a) below, in each Fiscal Year for each Parcel classified as Developed Property shall be determined by reference to Table 1 below.

**TABLE 1
MAXIMUM SPECIAL TAX RATES
DEVELOPED PROPERTY
FISCAL YEAR 2025-2026**

Development Class	Taxable Unit	Maximum Special Tax
Single Family Residential Property	DU	\$406
Multi-family Residential Property	Acre	\$1,987
Non-Residential Property	Acre	\$1,987

(a) Increase in the Maximum Special Tax

On each July 1, the Maximum Special Tax identified in Table 1 above, shall be increased annually, commencing July 1, 2026, by the amount equal to the greater of two percent (2%) or up to the percentage increase in the Consumer Price Index of the corresponding Maximum Special Tax in effect in the previous Fiscal Year at the sole discretion of the Administrator.

(b) Multiple Development Classes

In some instances, a Parcel of Developed Property may contain more than one Development Class. The Maximum Special Tax that may be levied on such Parcel shall be the sum of the Maximum Special Tax that can be levied for each Development Class located on that Parcel. For a Parcel that contains two or more different Development Classes or the Acreage of such Parcel shall be allocated to each type of property based on the amount of Acreage designated for each land use as determined by reference to the site plan approved for such Parcel. The Administrator's allocation to each Development Class shall be final.

Once a Maximum Special Tax has been assigned to a Parcel of Developed Property, the Maximum Special Tax shall not be reduced in future Fiscal Years regardless of changes in Development Class, Square Footage, or Acreage, unless a reduction in the Maximum Special Tax is approved by the Board for the entire CFD.

(c) Accessory Dwelling Unit(s)

Where an Accessory Dwelling Unit(s) is on the same Assessor Parcel Number as another Taxable Unit, the Accessory Dwelling Unit(s) is not considered a separate Taxable Unit and will not be added to the calculation of the Maximum Special Tax for a Parcel.

2. **Approved Property**

The Maximum Special Tax for each Parcel of Approved Property shall be equal to the product of the applicable Undeveloped Property Maximum Special Tax per Acre times the Acreage of such Parcel; provided, however, for a Parcel of Approved Property that is expected to become Single Family Residential Property as reasonably determined by the Administrator based on the Final Map for such Parcel, the Maximum Special Tax for such Parcel of Approved Property shall be calculated pursuant to Section C.1., as if such Parcel were already designated as Developed Property and classified as Single Family Residential Property.

The Maximum Special Tax for Approved Property shall be increased annually, commencing July 1, 2026, by the amount equal to the greater of two percent (2%) or up to the percentage increase in the Consumer Price Index of the corresponding Maximum Special Tax in effect in the previous Fiscal Year at the sole discretion of the Administrator.

3. **Taxable Property Owner's Association Property and Taxable Public Property**

The Maximum Special Tax for each Parcel of Taxable Property Owner's Association Property or Taxable Public Property shall be equal to the product of the applicable Undeveloped Property Maximum Special Tax per Acre times the Acreage of such Parcel.

The Maximum Special Tax for Taxable Property Owner's Association Property and Taxable Public Property shall be increased annually, commencing July 1, 2026, by the amount equal to the greater of two percent (2%) or up to the percentage increase in the Consumer Price Index of the corresponding Maximum Special Tax in effect in the previous Fiscal Year at the sole discretion of the Administrator.

4. **Undeveloped Property**

The Maximum Special Tax that may be levied and escalated for each Parcel classified as Undeveloped Property for each Parcel shall be \$1,987 per Acre.

The Maximum Special Tax for Undeveloped Property shall be increased annually, commencing July 1, 2026, by the amount equal to the greater of two percent (2%) or up to the percentage increase in the Consumer Price Index of the corresponding Maximum Special Tax in effect in the previous Fiscal Year at the sole discretion of the Administrator.

5. **Public Property and/or Property Owner's Association Property**

The Maximum Special Tax that may be levied and escalated for each Parcel classified as Property Owner's Association Property and/or Public Property shall be \$0.00 per Acre. **There shall be no levy on Property Owner's Association Property and/or Public Property.**

D. **METHOD OF APPORTIONMENT OF THE SPECIAL TAX**

Commencing with Fiscal Year 2025-2026 and for each following Fiscal Year, the Administrator shall levy the Special Tax on all Taxable Property until the amount of Special Tax equals the Special Tax Requirement in accordance with the following steps:

First: The Special Tax shall be levied Proportionately on each Parcel of Developed Property at up to 100% of the applicable Maximum Special Tax as needed to satisfy the Special Tax Requirement;

Second: If additional moneys are needed to satisfy the Special Tax Requirement after the first step has been completed, the Special Tax shall be levied Proportionately on each Parcel of Approved Property at up to 100% of the Maximum Special Tax for Approved Property.

Third: If additional moneys are needed to satisfy the Special Tax Requirement after the first two steps have been completed, the Special Tax shall be levied Proportionately on each Parcel of Taxable Property Owner's Associations Property up to 100% of the applicable Maximum Special Tax for Taxable Property Owner's Association.

Fourth: If additional moneys are needed to satisfy the Special Tax requirement after the first three steps have been completed, the Special Tax shall be levied Proportionately on each Parcel of Taxable Public Property at up to 100% of the applicable Maximum Special Tax for Taxable Public Property.

Fifth: If additional moneys are needed to satisfy the Special Tax Requirement after the first four steps have been completed, the Special Tax shall be levied Proportionately on each Parcel of Undeveloped Property at up to 100% of the applicable Maximum Special Tax for Undeveloped Property.

Notwithstanding the above, under no circumstances will the Special Taxes levied in any Fiscal Year against any Parcel of Residential Property for which a Certificate of Occupancy has been issued be increased by more than ten percent (10%) as a result of a delinquency in the payment of the Special Tax applicable to any other Parcel above the amount that would have been levied in that Fiscal Year had there never been any such delinquency or default of the CFD.

E. EXEMPTIONS

The CFD shall not levy Special Taxes on Property Owner's Association Property (except Taxable Property Owner's Association Property) or Public Property (except Taxable Public Property) within the CFD.

F. MANNER OF COLLECTION

The Special Tax shall be collected in the same manner and at the same time as ordinary ad valorem property taxes and shall be subject to the same penalties, the same procedure, sale and lien priority in the case of delinquency; provided, however, that the Administrator may directly bill the Special Tax, may collect Special Taxes at a different time or in a different manner if necessary to meet the financial obligations of the CFD, and provided further that the CFD may covenant to foreclose and may actually foreclose on Parcels having delinquent Special Taxes as permitted by the Act.

G. APPEALS

Any taxpayer may file a written appeal of the Special Tax on his/her Parcel(s) with the Administrator, provided that the appellant is current in his/her payments of Special Taxes. During pendency of an appeal, all Special Taxes must be paid on or before the payment due date established when the levy was made. The appeal must specify the reasons why the appellant claims the Special Tax is in error. The Administrator shall review the appeal, meet with the appellant if the Administrator deems necessary, and advise the appellant of its determination. If the Administrator agrees with the appellant, the Administrator shall

grant a credit to eliminate or reduce future Special Taxes on the appellant's Parcel(s). No refunds of previously paid Special Taxes shall be made.

The Administrator shall interpret this Rate and Method of Apportionment and make determinations relative to the annual levy and administration of the Special Tax and any taxpayer who appeals, as herein specified.

H. PREPAYMENT OF SPECIAL TAX

The Special Tax may not be prepaid.

I. TERM OF THE SPECIAL TAX

The Special Tax shall be levied annually in perpetuity unless terminated earlier by the County.

EXHIBIT A

SERVICES AND INCIDENTAL EXPENSES

Services

The services which may be funded with proceeds of the special tax of CFD No. 25-5M, as provided by Section 53313 of the Act, will include all costs attributable to the following services:

- i. Street light maintenance, which includes energy charges, operation, maintenance, and administration of street lighting located within the designated boundaries of the CFD; and
- ii. Administration, inspection, and maintenance of all stormwater facilities and BMPs to include: water quality basins, fossil filters, basin forebays, and all other NPDES/WQMP/BMP related devices and structures as approved and accepted by the Community Facilities District; administration includes, but is not limited to, quality control and assurance of inspections and maintenance, general contract management, scheduling of inspections and maintenance, and general oversight of all NPDES/WQMP/BMP operations; inspection includes, but is not limited to, travel time, visual inspection process and procedures for functionality, GPS location recording, assurance of proper vegetation, functioning irrigation, and citing operational or structural deficiencies, erosion, trash, silt and sediment build-up; and maintenance includes, but is not limited to, repair or replacement of any deficiencies noted during inspection, weed control and abatement, trash removal, and healthy upkeep of required plant materials within the boundaries of the CFD.

Incidental Expenses

The incidental expenses proposed to be incurred include the following:

- i. The cost associated with the creation of the Community Facilities District, determination of the amount of taxes, collection of taxes, including litigation expenses, if any, costs for processing payment of taxes, or other administrative costs otherwise incurred in order to carry out the authorized purposes of the Community Facilities District; and
- ii. Any other expenses incidental to the performance and inspection of the authorized Services.

STATEMENT FROM THE DIRECTOR OF OFFICE OF ECONOMIC DEVELOPMENT (ACTING AS ELECTION OFFICIAL) TO THE BOARD OF SUPERVISORS AS TO THE CANVASS OF BALLOTS VOTED IN AND THE RESULTS OF THE CONSOLIDATED SPECIAL ELECTIONS FOR COMMUNITY FACILITIES DISTRICT NO. 25-5M (LEON RIDGE) OF THE COUNTY OF RIVERSIDE, STATE OF CALIFORNIA, HELD ON JANUARY 27, 2026.

I, Suzanne Holland, Director of Office of Economic Development of Riverside County, acting as the election official pursuant to Resolution No. 2026-004 adopted by the Board of Supervisors of Riverside County ("Board of Supervisors") on January 27, 2026 make the following statements regarding the consolidated special elections held within and for Community Facilities District No. 25-5M (Leon Ridge) of the County of Riverside, State of California (the "Community Facilities District"), on January 27, 2026 on (i) the proposition with respect to the annual levy of special taxes on taxable property within the Community Facilities District to fund, pay for, and finance authorized maintenance services for administration, inspection of street light maintenance, drainage, and to pay expenses incidental thereto and (ii) the proposition with respect to establishing an appropriations limit for the Community Facilities District:

(1) I have received a signed written waiver entitled "Petition, Waiver, and Consent" from the owner of all the land within the Community Facilities District ("Owner").

(2) The written waiver, among other matters, waived compliance with the provisions of Section 53326 of the Government Code to the effect that a special election with respect to the levy of special taxes within the Community Facilities District must be held at least ninety (90) days, but not more than one hundred eighty (180) days, following the adoption of the resolution of formation establishing the Community Facilities District and consented to the holding of the consolidated special elections on January 27, 2026.

(3) I have received a written certification from the Registrar of Voters of the County of Riverside, stating that there are no registered voters residing within the Community Facilities District. Accordingly, pursuant to Section 53326 of the Government Code, and as determined by the Board of Supervisors in Resolution No. 2026-004, the vote in the consolidated special elections was to be by the landowners of the Community Facilities District, with each landowner having one vote for each acre, or portion thereof, of land that he or she owns within the Community Facilities District.

(4) Pursuant to Resolution No. 2026-004, an Official Ballot together with a Ballot Pamphlet and Instructions to Voter containing Instructions to Landowner Voter, a Sample Ballot, and a copy of Resolution No. 2025-297 adopted by the Board of Supervisors on December 9, 2025, was delivered to the Owner. Also delivered to the Owner was an official identification envelope, with return postage affixed thereto, for returning the voted Official Ballot.

(5) Pursuant to Section 53326 of the Government Code, for purposes of the consolidated special elections, the Owner was entitled to one vote for each acre, or portion thereof, of land within the Community Facilities District which Owner owned. Based on the approximate acreage of land owned by the Owner within the Community Facilities District, Owner was entitled to the following votes.

<u>Owner</u>	<u>Acreage</u>	<u>Votes</u>
GM GABRYCH FAMILY LP GENUS LP, a California limited partnership GENUS LP, a California limited partnership EMPIRE COMMUNITIES, LLC, a California limited liability company	32.11	33
Totals	32.11	33

(6) The voted Official Ballot was returned to me by the Owner, sealed in aforementioned identification envelope, prior to 9:00 a.m. on January 27, 2026. Each returned ballot was voted with a cross marked in the box after the word "YES" following each proposition set forth on the ballot and had a signed statement attached that the signer was entitled to vote the ballot on behalf of the Owner named therein, and that it was the intent of that Owner to vote all votes to which it was entitled in the manner marked on the ballot. I have canvassed the ballots returned in the consolidated special elections, being the Official Ballot above referred to, and determined that the results of the elections with respect to each proposition set forth in the Official Ballot are as follows:

Proposition A: 33 YES votes, 0 NO votes

Proposition B: 33 YES votes, 0 NO votes

(7) More than two-thirds of the votes cast in the consolidated special elections are in favor of all such propositions.

Dated: January 27, 2026



SUZANNE HOLLAND
DIRECTOR
OFFICE OF ECONOMIC DEVELOPMENT
COUNTY OF RIVERSIDE
ELECTION OFFICIAL

STATEMENT FROM THE DIRECTOR OF OFFICE OF ECONOMIC DEVELOPMENT (ACTING AS ELECTION OFFICIAL) TO THE BOARD OF SUPERVISORS AS TO THE CANVASS OF BALLOTS VOTED IN AND THE RESULTS OF THE CONSOLIDATED SPECIAL ELECTIONS FOR COMMUNITY FACILITIES DISTRICT NO. 25-5M (LEON RIDGE) OF THE COUNTY OF RIVERSIDE, STATE OF CALIFORNIA, HELD ON JANUARY 27, 2026.

I, Suzanne Holland, Director of Office of Economic Development of Riverside County, acting as the election official pursuant to Resolution No. 2026-004 adopted by the Board of Supervisors of Riverside County ("Board of Supervisors") on January 27, 2026 make the following statements regarding the consolidated special elections held within and for Community Facilities District No. 25-5M (Leon Ridge) of the County of Riverside, State of California (the "Community Facilities District"), on January 27, 2026 on (i) the proposition with respect to the annual levy of special taxes on taxable property within the Community Facilities District to fund, pay for, and finance authorized maintenance services for administration, inspection of street light maintenance, drainage, and to pay expenses incidental thereto and (ii) the proposition with respect to establishing an appropriations limit for the Community Facilities District:

(1) I have received a signed written waiver entitled "Petition, Waiver, and Consent" from the owner of all the land within the Community Facilities District ("Owner").

(2) The written waiver, among other matters, waived compliance with the provisions of Section 53326 of the Government Code to the effect that a special election with respect to the levy of special taxes within the Community Facilities District must be held at least ninety (90) days, but not more than one hundred eighty (180) days, following the adoption of the resolution of formation establishing the Community Facilities District and consented to the holding of the consolidated special elections on January 27, 2026.

(3) I have received a written certification from the Registrar of Voters of the County of Riverside, stating that there are no registered voters residing within the Community Facilities District. Accordingly, pursuant to Section 53326 of the Government Code, and as determined by the Board of Supervisors in Resolution No. 2026-004, the vote in the consolidated special elections was to be by the landowners of the Community Facilities District, with each landowner having one vote for each acre, or portion thereof, of land that he or she owns within the Community Facilities District.

(4) Pursuant to Resolution No. 2026-004, an Official Ballot together with a Ballot Pamphlet and Instructions to Voter containing Instructions to Landowner Voter, a Sample Ballot, and a copy of Resolution No. 2025-297 adopted by the Board of Supervisors on December 9, 2025, was delivered to the Owner. Also delivered to the Owner was an official identification envelope, with return postage affixed thereto, for returning the voted Official Ballot.

(5) Pursuant to Section 53326 of the Government Code, for purposes of the consolidated special elections, the Owner was entitled to one vote for each acre, or portion thereof, of land within the Community Facilities District which Owner owned. Based on the approximate acreage of land owned by the Owner within the Community Facilities District, Owner was entitled to the following votes.

<u>Owner</u>	<u>Acreage</u>	<u>Votes</u>
Leon Ridge – Winchester, L.P. c/o Hearthstone, Inc.	18.06	19
Totals	18.06	19

(6) The voted Official Ballot was returned to me by the Owner, sealed in aforementioned identification envelope, prior to 9:00 a.m. on January 27, 2026. Each returned ballot was voted with a cross marked in the box after the word "YES" following each proposition set forth on the ballot and had a signed statement attached that the signer was entitled to vote the ballot on behalf of the Owner named therein, and that it was the intent of that Owner to vote all votes to which it was entitled in the manner marked on the ballot. I have canvassed the ballots returned in the consolidated special elections, being the Official Ballot above referred to, and determined that the results of the elections with respect to each proposition set forth in the Official Ballot are as follows:

Proposition A: 19 YES votes, 0 NO votes

Proposition B: 19 YES votes, 0 NO votes

(7) More than two-thirds of the votes cast in the consolidated special elections are in favor of all such propositions.

Dated: January 27, 2026



SUZANNE HOLLAND
DIRECTOR
OFFICE OF ECONOMIC DEVELOPMENT
COUNTY OF RIVERSIDE
ELECTION OFFICIAL

COPY

98/37

SHEET 1 OF 2 SHEETS

PROPOSED BOUNDARY MAP
COMMUNITY FACILITIES DISTRICT NO. 25-5M
(LEON RIDGE)
COUNTY OF RIVERSIDE, STATE OF CALIFORNIA

I HEREBY CERTIFY THAT THE WITHIN MAP SHOWING PROPOSED BOUNDARIES OF COMMUNITY FACILITIES DISTRICT NO. 25-5M (LEON RIDGE), COUNTY OF RIVERSIDE, STATE OF CALIFORNIA, WAS APPROVED BY THE BOARD OF SUPERVISORS AT A REGULAR MEETING THEREOF, HELD ON 9th DAY OF DEC, 2025, BY RESOLUTION NO. 2025-297

Kimberly A. Roberts
 CLERK OF THE BOARD OF SUPERVISORS
 COUNTY OF RIVERSIDE

FILED IN THE OFFICE OF THE CLERK OF THE BOARD OF SUPERVISORS OF THE COUNTY OF RIVERSIDE, STATE OF CALIFORNIA. THIS 9th DAY OF DEC, 2025.

Kimberly A. Roberts
 CLERK OF THE BOARD OF SUPERVISORS
 COUNTY OF RIVERSIDE



FILED THIS 17 DAY OF December, 2025 AT THE HOUR OF 12:23 O'CLOCK P.M. IN BOOK 98 OF MAPS OF ASSESSMENT AND COMMUNITY FACILITIES DISTRICTS AT PAGE 37-38, IN THE OFFICE OF THE COUNTY RECORDER, IN THE COUNTY OF RIVERSIDE, STATE OF CALIFORNIA.

FEE: \$11.00 NO.: 2025-0391475
 PETER ALDANA, ASSESSOR, COUNTY CLERK, RECORDER

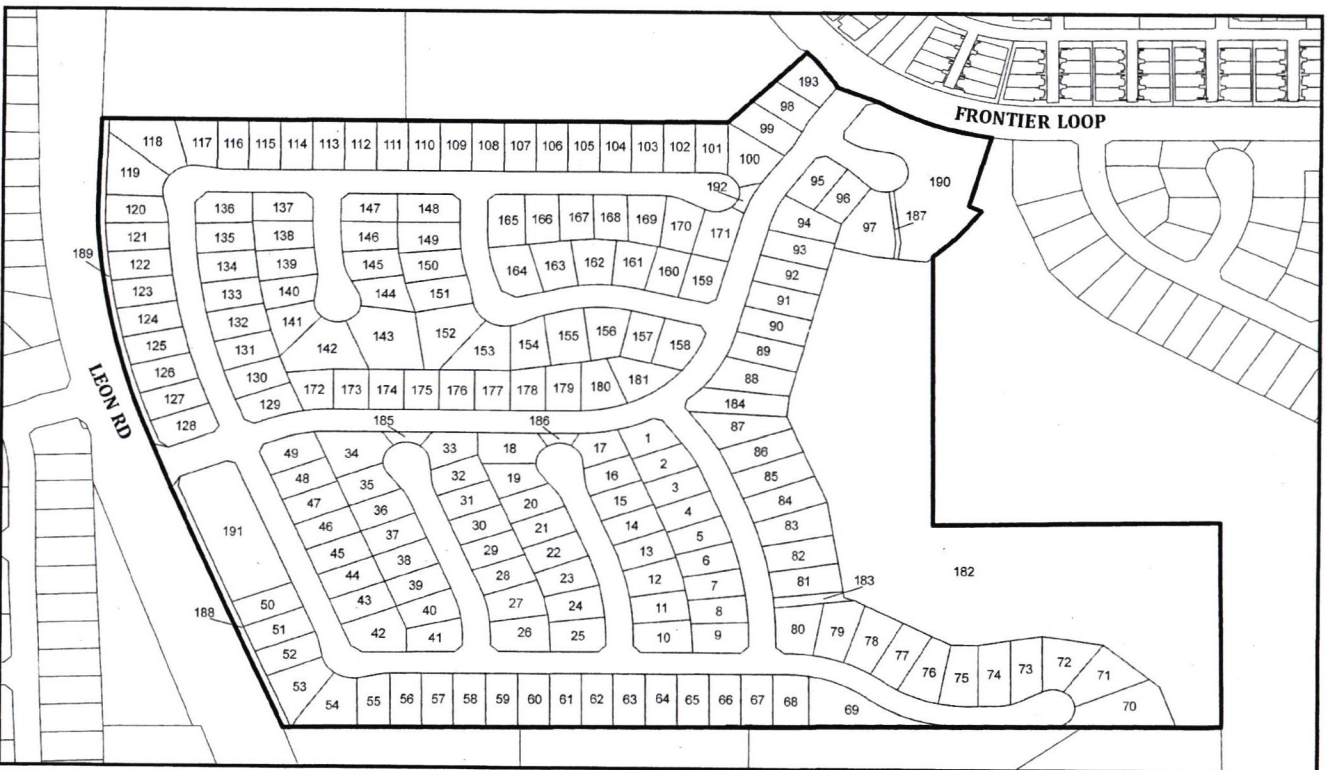
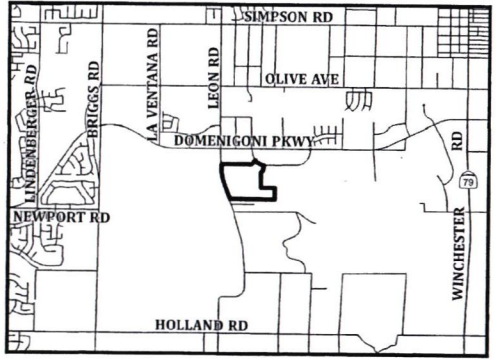
BY: Jackie [Signature]
 DEPUTY



LEGEND

-  CFD BOUNDARY
-  PARCEL LINE
- XXX-XXX-XXX ASSESSOR PARCEL NUMBER
- 1** MAP REFERENCE NUMBER

THIS BOUNDARY MAP CORRECTLY SHOWS THE LOT OR PARCEL OF LAND INCLUDED WITHIN THE BOUNDARIES OF THE COMMUNITY FACILITIES DISTRICT. FOR DETAILS CONCERNING THE LINES AND DIMENSIONS OF LOTS OR PARCEL REFER TO THE COUNTY ASSESSOR MAPS FOR FISCAL YEAR 2025-26.

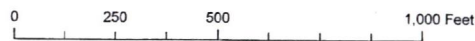

PROPOSED BOUNDARY MAP
COMMUNITY FACILITIES DISTRICT NO. 25-5M
(LEON RIDGE)
COUNTY OF RIVERSIDE, STATE OF CALIFORNIA

MAP REF.	APN	MAP REF.	APN	MAP REF.	APN	MAP REF.	APN	MAP REF.	APN
1	461-410-001	40	461-420-023	79	461-412-010	118	461-440-010	157	461-432-004
2	461-410-002	41	461-420-024	80	461-412-011	119	461-440-011	158	461-432-005
3	461-410-003	42	461-420-025	81	461-412-012	120	461-440-012	159	461-431-013
4	461-410-004	43	461-420-026	82	461-412-013	121	461-440-013	160	461-431-014
5	461-410-005	44	461-420-027	83	461-412-014	122	461-440-014	161	461-431-015
6	461-410-006	45	461-420-028	84	461-412-015	123	461-440-015	162	461-431-016
7	461-410-007	46	461-420-029	85	461-412-016	124	461-440-016	163	461-431-017
8	461-410-008	47	461-420-030	86	461-412-017	125	461-440-017	164	461-431-018
9	461-410-009	48	461-420-031	87	461-412-018	126	461-440-018	165	461-431-019
10	461-410-010	49	461-420-032	88	461-430-001	127	461-440-019	166	461-431-020
11	461-410-011	50	461-421-001	89	461-430-002	128	461-440-020	167	461-431-021
12	461-410-012	51	461-421-002	90	461-430-003	129	461-441-001	168	461-431-022
13	461-410-013	52	461-421-003	91	461-430-004	130	461-441-002	169	461-431-023
14	461-410-014	53	461-421-004	92	461-430-005	131	461-441-003	170	461-431-024
15	461-410-015	54	461-421-005	93	461-430-006	132	461-441-004	171	461-431-025
16	461-410-016	55	461-421-006	94	461-430-007	133	461-441-005	172	461-441-026
17	461-410-017	56	461-421-007	95	461-430-008	134	461-441-006	173	461-441-027
18	461-420-001	57	461-421-008	96	461-430-009	135	461-441-007	174	461-441-028
19	461-420-002	58	461-421-009	97	461-430-010	136	461-441-008	175	461-441-029
20	461-420-003	59	461-421-010	98	461-431-002	137	461-441-009	176	461-441-030
21	461-420-004	60	461-421-011	99	461-431-003	138	461-441-010	177	461-441-031
22	461-420-005	61	461-421-012	100	461-431-004	139	461-441-011	178	461-432-006
23	461-420-006	62	461-421-013	101	461-431-005	140	461-441-012	179	461-432-007
24	461-420-007	63	461-411-001	102	461-431-006	141	461-441-013	180	461-432-008
25	461-420-008	64	461-411-002	103	461-431-007	142	461-441-014	181	461-432-009
26	461-420-009	65	461-411-003	104	461-431-008	143	461-441-015	182	461-190-087
27	461-420-010	66	461-411-004	105	461-431-009	144	461-441-016	183	461-412-019
28	461-420-011	67	461-411-005	106	461-431-010	145	461-441-017	184	461-430-011
29	461-420-012	68	461-411-006	107	461-431-011	146	461-441-018	185	461-420-033
30	461-420-013	69	461-411-007	108	461-431-012	147	461-441-019	186	461-420-034
31	461-420-014	70	461-412-001	109	461-440-001	148	461-441-020	187	461-430-012
32	461-420-015	71	461-412-002	110	461-440-002	149	461-441-021	188	461-421-014
33	461-420-016	72	461-412-003	111	461-440-003	150	461-441-022	189	461-440-021
34	461-420-017	73	461-412-004	112	461-440-004	151	461-441-023	190	461-430-013
35	461-420-018	74	461-412-005	113	461-440-005	152	461-441-024	191	461-421-015
36	461-420-019	75	461-412-006	114	461-440-006	153	461-441-025	192	461-431-026
37	461-420-020	76	461-412-007	115	461-440-007	154	461-432-001	193	461-431-027
38	461-420-021	77	461-412-008	116	461-440-008	155	461-432-002		
39	461-420-022	78	461-412-009	117	461-440-009	156	461-432-003		